



Hudson Valley Research Park  
2070 Route 52  
Hopewell Junction, NY 12533-3507  
S. C. Hawkins, Z/325

November 30, 2009

Mr. Edwin Dassatti, P.E.  
Director, Bureau of Solid Waste and Corrective Action  
Division of Solid and Hazardous Materials  
New York State Department of Environmental Conservation  
625 Broadway, 9<sup>th</sup> Floor  
Albany, New York 12233-7250

RECEIVED  
NYSDEC

DEC 01 2009

Bureau of Hazardous Waste &  
Radiation Management  
Division of Solid & Hazardous Materials

Subject: Solid Waste Management Unit Inventory Update

Reference: IBM East Fishkill Corrective Action Program  
IBM East Fishkill Facility  
Hopewell Junction, New York  
NYSDEC Part 373 Permit 3-1323-0025-00249-0  
EPA ID No. NYD000707901

Dear Mr. Dassatti:

The purpose of this letter is to provide you with the required semiannual update of our Solid Waste Management Unit (SWMU) Inventory pursuant to Module III.C.1 and 2 of the above referenced Part 373 Permit. Six SWMUs were added to the facility inventory during this semiannual period of May 2009 through October 2009. Two of these tanks, #3988 and #3989, are newly identified SWMU(s) which were constructed prior to the issuance of the Part 373 Permit. Additional information for these two tanks will be submitted to your office within 30 days as required by the citation referenced above. Enclosed is an updated copy of the *NYSDEC Part 373 Permit Document, Module III Corrective Action, Map 1, Solid Waste Management Unit Location Map*, dated 11/25/09.

If you have any questions regarding this submittal, please contact Jackie Braungart at (845) 892-1672.

I certify under penalty of law that this document and all attachments were prepared under my direction or supervision in accordance with a system designed to assure that qualified personnel properly gather and evaluate the information submitted. Based on my inquiry of the person or persons who manage the system, or those persons directly responsible for gathering the information, the information submitted is, to the best of my knowledge and belief, true, accurate and complete. I am aware that there are significant penalties for submitting false information, including the possibility of fine and imprisonment for knowing violations.

Sincerely,  
International Business Machines Corporation

  
Steven C. Hawkins, Manager  
Environmental Regulatory Engineering

c: K. Brezner, NYSDEC Region 3, Regional Solid & Hazardous Materials Engineer  
J. Reidy, USEPA Region 2, New York Facilities (without enclosure)  
R. Schatz, ESDC (without enclosure)  
H. Wilkie, NYSDEC

**IBM East Fishkill Corrective Action Program**  
**IBM East Fishkill Facility**  
**Hopewell Junction, New York**  
**NYSDEC Part 373 Permit 3-1323-0025-00249-0**  
**EPA ID No. NYD000707901**

**Semiannual Solid Waste Management Unit (SWMU) Inventory Update**  
**May 2009 through October 2009**

Tank ID	Contents	Building	Above / Below	Inside / Outside	Secondary Containment	Capacity (gallons)	Dimensions	Material of Construction	Constructed / In Service Date	Unit Type	Function	Documented Release	Sampling Results	Groundwater Remediation Area
3988	Industrial Waste	323	Above	Inside	TBD	500	60" x 72"	FRP	circa 1985	Tank	Transfer	TBD	TBD	TBD
3989	Industrial Waste	323	Above	Inside	TBD	500	60" x 72"	FRP	circa 1985	Tank	Transfer	TBD	TBD	TBD
3995	Industrial Waste	323A	Above	Inside	Building Trench System	1000	66" x 84"	FRP	June-09	Tank	Holding	No	N/A	No
3996	Industrial Waste	323A	Above	Inside	Building Trench System	1000	66" x 84"	FRP	June-09	Tank	Holding	No	N/A	No
3997	Industrial Waste	323A	Above	Inside	Building Trench System	1000	66" x 84"	FRP	June-09	Tank	Holding	No	N/A	No
3998	Industrial Waste	323A	Above	Inside	Building Trench System	1000	66" x 84"	FRP	June-09	Tank	Holding	No	N/A	No



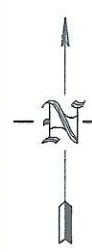

SOLID WASTE MANAGEMENT UNITS	
CG CONTAMINATED GROUNDWATER UNIT	----- ABOVE GROUND FLUORIDE PIPELINES
CS CONTAINER STORAGE/TRANSFER AREA	----- BELOW GROUND FLUORIDE PIPELINES
CW CONTAINER WASTE	----- ABOVE GROUND INDUSTRIAL WASTE PIPELINES
DB DUMPSTER BAY	----- BELOW GROUND INDUSTRIAL WASTE PIPELINES
IS DUMPSTER STORAGE AREA	----- ABOVE GROUND SOLVENT PIPELINES
FL FLUORIDE/HEAVY METALS WASTE UNIT	----- BELOW GROUND SOLVENT PIPELINES
HM HEAVY METALS	
IW INDUSTRIAL WASTE UNIT	
LP LANDFILL	□ ABOVE GROUND FLUORIDE BUILDING DRAINS
PE PERCHLOROETHYLENE RECYCLE UNIT	□ ABOVE GROUND INDUSTRIAL WASTE BUILDING DRAINS
PIW PRODUCTION WELL	□ ABOVE GROUND SOLVENT BUILDING DRAINS
SA SANITARY/TREATED INDUSTRIAL WASTE UNIT	□ BELOW GROUND BUILDING DRAINS (SOLVENT, FLUORIDE & IW WASTE)
SO SOLVENT WASTE UNIT	
SW SPILL WASTE UNIT	
TMH TMH WASTE UNIT	
TS TANK TRAILER STORAGE AREA	
NH4 AMMONIA WASTEWATER UNIT	
FP Filter Press	
L/U/L Tank Truck Loading/Unloading Area	
LS Lift Stations	

**LEGEND**  
--- IBM PROPERTY LINE  
--- TOPOGRAPHIC CONTOUR (5' INTERVAL)

**NOTES**  
1. FORMER IBM WEST COMPLEX/CURRENT PREI HOPEWELL JUNCTION ASSOCIATES FACILITY

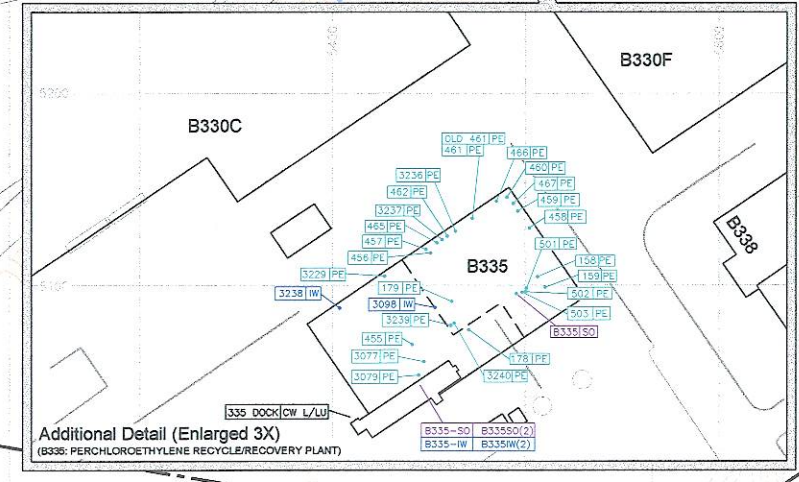
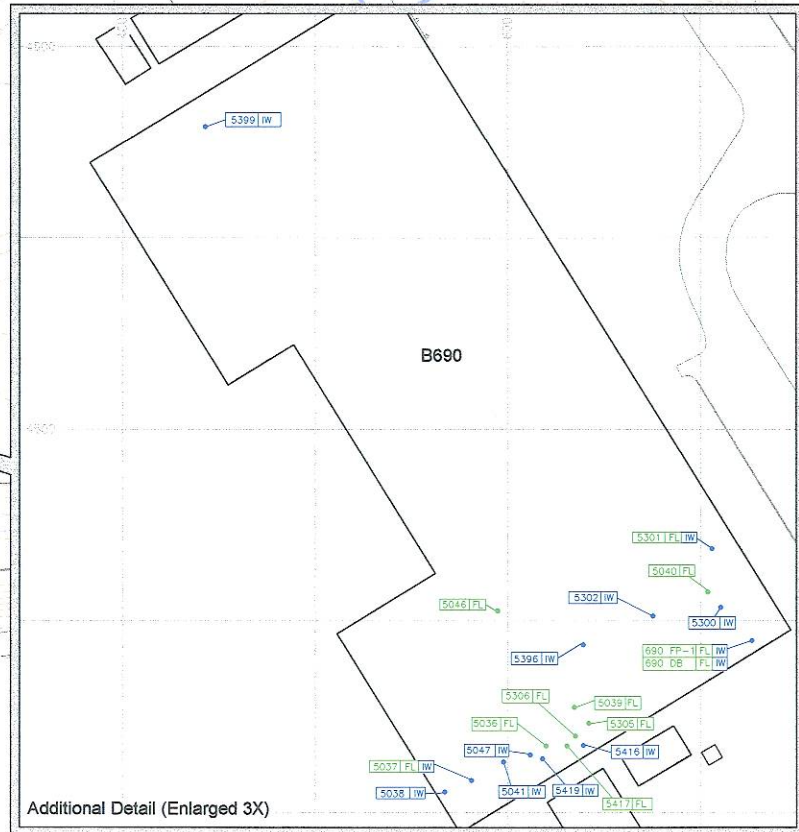
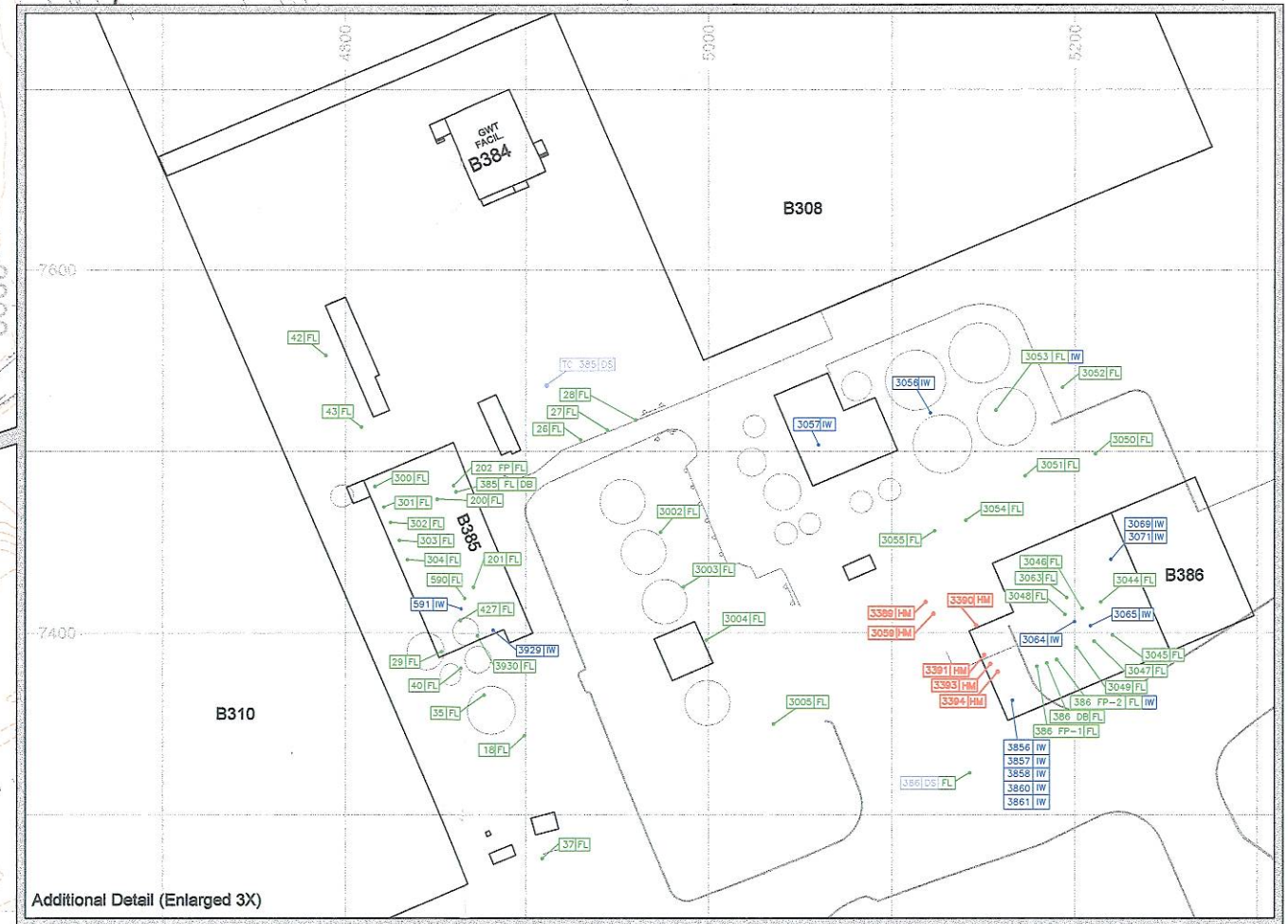

<b>IBM</b> EAST FISHKILL FACILITY DUTCHESS COUNTY, NEW YORK	
NYSDEC PART 373 PERMIT DOCUMENT	
MODULE III CORRECTIVE ACTION	
MAP 1	
SOLID WASTE MANAGEMENT	
UNIT LOCATION MAP	
D:\BWA\BWA\BWA.DWG	REVISIONS
CREATED 03/09/05 M. WEST, IBM CORP. (SHEPHERD MP&M)	
UPDATED 06/10/05 M. WEST, IBM CORP.	
UPDATED 09/04/07 C. BROWN	
UPDATED 11/06/09 C. BROWN	