



Sterling Environmental Engineering, P.C.

February 27, 2023

Mr. Daniel R. Lanners, P.E.
New York State Department of Environmental Conservation
Division of Environmental Remediation
Remedial Bureau C
625 Broadway, 11th Floor
Albany, New York 12233-7014

Email: daniel.lanners@dec.ny.gov

Subject: Groundwater Monitoring Report – First Quarter, 2023
Apple Valley Shopping Center
Freedom Plains Road, Dutchess County, LaGrange, New York
Site No. 314084
STERLING File #23008

Dear Mr. Lanners,

This letter report provides results of the 1st quarter groundwater monitoring event for 2023 performed by Sterling Environmental Engineering, P.C. (STERLING) at the Apple Valley Shopping Center (AVSC, or the “Site”) in LaGrange, New York on February 2, 2023.

Groundwater samples were collected from recovery wells AV-2, RW-3, and from the groundwater treatment system effluent discharge, AVS-EFF. Samples collected from the monitoring locations were analyzed for the following site-specific chlorinated volatile organic compounds (cVOC): tetrachloroethene (PCE), trichloroethene (TCE), cis-1,2-dichloroethene (DCE), and vinyl chloride. As reported in the November 8, 2022 status letter, recovery wells RW-1 and RW-2 are temporarily out of service pending repairs.

Treatment System Operations

For the period of December 14, 2022 (fourth quarter monitoring event) through February 2, 2023 (first quarter monitoring event), the treatment system recovered, treated, and discharged approximately 481,241 gallons of groundwater based on recorded system data. For the total period from startup of the system in May 2019 to this sample event, the system recovered, treated, and discharged approximately 12,259,897 gallons. Quarterly maintenance and inspection were performed during the monitoring event.

RW-1 and RW-2 remain temporarily out of service pending repairs. STERLING is coordinating with vendors to obtain pricing and confirm availability to jet and redevelop the wells prior to reinstalling the pumps.

Groundwater Sampling and Analysis: VOCs

Groundwater samples were collected from the sampling ports in the treatment system trailer directly into laboratory provided glassware. The sampling point for the treatment system effluent was collected directly from the discharge pipe. Samples were transported in a cooler with ice under chain of custody

“Serving our clients and the environment since 1993”

protocol to Alpha Analytical of Westborough, MA for analysis of site-specific cVOCs by USEPA Method 8260C.

Groundwater Sampling and Laboratory Analytical Results

Analytical results for collected samples are summarized in Table 1 and the analytical report is included in Attachment A.

Table 1 – February 2, 2023 Groundwater Monitoring Sample Results

ANALYTE	Regulatory Standard µg/L	AV-2	RW-1	RW-2	RW-3	AVS-EFF
Tetrachloroethene (PCE)	5	170	NS	NS	170	0.31 J
Vinyl chloride	2	0.09 J	NS	NS	0.07 J	0.07 U
Trichloroethene (TCE)	5	15	NS	NS	16	0.18 U
cis-1,2-Dichloroethene (DCE)	5	26	NS	NS	27	0.70 U
Total VOCs	--	211.09 J	NS	NS	213.07 J	0.31 J

Notes: Regulatory Standard is New York TOGS 1.1.1 Ambient Water Quality Standards, June 2004

Bold and highlighted concentrations exceed applicable regulatory standard.

U – Not Detected (ND). The analyte was analyzed for, but was not detected above the reported sample quantitation limit.

J – Concentration is above the laboratory method detection limit but below the reporting limit and is estimated.

NS – Not Sampled

Recovery Wells – Concentrations of PCE, TCE, and DCE were detected above the TOGS 1.1.1 Water Quality Standards and Guidance Values of 5 µg/l in groundwater samples collected from AV-2 and RW-3.

Effluent Discharge – Concentrations of site-specific cVOCs were all below TOGS 1.1.1 Water Quality Standards and Guidance Values for sample AVS-EFF indicating proper operation of the treatment system.

Conclusions and Discussion

Site-specific cVOCs exist in recovered onsite groundwater at concentrations above the TOGS 1.1.1 Water Quality Standards and Guidance Values, which is consistent with prior monitoring events.

The effluent discharge sample (AVS-EFF) contained no cVOC concentrations above the TOGS 1.1.1 Water Quality Standards and Guidance Values confirming that the treatment system is functioning properly.

STERLING will provide a schedule for repairing and reinstalling the pumps in recovery wells RW-1 and RW-2 once a subcontractor is retained.

The next monitoring is scheduled for the second quarter of 2023 consisting of the following:

- Sampling recovery wells and treatment system effluent.
- Sampling of monitoring wells MW-2 and MW-7.
- Onsite maintenance and cleaning of the treatment system.

Please contact me should you have any questions.

Very Truly Yours,

STERLING ENVIRONMENTAL ENGINEERING, P.C.



Mark P. Millspaugh, P.E.
President

Mark.Millspaugh@sterlingenvironmental.com

MPM/am

Via Email

Attachments: Figure 1 – Site Location Map
Figure 2 – Selected Site Features
Attachment A – Laboratory Analytical Report

cc: David Engel, Esq.

FIGURES

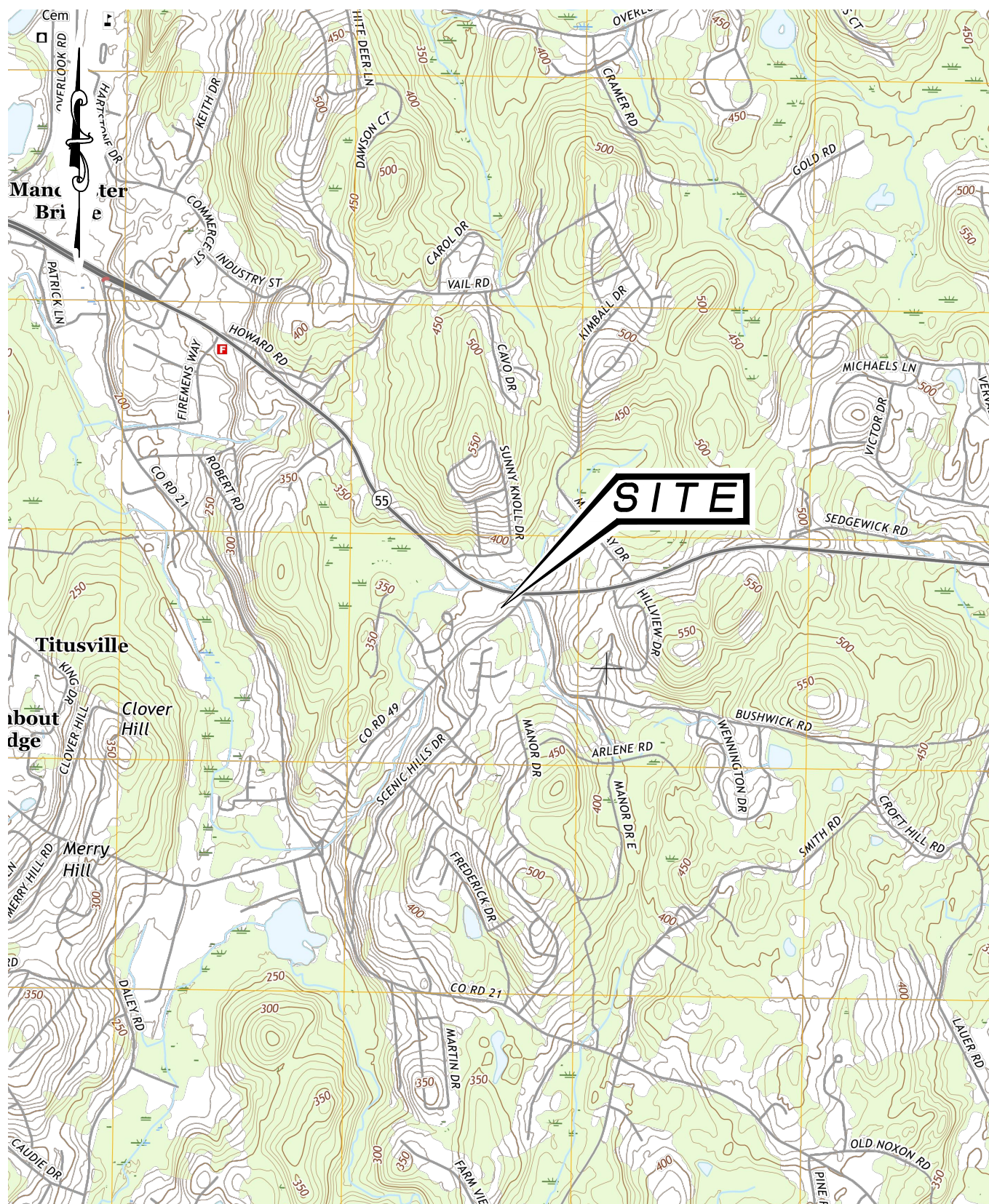

STERLING

Sterling Environmental Engineering, P.C.

24 Wade Road ♦ Latham, New York 12110

SITE LOCATION MAP
APPLE VALLEY SHOPPING CENTER
FREEDOM PLAINS ROAD

TOWN OF LAGRANGE

DUTCHESS CO., N.Y.

PROJ. No.:	23008	DATE:	9/25/2019	SCALE:	1" = 2000'	DWG. NO.	23008001	FIGURE	1
------------	-------	-------	-----------	--------	------------	----------	----------	--------	---

S:\Sterling\Projects\2003 Projects\Apple Valley - 23008\Drawings-Maps-Figures\CAD\23008028 - F2 - Selected Site Features Map (NO GWLE).dwg CAD 1/18/2022 10:54 AM



* LOT 6 AND 379 TITUSVILLE ROAD RESIDENCES ARE NOT ON MUNICIPAL WATER SUPPLY AND OBTAINS WATER FROM ONSITE WELL.

- MW-5 MONITORING WELL
- ▲ AV-2 ■ RW-1 RECOVERY WELL
- P-3 PIEZOMETER
- ◆ SUB-SLAB VAPOR MONITORING POINT

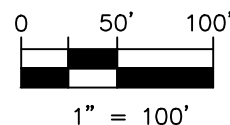

MAP REFERENCE: DISCOVER GIS DATA NY, 2016 ORTHOIMAGERY

STERLING

Sterling Environmental Engineering, P.C.

24 Wade Road • Latham, New York 12110

SELECTED SITE FEATURES MAP
APPLE VALLEY SHOPPING CENTER
FREEDOM PLAINS ROAD

TOWN OF LAGRANGE

DUTCHESS CO., NY

PROJ. No.: 23008 | DATE: 01/18/2022 | SCALE: 1" = 100' | DWG. NO. 23008028 | FIGURE 2

ATTACHMENT A
LABORATORY ANALYTICAL REPORT



ANALYTICAL REPORT

Lab Number:	L2305913
Client:	Sterling Environmental Engineering 24 Wade Road Latham, NY 12110
ATTN:	Andrew Millspaugh
Phone:	(518) 456-4900
Project Name:	APPLE VALLEY SHOPPING CENTER
Project Number:	23008
Report Date:	02/08/23

The original project report/data package is held by Alpha Analytical. This report/data package is paginated and should be reproduced only in its entirety. Alpha Analytical holds no responsibility for results and/or data that are not consistent with the original.

Certifications & Approvals: MA (M-MA086), NH NELAP (2064), CT (PH-0574), IL (200077), ME (MA00086), MD (348), NJ (MA935), NY (11148), NC (25700/666), PA (68-03671), RI (LAO00065), TX (T104704476), VT (VT-0935), VA (460195), USDA (Permit #P330-17-00196).

Eight Walkup Drive, Westborough, MA 01581-1019
508-898-9220 (Fax) 508-898-9193 800-624-9220 - www.alphalab.com



Project Name: APPLE VALLEY SHOPPING CENTER
Project Number: 23008

Lab Number: L2305913
Report Date: 02/08/23

Alpha Sample ID	Client ID	Matrix	Sample Location	Collection Date/Time	Receive Date
L2305913-01	AVS-EFF	WATER	LAGRANGE, NY	02/02/23 09:30	02/02/23
L2305913-02	RW-3	WATER	LAGRANGE, NY	02/02/23 10:05	02/02/23
L2305913-03	AV-2	WATER	LAGRANGE, NY	02/02/23 10:10	02/02/23
L2305913-04	TB02022023	WATER	LAGRANGE, NY	02/02/23 00:00	02/02/23

Project Name: APPLE VALLEY SHOPPING CENTER
Project Number: 23008

Lab Number: L2305913
Report Date: 02/08/23

Case Narrative

The samples were received in accordance with the Chain of Custody and no significant deviations were encountered during the preparation or analysis unless otherwise noted. Sample Receipt, Container Information, and the Chain of Custody are located at the back of the report.

Results contained within this report relate only to the samples submitted under this Alpha Lab Number and meet NELAP requirements for all NELAP accredited parameters unless otherwise noted in the following narrative. The data presented in this report is organized by parameter (i.e. VOC, SVOC, etc.). Sample specific Quality Control data (i.e. Surrogate Spike Recovery) is reported at the end of the target analyte list for each individual sample, followed by the Laboratory Batch Quality Control at the end of each parameter. Tentatively Identified Compounds (TICs), if requested, are reported for compounds identified to be present and are not part of the method/program Target Compound List, even if only a subset of the TCL are being reported. If a sample was re-analyzed or re-extracted due to a required quality control corrective action and if both sets of data are reported, the Laboratory ID of the re-analysis or re-extraction is designated with an "R" or "RE", respectively.

When multiple Batch Quality Control elements are reported (e.g. more than one LCS), the associated samples for each element are noted in the grey shaded header line of each data table. Any Laboratory Batch, Sample Specific % recovery or RPD value that is outside the listed Acceptance Criteria is bolded in the report. In reference to questions H (CAM) or 4 (RCP) when "NO" is checked, the performance criteria for CAM and RCP methods allow for some quality control failures to occur and still be within method compliance. In these instances, the specific failure is not narrated but noted in the associated QC Outlier Summary Report, located directly after the Case Narrative. QC information is also incorporated in the Data Usability Assessment table (Format 11) of our Data Merger tool, where it can be reviewed in conjunction with the sample result, associated regulatory criteria and any associated data usability implications.

Soil/sediments, solids and tissues are reported on a dry weight basis unless otherwise noted. Definitions of all data qualifiers and acronyms used in this report are provided in the Glossary located at the back of the report.

HOLD POLICY - For samples submitted on hold, Alpha's policy is to hold samples (with the exception of Air canisters) free of charge for 21 calendar days from the date the project is completed. After 21 calendar days, we will dispose of all samples submitted including those put on hold unless you have contacted your Alpha Project Manager and made arrangements for Alpha to continue to hold the samples. Air canisters will be disposed after 3 business days from the date the project is completed.

Please contact Project Management at 800-624-9220 with any questions.

Project Name: APPLE VALLEY SHOPPING CENTER
Project Number: 23008

Lab Number: L2305913
Report Date: 02/08/23

Case Narrative (continued)

Report Submission

All non-detect (ND) or estimated concentrations (J-qualified) have been quantitated to the limit noted in the MDL column.

I, the undersigned, attest under the pains and penalties of perjury that, to the best of my knowledge and belief and based upon my personal inquiry of those responsible for providing the information contained in this analytical report, such information is accurate and complete. This certificate of analysis is not complete unless this page accompanies any and all pages of this report.

Authorized Signature:



Cristin Walker

Title: Technical Director/Representative

Date: 02/08/23

ORGANICS

VOLATILES

Project Name: APPLE VALLEY SHOPPING CENTER
Project Number: 23008

Lab Number: L2305913
Report Date: 02/08/23

SAMPLE RESULTS

Lab ID: L2305913-01
Client ID: AVS-EFF
Sample Location: LAGRANGE, NY

Date Collected: 02/02/23 09:30
Date Received: 02/02/23
Field Prep: Not Specified

Sample Depth:

Matrix: Water
Analytical Method: 1,8260D
Analytical Date: 02/06/23 15:05
Analyst: MJV

Parameter	Result	Qualifier	Units	RL	MDL	Dilution Factor
Volatile Organics by GC/MS - Westborough Lab						
Tetrachloroethene	0.31	J	ug/l	0.50	0.18	1
Vinyl chloride	ND		ug/l	1.0	0.07	1
Trichloroethene	ND		ug/l	0.50	0.18	1
cis-1,2-Dichloroethene	ND		ug/l	2.5	0.70	1

Surrogate	% Recovery	Qualifier	Acceptance Criteria
1,2-Dichloroethane-d4	126		70-130
Toluene-d8	98		70-130
4-Bromofluorobenzene	107		70-130
Dibromofluoromethane	125		70-130

Project Name: APPLE VALLEY SHOPPING CENTER
Project Number: 23008

Lab Number: L2305913
Report Date: 02/08/23

SAMPLE RESULTS

Lab ID: L2305913-02
Client ID: RW-3
Sample Location: LAGRANGE, NY

Date Collected: 02/02/23 10:05
Date Received: 02/02/23
Field Prep: Not Specified

Sample Depth:

Matrix: Water
Analytical Method: 1,8260D
Analytical Date: 02/07/23 14:20
Analyst: LAC

Parameter	Result	Qualifier	Units	RL	MDL	Dilution Factor
Volatile Organics by GC/MS - Westborough Lab						
Tetrachloroethene	220	E	ug/l	0.50	0.18	1
Vinyl chloride	ND		ug/l	1.0	0.07	1
Trichloroethene	16		ug/l	0.50	0.18	1
cis-1,2-Dichloroethene	27		ug/l	2.5	0.70	1

Surrogate	% Recovery	Qualifier	Acceptance Criteria
1,2-Dichloroethane-d4	104		70-130
Toluene-d8	100		70-130
4-Bromofluorobenzene	102		70-130
Dibromofluoromethane	94		70-130

Project Name: APPLE VALLEY SHOPPING CENTER
Project Number: 23008

Lab Number: L2305913
Report Date: 02/08/23

SAMPLE RESULTS

Lab ID: L2305913-02 D
Client ID: RW-3
Sample Location: LAGRANGE, NY

Date Collected: 02/02/23 10:05
Date Received: 02/02/23
Field Prep: Not Specified

Sample Depth:

Matrix: Water
Analytical Method: 1,8260D
Analytical Date: 02/06/23 14:40
Analyst: MJV

Parameter	Result	Qualifier	Units	RL	MDL	Dilution Factor
-----------	--------	-----------	-------	----	-----	-----------------

Volatile Organics by GC/MS - Westborough Lab						
--	--	--	--	--	--	--

Tetrachloroethene	170		ug/l	1.2	0.45	2.5
-------------------	-----	--	------	-----	------	-----

Surrogate	% Recovery	Qualifier	Acceptance Criteria
1,2-Dichloroethane-d4	114		70-130
Toluene-d8	100		70-130
4-Bromofluorobenzene	108		70-130
Dibromofluoromethane	114		70-130

Project Name: APPLE VALLEY SHOPPING CENTER
Project Number: 23008

Lab Number: L2305913
Report Date: 02/08/23

SAMPLE RESULTS

Lab ID: L2305913-03
Client ID: AV-2
Sample Location: LAGRANGE, NY

Date Collected: 02/02/23 10:10
Date Received: 02/02/23
Field Prep: Not Specified

Sample Depth:

Matrix: Water
Analytical Method: 1,8260D
Analytical Date: 02/07/23 14:40
Analyst: LAC

Parameter	Result	Qualifier	Units	RL	MDL	Dilution Factor
Volatile Organics by GC/MS - Westborough Lab						
Tetrachloroethene	220	E	ug/l	0.50	0.18	1
Vinyl chloride	0.09	J	ug/l	1.0	0.07	1
Trichloroethene	15		ug/l	0.50	0.18	1
cis-1,2-Dichloroethene	26		ug/l	2.5	0.70	1

Surrogate	% Recovery	Qualifier	Acceptance Criteria
1,2-Dichloroethane-d4	105		70-130
Toluene-d8	99		70-130
4-Bromofluorobenzene	104		70-130
Dibromofluoromethane	100		70-130

Project Name: APPLE VALLEY SHOPPING CENTER
Project Number: 23008

Lab Number: L2305913
Report Date: 02/08/23

SAMPLE RESULTS

Lab ID: L2305913-03 D
 Client ID: AV-2
 Sample Location: LAGRANGE, NY

Date Collected: 02/02/23 10:10
 Date Received: 02/02/23
 Field Prep: Not Specified

Sample Depth:

Matrix: Water
 Analytical Method: 1,8260D
 Analytical Date: 02/06/23 14:16
 Analyst: MJV

Parameter	Result	Qualifier	Units	RL	MDL	Dilution Factor
-----------	--------	-----------	-------	----	-----	-----------------

Volatile Organics by GC/MS - Westborough Lab						
--	--	--	--	--	--	--

Tetrachloroethene	170		ug/l	1.2	0.45	2.5
-------------------	-----	--	------	-----	------	-----

Surrogate	% Recovery	Qualifier	Acceptance Criteria
1,2-Dichloroethane-d4	115		70-130
Toluene-d8	101		70-130
4-Bromofluorobenzene	105		70-130
Dibromofluoromethane	116		70-130

Project Name: APPLE VALLEY SHOPPING CENTER
Project Number: 23008

Lab Number: L2305913
Report Date: 02/08/23

SAMPLE RESULTS

Lab ID: L2305913-04
Client ID: TB02022023
Sample Location: LAGRANGE, NY

Date Collected: 02/02/23 00:00
Date Received: 02/02/23
Field Prep: Not Specified

Sample Depth:

Matrix: Water
Analytical Method: 1,8260D
Analytical Date: 02/06/23 13:51
Analyst: PID

Parameter	Result	Qualifier	Units	RL	MDL	Dilution Factor
Volatile Organics by GC/MS - Westborough Lab						
Tetrachloroethene	ND		ug/l	0.50	0.18	1
Vinyl chloride	ND		ug/l	1.0	0.07	1
Trichloroethene	ND		ug/l	0.50	0.18	1
cis-1,2-Dichloroethene	ND		ug/l	2.5	0.70	1

Surrogate	% Recovery	Qualifier	Acceptance Criteria
1,2-Dichloroethane-d4	125		70-130
Toluene-d8	99		70-130
4-Bromofluorobenzene	106		70-130
Dibromofluoromethane	129		70-130

Project Name: APPLE VALLEY SHOPPING CENTER
Project Number: 23008

Lab Number: L2305913
Report Date: 02/08/23

Method Blank Analysis
Batch Quality Control

Analytical Method: 1,8260D
 Analytical Date: 02/06/23 09:46
 Analyst: PID

Parameter	Result	Qualifier	Units	RL	MDL
Volatile Organics by GC/MS - Westborough Lab for sample(s): 01-04 Batch: WG1741609-5					
Tetrachloroethene	ND		ug/l	0.50	0.18
Vinyl chloride	ND		ug/l	1.0	0.07
Trichloroethene	ND		ug/l	0.50	0.18
cis-1,2-Dichloroethene	ND		ug/l	2.5	0.70

Surrogate	%Recovery	Qualifier	Acceptance Criteria
1,2-Dichloroethane-d4	115		70-130
Toluene-d8	99		70-130
4-Bromofluorobenzene	107		70-130
Dibromofluoromethane	124		70-130

Project Name: APPLE VALLEY SHOPPING CENTER
Project Number: 23008

Lab Number: L2305913
Report Date: 02/08/23

Method Blank Analysis
Batch Quality Control

Analytical Method: 1,8260D
 Analytical Date: 02/07/23 07:59
 Analyst: PID

Parameter	Result	Qualifier	Units	RL	MDL
Volatile Organics by GC/MS - Westborough Lab for sample(s): 02-03 Batch: WG1741944-5					
Tetrachloroethene	ND		ug/l	0.50	0.18
Vinyl chloride	ND		ug/l	1.0	0.07
Trichloroethene	ND		ug/l	0.50	0.18
cis-1,2-Dichloroethene	ND		ug/l	2.5	0.70

Surrogate	%Recovery	Qualifier	Acceptance Criteria
1,2-Dichloroethane-d4	113		70-130
Toluene-d8	102		70-130
4-Bromofluorobenzene	96		70-130
Dibromofluoromethane	108		70-130

Lab Control Sample Analysis

Batch Quality Control

Project Name: APPLE VALLEY SHOPPING CENTER

Project Number: 23008

Lab Number: L2305913

Report Date: 02/08/23

Parameter	LCS %Recovery	Qual	LCSD %Recovery	Qual	%Recovery Limits	RPD	Qual	RPD Limits
Volatile Organics by GC/MS - Westborough Lab Associated sample(s): 01-04 Batch: WG1741609-3 WG1741609-4								
Tetrachloroethene	91		96		70-130	5		20
Vinyl chloride	100		110		55-140	10		20
Trichloroethene	90		95		70-130	5		20
cis-1,2-Dichloroethene	100		100		70-130	0		20

Surrogate	LCS %Recovery	Qual	LCSD %Recovery	Qual	Acceptance Criteria
1,2-Dichloroethane-d4	111		109		70-130
Toluene-d8	103		103		70-130
4-Bromofluorobenzene	99		104		70-130
Dibromofluoromethane	112		109		70-130

Lab Control Sample Analysis

Batch Quality Control

Project Name: APPLE VALLEY SHOPPING CENTER

Project Number: 23008

Lab Number: L2305913

Report Date: 02/08/23

Parameter	LCS %Recovery	Qual	LCSD %Recovery	Qual	%Recovery Limits	RPD	Qual	RPD Limits
Volatile Organics by GC/MS - Westborough Lab Associated sample(s): 02-03 Batch: WG1741944-3 WG1741944-4								
Tetrachloroethene	96		89		70-130	8		20
Vinyl chloride	88		90		55-140	2		20
Trichloroethene	95		92		70-130	3		20
cis-1,2-Dichloroethene	89		90		70-130	1		20

Surrogate	LCS %Recovery	Qual	LCSD %Recovery	Qual	Acceptance Criteria
1,2-Dichloroethane-d4	109		109		70-130
Toluene-d8	105		102		70-130
4-Bromofluorobenzene	95		96		70-130
Dibromofluoromethane	102		107		70-130

Project Name: APPLE VALLEY SHOPPING CENTER**Lab Number:** L2305913**Project Number:** 23008**Report Date:** 02/08/23**Sample Receipt and Container Information**

Were project specific reporting limits specified?

YES

Cooler Information**Cooler** **Custody Seal**

A Absent

Container Information

Container ID	Container Type	Cooler	Initial pH	Final pH	Temp deg C	Pres	Seal	Frozen Date/Time	Analysis(*)
L2305913-01A	Vial HCl preserved	A	NA		4.7	Y	Absent		NYTCL-8260-R2(14)
L2305913-01B	Vial HCl preserved	A	NA		4.7	Y	Absent		NYTCL-8260-R2(14)
L2305913-01C	Vial HCl preserved	A	NA		4.7	Y	Absent		NYTCL-8260-R2(14)
L2305913-02A	Vial HCl preserved	A	NA		4.7	Y	Absent		NYTCL-8260-R2(14)
L2305913-02B	Vial HCl preserved	A	NA		4.7	Y	Absent		NYTCL-8260-R2(14)
L2305913-02C	Vial HCl preserved	A	NA		4.7	Y	Absent		NYTCL-8260-R2(14)
L2305913-03A	Vial HCl preserved	A	NA		4.7	Y	Absent		NYTCL-8260-R2(14)
L2305913-03B	Vial HCl preserved	A	NA		4.7	Y	Absent		NYTCL-8260-R2(14)
L2305913-03C	Vial HCl preserved	A	NA		4.7	Y	Absent		NYTCL-8260-R2(14)
L2305913-04A	Vial HCl preserved	A	NA		4.7	Y	Absent		NYTCL-8260-R2(14)
L2305913-04B	Vial HCl preserved	A	NA		4.7	Y	Absent		NYTCL-8260-R2(14)

Project Name: APPLE VALLEY SHOPPING CENTER
Project Number: 23008

Lab Number: L2305913
Report Date: 02/08/23

GLOSSARY

Acronyms

DL	- Detection Limit: This value represents the level to which target analyte concentrations are reported as estimated values, when those target analyte concentrations are quantified below the limit of quantitation (LOQ). The DL includes any adjustments from dilutions, concentrations or moisture content, where applicable. (DoD report formats only.)
EDL	- Estimated Detection Limit: This value represents the level to which target analyte concentrations are reported as estimated values, when those target analyte concentrations are quantified below the reporting limit (RL). The EDL includes any adjustments from dilutions, concentrations or moisture content, where applicable. The use of EDLs is specific to the analysis of PAHs using Solid-Phase Microextraction (SPME).
EMPC	- Estimated Maximum Possible Concentration: The concentration that results from the signal present at the retention time of an analyte when the ions meet all of the identification criteria except the ion abundance ratio criteria. An EMPC is a worst-case estimate of the concentration.
EPA	- Environmental Protection Agency.
LCS	- Laboratory Control Sample: A sample matrix, free from the analytes of interest, spiked with verified known amounts of analytes or a material containing known and verified amounts of analytes.
LCSD	- Laboratory Control Sample Duplicate: Refer to LCS.
LFB	- Laboratory Fortified Blank: A sample matrix, free from the analytes of interest, spiked with verified known amounts of analytes or a material containing known and verified amounts of analytes.
LOD	- Limit of Detection: This value represents the level to which a target analyte can reliably be detected for a specific analyte in a specific matrix by a specific method. The LOD includes any adjustments from dilutions, concentrations or moisture content, where applicable. (DoD report formats only.)
LOQ	- Limit of Quantitation: The value at which an instrument can accurately measure an analyte at a specific concentration. The LOQ includes any adjustments from dilutions, concentrations or moisture content, where applicable. (DoD report formats only.) Limit of Quantitation: The value at which an instrument can accurately measure an analyte at a specific concentration. The LOQ includes any adjustments from dilutions, concentrations or moisture content, where applicable. (DoD report formats only.)
MDL	- Method Detection Limit: This value represents the level to which target analyte concentrations are reported as estimated values, when those target analyte concentrations are quantified below the reporting limit (RL). The MDL includes any adjustments from dilutions, concentrations or moisture content, where applicable.
MS	- Matrix Spike Sample: A sample prepared by adding a known mass of target analyte to a specified amount of matrix sample for which an independent estimate of target analyte concentration is available. For Method 332.0, the spike recovery is calculated using the native concentration, including estimated values.
MSD	- Matrix Spike Sample Duplicate: Refer to MS.
NA	- Not Applicable.
NC	- Not Calculated: Term is utilized when one or more of the results utilized in the calculation are non-detect at the parameter's reporting unit.
NDPA/DPA	- N-Nitrosodiphenylamine/Diphenylamine.
NI	- Not Ignitable.
NP	- Non-Plastic: Term is utilized for the analysis of Atterberg Limits in soil.
NR	- No Results: Term is utilized when 'No Target Compounds Requested' is reported for the analysis of Volatile or Semivolatile Organic TIC only requests.
RL	- Reporting Limit: The value at which an instrument can accurately measure an analyte at a specific concentration. The RL includes any adjustments from dilutions, concentrations or moisture content, where applicable.
RPD	- Relative Percent Difference: The results from matrix and/or matrix spike duplicates are primarily designed to assess the precision of analytical results in a given matrix and are expressed as relative percent difference (RPD). Values which are less than five times the reporting limit for any individual parameter are evaluated by utilizing the absolute difference between the values; although the RPD value will be provided in the report.
SRM	- Standard Reference Material: A reference sample of a known or certified value that is of the same or similar matrix as the associated field samples.
STLP	- Semi-dynamic Tank Leaching Procedure per EPA Method 1315.
TEF	- Toxic Equivalency Factors: The values assigned to each dioxin and furan to evaluate their toxicity relative to 2,3,7,8-TCDD.
TEQ	- Toxic Equivalent: The measure of a sample's toxicity derived by multiplying each dioxin and furan by its corresponding TEF and then summing the resulting values.
TIC	- Tentatively Identified Compound: A compound that has been identified to be present and is not part of the target compound list (TCL) for the method and/or program. All TICs are qualitatively identified and reported as estimated concentrations.

Report Format: DU Report with 'J' Qualifiers



Project Name: APPLE VALLEY SHOPPING CENTER
Project Number: 23008

Lab Number: L2305913
Report Date: 02/08/23

Footnotes

- 1 - The reference for this analyte should be considered modified since this analyte is absent from the target analyte list of the original method.

Terms

Analytical Method: Both the document from which the method originates and the analytical reference method. (Example: EPA 8260B is shown as 1,8260B.) The codes for the reference method documents are provided in the References section of the Addendum.

Chlordane: The target compound Chlordane (CAS No. 57-74-9) is reported for GC ECD analyses. Per EPA, this compound "refers to a mixture of chlordane isomers, other chlorinated hydrocarbons and numerous other components." (Reference: USEPA Toxicological Review of Chlordane, In Support of Summary Information on the Integrated Risk Information System (IRIS), December 1997.)

Difference: With respect to Total Oxidizable Precursor (TOP) Assay analysis, the difference is defined as the Post-Treatment value minus the Pre-Treatment value.

Final pH: As it pertains to Sample Receipt & Container Information section of the report, Final pH reflects pH of container determined after adjustment at the laboratory, if applicable. If no adjustment required, value reflects Initial pH.

Frozen Date/Time: With respect to Volatile Organics in soil, Frozen Date/Time reflects the date/time at which associated Reagent Water-preserved vials were initially frozen. Note: If frozen date/time is beyond 48 hours from sample collection, value will be reflected in 'bold'.

Gasoline Range Organics (GRO): Gasoline Range Organics (GRO) results include all chromatographic peaks eluting from Methyl tert butyl ether through Naphthalene, with the exception of GRO analysis in support of State of Ohio programs, which includes all chromatographic peaks eluting from Hexane through Dodecane.

Initial pH: As it pertains to Sample Receipt & Container Information section of the report, Initial pH reflects pH of container determined upon receipt, if applicable.

PAH Total: With respect to Alkylated PAH analyses, the 'PAHs, Total' result is defined as the summation of results for all or a subset of the following compounds: Naphthalene, C1-C4 Naphthalenes, 2-Methylnaphthalene, 1-Methylnaphthalene, Biphenyl, Acenaphthylene, Acenaphthene, Fluorene, C1-C3 Fluorenes, Phenanthrene, C1-C4 Phenanthrenes/Anthracenes, Anthracene, Fluoranthene, Pyrene, C1-C4 Fluoranthenes/Pyrenes, Benz(a)anthracene, Chrysene, C1-C4 Chrysenes, Benzo(b)fluoranthene, Benzo(j)+(k)fluoranthene, Benzo(e)pyrene, Benzo(a)pyrene, Perylene, Indeno(1,2,3-cd)pyrene, Dibenz(ah)+(ac)anthracene, Benzo(g,h,i)perylene. If a 'Total' result is requested, the results of its individual components will also be reported.

PFAS Total: With respect to PFAS analyses, the 'PFAS, Total (5)' result is defined as the summation of results for: PFHpA, PFHxS, PFOA, PFNA and PFOS. In addition, the 'PFAS, Total (6)' result is defined as the summation of results for: PFHpA, PFHxS, PFOA, PFNA, PFDA and PFOS. For MassDEP DW compliance analysis only, the 'PFAS, Total (6)' result is defined as the summation of results at or above the RL. Note: If a 'Total' result is requested, the results of its individual components will also be reported.

Total: With respect to Organic analyses, a 'Total' result is defined as the summation of results for individual isomers or Aroclors. If a 'Total' result is requested, the results of its individual components will also be reported. This is applicable to 'Total' results for methods 8260, 8081 and 8082.

Data Qualifiers

- A** - Spectra identified as "Aldol Condensates" are byproducts of the extraction/concentration procedures when acetone is introduced in the process.
- B** - The analyte was detected above the reporting limit in the associated method blank. Flag only applies to associated field samples that have detectable concentrations of the analyte at less than ten times (10x) the concentration found in the blank. For MCP-related projects, flag only applies to associated field samples that have detectable concentrations of the analyte at less than ten times (10x) the concentration found in the blank. For DOD-related projects, flag only applies to associated field samples that have detectable concentrations of the analyte at less than ten times (10x) the concentration found in the blank AND the analyte was detected above one-half the reporting limit (or above the reporting limit for common lab contaminants) in the associated method blank. For NJ-Air-related projects, flag only applies to associated field samples that have detectable concentrations of the analyte above the reporting limit. For NJ-related projects (excluding Air), flag only applies to associated field samples that have detectable concentrations of the analyte, which was detected above the reporting limit in the associated method blank or above five times the reporting limit for common lab contaminants (Phthalates, Acetone, Methylene Chloride, 2-Butanone).
- C** - Co-elution: The target analyte co-elutes with a known lab standard (i.e. surrogate, internal standards, etc.) for co-extracted analyses.
- D** - Concentration of analyte was quantified from diluted analysis. Flag only applies to field samples that have detectable concentrations of the analyte.
- E** - Concentration of analyte exceeds the range of the calibration curve and/or linear range of the instrument.
- F** - The ratio of quantifier ion response to qualifier ion response falls outside of the laboratory criteria. Results are considered to be an estimated maximum concentration.
- G** - The concentration may be biased high due to matrix interferences (i.e. co-elution) with non-target compound(s). The result should be considered estimated.
- H** - The analysis of pH was performed beyond the regulatory-required holding time of 15 minutes from the time of sample collection.
- I** - The lower value for the two columns has been reported due to obvious interference.
- J** - Estimated value. The Target analyte concentration is below the quantitation limit (RL), but above the Method Detection Limit (MDL) or Estimated Detection Limit (EDL) for SPME-related analyses. This represents an estimated concentration for Tentatively

Report Format: DU Report with 'J' Qualifiers



Project Name: APPLE VALLEY SHOPPING CENTER
Project Number: 23008

Lab Number: L2305913
Report Date: 02/08/23

Data Qualifiers

Identified Compounds (TICs).

- M** - Reporting Limit (RL) exceeds the MCP CAM Reporting Limit for this analyte.
- ND** - Not detected at the method detection limit (MDL) for the sample, or estimated detection limit (EDL) for SPME-related analyses.
- NJ** - Presumptive evidence of compound. This represents an estimated concentration for Tentatively Identified Compounds (TICs), where the identification is based on a mass spectral library search.
- P** - The RPD between the results for the two columns exceeds the method-specified criteria.
- Q** - The quality control sample exceeds the associated acceptance criteria. For DOD-related projects, LCS and/or Continuing Calibration Standard exceedences are also qualified on all associated sample results. Note: This flag is not applicable for matrix spike recoveries when the sample concentration is greater than 4x the spike added or for batch duplicate RPD when the sample concentrations are less than 5x the RL. (Metals only.)
- R** - Analytical results are from sample re-analysis.
- RE** - Analytical results are from sample re-extraction.
- S** - Analytical results are from modified screening analysis.
- V** - The surrogate associated with this target analyte has a recovery outside the QC acceptance limits. (Applicable to MassDEP DW Compliance samples only.)
- Z** - The batch matrix spike and/or duplicate associated with this target analyte has a recovery/RPD outside the QC acceptance limits. (Applicable to MassDEP DW Compliance samples only.)

Report Format: DU Report with 'J' Qualifiers



Project Name: APPLE VALLEY SHOPPING CENTER
Project Number: 23008

Lab Number: L2305913
Report Date: 02/08/23

REFERENCES

- 1 Test Methods for Evaluating Solid Waste: Physical/Chemical Methods. EPA SW-846. Third Edition. Updates I - VI, 2018.

LIMITATION OF LIABILITIES

Alpha Analytical performs services with reasonable care and diligence normal to the analytical testing laboratory industry. In the event of an error, the sole and exclusive responsibility of Alpha Analytical shall be to re-perform the work at it's own expense. In no event shall Alpha Analytical be held liable for any incidental, consequential or special damages, including but not limited to, damages in any way connected with the use of, interpretation of, information or analysis provided by Alpha Analytical.

We strongly urge our clients to comply with EPA protocol regarding sample volume, preservation, cooling, containers, sampling procedures, holding time and splitting of samples in the field.



Alpha Analytical, Inc.Facility: **Company-wide**Department: **Quality Assurance**Title: **Certificate/Approval Program Summary**ID No.: **17873**

Revision 19

Published Date: 4/2/2021 1:14:23 PM

Page 1 of 1

Certification Information

The following analytes are not included in our Primary NELAP Scope of Accreditation:

Westborough Facility**EPA 624/624.1:** m/p-xylene, o-xylene, Naphthalene**EPA 625/625.1:** alpha-Terpineol**EPA 8260C/8260D:** NPW: 1,2,4,5-Tetramethylbenzene; 4-Ethyltoluene, Azobenzene; SCM: Iodomethane (methyl iodide), 1,2,4,5-Tetramethylbenzene; 4-Ethyltoluene.**EPA 8270D/8270E:** NPW: Dimethylnaphthalene, 1,4-Diphenylhydrazine, alpha-Terpineol; SCM: Dimethylnaphthalene, 1,4-Diphenylhydrazine.**SM4500:** NPW: Amenable Cyanide; SCM: Total Phosphorus, TKN, NO₂, NO₃.**Mansfield Facility****SM 2540D:** TSS**EPA 8082A:** NPW: PCB: 1, 5, 31, 87, 101, 110, 141, 151, 153, 180, 183, 187.**EPA TO-15:** Halothane, 2,4,4-Trimethyl-2-pentene, 2,4,4-Trimethyl-1-pentene, Thiophene, 2-Methylthiophene,

3-Methylthiophene, 2-Ethylthiophene, 1,2,3-Trimethylbenzene, Indan, Indene, 1,2,4,5-Tetramethylbenzene, Benzothiophene, 1-Methylnaphthalene.

Biological Tissue Matrix: EPA 3050B

The following analytes are included in our Massachusetts DEP Scope of Accreditation

Westborough Facility:**Drinking Water****EPA 300.0:** Chloride, Nitrate-N, Fluoride, Sulfate; **EPA 353.2:** Nitrate-N, Nitrite-N; **SM4500NO3-F:** Nitrate-N, Nitrite-N; **SM4500F-C, SM4500CN-CE,****EPA 180.1, SM2130B, SM4500CI-D, SM2320B, SM2540C, SM4500H-B, SM4500NO2-B****EPA 332:** Perchlorate; **EPA 524.2:** THMs and VOCs; **EPA 504.1:** EDB, DBCP.**Microbiology:** **SM9215B; SM9223-P/A, SM9223B-Colilert-QT, SM9222D.****Non-Potable Water****SM4500H,B, EPA 120.1, SM2510B, SM2540C, SM2320B, SM4500CL-E, SM4500F-BC, SM4500NH3-BH:** Ammonia-N and Kjeldahl-N, **EPA 350.1:**Ammonia-N, **LACHAT 10-107-06-1-B:** Ammonia-N, **EPA 351.1, SM4500NO3-F, EPA 353.2:** Nitrate-N, **SM4500P-E, SM4500P-B, E, SM4500SO4-E,****SM5220D, EPA 410.4, SM5210B, SM5310C, SM4500CL-D, EPA 1664, EPA 420.1, SM4500-CN-CE, SM2540D, EPA 300:** Chloride, Sulfate, Nitrate.**EPA 624.1:** Volatile Halocarbons & Aromatics,**EPA 608.3:** Chlordane, Toxaphene, Aldrin, alpha-BHC, beta-BHC, gamma-BHC, delta-BHC, Dieldrin, DDD, DDE, DDT, Endosulfan I, Endosulfan II,

Endosulfan sulfate, Endrin, Endrin Aldehyde, Heptachlor, Heptachlor Epoxide, PCBs

EPA 625.1: SVOC (Acid/Base/Neutral Extractables), **EPA 600/4-81-045:** PCB-Oil.**Microbiology:** **SM9223B-Colilert-QT; Enterolert-QT, SM9221E, EPA 1600, EPA 1603, SM9222D.****Mansfield Facility:****Drinking Water****EPA 200.7:** Al, Ba, Cd, Cr, Cu, Fe, Mn, Ni, Na, Ag, Ca, Zn. **EPA 200.8:** Al, Sb, As, Ba, Be, Cd, Cr, Cu, Pb, Mn, Ni, Se, Ag, TL, Zn. **EPA 245.1 Hg.****EPA 522, EPA 537.1.****Non-Potable Water****EPA 200.7:** Al, Sb, As, Be, Cd, Ca, Cr, Co, Cu, Fe, Pb, Mg, Mn, Mo, Ni, K, Se, Ag, Na, Sr, TL, Ti, V, Zn.**EPA 200.8:** Al, Sb, As, Be, Cd, Cr, Cu, Fe, Pb, Mn, Ni, K, Se, Ag, Na, TL, Zn.**EPA 245.1 Hg.****SM2340B**

For a complete listing of analytes and methods, please contact your Alpha Project Manager.

ALPHA LABORATORY	NEW YORK CHAIN OF CUSTODY	Service Centers Mahwah, NJ 07430: 35 Whitney Rd, Suite 5 Albany, NY 12205: 14 Walker Way Tonawanda, NY 14150: 275 Cooper Ave, Suite 105	Page 1 of 1		Date Rec'd in Lab	2/3/23	ALPHA Job # L2305913
Westborough, MA 01581 8 Walkup Dr. TEL: 508-898-9220 FAX: 508-898-9193		Mansfield, MA 02048 320 Forbes Blvd TEL: 508-822-9300 FAX: 508-822-3268	Project Information		Deliverables	Billing Information	
Client Information		Project Name:		ASP-A <input checked="" type="checkbox"/> ASP-B <input type="checkbox"/> <input type="checkbox"/> EQulS (1 File) <input checked="" type="checkbox"/> EQulS (4 File) <input type="checkbox"/> Other		Same as Client Info <input checked="" type="checkbox"/>	
Client: Sterling Env		(Use Project name as Project #) <input type="checkbox"/>		Regulatory Requirement		Disposal Site Information	
Address: 24 Wacker Rd Lothan NY 12110		Project Manager: Andrew Millsbaugh		<input checked="" type="checkbox"/> NY TOGS <input type="checkbox"/> NY Part 375 <input type="checkbox"/> AWQ Standards <input type="checkbox"/> NY CP-51 <input type="checkbox"/> NY Restricted Use <input type="checkbox"/> Other <input type="checkbox"/> NY Unrestricted Use <input type="checkbox"/> NYC Sewer Discharge		Please identify below location of applicable disposal facilities.	
Phone: 518 456-4900		Turn-Around Time				Disposal Facility: <input type="checkbox"/> NJ <input type="checkbox"/> NY <input type="checkbox"/> Other:	
Fax:		Standard <input checked="" type="checkbox"/>		Due Date:			
Email:		Rush (only if pre approved) <input type="checkbox"/>		# of Days:			
These samples have been previously analyzed by Alpha <input type="checkbox"/>							
Other project specific requirements/comments: andrewmillsbaugh@sterlingenvironmental.com paul.scholar@sterlingenvironmental.com Please specify Metals or TAL. *Report Only: PCE, TCE, cis 12 DCE, Vinyl Chloride							
ALPHA Lab ID (Lab Use Only)	Sample ID	Collection Date	Time	Sample Matrix	Sampler's Initials	ANALYSIS	
05913-01	AV5-EFF	2-2-23	930	GW	PWS	X	
-02	RW-3	↓	1005	↓	↓	X	
-03	AV-2	↓	1010	↓	↓	X	
-04	TB02022023	↓	-	LW	↓	X	
(Signature across rows)							
Preservative Code: A = None B = HCl C = HNO ₃ D = H ₂ SO ₄ E = NaOH F = MeOH G = NaHSO ₄ H = Na ₂ S ₂ O ₃ K/E = Zn Ac/NaOH O = Other		Container Code: P = Plastic A = Amber Glass V = Vial G = Glass B = Bacteria Cup C = Cube O = Other E = Encore D = BOD Bottle		Westboro: Certification No: MA935 Mansfield: Certification No: MA015			
		Relinquished By:		Date/Time	Received By:		
		Date/Time		Date/Time			
		2-2-23		2/2/23 1550			
		2/2/23 1550		2/3/23 0000			
Form No: 01-25 HC (rev. 30-Sept-2013)							