

EBIZNEWDOC



EBIZNEWDOC

Write or Copy/Paste Document Title In This Space

Report.HW.336025.01-22-2008.SVIairMonitoringResults

DO NOT PHOTOCOPY. PRINT FROM PDF VERSION ONLY.



EBIZNEWDOC

EBIZNEWDOC



Ecosystems Strategies, Inc.

24 Davis Avenue, Poughkeepsie, New York 12603-2332

Environmental Services and Solutions

TEL: 845-452-1658 • FAX: 845-485-7083

•EMAIL: mail@ecosystemsstrategies.com

IAMP STATUS REPORT

TO: PAUL OLIVO - USEPA
FROM: PAUL H. CIMINELLO, PRESIDENT
DATE: JANUARY 22, 2008
RE: WALLKILL WELLFIELD SITE, MIDDLETOWN, NEW YORK
INTERIM REPORT FOR THE SECOND ROUND OF INDOOR AIR
QUALITY TESTING
ESI FILE: LM97145.41

The purpose of this Status Report is to provide you with pertinent information on the recently completed air quality testing prior to the completion of the Indoor Air Quality Report, which will be completed after receipt of the Data Validation Report. As agreed in verbal communications, Ecosystems Strategies, Inc. (ESI) is providing these data in anticipation of a technical project meeting later this month.

Crawl-space and sub-slab vapor testing was completed at five residences located near the Walkill Wellfield property during the first week of December 2007. A map showing the locations of all homes sampled in this round is included as Attachment A of this status report. Summa canisters fitted with 24-hour flow regulators were placed on December 3 and December 4, 2007. All sampling activities were done in accordance with the Indoor Air Monitoring Plan (IAMP), prepared by ESI, dated October 22, 2007 (Revised November 27, 2007).

Mr. Douglas Auld of Malcolm Pirnie (representative of the USEPA) was present during the sub-slab vapor sampling at 324 Highland Avenue Extension on December 3, 2007.

Crawl-space air and sub-slab vapor testing was completed at four of ten residences (313, 319, 325, and 327, Highland Avenue Extension) where previous permission had been granted for the testing. In addition, permission was obtained to complete testing at 324 Highland Avenue Extension. Several attempts were made by ESI to schedule testing at the other six residences without success. ESI also attempted to contact other nearby residents while on-site in December. To date, none of the other residents contacted has given permission for testing.

Results (in $\mu\text{g}/\text{m}^3$, except for helium) from the previous sampling event in March 2006 and the current sampling event (December 2007) are as follows:

Ecosystems Strategies, Inc.*Environmental Services and Solutions***IAMP STATUS REPORT**

JANUARY 22, 2008

ESI FILE: LM97145.41

Page 2 of 2

House Number on Highland Avenue Extension	Sample Identification									
	313	319		324	325	327		334	Outside	Duplicate
Date	12/07	3/06	12/07	12/07	12/07	3/06	12/07	3/06	12/07	12/07
1,1-Dichloroethene	ND	ND	ND	ND	ND	ND	ND	ND	ND	ND
1,2-Dichloroethane	ND	ND	ND	ND	ND	ND	ND	ND	ND	ND
1,2-Dichloroethene (total)	ND	NA	ND	1.6	ND	NA	ND	NA	ND	ND
Cis-1,2-Dichloroethene	ND	ND	ND	1.6	ND	ND	ND	4.4	ND	ND
Tetrachloroethene	ND	19.9	ND	2.1	ND	20.3	ND	26.0	ND	ND
Trans-1,2-Dichloroethene	ND	ND	ND	ND	ND	ND	ND	ND	ND	ND
Trichloroethene	ND	1.86 J	ND	ND	ND	1.86	ND	3.61 J	ND	ND
Vinyl Chloride	ND	ND	ND	1.4	ND	ND	ND	ND	ND	ND
Total Target Analytes	ND	21.76	ND	6.7	ND	22.6	ND	34.01	ND	ND
Helium (%)	2.8	NA	NA	7.3	NA	NA	NA	ND	NA	NA

ND= Not Detected

NA= Not Applicable

J = the concentration given is an approximate value.

PCE concentrations in samples collected in March 2006 ranged from 19.9 $\mu\text{g}/\text{m}^3$ to 26.0 $\mu\text{g}/\text{m}^3$; however, in December both of the same houses had non-detectable levels of PCE. 324 Highland Avenue Extension, which adjoins the Site to the west of the site, had a total target analyte level of 6.7 $\mu\text{g}/\text{m}^3$ and a PCE level of 2.1 $\mu\text{g}/\text{m}^3$. Concentrations at this level will not generally constitute a threat to air quality within the living areas of the residences. All other residences tested in December 2007 had non-detectable levels for all of the compounds of concern. A complete data package as provided by the laboratory is included as Attachment B of this status report.

PHC:edl:cpr

Attachments:

- A Sampling Location Map
- B Laboratory Results

cc: W. Stern
M. Baker, Esq.
File

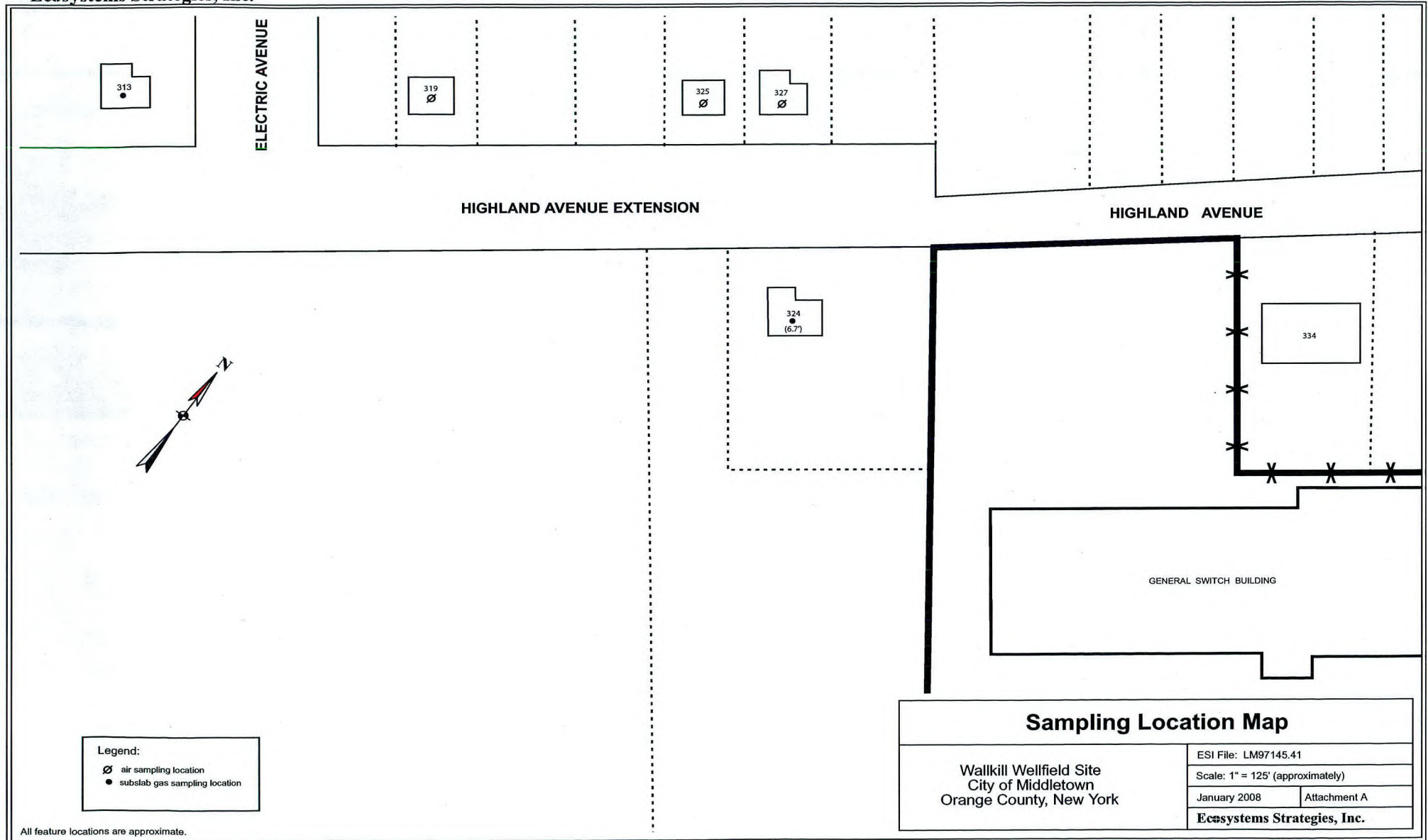

TestAmerica
South Burlington, VT

**Sample Data Summary
Package**

SDG: 123356