

**FACT SHEET****State Superfund
Program****Receive Site Fact Sheets by *Email*.** See "For More Information" to Learn How.

Site Name: Ramapo Paint Sludge Site
DEC Site #: 344064
Address: Route 17
Ramapo, NY 10911

Have questions?
See
"Who to Contact"
Below

Interim Remedial Measure to Begin for Operable Unit

The New York State Department of Environmental Conservation (NYSDEC) and the Ford Motor Company (the Remedial Party identified for the site) are proposing an expedited cleanup for Operable Unit 1 (OU-1) of the Ramapo Paint Sludge Site ("site") located at Route 17, Ramapo, Rockland County. Please see the map for the site location. Documents related to the cleanup of this site can be found at the locations identified below under "Where to Find Information."

Interim Remedial Measure (IRM) Work Plan

An IRM is a cleanup activity performed when a source of contamination or exposure pathway (the way in which a person may contact contamination) can be effectively addressed without extensive investigation and evaluation.

The IRM work plan describes the proposed cleanup activities for OU-1 that include:

Removal of visible paint sludge and soil that exceeds the soil cleanup objective for lead and volatile organic compounds (benzene, toluene, ethylbenzene, xylenes, acetone) for restricted residential land use. Approximately 10,000 cubic yards of contaminated soil and paint sludge will be excavated from three areas and properly disposed of off-site. An approved community air monitoring plan will be employed during all ground intrusive activities at the site to protect public health. Dewatering will be conducted as necessary to allow for removal of paint sludge and contaminated soil. The water will be treated to NYS Groundwater standards and be allowed to infiltrate back into the ground in a constructed recharge basin. Post excavation samples of the side walls and floor of the excavation area will be collected and submitted for analysis to confirm the limits of the contamination. The excavation will be backfilled with clean gravel or soil that meets soil cleanup objectives.

In addition, an area of riverbank (approximately 200 feet by 50 feet) will be addressed. The riverbank will be removed and backfilled with material meeting unrestricted or ecological soil cleanup objectives. The site and the river bank will be restored to enhance the ecological habitat of the excavation area.

Following completion of the construction activities a Construction Completion Report will be prepared.

Summary of the Investigation

The Ramapo Paint Sludge OU-1 site is the North of Ramapo Well Field area where paint sludge waste deposits have been identified. The site is primarily undeveloped and contains a portion of the United Water Well Field. The Remedial Investigation was completed in September 2010 and identified paint sludge deposits and contaminated soil. Contaminants include volatile organic compounds (benzene, toluene, ethylbenzene, xylenes, acetone) above the unrestricted Soil Cleanup Objectives. Inorganics (metals, lead and arsenic) were also noted above the unrestricted Soil Cleanup Objectives. Groundwater investigations did not indicate site related contamination of shallow groundwater. In the Fall of 2012, an area of paint sludge was also observed along the bank of the Ramapo River following erosion from Hurricane Irene.

A public availability session was held on March 24, 2011 to present the findings of the Remedial Investigation Report. The Department accepted Ford Motor Company's proposal for an IRM in OU-1 in July 2011 and the remedial design has been ongoing since.

Additional site details, including environmental and health assessment summaries, are available on NYSDEC's website at:

<http://www.dec.ny.gov/cfm/external/derexternal/haz/details.cfm?pageid=3&progno=344064>

State Superfund Program: New York's State Superfund Program (SSF) identifies and characterizes suspected inactive hazardous waste disposal sites. Sites that pose a significant threat to public health and/or the environment go through a process of investigation, evaluation, cleanup and monitoring.

NYSDEC attempts to identify parties responsible for site contamination and require cleanup before committing State funds.

For more information about the SSF, visit: <http://www.dec.ny.gov/chemical/8439.html>

FOR MORE INFORMATION

Where to Find Information

Project documents are available at the following locations to help the public stay informed.

Finkelstein Memorial Library
24 Chestnut St
Spring Valley, NY 10977
phone: (845) 352-5700

Village of Hillburn
Village Hall
31 Mountain Avenue
Hillburn, NY 10931
phone: (845) 357-2036

Town of Ramapo
Department of Public Works
Attn: Edward Dzurinko
16 Pioneer Avenue
Tallman, NY 10982
phone: (845) 357-0591

Who to Contact

Comments and questions are always welcome and should be directed as follows:

Project Related Questions

Bill Bennett
Department of Environmental Conservation
Division of Environmental Remediation
625 Broadway
Albany, NY 12233-7014
518-402-9659
wbbennet@gw.dec.state.ny.us

Site-Related Health Questions

Anthony Perretta
New York State Department of Health
Empire State Plaza Corning Tower, Room 1787
Albany, NY 12237
518-402-7880
BEEI@health.state.ny.us

We encourage you to share this fact sheet with neighbors and tenants, and/or post this fact sheet in a prominent area of your building for others to see.

Receive Site Fact Sheets by Email

Have site information such as this fact sheet sent right to your email inbox. NYSDEC invites you to sign up with one or more contaminated sites county email listservs available at the following web page:
<http://www.dec.ny.gov/chemical/61092.html>. It's quick, it's free, and it will help keep you *better informed*.



As a listserv member, you will periodically receive site-related information/announcements for all contaminated sites in the county(ies) you select.

Note: Please disregard if you already have signed up and received this fact sheet electronically.

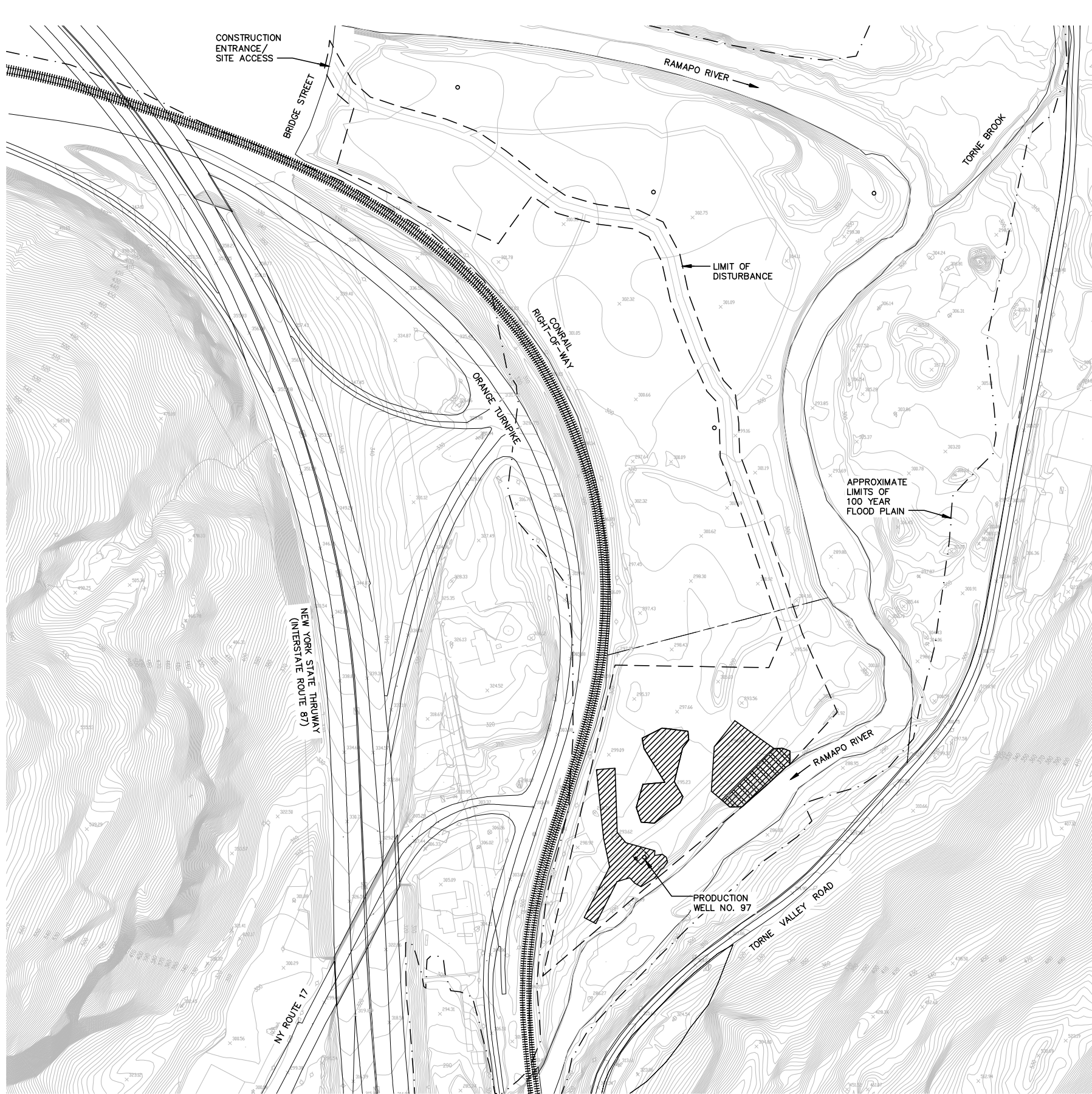

- LEGEND
- LIMIT OF EXCAVATION
 - STREAM BANK RESTORATION
 - UNITED WATER PRODUCTION WELL
 - EXISTING CONTOUR
 - EXISTING SPOT ELEVATION
 - PROPERTY BOUNDARY
 - LIMITS OF DISTURBANCE
 - FENCE LINE
 - APPROXIMATE LIMITS OF 100 YEAR FLOOD PLAIN

INTERIM REMEDIAL MEASURE WORK PLAN FOR PAINT SLUDGE
REMOVAL WITHIN OU-1 RAMAPO PAINT SLUDGE SITE
RAMAPO, NEW YORK

RAMAPO PAINT SLUDGE SITE OU-1



FIGURE
2

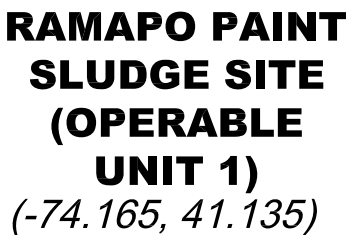

NEW YORK

QUADRANGLE LOCATION

QUADRANGLE LOCATION



1