

From: "Jones, Michael" <Michael.Jones@arcadis-us.com>
To: Douglas MacNeal <dkmacnea@gw.dec.state.ny.us>
CC: "Morgan, James F." <James.F.Morgan@nationalgrid.com>, "Evans, Allen" <Al...>
Date: 9/16/2013 3:19 PM
Subject: National Grid North Albany Former MGP Site - Water Line Replacement Activities
Attachments: 36648B02-1.pdf; soilNationalGrid.pdf; water2NationalGrid.pdf

Doug:

This e-mail presents a summary of the water main replacement activities at the National Grid former MGP site on August 28, 2013. A leak in the water main that extends from Broadway to Building 2 was discovered when National Grid employees reported for work on the morning of 8/29. The leak resulted in water backing up in the parking area located in front of the main entrance at the west end of Building 2 and flooding within an elevator shaft located adjacent to the building entrance. Upon discovery of the water main leak, the water supply to the building was shut off and the following contractors were mobilized to the site to locate and replace the leaking section of piping:

Keller's Backhoe (Excavation Contractor)
Environmental Products and Services (Spill Response Contractor)
BPI Piping (Pumping and Flushing of Piping System)

In addition, ARCADIS mobilized an engineer to the site to observe the pipe replacement efforts and Adirondack Environmental mobilized a technician to conduct air monitoring and collect waste characterization samples.

Beginning at approximately 1 PM on 8/29, efforts were made to locate the leak in the water main. A section of the asphalt pavement in the parking area was saw cut and removed with an excavator. An approximately 6-foot deep by 6-foot diameter hole was excavated to locate and uncover the suspected leaking section of pipe. The location of the excavation (approximately 20 feet west of the building near the main entrance) is shown on the attached figure. Soil within the excavation was completely saturated and a trench box was utilized to maintain the excavation side walls. Standing water within the excavation was removed using a vacuum truck and inspection of the pipe revealed two holes which were identified as the source of the leak. The section of the pipe with the holes was then cut out and replaced. The piping was then flushed and tested prior to backfilling the excavation with clean imported gravel fill. The excavation area will be repaved to restore the parking area surface.

Air monitoring was conducted by Adirondack using a photoionization detector (PID) during the excavation activities. No elevated PID measurements or noticeable odors were encountered during the excavation activities. ARCADIS' onsite engineer noted the presence of a slight sheen on the surface of water within the excavation; however, the source of the sheen is not known.

All excavated soil and the saw cut asphalt were containerize in a roll-off container for off-site disposal. Waste characterization results for the excavated soil are attached. The soil will be transported for offsite landfill disposal as a non-hazardous waste.

All water removed from the excavation and from the elevator pit inside the building was containerized in two Frac Tanks. Waste characterization results for the containerized water are attached. The water will be transported to an industrial waste treatment facility for treatment/disposal.

Please do not hesitate to contact me or Jim Morgan if you have any questions or need additional information.

Regards,
Michael Jones |Vice President|
michael.jones@arcadis-us.com<mailto:firstname.lastname@arcadis-us.com>
ARCADIS U.S., Inc. | 6723 Towpath Road, Box 66 |Syracuse, NY 13214

T. 315.671.9211| M. 315.247.3244| F.315.449.4111
www.arcadis-us.com<<http://www.arcadis-us.com/>>
Professional Affiliate/ARCADIS of New York, Inc.
ARCADIS, Imagine the result
Please consider the environment before printing this email.

[ARCADIS 125 Logo]

NOTICE: This e-mail and any files transmitted with it are the property of ARCADIS U.S., Inc. and its affiliates. All rights, including without limitation copyright, are reserved. The proprietary information contained in this e-mail message, and any files transmitted with it, is intended for the use of the recipient(s) named above. If the reader of this e-mail is not the intended recipient, you are hereby notified that you have received this e-mail in error and that any review, distribution or copying of this e-mail or any files transmitted with it is strictly prohibited. If you have received this e-mail in error, please notify the sender immediately and delete the original message and any files transmitted. The unauthorized use of this e-mail or any files transmitted with it is prohibited and disclaimed by ARCADIS U.S., Inc. and its affiliates. Nothing herein is intended to constitute the offering or performance of services where otherwise restricted by law.

CITY:SYRACUSE,N.Y. DIV:GROUP:EN/IN/HDV DB:RCB,RALLEN,E,KRAHMER LD: PIC:T.W. YOUNG PW:TM:M. JONES TR:T. NOWAK LYRON:"OFF-REF" G:\ENVCAD\SYRACUSE\SELECT\1903648\000\000\000\DWG\36648B02.DWG LAYOUT: 1. SAVED: 9/4/2013 1:11 PM ACADVER: 18.15 (LMS TECH) PAGES: 1. PLOTSTYLETABLE: PUTFULL.CTB PLOTTED: 9/4/2013 1:13 PM BY: KRAHMER, ERIC

IMAGES: PROJECTNAME: 36648XDL 36648X01

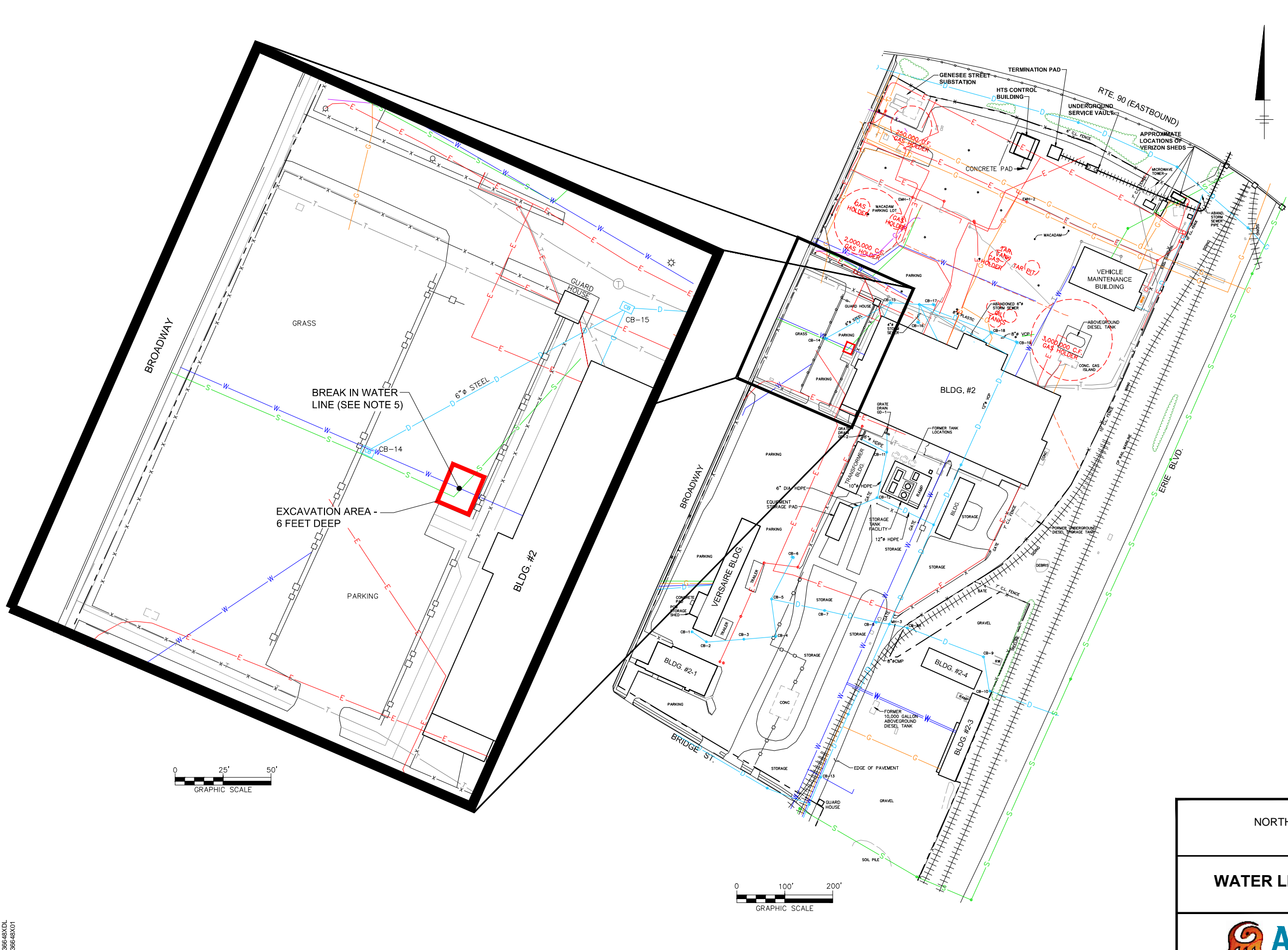

- LEGEND:**
- +++++ APPROXIMATE LOCATION OF HIGH TEMPERATURE SUPERCONDUCTIVE CABLE
 - GUARD RAIL
 - x— FENCE
 - +++++ EXISTING RAILROAD
 - - - - - HISTORICAL SITE FEATURE
 - - - - - APPROXIMATE PROPERTY LINE
 - * UTILITY POLE
 - CB EXISTING CATCH BASIN
 - EXISTING STORM SEWER MANHOLE
 - EXISTING SANITARY MANHOLE
 - EXISTING ELECTRICAL MANHOLE
 - EXISTING TELEPHONE MANHOLE
 - EXISTING UNKNOWN UTILITY MANHOLE
 - D STORM SEWER
 - S SANITARY SEWER
 - T TELEPHONE LINE
 - E ELECTRICAL LINE
 - G GAS LINE
 - W WATER LINE
 - C CABLE LINE
 - - - - - UNKNOWN UTILITY

- NOTES:**
1. BASE MAP (INCLUDING BUILDING LOCATIONS AND PSA/IRM SAMPLING LOCATIONS) DEVELOPED FROM ELECTRONIC FILE OF NIAGARA MOHAWK POWER CORPORATION (NMPC) DRAWING NO. C-29736-C, DATED JULY 1994, ENTITLED NORTH ALBANY SERVICE CENTER HAZARDOUS WASTE MANAGEMENT PERMIT APPLICATION, TOPOGRAPHIC MAP - INDEX SHEET.
 2. LOCATIONS OF UNDERGROUND UTILITIES (INCLUDING ON-SITE STORM SEWERS, SANITARY SEWERS, TELEPHONE LINES, ELECTRICAL LINES, GAS LINES, WATER LINES, AND CABLE) WERE DIGITIZED FROM NMPC DRAWING NO. D-29734-E, FILE INDEX NO. 20.3-A1.1-B2, DATED JUNE 27, 1994, ENTITLED NORTH ALBANY SERVICE CENTER SITE PLAN - PAVING (OUTSIDE FENCE). LOCATION OF UNDERGROUND TELEPHONE LINES, ELECTRICAL LINES, GAS LINES, AND CABLE LINES WERE UPDATED BASED ON ELECTROMAGNETIC UTILITY SURVEY CONDUCTED BY UNDERGROUND SERVICES, INC. DURING OCTOBER 2012. ACTUAL LOCATIONS OF UNDERGROUND UTILITIES MUST BE DETERMINED/CONFIRMED PRIOR TO IMPLEMENTING SUBSURFACE WORK ACTIVITIES.
 3. LOCATIONS OF MANHOLES AND CATCH BASINS WERE OBTAINED FROM SURVEYS CONDUCTED BY NMPC DURING JULY/AUGUST 1997 AND NATIONAL GRID DURING OCTOBER 2012.
 4. LOCATIONS OF OFF-SITE STORM AND SANITARY SEWERS WERE DIGITIZED FROM CITY OF ALBANY DRAWINGS AND ARE APPROXIMATE.
 5. APPROXIMATE 8-FOOT SECTION OF WATER LINE REPLACED (8-29-2013).

NATIONAL GRID
NORTH ALBANY FORMER MGP SITE
ALBANY, NEW YORK

WATER LINE REPLACEMENT MAP

FIGURE
1



Experience is the solution

314 North Pearl Street ♦ Albany, New York 12207
(800) 848-4983 ♦ (518) 434-4546 ♦ Fax (518) 434-0891

September 05, 2013

Barbara Scheurer
National Grid
1125 Broadway
Albany, NY 12204

Work Order No: 130830017

PO#: 3200007707

TEL: (518) 433-3696

FAX: (518) 433-3892

RE: Analysis of Samples
Various

Dear Barbara Scheurer:

Adirondack Environmental Services, Inc received 4 samples on 8/30/2013 for the analyses presented in the following report.

Please see case narrative for specifics on analysis.

If you have any questions regarding these tests results, please feel free to call.

Sincerely,

Christopher Hess
QA Manager

ELAP#: 10709

Adirondack Environmental Services, Inc

CASE NARRATIVE

CLIENT: National Grid
Project: Analysis of Samples
Lab Order: 130830017

Date: 05-Sep-13

Sample containers were supplied by Adirondack Environmental Services.

The analysis for TCLP was completed using totals analysis for the following constituents. This is allowed by method SW-846 1311 as per section 1.2.

-Volatile Organics

Qualifiers:

ND - Not Detected at reporting limit

J - Analyte detected below quantitation limit

B - Analyte detected in Blank

X - Exceeds maximum contamination limit

H - Hold time exceeded

C - Details are above in Case Narrative

S - LCS Spike recovery outside acceptable limits(+ is over - is under)

R - Duplication outside acceptable limits

T - Tentatively Identified Compound-Estimated

E - Above quantitation range-Estimated

M - Matrix Spike outside acceptable limits(+ is over - is under)

Note : All Results are reported as wet weight unless noted

The results relate only to the items tested. Information supplied by the client is assumed to be correct.

Adirondack Environmental Services, Inc

Date: 05-Sep-13

CLIENT: National Grid
Work Order: 130830017
Reference: Analysis of Samples / Various
PO#: 3200007707

Client Sample ID: 1125 Broadway
Collection Date: 8/30/2013
Lab Sample ID: 130830017-004
Matrix: SOIL

Analyses	Result	PQL	Qual	Units	DF	Date Analyzed
POLYCHLORINATED BIPHENYLS SW8082						Analyst: KF
(Prep: SW3545 - 8/30/2013)						
Aroclor 1016	75	39	M-	µg/Kg-dry	1	8/30/2013 1:59:08 PM
Aroclor 1221	< 39	39		µg/Kg-dry	1	8/30/2013 1:59:08 PM
Aroclor 1232	< 39	39		µg/Kg-dry	1	8/30/2013 1:59:08 PM
Aroclor 1242	< 39	39		µg/Kg-dry	1	8/30/2013 1:59:08 PM
Aroclor 1248	< 39	39		µg/Kg-dry	1	8/30/2013 1:59:08 PM
Aroclor 1254	< 39	39		µg/Kg-dry	1	8/30/2013 1:59:08 PM
Aroclor 1260	< 39	39		µg/Kg-dry	1	8/30/2013 1:59:08 PM
Surr: Decachlorobiphenyl	70.2	48.1-152		%REC	1	8/30/2013 1:59:08 PM
TCLP VOLATILES AS TOTALS (SW5035 PREP) SW8260B						Analyst: SJ
(Prep: SW5035 - 8/30/2013)						
Benzene	< 0.56	0.56		µg/g-dry	50	9/3/2013 11:16:00 AM
Surr: 1,2-Dichloroethane-d4	102	62.7-138		%REC	50	9/3/2013 11:16:00 AM
Surr: 4-Bromofluorobenzene	95.9	65-133		%REC	50	9/3/2013 11:16:00 AM
Surr: Toluene-d8	96.7	70-141		%REC	50	9/3/2013 11:16:00 AM
MOISURE CONTENT ASTM D2216 D2216						Analyst: KF
Percent Moisture	14.9	0.1		wt%	1	8/30/2013

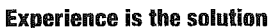

CHAIN OF CUSTODY RECORD

AES Work Order #

ES Work Order # 130830017

A full service analytical research laboratory offering solutions to environmental concerns

[illegible]

Shipment Arrived Via: FedEx UPS <u>Client</u> AES Other: _____			CC Report To / Special Instructions/Remarks: DSALEH@eepsdvermont.com		
Turnaround Time Request: <input type="checkbox"/> 1 Day <input type="checkbox"/> 3 Day <input type="checkbox"/> Normal <input type="checkbox"/> 2 Day <input type="checkbox"/> 5 Day <i>ASAP</i>					
Relinquished by: (Signature) <i>[Signature]</i>			Received by: (Signature)		Date/Time
Relinquished by: (Signature)			Received by: (Signature)		Date/Time
Relinquished by: (Signature)			Received for Laboratory by: <i>[Signature]</i>		Date/Time 8/30/13 11:00 AM
TEMPERATURE Ambient or <u>Chilled</u>		AES Bottles <input checked="" type="checkbox"/> Y <input type="checkbox"/> N	PROPERLY PRESERVED <input checked="" type="checkbox"/> Y <input type="checkbox"/> N		RECEIVED WITHIN HOLDING TIMES <input checked="" type="checkbox"/> Y <input type="checkbox"/> N
Notes: _____		Notes: _____		Notes: _____	

PINK - Generator Copy

Adirondack Environmental Services, Inc.



Experience is the solution

314 North Pearl Street • Albany, New York 12207 • (518) 434-4546 • Fax (518) 434-0891

TERMS, CONDITIONS & LIMITATIONS

All service rendered by the **Adirondack Environmental Services, Inc.** are undertaken and all rates are based upon the following terms:

- (a) Neither **Adirondack Environmental Services, Inc.**, nor any of its employees, agents or sub-contractors shall be liable for any loss or damage arising out of **Adirondack Environmental Services, Inc.**'s performance or nonperformance, whether by way of negligence or breach of contract, or otherwise, in any amount greater than twice the amount billed to the customer for the work leading to the claim of the customer. Said remedy shall be the sole and exclusive remedy against **Adirondack Environmental Services, Inc.** arising out of its work.
- (b) All claims made must be in writing within forty-five (45) days after delivery of the **Adirondack Environmental Services, Inc.** report regarding said work or such claim shall be deemed or irrevocably waived.
- (c) **Adirondack Environmental Services, Inc.** reports are submitted in writing and are for our customers only. Our customers are considered to be only those entities being billed for our services. Acquisition of an **Adirondack Environmental Services, Inc.** report by other than our customer does not constitute a representation of **Adirondack Environmental Services, Inc.** as to the accuracy of the contents thereof.
- (d) In no event shall **Adirondack Environmental Services, Inc.**, its employees, agents or sub-contractors be responsible for consequential or special damages of any kind or in any amount.
- (e) No deviation from the terms set forth herein shall bind **Adirondack Environmental Services, Inc.** unless in writing and signed by a Director of **Adirondack Environmental Services, Inc.**
- (f) Results pertain only to items analyzed. Information supplied by client is assumed to be correct. This information may be used on reports and in calculations and **Adirondack Environmental Services, Inc.** is not responsible for the accuracy of this information.
- (g) Payments by Credit Card/Purchase Cards are subject to a 3% additional charge.



Experience is the solution

314 North Pearl Street ♦ Albany, New York 12207
(800) 848-4983 ♦ (518) 434-4546 ♦ Fax (518) 434-0891

August 30, 2013

Barbara Scheurer
National Grid
1125 Broadway
Albany, NY 12204

Work Order No: 130829012

TEL: (518) 433-3696

PO#: 3200007707

FAX: (518) 433-3892

RE: Analysis of Samples
1125 Broadway

Dear Barbara Scheurer:

Adirondack Environmental Services, Inc received 1 sample on 8/29/2013 for the analyses presented in the following report.

Please see case narrative for specifics on analysis.

If you have any questions regarding these tests results, please feel free to call.

Sincerely,

Christopher Hess
QA Manager

ELAP#: 10709

Adirondack Environmental Services, Inc**CASE NARRATIVE**

CLIENT: National Grid
Project: Analysis of Samples
Lab Order: 130829012

Date: 30-Aug-13

Sample containers were supplied by Adirondack Environmental Services.

Qualifiers:

ND - Not Detected at reporting limit

J - Analyte detected below quantitation limit

B - Analyte detected in Blank

X - Exceeds maximum contamination limit

H - Hold time exceeded

C - Details are above in Case Narrative

S - LCS Spike recovery outside acceptable limits(+ is over - is under)

R - Duplication outside acceptable limits

T - Tentatively Identified Compound-Estimated

E -Above quantitation range-Estimated

M - Matrix Spike outside acceptable limits(+ is over - is under)

Note : All Results are reported as wet weight unless noted

The results relate only to the items tested. Information supplied by the client is assumed to be correct.

Adirondack Environmental Services, Inc

Date: 30-Aug-13

CLIENT: National Grid
Project: Analysis of Samples
1125 Broadway

LabWork Order: 130829012
PO#: 3200007707

Lab SampleID: 130829012-001**Collection Date:** 8/29/2013**Client Sample ID:** 1125 Broadway**Matrix:** WATER

Analyses	Result	PQL	Qual	Units	DF	Date Analyzed
POLYCHLORINATED BIPHENYLS E608						Analyst: KF
(Prep: SW3535 - 8/29/2013)						
Aroclor 1016	< 0.406	0.406		µg/L	1	8/29/2013 2:54:47 PM
Aroclor 1221	< 0.406	0.406		µg/L	1	8/29/2013 2:54:47 PM
Aroclor 1232	< 0.406	0.406		µg/L	1	8/29/2013 2:54:47 PM
Aroclor 1242	< 0.406	0.406		µg/L	1	8/29/2013 2:54:47 PM
Aroclor 1248	< 0.406	0.406		µg/L	1	8/29/2013 2:54:47 PM
Aroclor 1254	< 0.406	0.406		µg/L	1	8/29/2013 2:54:47 PM
Aroclor 1260	< 0.406	0.406		µg/L	1	8/29/2013 2:54:47 PM
Surr: Decachlorobiphenyl	59.4	48.1-152		%REC	1	8/29/2013 2:54:47 PM
Surr: Tetrachloro-m-xylene	74.6	28-138		%REC	1	8/29/2013 2:54:47 PM

VOLATILE ORGANICS-(SW5030B PREP) SW8260B

Analyst: SJ

Benzene	< 10	10		µg/L	2	8/30/2013 2:09:00 PM
Surr: 1,2-Dichloroethane-d4	99.8	72.5-138		%REC	2	8/30/2013 2:09:00 PM
Surr: 4-Bromofluorobenzene	98.3	68.4-129		%REC	2	8/30/2013 2:09:00 PM
Surr: Toluene-d8	99.1	69.1-127		%REC	2	8/30/2013 2:09:00 PM



314 North Pearl Street
Albany, New York 12207
518-434-4546/434-0891 FAX

CHAIN OF CUSTODY RECORD

AES Work Order #

130829012

Experience is the solution

A full service analytical research laboratory offering solutions to environmental concerns

Client Name: <i>National Grid</i>		Address: <i>1125 Broadway, Albany NY</i>						
Send Report To: <i>Barb/Donna/Jon</i>		Project Name (Location): <i>1125 Broadway</i>			Samplers: (Names) <i>* SAM Saleh</i>			
Client Phone No: <i>518-465-4000</i>		Client Email: <i>JBigelow@eps of vermont.com</i>		PO Number: <i>A20201</i>		Samplers: (Signature) <i>* [Signature]</i>		
AES Sample Number	Client Sample Identification & Location	Date Sampled	Time A=a.m. P=p.m.	Sample Type Matrix Comp Grab			Number of Cont's	Analysis Required
<i>001</i>	<i>1125 Broadway</i>	<i>8/29/13</i>		<i>A</i>	<i>Cig</i>	<i>X</i>	<i>1</i>	<i>PCB's,</i>
				<i>P</i>				<i>Total Benzene</i>
				<i>A</i>				
				<i>P</i>				
				<i>A</i>				
				<i>P</i>				
				<i>A</i>				
				<i>P</i>				
				<i>A</i>				
				<i>P</i>				
				<i>A</i>				
				<i>P</i>				
				<i>A</i>				
				<i>P</i>				
				<i>A</i>				
				<i>P</i>				
				<i>A</i>				
				<i>P</i>				
				<i>A</i>				
				<i>P</i>				
				<i>A</i>				
				<i>P</i>				

Shipment Arrived Via:

FedEx UPS Client AES Other: _____

Turnaround Time Request:

☒ 1 Day ☐ 3 Day ☐ Normal
☐ 2 Day ☐ 5 Day

24 Hour

CC Report To / Special Instructions/Remarks:

JBigelow@eps of vermont.com

DSaleh@eps of vermont.com

Relinquished by: (Signature)

[Signature]

Received by: (Signature)

Date/Time

Relinquished by: (Signature)

Received by: (Signature)

Date/Time

Relinquished by: (Signature)

Received for Laboratory by:

Date/Time

[Signature]

8/29/13 1148am

TEMPERATURE

Ambient or Chilled

Notes: *25*

AES Bottles

Y ☒ N ☐

PROPERLY PRESERVED

Q N

Notes:

RECEIVED WITHIN HOLDING TIMES

Y N

Notes:

WHITE - Lab Copy

YELLOW - Sampler Copy

PINK - Generator Copy

Adirondack Environmental Services, Inc.



Experience is the solution

314 North Pearl Street • Albany, New York 12207 • (518) 434-4546 • Fax (518) 434-0891

TERMS, CONDITIONS & LIMITATIONS

All service rendered by the **Adirondack Environmental Services, Inc.** are undertaken and all rates are based upon the following terms:

- (a) Neither **Adirondack Environmental Services, Inc.**, nor any of its employees, agents or sub-contractors shall be liable for any loss or damage arising out of **Adirondack Environmental Services, Inc.**'s performance or nonperformance, whether by way of negligence or breach of contract, or otherwise, in any amount greater than twice the amount billed to the customer for the work leading to the claim of the customer. Said remedy shall be the sole and exclusive remedy against **Adirondack Environmental Services, Inc.** arising out of its work.
- (b) All claims made must be in writing within forty-five (45) days after delivery of the **Adirondack Environmental Services, Inc.** report regarding said work or such claim shall be deemed or irrevocably waived.
- (c) **Adirondack Environmental Services, Inc.** reports are submitted in writing and are for our customers only. Our customers are considered to be only those entities being billed for our services. Acquisition of an **Adirondack Environmental Services, Inc.** report by other than our customer does not constitute a representation of **Adirondack Environmental Services, Inc.** as to the accuracy of the contents thereof.
- (d) In no event shall **Adirondack Environmental Services, Inc.**, its employees, agents or sub-contractors be responsible for consequential or special damages of any kind or in any amount.
- (e) No deviation from the terms set forth herein shall bind **Adirondack Environmental Services, Inc.** unless in writing and signed by a Director of **Adirondack Environmental Services, Inc.**
- (f) Results pertain only to items analyzed. Information supplied by client is assumed to be correct. This information may be used on reports and in calculations and **Adirondack Environmental Services, Inc.** is not responsible for the accuracy of this information.
- (g) Payments by Credit Card/Purchase Cards are subject to a 3% additional charge.