

August 30, 2013

ELECTRONIC TRANSMITTAL

John Strang, P.E.
New York State Department of Environmental Conservation
Division of Hazardous Waste Remediation
1150 N. Westcott Road
Schenectady, New York 12306-2014

Re: Amphenol Plating Operations
Sidney, NY
Spill # 1305408
15 Day Report

Dear Mr. Strang:

As directed in your e-mail dated August 21, 2013 and in compliance with New York State ECL Subpart 372-3.4(g), attached please find the 15 day report addressing the suspected release of acidic wastewater from the plating operations at the Amphenol Aero-space facility in Sidney, NY.

Should you have any questions, please do not hesitate to contact us.

Respectfully yours,
JTM Associates, LLC



James T. Mickam, P.G.
President

Cc: J Bianchi – Amphenol
J Quinn – NYSDEC
A Elliott – NYSDEC
H Brezner – NYSDEC

Attachment

Amphenol – Aerospace
Sidney, New York

Plating Operations
Possible Acidic Wastewater Loss
15 Day Incident Report
August 30, 2013

This report is submitted in compliance with New York State ECL Subpart 372-3.4(g) as it relates to a possible loss of RCRA hazardous waste from the plating operations wastewater conveyance system at the Amphenol – Aerospace facility located in Sidney, New York. This report also responds to the directive received from the New York Department of Environmental Conservation in an e-mail from John Strang, PE dated August 21, 2013 to Joseph Bianchi at Amphenol – Aerospace. The information provided below follows the format mandated by Subpart 372-3.4(g) 10.

(i) name, address, and telephone number of the owner or operator

Amphenol Aero-space
Attn: Joseph M. Bianchi
40 – 60 Delaware Avenue
Sidney, New York 13838
PH: 607.563.5940

(ii) name, address, and telephone number of the facility

Amphenol Aero-space
40 – 60 Delaware Avenue
Sidney, New York 13838
PH: 800.678.0141

(iii) date, time, and type of incident

August 16, 2013 at 1600 hrs. EDT
Suspected loss of acidic process wastewater from the wastewater conveyance line

(iv) name and quantity of material involved

Acidic process wastewater from metals plating operation
Unknown quantity

(v) extent of injuries, if any

No reported injuries

(vi) assessment of actual or potential hazards to human health or the environment

The suspected release area is within a listed NYSDEC Inactive Hazardous Waste Site (West Well / Plating Building site #413010) and under an Administrative Order on Consent (AOC). The AOC requires the operation of interim remedial measures that include the continuous pumping of two shallow groundwater monitoring wells (MW-7 and MW-11 depicted on Figure 1) and the pumping of the West Well industrial supply well. Groundwater monitoring and reporting to NYSDEC takes place quarterly. Routine, groundwater monitoring indicated that the pH in groundwater samples at select groundwater monitoring wells was below historic values. Additional sampling and analyses confirmed the atypically low pH values.

The suspected loss of acidic wastewater from a below grade conveyance system could have affected the chemistry of soil and groundwater proximate to the release area. At this writing, no complete human health exposure pathways are apparent given:

- the suspected release occurred below grade and beneath the concrete floor of the plating building effectively preventing direct contact exposure of any impacted soils and groundwater
- groundwater collected at the site for industrial use or remediation is not used for potable purposes

The potential environmental hazards resulting from the suspected acidic wastewater release include contamination to the soils and groundwater near the release area. Prior to the suspected release, the soils beneath the plating building were thought to represent a source of heavy metals to the groundwater. The suspected loss addressed by this report could have increased the mass of heavy metals available in the soil for release to the groundwater.

(vii) estimated quantity and disposition of recovered material that resulted from the incident

Suspected lost acidic wastewater has not been recovered. However, the suspected release area is near a monitoring well (MW-11) that is pumped to recover already impacted groundwater to satisfy the terms of the AOC for the site. Impacted soils, if any, were not exposed during the conveyance system repairs and therefore not excavated and removed.

FIGURE 1
AMPHENOL CORPORATION
WEST WELL SITE
SIDNEY, NEW YORK

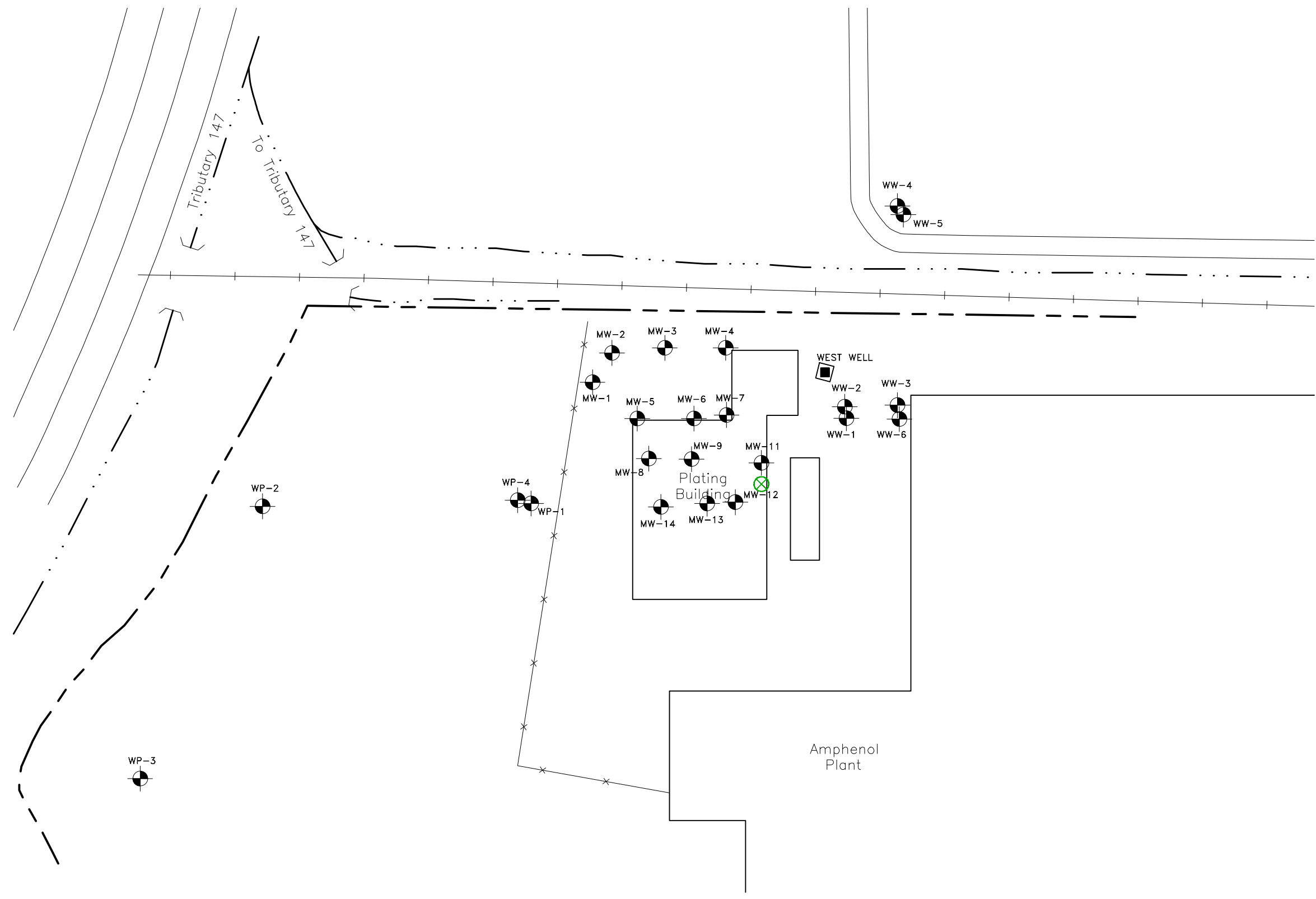

LEGEND

- PROPERTY LINE
- x-x- FENCE LINE
- +--+ RAILROAD
- SUPPLY WELL LOCATION
- MONITORING WELL LOCATION
- ⊗ LOCATION OF SUSPECTED WASTE WATER RELEASE

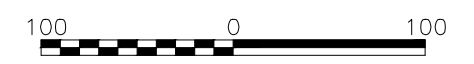

Adapted from O'Brien & Gere Engineers, Inc. 1/17/95. and ERM 5/99.

FILE NO. 001.001-116