



Construction Complete Final Engineering Report - Soils and Sediments IRM

**Ward Products Site
Amsterdam, New York
Site Code 4-29-004**

Prepared by:

RETEC ENGINEERING, P.C.

Under Contract To:

**The RETEC Group, Inc.
1001 West Seneca Street, Suite 204
Ithaca, New York 14850-3342**

RETEC Project Number: NWR01-15852-600

Prepared for:

**New Water Realty Corporation
61 Edson Street
Amsterdam, New York 12010**

August 18, 2004

Construction Complete Final Engineering Report - Soils and Sediments IRM

**Ward Products Site
Amsterdam, New York
Site Code 4-29-004**

Prepared by:

RETEC ENGINEERING, P.C.

Under Contract To:

**The RETEC Group, Inc.
1001 West Seneca Street, Suite 204
Ithaca, New York 14850-3342**

RETEC Project Number: NWR01-15852-600

Prepared for:

**New Water Realty Corporation
61 Edson Street
Amsterdam, New York 12010**

Prepared by:



Mark Hofferbert, P.E., Project Manager

Reviewed by:

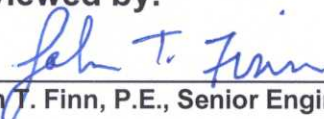

John T. Finn, P.E., Senior Engineer

August 18, 2004

Table of Contents

Engineer's Certification

Executive Summary

1	Introduction.....	1-1
1.1	Site Description.....	1-1
1.2	Project Responsibilities.....	1-1
1.3	Project Approach and Remedial Criteria	1-2
2	Summary of Remedial Activities.....	2-1
2.1	Clearing and Grubbing.....	2-1
2.2	Soil and Sediment Excavation	2-1
2.3	Transportation and Disposal	2-1
2.4	Erosion and Sedimentation Control	2-2
2.5	Site Restoration and Drainage	2-2
2.6	Mobilization, Demobilization, Decontamination	2-3
2.7	Health and Safety	2-3
2.8	Quality Assurance	2-3
2.9	Air Monitoring	2-3
2.10	Soil Sampling and Analyses	2-4
3	Conclusions.....	3-1
4	References.....	4-1

List of Appendices

Appendix A	Summary of Relevant Analytical Results and Depths of As-Built Excavations
Appendix B	Analytical Laboratory Reports
Appendix C	Summary of Waste Shipments and Certificates of Disposal (Hazardous Materials)
Appendix D	Site Photographs

List of Figures

- Figure 1 Site Location
- Figure 2 As-Built Site Plan
- Figure 3 As-Built On-site Detail

Engineer's Certification

I certify that the NYSDEC approved Interim Remedial Measure Work Plan – Selected Soils and Sediments, dated September 24, 2003, including all subsequent Addenda and NYSDEC approved changes, was implemented, and all construction activities were completed in accordance with the Work Plan, and were witnessed by me or by a person under my direct supervision.

Work for this project was performed in accordance with generally accepted professional practices for the nature and condition of the work completed in the same or similar localities, at the time the work was performed.

No other warranty, express or implied, is made.



Executive Summary

This document is the Final Engineering Report for an Interim Remedial Measure (IRM) for the removal of selected deposits of soil and sediments associated with the Ward Products facility in Amsterdam, New York (NYSDEC Order on Consent index number W4-0762-96-06).

The IRM successfully completed the remedial goals, i.e. to excavate and remove on-site and off-site soils and sediments (associated with the former site operations) that contained concentrations of contaminants in excess of TCLP limits. The as-built areas of excavation are shown in the attached Figures.

Consistent with the project schedule, remedial construction commenced on January 5, 2004, and substantial completion of the project was accomplished by February 6, 2004. The final site restoration tasks were completed in June 2004.

The RETEC Group, Inc. was the general remediation contractor, and SLC Environmental Services (SLC) was the remediation subcontractor. Additional oversight was provided by NYSDEC.

The remedial activities completed under this IRM included:

- Excavation and off-site disposal of 345.71 tons of cadmium contaminated sediments which were classified as hazardous for disposal purposes;
- Excavation and off-site disposal of 696.02 tons of non-hazardous cadmium and chromium contaminated soil;
- Placing fabric and armor stone within the excavated sediment areas;
- Placing clean fill and topsoil as necessary on all other disturbed areas;
- Installation of a subsurface footer drain and site re-grading to enhance onsite runoff near the existing building; and
- Additional standard procedures for conducting the work in a manner protective of human health and the environment.

The remedial work was conducted in accordance with:

- The Interim Remedial Measure Work Plan (September 24, 2003);
- Addenda #1 through #7 (October 24, 2003);
- Additional Instructions to Bidders (November 17, 2003); and
- The Site Specific Health and Safety Plan (October 13, 2003).

There are no ongoing operations or maintenance tasks associated with this completed IRM, and no O&M Plan is required.

1 Introduction

This document is the Final Engineering Report for an Interim Remedial Measure (IRM) for the removal of selected deposits of material associated with the Ward Products facility in Amsterdam, New York. The material removed included certain soils and sediments known or anticipated by New Water Realty Corporation (NWR) and RETEC Engineering, P.C. (RETEC) to exceed TCLP limits for cadmium.

The Remedial Investigations Report [Normandeau, 2001] and supplemental field data [Normandeau, 2002, and Normandeau, 2003] identified soil and sediment both on and off the site which contain cadmium, chromium, nickel, zinc, and lead in excess of the New York State Department of Environmental Conservation (NYSDEC) recommended cleanup objectives. Only cadmium was detected in concentrations exceeding the TCLP limits. The exception was a small quantity of material that was removed during a previous (“Drain Pipe”) IRM that contained chromium and lead in excess of TCLP limits.

This Report describes the results of the remediation of the impacted material and the elimination of the associated risk to public health and the environment. This Report has been prepared in accordance with Section V of the Consent Order for this site [NYSDEC, 1997].

1.1 Site Description

The Ward Products site lies in an industrial area on the north side of Edson Street Extension, as shown in Figure 1. The site is an 8.6-acre property that consists of a large paved parking lot, a 69,556 square-foot single story building, and lawn and wooded areas. A drainage ditch begins north of the building and runs southeast, then southwest along the property line. It then runs under Edson Street to the East Branch stream. Prior to site work at the UCMI property, the drainage ditch ran to the West Branch stream. Both stream branches run through culverts under Sam Stratton road, then south to the Mohawk River in the City of Amsterdam. Both streams are typically damp, with sporadic flow.

Reports by Normandeau Associates, Inc. (NAI), [2001, 2002, 2003] provide more complete descriptions of the stratigraphy and hydrogeology, as well as the results of the environmental investigations conducted at the site.

1.2 Project Responsibilities

The principal organizations involved in designing and construction of the IRM were NWR, NYSDEC, RETEC, and SLC Environmental (SLC). Ward Products, LLC (WP) is the current occupant of the property and its facilities.

As the site owner, NWR was responsible to NYSDEC for the remedial design, construction, and evaluation in accordance with the Order on Consent.

The NYSDEC reviewed NWR's remedial designs, plans, and specifications for substantial compliance with the agency's regulations. Reviews were provided by both the Division of Environmental Remediation and the Division of Fish and Wildlife.

The New York State Department of Health (NYSDOH) also reviewed NWR's remedial designs, plans, and specifications, particularly those pertaining to the protection of human health, such as the air monitoring program.

RETEC was the engineer and general contractor responsible for the design and implementation of the IRM. RETEC conducted field engineering and subcontractor supervision during the work.

The subcontractor, SLC, was selected by NWR and RETEC from among qualified companies. SLC was responsible for the performance of the work in accordance with the drawings and specifications incorporated in the IRM Work Plan [RETEC, 2003]. SLC was given a copy of the Order on Consent and was required to comply with it as a condition of their contract.

1.3 Project Approach and Remedial Criteria

The project approach was to excavate and remove on-site and off-site soils and sediments associated with the former operations of Ward Products that contained concentrations of contaminants in excess of TCLP limits.

Known TCLP exceedances in sediments were located in the site drainage ditch from an on-site concrete pipe outfall to a location 50 to 100 feet downstream of Edson Street. Additional locations were at one sample point near the upstream (on-site) end of the ditch and at the inlets to the east and west (off-site) culverts under Sam Stratton Road. Impacts were deepest at the pipe outfall (24-inches), but typically were between 6 inches and 18 inches deep.

Suspected TCLP exceedances in on-site soils were located primarily around the northeast corner of the building but extended sporadically uphill approximately 150 feet to sample location S-82. Impacts were deepest at S-12 (36 inches) and S-7 (30 inches), but typically were between 6 inches and 18 inches deep.

The scope of work for this IRM included the following actions:

- Prepare the job site;
- Clear excavation areas as necessary;
- Excavate, characterize, and dispose of material;
- Import and regrade surface soil;

- Restore or improve runoff patterns;
- Hydroseed all disturbed areas;
- Document as-built conditions; and
- Demobilize from the site.

Specifically, the approach was to excavate within the defined areas and remove:

- On-site and off-site soils and sediments known to contain leachable cadmium in concentrations in excess of the TCLP limit of 1.0 mg/L;
- On-site and off-site ditch sediments containing an excess of 50 mg/Kg total cadmium;
- On-site soils containing an excess of 30 mg/Kg of cadmium; and
- On-site soils containing an excess of 450 mg/Kg of chromium.

Though the intent of the IRM was simply to remove TCLP “hazardous” soils and sediments associated with the Ward Products site, the totals criteria (mg/Kg) were used as guidance.

The total volume of impacted material was estimated to be in the magnitude of 650 cubic yards (or 975 tons, assuming 1.5 tons per cubic yard).

Soil and sediment analytical results, and the as-built depths of excavation at each sample location, are tabulated in Appendix A. The approximate areal extents of the as-built excavations are shown in the Figures. The actual weights of excavated materials (hazardous and non-hazardous) are tabulated in Appendix C.

2 Summary of Remedial Activities

2.1 Clearing and Grubbing

On January 5, 2004, RETEC and SLC mobilized to the site and began clearing brush, laying out the excavation perimeters, and meeting with underground utility locators.

Significant clearing was required north of the building and in the drainage ditch areas. To the extent practicable, trees of greater than 3-inch diameter outside of the excavation were not removed.

Subsurface vegetation (root balls, etc.) from within the excavation was disposed of off site as impacted material.

2.2 Soil and Sediment Excavation

Excavation began on January 8, and was complete by February 6, 2004.

Throughout the work, RETEC staked and flagged the limits and depths of excavation. Final excavation depths were determined by RETEC based on confirmation sampling results. Several locations required re-excavation and re-sampling before confirmation results were acceptable.

Soil was excavated with a Kobelco 115SR excavator except in areas of limited access, wherein the soil was excavated with a Cat 302.5 mini-excavator.

Due to continuously frozen conditions through January and February, and subsequent low flow in the ditches, dewatering was not necessary to meet applicable transportation and disposal requirements.

Off-site sediments were generally loaded directly into haul trucks and immediately transported and disposed of off-site. Some sediments were temporarily stockpiled on 6-mil polyethylene between truck loads.

On-site soils and sediments were transferred to on-site stockpiles with a Cat IT28G front-end loader. TCLP hazardous and non-hazardous soils were stockpiled separately. Stockpiled material was placed on, and covered by, 6-mil polyethylene at an on-site location approved by RETEC, NWR, and WP.

SLC removed sections of existing chain link fence to facilitate the work. The fence was later repaired to its original or better condition.

2.3 Transportation and Disposal

Existing analytical data was made available to the selected disposal facilities prior to commencing the work. Additional sampling and analysis was also performed to complete the pre-characterization of the materials.

“Hazardous” materials were disposed of at Chem Waste Management’s landfill in Model City, NY. “Non-hazardous” materials were disposed of at the City of Albany’s landfill. The selected facilities were required to be properly permitted to dispose of the waste.

All haul trucks were lined with, and loads were covered by, 6-mil (minimum) polyethylene. Haul trucks were loaded from the stockpiles with the front-end loader.

All trucks accessed the site from the west via Widow Susan Road. Trucks were not permitted to travel east on Edson Street through the residential neighborhood.

RETEC, as NWR’s designated representative, signed the transportation manifests prior to loads leaving the site.

Shipment of excavated material was completed on February 4th. The total weight of excavated TCLP hazardous soil was 345.71 tons. The weight of non-hazardous soil was 696.02 tons.

2.4 Erosion and Sedimentation Control

SLC complied with general erosion and sedimentation control practices.

Due to the sustained cold season, there was little or no flow in the work areas. Silt fence was, however, installed near location S-82 (downgradient of a perennial spring), and surface flow was diverted around the East Culvert excavation with a small temporary ditch.

2.5 Site Restoration and Drainage

Following excavation, excavated ditch areas were lined with geofabric and armor stone. The on-site excavation areas were backfilled with clean imported fill and re-graded to control runoff.

Due to inclement weather in January and February, final on-site restoration, including placement of topsoil and hydroseed, was completed during a second site mobilization in the week of June 14th. The last restoration task, fence repair, was completed the week of June 28th.

On-site drainage was improved with installation of a subsurface drain tile. Approximately 500-feet of drain tile was placed in a sloped trench around the northeast and southeast walls of the building, as shown on Figure 3. Cleanouts were installed near the building corners. Portions of the ditch north of the building (at the upper fence line) were also cleared of organic debris to improve drainage of the upgradient site areas.

Ultimately, all disturbed areas were re-graded as necessary to restore or improve drainage patterns. All disturbed areas were hydroseeded with the

supplier's recommended lbs/acre of seed and nutrients. SLC maintained the area until a vegetative cover was established. All project-related site debris was removed prior to final demobilization from the site.

2.6 Mobilization, Demobilization, Decontamination

SLC and RETEC confined their operations to the areas designated by NWR and WP.

The work areas were delineated (with temporary fencing and caution tape) to ensure the safety of the facility workers, visitors, and construction personnel.

Equipment and personnel that came in contact with impacted soil were cleaned prior to demobilization from the site.

2.7 Health and Safety

SLC and RETEC were required to comply with all applicable health and safety requirements including OSHA regulations 40 CFR 1926, 40 CFR 1910, and RETEC's site-specific Health and Safety Plan (HASP). RETEC's HASP was reviewed by NYSDEC and NYSDOH prior to the work.

Hours of operation were daylight hours between 7 AM and 5 PM, Monday through Friday.

2.8 Quality Assurance

The work utilized standard quality assurance procedures including:

- Submittal by SLC of weigh tickets for all earthen materials transported to or from the site;
- Submittal by SLC, prior to the work, of sieve analyses for all imported earthen material. Materials were required to meet NYSDOT specifications, if applicable;
- Submittal by SLC, prior to the work, of analytical data indicating that imported material was non-contaminated; and
- Field verification by RETEC of excavation and placed material depths, areas, and volumes.

2.9 Air Monitoring

In accordance with 29 CFR 1910.120(h), and the NYSDOH generic Community Air Monitoring Plan, RETEC performed air monitoring during

the field work. The Minirae photoionization detector and Miniram dust meter readings were consistently below the applicable action levels.

Due to the extreme cold weather (typically 0 to 20 °F) the meters were periodically inoperative. The work was, however, continuously supervised by RETEC and at no time was visible dust generated, except for unsustained (less than 1-minute) events while off-loading clean imported fill.

Settled dust was at no time visible on the snow around the excavations. Odors were not detected at any time.

Doors and windows near excavation areas were temporarily locked and cordoned with caution tape from the inside during nearby material handling activities.

2.10 Soil Sampling and Analyses

Prior to excavation, RETEC collected soil and sediment samples for pre-characterization and landfill approval. One sample (designated “NH Composite”) was representative of the on-site metals-impacted soils. A second pre-characterization sample (designated “Ditch”) was representative of the sediments in the on- and off-site ditch areas.

“NH Composite” was analyzed for full TCLP and PCBs, the results of which were found to be acceptable to the City of Albany (non-hazardous) landfill. The “Ditch” sample was analyzed for TCLP metals, PCBs, and Reactivity, the results of which were found to be acceptable (as a D006 hazardous waste) to Chem Waste Management’s landfill in Model City, NY.

Adirondack Environmental Services performed the laboratory analyses for this project.

Throughout the work, RETEC collected confirmation soil samples. The samples were composites of sub-samples taken around the bottom of each excavation area. Split samples were available to the NYSDEC representative upon request.

Confirmatory excavation bottom samples were collected from the on-site soil excavations and analyzed by Method 6010B for total cadmium. Excavation in these on-site sections continued vertically until the excavation bottom was shown to comply with the IRM’s site-specific total cadmium limit for soils of 30 mg/Kg.

Confirmatory excavation bottom samples were also collected and analyzed (same method) from the off-site sediment excavations. Excavation in these off-site sections continued vertically until the excavation bottom was shown to comply with the IRM’s site-specific total cadmium limit for sediments of 50 mg/Kg.

In several locations (approximately one out of four) the cleanup objective was not met, so after receipt of the sampling data additional soil was excavated from those locations and confirmation sampling was repeated. In three locations (S46, C-2, and S82), the remaining cadmium concentrations were above the total cadmium objective, but subsequent TCLP analyses from those areas showed that the remaining soil there was non-hazardous and that, with NYSDEC concurrence, the objective of the IRM was met.

Following review of the analytical data, and in consultation with NYSDEC and NWR, RETEC instructed the laboratory to analyze some of the ditch samples for additional parameters (TCLP cadmium and total chromium, nickel, zinc and cyanide). These analyses were included to provide a more complete comparison of Pre- vs. Post-IRM residuals. The results do not affect the conclusion that the IRM met its goals.

3 Conclusions

The IRM successfully achieved the required performance criteria, namely:

- Excavation and proper disposal of the TCLP “hazardous” soils and sediments from within the excavation limits shown in the figures;
- Reduction of exposure of on-site workers and visitors to contaminated material;
- Provision for adequate site drainage;
- Protection of existing structures and properties; and
- Protection of human health and the environment during all phases of the work, particularly the safety of on-site employees and the quality of downwind air.

4 References

- NYSDEC, 1997. New York State Department of Environmental Conservation Order on Consent, Ward Products, Inc. Index #W4-0762-96-06, Site Code #4-29-004.
- Normandeau Associates, Inc., 2001. Remedial Investigations Report, Ward Products Corporation, July 2001.
- Normandeau Associates, Inc., 2002. Progress Report for January 2002, Ward Products Corporation, February 2002.
- Normandeau Associates, Inc., 2003. Progress Report for April 2003, Ward Products Corporation, May 2003.
- RETEC, 2003. Interim Remedial Measure Work Plan – Selected Soils and Sediments, Ward Products Site, September 24, 2003.

Figures

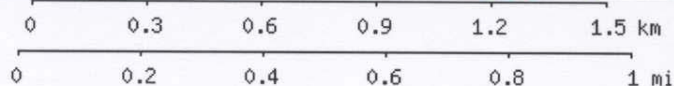

Amsterdam quadrangle

Projection is UTM Zone 18 NAD83 Datum



M=-14.084
G=0.557

FIGURE 1
Site Location

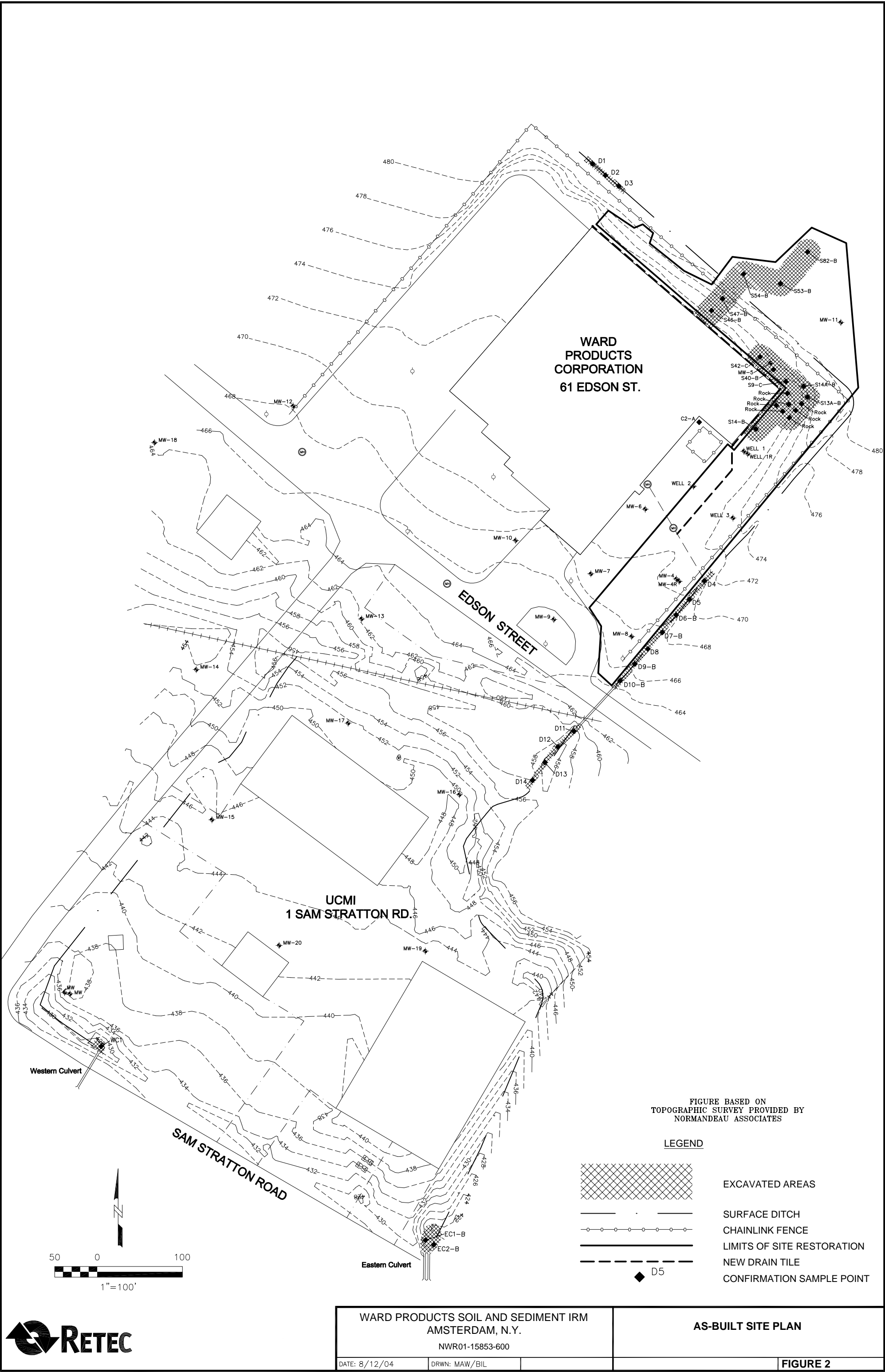

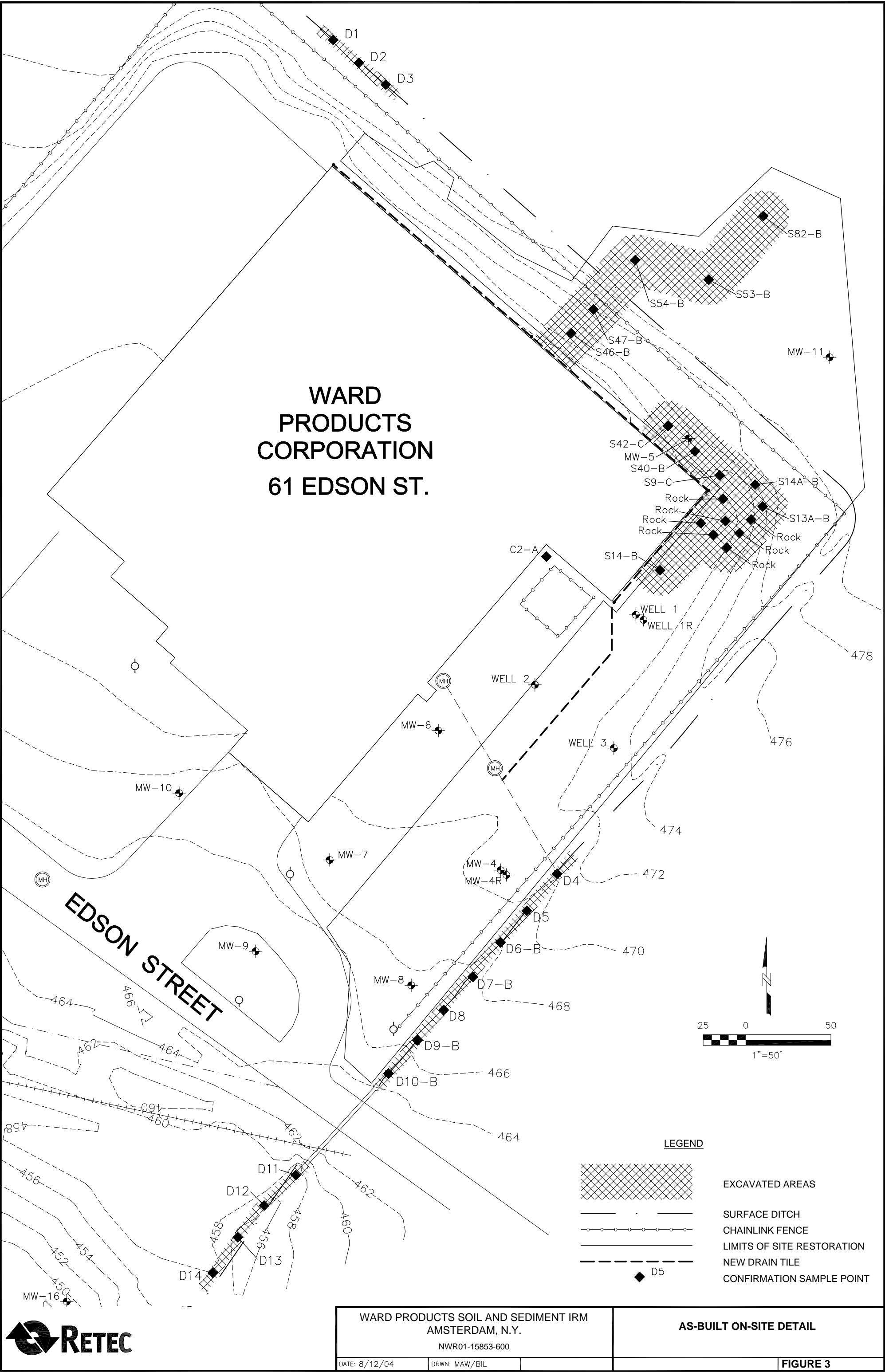

Appendix A

Summary of Relevant Analytical Results and Depths of As-Built Excavations

Analytical and Excavation Summary Table

Selected Soils and Sediments IRM - Ward Products Site, Amsterdam, NY

8/18/04, RETEC

Sample ID		Pre-IRM Sample Depth, or Post-IRM Excavation Depth, feet	Total Cadmium, mg/Kg	Total Chromium, mg/Kg	Total Nickel, mg/Kg	Total Zinc, mg/Kg	Total Cyanide, mg/Kg	TCLP Cadmium, mg/L	Notes
D1	Post-IRM	0.7	20.7	---	---	---	---	---	No Pre-IRM sample.
UPSTREAM	Pre-IRM	0.5	628	3130	3170	1010	47.6	8.35	
D2	Post-IRM	0.7	0.34	24.5	< 2.5	67.7	< 0.5	< 0.05	
D3	Post-IRM	0.7	2.21	---	---	---	---	---	No Pre-IRM sample.
OUTFALL	Pre-IRM	1.0	143	3550	2250	2020	51.7	2.75	
D4	Post-IRM	1.6	2.04	58.5	41.8	55.9	< 0.5	< 0.05	
D5	Post-IRM	1.8	6.85	---	---	---	---	---	No Pre-IRM sample.
D6	Mid-IRM	1.5	62.7	---	---	---	---	1.57	No Pre-IRM sample. Mid sample failed.
D6-B	Post-IRM	2.0	< 0.25	---	---	---	---	---	
MIDPOINT	Pre-IRM	0.5	66.5	587	396	241	3.35	1.32	
D7	Mid-IRM	1.0	209	---	---	---	---	---	Mid sample failed.
D7-B	Post-IRM	2.2	4.87	42.6	68.4	35.9	< 0.5	0.22	
D8	Post-IRM	1.9	7.11	---	---	---	---	---	No Pre-IRM sample.
D9	Mid-IRM	1.0	155	---	---	---	---	---	No Pre-IRM sample. Mid sample failed.
D9-B	Post-IRM	1.7	< 0.25	---	---	---	---	---	
UPSTREAM CULVERT	Pre-IRM	0.5	165	1730	1600	607	19.7	1.57	
D10	Mid-IRM	0.8	45.2	---	---	---	---	---	Mid sample passed but location re-graded.
D10-B	Post-IRM	1.1	12.2	148	193	76.6	< 0.5	0.24	
DOWNSTREAM CULVERT	Pre-IRM	1.0	149	1360	1580	808	10.3	1.77	
D11	Post-IRM	1.6	14.8	97.9	22.2	53.9	< 0.5	0.38	
D12	Post-IRM	1.4	0.92	---	---	---	---	---	No Pre-IRM sample.
DOWNSTREAM 50'	Pre-IRM	1.0	61.6	313	349	183	6.94	1.15	
D13	Post-IRM	1.2	< 0.25	17	< 2.5	46.3	< 0.5	< 0.05	
D14	Post-IRM	0.7	< 0.25						No Pre-IRM sample.
EB CULVERT	Pre-IRM	1.0	71	660	605	209	6.5	---	
EC1	Mid-IRM	1.5	67.4	---	---	---	---	---	Mid sample failed.
EC2	Mid-IRM	1.5	80	---	---	---	---	---	Mid sample failed.
EC1-B	Post-IRM	3.5	10.2	84.8	48.9	37.4	< 0.5	0.05	
EC2-B	Post-IRM	3.5	4.69	45.9	21.6	32.2	< 0.5	0.08	
WB CULVERT	Pre-IRM	0.5	31.8	700	210	130	< 1.0	---	
WC1	Post-IRM	0.5	4.16	191	12.9	58.4	< 0.5	0.08	
S9	Pre-IRM	1.0	54.5	---	---	---	---	---	
S9-B	Mid-IRM	0.5	< 0.25	---	---	---	---	---	Insufficient initial depth, re-excavated.
S9-C	Post-IRM	1.2	< 0.25	---	---	---	---	---	
S10	Pre-IRM	1.0	60.5	---	---	---	---	---	Excavation went to visually clean bedrock, no sample collected.
---	Post-IRM	1.2	rock	---	---	---	---	---	
S11	Pre-IRM	1.3	50	---	---	---	---	---	Excavation went to visually clean bedrock, no sample collected.
---	Post-IRM	1.2	rock	---	---	---	---	---	
S12	Pre-IRM	2.5	42.7	---	---	---	---	---	Excavation went to visually clean bedrock, no sample collected.
---	Post-IRM	2.4	rock	---	---	---	---	---	
S13	Pre-IRM	0.5	7.8	---	---	---	---	---	Excavation went to visually clean bedrock, no sample collected.
---	Post-IRM	0.9	rock	---	---	---	---	---	
S13A	Pre-IRM	0.2	46.2	---	---	---	---	---	
S13A-B	Post-IRM	0.6	1.0	---	---	---	---	---	
S14A	Pre-IRM	1.0	87	---	---	---	---	---	
S14A-B	Post-IRM	1.1	11.4	---	---	---	---	---	
S15A	Pre-IRM	1.0	66	---	---	---	---	---	Excavation went to visually clean bedrock, no sample collected.
---	Post-IRM	1.5	rock	---	---	---	---	---	
S16A	Pre-IRM	1.0	61	---	---	---	---	---	Excavation went to visually clean bedrock, no sample collected.
---	Post-IRM	0.9	rock	---	---	---	---	---	
S17A	Pre-IRM	1.0	44.4	---	---	---	---	---	Excavation went to visually clean bedrock, no sample collected.
---	Post-IRM	0.9	rock	---	---	---	---	---	
S40	Pre-IRM	1.0	47	---	---	---	---	---	
S40-B	Post-IRM	1.3	15.3	---	---	---	---	---	
S42	Pre-IRM	0.2	263	---	---	---	---	---	
S42-B	Mid-IRM	0.5	111	---	---	---	---	---	Mid sample failed.
S42-C	Post-IRM	1.9	< 0.25	---	---	---	---	---	
S46	Pre-IRM	1.0	38	---	---	---	---	---	
S46-B	Post-IRM	1.4	53.5	---	---	---	---	0.33	High Total Cd but acceptable TCLP Cd.
S47	Pre-IRM	1.0	44.7	---	---	---	---	---	
S47-B	Post-IRM	1.8	4.71	---	---	---	---	---	
S53	Pre-IRM	0.2	52.2	---	---	---	---	---	
S53-B	Post-IRM	0.5	28.7	---	---	---	---	---	
S82	Pre-IRM	1.0	47.5	---	---	---	---	---	
S82-B	Post-IRM	1.5	30.2	---	---	---	---	0.24	High Total Cd but acceptable TCLP Cd.
C2	Pre-IRM	1.0	150	---	---	---	---	---	Location C2 (under 12" clean topsoil) was resampled by hand auger w/o excavation.
C2-A	Post-IRM	1.0 - 2.0	---	---	---	---	---	< 0.05	High Total Cd but acceptable TCLP Cd.
S14	Pre-IRM	0.5	---	510	---	---	---	---	
S14-B	Post-IRM	1.1	---	164	---	---	---	---	
S54	Pre-IRM	1.0	---	463	---	---	---	---	
S54-B	Post-IRM	1.0	---	94.2	---	---	---	---	
Clean-Up Criteria, Ditches/Culverts		Per Design	< 50	< 450	na	na	na	< 1.0	
Clean-Up Criteria, On-Site Soils		Per Design	< 30	< 450	na	na	na	< 1.0	

Post-IRM excavation depths surveyed or measured by RETEC.
--- No sample taken.

Appendix B

Analytical Laboratory Reports



Experience is the solution
314 North Pearl Street ♦ Albany, New York 12207
(800) 848-4983 ♦ (518) 434-4546 ♦ Fax (518) 434-0891

December 08, 2003

Mark Hofferbert
RETEC
1001 West Seneca St.
Suite 204
Ithaca, NY 14850
TEL: (607) 277-5716
FAX: (607) 277-9057

*Ditch
TEL P Metals*

RE: Ward Products IRM

Order No.: 031205023

Dear Mark Hofferbert:

Adirondack Environmental Services, Inc received 1 sample on 12/5/2003 for the analyses presented in the following report.

There were no problems with the analyses and all associated QC met EPA or laboratory specifications, except if noted.

If you have any questions regarding these tests results, please feel free to call.

Sincerely,

ELAP#: 10709
AIHA#: 100307

Christopher Hess
QA Manager

FAX:
Dan Shearer

Adirondack Environmental Services, Inc

Date: 08-Dec-03

CLIENT: RETEC
Lab Order: 031205023
Project: Ward Products IRM
Lab ID: 031205023-001

Client Sample ID: Ditch
Collection Date: 12/3/2003

Matrix: SOIL

Analyses	Result	PQL	Qual	Units	DF	Date Analyzed
MERCURY, TCLP		SW1311/7470A	(SW7470A)			Analyst: SM
Mercury-TCLP	< 0.020	0.020		mg/L	1	12/8/2003
ICP METALS, TCLP		SW1311/6010A	(SW1311)			Analyst: SM
Arsenic-TCLP	< 0.05	0.05		mg/L	1	12/8/2003 11:36:00 AM
Barium-TCLP	0.56	0.10		mg/L	1	12/8/2003 11:36:00 AM
Cadmium-TCLP	1.25	0.05	*	mg/L	1	12/8/2003 11:36:00 AM
Chromium-TCLP	< 0.05	0.05		mg/L	1	12/8/2003 11:36:00 AM
Lead-TCLP	< 0.05	0.05		mg/L	1	12/8/2003 11:36:00 AM
Selenium-TCLP	< 0.05	0.05		mg/L	1	12/8/2003 11:36:00 AM
Silver-TCLP	< 0.10	0.10		mg/L	1	12/8/2003 11:36:00 AM

Qualifiers: ND - Not Detected at the Reporting Limit
J - Analyte detected below quantitation limits
B - Analyte detected in the associated Method Blank
* - Value exceeds Maximum Contaminant Level

S - Spike Recovery outside accepted recovery limits
R - RPD outside accepted recovery limits
E - Value above quantitation range

No.

CHAIN OF CUSTODY RECORD

[illegible]

PINK COPY - Sampler

YELLOW COPY - Laboratory

WHITE COPY - RETEC

RELEC

REMEDIA T I O
TECHNOLOGIES IN

REMEDIAATION TECHNOLOGIES
1001 W. Seneca Street, Suite 204
Ithaca, NY 14850
(607) 277-5716
Fax (607) 277-9057



Experience is the solution

314 North Pearl Street ♦ Albany, New York 12207
(800) 848-4983 ♦ (518) 434-4546 ♦ Fax (518) 434-0891

January 06, 2004

Mark Hofferbert

RETEC

1001 West Seneca St.

Suite 204

Ithaca, NY 14850

TEL: (607) 277-5716

FAX: (607) 277-9057

RE: Ward Products

Order No.: 040105037

Dear Mark Hofferbert:

Adirondack Environmental Services, Inc received 1 sample on 1/5/2004 for the analyses presented in the following report.

There were no problems with the analyses and all associated QC met EPA or laboratory specifications, except if noted.

If you have any questions regarding these tests results, please feel free to call.

Sincerely,

ELAP#: 10709
AIHA#: 100307

A handwritten signature in cursive script, appearing to read "Tara Daniels", is written over the printed name.

Tara Daniels
Laboratory Manager

Ditch
PCBS
Reactivity

Adirondack Environmental Services, Inc

Date: 06-Jan-04

CLIENT: RETEC**Client Sample ID:** Ditch**Lab Order:** 040105037**Collection Date:** 1/5/2004**Project:** Ward Products**Lab ID:** 040105037-001**Matrix:** SOIL

Analyses	Result	PQL	Qual	Units	DF	Date Analyzed
POLYCHLORINATED BIPHENYLS		SW8082		(CLP4_PEST)		Analyst: KF
Aroclor 1016	< 49	49		µg/Kg-dry	1	1/5/2004
Aroclor 1221	< 49	49		µg/Kg-dry	1	1/5/2004
Aroclor 1232	< 49	49		µg/Kg-dry	1	1/5/2004
Aroclor 1242	< 49	49		µg/Kg-dry	1	1/5/2004
Aroclor 1248	< 49	49		µg/Kg-dry	1	1/5/2004
Aroclor 1254	150	49		µg/Kg-dry	1	1/5/2004
Aroclor 1260	< 49	49		µg/Kg-dry	1	1/5/2004
CYANIDE, REACTIVE		SW7.3.3.2				Analyst: MC
Reactive Cyanide	< 1	1		µg/g	1	1/5/2004
REACTIVE SULFIDE		SW7.3.4.2				Analyst: MC
Reactive Sulfide	< 10	10		µg/g	1	1/5/2004
REACTIVITY		SW846 7.3.3				Analyst: MC
Reactivity	Non Reactive	0			1	1/5/2004

Qualifiers: ND - Not Detected at the Reporting Limit
J - Analyte detected below quantitation limits
B - Analyte detected in the associated Method Blank
* - Value exceeds Maximum Contaminant Level

S - Spike Recovery outside accepted recovery limits
R - RPD outside accepted recovery limits
E - Value above quantitation range



Experience is the solution

314 North Pearl Street ♦ Albany, New York 12207
(800) 848-4983 ♦ (518) 434-4546 ♦ Fax (518) 434-0891

NH Composite

January 13, 2004

Mark Hofferbert

RETEC

1001 West Seneca St.

Suite 204

Ithaca, NY 14850

TEL: (607) 277-5716

FAX: (607) 277-9057

RE: Ward Products

Order No.: 040108021

Dear Mark Hofferbert:

Adirondack Environmental Services, Inc received 1 sample on 1/8/2004 for the analyses presented in the following report.

There were no problems with the analyses and all associated QC met EPA or laboratory specifications, except if noted.

If you have any questions regarding these tests results, please feel free to call.

Sincerely,

Tara Daniels
Laboratory Manager

ELAP#: 10709
AIHA#: 100307

FAX:

Dan Shearer(716)433-0802
Mark Hofferbert

Adirondack Environmental Services, Inc

Date: 13-Jan-04

CLIENT: RETEC
Lab Order: 040108021
Project: Ward Products
Lab ID: 040108021-001

Client Sample ID: NH Composite
Collection Date: 1/7/2004
Matrix: SOIL

Analyses	Result	PQL	Qual	Units	DF	Date Analyzed
POLYCHLORINATED BIPHENYLS		SW8082		(CLP4_PEST)		Analyst: KF
Aroclor 1016	< 41	41		µg/Kg-dry	1	1/8/2004
Aroclor 1221	< 41	41		µg/Kg-dry	1	1/8/2004
Aroclor 1232	< 41	41		µg/Kg-dry	1	1/8/2004
Aroclor 1242	< 41	41		µg/Kg-dry	1	1/8/2004
Aroclor 1248	< 41	41		µg/Kg-dry	1	1/8/2004
Aroclor 1254	< 41	41		µg/Kg-dry	1	1/8/2004
Aroclor 1260	< 41	41		µg/Kg-dry	1	1/8/2004
HERBICIDES, TCLP LEACHED		SW1311/8151				Analyst: TN
2,4,5-TP (Silvex)-TCLP	< 0.2	0.2		mg/L	1	1/12/2004
2,4-D-TCLP	< 2.0	2.0		mg/L	1	1/12/2004
PESTICIDES, TCLP LEACHED		SW1311/8081A		(SW3520B)		Analyst: KF
Chlordane-TCLP	< 0.005	0.005		mg/L	1	1/8/2004
Endrin-TCLP	< 0.005	0.005		mg/L	1	1/8/2004
gamma-BHC(Lindane)-TCLP	< 0.005	0.005		mg/L	1	1/8/2004
Heptachlor epoxide-TCLP	< 0.005	0.005		mg/L	1	1/8/2004
Heptachlor-TCLP	< 0.005	0.005		mg/L	1	1/8/2004
Methoxychlor-TCLP	< 0.050	0.050		mg/L	1	1/8/2004
Toxaphene-TCLP	< 0.050	0.050		mg/L	1	1/8/2004
MERCURY, TCLP		SW1311/7470A		(SW7470A)		Analyst: KH
Mercury-TCLP	< 0.020	0.020		mg/L	1	1/9/2004
ICP METALS, TCLP		SW1311/6010A		(SW1311)		Analyst: KH
Arsenic-TCLP	< 0.05	0.05		mg/L	1	1/9/2004 1:32:00 PM
Barium-TCLP	0.74	0.10		mg/L	1	1/9/2004 1:32:00 PM
Cadmium-TCLP	0.68	0.05		mg/L	1	1/9/2004 1:32:00 PM
Chromium-TCLP	0.44	0.05		mg/L	1	1/9/2004 1:32:00 PM
Lead-TCLP	0.05	0.05		mg/L	1	1/9/2004 1:32:00 PM
Selenium-TCLP	< 0.05	0.05		mg/L	1	1/9/2004 1:32:00 PM
Silver-TCLP	< 0.10	0.10		mg/L	1	1/9/2004 1:32:00 PM
TCLP-SEMIVOLATILES		SW1311/8270C		(SW3510)		Analyst: MT
1,4-Dichlorobenzene -TCLP	< 100	100		µg/L	1	1/13/2004 1:40:00 PM
2,4,5-Trichlorophenol-TCLP	< 100	100		µg/L	1	1/13/2004 1:40:00 PM
2,4,6-Trichlorophenol-TCLP	< 100	100		µg/L	1	1/13/2004 1:40:00 PM
2,4-Dinitrotoluene-TCLP	< 100	100		µg/L	1	1/13/2004 1:40:00 PM
Cresols, Total-TCLP	180	100		µg/L	1	1/13/2004 1:40:00 PM
Hexachlorobenzene-TCLP	< 100	100		µg/L	1	1/13/2004 1:40:00 PM
Hexachlorobutadiene-TCLP	< 100	100		µg/L	1	1/13/2004 1:40:00 PM
Hexachloroethane-TCLP	< 100	100		µg/L	1	1/13/2004 1:40:00 PM
Nitrobenzene-TCLP	< 100	100		µg/L	1	1/13/2004 1:40:00 PM

Qualifiers: ND - Not Detected at the Reporting Limit
J - Analyte detected below quantitation limits
B - Analyte detected in the associated Method Blank
* - Value exceeds Maximum Contaminant Level

S - Spike Recovery outside accepted recovery limits
R - RPD outside accepted recovery limits
E - Value above quantitation range

Adirondack Environmental Services, Inc

Date: 13-Jan-04

CLIENT: RETEC
Lab Order: 040108021
Project: Ward Products
Lab ID: 040108021-001

Client Sample ID: NH Composite
Collection Date: 1/7/2004

Matrix: SOIL

Analyses	Result	PQL	Qual	Units	DF	Date Analyzed
TCLP-SEMIVOLATILES		SW1311/8270C	(SW3510)			Analyst: MT
Pentachlorophenol-TCLP	< 500	500		µg/L	1	1/13/2004 1:40:00 PM
Pyridine-TCLP	< 100	100		µg/L	1	1/13/2004 1:40:00 PM
TCLP VOLATILES		SW1311/8260	(SW1311)			Analyst: ML
1,1-Dichloroethene-TCLP	< 5	5		µg/L	1	1/9/2004 2:31:00 PM
1,2-Dichloroethane-TCLP	< 5	5		µg/L	1	1/9/2004 2:31:00 PM
1,4-Dichlorobenzene-TCLP	< 5	5		µg/L	1	1/9/2004 2:31:00 PM
2-Butanone-TCLP	< 10	10		µg/L	1	1/9/2004 2:31:00 PM
Benzene-TCLP	< 5	5		µg/L	1	1/9/2004 2:31:00 PM
Carbon tetrachloride-TCLP	< 5	5		µg/L	1	1/9/2004 2:31:00 PM
Chlorobenzene-TCLP	< 5	5		µg/L	1	1/9/2004 2:31:00 PM
Chloroform-TCLP	< 5	5		µg/L	1	1/9/2004 2:31:00 PM
Tetrachloroethene-TCLP	< 5	5		µg/L	1	1/9/2004 2:31:00 PM
Trichloroethene-TCLP	< 5	5		µg/L	1	1/9/2004 2:31:00 PM
Vinyl chloride-TCLP	< 10	10		µg/L	1	1/9/2004 2:31:00 PM

Qualifiers: ND - Not Detected at the Reporting Limit
J - Analyte detected below quantitation limits
B - Analyte detected in the associated Method Blank
* - Value exceeds Maximum Contaminant Level

S - Spike Recovery outside accepted recovery limits
R - RPD outside accepted recovery limits
E - Value above quantitation range

CHAIN OF CUSTODY RECORD

RETEC
REMEDICATION
TECHNOLOGIES INC.

REMEDIATION TECHNOLOGIES
1001 W. Seneca Street, Suite 204
Ithaca, NY 14850
(607) 277-5716
Fax (607) 277-9057



Experience is the solution

314 North Pearl Street ♦ Albany, New York 12207
(800) 848-4983 ♦ (518) 434-4546 ♦ Fax (518) 434-0891

January 13, 2004

554-B

Mark Hofferbert
RETEC
1001 West Seneca St.
Suite 204
Ithaca, NY 14850
TEL: (607) 277-5716
FAX: (607) 277-9057

RE: Ward Products

Order No.: 040112003

Dear Mark Hofferbert:

Adirondack Environmental Services, Inc received 2 samples on 1/12/2004 for the analyses presented in the following report.

There were no problems with the analyses and all associated QC met EPA or laboratory specifications, except if noted.

If you have any questions regarding these tests results, please feel free to call.

Sincerely,

ELAP#: 10709
AIHA#: 100307

Tara Daniels
Laboratory Manager

FAX:
Mark Hofferbert

Adirondack Environmental Services, Inc

Date: 13-Jan-04

CLIENT: RETEC
Lab Order: 040112003
Project: Ward Products
Lab ID: 040112003-002

Client Sample ID: S 54-B
Collection Date: 1/9/2004

Matrix: SOIL

Analyses	Result	PQL	Qual	Units	DF	Date Analyzed
ICP METALS		SW6010B		(SW3050A)		Analyst: KH
Chromium	94.2	0.25		µg/g	1	1/12/2004 3:12:00 PM

Qualifiers: ND - Not Detected at the Reporting Limit
J - Analyte detected below quantitation limits
B - Analyte detected in the associated Method Blank
* - Value exceeds Maximum Contaminant Level

S - Spike Recovery outside accepted recovery limits
R - RPD outside accepted recovery limits
E - Value above quantitation range

No.

CHAIN OF CUSTODY RECORD

PROJ. NO.		PROJECT NAME		NO. OF CONTAINERS										
SAMPLERS:		RECEIVING LABORATORY:												
SAMPLE NO.	DATE	TIME	SAMPLE LOCATION		TCLP Metals (8)	TCLP Volatiles	TCLP Semi-Volatiles	TCLP Pesticides/Herbicides	PCBs (µg/kg)	Total Cr (µg/kg)	Total Chromium	REMARKS		
	1-9-04	15:30	Stock Pile A	001	4	X	X	X	X	X	X	3 day Rush turnaround *		
	1-9-04	15:45	S 54-B	002	1	X	X	X	X	X	X	1 day Rush turnaround		
046112003														
10°C														
Relinquished by: (Signature)		Date/Time		Received by: (Signature)		Relinquished by: (Signature)		Date/Time		Received by: (Signature)				
Relinquished by: (Signature)		Date/Time		Received by: (Signature)		Relinquished by: (Signature)		Date/Time		Received by: (Signature)				
Relinquished by: (Signature)		Date/Time		Received for laboratory by: (Signature)		Date/Time								
REMARKS:														
* Hold Stockpile A until further NOTICE 1/12/04 DMA														

PINK COPY - Sampler

YELLOW COPY - Laboratory

WHITE COPY - RETEC



REMEDATION TECHNOLOGIES
 1001 W. Seneca Street, Suite 204
 Ithaca, NY 14850
 (607) 277-5716
 Fax (607) 277-9057



Experience is the solution

314 North Pearl Street ♦ Albany, New York 12207
(800) 848-4983 ♦ (518) 434-4546 ♦ Fax (518) 434-0891

January 20, 2004

Mark Hofferbert

RETEC

1001 West Seneca St.

Suite 204

Ithaca, NY 14850

TEL: (607) 277-5716

FAX: (607) 277-9057

547-B

546-B

542-B (Fail)

RE: Ward Products

Order No.: 040115036

Dear Mark Hofferbert:

Adirondack Environmental Services, Inc received 3 samples on 1/15/2004 for the analyses presented in the following report.

There were no problems with the analyses and all associated QC met EPA or laboratory specifications, except if noted.

If you have any questions regarding these tests results, please feel free to call.

Sincerely,

ELAP#: 10709

AIHA#: 100307

Christopher Hess

QA Manager

FAX:

Mark Hofferbert

Adirondack Environmental Services, Inc

Date: 20-Jan-04

CLIENT: RETEC**Client Sample ID:** S-47B**Lab Order:** 040115036**Collection Date:** 1/14/2004**Project:** Ward Products**Lab ID:** 040115036-001**Matrix:** SOIL

Analyses	Result	PQL	Qual	Units	DF	Date Analyzed
ICP METALS		SW6010B		(SW3050A)		Analyst: KH
Cadmium	4.71	0.25		µg/g	1	1/16/2004 11:40:00 AM

Qualifiers: ND - Not Detected at the Reporting Limit
J - Analyte detected below quantitation limits
B - Analyte detected in the associated Method Blank
* - Value exceeds Maximum Contaminant Level

S - Spike Recovery outside accepted recovery limits
R - RPD outside accepted recovery limits
E - Value above quantitation range

Adirondack Environmental Services, Inc

Date: 20-Jan-04

CLIENT: RETEC
Lab Order: 040115036
Project: Ward Products
Lab ID: 040115036-002

Client Sample ID: S-46B
Collection Date: 1/14/2004
Matrix: SOIL

Analyses	Result	PQL	Qual	Units	DF	Date Analyzed
ICP METALS		SW6010B		(SW3050A)		Analyst: KH
Cadmium	53.3	0.25		µg/g	1	1/16/2004 11:45:00 AM
ICP METALS, TCLP		SW1311/6010A		(SW1311)		Analyst: KH
Cadmium-TCLP	0.33	0.05		mg/L	1	1/20/2004 12:12:00 PM

Qualifiers: ND - Not Detected at the Reporting Limit
J - Analyte detected below quantitation limits
B - Analyte detected in the associated Method Blank
* - Value exceeds Maximum Contaminant Level

S - Spike Recovery outside accepted recovery limits
R - RPD outside accepted recovery limits
E - Value above quantitation range

Adirondack Environmental Services, Inc

Date: 20-Jan-04

CLIENT: RETEC
Lab Order: 040115036
Project: Ward Products
Lab ID: 040115036-003

Client Sample ID: S-42B
Collection Date: 1/14/2004
Matrix: SOIL

Analyses	Result	PQL	Qual	Units	DF	Date Analyzed
ICP METALS		SW6010B		(SW3050A)		Analyst: KH
Cadmium	111	0.25		µg/g	1	1/16/2004 11:50:00 AM

Qualifiers: ND - Not Detected at the Reporting Limit
J - Analyte detected below quantitation limits
B - Analyte detected in the associated Method Blank
* - Value exceeds Maximum Contaminant Level

S - Spike Recovery outside accepted recovery limits
R - RPD outside accepted recovery limits
E - Value above quantitation range

No.

CHAIN OF CUSTODY RECORD

[illegible]

PINK COPY - Sampler

YELLOW COPY - Laboratory

WHITE COPY - RETEC

REMEDIATION TECHNOLOGIES
1001 W. Seneca Street, Suite 204
Ithaca, NY 14850
(607) 277-5716
Fax (607) 277-9057



Experience is the solution

314 North Pearl Street ♦ Albany, New York 12207
(800) 848-4983 ♦ (518) 434-4546 ♦ Fax (518) 434-0891

January 23, 2004

Mark Hofferbert

RETEC

1001 West Seneca St.

Suite 204

Ithaca, NY 14850

TEL: (607) 277-5716

FAX: (607) 277-9057

D7 (Fail)

D8

D9 (Fail)

D10

S82-B

RE: Ward Products

Order No.: 040120001

Dear Mark Hofferbert:

Adirondack Environmental Services, Inc received 5 samples on 1/20/2004 for the analyses presented in the following report.

There were no problems with the analyses and all associated QC met EPA or laboratory specifications, except if noted.

If you have any questions regarding these tests results, please feel free to call.

Sincerely,

ELAP#: 10709

AIHA#: 100307

A handwritten signature in black ink, appearing to read "Chris Hess", is written over a horizontal line.

Christopher Hess

QA Manager

FAX:

Mark Hofferbert

Adirondack Environmental Services, Inc

Date: 23-Jan-04

CLIENT: RETEC**Client Sample ID:** D7**Lab Order:** 040120001**Collection Date:** 1/19/2004**Project:** Ward Products**Lab ID:** 040120001-001**Matrix:** SOIL

Analyses	Result	PQL	Qual	Units	DF	Date Analyzed
ICP METALS		SW6010B		(SW3050A)		Analyst: KH
Cadmium	209	0.25		µg/g	1	1/20/2004 1:29:00 PM

Qualifiers:

ND - Not Detected at the Reporting Limit

S - Spike Recovery outside accepted recovery limits

J - Analyte detected below quantitation limits

R - RPD outside accepted recovery limits

B - Analyte detected in the associated Method Blank

E - Value above quantitation range

* - Value exceeds Maximum Contaminant Level

Adirondack Environmental Services, Inc**Date:** 23-Jan-04

CLIENT: RETEC
Lab Order: 040120001
Project: Ward Products
Lab ID: 040120001-002

Client Sample ID: D8
Collection Date: 1/19/2004
Matrix: SOIL

Analyses	Result	PQL	Qual	Units	DF	Date Analyzed
ICP METALS		SW6010B		(SW3050A)		Analyst: KH
Cadmium	7.11	0.25		µg/g	1	1/20/2004 1:35:00 PM

Qualifiers: ND - Not Detected at the Reporting Limit
J - Analyte detected below quantitation limits
B - Analyte detected in the associated Method Blank
* - Value exceeds Maximum Contaminant Level

S - Spike Recovery outside accepted recovery limits
R - RPD outside accepted recovery limits
E - Value above quantitation range

Adirondack Environmental Services, Inc

Date: 23-Jan-04

CLIENT: RETEC

Client Sample ID: D9

Lab Order: 040120001

Collection Date: 1/19/2004

Project: Ward Products

Lab ID: 040120001-003

Matrix: SOIL

Analyses	Result	PQL	Qual	Units	DF	Date Analyzed
ICP METALS		SW6010B		(SW3050A)		Analyst: KH
Cadmium	155	0.25		µg/g	1	1/20/2004 1:40:00 PM

Qualifiers:

ND - Not Detected at the Reporting Limit

S - Spike Recovery outside accepted recovery limits

J - Analyte detected below quantitation limits

R - RPD outside accepted recovery limits

B - Analyte detected in the associated Method Blank

E - Value above quantitation range

* - Value exceeds Maximum Contaminant Level

Adirondack Environmental Services, Inc

Date: 23-Jan-04

CLIENT: RETEC**Client Sample ID:** D10**Lab Order:** 040120001**Collection Date:** 1/19/2004**Project:** Ward Products**Lab ID:** 040120001-004**Matrix:** SOIL

Analyses	Result	PQL	Qual	Units	DF	Date Analyzed
ICP METALS		SW6010B		(SW3050A)		Analyst: KH
Cadmium	45.2	0.25		µg/g	1	1/20/2004 1:43:00 PM

Qualifiers:

ND - Not Detected at the Reporting Limit

S - Spike Recovery outside accepted recovery limits

J - Analyte detected below quantitation limits

R - RPD outside accepted recovery limits

B - Analyte detected in the associated Method Blank

E - Value above quantitation range

* - Value exceeds Maximum Contaminant Level

Adirondack Environmental Services, Inc**Date:** 23-Jan-04**CLIENT:** RETEC**Client Sample ID:** S82-B**Lab Order:** 040120001**Collection Date:** 1/19/2004**Project:** Ward Products**Lab ID:** 040120001-005**Matrix:** SOIL

Analyses	Result	PQL	Qual	Units	DF	Date Analyzed
ICP METALS		SW6010B		(SW3050A)		Analyst: KH
Cadmium	30.2	0.25		µg/g	1	1/20/2004 1:47:00 PM
ICP METALS, TCLP		SW1311/6010A		(SW1311)		Analyst: SM
Cadmium-TCLP	0.24	0.05		mg/L	1	1/23/2004 12:12:00 PM

Qualifiers:

ND - Not Detected at the Reporting Limit

S - Spike Recovery outside accepted recovery limits

J - Analyte detected below quantitation limits

R - RPD outside accepted recovery limits

B - Analyte detected in the associated Method Blank

E - Value above quantitation range

* - Value exceeds Maximum Contaminant Level

No.

CHAIN OF CUSTODY RECORD

PROJ. NO.		PROJECT NAME	
SAMPLERS:			
RECEIVING LABORATORY:			
SAMPLE NO.	DATE	TIME	SAMPLE LOCATION
	1-19-04	1330	D7 > 001
		1330	D7 >
		1335	D8 > 002
		1335	D8 >
		1340	D9 > 003
		1340	D9 >
		1345	D10 > 004
		1345	D10 >
		14:20	S B2-B > 005
		14:20	S B2-B >
040120001			
Relinquished by: (Signature)		Date/Time	Received by: (Signature)
[Signature]		1-19-04 16:00	[Signature]
Relinquished by: (Signature)		Date/Time	Received by: (Signature)
[Signature]			
Relinquished by: (Signature)		Date/Time	Received for laboratory by: (Signature)
[Signature]			M [Signature]
REMARKS:		Date/Time	
4°C		1/20/04	7:32 AM

Please Fax Results to
Best Western
c/o Mark Hofferbert
518-842-0940

(SOIL)

Rush totals (1 day)
Hold TCLPs

RELTEC
REMEDIATION TECHNOLOGIES INC.
1001 W. Seneca Street, Suite 20
Ithaca, NY 14850
(607) 277-5711
Fax (607) 277-9055

PINK COPY - Sampler

YELLOW COPY - Laboratory

WHITE COPY - RETEC



Experience is the solution

314 North Pearl Street ♦ Albany, New York 12207
(800) 848-4983 ♦ (518) 434-4546 ♦ Fax (518) 434-0891

January 28, 2004

Mark Hofferbert
RETEC
1001 West Seneca St.
Suite 204
Ithaca, NY 14850

TEL: (607) 277-5716

FAX: (607) 277-9057

RE: Ward Products

Order No.: 040121003

Dear Mark Hofferbert:

Adirondack Environmental Services, Inc received 2 samples on 1/21/2004 for the analyses presented in the following report.

There were no problems with the analyses and all associated QC met EPA or laboratory specifications, except if noted.

If you have any questions regarding these tests results, please feel free to call.

Sincerely,

ELAP#: 10709

AIHA#: 100307

Christopher Hess
QA Manager

Adirondack Environmental Services, Inc

Date: 28-Jan-04

CLIENT: RETEC**Client Sample ID:** S42-C**Lab Order:** 040121003**Collection Date:** 1/20/2004**Project:** Ward Products**Lab ID:** 040121003-001**Matrix:** SOIL

Analyses	Result	PQL	Qual	Units	DF	Date Analyzed
ICP METALS		SW6010B		(SW3050A)		Analyst: SM
Cadmium	< 0.25	0.25		µg/g	1	1/21/2004 3:42:00 PM

Qualifiers: ND - Not Detected at the Reporting Limit
J - Analyte detected below quantitation limits
B - Analyte detected in the associated Method Blank
* - Value exceeds Maximum Contaminant Level

S - Spike Recovery outside accepted recovery limits
R - RPD outside accepted recovery limits
E - Value above quantitation range

Adirondack Environmental Services, Inc**Date:** 28-Jan-04**CLIENT:** RETEC**Client Sample ID:** S9-B**Lab Order:** 040121003**Collection Date:** 1/20/2004**Project:** Ward Products**Lab ID:** 040121003-002**Matrix:** SOIL

Analyses	Result	PQL	Qual	Units	DF	Date Analyzed
ICP METALS		SW6010B		(SW3050A)		Analyst: SM
Cadmium	< 0.25	0.25		µg/g	1	1/21/2004 3:55:00 PM

Qualifiers: ND - Not Detected at the Reporting Limit
J - Analyte detected below quantitation limits
B - Analyte detected in the associated Method Blank
* - Value exceeds Maximum Contaminant Level

S - Spike Recovery outside accepted recovery limits
R - RPD outside accepted recovery limits
E - Value above quantitation range

No.

CHAIN OF CUSTODY RECORD

PROJ. NO.		PROJECT NAME Ward Products		NO. OF CONTAINERS	Total cadmium	TCLP Cadmium					Please Fax Results to Best Western C/O Mark Hofferbert 518-842-0940 SOILS		
SAMPLERS: Jesse Lloyd		RECEIVING LABORATORY: Adirondack, Albany											
SAMPLE NO.	DATE 1-20-04	TIME	SAMPLE LOCATION										
	15:00		S42C S 82 C 001	1	X						Hold For possible TCLP ↓ Rush totals (1 day)		
	15:30		S 9-B 002	1	X								
<div style="border: 1px solid black; border-radius: 50%; width: 150px; height: 100px; margin: 10px auto; text-align: center; line-height: 100px;">040121003</div> <div style="border: 1px solid black; border-radius: 50%; width: 200px; height: 150px; margin: 10px auto; text-align: center; line-height: 150px;"> * ↓ Change ID AS per client's call 1/21/04 @ 845am DMA </div>											5°C		
Relinquished by: (Signature) Jesse Lloyd		Date/Time 1-20-04 16:00		Received by: (Signature) J. F. W. K.		Relinquished by: (Signature)		Date/Time		Received by: (Signature)			
Relinquished by: (Signature)		Date/Time		Received by: (Signature)		Relinquished by: (Signature)		Date/Time		Received by: (Signature)			
Relinquished by: (Signature)		Date/Time		Received for laboratory by: (Signature) M P		Date/Time 1/21/04 8:12							
REMARKS:													



REMEDATION TECHNOLOGIES
1001 W. Seneca Street, Suite 204
Ithaca, NY 14850
(607) 277-5716
Fax (607) 277-9057



Experience is the solution

314 North Pearl Street ♦ Albany, New York 12207
(800) 848-4983 ♦ (518) 434-4546 ♦ Fax (518) 434-0891

D 9-B

S 144-B

January 29, 2004

Mark Hofferbert

RETEC

1001 West Seneca St.

Suite 204

Ithaca, NY 14850

TEL: (607) 277-5716

FAX: (607) 277-9057

RE: Ward Products

Order No.: 040128003

Dear Mark Hofferbert:

Adirondack Environmental Services, Inc received 2 samples on 1/28/2004 for the analyses presented in the following report.

There were no problems with the analyses and all associated QC met EPA or laboratory specifications, except if noted.

If you have any questions regarding these tests results, please feel free to call.

Sincerely,

ELAP#: 10709

AIHA#: 100307

Christopher Hess

QA Manager

FAX:

Mark Hofferbert

Adirondack Environmental Services, Inc

Date: 29-Jan-04

CLIENT: RETEC
Lab Order: 040128003
Project: Ward Products
Lab ID: 040128003-001

Client Sample ID: D9-B
Collection Date: 1/27/2004
Matrix: SOIL

Analyses	Result	PQL	Qual	Units	DF	Date Analyzed
ICP METALS		SW6010B		(SW3050A)		Analyst: WB
Cadmium	< 0.25	0.25		µg/g	1	1/28/2004 12:55:00 PM

Qualifiers: ND - Not Detected at the Reporting Limit
J - Analyte detected below quantitation limits
B - Analyte detected in the associated Method Blank
* - Value exceeds Maximum Contaminant Level

S - Spike Recovery outside accepted recovery limits
R - RPD outside accepted recovery limits
E - Value above quantitation range

Adirondack Environmental Services, Inc

Date: 29-Jan-04

CLIENT: RETEC
Lab Order: 040128003
Project: Ward Products
Lab ID: 040128003-002

Client Sample ID: S14A-B
Collection Date: 1/27/2004

Matrix: SOIL

Analyses	Result	PQL	Qual	Units	DF	Date Analyzed
ICP METALS		SW6010B		(SW3050A)		Analyst: WB
Cadmium	11.4	0.25		µg/g	1	1/28/2004 1:09:00 PM

Qualifiers: ND - Not Detected at the Reporting Limit
J - Analyte detected below quantitation limits
B - Analyte detected in the associated Method Blank
* - Value exceeds Maximum Contaminant Level

S - Spike Recovery outside accepted recovery limits
R - RPD outside accepted recovery limits
E - Value above quantitation range

No.

CHAIN OF CUSTODY RECORD

PROJ. NO.		PROJECT NAME Ward Products						NO. OF CONTAINERS		Fax report to Best Western c/o Mark Hoffert 518-842-0940							
SAMPLERS: <i>Jesse Lloyd</i>																	
RECEIVING LABORATORY: Adirondack, Albany																	
SAMPLE NO.	DATE	TIME	SAMPLE LOCATION							REMARKS							
	1-5-04	12:00	Ditch JC														
	1-27-04		D9-B 001							1 day rush turnaround, hold remaining sample							
	1-27-04	1100	S14A-B 002														
			AH + JC														
			(SOILS)														
			(040128003)														
										(6°C)							
Relinquished by: (Signature) <i>Jesse Lloyd</i>			Date/Time 1-27-04 16:15		Received by: (Signature) <i>[Signature]</i>			Relinquished by: (Signature)			Date/Time		Received by: (Signature)				
Relinquished by: (Signature)			Date/Time		Received by: (Signature)			Relinquished by: (Signature)			Date/Time		Received by: (Signature)				
Relinquished by: (Signature)			Date/Time		Received for laboratory by: (Signature) <i>M.</i>			Date/Time 1/28/04 8 ⁴⁵		<p>REMEDIATION TECHNOLOGIES INC. 1001 W. Seneca Street, Suite 20 Ithaca, NY 1485 (607) 277-571 Fax (607) 277-905</p>							
REMARKS:																	

PINK COPY - Sampler

YELLOW COPY - Laboratory

WHITE COPY - RETEC



Experience is the solution
314 North Pearl Street ♦ Albany, New York 12207
(800) 848-4983 ♦ (518) 434-4546 ♦ Fax (518) 434-0891

February 04, 2004

Mark Hofferbert
RETEC
1001 West Seneca St.
Suite 204
Ithaca, NY 14850

TEL: (607) 277-5716
FAX: (607) 277-9057

S 40 - 13

D 4

D 5

D 6 (Fail)

RE: Ward Products

Order No.: 040119008

Dear Mark Hofferbert:

Adirondack Environmental Services, Inc received 4 samples on 1/19/2004 for the analyses presented in the following report.

There were no problems with the analyses and all associated QC met EPA or laboratory specifications, except if noted.

If you have any questions regarding these tests results, please feel free to call.

Sincerely,

ELAP#: 10709

AIHA#: 100307

Christopher Hess
QA Manager

FAX:
Mark Hofferbert

CLIENT: RETEC

Project: Ward Products

Lab Order: 040119008

CASE NARRATIVE

This is an updated report 2/4/04 to include the added analytes for Total Chromium, Nickel, Zinc, TCLP Cadmium and Cyanide.

Adirondack Environmental Services, Inc

Date: 04-Feb-04

CLIENT: RETEC
Lab Order: 040119008
Project: Ward Products
Lab ID: 040119008-001

Client Sample ID: S-40B
Collection Date: 1/16/2004
Matrix: SOIL

Analyses	Result	PQL	Qual	Units	DF	Date Analyzed
ICP METALS		SW6010B		(SW3050A)		Analyst: KH
Cadmium	15.3	0.25		µg/g	1	1/19/2004 11:02:00 AM

Qualifiers: ND - Not Detected at the Reporting Limit
J - Analyte detected below quantitation limits
B - Analyte detected in the associated Method Blank
* - Value exceeds Maximum Contaminant Level

S - Spike Recovery outside accepted recovery limits
R - RPD outside accepted recovery limits
E - Value above quantitation range

Adirondack Environmental Services, Inc

Date: 04-Feb-04

CLIENT: RETEC

Client Sample ID: D-4

Lab Order: 040119008

Collection Date: 1/16/2004

Project: Ward Products

Lab ID: 040119008-002

Matrix: SOIL

Analyses	Result	PQL	Qual	Units	DF	Date Analyzed
ICP METALS		SW6010B		(SW3050A)		Analyst: KH
Cadmium	2.04	0.25		µg/g	1	1/19/2004 11:18:00 AM
Chromium	58.5	0.25		µg/g	1	1/19/2004 11:18:00 AM
Nickel	41.8	2.50		µg/g	1	1/19/2004 11:18:00 AM
Zinc	55.9	0.50		µg/g	1	1/19/2004 11:18:00 AM
ICP METALS, TCLP		SW1311/6010A		(SW1311)		Analyst: KH
Cadmium-TCLP	< 0.05	0.05		mg/L	1	2/3/2004 12:50:00 PM
CYANIDE, TOTAL		SW9012				Analyst: MC
Cyanide	< 0.5	0.5	H	µg/g	1	2/3/2004

Qualifiers:

ND - Not Detected at the Reporting Limit

S - Spike Recovery outside accepted recovery limits

J - Analyte detected below quantitation limits

R - RPD outside accepted recovery limits

B - Analyte detected in the associated Method Blank

E - Value above quantitation range

* - Value exceeds Maximum Contaminant Level

Adirondack Environmental Services, Inc**Date:** 04-Feb-04**CLIENT:** RETEC**Client Sample ID:** D-5**Lab Order:** 040119008**Collection Date:** 1/16/2004**Project:** Ward Products**Lab ID:** 040119008-003**Matrix:** SOIL

Analyses	Result	PQL	Qual	Units	DF	Date Analyzed
ICP METALS		SW6010B		(SW3050A)		Analyst: KH
Cadmium	6.85	0.25		µg/g	1	1/19/2004 11:22:00 AM

Qualifiers: ND - Not Detected at the Reporting Limit
J - Analyte detected below quantitation limits
B - Analyte detected in the associated Method Blank
* - Value exceeds Maximum Contaminant Level

S - Spike Recovery outside accepted recovery limits
R - RPD outside accepted recovery limits
E - Value above quantitation range

Adirondack Environmental Services, Inc

Date: 04-Feb-04

CLIENT: RETEC

Client Sample ID: D-6

Lab Order: 040119008

Collection Date: 1/16/2004

Project: Ward Products

Lab ID: 040119008-004

Matrix: SOIL

Analyses	Result	PQL	Qual	Units	DF	Date Analyzed
ICP METALS		SW6010B		(SW3050A)		Analyst: KH
Cadmium	62.7	0.25		µg/g	1	1/19/2004 11:26:00 AM
ICP METALS, TCLP		SW1311/6010A		(SW1311)		Analyst: SM
Cadmium-TCLP	1.57	0.05	*	mg/L	1	1/21/2004 4:07:00 PM

Qualifiers: ND - Not Detected at the Reporting Limit
J - Analyte detected below quantitation limits
B - Analyte detected in the associated Method Blank
* - Value exceeds Maximum Contaminant Level

S - Spike Recovery outside accepted recovery limits
R - RPD outside accepted recovery limits
E - Value above quantitation range



Experience is the solution

314 North Pearl Street ♦ Albany, New York 12207
(800) 848-4983 ♦ (518) 434-4546 ♦ Fax (518) 434-0891

February 04, 2004

Mark Hofferbert

RETEC

1001 West Seneca St.

Suite 204

Ithaca, NY 14850

TEL: (607) 277-5716

FAX: (607) 277-9057

D 11

S 13 A-B

D 12

D 13

D 14

RE: Ward Products

Order No.: 040122006

Dear Mark Hofferbert:

Adirondack Environmental Services, Inc received 5 samples on 1/22/2004 for the analyses presented in the following report.

There were no problems with the analyses and all associated QC met EPA or laboratory specifications, except if noted.

If you have any questions regarding these tests results, please feel free to call.

Sincerely,

ELAP#: 10709

AIHA#: 100307

Christopher Hess

QA Manager

FAX:

Mark Hofferbert

Adirondack Environmental Services, Inc**Date:** 04-Feb-04**CLIENT:** RETEC**Project:** Ward Products**Lab Order:** 040122006**CASE NARRATIVE**

This is an updated report 2/4/04 to include the added analytes for Total Chromium, Nickel, Zinc, TCLP Cadmium and Cyanide.

Adirondack Environmental Services, Inc

Date: 04-Feb-04

CLIENT: RETEC
Lab Order: 040122006
Project: Ward Products
Lab ID: 040122006-001

Client Sample ID: D-11
Collection Date: 1/21/2004
Matrix: SOIL

Analyses	Result	PQL	Qual	Units	DF	Date Analyzed
ICP METALS		SW6010B	(SW3050A)			Analyst: SM
Cadmium	14.8	0.25		µg/g	1	1/22/2004 1:27:00 PM
Chromium	97.9	0.25		µg/g	1	1/22/2004 1:27:00 PM
Nickel	22.2	2.50		µg/g	1	1/22/2004 1:27:00 PM
Zinc	53.9	0.50		µg/g	1	1/22/2004 1:27:00 PM
ICP METALS, TCLP		SW1311/6010A	(SW1311)			Analyst: KH
Cadmium-TCLP	0.38	0.05		mg/L	1	2/3/2004 12:57:00 PM
CYANIDE, TOTAL		SW9012				Analyst: MC
Cyanide	< 0.5	0.5		µg/g	1	2/3/2004

Qualifiers: ND - Not Detected at the Reporting Limit
J - Analyte detected below quantitation limits
B - Analyte detected in the associated Method Blank
* - Value exceeds Maximum Contaminant Level

S - Spike Recovery outside accepted recovery limits
R - RPD outside accepted recovery limits
E - Value above quantitation range

Adirondack Environmental Services, Inc**Date:** 04-Feb-04**CLIENT:** RETEC**Client Sample ID:** S-13A-B**Lab Order:** 040122006**Collection Date:** 1/21/2004**Project:** Ward Products**Lab ID:** 040122006-002**Matrix:** SOIL

Analyses	Result	PQL	Qual	Units	DF	Date Analyzed
ICP METALS		SW6010B		(SW3050A)		Analyst: SM
Cadmium	1.00	0.25		µg/g	1	1/22/2004 1:46:00 PM

Qualifiers:

ND - Not Detected at the Reporting Limit

S - Spike Recovery outside accepted recovery limits

J - Analyte detected below quantitation limits

R - RPD outside accepted recovery limits

B - Analyte detected in the associated Method Blank

E - Value above quantitation range

* - Value exceeds Maximum Contaminant Level

Adirondack Environmental Services, Inc

Date: 04-Feb-04

CLIENT: RETEC**Client Sample ID:** D-12**Lab Order:** 040122006**Collection Date:** 1/21/2004**Project:** Ward Products**Lab ID:** 040122006-003**Matrix:** SOIL

Analyses	Result	PQL	Qual	Units	DF	Date Analyzed
ICP METALS		SW6010B		(SW3050A)		Analyst: SM
Cadmium	0.92	0.25		µg/g	1	1/22/2004 1:51:00 PM

Qualifiers:

ND - Not Detected at the Reporting Limit

S - Spike Recovery outside accepted recovery limits

J - Analyte detected below quantitation limits

R - RPD outside accepted recovery limits

B - Analyte detected in the associated Method Blank

E - Value above quantitation range

* - Value exceeds Maximum Contaminant Level

Adirondack Environmental Services, Inc

Date: 04-Feb-04

CLIENT: RETEC**Client Sample ID:** D-13**Lab Order:** 040122006**Collection Date:** 1/21/2004**Project:** Ward Products**Lab ID:** 040122006-004**Matrix:** SOIL

Analyses	Result	PQL	Qual	Units	DF	Date Analyzed
ICP METALS		SW6010B		(SW3050A)		Analyst: SM
Cadmium	< 0.25	0.25		µg/g	1	1/22/2004 2:32:00 PM
Chromium	17.0	0.25		µg/g	1	1/22/2004 2:32:00 PM
Nickel	< 2.50	2.50		µg/g	1	1/22/2004 2:32:00 PM
Zinc	46.3	0.50		µg/g	1	1/22/2004 2:32:00 PM
ICP METALS, TCLP		SW1311/6010A		(SW1311)		Analyst: KH
Cadmium-TCLP	< 0.05	0.05		mg/L	1	2/3/2004 1:03:00 PM
CYANIDE, TOTAL		SW9012				Analyst: MC
Cyanide	< 0.5	0.5		µg/g	1	2/3/2004

Qualifiers: ND - Not Detected at the Reporting Limit
J - Analyte detected below quantitation limits
B - Analyte detected in the associated Method Blank
* - Value exceeds Maximum Contaminant Level

S - Spike Recovery outside accepted recovery limits
R - RPD outside accepted recovery limits
E - Value above quantitation range

Adirondack Environmental Services, Inc**Date:** 04-Feb-04**CLIENT:** RETEC**Client Sample ID:** D-14**Lab Order:** 040122006**Collection Date:** 1/21/2004**Project:** Ward Products**Lab ID:** 040122006-005**Matrix:** SOIL

Analyses	Result	PQL	Qual	Units	DF	Date Analyzed
ICP METALS		SW6010B		(SW3050A)		Analyst: SM
Cadmium	< 0.25	0.25		µg/g	1	1/22/2004 2:35:00 PM

Qualifiers: ND - Not Detected at the Reporting Limit
J - Analyte detected below quantitation limits
B - Analyte detected in the associated Method Blank
* - Value exceeds Maximum Contaminant Level

S - Spike Recovery outside accepted recovery limits
R - RPD outside accepted recovery limits
E - Value above quantitation range

No.

CHAIN OF CUSTODY RECORD

[illegible]

PINK COPY - Sampler

YELLOW COPY - Laboratory

WHITE COPY - RETEC



Experience is the solution
314 North Pearl Street ♦ Albany, New York 12207
(800) 848-4983 ♦ (518) 434-4546 ♦ Fax (518) 434-0891

February 04, 2004

Mark Hofferbert
RETEC

1001 West Seneca St.
Suite 204
Ithaca, NY 14850

TEL: (607) 277-5716
FAX: (607) 277-9057

D 7-B

D 10-B

S 9-C

RE: Ward Products

Order No.: 040129011

Dear Mark Hofferbert:

Adirondack Environmental Services, Inc received 3 samples on 1/29/2004 for the analyses presented in the following report.

There were no problems with the analyses and all associated QC met EPA or laboratory specifications, except if noted.

If you have any questions regarding these tests results, please feel free to call.

Sincerely,

ELAP#: 10709
AIHA#: 100307

Christopher Hess
QA Manager

FAX:
Mark Hofferbert

Adirondack Environmental Services, Inc**Date:** 04-Feb-04**CLIENT:** RETEC**Project:** Ward Products**Lab Order:** 040129011**CASE NARRATIVE**

This is an updated report 2/4/04 to include the added analytes for Total Chromium, Nickel, Zinc, TCLP Cadmium and Cyanide.

Adirondack Environmental Services, Inc

Date: 04-Feb-04

CLIENT: RETEC
Lab Order: 040129011
Project: Ward Products
Lab ID: 040129011-001

Client Sample ID: D-7B
Collection Date: 1/28/2004
Matrix: SOIL

Analyses	Result	PQL	Qual	Units	DF	Date Analyzed
ICP METALS		SW6010B	(SW3050A)			Analyst: KH
Cadmium	4.87	0.25		µg/g	1	1/29/2004 1:21:00 PM
Chromium	42.6	0.25		µg/g	1	1/29/2004 1:21:00 PM
Nickel	68.4	2.50		µg/g	1	1/29/2004 1:21:00 PM
Zinc	35.9	0.50		µg/g	1	1/29/2004 1:21:00 PM
ICP METALS, TCLP		SW1311/6010A	(SW1311)			Analyst: KH
Cadmium-TCLP	0.22	0.05		mg/L	1	2/3/2004 1:12:00 PM
CYANIDE, TOTAL		SW9012				Analyst: MC
Cyanide	< 0.5	0.5		µg/g	1	2/3/2004

Qualifiers: ND - Not Detected at the Reporting Limit
J - Analyte detected below quantitation limits
B - Analyte detected in the associated Method Blank
* - Value exceeds Maximum Contaminant Level

S - Spike Recovery outside accepted recovery limits
R - RPD outside accepted recovery limits
E - Value above quantitation range

Adirondack Environmental Services, Inc

Date: 04-Feb-04

CLIENT: RETEC
Lab Order: 040129011
Project: Ward Products
Lab ID: 040129011-002

Client Sample ID: D-10B
Collection Date: 1/28/2004
Matrix: SOIL

Analyses	Result	PQL	Qual	Units	DF	Date Analyzed
ICP METALS		SW6010B		(SW3050A)		Analyst: KH
Cadmium	12.2	0.25		µg/g	1	1/29/2004 1:35:00 PM
Chromium	148	0.25		µg/g	1	1/29/2004 1:35:00 PM
Nickel	193	2.50		µg/g	1	1/29/2004 1:35:00 PM
Zinc	76.6	0.50		µg/g	1	1/29/2004 1:35:00 PM
ICP METALS, TCLP		SW1311/6010A		(SW1311)		Analyst: KH
Cadmium-TCLP	0.24	0.05		mg/L	1	2/3/2004 1:15:00 PM
CYANIDE, TOTAL		SW9012				Analyst: MC
Cyanide	< 0.5	0.5		µg/g	1	2/3/2004

Qualifiers: ND - Not Detected at the Reporting Limit
J - Analyte detected below quantitation limits
B - Analyte detected in the associated Method Blank
* - Value exceeds Maximum Contaminant Level

S - Spike Recovery outside accepted recovery limits
R - RPD outside accepted recovery limits
E - Value above quantitation range

Adirondack Environmental Services, Inc**Date:** 04-Feb-04**CLIENT:** RETEC**Client Sample ID:** S9-C**Lab Order:** 040129011**Collection Date:** 1/28/2004**Project:** Ward Products**Lab ID:** 040129011-003**Matrix:** SOIL

Analyses	Result	PQL	Qual	Units	DF	Date Analyzed
ICP METALS		SW6010B		(SW3050A)		Analyst: KH
Cadmium	< 0.25	0.25		µg/g	1	1/29/2004 1:39:00 PM

Qualifiers: ND - Not Detected at the Reporting Limit
J - Analyte detected below quantitation limits
B - Analyte detected in the associated Method Blank
* - Value exceeds Maximum Contaminant Level

S - Spike Recovery outside accepted recovery limits
R - RPD outside accepted recovery limits
E - Value above quantitation range



Experience is the solution

314 North Pearl Street ♦ Albany, New York 12207
(800) 848-4983 ♦ (518) 434-4546 ♦ Fax (518) 434-0891

February 04, 2004

Mark Hofferbert

RETEC

1001 West Seneca St.

Suite 204

Ithaca, NY 14850

TEL: (607) 277-5716

FAX: (607) 277-9057

S 53-B

S 14-X

D 1

D 2

D 3

RE: Ward Products

Order No.: 040113003

Dear Mark Hofferbert:

Adirondack Environmental Services, Inc received 5 samples on 1/13/2004 for the analyses presented in the following report.

There were no problems with the analyses and all associated QC met EPA or laboratory specifications, except if noted.

If you have any questions regarding these tests results, please feel free to call.

Sincerely,

ELAP#: 10709

AIHA#: 100307

Christopher Hess

QA Manager

FAX:

Mark Hofferbert

Adirondack Environmental Services, Inc**Date:** 04-Feb-04**CLIENT:** RETEC**Project:** Ward Products**Lab Order:** 040113003**CASE NARRATIVE**

This is an updated report 2/4/04 to include the added analytes for Total Chromium, Nickel, Zinc, TCLP Cadmium and Cyanide.

Adirondack Environmental Services, Inc

Date: 04-Feb-04

CLIENT: RETEC

Client Sample ID: S-53B

Lab Order: 040113003

Collection Date: 1/12/2004

Project: Ward Products

Lab ID: 040113003-001

Matrix: SOIL

Analyses	Result	PQL	Qual	Units	DF	Date Analyzed
ICP METALS		SW6010B		(SW3050A)		Analyst: SM
Cadmium	28.7	0.25		µg/g	1	1/13/2004 1:50:00 PM

Qualifiers:

ND - Not Detected at the Reporting Limit

S - Spike Recovery outside accepted recovery limits

J - Analyte detected below quantitation limits

R - RPD outside accepted recovery limits

B - Analyte detected in the associated Method Blank

E - Value above quantitation range

* - Value exceeds Maximum Contaminant Level

Adirondack Environmental Services, Inc**Date:** 04-Feb-04**CLIENT:** RETEC**Client Sample ID:** S-14B**Lab Order:** 040113003**Collection Date:** 1/12/2004**Project:** Ward Products**Lab ID:** 040113003-002**Matrix:** SOIL

Analyses	Result	PQL	Qual	Units	DF	Date Analyzed
ICP METALS		SW6010B		(SW3050A)		Analyst: SM
Chromium	164	0.25		µg/g	1	1/13/2004 1:57:00 PM

Qualifiers: ND - Not Detected at the Reporting Limit
J - Analyte detected below quantitation limits
B - Analyte detected in the associated Method Blank
* - Value exceeds Maximum Contaminant Level

S - Spike Recovery outside accepted recovery limits
R - RPD outside accepted recovery limits
E - Value above quantitation range

Adirondack Environmental Services, Inc

Date: 04-Feb-04

CLIENT: RETEC

Client Sample ID: D-1

Lab Order: 040113003

Collection Date: 1/12/2004

Project: Ward Products

Lab ID: 040113003-003

Matrix: SOIL

Analyses	Result	PQL	Qual	Units	DF	Date Analyzed
ICP METALS		SW6010B		(SW3050A)		Analyst: SM
Cadmium	20.7	0.25		µg/g	1	1/13/2004 2:00:00 PM

Qualifiers:

ND - Not Detected at the Reporting Limit

S - Spike Recovery outside accepted recovery limits

J - Analyte detected below quantitation limits

R - RPD outside accepted recovery limits

B - Analyte detected in the associated Method Blank

E - Value above quantitation range

* - Value exceeds Maximum Contaminant Level

Adirondack Environmental Services, Inc

Date: 04-Feb-04

CLIENT: RETEC**Client Sample ID:** D-2**Lab Order:** 040113003**Collection Date:** 1/12/2004**Project:** Ward Products**Lab ID:** 040113003-004**Matrix:** SOIL

Analyses	Result	PQL	Qual	Units	DF	Date Analyzed
ICP METALS		SW6010B		(SW3050A)		Analyst: SM
Cadmium	0.34	0.25		µg/g	1	1/13/2004 2:05:00 PM
Chromium	24.5	0.25		µg/g	1	1/13/2004 2:05:00 PM
Nickel	< 2.50	2.50		µg/g	1	1/13/2004 2:05:00 PM
Zinc	67.7	0.50		µg/g	1	1/13/2004 2:05:00 PM
ICP METALS, TCLP		SW1311/6010A		(SW1311)		Analyst: KH
Cadmium-TCLP	< 0.05	0.05		mg/L	1	2/3/2004 12:46:00 PM
CYANIDE, TOTAL		SW9012				Analyst: MC
Cyanide	< 0.5	0.5	H	µg/g	1	2/3/2004

Qualifiers: ND - Not Detected at the Reporting Limit
J - Analyte detected below quantitation limits
B - Analyte detected in the associated Method Blank
* - Value exceeds Maximum Contaminant Level

S - Spike Recovery outside accepted recovery limits
R - RPD outside accepted recovery limits
E - Value above quantitation range

Adirondack Environmental Services, Inc

Date: 04-Feb-04

CLIENT: RETEC

Client Sample ID: D-3

Lab Order: 040113003

Collection Date: 1/12/2004

Project: Ward Products

Lab ID: 040113003-005

Matrix: SOIL

Analyses	Result	PQL	Qual	Units	DF	Date Analyzed
ICP METALS		SW6010B		(SW3050A)		Analyst: SM
Cadmium	2.21	0.25		µg/g	1	1/13/2004 2:10:00 PM

Qualifiers:

ND - Not Detected at the Reporting Limit

S - Spike Recovery outside accepted recovery limits

J - Analyte detected below quantitation limits

R - RPD outside accepted recovery limits

B - Analyte detected in the associated Method Blank

E - Value above quantitation range

* - Value exceeds Maximum Contaminant Level

No.

CHAIN OF CUSTODY RECORD

velocity
cm/s

PROJ. NO.		PROJECT NAME		NO. OF CONTAINERS	Total Cadmium				TCLP Cadmium				Total Chromium				REMARKS		
SAMPLERS:																			
RECEIVING LABORATORY:																			
SAMPLE NO.	DATE	TIME	SAMPLE LOCATION																
001	1-12-04	8:00	S-53 B	1	X										Rush turnaround (1 day)				
		8:00	S-53 B	1	X										Hold TCLP Cadmium				
002		8:30	S-14 B	1			X								Rush turnaround (1 day)				
		8:30	S-14 B SL																
003	1-12-04	16:00	D-1	1	X										Rush turnaround (1 day)				
		16:00	D-1	1	X										Hold TCLP				
004		16:05	D-2	1	X										Rush turnaround (1 day)				
		16:05	D-2	1	X										Hold TCLP				
005		11:45	D-3		X										Rush turnaround (1 day)				
		16:45	D-3		X										Hold TCLP				
040113003																			
Relinquished by: (Signature)		Date/Time		Received by: (Signature)		Relinquished by: (Signature)		Date/Time		Received by: (Signature)		Relinquished by: (Signature)		Date/Time		Received by: (Signature)			
[Signature]		1-12-04 17:00		[Signature]		[Signature]				[Signature]		[Signature]				[Signature]			
Relinquished by: (Signature)		Date/Time		Received by: (Signature)		Relinquished by: (Signature)		Date/Time		Received by: (Signature)		Relinquished by: (Signature)		Date/Time		Received by: (Signature)			
[Signature]				[Signature]		[Signature]				[Signature]		[Signature]				[Signature]			
Relinquished by: (Signature)		Date/Time		Received for laboratory by: (Signature)		Date/Time													
[Signature]				[Signature]		1/13/04 845													
REMARKS: 10°C																 <p>RE/EC REMEDICATION TECHNOLOGIES INC.</p>		<p>REMEDIATION TECHNOLOGIES 1001 W. Seneca Street, Suite 20 Ithaca, NY 14850 (607) 277-5711 Fax (607) 277-9051</p>	

PINK COPY - Sampler

YELLOW COPY - Laboratory

WHITE COPY - RETEC

RELEC
REMEDIA TIO
TECHNOLOGIES IN

REMEDIATION TECHNOLOGIES
1001 W. Seneca Street, Suite 204
Ithaca, NY 14850
(607) 277-5716
Fax (607) 277-9057



Experience is the solution

314 North Pearl Street ♦ Albany, New York 12207
(800) 848-4983 ♦ (518) 434-4546 ♦ Fax (518) 434-0891

February 06, 2004

Mark Hofferbert

RETEC

1001 West Seneca St.

Suite 204

Ithaca, NY 14850

TEL: (607) 277-5716

FAX: (607) 277-9057

EC1-B

EC2-B

RE: Ward Products

Order No.: 040130002

Dear Mark Hofferbert:

Adirondack Environmental Services, Inc received 2 samples on 1/30/2004 for the analyses presented in the following report.

There were no problems with the analyses and all associated QC met EPA or laboratory specifications, except if noted.

If you have any questions regarding these tests results, please feel free to call.

Sincerely,

ELAP#: 10709

AIHA#: 100307

Christopher Hess

QA Manager

FAX:

Mark Hofferbert

Adirondack Environmental Services, Inc**Date:** 06-Feb-04

CLIENT: RETEC
Project: Ward Products
Lab Order: 040130002

CASE NARRATIVE

This is an updated report 2/4/04 to include the added analytes for Total Chromium, Nickel, Zinc, TCLP Cadmium and Cyanide.

Adirondack Environmental Services, Inc

Date: 06-Feb-04

CLIENT: RETEC
Lab Order: 040130002
Project: Ward Products
Lab ID: 040130002-001

Client Sample ID: EC 1-B
Collection Date: 1/29/2004
Matrix: SOIL

Analyses	Result	PQL	Qual	Units	DF	Date Analyzed
ICP METALS		SW6010B		(SW3050A)		Analyst: SM
Cadmium	10.2	0.25		µg/g	1	1/30/2004 1:17:00 PM
Chromium	84.8	0.25		µg/g	1	1/30/2004 1:17:00 PM
Nickel	48.9	2.50		µg/g	1	1/30/2004 1:17:00 PM
Zinc	37.4	0.50		µg/g	1	1/30/2004 1:17:00 PM
ICP METALS, TCLP		SW1311/6010A		(SW1311)		Analyst: KH
Cadmium-TCLP	0.05	0.05		mg/L	1	2/3/2004 2:58:00 PM
CYANIDE, TOTAL		SW9012				Analyst: MC
Cyanide	< 0.5	0.5		µg/g	1	2/5/2004

Qualifiers: ND - Not Detected at the Reporting Limit
J - Analyte detected below quantitation limits
B - Analyte detected in the associated Method Blank
* - Value exceeds Maximum Contaminant Level

S - Spike Recovery outside accepted recovery limits
R - RPD outside accepted recovery limits
E - Value above quantitation range

Adirondack Environmental Services, Inc

Date: 06-Feb-04

CLIENT: RETEC
Lab Order: 040130002
Project: Ward Products
Lab ID: 040130002-002

Client Sample ID: EC 2-B
Collection Date: 1/29/2004

Matrix: SOIL

Analyses	Result	PQL	Qual	Units	DF	Date Analyzed
ICP METALS		SW6010B		(SW3050A)		Analyst: SM
Cadmium	4.69	0.25		µg/g	1	1/30/2004 1:44:00 PM
Chromium	45.9	0.25		µg/g	1	1/30/2004 1:44:00 PM
Nickel	21.6	2.50		µg/g	1	1/30/2004 1:44:00 PM
Zinc	32.2	0.50		µg/g	1	1/30/2004 1:44:00 PM
ICP METALS, TCLP		SW1311/6010A		(SW1311)		Analyst: KH
Cadmium-TCLP	0.08	0.05		mg/L	1	2/3/2004 3:02:00 PM
CYANIDE, TOTAL		SW9012				Analyst: MC
Cyanide	< 0.5	0.5		µg/g	1	2/5/2004

Qualifiers: ND - Not Detected at the Reporting Limit
J - Analyte detected below quantitation limits
B - Analyte detected in the associated Method Blank
* - Value exceeds Maximum Contaminant Level

S - Spike Recovery outside accepted recovery limits
R - RPD outside accepted recovery limits
E - Value above quantitation range



FAX COVER NOTE

(607) 277-5716 Phone
(607) 277-9057 Fax
www.retec.com

To: Adirondak Labs
Sample Log-In
(Dina or Mike)

Pages: 1 including cover

Fax No.: 518-434-0891

Proj. No.: Amsterdam

From: Mark Hoffert

Date: 2/2/04

Message:

Hi Dina/Mike,

Please pull out the following ^{9 soil} samples:

¹¹³⁰⁰³⁻⁰⁰⁴ D-2^x, ¹¹⁹⁰⁰⁸⁻⁰⁰² D-4^x, ¹²⁹⁰¹¹⁻⁰⁰¹ D-7B^x, ¹²⁹⁰¹¹⁻⁰⁰² D-10B^x, ¹²²⁶⁰⁶⁻⁰ D-11^x,
¹²²⁰⁰⁰⁻⁰⁰⁴ D-13^x, ¹³⁰⁰⁰²⁻⁰⁰¹ EC1-B^x, ¹³⁰⁰⁰²⁻⁰⁰² EC2-B^x, ¹²³⁰⁰²⁻⁰⁰¹ WC-1^x

And analyze ^{all} for the following parameters:

• TCLP Cadmium - (Rush Turnaround)

- Total Chromium
- " Nickel
- " Zinc
- " Cyanide

(By end of week, say 3 day TAT)

Hardcopy To Follow:

☐ Yes ☒ No

I'm in my office today 607 277 5716

So please call when you get a chance. Thanks

Mark Hoffert



Experience is the solution

314 North Pearl Street ♦ Albany, New York 12207
(800) 848-4983 ♦ (518) 434-4546 ♦ Fax (518) 434-0891

February 06, 2004

Mark Hofferbert
RETEC

1001 West Seneca St.
Suite 204

Ithaca, NY 14850

TEL: (607) 277-5716

FAX: (607) 277-9057

RE: Ward Products

Order No.: 040123002

Dear Mark Hofferbert:

Adirondack Environmental Services, Inc received 4 samples on 1/22/2004 for the analyses presented in the following report.

There were no problems with the analyses and all associated QC met EPA or laboratory specifications, except if noted.

If you have any questions regarding these tests results, please feel free to call.

Sincerely,

Christopher Hess
QA Manager

ELAP#: 10709
AIHA#: 100307

FAX:
Mark Hofferbert

WCI

EC1 (Fail)

EC2 (Fail)

D6-B

CLIENT: RETEC
Project: Ward Products
Lab Order: 040123002

CASE NARRATIVE

This is an updated report 2/4/04 to include the added analytes for Total Chromium, Nickel, Zinc, TCLP Cadmium and Cyanide.

Adirondack Environmental Services, Inc

Date: 06-Feb-04

CLIENT: RETEC
Lab Order: 040123002
Project: Ward Products
Lab ID: 040123002-001

Client Sample ID: WC-1
Collection Date: 1/22/2004

Matrix: SOIL

Analyses	Result	PQL	Qual	Units	DF	Date Analyzed
ICP METALS		SW6010B		(SW3050A)		Analyst: SM
Cadmium	4.16	0.25		µg/g	1	1/23/2004 11:37:00 AM
Chromium	191	0.25		µg/g	1	1/23/2004 11:37:00 AM
Nickel	12.9	2.50		µg/g	1	1/23/2004 11:37:00 AM
Zinc	58.4	0.50		µg/g	1	1/23/2004 11:37:00 AM
ICP METALS, TCLP		SW1311/6010A		(SW1311)		Analyst: KH
Cadmium-TCLP	0.08	0.05		mg/L	1	2/3/2004 1:07:00 PM
CYANIDE, TOTAL		SW9012				Analyst: MC
Cyanide	< 0.5	0.5		µg/g	1	2/5/2004

Qualifiers: ND - Not Detected at the Reporting Limit
J - Analyte detected below quantitation limits
B - Analyte detected in the associated Method Blank
* - Value exceeds Maximum Contaminant Level

S - Spike Recovery outside accepted recovery limits
R - RPD outside accepted recovery limits
E - Value above quantitation range

Adirondack Environmental Services, Inc

Date: 06-Feb-04

CLIENT:	RETEC	Client Sample ID:	EC-1
Lab Order:	040123002	Collection Date:	1/22/2004
Project:	Ward Products		
Lab ID:	040123002-002	Matrix:	SOIL

Analyses	Result	PQL	Qual	Units	DF	Date Analyzed
----------	--------	-----	------	-------	----	---------------

ICP METALS		SW6010B		(SW3050A)		Analyst: SM
Cadmium	67.4	0.25		µg/g	1	1/23/2004 11:54:00 AM

Qualifiers:

ND - Not Detected at the Reporting Limit

J - Analyte detected below quantitation limits

B - Analyte detected in the associated Method Blank

* - Value exceeds Maximum Contaminant Level

S - Spike Recovery outside accepted recovery limits

R - RPD outside accepted recovery limits

E - Value above quantitation range

Adirondack Environmental Services, Inc

Date: 06-Feb-04

CLIENT: RETEC**Client Sample ID:** EC-2**Lab Order:** 040123002**Collection Date:** 1/22/2004**Project:** Ward Products**Lab ID:** 040123002-003**Matrix:** SOIL

Analyses	Result	PQL	Qual	Units	DF	Date Analyzed
ICP METALS		SW6010B		(SW3050A)		Analyst: SM
Cadmium	80.0	0.25		µg/g	1	1/23/2004 12:01:00 PM

Qualifiers: ND - Not Detected at the Reporting Limit
J - Analyte detected below quantitation limits
B - Analyte detected in the associated Method Blank
* - Value exceeds Maximum Contaminant Level

S - Spike Recovery outside accepted recovery limits
R - RPD outside accepted recovery limits
E - Value above quantitation range

Adirondack Environmental Services, Inc**Date:** 06-Feb-04

CLIENT: RETEC
Lab Order: 040123002
Project: Ward Products
Lab ID: 040123002-004

Client Sample ID: D-6B
Collection Date: 1/22/2004

Matrix: SOIL

Analyses	Result	PQL	Qual	Units	DF	Date Analyzed
ICP METALS		SW6010B		(SW3050A)		Analyst: SM
Cadmium	< 0.25	0.25		µg/g	1	1/23/2004 12:06:00 PM

Qualifiers: ND - Not Detected at the Reporting Limit
J - Analyte detected below quantitation limits
B - Analyte detected in the associated Method Blank
* - Value exceeds Maximum Contaminant Level

S - Spike Recovery outside accepted recovery limits
R - RPD outside accepted recovery limits
E - Value above quantitation range

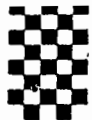

The RETEC Group, Inc.
1001 W. Seneca Street, Suite 204
Ithaca, NY 14850-3342



FAX COVER NOTE

(607) 277-5716 Phone
(607) 277-9057 Fax
www.retec.com

To: Adirondak Labs
Sample Log-In
(Dina or Mike)

Pages: 1 including cover

Fax No.: 518-434-0891

Proj. No.: Amsterdam

From: Mark Hofferbert

Date: 2/2/04

Message:

Hi Dina/Mike,

Please pull out the following ^{9 soil} samples:

¹¹³⁰⁰³⁻⁰⁰⁴ D-2^x, ¹¹⁹⁰⁰⁸⁻⁰⁰² D-4^x, ¹²⁹⁰¹¹⁻⁰⁰¹ D-7B^x, ¹²⁹⁰¹¹⁻⁰⁰² D-10B^x, ¹²²⁶⁰⁶⁻⁰⁰ D-11^x
¹²²⁰⁰⁵⁻⁰⁰⁴ D-13^x, ¹³⁰⁰⁰²⁻⁰⁰¹ EC1-B^x, ¹³⁰⁰⁰²⁻⁰⁰² EC2-B^x, ¹²³⁰⁰²⁻⁰⁰¹ WC-1^x

And analyze ^{all} for the following parameters:

- TCLP Cadmium - (Rush Turn Around)
 - Total Chromium
 - " Nickel
 - " Zinc
 - " Cyanide
- (By end of week, say 3 day TAT)

Hardcopy To Follow:

☐ Yes ☒ No

I'm in my office today 607 277 5716
So please call when you get a chance. Thanks

Mark Hofferbert



Experience is the solution
314 North Pearl Street ♦ Albany, New York 12207
(800) 848-4983 ♦ (518) 434-4546 ♦ Fax (518) 434-0891

C 2-A

May 26, 2004

Mark Hofferbert
RETEC
1001 West Seneca St.
Suite 204
Ithaca, NY 14850
TEL: (607) 277-5716
FAX: (607) 277-9057

RE: Ward Products

Order No.: 040525008

Dear Mark Hofferbert:

Adirondack Environmental Services, Inc received 1 sample on 5/25/2004 for the analyses presented in the following report.

There were no problems with the analyses and all associated QC met EPA or laboratory specifications, except if noted.

If you have any questions regarding these tests results, please feel free to call.

Sincerely,

ELAP#: 10709
AIHA#: 100307

Christopher Hess
QA Manager

FAX:
Dan Shearer
Mark Hofferbert

Adirondack Environmental Services, Inc

Date: 26-May-04

CLIENT: RETEC

Client Sample ID: C2A

Lab Order: 040525008

Collection Date: 5/21/2004

Project: Ward Products

Lab ID: 040525008-001

Matrix: SOIL

Analyses	Result	PQL	Qual	Units	DF	Date Analyzed
ICP METALS, TCLP		SW1311/6010A	(SW1311)			Analyst: KH
Cadmium-TCLP	< 0.05	0.05		mg/L	1	5/26/2004 11:10:00 AM

Qualifiers:

ND - Not Detected at the Reporting Limit

S - Spike Recovery outside accepted recovery limits

J - Analyte detected below quantitation limits

R - RPD outside accepted recovery limits

B - Analyte detected in the associated Method Blank

E - Value above quantitation range

* - Value exceeds Maximum Contaminant Level

No.

CHAIN OF CUSTODY RECORD

[illegible]

PINK COPY - Sampler

YELLOW COPY - Laboratory

WHITE COPY - RETEC

Appendix C

Summary of Waste Shipments and Certificates of Disposal (Hazardous Materials)

Ward Products Soil and Sediment IRM

New Water Realty Corp
61 Edson St
Amsterdam, NY 12010
EPA # NYD066833781

HAZARDOUS MATERIALS

Manifest #	Ship Date	Tons
NYH1389 465	1/15/2004	31.72
NYH1389 492	1/15/2004	28.37
NYH1389 546	1/15/2004	28.58
NYH1389 555	1/21/2004	33.69
NYH1389 564	1/21/2004	31.00
NYH1389 573	1/22/2004	32.67
NYH1389 582	1/22/2004	29.25
NYH1389 591	1/22/2004	25.59
NYH1389 609	1/29/2004	22.37
NYH1389 618	1/29/2004	25.64
NYH1389 627	2/4/2004	21.37
NYH1307 844	2/4/2004	31.71
NYH1307 853	2/5/2004	3.75
Total:		345.71

NON-HAZARDOUS MATERIALS

Manifest #	Ship Date	Tons
312261	1/20/2004	31.04
312262	1/20/2004	26.54
312263	1/20/2004	28.14
312264	1/20/2004	33.43
312265	1/20/2004	35.69
312266	1/20/2004	29.27
312267	1/21/2004	28.62
312268	1/21/2004	32.89
312269	1/21/2004	31.00
312270	1/21/2004	28.85
312271	1/21/2004	36.56
312272	1/21/2004	31.63
312273	1/22/2004	28.17
312274	1/22/2004	30.49
312275	1/27/2004	30.66
312276	1/27/2004	28.77
312780	1/30/2004	22.36
312781	1/30/2004	28.16
312782	1/30/2004	27.48
312783	1/30/2004	28.20
312784	1/30/2004	27.26
312785	2/3/2004	27.95
312786	2/3/2004	32.72
312787	2/3/2004	10.14
Total:		696.02

FEB-20-2004 17:29

SLC ENVIRONMENTAL SERVICES

716 433 0802 P.02/02

FEB-20-2004 13:55 FROM: CWM RECORDS

7167540253

TO: 7166816165

P.2/14



WASTE MANAGEMENT, INC.

CWM Chemical Services, L.L.C.
1550 Balmer Rd
P.O. Box 200
Model City, N.Y. 14107
716/754-8231

NEW WATER REALTY CORP
ATTN: ENVIRONMENTAL COMPLIANCE DEPT
NYD066833781
61 EDSON ST
AMSTERDAM NY 12010-5238

CERTIFICATE OF DISPOSAL

CWM CHEMICAL SERVICES, L.L.C., EPA ID: NYD049836679, has received waste material from NEW WATER REALTY CORP on 01/16/04 as described on Hazardous Waste Manifest number NYH1389465 Sequence number 01.

Profile Number: CX1963
CWM Tracking ID: 8158202001
CWM Unit #: 1*0
Disposal Date: 01/26/04

I certify, on behalf of the above listed treatment facility, that to the best of my knowledge, the above-described waste was managed in compliance with all applicable laws, regulations, permits and licenses on the date listed above.

A handwritten signature in black ink, appearing to read 'Richard Sturges', written over a horizontal line.

RICHARD STURGES
DISTRICT MANAGER
Certificate # 260868
01/27/04

For questions please call
our Customer Service Dept.
at (800) 843-3604



WASTE MANAGEMENT, INC.

CWM Chemical Services, L.L.C.
1550 Balmer Rd.
P.O. Box 200
Model City, N.Y. 14107
716/754-8231

NEW WATER REALTY CORP
ATTN: ENVIRONMENTAL COMPLIANCE DEPT
NYD066833781
61 EDSON ST
AMSTERDAM NY 12010-5238

CERTIFICATE OF DISPOSAL

CWM CHEMICAL SERVICES, L.L.C., EPA ID: NYD049836679, has received waste material from NEW WATER REALTY CORP on 01/16/04 as described on Hazardous Waste Manifest number NYH1389492 Sequence number 01.

Profile Number: CX1963
CWM Tracking ID: 8158202301
CWM Unit #: 1*0
Disposal Date: 01/26/04

I certify, on behalf of the above listed treatment facility, that to the best of my knowledge, the above-described waste was managed in compliance with all applicable laws, regulations, permits and licenses on the date listed above.

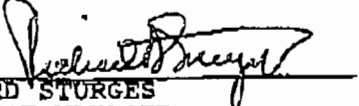
RICHARD STURGES
DISTRICT MANAGER
Certificate # 260823
01/27/04

For questions please call
our Customer Service Dept.
at (800) 843-3604

FEB-20-2004 15:55 FROM: CWM RECORDS

7167540253

TQ: 7166816165

P.3/14



WASTE MANAGEMENT, INC.

CWM Chemical Services, L.L.C.
1550 Balmer Rd.
P.O. Box 200
Model City, N.Y. 14107
716/754-8231

NEW WATER REALTY CORP
ATTN: ENVIRONMENTAL COMPLIANCE DEPT
NYD066833781
61 EDSON ST
AMSTERDAM NY 12010-5238

CERTIFICATE OF DISPOSAL

CWM CHEMICAL SERVICES, L.L.C., EPA ID: NYD049836679, has received waste material from NEW WATER REALTY CORP on 01/16/04 as described on Hazardous Waste Manifest number NYH1389546 Sequence number 01.

Profile Number: CX1963
CWM Tracking ID: 8158202101
CWM Unit #: 1*0
Disposal Date: 01/26/04

I certify, on behalf of the above listed treatment facility, that to the best of my knowledge, the above-described waste was managed in compliance with all applicable laws, regulations, permits and licenses on the date listed above.

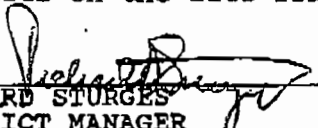
RICHARD STURGES
DISTRICT MANAGER
Certificate # 260822
01/27/04

For questions please call
our Customer Service Dept.
at (800) 843-3604



WASTE MANAGEMENT, INC.

CWM Chemical Services, L.L.C.
1550 Balmer Rd.
P.O. Box 200
Model City, N.Y. 14107
716/754-8231

NEW WATER REALTY CORP
ATTN: ENVIRONMENTAL COMPLIANCE DEPT
NYD066833781
61 EDSON ST
AMSTERDAM NY 12010-5238

CERTIFICATE OF DISPOSAL

CWM CHEMICAL SERVICES, L.L.C., EPA ID: NYD049836679, has received waste material from NEW WATER REALTY CORP on 01/22/04 as described on Hazardous Waste Manifest number NYH1389555 Sequence number 01.

Profile Number: CX1963
CWM Tracking ID: 8158222801
CWM Unit #: 1*0
Disposal Date: 01/22/04

I certify, on behalf of the above listed treatment facility, that to the best of my knowledge, the above-described waste was managed in compliance with all applicable laws, regulations, permits and licenses on the date listed above.

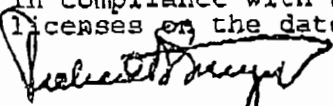

RICHARD STURGES
DISTRICT MANAGER
Certificate # 260622
01/23/04

For questions please call
our Customer Service Dept.
at (800) 843-3604



WASTE MANAGEMENT, INC.

CWM Chemical Services, L.L.C.
1550 Balmer Rd.
P.O. Box 200
Model City, N.Y. 14107
716/754-8231

NEW WATER REALTY CORP
ATTN: ENVIRONMENTAL COMPLIANCE DEPT
NYD066833781
61 EDSON ST
AMSTERDAM NY 12010-5238

CERTIFICATE OF DISPOSAL

CWM CHEMICAL SERVICES, L.L.C., EPA ID: NYD049836679, has received waste material from NEW WATER REALTY CORP on 01/22/04 as described on Hazardous Waste Manifest number NYH1389564 Sequence number 01.

Profile Number: CX1963
CWM Tracking ID: 8158222901
CWM Unit #: 1*0
Disposal Date: 01/22/04

I certify, on behalf of the above listed treatment facility, that to the best of my knowledge, the above-described waste was managed in compliance with all applicable laws, regulations, permits and licenses on the date listed above.

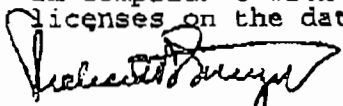
RICHARD STURGES
DISTRICT MANAGER
Certificate # 260623
01/23/04

For questions please call
our Customer Service Dept.
at (800) 843-3604



WASTE MANAGEMENT, INC.

CWM Chemical Services, L.L.C.
1550 Balmer Rd
P.O. Box 200
Model City, N.Y. 14107
716/754-8231

NEW WATER REALTY CORP
ATTN: ENVIRONMENTAL COMPLIANCE DEPT
NYD066833781
61 EDSON ST
AMSTERDAM NY 12010-5238

CERTIFICATE OF DISPOSAL

CWM CHEMICAL SERVICES, L.L.C., EPA ID: NYD049836679, has received waste material from NEW WATER REALTY CORP on 01/26/04 as described on Hazardous Waste Manifest number NYH1389573 Sequence number 01.

Profile Number: CX1963
CWM Tracking ID: 8158226201
CWM Unit #: 1*0
Disposal Date: 01/26/04

I certify, on behalf of the above listed treatment facility, that to the best of my knowledge, the above-described waste was managed in compliance with all applicable laws, regulations, permits and licenses on the date listed above.

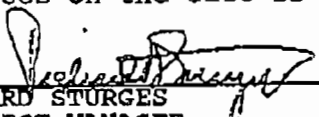
RICHARD STURGES
DISTRICT MANAGER
Certificate # 260832
01/27/04

For questions please call
our Customer Service Dept.
at (800) 843-3604



WASTE MANAGEMENT, INC.

CWM Chemical Services, L.L.C.

1550 Balmer Rd.

P.O. Box 200

Model City, N.Y. 14107

716/754-8231

NEW WATER REALTY CORP
ATTN: ENVIRONMENTAL COMPLIANCE DEPT
NYD066833781
61 EDSON ST
AMSTERDAM NY 12010-5238

CERTIFICATE OF DISPOSAL

CWM CHEMICAL SERVICES, L.L.C., EPA ID: NYD049836679, has received waste material from NEW WATER REALTY CORP on 01/26/04 as described on Hazardous Waste Manifest number NYH1389582 Sequence number 01.

Profile Number: CX1963
CWM Tracking ID: 8158226401
CWM Unit #: 1*0
Disposal Date: 01/26/04

I certify, on behalf of the above listed treatment facility, that to the best of my knowledge, the above-described waste was managed in compliance with all applicable laws, regulations, permits and licenses on the date listed above.

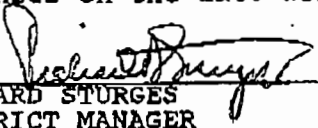
RICHARD STURGES
DISTRICT MANAGER
Certificate # 260834
01/27/04

For questions please call
our Customer Service Dept.
at (800) 843-3604



WASTE MANAGEMENT, INC.

CWM Chemical Services, L.L.C.
1550 Balmer Rd.
P.O. Box 200
Model City, N.Y. 14107
716/754-8231

NEW WATER REALTY CORP
ATTN: ENVIRONMENTAL COMPLIANCE DEPT
NYD066833781
61 EDSON ST
AMSTERDAM NY 12010-5238

CERTIFICATE OF DISPOSAL

CWM CHEMICAL SERVICES, L.L.C., EPA ID: NYD049836679, has received waste material from NEW WATER REALTY CORP on 01/26/04 as described on Hazardous Waste Manifest number NYH1389591 Sequence number 01.

Profile Number: CX1963
CWM Tracking ID: 8158226701
CWM Unit #: 1*0
Disposal Date: 01/26/04

I certify, on behalf of the above listed treatment facility, that to the best of my knowledge, the above-described waste was managed in compliance with all applicable laws, regulations, permits and licenses on the date listed above.

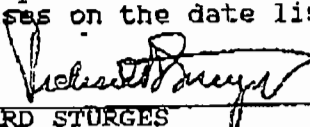
RICHARD STURGES
DISTRICT MANAGER
Certificate # 260837
01/27/04

For questions please call
our Customer Service Dept.
at (800) 843-3604



WASTE MANAGEMENT, INC.

CWM Chemical Services, L.L.C.
1550 Balmer Rd.
P.O. Box 200
Model City, N.Y. 14107
716/754-8231

NEW WATER REALTY CORP
ATTN: ENVIRONMENTAL COMPLIANCE DEPT
NYD066833781
61 EDSON ST
AMSTERDAM NY 12010-5238

CERTIFICATE OF DISPOSAL

CWM CHEMICAL SERVICES, L.L.C., EPA ID: NYD049836679, has received waste material from NEW WATER REALTY CORP on 02/02/04 as described on Hazardous Waste Manifest number NYH1389609 Sequence number 01.

Profile Number: CX1963
CWM Tracking ID: 8158240701
CWM Unit #: 1*0
Disposal Date: 02/02/04

I certify, on behalf of the above listed treatment facility, that to the best of my knowledge, the above-described waste was managed in compliance with all applicable laws, regulations, permits and licenses on the date listed above.

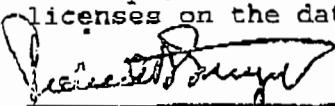
RICHARD STURGES
DISTRICT MANAGER
Certificate # 261040
02/03/04

For questions please call
our Customer Service Dept.
at (800) 843-3604



WASTE MANAGEMENT, INC.

CWM Chemical Services, L.L.C.
1550 Balmer Rd
P.O. Box 200
Madison City, N.Y. 14107
716/754-8231

NEW WATER REALTY CORP
ATTN: ENVIRONMENTAL COMPLIANCE DEPT
NYD066833781
61 EDSON ST
AMSTERDAM NY 12010-5238

CERTIFICATE OF DISPOSAL

CWM CHEMICAL SERVICES, L.L.C., EPA ID: NYD049836679, has received waste material from NEW WATER REALTY CORP on 02/02/04 as described on Hazardous Waste Manifest number NYH1389618 Sequence number 01.

Profile Number: CX1963
CWM Tracking ID: 8158241901
CWM Unit #: 1*0
Disposal Date: 02/02/04

I certify, on behalf of the above listed treatment facility, that to the best of my knowledge, the above-described waste was managed in compliance with all applicable laws, regulations, permits and licenses on the date listed above.

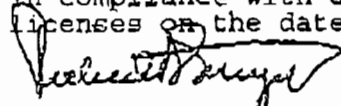
RICHARD STURGES
DISTRICT MANAGER
Certificate # 261049
02/03/04

For questions please call
our Customer Service Dept.
at (800) 843-3604



WASTE MANAGEMENT, INC.

CWM Chemical Services, L.L.C.
1550 Balmer Rd.
P.O. Box 200
Model City, N.Y. 14107
716/754-8231

NEW WATER REALTY CORP
ATTN: ENVIRONMENTAL COMPLIANCE DEPT
NYD066833781
61 EDSON ST
AMSTERDAM NY 12010-5238

CERTIFICATE OF DISPOSAL

CWM CHEMICAL SERVICES, L.L.C., EPA ID: NYD049836679, has received waste material from NEW WATER REALTY CORP on 02/05/04 as described on Hazardous Waste Manifest number NYH1389627 Sequence number 01.

Profile Number: CX1963
CWM Tracking ID: 8158246901
CWM Unit #: 1*0
Disposal Date: 02/05/04

I certify, on behalf of the above listed treatment facility, that to the best of my knowledge, the above-described waste was managed in compliance with all applicable laws, regulations, permits and licenses on the date listed above.

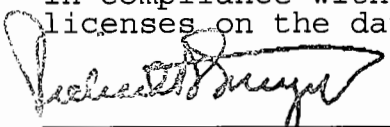

RICHARD STURGES
DISTRICT MANAGER
Certificate # 261100
02/06/04

For questions please call
our Customer Service Dept.
at (800) 843-3604



WASTE MANAGEMENT, INC.

CWM Chemical Services, L.L.C.
1550 Balmer Rd.
P.O. Box 200
Model City, N.Y. 14107
716/754-8231

NEW WATER REALTY CORP
ATTN: ENVIRONMENTAL COMPLIANCE DEPT
NYD066833781
61 EDSON ST
AMSTERDAM NY 12010-5238

CERTIFICATE OF DISPOSAL

CWM CHEMICAL SERVICES, L.L.C., EPA ID: NYD049836679, has received waste material from NEW WATER REALTY CORP on 02/05/04 as described on Hazardous Waste Manifest number NYH1307844 Sequence number 01.

Profile Number: CX1963
CWM Tracking ID: 8158246601
CWM Unit #: 1*0
Disposal Date: 02/05/04

I certify, on behalf of the above listed treatment facility, that to the best of my knowledge, the above-described waste was managed in compliance with all applicable laws, regulations, permits and licenses on the date listed above.

RICHARD STURGES
DISTRICT MANAGER
Certificate # 261098
02/06/04

For questions please call
our Customer Service Dept.
at (800) 843-3604



WASTE MANAGEMENT, INC.

CWM Chemical Services, L.L.C.
1550 Balmer Rd
P.O. Box 200
Madison City, N.Y. 14107
716/754-8231

NEW WATER REALTY CORP
ATTN: ENVIRONMENTAL COMPLIANCE DEPT
NYD066833781
61 EDSON ST
AMSTERDAM NY 12010-5238

CERTIFICATE OF DISPOSAL

CWM CHEMICAL SERVICES, L.L.C., EPA ID: NYD049836679, has received waste material from NEW WATER REALTY CORP on 02/09/04 as described on Hazardous Waste Manifest number NYH1307853 Sequence number 01.

Profile Number: CX1963
CWM Tracking ID: 8158255101
CWM Unit #: 1*0
Disposal Date: 02/09/04

I certify, on behalf of the above listed treatment facility, that to the best of my knowledge, the above-described waste was managed in compliance with all applicable laws, regulations, permits and licenses on the date listed above.

RICHARD STURGES
DISTRICT MANAGER
Certificate # 261282
02/10/04

For questions please call
our Customer Service Dept.
at (800) 843-3604

Appendix D

Site Photographs



Trenching for Drain Tile



Drain Tile Placement Behind Building



Excavation Work and Clean Fill Stockpiles



Excavation Northeast of Building



Topsoil Surface Preparation with Stone Rake



Placing Hydroseed on Finished Topsoil



Restored (As-Built) Lawn



Restored (As-Built) Lawn



As-Built Ditch at Edson Street (North)
(Construction fence was removed)

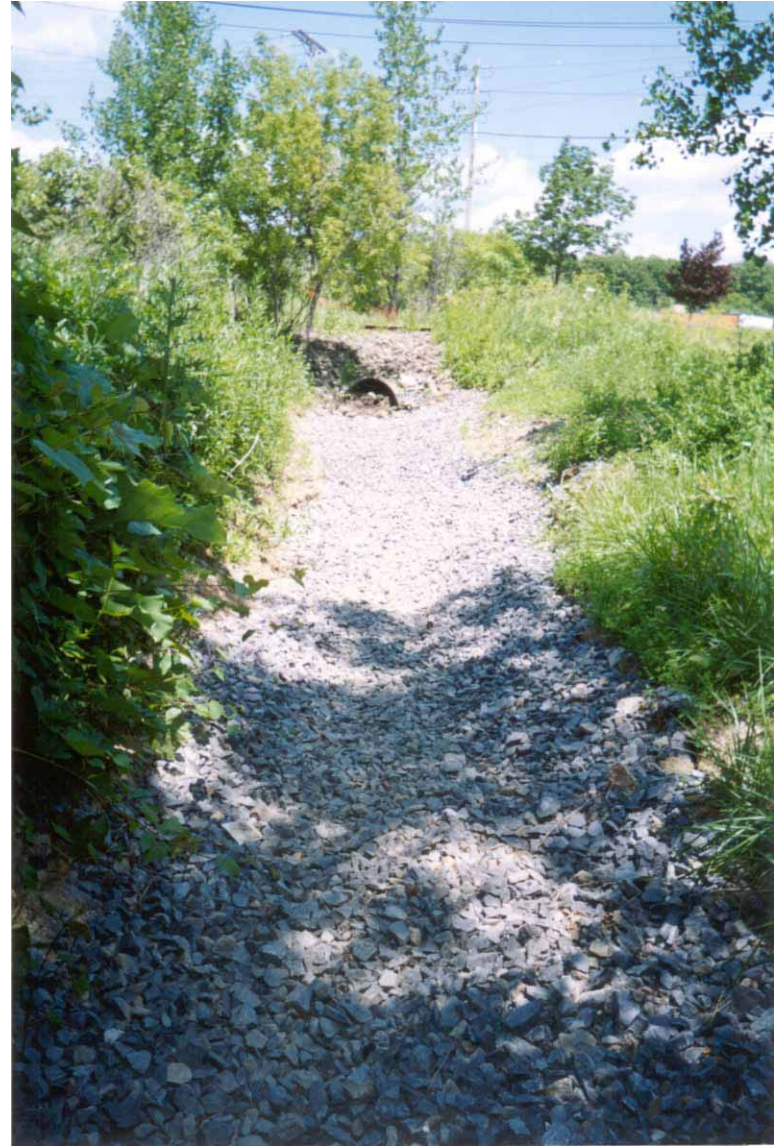

As-Built Ditch at Edson Street (South)



As-Built Ditch at Sam Stratton Road (East)



As-Built Ditch at Sam Stratton Road (West)