

LIMITED SITE DATA
ATTACHMENT J
ASBESTOS SURVEY REPORT

ASBESTOS SURVEY REPORT

34 Freeman's Bridge Road Site

Prepared for:

New York State Department of Environmental Conservation
625 Broadway
Albany, New York 12233

Prepared by:

Earth Tech Northeast, Inc.
40 British American Blvd.
Latham, New York 12110

October, 2005

Table of Contents

	Page
1.0 INTRODUCTION	1-1
2.0 LIMITATIONS.....	2-1
3.0 ASBESTOS SAMPLING SUMMARY	3-1

Appendices

APPENDIX A	LABORATORY REPORTS
APPENDIX B	CREDENTIALS

1.0 INTRODUCTION

On September 9, 2005, Earth Tech Northeast, Inc. (Earth Tech) conducted a demolition project survey for the presence of asbestos containing building materials in the building structure located at the 34 Freeman's Bridge Road Site in Glenville, New York. Ms. Patrice Poole (Asbestos Inspector #05-05628) conducted this inspection generally following the procedures and guidelines commonly used and accepted by federal and state regulations. The objective of the survey was to identify the presence and approximate the locations and quantities of suspect asbestos containing building materials (ACBM) that may be disturbed during the planned demolition of this building.

The inspector proceeded by assessing all areas of the building, including the roof sections, with the potential to contain asbestos that will be disturbed during the demolition project. The inspector selected materials from the building for inclusion in the inspection through professional experience and an understanding of the historical uses of asbestos. Generally speaking, if the building material within the building structure could contain asbestos, the material was included in the inspection.

Material included in the survey were identified and recorded with respect to grouped homogeneous sampling areas. Representative bulk samples were collected from locations within each homogeneous sampling area. Sampling information was recorded on chain of custody forms for documentation. Samples were individually preserved within a container and transported to an independent laboratory for asbestos analysis.

EMSL Analytical, Inc. of Westmont, New Jersey, (ELAP #10872, and NVLAP Code 101048-0) conducted laboratory analysis of asbestos samples via polarized light microscopy (PLM) and or transmission electron microscopy (TEM). Friable asbestos samples were analyzed by the method of PLM only. Non-friable organically bound (NOB) samples were initially analyzed by PLM, and, if initially negative for asbestos (i.e., <1% by weight), the negative result was confirmed by TEM. Samples were also analyzed by positive-stop methodology. Once a sample collected from a homogeneous group was analyzed and a positive (greater than 1%) was identified the remaining samples were not analyzed.

2.0 LIMITATIONS

The information provided in this report was compiled from field and laboratory data obtained during the site visit. Observations noted and recorded are intended to represent the conditions that existed at the subject site at the time and date that the observations were made.

Determinations of suspect asbestos containing material within the building were subject to the accessibility of individual areas or spaces. Earth Tech accepts no responsibility for the content of the building materials within areas or spaces that were unknown to us or not reasonably accessible. Earth Tech assumes no liability for any buildings that were not identified by the client that may fall under state or federal regulations.

Conclusions and recommendations provided in this report are based on the assumption that materials identified are homogeneous throughout their application.

The following limitations/conditions were noted as part of the survey:

- The asbestos survey was not conducted according to established USEPA AHERA (Asbestos Hazard Emergency Response Act) protocols, as required for public schools. This survey was conducted following general industry practices to identify those asbestos containing materials present in the building within the area described as the demolition project area. All inspection activities were, however, conducted by an AHERA certified asbestos inspector (NYSDOL Licenses No. 05-05628).
- The inspection was limited to only those materials within the described demolition project area that have the potential to be disturbed during the demolition.

3.0 ASBESTOS SAMPLING SUMMARY

The results of the asbestos sampling are provided in Table 1, sample locations are shown on Figure 1 and the laboratory results are presented in Appendix A. Based on this asbestos survey none of the building materials that will be disturbed during the planned demolition project have been identified as asbestos containing.

Table 1 - Summary of Asbestos Sampling Results*34 Freeman's Bridge Road Site**Glenville, New York**9/9/2005*

Sample	Description	Location /Area	PLM Results (%, type)	TEM Results (%, type)
MSP-1B	Wallboard Paper	Metal Storage Portion	NAD	Not applicable
MSP-1C	Wallboard Paper	Metal Storage Portion	NAD	Not applicable
MSP-2B	Wallboard	Metal Storage Portion	NAD	Not applicable
MSP-2C	Wallboard	Metal Storage Portion	NAD	Not applicable
MSA-1A	Brown Wallboard Paper	Main Storage Area	NAD	Not applicable
MSA-1B	Brown Wallboard Paper	Main Storage Area	NAD	Not applicable
MSA-1C	Brown Wallboard Paper	Main Storage Area	NAD	Not applicable
MSA-2A	White Wallboard	Main Storage Area	NAD	Not applicable
MSA-2B	White Wallboard	Main Storage Area	NAD	Not applicable
MSA-2C	White Wallboard	Main Storage Area	NAD	Not applicable
MSA-3A	White Ceiling Tile Type 4	Main Storage Area	NAD	Not applicable
MSA-3B	White Ceiling Tile Type 4	Main Storage Area	NAD	Not applicable
MSA-3C	White Ceiling Tile Type 4	Main Storage Area	NAD	Not applicable
DUP-1	White Ceiling Tile Type 4	Main Storage Area	NAD	Not applicable
MSA-4A	White Ceiling Tile Type 1	Main Storage Area	NAD	Not applicable
MSA-4B	White Ceiling Tile Type 1	Main Storage Area	NAD	Not applicable
MSA-4C	White Ceiling Tile Type 1	Main Storage Area	NAD	Not applicable
MSA-5A	White Ceiling Tile Type 2	Main Storage Area	NAD	Not applicable
MSA-5B	White Ceiling Tile Type 2	Main Storage Area	NAD	Not applicable
MSA-5C	White Ceiling Tile Type 2	Main Storage Area	NAD	Not applicable
OPA-1A	Tan Blown In Insulation	Open Office Area	NAD	Not applicable
OPA-1B	Tan Blown In Insulation	Open Office Area	NAD	Not applicable
OPA-1C	Tan Blown In Insulation	Open Office Area	NAD	Not applicable
OPA-2A	Brown Ceiling Tile	Open Office Area	NAD	Not applicable
OPA-2B	Brown Ceiling Tile	Open Office Area	NAD	Not applicable
OPA-2C	Brown Ceiling Tile	Open Office Area	NAD	Not applicable
OPA-3A	Brown Wallboard Paper	Open Office Area	NAD	Not applicable
OPA-3B	Brown Wallboard Paper	Open Office Area	NAD	Not applicable
OPA-3C	Brown Wallboard Paper	Open Office Area	NAD	Not applicable

PLM Test Method : NYS ELAP 198.1, TEM Test Method: NYS ELAP 198.41

ANR: Only the first sample in each Homogenous sample group was analyzed.

CNR: Confirmation analysis was not required due to positive PLM Result (i.e., >1% by weight)

NAD: No Asbestos Detected in the sample above the method detection limit.

NAC: Non-Asbestos Containing, sample may have trace of asbestos below the definitive concentration of 1% for Asbestos Containing Building Material

Table 1 - Summary of Asbestos Sampling Results*34 Freeman's Bridge Road Site**Glenville, New York**9/9/2005*

Sample	Description	Location /Area	PLM Results (%, type)	TEM Results (%, type)
OPA-4A	White Wallboard	Open Office Area	NAD	Not applicable
OPA-4B	White Wallboard	Open Office Area	NAD	Not applicable
OPA-4C	White Wallboard	Open Office Area	NAD	Not applicable
OPA-5A	Cloth Wire Wrap	Open Office Area	NAD	NAD
OPA-5B	Cloth Wire Wrap	Open Office Area	NAD	NAD
S-1A	White Ceiling Tile Type 1	Showroom	NAD	Not applicable
S-1B	White Ceiling Tile Type 1	Showroom	NAD	Not applicable
S-1C	White Ceiling Tile Type 1	Showroom	NAD	Not applicable
S-2A	White Ceiling Tile Type 2	Showroom	NAD	Not applicable
S-2B	White Ceiling Tile Type 2	Showroom	NAD	Not applicable
S-2C	White Ceiling Tile Type 2	Showroom	NAD	Not applicable
S-3A	White Ceiling Tile Type 3	Showroom	NAD	Not applicable
S-3B	White Ceiling Tile Type 3	Showroom	NAD	Not applicable
S-4A	Brown Mastic (ceiling tile type 3)	Showroom	< 1% Anthophyllite	NAD
S-4B	Brown Mastic (ceiling tile type 3)	Showroom	< 1% Anthophyllite	NAD
S-4C	Brown Mastic (ceiling tile type 3)	Showroom	< 1% Anthophyllite	NAD
S-5A	Brown Wallboard Paper	Showroom	NAD	Not applicable
S-5B	Brown Wallboard Paper	Showroom	NAD	Not applicable
S-5C	Brown Wallboard Paper	Showroom	NAD	Not applicable
S-6A	White Wallboard	Showroom	NAD	Not applicable
S-6B	White Wallboard	Showroom	NAD	Not applicable
S-6C	White Wallboard	Showroom	NAD	Not applicable
W-1A	Brown Wallboard Paper	Woodshop	NAD	Not applicable
W-1B	Brown Wallboard Paper	Woodshop	NAD	Not applicable
W-1C	Brown Wallboard Paper	Woodshop	NAD	Not applicable
W-2A	White Wallboard	Woodshop	NAD	Not applicable
W-2B	White Wallboard	Woodshop	NAD	Not applicable
W-2C	White Wallboard	Woodshop	NAD	Not applicable

PLM Test Method : NYS ELAP 198.1, TEM Test Method: NYS ELAP 198.41

ANR: Only the first sample in each Homogenous sample group was analyzed.

CNR: Confirmation analysis was not required due to positive PLM Result (i.e., >1% by weight)

NAD: No Asbestos Detected in the sample above the method detection limit.

NAC: Non-Asbestos Containing, sample may have trace of asbestos below the definitive concentration of 1% for Asbestos Containing Building Material

Table 1 - Summary of Asbestos Sampling Results*34 Freeman's Bridge Road Site**Glenville, New York**9/9/2005*

Sample	Description	Location /Area	PLM Results (%, type)	TEM Results (%, type)
OBS-1A	Brown Wallboard Paper	Office/Bathroom/Shower Room	NAD	Not applicable
OBS-1B	Brown Wallboard Paper	Office/Bathroom/Shower Room	NAD	Not applicable
OBS-1C	Brown Wallboard Paper	Office/Bathroom/Shower Room	NAD	Not applicable
OBS-2A	White Wallboard	Office/Bathroom/Shower Room	NAD	Not applicable
OBS-2B	White Wallboard	Office/Bathroom/Shower Room	NAD	Not applicable
OBS-2C	White Wallboard	Office/Bathroom/Shower Room	NAD	Not applicable
OBS-3A	Brown Wallboard Paper 2nd lyr	Office/Bathroom/Shower Room (shower room)	NAD	Not applicable
OBS-4A	White Wallboard 2nd lyr	Office/Bathroom/Shower Room (shower room)	NAD	Not applicable
OBS-5A	White Ceiling Tile Type A	Office/Bathroom/Shower Room	NAD	Not applicable
OBS-5B	White Ceiling Tile Type A	Office/Bathroom/Shower Room	NAD	Not applicable
OBS-5C	White Ceiling Tile Type A	Office/Bathroom/Shower Room	NAD	Not applicable
OBS-6A	White Ceiling Tile Type B	Office/Bathroom/Shower Room	NAD	Not applicable
OBS-6B	White Ceiling Tile Type B	Office/Bathroom/Shower Room	NAD	Not applicable
OBS-6C	White Ceiling Tile Type B	Office/Bathroom/Shower Room	NAD	Not applicable
DUP-3	White Ceiling Tile Type B	Office/Bathroom/Shower Room	NAD	Not applicable
OBS-7A	Black Carpet Under Layment	Office/Bathroom/Shower Room	NAD	Not applicable
OBS-7B	Black Carpet Under Layment	Office/Bathroom/Shower Room	NAD	Not applicable
OBS-7C	Black Carpet Under Layment	Office/Bathroom/Shower Room	NAD	Not applicable
RMOB-1A	Black Tar Paper	Roof over Office/Bathroom/Shower Room	NAD	NAD
RMOB-1B	Black Tar Paper	Roof over Office/Bathroom/Shower Room	NAD	< 1% Chrysotile
RMOB-1C	Black Tar Paper	Roof over Office/Bathroom/Shower Room	NAD	NAD
RMOB-2A	Black Shingle	Roof over Office/Bathroom/Shower Room	NAD	< 1% Chrysotile
DUP-2	Black Shingle	Roof over Office/Bathroom/Shower Room	NAD	< 1% Chrysotile
RMOB-2B	Black Shingle	Roof over Office/Bathroom/Shower Room	NAD	NAD
RMM-1A	Black Tar Paper	Main Roof	NAD	NAD
RMM-1B	Black Tar Paper	Main Roof	NAD	NAD
RMM-1C	Black Tar Paper	Main Roof	NAD	NAD

PLM Test Method : NYS ELAP 198.1, TEM Test Method: NYS ELAP 198.41

ANR: Only the first sample in each Homogenous sample group was analyzed.

CNR: Confirmation analysis was not required due to positive PLM Result (i.e., >1% by weight)

NAD: No Asbestos Detected in the sample above the method detection limit.

NAC: Non-Asbestos Containing, sample may have trace of asbestos below the definitive concentration of 1% for Asbestos Containing Building Material

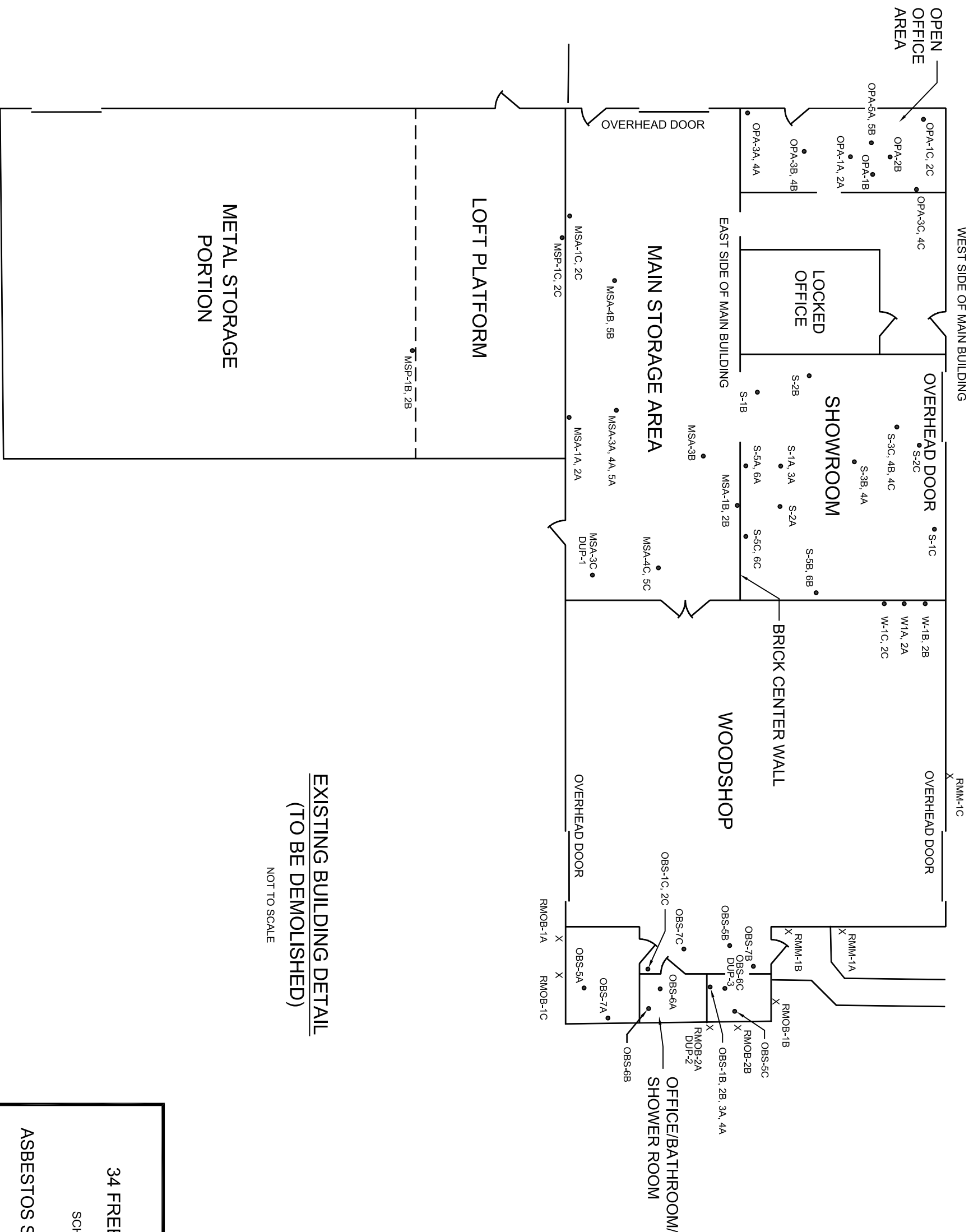

EXISTING BUILDING DETAIL
(TO BE DEMOLISHED)
NOT TO SCALE



34 FREEMAN'S BRIDGE ROAD SITE
TOWN OF GLENVILLE
SCHENECTADY COUNTY, NEW YORK
NYSDEC SITE # 4-47-028

APPENDIX A

Laboratory Reports

EMSL Analytical, Inc.

100 Middle Ave., Westmont, NJ 08058

Phone: (609) 995-4999 Fax: (609) 995-4993 Email: info@emsl.com

Attn: **Chris Hunsicker**
Earth Tech
40 British American Boulevard
Latham, NY 12110

Customer ID: RE150
 Customer PO:
 Received: 09/13/05 11:22 AM
 EMSL Order: 040517543

Fax: (518) 951-2300 Phone: (518) 951-2200
 Project: 83060.02 FREEMAN'S BRIDGE

EMSL Proj:
 Analysis Date: 9/15/2005
 Report Date: 9/15/2005

Asbestos Analysis of Bulk Materials by PLM via the NY State ELAP 198.1 Method

Sample	Location	Appearance	Non-Asbestos		Asbestos
			% Fibrous	% Non-Fibrous	% Type
OPA-2A 040517543-0001		Brown/Gray/White Fibrous Heterogeneous	60.00% Cellulose 10.00% Min. Wool	30.00% Non-fibrous (other)	None Detected
OPA-2B 040517543-0002		Brown/Gray/White Fibrous Heterogeneous	60.00% Cellulose 10.00% Min. Wool	30.00% Non-fibrous (other)	None Detected
OPA-2C 040517543-0003		Brown/Gray/White Fibrous Heterogeneous	60.00% Cellulose 10.00% Min. Wool	30.00% Non-fibrous (other)	None Detected
OPA-3A 040517543-0004		Brown/White Fibrous Heterogeneous	10.00% Cellulose	90.00% Non-fibrous (other)	None Detected
OPA-3B 040517543-0005		Brown/White Fibrous Heterogeneous	10.00% Cellulose	90.00% Non-fibrous (other)	None Detected
OPA-3C 040517543-0006		Brown/White Fibrous Heterogeneous	10.00% Cellulose	90.00% Non-fibrous (other)	None Detected
OPA-4A 040517543-0007		Brown/Gray Fibrous Heterogeneous	10.00% Cellulose	90.00% Non-fibrous (other)	None Detected
OPA-4B 040517543-0008		Brown/Gray Fibrous Heterogeneous	10.00% Cellulose	90.00% Non-fibrous (other)	None Detected
OPA-4C 040517543-0009		Brown/Gray/White Fibrous Heterogeneous	10.00% Cellulose	90.00% Non-fibrous (other)	None Detected
MSP-1A 040517543-0010					Not Submitted

Analyst(s)

Will DiBella (16)

Stephen Siegel, CIH
 or other approved signatory

PLM has been known to miss asbestos in a small percentage of samples which contain asbestos. Negative PLM results cannot be guaranteed. Samples reported as <1% or none detected should be tested with TEM. The above test report relates only to the items tested. This report may not be reproduced, except in full, without written approval by EMSL Analytical, Inc. The above test must not be used by the client to claim product endorsement by NVLAP nor any agency of the United States Government. The test results contained within this report meet the requirements of NELAP unless otherwise noted.

Analysis performed by EMSL Westmont (NVLAP #101048-0), NY ELAP 10672

EMSL Analytical, Inc.

10 Middlesex Ave., Westmont, NJ 08059

Phone: (609) 951-4000 Fax: (609) 951-4000 Email: info@emsl.com

Attn: **Chris Hunsicker**
Earth Tech
40 British American Boulevard
Latham, NY 12110

Customer ID: RE150
 Customer PO:
 Received: 09/13/05 11:22 AM
 EMSL Order: 040517543

Fax: (518) 951-2300 Phone: (518) 951-2200
 Project: 83060.02 FREEMAN'S BRIDGE

EMSL Proj:
 Analysis Date: 9/15/2005
 Report Date: 9/15/2005

Asbestos Analysis of Bulk Materials by PLM via the NY State ELAP 198.1 Method

Sample	Location	Appearance	Non-Asbestos		Asbestos
			% Fibrous	% Non-Fibrous	% Type
MSP-2A 040517543-0011					Not Submitted
OBS-1A 040517543-0012		Brown/White Fibrous Heterogeneous	20.00% Cellulose	80.00% Non-fibrous (other)	None Detected
OBS-1B 040517543-0013		Brown/White Fibrous Heterogeneous	50.00% Cellulose	50.00% Non-fibrous (other)	None Detected
S-1C 040517543-0014		Brown/White Fibrous Heterogeneous	30.00% Cellulose	70.00% Non-fibrous (other)	None Detected
OBS-3A 040517543-0015		Brown/White Fibrous Heterogeneous	60.00% Cellulose	40.00% Non-fibrous (other)	None Detected
OBS-4A 040517543-0016		Brown/Gray Fibrous Heterogeneous	10.00% Cellulose	90.00% Non-fibrous (other)	None Detected

Analyst(s)

Will DiBella (16)

Stephen Siegel, CIH
 or other approved signatory

PLM has been known to miss asbestos in a small percentage of samples which contain asbestos. Negative PLM results cannot be guaranteed. Samples reported as <1% or none detected should be tested with TEM. The above test report relates only to the items tested. This report may not be reproduced, except in full, without written approval by EMSL Analytical, Inc. The above test must not be used by the client to claim product endorsement by NVLAP nor any agency of the United States Government. The test results contained within this report meet the requirements of NELAC unless otherwise noted.

Analysis performed by EMSL Westmont (NVLAP #101048-0), NY ELAP 10872

EMSL Analytical, Inc.

1007 Hudson Ave., Roseland, NJ 07068

Phone: (908) 200-4000 Fax: (908) 200-4000 Email: info@EMSL.com

Attn: Chris Hunsicker
 Earth Tech
 40 British American Boulevard
 Latham, NY 12110

Customer ID: REI50
 Customer PO:
 Received: 09/13/05 11:22 AM
 EMSL Order: 040517543

Fax: (518) 951-2300 Phone: (518) 951-2200
 Project: 83060.02 FREEMAN'S BRIDGE

EMSL Proj:
 Analysis Date: 9/15/2005
 Report Date: 9/15/2005

Asbestos Analysis of Non-Friable Organically Bound Materials by PLM via the NY State ELAP 198.6 Method

SAMPLE ID	DESCRIPTION	APPEARANCE	% MATRIX MATERIAL	% NON-ASBESTOS FIBERS	ASBESTOS TYPES
OPA-5A 040517543-0017		Brown Non-Fibrous Homogeneous	100.0	None	Inconclusive: No Asbestos Detected
OPA-5B 040517543-0018		Brown Non-Fibrous Homogeneous	100.0	None	Inconclusive: No Asbestos Detected

Analyst(s)

Will DiBella (2)

Stephen Siegel, CIH
 or other approved signatory

*Polarized Light Microscopy (PLM) is not consistently reliable in detecting asbestos in floor coverings and similar non-friable organically bound materials. Quantitative Transmission Electron Microscopy is currently the only method that can be used to determine if this material can be considered or treated as non-asbestos containing. The test results contained within this report meet the requirements of NELAP unless otherwise noted. EMSL maintains liability limited to cost of analysis. This report relates only to the samples reported above and may not be reproduced, except in full, without written approval by EMSL. The above test report relates only to the items tested. EMSL bears no responsibility for sample collection activities or analytical method limitations.

ACCREDITATIONS: AHA #100192, NVLAP #101048-0 and NY STATE ELAP #10872

EMSL Analytical, Inc.

107 Haddon Ave., Westmont, NJ 08108

Phone: (856) 858-4800 Fax: (856) 858-4960 Email: ssiegel@EMSL.com

Attn: Chris Hunsicker
Earth Tech
40 British American Boulevard
Latham, NY 12110

Fax: (518) 951-2300 Phone: (518) 951-2200
Project: 83060.02 FREEMAN'S BRIDGE

Customer ID: REI50
Customer PO:
Received: 09/13/05 11:22 AM
EMSL Order: 040517543
EMSL Proj:
Analysis Date: 9/16/2005
Report Date: 9/29/2005

Asbestos Analysis of Non-Friable Organically Bound materials by Transmission
Electron Microscopy via NYS ELAP Method 198.4

SAMPLE ID	DESCRIPTION	APPEARANCE	% MATRIX MATERIAL	% NON-ASBESTOS FIBERS	ASBESTOS TYPES	% TOTAL ASBESTOS
OPA-5A 040517543-0017		Brown Non-Fibrous Homogeneous	100.0	None	No Asbestos Detected	
OPA-5B 040517543-0018		Brown Non-Fibrous Homogeneous	100.0	None	No Asbestos Detected	

Analyst(s)

Steve Siegel (2)



Stephen Siegel, CIH
or other approved signatory

This laboratory is not responsible for % asbestos in total sample when the residue only is submitted for analysis. The above report relates only to the items tested. This report may not be reproduced, except in full, without written approval by EMSL Analytical, Inc. The test results contained within this report meet the requirements of NELAC unless otherwise noted.

ACCREDITATIONS: AIHA #100194, NVLAP #101048-0 and NY STATE ELAP #10872

.YTN0B-2

THIS IS THE LAST PAGE OF THE REPORT.

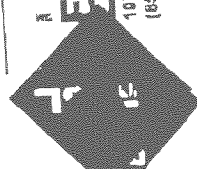

EMSL Analytical, Inc.

197 Haddon Ave., Westmont, NJ 08108
(856) 858-4800

Attn: Chris Hunsicker

Earth Tech
40 British American Boulevard
Latham, NY 12110

Phone: (518) 951-2200
Fax: (518) 951-2300
Project: B3080.02 FREEMAN'S BRIDGE

Customer ID: RE100
Customer PO: 09/13/05 11:22 AM
Received: 040517543
EMSL Order:
EMSL Proj:
Report Date: 9/16/2005

Asbestos Analysis of Bulk Material

Sample Description	Test	Analyzed Date	Color	Non Asbestos		Asbestos	Comments
				Fibrous	Non-Fibrous		
QPA-2A 40517543-0001	PLM NYS 198.1 Friable PLM NYS 198.6 NOB TEM NYS 198.4 NOB	9/15/2005	Brown/Gray/ White	60.00% Cellulose 10.00% Min. Wood	30%	None Detected	N/A
QPA-2B 40517543-0002	PLM NYS 198.1 Friable PLM NYS 198.6 NOB TEM NYS 198.4 NOB	9/15/2005	Brown/Gray/ White	60.00% Cellulose 10.00% Min. Wood	30%	None Detected	N/A
QPA-2C 40517543-0003	PLM NYS 198.1 Friable PLM NYS 198.6 NOB TEM NYS 198.4 NOB	9/15/2005	Brown/Gray/ White	60.00% Cellulose 10.00% Min. Wood	30%	None Detected	N/A
QPA-3A 40517543-0004	PLM NYS 198.1 Friable PLM NYS 198.6 NOB TEM NYS 198.4 NOB	9/15/2005	Brown/White	10.00% Cellulose	90%	None Detected	N/A
QPA-3B 40517543-0005	PLM NYS 198.1 Friable PLM NYS 198.6 NOB TEM NYS 198.4 NOB	9/15/2005	Brown/White	10.00% Cellulose	90%	None Detected	N/A
QPA-3C 40517543-0006	PLM NYS 198.1 Friable PLM NYS 198.6 NOB TEM NYS 198.4 NOB	9/15/2005	Brown/White	10.00% Cellulose	90%	None Detected	N/A
QPA-4A 40517543-0007	PLM NYS 198.1 Friable PLM NYS 198.6 NOB TEM NYS 198.4 NOB	9/15/2005	Brown/Gray	10.00% Cellulose	90%	None Detected	N/A

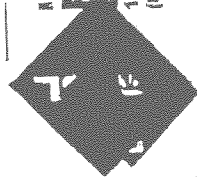

EMSL Analytical, Inc.

107 Haddon Ave., Westmont, NJ 08108
(856) 858-4800

Attn: Chris Hunsicker
Earth Tech
40 British American Boulevard
Latham, NY 12110

Fax: (518) 951-2300
Project: 83060.02 FREEMAN'S BRIDGE

Customer ID: RE150
Customer PO: 09/13/05 11:22 AM
Received: 040517543
EMSL Order:

EMSL Proj:
Report Date: 9/16/2005

Asbestos Analysis of Bulk Material

Sample Description	Test	Analyzed Date	Color	Fibrous	Non-Fibrous	Asbestos	Comments
OPA-4B 040517543-0008	PLM NYS 198.1 Friable PLM NYS 198.6 NOB TEM NYS 198.4 NOB	9/15/2005	Brown/Gray	10.00% Cellulose	90% N/A N/A	None Detected N/A N/A	N/A N/A
OPA-4C 040517543-0009	PLM NYS 198.1 Friable PLM NYS 198.6 NOB TEM NYS 198.4 NOB	9/15/2005	Brown/Gray/ White	10.00% Cellulose	90% N/A N/A	None Detected N/A N/A	N/A N/A
MSP-1A 040517543-0010	PLM NYS 198.1 Friable PLM NYS 198.6 NOB TEM NYS 198.4 NOB	9/15/2005			N/A N/A N/A	Not Submitted N/A N/A	N/A N/A
MSP-2A 040517543-0011	PLM NYS 198.1 Friable PLM NYS 198.6 NOB TEM NYS 198.4 NOB	9/15/2005			N/A N/A N/A	Not Submitted N/A N/A	N/A N/A
OBS-1A 040517543-0012	PLM NYS 198.1 Friable PLM NYS 198.6 NOB TEM NYS 198.4 NOB	9/15/2005	Brown/White	20.00% Cellulose	80% N/A N/A	None Detected N/A N/A	N/A N/A
OBS-1B 040517543-0013	PLM NYS 198.1 Friable PLM NYS 198.6 NOB TEM NYS 198.4 NOB	9/15/2005	Brown/White	50.00% Cellulose	50% N/A N/A	None Detected N/A N/A	N/A N/A
OBS-1C 040517543-0014	PLM NYS 198.1 Friable PLM NYS 198.6 NOB TEM NYS 198.4 NOB	9/15/2005	Brown/White	30.00% Cellulose	70% N/A N/A	None Detected N/A N/A	N/A N/A
OBS-3A 040517543-0015	PLM NYS 198.1 Friable PLM NYS 198.6 NOB TEM NYS 198.4 NOB	9/15/2005	Brown/White	60.00% Cellulose	40% N/A N/A	None Detected N/A N/A	N/A N/A



EMSL Analytical, Inc.

107 Haddon Ave., Westmont, NJ 08108
(856) 658-4800

Attn: Chris Hunsicker

Earth Tech
40 British American Boulevard
Latham, NY 12110

Fax: (518) 951-2300 Phone: (518) 951-2200
Project: 83060.02 FREEMAN'S BRIDGE

Customer ID: 150
Customer PO:
Received: 09/13/05 11:22 AM
EMSL Order: 040517543

EMSL Proj:

Report Date: 9/16/2005

Asbestos Analysis of Bulk Material

Sample Description	Test	Analyzed Date	Color	Non Asbestos		Asbestos	Comments
				Fibrous	Non-Fibrous		
QBS-4A 040517543-0016	PLM NYS 198.1 Friable	9/15/2005	Brown/Gray	10.00% Cellulose	90%	None Detected	N/A
	PLM NYS 198.6 NOB				N/A		N/A
	TEM NYS 198.4 NOB				N/A		N/A
QPA-5A 040517543-0017	PLM NYS 198.1 Friable				N/A	Inconclusive: None Detected	
	PLM NYS 198.6 NOB	9/15/2005	Brown		N/A	None Detected	N/A
	TEM NYS 198.4 NOB	9/16/2005	Brown				
QPA-5B 040517543-0018	PLM NYS 198.1 Friable				N/A	Inconclusive: None Detected	
	PLM NYS 198.6 NOB	9/15/2005	Brown		N/A	None Detected	
	TEM NYS 198.4 NOB	9/16/2005	Brown				

NOB = Non Friable Organically Bound
N/A = Not Applicable

Stephen Siegel

Stephen Siegel, CIH
or other approved signatory

EMSL maintains liability limited to cost of analysis. This report relates only to the samples reported above and may not be reproduced, except in full, without written approval by EMSL. The above test report relates only to the items tested. This test report must not be used to claim product endorsement by NVLAP or any agency of the U.S. Government. EMSL bears no responsibility for sample collection activities or analytical method limitations. The results in this report meet all requirements of the NELAP Standards unless otherwise noted. The laboratory is not responsible for the accuracy of results when requested to physically separate and analyze layered samples. PLM is not consistently reliable in detecting asbestos in floor coverings and similar NOB's. Quantitative TEM is currently the only method that can be used to determine if a NOB material can be considered or treated as non-asbestos containing.

ACCREDITATIONS: AIHA #100194, NVLAP #101048-0 and NY STATE ELAP #10872

NY 5198-V2

THIS IS THE LAST PAGE OF THE REPORT.



A Tech Infrastructure Services Company

Chain of Custody Record

040517543

REI 50

Project Number 03260.02		Project Name/Client FROEMAN'S RPTDGE		Custody Seal #		Earth Tech Cooler #	
Sample Container (Field ID Number)		Sample Description (Field ID Number)		Analysis Required		Matrix	
Item No.	Sample Description (Field ID Number)	Date	Time	Grab	Comp.	PID Reading (ppm)	Label Number
1	OPA-2A	9/19/05					
2	OPA-2D						
3	OPA-2C						
4	OPA-3A						
5	OPA-3B						
6	OPA-3C						
7	OPA-4A						
8	OPA-4B						
9	OPA-4C						
10	OPA-5A						
11	OPA-5B						
12	MSP-2A						
13	MSP-2A						
14	OPS-2A						
15	OPS-2B						
16	OPS-2C						
17	OPS-3A						
18	OPS-4A						

Received by: (Signature) *[Signature]* Date/Time 9/19/05 1400
Received by: (Signature) *[Signature]* Date/Time 9/19/05 1400

Relinquished by: (Signature) *[Signature]*
Relinquished by: (Signature) *[Signature]*

Send Lab Results To:
Chaz Hunsicker
EARTH TECH

Remarks: *[Redacted]*

Federal Express Airbill No.: *[Redacted]*
Lab: *[Redacted]*

Analysis Required: *[Redacted]*

Disposed of by: (Signature) *[Signature]* Date/Time 9/19/05 1400
Disposed of by: (Signature) *[Signature]* Date/Time 9/19/05 1400

Received by: (Signature) *[Signature]* Date/Time 9/19/05 1400
Received by: (Signature) *[Signature]* Date/Time 9/19/05 1400

Laboratory Receiving Notes:
Custody Seal Intact?
Temp. of Shipping Container:
Sample Condition:

Rev. 10/98

White Copy - Lab

Yellow Copy - File

Pink Copy - Client

F514/Earth.Sci

RECEIVED
FBI
MONTMONT, N.J.
05 SEP 13 2005

EMSL Analytical, Inc.

107 Haddon Ave., Westmont, NJ 08108

Phone: (856) 858-4800 Fax: (856) 858-4960 Email: ssiegel@EMSL.com

Attn: **Chris Hunsicker**
Earth Tech
40 British American Boulevard
Latham, NY 12110

Fax: (518) 951-2300 Phone: (518) 951-2200
 Project: **83060.02/FREEMAN'S BRIDGE**

Customer ID: REI50
 Customer PO:
 Received: 09/13/05 11:22 AM
 EMSL Order: 040517559
 EMSL Proj:
 Analysis Date: 9/15/2005
 Report Date: 10/4/2005

Asbestos Analysis of Bulk Materials by PLM via the NY State ELAP 198.1 Method

Sample	Location	Appearance	Non-Asbestos		Asbestos
			% Fibrous	% Non-Fibrous	% Type
S-1A 040517559-0001		Tan/White Fibrous Heterogeneous	35.00% Cellulose 35.00% Min. Wool	30.00% Non-fibrous (other)	None Detected
S-2A 040517559-0002		Brown/White Fibrous Heterogeneous	40.00% Cellulose 20.00% Min. Wool	40.00% Non-fibrous (other)	None Detected
S-3A 040517559-0003		Tan/White Fibrous Heterogeneous	65.00% Cellulose	35.00% Non-fibrous (other)	None Detected
4A 040517559-0004		Brown Non-Fibrous Homogeneous	Suggest TEM	100.00% Non-fibrous (other)	<1% Anthophyllite
S-4B 040517559-0005		Brown Non-Fibrous Homogeneous		100.00% Non-fibrous (other)	<1% Anthophyllite
S-4C 040517559-0006		Brown Non-Fibrous Homogeneous	Suggest TEM	100.00% Non-fibrous (other)	<1% Anthophyllite
S-5A 040517559-0007		Brown/White Fibrous Heterogeneous		35.00% Non-fibrous (other)	None Detected
S-5B 040517559-0008		Brown/White Fibrous Heterogeneous	65.00% Cellulose	35.00% Non-fibrous (other)	None Detected
S-5C 040517559-0009		Brown/White Fibrous Heterogeneous	60.00% Cellulose	40.00% Non-fibrous (other)	None Detected
S-6A 040517559-0010		White/Brown Fibrous Heterogeneous	5.00% Cellulose	95.00% Non-fibrous (other)	None Detected

Analyst(s)

Nancy Stalter (15)



Stephen Siegel, CIH
 or other approved signatory

EMSL has been known to miss asbestos in a small percentage of samples which contain asbestos. Negative PLM results cannot be guaranteed. Samples reported as <1% or none detected should be tested with TEM. The above test report relates only to the items tested. This report may not be reproduced, except in full, without written approval by EMSL Analytical, Inc. The above test must not be used by the client to claim product endorsement by NVLAP nor any agency of the United States Government. The test results contained within this report meet the requirements of NELAP unless otherwise noted.

Analysis performed by EMSL Westmont (NVLAP #101048-0), NY ELAP 10872

EMSL Analytical, Inc.

107 Haddon Ave., Westmont, NJ 08108

Phone: (356) 858-4800 Fax: (356) 858-4960 Email: ssiegel@EMSL.com

Attn: **Chris Hunsicker**
Earth Tech
40 British American Boulevard
Latham, NY 12110

Fax: (518) 951-2300 Phone: (518) 951-2200
Project: **83060.02/FREEMAN'S BRIDGE**

Customer ID: REI50
Customer PO:
Received: 09/13/05 11:22 AM
EMSL Order: 040517559

EMSL Proj:
Analysis Date: 9/15/2005
Report Date: 10/4/2005

Asbestos Analysis of Bulk Materials by PLM via the NY State ELAP 198.1 Method

Sample	Location	Appearance	Non-Asbestos		Asbestos
			% Fibrous	% Non-Fibrous	% Type
S-6B 040517559-0011		White/Brown Fibrous Heterogeneous	10.00% Cellulose	90.00% Non-fibrous (other)	None Detected
S-6C 040517559-0012		White/Brown Fibrous Heterogeneous	5.00% Cellulose	95.00% Non-fibrous (other)	None Detected
OPA-1A 040517559-0013		Tan Fibrous Heterogeneous	85.00% Cellulose	15.00% Non-fibrous (other)	None Detected
PA-1B 040517559-0014		Tan Fibrous Heterogeneous	80.00% Cellulose 5.00% Min. Wool	15.00% Non-fibrous (other)	None Detected
OPA-1C 040517559-0015		Tan Fibrous Heterogeneous	85.00% Cellulose	15.00% Non-fibrous (other)	None Detected

Analyst(s)

Nancy Stalter (15)



Stephen Siegel, CIH
or other approved signatory

PLM has been known to miss asbestos in a small percentage of samples which contain asbestos. Negative PLM results cannot be guaranteed. Samples reported as <1% or none detected should be tested with TEM. The above test report relates only to the items tested. This report may not be reproduced, except in full, without written approval by EMSL Analytical, Inc. The above test must not be used by the client to claim product endorsement by NVLAP nor any agency of the United States Government. The test results contained within this report meet the requirements of NELAP unless otherwise noted.

Analysis performed by EMSL Westmont (NVLAP #101048-0), NY ELAP 10872

EMSL Analytical, Inc.

107 Haddon Ave., Westmont, NJ 08108

Phone: (856) 858-4800 Fax: (856) 858-4960 Email: esicdcl@EMSL.com

EMSL

Attn: Chris Hunsicker
Earth Tech
40 British American Boulevard
Latham, NY 12110

Customer ID: RE150
Customer PO:
Received: 09/29/05 10:47 AM
EMSL Order: 040518662

Fax: (518) 951-2300 Phone: (518) 951-2200
Project: ORG. ID#040517559/83060.02/FREEMAN'S BRIDGE

EMSL Proj:
Analysis Date: 9/30/2005
Report Date: 9/30/2005

Asbestos Analysis of Non-Friable Organically Bound materials by Transmission
Electron Microscopy via NYS ELAP Method 198.4

SAMPLE ID	DESCRIPTION	APPEARANCE	% MATRIX MATERIAL	% NON-ASBESTOS FIBERS	ASBESTOS TYPES	% TOTAL ASBESTOS
S-4A 040518662-0001		Brown Non-Fibrous Homogeneous	100.0	None	No Asbestos Detected	
S-4B 040518662-0002		Brown Non-Fibrous Homogeneous	100.0	None	No Asbestos Detected	
S-4C 040518662-0003		Brown Non-Fibrous Homogeneous	100.0	None	No Asbestos Detected	

Minimum Silicate fibers observed on all three samples.

Analyst(s)

Steve Siegel (3)



Stephen Siegel, CIH
or other approved signatory

This laboratory is not responsible for % asbestos in total sample when the residue only is submitted for analysis. The above report relates only to the items tested. This report may not be reproduced, except in full, without written approval by EMSL Analytical, Inc. The test results contained within this report meet the requirements of NELAP unless otherwise noted.

CREDITATIONS: AIHA #100194, NVLAP #101048-0 and NY STATE ELAP #10872

MYTNOB-2

THIS IS THE LAST PAGE OF THE REPORT.

1

04051755

Project Number 03060.02		Project Name/Client FLEEMAN'S B&B CO		Custody Seal #		Earth Tech Cooler #	
Sample Custodian Signature		Signature		Analysis Required		Matrix	
Item No.	Sample Description (Field ID Number)	Date	Time	Grab	Comp	PID Reading (ppm)	Label Number
1	S-1A-2C	9/14/08		X			
2	S-2A-2C						
3	S-3A-2C						
4	S-4A						
5	S-4B						
6	S-4C						
7	S-5A-C						
8	S-6A-C						
9	S-5A						
10	S-5B						
11	S-5C						
12	S-6A						
13	S-6B						
14	S-6C						
15	OPA-2A						
16	OPA-4B						
17	OPA-1C						
18							

Relinquished by: (Signature)	Received by: (Signature)	Disposed of by: (Signature)	Items:	Date / Time
<i>[Signature]</i>	<i>[Signature]</i>			
Relinquished by: (Signature)	Received by: (Signature)	Disposed of by: (Signature)	Items:	Date / Time

Send Lab Results To:	Remarks:	Lab Delivery Method:
CHRISTIAN, CARR	<i>[Redacted]</i>	<input checked="" type="checkbox"/> Common carrier
EARTH TECH	Federal Express Account No.:	
	Lab:	

Laboratory Receiving Notes:	
Custody Seal Intact:	<input checked="" type="checkbox"/>
Temp of Shipping Container:	<input checked="" type="checkbox"/>
Sample Collection:	<input checked="" type="checkbox"/>

04051755
9/14/08
FLEEMAN'S B&B CO
EARTH TECH

EMSL Analytical, Inc.

107 Haddon Ave., Westmont, NJ 08108

Phone: (856) 858-4800

Fax: (856) 858-4960

Email: ssiegonl@EMSL.com**EMSL**

Attn: **Chris Hunsicker**
Earth Tech
40 British American Boulevard
Latham, NY 12110

Fax: (518) 951-2300

Phone: (518) 951-2200

Project: 83060.02/FREEMAN'S BRIDGE

Customer ID: RE150

Customer PO:

Received: 09/13/05 11:22 AM

EMSL Order: 040517555

EMSL Proj:

Analysis Date: 9/19/2005

Report Date: 9/19/2005

Asbestos Analysis of Bulk Materials by PLM via the NY State ELAP 198.1 Method

Sample	Location	Appearance	Non-Asbestos		Asbestos % Type
			% Fibrous	% Non-Fibrous	
MSA-4A 040517555-0001		White/Brown Fibrous Heterogeneous	45.00% Cellulose 35.00% Min. Wool	20.00% Non-fibrous (other)	None Detected
MSA-4B 040517555-0002		White/Brown Fibrous Heterogeneous	45.00% Cellulose 35.00% Min. Wool	20.00% Non-fibrous (other)	None Detected
MSA-4C 040517555-0003		White/Brown Fibrous Heterogeneous	45.00% Cellulose 35.00% Min. Wool	20.00% Non-fibrous (other)	None Detected
MSA-5A 040517555-0004		White/Brown Fibrous Heterogeneous	45.00% Cellulose 35.00% Min. Wool	20.00% Non-fibrous (other)	None Detected
3A-5B 040517555-0005		White/Brown Fibrous Heterogeneous	45.00% Cellulose 35.00% Min. Wool	20.00% Non-fibrous (other)	None Detected
MSA-5C 040517555-0006		White/Brown Fibrous Heterogeneous	45.00% Cellulose 35.00% Min. Wool	20.00% Non-fibrous (other)	None Detected
DUP 1 040517555-0007		White/Brown/Pink Fibrous Heterogeneous	10.00% Cellulose 40.00% Min. Wool	50.00% Non-fibrous (other)	None Detected
DUP 3 040517555-0008		White/Brown/Pink Fibrous Heterogeneous	10.00% Cellulose 40.00% Min. Wool	50.00% Non-fibrous (other)	None Detected
MSP 2B 040517555-0009		Brown/White Fibrous Heterogeneous	40.00% Cellulose	60.00% Non-fibrous (other)	None Detected
MSP 2C 040517555-0010		Brown/White Fibrous Heterogeneous	40.00% Cellulose	60.00% Non-fibrous (other)	None Detected

Analyst(s)

Debra Beard (16)

Stephen Siegel, CIH
 or other approved signatory

PLM has been known to miss asbestos in a small percentage of samples which contain asbestos. Negative PLM results cannot be guaranteed. Samples reported as <1% or none should be tested with TEM. The above test report relates only to the items tested. This report may not be reproduced, except in full, without written approval by EMSL Analytical, Inc. The above text must not be used by the client to claim product endorsement by NVLAP nor any agency of the United States Government. The test results contained in this report meet the requirements of NELAP unless otherwise noted.

Analysis performed by EMSL Westmont (NVLAP #101048-01, NY ELAP 10872)

PLM Point Count-1

EMSL Analytical, Inc.

107 Haddon Ave., Westmont, NJ 08108

Phone: (856) 858-4800 Fax: (856) 858-4960 Email: sale@emsl.com**EMSL**

Attn: **Chris Hunsicker**
Earth Tech
40 British American Boulevard
Latham, NY 12110

Fax: (518) 951-2300 Phone: (518) 951-2200
 Project: 83060.02/FREEMAN'S BRIDGE

Customer ID: RE150
 Customer PO:
 Received: 09/13/05 11:22 AM
 EMSL Order: 040517555
 EMSL Proj:
 Analysis Date: 9/19/2005
 Report Date: 9/19/2005

Asbestos Analysis of Bulk Materials by PLM via the NY State ELAP 198.1 Method

Sample	Location	Appearance	Non-Asbestos		Asbestos
			% Fibrous	% Non-Fibrous	% Type
MSP 1B 040517555-0011		Black/Brown/White Fibrous Heterogeneous	80.00% Cellulose	20.00% Non-fibrous (other)	None Detected
MSP 1C 040517555-0012		Brown/White Fibrous Heterogeneous	80.00% Cellulose	20.00% Non-fibrous (other)	None Detected
S-1B 040517555-0013		White/Brown Fibrous Heterogeneous	45.00% Cellulose 35.00% Min. Wool	20.00% Non-fibrous (other)	None Detected
S-1C 0517555-0014		White/Brown Fibrous Heterogeneous	45.00% Cellulose 35.00% Min. Wool	20.00% Non-fibrous (other)	None Detected
S-2B 040517555-0015		White/Brown Fibrous Heterogeneous	45.00% Cellulose 35.00% Min. Wool	20.00% Non-fibrous (other)	None Detected
S-2C 040517555-0016		White/Brown Fibrous Heterogeneous	45.00% Cellulose 35.00% Min. Wool	20.00% Non-fibrous (other)	None Detected

Analyst(s)

Dekora Beard (16)

Stephen Siegel, CIH
 or other approved signatory

It has been known to miss asbestos in a small percentage of samples which contain asbestos. Negative PLM results cannot be guaranteed. Samples reported as <1% or none detected should be tested with TEM. The above test report relates only to the items tested. This report may not be reproduced, except in full, without written approval by EMSL Analytical, Inc. The above test must not be used by the client to claim product endorsement by NVLAP nor any agency of the United States Government. The test results contained within this report meet the requirements of NELAP unless otherwise noted.

Analysis performed by EMSL Westmont (NVLAP #101048-0), NY ELAP 10872

PLMPointCount-1

THIS IS THE LAST PAGE OF THE REPORT.

EMSL Analytical, Inc.

107 Haddon Ave., Westmont, NJ 08108

Phone: (856) 858-4800 Fax: (856) 858-4960 Email: ssiegel@EMSL.com**EMSL**

Attn: **Chris Hunsicker**
Earth Tech
40 British American Boulevard
Latham, NY 12110

Fax: (518) 951-2300

Phone: (518) 951-2200

Project: 83060.02/FREEMAN'S BRIDGE

Customer ID: RE150

Customer PO:

Received: 09/13/05 11:22 AM

EMSL Order: 040517555

EMSL Proj:

Analysis Date: 9/19/2005

Report Date: 9/19/2005

**Asbestos Analysis of Non-Friable Organically Bound Materials by PLM via the NY
State ELAP 198.6 Method**

SAMPLE ID	DESCRIPTION	APPEARANCE	% MATRIX MATERIAL	% NON-ASBESTOS FIBERS	ASBESTOS TYPES
DUP 2 040517555-0017		Black Non-Fibrous Homogeneous	100.0	None	Inconclusive: No Asbestos Detected

Analyst(s)

Delores Beard (1)

Stephen Siegel, CIH
or other approved signatory

*Polarized Light Microscopy (PLM) is not consistently reliable in detecting asbestos in floor coverings and similar non-friable organically bound materials. Quantitative Transmission Electron Microscopy is currently the only method that can be used to determine if this material can be considered or treated as non-asbestos containing. The test results contained within this report meet the requirements of NELAC unless otherwise noted. EMSL maintains liability limited to cost of analysis. This report relates only to the samples reported above and may not be reproduced, except in full, without written approval by EMSL. The above test report relates only to the items tested. EMSL bears no responsibility for sample section activities or analytical method limitations.

ACCREDITATIONS: AIHA #100192, NVLAP #101048-0 and NY STATE ELAP #10872

NYS198-2

THIS IS THE LAST PAGE OF THE REPORT.

EMSL Analytical, Inc.

107 Haddon Ave., Westmont, NJ 08108

Phone: (856) 858-4800 Fax: (856) 858-4960 Email: ssiegel@EMSL.com

Attn: Chris Hunsicker
Earth Tech
40 British American Boulevard
Latham, NY 12110

Fax: (518) 951-2300 Phone: (518) 951-2200
Project: 83060.02/FREEMAN'S BRIDGE

Customer ID: REI50
Customer PO:
Received: 09/13/05 11:22 AM
EMSL Order: 040517555
EMSL Proj:
Analysis Date: 9/20/2005
Report Date: 9/29/2005

Asbestos Analysis of Non-Friable Organically Bound materials by Transmission
Electron Microscopy via NYS ELAP Method 198.4

SAMPLE ID	DESCRIPTION	APPEARANCE	% MATRIX MATERIAL	% NON-ASBESTOS FIBERS	ASBESTOS TYPES	% TOTAL ASBESTOS
DUP 2 040517555-0017		Black Non-Fibrous Homogeneous	99.7	None	<1 Chrysotile	<1

Analyst(s)

Anant Samudra (1)



Stephen Siegel, CIH
or other approved signatory

This laboratory is not responsible for % asbestos in total sample when the residue only is submitted for analysis. The above report relates only to the items tested. This report may not be reproduced, except in full, without written approval by EMSL Analytical, Inc. The test results contained within this report meet the requirements of NELAC unless otherwise noted.
ACCREDITATIONS: AIHA #100194, NVLAP #101048-0 and NY STATE ELAP #10872

Chain of Custody Record

040517555

RECEIVED
E.M.S.L.
WESTMON
22:11 MAY 81
F514/Earth.Sci

Pink Copy - Client

Yellow Copy - File

White Copy - Lab

Rev. 10/98

EMSL Analytical, Inc.

107 Haddon Ave., Westmont, NJ 08108

Phone: (856) 358-4800 Fax: (856) 358-4950 Email: ssiegel@EMSL.com

Attn: **Chris Hunsicker**
Earth Tech
40 British American Boulevard
Latham, NY 12110

Customer ID: RE150
Customer PO:
Received: 09/13/05 11:22 AM
EMSL Order: 040517577

Fax: (518) 951-2300 Phone: (518) 951-2200
Project: 83060.02/FREEMAN'S BRIDGE

EMSL Proj:
Analysis Date: 9/15/2005
Report Date: 10/4/2005

Asbestos Analysis of Bulk Materials by PLM via the NY State ELAP 198.1 Method

Sample	Location	Appearance	Non-Asbestos		Asbestos
			% Fibrous	% Non-Fibrous	% Type
W-1A 040517577-0001		Brown/White Fibrous Heterogeneous	70.00% Cellulose	30.00% Non-fibrous (other)	None Detected
W-1B 040517577-0002		Brown/White Fibrous Heterogeneous	60.00% Cellulose	40.00% Non-fibrous (other)	None Detected
W-1C 040517577-0003		Brown/White Fibrous Heterogeneous	70.00% Cellulose	30.00% Non-fibrous (other)	None Detected
-2A 040517577-0004		White Fibrous Heterogeneous	10.00% Cellulose 5.00% Glass	85.00% Non-fibrous (other)	None Detected
W-2B 040517577-0005		White Fibrous Heterogeneous	10.00% Cellulose 5.00% Glass	85.00% Non-fibrous (other)	None Detected
W-2C 040517577-0006		White Fibrous Heterogeneous	10.00% Cellulose 5.00% Glass	85.00% Non-fibrous (other)	None Detected
MSA-1A 040517577-0007		Brown/White Fibrous Heterogeneous	90.00% Cellulose	10.00% Non-fibrous (other)	None Detected
MSA-1B 040517577-0008		Brown/Gray Fibrous Heterogeneous	80.00% Cellulose	20.00% Non-fibrous (other)	None Detected
MSA-1C 040517577-0009		Brown/White/Gray Fibrous Heterogeneous	80.00% Cellulose	20.00% Non-fibrous (other)	None Detected
MSA-2A 040517577-0010		Brown/Gray Fibrous Heterogeneous	10.00% Cellulose	90.00% Non-fibrous (other)	None Detected

Analyst(s)

Will DiBella (15)



Stephen Siegel, CIH
or other approved signatory

PLM has been known to miss asbestos in a small percentage of samples which contain asbestos. Negative PLM results cannot be guaranteed. Samples reported as <1% or none detected should be tested with TEM. The above test report relates only to the items tested. This report may not be reproduced, except in full, without written approval by EMSL Analytical, Inc. The above test must not be used by the client to claim product endorsement by NVLAP nor any agency of the United States Government. The test results contained within this report meet the requirements of NELAP unless otherwise noted.

Analysis performed by EMSL Westmont (NVLAP #101048-0), NY ELAP 10872

EMSL Analytical, Inc.

107 Haddon Ave., Westmont, NJ 08108

Phone: (856) 358-4900 Fax: (856) 858-4950 Email: sjsiegel@EMSL.com

Attn: **Chris Hunsicker**
Earth Tech
40 British American Boulevard
Latham, NY 12110

Fax: (518) 951-2300 Phone: (518) 951-2200

Project: **83060.02/FREEMAN'S BRIDGE**

Customer ID: RE150
Customer PO:
Received: 09/13/05 11:22 AM
EMSL Order: 040517577

EMSL Proj:
Analysis Date: 9/15/2005
Report Date: 10/4/2005

Asbestos Analysis of Bulk Materials by PLM via the NY State ELAP 198.1 Method

Sample	Location	Appearance	Non-Asbestos		Asbestos
			% Fibrous	% Non-Fibrous	% Type
MSA-2B 040517577-0011		Brown/White Fibrous Heterogeneous	10.00% Cellulose	90.00% Non-fibrous (other)	None Detected
MSA-2C 040517577-0012		Brown/Gray Fibrous Heterogeneous	10.00% Cellulose	90.00% Non-fibrous (other)	None Detected
MSA-3A 040517577-0013		Gray/White Fibrous Heterogeneous	40.00% Cellulose 20.00% Min. Wool	40.00% Non-fibrous (other)	None Detected
3A-3B 040517577-0014		Gray/White Fibrous Heterogeneous	40.00% Cellulose 20.00% Min. Wool	40.00% Non-fibrous (other)	None Detected
MSA-3C 040517577-0015		Gray/White Fibrous Heterogeneous	40.00% Cellulose 20.00% Min. Wool	40.00% Non-fibrous (other)	None Detected

Analyst(s)

Will DiBella (15)



Stephen Siegel, CIH
or other approved signatory

It has been known to miss asbestos in a small percentage of samples which contain asbestos. Negative PLM results cannot be guaranteed. Samples reported as <1% or none detected should be tested with TEM. The above test report relates only to the items tested. This report may not be reproduced, except in full, without written approval by EMSL Analytical, Inc. The above test must not be used by the client to claim product endorsement by NVLAP nor any agency of the United States Government. The test results contained within this report meet the requirements of NELAC unless otherwise noted.

Analysis performed by EMSL Westmont (NVLAP #101048-0), NY ELAP 10872

Chain of Custody Record



EARTHTECH

A Tyco Infrastructure Services Company

Project Number 32000.02		Project Name/Client FARMER'S ROAD		Custody Seal #		Earth Tech Cooler #	
Sample Custodian: (Signature) <i>[Signature]</i>		Analysis Required		Matrix		Sample Container	
Item No.	Sample Description (Field ID Number)	Date	Time	Grab	Comp	PID Reading (ppm)	Label Number
1	W-1A	7/9/05		X			
2	W-1B						
3	W-1C						
4	W-2A						
5	W-2B						
6	W-2C						
7	MSA-1A						
8	MSA-1B						
9	MSA-1C						
10	MSA-2A						
11	MSA-2B						
12	MSA-2C						
13	MSA-3A						
14	MSA-3B						
15	MSA-3C						
16	MSA-4A						
17	MSA-4B						
18							

Relinquished by: (Signature)	Date / Time	Received by: (Signature)	Disposed of by: (Signature)	Items:	Date / Time
<i>[Signature]</i>	7/12/05 1:10				
Relinquished by: (Signature)		Received by: (Signature)	Disposed of by: (Signature)	Items:	Date / Time

Send Lab Results To:	Check Delivery Method:	Laboratory Receiving Notes:
Remarks: AVAL 26 BY POSS 7/12/05 BY GORE PL	<input type="checkbox"/> Samples delivered in person <input type="checkbox"/> Common carrier	Custody Seal Intact? Temp. of Shipping Container: Sample Condition:

EMSL Analytical, Inc.

107 Haddon Ave., Westmont, NJ 08108

Phone: (856) 852-4800 Fax: (856) 852-4966 Email: ssiegel@EMSL.com

Attn: **Chris Hunsicker**
Earth Tech
40 British American Boulevard
Latham, NY 12110

Fax: (518) 951-2300 Phone: (518) 951-2200
Project: 83060.02/FREEMAN'S BRIDGE

Customer ID: REI50
Customer PO:
Received: 09/13/05 11:22 AM
EMSL Order: 040517574

EMSL Proj:
Analysis Date: 9/15/2005
Report Date: 10/4/2005

Asbestos Analysis of Bulk Materials by PLM via the NY State ELAP 198.1 Method

Sample	Location	Appearance	Non-Asbestos		Asbestos
			% Fibrous	% Non-Fibrous	% Type
0BS-2A 040517574-0001		Brown/White Fibrous Heterogeneous	10.00% Cellulose 5.00% Glass	85.00% Non-fibrous (other)	None Detected
0BS-2B 040517574-0002		Brown/White Fibrous Heterogeneous	10.00% Cellulose 5.00% Glass	85.00% Non-fibrous (other)	None Detected
0BS-2C 040517574-0003		Brown/White Fibrous Heterogeneous	10.00% Cellulose 5.00% Glass	85.00% Non-fibrous (other)	None Detected
0BS-5A 040517574-0004		Brown/Gray/White Fibrous Heterogeneous	40.00% Cellulose 40.00% Min. Wool	20.00% Non-fibrous (other)	None Detected
0BS-5B 040517574-0005		Brown/Gray/White Fibrous Heterogeneous	40.00% Cellulose 40.00% Min. Wool	20.00% Non-fibrous (other)	None Detected
0BS-5C 040517574-0006		Brown/Gray/White Fibrous Heterogeneous	40.00% Cellulose 40.00% Min. Wool	20.00% Non-fibrous (other)	None Detected
0BS-6A 040517574-0007		Brown/Gray/White Fibrous Heterogeneous	40.00% Cellulose 40.00% Min. Wool	20.00% Non-fibrous (other)	None Detected
0BS-6B 040517574-0008		Brown/Gray/White Fibrous Heterogeneous	40.00% Cellulose 40.00% Min. Wool	20.00% Non-fibrous (other)	None Detected
0BS-6C 040517574-0009		Brown/Gray/White Fibrous Heterogeneous	40.00% Cellulose 40.00% Min. Wool	20.00% Non-fibrous (other)	None Detected
0BS-7A 040517574-0010		Black/Tan Non-Fibrous Heterogeneous		100.00% Non-fibrous (other)	None Detected

Analyst(s)

Will DiBella (12)



Stephen Siegel, CIH
or other approved signatory

PLM has been known to miss asbestos in a small percentage of samples which contain asbestos. Negative PLM results cannot be guaranteed. Samples reported as <1% or none detected should be tested with TEM. The above test report relates only to the items tested. This report may not be reproduced, except in full, without written approval by EMSL Analytical, Inc. The above test must not be used by the client to claim product endorsement by NVLAP nor any agency of the United States Government. The test results contained within this report meet the requirements of NELAC unless otherwise noted.

Analysis performed by EMSL Westmont (NVLAP #101048-0), NY ELAP 10872

EMSL Analytical, Inc.

107 Haddon Ave., Westmont, NJ 08108

Phone: (856) 858-4800 Fax: (856) 858-4960 Email: jsiegel@EMSL.com

Attn: **Chris Hunsicker**
Earth Tech
40 British American Boulevard
Latham, NY 12110

Fax: (518) 951-2300 Phone: (518) 951-2200
Project: 83060.02/FREEMAN'S BRIDGE

Customer ID: RE150
Customer PO:
Received: 09/13/05 11:22 AM
EMSL Order: 040517574

EMSL Proj:
Analysis Date: 9/15/2005
Report Date: 10/4/2005

Asbestos Analysis of Bulk Materials by PLM via the NY State ELAP 198.1 Method

Sample	Location	Appearance	Non-Asbestos		Asbestos
			% Fibrous	% Non-Fibrous	% Type
0BS-7B 040517574-0011		Black/Tan/White Non-Fibrous Heterogeneous		100.00% Non-fibrous (other)	None Detected
0BS-7C 040517574-0012		Black/Tan/White Non-Fibrous Heterogeneous		100.00% Non-fibrous (other)	None Detected

Analyst(s)

Will DiBella (12)

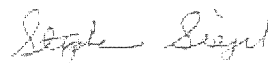

Stephen Siegel, CIH
or other approved signatory

LM has been known to miss asbestos in a small percentage of samples which contain asbestos. Negative PLM results cannot be guaranteed. Samples reported as <1% or none detected should be tested with TEM. The above test report relates only to the items tested. This report may not be reproduced, except in full, without written approval by EMSL Analytical, Inc. The above test must not be used by the client to claim product endorsement by NVLAP nor any agency of the United States Government. The test results contained within this report meet the requirements of NELAC unless otherwise noted.

Analysis performed by EMSL Westmont (NVLAP #101048-0), NY ELAP 10872



040517574

Chain of Custody Record

Project Number 03060, 02		Project Name/Client FREMONT'S DEPOT		Custody Seal #		Earth Tech Cooler #	
Sample Custodian: (Signature)				Analysis Required		Matrix	
Item No.	Sample Description (Field ID Number)	Date	Time	Lab	Comp	PID Reading (ppm)	Label Number
1	OBS - 2A	9/9/03					
2	OBS - 2B						
3	OBS - 2C						
4	OBS - 5A						
5	OBS - 5B						
6	OBS - 5C						
7	OBS - 6A						
8	OBS - 6B						
9	OBS - 6C						
10	OBS - 7A						
11	OBS - 7B						
12	OBS - 7C						
13							
14							
15							
16							
17							
18							

Received by: (Signature)	Received by: (Signature)	Received by: (Signature)	Disposed of by: (Signature)	Disposed of by: (Signature)	Disposed of by: (Signature)
9/12/03 1400	9/12/03 1400	9/12/03 1400	9/12/03 1400	9/12/03 1400	9/12/03 1400

Send Lab Results To:	Remarks:
CHRIS HUNSRKEN	9/12/03 1400
EARTH TECH	

RECEIVED
F514/Earth Sci
WESTMONT
22:11:22
SEP 13 2003

White Copy - Lab
Yellow Copy - File
Pink Copy - Client

Rev. 10/98

EMSL Analytical, Inc.

107 Haddon Ave., Westmont, NJ 08108

Phone: (856) 858-4300 Fax: (856) 858-4960 Email: ssiegel@EMSL.com

Attn: Chris Hunsicker
Earth Tech
40 British American Boulevard
Latham, NY 12110

Fax: (518) 951-2300 Phone: (518) 951-2200
Project: 83060.02/FREEMAN'S BRIDGE

Customer ID: REI50
Customer PO:
Received: 09/13/05 11:22 AM
EMSL Order: 040517568

EMSL Proj:
Analysis Date: 9/19/2005
Report Date: 10/4/2005

Asbestos Analysis of Bulk Materials by PLM via the NY State ELAP 198.1 Method

Sample	Location	Appearance	Non-Asbestos		Asbestos
			% Fibrous	% Non-Fibrous	% Type
S-3B		White/Brown	90.00% Cellulose	10.00% Non-fibrous (other)	None Detected
040517568-0001		Fibrous			
		Heterogeneous			

Analyst(s)

Delores Beard (1)



Stephen Siegel, CIH
or other approved signatory

LM has been known to miss asbestos in a small percentage of samples which contain asbestos. Negative PLM results cannot be guaranteed. Samples reported as <1% or none detected should be tested with TEM. The above test report relates only to the items tested. This report may not be reproduced, except in full, without written approval by EMSL Analytical, Inc. The above test must not be used by the client to claim product endorsement by NVLAP nor any agency of the United States Government. The test results contained within this report meet the requirements of NELAC unless otherwise noted.

Analysis performed by EMSL Westmont (NVLAP #101048-0), NY ELAP 10872

040517568

Chain of Custody Record



A Terra Infrastructure Services Company

Project Number 03060.02		Project Name/Client FOREMAN'S BRIDGE		Custody Seal #		Earth Tech Cooler #	
Sample (Signature)		Analysis Required		Matrix		Sample Container	
Item No.	Sample Description (Field ID Number)	Date	Time	Comp	PID Reading (ppm)	Label Number	
1	S-3D	9/19/05		X			
2	S-3C						
3							
4							
5							
6							
7							
8							
9							
10							
11							
12							
13							
14							
15							
16							
17							
18							
Relinquished by: (Signature)		Date / Time		Received by: (Signature)		Date / Time	
<i>[Signature]</i>		9/12/05 1400		<i>[Signature]</i> FX		9/13/05 11:20 AM	
Relinquished by: (Signature)		Date / Time		Received by: (Signature)		Date / Time	
<i>[Signature]</i>				<i>[Signature]</i>			
Send Lab Results To:		Check Delivery Method:		Laboratory Receiving Notes:		Custody Seal Intact?	
CHARIS HUNTSCHER		ANALYZE BY POSITIVE		Samples delivered in person		<input type="checkbox"/>	
EARTH TECH		STOP BY GROUP #		Common carrier		<input type="checkbox"/>	
Federal Express Account No.:		Lab:		Temp. of Shipping Container:		Sample Condition:	

Rev. 10/98

White Copy - Lab

Yellow Copy - File

Pink Copy - Client

FS14/Earth.Sci

EMSL Analytical, Inc.

1007 Madison Ave., New York, NY 10017

Phone: (908) 350-2000 Fax: (908) 350-4000 Email: info@emsl.com

Attn: **Chris Hunsicker**
Earth Tech
40 British American Boulevard
Latham, NY 12110

Fax: (518) 951-2300 Phone: (518) 951-2200
 Project: 83060.02 FREEMAN'S BRIDGE

Customer ID: REI50
 Customer PO:
 Received: 09/13/05 11:24 AM
 EMSL Order: 040517544
 EMSL Proj:
 Analysis Date: 9/19/2005
 Report Date: 9/19/2005

Asbestos Analysis of Non-Friable Organically Bound Materials by PLM via the NY State ELAP 198.6 Method

SAMPLE ID	DESCRIPTION	APPEARANCE	% MATRIX MATERIAL	% NON-ASBESTOS FIBERS	ASBESTOS TYPES
RMOB-1A 040517544-0001		Black Non-Fibrous Homogeneous	100.0	None	Inconclusive: No Asbestos Detected
RMOB-1B 040517544-0002		Black Non-Fibrous Homogeneous	100.0	None	Inconclusive: No Asbestos Detected
RMOB-1C 040517544-0003		Black Non-Fibrous Homogeneous	100.0	None	Inconclusive: No Asbestos Detected
RMOB-2A 040517544-0004		Black Non-Fibrous Homogeneous	100.0	None	Inconclusive: No Asbestos Detected
RMOB-2B 040517544-0005		Black Non-Fibrous Homogeneous	100.0	None	Inconclusive: No Asbestos Detected
RMM-1A 040517544-0006		Black Non-Fibrous Homogeneous	100.0	None	Inconclusive: No Asbestos Detected
RMM-1B 040517544-0007		Black Non-Fibrous Homogeneous	100.0	None	Inconclusive: No Asbestos Detected
RMM-1C 040517544-0008		Black Non-Fibrous Homogeneous	100.0	None	Inconclusive: No Asbestos Detected

Analyst(s)

Delores Beard (8)

Stephen Siegel, CIH
 or other approved signatory

*Polarized Light Microscopy (PLM) is not consistently reliable in detecting asbestos in floor coverings and similar non-friable organically bound materials. Quantitative Transmission Electron Microscopy is currently the only method that can be used to determine if this material can be considered or treated as non-asbestos containing. The test results contained within this report meet the requirements of NELAC unless otherwise noted. EMSL maintains liability limited to cost of analysis. This report relates only to the samples reported above and may not be reproduced, except in full, without written approval by EMSL. The above test report relates only to the items tested. EMSL bears no responsibility for sample collection activities or analytical method imitations.

ACCREDITATIONS: AIHA #100192, NVLAP #101048-0 and NY STATE ELAP #10872

EMSL Analytical, Inc.

107 Haddon Ave., Westmont, NJ 08108

Phone: (856) 858-4800 Fax: (856) 858-4960 Email: ssiegel@EMSL.com

Attn: **Chris Hunsicker**
Earth Tech
40 British American Boulevard
Latham, NY 12110

Fax: (518) 951-2300 Phone: (518) 951-2200
Project: **83060.02 FREEMAN'S BRIDGE**

Customer ID: RE150
Customer PO:
Received: 09/13/05 11:24 AM
EMSL Order: 040517544
EMSL Proj:
Analysis Date: 9/20/2005
Report Date: 9/29/2005

**Asbestos Analysis of Non-Friable Organically Bound materials by Transmission
Electron Microscopy via NYS ELAP Method 198.4**

SAMPLE ID	DESCRIPTION	APPEARANCE	% MATRIX MATERIAL	% NON-ASBESTOS FIBERS	ASBESTOS TYPES	% TOTAL ASBESTOS
RMOB-1A 040517544-0001		Black Non-Fibrous Homogeneous	100.0	None	No Asbestos Detected	
RMOB-1B 040517544-0002		Black Non-Fibrous Homogeneous	99.4	None	<1 Chrysotile	<1
RMOB-1C 040517544-0003		Black Non-Fibrous Homogeneous	100.0	None	No Asbestos Detected	
MOB-2A 040517544-0004		Black Non-Fibrous Homogeneous	99.3	None	<1 Chrysotile	<1
RMOB-2B 040517544-0005		Black Non-Fibrous Homogeneous	100.0	None	No Asbestos Detected	
RMM-1A 040517544-0006		Black Non-Fibrous Homogeneous	100.0	None	No Asbestos Detected	
RMM-1B 040517544-0007		Black Non-Fibrous Homogeneous	100.0	None	No Asbestos Detected	
RMM-1C 040517544-0008		Black Non-Fibrous Homogeneous	100.0	None	No Asbestos Detected	

Analyst(s)

Anant Samudra (8)



Stephen Siegel, CIH
or other approved signatory

This laboratory is not responsible for % asbestos in total sample when the residue only is submitted for analysis. The above report relates only to the items tested. This report may not be reproduced, except in full, without written approval by EMSL Analytical, Inc. The test results contained within this report meet the requirements of NELAC unless otherwise noted.
ACCREDITATIONS: AIHA #100194, NVLAP #101048-0 and NY STATE ELAP #10872

NYTNOB-2

THIS IS THE LAST PAGE OF THE REPORT.

1

040517544

Chain of Custody Record

REI-50



A Tyco Infrastructure Services Company

Project Number		Project Name/Client		Custody Seal #		Earth Tech Cooler #	
Sample Description (Field ID Number)		Date		Analysis Required		Matrix	
Item No.	Sample Description (Field ID Number)	Date	Time	Lab	Comp.	PID Reading (ppm)	Label Number
1	RmoB-2A	9/19/05					
2	2B						
3	3C						
4	RmoB-2A						
5	RmoB-2B						
6	RmoB-2A						
7	4B						
8	1C						
9							
10							
11							
12							
13							
14							
15							
16							
17							
18							
Received by: (Signature)		Date / Time		Received by: (Signature)		Date / Time	
Refiniquished by: (Signature)		Date / Time		Refiniquished by: (Signature)		Date / Time	
Send Lab Results To:		Date / Time		Check Delivery Method:		Laboratory Receiving Notes:	
CHRIS THURGOOD		9/12/05 1400		<input checked="" type="checkbox"/> Samples delivered in person <input type="checkbox"/> Common carrier		Custody Seal Intact?	
EAG-774 RECH		Federal Express Airbill No.:		Temp of Shipping Container:		Sample Condition:	
		Lab:					

SAMPLES ACCEPTED FOR ANALYSIS BY EMT ANALYTICAL INC.

RECEIVED
WESTON
13 AUG 24
F314/Earth.Sci

White Copy - Lab
Yellow Copy - File
Pink Copy - Client

APPENDIX B

Credentials

STATE OF NEW YORK - DEPARTMENT OF LABOR
ASBESTOS CERTIFICATE



PATRICE M POOLE

CLASS
D INSPECTOR



CERT# 05-05628
EXPIRES 04/06

MUST BE CARRIED ON ASBESTOS PROJECTS



DMV# 590990642
EYES BRO
HAIR BLK
HGT 5' 05"

IF FOUND RETURN TO:
NYSDEL - L&C UNIT
ROOM 161 BUILDING 12
STATE OFFICE CAMPUS
ALBANY NY 12240

DIVISION OF SAFETY AND HEALTH

License and Certificate Unit
BUILDING 12, STATE CAMPUS
ALBANY, NY 12240

RESTRICTED LICENSE
Asbestos Removal Not
Permitted

ASBESTOS HANDLING LICENSE

Contractor: **EARTH TECH, INC. DBA EARTH TECH**
NORTHEAST, INC.

LICENSE NUMBER: 04-0306

40 BRITISH AMERICAN BLVD.
LATHAM, NY 12110

DATE OF ISSUE: 6/1/2005

EXPIRATION DATE: 6/30/2006

Duly Authorized Representative: **Thomas J. Cascino, P.E.**

This license has been issued in accordance with applicable provisions of Article 30 of the Labor Law of New York State and of the New York State Codes, Rules and Regulations (12 NYCRR Part 56). It is subject to suspension or revocation for a (1) serious violation of state, federal or local laws with regard to the conduct of an asbestos project, or (2) demonstrated lack of responsibility in the conduct of any job involving asbestos or asbestos material.

This license is valid only for the contractor named above and this license or a photocopy must be prominently displayed at the asbestos project worksite. This license verifies that all persons employed by the licensee on an asbestos project in New York State have been issued an Asbestos Certificate, appropriate for the type of work they perform, by the New York State Department of Labor.

SH 432 (6-03)

Anthony Germano, Director
FOR THE COMMISSIONER OF LABOR