



Shaw Project 830319

FINAL

March 2007

Removal Action Report for the Drum Removal Area

Plattsburgh Air Force Base
Plattsburgh, New York

Air Force Center for Environmental Excellence
Brooks Air Force Base, Texas

Contract No. F41624-01-D-8541
Delivery Order 0020





DEPARTMENT OF THE AIR FORCE
AIR FORCE REAL PROPERTY AGENCY



March 14, 2007

MEMORANDUM FOR NYS DEPT OF ENVMTL CONSERVATION (NYSDEC)
ATTN: MR. DANIEL EATON
Bureau of Eastern Remedial Action
625 Broadway, 11th Floor
Albany NY 12233-7015



FROM: AFRPA/COO-ER Plattsburgh
304 New York Road
Plattsburgh NY 12903

SUBJECT: Removal Action Report for the Drum Removal Area

Attached for your information, review, comment, and/or concurrence is the Removal Action Report for Drum Removal Area (a.k.a., the "Buried Drum Site"). This report details actions taken in regards to the buried drums that were encountered during construction of the IRP Site FT-002/Industrial Area Groundwater Operable Unit extraction wells. As indicated in this report, we recommend no further action.

As indicated during previous BRAC Cleanup Team meetings, closeout of the "Buried Drum Site" will be documented in the Proposed Plan/Record of Decision for Miscellaneous EBS Factors.

If you have any questions, please contact me at 518-563-2871, extension 15, or dave.farnsworth@afarpa.pentagon.af.mil.

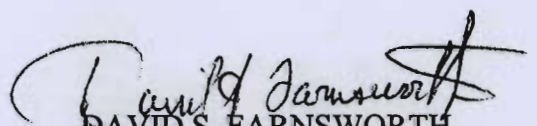
DAVID S. FARNSWORTH
BRAC Environmental Coordinator

Attachment:
Removal Action Report (1 cy)

cc:
USEPA, Reg 2 (Mr. Robert Morse)
NYSDEC, Reg 5 (Mr. Russell Huyck) (1 cy)
NYSDOH (Ms. Wendy Kuchner) (1 cy)

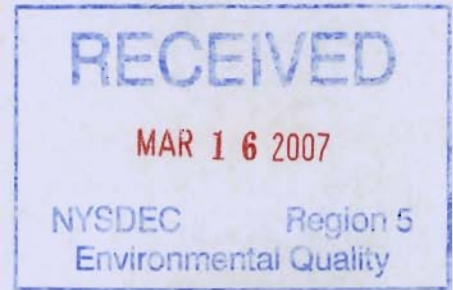

Shaw Project 830319

March 2007

FINAL

Removal Action Report for the Drum Removal Area

Plattsburgh Air Force Base
Plattsburgh, New York

Air Force Center for Environmental Excellence
Brooks Air Force Base, Texas

Contract No. F41624-01-D-8541
Delivery Order 0020



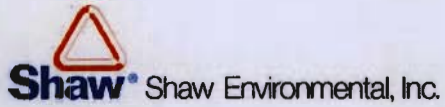

**FINAL
REMOVAL ACTION REPORT
FOR
DRUM REMOVAL AREA**

Prepared For:

AFRPA/DA Plattsburgh
304 New York Road
Plattsburgh, NY 12903

Under Contract To:

Air Force Center for Environmental Excellence
3207 North Road
Brooks AFB, TX 78235-5363

Prepared by:

Shaw Environmental, Inc.
88C Elm Street
Hopkinton, MA 01748-1656

Shaw Project No. 830319
March 2007

TABLE OF CONTENTS

EXECUTIVE SUMMARY iii

SECTION **PAGE**

1.0 INTRODUCTION 1

 1.1 Background 1

 1.2 Preliminary Investigation 1

 1.3 Results 2

2.0 FIRST REMOVAL ACTION 3

 2.1 Initial Drum and Soil Removal 3

 2.1.1 Post-Excavation Sampling – Round 1 3

 2.1.2 Drum Sampling 3

 2.1.3 Staged Soil Sampling 4

 2.1.4 Results of Initial Excavation 4

 2.2 Second Soil Removal and Magnetometer Survey 4

 2.2.1 Post-Excavation Soil Sampling – Round 2 4

 2.2.2 Magnetometer Survey 5

 2.2.3 Results of Additional Soil Removal 5

 2.3 Soil Borings 5

 2.3.1 Soil Boring Results 6

 2.4 Third Soil Removal 6

 2.4.1 Post-Excavation Soil Sampling – Round 3 6

 2.4.2 Post-Excavation Groundwater Sampling 6

 2.5 First Removal Action Results 7

3.0 SECOND REMOVAL ACTION 8

 3.1 Test Pits and Test Trench 8

 3.2 Second Drum and Soil Removal 8

 3.2.1 Waste Characterization Sampling 8

 3.3 Second Removal Action Results 9

 3.4 Comprehensive Removal Action Results and Recommendations 9

4.0 DISPOSAL SUMMARY 10

 4.1 First Disposal Event 10

 4.2 Second Disposal Event 10

TABLES

1. Summary Table of Detected Compounds – Soil Assessment Sampling

2. Summary Table of Detected Compounds – Round 1

3. Waste Characterization Results – Drum Sampling Event 1

4. Waste Characterization Results – Soil Pile Sampling Event 1

5. Summary Table of Detected Compounds – Round 2

6. Summary Table of Detected Compounds – Soil Boring Samples

7. Summary Table of Detected Compounds – Round 3

8. Summary Table of Detected Compounds in Groundwater – Round 3

9. Analyte Exceedances for all Post-Excavation Soil Sampling Events

10. Test Pit and Test Trench Summary

11. Waste Characterization Results – Asphalt Sealer

12. Waste Characterization Results – Soil Pile Sampling Event 2 – TCLP Analysis

13. Waste Characterization Results – Soil Pile Sampling Event 2 – Total Analysis

FIGURES

- 1 Site Location Map – Drum Removal Area
- 2 Excavation and Sampling Locations – First Removal Action
- 3 Post-Excavation Sample Points – Round 2 – 12 May 2004
- 4 Soil Boring Locations – 13 July 2004
- 5 Excavation Extents and Sampling Locations – Round 3
- 6 Excavation, Test Pit, and Test Trench Locations

APPENDICES

- A Photo Log
- B Disposal Documentation

ACRONYMS AND ABBREVIATIONS

AFCEE	Air Force Center for Environmental Excellence
AFRPA	Air Force Real Property Agency
bgs	below ground surface
DOT	United States Department of Transportation
ft	feet
gal	gallon
IRP	Installation Restoration Program
mg/kg	milligrams per kilogram (ppm)
NY	New York
PCB	polychlorinated biphenyl
PID	photoionization detector
PPE	personal protective equipment
ppm	parts per million
RCOs	Recommended Soil Cleanup Objectives
RCRA	Resource Conservation and Recovery Act
SAC	Strategic Air Command
Shaw	Shaw Environmental & Infrastructure, Inc.
SVOC	semi-volatile organic compound
TAGM	Technical and Administrative Guidance Memorandum
TAL	Target Analyte List
TOC	total organic carbon
US	United States
USAF	US Air Force
VOC	volatile organic compound

EXECUTIVE SUMMARY

A buried container at a shallow depth was discovered east of FT-002 Source Operable Unit by Shaw personnel in July 2003 during construction of the IRP Site FT-002 Groundwater Operable Unit Remedial Action. This discovery was reported to responsible Base personnel who directed Shaw to determine the nature of the buried container and contents (if present) and to assess possible impacts to soil quality. Past site history and usage suggest that the container was buried prior to Base construction in the 1950s.

The initial assessment included air monitoring and soil sampling. The assessment results showed elevated levels of VOCs in ambient air and impacts to soil quality. Based on these findings, a removal action was initiated to recover all containers and impacted soil.

The removal action, along with additional assessments (magnetometer survey and soil borings), was conducted in three phases between November 2003 and October 2004. Buried drums and impacted soil were recovered and characterized for off-site disposal. Two drums with contents and 244.53 tons of impacted soil were disposed. Additional buried drums outside of the original removal site limits were discovered during this removal action. These drums contained asphalt sealer. As a result, additional assessment activities were conducted to delineate the extent of the internment site and a second removal action was initiated.

Test pits and trenches were excavated to assess the extents of the second burial site, and to investigate the surrounding area. No additional drums or containers with contents, or impacted soil were discovered outside of the originally identified burial site. All drums, asphalt sealer, and impacted soil were recovered, staged, and sampled for disposal characterization. Three overpacked drums, three 1-cubic yard boxes, and 422.5 tons of impacted soil were disposed off-site along with 63.45 tons of metallic debris and concrete.

Post-excavation sampling results show that all contaminants of concern have been eliminated or reduced below their respective compound-specific RCOs, and that all sources of contamination in soil have been removed. Magnetometer surveys, test pits, trenches, and inspections did not discover any additional burial sites or impacted soil. Consequently, no further action for soil is indicated or recommended for this site.

Impacts to groundwater were assessed and found to be minimal. Additionally, this site is within the IRP Site FT-002 Groundwater Operable Unit where remedial systems are already in place and operating to recover and treat groundwater. Consequently, no further action for groundwater is indicated or recommended for this site.

1.0 INTRODUCTION

All work described in this Removal Action Report was performed at the former Plattsburgh Air Force Base, Plattsburgh, New York (NY) by Shaw Environmental & Infrastructure, Inc. (Shaw) for the United States (US) Air Force Center for Environmental Excellence (AFCEE) under contract number F41624-01-D-8541, Task Order 0020.

The former Plattsburgh Air Force Base (the Base) was the oldest military post in the US. The original military reservation was purchased by the Federal Government in 1814, with additional acreage acquired in 1838 to allow construction of the Plattsburgh Barracks east of the current NY State Route 9 (see Figure 1). The original Base and some acreage located west of Route 9 was occupied or used by the US Army, US Army Air Force, the US Navy, and then by the New York State Housing Commission. The Federal Government reacquired possession of the Base in 1953 and additional acreage located west of NY State Route 9 was acquired to enable construction of a Strategic Air Command (SAC) facility. The groundbreaking ceremony for this expanded Base was held on 29 January 1954, and the Base was utilized by the SAC and other USAF units until closed on 25 September 1995.

The USAF conducted environmental investigations in preparation for base closure. Investigations conducted in 1987 detected volatile organic contaminants (VOCs) in shallow monitoring wells downgradient of the former hazardous materials storage area. As a result of these investigations, the Base was placed on the US Environmental Protection Agency (EPA) National Priorities List on 21 November 1989.

1.1 BACKGROUND

A buried container at a shallow depth was discovered east of FT-002 by Shaw personnel in July 2003 during layout activities for construction of the IRP Site FT-002 Groundwater Operable Unit Remedial Action. This discovery was reported to responsible Base personnel who directed Shaw to determine the nature of the buried container and contents if present, and to assess possible impacts to soil quality. The site location is shown on Figure 1, and the general site layout on Figure 2.

The site is adjacent to a concrete pad that had reportedly been a former highway maintenance garage. A number of other buildings in this area (nature unknown) are shown on topographic maps published in 1906 and 1943. All of these structures were presumably vacated in the early 1950s when the USAF took possession of the property. It is unlikely that the drums were interred after this time since the location is less than 1,000 feet (ft) from the centerline of the military airstrip which was in use from 1955 until 1995. Activities allowed within this restricted clearance zone were strictly limited and would have been closely monitored by USAF security personnel.

1.2 PRELIMINARY INVESTIGATION

A preliminary investigation was conducted to determine the nature of the container, assess soil quality, and to provide data required to establish what level of personal protective equipment (PPE) would be required during the removal action.

In order to determine the proper level of PPE, a photoionization detector (PID) and compound-specific Dräger tubes were used to assess VOC concentrations in ambient air prior to initiating intrusive activities. The total VOC concentration as indicated by the PID was 1,800 parts-per-million (ppm). This total VOC concentration decreased rapidly away from the open container. Compound-specific Dräger tube results showed xylenes at a concentration of 120 ppm, toluene at 30 ppm, ethyl benzene at 20 ppm, a trace of benzene, and no vinyl chloride. Due to the elevated levels of VOCs in ambient air, PPE Level C was used for the initial removal activities. This was later upgraded to Level B as VOC concentrations increased.

Initial soil removal to expose the top of the container was conducted by hand. Stained soil was noted around the top of the container which was discovered to be a buried drum. Consequently, shallow subsurface soil sample PAFB-SS-ANOM-001 was collected on 17 July 2003 from the stained soil and analyzed for volatile organic compounds (VOCs), semi-volatile organic compounds (SVOCs), pesticides, polychlorinated biphenyls (PCBs), and metals. Analytical results were compared with total and compound-specific Recommended Soil Cleanup Objectives (RCOs) in Appendix A of New York State Department of Environmental Conservation Technical and Administrative Guidance Memorandum (TAGM) 4046. Analytical results were also compared with established Site Background concentrations for metals.

Exceedances were noted for total VOCs and for ethylbenzene, p-isopropyltoluene, methylene chloride, and total xylenes. Exceedances were also noted for the metals chromium, selenium, and silver. No SVOCs, PCBs, or pesticides were detected. A summary of all compounds detected in PAFB-SS-ANON-001 is presented in Table 1. Exceedances are indicated in bold print.

1.3 RESULTS

The preliminary investigation showed that at least one buried drum and contaminated soil were present. Based on these results, the base directed that the site be excavated and that all drums, other containers, and contaminated soil be removed and properly disposed of.

2.0 FIRST REMOVAL ACTION

Removals at the original discovery site were conducted in several phases. Each phase of the removal was guided by the results from the previous phase.

2.1 INITIAL DRUM AND SOIL REMOVAL

The site was prepared for excavation on 12 November 2003. High visibility fencing was erected around the proposed excavation area and a bermed and lined waste staging area was constructed. The initial excavation was conducted on 17 November 2003. Based on preliminary investigation results, the initial excavation was conducted in Level C PPE. However, VOC concentrations in ambient air increased as the soil removal progressed and the PPE level was raised to Level B.

Thirteen partially intact 55-gallon drums were uncovered. Most were stacked 2 high in an area approximately 20 ft x 20 ft x 5 ft deep. Eleven of the drums were corroded and empty. Two of the drums still contained product and were overpacked for disposal characterization sampling and analysis. The soil was a dry to moist, fine-medium sand with some silt and occasional pebbles or cobbles. No significant amount of organic material was noted. The soil permeability was estimated to be high. Recovered soil and drums are shown on Photo 1. The extent of excavation is shown in Photo 2.

Exploratory test pits were excavated following this removal action to determine whether other buried containers or drums were present. Since the initial removal had occurred at the south end of a shallow swale, test pits were excavated 50 ft and 100 ft to the north in the same swale. No additional drums, containers, or impacted soils were found.

2.1.1 Post-Excavation Sampling – Round 1

Post-excavation soil samples PE-1 through PE-5 were collected from 0-6 inches below the bottom of the excavation at the locations shown on Figure 2. The excavation bottom was approximately 5 ft below ground surface (bgs). Sampling results showed RCO exceedances for the VOC acetone (0.229 to 8.08 mg/kg) and total VOCs in sample PE-3 (21.6 mg/kg), the SVOC dibenzofuran (0.325 mg/kg), total pesticides in sample PE-3 (225 mg/kg), and for the individual pesticides 4,4'-DDT (3.71 and 217 mg/kg), 4,4'-DDD (5.58 mg/kg), and 4,4'-DDE (2.73 mg/kg). A summary of detected compounds in all samples is presented as Table 2.

2.1.2 Drum Sampling

Drum samples DC and DR-1 collected to characterize the drum contents for disposal. The total VOC concentration was 93,303 mg/kg in sample DC. VOC compounds included acetone (1,140 mg/kg), ethylbenzene (3,990 mg/kg), hexachlorobutadiene (1,450 mg/kg), methylene chloride (55,800 mg/kg), naphthalene (1,170 mg/kg), and xylenes (28,130 mg/kg). The pesticides 4,4'-DDT (749 mg/kg), 4,4'-DDD (32.6 mg/kg), and 4,4'-DDE (2.95 and 8.73 mg/kg) were also detected. The SVOCs 2-methylnaphthalene (298 mg/kg) and naphthalene (115 mg/kg) were also detected in sample DC along with the metals chromium (904 mg/kg) and lead (10.5 mg/kg).

VOCs were not detected in drum DR-1. The SVOCs 2-methylnaphthalene and naphthalene were detected at low concentrations. The pesticides 4,4'-DDE (2.95 mg/kg), 4,4'-DDD (0.0186 mg/kg), 4,4'-DDT (0.13 mg/kg), and endosulfan sulfate (0.00188) were also reported. The metals chromium (2.92 mg/kg) and lead (6.83 mg/kg) were detected along with mercury (0.0218 mg/kg). The reported pH was 12.8.

Based on these results, drum DC was characterized as hazardous, while drum DR-1 was non-hazardous. Analytical results are shown on Table 3. Disposal is discussed in Section 4.

2.1.3 Staged Soil Sampling

Composite soil samples SP1 and SP2 were collected from the staged soil to assess disposal characteristics. These samples were analyzed for VOCs, SVOCs, PCBs, pesticides, RCRA 8 metals, and corrosivity. The total VOC concentration was 263.5 mg/kg. VOC compounds included acetone, ethylbenzene, methylene chloride, toluene, and o-xylene. The total SVOC concentration of 413 mg/kg was due primarily to 2-methylnaphthalene which was detected at a reported concentration of 408 mg/kg. The SVOCs dibenzofuran, naphthalene, and phenanthrene were also detected. Total pesticides were reported at a concentration of 548 mg/kg. This total was primarily due to 4,4'-DDT (508 mg/kg) and 4,4'-DDD (34.4 mg/kg). Lindane, heptachlor, and 4,4'-DDE were also detected. The pH of the soil was 7.08. Based on these results, the soil was classified as non-RCRA hazardous for disposal purposes. Analytical results are shown on Table 4. Disposal is discussed in Section 4.

2.1.4 Results of Initial Excavation

All drums at the original discovery site were removed during the initial excavation. Contaminated soil was identified based on odor and appearance and removed to a prepared soil staging area. Analytical results from the drum samples indicate that the leaking drums most likely were the source for the observed soil contamination. Post-excavation sampling results indicated that pesticide DDT was still present at a concentration in excess of its RCO in soil at the base of the excavation.

Based on these results, the Air Force directed that an additional 1 to 1.5 ft of soil be removed from the base of the excavation and that a second round of post-excavation samples be collected for analysis to assess whether all cleanup objectives had been achieved.

2.2 SECOND SOIL REMOVAL AND MAGNETOMER SURVEY

An additional 1 to 1.5 feet (ft) of soil was removed from the base of the drum excavation on 12 May 2004. Stained soil with a very strong odor was present in irregular patches in the central portion of the excavation at approximately 6 ft bgs as shown on Photo 3. Consequently, an additional 5 ft of soil was removed from this area. Unstained soil with a slight but distinct odor was present at the base of the central excavation at approximately 11 ft bgs. All soil was placed in the soil staging area. Final excavation extents are shown on Photo 4.

2.2.1 Post-Excavation Soil Sampling – Round 2

Soil samples PE2-1, -2, -4, and -5 were collected from 6 - 6.5 ft bgs at the locations shown on Figure 3. Soil sample PE2-3 was collected from the central excavation area at a depth of 11 – 11.5 ft bgs. All samples were analyzed for VOCs, SVOCs, PCBs, pesticides, herbicides, and TAL metals. One additional sample was collected for analysis of total organic carbon (TOC).

Trace concentrations of VOCs, SVOCs, and pesticides were detected in samples PE2-1, -2, -4, and -5. No exceedances were noted. PCBs were not detected in any of the five samples. A summary of detected compounds is presented as Table 5. The TOC content of the subsurface soil was 0%.

The total VOC concentration in sample PE2-3, located in the center of the excavation area, was 157.1 mg/kg. Individual RCO exceedances were noted for n-butylbenzene (17.2 mg/kg), p-isopropyltoluene (13.2 mg/kg), naphthalene (17.2 mg/kg), n-propylbenzene (14.3 mg/kg), 1,2,4-trimethylbenzene (36.7 mg/kg), 1,3,5-trimethylbenzene (30.2 mg/kg), and xylenes (16.17 mg/kg). Seven other VOCs were also detected. The SVOCs 2-methylnaphthalene (92.8 mg/kg) and naphthalene (26.2 mg/kg) were detected above their respective RCOs. Total pesticides were detected at a concentration of 1,378 mg/kg. Lindane (0.540 mg/kg), 4,4'-DDD (72.3 mg/kg), 4,4'-DDE (14.7 mg/kg), and 4,4'-DDT (1,290 mg/kg) were all detected at concentrations above their respective RCOs. The herbicide 2,4,5-T was reported at a concentration of 0.0274 mg/kg, well below its RCO of 1.9 mg/kg. No PCBs were detected, and there were no exceedances noted for the detected metals.

2.2.2 Magnetometer Survey

A magnetometer survey was conducted over grass-covered areas north, south, and east of the concrete pad. Numerous anomalies were detected, marked with spray paint, and investigated by hand digging. The digging uncovered barbed wire, rebar, metal strapping, chain link fence parts, a drum fragment, a railroad tie with hardware attached, buried concrete with rebar, and other metallic debris. One crushed and empty 20-gal drum was also uncovered. Examples of materials uncovered are shown on Photo 5. No stained soil or odors were noted at any of the locations. These results indicate that the areas surveyed had been used to dispose of debris. Given the depth of burial, and the well developed surface soil horizon overlying the debris, it is assumed that the debris was deposited prior to Base construction.

2.2.3 Results of Additional Soil Removal

Comparing analytical results for shallow subsurface sample PAFB-SS-ANON-001 (32,083 mg/kg) and the Round 1 post-excavation samples (22.152 mg/kg) shows that a significant decrease in total VOCs was achieved. However, the post-excavation sample results also included elevated levels of pesticides that were not detected in the shallow soil sample. The pesticides detected were most likely the result of leaking drums since one of the drums recovered still contained significant levels of pesticides.

During the second soil removal, stained soil with a very strong odor was present in the central portion of the excavation directly beneath the area where the leaking drums were discovered. Consequently, an additional 5 ft of soil was removed from this area before a post-excavation sample was collected. Analytical results for sample PE2-3, collected from the central excavation area, show increasing VOC, SVOC, and pesticide concentrations with depth below the base of the buried drums. In contrast, results for samples PE2-1, -2, -4, and -5, collected at the same horizon as the stained soil, showed only trace amounts of contaminants 10 ft to the north and south. These results suggest that as drums corroded and leaked, the primary migration pathway was vertically downward through the highly permeable soil, and that there was no significant lateral migration of contaminants. Consequently, it is expected that soil impacted by product leaking from the buried drums is primarily limited to a vertical soil column beneath the drum internment area.

Based on these results, the Air Force directed that 3 soil borings be advanced from the existing ground surface to the top of groundwater, and that soil samples be collected at 5-ft intervals for analysis of VOCs, SVOCs, and pesticides.

2.3 SOIL BORINGS

Three soil borings were advanced from ground surface to the top of groundwater at the locations shown on Figure 4 on 13 July 2004. Soil samples were collected at 5-foot intervals for analysis of VOCs, SVOCs, and pesticides. The recovered soil was gray, fine-to-medium grained sand with little to no fines, no organic matter, and a few small pebbles. No stains or odors were noted in any of the samples recovered from soil boring SB-1 to the west or SB-2 to the east. Samples recovered from soil boring SB-3 in the center of the excavation area exhibited a slight odor with no staining noted. Groundwater was encountered at a depth of approximately 26–27 ft bgs.

A total of 14 soil samples were collected for analysis. Five samples were collected from soil boring SB-1 and SB-2, three from SB-3, and one duplicate of field sample SB-03D. The only exceedance for a single compound was for 4,4'-DDT at 15.9 mg/kg in sample SB-03E collected from a depth of 25-27 ft bgs. The RCO for this compound is 2.1 mg/kg. The total pesticide concentration for this sample is 17.0 mg/kg, in exceedance of its RCO of <10 mg/kg. Sample depths and analytical results for all detected compounds are presented on Table 6.

2.3.1 Soil Boring Results

No exceedances were noted for any compound, or for total compound concentrations, in borings SB-1 and SB-2. Exceedances were noted for pesticides in boring SB-3 at the top of groundwater. Based on these results, the Air Force directed that a column of soil 10 ft x 10 ft be excavated and removed from the base of the excavation down to the top of groundwater.

2.4 THIRD SOIL REMOVAL

The third soil removal action was conducted from 12 to 18 October 2004 when the top of groundwater was encountered at 32.7 ft bgs. Soil excavated from within the 10 ft x 10 ft area was staged in a bermed and lined soil staging area. Soil removed from outside this area was staged nearby and used as backfill.

While expanding the excavation area to maintain proper slopes, additional drums and drum fragments containing asphalt sealer (see Photo 6), tar-impacted soil, and debris (see Photo 7) were discovered south and southwest of the previous assessment area. The tar-impacted soil contained globules and mats of asphalt sealer, was slightly stained where it was in contact with the tar, and exhibited a strong odor. Recovered drums, drum fragments, and containers were placed in a separate bermed, lined staging area. Three of the partially intact drums containing asphalt sealer were overpacked.

Additional soil exhibiting a chemical odor was discovered to the southeast as shown on Figure 5. The odor was similar to the odor noted during the original removal action; however, no additional drums or containers were found in this area. The absence of drums, the shallow depths at which the soil was encountered, and the limited extent suggest that this was a former spill/discharge site. All of this additional soil was removed during the excavation and placed in the soil staging area. The area where the soil was encountered was eventually incorporated into the general excavation required for the soil removal. The final excavation extent is shown on Photo 8.

2.4.1 Post-Excavation Soil Sampling – Round 3

Five post-excavation soil samples and one groundwater sample were collected on 19 October 2004 for analysis of VOCs, SVOCs, pesticides, PCBs, and TAL metals. Samples PE3-1 through PE3-4 were collected from just above the top of groundwater at a depth of 32 ft bgs. Soil sample PE3-5 was collected from the center of the removal area from just below the top of groundwater at a depth of 33 ft bgs. No stains or odors were detected during sampling. The extent of the third excavation event with confirmation soil sampling locations indicated is presented on Figure 5. A summary of all detected compounds from this sampling event is presented on Table 7.

No VOCs, SVOCs, or PCBs were detected in any soil sample. The pesticides 4,4'-DDD and 4,4'-DDT were detected at concentrations well below their respective RCOs. No exceedances were noted for the 16 metals detected.

2.4.2 Post-Excavation Groundwater Sampling

Sample PE3-W was collected in the center of the excavation from below the top of groundwater at a depth of 33 ft bgs. This sample was analyzed for VOCs, SVOCs, pesticides, PCBs, and metals. Results were compared with standards presented in Ambient Water Quality Standards and Guidance Values and Groundwater Effluent Limitations, New York State Department of Environmental Conservation, Division of Water Technical and Operation Guidance Series (1.1.1), June 1988. A summary of all detected compounds from sample PE3-W is presented on Table 8.

No exceedances were noted for VOCs, SVOCs, PCBs, or metals. The pesticides 4,4'-DDD (2.07 micrograms-per-liter (ug/L)) and 4,4'-DDT (18.7 ug/L) were detected. While these reported concentrations are in excess of the respective compound-specific standards of 0.3 and 0.2 ug/L, this area is within the FT-002 Groundwater Operable Unit where groundwater remediation systems are already in place and

operating. Additionally, the existing land use and groundwater use restrictions minimize the risk posed by these pesticides.

2.5 FIRST REMOVAL ACTION RESULTS

Post-excavation sampling following the third soil removal shows that all remedial objectives for soil have been achieved. A summary table showing maximum detected concentrations for all compound exceedances for all sampling events is presented as Table 9. The results show that reductions below all respective compound-specific and total RCOs have been achieved. However, the discovery of additional drums and tar-impacted soil outside of and separate from the original assessment and excavation areas showed that the site required additional investigation and remediation.

Based on these findings, the Air Force directed that test pits and trenches be excavated to assess the extent of the newly discovered drum internment area, and to determine whether additional buried containers were present to the east and south. Assessment results and removal activities are discussed in Section 3.

3.0 SECOND REMOVAL ACTION

Test pits and trenches were excavated to assess the extent of previously discovered buried drums, and to determine if additional internment areas were present at the site.

3.1 TEST PITS AND TEST TRENCH

Thirty-one test pits of varying size and one test trench (TT-01) were excavated at the site between 29 August and 01 September 2005. Buried drums and drum fragments, some containing asphalt sealer, and other empty containers and debris were discovered during these activities. The asphalt sealer was a glossy black, highly viscous material that flowed slowly when unconfined. Debris consisted of concrete fragments, sign posts with concrete anchors, metal, steel cable, railroad ties, burnt wood, and building demolition debris (see Photos 5 and 7 for typical examples). Foundations and footings associated with previous structures at this site were also encountered (see Photo 9). Test pit and trenching locations are shown on Figure 6. Soil boring locations SB-1, -2, and -3 are included for reference with previous figures. A summary of the test pit and test trench locations, dimensions, and findings is presented on Table 10.

Drums, drum fragments, other empty containers, asphalt sealer, and stained soil were present in test pits TP-05, TP-09, and TP-11. No liquid wastes were discovered in any of the test pits or the test trench. Twelve test pits and TT-01 contained various types of debris, while 14 were clear of any foreign materials. What appear to be wall footings and basement structures were discovered in TP-23, TP-25, TP-26, and TT-01.

3.2 SECOND DRUM AND SOIL REMOVAL

As directed by the Air Force, a general excavation to approximately 6 ft bgs was conducted on 01 September 2005, around test pits TP-05, TP-09, and TP-11. Three partially intact drums and numerous drum fragments containing asphalt sealer were recovered. Impacted soil was limited to what was in contact with the tar.

The 3 partially intact drums were overpacked. Drum fragments and mats of asphalt sealer with soil adhering to them were placed in a lined staging area and covered. Some small tar fragments and all stained soil that had been in contact with tar were placed in the soil staging area. Due to the highly viscous nature of the materials removed (see Photo 10), a visual inspection was sufficient to ensure that all impacted soil was removed. The extent of the removal area is shown on Figure 5.

3.2.1 Waste Characterization Sampling

Composite asphalt sealer sample WT-01, and composite waste soil samples WS-01 and WS-02, were collected for disposal characterization. Sample WT-01 was submitted for total analysis, while soil samples WS-01 and WS-02 were submitted for full TCLP analyses. All three samples were also analyzed for diesel range organics and RCRA Characteristics. Sample WS-02 was split, and soil sample WS-03 was submitted for analysis using conventional extraction methods. Analytical results are shown on Tables 11, 12, and 13.

Diesel range organics in sample WT-01 was reported at a concentration of 5,170 mg/kg. No SVOCs, pesticides, herbicides, or PCBs were detected. The metals arsenic, barium, cadmium, chromium (45.4 mg/kg), lead (170 mg/kg), and silver (9.39 mg/kg) were also detected.

Diesel range organics for soil samples WS-01 and WS-02 were detected at reported concentrations of 2.83 and 13.9 mg/kg, respectively. No VOCs SVOCs, pesticides, herbicides, or PCBs were detected in the TCLP analyses. The metal barium was detected a concentrations of 0.212 and 0.161 mg/L. The VOCs acetone, methylene chloride, and naphthalene were detected in sample WS-03 at low concentrations. The pesticides 4,4'-DDE (0.0253 mg/kg), 4,4'-DDD (0.0917 mg/kg), and 4,4'-DDT (1.71 mg/kg) were also detected. No SVOCs or PCBs were reported.

Based on these results, both waste streams were characterized as non-DOT, non-RCRA regulated materials. Disposal is discussed in Section 4.

3.3 SECOND REMOVAL ACTION RESULTS

All drums and containers discovered during the test pitting, trenching, and removal action were recovered and staged for disposal. All tar and tar-impacted soil was excavated and placed in the soil staging area. Solid debris, consisting primarily of fence and sign posts, concrete, and metallic debris, was staged for removal. All test pits, trenches, and excavations were backfilled and graded.

3.4 COMPREHENSIVE REMOVAL ACTION RESULTS AND RECOMMENDATIONS

Soil and groundwater at this removal site had been impacted by leaking drums and containers. The contamination sources were located during subsequent site investigations and assessments. Two removal actions were conducted to remove all drums, containers, and impacted soil. All recovered materials were sent off-site for disposal.

Post-excavation sampling results show that all contaminants of concern have been eliminated or reduced below their respective compound-specific RCOs, and that all identified sources of contamination have been removed. Magnetometer surveys, test pits, trenches, and inspections did not discover any additional burial sites or impacted soil. Consequently, no further action for soil is indicated or recommended for this site.

Impacts to groundwater were assessed and found to be minimal. Additionally, this site is within the IRP Site FT-002 Groundwater Operable Unit where remedial systems are already in place and operating to recover and treat groundwater. Consequently, no further action for groundwater is indicated or recommended for this site.

4.0 DISPOSAL SUMMARY

Two separate disposal events were conducted during this removal action. Disposal documentation is presented in Appendix B.

4.1 FIRST DISPOSAL EVENT

On 30 May and 01 June 2004, 244.53 tons of Non-DOT, Non-RCRA Regulated Material (Non Hazardous Soil) was loaded out for transportation to the Seneca Meadows Landfill in Waterloo, NY for disposal. See Appendix B-1 for disposal documentation.

On 08 April 2004, one drum of Waste Flammable Liquids, Toxic, N.O.S., 3, 6.1, UN1992, II (Xylene, Methylene Chloride, Chrome) was picked up for transportation to Ross Incineration Services, Inc. in Grafton, OH for disposal, while one drum of Non-DOT, Non-RCRA Regulated Material (Inert Sludge) was picked up for transportation to the Penn Ohio facility in Ashtabula, OH for disposal. See Appendix B-2 for disposal documentation.

4.2 SECOND DISPOSAL EVENT

On 15 and 16 November 2005, 422.5 tons of Non-DOT, Non-RCRA regulated contaminated soil was loaded out and transported to the Rapp Road Waste Management Facility in Albany, NY for disposal. See Appendix B-3 for disposal documentation.

On 15 November 2005, three 85-gallon steel drums (asphalt sealer) and 3 cubic yard boxes (soil/drum fragments) of Non-RCRA, Non-DOT Regulated Material were picked up for transportation to the General Environmental Management disposal facility in Cleveland, OH. See Appendix B-4 for disposal documentation.

On 16 November 2005, 63.45 tons of soil with concrete and metallic debris were loaded out and transported to the Franklin County Landfill in Constable, NY for disposal. See Appendix B-5 for disposal documentation.

4.0 DISPOSAL SUMMARY

Two separate disposal events were conducted during this removal action. Disposal documentation is presented in Appendix B.

4.1 FIRST DISPOSAL EVENT

On 30 May and 01 June 2004, 244.53 tons of Non-DOT, Non-RCRA Regulated Material (Non Hazardous Soil) was loaded out for transportation to the Seneca Meadows Landfill in Waterloo, NY for disposal. See Appendix B-1 for disposal documentation.

On 08 April 2004, one drum of Waste Flammable Liquids, Toxic, N.O.S., 3, 6.1, UN1992, II (Xylene, Methylene Chloride, Chrome) was picked up for transportation to Ross Incineration Services, Inc. in Grafton, OH for disposal, while one drum of Non-DOT, Non-RCRA Regulated Material (Inert Sludge) was picked up for transportation to the Penn Ohio facility in Ashtabula, OH for disposal. See Appendix B-2 for disposal documentation

4.2 SECOND DISPOSAL EVENT

On 15 and 16 November 2005, 422.5 tons of Non-DOT, Non-RCRA regulated contaminated soil was loaded out and transported to the Rapp Road Waste Management Facility in Albany, NY for disposal. See Appendix B-3 for disposal documentation.

On 15 November 2005, three 85-gallon steel drums (asphalt sealer) and 3 cubic yard boxes (soil/drum fragments) of Non-RCRA, Non-DOT Regulated Material were picked up for transportation to the General Environmental Management disposal facility in Cleveland, OH. See Appendix B-4 for disposal documentation.

On 16 November 2005, 63.45 tons of soil with concrete and metallic debris were loaded out and transported to the Franklin County Landfill in Constable, NY for disposal. See Appendix B-5 for disposal documentation.

TABLES

TABLE 1
SUMMARY TABLE OF DETECTED COMPOUNDS
SOIL ASSESSMENT SAMPLING

		SAMPLE ID =>	PAFB-SS- ANON-001	Rec Soil ⁽¹⁾ Cleanup Objective
		DATE =>	07/16/03	
		MATRIX =>	Soil	
		SAMPLE DEPTH =>	0 - 6 in	
ANALYSIS	ANALYTE	UNITS		
VOCs	Ethylbenzene	mg/kg	2310	5.5
VOCs	Isopropyltoluene, p-	mg/kg	233	ns (<10)
VOCs	Methylene chloride	mg/kg	13800	0.1
VOCs	Xylenes, total	mg/kg	15740	1.2
	TOTAL VOCs	mg/kg	32083	<10
SVOCs	None detected	mg/kg	n/a	n/a
Pesticides	None detected	mg/kg	n/a	n/a
PCBs	None detected	mg/kg	n/a	n/a
Metals, TAL	Aluminum, total	mg/kg	1210	8510 (SB)
Metals, TAL	Antimony, total	mg/kg	3.58	12.6 (SB)
Metals, TAL	Arsenic, total	mg/kg	1.03	7.5
Metals, TAL	Barium, total	mg/kg	2.19	300
Metals, TAL	Beryllium, total	mg/kg	0.0996	0.74 (SB)
Metals, TAL	Cadmium, total	mg/kg	0.180	1.3 (SB)
Metals, TAL	Calcium, total	mg/kg	978	30200 (SB)
Metals, TAL	Chromium, total	mg/kg	1180	19.5 (SB)
Metals, TAL	Cobalt, total	mg/kg	u	30
Metals, TAL	Copper, total	mg/kg	2.76	44.1 (SB)
Metals, TAL	Iron, total	mg/kg	47900	36700 (SB)
Metals, TAL	Lead, total	mg/kg	5.06	79.4 (SB)
Metals, TAL	Magnesium, total	mg/kg	428	3340 (SB)
Metals, TAL	Manganese, total	mg/kg	157	474 (SB)
Metals, TAL	Nickel, total	mg/kg	3.48	13
Metals, TAL	Potassium, total	mg/kg	77.6	929 (SB)
Metals, TAL	Selenium, total	mg/kg	5.16	2
Metals, TAL	Silver, total	mg/kg	2.02	u (SB)
Metals, TAL	Sodium, total	mg/kg	313	520 (SB)
Metals, TAL	Vanadium, total	mg/kg	5.07	150
Metals, TAL	Zinc, total	mg/kg	14.5	63.4 (SB)
Physical	Percent solids	%	88.4	n/a

NOTES:

- (1) TAGM #4046, Appendix A
- TAL = Target Analyte List
- u = not detected
- mg/kg = milligrams per kilogram or parts-per-million
- n/a = not applicable
- ns = not specified in TAGM #4046, Appendix A
- SB = site background

TABLE 2
SUMMARY TABLE OF DETECTED COMPOUNDS
ROUND 1

ANALYSIS	ANALYTE	SAMPLE ID => DATE => MATRIX => SAMPLE DEPTH =>		PE-1	PE-2	PE-3	PE-4	PE-5	Rec Soil ⁽¹⁾ Cleanup Objective
		UNITS	mg/kg	mg/kg	mg/kg	mg/kg	mg/kg	mg/kg	
VOCs	Acetone		0.434	8.08	0.568	0.321	0.229	0.2	
VOCs	Butylbenzene, n-		u	0.00353	1.35	u	u	ns (<10)	
VOCs	Butylbenzene, sec-		u	u	0.167	u	u	ns (<10)	
VOCs	Butylbenzene, tert-		u	u	0.0227	u	u	ns (<10)	
VOCs	Chlorobenzene		u	u	0.0151	u	u	1.7	
VOCs	Dichlorobenzene, 1,2-		u	u	0.00629	u	u	7.9	
VOCs	Dichlorobenzene, 1,4-		u	u	0.0471	u	u	8.5	
VOCs	Ethylbenzene		0.000647	0.000839	0.0913	u	u	5.5	
VOCs	Isopropylbenzene		u	u	0.0991	u	u	ns (<10)	
VOCs	Isopropyltoluene, p-		0.000552	0.00810	0.443	u	u	ns (<10)	
VOCs	Methylene chloride		0.00628	0.00253	0.00742	u	0.00168	0.1	
VOCs	Naphthalene		0.0850	u	15.5	0.000562	u	ns (<10)	
VOCs	Propylbenzene, n-		u	u	0.408	u	u	ns (<10)	
VOCs	Tetrachloroethane		u	u	u	u	u	ns (<10)	
VOCs	Trimethylbenzene, 1,2,4-		u	u	0.322	u	u	ns (<10)	
VOCs	Trimethylbenzene, 1,3,5-		0.000672	0.00152	1.97	u	u	ns (<10)	
VOCs	Xylenes, total		0.00326	0.00368	0.5667	u	u	1.2	
	TOTAL VOCs		0.5304	8.100	21.6	0.321562	0.23068	<10	
SVOCS	Dibenzofuran		u	u	0.325	u	u	0.014	
SVOCS	Fluorene		u	u	0.336	u	u	50.0	
SVOCS	Methylnaphthalene, 2-		u	0.434	15.9	u	u	36.4	
SVOCS	Naphthalene		u	0.0937	3.22	u	u	13.0	
	TOTAL SVOCS		0	0.528	19.8	0	0	<500	
Pesticides	BHC, gamma (Lindane)		0.000535	0.0014	0.00432	u	u	0.06	
Pesticides	DDD, 4,4'-		0.0978	0.243	5.58	0.00400	0.0345	2.9	
Pesticides	DDE, 4,4'-		0.0212	0.0460	2.73	0.00148	0.0381	2.1	
Pesticides	DDT, 4,4'-		1.53	3.71	2.17	0.0849	1.4	2.1	
Pesticides	Heptachlor		u	u	0.0088	u	u	0.10	
	TOTAL Pesticides		1.65	4.00	225	0.0904	1.47	<10	
Herbicides	n/a		---	---	---	---	---	n/a	
PCBs	None detected		n/a	n/a	n/a	n/a	n/a	n/a	
Metals, TAL	Aluminum, total		---	---	---	---	---	8510 (SB)	
Metals, TAL	Antimony, total		---	---	---	---	---	12.6 (SB)	
Metals, RCRA	Arsenic, total		0.812	0.732	0.834	0.844	0.671	7.5	

TABLE 2
SUMMARY TABLE OF DETECTED COMPOUNDS
ROUND 1

ANALYSIS	ANALYTE	UNITS	SAMPLE ID => DATE => MATRIX => SAMPLE DEPTH =>	PE-1 11/25/03 Soil 5 ft	PE-2 11/25/03 Soil 5 ft	PE-3 11/25/03 Soil 5 ft	PE-4 11/25/03 Soil 5 ft	PE-5 11/25/03 Soil 5 ft	Rec Soil ⁽¹⁾ Cleanup Objective
Metals, RCRA	Barium, total	mg/kg		7.14	5.03	6.55	6.75	6.14	300
Metals, TAL	Beryllium, total	mg/kg							0.74 (SB)
Metals, RCRA	Cadmium, total	mg/kg		0.0951	0.0673	0.0829	0.0778	0.0892	1.3 (SB)
Metals, TAL	Calcium, total	mg/kg							30200 (SB)
Metals, RCRA	Chromium, total	mg/kg		3.19	6.68	2.10	2.07	2.51	19.5 (SB)
Metals, TAL	Cobalt, total	mg/kg							30
Metals, TAL	Copper, total	mg/kg							44.1 (SB)
Metals, TAL	Iron, total	mg/kg							36700 (SB)
Metals, RCRA	Lead, total	mg/kg		1.52	1.49	2.67	1.47	2.46	79.4 (SB)
Metals, TAL	Magnesium, total	mg/kg							3340 (SB)
Metals, TAL	Manganese, total	mg/kg							474 (SB)
Metals, TAL	Nickel, total	mg/kg							13
Metals, TAL	Potassium, total	mg/kg							929 (SB)
Metals, RCRA	Selenium, total	mg/kg		U	U	U	U	0.108	2
Metals, RCRA	Silver, total	mg/kg		U	U	U	U	U	U (SB)
Metals, TAL	Sodium, total	mg/kg							520 (SB)
Metals, TAL	Vanadium, total	mg/kg							150
Metals, TAL	Zinc, total	mg/kg							63.4 (SB)
Physical	Corrosivity pH	%		7.57	6.29	8.21	7.31	8.25	n/a
Physical	Percent solids	%		96.6	95.9	95.6	93.5	96.0	n/a

NOTES:

(1) TAGM #4046, Appendix A

RCRA = Resource Conservation and Recovery Act

U = not detected

r = result rejected due to quality control deficiencies

mg/kg = milligrams per kilogram or parts-per-million

n/a = not applicable

ns = not specified in TAGM #4046, Appendix A

SB = site background

--- = sample not analyzed for this analyte

TABLE 3
WASTE CHARACTERIZATION RESULTS
DRUM SAMPLING EVENT 1

Analysis	Sample ID or Sampling Event => Date => Matrix => Sample Depth =>		DC 11/25/03 contents drum 2 n/a	DR-1 11/25/03 contents drum 1 n/a
	Analyte	Units		
VOC	Acetone	mg/kg	1140	u
VOC	Carbon tetrachloride	mg/kg	698	u
VOC	1-Chlorohexane	mg/kg	191	u
VOC	Ethylbenzene	mg/kg	3990	u
VOC	Hexachlorobutadiene	mg/kg	1450	u
VOC	Isopropylbenzene	mg/kg	68.9	u
VOC	p-isopropyltoluene	mg/kg	525	u
VOC	Methylene chloride	mg/kg	55800	u
VOC	Napthalene	mg/kg	1170	u
VOC	n-Propylbenzene	mg/kg	0.0182	u
VOC	Toluene	mg/kg	64.6	u
VOC	Trichloroethene	mg/kg	0.00309	u
VOC	1,2,4-Trimethylbenzene	mg/kg	75.1	u
VOC	o-Xylene	mg/kg	6630	u
VOC	m-,p-Xylene	mg/kg	21500	u
SVOC	2-Methylnapthalene	mg/kg	298	0.362
SVOC	Napthalene	mg/kg	115	0.0928
Pesticide	beta-BHC	mg/kg	0.0262	u
Pesticide	gamma-BHC (Lindane)	mg/kg	0.126	u
Pesticide	4,4'-DDE	mg/kg	8.73	2.95
Pesticide	4,4'-DDD	mg/kg	32.6	0.0186
Pesticide	4,4'-DDT	mg/kg	749	0.13
Pesticide	Endosulfan sulfate	mg/kg	u	0.00188
PCBs	none detected	mg/kg	u	u
Metal	Arsenic	mg/kg	1.03	1.09
Metal	Barium	mg/kg	4.35	6.69
Metal	Cadmium	mg/kg	0.155	0.116
Metal	Chromium	mg/kg	904	2.92
Metal	Lead	mg/kg	10.5	6.83
Metal	Mercury	mg/kg	u	0.0218
Metal	Selenium	mg/kg	0.173	u
9045C	Percent solids	%	82.1	90.8
D2216-90	pH	SU	not reported	12.8

NOTES:

u = not detected

mg/kg = milligrams per kilogram or parts-per-million

TABLE 4
WASTE CHARACTERIZATION RESULTS
SOIL PILE SAMPLING EVENT 1

Analysis	Sample ID or Sampling Event =>		SP1	SP2
	Date =>		11/25/03	11/25/03
		Matrix =>	soil	soil
		Sample Depth =>	n/a	n/a
	Analyte	Units		
VOC	Acetone	mg/kg	14.2	1.6
VOC	n-Butylbenzene	mg/kg	0.0744	8.86
VOC	sec-Butylbenzene	mg/kg	0.0115	1.42
VOC	Ethylbenzene	mg/kg	0.094	7.05
VOC	1,4-Dichlorobenzene	mg/kg	u	0.0799
VOC	Isopropylbenzene	mg/kg	0.0221	1.27
VOC	p-Isopropyltoluene	mg/kg	0.394	5.97
VOC	Methylene Chloride	mg/kg	0.00675	0.112
VOC	Napthalene	mg/kg	0.125	199
VOC	n-Propylbenzene	mg/kg	0.0182	3.57
VOC	Toluene	mg/kg	u	0.286
VOC	Trichloroethene	mg/kg	0.00309	n/d
VOC	1,3,5-Trimethylbenzene	mg/kg	0.107	14.6
VOC	o-Xylene	mg/kg	0.684	19.7
VOC	m-,p-Xylene	mg/kg	0.00426	n/d
SVOC	Dibenzofuran	mg/kg	u	4.61
SVOC	2-Methylnapthalene	mg/kg	0.618	408
SVOC	Napthalene	mg/kg	0.0873	u
SVOC	Phenanthrene	mg/kg	u	0.598
Pesticide	Lindane	mg/kg	u	0.211
Pesticide	Heptachlor	mg/kg	u	0.00545
Pesticide	4,4'-DDE	mg/kg	0.378	5.39
Pesticide	4,4'-DDD	mg/kg	1.68	34.4
Pesticide	4,4'-DDT	mg/kg	29.7	508
PCBs	none detected	mg/kg	u	u
Metal	Arsenic	mg/kg	1.01	0.825
Metal	Barium	mg/kg	6.72	3.96
Metal	Cadmium	mg/kg	0.0799	0.0726
Metal	Chromium	mg/kg	6.77	4.91
Metal	Lead	mg/kg	2.62	1.47
9045C	Percent solids	%	95.7	95.4
D2216-90	pH	SU	7.08	not reported

NOTES:

u = not detected

mg/kg = milligrams per kilogram or parts-per-million

TABLE 5
SUMMARY TABLE OF DETECTED COMPOUNDS
ROUND 2

ANALYSIS	ANALYTE	UNITS	SAMPLE ID =>		PE2-1 05/12/04 Soil 6 - 6.5 ft	PE2-2 05/12/04 Soil 6 - 6.5 ft	PE2-3 05/12/04 Soil 11 - 11.5 ft	PE2-4 05/12/04 Soil 6 - 6.5 ft	PE2-5 05/12/04 Soil 6 - 6.5 ft	TOC-1 05/12/04 Soil 5 ft	Rec Soil ⁽¹⁾ Cleanup Objective
			DATE =>	MATRIX =>							
VOCs	Acetone	mg/kg		r		0.0715		u			0.2
VOCs	Butylbenzene, n-	mg/kg		u		17.2		u			ns (<10)
VOCs	Butylbenzene, sec-	mg/kg		u		6.35		u			ns (<10)
VOCs	Butylbenzene, tert-	mg/kg		u		0.902		u			ns (<10)
VOCs	Chlorobenzene	mg/kg		u				u			1.7
VOCs	Dichlorobenzene, 1,2-	mg/kg		u				u			7.9
VOCs	Dichlorobenzene, 1,4-	mg/kg		u		0.328		u			8.5
VOCs	Ethylbenzene	mg/kg		u		2.13		u			5.5
VOCs	Isopropylbenzene	mg/kg		u		2.39		u			ns (<10)
VOCs	Isopropyltoluene, p-	mg/kg		u		13.2		u			ns (<10)
VOCs	Methylene chloride	mg/kg		u				u			0.1
VOCs	Naphthalene	mg/kg		u		17.2		0.000533			ns (<10)
VOCs	Propylbenzene, n-	mg/kg		u		14.3		u			ns (<10)
VOCs	Tetrachloroethane	mg/kg		u		0.00566		u			ns (<10)
VOCs	Trimethylbenzene, 1,2,4-	mg/kg		u		36.7		u			ns (<10)
VOCs	Trimethylbenzene, 1,3,5-	mg/kg		u		30.2		u			ns (<10)
VOCs	Xylenes, total	mg/kg		u		16.17		u			1.2
	TOTAL VOCs	mg/kg		0		157.1		0.000533			<10
SVOCs	Dibenzofuran	mg/kg		u				u			0.014
SVOCs	Fluorene	mg/kg		u				u			50.0
SVOCs	Methylnaphthalene, 2-	mg/kg		u		92.8		0.225			36.4
SVOCs	Naphthalene	mg/kg		u		26.2		u			13.0
	TOTAL SVOCs	mg/kg		0		119.0		0.225			<500
Pesticides	BHC, gamma (Lindane)	mg/kg		u		0.540		u			0.06
Pesticides	DDD, 4,4'-	mg/kg		0.0254		0.00211		0.00282			2.9
Pesticides	DDE, 4,4'-	mg/kg		0.00765		0.000990		0.00486			2.1
Pesticides	DDT, 4,4'-	mg/kg		0.440		0.0429		0.0494			2.1
Pesticides	Heptachlor	mg/kg		u				u			0.10
	TOTAL Pesticides	mg/kg		0.473		0.0460		0.0571			<10
Herbicides	2,4,5-T	mg/kg		u		0.0274		u			1.9
PCBs	None detected	mg/kg		n/a		n/a		n/a			n/a
TOC	Total Organic Carbon	%								0	n/a
Metals, TAL	Aluminum, total	mg/kg		1170		1460		1960			8510 (SB)
Metals, TAL	Antimony, total	mg/kg		0.553		0.778		0.786			12.6 (SB)

TABLE 5
SUMMARY TABLE OF DETECTED COMPOUNDS
ROUND 2

ANALYSIS	ANALYTE	UNITS	SAMPLE ID =>	PE2-1	PE2-2	PE2-3	PE2-4	PE2-5	TOC-1	Rec Soil
			DATE =>	05/12/04	05/12/04	05/12/04	05/12/04	05/12/04	05/12/04	Cleanup
			MATRIX =>	Soil	Soil	Soil	Soil	Soil	Soil	Objective
			SAMPLE DEPTH =>	6 - 6.5 ft	6 - 6.5 ft	11 - 11.5 ft	6 - 6.5 ft	6 - 6.5 ft	5 ft	
Metals, TAL	Arsenic, total	mg/kg		0.577	0.458	0.645	0.792	0.814	---	7.5
Metals, TAL	Barium, total	mg/kg		3.22	3.03	3.52	6.89	6.68	---	300
Metals, TAL	Beryllium, total	mg/kg		0.0934	0.105	0.112	0.131	0.180	---	0.74 (SB)
Metals, TAL	Cadmium, total	mg/kg		0.0328	0.0398	0.0329	0.0424	0.0442	---	1.3 (SB)
Metals, TAL	Calcium, total	mg/kg		573	382	475	641	811	---	30200 (SB)
Metals, TAL	Chromium, total	mg/kg		1.72	1.44	2.08	2.04	3.52	---	19.5 (SB)
Metals, TAL	Cobalt, total	mg/kg		0.916	0.813	0.825	1.01	0.844	---	30
Metals, TAL	Copper, total	mg/kg		1.23	1.23	1.11	1.6	1.67	---	44.1 (SB)
Metals, TAL	Iron, total	mg/kg		3250	2960	3820	4690	5810	---	36700 (SB)
Metals, TAL	Lead, total	mg/kg		0.831	0.725	0.765	1.57	1.21	---	79.4 (SB)
Metals, TAL	Magnesium, total	mg/kg		521	614	759	836	1300	---	3340 (SB)
Metals, TAL	Manganese, total	mg/kg		55.1	35.5	53.3	82.1	49.2	---	474 (SB)
Metals, TAL	Nickel, total	mg/kg		2.21	2.33	3.54	3.15	3.62	---	13
Metals, TAL	Potassium, total	mg/kg		150	180	236	239	356	---	929 (SB)
Metals, TAL	Selenium, total	mg/kg		u	u	u	u	u	---	2
Metals, TAL	Silver, total	mg/kg		u	u	u	u	u	---	u (SB)
Metals, TAL	Sodium, total	mg/kg		17.4	14.2	15.4	21.6	21.6	---	520 (SB)
Metals, TAL	Vanadium, total	mg/kg		3.32	2.52	3.60	5.33	5.97	---	150
Metals, TAL	Zinc, total	mg/kg		4.72	5.22	5.55	7.14	7.04	---	63.4 (SB)
Physical	Percent solids	%		96.9	97.6	96.4	97.4	96.8	97.0	n/a

NOTES:

(1) TAGM #4046, Appendix A

TAL = Target Analyte List

u = not detected

r = result rejected due to quality control deficiencies

mg/kg = milligrams per kilogram or parts-per-million

n/a = not applicable

ns = not specified in TAGM #4046, Appendix A

SB = site background

--- = sample not analyzed for this analyte

TABLE 6
SUMMARY TABLE OF DETECTED COMPOUNDS
SOIL BORING SAMPLES

ANALYSIS	ANALYTE	UNITS	SB-01A	SB-01B	SB-01C	SB-01D	SB-01E	SB-02A	SB-02B	SB-02C	SB-02D	SB-02E	Rec Soil (1)
			07/13/04 Soil 5 - 7 ft	07/13/04 Soil 10 - 12 ft	07/13/04 Soil 15 - 17 ft	07/13/04 Soil 20 - 22 ft	07/13/04 Soil 25 - 27 ft	07/13/04 Soil 5 - 7 ft	07/13/04 Soil 10 - 12 ft	07/13/04 Soil 15 - 17 ft	07/13/04 Soil 20 - 22 ft	07/13/04 Soil 25 - 27 ft	Rec Cleanup Objective
VOCs	Acetone	mg/kg	u	u	u	u	u	u	u	u	u	u	0.2
VOCs	Butylbenzene, n-	mg/kg	u	u	u	u	u	u	u	u	u	u	ns (<10)
VOCs	Dichloroethene, cis-1,2-	mg/kg	u	u	u	u	u	u	u	0.00695	u	u	ns (<10)
VOCs	Isopropyltoluene, p-	mg/kg	u	u	u	u	u	u	u	u	u	u	ns (<10)
VOCs	Trichloroethene	mg/kg	u	u	u	u	u	u	u	0.563	u	u	0.7
VOCs	Trimethylbenzene, 1,3,5-	mg/kg	u	u	u	u	u	u	u	u	u	u	ns (<10)
	TOTAL VOCs	mg/kg	0	0	0	0	0	0	0	0	0.570	0	<10
SVOCs	Methylnaphthalene, 2-	mg/kg	u	u	u	u	u	u	u	u	u	u	36.4
	TOTAL SVOCs	mg/kg	0	0	0	0	0	0	0	0	0	0	<500
Pesticides	BHC, gamma (Lindane)	mg/kg	u	u	u	u	u	u	u	u	u	u	0.06
Pesticides	DDD, 4,4'	mg/kg	u	u	u	u	u	u	u	u	u	u	2.9
Pesticides	DDE, 4,4'	mg/kg	0.60246	u	u	u	u	u	u	u	u	u	2.1
Pesticides	DDT, 4,4'	mg/kg	0.00357	u	u	u	u	u	u	u	u	u	2.1
	TOTAL Pesticides	mg/kg	0.60603	0	0	0	0	0	0	0	0	0	<10
Physical	Percent solids	%	96.4	96.7	96.0	96.8	81.1	96.0	91.4	93.7	95.7	93.0	n/a

NOTES:
(1) TAGM #4046, Appendix A
u = not detected
mg/kg = milligrams per kilogram or parts-per-million
ns = not specified in TAGM #4046, Appendix A
n/a = not applicable

ANALYSIS	ANALYTE	UNITS	SB-03C	SB-03D	DUPE	SB-03E	Rec Soil (1)
			07/13/04 Soil 15 - 17 ft	07/13/04 Soil 20 - 22 ft	07/13/04 Soil 20 - 22 ft	07/13/04 Soil 25 - 27 ft	Rec Cleanup Objective
VOCs	Acetone	mg/kg	u	0.00405	u	0.0173	0.2
VOCs	Butylbenzene, n-	mg/kg	u	u	u	0.0241	ns (<10)
VOCs	Dichloroethene, cis-1,2-	mg/kg	u	u	u	0.00793	ns (<10)
VOCs	Isopropyltoluene, p-	mg/kg	u	u	u	0.0091	ns (<10)
VOCs	Trichloroethene	mg/kg	u	u	u	0.466	0.7
VOCs	Trimethylbenzene, 1,3,5-	mg/kg	u	u	u	0.0205	ns (<10)
	TOTAL VOCs	mg/kg	0	0.00405	0	0.545	<10
SVOCs	Methylnaphthalene, 2-	mg/kg	u	u	u	0.249	36.4
	TOTAL SVOCs	mg/kg	0	0	0	0.25	<500
Pesticides	BHC, gamma (Lindane)	mg/kg	u	u	u	0.00529	0.06
Pesticides	DDD, 4,4'	mg/kg	0.00828	0.0913	0.0681	0.913	2.9
Pesticides	DDE, 4,4'	mg/kg	0.00175	0.0220	0.0159	0.179	2.1
Pesticides	DDT, 4,4'	mg/kg	0.150	1.56	1.09	15.9	2.1
	TOTAL Pesticides	mg/kg	0.160	1.67	1.17	17.0	<10
Physical	Percent solids	%	96.6	96.4	96.1	96.2	n/a

TABLE 7
SUMMARY TABLE OF DETECTED COMPOUNDS IN SOIL
ROUND 3

Analysis	Sample ID => Date => Matrix => Sample Depth => Remarks =>	PE3-1 10/19/04 Soil 32 ft bgs north wall	PE3-2 10/19/04 Soil 32 ft bgs east wall	PE3-3 10/19/04 Soil 32 ft bgs south wall	PE3-4 10/19/04 Soil 32 ft bgs west wall	PE3-5 10/19/04 Soil 33 ft bgs bottom	PE3-6 (1) 10/19/04 Soil 32 ft bgs duplicate	Rec Soil (2) Cleanup Objective
VOC, TCL	None detected	u	u	u	u	u	u	n/a
SVOC, TCL	None detected	u	u	u	u	u	u	n/a
Pesticide	DDD, 4,4'-	u	u	u	0.00193	0.00365	u	2.9
Pesticide	DDE, 4,4'-	u	u	u	u	u	u	2.1
Pesticide	DDT, 4,4'-	0.0170	u	u	0.0348	0.0588	0.0189	2.1
TOTAL Pesticides		0.0170	0.0000	0.0000	0.0367	0.0625	0.0189	<10
PCBs	None detected	u	u	u	u	u	u	n/a
Metals, TAL	Aluminum, total	1480	1170	1320	1640	1780	1300	8510 (SB)
Metals, TAL	Arsenic, total	0.884	0.907	1.03	1.08	1.31	0.861	7.5
Metals, TAL	Barium, total	5.58	4.07	4.77	6.88	7.17	6.26	300
Metals, TAL	Calcium, total	5820	806	687	420	1600	4530	30200 (SB)
Metals, TAL	Chromium, total	2.23	2.21	2.4	1.97	2.84	2.06	19.5 (SB)
Metals, TAL	Cobalt, total	1.10	1.17	1.18	1.08	1.24	1.09	30
Metals, TAL	Copper, total	1.44	1.27	1.36	1.46	1.57	1.35	44.1 (SB)
Metals, TAL	Iron, total	4000	3620	4640	3900	4300	3710	36700 (SB)
Metals, TAL	Lead, total	1.07	0.788	0.810	0.920	0.854	0.967	79.4 (SB)
Metals, TAL	Magnesium, total	2260	695	673	775	1350	2210	3340 (SB)
Metals, TAL	Manganese, total	99.7	25.3	27.0	71.1	82.4	103	474 (SB)
Metals, TAL	Nickel, total	2.02	1.89	2.01	1.74	2.85	1.82	13
Metals, TAL	Potassium, total	251	223	236	246	363	249	929 (SB)
Metals, TAL	Selenium, total	u	u	u	u	u	u	2
Metals, TAL	Silver, total	u	u	u	u	u	u	u (SB)
Metals, TAL	Sodium, total	19.7	19.5	27.5	15.7	20.1	20.0	520 (SB)
Metals, TAL	Vanadium, total	5.78	5.14	6.42	4.88	5.95	5.31	150
Metals, TAL	Zinc, total	5.01	4.41	4.74	5.12	6.26	4.58	63.4 (SB)
Physical	Percent solids	%	97.3	97.0	96.8	82.1	97.2	n/a

NOTES:

(1) Duplicate of sample PE3-1

(2) TAGM #4046, Appendix A or as noted

SB = site background from Background Surface Soil and Groundwater Survey for the Plattsburgh Air Force Base, New York: URS Consultants, Inc., Buffalo, New York, January 1996, Final.

u = not detected

mg/kg = milligrams per kilogram or parts per million

n/a = not applicable

TABLE 8
SUMMARY TABLE OF DETECTED COMPOUNDS IN GROUNDWATER
ROUND 3

Analysis	Sample ID => PE3-W		Trip Blank 10/19/04 water n/a from lab	Standard or Guidance Value	Source of Standard or Guidance Value	
	Date => 10/19/04	Matrix => water				
	Sample Depth => 33 ft bgs	Remarks => grab sample				
	Analyte	Units				
VOC, TCL	Methylene chloride	ug/L	u	0.322	5	TOGS 1.1.1 ⁽¹⁾
VOC, TCL	Toluene	ug/L	0.331	0.359	5	TOGS 1.1.1
SVOC, TCL	None detected	ug/L	u	---	n/a	
Pesticide	Gamma-BHC (Lindane)	ug/L	0.0921	---	2.9	TOGS 1.1.1
Pesticide	DDD, 4,4'-	ug/L	2.07	---	0.3	TOGS 1.1.1
Pesticide	DDE, 4,4'-	ug/L	0.148	---	0.2	TOGS 1.1.1
Pesticide	DDT, 4,4'-	ug/L	18.7	---	0.2	TOGS 1.1.1
PCBs	None detected	ug/L	u	---	n/a	
Metals, TAL	Aluminum, total	ug/L	2430	---	29600	Site Background ⁽²⁾
Metals, TAL	Antimony, total	ug/L	0.667	---	3	TOGS 1.1.1
Metals, TAL	Arsenic, total	ug/L	1.43	---	3.6	Site Background
Metals, TAL	Barium, total	ug/L	19	---	200	Site Background
Metals, TAL	Beryllium, total	ug/L	0.0984	---	3	TOGS 1.1.1
Metals, TAL	Calcium, total	ug/L	50800	---	175000	Site Background
Metals, TAL	Cobalt, total	ug/L	2.39	---	19.8	Site Background
Metals, TAL	Iron, total	ug/L	3790	---	51600	Site Background
Metals, TAL	Lead, total	ug/L	4.06	---	26.4	Site Background
Metals, TAL	Magnesium, total	ug/L	5710	---	80600	Site Background
Metals, TAL	Manganese, total	ug/L	441	---	5470	Site Background
Metals, TAL	Potassium, total	ug/L	1980	---	40000	Site Background
Metals, TAL	Selenium, total	ug/L	0.673	---	10	TOGS 1.1.1
Metals, TAL	Sodium, total	ug/L	5950	---	77700	Site Background
Metals, TAL	Thallium, total	ug/L	0.222	---	0.5	TOGS 1.1.1
Metals, TAL	Zinc, total	ug/L	5.36	---	349	Site Background

NOTES:

(1) Ambient Water Quality Standards and Guidance Values and Groundwater Effluent Limitations: New York State Department of Environmental Conservation, Division of Water Technical and Operational Guidance Series (1.1.1), June 1988.

(2) Background Surface Soil and Groundwater Survey for the Plattsburgh Air Force Base, Plattsburgh, New York: URS Consultants, Inc., Buffalo, New York, January 1996, Final.

ug/L = micrograms per Liter or parts per billion

--- = sample not analyzed for this parameter

TABLE 9
ANALYTE EXCEEDANCES FOR ALL POST-EXCAVATION SOIL SAMPLING EVENTS

Analysis	Sample ID or Sampling Event =>		PAFB-SS-ANON-001 07/16/03 Soil 0 - 6 in bgs	Sampling Event 1 11/25/03 Soil 4.5 - 5 ft bgs	Sampling Event 2 05/12/04 Soil 11 - 11.5 ft bgs	Sampling Event 3 10/19/04 Soil 32 ft bgs	Rec Soil (1) Cleanup Objective
	Analyte	Sample Depth =>					
VOC	Acetone	Units	u	8.08	r	u	0.2
VOC	Butylbenzene, n-	mg/kg	u	1.21	17.2	u	ns (<10)
VOC	Ethylbenzene	mg/kg	2310	0.275	2.13	u	5.5
VOC	Isopropyltoluene, p-	mg/kg	233	0.575	13.2	u	ns (<10)
VOC	Methylene chloride	mg/kg	13800	0.00742	u	u	0.1
VOC	Naphthalene	mg/kg	u	5.83	17.2	u	ns (<10)
VOC	Propylbenzene, n-	mg/kg	u	0.757	14.3	u	ns (<10)
VOC	Trimethylbenzene, 1,2,4-	mg/kg	u	0.322	36.7	u	ns (<10)
VOC	Trimethylbenzene, 1,3,5-	mg/kg	u	2.33	30.2	u	ns (<10)
VOC	Xylenes, total	mg/kg	15740	1.028	16.17	u	1.2
	TOTAL VOCs	mg/kg	32083	22.152	157.1	0.0	<10
SVOC	Methylnaphthalene, 2-	mg/kg	u	15.9	92.8	u	36.4
SVOC	Naphthalene	mg/kg	u	3.22	26.2	u	13.0
Pesticide	BHC, gamma (Lindane)	mg/kg	u	0.00432	0.540	u	0.06
Pesticide	DDD, 4,4'	mg/kg	u	5.58	72.3	0.00365	2.9
Pesticide	DDE, 4,4'	mg/kg	u	2.73	14.7	u	2.1
Pesticide	DDT, 4,4'	mg/kg	u	217	1290	0.0588	2.1
	TOTAL Pesticides	mg/kg	0	225	1378	0.0625	<10
Metal	Chromium	mg/kg	1190	6.68	3.52	2.84	19.5 (SB)
Metal	Selenium, total	mg/kg	5.16	0.108	u	u	2
Metal	Silver, total	mg/kg	2.02	u	u	u	u (SB)

NOTES:

- (1) TAGM #4046, Appendix A
- SB = site background
- u = not detected
- mg/kg = milligrams per kilogram or parts-per-million
- ns = not specified in TAGM #4046, Appendix A
- r = result rejected due to quality control deficiencies

TABLE 10
TEST PIT AND TRENCH SUMMARY

TEST PIT	DATE	LOCATION		DIMENSIONS			REMARKS ⁽¹⁾
		NORTHING	EASTING	(ft)			
				L	W	D	
TP-01	08/29/05	1700062	722679	8 - 10	6	5 - 6	concrete frags
TP-02	08/29/05	1700048	722659	8 - 10	6	5 - 6	burnt wood
TP-03	08/29/05	1700049	722634	8 - 10	6	5 - 6	clear
TP-04	08/29/05	1700050	722610	8 - 10	6	5 - 6	clear
TP-05	08/29/05	1700044	722588	8 - 10	6	5 - 6	drums, debris, stained fill, no odor
TP-06	08/29/05	1700038	722571	8 - 10	6	5 - 6	fill, minor debris
TP-07	08/29/05	1700027	722558	8 - 10	6	5 - 6	debris
TP-08	08/29/05	1700055	722557	8 - 10	6	5 - 6	debris
TP-09	08/29/05	1700054	722580	8 - 10	6	5 - 6	drums, debris
TP-10	08/29/05	1700061	722606	8 - 10	6	5 - 6	clear
TP-11	08/29/05	1700029	722598	8 - 10	6	5 - 6	drums, debris
TP-12	08/29/05	1700035	722600	8 - 10	6	5 - 6	burnt wood
TP-13	08/29/05	1700074	722625	12	8	6.5	clear
TP-14	08/29/05	1700086	722611	12	8	6	debris
TP-15	08/29/05	1700065	722585	8 - 10	6	5 - 6	debris
TP-16	08/29/05	1700091	722626	15	15	10	debris
TP-17	08/30/05	1700124	722646	8 - 10	6	5 - 6	clear
TP-18	08/30/05	1700084	722661	8 - 10	6	5 - 6	clear
TP-19	08/30/05	1699976	722563	8 - 10	6	5 - 6	debris
TP-20	08/30/05	1699979	722614	25	6	5 - 6	debris
TP-21	08/30/05	1699981	722639	8 - 10	6	5 - 6	clear
TP-22	08/30/05	1699912	722614	20	10	6.5	building basement
TP-23	08/30/05	1699849	722622	8 - 10	6	5 - 6	clear
TP-24	08/30/05	1699841	722659	8 - 10	6	5 - 6	debris, leach pipe ?
TP-25	08/30/05	1699879	722704	15	8	6.5	building basement
TP-26	08/30/05	1699910	722659	20	8	6.5	building basement
TP-27	08/30/05	1699934	722722	15	6	6.5	debris
TP-28	09/01/05	1699955	722778	10	6	5	debris
TP-29	09/01/05	1699808	722752	8 - 10	6	5 - 6	clear
TP-30	09/01/05	1699903	722569	8 - 10	6	5 - 6	clear
TP-31	09/01/05	1699939	722477	8 - 10	6	5 - 6	clear
TEST TRENCH TT-01	DATE	LOCATION		DIMENSIONS			REMARKS
		NORTHING	EASTING	(ft)			
				L	W	D	
Start	08/30/05	1700040	722645	112	6	5 - 6.5	north end
End	08/30/05	1699930	722671				south end

TABLE 11
WASTE CHARACTERIZATION RESULTS
ASPHALT SEALER

Sample =>	WT-01		
Date =>	08/31/05		
Matrix =>	tar		
ANALYSIS			
Compounds	Units	Reported Conc	Q
TPH			
Diesel range organics	mg/kg	5170	
VOCs, Total			
Benzene	mg/kg	3.05	
Butylbenzene, n-	mg/kg	0.724	
Butylbenzene, sec-	mg/kg	0.264	F
Ethylbenzene	mg/kg	2.73	
Isopropylbenzene	mg/kg	0.402	F
Isopropyltoluene, p-	mg/kg	0.340	F
Methylene chloride	mg/kg	59.6	
Naphthalene	mg/kg	1.21	
Propylbenzene, n-	mg/kg	0.754	
Toluene	mg/kg	19.5	
Trimethylbenzene, 1,2,4-	mg/kg	4.08	
Trimethylbenzene, 1,3,5-	mg/kg	1.09	
Xylene, m-,p-	mg/kg	7.13	
Xylene, o-	mg/kg	2.86	
SVOCs, Total			
All compounds	mg/kg	---	U
Pest/Herb, Total ⁽¹⁾			
All compounds	mg/kg	---	U
PCBs, Total			
All compounds	mg/kg	---	U
RCRA Metals, Total			
Arsenic	mg/kg	0.641	F
Barium	mg/kg	2.64	
Cadmium	mg/kg	0.104	F
Chromium	mg/kg	45.4	
Lead	mg/kg	170	
Silver	mg/kg	9.39	
RCRA Characteristics			
Reactivity, sulfide	mg/kg	---	NA
Reactivity, cyanide	mg/kg	---	NA
Corrosivity pH	--	5.57	SU
Ignitability	° C	65	>

NOTES:

- (1) All herbicide data was R qualified as unusable due to LCS spike recovery failures
- (2) Requested TCLP analyses could not be performed
- Q Qualifier
- F Reported concentration above MDL but below RL
- U Compound not detected at a concentration at or above MDL
- > greater than
- mg/kg milligrams per kilogram
- ° C degrees Centigrade
- SU standard units

TABLE 12
WASTE CHARACTERIZATION RESULTS
SOIL PILE SAMPLING EVENT 2
TCLP ANALYSIS

Sample =>	WS-01	WS-02			
Date =>	08/31/05	08/31/05			
Matrix =>	soil	soil			
ANALYSIS	Units	Reported Conc	Q	Reported Conc	Q
Compounds					
TPH					
Diesel range organics	mg/kg	2.83	F	13.9	
VOCs, TCLP					
All compounds	ug/L	---	U	---	U
SVOCs, TCLP					
All compounds	ug/L	---	U	---	U
Pest/Herb, TCLP					
All compounds	ug/L	---	U	---	U
PCBs, TCLP					
All compounds	mg/kg	---	U	---	U
RCRA Metals, TCLP					
Barium	mg/L	0.212	F	0.161	F
RCRA Characteristics					
Reactivity, sulfide	mg/kg	---	U	---	U
Reactivity, cyanide	mg/kg	---	U	---	U
Corrosivity pH	--	7.82		8.78	SU
Ignitability	° C	65	>	65	>

NOTES:

- Q Qualifier
- F Reported concentration above MDL but below RL
- U Compound not detected at a concentration at or above MDL
- > greater than
- mg/kg milligrams per kilogram
- mg/L milligrams per liter
- ug/L micrograms per liter
- ° C degrees Centigrade
- SU standard units

TABLE 13
WASTE CHARACTERIZATION RESULTS
SOIL PILE SAMPLING EVENT 2
TOTAL ANALYSIS

Sample =>	WS-03
Date =>	08/31/05
Matrix =>	soil

ANALYSIS Compounds	Units	Reported Conc	Q
VOCs, Total			
Acetone	mg/kg	0.00568	F
Methylene chloride	mg/kg	0.00161	F
Naphthalene	mg/kg	0.000567	F
SVOCs, Total			
All compounds	mg/kg	---	U
Pest/Herb, Total			
4,4'-DDE	mg/kg	0.0253	
4,4'-DDD	mg/kg	0.0917	
4,4'-DDT	mg/kg	1.71	
PCBs, Total			
All compounds	mg/kg	---	U
RCRA Metals, Total			
Arsenic	mg/kg	0.278	F
Barium	mg/kg	5.51	F
Chromium	mg/kg	2.72	SU
Lead	mg/kg	0.963	F

NOTES:

WS-03 Sample WS-03 is a split of sample WS-02
 Q Qualifier
 F Reported concentration above MDL but below RL
 U Compound not detected at a concentration at or
 above MDL
 > greater than
 mg/kg milligrams per kilogram
 ° C degrees Centigrade
 SU standard units

FIGURES

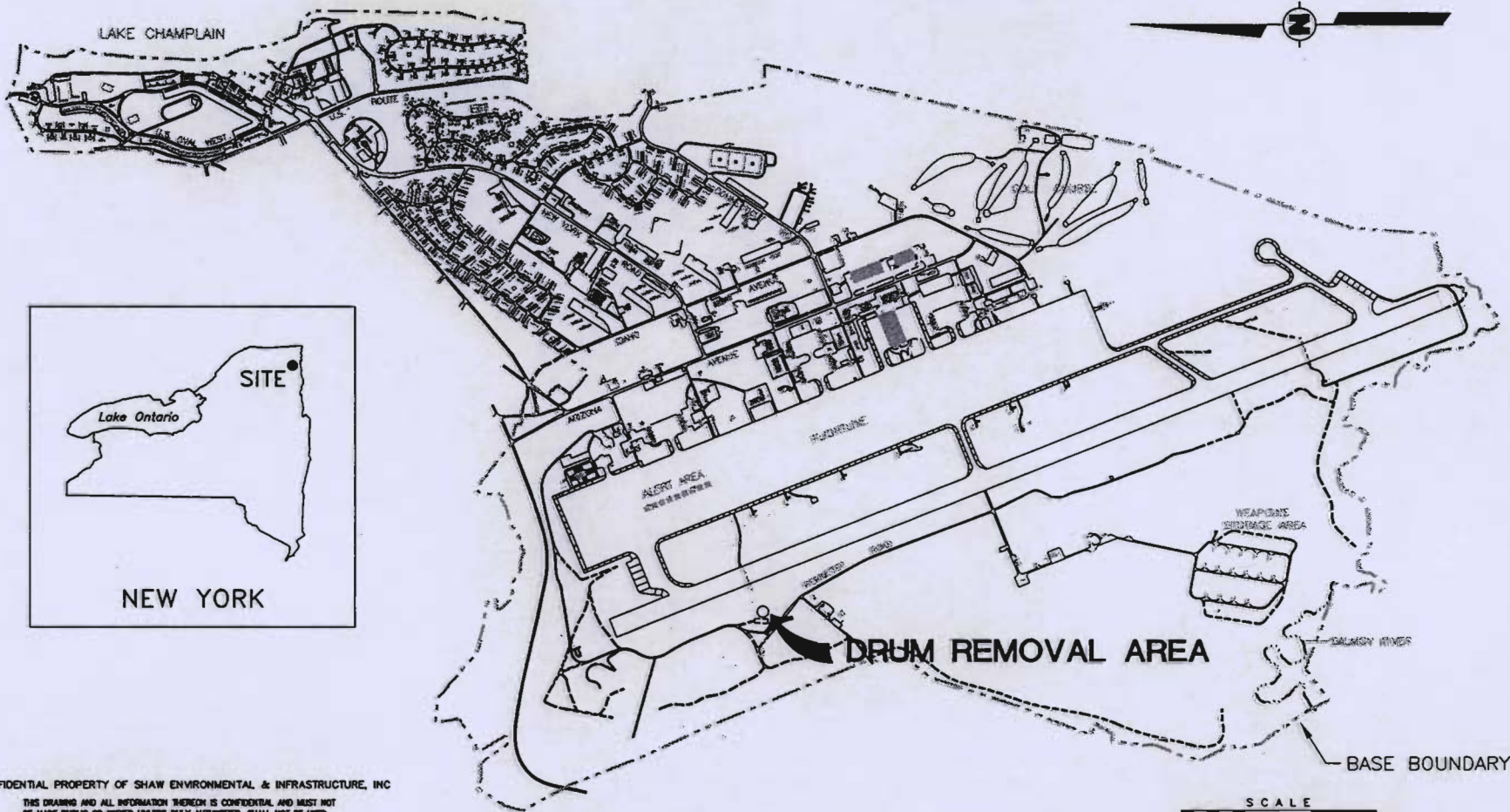

CONFIDENTIAL PROPERTY OF SHAW ENVIRONMENTAL & INFRASTRUCTURE, INC
 THIS DRAWING AND ALL INFORMATION THEREON IS CONFIDENTIAL AND MUST NOT
 BE MADE PUBLIC OR COPIED UNLESS DULY AUTHORIZED. SHALL NOT BE USED
 EXCEPT FOR THE PURPOSE FOR WHICH IT WAS SUPPLIED, AND IS SUBJECT TO
 RETURN ON DEMAND. ALL RIGHTS OF INVENTION OR DESIGN ARE RESERVED.

Legend

----- BASE BOUNDARY



Drawn By: S. McGinn	Checked By: B. Coats	Approved By:
Date: 06/07/06	Scale: AS SHOWN	Drawing No. 830319-A01

FIGURE 1
 SITE LOCATION MAP
 DRUM REMOVAL AREA
 PLATTSBURGH AIR FORCE BASE, NEW YORK
 PREPARED FOR
 AIR FORCE CENTER FOR
 ENVIRONMENTAL EXCELLENCE
 BROOKS AIR FORCE BASE, TEXAS

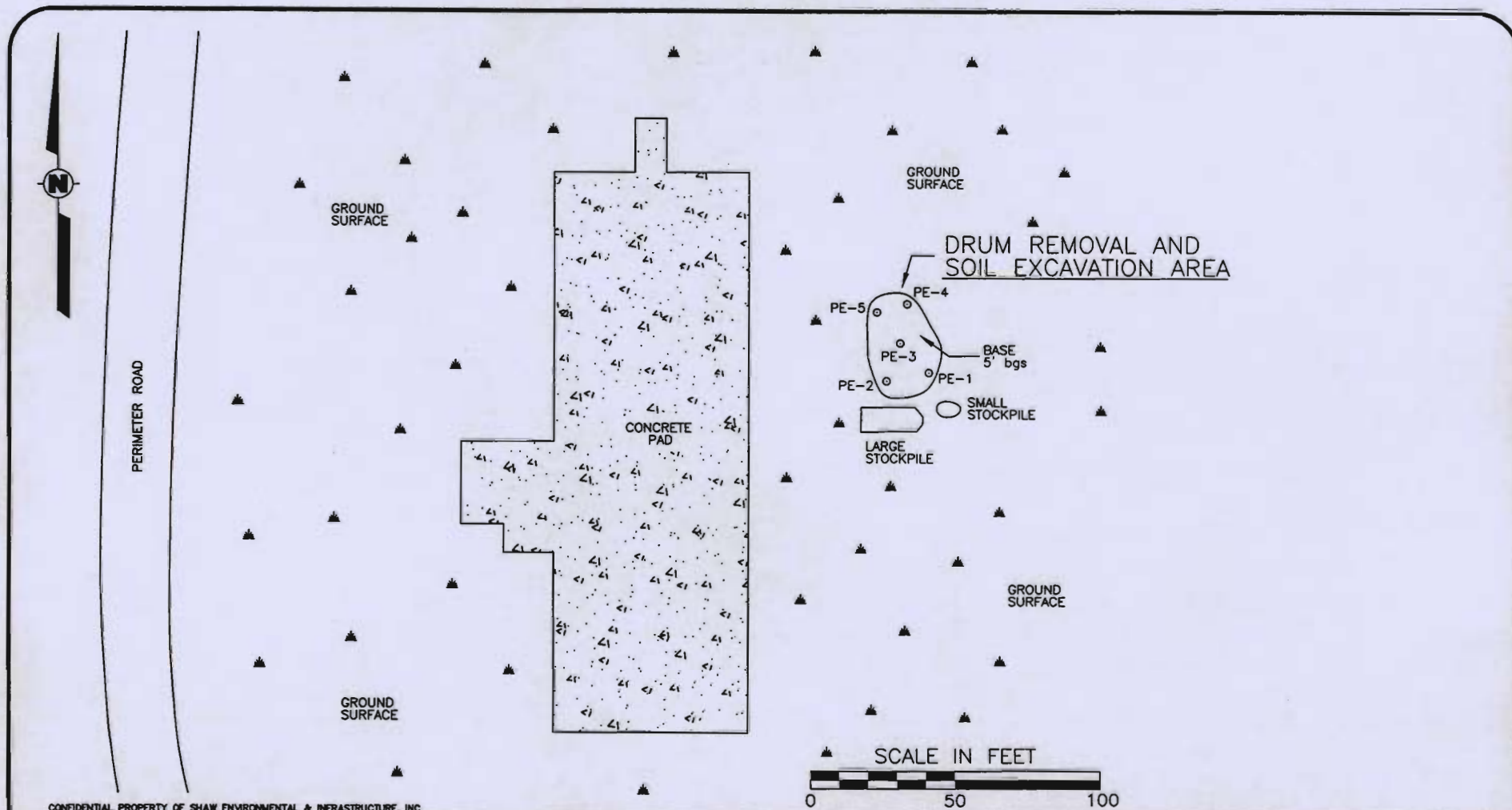

CONFIDENTIAL PROPERTY OF SHAW ENVIRONMENTAL & INFRASTRUCTURE, INC.

Legend

- SOIL SAMPLING LOCATION
- ▲ GRASS

THIS DRAWING AND ALL INFORMATION THEREON IS CONFIDENTIAL AND MUST NOT BE MADE PUBLIC OR COPIED UNLESS DULY AUTHORIZED. SHALL NOT BE USED EXCEPT FOR THE PURPOSE FOR WHICH IT WAS SUPPLIED, AND IS SUBJECT TO RETURN ON DEMAND. ALL RIGHTS OF INVENTION OR DESIGN ARE RESERVED.



Shaw
Shaw Environmental & Infrastructure Inc.

Drawn By: S. McGinn	Checked By: B. Coats	Approved By:
Date: 06/07/06	Scale: AS SHOWN	Drawing No. 1st Removal

FIGURE 2
EXCAVATION AND SAMPLING LOCATIONS
FIRST REMOVAL ACTION
DRUM REMOVAL AREA

PLATTSBURGH AIR FORCE BASE, NEW YORK
PREPARED FOR
AFCEE
BROOKS AIR FORCE BASE, TEXAS

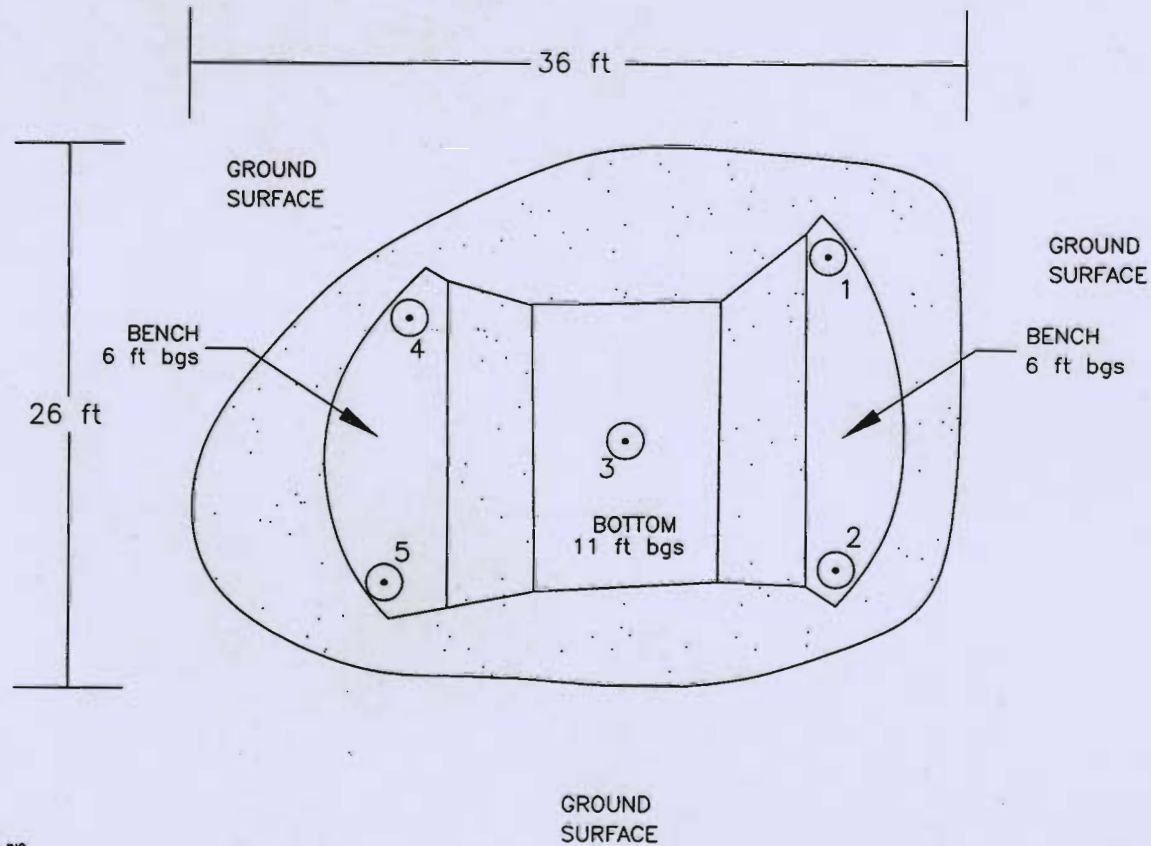
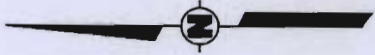

CONFIDENTIAL PROPERTY OF SHAW ENVIRONMENTAL & INFRASTRUCTURE, INC

THIS DRAWING AND ALL INFORMATION THEREON IS CONFIDENTIAL AND MUST NOT BE MADE PUBLIC OR COPIED UNLESS DULY AUTHORIZED. SHALL NOT BE USED EXCEPT FOR THE PURPOSE FOR WHICH IT WAS SUPPLIED, AND IS SUBJECT TO RETURN ON DEMAND. ALL RIGHTS OF INVENTION OR DESIGN ARE RESERVED.

Legend

- ⊙ = SAMPLE POINT
- 1 = PE2-1
- 2 = PE2-2
- 3 = PE2-3
- 4 = PE2-4
- 5 = PE2-5



Shaw Environmental & Infrastructure inc.

Drawn By: S. McGinn	Checked By: B. Coats	Approved By:
Date: 06/07/06	Scale: AS SHOWN	Drawing No. 830319-A02

FIGURE 3
POST-EXCAVATION SAMPLE POINTS
ROUND 2 - 12 MAY 2004
PLATTSBURGH AIR FORCE BASE, NEW YORK
PREPARED FOR
AIR FORCE CENTER FOR
ENVIRONMENTAL EXCELLENCE
BROOKS AIR FORCE BASE, TEXAS

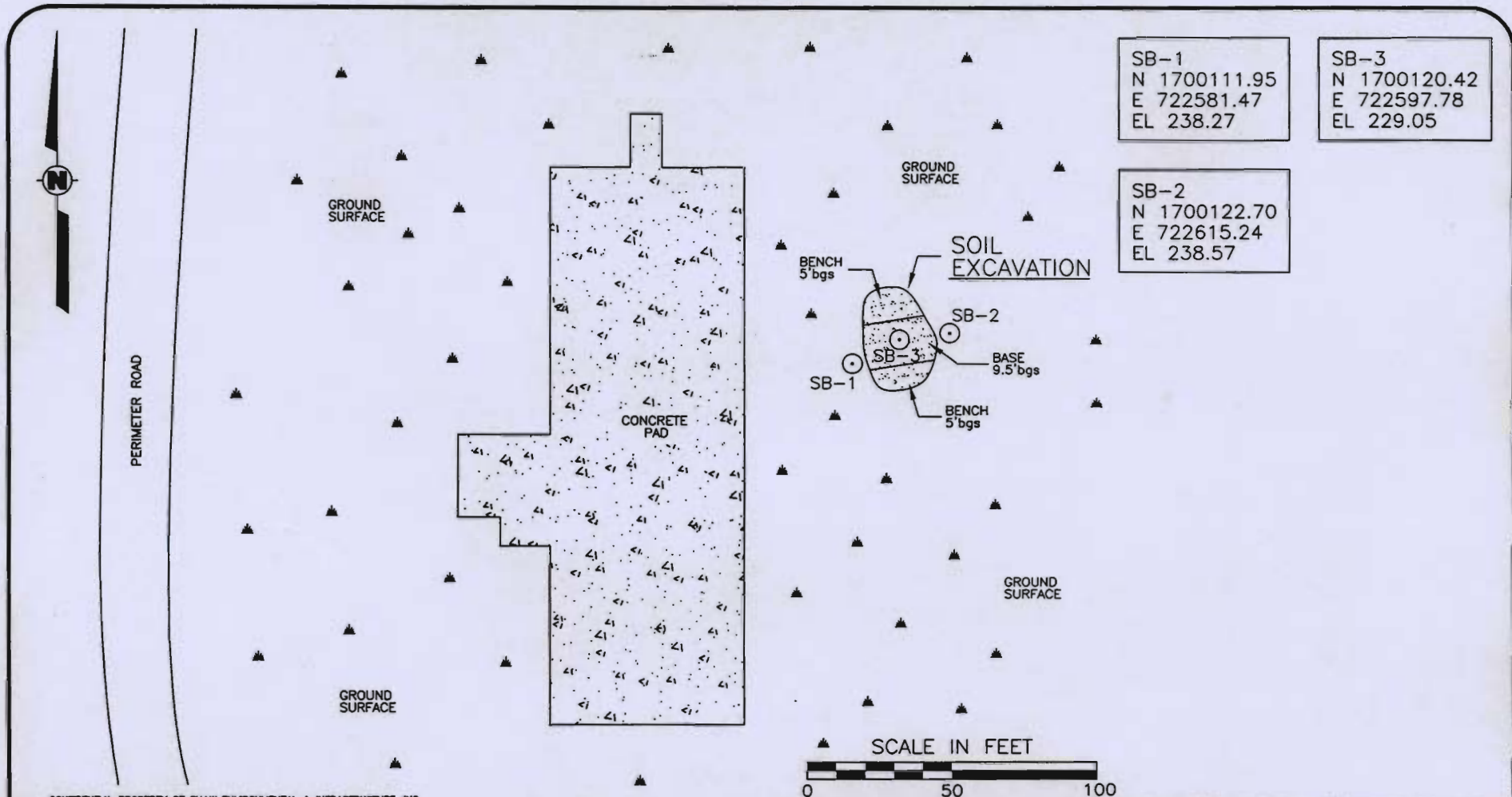

SB-1
 N 1700111.95
 E 722581.47
 EL 238.27

SB-3
 N 1700120.42
 E 722597.78
 EL 229.05

SB-2
 N 1700122.70
 E 722615.24
 EL 238.57

CONFIDENTIAL PROPERTY OF SHAW ENVIRONMENTAL & INFRASTRUCTURE, INC

Legend

○ SOIL BORING LOCATION
 ▲ GRASS

THIS DRAWING AND ALL INFORMATION THEREON IS CONFIDENTIAL AND MUST NOT BE MADE PUBLIC OR COPIED UNLESS DAILY AUTHORIZED. SHALL NOT BE USED EXCEPT FOR THE PURPOSE FOR WHICH IT WAS SUPPLIED, AND IS SUBJECT TO RETURN OR DESTRUCTION. ALL RIGHTS OF INVENTION OR DESIGN ARE RESERVED.

Shaw
 Shaw Environmental & Infrastructure Inc.

Drawn By: S. McGinn	Checked By: B. Coats	Approved By:
Date: 06/07/06	Scale: AS SHOWN	Drawing No. Boring Loc's

FIGURE 4
 SOIL BORING LOCATIONS
 13 JULY 2004
 DRUM REMOVAL AREA

PLATTSBURGH AIR FORCE BASE, NEW YORK
 PREPARED FOR
 AFCEE
 BROOKS AIR FORCE BASE, TEXAS

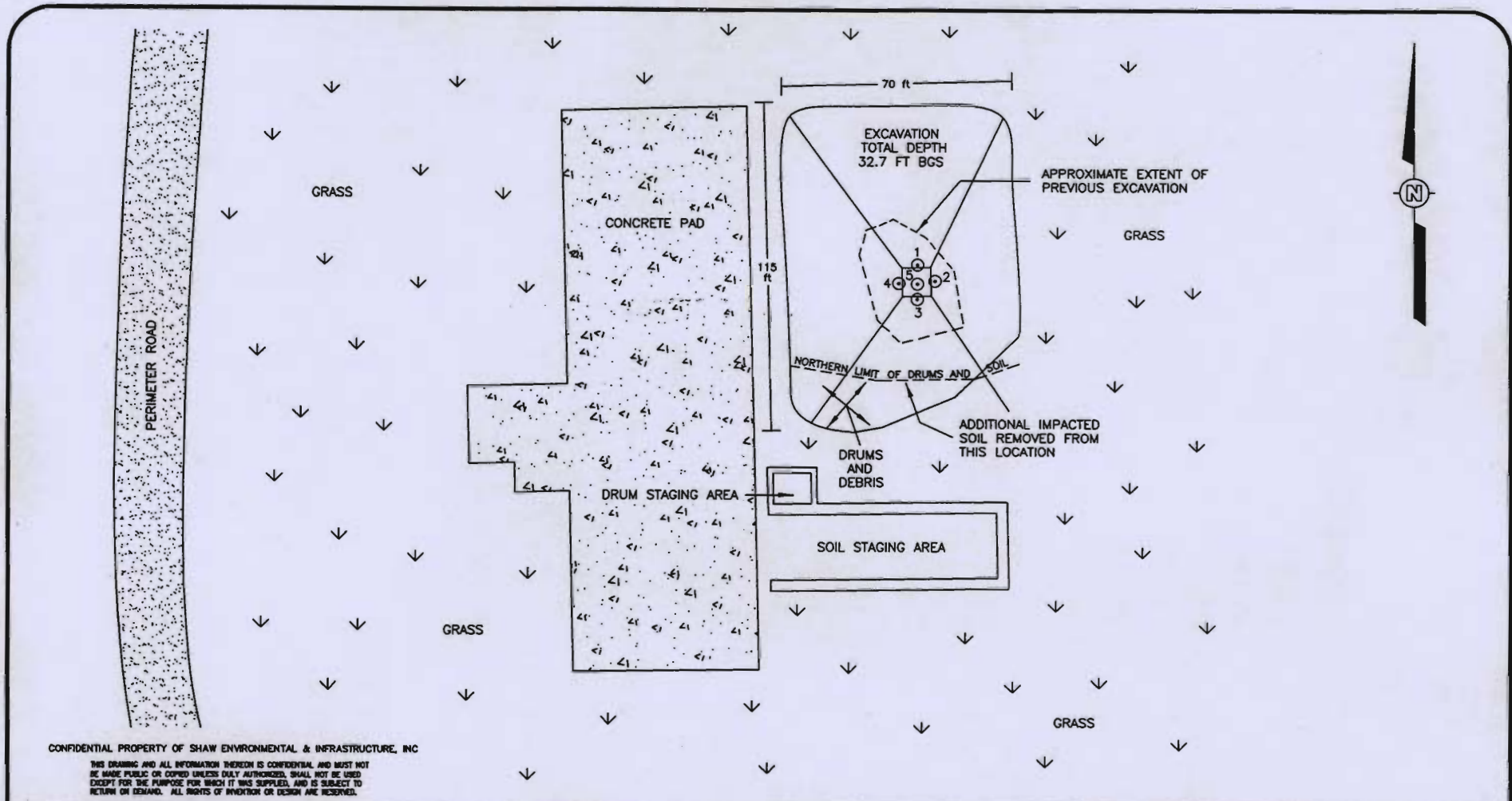

CONFIDENTIAL PROPERTY OF SHAW ENVIRONMENTAL & INFRASTRUCTURE, INC

THIS DRAWING AND ALL INFORMATION THEREON IS CONFIDENTIAL AND MUST NOT BE MADE PUBLIC OR COPIED UNLESS ORLY AUTHORIZED. SHALL NOT BE USED EXCEPT FOR THE PURPOSE FOR WHICH IT WAS SUPPLIED, AND IS SUBJECT TO RETURN ON DEMAND. ALL RIGHTS OF INVENTION OR DESIGN ARE RESERVED.

Legend

⊙2 Soil sampling location PE3-2



Shaw Environmental & Infrastructure inc.

Drawn By: S. McGINN	Checked By: B. Coats	Approved By:
Date: 06/07/06	Scale: NTS	Drawing No. NewXcv

FIGURE 5
EXCAVATION EXTENTS AND SAMPLING
LOCATIONS - ROUND 3
PLATTSBURGH AIR FORCE BASE, NY
PREPARED FOR
AFCEE
BROOKS AIR FORCE BASE, TX

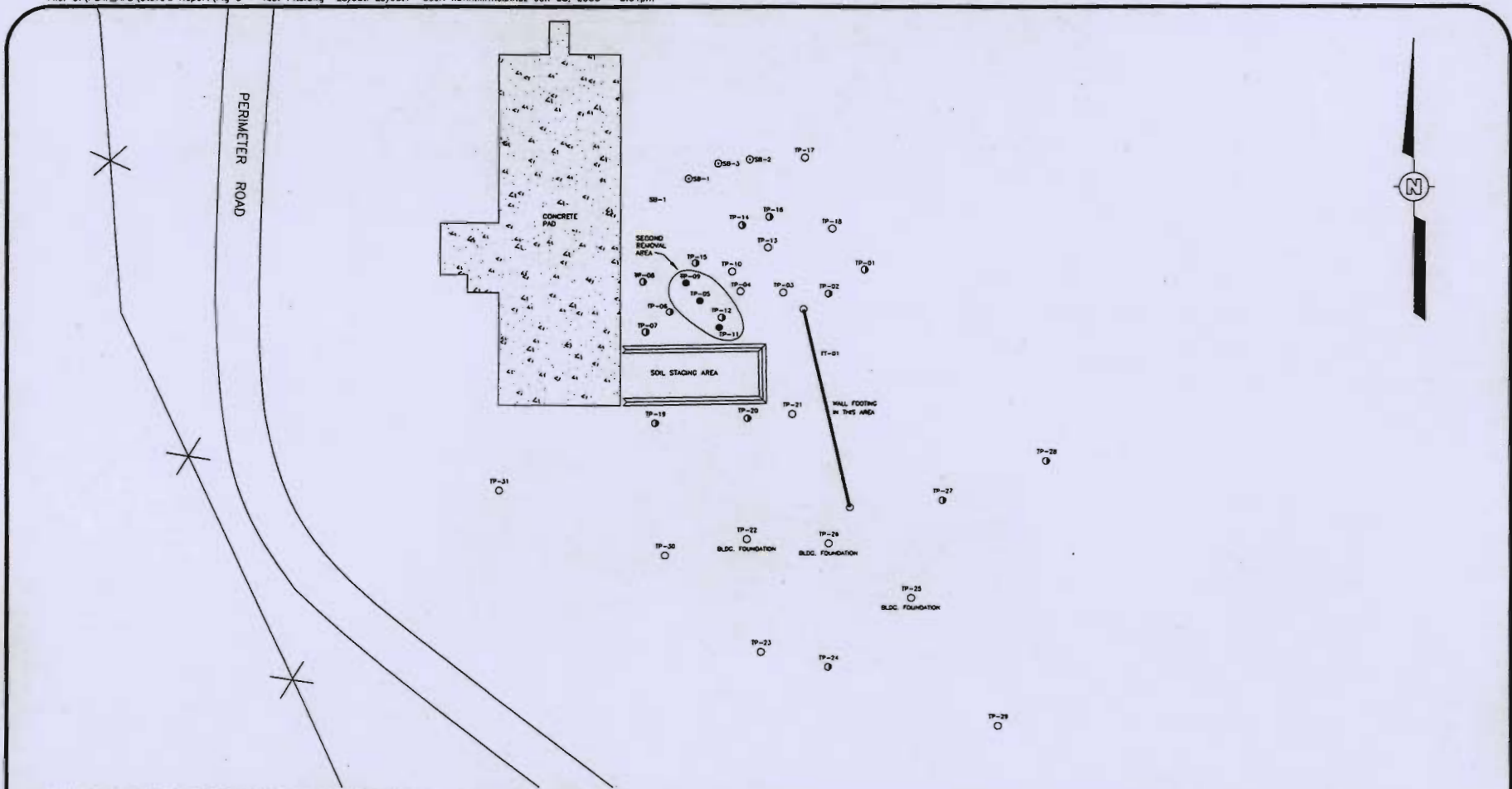

CONFIDENTIAL PROPERTY OF SHAW ENVIRONMENTAL & INFRASTRUCTURE, INC

Legend

- TEST PIT WITH DRUMS OR DRUM FRAGMENTS
- ⊙ TEST PIT WITH DEBRIS
- TEST PIT WITHOUT DEBRIS
- ⊙ SOIL BORING LOCATION



Shaw Environmental & Infrastructure, Inc.

Drawn By: S. MCGINN	Checked By: B. Coats	Approved By: P. FARRINGTON
Date: 06/07/06	Scale: NTS	Drawing No. FIG 5 - TEST PITS

FIGURE 6
EXCAVATION, TEST PIT
AND TEST TRENCH LOCATIONS
DRUM REMOVAL AREA

PLATTSBURGH AIR FORCE BASE, NY

PREPARED FOR

AFCEE
BROOKS AIR FORCE BASE, TX

APPENDIX A

PHOTO LOG



Photo 1 – Stockpiled soil and drums recovered during the initial drum and soil removal (17 NOV 2003)



Photo 2 – Extent of excavation at conclusion of initial drum and soil removal (25 NOV 2003)



Photo 3 – Stained soil at base of second soil removal excavation (12 MAY 2004).



Photo 4 – Extent of excavation at conclusion of second soil removal excavation
(12 MAY 2004).



Photo 5 – Examples of metallic debris located during magnetometer survey. Clockwise from top left: railroad tie, small crushed drum, wire, fencing (17 MAY 2004).



Photo 6 – Drums with tar/asphalt sealer recovered during third soil removal action (13 OCT 2004).



Photo 7 – Example of metallic debris recovered during third soil removal. Recovered debris included fence and sign posts with concrete, rail ties, rail, cable, and wire (13 OCT 2004).



Photo 8 – Extent of excavation at conclusion of third soil removal action. Groundwater is present at the bottom of the excavation at 32.7 ft below ground surface (20 OCT 2004).



Photo 9 – Examples of cinder blocks, cable, foundations, and footings uncovered during the test pitting and trenching (29 and 30 AUG 2005).



Photo 10 – Examples of tar mats and drum fragments recovered during the second removal action. Note the cohesive nature of the recovered tar mat with adhered soil. (01 SEP 2005).

APPENDIX B
DISPOSAL DOCUMENTATION

APPENDIX B-1
DISPOSAL EVENT 1 - SOIL

**NON-HAZARDOUS
WASTE MANIFEST**

Generator's US EPA ID No. **NY 4571924774**

Manifest Document No. **SD-003**

2. Page 1 of 1

3. Generator's Name and Mailing Address
**Air Force Real Property Agency/DA Plattsburgh
304 New York Ave., Plattsburgh, NY 12903**

Same

4. Generator's Phone (**518**) **563-2871** Attn: **Steve Gagnier** EXT. **14**

5. Transporter 1 Company Name
Mangiard Brothers Trucking, Inc.

6. US EPA ID Number
NYR000097972

A. Transporter's Phone
518 477-8840

7. Transporter 2 Company Name

8. US EPA ID Number

B. Transporter's Phone

9. Designated Facility Name and Site Address
**Saratoga Meadows Landfill
1786 Saloman Road
Waterloo, NY 13165**

10. US EPA ID Number
NOT REQUIRED

C. Facility's Phone
315 539-5624

11. Waste Shipping Name and Description

12. Containers
No. Type

13. Total
Quantity

14. Unit
Wt/Vol

a. **Non DOT, Non RCRA Regulated Material
(Non Hazardous Soil)**

0.01

DT

0.0035

T

D. Additional Descriptions for Materials Listed Above

A: App# **04-051**

E. Handling Codes for Wastes Listed Above

15. Special Handling Instructions and Additional Information

Emergency Contact: Capitol Environmental (302) 652-8899

Job#CAN-LHIC-

16. GENERATOR'S CERTIFICATION: I certify the materials described above on this manifest are not subject to federal regulations for reporting proper disposal of Hazardous Waste.

Printed/Typed Name
STEPHEN G. GAGNIER

Signature
[Signature]

Month Day Year
10 6 30 04

17. Transporter 1 Acknowledgement of Receipt of Materials

Printed/Typed Name
J W BROWN

Signature
[Signature]

Month Day Year
10 6 30 04

18. Transporter 2 Acknowledgement of Receipt of Materials

Printed/Typed Name

Signature

Month Day Year

19. Discrepancy Indication Space

20. Facility Owner or Operator: Certification of receipt of waste materials covered by this manifest except as noted in Item 19.

Printed/Typed Name

Signature
[Signature]

Month Day Year
10 6 30 04

GENERATOR

TRANSPORTER

FACILITY

ORIGINAL - RETURN TO GENERATOR

Seneca Meadows, Inc.
1786 Salzman Rd.
Waterloo, NY 13165
PH: (315) 539-5624 Fax: (315) 539-3097

Ticket: 1113946
Date: 06/30/2004
Time: 13:45:42 - 14:22:45

Customer: 15CAP / CAPITOL ENVIROMEN

Carrier: 0501 / MANGIARDI BROS TRU
Profile: 2004-051-15CAP / 15CAP-2004-05

Origin: 26 / CLINTON
Truck: MAN36
Comment:

Gross: 107320LBS
Tare: 38340LBS
Net: 68980LBS

Wastes & Services	Quantity
BCS01 / B/R-CONTAM SOIL	34.4900 Tons

Weighmaster: CARRIE 450047

Driver: *[Signature]*

**NON-HAZARDOUS
WASTE MANIFEST**

Generator's US EPA ID No. **NY 4571924774**

Manifest Document No. **9-D-002**

2. Page **1** of **1**

3. Generator's Name and Mailing Address
Air Force Real Property Agency/DA Plattsburgh
304 New York Ave., Plattsburgh, NY 12903
 4. Generator's Phone (**518**) **563-2871** Attn: **Steve Gagnier EXT. 14**

Same

5. Transporter 1 Company Name
Margard Brothers Trucking, Inc. 6. US EPA ID Number
NYR000097972

A. Transporter's Phone **518 477-8940**

7. Transporter 2 Company Name 8. US EPA ID Number

B. Transporter's Phone

9. Designated Facility Name and Site Address
Seneca Meadows Landfill
1788 Sakman Road
Watrous, NY 13165 10. US EPA ID Number
NOT REQUIRED

C. Facility's Phone
315 538-5624

11. Waste Shipping Name and Description

12. Containers
 No. Type

13. Total
 Quantity

14. Unit
 Wt/Vol

a. **Non DOT, Non RCRA Regulated Material
 (Non Hazardous Soil)**

0.01

DT

0.0031

T

D. Additional Descriptions for Materials Listed Above
A: App# 04-051

E. Handling Codes for Wastes Listed Above

15. Special Handling Instructions and Additional Information

Emergency Contact: Capitol Environmental (302) 652-8999

Job#CAN-LHC-

16. GENERATOR'S CERTIFICATION: I certify the materials described above on this manifest are not subject to federal regulations for reporting proper disposal of Hazardous Waste.

Printed/Typed Name
STEPHEN G. GAGNIER

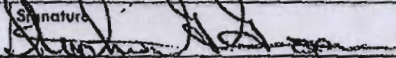
Signature

Month Day Year
10.6.30.04

17. Transporter 1 Acknowledgment of Receipt of Materials

Printed/Typed Name
Patrick E Root

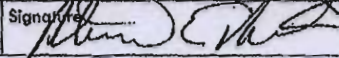
Signature

Month Day Year
10.05.04

18. Transporter 2 Acknowledgment of Receipt of Materials

Printed/Typed Name

Signature

Month Day Year

19. Discrepancy Indication Space

20. Facility Owner or Operator: Certification of receipt of waste materials covered by this manifest except as noted in Item 19.

Printed/Typed Name

Signature

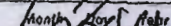
Month Day Year

GENERATOR

TRANSPORTER

FACILITY

ORIGINAL - RETURN TO GENERATOR

Seneca Meadows, Inc.
1786 Salzman Rd.
Waterloo, NY 13165
Ph: (315) 539-5624 Fax: (315) 539-3097

Ticket: 1113943
Date: 06/30/2004
Time: 13:27:11 - 14:20:03

Customer: 15CAP / CAPITOL ENVIROMEN

Carrier: 8501 / MANGIARDI BROS TRU
Profile: 2004-051-15CAP / 15CAP-2004-05

Origin: 26 / CLINTON
Truck: MAN43
Comment:

Gross: 102200LBS
Tare: 38500LBS
Net: 63700LBS

Wastes & Services	Quantity
BC801 / B/R-CONTAM SOIL	31.8500 Tons

Weighmaster: CARRIE 450047

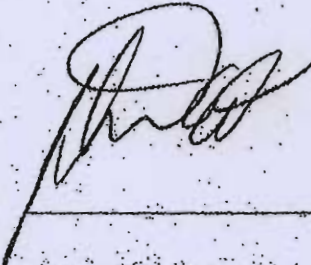
Driver: 

**NON-HAZARDOUS
WASTE MANIFEST**

1. Generator's US EPA ID No.
NY 4671924774

Manifest Document No.
S.D.003

2. Page 1 of 1

3. Generator's Name and Mailing Address

**Air Force Real Property Agency/DA Plattsburgh
304 New York Ave., Plattsburgh, NY 12903**

Same

4. Generator's Phone (518) 563-2871

Attn: Steve Gagnier EXT 14

5. Transporter 1 Company Name

Mangardi Brothers Trucking, Inc.

6. US EPA ID Number

NYR000097972

A. Transporter's Phone

518 477-8940

7. Transporter 2 Company Name

8. US EPA ID Number

B. Transporter's Phone

9. Designated Facility Name and Site Address

**Seneca Meadows Landfill
1766 Salzman Road
Waterloo, NY 13165**

10. US EPA ID Number

NOT REQUIRED

C. Facility's Phone

315 538-5624

11. Waste Shipping Name and Description

a. **Non DOT, Non RCRA Regulated Material
(Non Hazardous Soil)**

12. Containers	13. Total Quantity	14. Unit Wt/Vol
No. Type		
00.1 DT	0.0035	T
.	.	.
.	.	.
.	.	.
.	.	.

D. Additional Descriptions for Materials Listed Above

A: App# 04-051

E. Handling Codes for Wastes Listed Above

15. Special Handling Instructions and Additional Information

Emergency Contact: Capitol Environmental (302) 652-8999

Job#CAN-LHIC-

16. GENERATOR'S CERTIFICATION: I certify the materials described above on this manifest are not subject to federal regulations for reporting proper disposal of Hazardous Waste.

Printed/Typed Name

STEPHEN S. GAGNIER

Signature

Month Day Year

10/30/04

17. Transporter 1 Acknowledgment of Receipt of Materials

Printed/Typed Name

Chris Hale

Signature

Month Day Year

10/30/04

18. Transporter 2 Acknowledgment of Receipt of Materials

Printed/Typed Name

Signature

Month Day Year

19. Discrepancy Indication Space

20. Facility Owner or Operator: Certification of receipt of waste materials covered by this manifest except as noted in Item 19.

Printed/Typed Name

Signature

Month Day Year

10/30/04

GENERATOR

TRANSPORTER

FACILITY

ORIGINAL - RETURN TO GENERATOR

Seneca Meadows, Inc.
1786 Salzman Rd.
Waterloo, NY 13165
Ph: (315) 539-8624 Fax: (315) 539-3097

Ticket: 1113955
Date: 06/30/2004
Time: 14:11:22 - 14:31:30

Customer: 15CAP / CAPITOL ENVIRONMEN

Carrier: 0501 / MANGIARDI BROS TRU
Profile: 2004-031-15CAP / 15CAP-2004-05

Origin: 25 / CLINTON
Truck: MAN45
Comment:

Gross: 111950LBS
Tare: 36140LBS
Net: 75820LBS

Wastes & Services	Quantity
BGS01 / D/R-CONTAM SOIL	37.9100 Tons

Weighmaster: CARRIE 450047

Driver: Chris DeB

**NON-HAZARDOUS
WASTE MANIFEST**

Generator's US EPA ID No.
NY 4571924774

Manifest Document No.
SD 004

2. Page 1 of 1

3. Generator's Name and Mailing Address
**Air Force Real Property Agency/DA Plattsburgh
304 New York Ave., Plattsburgh, NY 12903**

4. Generator's Phone (**518**) **563-2871** Attn: **Steve Gagnier EXT. 14**

Same

5. Transporter 1 Company Name
Manglard Brothers Trucking, Inc.

6. US EPA ID Number
NYR000097972

A. Transporter's Phone
518 477-8840

7. Transporter 2 Company Name

8. US EPA ID Number

B. Transporter's Phone

9. Designated Facility Name and Site Address
**Seneca Meadows Landfill
1786 Saloman Road
Watertown, NY 13185**

10. US EPA ID Number
NOT REQUIRED

C. Facility's Phone
315 538-5624

11. Waste Shipping Name and Description

12. Containers No.	Type	13. Total Quantity	14. Unit Wt/Vol
001	DT	00.033	T
.	.	.	.
.	.	.	.
.	.	.	.

a. **Non DOT, Non RCRA Regulated Material
(Non Hazardous Soil)**

GENERATOR

D. Additional Descriptions for Materials Listed Above
A: App# 04-051

E. Handling Codes for Wastes Listed Above

15. Special Handling Instructions and Additional Information

Emergency Contact: Capitol Environmental (302) 652-8899 Job#CAN-LHIC-

16. GENERATOR'S CERTIFICATION: I certify the materials described above on this manifest are not subject to federal regulations for reporting proper disposal of Hazardous Waste.

Printed/Typed Name
STEPHEN S. GAGNIER

Signature
[Signature]

Month Day Year
06 | 30 | 04

17. Transporter 1 Acknowledgement of Receipt of Materials

Printed/Typed Name
[Signature]

Signature
[Signature]

Month Day Year
06 | 30 | 04

18. Transporter 2 Acknowledgement of Receipt of Materials

Printed/Typed Name

Signature

Month Day Year

19. Discrepancy Indication Space

20. Facility Owner or Operator: Certification of receipt of waste materials covered by this manifest except as noted in Item 19.

Printed/Typed Name

Signature
[Signature]

Month Day Year
06 | 30 | 04

TRANSPORTER

FACILITY

ORIGINAL - RETURN TO GENERATOR

Seneca Meadows, Inc.
1786 Salzman Rd.
Waterloo, NY 13165
Ph: (315) 539-5624 Fax: (315) 539-3097

Ticket: 1113953
Date: 06/30/2004
Time: 14:10:26 - 14:28:59

Customer: 15CAP / CAPITOL ENVIROMEN

Carrier: 8501 / MANGIARDI BROS TRU
Profile: 2004-051-15CAP / 15CAP-2004-05

Origin: 26 / CLINTON
Truck: MAN44
Comment:

Gross: 106260LBS
Tare: 36360LBS
Net: 69900LBS

Wastes & Services:

Quantity

BCB01 / B/R-CONTAM SOIL

34.9500 Tons

Weighmaster: CARRIE 450047

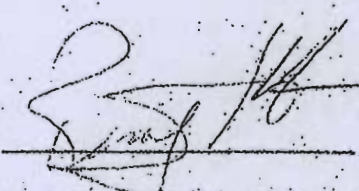
Driver: 

**NON-HAZARDOUS
WASTE MANIFEST**

1. Generator's US EPA ID No.
NY 4571924774

Manifest Document No.
SD 005

2. Page 1
of 1

3. Generator's Name and Mailing Address:
**Air Force Real Property Agency/DA Plattsburgh
304 New York Ave., Plattsburgh, NY 12903**

Same

4. Generator's Phone (**518**) **563-2871** Attn: **Steve Gagner EXT 14**

5. Transporter 1 Company Name
Mangardi Brothers Trucking, Inc.

6. US EPA ID Number
NYR000097972

A. Transporter's Phone
518 477-8840

7. Transporter 2 Company Name

8. US EPA ID Number

B. Transporter's Phone

9. Designated Facility Name and Site Address
**Seneca Meadows Landfill
1786 Salzman Road
Waterloo, NY 13165**

10. US EPA ID Number
NOT REQUIRED

C. Facility's Phone
315 539-5624

11. Waste Shipping Name and Description

12. Containers
No. Type

13. Total
Quantity

14. Unit
Wt/Vol

a. **Non DOT, Non RCRA Regulated Material
(Non Hazardous Soil)**

001

DT

00035

T

D. Additional Descriptions for Materials Listed Above

A: App# 04-051

E. Handling Codes for Wastes Listed Above

15. Special Handling Instructions and Additional Information

Emergency Contact: Capitol Environmental (302) 652-8869

Job#CAN-LHIC-

16. GENERATOR'S CERTIFICATION: I certify the materials described above on this manifest are not subject to federal regulations for reporting proper disposal of Hazardous Waste.

Printed/Typed Name
STEPHEN G. GAGNER

Signature
[Signature]

Month Day Year
10/01/04

17. Transporter 1 Acknowledgement of Receipt of Materials

Printed/Typed Name
Chris Hale

Signature
[Signature]

Month Day Year
07/01/04

18. Transporter 2 Acknowledgement of Receipt of Materials

Printed/Typed Name

Signature

Month Day Year

19. Discrepancy Indication Space

20. Facility Owner or Operator: Certification of receipt of waste materials covered by this manifest except as noted in Item 19.

Printed/Typed Name

Signature
[Signature]

Month Day Year
10/01/04

GENERATOR

TRANSPORTER

FACILITY

ORIGINAL - RETURN TO GENERATOR

Seneca Meadows, Inc.
1786 Salzman Rd.
Waterloo, NY 13165
PH: (315) 539-5624 Fax: (315) 539-3097

Ticket: 1114485
Date: 07/01/2004
Time: 13:51:46 - 14:07:59

Customer: 15CAP / CAPITOL ENVIROMEN

Carrier: 8501 / MANGIARDI BROS TRU
Profile: 2004-051-15CAP / 15CAP-2004-05

Origin: 26 / CLINTON
Truck: MAN48
Comment:

Gross: 111300LBS
Tare: 36050LBS
Net: 75240LBS

Wastes & Services

Quantity

BCSQ1 / B/R-CONTAM BOIL

37.6200 Tons

Weighmaster: CARRIE 450047

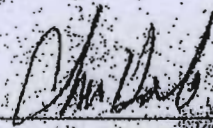
Driver: 

**NON-HAZARDOUS
WASTE MANIFEST**

1. Generator's US EPA ID No.
NY 457.1924774

Manifest Document No.
SD 006

2. Page 1
of 1

3. Generator's Name and Mailing Address

**Air Force Real Property Agency/DA Plattsburgh
304 New York Ave., Plattsburgh, NY 12903**

Same

4. Generator's Phone (518) 563-2871 Attn: Steve Gagnier EXT 14

5. Transporter 1 Company Name
Manglard Brothers Trucking, Inc.

6. US EPA ID Number
NYRQ00097972

A. Transporter's Phone
518 477-8940

7. Transporter 2 Company Name

8. US EPA ID Number

B. Transporter's Phone

9. Designated Facility Name and Site Address

**Seneca Meadows Landfill
1788 Salzman Road
Watrous, NY 13165**

10. US EPA ID Number

NOT REQUIRED

C. Facility's Phone

315 538-5624

11. Waste Shipping Name and Description

a. **Non DOT, Non RCRA Regulated Material
(Non Hazardous Soil)**

12. Containers
No. Type

13. Total
Quantity

14. Unit
Wt/Vol

001 DT 000.32 T

D. Additional Descriptions for Materials Listed Above

A: App# 04-051

E. Handling Codes for Wastes Listed Above

15. Special Handling Instructions and Additional Information

Emergency Contact: Caprol Environmental (302) 652-8999

Job#CAN-LHC-

16. GENERATOR'S CERTIFICATION: I certify the materials described above on this manifest are not subject to federal regulations for reporting proper disposal of Hazardous Waste.

Printed/Typed Name
STEPHEN G. GAGNIER

Signature
[Signature]

Month Day Year
07 01 04

17. Transporter 1 Acknowledgement of Receipt of Materials

Printed/Typed Name
J W BROWN

Signature
[Signature]

Month Day Year
07 01 04

18. Transporter 2 Acknowledgement of Receipt of Materials

Printed/Typed Name

Signature

Month Day Year

19. Discrepancy Indication Space

20. Facility Owner or Operator: Certification of receipt of waste materials covered by this manifest except as noted in item 19.

Printed/Typed Name

Signature
[Signature]

Month Day Year
07 01 04

GENERATOR

TRANSPORTER

FACILITY

ORIGINAL - RETURN TO GENERATOR

Seneca Meadows, Inc.
786 Salway Rd.
Watertown, NY 13165
Ph: (315) 539-5624 Fax: (315) 539-3097

Ticket: 1114547
Date: 07/01/2004
Time: 15:11:22 - 15:30:24

Customer: 15CAP / CAPITOL ENVIRONMEN

Carrier: 8501 / MANGIARDI BROS TRU
Prof Net: 2004-051-15CAP / 15CAP-2004-05

Origin: 26 / CLINTON
Truck: MAN35
Comment:

Gross: 103820LBS
Tare: 38020LBS
Net: 65800LBS

Wastes & Services	Quantity
B0601 / B/R-CONTAM SOIL	32.9000 Tons

Highmaster: RUS6 45001A

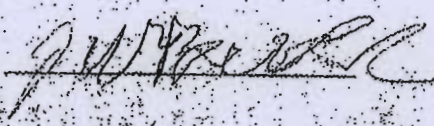
Driver: 

**NON-HAZARDOUS
WASTE MANIFEST**

1. Generator's US EPA ID No.
NY 4571924774

Manifest Document No.
SD-007

2. Page 1
of 1

3. Generator's Name and Mailing Address

**Air Force Real Property Agency/DA Plattsburgh
304 New York Ave., Plattsburgh, NY 12903**

Same

4. Generator's Phone (**518**) **563-2871** Attn: **Steve Gagnier** **EXT 14**

5. Transporter 1 Company Name
Manglard Brothers Trucking, Inc.

6. US EPA ID Number
NYR000097972

A. Transporter's Phone
518 477-8940

7. Transporter 2 Company Name

8. US EPA ID Number

B. Transporter's Phone

9. Designated Facility Name and Site Address

**Seneca Meadows Landfill
1786 Sakman Road
Watford, NY 13165**

10. US EPA ID Number

NOT REQUIRED

C. Facility's Phone

315 538-5524

11. Waste Shipping Name and Description

a. **Non DOT, Non RCRA Regulated Material
(Non Hazardous Soil)**

12. Containers
No. Type

0.01 DT 0.0033 T

b.

c.

d.

GENERATOR

REMOVING

FACILITY

D. Additional Descriptions for Materials Listed Above

A: App# 04-051

E. Handling Codes for Wastes listed Above

15. Special Handling Instructions and Additional Information

Emergency Contact: Capkol Environmental (302) 652-8899

Job#CAN-LHIC-

16. GENERATOR'S CERTIFICATION: I certify the materials described above on this manifest are not subject to federal regulations for reporting proper disposal of Hazardous Waste.

Printed/Typed Name

STEPHEN G. GAGNIER

Signature



Month Day Year

10/7/04

17. Transporter 1 Acknowledgement of Receipt of Materials

Printed/Typed Name

Kathy Mosley

Signature

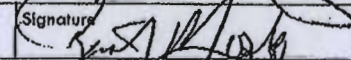

Month Day Year

07/01/04

18. Transporter 2 Acknowledgement of Receipt of Materials

Printed/Typed Name

Signature

Month Day Year

19. Discrepancy Indication Space

20. Facility Owner or Operator: Certification of receipt of waste materials covered by this manifest except as noted in Item 19.

Printed/Typed Name

Signature

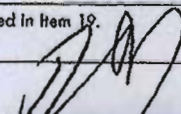

Month Day Year

11/1/04

ORIGINAL - RETURN TO GENERATOR

Seneca Meadows, Inc.
1786 Balchman Rd.
Waterloo, NY 13165
Ph: (315) 539-5624 Fax: (315) 539-3097

Ticket: 1114532
Date: 07/01/2004
Time: 15:14:20 - 15:34:51

Customer: 15CAP / CAPITOL ENVIROMEN

Carrier: 8501 / MANGIARDI BROS TRU
Profile: 2004-051-15CAP / 15CAP-2004-03
Gross: 105760LBS
Tare: 36140LBS
Net: 69620LBS

Origin: 26 / CLINTON
Truck: MAN44
Comment:

Wastes & Services	Quantity
BCS01 / B/R-CONTAM SOIL	34.8100 Tons

Waighmaster: RUSS 450014

Driver: 

APPENDIX B-2
DISPOSAL EVENT 1 - CONTAINERS

**NON-HAZARDOUS
WASTE MANIFEST**

1. Generator's US EPA ID No.
NY 4571.9.2.4.7.7.4

Manifest Document No.
40302

2. Page 1
of 1

3. Generator's Name and Mailing Address

**Air Force Real Property Agency/DA Plattsburgh
304 New York Ave., Plattsburgh, NY 12903**

Same

4. Generator's Phone (**518**) **563-2871** Attn: Steve Gagnier **EXT 14**

5. Transporter 1 Company Name

Freehold Cartage, Inc.

6. US EPA ID Number

N J D 0 5 4 1.2.6.1.8.4

A. Transporter's Phone

732 462-1001

7. Transporter 2 Company Name

8. US EPA ID Number

B. Transporter's Phone

9. Designated Facility Name and Site Address

**Penn Ohio
4813 Woodman Avenue
Ashtabula, OH 44004**

10. US EPA ID Number

O H R 0 0 0 0 2 8 8.3.7

C. Facility's Phone

440 992-7906

11. Waste Shipping Name and Description

a. **Non DOT, Non RCRA Regulated Material
(Inert Sludge)**

12. Containers
No. Type

1 DM

13. Total
Quantity

55

14. Unit
Wt/Vol

**G
unit**

D. Additional Descriptions for Materials Listed Above

A: App# 4030802

E. Handling Codes for Wastes listed Above

15. Special Handling Instructions and Additional Information

Emergency Contact: Capitol Environmental (302) 652-8999

Job#CAN-LHIC-

16. GENERATOR'S CERTIFICATION: I certify the materials described above on this manifest are not subject to federal regulations for reporting proper disposal of Hazardous Waste.

Printed/Typed Name
STEPHEN G. GAGNIER

Signature
[Signature]

Month Day Year
04 08 04

17. Transporter 1 Acknowledgement of Receipt of Materials

Printed/Typed Name
WALTER W BROOKS

Signature
[Signature]

Month Day Year
04 08 04

18. Transporter 2 Acknowledgement of Receipt of Materials

Printed/Typed Name

Signature

Month Day Year

19. Discrepancy Indication Space

20. Facility Owner or Operator: Certification of receipt of waste materials covered by this manifest except as noted in Item 19.

Printed/Typed Name

Signature

Month Day Year

ORIGINAL - RETURN TO GENERATOR

GENERATOR

TRANSPORTER

FACILITY

PRESS HARD — You Are Writing Through Eight Copies (See Reverse Side)

STATE OF NEW YORK
DEPARTMENT OF ENVIRONMENTAL CONSERVATION
DIVISION OF SOLID & HAZARDOUS MATERIALS



NYG 4047021

HAZARDOUS WASTE MANIFEST
P.O. Box 12820, Albany, New York 12212

Please type or print. Do not staple

(Hazardous Waste Manifest 1/23/03)

In case of emergency or spill immediately call the National Response Center (800) 424-8802 and the NYS Department of Environmental Conservation (518) 457-7362

UNIFORM HAZARDOUS WASTE MANIFEST		1. Generator's US EPA ID No. NY 457192477447021	Manifest Doc. No.	2. Page 1 of 1	Information within heavy bold line is not required by Federal Law.	
3. Generator's Name and Mailing Address Air Force Real Property Agency/DA-Plattsburgh 304 New York Ave., Plattsburgh, NY 12903				A. NYG 4047021		
4. Generator's Telephone Number (518 583-2871) Attn: Steve Gagnier				B. Generator's ID Same		
5. Transporter 1 (Company Name) Freehold Cartage, Inc.		6. US EPA ID Number NJD054126164		C. State Transporter's ID 1638046 ME		
7. Transporter 2 (Company Name)		8. US EPA ID Number		D. Transporter's Telephone (732 462-1001)		
9. Designated Facility Name and Site Address Ross Incineration Services, Inc. 36790 Giles Road Grafton, OH 44044		10. US EPA ID Number OH DQ48415665		E. State Transporter's ID		
				F. Transporter's Telephone ()		
				G. State Facility ID		
				H. Facility Telephone () 800 878-7677		
11. US DOT Description (Including Proper Shipping Name, Hazard Class and ID Number)		12. Containers	13. Total	14. Unit	I. Waste No.	
a. X Waste Flammable Liquids, Toxic, N.O.S., 3, 6.1, UN1992, II (Xylene, Methylene Chloride, Chroma)		001	DF	55 G	EPA	D001
b.					STATE	
c.					EPA	
d.					STATE	
J. Additional Descriptions for Materials listed Above				K. Handling Codes for Wastes Listed Above		
a. 61268 ERG 131 Also: D007				a. <input type="checkbox"/> c. <input type="checkbox"/>		
b.				b. <input type="checkbox"/> d. <input type="checkbox"/>		
15. Special Handling Instructions and Additional Information WEAR APPROPRIATE P.P.E. Emergency Contact: Capitol Environmental, (302) 652-8999 Job# CAN-LHIC-						
16. GENERATOR'S CERTIFICATION: I hereby declare that the contents of this consignment are fully and accurately described above by proper shipping name and are classified, packed, marked and labeled, and are in all respects in proper condition for transport by highway according to applicable international and national government regulations and state laws and regulations. If I am a large quantity generator, I certify that I have a program in place to reduce the volume and toxicity of waste generated to the degree I have determined to be economically practicable and that I have selected the practicable method of treatment, storage, or disposal currently available to me which minimizes the present and future threat to human health and the environment; OR if I am a small quantity generator, I have made a good faith effort to minimize my waste generation and select the best waste management method that is available to me and that I can afford.						
Printed/Typed Name STEVEN G. GAGNIER		Signature <i>Steve Gagnier</i>		Mo. Day Year 10 16 04		
17. Transporter 1 Acknowledgement of Receipt of Materials						
Printed/Typed Name WALTER BROOKS		Signature <i>Walter Brooks</i>		Mo. Day Year 10 10 04		
18. Transporter 2 Acknowledgement of Receipt of Materials						
Printed/Typed Name		Signature		Mo. Day Year		
19. Discrepancy Indication Space						
20. Facility Owner or Operator: Certification of receipt of hazardous materials covered by this manifest except as noted in Item 19.						
Printed/Typed Name		Signature		Mo. Day Year		

GENERATOR

TRANSPORTER

FACILITY

NYG 4047021

STATE OF NEW YORK
DEPARTMENT OF ENVIRONMENTAL CONSERVATION
DIVISION OF SOLID & HAZARDOUS MATERIALS



HAZARDOUS WASTE MANIFEST
P.O. Box 12820, Albany, New York 12212

Hazardous Waste Manifest 1/23/03

Type or print. Do not staple

in case of emergency or spill immediately call the National Response Center (300) 424-8802 and the NYS Department of Environmental Conservation (518) 457-7362

UNIFORM HAZARDOUS WASTE MANIFEST		1. Generator's US EPA ID No.	Manifest Doc. No.	2. Page 1 of 1	Information within heavy bold line is not required by Federal Law.	
3. Generator's Name and Mailing Address <i>NY State Dept of Environmental Conservation</i>			A. Generator's ID NYG 4047021			
4. Generator's Telephone Number <i>518 457 7362</i>		6. US EPA ID Number		C. State Transporter's ID		
5. Transporter 1 (Company Name) <i>Trinity Transport, Inc.</i>		8. US EPA ID Number		D. Transporter's Telephone () () () () () ()		
7. Transporter 2 (Company Name)		10. US EPA ID Number		E. State Transporter's ID		
9. Designated Facility Name and Site Address <i>State Dept of Environmental Conservation</i>		10. US EPA ID Number		F. Transporter's Telephone () () () () () ()		
				G. State Facility ID		
				H. Facility Telephone () () () () () ()		
11. US DOT Description (Including Proper Shipping Name, Hazard Class and ID Number)		12. Containers	13. Total	14. Unit	I. Waste No.	
a. <i>Polystyrene Styrene, Toxic, Flammable</i>		Number	Type	Quantity	Wt/Vol	EPA STATE
b.						EPA STATE
c.						EPA STATE
d.						EPA STATE
J. Additional Descriptions for Materials listed Above		K. Handling Codes for Wastes Listed Above				
a.						c.
b.						d.
15. Special Handling Instructions and Additional Information WEAR APPROPRIATE PPE						
16. GENERATOR'S CERTIFICATION: I hereby declare that the contents of this consignment are fully and accurately described above by proper shipping name and are classified, packed, marked and labeled, and are in all respects in proper condition for transport by highway according to applicable international and national government regulations and state laws and regulations. If I am a large quantity generator, I certify that I have a program in place to reduce the volume and toxicity of waste generated to the degree I have determined to be economically practicable and that I have selected the practicable method of treatment, storage, or disposal currently available to me which minimizes the present and future threat to human health and the environment; OR if I am a small quantity generator, I have made a good faith effort to minimize my waste generation and select the best waste management method that is available to me and that I can afford.						
Printed/Typed Name		Signature		Mo.	Day	Year
17. Transporter 1 Acknowledgment of Receipt of Materials		Signature		Mo.	Day	Year
18. Transporter 2 Acknowledgment of Receipt of Materials		Signature		Mo.	Day	Year
19. Discrepancy Indication Space						
20. Facility Owner or Operator: Certification of receipt of hazardous materials covered by this manifest except as noted in Item 19.						
Printed/Typed Name CHRIS WEAVER		Signature <i>Chris Weaver</i>		Mo.	Day	Year 10/4/21/04

COPY 7—Transporter Copy—Retained by Transporter



FREEHOLD CARTAGE INC.

P.O. BOX 5010 • FREEHOLD, NJ 07728-5010
(732) 462-1001 • FAX (732) 308-0924

BILL OF LADING

FCI EPA ID NO. NJD054126164

P 34493

114 Schoolground Rd.
Branford, CT 06405
Phone: (203) 483-5964
Fax: (203) 483-5984

350 Pigeon Point Road
New Castle, DE 19720
Phone: (302) 658-2005
Fax: (302) 658-6229

175 Bartow Mun. Airport
Bartow, FL 33830
Phone: (863) 533-4599
Fax: (863) 533-1613

5533 Dunham Road
Maple Heights, OH 44137
Phone: (330) 835-3473
Fax: (330) 835-3732

108 Monahan Avenue
Dunmore, PA 18512
Phone: (570) 342-7232
Fax: (570) 342-7367

40 Boulevard St.
Sumter, SC 29150
Phone: (803) 773-2611
Fax: (803) 773-2942

SHIPPER NAME/ADDRESS <i>AIR FORCE BRANCH PROJECT</i>		PHONE <i>706 4463</i>		APPOINTMENT TIME <i>4/13/04 7:15 AM</i>	
FCI REP. LOADING (PRINT) <i>W. BROOKS</i>		PROCEDURE	EQUIP. SPOTTED	EQUIP. REMOVED	TIME AT SHIPPER
COMMENTS OR DELAYS AT SHIPPER		EQUIPMENT USED RECEIVED <i>APR 13 2004</i>			

BROKER <i>W. BROOKS</i>	MANIFEST/DOCUMENT NOT A MATHEM				
----------------------------	--------------------------------	--	--	--	--

(X) HM	PROPER U.S. D.O.T. SHIPPING NAME	U.S. D.O.T. HAZARDOUS CLASS	NA/UN/NO.	PACKING GROUP	NO. CONT.	CONT. TYPE	NET QUANTITY	UNIT MEASURE	WASTE NO.	FORM
1										
2										
3										

SPECIAL HANDLING INSTRUCTIONS INCLUDING CONTAINER EXEMPTION NUMBER.

SHIPPER'S CERTIFICATION: This is to certify that the above named materials are properly classified, described, packaged, marked and labeled and are in proper condition for transportation according to the applicable regulations of the Department of Transportation, U.S. EPA and the State. The materials described above were consigned to the Transporter named. The consignee can and will accept the shipment and has a valid permit to do so if required. I certify that the foregoing is true and correct to the best of my knowledge.

Payment to the contractor for waste removal does not constitute payment to the carrier and if the contractor does not pay the carrier, the shipper is obligated to pay the agreed rate offered to the contractor.

PLEASE PRINT NAME/TITLE <i>Brooks</i>	SHIPPER'S SIGNATURE <i>Brooks</i>	DATE UNLOADED <i>APR 13 2004</i>
--	--------------------------------------	-------------------------------------

CONSIGNEE NAME/ADDRESS		PHONE		APPOINTMENT TIME	
FCI REP. UNLOADING (PRINT)		PROCEDURE	EQUIP. SPOTTED	EQUIP. REMOVED	TIME AT CONSIGNEE
COMMENTS OR DELAYS AT CONSIGNEE		EQUIPMENT USED			

PLEASE PRINT NAME/TITLE	CONSIGNEE SIGNATURE <i>X</i>	DATE UNLOADED <i>APR 13 2004</i>
-------------------------	---------------------------------	-------------------------------------

AR H-0257	MD HWH-167	MO H-1490	OH UPW-0190713-OH	TX 40705
CT CT-HW-307	2001-OPV-2335	ND WH-429	OK UPW-0190713-OH	WI 11602
DE DE-HW-203	ME ME-HWT-47	NH TNH-0047	ONTARIO, CANADA A 840943	WV UPW-0190713-OH
DE-SW-203	ME-WOT-47	NJ S-2265	PA PA-AH-0067	
IL UPW-0190713-OH	MI UPW-0190713-OH	15939	QUEBEC, CANADA QC-6ML-047	
MA MA-294	MN UPW-0190713-OH	NY NJ-113	RI RI-535	

White - FCI Original
Yellow - FCI Billing
Blue - FCI Office/Customs

P21102

APPENDIX B-3
DISPOSAL EVENT 2 - SOIL

M-43

Please print or type
Form designed for use on plain (12-pitch) typewriter.

NON-HAZARDOUS WASTE MANIFEST		1. Generator's US EPA ID No. N.Y. 4.5.7.1.9.2.4.7.7.4	Manifest Document No. 0001	2. Page 1 of 1
3. Generator's Name and Mailing Address Air Force Real Property/DA Plattsburgh 304 New York Road, Plattsburgh, NY 12903				
4. Generator's Phone (518) 363-2871				
5. Transporter 1 Company Name Mangiardi Bros. Trucking		6. US EPA ID Number N/A		A. Transporter's Phone 518-477-8940
7. Transporter 2 Company Name		8. US EPA ID Number		B. Transporter's Phone
9. Designated Facility Name and Site Address City of Albany Landfill 525 Rapp Road Albany, NY 12205		10. US EPA ID Number N/A		C. Facility's Phone 518-869-3651
11. Waste Shipping Name and Description			12. Containers	13. Total Quantity
a. Non RCRA, Non DOT Regulated Material (Petroleum Contaminated Soil)			No. Type	Unit
			0 0 1 D T	EST. X X X 3 5 T
b.				
c.				
d.				
D. Additional Descriptions for Materials Listed Above Lot # 2497			E. Handling Codes for Wastes Listed Above L	
15. Special Handling Instructions and Additional Information Emergency Contact: CMS (866) 734-2553				
16. GENERATOR'S CERTIFICATION: I certify the materials described above on this manifest are not subject to federal regulations for reporting proper disposal of Hazardous Waste.				
Printed/Typed Name STEPHEN G. Grenier		Signature <i>[Signature]</i>		Month Day Year 11/1/505
17. Transporter 1 Acknowledgement of Receipt of Materials		Printed/Typed Name J.W. Brown		Signature <i>[Signature]</i>
18. Transporter 2 Acknowledgement of Receipt of Materials		Printed/Typed Name		Signature
19. Discrepancy Indication Space				
20. Facility Owner or Operator: Certification of receipt of waste materials covered by this manifest except as noted in Item 19.				
Printed/Typed Name		Signature <i>[Signature]</i>		Month Day Year

GENERATOR

TRANSPORTER

FACILITY



DEPARTMENT OF GENERAL SERVICES
 Rapp Road Waste Management Facility
 525 Rapp Rd Albany, N.Y. 12205
 (518) 869-3651

006029 Corbett Management Serv., LLC
 4880 Duguid Road
 Manlius NY 13104

02	247218	P4 I		teia Smith		
DATE IN	DATE OUT	TIME IN	TIME OUT	VEHICLE	ROLL OFF	
11/15/05	11/15/05	11:22	11:46	7001		
REFERENCE			ORIGIN			
2497-						

Scale 1 Gross Wt.	104200	LB	Inbound - Charge ticket
Scale 2 Tare Wt.	38540	LB	
Net Weight	65660	LB	

QTY.	UNIT	DESCRIPTION	RATE	EXTENSION	FEE	TOTAL
32.83	TON	CONTAMINATED SOIL	:		0.00	

Operating hours: 7 am to 3 pm, Monday - Friday
 THIS IS TO CERTIFY THAT THIS LOAD DOES NOT CONTAIN ANY
 NON ACCEPTABLE MATERIALS AS DEFINED BY LANDFILL PERMIT
 AGREEMENT

LOT # 2497-43

SIGNATURE *[Handwritten Signature]*

NET AMOUNT
CHANGE
CHECK NO.

Please print or type.
Form designed for use on a 12-inch typewriter.

**NON-HAZARDOUS
WASTE MANIFEST**

1. Generator's US EPA ID No.
N.Y.4.5.7.1.9.2.4.7.7.4

Manifest Document No.
.0.0.2

2. Page 1
of 1

3. Generator's Name and Mailing Address

Air Force Real Property/DA Plattsburgh
304 New York Road, Plattsburgh, NY 12903

M-38

4. Generator's Phone (518) 563-2871

5. Transporter 1 Company Name

Mangiardi Bros. Trucking

6. US EPA ID Number

N/A

A. Transporter's Phone

518-477-8940

7. Transporter 2 Company Name

8. US EPA ID Number

B. Transporter's Phone

9. Designated Facility Name and Site Address

City of Albany Landfill
525 Rapp Road
Albany, NY 12205

10. US EPA ID Number

N/A

C. Facility's Phone

518-869-3651

11. Waste Shipping Name and Description

a. Non RCRA, Non DOT Regulated Material
(Petroleum Contaminated Soil)

12. Containers No.	Type	13. Total Quantity	14. Unit Wt/Vol
0.01	D.T.	EST. X.X.35	T

b.

c.

d.

D. Additional Descriptions for Materials Listed Above

Lot # 2497

E. Handling Codes for Wastes Listed Above

L

15. Special Handling Instructions and Additional Information

Emergency Contact: CNS (866) 734-2533

16. GENERATOR'S CERTIFICATION: I certify the materials described above on this manifest are not subject to federal regulations for reporting proper disposal of Hazardous Waste.

Printed/Typed Name
STEPHEN G. GAGNER

Signature
[Signature]

Month Day Year
11 15 05

17. Transporter 1 Acknowledgement of Receipt of Materials

Printed/Typed Name
MARCY HARRIS

Signature
[Signature]

Month Day Year
11 15 05

18. Transporter 2 Acknowledgement of Receipt of Materials

Printed/Typed Name

Signature

Month Day Year

19. Discrepancy Indication Space

20. Facility Owner or Operator: Certification of receipt of waste materials covered by this manifest except as noted in Item 19.

Printed/Typed Name

Signature
[Signature]

Month Day Year

GENERATOR

TRANSPORTER

FACILITY



CITY OF ALBANY
DEPARTMENT OF GENERAL SERVICES
 Rapp Road Waste Management Facility
 525 Rapp Rd • Albany, N.Y. 12205
 (518) 869-3651

006029 Corbett Management Serv., LLC
 4880 Duguid Road
 Manlius NY 13104

SITE	TICKET	GRID		WEIGHMASTER	
02	247219	P4 I		teia Smith	
DATE IN	DATE OUT	TIME IN	TIME OUT	VEHICLE	ROLL OFF
11/15/05	11/15/05	11:24	11:35	7002	
REFERENCE			ORIGIN		
2497-38					

Scale 1 Gross Wt. 104780 LB
 Scale 2 Tare Wt. 38120 LB
 Net Weight 66660 LB

Inbound - Charge ticket

QTY.	UNIT	DESCRIPTION	RATE	EXTENSION	FEE	TOTAL
33.33	TON	CONTAMINATED SOIL			0.00	

Operating hours: 7 am to 3 pm, Monday - Friday

THIS IS TO CERTIFY THAT THIS LOAD DOES NOT CONTAIN ANY
 NON ACCEPTABLE MATERIALS AS DEFINED BY LANDFILL PERMIT
 AGREEMENT

LOT # 2497-38

SIGNATURE _____

NET AMOUNT
TENDERED
CHANGE
CHECK NO.

NON-HAZARDOUS WASTE MANIFEST

1. Generator's US EPA ID No.
N.Y.4.5.7.1.9.2.4.7.7.4

Manifest Document No.
003

2. Page 1 of 1

3. Generator's Name and Mailing Address

Air Force Real Property/DA Plattsburgh
304 New York Road, Plattsburgh, NY 12903

4. Generator's Phone (518) 863-2871 X 14

M-30

5. Transporter 1 Company Name

Nangiardi Bros. Trucking

6. US EPA ID Number

N/A

A. Transporter's Phone

518-477-8940

7. Transporter 2 Company Name

8. US EPA ID Number

N/A

B. Transporter's Phone

9. Designated Facility Name and Site Address

City of Albany Landfill
525 Rapp Road
Albany, NY 12205

10. US EPA ID Number

N/A

C. Facility's Phone

518-869-3651

11. Waste Shipping Name and Description

a. Non RCRA, Non DOT Regulated Material
(Petroleum Contaminated Soil)

12. Containers No.	Type	13. Total Quantity	14. Unit Wt/Vol
0.01	D.TX	EST. X.X35	T

D. Additional Descriptions for Materials Listed Above

Lot # 2497

E. Handling Codes for Wastes Listed Above

L

15. Special Handling Instructions and Additional Information

Emergency Contact: CHS (866) 734-2553

16. GENERATOR'S CERTIFICATION: I certify the materials described above on this manifest are not subject to federal regulations for reporting proper disposal of Hazardous Waste.

Printed/Typed Name STEPHEN G. Gagnier	Signature <i>[Signature]</i>	Month Day Year 11/15/05
--	---------------------------------	----------------------------

17. Transporter 1 Acknowledgement of Receipt of Materials	Printed/Typed Name Paul Kietzman	Signature <i>[Signature]</i>	Month Day Year 11/15/05
---	-------------------------------------	---------------------------------	----------------------------

18. Transporter 2 Acknowledgement of Receipt of Materials	Printed/Typed Name	Signature	Month Day Year
---	--------------------	-----------	----------------

19. Discrepancy Indication Space

20. Facility Owner or Operator: Certification of receipt of waste materials covered by this manifest except as noted in Item 19.

Printed/Typed Name	Signature <i>[Signature]</i>	Month Day Year
--------------------	---------------------------------	----------------

GENERATOR

TRANSPORTER

FACILITY



CITY OF ALBANY
DEPARTMENT OF GENERAL SERVICES
 Rapp Road Waste Management Facility
 525 Rapp Rd • Albany, N.Y. 12205
 (518) 869-3651

006029 Corbett Management Serv., LLC
 4880 Duguid Road
 Manlius NY 13104

SITE	TICKET	GRID		WEIGHMASTER	
02	247209	P4 I		teia Smith	
DATE IN	DATE OUT	TIME IN	TIME OUT	VEHICLE	ROLL OFF
11/15/05	11/15/05	10:57	11:22	7005	
REFERENCE			ORIGIN		
2497-30					

Scale 1 Gross Wt.	104720	LB	Inbound - Charge ticket
Scale 2 Tare Wt.	38200	LB	
Net Weight	66520	LB	

QTY.	UNIT	DESCRIPTION	RATE	EXTENSION	FEE	TOTAL
33.26	TON	CONTAMINATED SOIL			0.00	

Operating hours: 7 am to 3 pm, Monday - Friday
 THIS IS TO CERTIFY THAT THIS LOAD DOES NOT CONTAIN ANY
 NON ACCEPTABLE MATERIALS AS DEFINED BY LANDFILL PERMIT
 AGREEMENT

LOT # 2497-30

SIGNATURE _____

NET AMOUNT
TENDERED
CHANGE
CHECK NO.

Please print or type
(Form designed for use on nine (12-pitch) typewriter)

**NON-HAZARDOUS
WASTE MANIFEST**

1. Generator's US EPA ID No.

N.Y.4.5.7.1.9.2.4.7.7.4

Manifest Document No.
. . . 0 . 0 . 4

2. Page 1
of 1

3. Generator's Name and Mailing Address

Air Force Real Property/DA Plattsburgh
304 New York Road, Plattsburgh, NY 12903

M-41

4. Generator's Phone

518-2871 X14

5. Transporter 1 Company Name

Maniardi Bros. Trucking

6. US EPA ID Number

N/A

A. Transporter's Phone

518-477-8940

7. Transporter 2 Company Name

8. US EPA ID Number

N/A

B. Transporter's Phone

9. Designated Facility Name and Site Address

City of Albany Landfill
525 Rapp Road
Albany, NY 12205

10. US EPA ID Number

N/A

C. Facility's Phone

518-869-3651

11. Waste Shipping Name and Description

a. Non RCRA, Non DOT Regulated Material
(Petroleum Contaminated Soil)

12. Containers No.	Type	13. Total Quantity	14. Unit Wt/Vol
0.01	D.T	EST XXX3.5	T

b.

c.

d.

D. Additional Descriptions for Materials Listed Above

Lot # 2497

E. Handling Codes for Wastes Listed Above

L

15. Special Handling Instructions and Additional Information

Emergency Contact: CNS (866) 734-2553

16. GENERATOR'S CERTIFICATION: I certify the materials described above on this manifest are not subject to federal regulations for reporting proper disposal of Hazardous Waste.

Printed/Typed Name

STEPHEN G. GAGLIARDI

Signature

[Signature]

Month Day Year

11/15/05

17. Transporter 1 Acknowledgement of Receipt of Materials

Printed/Typed Name

RON PENNETTI

Signature

[Signature]

Month Day Year

10/15/05

18. Transporter 2 Acknowledgement of Receipt of Materials

Printed/Typed Name

Wayne Dancy

Signature

[Signature]

Month Day Year

11/15/05

19. Discrepancy Indication Space

003

20. Facility Owner or Operator: Certification of receipt of waste materials covered by this manifest except as noted in Item 19.

Printed/Typed Name

Signature

[Signature]

Month Day Year

.

GENERATOR

TRANSPORTER

FACILITY



CITY OF ALBANY
DEPARTMENT OF GENERAL SERVICES
Rapp Road Waste Management Facility
525 Rapp Rd • Albany, N.Y. 12205
(518) 869-3651

006029 Corbett Management Serv., LLC
4880 Duguid Road
Manlius NY 13104

SITE	TICKET	GRID		WEIGHMASTER	
02	247208	P4 I		teia Smith	
DATE IN	DATE OUT	TIME IN	TIME OUT	VEHICLE	ROLL OFF
11/15/05	11/15/05	10:56	11:17	7004	
REFERENCE			ORIGIN		
2497-41					

Scale 1 Gross Wt.	110720	LB	Inbound - Charge ticket		
Scale 2 Tare Wt:	36980	LB			
Net Weight	73740	LB			

QTY.	UNIT	DESCRIPTION	RATE	EXTENSION	FEE	TOTAL
36.87	TON	CONTAMINATED SOIL			0.00	

Operating hours: 7 am to 3 pm, Monday - Friday

THIS IS TO CERTIFY THAT THIS LOAD DOES NOT CONTAIN ANY
NON ACCEPTABLE MATERIALS AS DEFINED BY LANDFILL PERMIT
AGREEMENT

LOT # 2497-41

SIGNATURE _____

NET AMOUNT
TENDED
CHANGE
CHECK NO.

**NON-HAZARDOUS
 WASTE MANIFEST**

1. Generator's US EPA ID No.
 N.Y.4.5.7.1.9.2.4.7.7.4

Manifest Document No.
 . 8 0 5

2. Page 1
 of 1

3. Generator's Name and Mailing Address

Air Force Real Property/DA Plattsburgh
 304 New York Road, Plattsburgh, NY 12903

M 48

4. Generator's Phone ()

563-2871

5. Transporter 1 Company Name

Mangiardi Bros. Trucking

6. US EPA ID Number

N/A

A. Transporter's Phone

518-477-8940

7. Transporter 2 Company Name

8. US EPA ID Number

B. Transporter's Phone

9. Designated Facility Name and Site Address

City of Albany Landfill
 525 Rapp Road
 Albany, NY 12205

10. US EPA ID Number

N/A

C. Facility's Phone

518-869-3651

11. Waste Shipping Name and Description

a. Non RCRA, Non DOT Regulated Material
 (Petroleum Contaminated Soil)

12. Containers No.	Type	13. Total Quantity	14. Unit Wt/Vol
0.01	D.T	EST. X 3.5	T
.	.	.	.
.	.	.	.
.	.	.	.

D. Additional Descriptions for Materials Listed Above

Lot # 2497

E. Handling Codes for Wastes Listed Above

L

15. Special Handling Instructions and Additional Information

Emergency Contact: CHS (866) 734-2553

16. GENERATOR'S CERTIFICATION: I certify the materials described above on this manifest are not subject to federal regulations for reporting proper disposal of Hazardous Waste.

Printed/Typed Name

STEPHEN G. GAGNER

Signature

Month Day Year
 11 15 05

17. Transporter 1 Acknowledgement of Receipt of Materials

Printed/Typed Name

WAYNE DANN

Signature

Month Day Year
 11 15 05

18. Transporter 2 Acknowledgement of Receipt of Materials

Printed/Typed Name

Signature

Month Day Year
 . . .

19. Discrepancy Indication Space

20. Facility Owner or Operator: Certification of receipt of waste materials covered by this manifest except as noted in Item 19.

Printed/Typed Name

Signature

Month Day Year
 . . .

GENERATOR

TRANSPORTER

FACILITY



CITY OF ALBANY
DEPARTMENT OF GENERAL SERVICES
 Rapp Road Waste Management Facility
 525 Rapp Rd • Albany, N.Y. 12205
 (518) 869-3651

006029 Corbett Management Serv., LLC
 4880 Duguid Road
 Manlius NY 13104

SITE	TICKET	GRID	WEIGHMASTER		
02	247207	P4 I	teia Smith		
DATE IN	DATE OUT	TIME IN	TIME OUT	VEHICLE	ROLL OFF
11/15/05	11/15/05	10:54	11:21	7003	
REFERENCE			ORIGIN		
2497-45					

Scale 1 Gross Wt.	109440	LB	Inbound - Charge ticket			
Scale 2 Tare Wt.	35900	LB				
Net Weight	73540	LB				
QTY.	UNIT	DESCRIPTION	RATE	EXTENSION	FEE	TOTAL
36.77	TON	CONTAMINATED SOIL			0.00	

Operating hours: 7 am to 3 pm, Monday - Friday
 THIS IS TO CERTIFY THAT THIS LOAD DOES NOT CONTAIN ANY
 NON ACCEPTABLE MATERIALS AS DEFINED BY LANDFILL PERMIT
 AGREEMENT

LOT # 2497-45

SIGNATURE _____

NET AMOUNT
109440
35900
73540
0.00
73540
0.00
73540

7003 (30)

Please print or type
(Form designed for use on 4112 pitch typewriter)

**NON-HAZARDOUS
WASTE MANIFEST**

1. Generator's US EPA ID No.

N.Y.4.5.7.1.9.2.4.7.7.4

Manifest Document No.
0006

2. Page 1
of 1

3. Generator's Name and Mailing Address

Air Force Real Property/DA Plattsburgh
304 New York Road, Plattsburgh, NY 12903

4. Generator's Phone

518-287-1111

M-30

5. Transporter 1 Company Name

Mangiardi Bros. Trucking

6. US EPA ID Number

N/A

A. Transporter's Phone

518-477-8940

7. Transporter 2 Company Name

8. US EPA ID Number

B. Transporter's Phone

9. Designated Facility Name and Site Address

City of Albany Landfill
525 Rapp Road
Albany, NY 12205

10. US EPA ID Number

N/A

C. Facility's Phone

518-869-3651

11. Waste Shipping Name and Description

a. Non RCRA, Non DOT Regulated Material
(Petroleum Contaminated Soil)

12. Containers No. Type
13. Total Quantity
14. Unit Wt/Vol

0 0 1 D T EST. XX X 35 T

D. Additional Descriptions for Materials Listed Above

Lot # 2497

E. Handling Codes for Wastes Listed Above

L

15. Special Handling Instructions and Additional Information

Emergency Contact: CNS (866) 734-2553

16. GENERATOR'S CERTIFICATION: I certify the materials described above on this manifest are not subject to federal regulations for reporting proper disposal of Hazardous Waste.

Printed/Typed Name

STEPHEN B. GAGNER

Signature

[Signature]

Month Day Year

11 15 05

17. Transporter 1 Acknowledgement of Receipt of Materials

Printed/Typed Name

Paul Kitzman

Signature

[Signature]

Month Day Year

11 15 05

18. Transporter 2 Acknowledgement of Receipt of Materials

Printed/Typed Name

Signature

Month Day Year

19. Discrepancy Indication Space

20. Facility Owner or Operator: Certification of receipt of waste materials covered by this manifest except as noted in Item 19.

Printed/Typed Name

Signature

[Signature]

Month Day Year

GENERATOR

TRANSPORTER

FACILITY



CITY OF ALBANY
DEPARTMENT OF GENERAL SERVICES
Rapp Road Waste Management Facility
525 Rapp Rd • Albany, N.Y. 12205
(518) 869-3651

006029 Corbett Management Serv., LLC
4880 Duguid Road
Manlius NY 13104

SITE	TICKET	GRID		WEIGHMASTER	
02	247327	P4 I		JG 010214	
DATE IN	DATE OUT	TIME IN	TIME OUT	VEHICLE	ROLL OFF
11/16/05	11/16/05	08:54	09:24	7003	
REFERENCE			ORIGIN		
2497-30					

Scale 1 Gross Wt. 108600 LB
Scale 2 Tare Wt. 38720 LB
Net Weight 69880 LB

Inbound - Charge ticket

QTY.	UNIT	DESCRIPTION	RATE	EXTENSION	FEE	TOTAL
34.94	TON	CONTAMINATED SOIL			0.00	

Operating hours: 7 am to 3 pm, Monday - Friday

THIS IS TO CERTIFY THAT THIS LOAD DOES NOT CONTAIN ANY
NON ACCEPTABLE MATERIALS AS DEFINED BY LANDFILL PERMIT
AGREEMENT

LOT # 2497

SIGNATURE _____

NET AMOUNT
TENDERED
CHANGE
CHECK NO.

7001-45

Please print or type.
Form designed for use on 12 inch typewriter.

**NON-HAZARDOUS
WASTE MANIFEST**

1. Generator's US EPA ID No.
N.Y.4.5.7.1.9.2.4.7.7.4

Manifest Document No.
007

2. Page 1
of 1

3. Generator's Name and Mailing Address

Air Force Real Property/DA Plattsburgh
304 New York Road, Plattsburgh, NY 12903

4. Generator's Phone () X14
563-2811

5. Transporter 1 Company Name

Mangiardi Bros. Trucking

6. US EPA ID Number

N/A

A. Transporter's Phone

518-477-8940

7. Transporter 2 Company Name

8. US EPA ID Number

B. Transporter's Phone

9. Designated Facility Name and Site Address

City of Albany Landfill
525 Rapp Road
Albany, NY 12205

10. US EPA ID Number

N/A

C. Facility's Phone

518-869-3631

11. Waste Shipping Name and Description

a. Non RCRA, Non DDT Regulated Material
(Petroleum Contaminated Soil)

12. Containers
No. Type

13. Total
Quantity

14. Unit
Wt/Vol

0.01 D.T.X. EST. 35 T

D. Additional Descriptions for Materials Listed Above

Lot # 2497

E. Handling Codes for Wastes Listed Above

L

15. Special Handling Instructions and Additional Information

Emergency Contact: CMS (866) 734-2553

16. GENERATOR'S CERTIFICATION: I certify the materials described above on this manifest are not subject to federal regulations for reporting proper disposal of Hazardous Waste.

Printed/Typed Name
STEPHEN G. Cognier

Signature
Stephen G. Cognier

Month Day Year
11 15 05

17. Transporter 1 Acknowledgement of Receipt of Materials

Printed/Typed Name
Clyde Doucy

Signature
Clyde Doucy

Month Day Year
11 15 05

18. Transporter 2 Acknowledgement of Receipt of Materials

Printed/Typed Name

Signature

Month Day Year

19. Discrepancy Indication Space

20. Facility Owner or Operator: Certification of receipt of waste materials covered by this manifest except as noted in Item 19.

Printed/Typed Name

Signature
[Signature]

Month Day Year

GENERATOR

TRANSPORTER

FACILITY



CITY OF ALBANY
DEPARTMENT OF GENERAL SERVICES
 Rapp Road Waste Management Facility
 525 Rapp Rd • Albany, N.Y. 12205
 (518) 869-3651

006029 Corbett Management Serv.,LLC
 4880 Duguid Road
 Manlius NY 13104

SITE	TICKET	GRID		WEIGHMASTER	
02	247312	P4 I		JG 010214	
DATE IN	DATE OUT	TIME IN	TIME OUT	VEHICLE	ROLL OFF
11/16/05	11/16/05	07:55	08:11	7001	
REFERENCE			ORIGIN		
2497-45					

Scale 1 Gross Wt. 106760 LB
 Scale 2 Tare Wt. 36000 LB
 Net Weight 70760 LB
 Inbound - Charge ticket

QTY.	UNIT	DESCRIPTION	RATE	EXTENSION	FEE	TOTAL
35.38	TON	CONTAMINATED SOIL			0.00	

Operating hours: 7 am to 3 pm, Monday - Friday
 THIS IS TO CERTIFY THAT THIS LOAD DOES NOT CONTAIN ANY
 NON ACCEPTABLE MATERIALS AS DEFINED BY LANDFILL PERMIT
 AGREEMENT

LOT # 2497

SIGNATURE _____

NET AMOUNT
TENDERED
CHANGE
CHECK NO.

2002 (41)

Please print or type
Form designed for use on elite (12-pitch) typewriter

**NON-HAZARDOUS
WASTE MANIFEST**

1. Generator's US EPA ID No.

N.Y.4.5.7.1.9.2.4.7.7.4

Manifest Document No.

0008

2. Page 1

of 1

3. Generator's Name and Mailing Address

Air Force Real Property/DA Plattsburgh
304 New York Road, Plattsburgh, NY 12903

4. Generator's Phone

518-477-4444

5. Transporter 1 Company Name

Mangiardi Bros. Trucking

6.

US EPA ID Number

N/A

A. Transporter's Phone

518-477-8940

7. Transporter 2 Company Name

8.

US EPA ID Number

B. Transporter's Phone

9. Designated Facility Name and Site Address

City of Albany Landfill
525 Rapp Road
Albany, NY 12205

10.

US EPA ID Number

N/A

C. Facility's Phone

518-869-3651

11. Waste Shipping Name and Description

a. Non RCRA, Non DOT Regulated Material
(Petroleum Contaminated Soil)

12. Containers
No. Type

001 D T

13. Total Quantity

EST. 35 T

14. Unit Wt/Vol

T

D. Additional Descriptions for Materials Listed Above

Lot # 2497

E. Handling Codes for Wastes Listed Above

L

15. Special Handling Instructions and Additional Information

Emergency Contact: CMS (866) 734-2553

16. GENERATOR'S CERTIFICATION: I certify the materials described above on this manifest are not subject to federal regulations for reporting proper disposal of Hazardous Waste.

Printed/Typed Name

STEPHEN Q. RANIERI

Signature

[Signature]

Month Day Year

11 15 05

17. Transporter 1 Acknowledgement of Receipt of Materials

Printed/Typed Name

Ron Farnell

Signature

[Signature]

Month Day Year

11 15 05

18. Transporter 2 Acknowledgement of Receipt of Materials

Printed/Typed Name

Signature

Month Day Year

19. Discrepancy Indication Space

20. Facility Owner or Operator: Certification of receipt of waste materials covered by this manifest except as noted in Item 19.

Printed/Typed Name

[Signature]

Signature

Month Day Year

GENERATOR
TRANSPORTER
FACILITY



CITY OF ALBANY
DEPARTMENT OF GENERAL SERVICES
 Rapp Road Waste Management Facility
 525 Rapp Rd • Albany, N.Y. 12205
 (518) 869-3651

006029 Corbett Management Serv.,LLC
 4880 Duguid Road
 Manlius NY 13104

SITE	TICKET	GRID		WEIGHMASTER	
02	247313	P4 I		JG 010214	
DATE IN	DATE OUT	TIME IN	TIME OUT	VEHICLE	ROLL OFF
11/16/05	11/16/05	07:56	08:16	7002	
REFERENCE			ORIGIN		
2497-41					

Scale 1 Gross Wt.	112880	LB	Inbound - Charge ticket
Scale 2 Tare Wt.	36480	LB	
Net Weight	76400	LB	

QTY.	UNIT	DESCRIPTION	RATE	EXTENSION	FEE	TOTAL
38.20	TON	CONTAMINATED SOIL			0.00	

Operating hours: 7 am to 3 pm, Monday - Friday
 THIS IS TO CERTIFY THAT THIS LOAD DOES NOT CONTAIN ANY
 NON ACCEPTABLE MATERIALS AS DEFINED BY LANDFILL PERMIT
 AGREEMENT

LOT # 2497

SIGNATURE _____

NET AMOUNT
TENDERED
CHANGE
CHECK NO.

7004-38

Please print or type
Form designed for use on elite (12-pin) typewriter.

**NON-HAZARDOUS
WASTE MANIFEST**

1. Generator's US EPA ID No.
N.Y.4.5.7.1.9.2.4.7.7.4

Manifest Document No.
009

2. Page 1
of 1

3. Generator's Name and Mailing Address
Air Force Real Property/DA Plattsburgh
304 New York Road, Plattsburgh, NY 12903

M-38

4. Generator's Phone
563-2871

6. US EPA ID Number
N/A

A. Transporter's Phone
518-477-8940

5. Transporter 1 Company Name
Mangiardi Bros. Trucking

8. US EPA ID Number

B. Transporter's Phone

7. Transporter 2 Company Name

10. US EPA ID Number

C. Facility's Phone

9. Designated Facility Name and Site Address
City of Albany Landfill
525 Rapp Road
Albany, NY 12205

518-869-3651

11. Waste Shipping Name and Description

12. Containers
No. Type

a. Non RCRA, Non DOT Regulated Material
(Petroleum Contaminated Soil)

13. Total Quantity
EST. 3.5 T
0.01 D.T

b.

c.

d.

D. Additional Descriptions for Materials Listed Above
Lot # 2497

E. Handling Codes for Wastes Listed Above
L

15. Special Handling Instructions and Additional Information
Emergency Contact: CMS (866) 734-2553

16. GENERATOR'S CERTIFICATION: I certify the materials described above on this manifest are not subject to federal regulations for reporting proper disposal of Hazardous Waste.

Printed/Typed Name
STEPHEN G. RAGNER

Signature
[Signature]

Month Day Year
11 15 05

17. Transporter 1 Acknowledgement of Receipt of Materials
Printed/Typed Name
MARTY MAGNUS

Signature
[Signature]

Month Day Year
11 15 05

18. Transporter 2 Acknowledgement of Receipt of Materials
Printed/Typed Name

Signature

Month Day Year

19. Discrepancy Indication Space

20. Facility Owner or Operator: Certification of receipt of waste materials covered by this manifest except as noted in Item 19.

Printed/Typed Name

Signature
[Signature]

Month Day Year

GENERATOR

TRANSPORTER

FACILITY



CITY OF ALBANY
DEPARTMENT OF GENERAL SERVICES
 Rapp Road Waste Management Facility
 525 Rapp Rd • Albany, N.Y. 12205
 (518) 869-3651

006029 Corbett Management Serv., LLC
 4880 Duguid Road
 Manlius NY 13104

SITE		TICKET		GRID		WEIGHMASTER	
02		247320		P4 I		JG 010214	
DATE IN	DATE OUT	TIME IN	TIME OUT	VEHICLE	ROLL OFF		
11/16/05	11/16/05	08:17	08:34	7004			
REFERENCE				ORIGIN			
2497-38							

Scale 1 Gross Wt.	108660	LB	Inbound - Charge ticket
Scale 2 Tare Wt.	38380	LB	
Net Weight	70280	LB	

QTY.	UNIT	DESCRIPTION	RATE	EXTENSION	FEE	TOTAL
35.14	TON	CONTAMINATED SOIL			0.00	

Operating hours: 7 am to 3 pm, Monday - Friday

THIS IS TO CERTIFY THAT THIS LOAD DOES NOT CONTAIN ANY
 NON ACCEPTABLE MATERIALS AS DEFINED BY LANDFILL PERMIT
 AGREEMENT

LOT # 2497

SIGNATURE _____

NET AMOUNT
TENDERED
CHANGE
CHECK NO.

Please print or type
(Form designed for use on size 11.25 inch typewriter)

M. J. E.

43

**NON-HAZARDOUS
WASTE MANIFEST**

1. Generator's US EPA ID No.
N.Y.4.5.7.1.9.2.4.7.7.4

Manifest Document No.
0.1.0

2. Page 1
of 1

3. Generator's Name and Mailing Address
Air Force Real Property/DA Plattsburgh
304 New York Road, Plattsburgh, NY 12903

4. Generator's Phone
518-261-1111

5. Transporter 1 Company Name
Mengiardi Bros. Trucking

6. US EPA ID Number
N/A

A. Transporter's Phone
518-477-8940

7. Transporter 2 Company Name

8. US EPA ID Number

B. Transporter's Phone

9. Designated Facility Name and Site Address
City of Albany Landfill
525 Rapp Road
Albany, NY 12205

10. US EPA ID Number
N/A

C. Facility's Phone
518-869-3651

11. Waste Shipping Name and Description

12. Containers
No.

Type

13. Total
Quantity

14. Unit
Wt/Vol

a. Non RCRA, Non DOT Regulated Material
(Petroleum Contaminated Soil)

0.01

D.T

EST. 335

T

b.

c.

d.

D. Additional Descriptions for Materials Listed Above
Lot # 2497

E. Handling Codes for Wastes Listed Above
L

15. Special Handling Instructions and Additional Information
Emergency Contact: CNS (866) 734-2553

16. GENERATOR'S CERTIFICATION: I certify the materials described above on this manifest are not subject to federal regulations for reporting proper disposal of Hazardous Waste.

Printed/Typed Name
STEPHEN C. CAGNIER

Signature
[Signature]

Month Day Year
11 15 05

17. Transporter 1 Acknowledgement of Receipt of Materials
Printed/Typed Name
M. J. E.

Signature
[Signature]

Month Day Year
11 15 05

18. Transporter 2 Acknowledgement of Receipt of Materials
Printed/Typed Name

Signature

Month Day Year

19. Discrepancy Indication Space

20. Facility Owner or Operator: Certification of receipt of waste materials covered by this manifest except as noted in Item 19.

Printed/Typed Name

Signature
[Signature]

Month Day Year

GENERATOR

TRANSPORTER

FACILITY



CITY OF ALBANY
DEPARTMENT OF GENERAL SERVICES
 Rapp Road Waste Management Facility
 525 Rapp Rd • Albany, N.Y. 12205
 (518) 869-3651

006029 Corbett Management Serv.,LLC
 4880 Duguid Road
 Manlius NY 13104

SITE		TICKET		GRID		WEIGHMASTER	
02		247319		P4 I		JG 010214	
DATE IN	DATE OUT	TIME IN	TIME OUT	VEHICLE	ROLL OFF		
11/16/05	11/16/05	08:15	08:32	7003			
REFERENCE				ORIGIN			
2497-43							

Scale 1 Gross Wt. 109340 LB
 Scale 2 Tare Wt. 38140 LB
 Net Weight 71200 LB
 Inbound - Charge ticket

QTY.	UNIT	DESCRIPTION	RATE	EXTENSION	FEE	TOTAL
35.60	TON	CONTAMINATED SOIL			0.00	

Operating hours: 7 am to 3 pm, Monday - Friday

THIS IS TO CERTIFY THAT THIS LOAD DOES NOT CONTAIN ANY
 NON ACCEPTABLE MATERIALS AS DEFINED BY LANDFILL PERMIT
 AGREEMENT

LOT # 2497

SIGNATURE

NET AMOUNT
TENDEREV
CHANGE
CHECK NO.

Please print or type
 (Form Regulated by 40 CFR 124.101)

**NON-HAZARDOUS
 WASTE MANIFEST**

1. Generator's US EPA ID No.
 N.Y.4.5.7.1.9.2.4.7.7.4

Manifest Document No.
 011

2. Page 1
 of 1

3. Generator's Name and Mailing Address

Air Force Real Property/DA Plattsburgh
 304 New York Road, Plattsburgh, NY 12903

4. Generator's Phone
 518 563-2871 x14

5. Transporter 1 Company Name
 Manglardi Bros. Trucking

6. US EPA ID Number
 N/A

A. Transporter's Phone
 518-477-8940

7. Transporter 2 Company Name

8. US EPA ID Number

B. Transporter's Phone

9. Designated Facility Name and Site Address

City of Albany Landfill
 525 Rapp Road
 Albany, NY 12205

10. US EPA ID Number
 N/A

C. Facility's Phone
 518-869-3651

11. Waste Shipping Name and Description

a. Non RCRA, Non DOT Regulated Material
 (Petroleum Contaminated Soil)

12. Containers
 No. Type

0.01 D.T. EST. 67.1 T

b.

c.

d.

D. Additional Descriptions for Materials Listed Above

Lot # 2497

E. Handling Codes for Wastes Listed Above

L

15. Special Handling Instructions and Additional Information

Emergency Contact: CMS (866) 734-2553

16. GENERATOR'S CERTIFICATION: I certify the materials described above on this manifest are not subject to federal regulations for reporting proper disposal of Hazardous Waste.

Printed/Typed Name
 STEPHEN C. COGNOLONE

Signature

Month Day Year
 11/16/05

17. Transporter 1 Acknowledgement of Receipt of Materials

Printed/Typed Name
 A. Russo

Signature

Month Day Year
 11/16/05

18. Transporter 2 Acknowledgement of Receipt of Materials

Printed/Typed Name

Signature

Month Day Year

19. Discrepancy Indication Space

20. Facility Owner or Operator: Certification of receipt of waste materials covered by this manifest except as noted in Item 19.

Printed/Typed Name

Signature

Month Day Year

GENERATOR

TRANSPORTER

FACILITY



CITY OF ALBANY
DEPARTMENT OF GENERAL SERVICES
 Rapp Road Waste Management Facility
 525 Rapp Rd • Albany, N.Y. 12205
 (518) 869-3651

006029 Corbett Management Serv., LLC
 4880 Duguid Road
 Manlius NY 13104

SITE	TICKET	GRID	WEIGHMASTER		
02	247410	P41	teia Smith		
DATE IN	DATE OUT	TIME IN	TIME OUT	VEHICLE	ROLL OFF
11/16/05	11/16/05	12:44	12:56	7001	
REFERENCE					
2497-47					
ORIGIN					

Inbound - Charge ticket					
Scale 1 Gross Wt.	103220	LB			
Scale 2 Tare Wt.	37680	LB			
Net Weight	65540	LB			
QTY.	32.77	TON	CONTAMINATED SOIL		
				RATE	TOTAL
				EXTENSION	
				FEE	0.00

Operating hours: 7 am to 3 pm, Monday - Friday
 THIS IS TO CERTIFY THAT THIS LOAD DOES NOT CONTAIN ANY
 NON ACCEPTABLE MATERIALS AS DEFINED BY LANDFILL PERMIT
 AGREEMENT

LOT # 2497-47

SIGNATURE _____

NET AMOUNT
TENURE
CHANGE
CHECK NO.

Please print or type
Form designed for use on site (12-punch copy type)

**NON-HAZARDOUS
WASTE MANIFEST**

1. Generator's US EPA ID No.
N.Y.4.5.7.1.9.2.4.7.7.4

Manifest Document No.
012

2. Page 1
of 1

3. Generator's Name and Mailing Address

Air Force Real Property/DA Plattsburgh
304 New York Road, Plattsburgh, NY 12903

4. Generator's Phone (518) 463-2871

5. Transporter 1 Company Name

Mangiardi Bros. Trucking

6. US EPA ID Number

N/A

A. Transporter's Phone

518-477-8940

7. Transporter 2 Company Name

8. US EPA ID Number

B. Transporter's Phone

9. Designated Facility Name and Site Address

City of Albany Landfill
525 Rapp Road
Albany, NY 12205

10. US EPA ID Number

N/A

C. Facility's Phone

518-869-3651

11. Waste Shipping Name and Description

a. Non RCRA, Non DOT Regulated Material
(Petroleum Contaminated Soil)

12. Containers
No. Type

0 0.1 D.T

13. Total
Quantity

EST. 11/20/05

14. Unit
Wt/Vol

D. Additional Descriptions for Materials Listed Above

Lot # 2497

E. Handling Codes for Wastes Listed Above

L

15. Special Handling Instructions and Additional Information

Emergency Contact: CMS (866) 734-2553

16. GENERATOR'S CERTIFICATION: I certify the materials described above on this manifest are not subject to federal regulations for reporting proper disposal of Hazardous Waste.

Printed/Typed Name

STEPHEN B. RAGNIOR

Signature

[Signature]

Month Day Year

11/16/05

17. Transporter 1 Acknowledgement of Receipt of Materials

Printed/Typed Name

Henry White

Signature

[Signature]

Month Day Year

11/16/05

18. Transporter 2 Acknowledgement of Receipt of Materials

Printed/Typed Name

Signature

Month Day Year

19. Discrepancy Indication Space

20. Facility Owner or Operator: Certification of receipt of waste materials covered by this manifest except as noted in Item 19.

Printed/Typed Name

[Signature]

Signature

Month Day Year

[Signature]

GENERATOR

TRANSPORTER

FACILITY



CITY OF ALBANY
DEPARTMENT OF GENERAL SERVICES
 Rapp Road Waste Management Facility
 525 Rapp Rd • Albany, N.Y. 12205
 (518) 869-3651

006029 Corbett Management Serv., LLC
 4880 Duguid Road
 Manlius NY 13104

SITE	TICKET	GRID		WEIGHMASTER	
02	247403	P4 I		teia Smith	
DATE IN	DATE OUT	TIME IN	TIME OUT	VEHICLE	ROLL OFF
11/16/05	11/16/05	12:11	12:38	7001	
REFERENCE			ORIGIN		
2497					

Scale 1 Gross Wt. 112760 LB
 Scale 2 Tare Wt. 38000 LB
 Net Weight 74760 LB

Inbound - Charge ticket

QTY.	UNIT	DESCRIPTION	RATE	EXTENSION	FEE	TOTAL
37.38	TON	CONTAMINATED SOIL			0.00	

Operating hours: 7 am to 3 pm, Monday - Friday

THIS IS TO CERTIFY THAT THIS LOAD DOES NOT CONTAIN ANY
 NON ACCEPTABLE MATERIALS AS DEFINED BY LANDFILL PERMIT
 AGREEMENT

LOT # 2497

SIGNATURE _____

NET AMOUNT
TENDERED
CHANGE
CHECK NO.

APPENDIX B-4
DISPOSAL EVENT 2 – CONTAINERS

Printed from BLS Form 351 (12/98) (Replaces BLS Form 351)

25

NON-HAZARDOUS WASTE MANIFEST

1. Generator's US EPA ID No.
N Y 4 5 7. 1. 9. 2. 4. 7. 7. 4

Manifest Doc. No.
1. 1. 605

2. Page 1 of 1

3. Generator's Name and Mailing Address
Air Force Real Property/DA Plattsburgh
304 New York Road, Plattsburgh, NY 12903

4. Generator's Phone (518) 563-2871

5. Transporter 1 Company Name
~~Freehold Cartage Inc~~ *Freehold Cartage Inc*

6. US EPA ID Number
~~N. J. D. 0. 5. 4. 1. 2. 5. 6. 4~~ *NY 004 76574*

A. Transporter's Phone
~~(732) 452-1001~~ *716-822-6400*

7. Transporter 2 Company Name

8. US EPA ID Number

B. Transporter's Phone

9. Designated Facility Name and Site Address
General Environmental Management
2655 Transport Road
Cleveland, OH 44115-3609

10. US EPA ID Number
O. H. D. 0. 0. 4. 1. 7. 8. 6. 1. 2

C. Facility's Phone
(216) 621-3694

11. Waste Shipping Name and Description

12. Containers
No. Type

13. Total Quantity

14. Unit WWVol

a. Non RCRA, Non DOT Regulated Material (Asphalt Sealer)

3 DM

EST. *XX/165*

G

b. Non RCRA, Non DOT Regulated Material (Soil/Drum Fragments)

XX/3 CF

EST. *XX/2400210*

c.

d.

D. Additional Descriptions for Materials Listed Above
11a. Approval Number: 4909-NY-5
11b. Approval Number: 4910-NY-5

E. Handling Codes for Wastes Listed Above

15. Special Handling Instructions and Additional Information
Emergency Contact: CMS (866) 734-2553

16. GENERATOR'S CERTIFICATION: I certify the materials described above on this manifest are not subject to federal regulations for reporting proper disposal of Hazardous Waste.

Printed/Typed Name
STEPHEN G. GARWICK

Signature
[Signature]

Month Day Year
11/15/05

17. Transporter 1 Acknowledgement of Receipt of Materials
Printed/Typed Name
JACQUE BRON

Signature
[Signature]

Month Day Year
11/15/05

18. Transporter 2 Acknowledgement of Receipt of Materials
Printed/Typed Name

Signature

Month Day Year

19. Discrepancy Indication Space

20. Facility Owner or Operator: Certification of receipt of waste materials covered by this manifest except as noted in Item 19.

Printed/Typed Name
Diamonds Smith

Signature
[Signature]

Month Day Year
11/16/05

GENERATOR

TRANSPORTER

FACILITY

APPENDIX B-5
CONCRETE AND METALLIC DEBRIS

Shaw

County of Franklin
Solid Waste Management Authority

Franklin County Landfill

Truck #: 849
Bill Acct: 361
Valley Sanitation

Ticket# 1044025

Haul Acct: 361
Valley Sanitation

	In	Out
Date	11/16/05	11/16/05
Time	13:18	15:03
IO	CHC	CHC

Transaction: 10 - Inbound Charge
 Payment: 1 - Charge
 Origin: 220 - Clinton County
 Destination: 3 - Cell No. 3
 Material: 501 - SMC - Valley Sanitation
 Reference:

	Lbs	Tons
Gross	69900	34.99 1
Tare	36700	18.35 1
Net	33200	16.64

Tendered: 0.00 Change: 0.00

Driver:

[Signature]

Scale Operator: Charity Clarke

Shaw

County of Franklin
Solid Waste Management Authority

Franklin County Landfill

Truck #: 850
Bill Acct: 361
Valley Sanitation

Ticket# 1044007

Haul Acct: 361
Valley Sanitation

	In	Out
Date	11/16/05	11/16/05
Time	09:36	10:25
IO	CHC	CHC

Transaction: 10 - Inbound Charge
 Payment: 1 - Charge
 Origin: 220 - Clinton County
 Destination: 3 - Cell No. 3
 Material: 501 - SMC - Valley Sanitation
 Reference:

	Lbs	Tons
Gross	45320	22.66 1
Tare	13460	6.73 1
Net	31860	15.93

Tendered: 0.00 Change: 0.00

Driver:

[Signature]

Scale Operator: Charity Clarke

Shaw

County of Franklin
Solid Waste Management Authority
Franklin County Landfill

Truck #: 850
Bill Acct: 361
Valley Sanitation
Paul Acct: 361
Valley Sanitation

Ticket# 1044026

In | Out
Date 11/16/05 | 11/16/05
Time 13:13 | 15:03
ID CHC | CHC

Transaction: 10 - Inbound Charge
Payment: 1 - Charge
Origin: 220 - Clinton County
Destination: 3 - Cell No. 3
Material: 501 - SMC0 - Valley Sanitation
Reference:

	lbs	Tons
Gross	47720	23.86 1
Tare	13080	6.54 1
Net	34640	17.32

tendered: 0.00 Change: 0.00

Driver:  Scale Operator: Charles Lucke

Shaw

Paul Acct: 361
Valley Sanitation

Transaction: 10 - Inbound Charge
Payment: 1 - Charge
Origin: 220 - Clinton County
Destination: 3 - Cell No. 3
Material: 501 - SMC0 - Valley Sanitation
Reference:

	lbs	Tons
Gross	44000	22.00 1
Tare	3680	1.84 1
Net	40320	20.16

tendered: 0.00 Change: 0.00