

7 Lowell Court
Teaneck, NJ 07666
November 6th, 1996

Mr. Tom Suozzo, Project Manager
NYSDEC
Region 7, Sub - Office
1679 NY Route 11
Kirkwood, New York 13795 - 1602

Re: GAF Site, Binghamton (C)
Site 704011

Dear Tom:

Attached , please find GAF's Final Report for the removal of soil, suspected to be contaminated with PCB'S, from the subject site. The report includes copies of various letters, transfer documentation, laboratory results and chain of custody papers.

If you have any questions please call Ms. Celeste Lagomarsino at 201 - 628 - 3035 or this writer at 201 - 692 - 1074.

Sincerely,



Neil A. Kaye, P.E. , DEE.
NAK Environmental Consulting

CC: Celeste Lagomarsino, GAF

FINAL REPORT

FOR

GAF CORPORATION
CHARLES STREET SITE
BINGHAMTON, NEW YORK

NAK CONSULTING SERVICES
7 LOWELL COURT
TEANECK, NJ 07666
201 - 692 - 1074
SEPTEMBER 1996

FINAL REPORT
GAF CORPORATION
CHARLES STREET SITE
BINGHAMTON, NEW YORK
SEPTEMBER 1996

NAK Consulting Services (NAKCS) completed a soil removal and testing project (95 - P005) in conformance with agreements reached with the New York State Department of Environmental Conservation (DEC) and GAF Corporation.

On August 8th, 10.78 cubic yards (1.5 tons / cubic yard) of soil, suspected to be contaminated with PCB's were excavated. The location was back filled with clean fill and returned to grade.

Test results show that samples taken from undisturbed surface soils near and around TP -1, in four directional quadrants, have concentrations of PCB's less than 1.0 part per million (PPM) in conformance with DEC surface soil standards. See attached description of tables and maps showing sampling locations and data. Laboratory analysis reports, Chain of Custody records, Broome Co. soil disposal approvals and other documentation are attached in the appendix.

Test results show that samples taken from depths ranging from 1.5 to 4.0 feet below surface range from less than one PPM to 6 PPM and meet standards set by the DEC of less than 10 PPM for subsurface soils 1.0 foot below surface.

Soils disposed of in the Broome Co. Landfill meet DEC disposal criteria.

These results indicate that all soils with potential contamination above DEC soil standards have been removed. De-listing should be pursued for the Charles Street site from the DEC superfund list.

TABLES AND FIGURES
CHARLES STREET SITE

FIGURE 1. SITE MAP SHOWING TEST LOCATION TP - 1

FIGURE 2. EXPLODED VIEW OF TP - 1 SHOWING LOCATIONS OF
A PCB SURVEY CONDUCTED IN 1995

TABLE 1. SAMPLE DATA FROM FIGURE 2 SHOWING FIELD SCREEN
RESULT DATA.

FIGURE 3. SAMPLE LOCATIONS FOR TESTING CONDUCTED ON
AUGUST 6TH, 1996.

TABLE 2. TEST DATA FROM SAMPLES TAKEN ON AUGUST 6TH, 1996
COMPARED WITH DEC SPLIT SAMPLES AND DEC STANDARDS

FIGURE 1

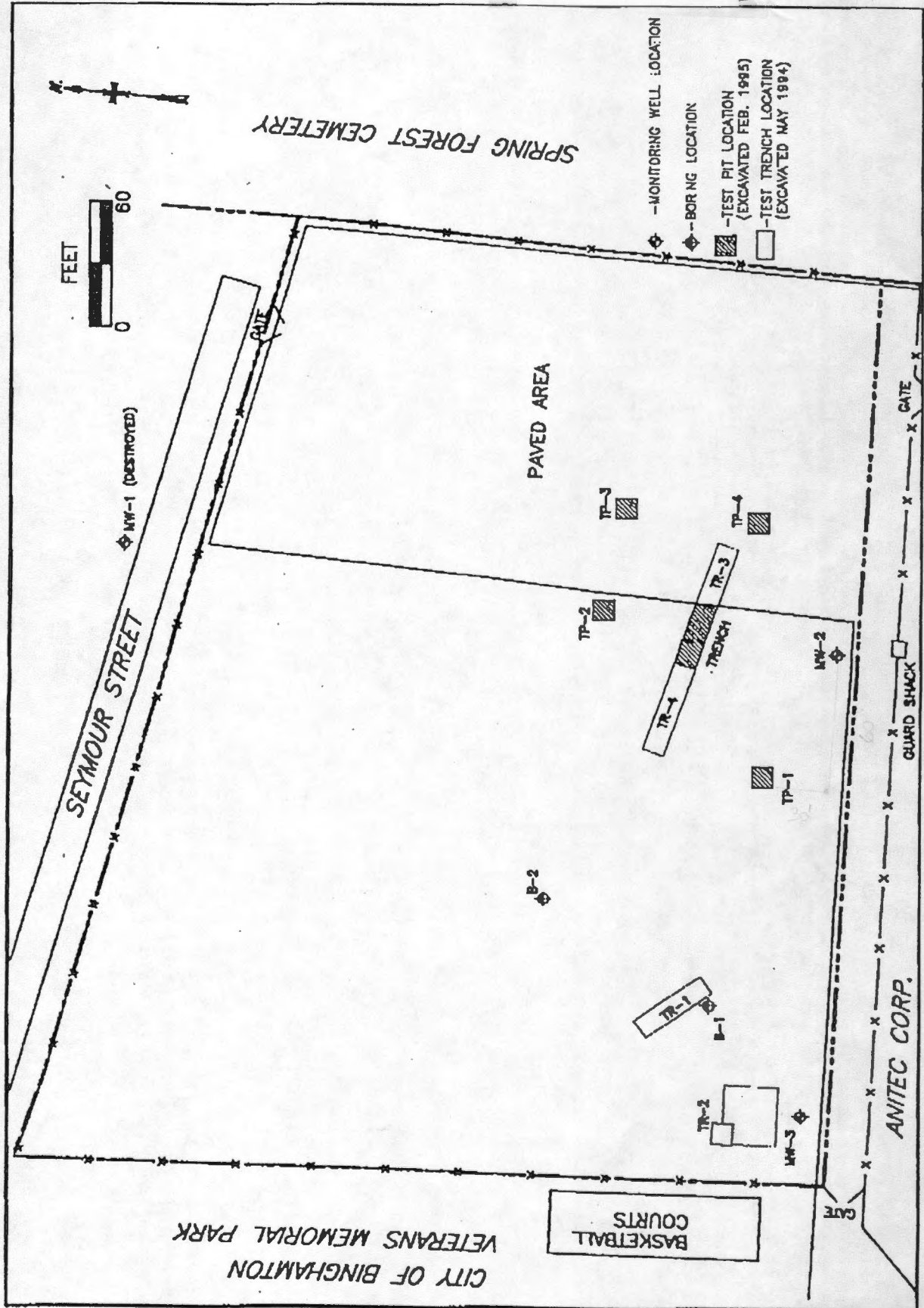

FIGURE 2

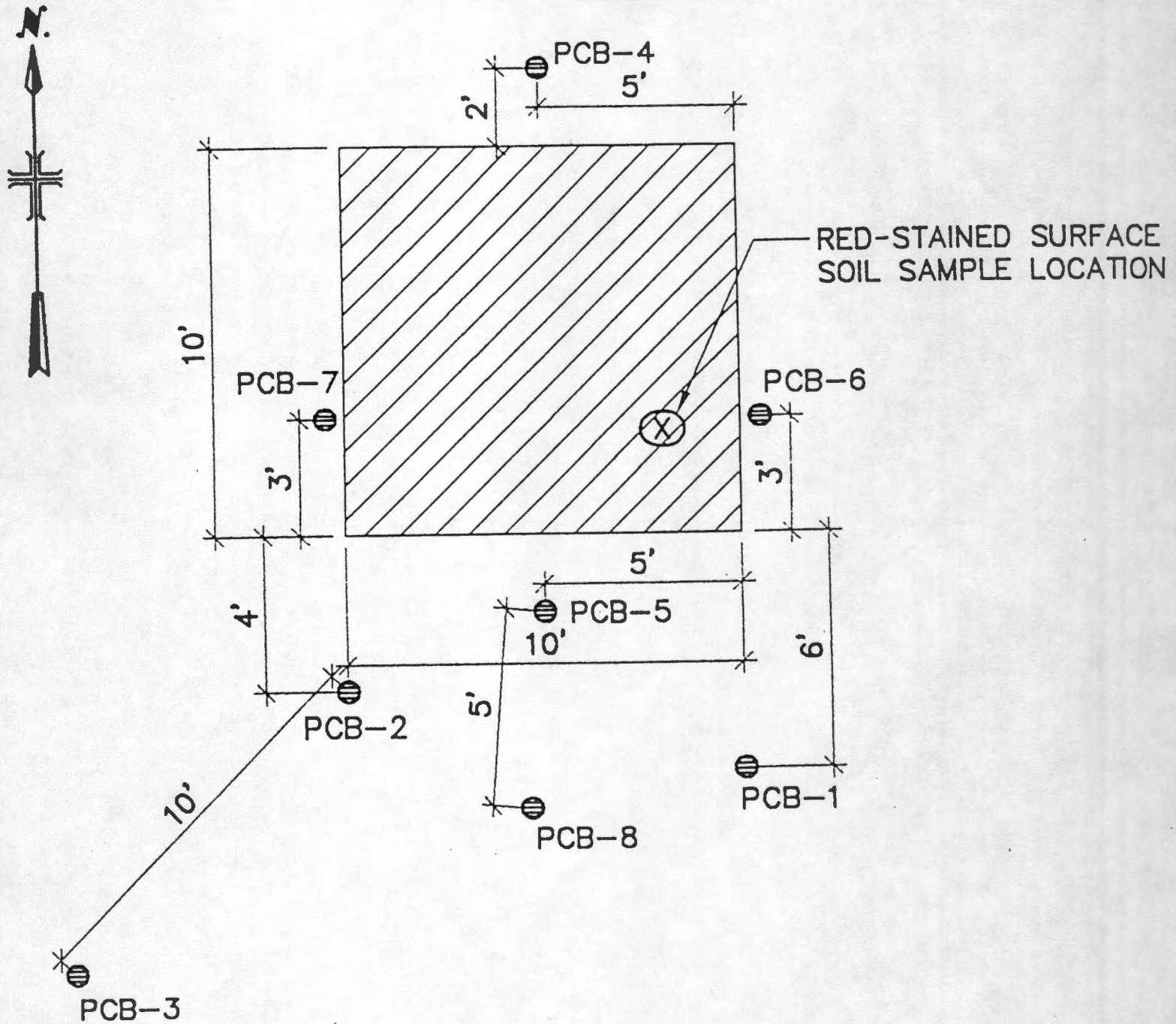

TABLE 1: PCB FIELD-SCREENING RESULTS
GAF PARKING LOT SITE
BINGHAMTON, NEW YORK

LOCATION	SAMPLE	DEPTH (FBL ¹)	RESULT ² (ppm)	LABORATORY ANALYSES	
				RESULT ³ (ppm)	PCB-TYPE
PCB-1	S-1	2-2.5	<10		
	S-2	3.5-4	<10		
	S-3	4.5-5	<10		
PCB-2	S-4	2-2.5	<10	0.080	Aroclor 1260
	S-5	3.5-4	<10		
	S-6	4.5-5	<10		
PCB-3	S-7	2-2.5	<10		
	S-8	3.4-4	<10		
	S-9	4.5-5	<10		
PCB-4	S-10	2-2.5	<10		
	S-11	3.5-4	<10		
	S-12	4.5-5	<10		
PCB-5	S-13	2-2.5	>50	0.24	Aroclor 1254
	S-14	3.5-4	>50	0.78	Aroclor 1242
	S-15	4.5-5	>10	<0.02	See note 4
PCB-6	S-16	2-2.5	<10		
	S-17	3.5-4	<10	<0.02	See note 4
	S-18	4.5-5	<10		
PCB-7	S-22	2-2.5	>10	<0.2	See note 4
	S-23	3.4-4	<10		
	S-24	4.5-5	<10		
PCB-8	S-19	2-2.5	<10		
	S-20	3.5-4	<10	<0.02	See note 4
	S-21	4.5-5	<10		
PCB-9 ⁵	S-22	NA ⁶	NA	<0.2	See note 4
See note 7	R.S.	0-0.2	>50		
NA	Equipment Blank	NA	NA	<0.1	See note 4

Notes: ¹ FBL¹ = Feet below land surface.

² Field-screening kit calibrated to Aroclor 1242.

³ Method EPA 8080

⁴ No PCBs of any type detected in this sample.

⁵ This sample is a blind duplicate of S-22.

⁶ NA = Not applicable.

⁷ This sample represents a surface-soil sample of red-stained (R.S.) soil; see Figure 1 for location.

APPENDIX



Broome County

DIVISION OF SOLID WASTE MANAGEMENT

Broome County Office Building / Government Plaza / Box 1766 / Binghamton, New York 13902 / Fax (607) 778-2395 / (607) 778-2250

John P. Kowalchuk, Director

Timothy M. Grippen, County Executive

August 20, 1996

Mr. Timothy McArdell
Environmental Products & Services Inc.
PO Box 369
Liverpool, NY 13088-0206

RE: CONTAMINATED SOIL
GAF PARKING LOT SITE
CHARLES STREET
BINGHAMTON, NY 13905

PROJECT NO. 964288

Dear Mr. McArdell:

Based on the analysis presented by Environmental Laboratory Services, the soil is acceptable for disposal at the Nanticoke Sanitary Landfill.

Should you have any questions please contact me at 778-2250.

Respectfully,

Edward M. Collins
Landfill Operations Manager

cc: Robert Denz, Environmental Health
Jerry Ballard, Nanticoke Landfill
Virginia Oggins, EMC Landfill Task Force
Bert Prohaska, Nanticoke Landfill CAC
Frank Trent, NYSDEC, Region 7

DEPT. OF ENVIRONMENTAL CONSERVATION
NYSDEC
BINGHAMTON, NY 13902
TEL: (607) 778-2250
FAX: (607) 778-2395

TABLE 2

TEST DATA
CHARLES STREET SITE
BINGHAMTON, NEW YORK

LOCATION AND SAMPLE NAME	PCB CONCENTRATION, PPM			
	GAF	DEC	DEC	STD
SURFACE SAMPLES,				
S - 1, SOUTH OF TP - 1	< 1.0	< 1.0	< 1.0	
S - 2, EAST OF TP - 1	< 1.0		< 1.0	
S - 3, NORTH OF TP - 1	< 1.0		< 1.0	
S - 4, WEST OF TP - 1	< 1.0	< 1.0	< 1.0	
SUBSURFACE SAMPLES,				
P -1, 3 FT SOUTHWEST CORNER OF TP - 1.	< 1.0		< 10.0	
P -2, 1.5 FT EAST SIDE OF TP - 1	2.1	2.3	< 10.0	
P -3, 1.5 FT NORTH SIDE OF TP -1	6.0		< 10.0	
DISPOSAL SAMPLE, DISP -1	3.0		< 50.0	

FIGURE 3

GAF PARKING LOT
SEYMOUR STREET
BINGHAMTON NEW YORK

EXCAVATION DATA AND SAMPLE LOCATIONS

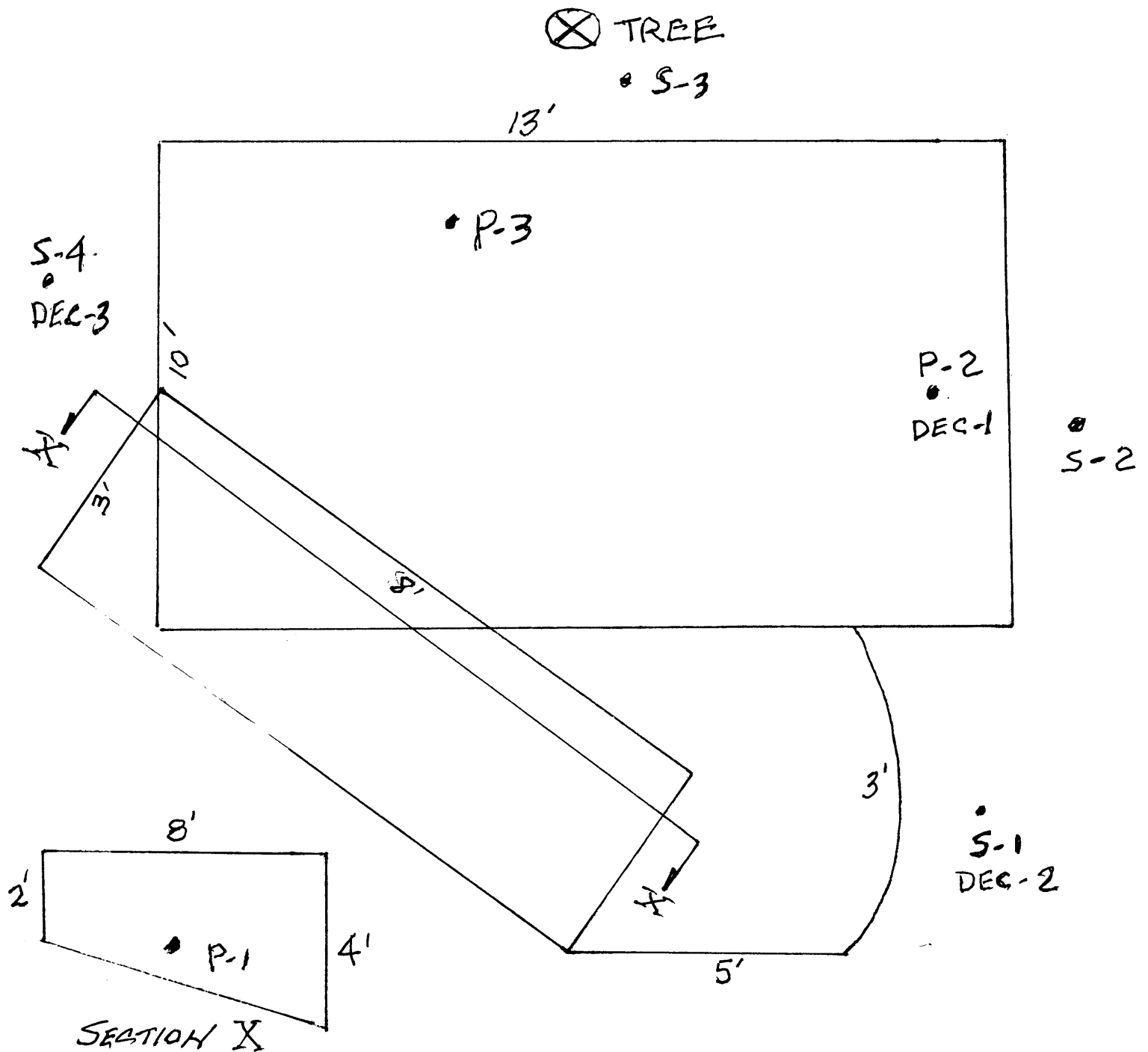



Environmental
LABORATORY SERVICES

2880 Caswell Street, Hancock Air Park, North Syracuse, NY 13212
(315) 458-8033, FAX (315) 458-0249, (800) 842-4667

4977
NAL
Job# S3017

Certified in:
• Connecticut
• Delaware
• Maryland
• Massachusetts
• New Hampshire
• New Jersey
• New York
• Pennsylvania
• Rhode Island

E.P.S. SYRACUSE
7635 EDGEComb DR.

PROJECT #: 964288
RECEIVED: 08/06/96

LIVERPOOL NY 13088
ATTN: ENVIRONMENTAL COORDINATOR

SITE ADDRESS: GAF CORPORATION
CHARLES STREET SITE
BINGHAMTON, NY

P.O. # 29050
CLIENT JOB NUMBER: S3017

TEST PERFORMED	RESULTS	UNITS	DATE PERFORMED	METHOD NUMBER	PERFORMED BY
SAMPLE #: 107428	CLIENT SAMPLE ID: S4977 P-1		DATE SAMPLED: 08/06/96		
SOLIDS, TOTAL	90	PERCENT	08/08/96	EPA 160.3	SKW
PCB'S	<1.0	MG/KG DRY WT.	08/12/96	EPA 8080	SKW

The sample was analyzed for the following seven aroclors; 1016, 1221, 1232, 1242, 1248, 1254, and 1260. The results of this analysis indicate that none of the aforementioned individual aroclors exceeded the minimum detectable limit reported.

SAMPLE #: 107429	CLIENT SAMPLE ID: S4977 P-2		DATE SAMPLED: 08/06/96		
SOLIDS, TOTAL	93	PERCENT	08/08/96	EPA 160.3	SKW
PCB'S		MG/KG DRY WT.	08/13/96	EPA 8080	SKW
AROCLOR 1016	<0.3				
AROCLOR 1221	<0.3				
AROCLOR 1232	<0.3				
AROCLOR 1242	<0.3				
AROCLOR 1248	2.1				
AROCLOR 1254	<0.3				
AROCLOR 1260	<0.3				

SAMPLE #: 107430	CLIENT SAMPLE ID: S4977 P-3		DATE SAMPLED: 08/06/96		
SOLIDS, TOTAL	94	PERCENT	08/08/96	EPA 160.3	SKW
PCB'S		MG/KG DRY WT.	08/13/96	EPA 8080	SKW
AROCLOR 1016	<0.3				
AROCLOR 1221	<0.3				
AROCLOR 1232	<0.3				
AROCLOR 1242	<0.3				
AROCLOR 1248	6.0				
AROCLOR 1254	<0.3				

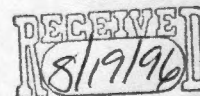



Environmental

LABORATORY SERVICES

7280 Caswell Street, Hancock Air Park, North Syracuse, NY 13212
(315) 458-8033, FAX (315) 458-0249, (800) 842-4667

Certified in:
• Connecticut
• Delaware
• Maryland
• Massachusetts
• New Hampshire
• New Jersey
• New York
• Pennsylvania
• Rhode Island

E.P.S. SYRACUSE
7635 EDGEComb DR.

PROJECT #: 964288
RECEIVED: 08/06/96

LIVERPOOL NY 13088
ATTN: ENVIRONMENTAL COORDINATOR

SITE ADDRESS: GAF CORPORATION
CHARLES STREET SITE
BINGHAMTON, NY

P.O. # 29050
CLIENT JOB NUMBER: S3017

TEST PERFORMED	RESULTS	UNITS	DATE PERFORMED	METHOD NUMBER	PERFORMED BY
SAMPLE #: 107430	CLIENT SAMPLE ID: S4977 P-3		DATE SAMPLED: 08/06/96		
PCB'S		MG/KG DRY WT.	08/13/96	EPA 8080	SKW
AROCLOR 1260	<0.3				

SAMPLE #: 107431	CLIENT SAMPLE ID: S4977 S-1		DATE SAMPLED: 08/06/96		
SOLIDS, TOTAL	84	PERCENT	08/08/96	EPA 160.3	SKW
PCB'S	<1.0	MG/KG DRY WT.	08/12/96	EPA 8080	SKW

The sample was analyzed for the following seven aroclors; 1016, 1221, 1232, 1242, 1248, 1254, and 1260. The results of this analysis indicate that none of the aforementioned individual aroclors exceeded the minimum detectable limit reported.

SAMPLE #: 107432	CLIENT SAMPLE ID: S4977 S-2		DATE SAMPLED: 08/06/96		
SOLIDS, TOTAL	91	PERCENT	08/08/96	EPA 160.3	SKW
PCB'S	<1.0	MG/KG DRY WT.	08/12/96	EPA 8080	SKW

The sample was analyzed for the following seven aroclors; 1016, 1221, 1232, 1242, 1248, 1254, and 1260. The results of this analysis indicate that none of the aforementioned individual aroclors exceeded the minimum detectable limit reported.

SAMPLE #: 107433	CLIENT SAMPLE ID: S4977 S-3		DATE SAMPLED: 08/06/96		
SOLIDS, TOTAL	94	PERCENT	08/08/96	EPA 160.3	SKW
PCB'S	<1.0	MG/KG DRY WT.	08/12/96	EPA 8080	SKW

The sample was analyzed for the following seven aroclors; 1016, 1221, 1232, 1242, 1248, 1254, and 1260. The results of this analysis indicate that none of the aforementioned individual aroclors exceeded the minimum detectable limit reported.



Environmental

LABORATORY SERVICES

7280 Caswell Street, Hancock Air Park, North Syracuse, NY 13212
(315) 458-8033, FAX (315) 458-0249, (800) 842-4667

Certified in:
• Connecticut
• Delaware
• Maryland
• Massachusetts
• New Hampshire
• New Jersey
• New York
• Pennsylvania
• Rhode Island

E.P.S. SYRACUSE
7635 EDGEComb DR.

PROJECT #: 964288
RECEIVED: 08/06/96

LIVERPOOL NY 13088
ATTN: ENVIRONMENTAL COORDINATOR

SITE ADDRESS: GAF CORPORATION
CHARLES STREET SITE
BINGHAMTON, NY

P.O. # 29050
CLIENT JOB NUMBER: S3017

TEST PERFORMED	RESULTS	UNITS	DATE PERFORMED	METHOD NUMBER	PERFORMED BY
SAMPLE #: 107434	CLIENT SAMPLE ID: S4977 S-4		DATE SAMPLED: 08/06/96		
SOLIDS, TOTAL	91	PERCENT	08/08/96	EPA 160.3	SKW
PCB'S	<1.0	MG/KG DRY WT.	08/13/96	EPA 8080	SKW

The sample was analyzed for the following seven aroclors; 1016, 1221, 1232, 1242, 1248, 1254, and 1260. The results of this analysis indicate that none of the aforementioned individual aroclors exceeded the minimum detectable limit reported.

SAMPLE #: 107435	CLIENT SAMPLE ID: S4977 DISP.-1		DATE SAMPLED: 08/06/96		
SOLIDS, TOTAL	90	PERCENT	08/08/96	EPA 160.3	SKW
PCB'S		MG/KG DRY WT.	08/13/96	EPA 8080	SKW
AROCLOR 1016	<0.3				
AROCLOR 1221	<0.3				
AROCLOR 1232	<0.3				
AROCLOR 1242	<0.3				
AROCLOR 1248	3.0				
AROCLOR 1254	<0.3				
AROCLOR 1260	<0.3				

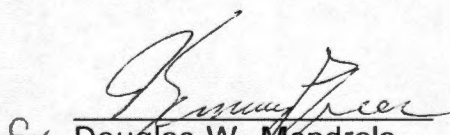
for Douglas W. Mendrala
Laboratory Director

08/14/96
Date

All tests performed under NYS ELAP Laboratory Certification # 11375 unless otherwise stated.



Environmental

PRODUCTS & SERVICES, INC.

(315) 471-0503 / (800) 843-8265

CHAIN OF CUSTODY RECORD:

EPS LAB LOG NO. 54977

[illegible]



LAIDLAW WASTE SYSTEMS

WASTE TRANSPORT DOCUMENT

PERMIT 7A-221

DATE 8-27-96DRIVER Don COMPANY LAIDLAW WASTE SYSTEMSWASTE DESCRIPTION Sol.

NUMBER OF TONS _____

NUMBER OF YARDS 20 yards

GENERATOR:

NAME Environmental ProductsADDRESS 44 Charles St.LOCATION ~~Charles St.~~ Seymour St. ST BuryDISPOSAL SITE BROOME COUNTY NANTICOKE LANDFILL

THIS MATERIAL REPRESENTS A NON-HAZARDOUS WASTE AS PER E.P.A. AND NYS D.E.C. REGULATIONS. THIS IS TO CERTIFY THAT THE ABOVE NAMED MATERIALS ARE PROPERLY CLASSIFIED AND DESCRIBED, AND ARE IN PROPER CONDITION FOR TRANSPORTATION ACCORDING TO APPLICABLE STATE AND FEDERAL LAW. THE WASTE WERE CONSIGNED TO THE TRANSPORTER NAMED. I CERTIFY THAT THE FOREGOING IS TRUE AND CORRECT TO THE BEST OF MY KNOWLEDGE.

DATE: 8-27-96SIGNATURE: [Signature]

PAGE 02
LAW WASTE
6077294674
08/30/1996 12:25

Ticket No
000202019
Scale #01

BR COUNTY NANTICOKE LANDFILL
GOV PLAZA 4TH FLOOR
P.O. Box 1766
BINGHAMTON NY 13902

5

Date :08/27/96
Time :10.38.24
11.13.12

Customer :0001
LAIDLAW WASTE SYSTEMS
19 EMMA STREET
P.O. BOX 215 WVS
BINGHAMTON NY 13905

Environmental

Order No :NOTE
DO NOT UNCOVER ROLLOFF UNTIL
Load No : 1
Total Tn : 16.17
Miles :

000690	29746AD WEST STAR TR	Gross	68440.00Lbs	Material \$
000627	ROLLOFF	Tare	36100.00Lbs	Delivery \$
000627	CONTAMINATED SOIL			Misc \$
		Net	32340.00Lbs	
			16.1700Tns	Total Due \$

WEIGH MASTER (CIS)

DRIVER

REMARKS DOWN AT DUMP SITE

STRAIGHT BILL OF LADING/NON-HAZARDOUS WASTE MANIFEST

No. _____

1.		Generator Information Generator Name: GAP (NAK CONSULTING SERVICES) Generator Mailing Address: 7 LOWELL COURT <div style="text-align: center;">TEANECK NJ 07866</div>				Site Address: CHARLES STREET <div style="text-align: center;">BINGHAMTON NY 13905</div> Generator Telephone No.: 201 692-1074																																															
2.		Destination/Disposal Facility Information Company Name: ENVIRONMENTAL PRODUCTS & SERVICES, INC. Telephone No.: 315 471-0503				Facility Site Address: 532 STATE FAIR BLVD <div style="text-align: center;">SYRACUSE NY 13204</div>																																															
3.		Transporter Information Transporter 1 Company Name: ENVIRONMENTAL PRODUCTS & SERVICES, (7A-010) Telephone No.: 315 471-0503 License Plate No.: PG 3016				Transporter 2 Company Name: _____ Telephone No.: _____ License Plate No.: _____																																															
4.		Material/Waste Description <table border="1" style="width: 100%; border-collapse: collapse;"> <thead> <tr> <th colspan="3">Containers</th> <th rowspan="2">Material Description/ <small>'Proper Shipping Name if DOT Hazardous Material</small></th> <th rowspan="2">'Hazard Class</th> <th rowspan="2">'ID Number</th> <th rowspan="2">'Packing Group</th> <th rowspan="2">Total Weight/ Volume</th> <th rowspan="2">Unit of Weight/ Volume</th> </tr> <tr> <th>No.</th> <th>Type</th> <th>'HM</th> </tr> </thead> <tbody> <tr> <td>a.</td> <td>001</td> <td>DM</td> <td>WASTE NON-RCRA SOLID, N.O.S. (PPE, SOIL)</td> <td>NON-HAZARDOUS</td> <td>NONE</td> <td>PG</td> <td>00200</td> <td>P</td> </tr> <tr><td>b.</td><td></td><td></td><td></td><td></td><td></td><td></td><td></td><td></td></tr> <tr><td>c.</td><td></td><td></td><td></td><td></td><td></td><td></td><td></td><td></td></tr> <tr><td>d.</td><td></td><td></td><td></td><td></td><td></td><td></td><td></td><td></td></tr> </tbody> </table>				Containers			Material Description/ <small>'Proper Shipping Name if DOT Hazardous Material</small>	'Hazard Class	'ID Number	'Packing Group	Total Weight/ Volume	Unit of Weight/ Volume	No.	Type	'HM	a.	001	DM	WASTE NON-RCRA SOLID, N.O.S. (PPE, SOIL)	NON-HAZARDOUS	NONE	PG	00200	P	b.									c.									d.								
Containers						Material Description/ <small>'Proper Shipping Name if DOT Hazardous Material</small>	'Hazard Class	'ID Number							'Packing Group	Total Weight/ Volume	Unit of Weight/ Volume																																				
No.	Type								'HM																																												
a.	001					DM	WASTE NON-RCRA SOLID, N.O.S. (PPE, SOIL)	NON-HAZARDOUS	NONE	PG	00200	P																																									
b.																																																					
c.																																																					
d.																																																					
5.		Job No.		6.		7.		8.																																													
		83017		Approval Nos. a. 10502 38627 b. _____ c. _____ d. _____		Purchase Order No. N/A		Additional Information NONE																																													
		NO#																																																			
10. Generator Certification: I hereby certify the above-named materials are properly classified, described, packaged, marked, and are in proper condition for transportation according to the applicable regulations of the Department of Transportation.																																																					
Generator Name: Richard F. Varrino Generator Signature: <i>Richard F. Varrino</i> Shipment Date: 8/27/96																																																					
11. Acknowledgement of Receipt of Material - To be Completed by Signatories																																																					
Transporter 1 Driver Name (Print): Richard F. Varrino Signature: <i>Richard F. Varrino</i> Shipment Date: 8/27/96 Transporter 2 Driver Name (Print): _____ Signature: _____ Shipment Date: _____																																																					
12. Facility Receiving Wastes - Authorized Agent: _____ Signature: <i>C. J. ...</i> Receipt Date: 8/27/96																																																					
13. Emergency Telephone No.: (315) 471-0503 Contact Name: TRACY DERRENBACHE <small>'Required for transportation of DOT Hazardous Material only.</small>																																																					
14. Discrepancy Indication Space to be Completed by the Disposal Facility.																																																					

This form may not be used for wastes identified as hazardous under state or RCRA regulations.