



ARCADIS of New York, Inc.
6723 Towpath Road
P O Box 66
Syracuse
New York 13214-0066
Tel 315 446 9120
Fax 315 449 0017

MEMO

To:
John Spellman, P.E.
NYSDEC
Division of Environmental Remediation
625 Broadway, 11th Floor
Albany, New York 12233-7014

Copies:
John Ruspantini, NYSEG
David Cornell, ARCADIS

From:
Jason Brien, P.E.

Date:
January 21 2014

ARCADIS Project No.:
B00013091 #5

Subject:
NYSEG Clark Street Former MGP Site
December 2013 Semi-Annual NAPL Monitoring

On behalf of NYSEG, this memorandum summarizes the results of the fourth semi-annual non-aqueous phase liquid (NAPL) monitoring event conducted at the Clark Street Former Manufactured Gas Plant (MGP) Site (the site) located in Auburn, New York (Site No. 7-06-008).

A year-long monthly NAPL monitoring program was conducted at the site from January 2010 to May 2011 in general accordance with the New York State Department of Environmental Conservation (NYSDEC) Record of Decision (ROD) (NYSDEC, 2009) and the NYSEG-approved February 2012 *Remedial Design Work Plan* (RDWP) (ARCADIS, 2010). The objective of the NAPL monitoring program was to gather data related to the presence and location of NAPL collecting in existing site bedrock monitoring wells. Detailed results of the year-long NAPL monitoring program were presented to NYSEG in a January 25, 2012 Monthly NAPL Monitoring Program – Annual Report. Upon receipt of the annual report, NYSEG requested (via a February 24, 2012 email to NYSEG) that NAPL monitoring continue at the site until remedial construction commences (anticipated late 2014).

As indicated in a June 13, 2012 Additional NAPL Monitoring Activities letter work plan to NYSEG, additional NAPL monitoring activities will be conducted on a semi-annual basis until upland remedial construction activities begin. The fourth semi-annual NAPL monitoring event was conducted in December 2013. NAPL monitoring activities and results are summarized in the following subsection.

NAPL Monitoring Activities and Results

Semi-annual NAPL monitoring activities were conducted on December 18, 2013. Per NYSEG's August 15, 2012 Semi-Annual NAPL Monitoring memorandum and NYSDEC's September 6, 2012 response letter, the number of wells monitored during the semi-annual NAPL gauging events was limited to those wells where NAPL has been visually observed since January 2010. Additionally, note that select bedrock monitoring wells were decommissioned by ARCADIS in November 2013 in support of the forthcoming remedial construction activities. The results of the NAPL monitoring activities are provided in the attached Table 1. Additionally, monitoring well locations where NAPL was observed are presented on Figure 1. As summarized in the table below, visual evidence of NAPL was observed in four monitoring wells. NAPL was unable to be recovered from the monitoring wells due to the small quantities encountered.

Monitoring Well	December 2013 Observations
MW-03B	Decommissioned
MW-04B	0.15 ft of NAPL
MW-04D	Trace NAPL blebs
MW-05B	Decommissioned
MW-06B	0.16 ft of NAPL
MW-07B	Decommissioned
MW-11D	Trace NAPL on probe

Disposable sampling equipment was containerized in labeled, DOT-certified 55-gallon drums that are stored in a secured drum locker at the site.

Path Forward

NYSEG will continue to monitor these wells on a semi-annual basis until remedial actions commence at the site. The next semi-annual monitoring event is scheduled for June 2014.

City: SYR Div/Group: SWG Created By: J.RAPP Last Saved By: jrapp
NYSEG (B0013091.0002.00170)
Q:\NYSEG\FormerClarkSt\SiteAnnualNAPLMonitoring\mxd\NAPL_Gauging_Dec2013.mxd 1/13/2014 4:22:45 PM

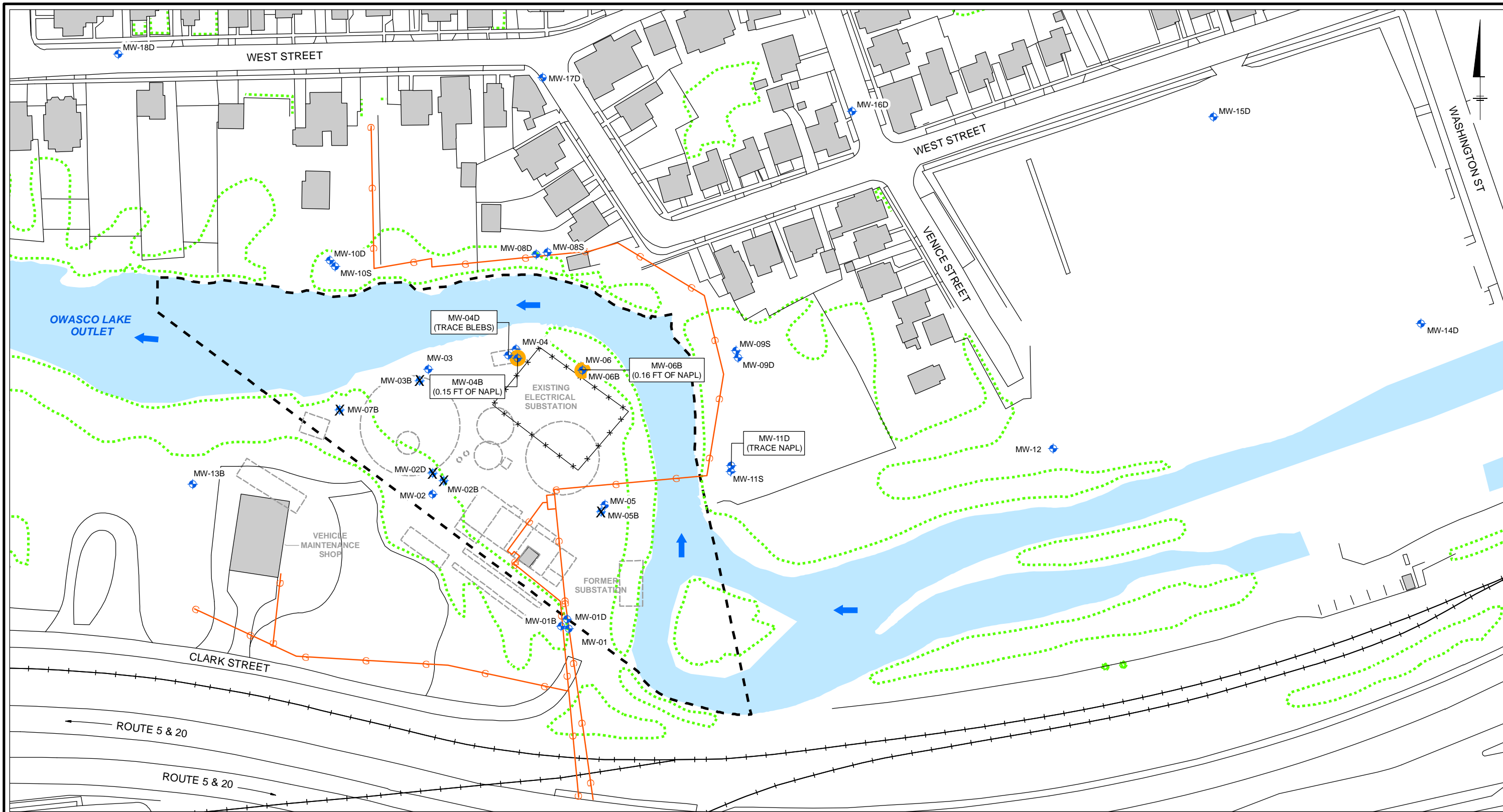

LEGEND:

- EXISTING MONITORING WELL
- MONITORING WELL CONTAINING MEASURABLE QUANTITIES OF NAPL
- MONITORING WELL DECOMMISSIONED
- NATURAL GAS LINE
- CHAIN LINK FENCE
- RAILROAD
- TREE LINE
- FORMER MGP STRUCTURE/
FORMER ELECTRICAL SUBSTATION
- EXISTING BUILDING
- SITE BOUNDARY (SEE NOTE 2)

NOTES:

- BASEMAP GENERATED FROM SUPPLEMENTAL REMEDIAL INVESTIGATION REPORT FIGURE 1-2 PREPARED BY URS (1117329.00000\B\GIS\SITEPLAN.MXD) DATED 07/13/2006.
- SITE BOUNDARY AS DEPICTED IN NYSDEC ROD.

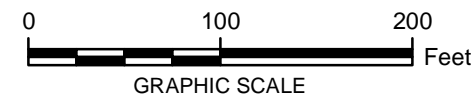

NYSEG
CLARK STREET FORMER MGP SITE
AUBURN, NEW YORK
SEMI-ANNUAL NAPL MONITORING

DECEMBER 2013 NAPL MONITORING



FIGURE
1