

November 11, 2016

SENT VIA EMAIL

Ms. Sarah Saucier  
NYSDEC  
625 Broadway  
Albany, New York 12233-7014  
Phone: (518) 402-9662  
E-mail: [sarah.saucier@dec.ny.gov](mailto:sarah.saucier@dec.ny.gov)

Subject: **NAPL Recovery – Status Report for October 2016**  
**Site #: 7-09-011**  
**NYSEG – Norwich Former MGP Site**

Dear Ms. Saucier:

On behalf of New York State Electric and Gas Corporation (NYSEG), Parsons has prepared this status report to describe events associated with non-aqueous phase liquid (NAPL) recovery at the Norwich Former Manufactured Gas Plant (Site) in Norwich, NY. This letter provides a summary of activities at the Site during the month of October 2016. Figure 1 shows the layout of the NAPL recovery system, Figure 2 shows cumulative total fluids (NAPL and water) collected to date.

### **PRODUCT RECOVERY**

During the month of October, the system was operational and recovered approximately 613 gallons of total fluids (NAPL and water), for a total volume of approximately 99,104 gallons to date. October system recovery, further discussed below, is estimated at approximately 20 gallons per day (gpd) on average. A cumulative total fluid recovery summary is provided in Figure 2.

Wells RW-09-03 and RW-10-02 were operational in the month of October. Each recovery well will continue to be monitored and pumping activities will be maintained through the month of November. Efforts to assess the condition of other existing wells and to make them operational will continue, to the extent practical.

### **RECOMMENDATIONS**

NAPL recovery and monitoring will continue through the month of November. Should an early and unexpectedly cold weather period occur in late fall/early winter, a period of system shutdown may be required.

Should you have any questions or require additional information, please do not hesitate to call me at (315) 552-9726 or Tracy Blazicek at (607) 762-8839.

Ms. Sarah Saucier  
NYSDEC  
NAPL Recover Status Report for October 2016  
November 11, 2016

Yours sincerely,

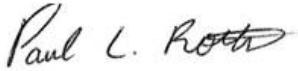
A handwritten signature in black ink that reads "Paul L. Roth". The signature is written in a cursive, flowing style.

Paul Roth  
Environmental Engineer

cc: Tracy Blazicek, NYSEG  
Melissa Doroski, NYSDOH  
Shane Blauvelt, Parsons  
Mike Smith, Parsons

## Figures

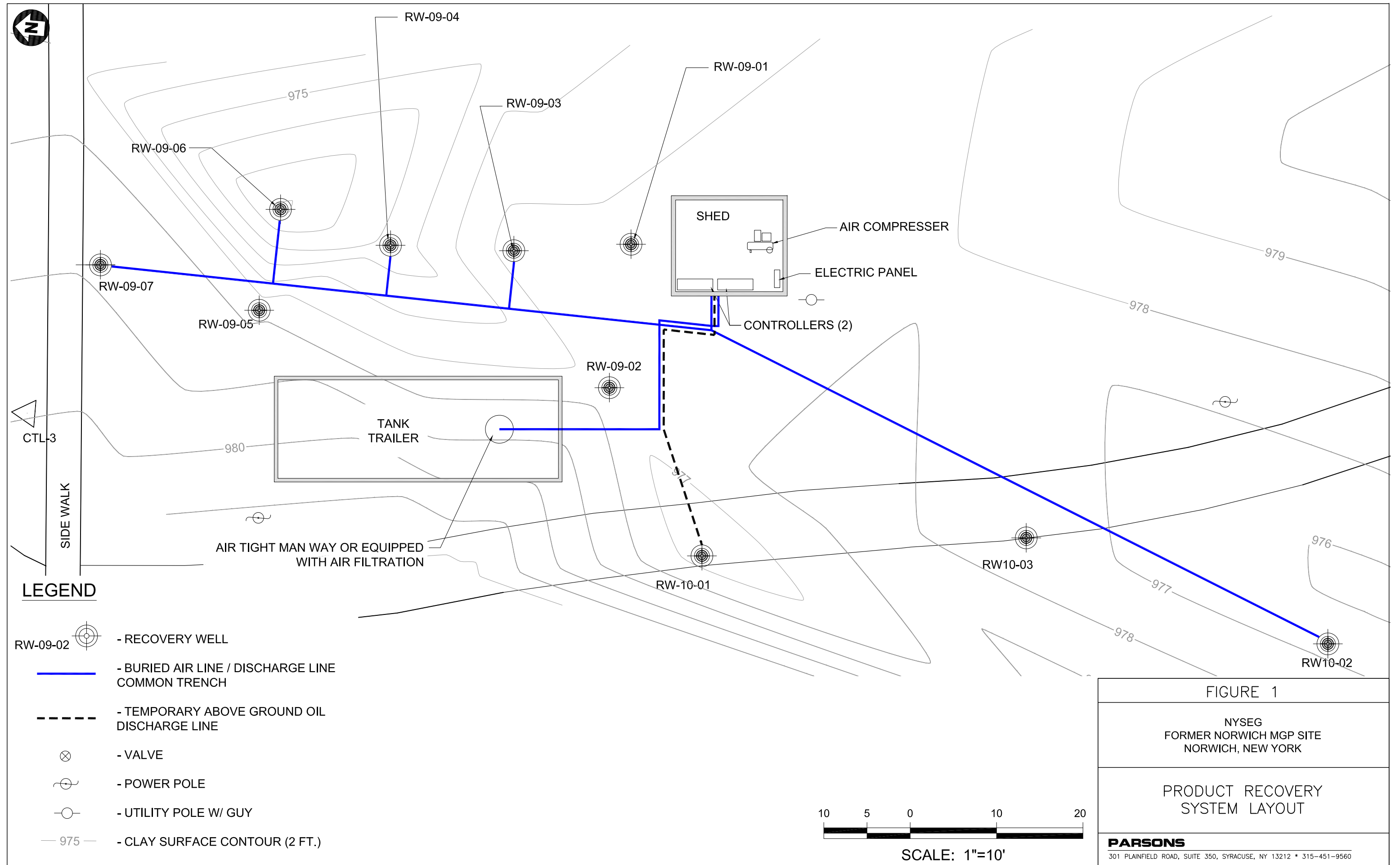

**Figure 2**  
**Total Fluids Recovery (2009 -October 2016)**  
**NYSEG Norwich Former MGP Site**

