



April 1, 2021

Stephanie Fitzgerald  
Environmental Engineer  
Div. of Remediation  
NYSDEC Region 7  
615 Erie Blvd. West, Syracuse, NY 13204-2400

Re: Annual Landfill Inspection Report (Year 17)  
Syracuse China Landfill  
Town of Salina, Onondaga County, New York  
NYSDEC Site Number 7-34-053

Dear Ms. Fitzgerald:

Rocterra, LLC (Rocterra), on behalf of TPC-York Inc. (TPC-York), has prepared this letter report to summarize the required monitoring and maintenance activities completed at the Syracuse China Landfill site located in the Town of Salina, Onondaga County, New York (Site No. 7-34-053). In accordance with New York State Department of Environmental Conservation (NYSDEC) requirements, activities for the seventeenth year of Operation, Monitoring and Maintenance (OM&M) were performed at the site. In accordance with the OM&M Plan prepared by Remedial Engineering, PC dated September 25, 2003 and the schedule approved by NYSDEC, the following activities were performed:

- Inspection of key site features including the landfill surface, vegetation, fence, access road and drainage features such as rip rap swales and energy dissipaters; and
- Maintenance activities.

Supporting figures and documentation are included at the end of this report.

## **LANDFILL MONITORING**

Rocterra conducted an inspection of the landfill and surrounding site areas on September 28, 2020 and October 14, 2020. Rocterra personnel inspected site vegetation, the landfill cap surface and the northern wetlands for any signs of erosion or significant settlement. Rocterra also inspected the swales, drop chute, energy dissipation structures, monitoring wells MW-2, MW-5, MW-6, MW-8 and MW-10, permanent landfill gas vents GV-1 through GV-7, fencing, access road and Syracuse

China signs for erosion, blockage or other damage. The results of Rocterra's inspection activities are summarized in the Site Monitoring, Inspection and Maintenance Forms, provided as Appendix A. Photographs showing the condition of key site features are provided as Appendix B. A site plan showing key site features is provided as Figure 2.

Rocterra's inspection indicated that the site was generally in good condition with no significant erosion or differential settlement at or around the landfill. The landfill surface was observed to be entirely stabilized with vegetation. The landfill drainage swales, drop chute and energy dissipation structures were observed to be in good condition, however, portions of the swales have become congested with vegetation. The permanent gas vents were also observed to be in good condition. The former trolley berm was observed to be generally clear of vegetation; rutting was observed due to wet conditions. The site fence was observed to be in good condition with the exception of approximately 250 feet of fencing along the northern border/Factory Avenue and approximately 40 feet near the Culvert along the southern border/train tracks (discussed further below in the Comments section). Vegetation overgrowth was observed periodically along the east, south and west fence line. Vegetation was cleared to assure the signs on the fence within the Factory Avenue right-of-way were unobstructed.

## **MAINTENANCE ACTIVITIES PERFORMED**

### ***Mowing and Weed-Whacking***

Annual mowing and weed-whacking activities were completed by Commercial Lawn and Landscape, Inc. on September 28, 2020, October 9 and 14, 2020. Mowing was conducted on the landfill surface, within the eastern portion of the site (outside of wetland areas) and along the access road. Mowing and weed-whacking were conducted within the landfill surface swales to remove woody growth. Photographs documenting the landscaping activities are included within Appendix B.

## **PROPOSED YEAR 18 (2021) OM&M AND MAINTENANCE ACTIVITIES**

### ***Herbicide Application***

Portions of the swales have become congested with vegetation. Treatment with a widely used aquatic herbicide Rodeo is proposed for Summer and Fall 2021.

### ***Mowing and Weed-Whacking***

In accordance with the OM&M Plan, the landfill will require annual mowing and weed-whacking in fall 2021 to prevent woody vegetation growth on the landfill cap and within the drainage swales. Landscape maintenance activities are scheduled for September of 2021 to avoid potential weather-related delays.

## ***Maintenance Activities***

In addition, tree and brush overgrowth along the toe in the northwest corner of the landfill was removed. Photographs documenting maintenance activities along the toe are included within Appendix B.

## ***Annual Landfill Inspection***

In accordance with the OM&M Plan, an inspection of the landfill is proposed for Year 18 of OM&M. The annual inspection is scheduled for September 2021.

## **SAMPLING EVENTS**

### ***Groundwater Monitoring***

TPC-York was granted approval via email correspondence dated November 20, 2015 to amend the groundwater sampling period to every five years. The next sampling event is scheduled to be performed in December 2024.

## **COMMENTS**

### ***Fencing***

Approximately 100 feet of fencing along the northern border/Factory Avenue has begun to deteriorate due to oxidation of the support posts. An additional, approximately 150 feet of fencing along the northern border/Factory Avenue have been damaged. Damage appears to have been caused by a vehicle accident. Broken pieces of autobody parts/plastic/debris were scattered throughout this area of damaged fencing. Contractors have been contacted and repairs are scheduled for Spring of 2021 along the northern border/Factory Avenue. An area of fencing at the west side of the culvert area has also been compromised. Stone was piled against the fencing, bending the support post and creating a large gap in the fencing. Figure 3 identifies the approximate locations of these areas. Photographs are included within Appendix B.

### ***Animal Dens/Burrows***

No animal dens/burrows were observed during the 2020 inspection.

### ***Culvert***

A culvert that runs beneath the CSX railroad tracks and exits along the southern border of the site has lost integrity due to erosion. There is approximately 40 feet of fencing in the vicinity of the culvert that is in danger of being destabilized as a result of the culvert deterioration (pictures have been included within Appendix B). Ownership of the culvert is being determined so that the appropriate party can be contacted to undertake the necessary repairs. As an alternative approach, an evaluation is being made of the feasibility of relocating the fence away from the culvert. However, relocation would either need to avoid the adjacent CSX railroad right-of-way or permission from CSX

would need to be obtained. An update will be provided at the conclusion of the evaluation of these various alternatives. Photographs are included within Appendix B.

***Periodic Review Report***

The last Periodic Review Report (PRR) was completed in December 2016. The Department approved a request to amend the PRR schedule to a five-year frequency in an email dated March 21, 2014. The site is not currently active and site maintenance/activities are limited to the items reported above. The institutional controls identified in the most recent 2016 PRR/Declaration of Covenants and Restrictions (groundwater use restrictions, soil management and site management) remain in place. The next PRR submission is scheduled to be submitted in December 2021.

Please call the undersigned with any questions regarding this report.

<b>Attachments:</b>	<b>Figure 1:</b>	Site Location Map
	<b>Figure 2:</b>	Site Plan
	<b>Figure 3:</b>	Site Feature Location Plan
	<b>Appendix A:</b>	Site Monitoring, Inspection and Maintenance Forms
	<b>Appendix B:</b>	Photographs

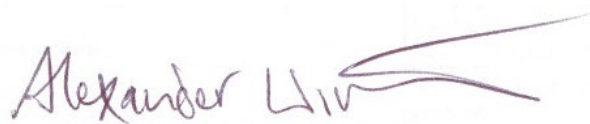

Alexander Wirth  
Principal, Senior Geologist

April 1, 2021  
Date

## FIGURES



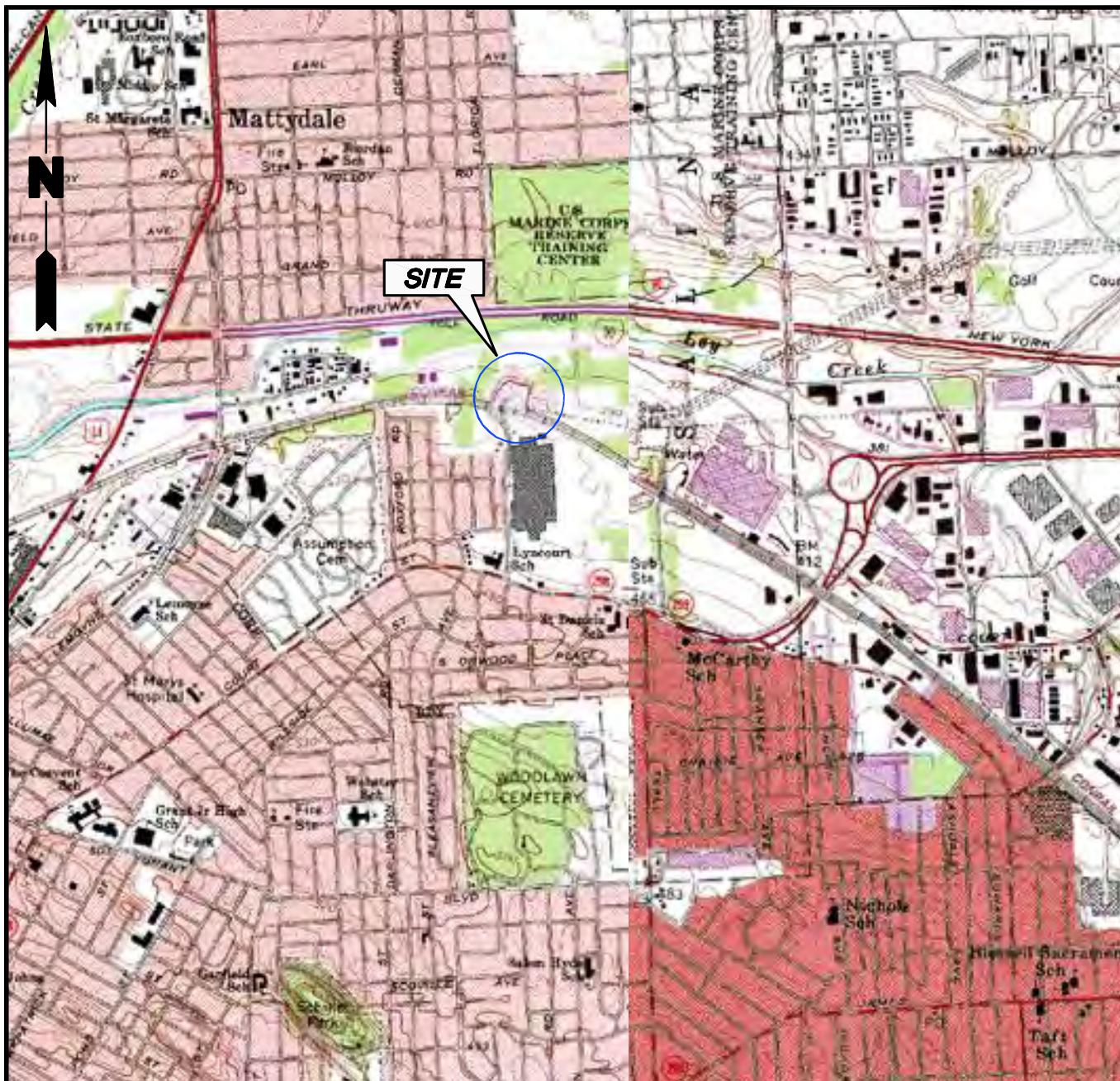

2,000' 0' 2,000'



## SOURCE

U.S.G.S. SYRACUSE EAST AND WEST, NEW YORK QUADRANGLES  
7.5 MINUTES SERIES (TOPOGRAPHIC)

Title:

## SITE LOCATION MAP

SYRACUSE CHINA LANDFILL  
TOWN OF SALINA, ONONDAGA COUNTY, NEW YORK

Prepared For:

PFALTZGRAFF CO.

 rooterra

Site Location Map

FIGURE

1



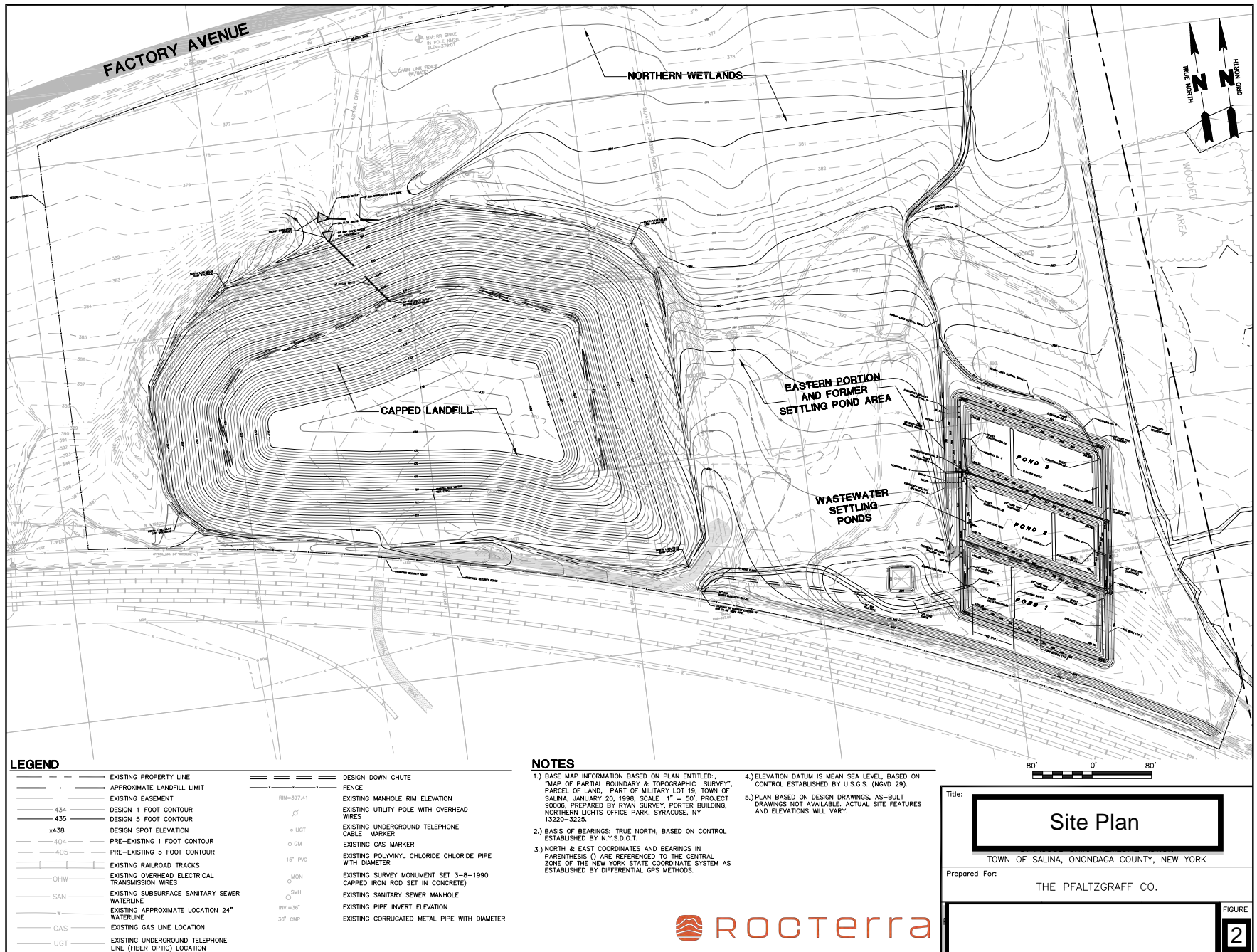



Google Earth Pro

feet  
meters |—————| 1000 |—————| 400

Site Feature Location Plan

 ROCTerra

Figure

3



## **APPENDIX A**

**Table 1**  
**MONITORING WELL GAUGING, GROUNDWATER ANALYTICAL AND MONITORING DATA**

Annual Landfill Inspection Report  
Syracuse China Landfill  
Town of Salina, Onondaga County, New York  
NYSDEC Site Number 7-34-053

Sample ID	Date	Sample Time	Depth to Water (Feet)	Depth to Bottom (Feet)	Top of Casing Elevation (Feet, Mean Sea Level)	Corrected Groundwater Elevation (Feet, Mean Sea Level)	Lead (mg/l)	Conductivity (mS/cm)	Dissolved Oxygen (PPM)	pH	Temperature (Celsius)	Turbidity (NTUs)
NYSDEC Standards							0.025					
MW-1	11/7/2012	14:30	21.78	25.3	400.8	379.02	<0.010	0.95	6.55	7.16	11.4	13.2
	9/11/2013	15:30	19.84	25.3	400.8	380.96	<0.010	1.01	6.99	7.10	15.3	11.0
	12/31/2014	14:30	20.77	25.3	400.8	380.03	<0.010	0.98	6.54	7.11	12.2	9.8
Abandoned												
MW-2	11/7/2012	14:00	5.32	13.3	391.2	385.88	<0.010	1.04	2.01	7.30	12.3	2.89
	9/11/2013	15:00	5.23	13.3	391.2	385.97	<0.010	1.00	2.57	7.20	14.6	3.33
	12/31/2014	14:00	5.28	13.3	391.2	385.92	<0.010	1.11	2.32	7.25	13.8	3.01
	12/12/2019	12:15	3.55	13.3	391.2	387.65	<0.010	1.20	1.09	7.36	8.4	9.78
MW-5	11/7/2012	15:30	5.13	13.4	387.4	382.27	<0.010	1.11	5.65	7.33	10.1	7.21
	9/11/2013	16:00	4.64	13.4	387.4	382.76	<0.010	1.21	6.11	7.21	12.3	5.03
	12/31/2014	15:00	4.84	13.4	387.4	382.56	<0.010	1.17	6.77	7.22	11.8	4.99
	12/12/2019	13:00	3.86	13.4	387.4	383.54	<0.010	1.20	1.99	7.18	8.1	8.99
MW-6	11/7/2012	13:00	4.73	17.0	411.3	406.57	<0.010	0.89	4.62	7.42	12.0	13.1
	9/11/2013	14:00	4.15	17.0	411.3	407.15	<0.010	0.88	4.89	7.32	13.3	10.01
	12/31/2014	13:00	4.44	17.0	411.3	406.86	<0.010	0.77	4.92	7.44	12.8	9.98
	12/12/2020	11:30	3.50	17.0	411.3	407.80	<0.010	0.76	1.99	7.00	9.6	9.88
MW-8	11/7/2012	17:00	7.15	23.0	388.7*	381.55	<0.010	3.07	2.24	6.88	9.0	9.67
	9/11/2013	17:30	4.43	23.0	388.7	384.27	<0.010	2.99	2.84	6.99	11.1	9.77
	12/31/2014	16:30	6.63	23.0	388.7	382.07	<0.010	3.02	2.64	6.89	10.4	8.88
	12/12/2019	14:30	3.49	23.0	388.7	385.21	<0.010	2.95	0.44	7.05	8.0	9.99
MW-10	11/7/2012	16:30	3.30	17.0	379.1	375.80	<0.010	2.84	2.49	6.84	11.1	14.2
	9/11/2013	17:00	3.28	17.0	379.1	375.82	<0.010	3.01	2.89	7.01	13.3	12.1
	12/31/2014	16:00	3.33	17.0	379.1	375.77	<0.010	2.98	2.66	6.89	12.2	10.11
	12/12/2019	13:45	2.86	17.0	379.1	376.24	<0.010	2.79	0.36	7.08	7.3	10.45

Notes:  
<1.0 = Not detected at or above the laboratory reporting limit shown.  
NYSDEC Standards and Guidance Values - New York State Department of Environmental Conservation Technical and Operational Guidance Series (TOSGS) 1.1.1, Ambient Water Quality Standards and Guidance Values, June 1998 and Addendum April 2000  
\* Revised elevation datum. Original TOC elevation= 387.8

**Table 2**  
**INSPECTION AND MAINTENANCE FORM**

Annual Landfill Inspection Report  
Syracuse China Landfill  
Town of Salina, Onondaga County, New York  
NYSDEC Site Number 7-34-053

Item	Action	Notes	Corrective Action Suggested
<b>MW-1</b>	Groundwater sampling, inspect for damage	Damaged/destroyed	Abandoned November 2, 2016
<b>MW-2</b>	Groundwater sampling, inspect for damage	NA	Annual inspection scheduled for September 2021
<b>MW-5</b>	Groundwater sampling, inspect for damage	NA	Annual inspection scheduled for September 2021
<b>MW-6</b>	Groundwater sampling, inspect for damage	NA	Annual inspection scheduled for September 2021
<b>MW-8</b>	Groundwater sampling, inspect for damage	NA	Annual inspection scheduled for September 2021
<b>MW-10</b>	Groundwater sampling, inspect for damage	NA	Annual inspection scheduled for September 2021
<b>GV-1</b>	Inspect for damage	NA	Annual inspection scheduled for September 2021
<b>GV-2</b>	Inspect for damage	NA	Annual inspection scheduled for September 2021
<b>GV-3</b>	Inspect for damage	NA	Annual inspection scheduled for September 2021
<b>GV-4</b>	Inspect for damage	NA	Annual inspection scheduled for September 2021
<b>GV-5</b>	Inspect for damage	NA	Annual inspection scheduled for September 2021
<b>GV-6</b>	Inspect for damage	NA	Annual inspection scheduled for September 2021
<b>GV-7</b>	Inspect for damage	NA	Annual inspection scheduled for September 2021
<b>Landfill Cap</b>	Inspect vegetation, inspect for erosion, inspect for significant/differential settling, mowing	NA	Landscaping/mowing scheduled for September 2021
<b>Northern Wetland</b>	Inspect vegetation	NA	Annual inspection scheduled for September 2021
<b>Swales</b>	Inspect for damage/blockage, weed wacking	Swales have significant vegetation	Herbicide application Spring/Fall 2021
<b>Drop Chute</b>	Inspect for damage/blockage, weed wacking	NA	Landscaping/weedwacking/herbicide scheduled for 2021
<b>Former Trolley Berm (via Factory Ave)</b>	Inspect for erosion, rutting, mowing	Low spot in southeast corner restricts access to the landfill by vehicle at times due to flooding/wet soils	Monitor for any significant erosion
<b>Fence</b>	Inspect integrity, inspect for significant vegetation	Vegetation observed along some areas of the fence	Annual inspection scheduled for September 2021, repairs to fence areas along the northern/southern borders scheduled for 2021
<b>Signs</b>	Inspect for vegetation/visual impairment	Replace signs as necessary during 2021 fence repairs.	Annual inspection scheduled for September 2021

Notes:  
NA- Not Applicable



## **APPENDIX B**

## Site Photos









## Culvert Area





## Toe Maintenance Area

