



April 6, 2022

Stephanie Fitzgerald
Environmental Engineer
Div. of Remediation
NYSDEC Region 7
615 Erie Blvd. West, Syracuse, NY 13204-2400

Re: Annual Landfill Inspection Report (Year 18)
Syracuse China Landfill
Town of Salina, Onondaga County, New York
NYSDEC Site Number 7-34-053

Dear Ms. Fitzgerald:

Rocterra, LLC (Rocterra), on behalf of TPC-York Inc. (TPC-York), has prepared this letter report to summarize the required monitoring and maintenance activities completed at the Syracuse China Landfill site located in the Town of Salina, Onondaga County, New York (Site No. 7-34-053). In accordance with New York State Department of Environmental Conservation (NYSDEC) requirements, activities for the eighteenth year of Operation, Monitoring and Maintenance (OM&M) were performed at the site. In accordance with the OM&M Plan prepared by Remedial Engineering, PC dated September 25, 2003 and the schedule approved by NYSDEC, the following activities were performed:

- Inspection of key site features including the landfill surface, vegetation, fence, access road and drainage features such as rip rap swales and energy dissipaters; and
- Maintenance activities.

Supporting figures and documentation are included at the end of this report.

LANDFILL MONITORING

Rocterra conducted an inspection of the landfill and surrounding site areas on November 13, 2021. Rocterra personnel inspected site vegetation, the landfill cap surface and the northern wetlands for any signs of erosion or significant settlement. Rocterra also inspected the swales, drop chute, energy dissipation structures, monitoring wells MW-2, MW-5, MW-6, MW-8 and MW-10, permanent landfill gas vents GV-1 through GV-7, fencing, access road and Syracuse China signs for erosion,

blockage or other damage. The results of Rocterra's inspection activities are summarized in the Site Monitoring, Inspection and Maintenance Forms, provided as Appendix A. Photographs showing the condition of key site features are provided as Appendix B. A site plan showing key site features is provided as Figure 2.

Rocterra's inspection indicated that the site was generally in good condition with no significant erosion or differential settlement at or around the landfill. The landfill surface was observed to be entirely stabilized with vegetation. The landfill drainage swales, drop chute and energy dissipation structures were observed to be in good condition, however, portions of the swales have become congested with vegetation. The permanent gas vents were also observed to be in good condition. The former trolley berm was observed to be generally clear of vegetation; rutting was observed due to wet conditions. The site fence was observed to be in good condition with the exception of approximately 250 feet of fencing along the northern border/Factory Avenue and approximately 40 feet near the Culvert along the southern border/train tracks (discussed further below in the Comments section). Vegetation overgrowth was observed periodically along the east, south and west fence line. Vegetation was cleared to assure the signs on the fence within the Factory Avenue right-of-way were unobstructed, with exception to the signs affixed to the damaged sections of fence.

MAINTENANCE ACTIVITIES PERFORMED

Mowing and Weed-Whacking

Despite being under contract with Commercial Lawn and Landscape, Inc., annual mowing and weed-whacking activities were not completed in 2021. After efforts to schedule maintenance activities in September, October and November, Commercial Lawn and Landscape Inc., notified Rocterra that they were unable to complete the work due to staffing shortages. Photographs documenting the landscaping are included within Appendix B.

PROPOSED YEAR 19 (2022) OM&M AND MAINTENANCE ACTIVITIES

Herbicide Application

Portions of the swales have become congested with vegetation. Treatment with a widely used aquatic herbicide Rodeo is proposed for August 2022.

Mowing and Weed-Whacking

In accordance with the OM&M Plan, the landfill will require annual mowing and weed-whacking in fall 2022 to prevent woody vegetation growth on the landfill cap and within the drainage swales. Landscape maintenance activities are scheduled for September of 2022 to avoid potential weather-related delays.

Annual Landfill Inspection

In accordance with the OM&M Plan, an inspection of the landfill is proposed for Year 19 of OM&M. The annual inspection is scheduled for September 2022.

SAMPLING EVENTS

Groundwater Monitoring

TPC-York was granted approval via email correspondence dated November 20, 2015 to amend the groundwater sampling period to every five years. The next sampling event is scheduled to be performed in December 2024.

COMMENTS

Fencing

Approximately 100 feet of fencing along the northern border/Factory Avenue has begun to deteriorate due to oxidation of the support posts. An additional, approximately 150 feet of fencing along the northern border/Factory Avenue have been damaged. Damage appears to have been caused by a vehicle accident. Broken pieces of autobody parts/plastic/debris were scattered throughout this area of damaged fencing. In 2021 Atlas Fence Inc. was contracted to repair the sections of fencing along Factory Avenue. During utility notification activities, it was determined that there was a conflict with National Grid. Rocterra, National Grid and Atlas Fence representatives all met on site on June 9, 2021 to review the potential conflict. On June 22, 2021 National Grid determined that a ten-foot buffer would need to be maintained from the underground gas line as-marked. This would require an offset to the current fence line. Rocterra proposes to meet NYSDEC on site to review a revised work scope and evaluate potential disturbances to the wetlands area.

An area of fencing at the west side of the culvert area has also been compromised. Stone was piled against the fencing, bending the support post and creating a large gap in the fencing. Figure 3 identifies the approximate locations of these areas. It is recommended that Onondaga County, CSX, NYSDEC and Rocterra representatives meet on site to discuss the fencing/culvert/failed slope area. Photographs are included within Appendix B.

Animal Dens/Burrows

No animal dens/burrows were observed during the 2020 inspection.

Culvert

A culvert that runs beneath the CSX railroad tracks and exits along the southern border of the site has lost integrity due to erosion. There is approximately 40 feet of fencing in the vicinity of the culvert that is in danger of being destabilized as a result of the culvert deterioration (pictures have been included within Appendix B). Upon review of as-built documents and evaluating the area in-person, the feasibility of relocating the fence

away from the culvert would conflict with the CSX railroad right-of-way. Photographs are included within Appendix B.

Periodic Review Report

The last Periodic Review Report (PRR) was completed in March 2022. The Department approved a request to amend the PRR schedule to a five-year frequency in an email dated March 21, 2014. The site is not currently active and site maintenance/activities are limited to the items reported above. The institutional controls identified in the most recent 2022 PRR/Declaration of Covenants and Restrictions (groundwater use restrictions, soil management and site management) remain in place. The next PRR submission is scheduled to be submitted in March 2027.

Please call the undersigned with any questions regarding this report.

Attachments:	Figure 1:	Site Location Map
	Figure 2:	Site Plan
	Figure 3:	Site Feature Location Plan
	Appendix A:	Site Monitoring, Inspection and Maintenance Forms
	Appendix B:	Photographs

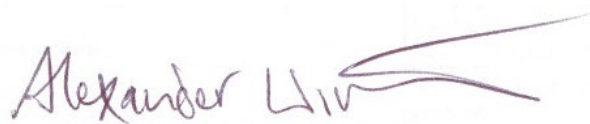

Alexander Wirth
Principal, Senior Geologist

April 6, 2022
Date

FIGURES

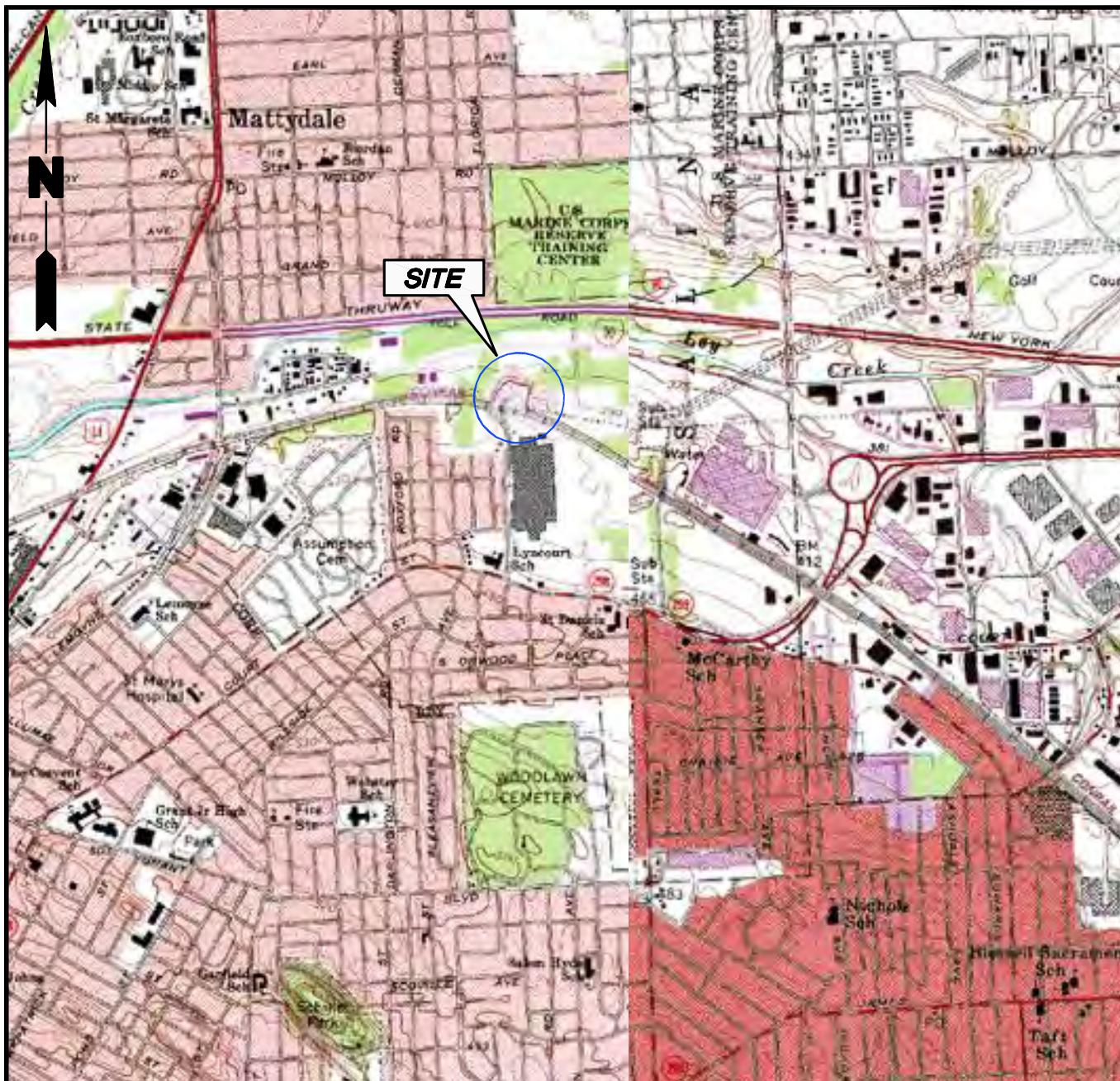

2,000' 0' 2,000'



SOURCE

U.S.G.S. SYRACUSE EAST AND WEST, NEW YORK QUADRANGLES
7.5 MINUTES SERIES (TOPOGRAPHIC)

Title:

SITE LOCATION MAP

SYRACUSE CHINA LANDFILL
TOWN OF SALINA, ONONDAGA COUNTY, NEW YORK

Prepared For:

PFALTZGRAFF CO.

 rooterra

Site Location Map

FIGURE

1

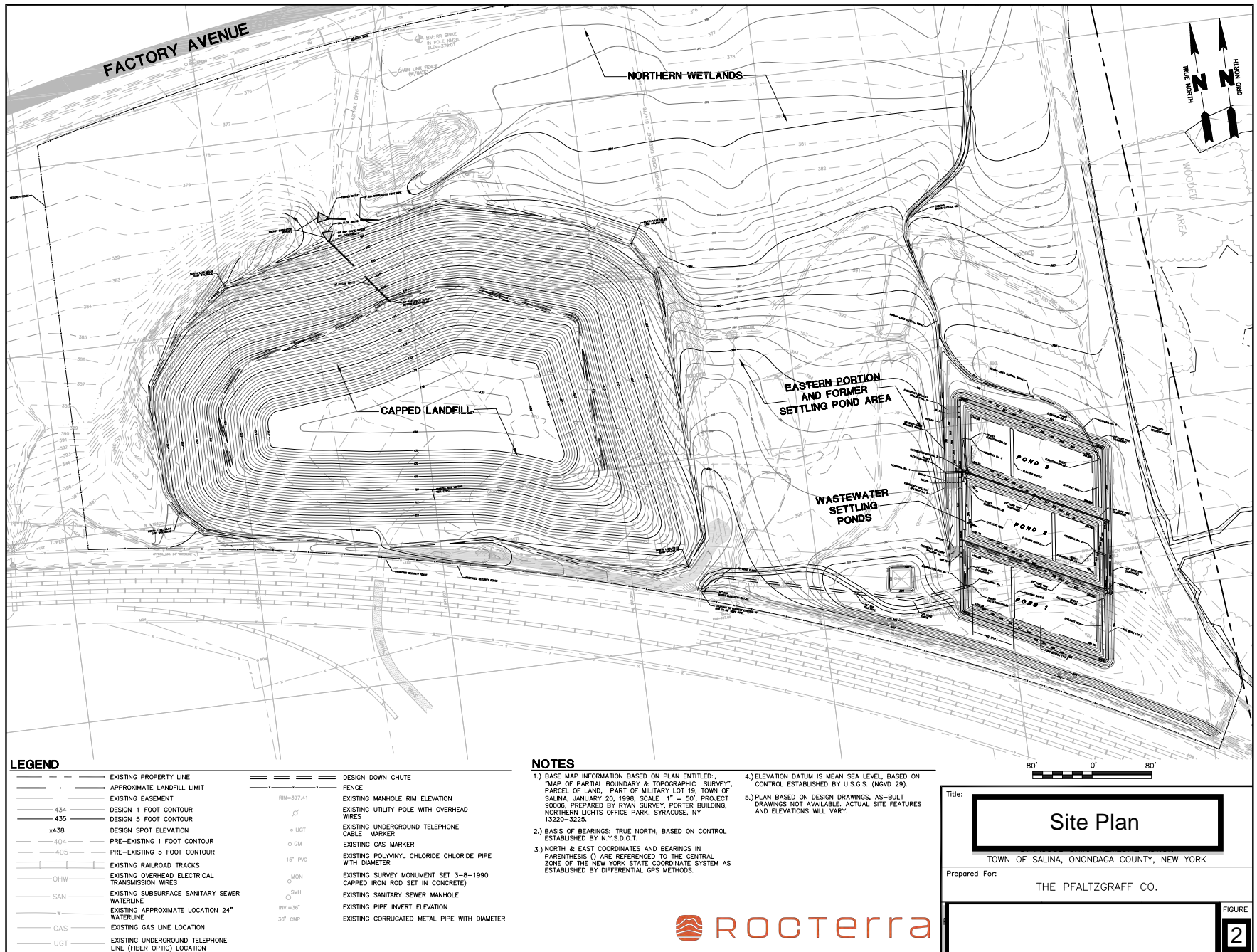



Google Earth Pro

feet
meters |—————| 1000 |—————| 400

Site Feature Location Plan

 ROCTerra

Figure

3

APPENDIX A

Table 1
MONITORING WELL GAUGING, GROUNDWATER ANALYTICAL AND MONITORING DATA

Annual Landfill Inspection Report
Syracuse China Landfill
Town of Salina, Onondaga County, New York
NYSDEC Site Number 7-34-053

Sample ID	Date	Sample Time	Depth to Water (Feet)	Depth to Bottom (Feet)	Top of Casing Elevation (Feet, Mean Sea Level)	Corrected Groundwater Elevation (Feet, Mean Sea Level)	Lead (mg/l)	Conductivity (mS/cm)	Dissolved Oxygen (PPM)	pH	Temperature (Celsius)	Turbidity (NTUs)
NYSDEC Standards							0.025					
MW-1	11/7/2012	14:30	21.78	25.3	400.8	379.02	<0.010	0.95	6.55	7.16	11.4	13.2
	9/11/2013	15:30	19.84	25.3	400.8	380.96	<0.010	1.01	6.99	7.10	15.3	11.0
	12/31/2014	14:30	20.77	25.3	400.8	380.03	<0.010	0.98	6.54	7.11	12.2	9.8
Abandoned												
MW-2	11/7/2012	14:00	5.32	13.3	391.2	385.88	<0.010	1.04	2.01	7.30	12.3	2.89
	9/11/2013	15:00	5.23	13.3	391.2	385.97	<0.010	1.00	2.57	7.20	14.6	3.33
	12/31/2014	14:00	5.28	13.3	391.2	385.92	<0.010	1.11	2.32	7.25	13.8	3.01
	12/12/2019	12:15	3.55	13.3	391.2	387.65	<0.010	1.20	1.09	7.36	8.4	9.78
MW-5	11/7/2012	15:30	5.13	13.4	387.4	382.27	<0.010	1.11	5.65	7.33	10.1	7.21
	9/11/2013	16:00	4.64	13.4	387.4	382.76	<0.010	1.21	6.11	7.21	12.3	5.03
	12/31/2014	15:00	4.84	13.4	387.4	382.56	<0.010	1.17	6.77	7.22	11.8	4.99
	12/12/2019	13:00	3.86	13.4	387.4	383.54	<0.010	1.20	1.99	7.18	8.1	8.99
MW-6	11/7/2012	13:00	4.73	17.0	411.3	406.57	<0.010	0.89	4.62	7.42	12.0	13.1
	9/11/2013	14:00	4.15	17.0	411.3	407.15	<0.010	0.88	4.89	7.32	13.3	10.01
	12/31/2014	13:00	4.44	17.0	411.3	406.86	<0.010	0.77	4.92	7.44	12.8	9.98
	12/12/2020	11:30	3.50	17.0	411.3	407.80	<0.010	0.76	1.99	7.00	9.6	9.88
MW-8	11/7/2012	17:00	7.15	23.0	388.7*	381.55	<0.010	3.07	2.24	6.88	9.0	9.67
	9/11/2013	17:30	4.43	23.0	388.7	384.27	<0.010	2.99	2.84	6.99	11.1	9.77
	12/31/2014	16:30	6.63	23.0	388.7	382.07	<0.010	3.02	2.64	6.89	10.4	8.88
	12/12/2019	14:30	3.49	23.0	388.7	385.21	<0.010	2.95	0.44	7.05	8.0	9.99
MW-10	11/7/2012	16:30	3.30	17.0	379.1	375.80	<0.010	2.84	2.49	6.84	11.1	14.2
	9/11/2013	17:00	3.28	17.0	379.1	375.82	<0.010	3.01	2.89	7.01	13.3	12.1
	12/31/2014	16:00	3.33	17.0	379.1	375.77	<0.010	2.98	2.66	6.89	12.2	10.11
	12/12/2019	13:45	2.86	17.0	379.1	376.24	<0.010	2.79	0.36	7.08	7.3	10.45

Notes:
<1.0 = Not detected at or above the laboratory reporting limit shown.
NYSDEC Standards and Guidance Values - New York State Department of Environmental Conservation Technical and Operational Guidance Series (TOSGS) 1.1.1, Ambient Water Quality Standards and Guidance Values, June 1998 and Addendum April 2000
* Revised elevation datum. Original TOC elevation= 387.8

Table 2
INSPECTION AND MAINTENANCE FORM

Annual Landfill Inspection Report
Syracuse China Landfill
Town of Salina, Onondaga County, New York
NYSDEC Site Number 7-34-053

Item	Action	Notes	Corrective Action Suggested
MW-1	Groundwater sampling, inspect for damage	Damaged/destroyed	Abandoned November 2, 2016
MW-2	Groundwater sampling, inspect for damage	NA	Annual inspection scheduled for September 2022
MW-5	Groundwater sampling, inspect for damage	NA	Annual inspection scheduled for September 2022
MW-6	Groundwater sampling, inspect for damage	NA	Annual inspection scheduled for September 2022
MW-8	Groundwater sampling, inspect for damage	NA	Annual inspection scheduled for September 2022
MW-10	Groundwater sampling, inspect for damage	NA	Annual inspection scheduled for September 2022
GV-1	Inspect for damage	NA	Annual inspection scheduled for September 2022
GV-2	Inspect for damage	NA	Annual inspection scheduled for September 2022
GV-3	Inspect for damage	NA	Annual inspection scheduled for September 2022
GV-4	Inspect for damage	NA	Annual inspection scheduled for September 2022
GV-5	Inspect for damage	NA	Annual inspection scheduled for September 2022
GV-6	Inspect for damage	NA	Annual inspection scheduled for September 2022
GV-7	Inspect for damage	NA	Annual inspection scheduled for September 2022
Landfill Cap	Inspect vegetation, inspect for erosion, inspect for significant/differential settling, mowing	NA	Landscaping/mowing scheduled for September 2022
Northern Wetland	Inspect vegetation	NA	Annual inspection scheduled for September 2022
Swales	Inspect for damage/blockage, weed wacking	Swales have significant vegetation	Herbicide application August 2022
Drop Chute	Inspect for damage/blockage, weed wacking	NA	Landscaping/weedwacking/herbicide scheduled for 2022
Former Trolley Berm (via Factory Ave)	Inspect for erosion, rutting, mowing	Low spot in southeast corner restricts access to the landfill by vehicle at times due to flooding/wet soils	Monitor for any significant erosion
Fence	Inspect integrity, inspect for significant vegetation	Fencing damaged	Meet with various stakeholders to determine the appropriate repair measures, complete by June 30, 2022
Signs	Inspect for vegetation/visual impairment	Replace signs as necessary during 2022 fence repairs.	Annual inspection scheduled for September 2022

Notes:
NA- Not Applicable

APPENDIX B

Site Photos







Culvert Area



