

ROUTE 96

300'

AS BUILT DRAWING  
89 KENDELL STREET.  
CLIFTON SPRINGS, NY 14432  
SCALE 1" = 42'-1"

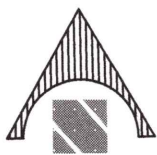

GRASS AREA

GRASS AREA

GRASS AREA

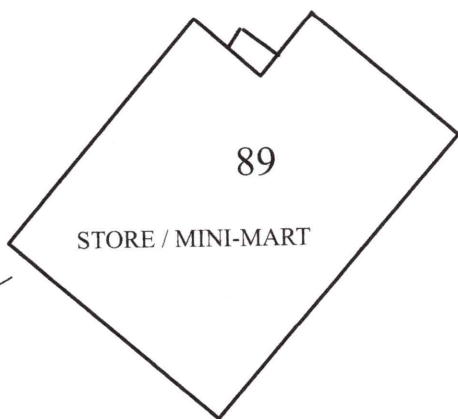

PROPANE TANK



GRASS AREA

89

STORE / MINI-MART

BLACKTOP

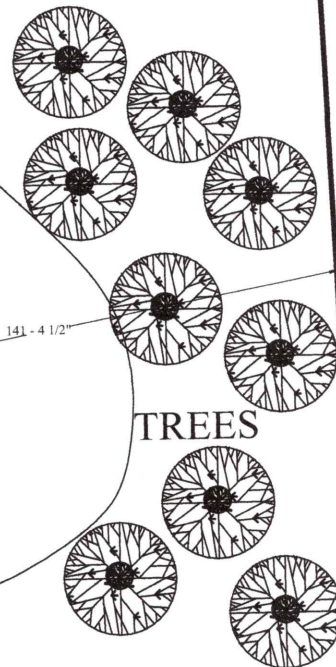

TREES

141'-4 1/2"

ENTER / EXIT

KENDELL STREET

300'

300'

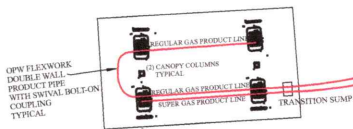

TANK SUMP REFER TO DRAWING TYPICAL

CONCRETE TANK MAT 4000 P.S.I. MIN. 3" THICK (10'x10')

INSTALLED 7/29/2018  
47'-8" x 8' x 8'  
16,000 GALLON SPLIT 12K / 4K

GRASS AREA

BLACKTOP

GRASS AREA

GRASS AREA

300'



**Tank Specific Information** **TANK NUMBER**

	1	2	3	4	5
<b>14. Underwriter Laboratories label or tank serial number.</b>					
<b>15. Tank type.*</b> (Indicate SW, DW, SW-OWS, or DW-OWS for each tank)	Compartment Tank A & B DWT - 6	DWT - 6			
<b>16. Interstitial Monitor type.**</b> (Indicate HYDRO, DRY, VAC or PRES for each tank)	HYDRO	HYDRO			
<b>17. Tank capacity.</b> (Indicate unit of measurement and record the capacities for each tank)	12,000 11,595	Select one: 4,000 4,021	<input checked="" type="checkbox"/> Gallons	<input type="checkbox"/> Liters	
<b>18. Tank free of visual damage.</b> (Document damage found and attach to this form)	YES	YES			
<b>19. Monitoring fluid visible on inner or outer tank wall.</b> (Indicate Yes or No for each tank)	NO	NO			
<b>20. Pre-Installation air/soap test performed without leaks.</b> Indicate which test in Section D you used per tank:	air/soap acc & fitting	air/soap acc & fitting			
<b>21. Hydrostatically monitored tanks:</b> Indicate Yes or N/A for each step completed per tank:					
• Sensor sits on tank top	N/A	N/A			
• Check and record monitoring-fluid level in reservoir	YES	YES			
• Annular space vented	YES	YES			
<b>22. Vacuum monitored tanks:</b>					
<b>record vacuum date</b>	N/A	N/A			
<b>record vacuum level</b>	N/A	N/A			

\* SW = Single Wall Tank • DW = Double-Wall Tank • SW-OWS = SW Oil / Water Separator • DW-OWS = DW Oil / Water Separator  
 \*\* HYDRO = Hydrostatic • DRY = Dry interstice space with probe • VAC = Vacuum • PRES = Positive Air Pressure

**Tank Deflection Measurements** Measurement instructions are found in Section 11 of Tank Installation Instructions.

1) First Vertical Diameter Measurement (Section 11, Figure 11-1)					
2) Second Vertical Diameter Measurement (Section 11, Figure 11-2)					
3) Third Vertical Diameter Measurement (Section 11, Figure 11-6)					
<b>Measurement A</b> - Tank deflection with backfill at tank top (subtract Measurement 3 from Measurement 1 above) <b>Refer to Table 11-1 for max. deflection values.</b>					
4) Fourth Vertical Diameter Measurement (Section 11, Figure 11-7)					
5) Fifth Vertical Diameter Measurement (Section 11, Figure 11-8)					
6) Calculate the final vertical diameter measurement (subtract Measurement 5 from Measurement 4 above)					
<b>Measurement B</b> - Tank deflection at subgrade (subtract Calculated Value (6) from Measurement 1 above) <b>Refer to Table 11-1 for max. deflection values.</b>					

**NOTICE**

If Measurement A or Measurement B exceeds the values shown in Table 11-1, immediately contact Tank Technical Support prior to proceeding with the installation.

CSI Tank Technical Support: (800) 537-4730

TABLE 11-1

Tank Diameter	Maximum Deflection
4'	1/2" (12mm)
6'	3/4" (19mm)
<b>8'</b>	1 1/4" (31mm)
10'	1 1/2" (38mm)
12'	1 3/4" (44mm)

**Tritec Construction**  
of Western New York Corp.  
440 Bartell Lane  
Webster, New York 14580  
585-329-6128 or 585-512-4990

**INSTALLER CERTIFICATION STATEMENT**

EVERSON DAIRY Inc  
89 KENDELL STREET.  
CLIFTON SPRINGS, NY 14432  
PBS # 8-419591

07/29/2018

Installation of new tanks.

SYSTEM TO BE INSTALLED IN COMPLIANCE WITH THE NEW YORK STATE STANDARDS FOR NEW  
AND SUBSTANTIALLY MODIFIED PETROLEUM STORAGE FACILITIES,  
6NYCRR PART 613-2.1(b)(4)(iii)(b).

Signature:



Rex Cameron  
Tritec Construction of WNY LLC  
440 Bartell Lane  
Webster, NY 14580