



**Groundwater  
& Environmental Services, Inc.**

---

300 Gateway Park Drive • North Syracuse, New York 13212 • 800-220-3069 • Fax 315-452-3237

---

April 8, 2011

Mr. Michael Mason, P.E.  
Mr. Vivek Nattanmai, P.E.  
Division of Environmental Remediation  
NYSDEC  
625 Broadway  
Albany, New York 12233-7013

**Re: Asbestos Abatement and Demolition Activities Summary  
Former Diamond Cleaners  
717 Lake Street  
Elmira, New York  
NYSDEC Site #80-8030**

Dear Mr. Mason and Mr. Nattanmai:

Groundwater & Environmental Services, Inc. (GES) is pleased to present this enclosed *Asbestos Abatement and Demolition Activities Summary* for the above referenced site. This report summarizes activities conducted during the asbestos abatement and demolition of the Former Diamond Cleaners building located at 717 Lake Street in the City of Elmira, NY.

All asbestos-containing material was removed from the site prior to demolition of the building. Currently, the site contains the remaining intact slab foundation in preparation for future remedial efforts. If you have any questions or comments, please contact us (800) 220-3069.

Sincerely,  
GROUNDWATER & ENVIRONMENTAL SERVICES, INC.

Richard A. Mayer Jr.  
Staff Hydrogeologist

Justin Domago  
Project Manager



# **ASBESTOS ABATEMENT AND DEMOLITION ACTIVITIES SUMMARY**

**FORMER DIAMOND CLEANERS  
717 LAKE STREET  
ELMIRA, NEW YORK  
NYSDEC SITE #80-8030**

**PREPARED FOR:**

**NEW YORK STATE DEPARTMENT OF ENVIRONMENTAL CONSERVATION  
DIVISION OF ENVIRONMENTAL REMEDIATION  
625 BROADWAY  
ALBANY, NEW YORK 12233**

**Report Date: April 8, 2011**

**Prepared By:**

---

**Richard A. Mayer Jr. – Staff Hydrogeologist**

**Prepared/Reviewed By:**

---

**Justin Domago - Project Manager**

**GROUNDWATER & ENVIRONMENTAL SERVICES, INC.  
300 Gateway Park Drive  
North Syracuse, NY 13212**

## TABLE OF CONTENTS

<b>1.0</b>	<b>INTRODUCTION.....</b>	<b>1</b>
<b>2.0</b>	<b>SITE BACKGROUND .....</b>	<b>1</b>
<b>3.0</b>	<b>ASBESTOS ABATEMENT .....</b>	<b>1</b>
<b>4.0</b>	<b>HAZARDOUS / UNIVERSIAL WASTE REMOVAL .....</b>	<b>2</b>
<b>5.0</b>	<b>BUILDING DEMOLITION.....</b>	<b>2</b>
<b>6.0</b>	<b>SUMMARY .....</b>	<b>3</b>

### List of Attachments

Figure 1: Site Map

- Appendix A: Photographic Documentation
- Appendix B: Daily Field Reports
- Appendix C: Waste Manifests and Weigh Tickets
- Appendix D: Demolition Permit
- Appendix E: Particulate Monitoring Data

## **1.0 INTRODUCTION**

Groundwater & Environmental Services, Inc. (GES) of North Syracuse, New York, was contracted by the New York State Department of Environmental Conservation (NYSDEC) to provide coordination and oversight for the asbestos abatement and demolition of the Former Diamond Cleaners in Elmira, NY. Onsite activities included the removal and disposal of asbestos-containing materials from the building followed by demolition and disposal of the structure as outlined in the February 9, 2011 *Demolition Work Plan*. This report provides a summary of the asbestos abatement and demolition activities.

## **2.0 SITE BACKGROUND**

The Former Diamond Cleaners site contains approximately 0.28 acres and is located at 717 Lake Street in the City of Elmira, NY (Figure 1). The property previously consisted of a single story commercial cement masonry building on a slab foundation that was used as a dry cleaning facility. A subsurface investigation has been previously conducted at the site which identified soil and groundwater contamination resulting from former site activities. As part of the preparation for future remedial actions, the building was razed to the slab foundation with the slab left intact.

An asbestos survey was conducted by MACTEC in April 2010 in which asbestos-containing materials (ACM) were identified in some of the former building materials. Additionally, several fluorescent light fixtures, polychlorinated biphenyl (PCB) containing ballasts, and mercury thermostats were also present in the structure. Prior to building demolition, all ACM, fluorescent light fixtures, PCB containing ballasts, and mercury thermostats were removed from the site.

## **3.0 ASBESTOS ABATEMENT**

Asbestos abatement services were provided by Abscope Environmental, Inc. (Abscope) of Canastota, NY (asbestos license #29339) from February 14<sup>th</sup> through February 17<sup>th</sup>, 2011. Third party air monitoring and laboratory testing was conducted by Empire Geo Services, Inc. (SJB) of Hamburg, NY (asbestos license #29433). All ACM previously identified in the April 2010 asbestos survey conducted by MACTEC was removed from the building as outlined in the *Demolition Work Plan* dated February 9, 2011 with the exception of the window caulk. Due to the construction of the exterior windows, their entire removal was not possible without forcibly removing the surrounding masonry block and thus potentially releasing airborne asbestos fibers. To prevent asbestos fibers from becoming airborne, the asbestos containing caulk was wetted down and scraped away from the window frames. Once removed, the caulk was wrapped in two layers of polyethylene sheeting and placed in a roll off container for transport offsite.

During the removal of ACM from the building, approximately 100 square feet of suspected ACM ceiling tile was identified by the onsite SJB representative. Due to the time required to obtain confirmation samples of this suspected ACM, approval was granted by the NYSDEC to remove the ceiling tiles. The ceiling tiles were lifted out of their frames and wrapped in two layers of polyethylene sheeting and placed in the ACM roll off container for transport offsite.

At the conclusion of the asbestos abatement, approximately 2.47 tons of ACM was removed from the building and disposed of at High Acres Landfill in Fairport, NY. Post abatement air monitoring and confirmation sampling was conducted by SJB to document removal of all ACM from the building prior to demolition. The results of the air monitoring and confirmation samples were sent directly to the NYSDEC. Photographic documentation of asbestos abatement activities are included in Appendix A. Additionally, daily



field reports documenting asbestos abatement activities are included in Appendix B. ACM waste manifests are provided in Appendix C.

#### **4.0 HAZARDOUS / UNIVERSAL WASTE REMOVAL**

Hazardous and/or universal waste at the site was collected and removed from the building prior to demolition activities. This included fluorescent light fixtures, PCB containing ballasts, and mercury thermostats. Approximately 15 kilograms of fluorescent light fixtures and one mercury thermostat was packaged separately and transported by Abscope to Solvents and Petroleum Service, Inc. of Syracuse, NY for disposal. Additionally, 77 kilograms of PCB containing ballasts was transported and disposed of by Veolia Environmental Services, Inc. of Stoughton, MA. Waste manifests are provided in Appendix C.

#### **5.0 BUILDING DEMOLITION**

Demolition services were provided by Abscope from March 8<sup>th</sup> through March 11<sup>th</sup>, 2011. Prior to building demolition, confirmation from SJB was obtained to verify that the building was clear of all ACM. Additionally, all hazardous and/or universal wastes were removed from the building and transported to the appropriate facility for disposal. All utilities were confirmed disconnected and were capped and/or plugged. Demolition permit #11-01 was issued by the Chemung County Code Enforcement Office to conduct demolition activities. A copy of the demolition permit is provided in Appendix D.

The building demolition was conducted as outlined in the *Demolition Work Plan* dated February 9, 2011 with the exception of encountering additional site preparation. To assist in the transportation of demolition debris offsite, the removal of one large ash tree from the northern property boundary was granted by the NYSDEC. After removal of the tree, a hydraulic excavator was used to demolish the building in sections starting from the back of the property and moving forward to the east. The demolition debris was sorted and processed for offsite disposal. Approximately 262 tons of construction and demolition (C&D) debris was removed from the site and disposed of at Hakes C&D Landfill in Painted Post, NY. Additionally, approximately 9.4 gross tons (GT) of steel was removed from the site and transported to Shulman Inc. of Elmira, NY for recycling.

All building debris was removed from the site and the remaining slab foundation was swept clean with a broom. Upon request from the NYSDEC, a snow fence was installed around the perimeter of the slab foundation to protect the public from potential trip hazards. Photographic documentation of demolition activities are included in Appendix A. Daily field reports documenting demolition activities are included in Appendix B. Weigh tickets for the C&D debris and recycled steel are provided in Appendix C.

During demolition of the building, particulate air monitoring was provided by GES to monitor the levels of fugitive dust. One particulate sampler was placed upwind to monitor background levels and two particulate samplers were placed downwind to monitor dust resulting from demolition activities. Visual confirmation that dust was confined to the property during building demolition was observed by GES personnel. Additionally, the particulate samplers did not record a result above the pre-established suppression threshold of 100  $\mu\text{g}/\text{m}^3$ . The particulate levels recorded during air monitoring are included in Appendix E.

## **6.0 SUMMARY**

In summary, the asbestos abatement and demolition activities that occurred at the subject site beginning on February 14<sup>th</sup>, 2011 included the following:

- The removal of approximately 2.47 tons of ACM from the former building.
- Third party confirmation that all ACM was removed from the building prior to demolition.
- The removal of all fluorescent light fixtures, PCB containing ballasts, and mercury thermostats from the former building.
- Demolition of the building and sorting of the debris as outlined in the February 9<sup>th</sup>, 2011 *Demolition Work Plan*.
- The removal of approximately 262 tons of C&D debris and the recycling of 9.4 tons of steel from the site.
- Air monitoring of particulate levels confirmed fugitive dust remained confined to the property.

**FIGURE**

---

LEGEND

- PROPERTY BOUNDARY
- o-o- CHAIN LINK FENCE
- [ ] CATCH BASIN
- (M) UTILITY MANHOLE
- UTILITY POLE
- FIRE HYDRANT
- ⊕ MONITORING WELL
- SS UNDERGROUND SANITARY SEWER LINE
- ST UNDERGROUND STORM SEWER LINE
- W UNDERGROUND WATER LINE
- G UNDERGROUND GAS LINE
- OHU OVERHEAD UTILITIES

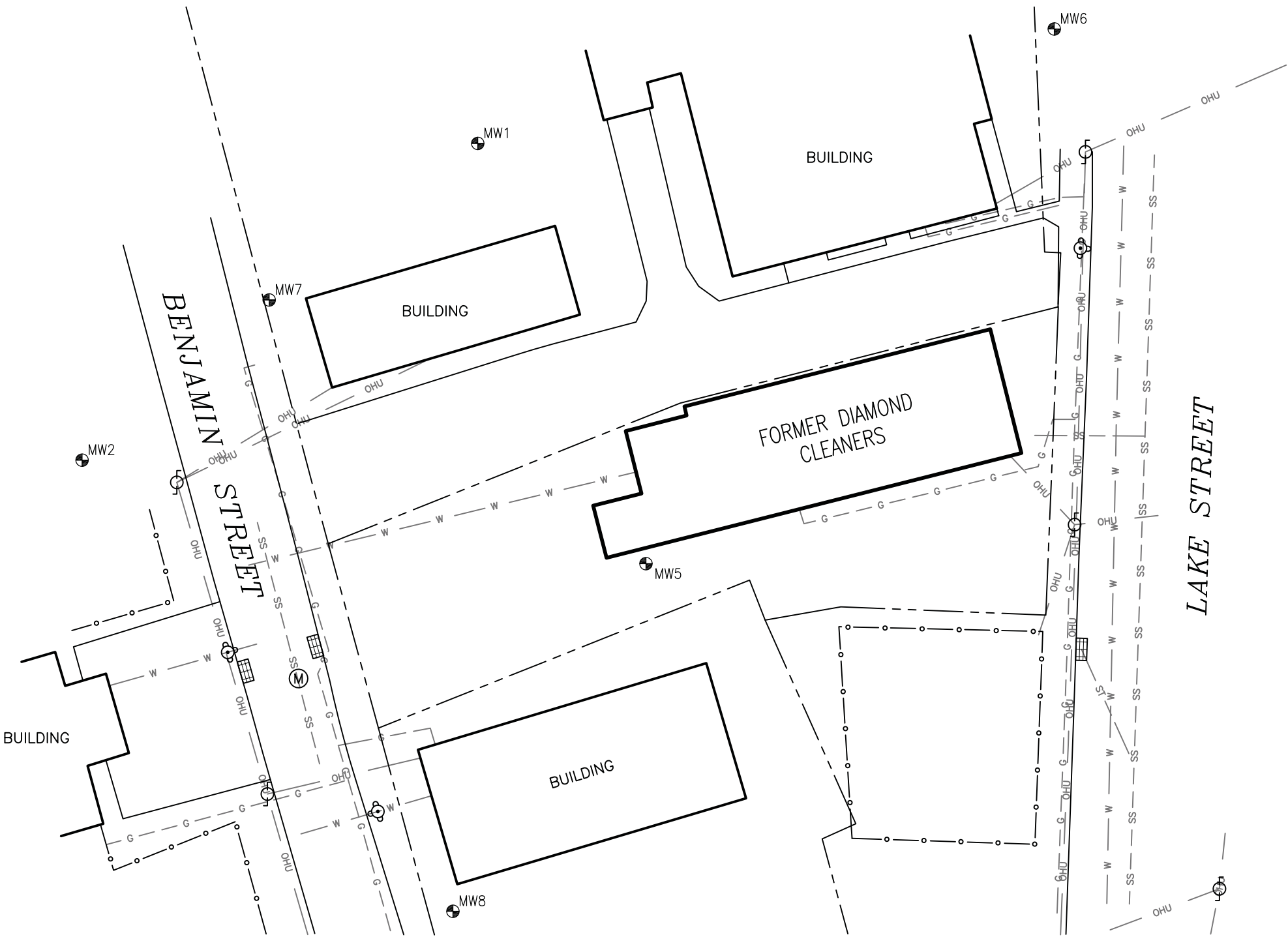

DRAFTED BY: B.C.S. (N.J.)	SITE MAP		
CHECKED BY:	NYSDEC #80-8030 (FORMER DIAMOND CLEANERS) 717 LAKE STREET ELMIRA, NEW YORK		
REVIEWED BY:	Groundwater & Environmental Services, Inc. 300 GATEWAY PARK DRIVE, NORTH SYRACUSE, NY 13212		
NORTH 	SCALE IN FEET 	DATE 2-15-11	FIGURE 1
	0 APPROXIMATE 40		

## **APPENDIX A – Photographic Documentation**

---



Photo #1: February 15, 2011 – Asbestos abatement preparation office area.



Photo #2: February 15, 2011 – Asbestos abatement preparation front entry area.





Photo #3: February 17, 2011 – ACM removal from roof flashing (back of building).



Photo #4: February 17, 2011 – ACM removal from roof flashing (center of building).





Photo #5: February 17, 2011 – ACM removal from roof flashing (front of building).



Photo #6: February 17, 2011 – ACM removal of window caulking.





Photo #7: February 18, 2011 – ACM removal of tile/cement board from front/office area.



Photo #8: February 18, 2011 – ACM removal of tile from front/office area.



Photo #9: February 18, 2011 – ACM removal of tile from front entry area.



Photo #10: February 18, 2011 – ACM removal of tile from bathroom area.





Photo #11: February 18, 2011 – Post ACM removal.



Photo #12: March 8, 2011 – Gas utility disconnect.





Photo #13: March 8, 2011 – Initiation of demolition activities (back of building).



Photo #14: March 8, 2011 – Demolition of building southern wall.





Photo #15: March 8, 2011 – Removal of steel from demolition debris.



Photo #16: March 8, 2011 – Demolition of central portion of the building.





Photo #17: March 8, 2011 – Building demolition (looking northeast).



Photo #18: March 9, 2011 – Sorting of demolition debris.





Photo #19: March 11, 2011 – Post building demolition (looking northwest).



Photo #20: March 11, 2011 – Post building demolition (looking east).

## **APPENDIX B – Daily Field Reports**

---



<b>SITE NAME</b> DEC Elmira, NY Diamond Cleaners		<b>GES Job No:</b> 06-02380
Site Facility No:	80-8030	Date : 2-14-2011
Project Manager	Rick Mayer	Staff : Scott McDonald
Checked w/Site Personnel PRIOR to starting work :		Weather: Cool w/ Drizzle
PRCA #		

Work Requested	Phase	Task	Completed	Time of Arrival :	0800
Liquid Levels <input type="checkbox"/>				Time of departure :	1730
System Check <input type="checkbox"/>				REPORT:	
GW Sample <input type="checkbox"/>					
System Sample <input type="checkbox"/>				<b>Total # of Samples to be Collected</b>	
Demo <input type="checkbox"/>				NA Wells for:	NA
Drum Pickup <input type="checkbox"/>				NA Wells for:	NA
Asb. Abtmnt <input checked="" type="checkbox"/>	08	275		NA System	NA
				Laboratory:	NA

#### Work REQUESTED (Comments or Special Information)

Sign HASP and review JSAs
Provide oversight during site mobilization and asbestos abatement activities.
Work should be conducted between the hours of 7 am and 5 pm.
Take photos of activities when applicable.
Ensure unauthorized persons stay out of safety perimeter.
Contact PM/CM prior to leaving site.

#### Work COMPLETED (Comments or Special Information)

Load vehicle / Prep for field work
Travel to the site
Perimeter fence set up / Snow removal
Initial project kick-off meeting
Begin asbestos abatement preparation in Bathroom / small office area

#### Additional Work Suggested/Recommended for next trip

### TIME LOG MUST FILL OUT

Please enter time interval for each

	Hours	Start time - End Time	Example	Hours	Start time	End Time
Prep	0.75	0515 - 0600	Prep	0.25	7:30	7:45
Drive to site	2.00	0600 - 0800	Drive to	1	7:45	8:45
Time on site	9.50	0800 - 1730	On site	2	8:45	10:45
Drive back	0.25	1730 - 1745	Drive back	0	Went to another site	
Unload time	—	—	Unload	0.25	2:45	3:00

Total 12.50

Total 3.5

\*\* Use total for Vehicle and equipment charges on sales and rental.  
LVE is onsite time only.

**SITE NAME**

DEC Elmira, NY Diamond Cleaners

**GES Job No:** 06-02380

Site Facility No:

80-8030

**Date :**

2-15-2011

Project Manager

Rick Mayer

**Staff :**

Scott McDonald

Checked w/Site Personnel PRIOR to starting work :

**Weather:**

Clear &amp; cold 15°F

PRCA #

**Work Requested****Phase****Task****Completed****Time of Arrival :**

0645

**Time of departure :**

1700

**REPORT:****Total # of Samples to be Collected**

NA

Wells for:

NA

NA

Wells for:

NA

NA

System

NA

**Laboratory:**

NA

**Work REQUESTED (Comments or Special Information)**

Sign HASP and review JSAs

Provide oversight during site mobilization and asbestos abatement activities.

Work should be conducted between the hours of 7 am and 5 pm.

Take photos of activities when applicable.

Ensure unauthorized persons stay out of safety perimeter.

Contact PM/CM prior to leaving site.

**Work COMPLETED (Comments or Special Information)**

→ Resumed set up of asbestos abatement enclosure for main area/restrooms  
 → identified approximately 10' x 10' area of suspected ACM (additional from scope)  
 → completed abatement of restrooms including 10' x 10' ceiling tiles  
 → set up abatement in primary area with negative air established  
 → Took Photos for documentation of activities  
 → Removal of Ballasts, bulbs, and thermostats

**Additional Work Suggested/Recommended for next trip****TIME LOG MUST FILL OUT**

Please enter time interval for each

	Hours	Start time - End Time	Example	Hours	Start time	End Time
Prep	—	—	Prep	0.25	7:30	7:45
Drive to site	0.25	0630 - 0645	Drive to	1	7:45	8:45
Time on site	10.25	0645 - 1700	On site	2	8:45	10:45
Drive back	0.25	1700 - 1715	Drive back	0	Went to another site	
Unload time	—	—	Unload	0.25	2:45	3:00

Total 10.75

Total 3.5

\*\* Use total for Vehicle and equipment charges on sales and rental.

LVE is onsite time only.

<b>SITE NAME</b> DEC Elmira, NY Diamond Cleaners		<b>GES Job No:</b> 06-02380
Site Facility No:	80-8030	Date : 2-16-2011
Project Manager	Rick Mayer	Staff : Scott McDonald
Checked w/Site Personnel PRIOR to starting work :		Weather: warm/sunny 50°F
PRCA #		

Work Requested	Phase	Task	Completed	Time of Arrival :	0645
Liquid Levels <input type="checkbox"/>				Time of departure :	1715
System Check <input type="checkbox"/>				REPORT:	
GW Sample <input type="checkbox"/>					
System Sample <input type="checkbox"/>				<b>Total # of Samples to be Collected</b>	
Demo <input type="checkbox"/>				NA Wells for:	NA
Drum Pickup <input type="checkbox"/>				NA Wells for:	NA
Asb. Abtmnt <input checked="" type="checkbox"/>	08	275		NA System	NA
				Laboratory:	NA

#### Work REQUESTED (Comments or Special Information)

Sign HASP and review JSAs
Provide oversight during site mobilization and asbestos abatement activities.
Work should be conducted between the hours of 7 am and 5 pm.
Take photos of activities when applicable.
Ensure unauthorized persons stay out of safety perimeter.
Contact PM/CM prior to leaving site.

#### Work COMPLETED (Comments or Special Information)

→ Removal of ACM from primary area
→ Final air samples collected from restroom area
→ Obtained approval from DEC to remove tree from property line to assist during demo removal
→ adjacent property owner approval to prop the tree on the property line
→ removed trees from perimeter of building
→ All ACM removed from inside the building

#### Additional Work Suggested/Recommended for next trip

### TIME LOG MUST FILL OUT

Please enter time interval for each

	Hours	Start time - End Time	Example	Hours	Start time	End Time
Prep	—	—	Prep	0.25	7:30	7:45
Drive to site	0.25	0630 - 0645	Drive to	1	7:45	8:45
Time on site	10.50	0645 - 1715	On site	2	8:45	10:45
Drive back	0.25	1715 - 1730	Drive back	0	Went to another site	
Unload time	—	—	Unload	0.25	2:45	3:00

Total 11.00

Total 3.5

\*\* Use total for Vehicle and equipment charges on sales and rental.  
LVE is onsite time only.

<b>SITE NAME</b> DEC Elmira, NY Diamond Cleaners		<b>GES Job No:</b> 06-02380
Site Facility No:	80-8030	Date : 2-17-2011
Project Manager	Rick Mayer	Staff : Scott McDonald
Checked w/Site Personnel PRIOR to starting work :		Weather: Clear / cool
PRCA #		

Work Requested	Phase	Task	Completed	Time of Arrival :	0645
Liquid Levels <input type="checkbox"/>				Time of departure :	1645
System Check <input type="checkbox"/>				REPORT:	
GW Sample <input type="checkbox"/>					
System Sample <input type="checkbox"/>				<b>Total # of Samples to be Collected</b>	
Demo <input type="checkbox"/>				NA Wells for:	NA
Drum Pickup <input type="checkbox"/>				NA Wells for:	NA
Asb. Abtmtnt <input checked="" type="checkbox"/>	08	275		NA System	NA
				Laboratory:	NA

#### Work REQUESTED (Comments or Special Information)

Sign HASP and review JSAs
Provide oversight during site mobilization and asbestos abatement activities.
Work should be conducted between the hours of 7 am and 5 pm.
Take photos of activities when applicable.
Ensure unauthorized persons stay out of safety perimeter.
Contact PM/CM prior to leaving site.

#### Work COMPLETED (Comments or Special Information)

→ Air samples from Lab confirmed bathroom clear of ACM
→ Veolia on site to pick up ballasts
→ Removal of window caulk ACM
→ All ACM removed
→ Final Air samples collected

#### Additional Work Suggested/Recommended for next trip

### TIME LOG MUST FILL OUT

Please enter time interval for each

	Hours	Start time - End Time	Example	Hours	Start time	End Time
Prep	—	—	Prep	0.25	7:30	7:45
Drive to site	0.25	0630 - 0645	Drive to	1	7:45	8:45
Time on site	10.00	0645 - 1645	On site	2	8:45	10:45
Drive back	0.25	1645 - 1700	Drive back	0	Went to another site	
Unload time	—	—	Unload	0.25	2:45	3:00

Total 10.50

Total 3.5

\*\* Use total for Vehicle and equipment charges on sales and rental.  
LVE is onsite time only.

<b>SITE NAME</b> DEC Elmira, NY Diamond Cleaners		<b>GES Job No:</b> 06-02380
Site Facility No:	80-8030	Date: 2-18-2011
Project Manager	Rick Mayer	Staff: Scott McDonald
Checked w/Site Personnel PRIOR to starting work:		Weather: warm / windy
PRCA #		

Work Requested	Phase	Task	Completed	Time of Arrival :	0630
Liquid Levels <input type="checkbox"/>				Time of departure :	1400
System Check <input type="checkbox"/>				REPORT:	
GW Sample <input type="checkbox"/>					
System Sample <input type="checkbox"/>				<b>Total # of Samples to be Collected</b>	
Demo <input type="checkbox"/>				NA Wells for:	NA
Drum Pickup <input type="checkbox"/>				NA Wells for:	NA
Asb. Abtmnt <input checked="" type="checkbox"/>	08	275		NA System	NA
				Laboratory:	NA

**Work REQUESTED (Comments or Special Information)**

Sign HASP and review JSAs

Provide oversight during site mobilization and asbestos abatement activities.

Work should be conducted between the hours of 7 am and 5 pm.

Take photos of activities when applicable.

Ensure unauthorized persons stay out of safety perimeter.

Contact PM/CM prior to leaving site.

**Work COMPLETED (Comments or Special Information)**

→ Removal of tree for prep of demo activities

→ All air samples came back clear

→ Removal of all ACM Prep materials - signs / Poly, etc.

→ Travel Back From site

**Additional Work Suggested/Recommended for next trip**

## TIME LOG MUST FILL OUT

Please enter time interval for each

	Hours	Start time - End Time	Example	Hours	Start time	End Time
Prep	0.25	0615 - 0630	Prep	0.25	7:30	7:45
Drive to site	0.25	0630 - 0645	Drive to	1	7:45	8:45
Time on site	7.25	0645 - 1400	On site	2	8:45	10:45
Drive back	2.00	1400 - 1600	Drive back	0	Went to another site	
Unload time	0.25	1600 - 1615	Unload	0.25	2:45	3:00

Total 10.00

Total 3.5

\*\* Use total for Vehicle and equipment charges on sales and rental.  
LVE is onsite time only.

<b>SITE NAME</b> DEC Elmira, NY Diamond Cleaners		<b>GES Job No:</b> 06-02380
Site Facility No: 80-8030		Date : 2-21-2011
Project Manager Rick Mayer		Staff : Scott McDonald
Checked w/Site Personnel PRIOR to starting work : _____		Weather: Cold w/ snow
PRCA # _____		

Work Requested	Phase	Task	Completed	Time of Arrival :	0800
Liquid Levels <input type="checkbox"/>				Time of departure :	1000
System Check <input type="checkbox"/>				REPORT:	
GW Sample <input type="checkbox"/>					
System Sample <input type="checkbox"/>				Total # of Samples to be Collected	
Demo <input type="checkbox"/>				NA Wells for:	NA
Drum Pickup <input type="checkbox"/>				NA Wells for:	NA
Asb. Abtmnt <input checked="" type="checkbox"/>	08	275		NA System	NA
				Laboratory:	NA

**Work REQUESTED (Comments or Special Information)**

Sign HASP and review JSAs
Provide oversight during site mobilization and asbestos abatement activities.
Work should be conducted between the hours of 7 am and 5 pm.
Take photos of activities when applicable.
Ensure unauthorized persons stay out of safety perimeter.
Contact PM/CM prior to leaving site.

**Work COMPLETED (Comments or Special Information)**

→ Provide oversight for the removal of ACM Dumpster
→ Travel to site - Poor weather
→ Travel Back from site

**Additional Work Suggested/Recommended for next trip**

**TIME LOG MUST FILL OUT**

Please enter time interval for each

	Hours	Start time - End Time	Example	Hours	Start time	End Time
Prep	—	—	Prep	0.25	7:30	7:45
Drive to site	2.50	0530 - 0800	Drive to	1	7:45	8:45
Time on site	2.00	0800 - 1000	On site	2	8:45	10:45
Drive back	2.00	1000 - 1200	Drive back	0	Went to another site	
Unload time	0.50	1200 - 1230	Unload	0.25	2:45	3:00

Total 7.00

Total 3.5

\*\* Use total for Vehicle and equipment charges on sales and rental.  
LVE is onsite time only.

<b>SITE NAME</b>	DEC Elmira, NY Diamond Cleaners	<b>GES Job No:</b>	06-02380
Site Facility No:	80-8030	Date :	3-7-2011
Project Manager	Rick Mayer	Staff :	Scott McDonald
Checked w/Site Personnel PRIOR to starting work :		Weather:	Cold / Snow
PRCA #			

<b>Work Requested</b>	<b>Phase</b>	<b>Task</b>	<b>Completed</b>	<b>Time of Arrival :</b>	1230
Liquid Levels <input type="checkbox"/>				<b>Time of departure :</b>	1300
System Check <input type="checkbox"/>				<b>REPORT:</b>	
GW Sample <input type="checkbox"/>					
System Sample <input type="checkbox"/>				<b>Total # of Samples to be Collected</b>	
Demo <input checked="" type="checkbox"/>	08	275		NA Wells for:	NA
Drum Pickup <input type="checkbox"/>				NA Wells for:	NA
Asb. Abtmnt <input type="checkbox"/>				NA System	NA
				<b>Laboratory:</b>	NA

#### Work REQUESTED (Comments or Special Information)

Sign HASP and review JSAs
Provide oversight during site demolition activities.
Work should be conducted between the hours of 7 am and 5 pm.
Take photos of activities when applicable.
Ensure unauthorized persons stay out of safety perimeter.
Set up perimeter particulate sampling and record results at least once per hour.
Contact PM/CM prior to leaving site.

#### Work COMPLETED (Comments or Special Information)

→ Travel to site - due to poor weather was forced off I-81 for road closure
→ Travel impacted the timing of equipment arrival for demo - will not be able to start demo today as previously planned.
→ mobilization to site for demo
→ unload air sampling devices into hotel for security

#### Additional Work Suggested/Recommended for next trip

### TIME LOG MUST FILL OUT

Please enter time interval for each

	Hours	Start time - End Time	Example	Hours	Start time	End Time
Prep	—	—	Prep	0.25	7:30	7:45
Drive to site	6.50	0600 - 1230	Drive to	1	7:45	8:45
Time on site	0.50	1230 - 1300	On site	2	8:45	10:45
Drive back	0.50	1300 - 1330	Drive back	0	Went to another site	
Unload time	0.50	1330 - 1400	Unload	0.25	2:45	3:00

Total 8.00

Total 3.5

\*\* Use total for Vehicle and equipment charges on sales and rental.  
LVE is onsite time only.

<b>SITE NAME</b> DEC Elmira, NY Diamond Cleaners		<b>GES Job No:</b> 06-02380
Site Facility No:	80-8030	Date : 3-8-2011
Project Manager	Rick Mayer	Staff : Scott McDonald
Checked w/Site Personnel PRIOR to starting work :		Weather: Cold / Clear
PRCA #		

<b>Work Requested</b>	<b>Phase</b>	<b>Task</b>	<b>Completed</b>	<b>Time of Arrival :</b> 0645
Liquid Levels <input type="checkbox"/>				<b>Time of departure :</b> 1745
System Check <input type="checkbox"/>				<b>REPORT:</b>
GW Sample <input type="checkbox"/>				
System Sample <input type="checkbox"/>				<b>Total # of Samples to be Collected</b>
Demo <input checked="" type="checkbox"/>	08	275		NA Wells for: NA
Drum Pickup <input type="checkbox"/>				NA Wells for: NA
Asb. Abtmnt <input type="checkbox"/>				NA System NA
				<b>Laboratory:</b> NA

**Work REQUESTED (Comments or Special Information)**

Sign HASP and review JSAs
Provide oversight during site demolition activities.
Work should be conducted between the hours of 7 am and 5 pm.
Take photos of activities when applicable.
Ensure unauthorized persons stay out of safety perimeter.
Set up perimeter particulate sampling and record results at least once per hour.
Contact PM/CM prior to leaving site.

**Work COMPLETED (Comments or Special Information)**

→ Conducted building demo and start of sorting debris
→ Set up air monitoring during Demo for particulates
→ Gas service capped @ building

**Additional Work Suggested/Recommended for next trip**

**TIME LOG MUST FILL OUT**

Please enter time interval for each

	Hours	Start time - End Time	Example	Hours	Start time	End Time
Prep	0.50	0600 - 0630	Prep	0.25	7:30	7:45
Drive to site	0.25	0630 - 0645	Drive to	1	7:45	8:45
Time on site	11.00	0645 - 1745	On site	2	8:45	10:45
Drive back	0.25	1745 - 1800	Drive back	0	Went to another site	
Unload time	-	-	Unload	0.25	2:45	3:00

Total 12.0

Total 3.5

\*\* Use total for Vehicle and equipment charges on sales and rental.  
LVE is onsite time only.



<b>SITE NAME</b> DEC Elmira, NY Diamond Cleaners		<b>GES Job No:</b> 06-02380
Site Facility No:	80-8030	Date: 3-9-2011
Project Manager	Rick Mayer	Staff: Scott McDonald
Checked w/Site Personnel PRIOR to starting work: _____		Weather: windy / cold $\approx 30^{\circ}\text{F}$
PRCA #	_____	

Work Requested	Phase	Task	Completed	Time of Arrival :	0630
Liquid Levels <input type="checkbox"/>	_____	_____	_____	Time of departure :	1745
System Check <input type="checkbox"/>	_____	_____	_____	REPORT:	_____
GW Sample <input type="checkbox"/>	_____	_____	_____		
System Sample <input type="checkbox"/>	_____	_____	_____	<b>Total # of Samples to be Collected</b>	
Demo <input checked="" type="checkbox"/>	08	275	_____	NA Wells for:	NA
Drum Pickup <input type="checkbox"/>	_____	_____	_____	NA Wells for:	NA
Asb. Abtmnt <input type="checkbox"/>	_____	_____	_____	NA System	NA
				Laboratory:	NA

**Work REQUESTED (Comments or Special Information)**

Sign HASP and review JSAs
Provide oversight during site demolition activities.
Work should be conducted between the hours of 7 am and 5 pm.
Take photos of activities when applicable.
Ensure unauthorized persons stay out of safety perimeter.
Set up perimeter particulate sampling and record results at least once per hour.
Contact PM/CM prior to leaving site.

**Work COMPLETED (Comments or Special Information)**

→ Sorting of demo debris and loading into trucks for disposal
→ 5 trucks w/ CSD material left site today
→ Transfer Air monitoring devices to R. Mayer for Dansville demo use

**Additional Work Suggested/Recommended for next trip**

**TIME LOG MUST FILL OUT**

Please enter time interval for each

	Hours	Start time - End Time	Example	Hours	Start time	End Time
Prep	0.50	0600 - 0630	Prep	0.25	7:30	7:45
Drive to site	0.50	0630 - 0700	Drive to	1	7:45	8:45
Time on site	10.75	0700 - 1745	On site	2	8:45	10:45
Drive back	0.25	1745 - 1800	Drive back	0	Went to another site	
Unload time	0.50	1800 - 1830	Unload	0.25	2:45	3:00

Total 12.50

Total 3.5

\*\* Use total for Vehicle and equipment charges on sales and rental.  
LVE is onsite time only.

<b>SITE NAME</b> DEC Elmira, NY Diamond Cleaners		<b>GES Job No:</b> 06-02380
Site Facility No:	80-8030	Date : 3-10-2011
Project Manager	Rick Mayer	Staff : Scott McDonald
Checked w/Site Personnel PRIOR to starting work :		Weather: Cloudy w/rain 40°F
PRCA #		

<b>Work Requested</b>	<b>Phase</b>	<b>Task</b>	<b>Completed</b>	<b>Time of Arrival :</b> 0630
Liquid Levels <input type="checkbox"/>				<b>Time of departure :</b> 1445
System Check <input type="checkbox"/>				<b>REPORT:</b>
GW Sample <input type="checkbox"/>				
System Sample <input type="checkbox"/>				<b>Total # of Samples to be Collected</b>
Demo <input checked="" type="checkbox"/>	08	275		NA Wells for: NA
Drum Pickup <input type="checkbox"/>				NA Wells for: NA
Asb. Abtmnt <input type="checkbox"/>				NA System NA
				<b>Laboratory:</b> NA

**Work REQUESTED (Comments or Special Information)**

Sign HASP and review JSAs

Provide oversight during site demolition activities.

Work should be conducted between the hours of 7 am and 5 pm.

Take photos of activities when applicable.

Ensure unauthorized persons stay out of safety perimeter.

Set up perimeter particulate sampling and record results at least once per hour.

Contact PM/CM prior to leaving site.

**Work COMPLETED (Comments or Special Information)**

→ Removal of all Demo Debris from site

→ Discuss site safety - DEC approves snow fence install

**Additional Work Suggested/Recommended for next trip**

## TIME LOG MUST FILL OUT

Please enter time interval for each

	Hours	Start time - End Time	Example	Hours	Start time	End Time
Prep	—	—	Prep	0.25	7:30	7:45
Drive to site	0.25	0600 - 0630	Drive to	1	7:45	8:45
Time on site	8.25	0630 - 1445	On site	2	8:45	10:45
Drive back	0.25	1445 - 1500	Drive back	0	Went to another site	
Unload time	—	—	Unload	0.25	2:45	3:00

Total 9.0

Total 3.5

\*\* Use total for Vehicle and equipment charges on sales and rental.  
LVE is onsite time only.

<b>SITE NAME</b> DEC Elmira, NY Diamond Cleaners		<b>GES Job No:</b> 06-02380
Site Facility No:	80-8030	Date : 3-11-2011
Project Manager	Rick Mayer	Staff : Scott McDonald
Checked w/Site Personnel PRIOR to starting work : _____		Weather: _____
PRCA #	_____	

Work Requested	Phase	Task	Completed	Time of Arrival :	0700
Liquid Levels <input type="checkbox"/>				Time of departure :	1230
System Check <input type="checkbox"/>				REPORT:	
GW Sample <input type="checkbox"/>					
System Sample <input type="checkbox"/>				<b>Total # of Samples to be Collected</b>	
Demo <input checked="" type="checkbox"/>	08	275		NA Wells for:	NA
Drum Pickup <input type="checkbox"/>				NA Wells for:	NA
Asb. Abtmnt <input type="checkbox"/>				NA System	NA
				Laboratory:	NA

**Work REQUESTED (Comments or Special Information)**

Sign HASP and review JSAs
Provide oversight during site demolition activities.
Work should be conducted between the hours of 7 am and 5 pm.
Take photos of activities when applicable.
Ensure unauthorized persons stay out of safety perimeter.
Set up perimeter particulate sampling and record results at least once per hour.
Contact PM/CM prior to leaving site.

**Work COMPLETED (Comments or Special Information)**

→ removal of final Dumpster
→ set up snow fence around perimeter of slab
→ Demob from site

**Additional Work Suggested/Recommended for next trip**

**TIME LOG MUST FILL OUT**

Please enter time interval for each

	Hours	Start time - End Time	Example	Hours	Start time	End Time
Prep	—	—	Prep	0.25	7:30	7:45
Drive to site	0.50	0630 - 0700	Drive to	1	7:45	8:45
Time on site	4.50	0700 - 1230	On site	2	8:45	10:45
Drive back	0	Went to another site	Drive back	0	Went to another site	
Unload time			Unload	0.25	2:45	3:00

Total 5.0

Total 3.5

\*\* Use total for Vehicle and equipment charges on sales and rental.  
LVE is onsite time only.

## **APENDIX C – Waste Manifests and Weigh Tickets**

---

## WASTE SHIPMENT RECORD

REPORT DATE

Abs/

GENERATOR	1. Work-site name and mailing address NYS DEC DER JOB #11023 625 BROADWAY ALBANY, NY 12233		Owner's Name NYS DEC "SEE BELOW"		Owner's telephone no. (518) 402-9819
	2. Operator's name and address ABSCOPE ENVIRONMENTAL, INC. - PROFILE #506306 1 COMMERCIAL DRIVE CANASTOTA, NY 13032				Operator's telephone no. (315) 697-8437
	3. Waste Disposal Site (WDS) Name HIGH ACRES LANDFILL Mailing Address 425 PERINTON PARKWAY FAIRPORT, NY 14450 Physical Site Location 425 PERINTON PKWY, FAIRPORT, NY		WDS telephone no. 585-223-6132 Additional Information FORMER DIAMOND CLEANERS 717 LAKE STREET ELMIRA, NY 14909		
	4. Name and address of responsible agency USEPA, REGION II 26 FEDERAL PLAZA NEW YORK, NY 10278				
	5. Description of materials RQ, ASBESTOS, 9, NA2212, III FRIABLE PLASTER		6. Containers No. 5 Type OP BR		7. Total quantity m³ (yd³) 34d 3 APPROX 34d 3 APPROX
TRANSPORTER	8. Special handling instructions and additional information				
	9. OPERATOR'S CERTIFICATION: I hereby declare that the contents of this consignment are fully and accurately described above by proper shipping name and are classified, packed, marked, and labeled, and are in all respects in proper condition for transport by highway according to applicable international and government regulations.				
	Printed/typed name & title EDNA ESBT SUPERVISOR		Signature [Signature]		Month Day Year 2/17/11
TRANSPORTER	10. Transporter 1 (Acknowledgment of receipt of materials) Printed/typed name & title William F. Blumenfeld Address and telephone no. 1 COMMERCIAL DRIVE CANASTOTA, NY 13032 315-697-8437		Signature [Signature]		Month Day Year 2/17/2011
	11. Transporter 2 (Acknowledgment of receipt of materials) Printed/typed name & title William F. Blumenfeld Address and telephone no. ABSCOPE ENVIRONMENTAL 1 COMMERCIAL DRIVE CANASTOTA, NY 13032		Signature [Signature]		Month Day Year 2/18/2011
DISPOSAL SITE	12. Discrepancy indication space GPS 021 N 43° 05' 07" W 077° 22' 61" ELEV 556				
	13. Waste disposal site owner or operator: Certification of receipt of asbestos materials covered by this manifest except as noted in Item 12.		Grid Coordinates East North El		
	Printed/typed name & title [Signature]		Signature [Signature]		Month Day Year 2/18/11

GENERATOR

204-FS-C6  
Rev. 6/94



High Acres LF  
425 Perinton Pkwy  
Fairport, NY, 14450  
Ph: (585) 223-6132

Original  
Ticket# 820806

Customer Name ABSCOPE-FRIABLE ABSCOPE-50630 Carrier ABS ABSCOPE ENVIRONMENTAL  
Ticket Date 02/18/2011 Vehicle# 1  
Payment Type Credit Account Container  
Manual Ticket# Driver  
Hauling Ticket# Check#  
Route Billing # 0001835  
State Waste Code Gen EPA ID  
Manifest 11023 Grid CELL 10  
Destination  
Profile 506306 (ABSCOPE-FRIABLE)  
Generator 190-ABSCOPEVARIOUS ABSCOPE ENV-VARIOUS GENERATORS

Time	Scale	Operator	Inbound	Gross	Net	Tons
In 02/18/2011 09:39:35	A Scale 1	sayra		10240 lb		
Out 02/18/2011 10:00:46	B Scale 2	SAYRA		8780 lb		
					1460 lb	
						0.73

Comments

Product	LD%	Qty	UOM	Rate	Fee	Amount	Origin
1 Asb Friable Tons A 100		0.73	Tons	11023	11001.01		MAD
2 FUEL-Fuel Surcharg 100		%		11017			MAD
3 EVF-P-Standard Env 100		%		11029			MAD
				11001.02			
				11031			
				11017			

Driver's Signature

*William J. [Signature]*

Total Ticket

Total Fees



## WASTE SHIPMENT RECORD

REPORT DATE

135  
26

GENERATOR	1. Work site name and mailing address NYS DEC DER JOB #11023 625 BROADWAY ALBANY, NY 12233		Owner's Name NYS DEC "SEE BELOW"		Owner's telephone no. (518) 402-9819	
	2. Operator's name and address ABSCOPE ENVIRONMENTAL, INC. PROFILE #103790NY 1 COMMERCIAL DRIVE CANASTOTA, NY 13032				Operator's telephone no. (315) 697-8437	
	3. Waste Disposal Site (WDS) Name HIGH ACRES LANDFILL Mailing Address 425 PERINTON PARKWAY FAIRPORT, NY 14450 Physical Site Location 425 PERINTON PKWY, FAIRPORT, NY		WDS telephone no. 585-223-6132		Additional Information WORK SITE: FORMER DIAMOND CLEANERS 717 LAKE STREET ELMIRA, NY 14909	
	4. Name and address of responsible agency					
	5. Description of materials NON FRIABLE VAT, MASTIC, TRANSITE, ROOFING ROOF FLASHING, WINDOW CAULK, GLAZING		6. Containers No. Type 28 BH 80 DP		7. Total quantity m <sup>3</sup> (yd <sup>3</sup> ) 500/3 APRIL 800/3 APRIL	
8. Special handling instructions and additional information						
9. OPERATOR'S CERTIFICATION: I hereby declare that the contents of this consignment are fully and accurately described above by proper shipping name and are classified, packed, marked, and labeled, and are in all respects in proper condition for transport by highway according to applicable international and government regulations. S. J. Mebit on behalf of NYS DEC Ed NESBIT SUPERVISOR Signature: Ed Mebit Month Day Year: 2/21/11 2/18/11						
TRANSPORTER	10. Transporter 1 (Acknowledgment of receipt of materials)					
	Printed/typed name & title GERALD GRAVEN Truck driver		Signature Gerald Graven		Month Day Year 2-21-11	
	Address and telephone no. 1 COMMERCIAL DRIVE CANASTOTA, NY 13032 315-697-8437					
TRANSPORTER	11. Transporter 2 (Acknowledgment of receipt of materials)					
	Printed/typed name & title		Signature		Month Day Year	
	Address and telephone no.					
DISPOSAL SITE	12. Discrepancy indication space					
	13. Waste disposal site owner or operator: Certification of receipt of asbestos materials covered by this manifest except as noted in Item 12.				Grid Coordinates East North El	
	Printed/typed name & title Mary Maloney		Signature Mary Maloney		Month Day Year 02 21 11	

ORIGINAL RETURN TO GENERATOR

204-FS-C6  
Rev. 6/94



High Acres LF  
425 Perinton Pkwy  
Fairport, NY, 14450  
Ph: (585) 223-6132

Original  
Ticket# 820945

Customer Name ABSCOPEENVREG-103790NY ABS COP Carrier ABS ABSCOPE ENVIRONMENTAL  
Ticket Date 02/21/2011 Vehicle# 26 Volume  
Payment Type Credit Account Container  
Manual Ticket# Driver  
Hauling Ticket# Check#  
Route Billing # 0005192  
State Waste Code Gen EPA ID  
Manifest 11023 Grid CELL 10  
Destination  
PO 11023  
Profile 103790NY (NON FRIABLE ASBESTOS)  
Generator 190-ABSCOPEVARIOUS ABSCOPE ENV-VARIOUS GENERATORS

	Time	Scale	Operator	Inbound	Gross	
In	02/21/2011 11:53:52	A_Scale_1	mmaloney		Tare	35500 lb
Out	02/21/2011 12:09:50	B_Scale_2	MMALONEY		Net	32100 lb
					Tons	3480 lb
Comments						1.74

	Product	LD%	Qty	UOM	Rate	Fee	Amount	Origin
1	Asb Non Fri-Tons-A 100		1.74	Tons				MAD
2	FUEL-Fuel Surcharg 100			%				MAD
3	EVF-P-Standard Env 100			%				MAD

11023

Driver's Signature

Total Fees  
Total Ticket





UNIFORM HAZARDOUS WASTE MANIFEST		1. Generator ID Number	2. Page 1 of	3. Emergency Response Phone	4. Manifest Tracking Number	
		NYSCESSG	1	(877) 818-0087	000466450 VES	
5. Generator's Name and Mailing Address		Generator's Site Address (if different than mailing address)				
NYSDEC DER 717 LAKE STREET ELMIRA, NY 14901		SAME				
Generator's Phone: 518 402-9814						
6. Transporter 1 Company Name		U.S. EPA ID Number				
VEOLIA ES TECHNICAL SOLUTIONS		NJ D 0 8 0 8 3 1 3 8 0				
7. Transporter 2 Company Name		U.S. EPA ID Number				
VEOLIN ES Industrial Services		TXR0000 77970				
8. Designated Facility Name and Site Address		U.S. EPA ID Number				
VEOLIA ES TECHNICAL SOLUTIONS 230 CANTON STREET						
Facility's Phone: 781 341-8080		STOUGHTON, MA 02072		MA 5 0 0 0 0 0 4 7 1 3		
9a. HM	9b. U.S. DOT Description (including Proper Shipping Name, Hazard Class, ID Number, and Packing Group (if any))	10. Containers No.	Type	11. Total Quantity	12. Unit Wt./Vol.	13. Waste Codes
X	1. UN3432, POLYCHLORINATED BIPHENYLS, SOLID, (NON-LEAKING PCB BALLASTS), 9, III, RQ (PCB'S RQ=1LB)	0 0 1	D M	0 0 3 6 2	K	MADG R
	2.					
	3.					
	4.					
14. Special Handling Instructions and Additional Information						
1) ERG: 171 W: 185604 A: GRT 185604 -I- ADDENDUM ATTACHED FOR ADDITIONAL TSCA INFORMATION **NEED CERT OF DISPOSAL** VEOLIA PERMIT#NJ410**ER SERVICES CONTRACTED BY VESTS** INDICATE VES TONALANCA NY Actual weight is 77K (100) 0502/15/11						
15. GENERATOR'S/OFFEROR'S CERTIFICATION: I hereby declare that the contents of this consignment are fully and accurately described above by the proper shipping name, and are classified, packaged, marked and labeled/placarded, and are in all respects in proper condition for transport according to applicable international and national governmental regulations. If export shipment and I am the Primary Exporter, I certify that the contents of this consignment conform to the terms of the attached EPA Acknowledgment of Consent. I certify that the waste minimization statement identified in 40 CFR 262.27(a) (if I am a large quantity generator) or (b) (if I am a small quantity generator) is true.						
Generator's/Offor's Printed/Typed Name		Signature		Month Day Year		
Scott McDonald on behalf of NYSDEC		[Signature]		0 2 1 7 1 1		
16. International Shipments <input type="checkbox"/> Import to U.S. <input type="checkbox"/> Export from U.S. Port of entry/exit: Date leaving U.S.:						
17. Transporter Acknowledgment of Receipt of Materials						
Transporter 1 Printed/Typed Name		Signature		Month Day Year		
WARREN SAVAGE		[Signature]		0 2 1 7 1 1		
Transporter 2 Printed/Typed Name		Signature		Month Day Year		
Ray Rickman		[Signature]		02/17/11		
18. Discrepancy						
18a. Discrepancy Indication Space <input type="checkbox"/> Quantity <input type="checkbox"/> Type <input type="checkbox"/> Residue <input type="checkbox"/> Partial Rejection <input type="checkbox"/> Full Rejection						
18b. Alternate Facility (or Generator) Manifest Reference Number: U.S. EPA ID Number						
Facility's Phone:						
18c. Signature of Alternate Facility (or Generator) Month Day Year						
19. Hazardous Waste Report Management Method Codes (i.e., codes for hazardous waste treatment, disposal, and recycling systems)						
1. H039		2.		3.		4.
20. Designated Facility Owner or Operator: Certification of receipt of hazardous materials covered by the manifest, except as noted in Item 18a						
Printed/Typed Name		Signature		Month Day Year		
JOHN MARIAN		[Signature]		02/18/11		



## Certificate of Recycling and/or Disposal

*This certificate certifies that the waste described below has been properly recycled and/or disposed in accordance with state, federal and local regulations. The document number shown below should be used when inquiring about any issues with the proper handling, recycling and/or disposal of the waste.*

**CUSTOMER:**

VEOLIA ES TECHNICAL SOLUTIONS, L.L.C.  
4400 RIVER ROAD

TONAWANDA, NY 14150

**GENERATOR:**

NYSDEC DER  
717 LAKE STREET

ELMIRA, NY 14901

**WASTE RECYCLED AND/OR DISPOSED:**Description

Recycle/Incineration - PCB Ballast

Quantity

77

Unit of Measure

K

Container Number

13643890001

**FACILITY:**

VEOLIA ES TECHNICAL SOLUTIONS, L.L.C. STOUGHTON, MA 02072 MA5000004713

**RECEIVED DATE:**

2/18/2011

**SO#**

530784

**DOCUMENT#:**

D736264

**SHIPPING PAPER:**

000466450VES



PAUL CONCA

OPERATIONS MANAGER

**SPS****Solvents and Petroleum Service, Inc.**1405 BREWERTON ROAD  
SYRACUSE, NEW YORK 13208PHONE (315) 454-4467 FAX (315) 454-8230  
www.solventsandpetroleum.com**443122**

Page 1

Order Date 2/17/11	Requested Date 2/17/11	P.O. Number NYS DEC	Customer Phone Number 697-8437
-----------------------	---------------------------	------------------------	-----------------------------------

**SOLD TO:**ABSCOPE ENVIRONMENTAL, INC.  
P.O. BOX 487  
CANASTOTA, N.Y. 13032**Ship To:**NYS DEC  
717 LAKE STREET  
ELMIRA, NY 14909

ROB CELL 382-2778

**Drivers Instructions/Notes:**

Driver: _____	Date: <u>2/17/11</u>	Customer: <u>X Peter Connor</u>
---------------	----------------------	---------------------------------

Empty Drums Returned: \_\_\_\_\_

**Product Description****DOT Description****Loc****Quantity Unit**UNIVERSAL WASTE LAMPS  
(1) 4-foot & (1) 8-footUNIVERSAL WASTE LAMP NON-DOT  
REGULATED; LAMPS BULBS, TUBES  
SCRAP-HAVING VALUE ONLY FOR  
RECLAMATION  
ACCUM. START DATE \_\_\_\_\_

NI

UNIT

THERMOSTAT (1) UNIT IN BUBBLE  
WRAP IN 5-G PAILUNIVERSAL WASTE//SPENT MERCURY  
DEVICES

NI

1.00 PAIL

1/5 G POLY PAIL W/SCREW ON LID

NI

1.00 PAIL

(1) HID bulb

CHEMICAL EMERGENCY # 1-800-315-4467 PRESS 4



environmental, inc.

1 Commercial Dr.  
PO Box 487  
Canastota, NY 13032  
(315) 697-8437  
FAX (315) 697-9391

DOCUMENT 1303

AEI JOB NO. 11810

STRAIGHT BILL OF LADING

NYSDEC 364 Permit No. 7A-369

TRANSPORTER 1 ABSCOPE ENVIRONMENTAL, INC.  
EPA ID # NY0000097444

VEHICLE ID #  
TRANS. 1 PHONE 315-697-8437

TRANSPORTER 2  
EPA ID #

VEHICLE ID #  
TRANS. 2 PHONE

DESIGNATED FACILITY SOLVENTS & PETROLEUM SERVICES			GENERATOR NYS DEC DER		
FACILITY EPA ID # NYD013277454			GENERATOR EPA ID# N/A		
ADDRESS 1405 BREWERTON ROAD			ADDRESS 717 LAKE STREET		
CITY SYRACUSE		STATE NY	ZIP	CITY ELMIRA	STATE NY
CONTAINERS NO. & SIZE		TYPE	HM	DESCRIPTION OF MATERIALS	TOTAL QUANTITY
30		BX		A. UNIVERSAL WASTE USED FLOURESCENT LAMPS	30 cwt.
1		BX		B. UNIVERSAL WASTE SPENT MERCURY DEVICES	5(cwt)
				C.	
				D.	
				E.	
				F.	
SPECIAL HANDLING INSTRUCTIONS EMERGENCY NUMBER 1-800-424-9300 CHEMTREC 1-4 ft 1-HID 1-8 ft 1-Thermostat					
TIME DEPARTED SHOP _____ TIME ON SITE _____ TIME LEFT SITE _____ TIME RETURN TO SHOP _____					
CUSTOMER SIGNATURE _____					

SHIPPERS CERTIFICATION: This is to certify that the above named materials are properly classified, described, packaged, marked and labeled and are in proper condition for transportation according to the applicable regulations of the Department of Transportation.

SHIPPER	PRINT Scott McDonald on Behalf of NYSDEC	SIGN Scott McDonald	DATE 2/15/11
TRANSPORTER 1	PRINT Rob D. Weber	SIGN Rob D. Weber	DATE 2-15-11
TRANSPORTER 2	PRINT Robert Conner	SIGN Robert Conner	DATE 2-17-11
RECEIVED BY	PRINT Georgia Weill	SIGN Georgia Weill	DATE 2/17/11

WHITE - OFFICE YELLOW - OFFICE PINK - TSDF GOLD - GENERATOR

In behalf of SPs

HAKES C & D LANDFILL  
4376 MANNING RIDGE ROAD  
PAINTED POST, NY 14870  
LICENSE#460031

TICKET: 112980  
DATE: 03/10/2011  
TIME: 08:47 - 09:14

CUSTOMER: 84-00289 / ABSCOPE ENVIRONMENTAL  
HAULCUST: WO: 0 APPROVAL #:

ORIGIN: CHEMUNG / CHEMUNG, NY

TRUCK: RIC001

GENERATOR: NA / NOT APPLICABLE TRAILER: PROFILE #: NA

HAULER: RIC / RICCELLI

COMMENT: 717 lake street letter on file 1311 ROUTE: NA / NOT APPLICABLE

MATERIAL

CD / CONSTRUCTION DEBRIS

QUANTITY UNIT  
29.7900 ST

P.O.:

GROSS: 102320 LBS

TARE: 42740 LBS

NET: 59580 LBS

CELL/TANK: CELL 5-6

I Certify under penalty of perjury that I am familiar with wastes  
authorized at this facility and that to the best of my knowledge all  
waste contained in this load is authorized for disposal at this facility.  
Driver: Ray Weighmaster: Shelley Shelley

IN: Shelley (600454) B: PCSCALE-HA

OUT: Shelley (600454) B: PCSCALE-HA





environmental, inc.

1 Commercial Dr.  
PO Box 487  
Canastota, NY 13032  
(315) 697-8437  
FAX (315) 697-9391

DOCUMENT 1311

AEI JOB NO. 11810

NYSDEC 364 Permit No. 7A-402

STRAIGHT BILL OF LADING

RICCELLI ENTERPRISES, INC.

TRANSPORTER 1

EPA ID #

VEHICLE ID #

TRANS. 1 PHONE

TRANSPORTER 2

EPA ID #

VEHICLE ID #

TRANS. 2 PHONE

DESIGNATED FACILITY HARES LANDFILL			GENERATOR NYS DEC DER			
FACILITY EPA ID # N/A			GENERATOR EPA ID# N/A			
ADDRESS 4376 MANNING RIDGE ROAD			ADDRESS 717 LAKE STREET			
CITY PAINTED POST		STATE NY	ZIP 14870	CITY ELKIRA	STATE NY	ZIP 14800
CONTAINERS NO. & SIZE	TYPE	HM	DESCRIPTION OF MATERIALS		TOTAL QUANTITY	UNIT WT/VOL
	DT	11	A. CONSTRUCTION & DEMOLITION DEBRIS NON HAZARDOUS N399		37	TONS
			B.			
			C.			
			D.			
			E.			
			F.			
SPECIAL HANDLING INSTRUCTIONS EMERGENCY NUMBER 1-800-424-9300 CHENTREC						
TIME DEPARTED SHOP _____ TIME ON SITE _____ TIME LEFT SITE _____ TIME RETURN TO SHOP _____						
CUSTOMER SIGNATURE _____						

SHIPPERS CERTIFICATION: This is to certify that the above named materials are properly classified, described, packaged, marked and labeled and are in proper condition for transportation according to the applicable regulations of the Department of Transportation.

SHIPPER	PRINT	SIGN	DATE
TRANSPORTER 1	PRINT	SIGN	DATE
TRANSPORTER 2	PRINT	SIGN	DATE
RECEIVED BY	PRINT	SIGN	DATE

WHITE - OFFICE YELLOW - OFFICE PINK - TSDF GOLD - GENERATOR

HAKESTON LANDFILL  
4376 MANNING RIDGE ROAD  
PAINTED POST, NY 14870  
LICENSE#460031

TICKET: 113002  
DATE: 03/10/2011  
TIME: 10:59 - 11:42

CUSTOMER: 84-00289 / ABSCOPE ENVIRONMENTAL

HAULCUST: WO: 0 APPROVAL #:

ORIGIN: CHEMUNG / CHEMUNG, NY

TRUCK: RIC001

TRAILER:

GENERATOR: NA / NOT APPLICABLE PROFILE #: NA

HAULER: RIC / RICCELLI

ROUTE: NA / NOT APPLICABLE

COMMENT: 717 lake street letter on file 1313

CELL/TANK: CELL 5-6

MATERIAL

QUANTITY UNIT

CD / CONSTRUCTION DEBRIS

33.7100 ST

I Certify under penalty of perjury that I am familiar with wastes  
authorized at this facility and that to the best of my knowledge all  
waste contained in this load is authorized for disposal at this facility.

Driver: BM

Weighmaster: Shelley

IN: Shelley (600454) B: PCSCALE-HA

OUT: Shelley (600454) B: PCSCALE-HA



environmental, inc.

1 Commercial Dr.  
PO Box 487  
Canastota, NY 13032  
(315) 697-8437  
FAX (315) 697-9391

Ric 801  
DOCUMENT 1313

STRAIGHT BILL OF LADING

AEI JOB NO. 11810

NYSDEC 364 Permit No. 7A-402

TRANSPORTER 1 RICCELLI ENTERPRISES, INC.  
EPA ID # N/A

VEHICLE ID # (801) 2139-RB  
TRANS. 1 PHONE 315-433-5115

TRANSPORTER 2  
EPA ID #

VEHICLE ID #  
TRANS. 2 PHONE

DESIGNATED FACILITY HAKES LANDFILL			GENERATOR HYS DEC DER		
FACILITY EPA ID # N/A			GENERATOR EPA ID# N/A		
ADDRESS 4276 HANNING RIDGE ROAD			ADDRESS 717 LAKE STREET		
CITY PAINTED POST		STATE NY	ZIP 14870	CITY ELMIRA	
STATE NY		ZIP 14909			
CONTAINERS NO. & SIZE	TYPE	HM	DESCRIPTION OF MATERIALS	TOTAL QUANTITY	UNIT WT/VOL
	OT	N	A. CONSTRUCTION & DEMOLITION DEBRIS NON HAZARDOUS WOOD	37	TONS
			B.		
			C.		
			D.		
			E.		
			F.		
SPECIAL HANDLING INSTRUCTIONS EMERGENCY NUMBER 1-800-424-9300 CHEMTREC					
TIME DEPARTED SHOP _____ TIME ON SITE _____ TIME LEFT SITE _____ TIME RETURN TO SHOP _____					
CUSTOMER SIGNATURE <i>[Signature]</i> N/A					

Hakes C&D Disposal, Inc.  
is not bound by any disclaimers  
that appear in this document.

SHIPPERS CERTIFICATION: This is to certify that the above named materials are properly classified, described, packaged, marked and labeled and are in proper condition for transportation according to the applicable regulations of the Department of Transportation.

SHIPPER	PRINT <i>[Signature]</i>	SIGN <i>[Signature]</i>	DATE 3/10/11
TRANSPORTER 1	PRINT Tom Rocken	SIGN <i>[Signature]</i>	DATE 3/10/11
TRANSPORTER 2	PRINT	SIGN	DATE
RECEIVED BY	PRINT Shelle Lawrence	SIGN <i>[Signature]</i>	DATE 3/10/11

WHITE - OFFICE YELLOW - OFFICE PINK - TSDF GOLD - GENERATOR



HAKES C&D LANDFILL  
4376 MANNING RIDGE ROAD  
PAINTED POST, NY 14870  
LICENSE#460031

TICKET: 112995  
DATE: 03/10/2011  
TIME: 10:38 - 11:07

CUSTOMER: 84-00289 / ABSCOPE ENVIRONMENTAL  
HAULCUST: WO: 0 APPROVAL #:

ORIGIN: CHEMUNG / CHEMUNG, NY

TRUCK: RIC825

TRAILER:

GENERATOR: NA / NOT APPLICABLE PROFILE #: NA

HAULER: RIC / RICCELLI

ROUTE: NA / NOT APPLICABLE

COMMENT: 717 lake street letter on file 1312

CELL/TANK: CELL 5-6

MATERIAL

CD / CONSTRUCTION DEBRIS

QUANTITY	UNIT
31.5000	ST

I Certify under penalty of perjury that I am familiar with wastes  
authorized at this facility and that to the best of my knowledge all  
waste contained in this load is authorized for disposal at this facility.  
Driver: *Shelley* Weighmaster: *Shelley*

IN: Shelley (600454) B: PCSCALE-HA

OUT: Shelley (600454) B: PCSCALE-HA



environmental, inc.

1 Commercial Dr.  
PO Box 487  
Canastota, NY 13032  
(315) 697-8437  
FAX (315) 697-8391

DOCUMENT 1312

AEI JOB NO. 11810

STRAIGHT BILL OF LADING

NYSDEC 364 Permit No. 7A-402

TRANSPORTER 1 RICCELLI ENTERPRISES, INC.  
EPA ID # N/A

VEHICLE ID # (825) 96411-PA  
TRANS. 1 PHONE 315-433-3113

TRANSPORTER 2  
EPA ID #

VEHICLE ID #  
TRANS. 2 PHONE

DESIGNATED FACILITY HAKES LANDFILL			GENERATOR NYS DEC DER		
FACILITY EPA ID # N/A			GENERATOR EPA ID# N/A		
ADDRESS 4376 HARRING RIDGE ROAD			ADDRESS 717 LAKE STREET		
CITY PAINTED POST		STATE NY	ZIP 14170	CITY ELMIRA	
STATE NY		ZIP 14905			
CONTAINERS NO. & SIZE	TYPE	HM	DESCRIPTION OF MATERIALS	TOTAL QUANTITY	UNIT WT/VOL
	BT	N	A. CONSTRUCTION & DEMOLITION DEBRIS NON HAZARDOUS WASTE	37	TONS
			B.		
			C.		
			D.		
			E.		
			F.		

Hakes C&D Disposal, Inc.  
is not bound by any disclaimers  
that appear in this document.

SPECIAL HANDLING INSTRUCTIONS EMERGENCY NUMBER 1-800-424-9300 CHEMTREC

TIME DEPARTED SHOP \_\_\_\_\_ TIME ON SITE \_\_\_\_\_ TIME LEFT SITE \_\_\_\_\_ TIME RETURN TO SHOP \_\_\_\_\_

CUSTOMER SIGNATURE *[Signature]*

SHIPPERS CERTIFICATION: This is to certify that the above named materials are properly classified, described, packaged, marked and labeled and are in proper condition for transportation according to the applicable regulations of the Department of Transportation.

SHIPPER	PRINT <i>[Signature]</i>	SIGN <i>[Signature]</i>	DATE 3/10/11
TRANSPORTER 1	PRINT ARON MURRAY	SIGN <i>[Signature]</i>	DATE 3-10-11
TRANSPORTER 2	PRINT <i>[Signature]</i>	SIGN <i>[Signature]</i>	DATE
RECEIVED BY	PRINT Shelle Lourenco	SIGN <i>[Signature]</i>	DATE 3/10/11

WHITE - OFFICE YELLOW - OFFICE PINK - TSDF GOLD - GENERATOR

HAKE'S C & S LANDFILL  
4376 MANNING RIDGE ROAD  
PAINTED POST, NY 14870  
LICENSE#460031

11670261  
TICKET: 112971  
DATE: 03/10/2011  
TIME: 08:16 - 08:39

CUSTOMER: 84-00289 / ABSCOPE ENVIRONMENTAL

HAULCUST: WO: 0 APPROVAL #:

ORIGIN: CHEMUNG / CHEMUNG, NY

TRUCK: RIC825

TRAILER:

GENERATOR: NA / NOT APPLICABLE PROFILE #: NA

HAULER: RIC / RICCELLI

ROUTE: NA / NOT APPLICABLE

COMMENT: 717 lake street letter on file 1310

CELL/TANK: CELL 5-6

MATERIAL	QUANTITY	UNIT
----------	----------	------

CD / CONSTRUCTION DEBRIS	29.9000	BT
--------------------------	---------	----

I Certify under penalty of perjury that I am familiar with wastes  
authorized at this facility and that to the best of my knowledge all  
waste contained in this load is authorized for disposal at this facility.  
Driver: Clayton Muckey Weighmaster: Shelley

IN: Shelley (600454) B: PCSCALE-HA

OUT: Shelley (600454) B: PCSCALE-HA





environmental, inc.

1 Commercial Dr.  
PO Box 487  
Canastota, NY 13032  
(315) 697-8437  
FAX (315) 697-9391

TRK 825  
DOCUMENT 1310

AEI JOB NO. 11810

NYSDEC 384 Permit No. 7A-402

### STRAIGHT BILL OF LADING

TRANSPORTER 1 RICCELLI ENTERPRISES, INC.  
EPA ID # N/A

VEHICLE ID # 525 (964) 111  
TRANS. 1 PHONE 315-433-5110

TRANSPORTER 2 \_\_\_\_\_  
EPA ID # \_\_\_\_\_

VEHICLE ID # \_\_\_\_\_  
TRANS. 2 PHONE \_\_\_\_\_

DESIGNATED FACILITY HALES LANDFILL			GENERATOR NYS DEC DER		
FACILITY EPA ID # N/A			GENERATOR EPA ID# N/A		
ADDRESS 4375 HANNING RIDGE ROAD			ADDRESS 717 LAKE STREET		
CITY PAINTED POST		STATE NY	ZIP 14270	CITY ELMIRA	
STATE NY		ZIP 14909			
CONTAINERS NO. & SIZE	TYPE	HM	DESCRIPTION OF MATERIALS	TOTAL QUANTITY	UNIT WT/VOL
	DT	N	A. CONSTRUCTION & DEMOLITION DEBRIS NON HAZARDOUS 1995	37	TONS
			B.		
			C.		
			D.		
			E.		
			F.		

Hales C&D Disposal, Inc.  
is not bound by any disclaimers  
that appear in this document.

SPECIAL HANDLING INSTRUCTIONS EMERGENCY NUMBER 1-800-424-9300 CHENTREC

TIME DEPARTED SHOP \_\_\_\_\_ TIME ON SITE \_\_\_\_\_ TIME LEFT SITE \_\_\_\_\_ TIME RETURN TO SHOP \_\_\_\_\_

CUSTOMER SIGNATURE Scott [Signature] DATE 5/10/11

**SHIPPERS CERTIFICATION:** This is to certify that the above named materials are properly classified, described, packaged, marked and labeled and are in proper condition for transportation according to the applicable regulations of the Department of Transportation.

SHIPPER	PRINT <u>Scott [Signature]</u>	SIGN <u>[Signature]</u>	DATE <u>5/10/11</u>
TRANSPORTER 1	PRINT <u>ARON MURPHY</u>	SIGN <u>[Signature]</u>	DATE <u>5-10-11</u>
TRANSPORTER 2	PRINT _____	SIGN _____	DATE _____
RECEIVED BY	PRINT <u>Scott [Signature]</u>	SIGN <u>[Signature]</u>	DATE <u>5/10/11</u>

WHITE - OFFICE    YELLOW - OFFICE    PINK - TSDF    GOLD - GENERATOR

HAKES C & D LANDFILL  
4376 MANNING RIDGE ROAD  
PAINTED POST, NY 14870  
LICENSE#460031

TICKET: 112919  
DATE: 03/09/2011  
TIME: 12:40 - 13:24

CUSTOMER: 84-00289 / ABSCOPE ENVIRONMENTAL  
HAULCUST: WO: 0 APPROVAL #:  
ORIGIN: CHEMUNG / CHEMUNG, NY  
TRUCK: ABS139 TRAILER:

P.O.:  
GROSS: 77780 LBS  
TARE: 38160 LBS  
NET: 39620 LBS

GENERATOR: NA / NOT APPLICABLE PROFILE #: NA  
HAULER: RIC / RICCELLI ROUTE: NA / NOT APPLICABLE  
COMMENT: 717 lake street/letter on file 1308

CELL/TANK: CELL 5-6

MATERIAL

QUANTITY UNIT

CD / CONSTRUCTION DEBRIS

(19,810) ST

I Certify under penalty of perjury that I am familiar with wastes  
authorized at this facility and that to the best of my knowledge all  
waste contained in this load is authorized for disposal at this facility.  
Driver: M. Orall Weighmaster: Laura C. Ha

IN: Laura (600416)

B: PCSCALE-HA

OUT: Laura (600416)

B: PCSCALE-HA



environmental, inc.

1 Commercial Dr.  
PO Box 487  
Canastota, NY 13032  
(315) 697-8437  
FAX (315) 697-9391

DOCUMENT 1308

TRK# 139-151

AEI JOB NO. 11810

### STRAIGHT BILL OF LADING

NYSDEC 384 Permit No. 7A-402

TRANSPORTER 1 RICCELLI ENTERPRISES, INC.

EPA ID # N/A

VEHICLE ID # 119102284 PA

TRANS. 1 PHONE 315-433-5113

TRANSPORTER 2 \_\_\_\_\_

EPA ID # \_\_\_\_\_

VEHICLE ID # \_\_\_\_\_

TRANS. 2 PHONE \_\_\_\_\_

DESIGNATED FACILITY HAKES LANDFILL			GENERATOR NYS DEC DER		
FACILITY EPA ID # N/A			GENERATOR EPA ID# N/A		
ADDRESS 4376 MANNING RIDGE ROAD			ADDRESS 717 LAKE STREET		
CITY PAINTED POST		STATE NY	ZIP 14270	CITY ELMIRA	
				STATE NY	
				ZIP 14909	
CONTAINERS NO. & SIZE	TYPE	HM	DESCRIPTION OF MATERIALS		TOTAL QUANTITY
	DT	N	A. CONSTRUCTION & DEMOLITION DEBRIS NON HAZARDOUS R999		34
			B.		TONS
			C.		
			D.		
			E.		
			F.		

SPECIAL HANDLING INSTRUCTIONS EMERGENCY NUMBER 1-800-424-9300 CHEMTREC

TIME DEPARTED SHOP \_\_\_\_\_ TIME ON SITE \_\_\_\_\_ TIME LEFT SITE \_\_\_\_\_ TIME RETURN TO SHOP \_\_\_\_\_

CUSTOMER SIGNATURE [Signature]

SHIPPERS CERTIFICATION: This is to certify that the above named materials are properly classified, described, packaged, marked and labeled and are in proper condition for transportation according to the applicable regulations of the Department of Transportation.

SHIPPER <u>[Signature]</u>	PRINT <u>[Signature]</u>	SIGN <u>[Signature]</u>	DATE <u>3-9-11</u>
TRANSPORTER 1 <u>[Signature]</u>	PRINT <u>[Signature]</u>	SIGN <u>[Signature]</u>	DATE <u>3-9-11</u>
TRANSPORTER 2 _____	PRINT _____	SIGN _____	DATE _____
RECEIVED BY <u>[Signature]</u>	PRINT <u>[Signature]</u>	SIGN <u>[Signature]</u>	DATE <u>3-9-11</u>

WHITE - OFFICE YELLOW - OFFICE PINK - TSDF GOLD - GENERATOR



HAKE'S C & D LANDFILL  
4376 MANNING RIDGE ROAD  
PAINTED POST, NY 14870  
LICENSE#460031

TICKET: 112897  
DATE: 03/09/2011  
TIME: 10:18 -- 10:35

CUSTOMER: 84-00289 / ABSCOPE ENVIRONMENTAL  
HAULCUST: NO: 0 APPROVAL #:  
ORIGIN: CHEMUNG / CHEMUNG, NY  
TRUCK: RIC139 TRAILER:

P.O. #  
GROSS: 86920 LBS  
TARE: 37720 LBS  
NET: 49200 LBS

GENERATOR: NA / NOT APPLICABLE PROFILE #: NA  
HAULER: RIC / RICCELLI ROUTE: NA / NOT APPLICABLE  
COMMENT: 717 lake street letter on file 1306  
MATERIAL

CELL/TANK: CELL 5-6

CD / CONSTRUCTION DEBRIS

QUANTITY UNIT  
24 5000 ST

I Certify under penalty of perjury that I am familiar with wastes  
authorized at this facility and that to the best of my knowledge all  
waste contained in this load is authorized for disposal at this facility.  
Driver: Michael P. Pender Weighmaster: Shelley

IN: Shelley (600454) B: PCSCALE-HA OUT: Shelley (600454) B: PCSCALE-HA



environmental, inc.

1 Commercial Dr.  
PO Box 487  
Canastota, NY 13032  
(315) 697-8437  
FAX (315) 697-8391

DOCUMENT 1306

AEI JOB NO. 11810

STRAIGHT BILL OF LADING

NYSDEC 384 Permit No. 7A-402

TRANSPORTER 1 RICCELLI ENTERPRISES, INC.  
EPA ID # N/A

VEHICLE ID # (139) 32264 PA  
TRANS. 1 PHONE 315-438-5115

TRANSPORTER 2  
EPA ID #

VEHICLE ID #  
TRANS. 2 PHONE

DESIGNATED FACILITY HALES LANDFILL			GENERATOR MYS DEC DER		
FACILITY EPA ID # N/A			GENERATOR EPA ID# N/A		
ADDRESS 4376 HANNING RIDGE ROAD			ADDRESS 717 LAKE STREET		
CITY PAINTED POST		STATE NY	ZIP 14870	CITY ELMIRA	
STATE NY		ZIP 14809		STATE NY	
CONTAINERS NO. & SIZE	TYPE	HM	DESCRIPTION OF MATERIALS	TOTAL QUANTITY	UNIT WT/VOL
	DT	N	A. CONSTRUCTION & DEMOLITION DEBRIS NON HAZARDOUS N999	39	TONS
			B.		
			C.		
			D.		
			E.		
			F.		
SPECIAL HANDLING INSTRUCTIONS EMERGENCY NUMBER 1-800-424-9300 CHEMTREC					
TIME DEPARTED SHOP _____ TIME ON SITE _____ TIME LEFT SITE _____ TIME RETURN TO SHOP _____					
CUSTOMER SIGNATURE Scott McDonald					

SHIPPERS CERTIFICATION: This is to certify that the above named materials are properly classified, described, packaged, marked and labeled and are in proper condition for transportation according to the applicable regulations of the Department of Transportation.

SHIPPER	PRINT Scott McDonald	SIGN Scott McDonald	DATE 3/9/11
TRANSPORTER 1	PRINT Michael Leonard	SIGN Michael Leonard	DATE 3-9-11
TRANSPORTER 2	PRINT	SIGN	DATE
RECEIVED BY	PRINT Shelle Lawrence	SIGN Shelle Lawrence	DATE 3/9/11

WHITE - OFFICE YELLOW - OFFICE PINK - TSDF GOLD - GENERATOR



HAKES C & D LANDFILL  
4376 MANNING RIDGE ROAD  
PAINTED POST, NY 14870  
LICENSE#460031

TICKET: 112892  
DATE: 03/09/2011  
TIME: 09:47 - 10:09

CUSTOMER: 04-00289 / ABSOPE ENVIRONMENTAL  
HAULCUST: WO: 0 APPROVAL #:

ORIGIN: CHEMUNG / CHEMUNG, NY

TRUCK: RIC825

GENERATOR: NA / NOT APPLICABLE PROFILE #: NA

HAULER: RIC / RICCELLI

COMMENT: 717 lake street letter on file 1305

MATERIAL

TRAILER:

ROUTE: NA / NOT APPLICABLE

P.O.:

GROSS: 111620 LBS

TARE: 42640 LBS

NET: 68980 LBS

CELL/TANK: CELL 5-6

CD / CONSTRUCTION DEBRIS

QUANTITY UNIT  
34.4900 ST

I Certify under penalty of perjury that I am familiar with wastes  
authorized at this facility and that to the best of my knowledge all  
waste contained in this load is authorized for disposal at this facility.

Driver: Chenmuckey

Weighmaster: Shelley

IN: Shelley (600454) B: PCSCALE-HA

OUT: Shelley (600454) B: PCSCALE-HA



environmental, inc.

1 Commercial Dr.  
PO Box 487  
Canastota, NY 13032  
(315) 697-8437  
FAX (315) 697-9391

### STRAIGHT BILL OF LADING

DOCUMENT 1305

AEI JOB NO. 11810

NYSDEC 364 Permit No. 7A-402

TRANSPORTER 1 RICCELLI ENTERPRISES, INC.  
EPA ID # N/A

VEHICLE ID # (825) 96411-PA  
TRANS. 1 PHONE 315-433-5115

TRANSPORTER 2 \_\_\_\_\_  
EPA ID # \_\_\_\_\_

VEHICLE ID # \_\_\_\_\_  
TRANS. 2 PHONE \_\_\_\_\_

DESIGNATED FACILITY HALES LANDFILL		GENERATOR NYS DEC DER	
FACILITY EPA ID # N/A		GENERATOR EPA ID# N/A	
ADDRESS 4376 MANNING RIDGE ROAD		ADDRESS 717 LAKE STREET	
CITY PAINTED POST	STATE NY	CITY ELNIRA	STATE NY
ZIP 14870		ZIP 14909	

CONTAINERS NO. & SIZE	TYPE	HM	DESCRIPTION OF MATERIALS	TOTAL QUANTITY	UNIT WT/VOL
	DT	N	A. CONSTRUCTION & DEMOLITION DEBRIS NON HAZARDOUS N999		37 TONS
			B.		
			C.		
			D.		
			E.		
			F.		

SPECIAL HANDLING INSTRUCTIONS EMERGENCY NUMBER 1-800-424-9300 CHEMTREC

TIME DEPARTED SHOP \_\_\_\_\_ TIME ON SITE \_\_\_\_\_ TIME LEFT SITE \_\_\_\_\_ TIME RETURN TO SHOP \_\_\_\_\_

CUSTOMER SIGNATURE Scott McDonald on Behalf of NYSDEC

SHIPPERS CERTIFICATION: This is to certify that the above named materials are properly classified, described, packaged, marked and labeled and are in proper condition for transportation according to the applicable regulations of the Department of Transportation. Hales G&D Disposal, Inc. is not responsible for any claims that appear in this document.

SHIPPER <u>Scott McDonald on Behalf of NYSDEC</u>	SIGN <u>ctt</u>	DATE <u>3/8/11</u>
TRANSPORTER 1 <u>AARON MUCKEY</u>	SIGN <u>Aaron Muckey</u>	DATE <u>3-8-11</u>
TRANSPORTER 2 _____	SIGN _____	DATE _____
RECEIVED BY <u>Shelley Lawrence</u>	SIGN <u>Shelley Lawrence</u>	DATE <u>3/8/11</u>

WHITE - OFFICE YELLOW - OFFICE PINK - TSDF GOLD - GENERATOR

HALES C & D LANDFILL  
4376 MANNING RIDGE ROAD  
PAINTED POST, NY 14870  
LICENSE#460031

TICKET: 112911  
DATE: 03/09/2011  
TIME: 12:09 - 12:51

CUSTOMER: 84-00289 / ABSCOPE ENVIRONMENTAL

HAULCUST: WO: 0 APPROVAL #:

ORIGIN: CHEMUNG / CHEMUNG, NY

TRUCK: ABS 825

TRAILER:

GENERATOR: NA / NOT APPLICABLE PROFILE #: NA

HAULER: RIC / RICCELLI

ROUTE: NA / NOT APPLICABLE

COMMENT: 717 lake street / letter on file 1307

CELL/TANK: CELL 5-6

MATERIAL	QUANTITY	UNIT
----------	----------	------

CD / CONSTRUCTION DEBRIS	31.8700	ST
--------------------------	---------	----

P.O.:

GROSS: 106440 LBS

TARE: 42700 LBS

NET: 63740 LBS

I Certify under penalty of perjury that I am familiar with wastes  
authorized at this facility and that to the best of my knowledge all  
waste contained in this load is authorized for disposal at this facility.

Driver: Laura Murphy

Weighmaster: Laura Murphy

IN: Laura (600416)

B: PCSCALE-HA

OUT: Laura (600416)

B: PCSCALE-HA



environmental, inc.

1 Commercial Dr.  
PO Box 487  
Canastota, NY 13032  
(315) 697-8437  
FAX (315) 697-9391

TRK  
825  
DOCUMENT 1307

AEI JOB NO. 11810

NYSDEC 384 Permit No. 7A-402

TRANSPORTER 1 RICCELLI ENTERPRISES, INC.

EPA ID #

VEHICLE ID # (825) 96411-PA

TRANS. 1 PHONE 315-433-3115

TRANSPORTER 2

EPA ID #

VEHICLE ID #

TRANS. 2 PHONE

DESIGNATED FACILITY HAKES LANDFILL			GENERATOR NYS DEC DER		
FACILITY EPA ID # N/A			GENERATOR EPA ID# N/A		
ADDRESS 4274 MANNING RIDGE ROAD			ADDRESS 717 LAKE STREET		
CITY PAINTED POST		STATE NY	ZIP 14870	CITY ELMIRA	
				STATE NY	
				ZIP 14905	
CONTAINERS NO. & SIZE	TYPE	HM	DESCRIPTION OF MATERIALS		TOTAL QUANTITY
	DT	N	A. CONSTRUCTION & DEMOLITION DEBRIS NON HAZARDOUS N999		37 TONS
			B.		
			C.		
			D.		
			E.		
			F.		

SPECIAL HANDLING INSTRUCTIONS EMERGENCY NUMBER 1-800-424-9300 CHEMTREC

TIME DEPARTED SHOP TIME ON SITE TIME LEFT SITE

CUSTOMER SIGNATURE

Hakes C&D Disposal, Inc.  
is not bound by any disclaimers  
that appear in this document.

SHIPPERS CERTIFICATION: This is to certify that the above named materials are properly classified, described, packaged, marked and labeled and are in proper condition for transportation according to the applicable regulations of the Department of Transportation.

SHIPPER	PRINT Laura Cresta	SIGN Laura Cresta	DATE 3-9-11
TRANSPORTER 1	PRINT AARON MUCKEY	SIGN Aaron Muckey	DATE 3-9-11
TRANSPORTER 2	PRINT	SIGN	DATE
RECEIVED BY	PRINT Laura Cresta	SIGN Laura Cresta	DATE 3-9-11

WHITE - OFFICE YELLOW - OFFICE PINK - TSDF GOLD - GENERATOR



HAKE'S C & D LANDFILL  
4376 MANNING RIDGE ROAD  
PAINTED POST, NY 14870  
LICENSE#460031

1070261  
TICKET: 112940

DATE: 03/09/2011

TIME: 14:43 - 15:00

CUSTOMER: 84-00289 / ABSCOPE ENVIRONMENTAL

HAULCUST: NO: 0

APPROVAL #:

P.O.:

ORIGIN: CHEMUNG / CHEMUNG, NY

TRUCK: ABS825

TRAILER: SL

GROSS: 97640 LBS

TARE: 42540 LBS

NET: 55100 LBS

GENERATOR: NA / NOT APPLICABLE PROFILE #: NA

HAULER: RIC / RICCELLI

ROUTE: NA / NOT APPLICABLE

COMMENT: 717 lake street / letter on file 1309

CELL/TANK: CELL 5-6

MATERIAL

QUANTITY UNIT

CD / CONSTRUCTION DEBRIS

27.5500

ST

I Certify under penalty of perjury that I am familiar with wastes  
authorized at this facility and that to the best of my knowledge all  
waste contained in this load is authorized for disposal at this facility.

Driver:

*Laura Muecke*

Weighmaster:

*Laura Muecke*

IN: Laura (600416)

B: PCSCALE-HA

OUT: Laura (600416)

B: PCSCALE-HA



environmental, inc.

1 Commercial Dr.  
PO Box 487  
Canastota, NY 13032  
(315) 697-8437  
FAX (315) 697-9391

TRK  
825  
DOCUMENT 1309

STRAIGHT BILL OF LADING

AEI JOB NO. 11810

NYSDEC 364 Permit No. 7A-402

TRANSPORTER 1 RIGCELLI ENTERPRISES, INC.  
EPA ID # N/A

VEHICLE ID # (5) 96411-PA  
TRANS. 1 PHONE 315-433-5115

TRANSPORTER 2 \_\_\_\_\_  
EPA ID # \_\_\_\_\_

VEHICLE ID # \_\_\_\_\_  
TRANS. 2 PHONE \_\_\_\_\_

DESIGNATED FACILITY HAKES LANDFILL			GENERATOR NYS DEC DER		
FACILITY EPA ID # N/A			GENERATOR EPA ID# N/A		
ADDRESS 4376 NANNING RIDGE ROAD			ADDRESS 717 LAKE STREET		
CITY PAINTED POST		STATE NY	ZIP 14870	CITY ELMIRA	
				STATE NY	
				ZIP 14909	
CONTAINERS NO. & SIZE	TYPE	HM	DESCRIPTION OF MATERIALS		TOTAL QUANTITY
	DT	N	A. CONSTRUCTION & DEMOLITION DEBRIS NON HAZARDOUS N999		37
			B.		
			C.		
			D.		
			E.		
			F.		

SPECIAL HANDLING INSTRUCTIONS EMERGENCY NUMBER 1-800-424-9300 CHEMTREC

TIME DEPARTED SHOP \_\_\_\_\_ TIME ON SITE \_\_\_\_\_ TIME LEFT SITE \_\_\_\_\_ TIME RETURN TO SHOP \_\_\_\_\_

CUSTOMER SIGNATURE [Signature]

SHIPPERS CERTIFICATION: This is to certify that the above named materials are properly classified, described, packaged, marked and labeled and are in proper condition for transportation according to the applicable regulations of the Department of Transportation.

SHIPPER	PRINT <u>[Signature]</u>	SIGN <u>[Signature]</u>	Hakes G&D Disposal, Inc. is not bound by any disclaimers that appear in this document. 3-7-11
TRANSPORTER 1	PRINT <u>DAVID MUCKEY</u>	SIGN <u>[Signature]</u>	
TRANSPORTER 2	PRINT _____	SIGN _____	
RECEIVED BY	PRINT <u>Laura Cuesta</u>	SIGN <u>[Signature]</u>	
			DATE 3-9-11

WHITE - OFFICE YELLOW - OFFICE PINK - TSDF GOLD - GENERATOR

\*\* Scale Ticket \*\*



197 E. Washington Ave  
Elmira, New York 14901  
Phone : (607) 733-7111  
Fax : (607) 733-0111

Ticket # : 00055830 Date : 10 Mar 2011  
Supplier : ABSCOP - ABScope ENVIRONMENTAL  
1 COMMERCIAL DRIVE  
PO BOX 487  
CANASTOTA, NY  
13032

Time In : 11:07 am Out : 11:07 am  
Served by: david Scale: 0

Gross	Tare	Net Weight
=====		
Steel, Long		
18.7857 GT	16.5536 GT	2.2321 GT

18.7857GT

2.2321

Number Of Items : 1

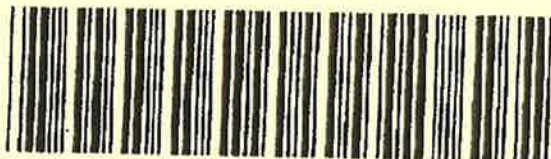

\*\* Scale Ticket \*\*



197 E. Washington Ave  
Elmira, New York 14901  
Phone : (607) 733-7111  
Fax : (607) 733-0111

Ticket # : 00055832 Date : 10 Mar 2011  
Supplier : ABSCOP - ABScope ENVIRONMENTAL  
1 COMMERCIAL DRIVE  
PO BOX 487  
CANASTOTA, NY  
13032

Time In : 11:08 am Out : 11:08 am  
Served by: david Scale: 0

Gross	Tare	Net Weight
=====		
Steel, Long		
15.7411 GT	14.1429 GT	1.5982 GT

15.7411GT

1.5982

Number Of Items : 1





Ticket # : 00055828 Date : 08 Mar 2011  
Supplier : ABSCOP - ABSCOPE ENVIRONMENTAL  
1 COMMERCIAL DRIVE  
PO BOX 487  
CANASTOTA, NY  
13032

Time In : 11:06 am Out : 11:07 am  
Served by: david Scale: 0

Gross	Tare	Net Weight
Steel, Long		
18.6250 GT	16.5536 GT	2.0714 GT

---

18.625 GT	2.0714
-----------	--------

Number Of Items : 1

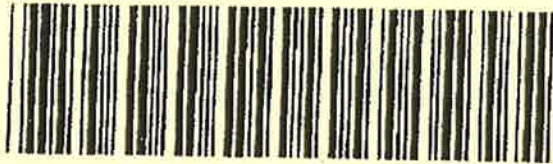

Ticket # : 00055831 Date : 09 Mar 2011  
Supplier : ABSCOP - ABSCOPE ENVIRONMENTAL  
1 COMMERCIAL DRIVE  
PO BOX 487  
CANASTOTA, NY  
13032

Time In : 11:07 am Out : 11:08 am  
Served by: david Scale: 0

Gross	Tare	Net Weight
Steel, Long		
20.6607 GT	17.1518 GT	3.5089 GT

---

20.6607GT	3.5089
-----------	--------

Number Of Items : 1

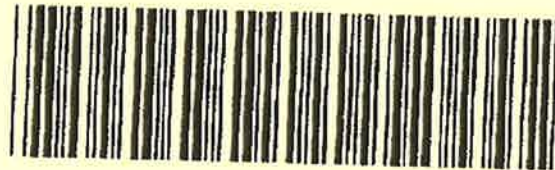

## **APENDIX D – Demolition Permit**

---



## Chemung County Code Enforcement Office

103 Washington St., PO Box 588

Elmira, New York 14902-0588

Phone: (607) 737-2019

Fax: (607) 737-2059

E-mail: [tkump@co.chemung.ny.us](mailto:tkump@co.chemung.ny.us)

---

February 22, 2011

Rob Drabot

Abscope Environmental Inc.

1 Commercial Drive, P.O. Box 487

Canastota, NY 13032

RE: 717 Lake Street- Demolition Permit #11-01  
Elmira (C), Chemung (Co)

Dear Mr. Drabot:

Enclosed with this correspondence is the **Demolition Permit** for the demolition of the structure at 717 Lake Street in the City of Elmira as described on the enclosed permit. This includes all the described activity as depicted on the application you submitted for this project. Please make sure that the permit (or a copy) is conspicuously posted at the site of the demolition. Note the condition on the permit that measures must be taken to prevent dust from leaving the site and to prevent mud and dirt from being tracked onto the streets.

I will be waiting to hear from you as soon as the demolition has been completed as per the approved plans and all debris has been removed from the site. Once I receive a signed statement from you stating that all planned work has been completed per the issued permit, I will issue a certificate of completion.

If there is a need on your part to have me perform any interim inspections at any point during the demolition, please do not hesitate to contact me. Please feel free to contact me at (607)-737-2019 if you have any questions. Thanks for your cooperation on this project.

Sincerely yours,

A handwritten signature in blue ink, appearing to read "Tom G. Kump".

Thomas G. Kump, P.E.

Code Enforcement Officer

Registration Number 0794-7167A



CHEMUNG COUNTY

# DEMOLITION PERMIT

No. 11-01 HAS BEEN GRANTED TO

ABSCOPE ENVIRONMENTAL INC, 1 COMMERCIAL DRIVE, CANASTOTA, NY

AT 717 LAKE STREET, ELMIRA, NY 14901 (89.11-3-83)

All work must be performed in accordance with the plans and application submitted for this project.

Date 2-22-11

A handwritten signature in blue ink, appearing to read "R. J. Kemp", is written over a horizontal line.

Code Enforcement Officer

Reg. No. 0794-7167A

Work Description/Conditions:

DEMOLITION OF ONE-STORY BLOCK BUILDING

NOTE: EFFORTS SHALL BE MADE BY CONTRACTOR TO PREVENT

DUST FROM LEAVING THE PROPERTY & MUD/DIRT FROM

BEING TRACKED ONTO ADJACENT STREETS

THIS CARD MUST BE POSTED IN A  
CONSPICUOUS PLACE ACCESSIBLE  
TO THE INSPECTORS.



## **APENDIX E – Particulate Monitoring Data**

---

March 8, 2011

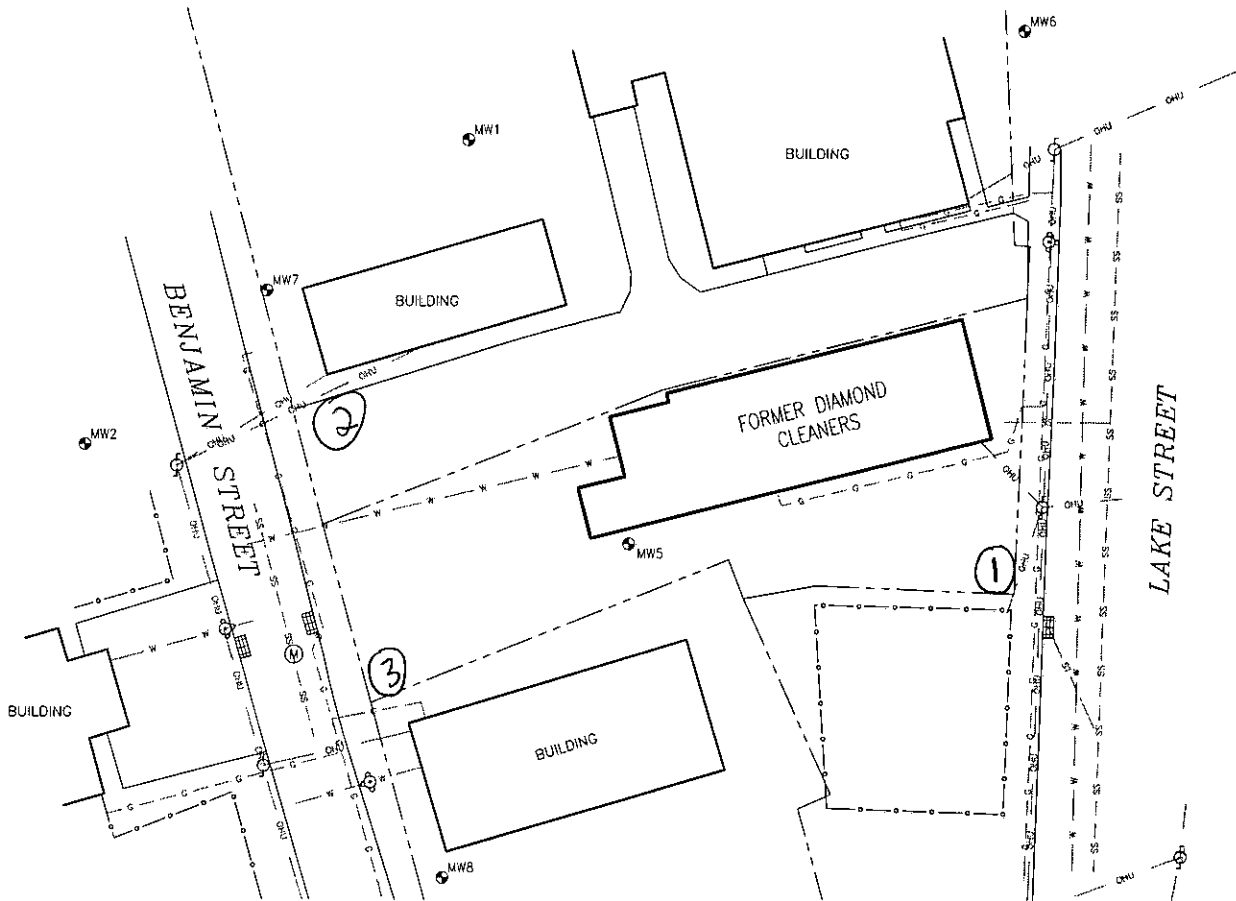

# LEGEND

- PROPERTY BOUNDARY
- o-o- CHAIN LINK FENCE
- [ ] CATCH BASIN
- (M) UTILITY MANHOLE
- (P) UTILITY POLE
- (F) FIRE HYDRANT
- (MW) MONITORING WELL
- SS --- UNDERGROUND SANITARY SEWER LINE
- ST --- UNDERGROUND STORM SEWER LINE
- W --- UNDERGROUND WATER LINE
- G --- UNDERGROUND GAS LINE
- OHU --- OVERHEAD UTILITIES

Number represents Dust  
Meter location and  
Unit

wind W 2-4 mph

←  
wind direction

DRAFTED BY: B.C.S. (N.J.)	SITE MAP		
CHECKED BY:	NYSDEC #80-8030 (FORMER DIAMOND CLEANERS) 717 LAKE STREET ELMIRA, NEW YORK		
REVIEWED BY:	Groundwater & Environmental Services, Inc. 300 GATEWAY PARK DRIVE, NORTH SYRACUSE, NY 13212		
NORTH 	SCALE IN FEET 	DATE 2-15-11	FIGURE
	0 APPROXIMATE 40		

## Dust Monitoring Record

### Facility / Site Information

Former Diamond Cleaners  
717 Lake Street  
Elmira, NY  
NYSDEC Site #80-8030

Dust monitor location: **Background Unit 1**

Model:,Dust Trak  
Model Number:,8520  
Serial Number:,85200212  
Test ID:,001  
Test Abbreviation:,  
Start Date:,03/08/2011  
Start Time:,08:23:13  
Duration (dd:hh:mm:ss):,0:08:15:00  
Time constant (seconds):,10  
Log Interval (mm:ss):,15:00  
Number of points:,33  
Notes:,

Statistics,Channel:,Aerosol  
,Units:,mg/m^3  
,Average:,0.018  
,Minimum:,0.008  
,Time of Minimum:,13:38:13  
,Date of Minimum:,03/08/2011  
,Maximum:,0.045  
,Time of Maximum:,10:08:13  
,Date of Maximum:,03/08/2011

Calibration,Sensor:,Aerosol  
,Cal. date,11/12/2009

Date	Time	Aerosol
MM/dd/yyyy	hh:mm:ss	mg/m^3
3/8/2011	08:38:13	0.037
3/8/2011	08:53:13	0.039
3/8/2011	09:08:13	0.036
3/8/2011	09:23:13	0.037
3/8/2011	09:38:13	0.038
3/8/2011	09:53:13	0.037
3/8/2011	10:08:13	0.045
3/8/2011	10:23:13	0.032
3/8/2011	10:38:13	0.028
3/8/2011	10:53:13	0.024
3/8/2011	11:08:13	0.013
3/8/2011	11:23:13	0.012
3/8/2011	11:38:13	0.011

## Dust Monitoring Record (continued)

### Facility / Site Information

Former Diamond Cleaners  
717 Lake Street  
Elmira, NY  
NYSDEC Site #80-8030

Dust monitor location: **Background Unit 1**

Date	Time	Aerosol
MM/dd/yyyy	hh:mm:ss	mg/m <sup>3</sup>
3/8/2011	11:53:13	0.011
3/8/2011	12:08:13	0.012
3/8/2011	12:23:13	0.016
3/8/2011	12:38:13	0.011
3/8/2011	12:53:13	0.015
3/8/2011	13:08:13	0.011
3/8/2011	13:23:13	0.009
3/8/2011	13:38:13	0.008
3/8/2011	13:53:13	0.010
3/8/2011	14:08:13	0.009
3/8/2011	14:23:13	0.009
3/8/2011	14:38:13	0.010
3/8/2011	14:53:13	0.010
3/8/2011	15:08:13	0.011
3/8/2011	15:23:13	0.012
3/8/2011	15:38:13	0.012
3/8/2011	15:53:13	0.012
3/8/2011	16:08:13	0.010
3/8/2011	16:23:13	0.010
3/8/2011	16:38:13	0.010



## Dust Monitoring Record

### Facility / Site Information

Former Diamond Cleaners  
717 Lake Street  
Elmira, NY  
NYSDEC Site #80-8030

Dust monitor location: **Downwind Unit 2**

Model:,Dust Trak  
Model Number:,8520  
Serial Number:,85202715  
Test ID:,001  
Test Abbreviation:,  
Start Date:,03/08/2011  
Start Time:,08:21:02  
Duration (dd:hh:mm:ss):,0:08:30:00  
Time constant (seconds):,10  
Log Interval (mm:ss):,15:00  
Number of points:,34  
Notes:,

Statistics,Channel:,Aerosol  
,Units:,mg/m^3  
,Average:,0.018  
,Minimum:,0.008  
,Time of Minimum:,11:36:02  
,Date of Minimum:,03/08/2011  
,Maximum:,0.040  
,Time of Maximum:,10:21:02  
,Date of Maximum:,03/08/2011

Calibration,Sensor:,Aerosol  
,Cal. date,06/30/2010

Date	Time	Aerosol
MM/dd/yyyy	hh:mm:ss	mg/m^3
3/8/2011	08:36:02	0.035
3/8/2011	08:51:02	0.033
3/8/2011	09:06:02	0.034
3/8/2011	09:21:02	0.035
3/8/2011	09:36:02	0.033
3/8/2011	09:51:02	0.034
3/8/2011	10:06:02	0.032
3/8/2011	10:21:02	0.040
3/8/2011	10:36:02	0.025
3/8/2011	10:51:02	0.025
3/8/2011	11:06:02	0.013
3/8/2011	11:21:02	0.012
3/8/2011	11:36:02	0.008

## Dust Monitoring Record (continued)

### Facility / Site Information

Former Diamond Cleaners  
717 Lake Street  
Elmira, NY  
NYSDEC Site #80-8030

Dust monitor location: **Downwind Unit 2**

Date	Time	Aerosol
MM/dd/yyyy	hh:mm:ss	mg/m <sup>3</sup>
3/8/2011	11:51:02	0.011
3/8/2011	12:06:02	0.011
3/8/2011	12:21:02	0.009
3/8/2011	12:36:02	0.009
3/8/2011	12:51:02	0.013
3/8/2011	13:06:02	0.011
3/8/2011	13:21:02	0.013
3/8/2011	13:36:02	0.010
3/8/2011	13:51:02	0.010
3/8/2011	14:06:02	0.011
3/8/2011	14:21:02	0.012
3/8/2011	14:36:02	0.008
3/8/2011	14:51:02	0.014
3/8/2011	15:06:02	0.012
3/8/2011	15:21:02	0.015
3/8/2011	15:36:02	0.014
3/8/2011	15:51:02	0.013
3/8/2011	16:06:02	0.011
3/8/2011	16:21:02	0.010
3/8/2011	16:36:02	0.009
3/8/2011	16:51:02	0.010

## Dust Monitoring Record

### Facility / Site Information

Former Diamond Cleaners  
717 Lake Street  
Elmira, NY  
NYSDEC Site #80-8030

Dust monitor location: **Downwind Unit 3**

Model:,Dust Trak  
Model Number:,8520  
Serial Number:, 23319  
Test ID:,001  
Test Abbreviation:,  
Start Date:,03/08/2011  
Start Time:,08:19:30  
Duration (dd:hh:mm:ss):,0:05:00:00  
Time constant (seconds):,10  
Log Interval (mm:ss):,15:00  
Number of points:,20  
Notes:,

Statistics,Channel:,Aerosol  
,Units:,mg/m<sup>3</sup>  
,Average:,0.020  
,Minimum:,0.006  
,Time of Minimum:,11:34:30  
,Date of Minimum:,03/08/2011  
,Maximum:,0.054  
,Time of Maximum:,09:34:30  
,Date of Maximum:,03/08/2011

Calibration,Sensor:,Aerosol  
,Cal. date,05/17/2010

Date	Time	Aerosol
MM/dd/yyyy	hh:mm:ss	mg/m <sup>3</sup>
3/8/2011	08:34:30	0.033
3/8/2011	08:49:30	0.032
3/8/2011	09:04:30	0.032
3/8/2011	09:19:30	0.032
3/8/2011	09:34:30	0.054
3/8/2011	09:49:30	0.031
3/8/2011	10:04:30	0.032
3/8/2011	10:19:30	0.028
3/8/2011	10:34:30	0.023
3/8/2011	10:49:30	0.023
3/8/2011	11:04:30	0.010
3/8/2011	11:19:30	0.008
3/8/2011	11:34:30	0.006

## Dust Monitoring Record (continued)

### Facility / Site Information

Former Diamond Cleaners  
717 Lake Street  
Elmira, NY  
NYSDEC Site #80-8030

Dust monitor location: **Downwind Unit 3**

Date	Time	Aerosol
MM/dd/yyyy	hh:mm:ss	mg/m <sup>3</sup>
3/8/2011	11:49:30	0.008
3/8/2011	12:04:30	0.009
3/8/2011	12:19:30	0.007
3/8/2011	12:34:30	0.007
3/8/2011	12:49:30	0.010
3/8/2011	13:04:30	0.009
3/8/2011	13:19:30	0.007
3/8/2011	14:07:13	0.005
3/8/2011	14:22:13	0.007
3/8/2011	14:37:13	0.007
3/8/2011	14:52:13	0.010
3/8/2011	15:07:13	0.009
3/8/2011	15:22:13	0.010
3/8/2011	15:37:13	0.010
3/8/2011	15:52:13	0.010
3/8/2011	16:07:13	0.009
3/8/2011	16:22:13	0.009
3/8/2011	16:37:13	0.008
3/8/2011	16:52:13	0.008