

# ENGINEERING INVESTIGATIONS AT INACTIVE HAZARDOUS WASTE SITES

---

## PRELIMINARY SITE ASSESSMENT

HENRIETTA TOWN DUMP  
HENRIETTA (T)

SITE NO. 828037  
MONROE (C)



---

Prepared for:

NEW YORK STATE  
DEPARTMENT OF ENVIRONMENTAL CONSERVATION  
50 Wolf Road, Albany, New York

---

Thomas C. Jorling, Commissioner

---

DIVISION OF HAZARDOUS WASTE REMEDIATION

---

Michael J. O'Toole, Jr., P.E. - Director

---

**URS Consultants, Inc.**

282 Delaware Avenue

Buffalo, New York 14202

**AUGUST 1991**

PRELIMINARY SITE ASSESSMENT  
TASK 1: DATA RECORDS SEARCH AND ASSESSMENT

HENRIETTA TOWN DUMP  
SITE NO. 828037  
HENRIETTA (T)/MONROE (C)

AUGUST 1991

Performed Under  
NYSDEC CONTRACT NO. D002340  
NYSDEC WORK ASSIGNMENT NO. D002340-3

By  
URS CONSULTANTS, INC.

For  
DIVISION OF HAZARDOUS WASTE REMEDIATION  
NEW YORK STATE DEPARTMENT OF ENVIRONMENTAL CONSERVATION

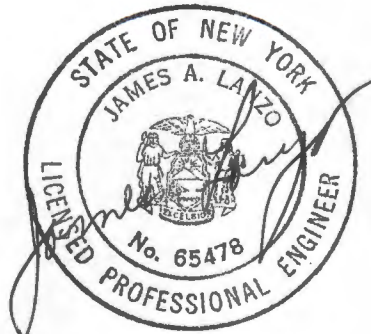

## TABLE OF CONTENTS

	Page No.
1. EXECUTIVE SUMMARY .....	1
2. PURPOSE .....	3
3. SCOPE OF WORK .....	4
4. SITE ASSESSMENT .....	7
4.1 Site History .....	7
4.2 Site Topography .....	8
4.3 Site Hydrology .....	8
4.4 Contamination Assessment .....	10
5. ASSESSMENT OF DATA ADEQUACY AND RECOMMENDATIONS .....	11
5.1 Hazardous Waste Deposition .....	11
5.2 Significant Threat Determination .....	11
5.3 Recommendations .....	11
APPENDIX A - REFERENCES	
APPENDIX B - SITE INSPECTION REPORT (USEPA FORM 2070-13)	
APPENDIX C - INTERVIEW DOCUMENTATION FORMS	
APPENDIX D - HAZARD RANKING SYSTEM	

## 1. EXECUTIVE SUMMARY

The Henrietta Town Dump (NYSDEC Site #828037) is located south of Lehigh Station Road and north of the NYS Thruway and northeast of thruway exit 46 in the Town of Henrietta, Monroe County, N.Y. (Figure 1).

The 19 acre Henrietta Town Dump was owned by the Town of Henrietta and independently operated from the early 1950s to June 1965 (Ref. 1). During that time period, the landfill reportedly accepted municipal, commercial and industrial waste. The site was sold by the Town of Henrietta in 1966. The site is currently owned by the 1233 Lehigh Station Back Acreage Corp. A portion of the property north of the former landfill and along Lehigh Station Road is used by both Bestway Environmental and Gypsum Services Corp.

The site is extremely overgrown and contains areas with a very irregular ground surface. Several of the footpaths which surround and cross the property are used for dirt bike trails as evidenced by the tire tracks in the muddy portions of the path. An oily sheen was noted on the water in the drainage ditch, which runs approximately east-west near a high voltage electrical transmission power line right-of-way.

Drums and other metal objects were observed to be protruding from the fill along the western edge of the site (Figure 2). Ridges of slightly higher elevation were observed in several areas of the landfill, especially along the eastern edge. Some appeared to be old hedgerows which marked the edge of a cultivated field. Others are believed to be a borrow area for cover at the landfill (Ref. MCDH).

The only disposal records available for the site are a 1962 Monroe County Community Description Report and some Health Department correspondence.



No evidence of hazardous waste disposal at the site was uncovered. However, because of the variety of waste known to have been disposed of at the site and to determine if there is a significant threat to the population or environment in the vicinity of the Henrietta Town Dump site, it is recommended that the NYSDEC perform additional work. This additional work should include a geophysical study as well as sampling and analysis of drums, soil, sediments, and surface water as well as excavation of test pits within the fill area. This study is intended to allow the site to be reclassified or delisted.

Photographs taken during the site inspection are presented as Figure 3.

Based on the information gathered for this investigation the following Hazard Ranking System scores were calculated:

$$S_M = 5.17 \text{ (} S_{GW} = 7.33, S_{SW} = 5.13, S_A = 0.00 \text{)}$$

$$S_{FE} = 0.00$$

$$S_{DC} = 16.67$$

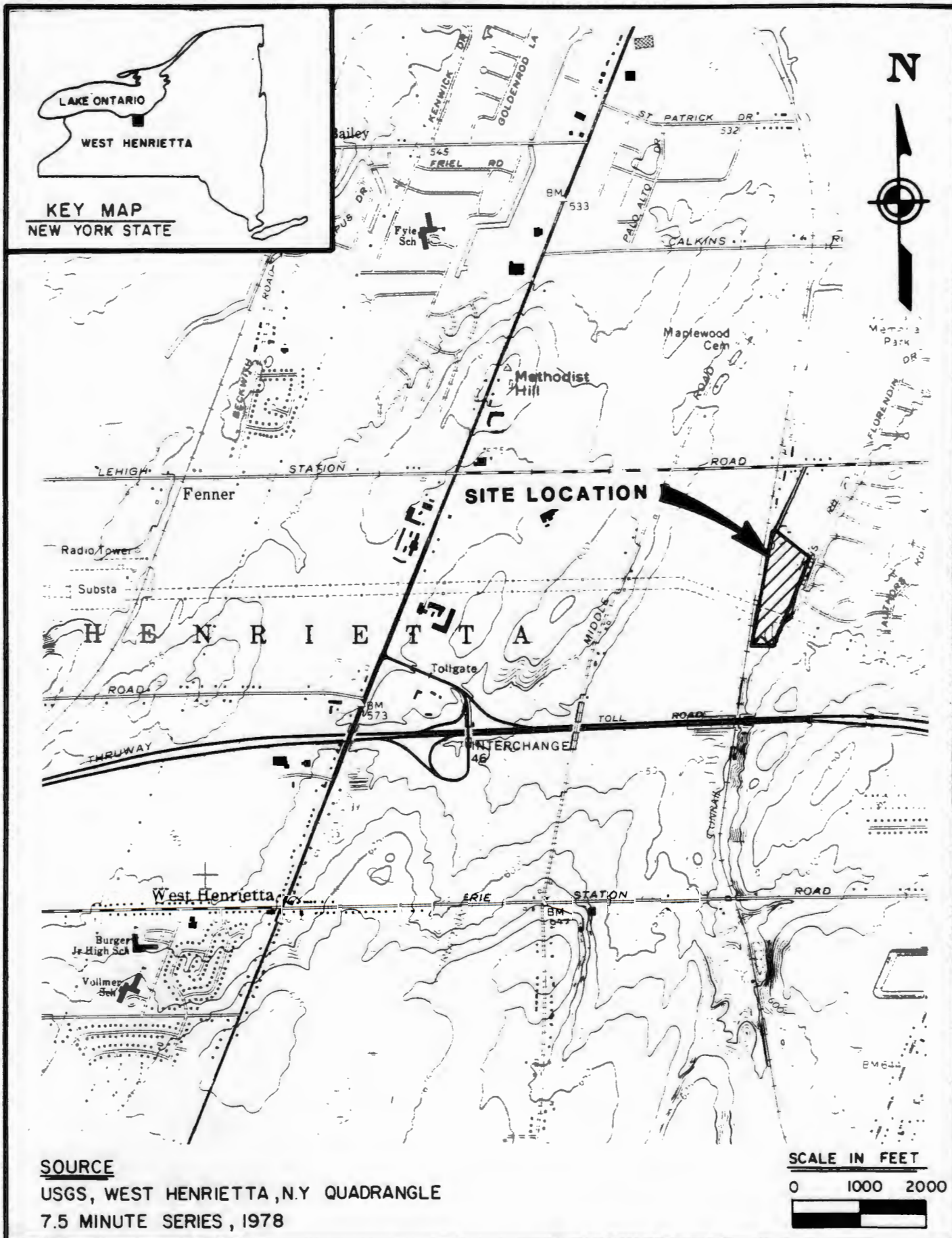

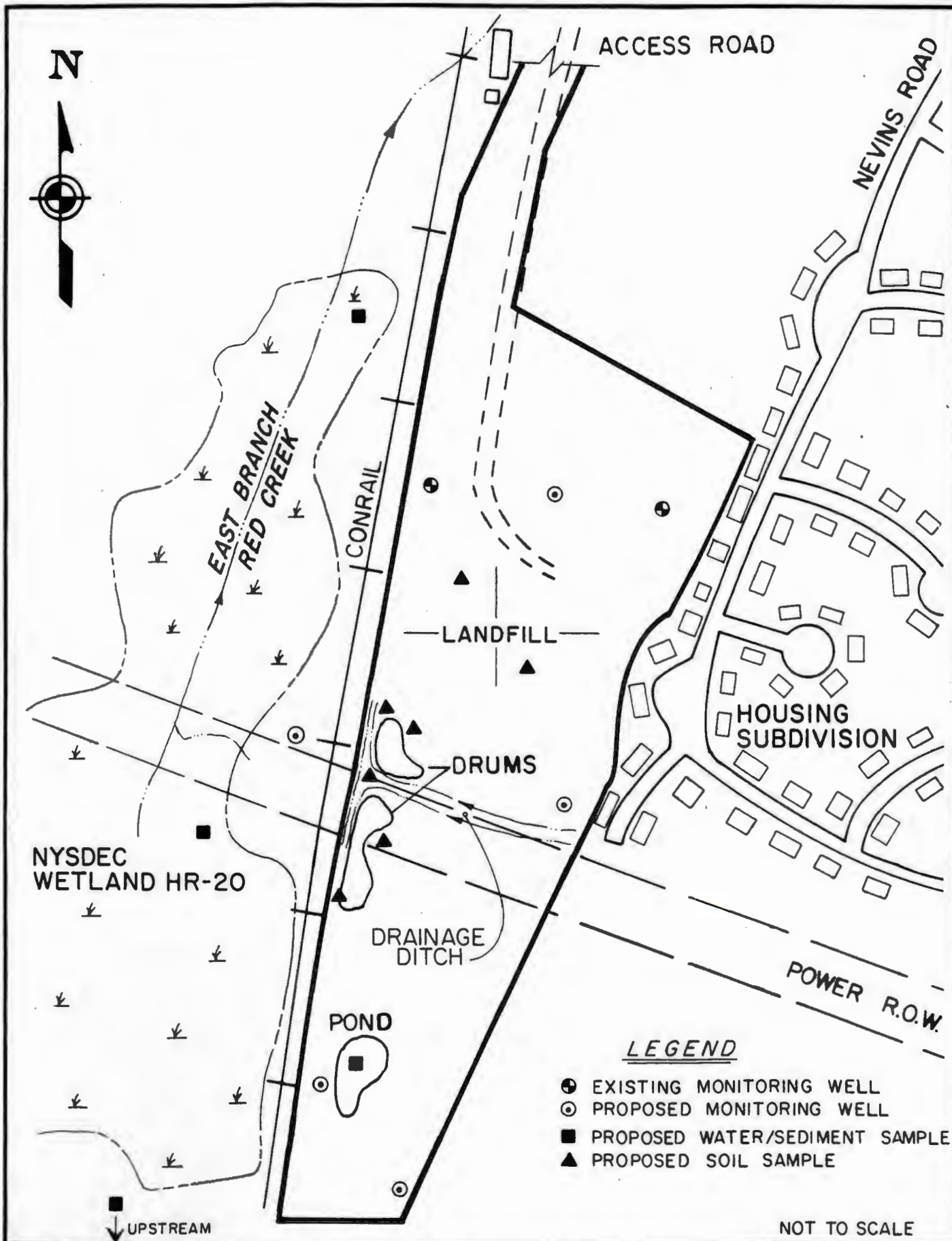



One of the two monitoring wells located on site. This one is located along the western edge of the site, north of the power ROW.



A large piece of abandoned machinery on the western side of the landfill, north of the power ROW. Aside from this and a few tires, there was very little trash on the surface of the landfill.

FIGURE 3-SITE PHOTOGRAPHS  
Henrietta Town Dump





Looking northwards across the pond at the southern end of the landfill. The water appeared to be a normal color. The overgrown nature of the area around the pond is typical of most of the site.



Looking southward along one of the rough access paths which surround the site. The filled area on the left is very overgrown.

**ADDITIONS/CHANGES TO REGISTRY  
OF INACTIVE HAZARDOUS WASTE DISPOSAL SITES**

1. SITE NAME <b>Henrietta Town Dump</b>		2. SITE NO. <b>828037</b>	3. TOWN <b>Henrietta</b>	4. COUNTY <b>Monroe</b>
5. REGION <b>8</b>	6. CLASSIFICATION Current <u><b>2a</b></u> / Proposed _____	7. ACTIVITY <input type="checkbox"/> Add <input type="checkbox"/> Reclassify <input type="checkbox"/> Delist <input type="checkbox"/> Modify _____		
8a. DESCRIBE LOCATION OF SITE (Attach U.S.G.S. Topographic Map showing site location). <b>NYS Thruway to exit 46, North on W. Henrietta Road to Lehigh Station Road. East approximately 1 mile, cross conrail tracks, site is on right side.</b>				
b. Quadrangle <u><b>West Henrietta</b></u> c. Site Latitude <u><b>43°03'07"</b></u> Longitude <u><b>77° 38'00"</b></u> d. Tax Map Number <u><b>175.20</b></u>				
9a BRIEFLY DESCRIBE THE SITE (Attach site plan showing disposal/sampling locations) <p>The site was the location of a landfill which accepted household, industrial and commercial waste. At least 150 tons of industrial waste was disposed of onsite. The site is extremely overgrown and adjacent to a residential neighborhood. There is evidence that residents of the housing subdivision are onsite, using the area for recreation as well as to dispose of yard waste. It was also noted, during the site inspection, that hunting appears to be taking place as well.</p>				
b. Area <u><b>19</b></u> acres c. EPA ID Number <u><b>NYD980762801</b></u> d. PA/SI <input checked="" type="checkbox"/> Yes <input type="checkbox"/> No				
e. Completed: <input type="checkbox"/> Phase I <input type="checkbox"/> Phase II <input checked="" type="checkbox"/> PSA <input type="checkbox"/> Sampling				
10. BRIEFLY LIST THE TYPE AND QUANTITY OF THE HAZARDOUS WASTE AND THE DATES THAT IT WAS DISPOSED OF AT THIS SITE <b>At least 150 tons of industrial waste. Dates of disposal are between the early 1950's and 1965.</b>				
11a. SUMMARIZED SAMPLING DATA ATTACHED <input type="checkbox"/> Air <input type="checkbox"/> Groundwater <input type="checkbox"/> Surface Water <input type="checkbox"/> Soil <input type="checkbox"/> Waste <input type="checkbox"/> EP Tox <input type="checkbox"/> TCLP no sampling at this site				
b. List contravened parameters and values  <b>none</b>				
12. SITE IMPACT DATA				
a. Nearest surface water: Distance <u><b>onsite</b></u> ft. Direction _____ Classification <u><b>none</b></u>				
b. Nearest groundwater: Depth <u><b>10</b></u> ft. Flow Direction <u><b>assumed west</b></u> <input type="checkbox"/> Sole Source <input type="checkbox"/> Primary <input type="checkbox"/> Principal				
c. Nearest water supply: Distance <u><b>unknown</b></u> ft. Direction _____ Active <input type="checkbox"/> Yes <input type="checkbox"/> No				
d. Nearest building: Distance <u><b>200</b></u> ft. Direction <u><b>East</b></u> Use <u><b>residence</b></u>				
e. Crops or livestock on site? <input type="checkbox"/> Yes <input checked="" type="checkbox"/> No				
f. Exposed hazardous waste? <input type="checkbox"/> Yes <input checked="" type="checkbox"/> No				
g. Controlled site access? <input type="checkbox"/> Yes <input checked="" type="checkbox"/> No				
h. Documented fish or wildlife mortality? <input type="checkbox"/> Yes <input checked="" type="checkbox"/> No				
i. Impact on special status fish or wildlife resource? <input type="checkbox"/> Yes <input checked="" type="checkbox"/> No				
j. Within a State Economic Development Zone? <input type="checkbox"/> Yes <input checked="" type="checkbox"/> No				
k. For Class 2a: Code _____ Health Model Score <u><b>1.5</b></u>				
l. For Class 2: Priority Category _____				
m. HRS Score <b>Sm=5.17, Sfe=0.00, Sdc=16.67</b>				
n. Significant Threat <input type="checkbox"/> Yes <input type="checkbox"/> No <input checked="" type="checkbox"/> Unknown				
13. SITE OWNER'S NAME <b>1233 Lehigh Station Back Acreage</b>		14. ADDRESS <b>1233 Lehigh Station Rd.</b>		15. TELEPHONE NUMBER <b>( )</b>
16. PREPARER <b>Phyllis Rettke/Geologist/URS Consultants, Inc.</b>				
<u><b>2/2/91</b></u> Date		Name, Title and Organization <i>Phyllis Rettke</i> Signature		
17. APPROVED				
Name, Title and Organization				
Date				
Signature				

## 2. PURPOSE

Task 1, Data Records Search and Assessment, of the Preliminary Site Assessment (PSA) was conducted at the Henrietta Town Dump, Site No. 828037, in the Town of Henrietta, Monroe County, New York by URS Consultants under contract to the New York State Department of Environmental Conservation (NYSDEC) Superfund Standby Contract (Contract No. D002340, Work Assignment No. D002340-3).

The Henrietta Town Dump site (Figure 1) is a suspected inactive hazardous waste site recognized by NYSDEC. This site is currently classified as Class 2a because there is insufficient information to document hazardous waste disposal and/or assess the significance of potential risks to public health or the environment. The purpose of a PSA is to provide the information for NYSDEC to reclassify the site according to the following classifications:

- o Class 2- Hazardous waste sites presenting a significant threat to the public health or the environment.
- o Class 3- Hazardous waste sites not presenting a significant threat to the public health or the environment
- o Delist-Sites where hazardous waste disposal can not be documented.



### 3. SCOPE OF WORK

The Preliminary Site Assessment, Task I, investigation at the Henrietta Town Dump site comprised several interrelated tasks as follows:

#### File Reviews and Data Search

An extensive data search was conducted, utilizing both site-specific and regional sources. This information was compiled from existing data as well as new sources. These include:

- o Visit to the NYSDEC office in Albany to conduct a file search  
6/14/90, (518) 457-9538  
- General files
- o Visit to the NYSDEC Region 8 office to conduct a file search  
10/2/90, (716) 226-2466  
- General files, NUS Report
- o Visit to the Monroe County Environmental Management Council,  
9/28/90, (716) 428-3023  
- File search, air photos
- o Visit to the Monroe County Health Department,  
9/28/90, (716) 274-6067  
- File search

#### Site Inspection

A site inspection was conducted on 10/17/90 in order to assess the surface conditions at the site and vicinity, observe evidence, if any, of hazardous substances or wastes present, photograph the site, conduct preliminary air monitoring using a PID (HNU) and a radiation meter, and to



confirm information obtained from the initial data search. During the 1 hour 10 minute site inspection, no readings above background level were noted on any monitoring instruments. A USEPA Site Inspection Report (EPA Form 2070-13) and the NYSDEC "Additions/Changes to the Registry of Inactive Hazardous Waste Disposal Sites" were completed following the site inspection.

The site inspection was conducted with the following personnel:

<u>NAME</u>	<u>TITLE</u>	<u>AFFILIATION</u>
Phyllis Rettke	Geologist	URS Consultants, Inc.
Ed Yurkstas	Associate Public Health Sanitarian	Monroe County Health Dept.
Ed Schmitt	Waste Recovery & Recycling Manager	Bestway Environmental

The Henrietta Town Dump has been closed since 1966. The property is currently owned by 1233 Lehigh Station Back Acreage Corp. (Ref. 2). A portion of the property directly north of the site is used by Bestway Environmental for their offices and parking for trucks as well as by Gypsum Services Corp. for a warehouse.

The site is extremely overgrown with areas of the ground surface that are very irregular. There are several footpaths which surround and cross the property which are used as dirt bike trails as evidenced by the tire tracks. During the site inspection an oily sheen was noted on the water in the drainage ditch which runs approximately east-west near the Rochester Gas and Electric right of way for their overhead electric lines.

Approximately 10 rusted drums and other metal objects were observed protruding from the fill along the western edge of the site (Figure 2). The drums were found in a brushy area adjacent to the manmade drainage ditch onsite. Ridges of slightly higher elevation were observed in

several areas of the landfill. Some appear to be old hedgerows which marked the edge of a former cultivated field. Others are believed to be the edges of a borrow area for cover used at the landfill (Ref. Ed Yurkstas).

Two onsite monitoring wells were observed during the site inspection near the northern end of the property. Although many sources, both state and local, were contacted no information about the construction or sampling of these wells could be found (Refs. 6, 22, 23, 24, 25, 26).

The site is located west of and adjacent to a housing subdivision. Yard waste was observed in piles along the eastern side of the landfill. It is believed that adjacent property owners in the housing subdivision are placing the yard waste onsite.

#### 4. SITE ASSESSMENT

##### 4.1 Site History

The former Henrietta Town Dump was owned by the Town of Henrietta and operated by Richard Corsetti and the Henrietta Landfill Corp. Operation of the landfill is reported to have begun in either the 1920s or the 1950s (Ref. 1). In an examination of aerial photos of the site, on file at the Monroe County Environmental Management Council (MCEMC), the 1951 photo showed no disturbance onsite, while the 1961 photo showed disturbance near the northern portion of the site. On this basis, URS believes that the 1950s date is more realistic.

The earliest record available for the site was a 1962 Community Description Report completed by the Monroe County Health Department (Ref. 3). This report lists estimated quantities of solid wastes received from the Town of Henrietta during 1962. Included are 6,000 tons of household waste, 1350 tons of commercial waste and 150 tons of industrial waste. Onsite burning is listed as being both practiced and regulated onsite. Regulation was by the Monroe County Health Department.

Poor management of the landfill in 1964 and 1965, including fires which caused problems for the residents in the adjacent area, were cited in Monroe Health Department memos (Ref. 4). Problems at the landfill cited by the Town of Henrietta included failure to deposit refuse in a trench, failure to compact refuse, failure to cover refuse, permitting refuse to burn, and failure to extinguish fires (Ref. 1). As a result of these problems, the Town of Henrietta contracted with another firm for disposal of the Town's trash at a different location. The site was officially closed on June 1, 1965 (Ref. 5). The property was then sold by the Town in 1966 (Ref. 2,6).

The site is currently unused, but due to its proximity to a residential area and the fact that it is unfenced, it is accessible to the general public. In addition to the bike trails, there is evidence of hunting activities (shotgun shells observed in the southern portion of the site) as well as casual dumping of yard waste along the eastern side of the site near Nevins Road.

A small number of rusted drums were observed protruding from the fill in an extremely brushy area on both sides of the manmade drainage ditch (See Figure 2).

Piles of brush observed during the site inspection near the northern border of the site are evidence that workers from Bestway Environmental, a waste removal company which handles commercial industrial and residential trash, are occasionally onsite. The number of workers and frequency of onsite activity is unknown.

#### 4.2 Site Topography

The Henrietta Town Dump is located in the bed of a former glacial lake. It is directly north of the Mendon Ponds Kame Complex and between two drumlins. The site is lower in elevation than some of the adjacent areas. As a result drainage from areas east, and south of the site is onto the site and into adjacent wetlands west of the site (Ref. 7,8).

#### 4.3 Site Hydrology

##### Surface Water Hydrology

The surface drainage from the Henrietta Town Dump is to the west into NYSDEC Regulated Wetland HR-20. Wetland HR-20 discharges into the East Branch of Red Creek, a class "C" stream (Ref. 9,10).



It was reported that a previous site owner excavated the drainage ditch which runs approximately east-west across the site (Ref. 11).

Additionally, a pond, on the southern portion of the site intercepts some of the runoff. All surface water onsite had a visible oily sheen.

#### Groundwater Hydrology

Groundwater is used for less than 0.1% of the population of the Town of Henrietta (Ref. 13), however none of these wells is believed to be downgradient of the site. The use of wells for potable water in the vicinity of the site is based on a portion of the population of the Town of Henrietta as reported in the 1980 Census. The 1980 Census data does not identify the location of these wells.

Any wells in the area are believed to be screened in the glacial overburden aquifer. In the Town of Henrietta this is typically silt and sand. The water quality from the Salina Group bedrock is poor due to high salt content and hardness, therefore, the overburden aquifer is the preferred aquifer for residential wells.

The Town of Henrietta reports that all of the houses in the area are receiving water from the Monroe County Water Authority (Ref. 12). Groundwater in the overburden is believed to flow to the west from the site.

Bedrock in the vicinity of the Henrietta Town Dump is reportedly the Vernon Shale member of the Silurian Salina Formation (Ref. 17). The Salina Formation consists of dolostone, shale, gypsum and salt layers (Ref. 7). Depth to bedrock is between 20 and 40 feet in the vicinity of the site (Ref. 17, 21).

#### 4.4 Contamination Assessment

A 1962 Community Description Report, completed by the Monroe County Health Department, lists residential as well as industrial and commercial refuse as being received by the facility (Ref. 3). Included in this list are 6,000 tons of household waste, 1350 tons of commercial waste and 150 tons of industrial waste. Reference was made to onsite burning as a disposal method. No reference was made to trenching at the site, but reference to inadequate daily cover was made by the MCHD (Ref. 4). Additionally, problems with inadequate or missing cover were also noted (Ref. 3,4).

Two monitoring wells are present onsite, however, no information could be located regarding their installation or subsequent sampling.

No analytical data could be located for the Henrietta Town Dump during the file search. Since industrial waste disposal has been reported and drums were observed onsite, the possibility of site contamination exists.

## 5. ASSESSMENT OF DATA ADEQUACY AND RECOMMENDATIONS

### 5.1 Hazardous Waste Deposition

There is no documentation of hazardous waste deposition at this site. One hundred fifty tons of industrial waste and 1,350 tons of commercial waste was reportedly deposited at the Henrietta Town Dump in 1962 (Ref. 3). An area containing rusted drums was observed during the site inspection. No information about other years of operation or the onsite drums was located during the file search. No information about the source or nature of the waste could be found. It is not known at this time whether any of the waste could be characterized as hazardous.

### 5.2 Significant Threat Determination

No analytical data exists to characterize the waste deposited at the Henrietta Town Dump. However, documentation indicates at least 150 tons of industrial waste was deposited at the landfill.

The rusted drums onsite indicate that the contents, if any, have a potential to impact the environment.

Due to the proximity of the site to houses along Nevins Road and the indication that both children and adults use the site for recreation as well as onsite dumping of yard waste, there is a potential for direct human contact with the waste (Ref. 15).

### 5.3 Recommendations

Based upon the quantity of commercial and industrial waste deposited at the site, it is recommended that further study be completed at the site. A two-phase study is recommended to allow the site to be

reclassified or delisted. Initially, the following activities should be conducted.

Specific recommendations include:

- o Geophysical study utilizing an EM-31 terrain conductivity meter and ground penetrating radar. This survey might locate any additional drum disposal areas, map the extent of the fill and locate any contaminant plumes.
- o Any intact drums should be sampled and the waste categorized. Drums should be tested for the RCRA hazardous waste characteristics of ignitibility, reactivity, and corrosivity, and EP Toxicity.
- o Surficial soil samples should be collected adjacent to the drum locations and on top of the landfill. Analysis of these samples would enable the NYSDEC to confirm any significant threat to the public through direct contact. The samples should be analyzed for full TCL parameters.
- o A minimum of 15 test pits should be excavated in locations to be determined prior to the commencement of work. Waste samples as well as soil from the excavated pits should be sampled and analyzed for full TCL parameters. Additionally, waste samples should be analyzed for hazardous waste characteristics and EP Toxicity.
- o Surface water and sediment samples from the pond, drainage ditch and NYSDEC Wetland HR-20 should be collected and analyzed for the full TCL parameters.



If hazardous waste or additional drums are encountered during the initial stage of this investigation, additional work may be needed to adequately evaluate this site. If no additional drums or hazardous waste is detected during the first phase of the study, the site should be considered for delisting. This additional work would include:

- o Location of well logs, construction details and analytical results for the two onsite monitoring wells. If inadequate details are obtained, then these wells should be replaced with new wells nearby.
- o Monitoring wells should be installed in the overburden both up and downgradient of the site. They will give groundwater flow direction and detect contamination migrating offsite. It is recommended that the groundwater be analyzed for the full Target Compound List (TCL) parameters.
- o Conduct a well survey to locate any downgradient residential or commercial wells. Any wells located within one mile should be sampled and the water tested for the full Target Compound List (TCL).

Ideally the soil, surface water and sediment samples should be collected in early spring, before the site is heavily vegetated.

# APPENDIX A

## *References*

## APPENDIX A

### REFERENCES

1. Rochester Democrat and Chronicle, May 20, 1965. "News of Your Town", "Henrietta Dump Kills Contract", Kaidy, M.
2. Schirmer, J., Assessor, Town of Henrietta, 1990. Personal Communication with Phyllis Rettke, RE: Ownership of the Henrietta Town Dump.
3. Monroe County Health Department, 1962. Community Description Report, Henrietta Town Dump.
4. DeSantis, J., Monroe County Health Department, 1963 - 1965. Memos to Cook, D., Supervisor, Town of Henrietta, RE: Inspections of the Henrietta Town Dump - 4 Separate Letters.
5. DeSantis, J., Monroe County Department of Health, 1965. Memo RE: Closing of the Henrietta Town Dump.
6. Martin, R., Highway Superintendent for the Town of Henrietta, 1990. RE: Closing date for the dump.
7. Van Diver, B., 1985. Roadside Geology of New York, Mountain Press Publishing Company, Missoula, Montana.
8. New York State Geological Survey, 1970. Geologic Map of New York, Finger Lakes Sheet. Map and Chart Series 15.
9. NYSDEC, 1986. Freshwater Wetland Map for a Portion of Monroe County.
10. Official Compilation, Codes Rules and Regulations of the State of New York, 1967. 6 Conservation, Volume B, Stream Classification.

11. NUS, 1983. Report for USEPA on the Henrietta Town Dump on file at NYSDEC Region 8, Avon, New York.
12. Veneron, K., Deputy Administrator of Public Utilities, Town of Henrietta, 1990. Personal Communication with Phyllis Rettke of URS Consultants, RE: Water Supply to the Town of Henrietta.
13. U.S. Department of Commerce, 1980. Census of Population.
14. Buffington, B., NYSDEC, 1990. Significant Habitat Information.
15. NYSDOH, 1986. Human Exposure Potential Ranking Model, Hazardous Waste Site Inspection Form, Henrietta Town Dump.
16. USDA, 1973. Soil Survey of Monroe County.
17. USACE, 19677 Genesee River Basin study.
18. USEPA, 1984. Uncontrolled Hazardous Waste Site Ranking System, A Users Manual, HW-10.
19. NOAA, 1985. Local Climatological Data, Rochester, New York.
20. USDA, 1977. Important Farmlands, Monroe County.
21. USGS Topographic Maps, West Henrietta, New York 1971, Photo Revised 1978, Pittsford, 1971.
22. Hartzhorn, L., MCEMC, 1991. Personal Communication with Phyllis Rettke of URS Consultants, Inc., RE: Information Search for Onsite Monitoring Wells.



23. Burton, R., MCHD, 1991. Personal Communication with Phyllis Rettke of URS Consultants, Inc., RE: Information Search for Onsite Monitoring Wells.
24. Sirgusa, B., Rochester Drilling, 1991. Personal Communication with Phyllis Rettke of URS Consultants, Inc., RE: Information Search for Onsite Monitoring Wells.
25. Popen, G., Town of Henrietta Assessors Office, 1991. Personal Communication with Phyllis Rettke of URS Consultants, Inc., RE: Information Search for Onsite Monitoring Wells.
26. Caffoe, T., NYSDEC Region 8, 1991. Personal Communication with Phyllis Rettke of URS Consultants, Inc., RE: Information Search for Onsite Monitoring Wells.

# Henrietta Kills Dump Contract

## Signs Deal to Truck Refuse to Scottsville

By MITCH KADY

Citing "persistent . . . failure by the contractor to operate a town dump in accordance with the requirements of a sanitary landfill," the Henrietta Town Board last night canceled its contract with the dump operator.

The board authorized a one-year contract with Sidney Applebaum, operator of Gates-Chill Disposal Co., which will truck refuse to Scottsville.

Supervisor Don W. Cook declared the town dump at Middle and Lehigh Station roads inoperative for the time being but not closed. It will be open to receive dead trees and brush brought in by town trucks.

Edward Clark, 464 Calkins Road, urged the board not to close the dump and suggested the town run it. In the event the Scottsville dump became unavailable or costs there mounted, Clark said, "we shouldn't let ourselves get boxed in."

Phasing out the dump was a prime recommendation of the town's special committee on zoning headed by Councilman Lucien A. Morin. The report was submitted to the town board early this year.

Supervisor Cook read a letter from Dr. Wendell R. Ames, county health director, contending the operator, Richard Corsetti, had been given "every opportunity to operate a sanitary landfill" but his efforts had "proved to be a complete failure."

The town resolution charged Corsetti and Henrietta Landfill Corp. with "failure to deposit refuse in a trench, failure to compact refuse, failure to cover refuse with earth, permitting refuse to burn and failure to extinguish fires."

On the last point, Cook said a fire has been burning or smoldering in the dump for three weeks. It is now being covered with dirt, and should be extinguished shortly.

Cook noted the town had no control over trash collector prices charged to homeowners but estimated that costs should remain about the same under the new con-



Mrs. Nancy Dubner, 83 Harwin Drive, the town was considering requiring by law that trash collectors accept large-size trash if it is tied or placed in a receptacle. Mrs. Dubner asked whether homeowners would be required to transport to Scottsville such articles as discarded water heaters and swing sets that the contractor is not likely to accept.

In its March report, the Morin committee mentioned complaints about fire hazards, smoke and smog, noxious fumes and gases, rats and other factors in its recommendation. Morin added last night that the problem confronted all towns, prompting Monroe County to order a study of a countywide garbage pickup system.

Supervisor Cook said the

town would reopen the dump if costs rose prohibitively and even might enter the collection business. However, he said some residents who discard their own refuse might object to paying if the town went into the business because they would be assessed for a service they don't use.

The City of Rochester will burn town trash under contract in its incinerators, but this is more expensive to town residents than collection by private contractors, the supervisor noted. The town's eight-acre town dump has been operated under contract since the 1920s.

The board approved a low bid of \$9,415 to build a concrete and brick youth cabin in the town Memorial Park. Lowest of three bidders was Robert N. Love.

DEPARTMENT OF  
HEALTH, EDUCATION, AND WELFARE  
PUBLIC HEALTH SERVICECOMMUNITY SOLID WASTE PRACTICES  
COMMUNITY DESCRIPTION REPORT

1. STATE NY 2. COUNTY Mon. 3. COMMUNITY Henrietta

4. DOES THE COMMUNITY OPERATE OR EXERCISE JURISDICTION OVER ALL OR ANY PART OF A SOLID WASTE COLLECTION OR DISPOSAL SYSTEM? (Check one)

OPERATE ☐ YES ☒ NO  
EXERCISE JURISDICTION ☐ YES ☒ NO

5. IF THE COMMUNITY IS A COUNTY, DISTRICT, OR OTHER POLITICAL JURISDICTION CONTAINING INCORPORATED PLACES, LIST SUCH INCORPORATED PLACES INCLUDED IN THIS COMMUNITY

6. ADDITIONAL ENTRIES ARE REQUIRED, CHECK HERE ☐ (31) AND MAKE ADDITIONAL ENTRIES IN ITEM #39.

7. IF THE COMMUNITY IS A COUNTY, DISTRICT, OR OTHER POLITICAL JURISDICTION CONTAINING INCORPORATED PLACES, LIST SUCH INCORPORATED PLACES THAT HAVE BEEN OR WILL BE SURVEYED SEPARATELY

8. ADDITIONAL ENTRIES ARE REQUIRED, CHECK HERE ☐ (32) AND MAKE ADDITIONAL ENTRIES IN ITEM #39.

9. POPULATION OF COMMUNITY, 1947 CENSUS. 43 44 45 46 47 48 49 50 51 52 53 54 55 56 57 58 59 60 61 62  
10. EST. CURRENT POPULATION 25000  
11. TOTAL AREA OF COMMUNITY (Sq. miles) 3.5

12. WHICH PLANNING AGENCIES INCLUDE SOLID WASTES AS PART OF THEIR COMPREHENSIVE PLANNING? (Check all appropriate categories)

63 ☐ NO AGENCY 64 ☐ LOCAL 65 ☒ COUNTY 66 ☐ REGIONAL

13. LEGISLATIVE-ADMINISTRATIVE REGULATIONS GOVERNING ON-SITE STORAGE (Check appropriate categories)

SOURCE	GARBAGE				OTHER REFUSE			
	REGULATIONS		ENFORCED		REGULATIONS		ENFORCED	
	YES	NO	YES	NO	YES	NO	YES	NO
HOUSEHOLD	<input type="checkbox"/>	<input checked="" type="checkbox"/>	<input type="checkbox"/>	<input checked="" type="checkbox"/>	<input type="checkbox"/>	<input checked="" type="checkbox"/>	<input type="checkbox"/>	<input checked="" type="checkbox"/>
COMMERCIAL	<input type="checkbox"/>	<input checked="" type="checkbox"/>	<input type="checkbox"/>	<input checked="" type="checkbox"/>	<input type="checkbox"/>	<input checked="" type="checkbox"/>	<input type="checkbox"/>	<input checked="" type="checkbox"/>
INDUSTRIAL	<input type="checkbox"/>	<input checked="" type="checkbox"/>	<input type="checkbox"/>	<input checked="" type="checkbox"/>	<input type="checkbox"/>	<input checked="" type="checkbox"/>	<input type="checkbox"/>	<input checked="" type="checkbox"/>
AGRICULTURAL	<input type="checkbox"/>	<input checked="" type="checkbox"/>	<input type="checkbox"/>	<input checked="" type="checkbox"/>	<input type="checkbox"/>	<input checked="" type="checkbox"/>	<input type="checkbox"/>	<input checked="" type="checkbox"/>
INSTITUTIONAL	<input type="checkbox"/>	<input checked="" type="checkbox"/>	<input type="checkbox"/>	<input checked="" type="checkbox"/>	<input type="checkbox"/>	<input checked="" type="checkbox"/>	<input type="checkbox"/>	<input checked="" type="checkbox"/>

12. LEGISLATIVE-ADMINISTRATIVE REGULATIONS FOR ON-SITE STORAGE ENFORCED PRIMARILY BY (Check one only)

☐ NO ENFORCEMENT  
☐ OPERATIONAL AUTHORITY  
☐ POLICE  
☒ HEALTH AUTHORITY  
☐ OTHER (Specify)

13. SUPERVISOR FOR WORK PERFORMANCE OF PRIVATE COLLECTORS PROVIDED PRIMARILY BY (Check one only)

☐ NONE ☒ PUBLIC HEALTH  
☒ PUBLIC WORKS ☐ OTHER (Specify)

14. COLLECTION WORK PERFORMED BY (Estimate to nearest 10% volume for each type of refuse. Rows should add horizontally to 100%)

SOURCE	PUBLIC AGENCY	PRIVATE COLLECTOR	INDIVIDUAL
HOUSEHOLD	4	95	1
COMMERCIAL		100	
INDUSTRIAL		100	
INSTITUTIONAL		100	
DEAD ANIMALS		100	
ABANDONED VEHICLES		100	

15. CLASSES OF HOUSEHOLD REFUSE NOT COLLECTED (Check appropriate categories)

GARBAGE ☐  
RUBBISH ☐  
YARD REFUSE ☐  
ASHES ☐  
COMBUSTIBLES ☐  
NON-COMBUSTIBLES ☐  
BULKY ITEMS ☐  
OTHER (Specify) ☐  
OTHER (Specify) ☐  
OTHER (Specify) ☐

16. HOUSEHOLD REFUSE COLLECTION FREQUENCY

TYPES OF REFUSE COLLECTED SEPARATELY	1 PER WEEK	2 PER WEEK	OTHER
COMBINED COLLECTION	<input checked="" type="checkbox"/>	<input type="checkbox"/>	<input type="checkbox"/>
GARBAGE	<input checked="" type="checkbox"/>	<input type="checkbox"/>	<input type="checkbox"/>
RUBBISH	<input checked="" type="checkbox"/>	<input type="checkbox"/>	<input checked="" type="checkbox"/>
YARD REFUSE	<input checked="" type="checkbox"/>	<input type="checkbox"/>	<input checked="" type="checkbox"/>
ASHES	<input checked="" type="checkbox"/>	<input type="checkbox"/>	<input type="checkbox"/>
COMBUSTIBLES	<input checked="" type="checkbox"/>	<input type="checkbox"/>	<input type="checkbox"/>
NON-COMBUSTIBLES	<input checked="" type="checkbox"/>	<input type="checkbox"/>	<input type="checkbox"/>
BULKY ITEMS	<input type="checkbox"/>	<input type="checkbox"/>	<input checked="" type="checkbox"/>
OTHER (Specify)	<input type="checkbox"/>	<input type="checkbox"/>	<input type="checkbox"/>
OTHER (Specify)	<input type="checkbox"/>	<input type="checkbox"/>	<input type="checkbox"/>
OTHER (Specify)	<input type="checkbox"/>	<input type="checkbox"/>	<input type="checkbox"/>



COMMUNITY DESCRIPTION REPORT (Page 2)

3

17. DEAD ANIMALS COLLECTED ANNUALLY

FIGURES AT LEFT REFER TO

NUMBER OF ANIMALS	TONS OF ANIMALS	ARE THESE FIGURES ESTIMATES?
LARGE ANIMALS [ ]	[ ]	<input type="checkbox"/> YES <input type="checkbox"/> NO
SMALL ANIMALS [ ]	[ ]	<input type="checkbox"/> YES <input type="checkbox"/> NO

18. NUMBER OF ABANDONED VEHICLES COLLECTED ANNUALLY

(ENTER NUMBER)

35

19. AVERAGE MANPOWER (MAN-YEARS) AND EQUIPMENT USED COLLECTING COMMUNITY SOLID WASTES

	SOURCES OF WASTES											
	HOUSEHOLD COMMERCIAL INSTITUTIONAL				STREET CLEANING				INDUSTRIAL			
P U D L I C	COLLECTORS AND DRIVERS (MAN-YEARS)											
P R I V A T E	COMPACTOR TRUCKS (NUMBER)											
	OTHER TRUCKS (NUMBER)											
	NUMBER OF FIRMS											
	COLLECTORS AND DRIVERS (MAN-YEARS)											
	COMPACTOR TRUCKS (NUMBER)											
	OTHER TRUCKS (NUMBER)											

20. INDICATE AMOUNTS MEASURED OR ESTIMATED OF COMMUNITY SOLID WASTES COLLECTED ANNUALLY

CLASSIFICATION	MEASURED										ESTIMATED										TONS	YARDS
	0	1	2	3	4	5	6	7	8	9	0	1	2	3	4	5	6	7	8	9		
REFUSE (Household)	0	4																			6000	X
REFUSE (Commercial)																					1350	X
REFUSE (Commercial and household combined)																						
REFUSE (Industrial)																					150	X
REFUSE (Agricultural)	0	5																				
REFUSE (Institutional)																						
DEMOLITION AND CONSTRUCTION REFUSE																						
STREET AND ALLEY CLEANINGS																						
TREE AND LANDSCAPING REFUSE																						
PARK AND BEACH REFUSE	0	6																				
CATCH BASIN REFUSE																						
SEWAGE TREATMENT PLANT SOLIDS AND PUMPING STATION CLEANINGS																						

21. AGENCY PRIMARILY RESPONSIBLE FOR RECOMMENDATIONS FOR LOCATION AND DEVELOPMENT OF NEW DISPOSAL SITES OR FACILITIES (Check one only)

☐ NONE

☒ HEALTH AUTHORITY

☐ OPERATIONAL AUTHORITY

☐ OTHER (Specify)

22. AGENCY PRIMARILY RESPONSIBLE FOR REGULATION OF DISPOSAL FACILITY OPERATIONS (Check one only)

☐ NONE

☐ POLICE

☐ OTHER (Specify)

☐ OPERATIONAL AUTHORITY

☒ HEALTH AUTHORITY

23. IS ON-SITE OPEN BURNING OF DEMOLITION, CONSTRUCTION, AND/OR LAND CLEARANCE WASTES . . .

PRACTICED? ☒ YES ☐ NO

REGULATED? ☒ YES ☐ NO

24. IS ON-SITE OPEN BURNING OF HOUSEHOLD REFUSE . . .

PRACTICED? ☒ YES ☐ NO

REGULATED? ☒ YES ☐ NO

25. IS ON-SITE OPEN BURNING OF COMMERCIAL, INSTITUTIONAL AND/OR AGRICULTURAL WASTES . . .

PRACTICED? ☒ YES ☐ NO

REGULATED? ☒ YES ☐ NO

28. INDICATE BELOW THE NUMBER OF REDUCTION ONLY OR DISPOSAL SITES UTILIZED BY THE COMMUNITY'S PUBLIC COLLECTORS, PRIVATE COLLECTORS AND OR INDIVIDUAL HAULERS (Enter Numbers)

DISPOSAL SITES	PUBLICALLY OPERATED	PRIVATELY OPERATED
LAND DISPOSAL SITES	50 51	52 53
INCINERATORS	54 55	56 57
LANDFILL STATIONS	58 59	60 61
SWINE FEEDING LOTS	62 63	64 65
COMPOST PLANTS	66 67	68 69
TEEPER BURNERS	70 71	72 73
OTHER (Specify)	74 75	76 77
	78 79	80 81
	82 83	84 85
	86 87	88 89
	90 91	92 93
	94 95	96 97
	98 99	100 101

29. REDUCTION AND OR DISPOSAL SITES SERVING THE COMMUNITY

TOTAL	1 2	NUMBER OUTSIDE COMMUNITY	19 20
NUMBER WITHIN COMMUNITY	17 18		

29. USE OF COMPLETED LAND DISPOSAL SITES

(List no. of sites in each category as applicable)

LAND DISPOSAL SITES	NUMBER
RECREATIONAL AREA OR PARK	21 22
PARKING LOT	23 24
LIGHT CONSTRUCTION	25 26
HEAVY CONSTRUCTION	27 28
AGRICULTURAL	29 30
NO SPECIFIC USE	31 32
OTHER (Specify)	33 34
	DO NOT USE 35
OTHER (Specify)	36 37
	DO NOT USE 38
OTHER (Specify)	39 40
	DO NOT USE 41

30. NUMBER OF PROMISCUOUS DUMP WITHIN THE COMMUNITY'S BOUNDARIES KNOWN TO BE ACTIVE

(Enter Number) 0

IF INFORMATION IS NOT AVAILABLE CHECK HERE ☐

30. ESTIMATED NUMBER OF HOUSEHOLD GARBAGE GRINDERS INSTALLED

(Enter Number) 500

31. ESTIMATED NUMBER OF GARBAGE GRINDERS IN COMMERCIAL AND INSTITUTIONAL ESTABLISHMENTS

(Enter Number) 15

32. ESTIMATED NUMBER OF ON-SITE INCINERATORS SERVING APARTMENT HOUSES, COMMERCIAL AND INSTITUTIONAL ESTABLISHMENTS

(Enter Number) 50

33. ESTIMATED NUMBER OF HOUSEHOLD ON-SITE INCINERATORS

(Enter Number) 10

34. COMMUNITY FUNDS BUDGETED FOR COLLECTION OF SOLID WASTES FOR CALENDAR OR FISCAL YEAR, 1967

a. EXCLUDING CAPITAL EXPENDITURES

\$ 16518

b. CAPITAL EXPENDITURES ONLY

\$

35. COMMUNITY FUNDS BUDGETED FOR DISPOSAL OF SOLID WASTES FOR CALENDAR OR FISCAL YEAR, 1967

13 0 14 8

a. EXCLUDING CAPITAL EXPENDITURES

\$ 48000

b. CAPITAL EXPENDITURES ONLY

\$

36. CLASSES OF REFUSE FOR WHICH COLLECTION AND/OR DISPOSAL FUNDS HAVE BEEN BUDGETED FOR CALENDAR OR FISCAL YEAR, 1967

REFUSE CATEGORY	COLLECTION	DISPOSAL
REFUSE (Household)	31 <input checked="" type="checkbox"/>	32 <input type="checkbox"/>
REFUSE (Commercial)	33 <input type="checkbox"/>	34 <input type="checkbox"/>
REFUSE (Industrial)	35 <input type="checkbox"/>	36 <input type="checkbox"/>
REFUSE (Agricultural)	37 <input type="checkbox"/>	38 <input type="checkbox"/>
REFUSE (Institutional)	39 <input type="checkbox"/>	40 <input type="checkbox"/>
STREET AND ALLEY CLEANINGS	41 <input checked="" type="checkbox"/>	42 <input type="checkbox"/>
DEMOLITION AND CONSTRUCTION REFUSE	43 <input type="checkbox"/>	44 <input type="checkbox"/>
TREE AND LANDSCAPING REFUSE	45 <input checked="" type="checkbox"/>	46 <input type="checkbox"/>
PARK AND BEACH REFUSE	47 <input type="checkbox"/>	48 <input type="checkbox"/>
CATCH BASIN REFUSE	49 <input type="checkbox"/>	50 <input type="checkbox"/>
SEWAGE TREATMENT PLANT SOLIDS AND PUMPING STATION CLEANINGS	51 <input type="checkbox"/>	52 <input type="checkbox"/>
DEAD ANIMALS	53 <input type="checkbox"/>	54 <input type="checkbox"/>
ABANDONED VEHICLES	55 <input type="checkbox"/>	56 <input type="checkbox"/>
OTHER (Specify)	57 <input type="checkbox"/>	58 <input type="checkbox"/>
OTHER (Specify)	59 <input type="checkbox"/>	60 <input type="checkbox"/>





15. <input type="checkbox"/> UNUSUALLY <input type="checkbox"/> SIGHTLY <input type="checkbox"/> APPEARANCE	16. <input type="checkbox"/> YES <input type="checkbox"/> NO <input type="checkbox"/> CONTROLLED	17. <input type="checkbox"/> YES <input type="checkbox"/> NO <input type="checkbox"/> IS BLOWING PAPER CONSIDERED TO BE A HAZARD?	18. <input type="checkbox"/> YES <input type="checkbox"/> NO <input type="checkbox"/> UNCONTROLLED <input type="checkbox"/> LIMITED <input type="checkbox"/> PLANNED AND	19. <input type="checkbox"/> YES <input type="checkbox"/> NO <input type="checkbox"/> ARE THERE SURFACE DRAINAGE PROBLEMS?	20. <input type="checkbox"/> YES <input type="checkbox"/> NO <input type="checkbox"/> ARE THERE LEACHING PROBLEMS?
---	--	---	--	--	--

21. GENERAL CHARACTER OF OPERATION (Judgment evaluation - check appropriate categories)

(Enter average per year)

22. NUMBER OF DAYS DISPOSAL SITE COULD NOT BE USED BECAUSE OF WEATHER CONNECTED CONDITIONS

23. FREQUENCY OF COVER <input type="checkbox"/> NONE <input type="checkbox"/> DAILY (except working day) <input type="checkbox"/> DAILY (working day) <input type="checkbox"/> OTHER (Specify)	24. IS SPREADING AND COMPACTION OF REFUSE HANDLED IN APPROXIMATELY TWO-FOOT LAYERS OR LESS? <input type="checkbox"/> YES <input type="checkbox"/> NO
--	--

25. WILL PUBLIC AGENCY CONTROL COMPLETED SITE USE? <input type="checkbox"/> YES <input type="checkbox"/> NO	26. MATERIAL USED FOR COVER <input type="checkbox"/> NONE <input type="checkbox"/> EARTH <input type="checkbox"/> OTHER (Specify)
---	---

27. IS USE OF COMPLETED SITE PLANNED? <input type="checkbox"/> YES <input type="checkbox"/> NO	28. IF YES, CHECK <input type="checkbox"/> RECREATIONAL <input type="checkbox"/> AREA OR PARK <input type="checkbox"/> LIGHT <input type="checkbox"/> CONSTRUCTION <input type="checkbox"/> AGRICULTURE <input type="checkbox"/> NO SPECIFIC USE
29. ZONING SURROUNDING SITE (Check predominant type only) <input type="checkbox"/> NONE <input type="checkbox"/> RESIDENTIAL <input type="checkbox"/> INDUSTRIAL <input type="checkbox"/> OTHER (Specify)	30. <input type="checkbox"/> COMMERCIAL <input type="checkbox"/> AGRICULTURAL

31. GENERAL CHARACTER OF SITE (CHECK ONE ONLY) <input type="checkbox"/> QUARRY OR BORROW PIT <input type="checkbox"/> GULLY-CANYON <input type="checkbox"/> LEVEL AREAS <input type="checkbox"/> OTHER (Specify)	32. Do not use 5A
33. 15. YEAR SITE PLACED IN OPERATION	34. 16. ANTICIPATED LIFE REMAINING (Years)
35. 17. TOTAL AREA OF SITE (Acres)	36. 18. AREA TO BE USED FOR LAND DISPOSAL (Acres)

37. 13. IS OPERATION REGULATED BY A HEALTH AUTHORITY? <input type="checkbox"/> YES <input type="checkbox"/> NO	38. IF YES, INDICATE LEVEL OF PRINCIPAL AUTHORITY <input type="checkbox"/> STATE <input type="checkbox"/> COUNTY <input type="checkbox"/> OTHER (Specify)
--	---

39. NAME OF POLITICAL JURISDICTION SERVED BY LAND DISPOSAL SITE	40. ESTIMATED PERCENT OF JURISDICTION SERVED BY SITE	41. AVERAGE DISTANCE OF SITE FROM CENTER OF SOURCE AREA (Miles)
42. 11. SITE OPERATED BY <input type="checkbox"/> PUBLIC AGENCY <input type="checkbox"/> PRIVATE AGENCY	43. 12. SITE OWNED BY <input type="checkbox"/> PUBLIC AGENCY <input type="checkbox"/> PRIVATE AGENCY	44. FOR ADDITIONAL ENTRIES, CHECK HERE (93)

45. 1. NAME OF PERSON COMPLETING FORM	46. 2. TITLE	47. 3. SITE LOCATION (Within Jurisdiction)	48. 4. ADDRESS OF SITE	49. 5. DATE OF SURVEY
50. 6. NAME OF SITE	51. 7. COUNTY	52. 8. ORGANIZATION AND ADDRESS	53. 9. DAY	54. 10. MONTH

LAND DISPOSAL SITE INVESTIGATION REPORT

COMMUNITY SOLID WASTE PRACTICES



CONTROL PROGRAMS		YES	NO	Do not use
RODENT CONTROL PROGRAM	NEEDED <input type="checkbox"/>	<input type="checkbox"/>	<input type="checkbox"/>	21
	PROVIDED <input type="checkbox"/>	<input type="checkbox"/>	<input type="checkbox"/>	22
FLY CONTROL PROGRAM	NEEDED <input type="checkbox"/>	<input type="checkbox"/>	<input type="checkbox"/>	23
	PROVIDED <input type="checkbox"/>	<input type="checkbox"/>	<input type="checkbox"/>	24
BIRD CONTROL PROGRAM	NEEDED <input type="checkbox"/>	<input type="checkbox"/>	<input type="checkbox"/>	25
	PROVIDED <input type="checkbox"/>	<input type="checkbox"/>	<input type="checkbox"/>	26
DUST CONTROL PROGRAM	NEEDED <input type="checkbox"/>	<input type="checkbox"/>	<input type="checkbox"/>	27
	PROVIDED <input type="checkbox"/>	<input type="checkbox"/>	<input type="checkbox"/>	28
COOR CONTROL PROGRAM	NEEDED <input type="checkbox"/>	<input type="checkbox"/>	<input type="checkbox"/>	29
	PROVIDED <input type="checkbox"/>	<input type="checkbox"/>	<input type="checkbox"/>	30

34. ARE QUANTITATIVE RECORDS KEPT IN ANY FORM? <input type="checkbox"/> YES <input type="checkbox"/> NO		Do not use 47
35. QUANTITIES OF SOLID WASTES RECEIVED ANNUALLY		
TONS WEIGHED	44 49 50 51 52 53 54	
TONS ESTIMATED	55 56 57 58 59 60 61	
CUBIC YARDS	62 63 64 65 66 67 68 69	
36. GENERAL CLASSIFICATION OF SOLID WASTES ACCEPTED AT DISPOSAL SITE (Check those accepted)		
<input type="checkbox"/> HOUSEHOLD 70	<input type="checkbox"/> INDUSTRIAL 72	<input type="checkbox"/> INSTITUTIONAL 74
<input type="checkbox"/> COMMERCIAL 71	<input type="checkbox"/> AGRICULTURAL 73	<input type="checkbox"/> INCINERATOR RESIDUE 75
37. CHECK ANY ITEMS LISTED BELOW WHICH ARE EXCLUDED FROM THE DISPOSAL SITE		
<input type="checkbox"/> ALL PUTRESCIBLES 15	<input type="checkbox"/> SEWAGE SOLIDS 21	<input type="checkbox"/> TIRES 27
<input type="checkbox"/> ALL NON-COMBUSTIBLES 16	<input type="checkbox"/> JUNKED AUTOMOBILES 22	<input type="checkbox"/> HAZARDOUS MATERIALS 23
<input type="checkbox"/> ALL COMBUSTIBLES 17	<input type="checkbox"/> LARGE APPLIANCES 23	<input type="checkbox"/> OTHER (Specify) 29
<input type="checkbox"/> GARBAGE 18	<input type="checkbox"/> DEMOLITION WASTES 24	<input type="checkbox"/> OTHER (Specify) 31
<input type="checkbox"/> DEAD ANIMALS 19	<input type="checkbox"/> CONSTRUCTION DEBRIS 25	
<input type="checkbox"/> WASTE OIL 20	<input type="checkbox"/> STREET SWEEPINGS 26	<input type="checkbox"/> OTHER (Specify) 33

38. EQUIPMENT AVAILABLE (Average utilized daily)		NUMBER
DRAGLINE OR SHOVEL-TYPE EXCAVATORS		35 36
CRAPERS (Self-propelled)		37 38
TRACTOR (Truck or Rubber Tire) (D bulldozer or High Lift)		39 40
TRUCKS		41 42
OTHER (Specify) _____	Do not use 43	44 45
OTHER (Specify) _____	Do not use 46	47 48
39. TOTAL NUMBER OF EMPLOYEES ON SITE (Average daily)		
40. HOURS OF DAILY OPERATION BEGIN _____ END _____		
41. NUMBER OF DAYS OPERATED PER WEEK _____		
42. ANNUAL OPERATING COST (Including supervision and equipment maintenance) \$ _____		
43. IS THIS A SANITARY LANDFILL? <input type="checkbox"/> YES <input type="checkbox"/> NO		

4. IF SOURCES OTHER THAN REPORTER DESIGNATED IN ITEM 7 WERE UTILIZED IN COMPLETING THIS FORM, INDICATE BELOW THE SOURCES USED AND ITEM NUMBERS

NAME OF PERSON	TITLE	ORGANIZATION	ITEM NUMBER(S)





April 11, 1963

Mr. Don W. Cook, Supervisor  
Town of Henrietta  
Henrietta Town Hall  
Erie Station Road  
Henrietta, New York

Dear Mr. Cook:

An inspection has been made of the Henrietta Town dump off of the Lehigh Station Road. This particular dump leaves much to be desired. It is not covered daily, the cover material is of a heavy clay. It is my hope that some arrangements can be made to improve the conditions. If it is not feasible to bring in good cover material and to cover this area on a daily basis I would suggest that the Town of Henrietta look for and obtain a new site which can be easily maintained in a sanitary manner.

If we can be of service to you regarding this problem please let us know.

Very truly yours,

JD:JM

Joseph DeSantis  
Associate Sanitarian

April 25, 1963

Mr. Don W. Cook, Supervisor  
Henrietta Town Hall  
Erie Station Road  
Henrietta, New York

Re: Henrietta Refuse  
Disposal Area

Dear Mr. Cook:

In my meeting with Mr. Corsetti he has assured me that he will operate a sanitary landfill and conform to the requirements of Part 19 of the New York State Sanitary Code and that the deficiencies which I discussed in my previous letter can be overcome. The only time Mr. Corsetti feels that he will have difficulties would be in inclement, cold weather. I assured him that he will be given every opportunity in the next few months to bring his portion of the landfill up to minimum standards.

I would suggest to you that someone from your staff be assigned to keep a close surveillance on the over-all operation including that portion of the landfill which is not included in the area operated by Mr. Corsetti and then possibly this area could advantageously serve the Town for a good number of years.

I am sure that the efforts of both the Town and Mr. Corsetti are needed to gain this end.

Very truly yours,

JD:JM  
cc: Richard Corsetti  
193 St. Patricks Dr.

Joseph DeSantis  
Associate Sanitarian

(4)  
April 23, 1964

Mr. Don W. Cook, Supervisor  
Henrietta Town Hall  
Erie Station Road  
Henrietta, New York 14467

Dear Mr. Cook:

For over a year now we have been trying to get the Henrietta dump in an acceptable condition so that it will conform to the requirements of the New York State Sanitary Code. It is still my opinion that the reason this dump can not be brought up to these standards is that good cover material is not readily available. I would suggest that either the dirt be hauled in and stockpiled, or that this dump be abandoned.

I believe that in the future stern measures will be taken in order to make all of our refuse disposal areas in the County conform to the minimum standards set up by the State of New York.

Respectfully yours,

JD:JM  
cc: Richard Corsetti  
193 St. Patricks Dr.

Joseph DeSantis  
Associate Public Health Engineer

4  
April 25, 1965

Don W. Cook, Supervisor  
Henrietta Town Hall  
475 Calkins Road  
Henrietta, New York 14467

Dear Mr. Cook:

For some time the Health Department has given Mr. Richard Corsetti every opportunity to operate a sanitary landfill on your Lehigh Station Road site. We feel that his efforts now have proved to be a complete failure. We are therefore advising the town of Henrietta to be prepared to close the Town Dump on June 1st, 1965 if the area is not in compliance with Part XIX of the New York State Sanitary Code prior to that date.

Very truly yours,

WRA:JM  
cc: Richard Corsetti  
193 St. Patricks Dr.

W. R. Ames, M.D.  
Director

**MONROE COUNTY DEPARTMENT OF HEALTH**

**44 MARSHALL STREET**

**MEMORANDUM**

**Date** July 9, 1965

**From:** Joseph DeSantis

**To:** File

**Subject:** Henrietta Dump

Dump closed June 1, 1965.



HR-21

HR-17

HR-20

HR-19

HR-10

9

MAP SCALE  
1" = 2000'

This is a section of the  
Flood Freshwater Wetlands Map  
of the State of New York  
County  
under Article 26 of the Environmental  
Conservation Law  
New York State Department of Environmental  
Conservation

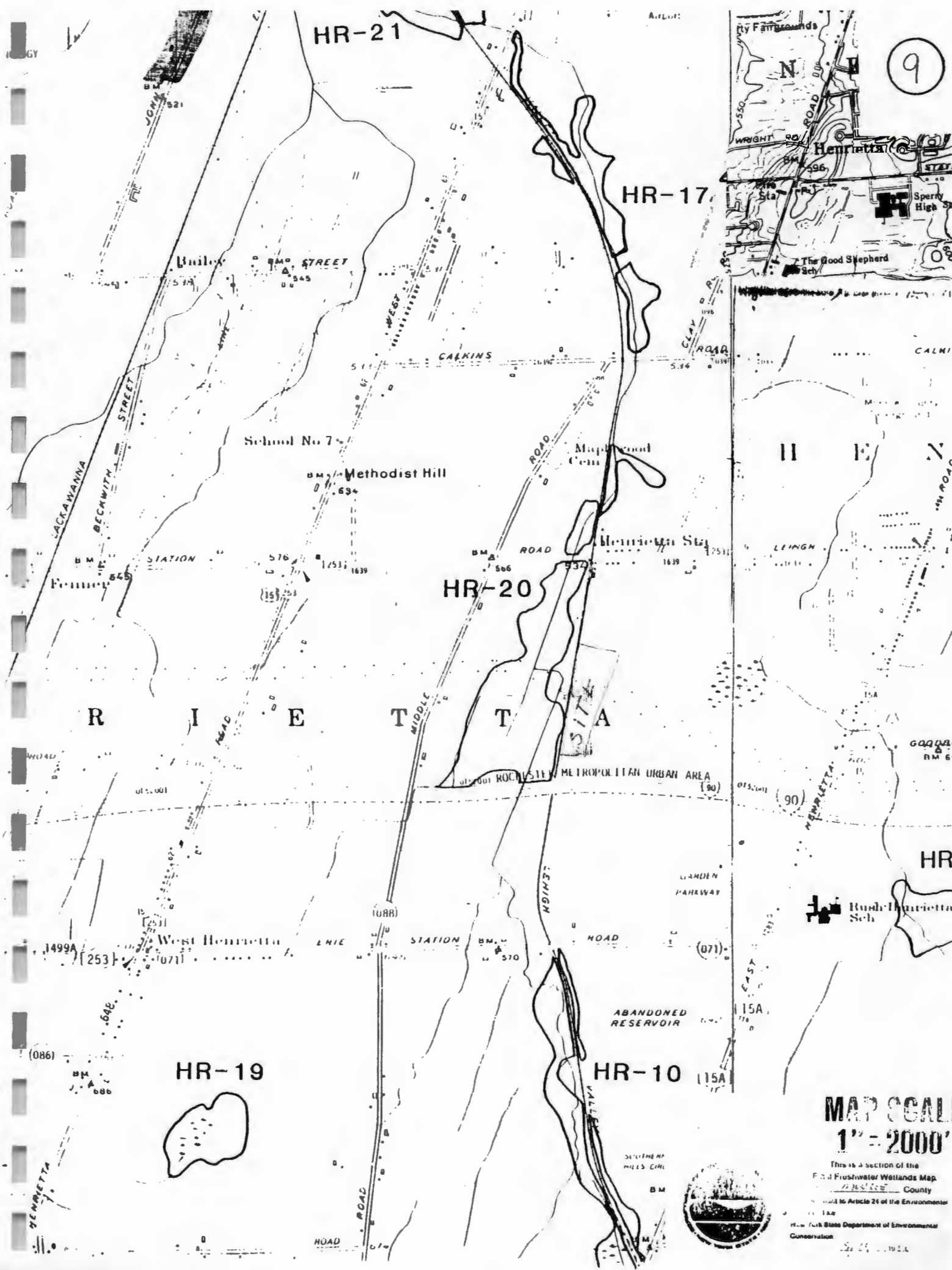

14

New York State Department of Environmental Conservation

Wildlife Resources Center  
Information Services  
700 Troy-Schenectady Road  
Latham, New York 12110-2400



Thomas C. Jorling  
Commissioner

RECEIVED

OCT 26, 1990

OCT 29 1990

Phyllis Rettke  
URS Consultants, Inc.  
570 Delaware Ave.  
Buffalo, NY 14202

35231.00 (50.0)

Dear Ms. Rettke:

We have reviewed the Significant Habitat Unit and the NY Natural Heritage Program files with respect to your request for biological information concerning seven Preliminary Site Assessments in Monroe County, N.Y.

We have identified two concerns on the Sigismondi Site #828011. The first is that a rare plant, the Sweet-scented Indian-Plantain (*Cacalia suaveolens*), was historically found in the vicinity of this site in the Allen Creek area of Penfield. This rare plant, ranked G4? S1 by the New York Natural Heritage Program, may still be present if suitable habitat still exists. We recommend a thorough search of the area by a qualified individual at the appropriate time of the year.

Also located near this project is a Significant Habitat, DEC #28-005, identified as the Lower Valley of Tributary 10 of Irondequoit Creek. This is a unique natural environment located in an urban area.

We did not identify any rarities or significant habitats on the other six sites.

Our files are continually growing as new habitats and occurrences of rare species and communities are discovered. In most cases, site-specific or comprehensive surveys for plant and animal occurrences have not been conducted. For these reasons, we can only provide data which have been assembled from our files. We cannot provide a definitive statement on the presence or absence of species, habitats or natural communities. This information should not be substituted for on-site surveys that may be required for environmental assessment.

This response applies only to known occurrences of rare animals, plants and natural communities and/or significant wildlife habitats. You should contact our regional office, Division of Regulatory Affairs, at the address enclosed for information regarding any regulated areas or permits that may be required (e.g., regulated wetlands) under State law.

If this project is still active one year from now we recommend that you contact us again so that we may update this response.

Sincerely,

*B. Buffington*

Burrell Buffington  
Significant Habitat Unit

Encs.

cc: Reg. 8, Regional Wildlife Mgr.

New York Heritage Program is supported in  
part by The Nature Conservancy

Distribution	
PR	✓
RR	
DMC	
VW	
FILE	

## **APPENDIX B**

*Site Inspection Report*  
*USEPA Form 2070-13*





POTENTIAL HAZARDOUS WASTE SITE  
SITE INSPECTION REPORT  
PART 1 - SITE LOCATION AND INSPECTION INFORMATION

I. IDENTIFICATION

01 STATE NY 02 SITE NUMBER D980762801

II. SITE NAME AND LOCATION

01 SITE NAME (Legal, common, or descriptive name of site) Henrietta Town Dump		02 STREET, ROUTE NO., OR SPECIFIC LOCATION IDENTIFIER Lehigh Station Road			
03 CITY Henrietta	04 STATE NY	05 ZIP CODE	06 COUNTY Monroe	07 COUNTY CODE	08 CONG DIST
09 COORDINATES LATITUDE 43° 03' 07" N LONGITUDE 77° 38' 00" W		10 TYPE OF OWNERSHIP (Check one) <input checked="" type="checkbox"/> A. PRIVATE <input type="checkbox"/> B. FEDERAL <input type="checkbox"/> C. STATE <input type="checkbox"/> D. COUNTY <input type="checkbox"/> E. MUNICIPAL <input type="checkbox"/> F. OTHER <input type="checkbox"/> G. UNKNOWN			

III. INSPECTION INFORMATION

01 DATE OF INSPECTION 10 / 17 / 90 MONTH DAY YEAR	02 SITE STATUS <input type="checkbox"/> ACTIVE <input checked="" type="checkbox"/> INACTIVE	03 YEARS OF OPERATION approx. 1950 1966 BEGINNING YEAR ENDING YEAR UNKNOWN	
04 AGENCY PERFORMING INSPECTION (Check all that apply) <input type="checkbox"/> A. EPA <input type="checkbox"/> B. EPA CONTRACTOR <input type="checkbox"/> C. MUNICIPAL <input type="checkbox"/> D. MUNICIPAL CONTRACTOR <input type="checkbox"/> E. STATE <input checked="" type="checkbox"/> F. STATE CONTRACTOR URS Consultants (Name of firm) <input type="checkbox"/> G. OTHER (Specify)			

05 CHIEF INSPECTOR Phyllis Rettke	06 TITLE Geologist	07 ORGANIZATION URS	08 TELEPHONE NO. (716) 882-5525
09 OTHER INSPECTORS Ed Yurkstas	10 TITLE Associate Public Health Sanitarian	11 ORGANIZATION MCHD	12 TELEPHONE NO. (716) 274-6052
Ed Schmidt	Waste Recycling and Recovery	Bestway Disposal	(716) 334-4410
			( )
			( )
			( )

13 SITE REPRESENTATIVES INTERVIEWED	14 TITLE	15 ADDRESS	16 TELEPHONE NO.
			( )
			( )
			( )
			( )
			( )
			( )
			( )
			( )

17 ACCESS GAINED BY (Check one) <input checked="" type="checkbox"/> PERMISSION <input type="checkbox"/> WARRANT	18 TIME OF INSPECTION 11:30 AM	19 WEATHER CONDITIONS Sunny, 60's
---	-----------------------------------	--------------------------------------

IV. INFORMATION AVAILABLE FROM

01 CONTACT Phyllis Rettke	02 OF (Agency/Organization) URS Consultants		03 TELEPHONE NO. (716) 883-5525
04 PERSON RESPONSIBLE FOR SITE INSPECTION FORM Same	05 AGENCY	06 ORGANIZATION	07 TELEPHONE NO. 08 DATE 11 / 1 / 90 MONTH DAY YEAR







POTENTIAL HAZARDOUS WASTE SITE  
SITE INSPECTION REPORT  
PART 3 - DESCRIPTION OF HAZARDOUS CONDITIONS AND INCIDENTS

I. IDENTIFICATION

01 STATE 02 SITE NUMBER  
NY D980762801

II. HAZARDOUS CONDITIONS AND INCIDENTS

01 ☒ A. GROUNDWATER CONTAMINATION 02 ☐ OBSERVED (DATE: \_\_\_\_\_) ☒ POTENTIAL ☐ ALLEGED  
03 POPULATION POTENTIALLY AFFECTED: \_\_\_\_\_ 04 NARRATIVE DESCRIPTION  
Groundwater is not used 3 miles downgradient from site. Groundwater may discharge into NYSDEC regulated wetland HR-20.

01 ☒ B. SURFACE WATER CONTAMINATION 02 ☐ OBSERVED (DATE: \_\_\_\_\_) ☒ POTENTIAL ☐ ALLEGED  
03 POPULATION POTENTIALLY AFFECTED: \_\_\_\_\_ 04 NARRATIVE DESCRIPTION  
NYSDEC regulated wetland HR-20 is adjacent to the site.

01 ☐ C. CONTAMINATION OF AIR 02 ☐ OBSERVED (DATE: \_\_\_\_\_) ☐ POTENTIAL ☐ ALLEGED  
03 POPULATION POTENTIALLY AFFECTED: \_\_\_\_\_ 04 NARRATIVE DESCRIPTION  
None

01 ☐ D. FIRE/EXPLOSIVE CONDITIONS 02 ☐ OBSERVED (DATE: \_\_\_\_\_) ☐ POTENTIAL ☐ ALLEGED  
03 POPULATION POTENTIALLY AFFECTED: \_\_\_\_\_ 04 NARRATIVE DESCRIPTION  
NA

01 ☒ E. DIRECT CONTACT 02 ☒ OBSERVED (DATE: 10/17/90) ☐ POTENTIAL ☐ ALLEGED  
03 POPULATION POTENTIALLY AFFECTED: \_\_\_\_\_ 04 NARRATIVE DESCRIPTION  
Tire tracks were observed along the paths which circle and cross the site, shotgun shells were observed on the southern half of the site. There is a residential area adjacent to the site.

01 ☒ F. CONTAMINATION OF SOIL 02 ☐ OBSERVED (DATE: \_\_\_\_\_) ☒ POTENTIAL ☐ ALLEGED  
03 AREA POTENTIALLY AFFECTED: unknown 04 NARRATIVE DESCRIPTION  
(Acres)  
Unstable containment of wastes could contaminate soil.

01 ☐ G. DRINKING WATER CONTAMINATION 02 ☐ OBSERVED (DATE: \_\_\_\_\_) ☐ POTENTIAL ☐ ALLEGED  
03 POPULATION POTENTIALLY AFFECTED: \_\_\_\_\_ 04 NARRATIVE DESCRIPTION  
Unknown but unlikely

01 ☐ H. WORKER EXPOSURE/INJURY 02 ☐ OBSERVED (DATE: \_\_\_\_\_) ☐ POTENTIAL ☐ ALLEGED  
03 WORKERS POTENTIALLY AFFECTED: unknown 04 NARRATIVE DESCRIPTION  
An unknown number of workers are on the northern portion of the site. Frequency of exposure and number of workers is unknown.

01 ☒ I. POPULATION EXPOSURE/INJURY 02 ☐ OBSERVED (DATE: \_\_\_\_\_) ☐ POTENTIAL ☐ ALLEGED  
03 POPULATION POTENTIALLY AFFECTED: 29,032 04 NARRATIVE DESCRIPTION  
Population within a .3 mile radius of the site.



POTENTIAL HAZARDOUS WASTE SITE  
SITE INSPECTION REPORT  
PART 3 - DESCRIPTION OF HAZARDOUS CONDITIONS AND INCIDENTS

I. IDENTIFICATION

01 STATE NY 02 SITE NUMBER D980762801

II. HAZARDOUS CONDITIONS AND INCIDENTS (Continued)

01 ☐ J. DAMAGE TO FLORA 02 ☐ OBSERVED (DATE: \_\_\_\_\_) ☐ POTENTIAL ☐ ALLEGED

04 NARRATIVE DESCRIPTION

None observed

01 ☐ K. DAMAGE TO FAUNA 02 ☐ OBSERVED (DATE: \_\_\_\_\_) ☐ POTENTIAL ☐ ALLEGED

04 NARRATIVE DESCRIPTION (Include names of species)

None observed

01 ☒ L. CONTAMINATION OF FOOD CHAIN 02 ☐ OBSERVED (DATE: \_\_\_\_\_) ☒ POTENTIAL ☐ ALLEGED

04 NARRATIVE DESCRIPTION

Any contaminants migrating from the rusted drums have the potential to contaminate the food chain.

01 ☒ M. UNSTABLE CONTAINMENT OF WASTES 02 ☒ OBSERVED (DATE: 10/17/90) ☐ POTENTIAL ☐ ALLEGED

(Spills, Runoff, Standing liquids, Leaking drums)

03 POPULATION POTENTIALLY AFFECTED: \_\_\_\_\_ 04 NARRATIVE DESCRIPTION

A number of drums were observed eroding from the fill. The landfill is unlined and was never properly operated.

01 ☒ N. DAMAGE TO OFFSITE PROPERTY 02 ☐ OBSERVED (DATE: \_\_\_\_\_) ☒ POTENTIAL ☐ ALLEGED

04 NARRATIVE DESCRIPTION

Runoff from the site has the potential to damage NYSDEC regulated wetland HR-20

01 ☐ O. CONTAMINATION OF SEWERS, STORM DRAINS, WWTPs 02 ☐ OBSERVED (DATE: \_\_\_\_\_) ☐ POTENTIAL ☐ ALLEGED

04 NARRATIVE DESCRIPTION

NA

01 ☒ P. ILLEGAL/UNAUTHORIZED DUMPING 02 ☒ OBSERVED (DATE: 11/1/90) ☐ POTENTIAL ☐ ALLEGED

04 NARRATIVE DESCRIPTION

Leaves and branches were observed along the eastern edge of the landfill behind the houses on Nevins Road

05 DESCRIPTION OF ANY OTHER KNOWN, POTENTIAL, OR ALLEGED HAZARDS

III. TOTAL POPULATION POTENTIALLY AFFECTED: \_\_\_\_\_

IV. COMMENTS

V. SOURCES OF INFORMATION (Cite specific references, e.g., State files, sampling analysis, reports)

Site inspection 10/17/90

NYSDEC Freshwater Wetlands map





POTENTIAL HAZARDOUS WASTE SITE  
SITE INSPECTION  
PART 4 - PERMIT AND DESCRIPTIVE INFORMATION

I. IDENTIFICATION  
01 STATE NY 02 SITE NUMBER D980762801

II. PERMIT INFORMATION

01 TYPE OF PERMIT ISSUED (Check all that apply)	02 PERMIT NUMBER	03 DATE ISSUED	04 EXPIRATION DATE	05 COMMENTS
<input type="checkbox"/> A. NPDES				
<input type="checkbox"/> B. UIC				
<input type="checkbox"/> C. AIR				
<input type="checkbox"/> D. RCRA				
<input type="checkbox"/> E. RCRA INTERIM STATUS				
<input type="checkbox"/> F. SPCC PLAN				
<input type="checkbox"/> G. STATE (Specify)				
<input type="checkbox"/> H. LOCAL (Specify)				
<input type="checkbox"/> I. OTHER (Specify)				
<input checked="" type="checkbox"/> J. NONE				

III. SITE DESCRIPTION

01 STORAGE/DISPOSAL (Check all that apply)	02 AMOUNT	03 UNIT OF MEASURE	04 TREATMENT (Check all that apply)	05 OTHER
<input type="checkbox"/> A. SURFACE IMPOUNDMENT			<input type="checkbox"/> A. INCINERATION	<input type="checkbox"/> A. BUILDINGS ON SITE
<input type="checkbox"/> B. PILES			<input type="checkbox"/> B. UNDERGROUND INJECTION	
<input checked="" type="checkbox"/> C. DRUMS, ABOVE GROUND	10+		<input type="checkbox"/> C. CHEMICAL/PHYSICAL	none
<input type="checkbox"/> D. TANK, ABOVE GROUND			<input type="checkbox"/> D. BIOLOGICAL	06 AREA OF SITE
<input type="checkbox"/> E. TANK, BELOW GROUND			<input type="checkbox"/> E. WASTE OIL PROCESSING	19 (Acres)
<input checked="" type="checkbox"/> F. LANDFILL	unknown		<input type="checkbox"/> F. SOLVENT RECOVERY	
<input type="checkbox"/> G. LANDFARM			<input type="checkbox"/> G. OTHER RECYCLING/RECOVERY	
<input type="checkbox"/> H. OPEN DUMP			<input type="checkbox"/> H. OTHER (Specify)	
<input type="checkbox"/> I. OTHER (Specify)			none	

07 COMMENTS

IV. CONTAINMENT

01 CONTAINMENT OF WASTES (Check one)  
☐ A. ADEQUATE, SECURE unknown ☐ B. MODERATE ☐ C. INADEQUATE, POOR ☐ D. INSECURE, UNSOUND, DANGEROUS

02 DESCRIPTION OF DRUMS, DIKING, LINERS, BARRIERS, ETC.

A number of rusted drums were observed eroding from the fill along the western side of the site.  
The landfill is unlined.

V. ACCESSIBILITY

01 WASTE EASILY ACCESSIBLE: ☒ YES ☐ NO  
02 COMMENTS

The barrier to the wastes was an overgrowth of foliage. When the plants die back in the winter, the wastes will be accessible.

VI. SOURCES OF INFORMATION (Cite specific references, e.g. state files, sample analysis reports)

Site inspection 10/17/90  
Assessor, Town of Henrietta



POTENTIAL HAZARDOUS WASTE SITE  
SITE INSPECTION REPORT  
PART 5 - WATER, DEMOGRAPHIC, AND ENVIRONMENTAL DATA

I. IDENTIFICATION

01 STATE NY 02 SITE NUMBER D980762801

II. DRINKING WATER SUPPLY

01 TYPE OF DRINKING SUPPLY (Check as applicable)	02 STATUS	03 DISTANCE TO SITE															
<table><tr><td>SURFACE</td><td>WELL</td></tr><tr><td>COMMUNITY A. <input checked="" type="checkbox"/></td><td>B. <input type="checkbox"/></td></tr><tr><td>NON-COMMUNITY C. <input type="checkbox"/></td><td>D. <input checked="" type="checkbox"/></td></tr></table>	SURFACE	WELL	COMMUNITY A. <input checked="" type="checkbox"/>	B. <input type="checkbox"/>	NON-COMMUNITY C. <input type="checkbox"/>	D. <input checked="" type="checkbox"/>	<table><tr><td>ENDANGERED</td><td>AFFECTED</td><td>MONITORED</td></tr><tr><td>A. <input type="checkbox"/></td><td>B. <input type="checkbox"/></td><td>C. <input type="checkbox"/></td></tr><tr><td>D. <input type="checkbox"/></td><td>E. <input type="checkbox"/></td><td>F. <input type="checkbox"/></td></tr></table>	ENDANGERED	AFFECTED	MONITORED	A. <input type="checkbox"/>	B. <input type="checkbox"/>	C. <input type="checkbox"/>	D. <input type="checkbox"/>	E. <input type="checkbox"/>	F. <input type="checkbox"/>	A. <u>&gt;3</u> (mi) B. <u>unknown</u> (mi)
SURFACE	WELL																
COMMUNITY A. <input checked="" type="checkbox"/>	B. <input type="checkbox"/>																
NON-COMMUNITY C. <input type="checkbox"/>	D. <input checked="" type="checkbox"/>																
ENDANGERED	AFFECTED	MONITORED															
A. <input type="checkbox"/>	B. <input type="checkbox"/>	C. <input type="checkbox"/>															
D. <input type="checkbox"/>	E. <input type="checkbox"/>	F. <input type="checkbox"/>															

III. GROUNDWATER

01 GROUNDWATER USE IN VICINITY (Check one)

☐ A. ONLY SOURCE FOR DRINKING    ☐ B. DRINKING (Other sources available)  
COMMERCIAL, INDUSTRIAL, IRRIGATION (No other water sources available)

☐ C. COMMERCIAL, INDUSTRIAL, IRRIGATION (Limited other sources available)    ☒ D. NOT USED, UNUSEABLE

02 POPULATION SERVED BY GROUND WATER <u>0</u>	03 DISTANCE TO NEAREST DRINKING WATER WELL <u>NA</u> (mi)			
04 DEPTH TO GROUNDWATER <u>10</u> (ft)	05 DIRECTION OF GROUNDWATER FLOW <u>assumed west</u>	06 DEPTH TO AQUIFER OF CONCERN <u>10</u> (ft)	07 POTENTIAL YIELD OF AQUIFER <u>unknown</u> (gpd)	08 SOLE SOURCE AQUIFER <input type="checkbox"/> YES <input checked="" type="checkbox"/> NO

09 DESCRIPTION OF WELLS (including usage, depth, and location relative to population and buildings)

Unknown, no construction details or well logs for the monitoring wells onsite were located during the file search.

10 RECHARGE AREA	11 DISCHARGE AREA
<input type="checkbox"/> YES    COMMENTS	<input checked="" type="checkbox"/> YES    COMMENTS Site discharges into wetland adjacent to the site
<input type="checkbox"/> NO	<input type="checkbox"/> NO

IV. SURFACE WATER

01 SURFACE WATER USE (Check one)

☒ A. RESERVOIR, RECREATION, DRINKING WATER SOURCE    ☐ B. IRRIGATION, ECONOMICALLY IMPORTANT RESOURCES    ☐ C. COMMERCIAL, INDUSTRIAL    ☐ D. NOT CURRENTLY USED

02 AFFECTED/POTENTIALLY AFFECTED BODIES OF WATER

NAME:	AFFECTED	DISTANCE TO SITE
<u>Red Creek - class "C" stream</u>	<input type="checkbox"/>	<u>0.04</u> (mi)
<u>NYSDEC wetland HR-20</u>	<input type="checkbox"/>	<u>0.04</u> (mi)
	<input type="checkbox"/>	

V. DEMOGRAPHIC AND PROPERTY INFORMATION

01 TOTAL POPULATION WITHIN	02 DISTANCE TO NEAREST POPULATION									
<table><tr><td>ONE (1) MILE OF SITE</td><td>TWO (2) MILES OF SITE</td><td>THREE (3) MILES OF SITE</td></tr><tr><td>A. <u>3232</u></td><td>B. <u>12,930</u></td><td>C. <u>29,092</u></td></tr><tr><td>NO. OF PERSONS</td><td>NO. OF PERSONS</td><td>NO. OF PERSONS</td></tr></table>	ONE (1) MILE OF SITE	TWO (2) MILES OF SITE	THREE (3) MILES OF SITE	A. <u>3232</u>	B. <u>12,930</u>	C. <u>29,092</u>	NO. OF PERSONS	NO. OF PERSONS	NO. OF PERSONS	<u>0.04</u> (mi)
ONE (1) MILE OF SITE	TWO (2) MILES OF SITE	THREE (3) MILES OF SITE								
A. <u>3232</u>	B. <u>12,930</u>	C. <u>29,092</u>								
NO. OF PERSONS	NO. OF PERSONS	NO. OF PERSONS								
03 NUMBER OF BUILDINGS WITHIN TWO (2) MILES OF SITE <u>3403</u>	04 DISTANCE TO NEAREST OFF-SITE BUILDING <u>0.04</u> (mi)									

05 POPULATION WITHIN VICINITY OF SITE (Provide narrative description of nature of population within vicinity of site, e.g., rural, village, densely populated urban area)

The population east of the site is located in a suburban subdivision, north of the site is a commercial area.



POTENTIAL HAZARDOUS WASTE SITE  
SITE INSPECTION REPORT  
PART 5 - WATER, DEMOGRAPHIC, AND ENVIRONMENTAL DATA

I. IDENTIFICATION  
01 STATE NY 02 SITE NUMBER D980762801

VI. ENVIRONMENTAL INFORMATION

01 PERMEABILITY OF UNSATURATED ZONE (Check one)

☐ A.  $10^{-8}$  -  $10^{-6}$  cm/sec ☐ B.  $10^{-4}$  -  $10^{-6}$  cm/sec ☒ C.  $10^{-4}$  -  $10^{-3}$  cm/sec ☐ D. GREATER THAN  $10^{-3}$  cm/sec

02 PERMEABILITY OF BEDROCK (Check one)

☐ A. IMPERMEABLE (Less than  $10^{-8}$  cm/sec) ☒ B. RELATIVELY IMPERMEABLE ( $10^{-6}$  -  $10^{-8}$  cm/sec) ☐ C. RELATIVELY PERMEABLE ( $10^{-2}$  -  $10^{-4}$  cm/sec) ☐ D. VERY PERMEABLE (Greater than  $10^{-2}$  cm/sec)

03 DEPTH TO BEDROCK

20-40 (ft)

04 DEPTH OF CONTAMINATED SOIL ZONE

unknown (ft)

05 SOIL pH

unknown

06 NET PRECIPITATION

6 (in)

07 ONE YEAR 24 HOUR RAINFALL

3.85 (in)

08 SLOPE

SITE SLOPE 1% %

DIRECTION OF SITE SLOPE W

TERRAIN AVERAGE SLOPE 1% %

09 FLOOD POTENTIAL

Not in floodplain  
SITE IS IN YEAR FLOODPLAIN

10

☐ SITE IS ON BARRIER ISLAND, COASTAL HIGH HAZARD AREA, RIVERINE FLOODWAY  
no

11 DISTANCE TO WETLANDS (5 acre minimum)

ESTUARINE

A. NA (mi)

OTHER

B. 0.2 (mi)

12 DISTANCE TO CRITICAL HABITAT (of endangered species)

(mi)

ENDANGERED SPECIES: None reported

13 LAND USE IN VICINITY

DISTANCE TO:

COMMERCIAL/INDUSTRIAL

A. 0.4 (mi)

RESIDENTIAL AREAS, NATIONAL/STATE PARKS,  
FORESTS, OR WILDLIFE RESERVES

B. 0.1 (mi)

AGRICULTURAL LANDS  
PRIME AG LAND

C. >2 (mi)

AG LAND

D. >1 (mi)

14 DESCRIPTION OF SITE IN RELATION TO SURROUNDING TOPOGRAPHY

The former landfill site is only slightly higher in elevation than the adjacent wetland to the west. The surface of the site is extremely irregular and very overgrown. Due to the excessive growth of vegetation, it was very difficult to observe the true topography of the site.

VII. SOURCES OF INFORMATION (Cite specific references, e.g., state files, aerial photos, reports)

NOAA, 1985, Climatological Data, Rochester, N.Y.  
USACOE, 1967, Genesee River Basin Study, Plate F #7  
USGS, 1978 West Henrietta Quadrangle





POTENTIAL HAZARDOUS WASTE SITE  
SITE INSPECTION REPORT  
PART 6 - SAMPLE AND FIELD INFORMATION

I. IDENTIFICATION

01 STATE | 02 SITE NUMBER  
NY | D980762801

II. SAMPLES TAKEN

SAMPLE TYPE	01 NUMBER OF SAMPLES TAKEN	02 SAMPLES SENT TO	03 ESTIMATED DATE RESULTS AVAILABLE
GROUNDWATER			
SURFACE WATER			
WASTE			
AIR			
RUNOFF			
SPILL			
SOIL			
VEGETATION			
OTHER		NONE	

III. FIELD MEASUREMENTS TAKEN

01 TYPE	02 COMMENTS
HNu-PID	No readings above background - 10/17/90
Radiation Meter	No readings above background - 10/17/90

IV. PHOTOGRAPHS AND MAPS Aerial - Monroe County Environmental Management Council

01 TYPE <input checked="" type="checkbox"/> GROUND <input type="checkbox"/> AERIAL	02 IN CUSTODY OF URS Consultants, Inc., Buffalo, New York <small>(Name of organization or individual)</small>
03 MAPS <input checked="" type="checkbox"/> YES <input type="checkbox"/> NO	04 LOCATION OF MAPS URS Consultants, 570 Delaware Avenue, Buffalo, New York 14202

V. OTHER FIELD DATA COLLECTED (Provide narrative description)

VI. SOURCES OF INFORMATION (Cite specific references, e.g. state files, sample analysis reports)

Site Inspection - 10/17/90  
Monroe County Environmental Management Council



POTENTIAL HAZARDOUS WASTE SITE  
SITE INSPECTION REPORT  
PART 7 - OWNER INFORMATION

I. IDENTIFICATION

01 STATE NY 02 SITE NUMBER D980762801

II. CURRENT OWNER(S)				PARENT COMPANY (If applicable)			
01 NAME 1233 Lehigh Station Back Acreage Corp.		02 D+B NUMBER 1989 to present		08 NAME		09 D+B NUMBER	
03 STREET ADDRESS (P.O. Box, RFD #, etc.) 1233 Lehigh Station Road		04 SIC CODE		10 STREET ADDRESS (P.O. Box, RFD #, etc.)		11 SIC CODE	
05 CITY Henrietta		06 STATE NY	07 ZIP CODE 14467	12 CITY		13 STATE	14 ZIP CODE
01 NAME		02 D+B NUMBER		08 NAME		09 D+B NUMBER	
03 STREET ADDRESS (P.O. Box, RFD #, etc.)		04 SIC CODE		10 STREET ADDRESS (P.O. Box, RFD #, etc.)		11 SIC CODE	
05 CITY		06 STATE	07 ZIP CODE	12 CITY		13 STATE	14 ZIP CODE
01 NAME		02 D+B NUMBER		08 NAME		09 D+B NUMBER	
03 STREET ADDRESS (P.O. Box, RFD #, etc.)		04 SIC CODE		10 STREET ADDRESS (P.O. Box, RFD #, etc.)		11 SIC CODE	
05 CITY		06 STATE	07 ZIP CODE	12 CITY		13 STATE	14 ZIP CODE
01 NAME		02 D+B NUMBER		08 NAME		09 D+B NUMBER	
03 STREET ADDRESS (P.O. Box, RFD #, etc.)		04 SIC CODE		10 STREET ADDRESS (P.O. Box, RFD #, etc.)		11 SIC CODE	
05 CITY		06 STATE	07 ZIP CODE	12 CITY		13 STATE	14 ZIP CODE
III. PREVIOUS OWNER(S) (List most recent first)				IV. REALTY OWNER(S) (If applicable, list most recent first)			
01 NAME Genesee Valley Waste Systems Formerly Bestway Disposal		02 D+B NUMBER		01 NAME		02 D+B NUMBER	
03 STREET ADDRESS (P.O. Box, RFD #, etc.) 1233 Lehigh Station Rd.		04 SIC CODE		03 STREET ADDRESS (P.O. Box, RFD #, etc.)		04 SIC CODE	
05 CITY Henrietta		06 STATE NY	07 ZIP CODE 14467	05 CITY		06 STATE	07 ZIP CODE
01 NAME Clifford Barcomb		02 D+B NUMBER 1974-1981		01 NAME		02 D+B NUMBER	
03 STREET ADDRESS (P.O. Box, RFD #, etc.) 22 Bishops Ct.		04 SIC CODE		03 STREET ADDRESS (P.O. Box, RFD #, etc.)		04 SIC CODE	
05 CITY Pittsford		06 STATE NY	07 ZIP CODE 14534	05 CITY		06 STATE	07 ZIP CODE
01 NAME Wembly Construction		02 D+B NUMBER 1966-1974		01 NAME		02 D+B NUMBER	
03 STREET ADDRESS (P.O. Box, RFD #, etc.) 1233 Lehigh Station Road		04 SIC CODE		03 STREET ADDRESS (P.O. Box, RFD #, etc.)		04 SIC CODE	
05 CITY Henrietta		06 STATE NY	07 ZIP CODE 14467	05 CITY		06 STATE	07 ZIP CODE
V. SOURCES OF INFORMATION (Cite specific references, e.g., state files, sample analysis, reports)							
James Schirmer, Assessor, Town of Henrietta Town of Henrietta Transferred ownership to Wembly Construction in 1966							



POTENTIAL HAZARDOUS WASTE SITE  
SITE INSPECTION REPORT  
PART 8 - OPERATOR INFORMATION

I. IDENTIFICATION  
01 STATE NY 02 SITE NUMBER D980762801

II. CURRENT OPERATOR (Provide if different from owner)				OPERATOR'S PARENT COMPANY (If applicable)			
01 NAME		02 D+B NUMBER		10 NAME		11 D+B NUMBER	
03 STREET ADDRESS (P.O. Box, RFD #, etc.)		04 SIC CODE		12 STREET ADDRESS (P.O. Box, RFD #, etc.)		13 SIC CODE	
05 CITY		06 STATE	07 ZIP CODE	14 CITY		15 STATE	16 ZIP CODE
08 YEARS OF OPERATION		09 NAME OF OWNER					
III. PREVIOUS OPERATOR(S) (List most recent first; provide only if different from owner)				PREVIOUS OPERATORS' PARENT COMPANIES (If applicable)			
01 NAME Richard Corsetti Henrietta Landfill Corp.		02 D+B NUMBER		10 NAME		11 D+B NUMBER	
03 STREET ADDRESS (P.O. Box, RFD #, etc.)		04 SIC CODE		12 STREET ADDRESS (P.O. Box, RFD #, etc.)		13 SIC CODE	
05 CITY Henrietta		06 STATE NY	07 ZIP CODE	14 CITY		15 STATE	16 ZIP CODE
08 YEARS OF OPERATION 1950's?-1965		09 NAME OF OWNER DURING THIS PERIOD Town of Henrietta					
01 NAME		02 D+B NUMBER		10 NAME		11 D+B NUMBER	
03 STREET ADDRESS (P.O. Box, RFD #, etc.)		04 SIC CODE		12 STREET ADDRESS (P.O. Box, RFD #, etc.)		13 SIC CODE	
05 CITY		06 STATE	07 ZIP CODE	14 CITY		15 STATE	16 ZIP CODE
08 YEARS OF OPERATION		09 NAME OF OWNER DURING THIS PERIOD					
01 NAME		02 D+B NUMBER		10 NAME		11 D+B NUMBER	
03 STREET ADDRESS (P.O. Box, RFD #, etc.)		04 SIC CODE		12 STREET ADDRESS (P.O. Box, RFD #, etc.)		13 SIC CODE	
05 CITY		06 STATE	07 ZIP CODE	14 CITY		15 STATE	16 ZIP CODE
08 YEARS OF OPERATION		09 NAME OF OWNER DURING THIS PERIOD					

IV. SOURCES OF INFORMATION (Cite specific references, e.g., state files, sample analysis, reports)

James Schirmer, Assessor, Town of Henrietta





POTENTIAL HAZARDOUS WASTE SITE  
SITE INSPECTION REPORT  
PART 9 - GENERATOR/TRANSPORTER INFORMATION

I. IDENTIFICATION  
01 STATE 02 SITE NUMBER  
NY D980762801

II. ON-SITE GENERATOR

01 NAME	02 D+B NUMBER	
03 STREET ADDRESS (P.O. Box, RFD #, etc.)	04 SIC CODE	
05 CITY	06 STATE 07 ZIP CODE	

III. OFF-SITE GENERATOR(S)

01 NAME	02 D+B NUMBER	01 NAME	02 D+B NUMBER
03 STREET ADDRESS (P.O. Box, RFD #, etc.)	04 SIC CODE	03 STREET ADDRESS (P.O. Box, RFD #, etc.)	04 SIC CODE
05 CITY	06 STATE 07 ZIP CODE	05 CITY	06 STATE 07 ZIP CODE
01 NAME	02 D+B NUMBER	01 NAME	02 D+B NUMBER
03 STREET ADDRESS (P.O. Box, RFD #, etc.)	04 SIC CODE	03 STREET ADDRESS (P.O. Box, RFD #, etc.)	04 SIC CODE
05 CITY	06 STATE 07 ZIP CODE	05 CITY	06 STATE 07 ZIP CODE

IV. TRANSPORTER(S)

01 NAME Unknown	02 D+B NUMBER	01 NAME	02 D+B NUMBER
03 STREET ADDRESS (P.O. Box, RFD #, etc.)	04 SIC CODE	03 STREET ADDRESS (P.O. Box, RFD #, etc.)	04 SIC CODE
05 CITY	06 STATE 07 ZIP CODE	05 CITY	06 STATE 07 ZIP CODE
01 NAME	02 D+B NUMBER	01 NAME	02 D+B NUMBER
03 STREET ADDRESS (P.O. Box, RFD #, etc.)	04 SIC CODE	03 STREET ADDRESS (P.O. Box, RFD #, etc.)	04 SIC CODE
05 CITY	06 STATE 07 ZIP CODE	05 CITY	06 STATE 07 ZIP CODE

V. SOURCES OF INFORMATION (Case specific references, e.g., state files, sample analysis, reports)

NYSDEC Region 8 Files





POTENTIAL HAZARDOUS WASTE SITE  
SITE INSPECTION REPORT  
PART 10 - PAST RESPONSE ACTIVITIES

L IDENTIFICATION

01 STATE 02 SITE NUMBER  
NY D989762801

II. PAST RESPONSE ACTIVITIES

01 ☐ A. WATER SUPPLY CLOSED  
04 DESCRIPTION

02 DATE \_\_\_\_\_

03 AGENCY \_\_\_\_\_

01 ☐ B. TEMPORARY WATER SUPPLY PROVIDED  
04 DESCRIPTION

02 DATE \_\_\_\_\_

03 AGENCY \_\_\_\_\_

01 ☐ C. PERMANENT WATER SUPPLY PROVIDED  
04 DESCRIPTION

02 DATE \_\_\_\_\_

03 AGENCY \_\_\_\_\_

01 ☐ D. SPILLED MATERIAL REMOVED  
04 DESCRIPTION

02 DATE \_\_\_\_\_

03 AGENCY \_\_\_\_\_

01 ☐ E. CONTAMINATED SOIL REMOVED  
04 DESCRIPTION

02 DATE \_\_\_\_\_

03 AGENCY \_\_\_\_\_

01 ☐ F. WASTE REPACKAGED  
04 DESCRIPTION

02 DATE \_\_\_\_\_

03 AGENCY \_\_\_\_\_

01 ☐ G. WASTE DISPOSED ELSEWHERE  
04 DESCRIPTION

02 DATE \_\_\_\_\_

03 AGENCY \_\_\_\_\_

01 ☐ H. ON SITE BURIAL  
04 DESCRIPTION

02 DATE \_\_\_\_\_

03 AGENCY \_\_\_\_\_

01 ☐ I. IN SITU CHEMICAL TREATMENT  
04 DESCRIPTION

02 DATE \_\_\_\_\_

03 AGENCY \_\_\_\_\_

01 ☐ J. IN SITU BIOLOGICAL TREATMENT  
04 DESCRIPTION

02 DATE \_\_\_\_\_

03 AGENCY \_\_\_\_\_

01 ☐ K. IN SITU PHYSICAL TREATMENT  
04 DESCRIPTION

02 DATE \_\_\_\_\_

03 AGENCY \_\_\_\_\_

01 ☐ L. ENCAPSULATION  
04 DESCRIPTION

02 DATE \_\_\_\_\_

03 AGENCY \_\_\_\_\_

01 ☐ M. EMERGENCY WASTE TREATMENT  
04 DESCRIPTION

02 DATE \_\_\_\_\_

03 AGENCY \_\_\_\_\_

01 ☐ N. CUTOFF WALLS  
04 DESCRIPTION

02 DATE \_\_\_\_\_

03 AGENCY \_\_\_\_\_

01 ☐ O. EMERGENCY DIKING/SURFACE WATER DIVERSION  
04 DESCRIPTION

02 DATE \_\_\_\_\_

03 AGENCY \_\_\_\_\_

01 ☐ P. CUTOFF TRENCHES/SUMP  
04 DESCRIPTION

02 DATE \_\_\_\_\_

03 AGENCY \_\_\_\_\_

01 ☐ Q. SUBSURFACE CUTOFF WALL  
04 DESCRIPTION

02 DATE \_\_\_\_\_

03 AGENCY \_\_\_\_\_



POTENTIAL HAZARDOUS WASTE SITE  
SITE INSPECTION REPORT  
PART 10 - PAST RESPONSE ACTIVITIES

I. IDENTIFICATION

01 STATE 02 SITE NUMBER  
NY D980762801

II PAST RESPONSE ACTIVITIES (Continued)

01 ☐ R. BARRIER WALLS CONSTRUCTED  
04 DESCRIPTION

02 DATE \_\_\_\_\_

03 AGENCY \_\_\_\_\_

01 ☐ S. CAPPING/COVERING  
04 DESCRIPTION

02 DATE \_\_\_\_\_

03 AGENCY \_\_\_\_\_

01 ☐ T. BULK TANKAGE REPAIRED  
04 DESCRIPTION

02 DATE \_\_\_\_\_

03 AGENCY \_\_\_\_\_

01 ☐ U. GROUT CURTAIN CONSTRUCTED  
04 DESCRIPTION

02 DATE \_\_\_\_\_

03 AGENCY \_\_\_\_\_

01 ☐ V. BOTTOM SEALED  
04 DESCRIPTION

02 DATE \_\_\_\_\_

03 AGENCY \_\_\_\_\_

01 ☐ W. GAS CONTROL  
04 DESCRIPTION

02 DATE \_\_\_\_\_

03 AGENCY \_\_\_\_\_

01 ☐ X. FIRE CONTROL  
04 DESCRIPTION

02 DATE \_\_\_\_\_

03 AGENCY \_\_\_\_\_

01 ☐ Y. LEACHATE TREATMENT  
04 DESCRIPTION

02 DATE \_\_\_\_\_

03 AGENCY \_\_\_\_\_

01 ☐ Z. AREA EVACUATED  
04 DESCRIPTION

02 DATE \_\_\_\_\_

03 AGENCY \_\_\_\_\_

01 ☐ 1. ACCESS TO SITE RESTRICTED  
04 DESCRIPTION

02 DATE \_\_\_\_\_

03 AGENCY \_\_\_\_\_

01 ☐ 2. POPULATION RELOCATED  
04 DESCRIPTION

02 DATE \_\_\_\_\_

03 AGENCY \_\_\_\_\_

01 ☐ 3. OTHER REMEDIAL ACTIVITIES  
04 DESCRIPTION

02 DATE \_\_\_\_\_

03 AGENCY \_\_\_\_\_

III. SOURCES OF INFORMATION (Cite specific references, e.g., state files, sample analysis, reports)



POTENTIAL HAZARDOUS WASTE SITE  
SITE INSPECTION REPORT  
PART 11 - ENFORCEMENT INFORMATION

I. IDENTIFICATION

01 STATE	02 SITE NUMBER
NY	D980762801

II. ENFORCEMENT INFORMATION

01 PAST REGULATORY/ENFORCEMENT ACTION ☐ YES ☐ NO

02 DESCRIPTION OF FEDERAL, STATE, LOCAL REGULATORY/ENFORCEMENT ACTION

III. SOURCES OF INFORMATION (See specific references, e.g., state files, sample analysis, reports)

## APPENDIX C

### *Interview Documentation Forms*



JOB NO. 35231.00.122

JOB NAME Henrietta Town Dump

**MEMO OF TELECON**

DATE 11/1/90

TELEPHONE 1-334-7700

PERSON CALLING Phyllis Pettke

PERSON CALLED James Schirmer

REPRESENTING URS

REPRESENTING Assessor, Tr of Henrietta

PURPOSE OF TELECON AND/OR EQUIPMENT INVOLVED: \_\_\_\_\_

**TEXT OF TELECON**

Henrietta Site

Tax ID # 175.200-01-083.100

① Current owners = 1233 Back Acreage Corp

Date of property change = July 14, 1989

Tax mailing address

270 E Highway 50 Suite 230

Wintergarden, Fla 32787

② Previous owner = Genesee Valley Waste Systems  
formerly Bestway Disposal (Mr Rock)  
from 1981

③ Previous owner = Clifford Barcomb

1976 - 2 parcels made into 1

1974 Cliff Bar Inc

1970 - Leslie Moore + wife transferred additional prop to  
Wembley

1966 Tr of Henrietta to Wembley Construction Co

buyers attorney = Chamberlin & Demonda  
1-716-232-3730

cc: \_\_\_\_\_

JOB NO. 35231.00.122

JOB NAME Henrietta Town Dump

**MEMO OF TELECON**

DATE 10/18

TELEPHONE 334-7700

PERSON CALLING Phyllis Rottke

PERSON CALLED Russ Martin

REPRESENTING URS

REPRESENTING Tn of Henrietta, Highway Dept

PURPOSE OF TELECON AND/OR EQUIPMENT INVOLVED: \_\_\_\_\_

**TEXT OF TELECON**

Highway garage moved 1965-66 and 4 before it was  
used after highway garage moved

Early to mid 1960's <sup>definitely</sup> 1968 closed

CC: \_\_\_\_\_

JOB NO. 35231.00.122/124 JOB NAME Hennetta Town Dump / John Street**MEMO OF TELECON**

DATE 12/6/90 TELEPHONE 716-334-7700  
PERSON CALLING Phyllis Rettke PERSON CALLED Ken Veneron  
REPRESENTING URS REPRESENTING Deputy Administrator of Public  
PURPOSE OF TELECON AND/OR EQUIPMENT INVOLVED: Utilities - Tn of Hennetta

**TEXT OF TELECON**

The Town of Hennetta has a municipal water supply - they buy water from the Monroe County Water Authority.

All water supplies in the area of the old Hennetta Town Dump and John Street sites is municipal. There are a few wells in the Town of Hennetta, but not in those two areas. The water lines near the Hennetta Town Dump have been in use since 1953.

The source of the water is Hemlock Lake and Lake Ontario.

CC: \_\_\_\_\_



**URS**

AN INTERNATIONAL PROFESSIONAL SERVICES ORGAN

JOB NO. 35231.00.122JOB NAME Henrietta Town Dump**MEMO OF TELECON**DATE 5/7/91TELEPHONE 428-5745PERSON CALLING Phyllis RettkePERSON CALLED Louise HartzhornREPRESENTING URSREPRESENTING MCEMC

PURPOSE OF TELECON AND/OR EQUIPMENT INVOLVED: \_\_\_\_\_

**TEXT OF TELECON**

No well information is available for wells in Monroe County. MCEMC has no info. on wells onsite at the Henrietta Town Dump. Suggested I call Richard Burton of the MCHDS Environmental Lab.

CC: \_\_\_\_\_



JOB NO. 35231.00.122

JOB NAME Henrietta Town Dump

**MEMO OF TELECON**

DATE

5/1/91

TELEPHONE

274-6819

PERSON CALLING

Phyllis Rettke

PERSON CALLED

Richard Burton

REPRESENTING

URS

REPRESENTING

MC HD-environmental

PURPOSE OF TELECON AND/OR EQUIPMENT INVOLVED:

**TEXT OF TELECON**

has no information about wells onsite. Suggested  
that they might be a Rochester Drilling well as  
it is orange in color.

JOB NO. 35231.00.122

JOB NAME Henrietta Town Dump

**MEMO OF TELECON**

DATE 5/7/91

TELEPHONE 458-0821

PERSON CALLING Phyllis Rettke

PERSON CALLED Ben Sargusa

REPRESENTING URS

REPRESENTING Rochester Dulling

PURPOSE OF TELECON AND/OR EQUIPMENT INVOLVED: \_\_\_\_\_

**TEXT OF TELECON**

Said he might be able to locate the wells if I sent him a copy of the site map. Faxed him a copy to 458-5041. Said he would call back with info.

5/8/91 Ben called to say that they are not RD wells.

CC: \_\_\_\_\_

JOB NO. 35231.00.122

JOB NAME Henrietta Town Dump

**MEMO OF TELECON**

DATE

5/8/91

TELEPHONE

334-7700

PERSON CALLING

Phyllis Rettke

PERSON CALLED

Gary Apen

REPRESENTING

URS

REPRESENTING

Henrietta Assessors's Off

PURPOSE OF TELECON AND/OR EQUIPMENT INVOLVED:

**TEXT OF TELECON**

Referred to Assessors office by Town Clerk's Office. Mr Apen didn't know if there were any records for the site and if so, where they might be found.

JOB NO. 35231.00.122

JOB NAME Henrietta Town Damp

**MEMO OF TELECON**

DATE

5/8/91

TELEPHONE

226-2466

PERSON CALLING

Phyllis Rettke

PERSON CALLED

Todd Caffee

REPRESENTING

URS

REPRESENTING

NYSDEC Region 8

PURPOSE OF TELECON AND/OR EQUIPMENT INVOLVED:

**TEXT OF TELECON**

*Doesn't know anything about these wells.  
First learned about them from the report.*

*Says if the owner is will not cooperate  
we may have to cut the locks off to sample  
the site.*



## APPENDIX D

### *Hazard Ranking System*

FACILITY NAME: HENRIETTA TOWN DUMP

LOCATION: Lehigh Station Road, Henrietta, New York

EPA REGION: II

PERSON(S) IN CHARGE OF THE FACILITY: 1233 Back Acreage Corp.

1233 Lehigh Station Road

Henrietta, New York 14467

NAME OF REVIEWER: URS Consultants, Inc. DATE: 1/24/91

**GENERAL DESCRIPTION OF THE FACILITY:**

(For example: landfill, surface impoundment, pile, container; types of hazardous substances; location of the facility; contamination route of major concern; types of information needed for rating; agency action;etc.)

The Henrietta Town Dump is a former municipal landfill which was owned by the Town of Henrietta, but was operated under contract with a private operator. The landfill was poorly managed with inadequate daily cover and numerous fires onsite. Although burning was an accepted method of disposal in the early 1960's, the Town of Henrietta decided to close the landfill in 1965. The types of materials disposed of at the site are unknown. Rusted drums were observed during the site inspection.

SCORES: Sm= 5.17 (Sgw = 7.33 Ssw = 5.13 Sa = 0.00)

Sfe = 0.00

Sdc = 16.67

**HRS COVER SHEET**

GROUND WATER ROUTE WORK SHEET					
RATING FACTOR	ASSIGNED VALUE	MULTI-PLIER	SCORE	MAX. SCORE	REF. (SECTION)
1 OBSERVED RELEASE	0 45 0	1	0	45	3.1
IF OBSERVED RELEASE IS GIVEN A SCORE OF 45, PROCEED TO LINE 4 IF OBSERVED RELEASE IS GIVEN A SCORE OF 0, PROCEED TO LINE 2					
2 ROUTE CHARACTERISTICS					3.2
DEPTH TO AQUIFER OF CONCERN	0 1 2 3 3	2	6	6	
NET PRECIPITATION	0 1 2 3 2	1	2	3	
PERMEABILITY OF THE UNSATURATED ZONE	0 1 2 3 1	1	1	3	
PHYSICAL STATE	0 1 2 3 1	1	1	3	
TOTAL ROUTE CHARACTERISTICS SCORE			10	15	
3 CONTAINMENT	0 1 2 3 3	1	3	3	3.3
4 WASTE CHARACTERISTICS					
TOXICITY/PERSISTANCE	0 3 6 9 6	1	6	18	3.4
HAZARDOUS WASTE QUANTITY	12 15 18 4 4 5 6 7 8	1	4	8	
TOTAL WASTE CHARACTERISTICS SCORE			10	26	
5 TARGETS					
GROUND WATER USE	0 1 2 3 2	3	6	9	
DISTANCE TO NEAREST WELL /POPULATION SERVED	0 4 6 8 10 12 16 18 8 24 30 32 35 40	1	8	40	
TOTAL TARGETS SCORE			14	49	
6 IF LINE 1 IS 45, MULTIPLY 1 X 4 X 5 IF LINE 1 IS 0, MULTIPLY 2 X 3 X 4 X 5			0 4200	57,330	
7 DIVIDE LINE 6 BY 57,330 AND MULTIPLY BY 100					
Sgw =			7.33		

GROUND WATER ROUTE WORK SHEET

SURFACE WATER ROUTE WORK SHEET						
RATING FACTOR	ASSIGNED VALUE	MULTI-PLIER	SCORE	MAX. SCORE	REF. (SECTION)	
1 OBSERVED RELEASE	0 45 <input type="text" value="0"/>	1	0	45	4.1	
IF OBSERVED RELEASE IS GIVEN A SCORE OF 45, PROCEED TO LINE 4 IF OBSERVED RELEASE IS GIVEN A SCORE OF 0, PROCEED TO LINE 2						
2 ROUTE CHARACTERISTICS					4.2	
FACILITIES SLOPE AND INTERVENING TERRAIN	0 1 2 3 <input type="text" value="1"/>	1	1	3		
1-yr 24 HOUR RAINFALL	0 1 2 3 <input type="text" value="3"/>	1	3	3		
DISTANCE TO NEAREST SURFACE WATER PHYSICAL STATE	0 1 2 3 <input type="text" value="3"/>	2	6	6		
	0 1 2 3 <input type="text" value="1"/>	1	1	3		
TOTAL ROUTE CHARACTERISTICS SCORE			11	15		
3 CONTAINMENT	0 1 2 3 <input type="text" value="3"/>	1	3	3	4.3	
4 WASTE CHARACTERISTICS						
TOXICITY/PERSISTANCE	0 3 6 9 12 15 <input type="text" value="6"/>	1	6	18	4.4	
HAZARDOUS WASTE QUANTITY	1 2 3 4 5 6 7 8 <input type="text" value="4"/>	1	4	8		
TOTAL WASTE CHARACTERISTICS SCORE			10	26		
5 TARGETS					4.5	
SURFACE WATER USE	0 1 2 3 <input type="text" value="2"/>	3	6	9		
DISTANCE TO A SENSITIVE ENVIRONMENT	0 1 2 3 <input type="text" value="2"/>	2	4	6		
POPULATION SERVED/DIST TO WATER INTAKE	0 4 6 8 10 12 16 18 20					
DOWNSTREAM	24 30 32 35 40 <input type="text" value="0"/>	1	0			
TOTAL TARGETS SCORE			10	55		
6 IF LINE 1 IS 45, MULTIPLY 1 X 4 X 5 IF LINE 1 IS 0, MULTIPLY 2 X 3 X 4 X 5			0 3300	64,350		
7 DIVIDE LINE 6 BY 64,350 AND MULTIPLY BY 100 Ssw =					5.13	

SURFACE WATER ROUTE WORK SHEET



AIR ROUTE WORK SHEET					
RATING FACTOR	ASSIGNED VALUE	MULTI-PLIER	SCORE	MAX. SCORE	REF. (SECTION)
1 OBSERVED RELEASE	0 45 <input type="text" value="0"/>	1	0	45	5.1
DATE AND LOCATION: 10/17/90 - Henrietta, New York					
SAMPLING PROTOCOL: HN <sub>μ</sub> (PID)					
IF LINE 1 IS 0, THE S <sub>a</sub> = 0. ENTER ON LINE 5 IF LINE 1 IS 45, THEN PROCEED TO; LINE 2.					
2 WASTE CHARACTERISTICS					5.2
REACTIVITY AND INCOMPATIBILITY      0 1 2 3 <input type="text" value="0"/> 1      3 TOXICITY                      0 1 2 3 <input type="text" value="0"/> 3      0      9 HAZARDOUS WASTE    3 4 5 6 7 8 <input type="text" value="0"/> 1      0      8 QUANTITY					
TOTAL WASTE CHARACTERISTICS SCORE			0	20	
3 TARGETS					5.3
POPULATION WITHIN      0 9 12 4 MILE RADIUS              21 24 27 <input type="text" value="0"/> 1      0      30 DISTANCE TO SENSITIVE ENVIRONMENT              0 1 2 3 <input type="text" value="0"/> 2      0      6 LAND USE                      0 1 2 3 <input type="text" value="0"/> 1      3					
TOTAL TARGETS SCORE			0	39	
4 MULTIPLY 1 X 2 X 3			0	35,100	
5 DIVIDE LINE 4 BY 35,100 AND MULTIPLY BY 100					
			S <sub>a</sub> =	0.00	

	S	S <sup>2</sup>
GROUNDWATER ROUTE SCORE (S <sub>gw</sub> )	7.33	53.67
SURFACE WATER ROUTE SCORE (S <sub>sw</sub> )	5.13	26.30
AIR ROUTE SCORE (S <sub>a</sub> )	0.00	0.00
S <sup>2</sup> <sub>gw</sub> + S <sup>2</sup> <sub>sw</sub> + S <sup>2</sup> <sub>a</sub>		79.97
square root of(S <sup>2</sup> <sub>gw</sub> + S <sup>2</sup> <sub>sw</sub> + S <sup>2</sup> <sub>a</sub> )		8.94
square root of (S <sup>2</sup> <sub>gw</sub> + S <sup>2</sup> <sub>sw</sub> + S <sup>2</sup> <sub>a</sub> )/1.73 = S <sub>m</sub>		5.17

WORKSHEET FOR COMPUTING S<sub>m</sub>

FIRE AND EXPLOSION WORK SHEET							
RATING FACTOR	ASSIGNED VALUE			MULTI-PLIER	SCORE	MAX. SCORE	REF. (SECTION)
1 CONTAINMENT	1	3	0	1	0	3	7.1
<b>2 WASTE CHARACTERISTICS</b>							
DIRECT EVIDENCE	0	3		1		3	7.2
IGNITABILITY	0	1	2	3	1	3	
REACTIVITY	0	1	2	3	1	3	
INCOMPATIBILITY	0	1	2	3	1	3	
HAZARDOUS WASTE						3	
QUANTITY	1	2	3	4	5	6	7
	8				1	8	
TOTAL WASTE CHARACTERISTICS SCORE					0	20	
<b>3 TARGETS</b>							
DISTANCE TO NEAREST	0	1	2	3	4	5	1
POPULATION							
DISTANCE TO NEAREST	0	1	2	3			1
BUILDING							
DISTANCE TO A SENSITIVE							
ENVIRONMENT	0	1	2	3			1
LAND USE	0	1	2	3			1
POPULATION WITHIN	0	1	2	3	4	5	1
2 MILE RADIUS							
BUILDINGS WITHIN	0	1	2	3	4	5	1
2 MILE RADIUS							
TOTAL TARGETS SCORE					0	24	
4 MULTIPLY 1 X 2 3					0	1,440	
5 DIVIDE LINE 4 BY 1,440 AND MULTIPLY BY 100							
Sfe =					0.00		

FIRE AND EXPLOSION WORK SHEET

DIRECT CONTACT WORK SHEET					
RATING FACTOR	ASSIGNED VALUE	MULTI-PLIER	SCORE	MAX. SCORE	REF. (SECTION)
1 OBSERVED RELEASE	0 45 <input type="text" value="0"/>	1	0	45	8.1
IF LINE 1 IS 45, PROCEED TO LINE 4 IF LINE 1 IS 0, PROCEED TO LINE 2					
2 ACCESSIBILITY	0 1 2 3 <input type="text" value="3"/>	1	3	3	8.2
3 CONTAINMENT	0 15 <input type="text" value="15"/>	1	15	15	8.3
4 WASTE CHARACTERISTICS TOXICITY	0 1 2 3 <input type="text" value="1"/>	5	5	15	8.4
5 TARGETS					8.5
POPULATION WITHIN 1 MILE RADIUS	0 1 2 3 4 5 <input type="text" value="4"/>	4	16	20	
DISTANCE TO A CRITICAL HABITAT	0 1 2 3 <input type="text" value="0"/>	4	0	12	
TOTAL TARGETS SCORE			16	32	
6 IF LINE 1 IS 45, MULTIPLY 1 X 4 X 5 IF LINE 1 IS 0, MULTIPLY 2 X 3 X 4 X 5			0 3600	21,600	
7 DIVIDE LINE 6 BY 21,600 AND MULTIPLY BY 100					
Sdc =				16.67	

DIRECT CONTACT WORK SHEET



GROUNDWATER ROUTE

1 OBSERVED RELEASE

o CONTAMINANTS DETECTED (5 MAXIMUM):

None

o RATIONALE FOR ATTRIBUTING THE CONTAMINANTS TO THE FACILITY:

NA

SCORE 0

\*\*\*

2. ROUTE CHARACTERISTICS

DEPTH TO AQUIFER OF CONCERN

o NAME/DESCRIPTION OF AQUIFER(S) OF CONCERN:

Glacial overburden aquifer

o DEPTH(S) FROM THE GROUND SURFACE TO THE HIGHEST SEASONAL LEVEL OF THE SATURATED ZONE [WATER TABLE(S)] OF THE AQUIFER OF CONCERN:

10 feet (Ref. 15)

o DEPTH FROM THE GROUND SURFACE TO THE LOWEST POINT OF WASTE DISPOSAL/STORAGE:

Unknown

SCORE 3

\*\*\*

NET PRECIPITATION

- o MEAN ANNUAL OR SEASONAL PRECIPITATION(LIST MONTHS FOR SEASONAL):

32 inches (Ref. 19)

- o MEAN ANNUAL OR SEASONAL EVAPORATION (LIST MONTHS FOR SEASONAL):

26 inches (Ref. 19)

- o NET PRECIPITATION (SUBTRACT THE ABOVE FIGURES):

6

SCORE 2

PERMEABILITY OF UNSATURATED ZONE

- o SOIL TYPE IN UNSATURATED ZONE:

Silty (Ref. 15)

- o PERMEABILITY ASSOCIATED WITH SOIL TYPE:

$10^{-4}$  cm/sec (Ref. 15)

SCORE

PHYSICAL STATE

- o PHYSICAL STATE OF SUBSTANCES AT TIME OF DISPOSAL (OR AT PRESENT TIME FOR GENERATED GASES):

Solid, unstabilized

SCORE 1

\*\*\*

### 3. CONTAINMENT

#### CONTAINMENT

- o METHOD(S) OF WASTE OF LEACHATE CONTAINMENT EVALUATED:

No liner, no runoff control

- o METHOD WITH THE HIGHEST SCORE:

No liner

SCORE 3

\*\*\*

### 4. WASTE CHARACTERISTICS

#### TOXICITY AND PERSISTENCE

- o COMPOUND(S) EVALUATED:

Compound Evaluated	Toxicity	Persistence	Score
Methane	1	1	6

Methane used by NYSDOH in their health assessment of the site.

- o COMPOUND WITH THE HIGHEST SCORE:

Methane (Ref. 3)

SCORE 6

#### HAZARDOUS WASTE QUANTITY

- o TOTAL QUANTITY OF HAZARDOUS SUBSTANCES AT THE FACILITY, EXCLUDING THOSE WITH A CONTAINMENT SCORE OF 0 (GIVE A REASONABLE ESTIMATE EVEN IF QUANTITY IS ABOVE MAXIMUM):

150 tons

SCORE 4

- o BASIS OF ESTIMATING AND/OR COMPUTING WASTE QUANTITY:

(Ref. 3)

\*\*\*

## 5. TARGETS

### GROUNDWATER USE

- o USE(S) OF AQUIFER(S) OF CONCERN WITHIN A 3-MILE RADIUS OF THE FACILITY:

Less than 1% of the population of the Town of Henrietta is supplied with water from private residential wells. Locations are unknown but water lines do exist near the site. Therefore, an alternate supply of water is available in the vicinity of the site (Ref. 13)

SCORE 2

### DISTANCE OF NEAREST WELL

- o LOCATION OF NEAREST WELL DRAWING FROM AQUIFER OF CONCERN OR OCCUPIED BUILDING NOT SERVED BY A PUBLIC WATER SUPPLY:

Unknown

- o DISTANCE TO ABOVE WELL OR BUILDING:

Unknown

### POPULATION SERVED BY GROUNDWATER WELL WITHIN A 3-MILE RADIUS

- o IDENTIFIED WATER-SUPPLY WELL(S) DRAWING FROM AQUIFER(S) OF CONCERN WITHIN A 3-MILE RADIUS AND POPULATIONS SERVED BY EACH:

Unknown, assume 2 to 3 miles

- o COMPUTATION OF LAND AREA IRRIGATED BY SUPPLY WELL(S) DRAWING FROM AQUIFER(S) OF CONCERN WITHIN A 3-MILE RADIUS, AND CONVERSION TO POPULATION(1.5 PEOPLE PER ACRE):

None reported

- o TOTAL POPULATION SERVED BY GROUNDWATER WITHIN A 3-MILE RADIUS:

261 (Ref. 13)

SCORE 8



SURFACE WATER ROUTE

1. OBSERVED RELEASE

- o CONTAMINANTS DETECTED IN SURFACE WATER AT THE FACILITY OR DOWNHILL FROM IT (5 MAXIMUM):

NA

- o RATIONALE FOR ATTRIBUTING THE CONTAMINANTS TO THE FACILITY:

NA

SCORE 0

\*\*\*

2. ROUTE CHARACTERISTICS

FACILITY SLOPE AND INTERVENING TERRAIN

- o AVERAGE SLOPE OF THE FACILITY IN PERCENT:

0-3%

- o NAME/DESCRIPTION OF THE NEAREST DOWNSLOPE SURFACE WATER:

Unnamed pond

- o AVERAGE SLOPE OF TERRAIN BETWEEN FACILITY AND ABOVE-CITED SURFACE WATER IN PERCENT:

0-3%

- o IS THE FACILITY LOCATED EITHER TOTALLY OR PARTIALLY IN SURFACE WATER?:

No

SCORE 1

- o IS THE FACILITY COMPLETELY SURROUNDED BY AREAS OF HIGHER ELEVATION?

No

1-YEAR 24 HOUR RAINFALL IN INCHES

3.85 (Ref. 18)

SCORE 3

DISTANCE TO NEAREST DOWNSLOPE SURFACE WATER

Adjacent

SCORE 3

PHYSICAL STATE OF WASTE

Solid

SCORE 1

\*\*\*

3. CONTAINMENT

CONTAINMENT

- o METHOD(S) OF WASTE OR LEACHATE CONTAINMENT EVALUATED:

No liner

- o METHOD WITH THE HIGHEST SCORE:

No liner

SCORE 3

\*\*\*

4. WASTE CHARACTERISTICS

TOXICITY AND PERSISTENCE

o COMPOUND(S) EVALUATED

Compound Evaluated	Toxicity	Persistence	Score
Methane	1	1	6

Methane was used by the NYSDOH in their health assessment of the site.

o COMPOUND WITH THE HIGHEST SCORE:

Methane (Ref. 3)

SCORE 6

HAZARDOUS WASTE QUANTITY

o TOTAL QUANTITY OF HAZARDOUS SUBSTANCES AT THE FACILITY EXCLUDING THOSE WITH A CONTAINMENT SCORE OF 0 (GIVE A REASONABLE ESTIMATE EVEN IF QUANTITY IS ABOVE MAXIMUM):

150 tons

SCORE 4

o BASIS OF ESTIMATING AND/OR COMPUTING WASTE QUANTITY:

(Ref. 3)

\*\*\*

5. TARGETS

SURFACE WATER USE

o USE(S) OF SURFACE WATER WITHIN 3 MILES DOWNSTREAM OF THE HAZARDOUS SUBSTANCE:

Recreation

Score 2

- o IS THERE TIDAL INFLUENCE?

No

DISTANCE TO A SENSITIVE ENVIRONMENT

- o DISTANCE TO A 5-ACRE(MINIMUM) COASTAL WETLAND, IF 2 MILES OR LESS:

None

- o DISTANCE TO A 5 ACRE (MINIMUM) FRESH-WATER WETLAND, IF 1 MILE OR LESS:

Adjacent - across Conrail Tracks

- o DISTANCE TO CRITICAL HABITAT OF AN ENDANGERED SPECIES OR NATIONAL WILDLIFE REFUGE, IF 1 MILE OR LESS:

None reported

SCORE 2

POPULATION SERVED BY SURFACE WATER

- o LOCATION(S) OF WATER-SUPPLY INTAKE(S) WITHIN 3 MILES(FREE-FLOWING BODIES) OR 1 MILE (STATIC WATER BODIES) DOWNSTREAM OF THE HAZARDOUS SUBSTANCE AND POPULATION SERVED BY EACH INTAKE:

NA



- o COMPUTATION OF LAND AREA IRRIGATED BY ABOVE-CITED INTAKE(S) AND CONVERSION TO POPULATION (1.5 PEOPLE PER ACRE):

None reported

- o TOTAL POPULATION SERVED

0

- o NAME/DESCRIPTION OF NEAREST ABOVE-CITED WATER BODIES:

East Branch of Red Creek

- o DISTANCE TO ABOVE-CITED INTAKES, MEASURED IN STREAM MILES:

NA

SCORE 0

\*\*\*

AIR ROUTE

1. OBSERVED RELEASE

o CONTAMINANTS DETECTED:

None

o DATE AND LOCATION OF DETECTION OF CONTAMINANTS:

10/17/90 - Henrietta, New York

o METHODS USED TO DETECT THE CONTAMINANTS:

HNu (PID)

o RATIONALE FOR ATTRIBUTING THE CONTAMINANTS TO THE SITE:

None

SCORE 0

\*\*\*

2. WASTE CHARACTERISTICS

REACTIVITY AND INCOMPATIBILITY

o MOST REACTIVE COMPOUND

NA

o MOST INCOMPATIBLE PAIR OF COMPOUNDS

NA

SCORE 0

TOXICITY

- o MOST TOXIC COMPOUND

NA

SCORE 0

HAZARDOUS WASTE QUANTITY

- o TOTAL QUANTITY OF HAZARDOUS WASTE:

NA

SCORE 0

- o BASIS OF ESTIMATING AND/OR COMPUTING WASTE QUANTITY:

\*\*\*

3 TARGETS

POPULATION WITHIN 4-MILE RADIUS

- o UNDERLINE RADIUS USED, GIVE POPULATION AND INDICATE HOW DETERMINED:

0 TO 4 MI      0 TO 1 MI      0 TO 0.5 MI      0 TO 0.25 MI

No air released

SCORE 0

DISTANCE TO A SENSITIVE ENVIRONMENT

- o DISTANCE TO 5 ACRE (MINIMUM) COASTAL WETLAND, IF 2 MILES OR LESS:

NA

- o DISTANCE TO 5 ACRE (MINIMUM) FRESH WATER WETLAND, IF 1 MILE OR LESS:

NA

- o DISTANCE TO CRITICAL HABITAT OF AN ENDANGERED SPECIES, IF 1 MILE OR LESS:

NA

SCORE 0

LAND USE

- o DISTANCE TO COMMERCIAL/INDUSTRIAL AREA , IF 1 MILE OR LESS:

NA

- o DISTANCE TO NATIONAL OR STATE PARK, FOREST, OR WILDLIFE RESERVE, IF 2 MILES OR LESS:

NA

- o DISTANCE TO RESIDENTIAL AREA, IF 2 MILES OR LESS:

NA

- o DISTANCE TO AGRICULTURAL LAND IN PRODUCTION WITHIN THE LAST 5 YEARS, IF 1 MILE OR LESS:

NA

- o DISTANCE TO PRIME AGRICULTURAL LAND IN PRODUCTION WITHIN PAST YEARS, IF 2 MILES OR LESS:

NA

- o IS A HISTORICAL OR LANDMARK SITE( NATIONAL REGISTER OR HISTORIC PLACES AND NATIONAL NATURAL LANDMARKS) WITHIN VIEW OF THE SITE?

NA

SCORE 0

\*\*\*



FIRE AND EXPLOSION

1. CONTAINMENT

o HAZARDOUS SUBSTANCES PRESENT:

No potential observed for fire and explosion

o TYPE OF CONTAINMENT, IF APPLICABLE:

SCORE 0

\*\*\*

2. WASTE CHARACTERISTICS

DIRECT EVIDENCE

o TYPE OF INSTRUMENT AND MEASUREMENTS:

NA

SCORE 0

IGNITABILITY

o COMPOUND USED

NA

SCORE 0

REACTIVITY

o MOST REACTIVE COMPOUND:

NA

SCORE 0

INCOMPATIBILITY

o MOST INCOMPATIBLE PAIR OF COMPOUNDS:

NA

SCORE 0

HAZARDOUS WASTE QUANTITY

- o TOTAL QUANTITY OF HAZARDOUS SUBSTANCES AT THE FACILITY:

NA

SCORE 0

- o BASIS OF ESTIMATING AND/OR COMPUTING WASTE QUANTITY:

NA

3 TARGETS

DISTANCE TO NEAREST POPULATION

NA

SCORE 0

DISTANCE TO NEAREST BUILDING

NA

SCORE 0

DISTANCE TO SENSITIVE ENVIRONMENT

- o DISTANCE TO WETLANDS

NA

- o DISTANCE TO CRITICAL HABITAT:

NA

SCORE 0

LAND USE

- o DISTANCE TO COMMERCIAL/INDUSTRIAL AREA  
NA
- o DISTANCE TO NATIONAL OR STATE PARK, FOREST OF WILDLIFE RESERVE, IF 2 MILES OR LESS:  
NA
- o DISTANCE TO RESIDENTIAL AREA, IF 2 MILES OR LESS:  
NA
- o DISTANCE TO AGRICULTURAL LAND IN PRODUCTION WITHIN PAST 5 YEARS, IF 1 MILE OR LESS:  
NA
- o DISTANCE TO PRIME AGRICULTURAL LAND IN PRODUCTION WITHIN PAST 5 YEARS, IF 2 MILES OR LESS:  
NA
- o IF A HISTORIC OR LANDMARK SITE ( NATIONAL REGISTER OF HISTORIC PLACES AND NATIONAL NATURAL LANDMARKS) WITHIN VIEW OF THE SITE?  
NA

SCORE 0

POPULATION WITHIN 2 MILE RADIUS

NA

SCORE 0

BUILDINGS WITHIN A 2 MILE RADIUS

NA

SCORE 0

\*\*\*

DIRECT CONTACT

1. OBSERVED INCIDENT

o DATE, LOCATION AND PERTINENT DETAILS OF INCIDENT:

None reported

SCORE 0

\*\*\*

2. ACCESSIBILITY

o DESCRIBE TYPE OF BARRIER(S):

None - site is unfenced

SCORE 3

\*\*\*

3. CONTAINMENT

o TYPE OF CONTAINMENT, IF APPLICABLE:

None, no liner, no adequate cap or cover

SCORE 15

\*\*\*

4. WASTE CHARACTERISTICS

TOXICITY

o COMPOUNDS EVALUATED

Methane (Ref. 15)

o COMPOUND WITH HIGHEST SCORE:

Methane

SCORE 1

\*\*\*