

- MAP NOTES:**
1. BASE MAP PREPARED IN DECEMBER 1997 FROM AN ELECTRONIC COPY OF A DRAWING DERIVED FROM DELPHI AUTOMOTIVE SYSTEMS, LEXINGTON AVENUE, UNDATED.
 2. PREVIOUS MONITORING, RECOVERY WELL, PEZOMETER AND P.K. NAIL LOCATIONS SURVEYED BY BERGMANN ASSOCIATES USING THE NORTHING AND EASTING GRID FOR THE SITE PREPARED BY LOCKWOOD SUPPORT SERVICES, INC. LOCATIONS OF WELLS SHOWN ON THIS MAP ARE APPROXIMATE. CORRELATIONS WITH LOCATIONS OF WELLS SHOWN ON THIS MAP AND OTHER MAPS ARE APPROXIMATE.
 3. LOCATION OF CITY OF ROCHESTER SEWER TUNNEL DETERMINED BY MONROE COUNTY DIVISION OF PURE WATER PERSONNEL DURING TUNNEL SURVEY PERFORMED 3 MAY 1991. LOCATIONS SHOWN ARE APPROXIMATE.
 4. LOCATIONS SHOWN FOR WELLS SR-11, R-11, DR-11, SR-103, R-103, DR-103, PZ-122, PZ-123, PZ-124, PZ-125, PZ-126, PZ-127, PZ-128, PZ-129, PZ-130, PZ-131, PZ-132, PZ-133, PZ-134, PZ-135, PZ-136, PZ-137, PZ-138, PZ-139, PZ-140, PZ-141, PZ-142, PZ-143, PZ-144, PZ-145, PZ-146, PZ-147, PZ-148, PZ-149, PZ-150, PZ-151, PZ-152, PZ-153, PZ-154, PZ-155, PZ-156, PZ-157, PZ-158, PZ-159, PZ-160, PZ-161, PZ-162, PZ-163, PZ-164, PZ-165, PZ-166, PZ-167, PZ-168, PZ-169, PZ-170, PZ-171, PZ-172, PZ-173, PZ-174, PZ-175, PZ-176, PZ-177, PZ-178, PZ-179, PZ-180, PZ-181, PZ-182, PZ-183, PZ-184, PZ-185, PZ-186, PZ-187, PZ-188, PZ-189, PZ-190, PZ-191, PZ-192, PZ-193, PZ-194, PZ-195, PZ-196, PZ-197, PZ-198, PZ-199, PZ-200, PZ-201, PZ-202, PZ-203, PZ-204, PZ-205, PZ-206, PZ-207, PZ-208, PZ-209, PZ-210, PZ-211, PZ-212, PZ-213, PZ-214, PZ-215, PZ-216, PZ-217, PZ-218, PZ-219, PZ-220, PZ-221, PZ-222, PZ-223, PZ-224, PZ-225, PZ-226, PZ-227, PZ-228, PZ-229, PZ-230, PZ-231, PZ-232, PZ-233, PZ-234, PZ-235, PZ-236, PZ-237, PZ-238, PZ-239, PZ-240, PZ-241, PZ-242, PZ-243, PZ-244, PZ-245, PZ-246, PZ-247, PZ-248, PZ-249, PZ-250, PZ-251, PZ-252, PZ-253, PZ-254, PZ-255, PZ-256, PZ-257, PZ-258, PZ-259, PZ-260, PZ-261, PZ-262, PZ-263, PZ-264, PZ-265, PZ-266, PZ-267, PZ-268, PZ-269, PZ-270, PZ-271, PZ-272, PZ-273, PZ-274, PZ-275, PZ-276, PZ-277, PZ-278, PZ-279, PZ-280, PZ-281, PZ-282, PZ-283, PZ-284, PZ-285, PZ-286, PZ-287, PZ-288, PZ-289, PZ-290, PZ-291, PZ-292, PZ-293, PZ-294, PZ-295, PZ-296, PZ-297, PZ-298, PZ-299, PZ-300, PZ-301, PZ-302, PZ-303, PZ-304, PZ-305, PZ-306, PZ-307, PZ-308, PZ-309, PZ-310, PZ-311, PZ-312, PZ-313, PZ-314, PZ-315, PZ-316, PZ-317, PZ-318, PZ-319, PZ-320, PZ-321, PZ-322, PZ-323, PZ-324, PZ-325, PZ-326, PZ-327, PZ-328, PZ-329, PZ-330, PZ-331, PZ-332, PZ-333, PZ-334, PZ-335, PZ-336, PZ-337, PZ-338, PZ-339, PZ-340, PZ-341, PZ-342, PZ-343, PZ-344, PZ-345, PZ-346, PZ-347, PZ-348, PZ-349, PZ-350, PZ-351, PZ-352, PZ-353, PZ-354, PZ-355, PZ-356, PZ-357, PZ-358, PZ-359, PZ-360, PZ-361, PZ-362, PZ-363, PZ-364, PZ-365, PZ-366, PZ-367, PZ-368, PZ-369, PZ-370, PZ-371, PZ-372, PZ-373, PZ-374, PZ-375, PZ-376, PZ-377, PZ-378, PZ-379, PZ-380, PZ-381, PZ-382, PZ-383, PZ-384, PZ-385, PZ-386, PZ-387, PZ-388, PZ-389, PZ-390, PZ-391, PZ-392, PZ-393, PZ-394, PZ-395, PZ-396, PZ-397, PZ-398, PZ-399, PZ-400, PZ-401, PZ-402, PZ-403, PZ-404, PZ-405, PZ-406, PZ-407, PZ-408, PZ-409, PZ-410, PZ-411, PZ-412, PZ-413, PZ-414, PZ-415, PZ-416, PZ-417, PZ-418, PZ-419, PZ-420, PZ-421, PZ-422, PZ-423, PZ-424, PZ-425, PZ-426, PZ-427, PZ-428, PZ-429, PZ-430, PZ-431, PZ-432, PZ-433, PZ-434, PZ-435, PZ-436, PZ-437, PZ-438, PZ-439, PZ-440, PZ-441, PZ-442, PZ-443, PZ-444, PZ-445, PZ-446, PZ-447, PZ-448, PZ-449, PZ-450, PZ-451, PZ-452, PZ-453, PZ-454, PZ-455, PZ-456, PZ-457, PZ-458, PZ-459, PZ-460, PZ-461, PZ-462, PZ-463, PZ-464, PZ-465, PZ-466, PZ-467, PZ-468, PZ-469, PZ-470, PZ-471, PZ-472, PZ-473, PZ-474, PZ-475, PZ-476, PZ-477, PZ-478, PZ-479, PZ-480, PZ-481, PZ-482, PZ-483, PZ-484, PZ-485, PZ-486, PZ-487, PZ-488, PZ-489, PZ-490, PZ-491, PZ-492, PZ-493, PZ-494, PZ-495, PZ-496, PZ-497, PZ-498, PZ-499, PZ-500, PZ-501, PZ-502, PZ-503, PZ-504, PZ-505, PZ-506, PZ-507, PZ-508, PZ-509, PZ-510, PZ-511, PZ-512, PZ-513, PZ-514, PZ-515, PZ-516, PZ-517, PZ-518, PZ-519, PZ-520, PZ-521, PZ-522, PZ-523, PZ-524, PZ-525, PZ-526, PZ-527, PZ-528, PZ-529, PZ-530, PZ-531, PZ-532, PZ-533, PZ-534, PZ-535, PZ-536, PZ-537, PZ-538, PZ-539, PZ-540, PZ-541, PZ-542, PZ-543, PZ-544, PZ-545, PZ-546, PZ-547, PZ-548, PZ-549, PZ-550, PZ-551, PZ-552, PZ-553, PZ-554, PZ-555, PZ-556, PZ-557, PZ-558, PZ-559, PZ-560, PZ-561, PZ-562, PZ-563, PZ-564, PZ-565, PZ-566, PZ-567, PZ-568, PZ-569, PZ-570, PZ-571, PZ-572, PZ-573, PZ-574, PZ-575, PZ-576, PZ-577, PZ-578, PZ-579, PZ-580, PZ-581, PZ-582, PZ-583, PZ-584, PZ-585, PZ-586, PZ-587, PZ-588, PZ-589, PZ-590, PZ-591, PZ-592, PZ-593, PZ-594, PZ-595, PZ-596, PZ-597, PZ-598, PZ-599, PZ-600, PZ-601, PZ-602, PZ-603, PZ-604, PZ-605, PZ-606, PZ-607, PZ-608, PZ-609, PZ-610, PZ-611, PZ-612, PZ-613, PZ-614, PZ-615, PZ-616, PZ-617, PZ-618, PZ-619, PZ-620, PZ-621, PZ-622, PZ-623, PZ-624, PZ-625, PZ-626, PZ-627, PZ-628, PZ-629, PZ-630, PZ-631, PZ-632, PZ-633, PZ-634, PZ-635, PZ-636, PZ-637, PZ-638, PZ-639, PZ-640, PZ-641, PZ-642, PZ-643, PZ-644, PZ-645, PZ-646, PZ-647, PZ-648, PZ-649, PZ-650, PZ-651, PZ-652, PZ-653, PZ-654, PZ-655, PZ-656, PZ-657, PZ-658, PZ-659, PZ-660, PZ-661, PZ-662, PZ-663, PZ-664, PZ-665, PZ-666, PZ-667, PZ-668, PZ-669, PZ-670, PZ-671, PZ-672, PZ-673, PZ-674, PZ-675, PZ-676, PZ-677, PZ-678, PZ-679, PZ-680, PZ-681, PZ-682, PZ-683, PZ-684, PZ-685, PZ-686, PZ-687, PZ-688, PZ-689, PZ-690, PZ-691, PZ-692, PZ-693, PZ-694, PZ-695, PZ-696, PZ-697, PZ-698, PZ-699, PZ-700, PZ-701, PZ-702, PZ-703, PZ-704, PZ-705, PZ-706, PZ-707, PZ-708, PZ-709, PZ-710, PZ-711, PZ-712, PZ-713, PZ-714, PZ-715, PZ-716, PZ-717, PZ-718, PZ-719, PZ-720, PZ-721, PZ-722, PZ-723, PZ-724, PZ-725, PZ-726, PZ-727, PZ-728, PZ-729, PZ-730, PZ-731, PZ-732, PZ-733, PZ-734, PZ-735, PZ-736, PZ-737, PZ-738, PZ-739, PZ-740, PZ-741, PZ-742, PZ-743, PZ-744, PZ-745, PZ-746, PZ-747, PZ-748, PZ-749, PZ-750, PZ-751, PZ-752, PZ-753, PZ-754, PZ-755, PZ-756, PZ-757, PZ-758, PZ-759, PZ-760, PZ-761, PZ-762, PZ-763, PZ-764, PZ-765, PZ-766, PZ-767, PZ-768, PZ-769, PZ-770, PZ-771, PZ-772, PZ-773, PZ-774, PZ-775, PZ-776, PZ-777, PZ-778, PZ-779, PZ-780, PZ-781, PZ-782, PZ-783, PZ-784, PZ-785, PZ-786, PZ-787, PZ-788, PZ-789, PZ-790, PZ-791, PZ-792, PZ-793, PZ-794, PZ-795, PZ-796, PZ-797, PZ-798, PZ-799, PZ-800, PZ-801, PZ-802, PZ-803, PZ-804, PZ-805, PZ-806, PZ-807, PZ-808, PZ-809, PZ-810, PZ-811, PZ-812, PZ-813, PZ-814, PZ-815, PZ-816, PZ-817, PZ-818, PZ-819, PZ-820, PZ-821, PZ-822, PZ-823, PZ-824, PZ-825, PZ-826, PZ-827, PZ-828, PZ-829, PZ-830, PZ-831, PZ-832, PZ-833, PZ-834, PZ-835, PZ-836, PZ-837, PZ-838, PZ-839, PZ-840, PZ-841, PZ-842, PZ-843, PZ-844, PZ-845, PZ-846, PZ-847, PZ-848, PZ-849, PZ-850, PZ-851, PZ-852, PZ-853, PZ-854, PZ-855, PZ-856, PZ-857, PZ-858, PZ-859, PZ-860, PZ-861, PZ-862, PZ-863, PZ-864, PZ-865, PZ-866, PZ-867, PZ-868, PZ-869, PZ-870, PZ-871, PZ-872, PZ-873, PZ-874, PZ-875, PZ-876, PZ-877, PZ-878, PZ-879, PZ-880, PZ-881, PZ-882, PZ-883, PZ-884, PZ-885, PZ-886, PZ-887, PZ-888, PZ-889, PZ-890, PZ-891, PZ-892, PZ-893, PZ-894, PZ-895, PZ-896, PZ-897, PZ-898, PZ-899, PZ-900, PZ-901, PZ-902, PZ-903, PZ-904, PZ-905, PZ-906, PZ-907, PZ-908, PZ-909, PZ-910, PZ-911, PZ-912, PZ-913, PZ-914, PZ-915, PZ-916, PZ-917, PZ-918, PZ-919, PZ-920, PZ-921, PZ-922, PZ-923, PZ-924, PZ-925, PZ-926, PZ-927, PZ-928, PZ-929, PZ-930, PZ-931, PZ-932, PZ-933, PZ-934, PZ-935, PZ-936, PZ-937, PZ-938, PZ-939, PZ-940, PZ-941, PZ-942, PZ-943, PZ-944, PZ-945, PZ-946, PZ-947, PZ-948, PZ-949, PZ-950, PZ-951, PZ-952, PZ-953, PZ-954, PZ-955, PZ-956, PZ-957, PZ-958, PZ-959, PZ-960, PZ-961, PZ-962, PZ-963, PZ-964, PZ-965, PZ-966, PZ-967, PZ-968, PZ-969, PZ-970, PZ-971, PZ-972, PZ-973, PZ-974, PZ-975, PZ-976, PZ-977, PZ-978, PZ-979, PZ-980, PZ-981, PZ-982, PZ-983, PZ-984, PZ-985, PZ-986, PZ-987, PZ-988, PZ-989, PZ-990, PZ-991, PZ-992, PZ-993, PZ-994, PZ-995, PZ-996, PZ-997, PZ-998, PZ-999, PZ-1000.
 5. INTERIOR SOIL-GAS SAMPLING, TEST BORING AND MONITORING WELL LOCATIONS SHOWN ARE BASED ON TAPE MEASUREMENTS BY HALEY & ALDRICH USING BUILDING COLUMN LINE OR OTHER REFERENCES. ALL LOCATIONS ARE APPROXIMATE.
 6. REFER TO TEXT FOR ADDITIONAL INFORMATION.

NOTE: REFER TO FIGURE 3 FOR A PLAN SHOWING THE SITE AT A SMALLER SCALE.

- LEGEND:**
- TEST PIT
 - SOL BORING
 - OVERBURDEN WELL
 - SHALLOW BEDROCK WELL
 - INTERMEDIATE BEDROCK WELL
 - DEEP BEDROCK WELL
 - STORM SEWER SAMPLE
 - SANITARY SEWER SAMPLE
 - WELL Z
 - RECOVERY WELL (FLOATING PRODUCT)
 - RECOVERY WELL (GROUNDWATER)
 - PEZOMETER
 - SOIL VAPOR EXTRACTION OR MONITORING WELL
 - HAND SAMPLE LOCATION
 - CITY OF ROCHESTER SEWER TUNNEL LOCATION
 - P.K. NAIL AT SURFACE ABOVE SEWER CENTERLINE
 - LOCATION OF BLASTED BEDROCK TRENCH
 - LOCATION OF FLOATING PRODUCT RECOVERY TRENCH
 - FORMER SOLVENT DEGREASER LOCATION
 - SOIL GAS SAMPLING LOCATION
 - SOIL GAS READINGS > 100 PPM TOTAL VOLATILES ORGANICS (TVOC) OR > 100 PPM CHLORINE SOLVENTS (CS) OR > 100 PPM AREAS WHERE SOIL GAS READINGS > 100 PPM
 - SITE BOUNDARY

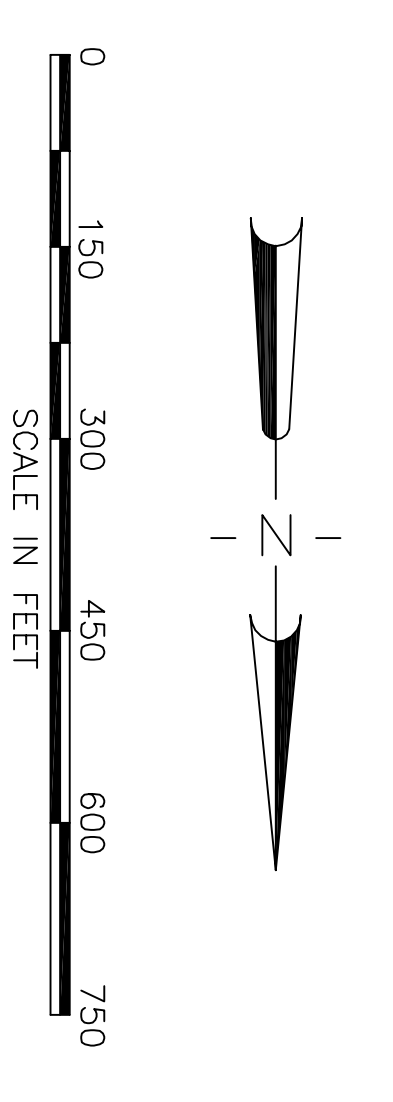

HALEY & ALDRICH
UNDERGROUND ENVIRONMENTAL SOLUTIONS

**DELPHI CORPORATION
REMEDIAL INVESTIGATION - LEXINGTON AVENUE FACILITY
ROCHESTER, NEW YORK**

SITE PLAN

SCALE: AS SHOWN

OCTOBER 2005

FIGURE 2

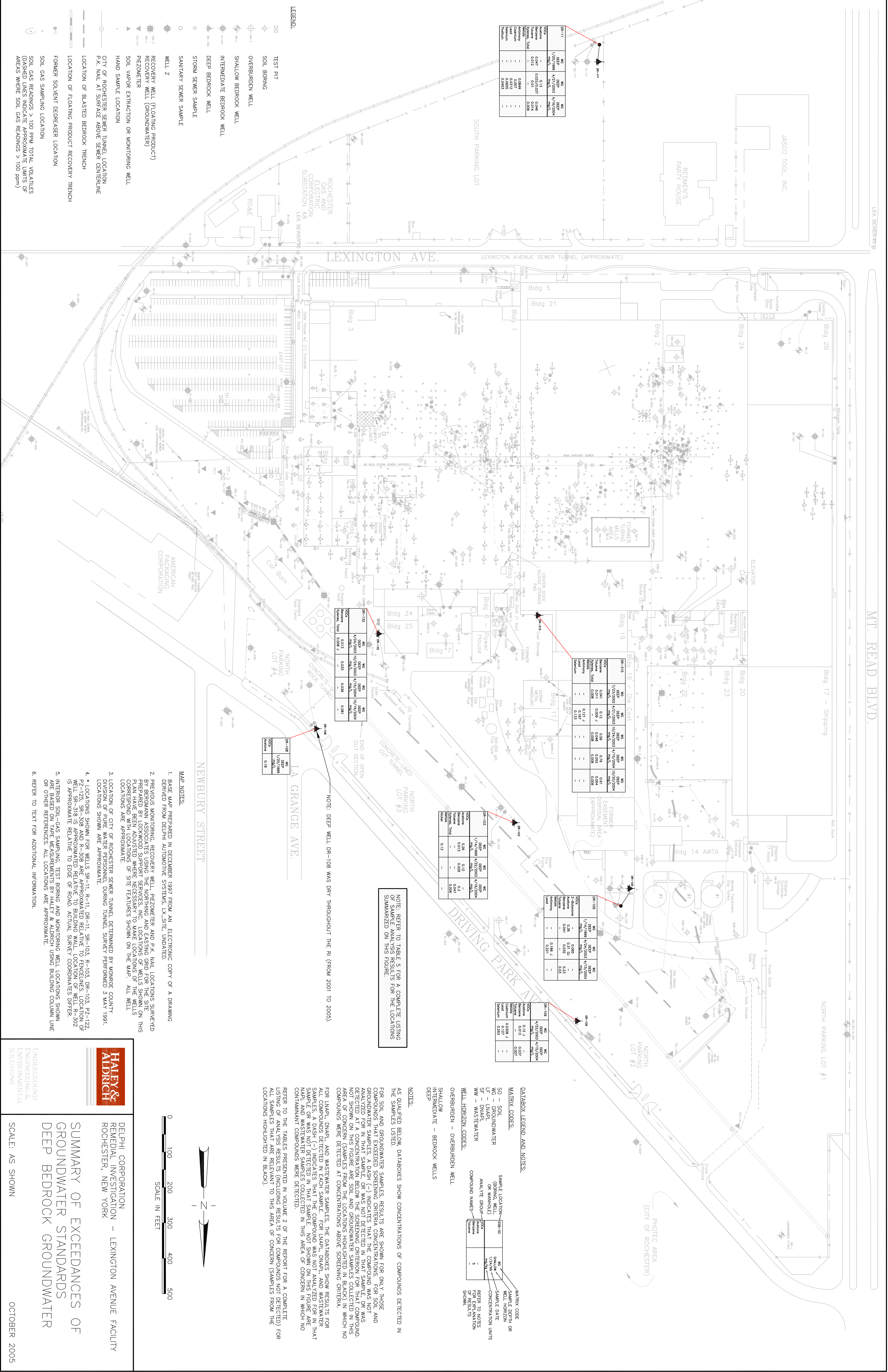

MT. READ BLVD.

NOTE: REFER TO TABLE 5 OF 8 FOR A COMPLETE LISTING OF SAMPLE ANALYSIS RESULTS FOR THE LOCATIONS SHIMBARIZED ON THIS FIGURE.

DATABASE LEGEND AND NOTES:
 MATRIX CODES:
 SO - SOIL
 GW - GROUNDWATER
 SF - SURFACE
 WW - WASTEWATER
 WELL HORIZON CODES:
 OVERBURDEN - OVERBURDEN WELL
 SHALLOW - SHALLOW WELL
 DEEP - DEEP WELL

NOTES:
 AS QUARIED BELOW DATABASES SHOW CONCENTRATIONS OF COMPOUNDS DETECTED IN THE SAMPLES LISTED.
 FOR SOIL AND GROUNDWATER SAMPLES, RESULTS ARE SHOWN FOR ONLY THOSE COMPOUNDS THAT EXCEEDED SCREENING CRITERIA CONCENTRATIONS. FOR SOIL AND GROUNDWATER SAMPLES, A DASH (-) INDICATES THAT THE COMPOUND WAS NOT DETECTED AT A CONCENTRATION BELOW THE SCREENING CRITERION FOR THAT COMPOUND. NOT SHOWN ON THIS FIGURE ARE SOIL AND GROUNDWATER SAMPLES COLLECTED IN THIS AREA OF CONCERN FROM THE LOCATION(S) IDENTIFIED IN BLACK IN WHICH NO CONCERN HAD BEEN IDENTIFIED BY THE SCREENING CRITERIA.
 FOR UNDERGROUND WASTEWATER SAMPLES, THE DATABASES SHOW RESULTS FOR SAMPLES THAT WERE DETECTED. SAMPLES THAT WERE NOT DETECTED FOR IN THAT AREA OF CONCERN ARE NOT SHOWN ON THIS FIGURE. IN THIS AREA OF CONCERN, NO CONTAMINANT COMPOUNDS WERE DETECTED.
 REFER TO THE TABLES PRESENTED IN VOLUME 2 OF THE REPORT FOR A COMPLETE LISTING OF ANALYSIS RESULTS (INCLUDING RESULTS FOR COMPOUNDS NOT DETECTED) FOR ALL SAMPLES THAT ARE RELEVANT TO THIS AREA OF CONCERN (SAMPLES FROM THE LOCATIONS HIGHLIGHTED IN BLACK).

- MAP NOTES:
1. BASE MAP PREPARED IN DECEMBER 1997 FROM AN ELECTRONIC COPY OF A DRAWING DERIVED FROM DELPHI AUTOMOTIVE SYSTEMS, LEXINGTON, NEW YORK.
 2. PREVIOUS MONITORING, RECOVERY WELL, PIEZOMETER AND P.K. NAL LOCATIONS SURVEYED BY BERGMANN ASSOCIATES USING THE NORTHING AND EASTING GRID FOR THE SITE PREPARED BY LOCKWOOD SUPPORT SERVICES, INC. LOCATIONS OF WELLS SHOWN ON THIS FIGURE ARE APPROXIMATE TO THE LOCATION(S) SHOWN ON THE MAP. ALL WELL LOCATIONS SHOWN ARE APPROXIMATE.
 3. LOCATION OF CITY OF ROCHESTER SEWER TUNNEL DETERMINED BY WATKINS COUNTY DIVISION OF PURE WATER PERSONNEL DURING TUNNEL SURVEY PERFORMED 3 MAY 1991. LOCATIONS SHOWN ARE APPROXIMATE.
 4. LOCATIONS SHOWN FOR WELLS SR-11, R-11, DR-11, SR-102, R-102, DR-102, SR-122, R-122, DR-122, SR-118, R-118, DR-118, SR-103, R-103, DR-103, SR-123, R-123, DR-123, SR-119, R-119, DR-119, SR-104, R-104, DR-104, SR-124, R-124, DR-124, SR-120, R-120, DR-120, SR-121, R-121, DR-121, SR-101, R-101, DR-101, SR-105, R-105, DR-105, SR-106, R-106, DR-106, SR-107, R-107, DR-107, SR-108, R-108, DR-108, SR-109, R-109, DR-109, SR-110, R-110, DR-110, SR-111, R-111, DR-111, SR-112, R-112, DR-112, SR-113, R-113, DR-113, SR-114, R-114, DR-114, SR-115, R-115, DR-115, SR-116, R-116, DR-116, SR-117, R-117, DR-117, SR-118, R-118, DR-118, SR-119, R-119, DR-119, SR-120, R-120, DR-120, SR-121, R-121, DR-121, SR-122, R-122, DR-122, SR-123, R-123, DR-123, SR-124, R-124, DR-124, SR-125, R-125, DR-125, SR-126, R-126, DR-126, SR-127, R-127, DR-127, SR-128, R-128, DR-128, SR-129, R-129, DR-129, SR-130, R-130, DR-130, SR-131, R-131, DR-131, SR-132, R-132, DR-132, SR-133, R-133, DR-133, SR-134, R-134, DR-134, SR-135, R-135, DR-135, SR-136, R-136, DR-136, SR-137, R-137, DR-137, SR-138, R-138, DR-138, SR-139, R-139, DR-139, SR-140, R-140, DR-140, SR-141, R-141, DR-141, SR-142, R-142, DR-142, SR-143, R-143, DR-143, SR-144, R-144, DR-144, SR-145, R-145, DR-145, SR-146, R-146, DR-146, SR-147, R-147, DR-147, SR-148, R-148, DR-148, SR-149, R-149, DR-149, SR-150, R-150, DR-150, SR-151, R-151, DR-151, SR-152, R-152, DR-152, SR-153, R-153, DR-153, SR-154, R-154, DR-154, SR-155, R-155, DR-155, SR-156, R-156, DR-156, SR-157, R-157, DR-157, SR-158, R-158, DR-158, SR-159, R-159, DR-159, SR-160, R-160, DR-160, SR-161, R-161, DR-161, SR-162, R-162, DR-162, SR-163, R-163, DR-163, SR-164, R-164, DR-164, SR-165, R-165, DR-165, SR-166, R-166, DR-166, SR-167, R-167, DR-167, SR-168, R-168, DR-168, SR-169, R-169, DR-169, SR-170, R-170, DR-170, SR-171, R-171, DR-171, SR-172, R-172, DR-172, SR-173, R-173, DR-173, SR-174, R-174, DR-174, SR-175, R-175, DR-175, SR-176, R-176, DR-176, SR-177, R-177, DR-177, SR-178, R-178, DR-178, SR-179, R-179, DR-179, SR-180, R-180, DR-180, SR-181, R-181, DR-181, SR-182, R-182, DR-182, SR-183, R-183, DR-183, SR-184, R-184, DR-184, SR-185, R-185, DR-185, SR-186, R-186, DR-186, SR-187, R-187, DR-187, SR-188, R-188, DR-188, SR-189, R-189, DR-189, SR-190, R-190, DR-190, SR-191, R-191, DR-191, SR-192, R-192, DR-192, SR-193, R-193, DR-193, SR-194, R-194, DR-194, SR-195, R-195, DR-195, SR-196, R-196, DR-196, SR-197, R-197, DR-197, SR-198, R-198, DR-198, SR-199, R-199, DR-199, SR-200, R-200, DR-200.
 5. INTERIOR SOIL-GAS SAMPLING, TEST BORING AND MONITORING WELL LOCATIONS SHOWN ARE BASED ON TAPE MEASUREMENTS BY HALEY & ADRICH USING BUILDING COLUMN LINE OR OTHER MEASUREMENTS. ALL LOCATIONS ARE APPROXIMATE.
 6. REFER TO TEXT FOR ADDITIONAL INFORMATION.

HALEY & ADRICH
 UNDERGROUND ENVIRONMENTAL SOLUTIONS

DELPHI CORPORATION
 REMEDIAL INVESTIGATION - LEXINGTON AVENUE FACILITY
 ROCHESTER, NEW YORK

SUMMARY OF EXCEEDANCES OF GROUNDWATER STANDARDS DEEP BEDROCK GROUNDWATER

SCALE: AS SHOWN

OCTOBER 2005

FIGURE 3

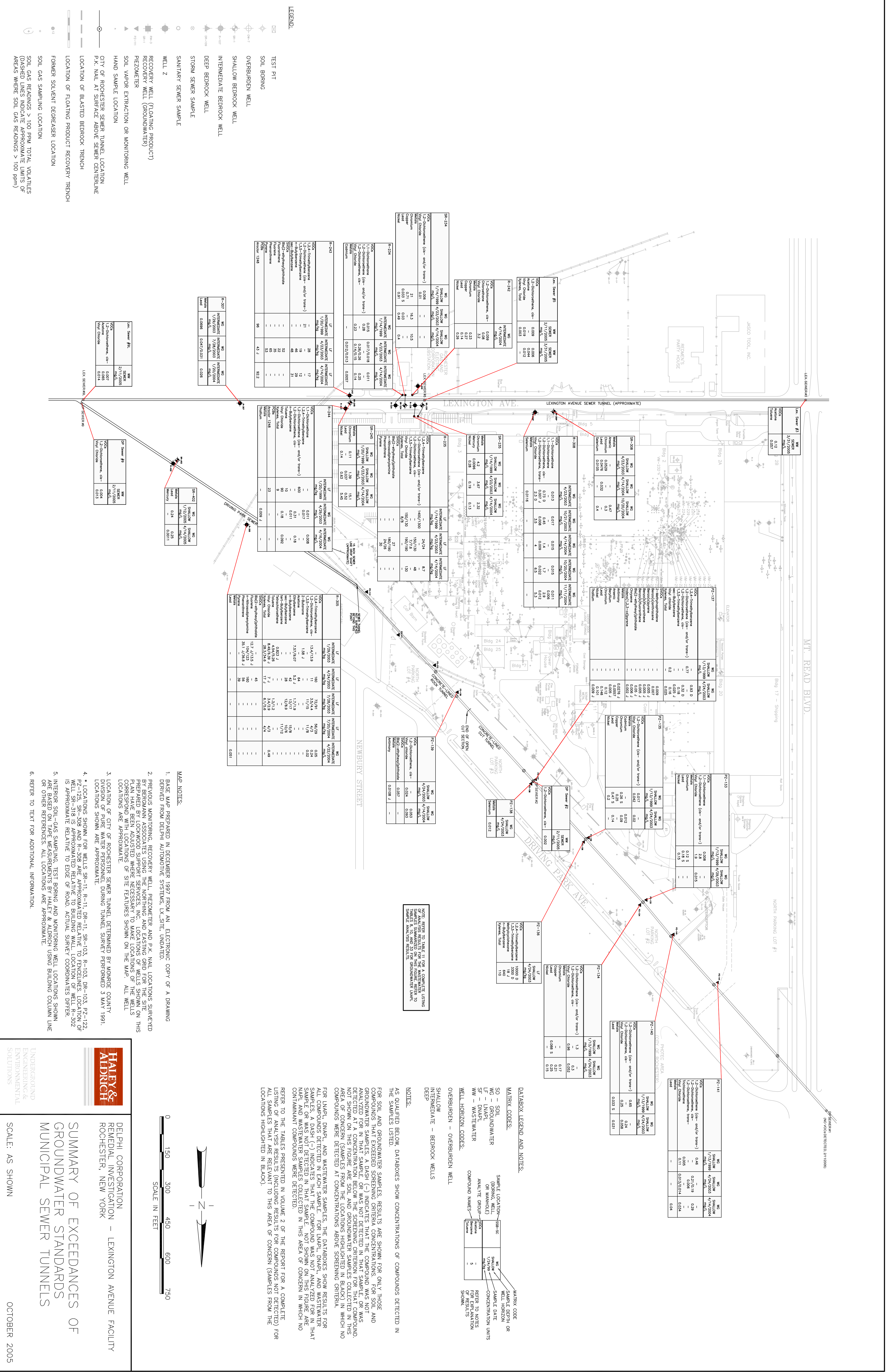

- MAP NOTES:**
1. BASE MAP PREPARED IN DECEMBER 1997 FROM AN ELECTRONIC COPY OF A DRAWING DERIVED FROM DELPHI AUTOMOTIVE SYSTEMS, LK, SITE, UNDATED.
 2. PREVIOUS MONITORING, RECOVERY WELL, PEZOMETER AND P.K. NAL LOCATIONS SURVEYED BY BERGMANN ASSOCIATES USING THE NORTHING AND EASTING GRID FOR THE SITE PREPARED BY LOCKWOOD SUPPORT SERVICES, INC. LOCATIONS OF WELLS SHOWN ON THIS CORRESPOND WITH LOCATIONS OF SURVEY COORDINATES DIFFER.
 3. LOCATION OF CITY OF ROCHESTER SEWER TUNNEL DETERMINED BY WONGKE COUNTY DIVISION OF PURE WATER PERSONNEL DURING TUNNEL SURVEY PERFORMED 3 MAY 1991. LOCATIONS SHOWN ARE APPROXIMATE.
 4. LOCATIONS SHOWN FOR WELLS SR-214, SR-215, SR-216, SR-217, SR-218, SR-219, SR-220, SR-221, SR-222, SR-223, SR-224, SR-225, SR-226, SR-227, SR-228, SR-229, SR-230, SR-231, SR-232, SR-233, SR-234, SR-235, SR-236, SR-237, SR-238, SR-239, SR-240 IS APPROXIMATE RELATIVE TO BUILDING WALL. LOCATION OF WELL R-302 IS INTERIOR SOIL-GAS SAMPLING, TEST BORING AND MONITORING WELL LOCATIONS SHOWN ARE BASED ON TAPE MEASUREMENTS BY HALEY & ADRICH USING BUILDING COLUMN LINE OR OTHER REFERENCE. ALL LOCATIONS ARE APPROXIMATE.
 6. REFER TO TEXT FOR ADDITIONAL INFORMATION.

HALEY & ADRICH
 UNDERGROUND ENVIRONMENTAL SOLUTIONS

DELPHI CORPORATION
 REMEDIAL INVESTIGATION - LEXINGTON AVENUE FACILITY
 ROCHESTER, NEW YORK

SUMMARY OF EXCEEDANCES OF GROUNDWATER STANDARDS MUNICIPAL SEWER TUNNELS

SCALE: AS SHOWN

OCTOBER 2005

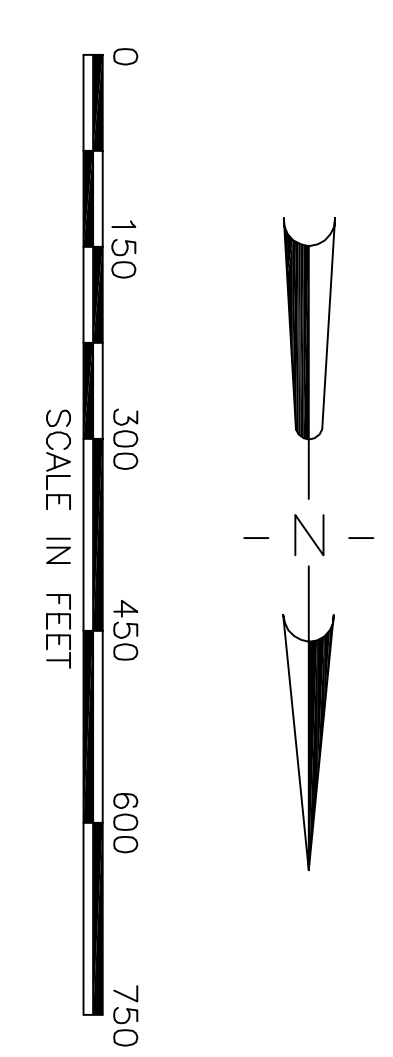

DATABASE LEGEND AND NOTES:

MATRIX CODES:

- SO - SOIL
- GW - GROUNDWATER
- WF - WASTE WATER
- WW - WASTE WATER
- OW - OVERBURDEN
- SB - SHALLOW BEDROCK
- IB - INTERMEDIATE BEDROCK
- DB - DEEP BEDROCK

SAMPLE LOCATION: SR-214

ANALYTE GROUP: VOC

COMPOUND NAME: Benzene

CONCENTRATION UNITS: mg/L

REFS TO NOTES FOR EXPLANATION OF CONCENTRATION UNITS: 5

NOTE: AS SHOWN BELOW DATABASES SHOW CONCENTRATIONS OF COMPOUNDS DETECTED IN THE SAMPLES LISTED.

FOR SOIL AND GROUNDWATER SAMPLES, RESULTS ARE SHOWN FOR ONLY THOSE COMPOUNDS THAT EXCEEDED SCREENING CRITERIA CONCENTRATIONS FOR SOIL AND GROUNDWATER SAMPLES. A DASH (-) INDICATES THAT THE COMPOUND WAS NOT DETECTED AT A CONCENTRATION BELOW THE SCREENING CRITERION FOR THAT COMPOUND. NOT SHOWN ON THIS FIGURE ARE SOIL AND GROUNDWATER SAMPLES COLLECTED IN THIS AREA OF CONCERN FROM THE LOCATION(S) IDENTIFIED IN BLACK(X) IN WHICH NO COMPOUND WAS DETECTED AT A CONCENTRATION ABOVE THE SCREENING CRITERION.

FOR UNDERGROUND WASTE WATER SAMPLES, THE DATABASES SHOW RESULTS FOR SAMPLES THAT WERE ANALYZED. A DASH (-) INDICATES THAT THE COMPOUND WAS NOT ANALYZED FOR IN THAT SAMPLE OR WAS NOT DETECTED IN THAT SAMPLE. NOT SHOWN ON THIS FIGURE ARE COMPOUNDS THAT WERE ANALYZED IN THIS AREA OF CONCERN IN WHICH NO CONTAMINANT COMPOUNDS WERE DETECTED.

REFER TO THE TABLES PRESENTED IN VOLUME 2 OF THE REPORT FOR A COMPLETE LISTING OF ANALYSIS RESULTS (INCLUDING RESULTS FOR COMPOUNDS NOT DETECTED) FOR ALL SAMPLES THAT ARE RELEVANT TO THIS AREA OF CONCERN (SAMPLES FROM THE LOCATIONS HIGHLIGHTED IN BLACK).

FIGURE 5

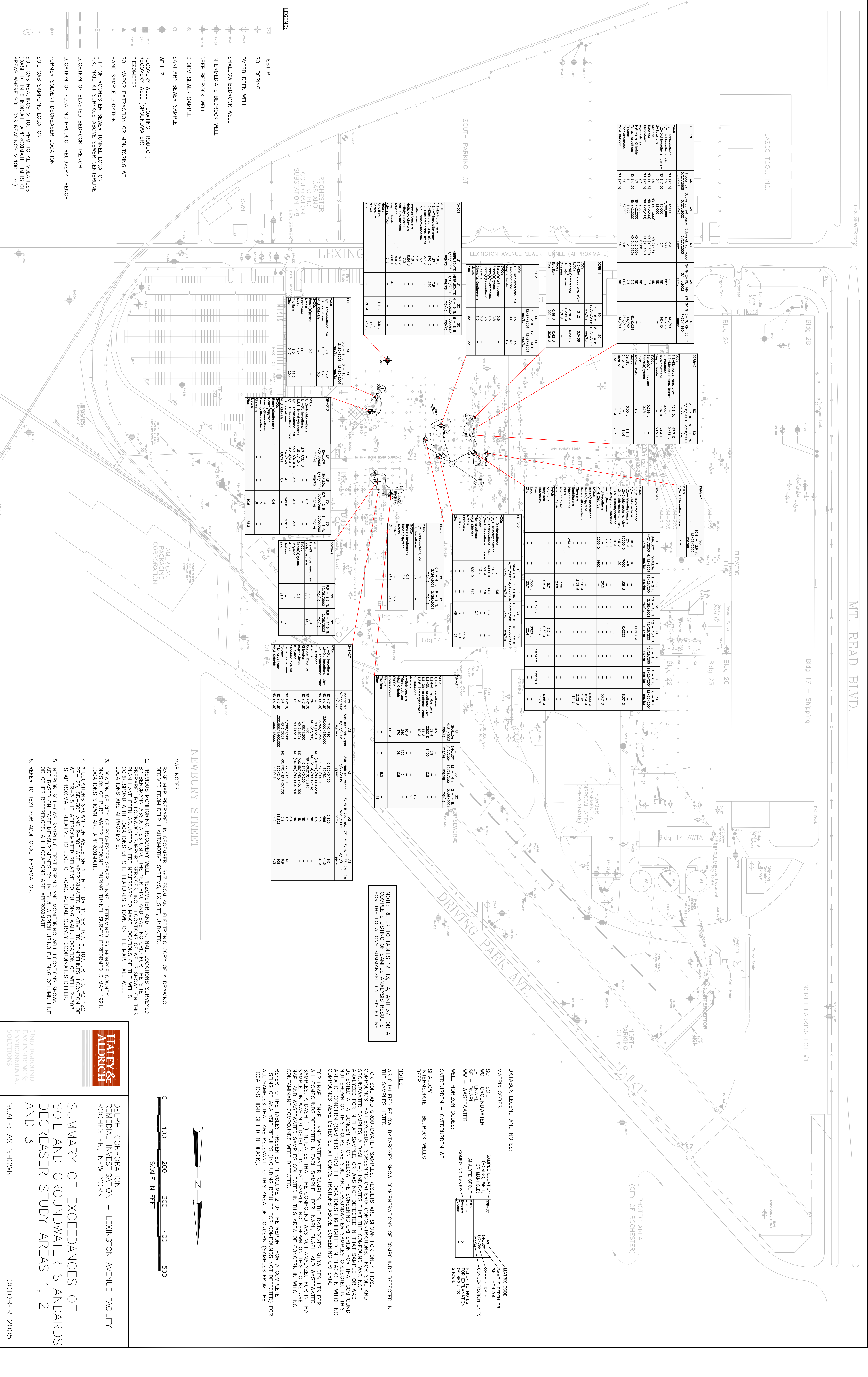

FIGURE 6

