



May 9, 2017

Reference No. 11137424

Ms. Danielle Miles
Division of Environmental Remediation
New York State Department of Environmental Conservation
6274 E. Avon-Lima Road
Avon, New York 144146

Dear Ms. Miles:

**Re: Old Erie Canal Site, Site No. 859015
Order on Consent and Administrative Settlement, Index #8-0533-98-06
Project Specific Excavation Work Plan and MW-1 Decommissioning Plan**

As requested in your letter dated May 3, 2017, GHD has prepared this Project Specific Excavation Work Plan and MW-1 Decommissioning Plan for the building addition project at the Old Erie Canal Site #859015. Parker-Hannifin Corporation (P-H) and General Electric Corporation (GE) are the remedial parties for the Site. The facility is currently owned and operated by Advanced Atomization Technologies (AATech). AATech plans to construct a 38-foot by 30-foot building addition on the south side of the main manufacturing facility as shown on the attached figure. This work plan covers the proposed construction work to be conducted by AATech. The 60-day notification for the project was submitted to NYSDEC and NYSDOH on April 28, 2017.

AATech is fully aware of the requirements of the Interim Site Management Plan (ISMP) for the Site and as such has asked GHD to assist them in complying with the ISMP.

1. Building Addition Footer Trench Excavation:

The project entails the excavation of three footer trenches, two 32 feet long and one 40 feet long. Each trench will be 4 feet wide and 4 feet deep. No soils will be reused on Site. Prior to mobilizing for the excavation, subsurface soil samples will be collected for waste characterization and off-Site disposal. The estimated volume of material to be removed is 62 cubic yards. The samples will be collected using direct push technology on Thursday, May 11, 2017. During trench excavation, the soils will be live loaded into dump trucks. The trench excavation will be completed in one day. Soil screening and air monitoring will be conducted during the pre-characterization and excavation activities.

Asphalt in the area of the footprint of the addition will be removed and disposed off-site.

The specific sections of the ISMP that will be implemented during this project include:

- 4.1 Soil Screening Methods
- 4.3 Materials Excavation and Load Out
- 4.4 Materials Transport Off-Site



- 4.5 Materials Disposal Off-Site
- 4.7 Fluids Management (if encountered)
- 4.9 Backfill from Off-Site Sources
- 4.10 Stormwater Pollution Prevention
- 4.11 Excavation Contingency Plan
- 4.12 Health and Safety Plan & Community Air Monitoring Plan
- 4.13 Odor Control Plan
- 4.14 Dust Control Plan

Each of these sections will be complied with as appropriate.

2. MW-1 Decommissioning:

The New York State Departments of Environmental Conservation (NYSDEC) and Health (NYSDOH) approved the removal of MW-1 that is located within the footprint of the building addition. The well was installed during a UST removal project completed prior to 2002. No construction details could be located for this well. Once the pre-characterization sampling is complete on Thursday, May 11, 2017, MW-1 will be pulled from the ground using the direct push rig and the resulting void will be filled with bentonite grout. Once the surrounding asphalt is removed, an 8-inch concrete floor slab will cover the location. If the PVC well cannot be pulled out, the well will be grouted in place.

Please do not hesitate to contact me at (716) 856-2142 if you have any questions.

Sincerely,

GHD



A handwritten signature in black ink that reads "Christine Barton". The script is cursive and fluid.

Christine Barton

CMB/ck/1

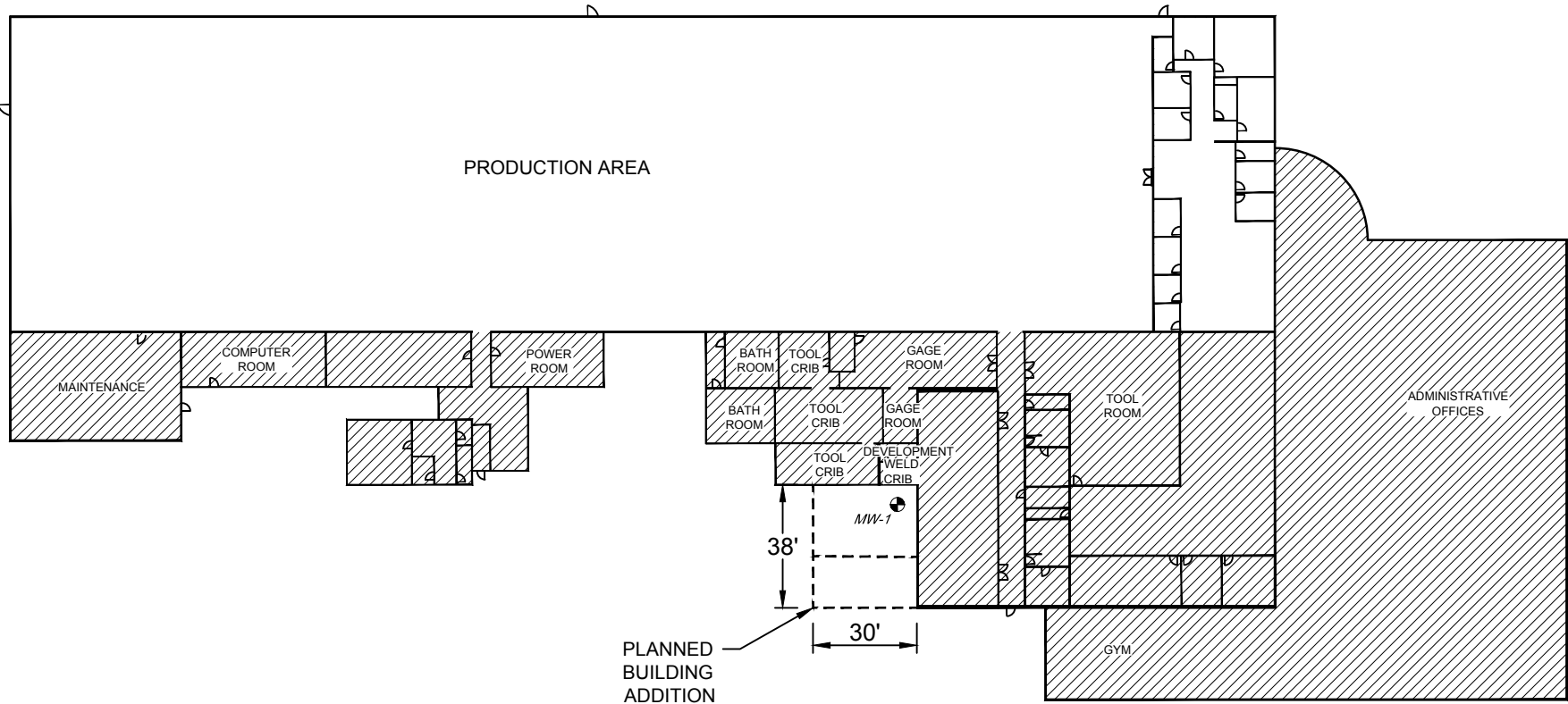
cc: Jim Schenker, Parker Hannifin Corp., Cleveland, OH (email: jim.schenker@parker.com)
John Uruskyj, GE Company, Albany, NY (email: john.uruskyj@corporate.ge.com)
Jim Kalinski, AATech (email: james.kalinski@advancedatomization.com)
Bernette Schilling, NYSDEC, Avon, NY (email: bernette.schilling@dec.ny.gov)
Melissa Doroski, NYSDOH, Troy, NY (email: mxm29@health.state.ny.us)
Dudley Loew, NYSDEC (email: Dudley.loew@dec.ny.gov)
Katherine Galanti, GHD (email: Katherine.galanti@ghd.com)



 PRODUCTION AREA
 NON-PRODUCTION AREA

MANUFACTURING BUILDING LAYOUT
 OLD ERIE CANAL SITE
 Clyde, New York