

F7.3

# Goodyear Dunlop Tires North America, Ltd.



Mr. Brian Sadowski  
New York State Dept. of Environmental Conservation  
270 Michigan Ave.  
Buffalo, NY 14203-2915

June 07, 2012

Well Testing Results and Periodic Review Report of Inactive Waste Site No. 915018

Dear Mr. Sadowski,

Please find the attached analytical results of our annual well testing sampled on 5/24/2012. The wells required to be sampled this year (year 18) are downgradient wells B3, B4, & C7. Downgradient wells A4 & C5 and upgradient wells A6 & C1 are not required to be tested at this time per the Long Term Monitoring Plan. The sample results are below action levels, with the exception of Total Phenols which are reported at the analytical laboratory method detection limit of <0.005 ug/L.

Please also find the results of the semi-annual Landfill Condition Inspections completed on 10/13/2011 & 4/12/2012.

We continue to allow the grass to grow until August 15<sup>th</sup> in certain areas, at the NYSDEC's request, to encourage ground nesting birds.

Finally, also submitted with these findings are the Periodic Review Report and Institutional and Engineering Controls Certification Form (IC/EC) as requested by the NYSDEC.

I will transmit this report electronically (.pdf) and also mail you a hard copy of the certification forms only.

Please contact me if you have any questions or if you need any additional information.

Thank you,

Mark R. Craft  
Environmental Coordinator  
(716) 879-8497

- attach:
1. IC/EC Certification Form
  2. Periodic Review Report (with sampling location map)
  3. Lab reports
  4. Site Layout (sample points)
  5. Long-term sampling schedule
  6. Action Levels for Downgradient Wells
  7. Semi-annual inspection forms



Enclosure 2  
**NEW YORK STATE DEPARTMENT OF ENVIRONMENTAL CONSERVATION**  
 Site Management Periodic Review Report Notice  
 Institutional and Engineering Controls Certification Form



Site No. 915018

**Site Details**

Box 1

Site Name **Dunlop Tire and Rubber**

Site Address: Sheridan Drive and River Road      Zip Code: 14150  
 City/Town: Tonawanda  
 County: Erie  
 Site Acreage: 25.0 (Landfill Areas)

Reporting Period: June 30, 2011 to June 30, 2012

- |  | YES                                 | NO                                  |
|--|-------------------------------------|-------------------------------------|
| 1. Is the information above correct?   | <input checked="" type="checkbox"/> | <input type="checkbox"/>            |
| If NO, include handwritten above or on a separate sheet.   |                                     |                                     |
| 2. Has some or all of the site property been sold, subdivided, merged, or undergone a tax map amendment during this Reporting Period?                              | <input type="checkbox"/>            | <input checked="" type="checkbox"/> |
| 3. Has there been any change of use at the site during this Reporting Period (see 6NYCRR 375-1.11(d))?   | <input type="checkbox"/>            | <input checked="" type="checkbox"/> |
| 4. Have any federal, state, and/or local permits (e.g., building, discharge) been issued for or at the property during this Reporting Period?                      | <input type="checkbox"/>            | <input checked="" type="checkbox"/> |
| <b>If you answered YES to questions 2 thru 4, include documentation or evidence that documentation has been previously submitted with this certification form.</b> |                                     |                                     |
| 5. Is the site currently undergoing development?   | <input type="checkbox"/>            | <input checked="" type="checkbox"/> |

**Box 2**

- |  | YES                                 | NO                       |
|--|-------------------------------------|--------------------------|
| 6. Is the current site use consistent with the use(s) listed below?<br>Closed Landfill | <input checked="" type="checkbox"/> | <input type="checkbox"/> |
| 7. Are all ICs/ECs in place and functioning as designed?                               | <input checked="" type="checkbox"/> | <input type="checkbox"/> |

**IF THE ANSWER TO EITHER QUESTION 6 OR 7 IS NO, sign and date below and DO NOT COMPLETE THE REST OF THIS FORM. Otherwise continue.**

A Corrective Measures Work Plan must be submitted along with this form to address these issues.

Signature of Owner, Remedial Party or Designated Representative \_\_\_\_\_

Date \_\_\_\_\_

SITE NO. 915018

Box 3

Description of Institutional Controls

Parcel

Owner

Institutional Control

65.17-2-1.111

Goodyear Dunlop Tires North America,

Monitoring Plan  
O&M Plan

Description of Engineering Controls

Box 4

Parcel

Engineering Control

65.17-2-1.111

Cover System  
Fencing/Access Control

Control Description for Site No. 915018

Parcel: 65.17-2-1.111

In March 1993, a Record of Decision (ROD) was issued for this site. During 1993 and 1994, three on-site landfills were capped with modified Part 360 clay caps that consisted of 18 inches of compacted clay and covered with 6 inches of soil. Other areas were paved for parking and tractor trailer storage. Post-closure maintenance of the cover system and groundwater monitoring are required to ensure long term effectiveness of the remedy and to provide early detection should failure occur. The site is fenced and has full time security.

**Periodic Review Report (PRR) Certification Statements**

1. I certify by checking "YES" below that:

- a) the Periodic Review report and all attachments were prepared under the direction of, and reviewed by, the party making the certification;
- b) to the best of my knowledge and belief, the work and conclusions described in this certification are in accordance with the requirements of the site remedial program, and generally accepted engineering practices; and the information presented is accurate and complete.

YES    NO

2. If this site has an IC/EC Plan (or equivalent as required in the Decision Document), for each Institutional or Engineering control listed in Boxes 3 and/or 4, I certify by checking "YES" below that all of the following statements are true:

- (a) the Institutional Control and/or Engineering Control(s) employed at this site is unchanged since the date that the Control was put in-place, or was last approved by the Department;
- (b) nothing has occurred that would impair the ability of such Control, to protect public health and the environment;
- (c) access to the site will continue to be provided to the Department, to evaluate the remedy, including access to evaluate the continued maintenance of this Control;
- (d) nothing has occurred that would constitute a violation or failure to comply with the Site Management Plan for this Control; and
- (e) if a financial assurance mechanism is required by the oversight document for the site, the mechanism remains valid and sufficient for its intended purpose established in the document.

YES    NO

**IF THE ANSWER TO QUESTION 2 IS NO, sign and date below and DO NOT COMPLETE THE REST OF THIS FORM. Otherwise continue.**

**A Corrective Measures Work Plan must be submitted along with this form to address these issues.**

\_\_\_\_\_  
Signature of Owner, Remedial Party or Designated Representative

\_\_\_\_\_  
Date

**SITE OWNER OR DESIGNATED REPRESENTATIVE SIGNATURE**

I certify that all information and statements in Boxes 1, 2, and 3 are true. I understand that a false statement made herein is punishable as a Class "A" misdemeanor, pursuant to Section 210.45 of the Penal Law.

I Aaron Hildebrand at Goodyear Dunlop Tires, NA Ltd.  
print name 10 Sheridan Drive, Tonawanda NY 14150  
print business address

am certifying as Plant Manager (Owner or Remedial Party)

for the Site named in the Site Details Section of this form.

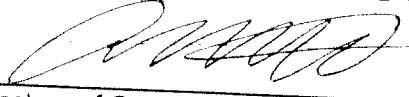
  
Signature of Owner, Remedial Party, or Designated Representative  
Rendering Certification

6/14/12  
Date

IC/EC CERTIFICATIONS

Qualified Environmental Professional Signature

Box 7

I certify that all information in Boxes 4 and 5 are true. I understand that a false statement made herein is punishable as a Class "A" misdemeanor, pursuant to Section 210.45 of the Penal Law.

I Mark Craft at Goodyear Dunlop Tires  
print name 10 Sheridan Drive, Tonawanda NY 14150  
print business address

am certifying as a Qualified Environmental Professional for the Goodyear Dunlop Tire Co  
(Owner or Remedial Party)

M. Craft  
Signature of Qualified Environmental Professional, for  
the Owner or Remedial Party, Rendering Certification

Stamp  
(Required for PE)

6/14/12  
Date

**GOODYEAR DUNLOP TIRES, NA LTD  
TONAWANDA, NEW YORK  
LANDCAP MANAGEMENT  
SITE MANAGEMENT PERIODIC REVIEW REPORT (PRR)**

**I. Introduction**

In 1994 a plan was developed to close inactive waste sites at the Goodyear Dunlop Tire, NA Ltd. (GDTNA) located in Tonawanda, New York. Solid waste, rubber and other wastes were consolidated into three separate areas (Areas A, B and C) within the GDTNA site. A monitoring plan was established based upon the results of site investigations. The goal of this plan is to monitor the long term effectiveness of the closure, and provide for early detection should failure occur.

At this time sampling required by the monitoring plan effectively shows that the capped areas are containing these wastes.

GDTNA will continue with the existing plan, until 2024 when we expect a new plan to be issued.

**II. Site Overview**

Please see the attached site map which shows the location of each of the three capped areas.

**III. Evaluate Remedy Performance, Effectiveness, and Protectiveness**

Post closure maintenance and groundwater monitoring of Areas A, B and C ensure that the closures continue to operate effectively.

**IV. IC/EC Plan Compliance Report**

Refer to the Control Description on IC/EC Certification Form.

**V. Monitoring Plan Compliance Report**

The capped areas are inspected on a semi-annual basis and maintenance is performed as needed to ensure cap integrity. Monitoring wells are sampled as

per the sampling schedule in Table 1 of the long term monitoring plan. A report detailing the results obtained from each sampling event is submitted annually for review by the NYSDEC.

**VI. Operation & maintenance Plan Compliance Report**

N/A

**VII. Overall PRR Conclusions and Recommendations**

GDTNA continues to meet the annual monitoring requirements set forth by the long term monitoring plan.

**VIII. Additional Guidance**

Additional guidance regarding the preparation and submittal of an acceptable PRR can be obtained from the Department's Project Manager for the site.





2801 Long Road  
Grand Island, NY 14072  
(716) 773-8401  
(800) 699-8606  
www.islechem.com

## Analysis Report

Client: Mark Craft  
Goodyear Dunlop Tires NA, Ltd.

Project: Water Samples for Analysis

PO Box 1109  
Buffalo, NY 14240

Well Sampling

Report Date: Friday, June 08, 2012

Report ID: NY205208.0.29730

Contact: Mark Craft

Batch Date: Thursday, May 24, 2012

Batch Time: 11:45

Batch: --

Received: Thursday, May 24, 2012  
12:30

Report Status: Final - Revised Version

Authorized Signature:

Richard V. Finn, Manager of Chemical Testing  
 Martin Ruszaj, Director of Chemical Testing

*The following result table is for 4 samples received by IsleChem LLC on 05/24/2012 submitted by Patrick Hagerty  
Also enclosed is the paperwork submitted with the samples.*

*Narrative:*

*Analyses were performed within required holding times unless otherwise noted below. All quality control results were within acceptable limits unless specifically noted in the report. Quality control analyses were performed on the samples in this report or samples of similar matrix that were analyzed in the analytical batch on the dates indicated in the report.*

*Notes:*

# Sample Results

Sample ID                    Location

Client:     Goodyear Dunlop Tires NA, Ltd.

Method

Report ID: NY205208.0.29730

Analyte

Sample Results

Units

Analyst

Vessel ID

Date

**208-0524-01**                    Well B3 / Field Grab - Ground Water     Sampled: 5/24/2012

**Metals**

EPA 200.7 Rev 4.4

Arsenic, Soluble	<0.01	mg/L	RVF 227203	2012-06-05
Arsenic, Total	<0.01	mg/L	RVF 227202	2012-06-05
Cadmium, Soluble	<0.01	mg/L	RVF 227203	2012-06-05
Cadmium, Total	<0.01	mg/L	RVF 227202	2012-06-05
Chromium, Soluble	<0.01	mg/L	RVF 227203	2012-06-05
Chromium, Total	<0.01	mg/L	RVF 227202	2012-06-05
Lead, Soluble	<0.01	mg/L	RVF 227203	2012-06-05
Lead, Total	<0.01	mg/L	RVF 227202	2012-06-05

**Volatiles**

EPA 624

1,2-Dichloroethene (Total)	<2	ug/L	RS 227200-227201	2012-05-30
1,1-Dichloroethane	<2	ug/L	RS 227200-227201	2012-05-30
EPA 8260C				
2-Butanone (Methylethyl ketone)	<10.0	ug/L	RS 227200-227201	2012-05-30
EPA 624				
1,1,1-Trichloroethane	<2	ug/L	RS 227200-227201	2012-05-30
Benzene	<0.5	ug/L	RS 227200-227201	2012-05-30

**WetChem**

EPA 420.1 Rev 1978

Phenols	<0.005	mg/L	ME 227199	2012-05-31
EPA 120.1 Rev 1982				
Specific Conductance	1350	umhos/cm	RVF 227204	2012-05-25
SM 18-21 2130 B (01)				
Turbidity	126	NTU	RVF 227204	2012-05-25

Time of Analysis: 9:00 am

end of Lab ID number 153927

# Sample Results

Sample ID                      Location

Client:      Goodyear Dunlop Tires NA, Ltd.

Method

Report ID: NY205208.0.29730

Analyte	Sample Results	Units	Analyst	Vessel ID	Date
<b>208-0524-02</b>	Well B4 / Field Grab - Ground Water	Sampled: 5/24/2012			

**Metals**

EPA 200.7 Rev 4.4

Arsenic, Soluble	<b>&lt;0.01</b>	mg/L	RVF 227209		2012-06-05
Arsenic, Total	<b>&lt;0.01</b>	mg/L	RVF 227208		2012-06-05
Cadmium, Soluble	<b>&lt;0.01</b>	mg/L	RVF 227209		2012-06-05
Cadmium, Total	<b>&lt;0.01</b>	mg/L	RVF 227208		2012-06-05
Chromium, Soluble	<b>&lt;0.01</b>	mg/L	RVF 227209		2012-06-05
Chromium, Total	<b>&lt;0.01</b>	mg/L	RVF 227208		2012-06-05
Lead, Soluble	<b>&lt;0.01</b>	mg/L	RVF 227209		2012-06-05
Lead, Total	<b>&lt;0.01</b>	mg/L	RVF 227208		2012-06-05

**Volatiles**

EPA 624

1,2-Dichloroethene (Total)	<b>&lt;2</b>	ug/L	RS 227206-227207		2012-05-30
1,1-Dichloroethane	<b>&lt;2</b>	ug/L	RS 227206-227207		2012-05-30
EPA 8260C					
2-Butanone (Methylethyl ketone)	<b>&lt;10</b>	ug/L	RS 227206-227207		2012-05-30
EPA 624					
1,1,1-Trichloroethane	<b>&lt;2</b>	ug/L	RS 227206-227207		2012-05-30
Benzene	<b>&lt;0.5</b>	ug/L	RS 227206-227207		2012-05-30

**WetChem**

EPA 420.1 Rev 1978

Phenols	<b>&lt;0.005</b>	mg/L	ME 227205		2012-05-31
EPA 120.1 Rev 1982					
Specific Conductance	<b>3160</b>	umhos/cm	RVF 227210		2012-05-25
SM 18-21 2130 B (01)					
Turbidity	<b>1.92</b>	NTU	RVF 227210		2012-05-25

*Time of Analysis: 9:00 am*

*end of Lab ID number 153928*

## Sample Results

Sample ID          Location          Client:          Goodyear Dunlop Tires NA, Ltd.  
 Method          Report ID: NY205208.0.29730

Analyte	Sample Results	Units	Analyst	Vessel ID	Date
---------	----------------	-------	---------	-----------	------

**208-0524-03**          Well C7 / Field Grab - Ground Water          Sampled: 5/24/2012

**Metals**

EPA 200.7 Rev 4.4

Arsenic, Soluble	<b>&lt;0.01</b>	<b>mg/L</b>	RVF 227215		2012-06-05
Arsenic, Total	<b>&lt;0.01</b>	<b>mg/L</b>	RVF 227214		2012-06-05
Cadmium, Soluble	<b>&lt;0.01</b>	<b>mg/L</b>	RVF 227215		2012-06-05
Cadmium, Total	<b>&lt;0.01</b>	<b>mg/L</b>	RVF 227214		2012-06-05
Chromium, Soluble	<b>&lt;0.01</b>	<b>mg/L</b>	RVF 227215		2012-06-05
Chromium, Total	<b>0.010</b>	<b>mg/L</b>	RVF 227214		2012-06-05
Lead, Soluble	<b>&lt;0.01</b>	<b>mg/L</b>	RVF 227215		2012-06-05
Lead, Total	<b>&lt;0.01</b>	<b>mg/L</b>	RVF 227214		2012-06-05

**Volatiles**

EPA 624

1,2-Dichloroethene (Total)	<b>&lt;2</b>	<b>ug/L</b>	RS 227212-227213		2012-05-30
1,1-Dichloroethane	<b>&lt;2</b>	<b>ug/L</b>	RS 227212-227213		2012-05-30

EPA 8260C

2-Butanone (Methylethyl ketone)	<b>&lt;10</b>	<b>ug/L</b>	RS 227212-227213		2012-05-30
---------------------------------	---------------	-------------	------------------	--	------------

EPA 624

1,1,1-Trichloroethane	<b>&lt;2</b>	<b>ug/L</b>	RS 227212-227213		2012-05-30
Benzene	<b>&lt;0.5</b>	<b>ug/L</b>	RS 227212-227213		2012-05-30

**WetChem**

EPA 420.1 Rev 1978

Phenols	<b>&lt;0.005</b>	<b>mg/L</b>	ME 227211		2012-05-31
---------	------------------	-------------	-----------	--	------------

EPA 120.1 Rev 1982

Specific Conductance	<b>3630</b>	<b>umhos/cm</b>	RVF 227216		2012-05-25
----------------------	-------------	-----------------	------------	--	------------

SM 18-21 2130 B (01)

Turbidity	<b>6.72</b>	<b>NTU</b>	RVF 227216		2012-05-25
-----------	-------------	------------	------------	--	------------

*Time of Analysis: 9:00 am*

*end of Lab ID number 153929*

# Sample Results

Sample ID                      Location                                      Client:      Goodyear Dunlop Tires NA, Ltd.  
Report ID: NY205208.0.29730

Method

Analyte	Sample Results	Units	Analyst	Vessel ID	Date
<b>208-0524-04</b>	Trip Blank / Trip Blank - DI Water	Sampled: 5/24/2012			
<b>Volatiles</b>					
EPA 624					
1,1-Dichloroethane	<2	ug/L	RS	227217	2012-05-30
EPA 8260C					
2-Butanone (Methylethyl ketone)	<10	ug/L	RS	227217	2012-05-30
EPA 624					
1,1,1-Trichloroethane	<2	ug/L	RS	227217	2012-05-30
Benzene	<0.5	ug/L	RS	227217	2012-05-30

end of Lab ID number 153930

### General Disclaimer

- The test results are submitted pursuant to IsleChem LLC's current terms and conditions of sale, including the company's standard warranty and limitation of liability provisions. No responsibility or liability is assumed for the manner in which the results are used or interpreted.
- This report is issued for the benefit of and may be relied upon by the client named above. The client bears full responsibility for deciding the level of testing for sample submitted to IsleChem LLC.
- These results pertain only to the items tested.
- This report shall not be reproduced except in full.
- If the sample(s) represented by these test results were not collected by IsleChem LLC then the test results are limited to the reported values determine by the analytical testing process. IsleChem LLC makes no representation regarding the sample's collection technique, condition, volume, homogeneity or any other aspect of the sample(s) prior to IsleChem LLC taking possession of the sample(s) and the influence it may have on the results.
- Unless notified in writing to return the samples covered by this report IsleChem LLC will store what remains of the sample(s), if anything, for a period of 60 days before discarding, unless otherwise required by law. A shipping and handling fee will be charged for the return of any sample(s).
- Certain analytes may not be covered by the NYS DOH or NELAP fields of accreditation. Results for those analytes are generated by the cited method using QA/QC guidelines from IsleChem's Quality Control Manual, where applicable.

All results for solid samples are reported on a dry weight basis unless otherwise noted.

The test results in this report meet all NELAP requirements for parameters that are within IsleChem's field of accreditation. Any exceptions to NELAP requirements are noted in the comments field.

Visit us on the web at [www.islechem.com](http://www.islechem.com)

## Groundwater Monitoring Information Sheet

Site Name: Dunlap  
Date: 05/23-24/12

Monitoring Well ID B-3

Sampling Date

### Well Structure Data

Evacuation Date: 05/23

Water Elevation: \_\_\_\_\_

Top of Inner Casing Elevation: \_\_\_\_\_

Bottom of Well: 170

Monitoring Well Diameter: 2"

Volume of Standing Water  $7.8 \times .163 = 1.27$

Water Level: 11.2

Volume of Excavated Water  $\times 3 = 3.81 / 4$  Gallons

Appearance/Observations Slightly cloudy 100% recharge

### Well Field Parameter Data

pH - Standard Units 6.91

Specific Conductance (umhos/cm) \_\_\_\_\_

Temperature - deg F 18°C / 64°F

Turbidity (ntu) \_\_\_\_\_

### Misc. Well Information

Was Well Locked?  Yes  No

Physical Condition of Well  Good  Fair  Poor

Was Well I.D. Easily Visible?  Yes  No

Solids Content  None  Medium  High

Weather on Sampling Day Sunny clear

Purging Method manual bailer

Patrick J. Nigety 05/25/12  
Field Technician Signature Date

## Groundwater Monitoring Information Sheet

Site Name: Dunlop Tine  
Date: 05/23-24/12

Monitoring Well ID: B4  
Sampling Date: 05/24/12

### Well Structure Data

Evacuation Date: 05/23 Water Elevation: \_\_\_\_\_

Top of Inner Casing Elevation: \_\_\_\_\_ Bottom of Well: 22.2

Monitoring Well Diameter: 2" Volume of Standing Water:  $14.5 \times 1.63 = 2.36$

Water Level: 7.7 Volume of Excavated Water:  $2.36 \times 3 = 7.09 / 7 \text{ gallons}$

Appearance/Observations: Clear 39% recharge

### Well Field Parameter Data

pH - Standard Units: 7.29 Specific Conductance (umhos/cm): \_\_\_\_\_

Temperature - deg F: 19°C / 64°F Turbidity (ntu): \_\_\_\_\_

### Misc. Well Information

Was Well Locked?  Yes  No Physical Condition of Well  Good  Fair  Poor

Was Well I.D. Easily Visible?  Yes  No Solids Content  None  Medium  High

Weather on Sampling Day: Sunny Clear Purging Method: Manual Bailer

Patrick Hagedorn  
Field Technician Signature Date: 5/25/12

## Groundwater Monitoring Information Sheet

Site Name: Dunlop Trce  
Date: 05/23-24/12

Monitoring Well ID: C-7  
Sampling Date: 05/24/12

### Well Structure Data

Evacuation Date: 05/23

Water Elevation: \_\_\_\_\_

Top of Inner Casing Elevation: \_\_\_\_\_

Bottom of Well: 23.2

Monitoring Well Diameter: 2"

Volume of Standing Water: 13.3 x .163 = 2.167

Water Level: 13.3

Volume of Excavated Water: 2.167 x 3 = 6.5 gallons

Appearance/Observations: clear

50% recharge 7 gallons

### Well Field Parameter Data

pH - Standard Units: 7.39

Specific Conductance (umhos/cm): \_\_\_\_\_

Temperature - deg F: 17° / 42.6°

Turbidity (ntu): \_\_\_\_\_

### Misc. Well Information

Was Well Locked?  Yes  No

Physical Condition of Well  Good  Fair  Poor

Was Well I.D. Easily Visible?  Yes  No

Solids Content  None  Medium  High

Weather on Sampling Day:  Sunny-clear

Purging Method:  manual bailer

Patrick Magaly 05/25/12  
Field Technician Signature Date





# CHAIN OF CUSTODY / REQUEST FOR LABORATORY ANALYSIS

2801 Long Road, Grand Island, NY 14072 (716)773-8401 (716)773-8517 (Fax) Page 1 of 2

Goodyear Dunlop Tires NA, Ltd. Organization Name PO Box 1109 Street Address Buffalo, NY 14240 City, State, Zip		Well Sampling Project Name Client PO / Release # Date Sampled		2 Samples / 12 Bottles # of Samples / # of Bottles 10-14 Days Turnaround Time/ Date Results Needed <i>NY25208 29930</i>								
Mark Craft Contact Person 879-8497 / 879-8400 Phone# / Fax#		E-mailed reporting upon request please provide e-mail below: mcraft@gdtna.com		IsleChem Project # Rush Work Performed at Priority Rate (see below)								
Sample ID	Sample Location	Matrix	E-mail Comp	Grab	Volatiles - Specific List **	As, Cd, Cr & Pb	Soluble Metals *	Specific Conductance	Turbidity	** Volatiles List: MEK, Benzene, 1,1-dichloroethane, 1,2- dichloroethane, 1,1,1- trichloroethane	Approved by Client Yes No Initials	Approved by Lab Yes No Initials
227199	Well B3	GW		X								
227200	Well B3	GW		X	X							
227202	Well B3	GW		X		X						
227203	Well B3	GW		X								
227204	Well B3	GW		X		X						
227205	Well B4	GW		X								
227206	Well B4	GW		X	X							
227208	Well B4	GW		X		X						
227209	Well B4	GW		X								
227210	Well B4	GW		X		X						

Comments:

Sampled By <i>[Signature]</i>	Date 05/24/12 11:45	Received by:	Date 5/24/12 12:20pm
Relinquished by <i>[Signature]</i>	Date 05/24/12 12:20	Relinquished by:	Date

Standard turnaround time is 10 days.

RUSH WORK CHARGES: 3-6 times the standard cost for same day depending on the time needed ~ 2.5 times the standard cost for next day ~ 1.75 times the standard cost for 3 day.  
 By relinquishing these samples to IsleChem, LLC, you are accepting the current IsleChem, LLC terms and conditions for the sale of services.

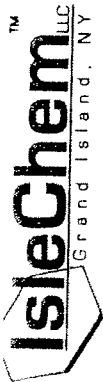

# CHAIN OF CUSTODY / REQUEST FOR LABORATORY ANALYSIS

2801 Long Road, Grand Island, NY 14072 (716)773-8401 (716)773-8517 (Fax)

<p>Goodyear Dunlop Tires NA, Ltd.          Organization Name          PO Box 1109          Street Address          Buffalo, NY 14240          City, State, Zip</p> <p>Mark Craft          Contact Person          879-8497 / 879-8400          Phone# / Fax#</p>	<p>Well Sampling          Project Name          PO Line 40          Client PO / Release #  <i>05/24/12</i>          Date Sampled</p>	<p>1 Sample / 6 Bottles + Trip Blank          # of Samples / # of Bottles          10-14 Days          Turnaround Time/ Date Results Needed  <i>NY205208 29930</i>          IsleChem Project #</p>														
<p>E-mailed reporting upon request please provide e-mail below:  <a href="mailto:mcraff@gdina.com">mcraff@gdina.com</a></p>																
Sample ID	Sample Location	Matrix	E-mail	Total Rec Phenols	Volatiles - Specific List **	As, Cd, Cr & Pb	Soluble Metals *	Specific Conductance	Turbidity	** Volatiles List: MEK, Benzene, 1,1-dichloroethane, 1,2-dichloroethane, 1,1,1-trichloroethane	Rush Work Performed at Priority Rate (see below)	Approved by Client	Yes	No	Initials	
			Comp	Grab												
227211	Well C7	GW		X	X											
227212	Well C7	GW		X	X											
227214	Well C7	GW		X		X										
227215	Well C7	GW		X												
227216	Well C7	GW		X			X									
227217	Trip Blank	DI Water														

**Comments:**

Sampled by:	<i>[Signature]</i>	Date	05/24/12	Time	1145	Received by:		Date	Time
Relinquished by:	<i>[Signature]</i>	Date	05/24/12	Time	1730	Relinquished by:		Date	Time
Standard turnaround time is 0 days						Received by lab:	<i>[Signature]</i>	Date	Time
								5/24/12	1030

RUSH WORK CHARGES: 3-6 times the standard cost for same day depending on the time needed ~ 2.5 times the standard cost for next day ~ 1.75 times the standard cost for 3 day.  
 By relinquishing these samples to IsleChem, LLC, you are accepting the current IsleChem, LLC terms and conditions for the sale of services.



Client Name: GOODYEAR DUNLOP TIRES

IsleChem, LLC Job Number: N4205208

Sample(s) received by: KEVIN RABER Date: 5/24/12 Time: 12:30 PM

Is the sample identified clearly with complete documentation including:

Sample location/Identification	<u>YES</u>	NO	N/A	Corrected
Sample date	<u>YES</u>	NO	N/A	Corrected
Sample time	YES	<u>NO</u>	N/A	Corrected
Client name	<u>YES</u>	NO	N/A	Corrected
Sampler's name	YES	<u>NO</u>	N/A	Corrected
Preservation type	<u>YES</u>	NO	N/A	Corrected
Required analysis is listed on each bottle	<u>YES</u>	NO	N/A	Corrected
Special remarks	YES	<u>NO</u>	N/A	Corrected

Are the sample labels clear & do they provide a unique identification of the sample? YES NO N/A Corrected

Are the sample containers appropriate? YES NO N/A Corrected

Is the sample date within the required hold times? YES NO N/A Corrected

Is there adequate volume available for requested analysis? YES NO N/A Corrected

Did the customer list what sample analysis is required? YES NO N/A Corrected

Is a chain of custody included? YES NO N/A Corrected

Is the chain of custody complete? YES NO N/A Corrected

Are the samples(s) free of apparent damage or contamination? YES NO N/A Corrected

Temperature 6°C Has cooling begun? YES NO N/A

Is temperature 6° C or less if sample was held prior to delivery date? YES NO N/A



Are samples appropriately preserved if necessary? YES NO N/A Corrected

Comments/Actions: \_\_\_\_\_  
\_\_\_\_\_  
\_\_\_\_\_

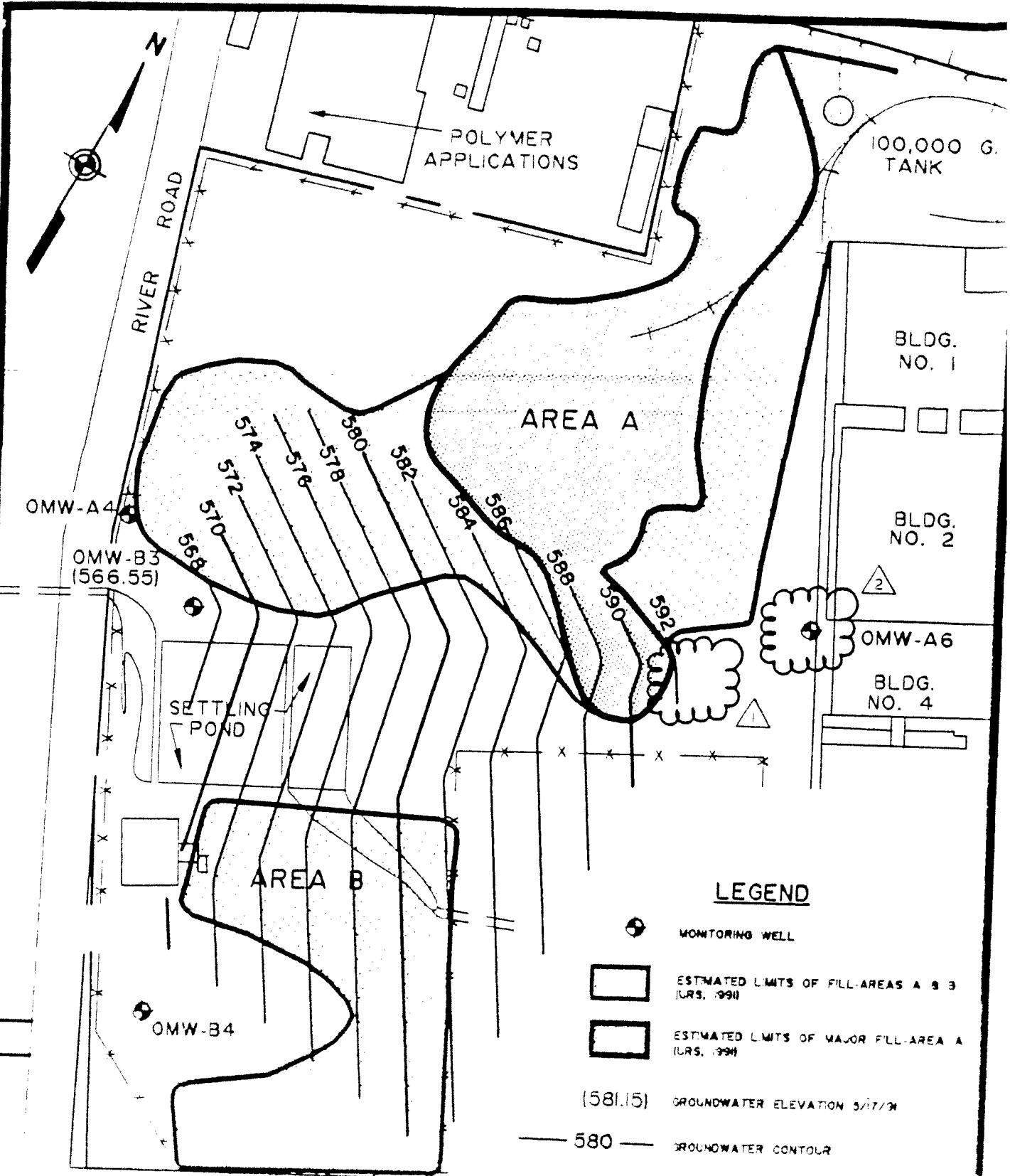
100552461 1:200 7/17/94 2:11.0



**LEGEND**

-  MONITORING WELL
-  ESTIMATED LIMITS OF FILL AREAS A & B (URS, 1991)
-  ESTIMATED LIMITS OF MAJOR FILL AREA A (URS, 1991)
- (581.15) GROUNDWATER ELEVATION 5/17/94
- 580 — GROUNDWATER CONTOUR

NO.	DATE	DESCRIPTION
1	5/17/94	MONITORING WELL
2	5/17/94	MONITORING WELL

**URS**

LONG TERM MONITORING WELL LOCATIONS  
AREAS A & B

FIGURE 2

35246\ 1-200 7/18/94 2 EID

NEW WAREHOUSE

OMW-C5  
(576.67)

OMW-C7

OMW-C1

AREA C

NEW YORK STATE THRUWAY

**LEGEND**



MONITORING WELL



ESTIMATED LIMITS OF FILL AREAS A & B  
(URS, 1991)

591.42

GROUNDWATER ELEVATION 5/17/94

590

GROUNDWATER ELEVATION

**URS**

CONSULTANTS, INC.

LONG TERM MONITORING WELL LOCATIONS  
AREA C

FIGURE 3

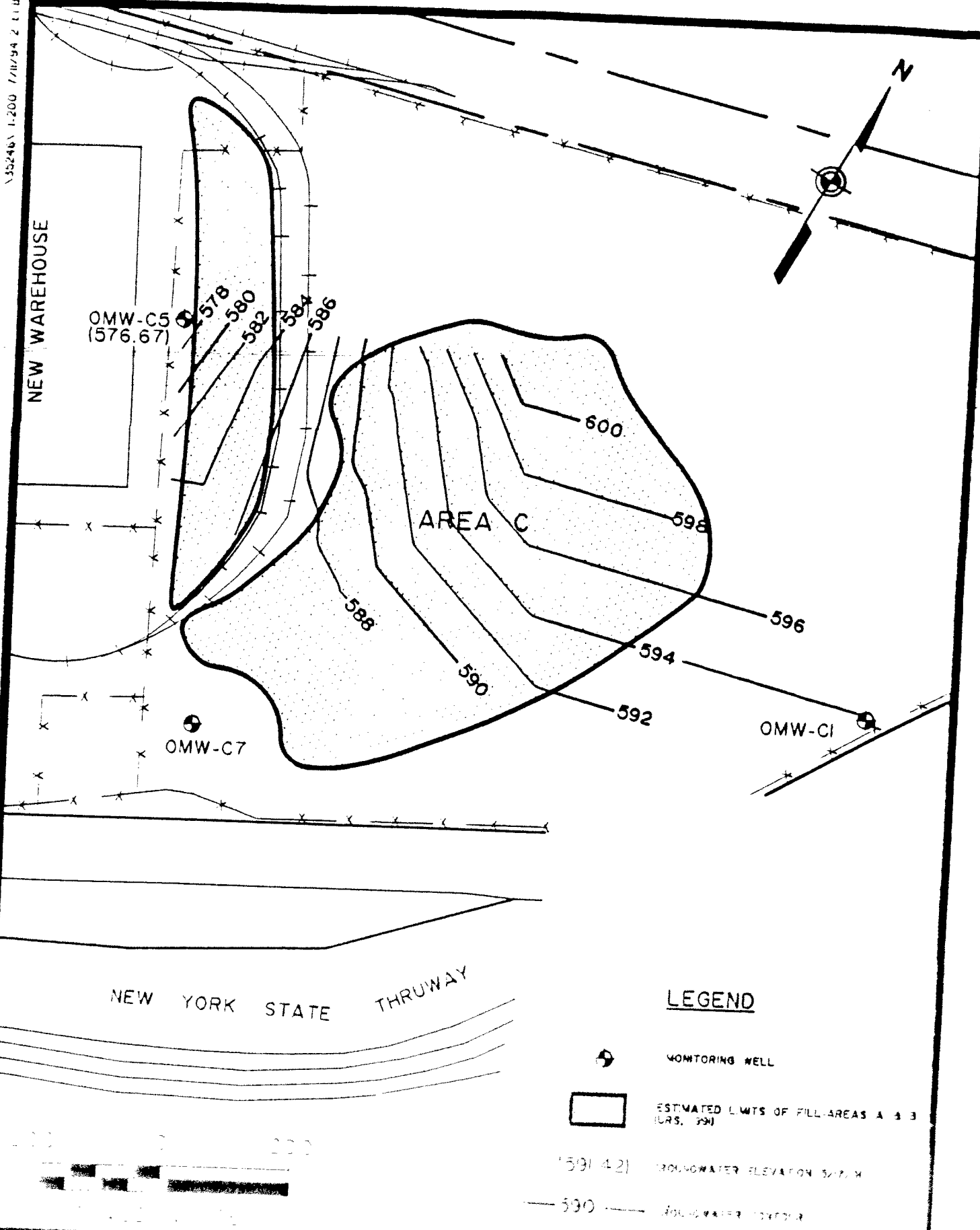

**TABLE 1  
SAMPLING SCHEDULE  
DUNLOP TIRE CORPORATION  
LONG TERM MONITORING PLAN  
INACTIVE WASTE SITES 915018 A, B AND C**

Year	Analytical Schedule	Number of Sampling Events Per Year							Sampling Season
		Upgradient		Downgradient					
		A6	C1	B3	B4	A4	C5	C7	
1	A	2	2	2	2	2	2	2	Spring/Fall
2,3	B			2	2	2	2	2	Spring/Fall
4,5	B			1	1	1	1	1	Spring
6-9	B			1	1			1	Spring
10	B			1	1	1	1	1	Spring
11-14	B			1	1			1	Spring
15	B			1	1	1	1	1	Spring
16-19	B			1	1			1	Spring
20	B			1	1	1	1	1	Spring
21-24	B			1	1			1	Spring
25	B			1	1	1	1	1	Spring
26-29	B			1	1			1	Spring
30	B			1	1	1	1	1	Spring

\* Analytical Schedules

A - TCL Volatiles, TCL Semivolatiles, TAL Metals.

B - Volatiles: 2 Butanone (MEK), Benzene, 1,1 Dichloroethane, 1,2 Dichloroethene (total), 1,1,1 trichloroethane. Other compounds if detected at or above levels of concern in year 1 sampling.

Semi Volatiles: Total Phenols. Other compounds if detected at or above levels of concern in year 1 sampling.

Metals: Arsenic, Cadmium, Chromium, Lead. Other analytes if detected at or above levels of concern in year 1 sampling.

TABLE 3

LONG TERM MONITORING PLAN  
 INACTIVE WASTE SITES 915018 A, B AND C  
 DUNLOP TIRE CORPORATION  
 GROUNDWATER ACTION LEVELS FOR DOWNGRAIENT WELLS

PARAMETER	TYPE	ARAR <sup>1</sup> VALUE (ppb)	OMW-B3 (ppb)	OMW-B4 <sup>2</sup> (ppb)	OMW-C5 (ppb)	OMW-C7 (ppb)
2-Butanone (MEK)	VOC	50	50	50	50	50
Benzene	VOC	0.7	0.7	2	0.7	0.7
1,1-Dichloroethane	VOC	5	5	5	5	5
1,2-Dichloroethene (Total)	VOC	5	5	5	5	5
1,1,1-Trichloroethane	VOC	5	5	5	5	5
Arsenic	MET	25	25	25	25	25
Cadmium	MET	10	10	28	16	10
Chromium	MET	50	50	178	66	50
Lead	MET	25	32	52	50	25
Total Phenols	SEMI	1	1	1	1	1

VOC = Volatile Organic Compounds

MET = Metals

SEMI = Semivolatile Organic Compound

<sup>1</sup> NYSDEC Ambient Water Quality Standards and Guidance values, November 1991

<sup>2</sup> Determined using existing data from OMW-B2

GOODYEAR DUNLOP TIRES, NORTH AMERICA LTD.  
 LANDFILL CONDITION - SEMI-ANNUAL INSPECTION REPORT

Site No.: 915018 A, B & C  
 Date of Inspection: 4/12/12

Name of Inspector: Tim Bots

see comment

	Topsoil Erosion Occurring?	Clay Cap Erosion Occurring?	Ditches Free of Obstruction?	Grass Cover Adequate?	Paved Areas Intact?	Note Any Damage.
<b>AREA "B"</b>						
Southern Area	<u>N</u>	<u>N</u>	<u>Y</u>	<u>Y</u>		<u>None</u>
Northern Area	<u>N</u>	<u>N</u>	<u>Y</u>	<u>Y</u>		
River Road Ditch	<u>N</u>	<u>N</u>	<u>Y</u>	<u>Y</u>		
<b>BORROW PIT</b>						
<b>AREA "A"</b>						
Central Area	<u>N</u>	<u>N</u>	<u>Y</u>	<u>Y</u>		
Northeast Area	<u>N</u>	<u>N</u>	<u>Y</u>	<u>Y</u>		
<b>AREA "C"</b>						
Outlying Area	<u>N</u>	<u>N</u>	<u>Y</u>	<u>Y</u>		
Major Area	<u>N</u>	<u>N</u>	<u>Y</u>	<u>Y</u>		
Ditch at Toe of Slope	<u>N</u>	<u>N</u>	<u>Y</u>	<u>Y</u>		
- Sheridan Drive Ditch	<u>N</u>	<u>N</u>	<u>Y</u>	<u>Y</u>		
Stockpile Area	<u>N</u>	<u>N</u>	<u>Y</u>	<u>Y</u>		
Warehouse Ditch	<u>N</u>	<u>N</u>	<u>Y</u>	<u>Y</u>		
<b>Paved Areas</b>						
Parking Lot					<u>Y</u>	<u>✓</u>
Driveway					<u>Y</u>	

**WEATHER CONDITIONS:**

Temperature 50°F  
 Wind Direction From NW  
 Wind Speed 5 mph  
 Precipitation Amount None  
 Sky Conditions partly cloudy  
 Inches of Snow Cover None

**Describe Any Corrective Action Required:**

General condition of landfill caps looks good.  
 see note regarding Sheridan Dr. ditch on figure 1 attached.

**Describe Any Corrective Action Taken:**



GOODYEAR DUNLOP TIRES, NORTH AMERICA LTD.  
 LANDFILL CONDITION - SEMI-ANNUAL INSPECTION REPORT

File 7.4

Site No.: 915018 A, B & C  
 Date of Inspection: 10/13/11

Name of Inspector: Tim BWS

	Topsoil Erosion Occurring?	Clay Cap Erosion Occurring?	Ditches Free of Obstruction?	Grass Cover Adequate?	Paved Areas Intact?	Note Any Damage.
<b>AREA "B"</b>						
Southern Area	<u>N</u>	<u>N</u>	<u>Y</u>	<u>Y</u>		
Northern Area	<u>N</u>	<u>N</u>	<u>Y</u>	<u>Y</u>		
River Road Ditch	<u>N</u>	<u>N</u>	<u>Y</u>	<u>Y</u>		
<b>BORROW PIT</b>						
<b>AREA "A"</b>						
Central Area	<u>N</u>	<u>N</u>	<u>Y</u>	<u>N</u>		
Northeast Area	<u>N</u>	<u>N</u>	<u>Y</u>	<u>N</u>		<u>has not been mowed</u>
<b>AREA "C"</b>						
Outlying Area	<u>N</u>	<u>N</u>	<u>Y</u>	<u>Y</u>		
Major Area	<u>N</u>	<u>N</u>	<u>Y</u>	<u>Y</u>		
Ditch at Toe of Slope	<u>N</u>	<u>N</u>	<u>Y</u>	<u>Y</u>		
Sheridan Drive Ditch	<u>N</u>	<u>N</u>	<u>Y</u>	<u>Y</u>		
Stockpile Area	<u>N</u>	<u>N</u>	<u>Y</u>	<u>Y</u>		
Warehouse Ditch	<u>N</u>	<u>N</u>	<u>Y</u>	<u>Y</u>		
<b>Paved Areas</b>						
Parking Lot						
Driveway						

**WEATHER CONDITIONS:**

Temperature 71°F  
 Wind Direction From Northwest  
 Wind Speed 5 mph  
 Precipitation Amount 0"  
 Sky Conditions Mostly Sunny  
 Inches of Snow Cover 0"

**Describe Any Corrective Action Required:**

- Mow grass in Area A  
- clear overgrowth outside fence at River Rd.

**Describe Any Corrective Action Taken:**

✓  
✓