

Goodyear Dunlop Tires North America, Ltd.



Mr. Brian Sadowski
New York State Dept. of Environmental Conservation
270 Michigan Avenue
Buffalo, NY 14203-2915

June 20, 2013

Well Testing Results and Periodic Review Report of Inactive Waste Site No. 915018

Dear Mr. Sadowski,

Please find the attached analytical results of our annual well testing sampled on June 6, 2013. The wells required to be sampled this year (year 19) are downgradient wells B3, B4, & C7. Downgradient wells A4 & C5 and upgradient wells A6 & C1 are not required to be tested at this time per the Long Term Monitoring Plan.

The follow parameters were reported above action levels:

- Total Phenols which were reported at the analytical laboratory method detection limits of <0.005 ug/L.
- Well B3 Total Arsenic was reported at 0.107 mg/L. We will grab a second sample from this well for Arsenic analysis per your guidance provided by phone on June 20, 2013. We will provide you with the results of this sampling when it becomes available.

Please also find the results of the semi-annual Landfill Condition Inspections completed on 10/04/2012 & 4/18/2013.

We continue to allow the grass to grow until August 15th in certain areas, at the NYSDEC's request, to encourage ground nesting birds.

Finally, also submitted with these findings are the Periodic Review Report and Institutional and Engineering Controls Certification Form (IC/EC) as requested by the NYSDEC.

I will transmit this report electronically (.pdf) and also mail you a hard copy of the certification forms only.

Please contact me if you have any questions or if you need any additional information.

Thank you,

Mark R. Craft
Environmental Coordinator
(716) 879-8497

- attach:
1. IC/EC Certification Form
 2. Periodic Review Report (with sampling location map)
 3. Lab reports
 4. Site Layout (sample points)
 5. Long-term sampling schedule
 6. Action Levels for Downgradient Wells
 7. Semi-annual inspection forms



Enclosure 2
NEW YORK STATE DEPARTMENT OF ENVIRONMENTAL CONSERVATION
 Site Management Periodic Review Report Notice
 Institutional and Engineering Controls Certification Form



	Site Details	Box 1
Site No.	915018	
Site Name Dunlop Tire and Rubber		
Site Address: Sheridan Drive and River Road		Zip Code: 14150
City/Town: Tonawanda		
County: Erie		
Site Acreage: 25.0 (Landfill Areas)		
Reporting Period: June 30, 2012 to June 30, 2013		
		YES NO
1. Is the information above correct?		<input checked="" type="checkbox"/> <input type="checkbox"/>
If NO, include handwritten above or on a separate sheet.		
2. Has some or all of the site property been sold, subdivided, merged, or undergone a tax map amendment during this Reporting Period?		<input type="checkbox"/> <input checked="" type="checkbox"/>
3. Has there been any change of use at the site during this Reporting Period (see 6NYCRR 375-1.11(d))?		<input type="checkbox"/> <input checked="" type="checkbox"/>
4. Have any federal, state, and/or local permits (e.g., building, discharge) been issued for or at the property during this Reporting Period?		<input type="checkbox"/> <input checked="" type="checkbox"/>
<i>(None pertaining to Landfill Areas) SPDES Renewed 2/1/13, Gen. SW Renewed 10/1/12, Sanitary Sewer Renewed 9/1/12</i> If you answered YES to questions 2 thru 4, include documentation or evidence that documentation has been previously submitted with this certification form.		
5. Is the site currently undergoing development?		<input type="checkbox"/> <input checked="" type="checkbox"/>
		Box 2
		YES NO
6. Is the current site use consistent with the use(s) listed below? Closed Landfill <i>Tire manufacturing not included</i>		<input checked="" type="checkbox"/> <input type="checkbox"/>
7. Are all ICs/ECs in place and functioning as designed?		<input checked="" type="checkbox"/> <input type="checkbox"/>
IF THE ANSWER TO EITHER QUESTION 6 OR 7 IS NO, sign and date below and DO NOT COMPLETE THE REST OF THIS FORM. Otherwise continue.		
A Corrective Measures Work Plan must be submitted along with this form to address these issues.		
Signature of Owner, Remedial Party or Designated Representative		Date

Description of Institutional Controls

<u>Parcel</u>	<u>Owner</u>	<u>Institutional Control</u>
65.17-2-1.111	Goodyear Dunlop Tires North America,	Monitoring Plan O&M Plan

1. March 1993, Record of Decision (ROD).
2. Post-closure maintenance of the cover system and groundwater monitoring to ensure long term effectiveness of the remedy and to provide early detection should failure occur.

Description of Engineering Controls

<u>Parcel</u>	<u>Engineering Control</u>
65.17-2-1.111	Cover System Fencing/Access Control

1. Capping of three on-site landfills in 1993 and 1994 with modified Part 360 clay caps that consisted of 18 inches of compacted clay and covered with 6 inches of soil.
2. Overlying other areas of the three landfills were asphalt paved for parking and tractor trailer storage in the Fall of 1992. Surface water runoff is directed to catch basins that discharge to the plant settling pond. Monitoring of this pond is routinely scheduled as a SPDES permit condition. The site is fenced and has full time security.

Periodic Review Report (PRR) Certification Statements

1. I certify by checking "YES" below that:

a) the Periodic Review report and all attachments were prepared under the direction of, and reviewed by, the party making the certification;

b) to the best of my knowledge and belief, the work and conclusions described in this certification are in accordance with the requirements of the site remedial program, and generally accepted engineering practices; and the information presented is accurate and complete.

YES NO

2. If this site has an IC/EC Plan (or equivalent as required in the Decision Document), for each Institutional or Engineering control listed in Boxes 3 and/or 4, I certify by checking "YES" below that all of the following statements are true:

(a) the Institutional Control and/or Engineering Control(s) employed at this site is unchanged since the date that the Control was put in-place, or was last approved by the Department;

(b) nothing has occurred that would impair the ability of such Control, to protect public health and the environment;

(c) access to the site will continue to be provided to the Department, to evaluate the remedy, including access to evaluate the continued maintenance of this Control;

(d) nothing has occurred that would constitute a violation or failure to comply with the Site Management Plan for this Control; and

(e) if a financial assurance mechanism is required by the oversight document for the site, the mechanism remains valid and sufficient for its intended purpose established in the document.

YES NO

IF THE ANSWER TO QUESTION 2 IS NO, sign and date below and DO NOT COMPLETE THE REST OF THIS FORM. Otherwise continue.

A Corrective Measures Work Plan must be submitted along with this form to address these issues.

Signature of Owner, Remedial Party or Designated Representative

Date

IC CERTIFICATIONS
SITE NO. 915018

Box 6

SITE OWNER OR DESIGNATED REPRESENTATIVE SIGNATURE

I certify that all information and statements in Boxes 1,2, and 3 are true. I understand that a false statement made herein is punishable as a Class "A" misdemeanor, pursuant to Section 210.45 of the Penal Law.

I John Romero at Goodyear Dunlop Tires, NA LTD
10 Sheridan Dr, Tonawanda NY 14150
print name print business address

am certifying as Plant Manager (Owner or Remedial Party)

for the Site named in the Site Details Section of this form.

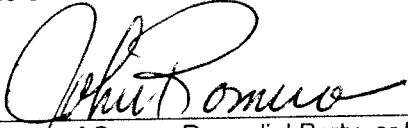
Signature of Owner, Remedial Party, or Designated Representative
Rendering Certification

7/11/13
Date

IC/EC CERTIFICATIONS

Box 7

Qualified Environmental Professional Signature

I certify that all information in Boxes 4 and 5 are true. I understand that a false statement made herein is punishable as a Class "A" misdemeanor, pursuant to Section 210.45 of the Penal Law.

I Mark Craft at Goodyear Dunlop Tires, NA LTD
10 Sheridan Dr., Tonawanda NY 14150
print name print business address

am certifying as a Qualified Environmental Professional for the Goodyear Dunlop Tires NA LTD
(Owner or Remedial Party)

M. Craft
Signature of Qualified Environmental Professional, for
the Owner or Remedial Party, Rendering Certification

Stamp
(Required for PE)

2/16/13
Date

**GOODYEAR DUNLOP TIRES, NA LTD
TONAWANDA, NEW YORK
LANDCAP MANAGEMENT
SITE MANAGEMENT PERIODIC REVIEW REPORT (PRR)**

I. Executive Summary

In 1994 a plan was developed to close inactive waste sites at the Goodyear Dunlop Tire, NA Ltd. (GDTNA) located in Tonawanda, New York. Solid waste, rubber and other wastes were consolidated into three separate areas (Areas A, B and C) within the GDTNA site. A monitoring plan was established based upon the results of site investigations. The goal of this plan is to monitor the long term effectiveness of the closure, and provide for early detection should failure occur.

At this time sampling required by the monitoring plan effectively shows that the capped areas are containing these wastes.

GDTNA will continue with the existing plan, until 2024 when we expect a new plan to be issued.

II. Site Overview

Please see the attached site maps which show the location of each of the three capped areas.

III. Evaluate Remedy Performance, Effectiveness, and Protectiveness

Post closure maintenance and groundwater monitoring of Areas A, B and C ensure that the closures continue to operate effectively.

IV. IC/EC Plan Compliance Report

Refer to the Control Description on IC/EC Certification Form.

V. Monitoring Plan Compliance Report

The capped areas are inspected on a semi-annual basis and maintenance is performed as needed to ensure cap integrity. Monitoring wells are sampled as

per the sampling schedule in Table 1 of the long term monitoring plan. A report detailing the results obtained from each sampling event is submitted annually for review by the NYSDEC.

VI. Operation & Maintenance Plan Compliance Report

Refer to section V.

VII. Overall PRR Conclusions and Recommendations

GDTNA continues to meet the annual monitoring requirements set forth by the long term monitoring plan.

VIII. Additional Guidance

Additional guidance regarding the preparation and submittal of an acceptable PRR can be obtained from the Department's Project Manager for the site.



2801 Long Road
Grand Island, NY 14072
(716) 773-8401
(800) 699-8606
(716) 773-8517 (fax)
www.islechem.com

Analysis Report

Client Goodyear Dunlop Tires NA, Ltd. Project Water Samples For Analysis
PO Box 1109 Well Sampling
Buffalo, NY 14240

Report Date 6/20/2013 Contact Mark Craft
Status Final - Revised Edition
ID NY306042.0.35075

Batch Date 6/6/2013
Time 11:15
Description --
Received 6/6/2013
13:10

Batch Contact Mark Craft

Authorized Signature 

Richard V. Finn, Manager of Chemical Testing

The following result table is for 4 samples received by IsleChem LLC on 6/6/2013 sampled by Patrick Hagerty on 6/6/2013 and submitted by Patrick Hagerty

Also enclosed are the Chain of Custody and Sample Receipt check list for this project.

Narrative:

Analyses were performed within the required holding times unless otherwise noted below. All quality control results were within acceptable limits unless specifically noted in the report. Quality control analyses were performed on the samples in this report or samples of similar matrix that were analyzed in the analytical batch on the dates indicated in the report.

Notes:

Sample Results

Report ID NY306042.0.35075

Client Goodyear Dunlop Tires NA, Ltd.

Sample ID	Location	Sample Results	Units	Data Qualifiers	Analyst	Vessel ID	Date
042-0606-1	Well B3 - Ground Water	Sampled 6/6/2013					
Metals							
EPA 200.7 Rev 4.4							
Field Grab							
Arsenic, Soluble		0.060	mg/L		RVF	252796	2013-06-14
Arsenic, Total		0.107	mg/L		RVF	252795	2013-06-14
Cadmium, Soluble		< 0.01	mg/L		RVF	252796	2013-06-14
Cadmium, Total		< 0.01	mg/L		RVF	252795	2013-06-14
Chromium, Soluble		< 0.01	mg/L		RVF	252796	2013-06-14
Chromium, Total		< 0.01	mg/L		RVF	252795	2013-06-14
Lead, Soluble		< 0.01	mg/L		RVF	252796	2013-06-14
Lead, Total		0.011	mg/L		RVF	252795	2013-06-14
Volatiles							
EPA 624							
Field Grab							
1,2-Dichloroethene (Total)		< 4	ug/L	A	RS	252793-252794	2013-06-08
trans-1,2-Dichloroethene		< 2	ug/L		RS	252793-252794	2013-06-08
1,1-Dichloroethane		< 2	ug/L		RS	252793-252794	2013-06-08
cis-1,2-Dichloroethene		< 2	ug/L		RS	252793-252794	2013-06-08
1,1,1-Trichloroethane		< 2	ug/L		RS	252793-252794	2013-06-08
Benzene		< 0.5	ug/L		RS	252793-252794	2013-06-08
EPA 8260C							
Field Grab							
2-Butanone (Methylethyl ketone)		< 10	ug/L		RS	252793-252794	2013-06-08
WetChem							
EPA 120.1 Rev 1982							
Field Grab							
Specific Conductance		1002	umhos/cm		RVF	252797	2013-06-07
EPA 420.1 Rev 1978							
Field Grab							
Phenols T. Rec.		< 0.005	mg/L		ME	252792	2013-06-17
SM 18-21 2130 B (01)							
Field Grab							
Turbidity		40.7	NTU		RVF	252797	2013-06-07
Time of Analysis: 9:00 am							

042-0606-2 Well B4 - Ground Water Sampled 6/6/2013

Sample ID	Location	Sample Results	Units	Data Qualifiers	Analyst	Vessel ID	Date
Metals							
EPA 200.7 Rev 4.4							
Field Grab							
Arsenic, Soluble		< 0.01	mg/L		RVF	252802	2013-06-14
Arsenic, Total		< 0.01	mg/L		RVF	252801	2013-06-14
Cadmium, Soluble		< 0.01	mg/L		RVF	252802	2013-06-14
Cadmium, Total		< 0.01	mg/L		RVF	252801	2013-06-14
Chromium, Soluble		< 0.01	mg/L		RVF	252802	2013-06-14
Chromium, Total		< 0.01	mg/L		RVF	252801	2013-06-14

Sample Results

Report ID NY306042.0.35075

Client Goodyear Dunlop Tires NA, Ltd.

Sample ID	Location							
Method	Analyte	Sample Results	Units	Data Qualifiers	Analyst	Vessel ID	Date	
042-0606-2	Well B4 - Ground Water Sampled 6/6/2013							
Metals								
EPA 200.7 Rev 4.4								
Field Grab								
	Lead, Soluble	< 0.01	mg/L		RVF	252802	2013-06-14	
	Lead, Total	< 0.01	mg/L		RVF	252801	2013-06-14	
Volatiles								
EPA 624								
Field Grab								
	1,2-Dichloroethene (Total)	< 4	ug/L	A	RS	252799-252800	2013-06-08	
	trans-1,2-Dichloroethene	< 2	ug/L		RS	252799-252800	2013-06-08	
	1,1-Dichloroethane	< 2	ug/L		RS	252799-252800	2013-06-08	
	cis-1,2-Dichloroethene	< 2	ug/L		RS	252799-252800	2013-06-08	
	1,1,1-Trichloroethane	< 2	ug/L		RS	252799-252800	2013-06-08	
	Benzene	< 0.5	ug/L		RS	252799-252800	2013-06-08	
EPA 8260C								
Field Grab								
	2-Butanone (Methylethyl ketone)	< 10	ug/L		RS	252799-252800	2013-06-08	
WetChem								
EPA 120.1 Rev 1982								
Field Grab								
	Specific Conductance	3170	umhos/cm		RVF	252803	2013-06-07	
EPA 420.1 Rev 1978								
Field Grab								
	Phenols T. Rec.	< 0.005	mg/L		ME	252798	2013-06-17	
SM 18-21 2130 B (01)								
Field Grab								
	Turbidity	12.8	NTU		RVF	252803	2013-06-07	
Time of Analysis: 9:00 am								
042-0606-3	Well C7 - Ground Water Sampled 6/6/2013							
Metals								
EPA 200.7 Rev 4.4								
Field Grab								
	Arsenic, Soluble	< 0.01	mg/L		RVF	252808	2013-06-14	
	Arsenic, Total	< 0.01	mg/L		RVF	252807	2013-06-14	
	Cadmium, Soluble	< 0.01	mg/L		RVF	252808	2013-06-14	
	Cadmium, Total	< 0.01	mg/L		RVF	252807	2013-06-14	
	Chromium, Soluble	< 0.01	mg/L		RVF	252808	2013-06-14	
	Chromium, Total	< 0.01	mg/L		RVF	252807	2013-06-14	
	Lead, Soluble	< 0.01	mg/L		RVF	252808	2013-06-14	
	Lead, Total	< 0.01	mg/L		RVF	252807	2013-06-14	
Volatiles								
EPA 624								
Field Grab								
	1,2-Dichloroethene (Total)	< 4	ug/L	A	RS	252805-252806	2013-06-08	

Sample Results

Report ID NY306042.0.35075

Sample ID Location Client Goodyear Dunlop Tires NA, Ltd.

Method Sample Results Units Data Qualifiers Analyst Vessel ID Date

042-0606-3 Well C7 - Ground Water Sampled 6/6/2013

Volatiles

EPA 624

Field Grab

trans-1,2-Dichloroethene < 2 ug/L RS 252805-252806 2013-06-08

1,1-Dichloroethane < 2 ug/L RS 252805-252806 2013-06-08

cis-1,2-Dichloroethene < 2 ug/L RS 252805-252806 2013-06-08

1,1,1-Trichloroethane < 2 ug/L RS 252805-252806 2013-06-08

Benzene < 0.5 ug/L RS 252805-252806 2013-06-08

EPA 8260C

Field Grab

2-Butanone (Methylethyl ketone) < 10 ug/L RS 252805-252806 2013-06-08

WetChem

EPA 120.1 Rev 1982

Field Grab

Specific Conductance 3760 umhos/cm RVF 252809 2013-06-07

EPA 420.1 Rev 1978

Field Grab

Phenols T. Rec. < 0.005 mg/L ME 252804 2013-06-17

SM 18-21 2130 B (01)

Field Grab

Turbidity 20.3 NTU RVF 252809 2013-06-07

Time of Analysis: 9:00 am

042-0606-4 Trip Blank - DI Water Sampled 6/6/2013

Volatiles

EPA 624

Trip Blank

1,2-Dichloroethene (Total) < 4 ug/L A RS 252818-252819 2013-06-08

trans-1,2-Dichloroethene < 2 ug/L RS 252818-252819 2013-06-08

1,1-Dichloroethane < 2 ug/L RS 252818-252819 2013-06-08

cis-1,2-Dichloroethene < 2 ug/L RS 252818-252819 2013-06-08

1,1,1-Trichloroethane < 2 ug/L RS 252818-252819 2013-06-08

Benzene < 0.5 ug/L RS 252818-252819 2013-06-08

EPA 8260C

Trip Blank

2-Butanone (Methylethyl ketone) < 10 ug/L RS 252818-252819 2013-06-08

Data Qualifiers and Definitions:

A Analyte is NOT covered by New York State NELAP Certification.

Sample Results

Report ID NY306042.0.35075

Sample ID

Location

Client Goodyear Dunlop Tires NA, Ltd.

Method

Analyte

Sample Results Units

Data Qualifiers Analyst

Vessel ID

Date

General Disclaimer

- The test results are submitted pursuant to IsleChem LLC's current terms and conditions of sale, including the company's standard warranty and limitation of liability provisions. No responsibility or liability is assumed for the manner in which the results are used or interpreted.
- This report is issued for the benefit of and may be relied upon by the client named above. The client bears full responsibility for deciding the level of testing for sample submitted to IsleChem LLC.
- These results pertain only to the items tested.
- This report shall not be reproduced except in full.
- If the sample(s) represented by these test results were not collected by IsleChem LLC then the test results are limited to the reported values determine by the analytical testing process. IsleChem LLC makes no representation regarding the sample's collection technique, condition, volume, homogeneity or any other aspect of the sample(s) prior to IsleChem LLC taking possession of the sample(s) and the influence it may have on the results.
- Unless notified in writing to return the samples covered by this report IsleChem LLC will store what remains of the sample(s), if anything, for a period of thirty (30) days, sixty (60) days for asbestos samples, before discarding, unless otherwise required by law. A shipping and handling fee with be charged for the return of any sample(s).
- Certain analytes may not be covered by the NYS DOH or NELAP fields of accreditation. Results for those analytes are generated by the cited method using QA/QC guidelines from IsleChem's Quality Control Manual, where applicable.

The test results in this report meet all NELAP requirements for parameters that are within IsleChem's field of accreditation. Any exceptions to NELAP requirements are noted in the comments field.

All results for solid samples are reported on a dry weight basis unless otherwise noted.

Visit us on the web at www.islechem.com

Groundwater Monitoring Information Sheet

Site Name: Dunlop/Goodyear
Date: 06/05-06/13

Monitoring Well ID B-3

Sampling Date 06/06/13

Well Structure Data

Evacuation Date: 06/05/13

Water Elevation: _____

Top of Inner Casing Elevation: _____

Bottom of Well: 17.2'

Monitoring Well Diameter: 2"

Volume of Standing Water $11.5 \times 1.63 \times 3 = 5.6$ gallons

Water Level: 5.7'

Volume of Excavated Water 6 gallons

Appearance/Observations orange cloudy water lessened toward bottom
5.7 = 100% recharge

Well Field Parameter Data

pH - Standard Units 6.59

Specific Conductance (umhos/cm) _____

Temperature - deg F 54

Turbidity (ntu) _____

Misc. Well Information

Was Well Locked? Yes No

Physical Condition of Well Good Fair Poor

Was Well I.D. Easily Visible? Yes No

Solids Content None Medium High

Weather on Sampling Day rain

Purging Method Manual Bailer

[Signature]
Field Technician Signature

06/06/13
Date

Groundwater Monitoring Information Sheet

Site Name: Dunlop / Goodyear
Date: 06/06/13

Monitoring Well ID: B4
Sampling Date: 06/06/13

Well Structure Data

Evacuation Date: 06/06/13 Water Elevation: _____
Top of Inner Casing Elevation: _____ Bottom of Well: 32.4

Monitoring Well Diameter: 2" Volume of Standing Water $16 \times .163 \times 3 = 7.82$ gallons

Water Level: 4.4 Volume of Excavated Water 7.5 gallons

Appearance/Observations: clear water 18.1' = 26%

Well Field Parameter Data

pH - Standard Units 7.06 Specific Conductance (umhos/cm) _____

Temperature - deg F 55 Turbidity (ntu) _____

Misc. Well Information

Was Well Locked? Yes No
Was Well I.D. Easily Visible? Yes No
Weather on Sampling Day rain
Physical Condition of Well Good Fair Poor
Solids Content None Medium High
Purging Method Manual Dewater

[Signature] 06/06/13
Field Technician Signature Date

Groundwater Monitoring Information Sheet

Site Name: Dunlop / Coodys
Date: 06/05 - 06/13

Monitoring Well ID: CT
Sampling Date: _____

Well Structure Data

Evacuation Date: 06/05/13

Water Elevation: _____

Top of Inner Casing Elevation: _____

Bottom of Well: 23.4'

Monitoring Well Diameter: 2"

Volume of Standing Water 16.7 x .163 x 3 = 8.16 gallons

Water Level: 6.7'

Volume of Excavated Water 7.5 gallons

Appearance/Observations: Clear

16.2' = 43% permeable

Well Field Parameter Data

pH - Standard Units 7.29

Specific Conductance (umhos/cm) _____

Temperature - deg F 54

Turbidity (ntu) _____

Misc. Well Information

Was Well Locked? Yes No

Physical Condition of Well Good Fair Poor

Was Well I.D. Easily Visible? Yes No

Solids Content None Medium High

Weather on Sampling Day rain

Purging Method manual bailer

Peter J. Coodys
Field Technician Signature

06/06/13
Date

CHAIN OF CUSTODY / REQUEST FOR LABORATORY ANALYSIS

2801 Long Road, Grand Island, NY 14072 (716)773-8401 (716)773-8517 (Fax)

Page 1 of 3

Goodyear Dunlop Tires NA, Ltd.		Well Sampling					1 Samples / 6 Bottles									
Organization Name		Project Name					# of Samples / # of Bottles									
PO Box 1109		PO Line 40					10-14 Days									
Street Address		Client PO / Release #					Turnaround Time/ Date Results Needed									
Buffalo, NY 14240		Date Sampled					NI 306042.0 35075									
City, State, Zip		IsleChem Project #					Rush Work Performed at Priority Rate (see below)									
Mark Craft		E-mailed reporting upon request please provide e-mail below: mcraft@gdtna.com					Approved by Client Yes No Initials _____									
Contact Person							Approved by Lab Yes No Initials _____									
Phone# / Fax#		E-mail					Bottle Type / Preservative									
Sample ID	Sample Location	Matrix	Comp	Grab	Total Rec. Phenols (787)	2-Butanone (MEK) (Group list below)	Benzene (Group list below)	1,1-Dichloroethane, 1,2-Dichloroethane & 1,1,1-Trichloroethane (Group list below)	Arsenic & Lead (Group list below)	Cadmium (Group list below)	Chromium (Group list below)	Soluble Metals * (2173)	Specific Conductance (789)	Turbidity * (1012)	Red Flag Limits	Bottle Type / Preservative
252792	Well B3	GW		X	X										1.0 ug/L	500 ml Amber Glass (H2SO4)
252793 252794	Well B3	GW		X		X									50 ug/L	(2) 40 ml VOA Vials (HCL)
	Well B3	GW		X			X								0.7 ug/L	
	Well B3	GW		X				X							5.0 ug/L	
252795	Well B3	GW		X					X						25 ug/L	500 ml Poly (HNO3)
	Well B3	GW		X						X					10 ug/L	
	Well B3	GW		X							X				50 ug/L	
252796	Well B3	GW		X								X				500 ml Poly (None) - Filter when received.
252797	Well B3	GW		X									X	X		250 ml Poly (None)

Comments: * Analyze soluble metals only if turbidity is >50 same list as total metals ** Metals: Arsenic, Lead, Cadmium & Chromium (2174)
 ** Volatiles List: MEK, Benzene, 1,1-dichloroethane, 1,2-dichloroethane and 1,1,1-trichloroethane (2175)

Sampled By: <i>[Signature]</i>	Date: 06/06/13	Time: 1:15	Received by:	Date:	Time:	Received by:	Date:	Time:
Relinquished by: <i>[Signature]</i>	Date: 06/06/13	Time: 12:28	Relinquished by:	Date:	Time:	Received by lab: <i>[Signature]</i>	Date: 6/6/13	Time: 1:10

Standard turnaround time is 10 days.
RUSH WORK CHARGES: 3-6 times the standard cost for same day depending on the time needed ~ 2.5 times the standard cost for next day ~ 1.75 times the standard cost for 3 day.
 By relinquishing these samples to IsleChem, LLC, you are accepting the current IsleChem, LLC terms and conditions for the sale of services.

CHAIN OF CUSTODY / REQUEST FOR LABORATORY ANALYSIS

2801 Long Road, Grand Island, NY 14072 (716)773-8401 (716)773-8517 (Fax)

Page 2 of 3

Goodyear Dunlop Tires NA, Ltd. <small>Organization Name</small>		Well Sampling <small>Project Name</small>					1 Samples / 6 Bottles <small># of Samples / # of Bottles</small>																								
PO Box 1109 <small>Street Address</small>		PO Line 40 <small>Client PO / Release #</small>					10-14 Days <small>Turnaround Time/ Date Results Needed</small>																								
Buffalo, NY 14240 <small>City, State, Zip</small>		06/06/13 <small>Date Sampled</small>					N.Y. 306042.0.35075 <small>IsleChem Project #</small>																								
Mark Craft <small>Contact Person</small>		E-mail <u>mcraft@gdtna.com</u>		Total Rec. Phenols (787)		2-Butanone (MEK) (Group list below)		Benzene (Group list below)		1,1-Dichloroethane, 1,2-Dichloroethane & 1,1,1-Trichloroethane (Group list below)		Arsenic & Lead (Group list below)		Cadmium (Group list below)		Chromium (Group list below)		Chromium (Group list below)		Soluble Metals * (2173)		Specific Conductance (789)		Turbidity * (1012)		Red Flag Limits		Rush Work Performed at Priority Rate (see below)			
879-8497 / 879-8400 <small>Phone# / Fax#</small>																												mailed reporting upon request please provide e-mail below:		Approved by Client	
<small>Sample ID</small>		<small>Sample Location</small>		<small>Matrix</small>		<small>Comp</small>		<small>Grab</small>		<small>500 ml Amber Glass (H2SO4)</small>		<small>500 ml Poly (HNO3)</small>		<small>500 ml Poly (None) - Filter when received.</small>		<small>250 ml Poly (None)</small>															
252798		Well B4		GW				X		X								1.0 ug/L		500 ml Amber Glass (H2SO4)											
252799 252800		Well B4		GW				X		X								50 ug/L		(2) 40 ml VOA Vials (HCL)											
		Well B4		GW				X		X								0.7 ug/L													
		Well B4		GW				X		X								5.0 ug/L													
252801		Well B4		GW				X		X								25 ug/L		500 ml Poly (HNO3)											
		Well B4		GW				X		X								10 ug/L													
		Well B4		GW				X		X								50 ug/L													
252802		Well B4		GW				X		X								X		500 ml Poly (None) - Filter when received.											
252803		Well B4		GW				X		X								X		X		250 ml Poly (None)									

Comments: * Analyze soluble metals only if turbidity is >50 same list as total metals ** Metals: Arsenic, Lead, Cadmium & Chromium (2174)
 ** Volatiles List: MEK, Benzene, 1,1-dichloroethane, 1,2-dichloroethane and 1,1,1-trichloroethane (2175)

Sampled By: <i>Patrick Neely</i>		Date: 06/06/13	Time: 1115	Received by:		Date:	Time:	Received by:		Date:	Time:
Relinquished by: <i>Patrick Neely</i>		Date: 06/06/13	Time: 1232	Relinquished by:		Date:	Time:	Received by lab: <i>[Signature]</i>		Date: 6/6/13	Time: 1:10p

Standard turnaround time is 10 days.
RUSH WORK CHARGES: 3-6 times the standard cost for same day depending on the time needed ~ 2.5 times the standard cost for next day ~ 1.75 times the standard cost for 3 day.
 By relinquishing these samples to IsleChem, LLC, you are accepting the current IsleChem, LLC terms and conditions for the sale of services.

CHAIN OF CUSTODY / REQUEST FOR LABORATORY ANALYSIS

2801 Long Road, Grand Island, NY 14072 (716)773-8401 (716)773-8517 (Fax)

3.030
Page 1 of 2

Goodyear Dunlop Tires NA, Ltd. Organization Name		Well Sampling Project Name					1 Samples / 6 Bottles # of Samples / # of Bottles									
PO Box 1109 Street Address		PO Line 40 Client PO / Release #					10-14 Days Turnaround Time/ Date Results Needed									
Buffalo, NY 14240 City, State, Zip		Date Sampled <i>06/06/13</i>					isleChem Project # <i>NY.306042.0.35075</i>									
Mark Craft Contact Person		E-mailed reporting upon request please provide e-mail below: mcraft@gdtna.com					Rush Work Performed at Priority Rate (see below) Approved by Client Yes No Initials _____ Approved by Lab Yes No Initials _____									
879-8497 / 879-8400 Phone# / Fax#																
Sample ID	Sample Location	Matrix	Comp	Grab	Total Rec. Phenols (787)	2-Butanone (MEK) (Group list below)	Benzene (Group list below)	1,1-Dichloroethane, 1,2-Dichloroethane & 1,1,1-Trichloroethane (Group list below)	Arsenic & Lead (Group list below)	Cadmium (Group list below)	Chromium (Group list below)	Soluble Metals * (2173) (Group list below)	Specific Conductance (789)	Turbidity * (1012)	Red Flag Limits	Bottle Type / Preservative
252804	Well C7	GW		X	X										1.0 ug/L	500 ml Amber Glass (H2SO4)
252805 252806	Well C7	GW		X		X									50 ug/L	(2) 40 ml VOA Vials (HCL)
	Well C7	GW		X			X								0.7 ug/L	
	Well C7	GW		X				X							5.0 ug/L	
252807	Well C7	GW		X					X						25 ug/L	500 ml Poly (HNO3)
	Well C7	GW		X						X					10 ug/L	
252808	Well C7	GW		X							X				50 ug/L	
252809	Well C7	GW		X								X	X			500 ml Poly (None) - Filter when received.
	Well C7	GW		X												250 ml Poly (None)
	Trip Blanks					252818										252819

Comments: * Analyze soluble metals only if turbidity is >50 same list as total metals ** Metals: Arsenic, Lead, Cadmium & Chromium (2174)

** Volatiles List: MEK, Benzene, 1,1-dichloroethane, 1,2-dichloroethane and 1,1,1-trichloroethane (2175)

Sampled By: <i>Robert Nagels</i>	Date: <i>06/06/13</i>	Time: <i>1115</i>	Received by:	Date:	Time:	Received by:	Date:	Time:
Relinquished by: <i>Robert Nagels</i>	Date: <i>06/06/13</i>	Time: <i>1230</i>	Relinquished by:	Date:	Time:	Received by lab: <i>[Signature]</i>	Date: <i>6/6/13</i>	Time: <i>1:10p</i>

Standard turnaround time is 10 days.
RUSH WORK CHARGES: 3-6 times the standard cost for same day depending on the time needed - 2.5 times the standard cost for next day - 1.75 times the standard cost for 3 day.
 By relinquishing these samples to IsleChem, LLC, you are accepting the current IsleChem, LLC terms and conditions for the sale of services.



Client Name: Goodyear

IsleChem, LLC Job Number: N.Y. 306092

Sample(s) received by: [Signature] Date: 6/6/13 Time: 1:10 p

Is the chain of custody identified clearly with complete documentation including:

Sample location/Identification	<u>YES</u>	NO	N/A	Corrected
Sample date	<u>YES</u>	NO	N/A	Corrected
Sample time	<u>YES</u>	NO	N/A	Corrected
Client name	<u>YES</u>	NO	N/A	Corrected
Preservation type	<u>YES</u>	NO	N/A	Corrected
Required analysis is listed on each bottle	<u>YES</u>	NO	N/A	Corrected
Are the sample labels clear and do they provide a unique identification of the sample linked to COC?	<u>YES</u>	NO	N/A	Corrected
Are the sample containers appropriate?	<u>YES</u>	NO	N/A	Corrected
Is the sample date within the required hold times?	<u>YES</u>	NO	N/A	Corrected
Is there adequate volume available for requested analysis?	<u>YES</u>	NO	N/A	Corrected
Did the customer list what sample analysis is required?	<u>YES</u>	NO	N/A	Corrected
Is a chain of custody included?	<u>YES</u>	NO	N/A	Corrected
Is the chain of custody complete?	<u>YES</u>	NO	N/A	Corrected
Are the sample(s) free of apparent damage?	<u>YES</u>	NO	N/A	Corrected
Temperature <u>8°C</u> Has cooling begun?	<u>YES</u>	NO	N/A	-
Is temperature 6° C or less if sample(s) were held prior to delivery date?	YES	NO	<u>N/A</u>	-
Are samples appropriately preserved if necessary?	<u>YES</u>	NO	N/A	Corrected
VOA sample vials do not have headspace or visible "pea-sized" air bubbles > (1/4") in diameter.	YES	NO	<u>N/A</u>	Corrected
If necessary, lab management has been notified of any short hold or quick TAT samples.	<u>YES</u>	NO	<u>N/A</u>	Corrected

Comments/Actions: _____

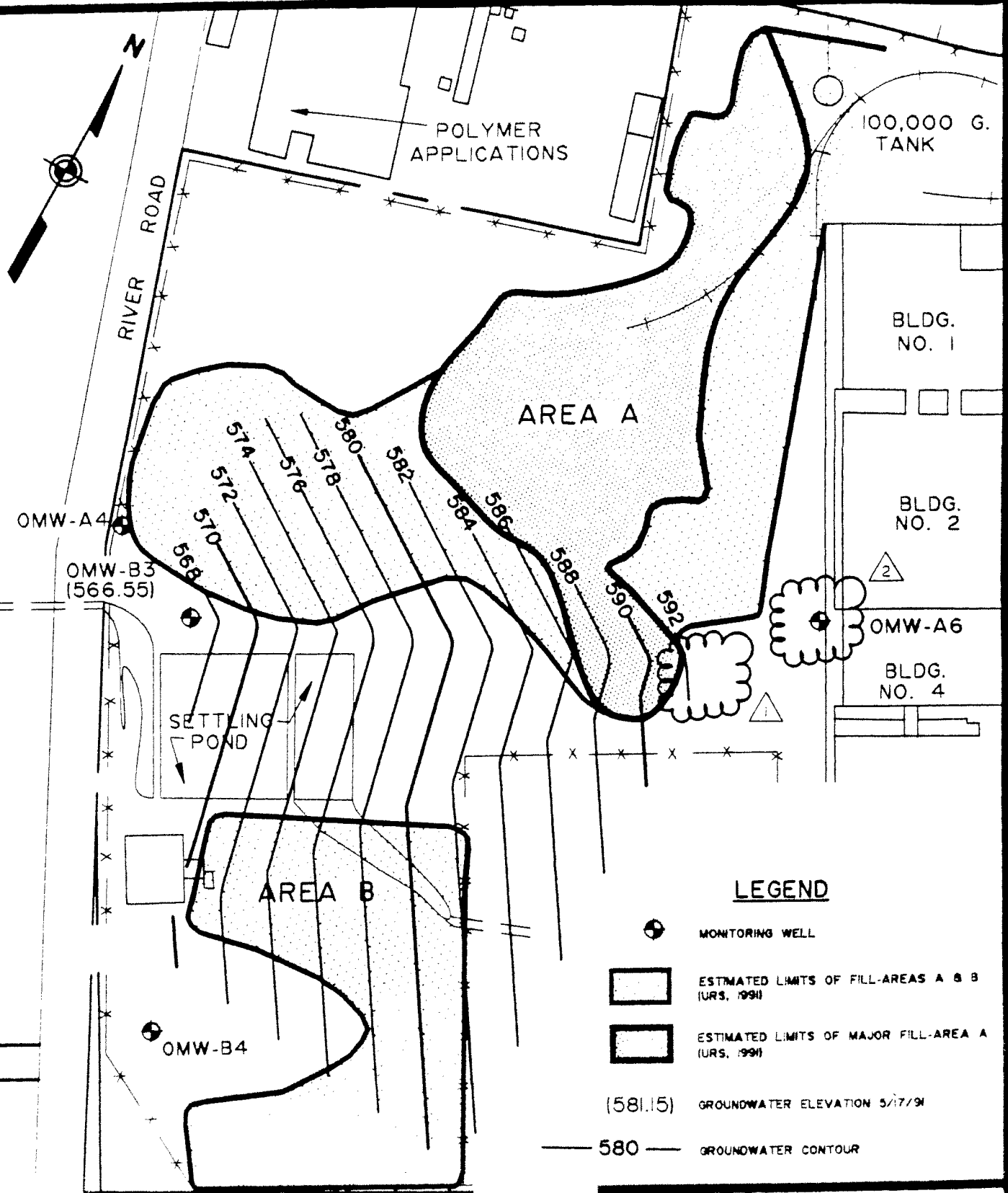

NO	DATE	DESCRIPTION
1	7-24-94	FIELD OMW A6
2	9-24-94	FIELD OMW A6

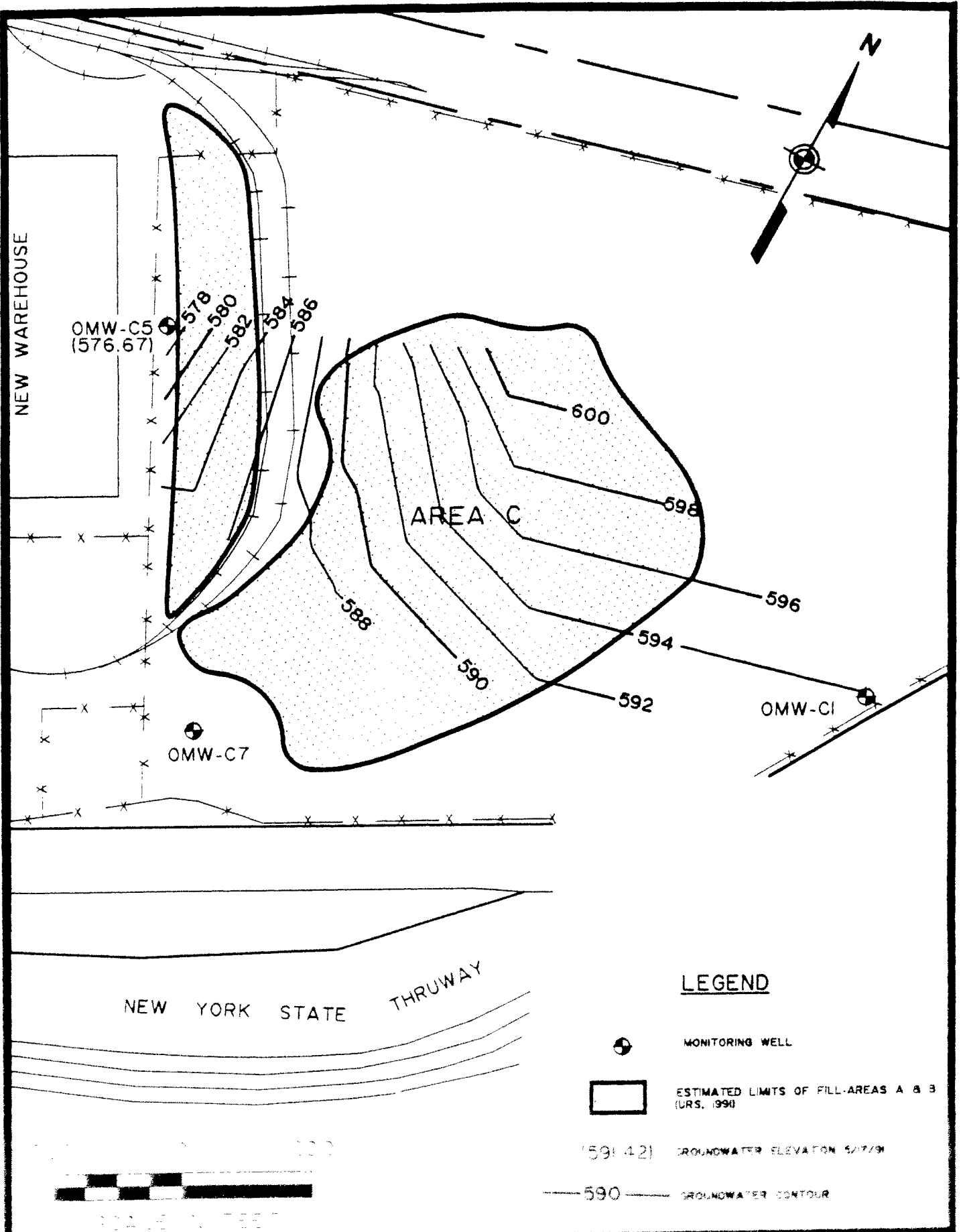

LEGEND



MONITORING WELL



ESTIMATED LIMITS OF FILL-AREAS A & B (URS, 1991)

(591.42)

GROUNDWATER ELEVATION 5/17/91

590

GROUNDWATER CONTOUR

URS

CONSULTANTS, INC.

LONG TERM MONITORING WELL LOCATIONS
AREA C

FIGURE 3

**TABLE 1
SAMPLING SCHEDULE
DUNLOP TIRE CORPORATION
LONG TERM MONITORING PLAN
INACTIVE WASTE SITES 915018 A, B AND C**

Year	Analytical Schedule	Number of Sampling Events Per Year							Sampling Season
		Upgradient		Downgradient					
		A6	C1	B3	B4	A4	C5	C7	
1	A	2	2	2	2	2	2	2	Spring/Fall
2,3	B			2	2	2	2	2	Spring/Fall
4,5	B			2	2	2	2	2	Spring/Fall
6-9	B			1	1	1	1	1	Spring
10	B			1	1			1	Spring
11-14	B			1	1	1	1	1	Spring
15	B			1	1			1	Spring
16-19	B			1	1	1	1	1	Spring
20	B			1	1			1	Spring
21-24	B			1	1	1	1	1	Spring
25	B			1	1			1	Spring
26-29	B			1	1	1	1	1	Spring
30	B			1	1	1	1	1	Spring

Start 1997
12 years = 1995

Year 9
2003

Year 10
2004

Analytical Schedules

- A - TCL Volatiles, TCL Semivolatiles, TAL Metals.
- B - Volatiles: 2 Butanone (MEK), Benzene, 1,1 Dichloroethane, 1,2 Dichloroethene (total), 1,1,1 trichloroethane. Other compounds if detected at or above levels of concern in year 1 sampling.
- Semi Volatiles: Total Phenols. Other compounds if detected at or above levels of concern in year 1 sampling.
- Metals: Arsenic, Cadmium, Chromium, Lead. Other analytes if detected at or above levels of concern in year 1 sampling.

TABLE 3
LONG TERM MONITORING PLAN
INACTIVE WASTE SITES 915018 A, B AND C
DUNLOP TIRE CORPORATION
GROUNDWATER ACTION LEVELS FOR DOWNGRAIDENT WELLS

PARAMETER	TYPE	ARAR ¹ VALUE (ppb)	OMW-B3 (ppb)	OMW-B4 ² (ppb)	OMW-C5 (ppb)	OMW-C7 (ppb)
2-Butanone (MEK)	VOC	50	50	50	50	50
Benzene	VOC	0.7	0.7	2	0.7	0.7
1,1-Dichloroethane	VOC	5	5	5	5	5
1,2-Dichloroethene (Total)	VOC	5	5	5	5	5
1,1,1-Trichloroethane	VOC	5	5	5	5	5
Arsenic	<i>MET</i>	25	25	25	25	25
Cadmium	<i>MET</i>	10	10	28	16	10
Chromium	<i>MET</i>	50	50	178	66	50
Lead	<i>MET</i>	25	32	52	50	25
Total Phenols	SEMI	1	1	1	1	1

VOC -- Volatile Organic Compounds

MET -- Metals

SEMI -- Semivolatile Organic Compound

¹ NYSDEC Ambient Water Quality Standards and Guidance values, November 1991

² Determined using existing data from OMW-B2

**GOODYEAR DUNLOP TIRES, NORTH AMERICA LTD.
LANDFILL CONDITION - SEMI-ANNUAL INSPECTION REPORT**

File 7.4

Site No.: 915018 A, B & C

Name of Inspector: Tim Bathory

Date of Inspection: 4/18/13

	Topsoil Erosion Occurring?	Clay Cap Erosion Occurring?	Ditches Free of Obstruction?	Grass Cover Adequate?	Paved Areas Intact?	Note Any Damage.
AREA "B"						
Southern Area	N	N	Y	Y		NA
Northern Area						
River Road Ditch						
BORROW PIT						
AREA "A"						
Central Area						
Northeast Area						
AREA "C"						
Outlying Area						
Major Area						
Ditch at Toe of Slope						
Sheridan Drive Ditch						
Stockpile Area						
Warehouse Ditch	N	N	N	N		
Paved Areas						
Parking Lot						
Driveway						

Bare patch where lawnmower burned
NA

WEATHER CONDITIONS:

Temperature 64°

Wind Direction _____

Wind Speed _____

Precipitation Amount 0"

Sky Conditions clear

Inches of Snow Cover 0"

Describe Any Corrective Action Required:

- Add fill/plant seed where lawnmower burned

Describe Any Corrective Action Taken:

Called landscaper to setup.

**GOODYEAR DUNLOP TIRES, NORTH AMERICA LTD.
LANDFILL CONDITION - SEMI-ANNUAL INSPECTION REPORT**

File 7.4

Site No.: 915018 A, B & C

Name of Inspector: Tim Bathory

Date of Inspection: 10/4/12

	Topsoil Erosion Occurring?	Clay Cap Erosion Occurring?	Ditches Free of Obstruction?	Grass Cover Adequate?	Paved Areas Intact?	Note Any Damage.
AREA "B"						
Southern Area	<u>N</u>	<u>N</u>	<u>Y</u>	<u>Y (minor dead spots)</u>	<u>NA</u>	<u>NA</u>
Northern Area	<u>N</u>	<u>N</u>	<u>Y</u>	<u>Y</u>	<u>NA</u>	<u>NA</u>
River Road Ditch	<u>N</u>	<u>N</u>	<u>Y</u>	<u>Y</u>	<u>NA</u>	<u>NA</u>
BORROW PIT						
AREA "A"						
Central Area	<u>N</u>	<u>N</u>	<u>Y</u>	<u>Y</u>	<u>NA</u>	<u>NA</u>
Northeast Area	<u>N</u>	<u>N</u>	<u>Y</u>	<u>Y</u>	<u>NA</u>	<u>NA</u>
AREA "C"						
Outlying Area	<u>N</u>	<u>N</u>	<u>Y</u>	<u>Y</u>	<u>NA</u>	<u>NA</u>
Major Area	<u>N</u>	<u>N</u>	<u>Y</u>	<u>Y</u>	<u>NA</u>	<u>bare patch where lawnmower burned</u>
Ditch at Toe of Slope	<u>N</u>	<u>N</u>	<u>Y</u>	<u>Y</u>	<u>NA</u>	<u>NA</u>
Sheridan Drive Ditch	<u>N</u>	<u>N</u>	<u>Y</u>	<u>Y</u>	<u>NA</u>	<u>NA</u>
Stockpile Area	<u>N</u>	<u>N</u>	<u>Y</u>	<u>Y</u>	<u>NA</u>	<u>NA</u>
Warehouse Ditch	<u>N</u>	<u>N</u>	<u>Y</u>	<u>Y</u>	<u>NA</u>	<u>NA</u>
Paved Areas						
Parking Lot	<u>Y</u>	<u>Y</u>	<u>Y</u>	<u>Y</u>	<u>Y</u>	<u>NA</u>
Driveway	<u>Y</u>	<u>Y</u>	<u>Y</u>	<u>Y</u>	<u>Y</u>	<u>NA</u>

WEATHER CONDITIONS:

Temperature -68°F
 Wind Direction to the East
 Wind Speed 10-15mph
 Precipitation Amount 0"
 Sky Conditions partly cloudy
 Inches of Snow Cover 0"

Describe Any Corrective Action Required:

- Plant grass seed where mower burned.

Describe Any Corrective Action Taken:

- Landscaper filled divots + planted seed (from fire trucks) (divots)