

Larry Clark



County of Erie

EDWARD J. RUTKOWSKI
COUNTY EXECUTIVE

DEPARTMENT OF ENVIRONMENT AND PLANNING

JOAN E. LORING
COMMISSIONER

April 3, 1985

ANTHONY T. VOELL
DEPUTY COMMISSIONER
ENVIRONMENTAL CONTROL

Mr. Peter Buechi
N.Y.S. Department of
Environmental Conservation
Region 9
600 Delaware Avenue
Buffalo, New York 14202

Re: Erie County DEP Hazardous
Waste Site Profile Report,
Whiting Roll-Up Door

Dear Mr. Buechi:

Attached is a copy of a draft report on the above subject site for your review and comment. If no comments are received by April 26, 1985, we will assume you are in general agreement with the information and conclusions presented.

Should you want to discuss this material, please do not hesitate to contact us (846-6339).

Very truly yours,

ANTHONY T. VOELL, P.E.
Deputy Commissioner

ATV:rb
Attachment

DRAFT

**HAZARDOUS WASTE SITE
PROFILE REPORT FOR
WHITING ROLL-UP DOOR MFG. CORP.
113 CEDAR ST.
AKRON, NEW YORK 14001
SITE #915081**

Prepared by
Erie County DEP
March 1985
Melvin H. Szymanski
Principal Environmental Quality Tech.

ADVISORY NOTE

The information contained in this document is presented to show environmental conditions, comparisons to ambient environmental standards and criteria and compliance status relative to applicable environmental regulations.

Any use of this information to assess the risks to personal or public health, identify potential personal or public liability or to estimate the costs of remedial activity should only be done after consultation with appropriate government agencies or private consultants.

Whiting Roll-up Door Mfg. Co.
113 Cedar St.
Akron, New York 14001
Site #915081

(1984)?

Volume III of Hazardous Waste Sites in New York State, prepared by DEC, lists this site as a disposal area for construction and demolition materials and that no hazardous waste had been identified on this site.

This report was prepared for the NYSDEC in accordance with the State/County Agreement.

Location

The site ^{is} was located at 113 Cedar St., Akron, New York, on the north boundry of the Village line.

Aerial Photography

Aerial photography for 1951 (Section 4H-194) and 1960 (Section 268-1059) showed no evidence of any landfill operation near the plant. However, the 1972 photo (Section 30-80) indicated a small disturbed area immediately east of the building complex. The area was noted to be about 75' X 100' in size.

Background

A review of DEP files revealed that DEC & DEP became aware of this disposal site in August of 1977. In October of 1977, A DEP inspector found wood, metal scrap, paper & drums containing paint solids at the disposal site.

In January of 1978 DEP received an application for a landfill permit from Whiting Roll-up Door. This application was forwarded to DEC immediately. There is no record of any action or correspondence in the DEP files regarding this application until late 1979 when DEC requested more information. In November of 1979 Whiting withdrew their request for a landfill permit.

In February 1980, during a DEC air permit compliance inspection, the DEC inspector again noted that "paint solids, metal & rubbish" were being disposed at the site.

In March of 1980, DEP requested that Whiting remove all material at the site by May 9, 1980, indicating that a legal referral would be recommended if the company did not comply. Disposition and follow-up of this request is unknown. DEC files have no records for Whiting Roll-up Door Co., Inc. as per a March 27, 1985 inquiry.

Environmental Data

Soil - The Soil in the area is listed as silty & Clayey with a pH less than 6.5. It is 30% to 50% sand with slow to moderate permability.

Bedrock - Fissile shale bedrock is located at depths greater than 4 feet.

Water - The natural water table is perched at 2 to 4 feet below the surface. There is a minimal potential of polluting the regional internal water table. The residential area adjacent to the site is served by a municipal water supply. Surface water would flow to a drainage ditch to the east of the site and eventually find its way to Murder Creek.

Flooding and Wetlands - The site has a minimal flooding potential. There are designated wetland areas about 1000 feet to the north and west of the site.

Field Inspection

On February 22, 1985 DEP, accompanied by Mr. Lauren Whiting, co-owner of company, a site inspection was conducted. Mr. Whiting informed DEP that all the material from the disposal site, including the drums of paint solids had been removed and sent off-site for disposal. Mr. Whiting did not remember where the material went.

Since spring of 1980, the company has expanded. The area of the former disposal site is now partially covered by a storage building. The rest of the area has been blacktopped. There is no visible evidence of any disposal area near the plant.

Sampling - There are no records that indicate any groundwater, surface water or soil samples had ever been taken.

Conclusion

The disposal site is no longer visible since construction of the storage building and blacktop coverage of area. The disposed of material has apparently been removed prior to construction. The site "as is now" does not appear to be a threat to the environment.

Recommendation

It is recommended that the site be removed from the hazardous waste site list, and that no further action be taken.

MHS:mmc
4/2/85

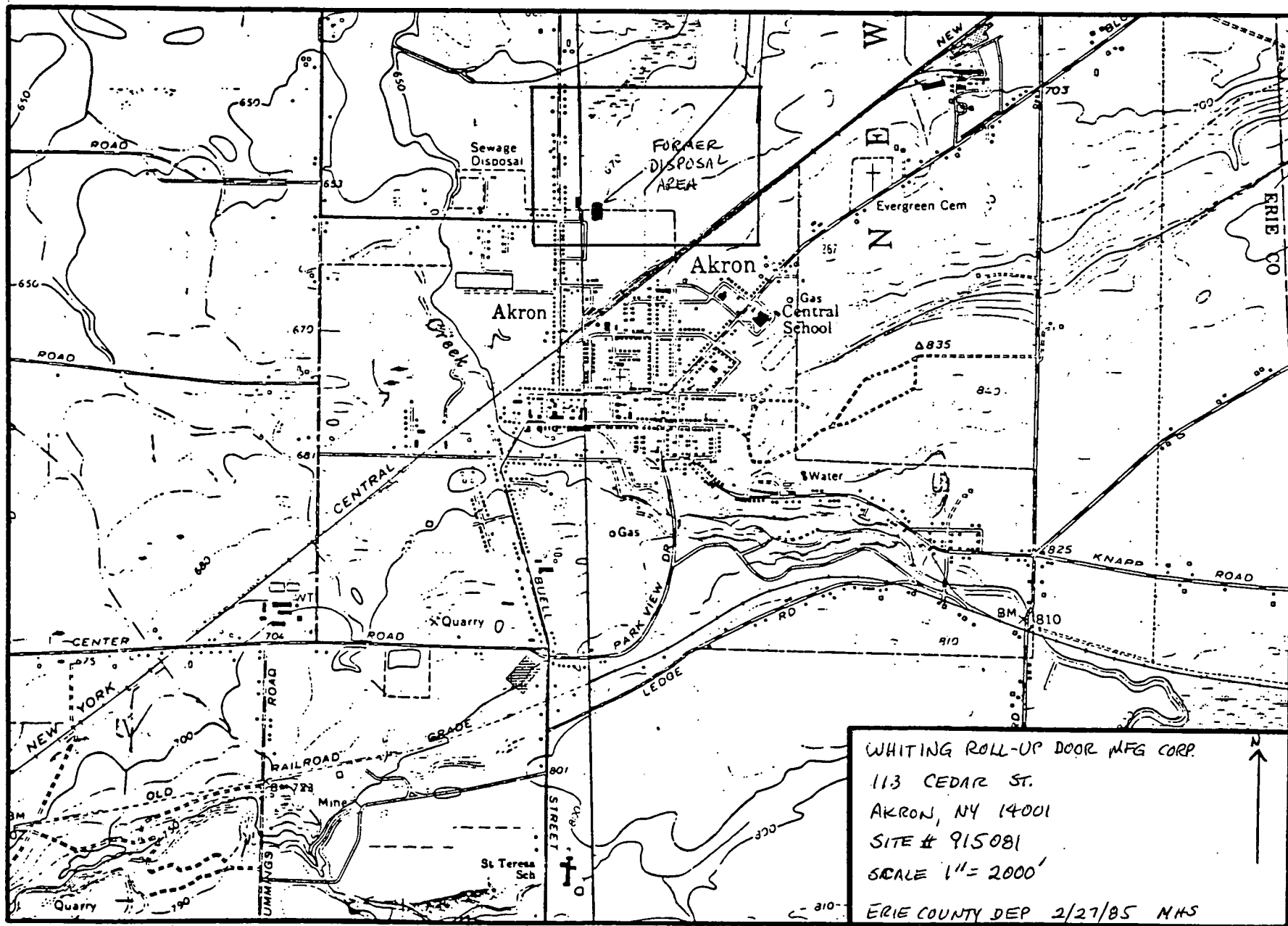

LITTLE LEAGUE
BASEBALL
FIELD

CEGAR ST.

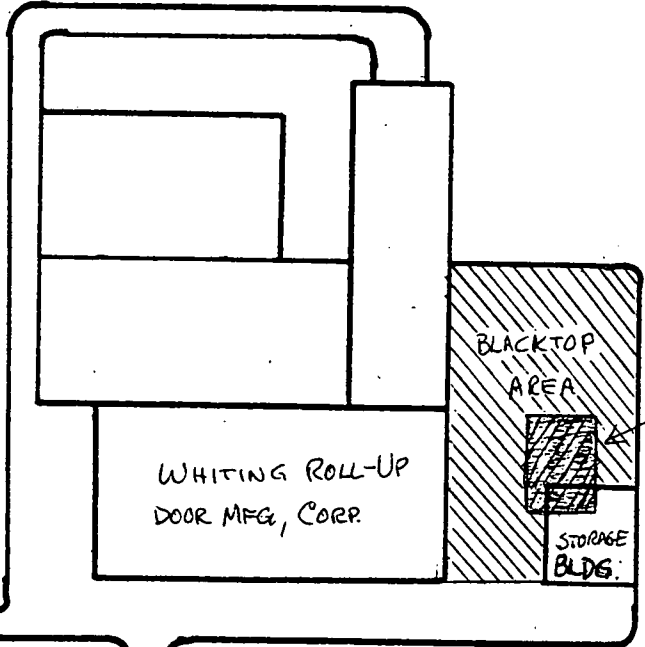

FORMER
DISPOSAL
AREA

DRAINAGE DITCH

LEWIS ST.

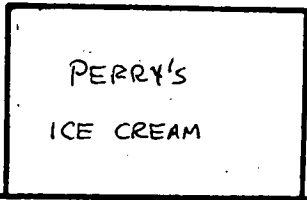

PERRY'S
ICE CREAM

WHITING ROLL-UP DOOR
113 CEDAR ST
AKRON, NY 14001
SITE # 915081
SCALE 1" = 200'
ERIE COUNTY DEP 2/27/85 MHS



REFERENCES

A. MAPS PREPARED BY URS ENGINEERS JANUARY 1980

719 - 1A - 0	Slope Soil Interpretation
719 - 2A - 0	Soil Permeability Interpretation
719 - 3A - 0	Depth of Bedrock
719 - 4A - 0	Potential For Overland - Near Surface Flow To Nearby Drainage Ways
719 - 5A - 0	Depth of Natural Water Tables
719 - 6A - 0	Soil Slumping & Flooding Potentials
719 - 7A - 0	Potential of Polluting Regional Internal Watertable
719 - 8A - 0	Subsoil Reaction Map
719 - 9A - 0	Bedrock Formation
719 - 10A - 0	Soil Texture - Soil Structure

DATA SOURCES FOR ABOVE LISTED MAPS

- (1) General Soil Map and Interpretation, Erie County, 1979. USDA
Soil Conservation Service And Cornell University Agricultural
Experiment Station.
- (2) Unpublished Soil Survey Field Sheets, Erie County, N. Y.
National Co-operative Soil Survey
- (3) Geology Of Erie County, E. T. Buehler, I. H. Tesmer,
Buffalo Society of Natural Sciences Bulletin, Vol. 21 # 3.

B. FLOOD PLAINS - NATIONAL FLOOD INSURANCE PROGRAM MAPS APR. 30, 1983

C. WETLANDS - NYS/DEC MAPS WETLAND INVENTORY PREPARED BY ECDEP PLANING DIVISION MAY 1981. UPDATED NOV. 1984.

D. AERIAL PHOTOGRAPHY

- 1951 - U. S. Dept. Of Agriculture, Production & Marketing
Administration (Robinson Aerial Surveys, Flying Completed Oct. 18, 1951)
- 1960 - Erie County Planning Board (American Air Surveys Inc.,
Flights on April 28, 1960 and May 2, 1960)
- 1972 - Erie County (Aero Service, Houston, Tex, Flights in Spring
and Fall of 1972).

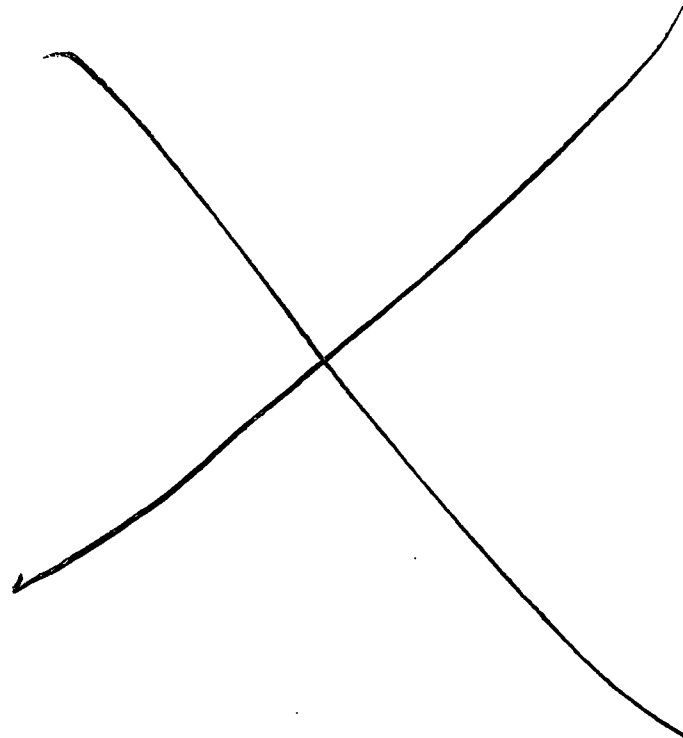

RECEIVED

APR 10 1985

N.Y.S.D.E.C.