

EMPIRE **GEO** SERVICES, INC.

A SUBSIDIARY OF SJB SERVICES, INC.

December 21, 2009
Empire Project No. BEV-06-013

New York State Department of Environmental Conservation
Region 9 Office
270 Michigan Avenue
Buffalo, New York 14203

Attention: Mr. Gene Melnyk

**Reference: Summary of Asbestos Abatement Field Oversight
And Air Sampling
Bengart & Memel Site
1079 Clinton Street, Buffalo, New York
NYSDEC Site Number 915115**

Dear Mr. Melnyk,

This brief report summarizes asbestos abatement field monitoring recently completed by Empire GeoServices, Inc. (Empire) at the referenced site. Our work was completed under our Standby Remedial Services Contract No. C100908 with the New York State Department of Environmental Conservation (NYSDEC). Empire's onsite field work was completed during December 3 & 4, 2009.

As part of their onsite remedial work, Op-Tech Environmental Services (Op-Tech) demolished a vacant onsite building having asbestos-containing materials (ACM) in the roofing components and in one window. This task was monitored by Mr. Joseph Scott (December 3 & 4) and Mr. Douglas Stamp (December 3) of Empire, who are certified by the New York State Department of Labor as asbestos Project Monitors (Certificate Nos. 546106 and 89-07587). The daily monitoring reports are attached.

Empire personnel also collected air samples during this work, as per New York State Department of Labor (NYSDOL) requirements. The air samples were analyzed by Empire's affiliate, SJB Services, Inc., at our Cortland, New York laboratory. The lab data reports, air sampling field forms, and associated site sketches are attached.

As indicated on the attached asbestos logs, Op-Tech completed the ACM removal in an appropriate manner. They set up a decontamination facility and delineated the asbestos work area with warning tape and signs. Op-Tech placed all removed ACM debris into trucks lined with polyethylene sheeting for transport to an offsite disposal facility. No asbestos fibers were detected in any of the air samples collected by Empire.



**CORPORATE/
BUFFALO OFFICE**

5167 South Park Avenue
Hamburg, NY 14075
Phone: (716) 649-8110
Fax: (716) 649-8051



ALBANY OFFICE

PO Box 2199
Ballston Spa, NY 12020

5 Knabner Road
Mechanicville, NY 12118
Phone: (518) 899-7491
(518) 899-7496



CORTLAND OFFICE

60 Miller Street
Cortland, NY 13045
Phone: (607) 758-7182
Fax: (607) 758-7188



ROCHESTER OFFICE

535 Summit Point Drive
Henrietta, NY 14467
Phone: (585) 359-2730
Fax: (585) 359-9668

MEMBER

ACEC New York

American Council of Engineering Companies of New York

We appreciate the opportunity to provide these services. If you have any questions or need anything further, please contact our office.

Sincerely,
EMPIRE GEO-SERVICES, INC.

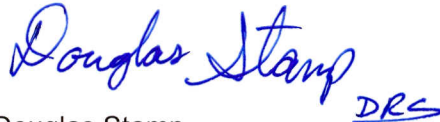

Douglas Stamp
Asbestos Project Monitor



David Steiner
Project Manager



Contract Drilling and Testing

Central New York Office

60 Miller Street Extension

Cortland, NY 13045

Telephone: (607) 758-7182

Fax: (607) 758-7188

10f2

INSPECTOR'S DAILY REPORT

Project: Bengart 3 Memel
Clinton St. Buffalo N.Y.
Client: NYS-DEC
Contractor: OP-Tech
Project No.: BEV-06-013

Date: 12.3.2009

S	M	T	W	TH	F	SA
Sunny		Clear		Overcast		Rain
to 32		32 to 50		50 to 70		70 to 85
Still		Moderate		High		85 +

OBSERVATIONS: On the above date, a representative of this company was present at the subject site for the purpose of Project monitor + Air tech.

0940. This writer on site, walk through with Doug Stamp to go over scope of work.

1000 This writer & Doug Stamp collect background sample cassettes.

1005 Begin collection of wipe samples.

10:45 Doug Stamp off site, DEC Rep off site. Abatement contractors continue establishment of personal decontamination unit.

1100 Decon is operational, contractor's begin pulling back walls.

1200 Bld 1/2 demolished, workers continue with demo of block walls.

1230 Roof of Bld. is down and completely intact, Contractors break for lunch.

1300 Contractors return to abatement, of roofing material.

Note - This writer has spoken with OP Tech Supervisor to inform him that Roofing material (ACM) must be inside waist container by the end of the shift. He was informed that he could leave ACM demo waist in work area until the morning when waist cans are delivered to site.

(Cont on Ind sheet)

Technician: [Signature]

Respectfully Submitted,
SJB SERVICES, INC.

Dave Verdon
Field Service Manager

Special Inspector



Contract
Drilling and
Testing

2 of 2

Central New York Office

60 Miller Street Extension

Cortland, NY 13045

Telephone: (607) 758-7182

Fax: (607) 758-7188

INSPECTOR'S DAILY REPORT

Project: Bengart & Memel 1079 Clinton St.
Client: NYSDEC
Contractor: OP-Tech
Project No.: BEV-06-013

Date: 12.3.2009

S	M	T	W	TH	F	SA	
Sunny		Clear		Overcast		Rain	Snow
to 32		32 to 50		50 to 70		70 to 85	85 +
Still		Moderate		High			

OBSERVATIONS: On the above date, a representative of this company was present at the subject site for the purpose of

(Cont. from sheet 1) This writer did inform Abatement supervisor that he had been misled to believe that 1445 Gene McNEK on site.

1500 Abatement complete Contractor's covering debris piles. This writer begins collection of samples.

1530 off site

Note: This writer did request that contractors drown ACM material that is on ground, also to cover with pally and secure to ensure no waist blows away. This writer did observe Abatement team using wet methods and they did comply with all my request. Gene NYSDEC is in agreement to this.

Contractors satisfied all my request, despite the extra work.

PCB wairst to stay on site / Not part of Asbestos debris. Construction debris to stay on site.

Technician:

Respectfully Submitted,
SJB SERVICES, INC.

Dave Verdon
Field Service Manager

Special Inspector



Contract Drilling and Testing

lot 3

Central New York Office

60 Miller Street Extension

Cortland, NY 13045

Telephone: (607) 758-7182

Fax: (607) 758-7188

INSPECTOR'S DAILY REPORT

Project: Bengant's memel
Client: NYSDEC
Contractor: OP-TECH
Project No.: BET-06-013

Date: 12.4.2009

S	M	T	W	TH	F	SA
Sunny		Clear		Overcast		Rain
to 32		32 to 50		50 to 70		70 to 85
Still		Moderate		High		85 +

OBSERVATIONS: On the above date, a representative of this company was present at the subject site for the purpose of Project monitor Air tech.

0630 This writer on site, begin set up of Sample collection equipment.

0700 OP tech on site ^{All} 3 employees. ~~Both~~ begin by setting up equipment, warming skid steer & excavator, in anticipation of loading wairst into vans this morning.

0730 Begin sample collection, all pumps drawing @ 2.5 μ m
Contractors begin putting debris into piles for wairst cans.

0800 1st wairst truck on site,

0915 1st wairst truck begin loading.

Gary Brit - op tech Project manager and OEC, Eugene Melnyk on site.

0955 1st truck full of contractors seal load w polly for transport to wairst facility.

Note - this writer did inform contractors that wairst haulers must be completely sealed with polly before leaving site.

1010 1st truck off site, 2 operators stage debris for loading.

1020 Gary Br. + off site.

1048 2nd wairst hauler on site.

1105 Contractors begin loading 2nd wairst hauler.

Continued on sheet 2

Technician: [Signature]

Respectfully Submitted,
SJB SERVICES, INC.

Dave Verdon
Field Service Manager

Special Inspector



Contract Drilling and Testing

Central New York Office

60 Miller Street Extension

Cortland, NY 13045

Telephone: (607) 758-7182

Fax: (607) 758-7188

20f3

INSPECTOR'S DAILY REPORT

Project: Bengart? memo1

Client: NYS DEC

Contractor: OP-TECH

Project No.: BEV-06-013

Date: 12.4.09

S	M	T	W	TH	F	SA
Sunny		Clear		Overcast		Rain
to 32		32 to 50		50 to 70		70 to 85
Still		Moderate		High		85 +

OBSERVATIONS: On the above date, a representative of this company was present at the subject site for the purpose of

Continued from sheet #1

Note This writer did inform contractor's that waist hauler must be lined with poly.

1150 2nd truck loaded, 2 Contractors seal truck for waist transport.

1200 2nd truck off site. Contractor's break for lunch.

1215 3rd truck on site. Contractors off @ lunch.

1220 Contractors return. Both begin to stage waist truck for loading. Poly line dumpster.

1252 Contractors begin loading 3rd waist truck.

1336 Contractor's seal waist load for transport.

1350 3rd truck off site.

Contractors stage bot and final waist load.

1420 4th and final truck on site, Contractor's line trailer for waist.

1430 Begin loading waist hauler

Continued on sheet #3

Technician: Dr. Jon

Respectfully Submitted,
SJB SERVICES, INC.

Dave Verdon
Field Service Manager

Special Inspector



**Contract
Drilling and
Testing**

3 of 3

Central New York Office

60 Miller Street Extension
Cortland, NY 13045
Telephone: (607) 758-7182
Fax: (607) 758-7188

INSPECTOR'S DAILY REPORT

Project: Bergert & meinel
Client: NYS DEC
Contractor: OP-Tech
Project No.: BEV-06-013

Date: 12.4.2009

S	M	T	W	TH	F	SA	
Sunny		Clear		Overcast		Rain	Snow
to 32		32 to 50		50 to 70		70 to 85	85 +
Still		Moderate		High			

OBSERVATIONS: On the above date, a representative of this company was present at the subject site for the purpose of

Continued from sheet #2

325 Final truck loaded, This writer conducted visual inspection of work area, All ACM removed, Clearance granted, Truck off site

3:30 This writer collects daily air samples, for transport to SJB LAB.

instruct contractors all off site.
Begin observance of waiting period.

500 this writer sets up 5 more sample collection pumps,

530 Begin sample collection.

700 This writer collects sample cassettes for transport to SJB

730 This writer collects equipment and completes paperwork off site to SJB with cassettes

End of Report.

Technician: 

Respectfully Submitted,
SJB SERVICES, INC.

Dave Verdon
Field Service Manager

Special Inspector

REPORT OF AIR SAMPLES

Phase Contrast Microscopy



Project:	Bengart & Memel Site (Site # 915115)	SJB Job. No	BEV-06-013
	Clinton Street, Buffalo, NY	Date Sampled:	12/03/09
Client:	NYSDEC	Date Analyzed:	12/05/09
Contractor:	Op-Tech	Date Received:	12/05/09
Work Area:	Block Building	Technician:	D. Stamp

FIELD ID NO.	LAB ID NO.	SAMPLE TYPE	LOCATION	SKETCH REF.	SAMPLE VOLUME (L)	F/mm ²	F/cc
B&M-01	A09CR32	Background	IWA - #1, Northwest Corner of Building	1	750	1.274	<0.004
B&M-02	A09CR33	Background	IWA - #2, Northeast Corner of Building	1	750	1.274	<0.004
B&M-03	A09CR34	Background	IWA - #3, East Side of Building	1	750	1.274	<0.004
B&M-04	A09CR35	Background	IWA - #4, South Side of Building	1	750	1.274	<0.004
B&M-05	A09CR36	Background	IWA - #5, West Side of Building / Laub Lot	1	750	1.274	<0.004
B&M-06	A09CR37	Background	OWA - #7, Clinton Auto Wrecking Lot	1	750	1.274	<0.004

Remarks: Samples were collected and data provided by SJB Services, Inc.
Rotometer Type: Dwyer. Calibration Date: 10/29/09. BIOS dry cal DC lite primary calibrator.
Prepared, analyzed and results calculated by NIOSH 7400 Method, Issue 2, "A" Rules 8/15/94.

TLTC - Filter Too Loaded To Count VOID - Filter Damaged / Unreadable IWA - Inside Work Area OWA - Outside Work Area NA - Not Applicable MICROSCOPE MODEL: Nikon Optiphot SERIAL NUMBER: 228500 ELAP NUMBER: 11117	Intralaboratory S _p : 5-20: 0.148 21-50: 0.120 51-100: 0.064 F/cc Levels of <0.01 Acceptable	Respectfully Submitted, SJB SERVICES, INC. Analyst: <i>Roberta Reynolds</i> Roberta Reynolds Lab Director: <i>Dave Verdon</i> Dave Verdon
--	--	---

REPORT OF AIR SAMPLES

Phase Contrast Microscopy



Project:	Bengart & Memel Site (Site # 915115)	SJB Job. No	BEV-06-013
	Clinton Street, Buffalo, NY	Date Sampled:	12/03/09
Client:	NYSDEC	Date Analyzed:	12/05/09
Contractor:	Op-Tech	Date Received:	12/05/09
Work Area:	Block Building	Technician:	D. Stamp

FIELD ID NO.	LAB ID NO.	SAMPLE TYPE	LOCATION	SKETCH REF.	SAMPLE VOLUME (L)	F/mm ²	F/cc
B&M-07	A09CR38	WIP	IWA - #1, North Corner of Building	3	975	1.274	<0.003
B&M-08	A09CR39	WIP	IWA - #2, Northwest Corner of Building	3	975	2.548	<0.003
B&M-09	A09CR40	WIP	IWA - #3, West Side of Building	3	975	1.274	<0.003
B&M-10	A09CR41	WIP	IWA - #4, Decon, East of Building	3	975	1.274	<0.003
B&M-11	A09CR42	WIP	IWA - #5, Southeast Corner of Building	3	975	1.274	<0.003
B&M-12	A09CR43	WIP	IWA - #6, South End of Building	3	975	1.274	<0.003
B&M-13	A09CR44	WIP	OWA - #7, East of Building	3	975	1.274	<0.003
B&M-14	A09CR45	Blank	N/A	N/A	N/A	<1.274	Accept
B&M-15	A09CR46	Blank	N/A	N/A	N/A	<1.274	Accept

Remarks: Samples were collected and data provided by SJB Services, Inc.
Rotometer Type: Dwyer. Calibration Date: 10/29/09. BIOS dry cal DC lite primary calibrator.
Prepared, analyzed and results calculated by NIOSH 7400 Method, Issue 2, "A" Rules 8/15/94.

TLTC - Filter Too Loaded To Count VOID - Filter Damaged / Unreadable IWA - Inside Work Area OWA - Outside Work Area NA - Not Applicable MICROSCOPE MODEL: Nikon Optiphot SERIAL NUMBER: 228500 ELAP NUMBER: 11117	Intralaboratory S _p : 5-20: 0.148 21-50: 0.120 51-100: 0.064 F/cc Levels of <0.01 Acceptable	Respectfully Submitted, SJB SERVICES, INC. Analyst: <i>Roberta Reynolds</i> Roberta Reynolds Lab Director: <i>Dave Verdon</i> Dave Verdon
--	--	---

REPORT OF AIR SAMPLES

Phase Contrast Microscopy



Project:	Bengart & Memel Site (Site # 915115)	SJB Job. No	BEV-06-013
	Clinton Street, Buffalo, NY	Date Sampled:	12/04/09
Client:	NYSDEC	Date Analyzed:	12/05/09
Contractor:	Op-Tech	Date Received:	12/05/09
Work Area:	Block Building	Technician:	J. Scott

FIELD ID NO.	LAB ID NO.	SAMPLE TYPE	LOCATION	SKETCH REF.	SAMPLE VOLUME (L)	F/mm ²	F/cc
B&M-16	A09CR47	WIP	Decon - Northwest Corner of Decon	3	1200	1.274	<0.002
B&M-17	A09CR48	WIP	OWA - Southwest Side of Debris	3	1200	1.274	<0.002
B&M-18	A09CR49	WIP	OWA - Southwest Corner of Site	3	1200	1.274	<0.002
B&M-19	A09CR50	WIP	OWA - Northwest Corner of Site	3	1200	1.274	<0.002
B&M-20	A09CR51	WIP	OWA - Southwest End of Property	3	1200	1.274	<0.002
B&M-21	A09CR52	Blank	N/A	N/A	N/A	<1.274	Accept
B&M-22	A09CR53	Blank	N/A	N/A	N/A	<1.274	Accept
B&M-23	A09CR54	Blank	N/A	N/A	N/A	<1.274	Accept

Remarks: Samples were collected and data provided by SJB Services, Inc.
Rotometer Type: Dwyer H-7. Calibration Date: 10/29/09. BIOS dry cal DC lite primary calibrator.
Prepared, analyzed and results calculated by NIOSH 7400 Method, Issue 2, "A" Rules 8/15/94.

TLTC - Filter Too Loaded To Count VOID - Filter Damaged / Unreadable IWA - Inside Work Area OWA - Outside Work Area NA - Not Applicable MICROSCOPE MODEL: Nikon Optiphot SERIAL NUMBER: 228500 ELAP NUMBER: 11117	Intralaboratory S _r : 5-20: 0.148 21-50: 0.120 51-100: 0.064 F/cc Levels of <0.01 Acceptable	Respectfully Submitted, SJB SERVICES, INC. Analyst: <i>Roberta Reynolds</i> Roberta Reynolds Lab Director: <i>Dave Verdon</i> Dave Verdon
--	--	---

REPORT OF AIR SAMPLES

Phase Contrast Microscopy



Project:	Bengart & Memel Site (Site # 915115)	SJB Job. No	BEV-06-013
	Clinton Street, Buffalo, NY	Date Sampled:	12/04/09
Client:	NYSDEC	Date Analyzed:	12/05/09
Contractor:	Op-Tech	Date Received:	12/05/09
Work Area:	Block Building	Technician:	J. Scott

FIELD ID NO.	LAB ID NO.	SAMPLE TYPE	LOCATION	SKETCH REF.	SAMPLE VOLUME (L)	F/mm ²	F/cc
B&M-24	A09CR55	Clearance	IWA - Northwest Corner of Decon	4	1200	1.274	<0.002
B&M-25	A09CR56	Clearance	IWA - Southeast Corner of Work Area	4	1200	1.274	<0.002
B&M-26	A09CR57	Clearance	IWA - South Central of Work Area	4	1200	1.274	<0.002
B&M-27	A09CR58	Clearance	IWA - Southwest Side of Work Area	4	1200	2.548	<0.002
B&M-28	A09CR59	Clearance	IWA - Southwest Corner of Work Area	4	1200	2.548	<0.002
B&M-29	A09CR60	Clearance	OWA - South of Decon, Clean Side of Fence	4	1200	1.274	<0.002
B&M-30	A09CR61	Clearance	OWA - Southwest Corner of Decon, Clean Side of Fence	4	1200	1.274	<0.002
B&M-31	A09CR62	Clearance	OWA - Central Location, Clean Side of Fence	4	1200	1.274	<0.002
B&M-32	A09CR63	Clearance	OWA - Clean Side of Fence, West of B&M-31	4	1200	2.548	<0.002
B&M-33	A09CR64	Clearance	OWA - Clean Side of Fence, West of B&M-32	4	1200	1.274	<0.002
B&M-34	A09CR65	Blank	N/A	N/A	N/A	<1.274	Accept
B&M-35	A09CR66	Blank	N/A	N/A	N/A	<1.274	Accept

Remarks: Samples were collected and data provided by SJB Services, Inc.
Rotometer Type: Dwyer H-7. Calibration Date: 10/29/09. BIOS dry cal DC lite primary calibrator.
Prepared, analyzed and results calculated by NIOSH 7400 Method, Issue 2, "A" Rules 8/15/94.

TLTC - Filter Too Loaded To Count VOID - Filter Damaged / Unreadable IWA - Inside Work Area OWA - Outside Work Area NA - Not Applicable MICROSCOPE MODEL: Nikon Optiphot SERIAL NUMBER: 228500 ELAP NUMBER: 11117	Intralaboratory S _p : 5-20: 0.148 21-50: 0.120 51-100: 0.064 F/cc Levels of <0.01 Acceptable	Respectfully Submitted, SJB SERVICES, INC. Analyst: <i>Roberta Reynolds</i> Roberta Reynolds Lab Director: <i>Dave Verdon</i> Dave Verdon
--	--	---



Contract
Drilling
and
Testing

ASBESTOS AIR SAMPLE DATA

CORTLAND OFFICE

60 Miller Street, Cortland, New York 13045
Phone: (607) 758-7182
Fax: (607) 758-7188

Page 1 of 2

PROJECT: Bengtson + Menel Site	DATE: 12-3-09	SHIFT: Day	Analysis: MPCM	[] TEM
CLIENT: NYSDEC +	PROJECT NO: BEY-06-01		Technician: Dave Stamp / Joe Scott	
CONTRACTOR: Ep-Tech	WORK AREA: Black Building		Rotometer Type: Dwyer Visi-Flow	
			Calibration Date: 10-29-09	

BIOS dry cal DC lite primary calibrator

Field ID	Lab ID Number	Sample Type	Location	Drwg. Ref.	Pump No.	Time		Flow		Volume (liters)	F/mm ²	F/CC
						Start	Stop	Start	Stop			
B+M 1		BL	IWA #1 NW Corner of Bldg	1	1	0900	1000	12.5 L/min	15 L/min	750		<0.004
B+M 2			IWA #2 NE Corner of Bldg		10			12.5 L/min	15 L/min			
B+M 3			IWA #3 E Side of Bldg		7			12.5 L/min	15 L/min			
B+M 4			IWA #4 S Side of Bldg		2			12.5 L/min	15 L/min			
B+M 5			IWA #5 W side of Bldg / Lamb Lot		4			12.5 L/min	15 L/min			
B+M 6			OWA #7 Clinton Auto Wrecking Lot		11			12.5 L/min	15 L/min			
B+M 7		WIP	IWA #1 NW corner of Bldg	3	1	1005	1530	3.0 L/min	9.0 L/min	975		<0.003
B+M 8			IWA #2 NW corner of Bldg		10	1005	1530	3.0 L/min	3.0 L/min			
B+M 9			IWA #3 west side of Bldg		7	1005	1530	3.0 L/min	3.0 L/min			
B+M 10			IWA #4 DECON East of Bldg		2	1005	1530	3.0 L/min	3.0 L/min			

CHAIN OF CUSTODY DOCUMENTATION

Relinquished By	Date	Time	Received By	Date	Time
Angela	12-3-09		R. Repetto	12/5	7:25

LEGEND

BL = Baseline
CL = Clearance
INT = Interim
P = Personal

STEL = Short Term Exposure Limit
IWA = Inside Work Area
OWA = Outside Work Area

Technician (signature): Dave Stamp

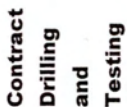

ASBESTOS AIR SAMPLE DATA

CORTLAND OFFICE
60 Miller Street, Cortland, New York 13045
Phone: (607) 758-7182
Fax: (607) 758-7188

PROJECT: <i>Bergant & memel</i>	DATE: <i>12.4.09</i>	SHIFT: <i>1st</i>	Analysis: <input checked="" type="checkbox"/> PCM <input type="checkbox"/> TEM
CLIENT: <i>NYSDEC</i>	PROJECT NO:		Technician: <i>A. Scott</i>
CONTRACTOR: <i>OP-tech</i>	WORK AREA: <i>Block 31d</i>		Rotometer Type: <i>Zefon H7</i>
BIOS dry cal DC lite primary calibrator			Calibration Date: <i>4.28.09</i>

[illegible]

CHAIN OF CUSTODY DOCUMENTATION

CHAIN OF CUSTODY DOCUMENTATION				LEGEND			
Relinquished By	Date	Time	Received By	Date	Time	BL = Baseline CL = Clearance INT = Interim P = Personal	STEL = Short Term Exposure Limit IWA = Inside work Area OWA = Outside Work Area
<i>Mr. Deon</i>	<i>12-4-2009</i>		<i>R. Reynolds</i>	<i>12/5</i>	<i>7:30</i>		
						Technician (signature) <i>[Signature]</i>	



Contract
Drilling
and
Testing

Ch's

ASBESTOS AIR SAMPLE DATA

CORTLAND OFFICE
60 Miller Street, Cortland, New York 13045
Phone: (607) 758-7182
Fax: (607) 758-7188

PROJECT: <u>Bergant & Menel</u>	DATE: <u>12.4.09</u>	SHIFT: <u>1st</u>	Analysis: [] PCM [] TEM
CLIENT: <u>NYS DEC</u>	PROJECT NO: _____		
CONTRACTOR: <u>OP-tech</u>	WORK AREA: <u>Block Bld.</u>		
BIOS dry cal DC lite primary calibrator			
Technician: <u>J. Scott</u>			
Rotometer Type: <u>Zefon H7</u>			
Calibration Date: <u>4.24.09</u>			

Field ID	Lab ID Number	Sample Type	Location	Drwg. Ref.	Pump No.	Time		Flow		Volume (liters)	F/mm ²	F/C
						Start	Stop	Start	Stop			
BAM 24		CL	IWA North west corner of decon	4	12	6:30	7:40	12.5	12.5	1200		LO.002
BAM 25			IWA South east corner of work area	1	3	6:30	7:40					
BAM 26			IWA South central of work area	1	7	6:30	7:40					
BAM 27			IWA South west side of work area	1	8	6:31	7:41					
BAM 28			IWA South west corner of work area	1	55BR 10	6:31	7:41					
BAM 29			OWA South of decon Clean side of fence	1	55BR 1	6:32	7:42					
BAM 30			OWA South west corner Clean side (decon)	1	55BR 2	6:32	7:42					
BAM 31			OWA Central location Clean side of fence	1	11	6:33	7:43					
BAM 32			OWA Ref. to map.	1	5	6:33	7:43					
BAM 33			OWA Ref. to map.	1	41	6:34	7:44					
BAM 34			Blank									
BAM 35			Field Blank									Accept

CHAIN OF CUSTODY DOCUMENTATION				LEGEND	
Relinquished By	Date	Time	Received By	Date	Time
<u>J. Scott</u>	<u>12.4.09</u>		<u>R. Reynolds</u>	<u>12/5</u>	<u>7:35</u>
STEL = Short Term Exposure Limit IWA = Inside Work Area OWA = Outside Work Area				BL = Baseline CL = Clearance INT = Interim P = Personal	
Technician (signature)				<u>J. Scott</u>	

WIP / Daily Air Samples

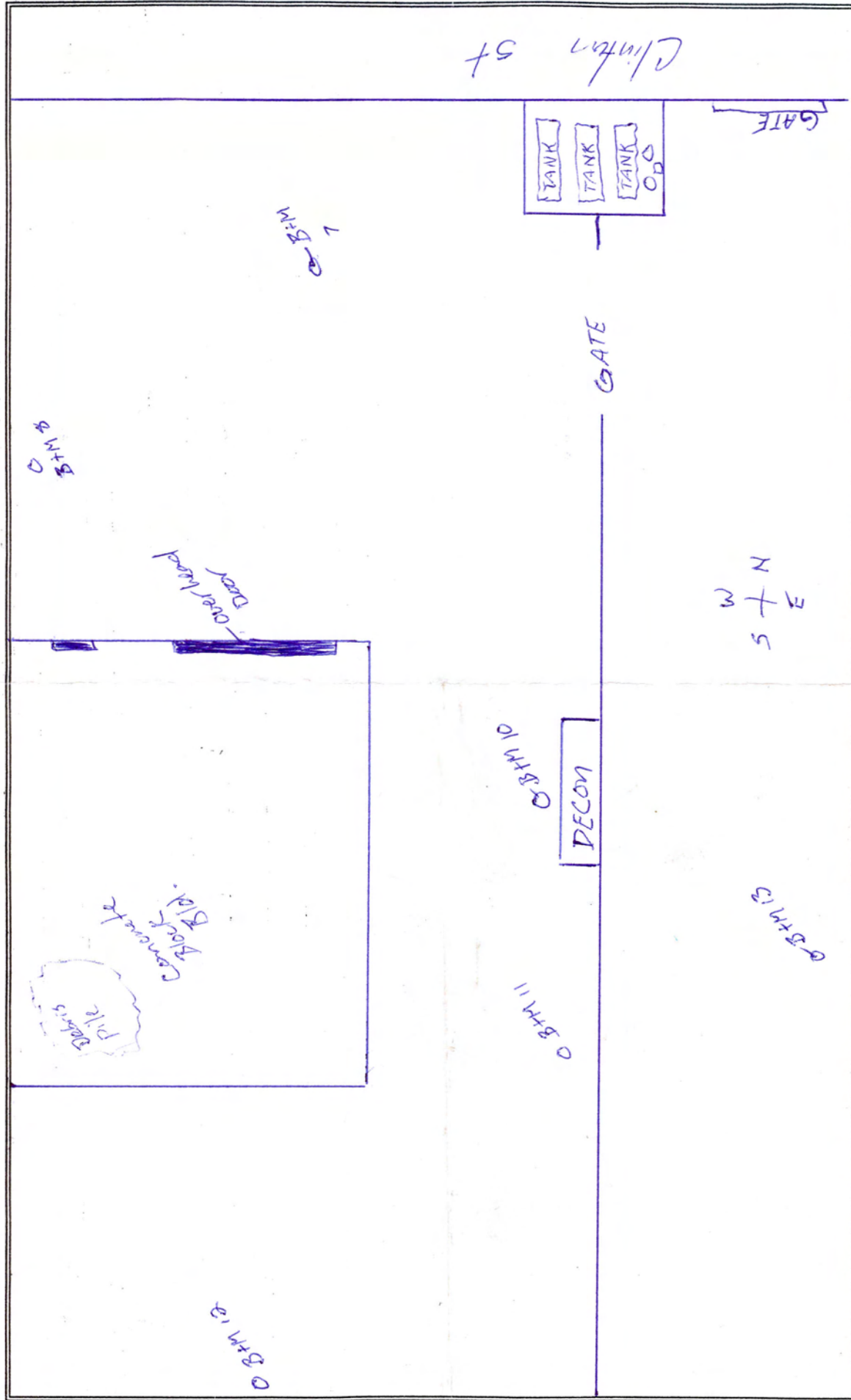

Contract Drilling
and Testing

60 Miller Street, Cortland, NY 13045

PROJECT: Bengart 3 memel 1079 Clinton St.	Drwn by/Copied from: G. Scott	Ref. no. 3	Date: 12.3.09
AREA: Concrete block bld.			

