



Tyco  
9 Roszel Road  
Princeton, NJ 08540 USA

April 22, 2015

Ms. Laura Surdej  
Erie County Department of Environment and Planning  
Division of Sewerage Management  
Erie County Sewer District # 6  
260 Lehigh Avenue  
Lackawanna, New York 14218

RE: Second Quarter 2015 Discharge Monitoring Report  
Scott Technologies, Inc., Groundwater Remediation Site, Lancaster, New York  
NYSDEC Site 9-15-149  
EC/BPDES Permit No. 14-04-E4045

Dear Ms. Surdej:

Scott Technologies, Inc. is pleased to provide you with the enclosed Second Quarter 2015 Discharge Monitoring Report for the Scott Technologies Groundwater Remediation Site located at AVOX Systems Inc., 25A Walter Winter Drive, Lancaster, New York 14086. This report is submitted in partial fulfillment of Erie County/Buffalo Pollution Discharge Elimination System (EC/BPDES) Permit No. 14-04-E4045, effective April 1, 2014 and the updated Part II: General Conditions dated March 24, 2014.

Scott Technologies commissioned AECOM, with an office located in Amherst, New York, to perform the required EC/BPDES quarterly sampling during the month of April 2015 and to prepare the enclosed report with the results.

I certify under the penalty of law that this document and all attachments were prepared under my direction or supervision in accordance with a system designed to assure that qualified personnel properly gather and evaluate the information submitted. Based on my inquiry of the person or persons who manage the systems, or those persons directly responsible for gathering the information, the information submitted is, to the best of my knowledge and belief, true, accurate, and complete. I am aware that there are significant penalties for submitting false information, including the possibility of a fine and imprisonment for known violations.

Ms. Laura Surdej  
April 21, 2015  
Page 2

Scott Technologies will continue to monitor the influent and effluent of the active remediation system located at the Site on a quarterly basis. The next scheduled quarterly discharge monitoring report is due by August 31, 2015.

If you have any questions regarding this submittal, please do not hesitate to contact me at the above address or at [jjaneczek@tyco.com](mailto:jjaneczek@tyco.com).

Very truly yours,  
Scott Technologies, Inc.

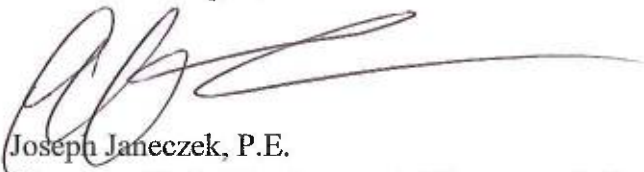

Joseph Janeczek, P.E.  
Director - Global Environmental Programs & Corporate Social Responsibility  
Tyco International

\enclosures

cc: Mr. Al Alagna, Buffalo Sewer Authority (electronic copy sent by AECOM)  
Mr. Glenn May, NYSDEC Region 9 (electronic copy sent by AECOM)  
Ms. Jennifer Davide, AVOX Systems Inc. (electronic copy sent by AECOM)  
Facility File, Lancaster, NY (hard copy sent by AECOM)

## TABLE

**Scott Technologies, Inc. - Groundwater Remediation Site  
Lancaster, New York**

EC/BPDES Permit No. 14-04-E4045

**Second Quarter 2015 Discharge Monitoring Report  
Sample Date - April 6, 2015**

<b>Parameter</b>	<b>Units</b>	<b>Total Maximum Daily Load (pounds per day)</b>	<b>Measured or Calculated Daily Load (Pounds per day)</b>	<b>Within Limits?</b>
pH (Method SM 4500 H+ B)	SU	5 - 12	8.27	Y
Total Extractable Hydrocarbons (Method 1664A)	mg/L	100	< 5.0	Y
Total Suspended Solids (Method SM 2540D)	mg/L	250	4.0	Y
<u>VOCs (Method 8260C)</u>				
Methylene Chloride	lbs/day	0.12	0.000014	Y
1,1,1-Trichloroethane	lbs/day	0.09	< 0.000010	Y
Trichloroethylene	lbs/day	0.04	< 0.000010	Y
Total 1,2-DCE (cis-1,2-DCE and trans-1,2-DCE)	lbs/day	0.02	< 0.00001	Y
1,1-Dichloroethane	lbs/day	0.0025	< 0.000010	Y
Chloroethane	lbs/day	0.025	< 0.000010	Y
Toluene	lbs/day	0.004	< 0.000010	Y
Total Daily Flow (discharge meter reading)	gallons per day	14,000	1,150	Y

Notes:

- SU standard units
- mg/L milligrams per liter
- ug/L micrograms per liter
- lbs/day pounds per day
- J Indicates analyte result was reported as an estimated concentration.
- < (value) Indicates calculated concentration less than the reported value,  
using effluent reporting limit as maximum possible concentration.
- DPE system was not running during sample collection.

## FIGURES

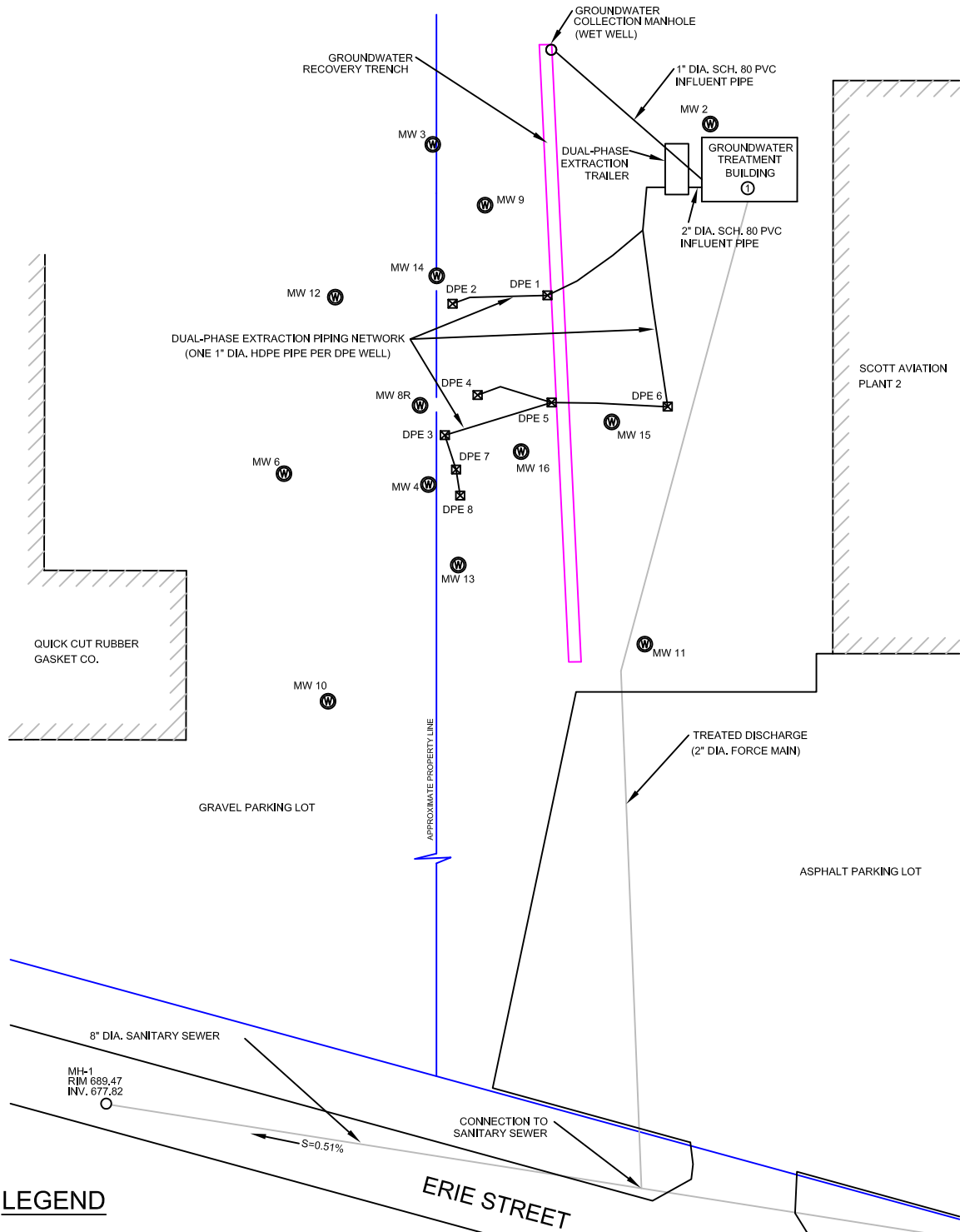

**LEGEND**

- MW 13 MONITORING WELL
- DPE 8 DUAL-PHASE EXTRACTION WELL
- APPROXIMATE PROPERTY BOUNDARY
- GROUNDWATER RECOVERY TRENCH
- SANITARY SEWER

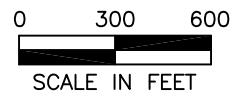

**FIGURE 1  
DUAL PHASE EXTRACTION SYSTEM  
LOCATION MAP**

FORMER SCOTT AVIATION FACILITY  
LANCASTER, NEW YORK

60288479

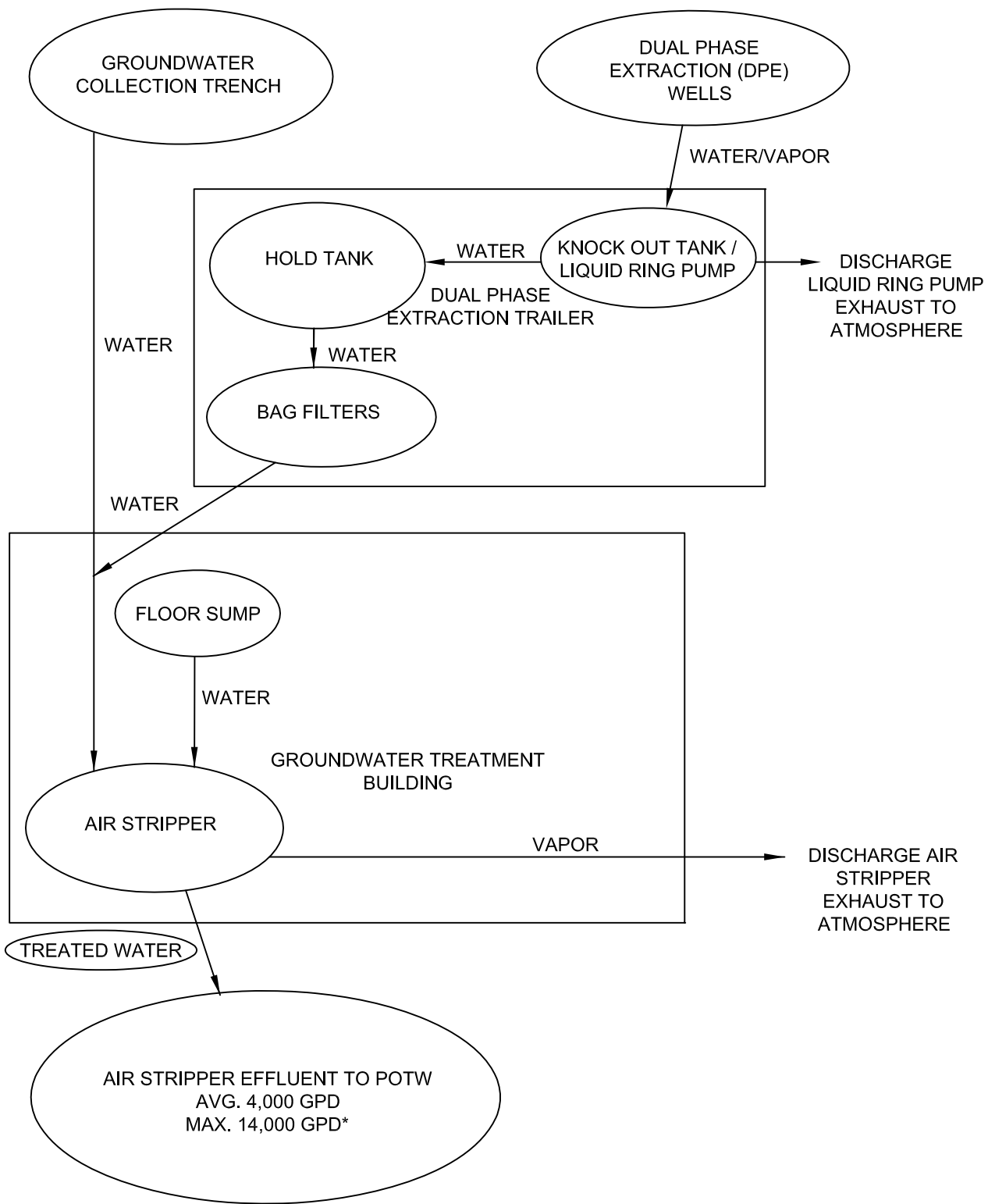

\*PER DISCHARGE PERMIT NO. 14-04-E4045



FIGURE 2  
COMBINED DUAL PHASE EXTRACTION  
REMEDICATION SYSTEM FLOW DIAGRAM

FORMER SCOTT AVIATION FACILITY  
LANCASTER, NEW YORK

60288479

## DAILY FIELD LOG



DAILY FIELD LOG



**Project** Scott Technologies, Inc., Groundwater Remediation Site, Lancaster, NY  
**Date** 6-Apr-15  
**Weather** Cloudy  
**Temperature Range** 45 deg F  
**AECOM Personnel on Site** Emily Laity  
**Time on Site** 08:00 - 16:00 hrs

**Air Stripper Totalizer Start Sampling\*** 5,667,880 gallons 8:00 hrs  
**Air Stripper Totalizer After Sampling\*** 5,668,620 gallons 16:00 hrs

**Summary of Sample Activities**

Time = 08:00 hrs  
 pH = 8  
 Fill 2, 40-ml vials (preserved with HCl) from influent sample tap. Fill 2, 1-L clear glass bottle (preserved with H<sub>2</sub>SO<sub>4</sub>) 1/4 full, from influent tap. Fill 1, 500-ml plastic bottle (unpreserved) 1/4 full from influent tap. Fill 1 250-ml plastic bottle (unpreserved) 1/4 full from influent tap. Water quality is clear with slight odor (no sheen).  
  
 Fill 2, 40-ml vials (preserved with HCl) from effluent sample tap. Fill 2, 1-L clear glass bottle (preserved with H<sub>2</sub>SO<sub>4</sub>) 1/4 full, respectively, from effluent tap. Fill 1, 500-ml plastic bottle (unpreserved) 1/4 full from effluent tap. Fill 1 250-ml plastic bottle (unpreserved) 1/4 full from effluent tap. Water quality is clear with no discernable odor or sheen.  
  
 Time = 10:00 hrs  
 pH = 8  
 Fill 2, 40-ml vials (preserved with HCl) from influent sample tap. Fill 2, 1-L clear glass bottle (preserved with H<sub>2</sub>SO<sub>4</sub>) 1/4 full, from influent tap. Fill 1, 500-ml plastic bottle (unpreserved) 1/4 full from influent tap. Fill 1 250-ml plastic bottle (unpreserved) 1/4 full from influent tap. Water quality is clear with slight odor (no sheen).  
  
 Fill 2, 40-ml vials (preserved with HCl) from effluent sample tap. Fill 2, 1-L clear glass bottle (preserved with H<sub>2</sub>SO<sub>4</sub>) 1/4 full, respectively, from effluent tap. Fill 1, 500-ml plastic bottle (unpreserved) 1/4 full from effluent tap. Fill 1 250-ml plastic bottle (unpreserved) 1/4 full from effluent tap. Water quality is clear with no discernable odor or sheen.  
  
 Time = 12:30 hrs  
 pH = 8  
 Fill 2, 40-ml vials (preserved with HCl) from influent sample tap. Fill 2, 1-L clear glass bottle (preserved with H<sub>2</sub>SO<sub>4</sub>) 1/4 full, from influent tap. Fill 1, 500-ml plastic bottle (unpreserved) 1/4 full from influent tap. Fill 1 250-ml plastic bottle (unpreserved) 1/4 full from influent tap. Water quality is clear with slight odor (no sheen).  
  
 Fill 2, 40-ml vials (preserved with HCl) from effluent sample tap. Fill 2, 1-L clear glass bottle (preserved with H<sub>2</sub>SO<sub>4</sub>) 1/4 full, respectively, from effluent tap. Fill 1, 500-ml plastic bottle (unpreserved) 1/4 full from effluent tap. Fill 1 250-ml plastic bottle (unpreserved) 1/4 full from effluent tap. Water quality is clear with no discernable odor or sheen.  
  
 Time = 15:30 hrs  
 pH = 8  
 Fill 2, 40-ml vials (preserved with HCl) from influent sample tap. Fill 2, 1-L clear glass bottle (preserved with H<sub>2</sub>SO<sub>4</sub>) 1/4 full, from influent tap. Fill 1, 500-ml plastic bottle (unpreserved) 1/4 full from influent tap. Fill 1 250-ml plastic bottle (unpreserved) 1/4 full from influent tap. Water quality is clear with slight odor (no sheen).  
  
 Fill 2, 40-ml vials (preserved with HCl) from effluent sample tap. Fill 2, 1-L clear glass bottle (preserved with H<sub>2</sub>SO<sub>4</sub>) 1/4 full, respectively, from effluent tap. Fill 1, 500-ml plastic bottle (unpreserved) 1/4 full from effluent tap. Fill 1 250-ml plastic bottle (unpreserved) 1/4 full from effluent tap. Water quality is clear with no discernable odor or sheen.

**Comments**

\*AS effluent totalizer was down; AS (GWCT) influent totalizer was running.  
 GWCT running at time of sample collection; DPE down due to November 2014 injection.  
 Air sample collected on 4/6/15 at 08:00 hrs from AS effluent for TO-15 analysis.  
  
 Maintain samples at 4 degrees C. Hand deliver samples to TestAmerica Laboratories, Inc. (Amherst, NY) under COC on 7/8/15 for analysis. Request laboratory to composite 40-ml samples and analyze for VOCs (8260C). Request laboratory to analyze influent and effluent samples for TEH (1664A), TSS (SM 2540D), and pH (SM 4500 H+B).

Signature: 

Date: 6-Apr-15

## **LABORATORY REPORT**

# TestAmerica

THE LEADER IN ENVIRONMENTAL TESTING

## ANALYTICAL REPORT

TestAmerica Laboratories, Inc.

TestAmerica Buffalo

10 Hazelwood Drive

Amherst, NY 14228-2298

Tel: (716)691-2600

TestAmerica Job ID: 480-77895-1

Client Project/Site: Scott Aviation site

Sampling Event: Influent/Effluent analysis

For:

AECOM, Inc.

100 Corporate Parkway

Suite 341

Amherst, New York 14226

Attn: Mr. Dino Zack

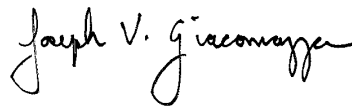

Authorized for release by:

4/20/2015 9:06:24 AM

Joe Giacomazza, Project Management Assistant II

[joe.giacomazza@testamericainc.com](mailto:joe.giacomazza@testamericainc.com)

Designee for

Brian Fischer, Manager of Project Management

(716)504-9835

[brian.fischer@testamericainc.com](mailto:brian.fischer@testamericainc.com)

### LINKS

Review your project  
results through

TotalAccess

Have a Question?



Visit us at:

[www.testamericainc.com](http://www.testamericainc.com)

*The test results in this report meet all 2003 NELAC and 2009 TNI requirements for accredited parameters, exceptions are noted in this report. This report may not be reproduced except in full, and with written approval from the laboratory. For questions please contact the Project Manager at the e-mail address or telephone number listed on this page.*

*This report has been electronically signed and authorized by the signatory. Electronic signature is intended to be the legally binding equivalent of a traditionally handwritten signature.*

*Results relate only to the items tested and the sample(s) as received by the laboratory.*

1

2

3

4

5

6

7

8

9

10

11



# Table of Contents

Cover Page . . . . .	1
Table of Contents . . . . .	2
Definitions/Glossary . . . . .	3
Case Narrative . . . . .	4
Client Sample Results . . . . .	5
Lab Chronicle . . . . .	11
Certification Summary . . . . .	12
Method Summary . . . . .	13
Sample Summary . . . . .	14
Receipt Checklists . . . . .	15
Chain of Custody . . . . .	16

# Definitions/Glossary

Client: AECOM, Inc.  
Project/Site: Scott Aviation site

TestAmerica Job ID: 480-77895-1

## Qualifiers

### GC/MS VOA

Qualifier	Qualifier Description
J	Result is less than the RL but greater than or equal to the MDL and the concentration is an approximate value.
B	Compound was found in the blank and sample.
*	LCS or LCSD exceeds the control limits

### General Chemistry

Qualifier	Qualifier Description
HF	Field parameter with a holding time of 15 minutes. Test performed by laboratory at client's request.

## Glossary

Abbreviation	These commonly used abbreviations may or may not be present in this report.
$\alpha$	Listed under the "D" column to designate that the result is reported on a dry weight basis
%R	Percent Recovery
CFL	Contains Free Liquid
CNF	Contains no Free Liquid
DER	Duplicate error ratio (normalized absolute difference)
Dil Fac	Dilution Factor
DL, RA, RE, IN	Indicates a Dilution, Re-analysis, Re-extraction, or additional Initial metals/anion analysis of the sample
DLC	Decision level concentration
MDA	Minimum detectable activity
EDL	Estimated Detection Limit
MDC	Minimum detectable concentration
MDL	Method Detection Limit
ML	Minimum Level (Dioxin)
NC	Not Calculated
ND	Not detected at the reporting limit (or MDL or EDL if shown)
PQL	Practical Quantitation Limit
QC	Quality Control
RER	Relative error ratio
RL	Reporting Limit or Requested Limit (Radiochemistry)
RPD	Relative Percent Difference, a measure of the relative difference between two points
TEF	Toxicity Equivalent Factor (Dioxin)
TEQ	Toxicity Equivalent Quotient (Dioxin)

# Case Narrative

Client: AECOM, Inc.  
Project/Site: Scott Aviation site

TestAmerica Job ID: 480-77895-1

**Job ID: 480-77895-1**

**Laboratory: TestAmerica Buffalo**

## Narrative

### Job Narrative 480-77895-1

#### Receipt

The samples were received on 4/7/2015 5:15 PM; the samples arrived in good condition, properly preserved and, where required, on ice. The temperature of the cooler at receipt was 2.8° C.

#### GC/MS VOA

Method(s) 8260C: The continuing calibration verification (CCV) associated with batch 236247 recovered outside acceptance criteria, low biased, for Carbon Disulfide, Cyclohexane, and Methylcyclohexane. A reporting limit (RL) standard was analyzed, and the target analytes were detected. Since the associated samples were non-detect for these analytes, the data have been reported..

Method(s) 8260C: The laboratory control sample (LCS) for batch 236247 recovered outside control limits for the following analytes: Dichlorodifluoromethane, Chlorodibromomethane, and Chloromethane. These were not requested spike compounds; therefore, the data have been qualified and reported. Trip Blank (480-77895-3).

Method(s) 8260C: The continuing calibration verification (CCV) associated with batch 236713 recovered above the upper control limit for Trichlorofluoromethane. The samples associated with this CCV were non-detects for the affected analyte; therefore, the data has been reported. The following samples are impacted: EFFLUENT (480-77895-1) and INFLUENT (480-77895-2).

Method(s) 8260C: The following Volatile sample(s) was composited by the laboratory on 4/16/2015 as requested by the client: EFFLUENT (480-77895-1) and INFLUENT (480-77895-2). Regulatory defined guidance for in-laboratory compositing of samples, is currently not available. Laboratory sample compositing was performed using established project specifications and/or laboratory standard operating procedures.

Method(s) 8260C: The method blank for batch 236713 contained methylene Chloride above the method detection limit. This target analyte concentration was less than the reporting limit (RL); therefore, re-extraction and/or re-analysis of samples was not performed.

No additional analytical or quality issues were noted, other than those described above or in the Definitions/Glossary page.

#### General Chemistry

Method(s) 9040C, SM 4500 H+ B: This analysis is normally performed in the field and has a method-defined holding time of 15 minutes. The following samples has been qualified with the "HF" flag to indicate analysis was performed in the laboratory outside the 15 minute timeframe: EFFLUENT (480-77895-1) and INFLUENT (480-77895-2).

No additional analytical or quality issues were noted, other than those described above or in the Definitions/Glossary page.

# Client Sample Results

Client: AECOM, Inc.  
Project/Site: Scott Aviation site

TestAmerica Job ID: 480-77895-1

**Client Sample ID: EFFLUENT**

**Lab Sample ID: 480-77895-1**

**Date Collected: 04/06/15 08:00**

**Matrix: Water**

**Date Received: 04/07/15 17:15**

**Method: 8260C - Volatile Organic Compounds by GC/MS**

Analyte	Result	Qualifier	RL	MDL	Unit	D	Prepared	Analyzed	Dil Fac
1,1,1-Trichloroethane	ND		1.0	0.82	ug/L			04/17/15 05:14	1
1,1,2,2-Tetrachloroethane	ND		1.0	0.21	ug/L			04/17/15 05:14	1
1,1,2-Trichloro-1,2,2-trifluoroethane	ND		1.0	0.31	ug/L			04/17/15 05:14	1
1,1,2-Trichloroethane	ND		1.0	0.23	ug/L			04/17/15 05:14	1
1,1-Dichloroethane	ND		1.0	0.38	ug/L			04/17/15 05:14	1
1,1-Dichloroethene	ND		1.0	0.29	ug/L			04/17/15 05:14	1
1,2,4-Trichlorobenzene	ND		1.0	0.41	ug/L			04/17/15 05:14	1
1,2-Dibromo-3-Chloropropane	ND		1.0	0.39	ug/L			04/17/15 05:14	1
1,2-Dibromoethane	ND		1.0	0.73	ug/L			04/17/15 05:14	1
1,2-Dichlorobenzene	ND		1.0	0.79	ug/L			04/17/15 05:14	1
1,2-Dichloroethane	ND		1.0	0.21	ug/L			04/17/15 05:14	1
1,2-Dichloropropane	ND		1.0	0.72	ug/L			04/17/15 05:14	1
1,3-Dichlorobenzene	ND		1.0	0.78	ug/L			04/17/15 05:14	1
1,4-Dichlorobenzene	ND		1.0	0.84	ug/L			04/17/15 05:14	1
2-Butanone (MEK)	ND		10	1.3	ug/L			04/17/15 05:14	1
2-Hexanone	ND		5.0	1.2	ug/L			04/17/15 05:14	1
4-Methyl-2-pentanone (MIBK)	ND		5.0	2.1	ug/L			04/17/15 05:14	1
<b>Acetone</b>	<b>3.5</b>	<b>J</b>	10	3.0	ug/L			04/17/15 05:14	1
Benzene	ND		1.0	0.41	ug/L			04/17/15 05:14	1
Bromodichloromethane	ND		1.0	0.39	ug/L			04/17/15 05:14	1
Bromoform	ND		1.0	0.26	ug/L			04/17/15 05:14	1
Bromomethane	ND		1.0	0.69	ug/L			04/17/15 05:14	1
Carbon disulfide	ND		1.0	0.19	ug/L			04/17/15 05:14	1
Carbon tetrachloride	ND		1.0	0.27	ug/L			04/17/15 05:14	1
Chlorobenzene	ND		1.0	0.75	ug/L			04/17/15 05:14	1
Chloroethane	ND		1.0	0.32	ug/L			04/17/15 05:14	1
Chloroform	ND		1.0	0.34	ug/L			04/17/15 05:14	1
Chloromethane	ND		1.0	0.35	ug/L			04/17/15 05:14	1
cis-1,2-Dichloroethene	ND		1.0	0.81	ug/L			04/17/15 05:14	1
cis-1,3-Dichloropropene	ND		1.0	0.36	ug/L			04/17/15 05:14	1
Cyclohexane	ND		1.0	0.18	ug/L			04/17/15 05:14	1
Dibromochloromethane	ND		1.0	0.32	ug/L			04/17/15 05:14	1
Dichlorodifluoromethane	ND		1.0	0.68	ug/L			04/17/15 05:14	1
Ethylbenzene	ND		1.0	0.74	ug/L			04/17/15 05:14	1
Isopropylbenzene	ND		1.0	0.79	ug/L			04/17/15 05:14	1
Methyl acetate	ND		2.5	0.50	ug/L			04/17/15 05:14	1
Methyl tert-butyl ether	ND		1.0	0.16	ug/L			04/17/15 05:14	1
Methylcyclohexane	ND		1.0	0.16	ug/L			04/17/15 05:14	1
<b>Methylene Chloride</b>	<b>1.5</b>	<b>B</b>	1.0	0.44	ug/L			04/17/15 05:14	1
Styrene	ND		1.0	0.73	ug/L			04/17/15 05:14	1
Tetrachloroethene	ND		1.0	0.36	ug/L			04/17/15 05:14	1
Toluene	ND		1.0	0.51	ug/L			04/17/15 05:14	1
trans-1,2-Dichloroethene	ND		1.0	0.90	ug/L			04/17/15 05:14	1
trans-1,3-Dichloropropene	ND		1.0	0.37	ug/L			04/17/15 05:14	1
Trichloroethene	ND		1.0	0.46	ug/L			04/17/15 05:14	1
Trichlorofluoromethane	ND		1.0	0.88	ug/L			04/17/15 05:14	1
Vinyl chloride	ND		1.0	0.90	ug/L			04/17/15 05:14	1
Xylenes, Total	ND		2.0	0.66	ug/L			04/17/15 05:14	1

TestAmerica Buffalo

# Client Sample Results

Client: AECOM, Inc.  
Project/Site: Scott Aviation site

TestAmerica Job ID: 480-77895-1

## Client Sample ID: EFFLUENT

Lab Sample ID: 480-77895-1

Date Collected: 04/06/15 08:00

Matrix: Water

Date Received: 04/07/15 17:15

Surrogate	%Recovery	Qualifier	Limits	Prepared	Analyzed	Dil Fac
1,2-Dichloroethane-d4 (Surr)	111		66 - 137		04/17/15 05:14	1
4-Bromofluorobenzene (Surr)	103		73 - 120		04/17/15 05:14	1
Toluene-d8 (Surr)	100		71 - 126		04/17/15 05:14	1

### General Chemistry

Analyte	Result	Qualifier	RL	MDL	Unit	D	Prepared	Analyzed	Dil Fac
Total Petroleum Hydrocarbons (1664A)	ND		5.0	1.9	mg/L		04/15/15 02:45	04/15/15 02:58	1
<b>Total Suspended Solids</b>	<b>4.0</b>		4.0	4.0	mg/L			04/10/15 11:56	1
<b>pH</b>	<b>8.27</b>	<b>HF</b>	0.100	0.100	SU			04/14/15 10:20	1



# Client Sample Results

Client: AECOM, Inc.  
Project/Site: Scott Aviation site

TestAmerica Job ID: 480-77895-1

**Client Sample ID: INFLUENT**

**Lab Sample ID: 480-77895-2**

**Date Collected: 04/06/15 08:00**

**Matrix: Water**

**Date Received: 04/07/15 17:15**

**Method: 8260C - Volatile Organic Compounds by GC/MS**

Analyte	Result	Qualifier	RL	MDL	Unit	D	Prepared	Analyzed	Dil Fac
1,1,1-Trichloroethane	ND		1.0	0.82	ug/L			04/17/15 05:37	1
1,1,2,2-Tetrachloroethane	ND		1.0	0.21	ug/L			04/17/15 05:37	1
1,1,2-Trichloro-1,2,2-trifluoroethane	ND		1.0	0.31	ug/L			04/17/15 05:37	1
1,1,2-Trichloroethane	ND		1.0	0.23	ug/L			04/17/15 05:37	1
<b>1,1-Dichloroethane</b>	<b>0.83</b>	<b>J</b>	1.0	0.38	ug/L			04/17/15 05:37	1
1,1-Dichloroethene	ND		1.0	0.29	ug/L			04/17/15 05:37	1
1,2,4-Trichlorobenzene	ND		1.0	0.41	ug/L			04/17/15 05:37	1
1,2-Dibromo-3-Chloropropane	ND		1.0	0.39	ug/L			04/17/15 05:37	1
1,2-Dibromoethane	ND		1.0	0.73	ug/L			04/17/15 05:37	1
1,2-Dichlorobenzene	ND		1.0	0.79	ug/L			04/17/15 05:37	1
1,2-Dichloroethane	ND		1.0	0.21	ug/L			04/17/15 05:37	1
1,2-Dichloropropane	ND		1.0	0.72	ug/L			04/17/15 05:37	1
1,3-Dichlorobenzene	ND		1.0	0.78	ug/L			04/17/15 05:37	1
1,4-Dichlorobenzene	ND		1.0	0.84	ug/L			04/17/15 05:37	1
2-Butanone (MEK)	ND		10	1.3	ug/L			04/17/15 05:37	1
2-Hexanone	ND		5.0	1.2	ug/L			04/17/15 05:37	1
4-Methyl-2-pentanone (MIBK)	ND		5.0	2.1	ug/L			04/17/15 05:37	1
<b>Acetone</b>	<b>3.3</b>	<b>J</b>	10	3.0	ug/L			04/17/15 05:37	1
Benzene	ND		1.0	0.41	ug/L			04/17/15 05:37	1
Bromodichloromethane	ND		1.0	0.39	ug/L			04/17/15 05:37	1
Bromoform	ND		1.0	0.26	ug/L			04/17/15 05:37	1
Bromomethane	ND		1.0	0.69	ug/L			04/17/15 05:37	1
Carbon disulfide	ND		1.0	0.19	ug/L			04/17/15 05:37	1
Carbon tetrachloride	ND		1.0	0.27	ug/L			04/17/15 05:37	1
Chlorobenzene	ND		1.0	0.75	ug/L			04/17/15 05:37	1
<b>Chloroethane</b>	<b>70</b>		1.0	0.32	ug/L			04/17/15 05:37	1
Chloroform	ND		1.0	0.34	ug/L			04/17/15 05:37	1
Chloromethane	ND		1.0	0.35	ug/L			04/17/15 05:37	1
cis-1,2-Dichloroethene	ND		1.0	0.81	ug/L			04/17/15 05:37	1
cis-1,3-Dichloropropene	ND		1.0	0.36	ug/L			04/17/15 05:37	1
Cyclohexane	ND		1.0	0.18	ug/L			04/17/15 05:37	1
Dibromochloromethane	ND		1.0	0.32	ug/L			04/17/15 05:37	1
Dichlorodifluoromethane	ND		1.0	0.68	ug/L			04/17/15 05:37	1
Ethylbenzene	ND		1.0	0.74	ug/L			04/17/15 05:37	1
Isopropylbenzene	ND		1.0	0.79	ug/L			04/17/15 05:37	1
Methyl acetate	ND		2.5	0.50	ug/L			04/17/15 05:37	1
Methyl tert-butyl ether	ND		1.0	0.16	ug/L			04/17/15 05:37	1
Methylcyclohexane	ND		1.0	0.16	ug/L			04/17/15 05:37	1
Methylene Chloride	ND		1.0	0.44	ug/L			04/17/15 05:37	1
Styrene	ND		1.0	0.73	ug/L			04/17/15 05:37	1
Tetrachloroethene	ND		1.0	0.36	ug/L			04/17/15 05:37	1
<b>Toluene</b>	<b>1.9</b>		1.0	0.51	ug/L			04/17/15 05:37	1
trans-1,2-Dichloroethene	ND		1.0	0.90	ug/L			04/17/15 05:37	1
trans-1,3-Dichloropropene	ND		1.0	0.37	ug/L			04/17/15 05:37	1
Trichloroethene	ND		1.0	0.46	ug/L			04/17/15 05:37	1
Trichlorofluoromethane	ND		1.0	0.88	ug/L			04/17/15 05:37	1
Vinyl chloride	ND		1.0	0.90	ug/L			04/17/15 05:37	1
Xylenes, Total	ND		2.0	0.66	ug/L			04/17/15 05:37	1

TestAmerica Buffalo

# Client Sample Results

Client: AECOM, Inc.  
Project/Site: Scott Aviation site

TestAmerica Job ID: 480-77895-1

**Client Sample ID: INFLUENT**

**Lab Sample ID: 480-77895-2**

**Date Collected: 04/06/15 08:00**

**Matrix: Water**

**Date Received: 04/07/15 17:15**

Surrogate	%Recovery	Qualifier	Limits	Prepared	Analyzed	Dil Fac
1,2-Dichloroethane-d4 (Surr)	113		66 - 137		04/17/15 05:37	1
4-Bromofluorobenzene (Surr)	105		73 - 120		04/17/15 05:37	1
Toluene-d8 (Surr)	99		71 - 126		04/17/15 05:37	1

## General Chemistry

Analyte	Result	Qualifier	RL	MDL	Unit	D	Prepared	Analyzed	Dil Fac
Total Petroleum Hydrocarbons (1664A)	ND		5.0	1.9	mg/L		04/15/15 02:45	04/15/15 02:58	1
Total Suspended Solids	ND		4.0	4.0	mg/L			04/10/15 11:56	1
pH	7.55	HF	0.100	0.100	SU			04/14/15 10:20	1

# Client Sample Results

Client: AECOM, Inc.  
Project/Site: Scott Aviation site

TestAmerica Job ID: 480-77895-1

**Client Sample ID: Trip Blank**

**Lab Sample ID: 480-77895-3**

**Date Collected: 04/06/15 08:00**

**Matrix: Water**

**Date Received: 04/07/15 17:15**

**Method: 8260C - Volatile Organic Compounds by GC/MS**

Analyte	Result	Qualifier	RL	MDL	Unit	D	Prepared	Analyzed	Dil Fac
1,1,1-Trichloroethane	ND		1.0	0.82	ug/L			04/15/15 18:56	1
1,1,2,2-Tetrachloroethane	ND		1.0	0.21	ug/L			04/15/15 18:56	1
1,1,2-Trichloro-1,2,2-trifluoroethane	ND		1.0	0.31	ug/L			04/15/15 18:56	1
1,1,2-Trichloroethane	ND		1.0	0.23	ug/L			04/15/15 18:56	1
1,1-Dichloroethane	ND		1.0	0.38	ug/L			04/15/15 18:56	1
1,1-Dichloroethene	ND		1.0	0.29	ug/L			04/15/15 18:56	1
1,2,4-Trichlorobenzene	ND		1.0	0.41	ug/L			04/15/15 18:56	1
1,2-Dibromo-3-Chloropropane	ND		1.0	0.39	ug/L			04/15/15 18:56	1
1,2-Dibromoethane	ND		1.0	0.73	ug/L			04/15/15 18:56	1
1,2-Dichlorobenzene	ND		1.0	0.79	ug/L			04/15/15 18:56	1
1,2-Dichloroethane	ND		1.0	0.21	ug/L			04/15/15 18:56	1
1,2-Dichloropropane	ND		1.0	0.72	ug/L			04/15/15 18:56	1
1,3-Dichlorobenzene	ND		1.0	0.78	ug/L			04/15/15 18:56	1
1,4-Dichlorobenzene	ND		1.0	0.84	ug/L			04/15/15 18:56	1
2-Butanone (MEK)	ND		10	1.3	ug/L			04/15/15 18:56	1
2-Hexanone	ND		5.0	1.2	ug/L			04/15/15 18:56	1
4-Methyl-2-pentanone (MIBK)	ND		5.0	2.1	ug/L			04/15/15 18:56	1
Acetone	ND		10	3.0	ug/L			04/15/15 18:56	1
Benzene	ND		1.0	0.41	ug/L			04/15/15 18:56	1
Bromodichloromethane	ND		1.0	0.39	ug/L			04/15/15 18:56	1
Bromoform	ND		1.0	0.26	ug/L			04/15/15 18:56	1
Bromomethane	ND		1.0	0.69	ug/L			04/15/15 18:56	1
Carbon disulfide	ND		1.0	0.19	ug/L			04/15/15 18:56	1
Carbon tetrachloride	ND		1.0	0.27	ug/L			04/15/15 18:56	1
Chlorobenzene	ND		1.0	0.75	ug/L			04/15/15 18:56	1
Chloroethane	ND		1.0	0.32	ug/L			04/15/15 18:56	1
Chloroform	ND		1.0	0.34	ug/L			04/15/15 18:56	1
Chloromethane	ND	*	1.0	0.35	ug/L			04/15/15 18:56	1
cis-1,2-Dichloroethene	ND		1.0	0.81	ug/L			04/15/15 18:56	1
cis-1,3-Dichloropropene	ND		1.0	0.36	ug/L			04/15/15 18:56	1
Cyclohexane	ND		1.0	0.18	ug/L			04/15/15 18:56	1
Dibromochloromethane	ND	*	1.0	0.32	ug/L			04/15/15 18:56	1
Dichlorodifluoromethane	ND	*	1.0	0.68	ug/L			04/15/15 18:56	1
Ethylbenzene	ND		1.0	0.74	ug/L			04/15/15 18:56	1
Isopropylbenzene	ND		1.0	0.79	ug/L			04/15/15 18:56	1
Methyl acetate	ND		2.5	0.50	ug/L			04/15/15 18:56	1
Methyl tert-butyl ether	ND		1.0	0.16	ug/L			04/15/15 18:56	1
Methylcyclohexane	ND		1.0	0.16	ug/L			04/15/15 18:56	1
Methylene Chloride	ND		1.0	0.44	ug/L			04/15/15 18:56	1
Styrene	ND		1.0	0.73	ug/L			04/15/15 18:56	1
Tetrachloroethene	ND		1.0	0.36	ug/L			04/15/15 18:56	1
Toluene	ND		1.0	0.51	ug/L			04/15/15 18:56	1
trans-1,2-Dichloroethene	ND		1.0	0.90	ug/L			04/15/15 18:56	1
trans-1,3-Dichloropropene	ND		1.0	0.37	ug/L			04/15/15 18:56	1
Trichloroethene	ND		1.0	0.46	ug/L			04/15/15 18:56	1
Trichlorofluoromethane	ND		1.0	0.88	ug/L			04/15/15 18:56	1
Vinyl chloride	ND		1.0	0.90	ug/L			04/15/15 18:56	1
Xylenes, Total	ND		2.0	0.66	ug/L			04/15/15 18:56	1

TestAmerica Buffalo

# Client Sample Results

Client: AECOM, Inc.  
Project/Site: Scott Aviation site

TestAmerica Job ID: 480-77895-1

**Client Sample ID: Trip Blank**

**Lab Sample ID: 480-77895-3**

**Date Collected: 04/06/15 08:00**

**Matrix: Water**

**Date Received: 04/07/15 17:15**

<i>Surrogate</i>	<i>%Recovery</i>	<i>Qualifier</i>	<i>Limits</i>	<i>Prepared</i>	<i>Analyzed</i>	<i>Dil Fac</i>
1,2-Dichloroethane-d4 (Surr)	114		66 - 137		04/15/15 18:56	1
4-Bromofluorobenzene (Surr)	111		73 - 120		04/15/15 18:56	1
Toluene-d8 (Surr)	101		71 - 126		04/15/15 18:56	1

# Lab Chronicle

Client: AECOM, Inc.  
Project/Site: Scott Aviation site

TestAmerica Job ID: 480-77895-1

## Client Sample ID: EFFLUENT

Date Collected: 04/06/15 08:00

Date Received: 04/07/15 17:15

## Lab Sample ID: 480-77895-1

Matrix: Water

Prep Type	Batch Type	Batch Method	Run	Dilution Factor	Batch Number	Prepared or Analyzed	Analyst	Lab
Total/NA	Analysis	8260C		1	236713	04/17/15 05:14	LJF	TAL BUF
Total/NA	Prep	1664A			236197	04/15/15 02:45	LAW	TAL BUF
Total/NA	Analysis	1664A		1	236198	04/15/15 02:58	LAW	TAL BUF
Total/NA	Analysis	SM 2540D		1	235400	04/10/15 11:56	RP	TAL BUF
Total/NA	Analysis	SM 4500 H+ B		1	236150	04/14/15 10:20	LED	TAL BUF

## Client Sample ID: INFLUENT

Date Collected: 04/06/15 08:00

Date Received: 04/07/15 17:15

## Lab Sample ID: 480-77895-2

Matrix: Water

Prep Type	Batch Type	Batch Method	Run	Dilution Factor	Batch Number	Prepared or Analyzed	Analyst	Lab
Total/NA	Analysis	8260C		1	236713	04/17/15 05:37	LJF	TAL BUF
Total/NA	Prep	1664A			236197	04/15/15 02:45	LAW	TAL BUF
Total/NA	Analysis	1664A		1	236198	04/15/15 02:58	LAW	TAL BUF
Total/NA	Analysis	SM 2540D		1	235400	04/10/15 11:56	RP	TAL BUF
Total/NA	Analysis	SM 4500 H+ B		1	236150	04/14/15 10:20	LED	TAL BUF

## Client Sample ID: Trip Blank

Date Collected: 04/06/15 08:00

Date Received: 04/07/15 17:15

## Lab Sample ID: 480-77895-3

Matrix: Water

Prep Type	Batch Type	Batch Method	Run	Dilution Factor	Batch Number	Prepared or Analyzed	Analyst	Lab
Total/NA	Analysis	8260C		1	236247	04/15/15 18:56	GTG	TAL BUF

**Laboratory References:**

TAL BUF = TestAmerica Buffalo, 10 Hazelwood Drive, Amherst, NY 14228-2298, TEL (716)691-2600

# Certification Summary

Client: AECOM, Inc.  
Project/Site: Scott Aviation site

TestAmerica Job ID: 480-77895-1

## Laboratory: TestAmerica Buffalo

Unless otherwise noted, all analytes for this laboratory were covered under each certification below.

Authority	Program	EPA Region	Certification ID	Expiration Date
New York	NELAP	2	10026	03-31-16

The following analytes are included in this report, but certification is not offered by the governing authority:

Analysis Method	Prep Method	Matrix	Analyte
SM 4500 H+ B		Water	pH

# Method Summary

Client: AECOM, Inc.  
Project/Site: Scott Aviation site

TestAmerica Job ID: 480-77895-1

Method	Method Description	Protocol	Laboratory
8260C	Volatile Organic Compounds by GC/MS	SW846	TAL BUF
1664A	HEM and SGT-HEM	1664A	TAL BUF
SM 2540D	Solids, Total Suspended (TSS)	SM	TAL BUF
SM 4500 H+ B	pH	SM	TAL BUF

**Protocol References:**

1664A = EPA-821-98-002

SM = "Standard Methods For The Examination Of Water And Wastewater",

SW846 = "Test Methods For Evaluating Solid Waste, Physical/Chemical Methods", Third Edition, November 1986 And Its Updates.

**Laboratory References:**

TAL BUF = TestAmerica Buffalo, 10 Hazelwood Drive, Amherst, NY 14228-2298, TEL (716)691-2600



# Sample Summary

Client: AECOM, Inc.  
Project/Site: Scott Aviation site

TestAmerica Job ID: 480-77895-1

Lab Sample ID	Client Sample ID	Matrix	Collected	Received
480-77895-1	EFFLUENT	Water	04/06/15 08:00	04/07/15 17:15
480-77895-2	INFLUENT	Water	04/06/15 08:00	04/07/15 17:15
480-77895-3	Trip Blank	Water	04/06/15 08:00	04/07/15 17:15

- 1
- 2
- 3
- 4
- 5
- 6
- 7
- 8
- 9
- 10
- 11



## Login Sample Receipt Checklist

Client: AECOM, Inc.

Job Number: 480-77895-1

**Login Number: 77895**

**List Source: TestAmerica Buffalo**

**List Number: 1**

**Creator: Kolb, Chris M**

Question	Answer	Comment
Radioactivity either was not measured or, if measured, is at or below background	True	
The cooler's custody seal, if present, is intact.	True	
The cooler or samples do not appear to have been compromised or tampered with.	True	
Samples were received on ice.	True	
Cooler Temperature is acceptable.	True	
Cooler Temperature is recorded.	True	
COC is present.	True	
COC is filled out in ink and legible.	True	
COC is filled out with all pertinent information.	True	
Is the Field Sampler's name present on COC?	True	
There are no discrepancies between the sample IDs on the containers and the COC.	True	
Samples are received within Holding Time.	True	
Sample containers have legible labels.	True	
Containers are not broken or leaking.	True	
Sample collection date/times are provided.	True	
Appropriate sample containers are used.	True	
Sample bottles are completely filled.	True	
Sample Preservation Verified	True	
There is sufficient vol. for all requested analyses, incl. any requested MS/MSDs	True	
VOA sample vials do not have headspace or bubble is <6mm (1/4") in diameter.	True	
If necessary, staff have been informed of any short hold time or quick TAT needs	True	
Multiphasic samples are not present.	True	
Samples do not require splitting or compositing.	True	
Sampling Company provided.	True	AECOM
Samples received within 48 hours of sampling.	True	
Samples requiring field filtration have been filtered in the field.	True	
Chlorine Residual checked.	N/A	



# TestAmerica

THE LEADER IN ENVIRONMENTAL TESTING

Temperature on Receipt \_\_\_\_\_  
 Drinking Water? Yes  No

## Chain of Custody Record

TAL-4124 (1007)

**Client:** AECOM **Project Manager:** Dino Zack **Date:** 4-6-15 **Chain of Custody Number:** 276435

**Address:** 100 Corporate Pkwy, Ste 341 **Telephone Number (Area Code)/Fax Number:** 716 836 4506 **Lab Number:** \_\_\_\_\_ **Page:** 1 of 1

**City:** Amherst **State:** NY **Zip Code:** 14226 **Site Contact:** D. Zack **Lab Contact:** B. Fischer

**Project Name and Location (State):** Scott Aviation Site (NY) **Carrier/Waybill Number:** \_\_\_\_\_

**Contract/Purchase Order/Quote No.:** \_\_\_\_\_

Sample I.D. No. and Description (Containers for each sample may be combined on one line)	Date	Time	Matrix						Containers & Preservatives						Analysis (Attach list if more space is needed)	Special Instructions/Conditions of Receipt						
			Air	Ambient	Sed	Soil	Unpres	H2SO4	HNO3	HCl	NaOH	ZnAc/NaOH	PH	8360B			8540D TSS	SM4500 PH				
Influent 2Q2015	4-6-15	8:00	X					22	8							X	X	X				
Effluent 2Q2015	4-6-15	8:00	X					22	8							X	X	X				
Trip Blank	4-6-15	8:00	X						3							X						

**Barcode:** 480-77895 Chain of Custody

**Possible Hazard Identification:**  
 Non-Hazard  Flammable  Skin Irritant  Poison B  Unknown  Return to Client  Disposal By Lab  Archive For \_\_\_\_\_ Months (A fee may be assessed if samples are retained longer than 1 month)

**Turn Around Time Required:**  
 24 Hours  48 Hours  7 Days  14 Days  21 Days  Other: STANDARD

**QC Requirements (Specify):**  
 1. Received By: [Signature] Date: 4-7-15 Time: 17:15  
 2. Received By: [Signature] Date: \_\_\_\_\_ Time: \_\_\_\_\_  
 3. Received By: [Signature] Date: \_\_\_\_\_ Time: \_\_\_\_\_

**Comments:** Please composite influent Grab #1 #2 #3 #4 and composite Effluent Grab #1 #2 #3 #4

**DISTRIBUTION:** WHITE - Returned to Client with Report; CANARY - Stays with the Sample; PINK - Field Copy

