



NEW YORK STATE DEPARTMENT OF ENVIRONMENTAL CONSERVATION  
 DIVISION OF ENVIRONMENTAL REMEDIATION  
**Site Classification Report**



DATE: 5/14/2013

<b>Site Code:</b> 915274	<b>Site Name:</b> Tonawanda Forge Site
<b>City:</b> Tonawanda	<b>Town:</b> Tonawanda
<b>Region:</b> 9	<b>County:</b> Erie
<b>Current Classification:</b> P	<b>Proposed Classification:</b> 02
<b>Estimated Size (acres):</b> 33.20	<b>Disposal Area:</b> Structure
<b>Significant Threat:</b> Yes	<b>Site Type:</b>
<b>Priority ranking Score:</b>	<b>Project Manager:</b> David Chiusano

**Summary of Approvals**

<b>Originator/Supervisor:</b> Gerard Burke	<b>03/20/2013</b>
<b>RHWRE:</b> Gregory Sutton / Martin Doster:	<b>03/20/2013</b>
<b>BEEI of NYSDOH:</b>	<b>04/18/2013</b>
<b>CO Bureau Director:</b> Michael Cruden, Director, Remedial Bureau E:	<b>04/18/2013</b>
<b>Assistant Division Director:</b> Michael J. Ryan, P.E.:	<b>04/23/2013</b>

**Basis for Classification Change**

Hazardous waste levels of contamination has been confirmed at the site as result of the spill from PCB transformer on site that resulted in PCB contamination of surface structures and site surface water. Site surface water conc. of PCBs significantly exceed water quality limits and a surface water release to the Niagara River, a Class A Special International Waterway, is possible through the local stormwater system.

**Site Description - Last Review: 04/12/2013**

**Location:** The Tonawanda Forge Site is located in an urban area at 2390 Kenmore Avenue in the Town of Tonawanda, Erie County. The site is approximately 2,300 feet southeast of the intersection of Kenmore Ave. and Sheridan Drive.

**Site Features:** The main site features of the 33.2 acre site include two remaining brick multi-story buildings which were part of the original manufacturing complex. The remaining three-quarters of the southern portion of the site consist of the building floor slab, parking lots or driveways. A large grassed area along Kenmore area consists of a former landfill area on the site.

**Current Zoning and Land Use:** The site is currently inactive, and is zoned for heavy industrial use. The surrounding parcels are currently used for heavy industrial applications however a residential area is located 500 feet directly south of the site.



**NEW YORK STATE DEPARTMENT OF ENVIRONMENTAL CONSERVATION  
DIVISION OF ENVIRONMENTAL REMEDIATION  
Site Classification Report**



DATE: 5/14/2013

**Site Code:** 915274

**Site Name:** Tonawanda Forge Site

Past Use of the Site: The property was originally part of the General Motors - Tonawanda Engine Plant facility that borders the site to the north, west and south. The forge facility was sold in 1994 to American Axle and Manufacturing, Inc. (American Axle). In 2008, American Axle sold the property to the current owner, Lewis Brothers, LLC (Lewis), of Richmond, Virginia. Upon sale of the property, Lewis began the demolition of the facility starting with the removal of the interior equipment and ending with the removal of all of the buildings superstructure. Upon the owner's refusal to expeditiously address petroleum contamination on the site and in violation of a stipulation agreement with DEC, DEC proceeded with the remediation of petroleum contaminated and a Site Characterization of the property under Spill Site number 0911809. During the demolition of the building, a subcontractor did not properly address a PCB transformer which resulted in a release of PCB oil within the facility. Again, upon the subcontractor and property owner's refusal to adequately address the spill in a timely manner, DEC instituted clean-up procedures under Spill Site number 1112690. While the majority this contamination has been addressed, the site surface water continues to exhibit elevated levels of PCBs above water quality limits. In addition, several areas of the site also exhibit PCB concentration above the regulatory criteria for a hazardous waste.

Site Geology and Hydrogeology: Soil boring results from the subsurface investigation revealed brown silt and clay and some clay with a trace of gravel to a depth of the termination of each soil boring. Bedrock was not encountered at depths up to 24 feet bgs but is believed to consist of the Upper Silurian-aged Salina Group, which generally consists of shale, and Dolostone.

Depth to groundwater at the property ranged from 0.5 feet to 15.82 feet. The local groundwater flow direction is estimated to be west towards the Niagara River, and may be influenced by local drainage features, seasonal groundwater level fluctuations, subsurface geology, surface topography, and/or other local site features.

---

**Contaminants of Concern (Including Materials Disposed)**

**Quantity Disposed**

**OU 01**

- PCB-AROCLOR 1254
- PCB-AROCLOR 1242
- PCB-AROCLOR 1248
- PCB-AROCLOR 1260

---

**Analytical Data Available for :** Groundwater, Surface Water, Soil, Sediment

**Applicable Standards Exceeded for:** Groundwater, Surface Water, Soil

---

**Site Environmental Assessment- Last Review: 04/12/2013**

Based upon investigations conducted to date, the primary contaminants of concern for OU 1 include PCBs and various petroleum products.

Primary concern at the site is the elevated levels of PCBs in surface water across the site property. While the storm water sewer remains in place, the outlets have been blocked at the property boundaries by the adjacent property owner (GMHC) in order to prevent contaminated surface water from entering their property. This has resulted in storm water ponding across the site. This surface water contains PCBs at concentrations of approximately 1 part per billion (ppb) which exceeds the water quality limit of 0.065 ppb. The source of the PCBs on site have not been determined to date.



NEW YORK STATE DEPARTMENT OF ENVIRONMENTAL CONSERVATION  
 DIVISION OF ENVIRONMENTAL REMEDIATION  
**Site Classification Report**



DATE: 5/14/2013

**Site Code:** 915274

**Site Name:** Tonawanda Forge Site

**Site Health Assessment - Last Update: 03/21/2013**

The site is completely fenced, which restricts public access. However, persons who enter the site could contact contaminants in the impounded surface waters. The NYSDOH will evaluate the potential for exposures to site-related contaminants once additional information from the investigation of the site becomes available.

	Start		End	
<b>OU 01</b>				
OGC Docket - SSF Order or Referral	5/17/13	PLN	6/28/13	PLN
Reclass Pkg.	2/21/13	ACT	5/14/13	ACT
Remedial Investigation	6/30/13	PLN	6/30/15	PLN

**Remedy Description and Cost**

**Remedy Description for Operable Unit 01**

**Total Cost**

<b>OU</b>	<b>Site Management Plan Approval:</b>	<b>Status:</b>
-----------	---------------------------------------	----------------



NEW YORK STATE DEPARTMENT OF ENVIRONMENTAL CONSERVATION  
 DIVISION OF ENVIRONMENTAL REMEDIATION  
**Site Classification Report**



DATE: 5/14/2013

**Site Code:** 915274

**Site Name:** Tonawanda Forge Site

NEW YORK STATE DEPARTMENT OF ENVIRONMENTAL CONSERVATION  
**Site Management Form**  
 5/14/2013

**SITE DESCRIPTION**

**SITE NO.** 915274

**SITE NAME** Tonawanda Forge Site

**SITE ADDRESS:** 2390 KENMORE AVENUE ZIP CODE: 14150

**CITY/TOWN:** Tonawanda

**COUNTY:** Erie

**ALLOWABLE USE:**

**SITE MANAGEMENT DESCRIPTION**

**SITE MANAGEMENT PLAN INCLUDES:** YES NO

- IC/EC Certification Plan
- Monitoring Plan
- Operation and Maintenance (O&M) Plan

Periodic Review Frequency:

Periodic Review Report Submittal Date:



NEW YORK STATE DEPARTMENT OF ENVIRONMENTAL CONSERVATION  
DIVISION OF ENVIRONMENTAL REMEDIATION  
**Site Classification Report**



DATE: 5/14/2013

**Site Code:** 915274

**Site Name:** Tonawanda Forge Site

**Description of Institutional Control**

0

Not Applicable/No IC's

**Description of Engineering Control**

Not Applicable/No EC's



**PUBLIC NOTICE**

**State Superfund Program**

\*Receive Site Information by *Email*. See **For More Information** to learn how.

**Site Name:** Tonawanda Forge Site

May 14, 2013

**Site No.** 915274      **Tax Map No.** 65.18-2-1

**Site Location:** 2390 Kenmore Avenue, Town of Tonawanda, Erie County 14150

**Inactive Hazardous Waste Disposal Site Classification Notice**

The Inactive Hazardous Waste Disposal Site Program (the State Superfund Program) is the State's program for identifying, investigating, and cleaning up sites where the disposal of hazardous waste may present a threat to public health and/or the environment. The New York State Department of Environmental Conservation (DEC) maintains a list of these sites in the Registry of Inactive Hazardous Waste Disposal Sites (the "Registry"). The site identified above, and located on a map on the reverse side of this page, was recently added to the Registry as a Class 2 site that presents a significant threat to public health and/or the environment for the following reason(s):

The site is currently vacant and contains an area of ponded water containing elevated levels of polychlorinated biphenyls (PCBs) above water quality standards. All potential drainage-ways from this area have been blocked to reduce the potential for off-site contaminant migration. Additional sampling is needed to define the nature and extent of contamination and to evaluate the potential for exposures on and off the site.

DEC will keep you informed throughout the investigation and cleanup of the site.

**If you own property adjacent to this site and are renting or leasing your property to someone else, please share this information with them. If you no longer wish to be on the contact list for this site or otherwise need to correct our records, please contact DEC's Project Manager listed below.**

**FOR MORE SITE INFORMATION**

Additional information about this site can be found using DEC's "Environmental Site Remediation Database Search" engine which is located on the internet at:

[www.dec.ny.gov/cfm/external/derexternal/index.cfm?pageid=3](http://www.dec.ny.gov/cfm/external/derexternal/index.cfm?pageid=3)

Comments and questions are always welcome and should be directed as follows:

Project Related Questions

David Chiusano, Project Manager  
NYS Department of Env. Conservation  
Div of Environmental Remediation  
625 Broadway; 12<sup>th</sup> Floor  
Albany, NY 12233-7017  
djchiusa@gw.dec.state.ny.us  
518-402-9814

Site Related Health Questions

Matt Forcucci, Environmental Specialist  
NYS Department of Health  
584 Delaware Avenue  
Buffalo, NY 14202  
bee@health.state.ny.us  
716-847-4501

DEC is sending you this notice in accordance with Environmental Conservation Law Article 27, Title 13 and its companion regulation (6 NYCRR 375-2.7(b)(6)(ii)) which requires the Department to notify all parties on the contact list for this site of this recent action.



**Approximate Site Location**

Tonawanda Forge Site

Site ID: 915274

2390 Kenmore Avenue

Town of Tonawanda, NY 14150



**FOR MORE INFORMATION**

**Receive Site Updates by Email**

Have site information such as this public notice sent right to your email inbox. DEC invites you to sign up with one or more contaminated sites county email listservs available at the following web page: [www.dec.ny.gov/chemical/61092.html](http://www.dec.ny.gov/chemical/61092.html) . It's *quick*, it's *free*, and it will help keep you *better informed*.



As a listserv member, you will periodically receive site-related information/announcements for all contaminated sites in the county(ies) you select.

You may continue also to receive paper copies of site information for a time after you sign up with a county listserv, until the transition to electronic distribution is complete.

**Note:** Please disregard if you received this notice by way of a county email listserv.

**Electronic copies:**

R. Schick, Director, Division of Environmental Remediation  
A. English, Director, Bureau of Technical Support  
K. Lewandowski, Chief, Site Control Section  
M. Cruden, Director, Remedial Bureau E  
G. Sutton, RHWRE, Region 9  
D. Chiusano, Project Manager  
D. Denk, Regional Permit Administrator, Region 9  
K. Davidson, Regional CPS, Region 9  
K. Anders, NYSDOH  
L. Ennist, DER, Bureau of Program Management  
B. Anderson, Site Control Section



Lewis Bros. LLC  
466 Southlake Blvd.  
Richmond, VA 23236

REL LLC  
7310 Chestnut Ridge Rd.  
Lockport, NY 14094

Curent Occupant  
2321 Kenmore Ave  
Buffalo, NY 14207

CSX Transporatation  
500 Water Street  
Jacksonville, FL 32202

National Grid  
300 Erie Blvd  
Syracuse, NY 13202

Wolf River LLC  
1502 Niagara Street  
Buffalo, NY 14213

Anthony F. Caruana  
Supervisor, Town of Tonawanda  
2919 Delaware Ave.  
Kenmore, NY 14217

Carleton Zeisz  
Councilman, Town of Tonawanda  
200 Niagara St  
Tonawanda, NY 14150

Mark Poloncarz  
County Executive, Erie County  
95 Franklin St., Rath Bldg.  
Buffalo, NY 14202

Timothy R. Hogues  
County Legislator, Erie County  
427 William St.  
Buffalo, NY 14204

Ken Swanekamp  
Chairman, Town of Tonawanda  
Planning Board  
2919 Delaware Ave.  
Kenmore, NY 14217

Chairman, Erie County Water  
Authority  
295 Main Street, Rm 350  
Buffalo, NY 14203

Chairman, Erie County IDA  
143 Genesse Street  
Buffalo, NY 14203

Maria Whyte  
Erie Co. Dept. Envir. and Planning  
95 Franklin St., Rath Bldg.  
Buffalo, NY 14202

Hon. Mark Grisanti  
State Senator  
2255 Baseline Road, District 60  
Grand Island, NY 14072

Hon. Robin Schimminger  
State Assemblyman  
3514 Delaware Ave, District 140  
Kenmore, NY 14217

Hon. Brian Higgins  
U.S. Congressman  
Buffalo Office  
726 Exchange St., Suite 601  
Buffalo, NY 14210

Hon. Christopher Collins  
U.S. Congressman  
Buffalo Office  
2813 Wehrle Drive  
Williamsville, NY 14221

Hon. Charles E Schumer  
U.S. Senator  
Buffalo Office  
130 South Elmwood Avenue #660  
Buffalo, NY 14202

Hon. Kirsten Gillibrand  
U.S. Senator  
Buffalo Office  
726 Exchange Street, Suite 511,  
Buffalo, NY 14210

Gale R. Burstein, M.D.  
Commissioner  
Erie Co. Health Dept.  
95 Franklin Street, Rm 931  
Buffalo, NY 14202

**New York State Department of Environmental Conservation**  
**Division of Environmental Remediation**  
**Bureau of Technical Support, 11<sup>th</sup> Floor**  
625 Broadway, Albany, NY 12233-7020  
**Phone:** (518) 402-9543 • **Fax:** (518) 402-9547  
**Website:** [www.dec.ny.gov](http://www.dec.ny.gov)



**CERTIFIED MAIL**  
**RETURN RECEIPT REQUESTED**

April 24, 2013

Lewis Bros LLC  
Attn: Mr. Samuel Lewis  
466 Southlake Blvd.  
Richmond, VA 23236

Dear Mr. Lewis:

As mandated by Section 27-1305 of the Environmental Conservation Law (ECL), the New York State Department of Environmental Conservation (Department) must maintain a registry of all inactive disposal sites suspected or known to contain hazardous wastes. The ECL also mandates that this Department notify, by certified mail, the owner of all or any part of each site or area included in the Registry of Inactive Hazardous Waste Disposal Sites.

Our records indicate that you are the owner or part owner of the site listed below. Therefore, this letter constitutes notification of the inclusion of such site in the Registry of Inactive Hazardous Waste Disposal Sites in New York State. Once listed in the Registry, the site becomes subject to certain restrictions prescribed by provisions of 6 NYCRR Part 375. These regulations may be found at the following DEC website address:  
<http://www.dec.ny.gov/regs/4373.html>.

DEC Site No.: 915274  
Site Name: Tonawanda Forge Site  
Site Address: 2390 Kenmore Avenue, Tonawanda, NY 14150  
Site Classification: 2

Enclosed is a copy of the Department's Inactive Hazardous Waste Disposal Site Report form as it will appear in the Registry. An explanation of the site classification is available at <http://www.dec.ny.gov/chemical/8663.html>. The Law allows the owner and/or operator of a site listed in the Registry to petition the Commissioner of the New York State Department of Environmental Conservation for deletion of such site, modification of site classification, or modification of any information regarding such site, by submitting a written statement setting forth the grounds of the petition.



Site #915274

New York State Department of Environmental Conservation  
Division of Environmental Remediation  
Bureau Technical Support, 11<sup>th</sup> Floor  
525 Broadway, Albany, NY 12233-1020  
Phone: (518) 402-9543 • Fax: (518) 402-9547  
Website: www.dec.ny.gov

Page 2

Such petition may be addressed to:

Honorable Joseph J. Martens  
Commissioner  
New York State Department of Environmental Conservation  
625 Broadway  
Albany, New York 12233-1010

For additional information, please contact Mr. Greg Sutton, the Project Manager, at 716-851-7220.

Sincerely,

  
for Kelly A. Lewandowski, P.E.  
Chief  
Site Control Section

Enclosures

ec: G. Sutton, Project Manager and RHWRE, Region 9

As mandated by Section 27-1305 of the Environmental Conservation Law (ECL), the New York State Department of Environmental Conservation (Department) must maintain a registry of all inactive disposal sites suspected or known to contain hazardous wastes. The ECL also mandates that this Department notify, by certified mail, the owner of all or any part of each site or area included in the Registry of Inactive Hazardous Waste Disposal Sites.

Our records indicate that you therefore, this letter constitutes notification of the inclusion of such site in the Registry of Inactive Hazardous Waste Disposal Sites in New York State. Once listed in the Registry, the site becomes subject to certain restrictions prescribed by provisions of 6 NYCRR Part 375. These regulations may be found at the following DEC website address: <http://www.dec.ny.gov/reg/473.html>

DEC Site No.: 915274  
Site Name: Tonnawanda Forge Site  
Site Address: 2390 Kenmore Avenue, Tonnawanda, NY 14150  
Site Classification: 2

Enclosed is a copy of the Department's Inactive Hazardous Waste Disposal Site Report form as it will appear in the Registry. An explanation of the site classification is available at <http://www.dec.ny.gov/reg/4803.html>. The law allows the owner and/or operator of a site listed in the Registry to petition the Commissioner of the New York State Department of Environmental Conservation for deletion of such site, modification of site classification, or modification of any information regarding such site, by submitting a written statement setting forth the grounds of the petition.





**NEW YORK STATE DEPARTMENT OF ENVIRONMENTAL CONSERVATION  
DIVISION OF ENVIRONMENTAL REMEDIATION  
Inactive Hazardous Waste Disposal Report**



<b>Site Code</b>	915274				
<b>Site Name</b>	Tonawanda Forge Site	<b>Address</b>	2390 KENMORE AVENUE		
<b>Classification</b>	02	<b>City</b>	Tonawanda	<b>Zip</b>	14150
<b>Region</b>	9	<b>County</b>	Erie	<b>Town</b>	Tonawanda
<b>Latitude</b>	42 degrees, 58 minutes, 2.00 seconds			<b>Estimated Size</b>	33.2000
<b>Longitude</b>	-78 degrees, 54 minutes, 27.00 seconds				
<b>Site Type</b>		<b>Disposal Area</b>	Structure		

### Site Description

**Location:** The Tonawanda Forge Site is located in an urban area at 2390 Kenmore Avenue in the Town of Tonawanda, Erie County. The site is approximately 2,300 feet southeast of the intersection of Kenmore Ave. and Sheridan Drive.

**Site Features:** The main site features of the 33.2 acre site include two remaining brick multi-story buildings which were part of the original manufacturing complex. The remaining three-quarters of the southern portion of the site consist of the building floor slab, parking lots or driveways. A large grassed area along Kenmore area consists of a former landfill area on the site.

**Current Zoning and Land Use:** The site is currently inactive, and is zoned for heavy industrial use. The surrounding parcels are currently used for heavy industrial applications however a residential area is located 500 feet directly south of the site.

**Past Use of the Site:** The property was originally part of the General Motors - Tonawanda Engine Plant facility that borders the site to the north, west and south. The forge facility was sold in 1994 to American Axle and Manufacturing, Inc. (American Axle). In 2008, American Axle sold the property to the current owner, Lewis Brothers, LLC (Lewis), of Richmond, Virginia. Upon sale of the property, Lewis began the demolition of the facility starting with the removal of the interior equipment and ending with the removal of all of the buildings superstructure. Upon the owner's refusal to expeditiously address petroleum contamination on the site and in violation of a stipulation agreement with DEC, DEC proceeded with the remediation of petroleum contaminated and a Site Characterization of the property under Spill Site number 0911809. During the demolition of the building, a subcontractor did not properly address a PCB transformer which resulted in a release of PCB oil within the facility. Again, upon the subcontractor and property owner's refusal to adequately address the spill in a timely manner, DEC instituted clean-up procedures under Spill Site number 1112690. While the majority this contamination has been addressed, the site surface water continues to exhibit elevated levels of PCBs above water quality limits. In addition, several areas of the site also exhibit PCB concentration above the regulatory criteria for a hazardous waste.

**Site Geology and Hydrogeology:** Soil boring results from the subsurface investigation revealed brown silt and clay and some clay with a trace of gravel to a depth of the termination of each soil boring. Bedrock was not encountered at depths up to 24 feet bgs but is believed to consist of the Upper Silurian-aged Salina Group, which generally consists of shale, and Dolostone.

Depth to groundwater at the property ranged from 0.5 feet to 15.82 feet. The local groundwater flow direction is estimated to be west towards the Niagara River, and may be influenced by local drainage features, seasonal groundwater level fluctuations, subsurface geology, surface topography, and/or other local site features.

### Contaminants of Concern (Including Materials Disposed)

### Quantity

#### OU 01

PCB-AROCLOR 1254  
PCB-AROCLOR 1242  
PCB-AROCLOR 1248  
PCB-AROCLOR 1260

**Analytical Data Available for :** Groundwater, Surface Water, Soil, Sediment

**Applicable Standards Exceeded for:** Groundwater, Surface Water, Soil



**Owners**

**Operators**

6523012

**Current Owner(s)**

Samuel Lewis

Lewis Brothers LLC

466 Southlake Blvd

Richmond

VA 23236

NEW YORK STATE DEPARTMENT OF ENVIRONMENTAL CONSERVATION  
DIVISION OF ENVIRONMENTAL REMEDIATION  
Investive Hazardous Waste Disposal Report



Site ID	Site Name	Address	City	County	State	Zip	Latitude	Longitude	Site Type
912374	Townsend Forge Site								

**Site Description**

The Townsend Forge Site is located in an undeveloped area at 1,000 A. Avenue, Townsends Forge, New York. The site is approximately 1,200 feet west of the intersection of A. Avenue and Spitzer Road. The site is situated on the eastern shore of the Townsends Forge Reservoir. The site is currently used for storage of various materials, including scrap metal, wood, and other debris. The site is surrounded by residential and commercial properties. The site is located in the Town of Townsends Forge, New York. The site is situated on the eastern shore of the Townsends Forge Reservoir. The site is currently used for storage of various materials, including scrap metal, wood, and other debris. The site is surrounded by residential and commercial properties. The site is located in the Town of Townsends Forge, New York.

**Quantities of Constituents (Including Hazardous Disposal)**

- PCB-APOLO/0R 1254
- PCB-APOLO/0R 1242
- PCB-APOLO/0R 1248
- PCB-APOLO/0R 1240

Constituent	Quantity	Unit

[Help](#)



# Product Tracking System

Home	Search	Reports	Manual Entry	Rates/ Commitments	PTS / EDW	EMCA Activity	May 09, 2013
------	--------	---------	--------------	-----------------------	-----------	---------------	--------------

Track & Confirm Intranet

Delivery Signature and Address

Tracking Number: 7190 1050 5799 2291 1778

This item was delivered on 04/26/2013 at 14:00:00

[< Return to Tracking Number View](#)

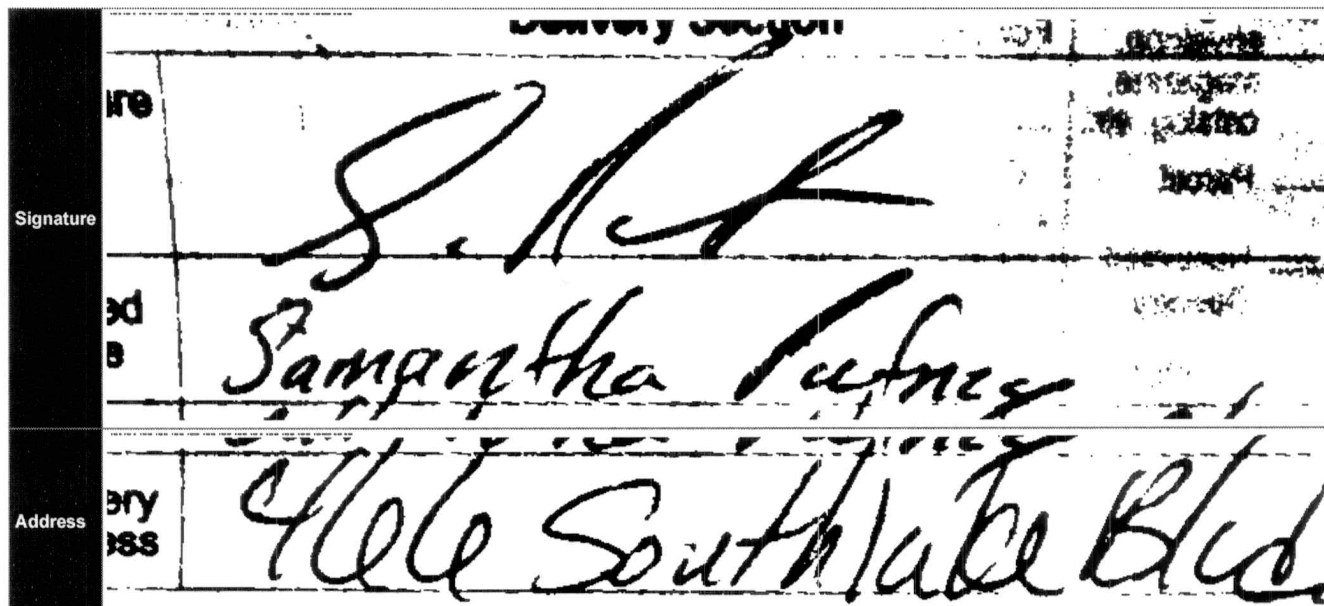

Enter up to 10 items separated by commas.

Select Search Type: Quick Search

Submit

Product Tracking System, All Rights Reserved  
Version: 1.1.0.148.3

**NEW YORK**  
state department of  
**HEALTH**

Nirav R. Shah, M.D., M.P.H.  
Commissioner

Sue Kelly  
Executive Deputy Commissioner

April 17, 2013

Mr. Michael Cruden, Director  
Remedial Bureau E  
NYS Dept. of Environmental Conservation  
Division of Environmental Remediation  
625 Broadway  
Albany, NY 12233

Re: **Site Classification Package**  
Tonawanda Forge  
Site #915274  
Tonawanda (T), Erie County

Dear Mr. Cruden:

Staff reviewed the *Site Classification Package*, in which your Department proposes listing the referenced property as a Class 2 site on the New York State Department of Environmental Conservation's Registry of Inactive Hazardous Waste Disposal Sites. Based on that review, I understand that the site is currently vacant and contains an area of ponded water containing elevated levels of polychlorinated biphenyls. All potential drainage-ways from this area have been plugged to reduce the potential for off-site contaminant migration. Additional sampling is needed to define the nature and extent of contamination and to evaluate the potential for exposures on and off the site.

Based on the information reviewed, I believe the site represents a significant threat to human health and concur with your Department's proposal to list the site as a Class 2. If you have any questions, please contact me or Ms. Deanna Ripstein at (518) 402-7860.

Sincerely,

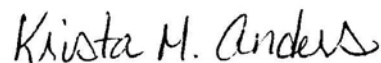

Krista M. Anders, Acting Director  
Bureau of Environmental Exposure Investigation

cc: A. Salame-Alfie, Ph.D.  
D. Ripstein / e-File  
M. Forcucci – NYSDOH WRO  
M. Kowalski – ECHD  
M. Ryan / K. Lewandowski – NYSDEC Central Office  
G. Sutton – NYSDEC Region 9

P:\Bureau\Sites\Region\_9\ERIE\915274\Class\_DOHConcur\_041713\_915274.pdf

Site Location  
Tonawanda Forge Site  
No. 915274

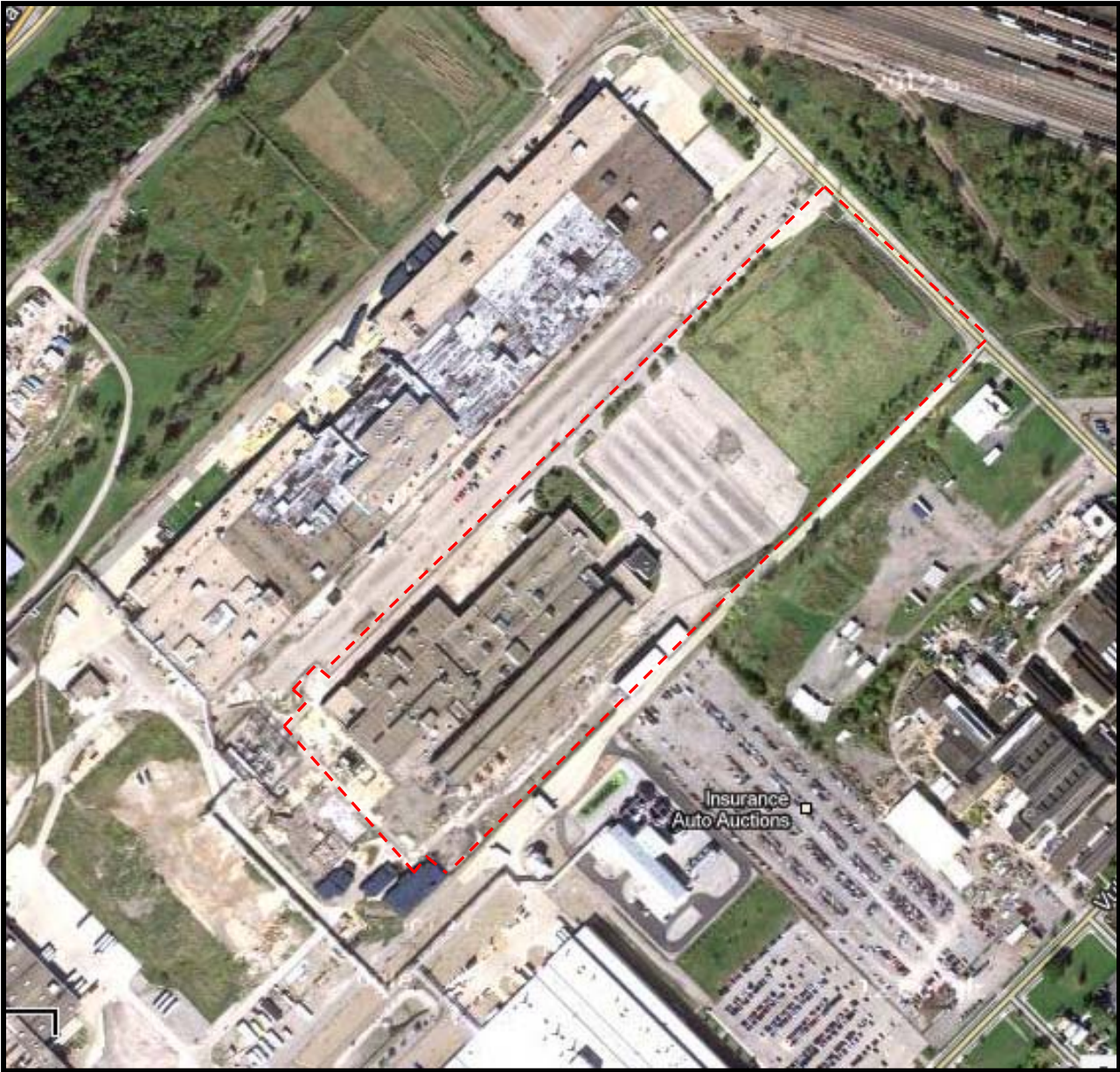



- LEGEND**
- TRACKS
  - x- FENCE
  - ⊕ STORM DRAIN
  - ⊙ UTILITY MANHOLE
  - ⊙ STORM SEWER MANHOLE
  - ⊙ SANITARY SEWER MANHOLE
  - ⊙ MONITORING WELL
  - UNDERGROUND SANITARY SEWER LINE
  - UNDERGROUND STORM SEWER LINE
  - SW X SURFACE WATER SAMPLE
  - MH O SURFACE WATER SAMPLE
  - SW1 WELL IDENTIFICATION
  - WATER SAMPLE TYPE
  - 2-3-12 SAMPLE DATE
  - 13.8 TOTAL PCBs (ug/L)
  - ug/L MICROGRAMS PER LITER

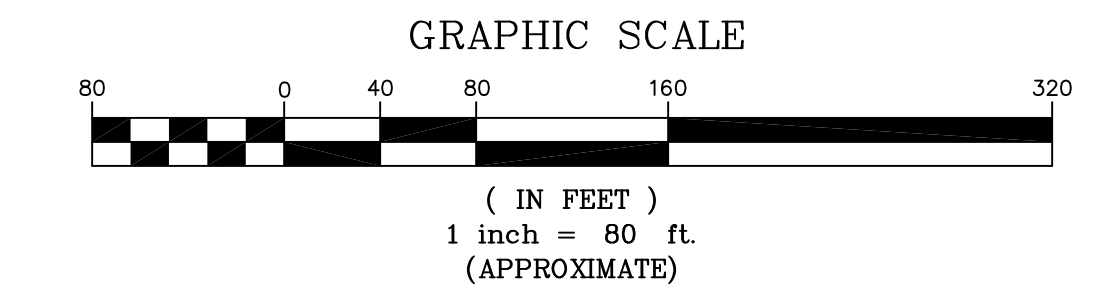
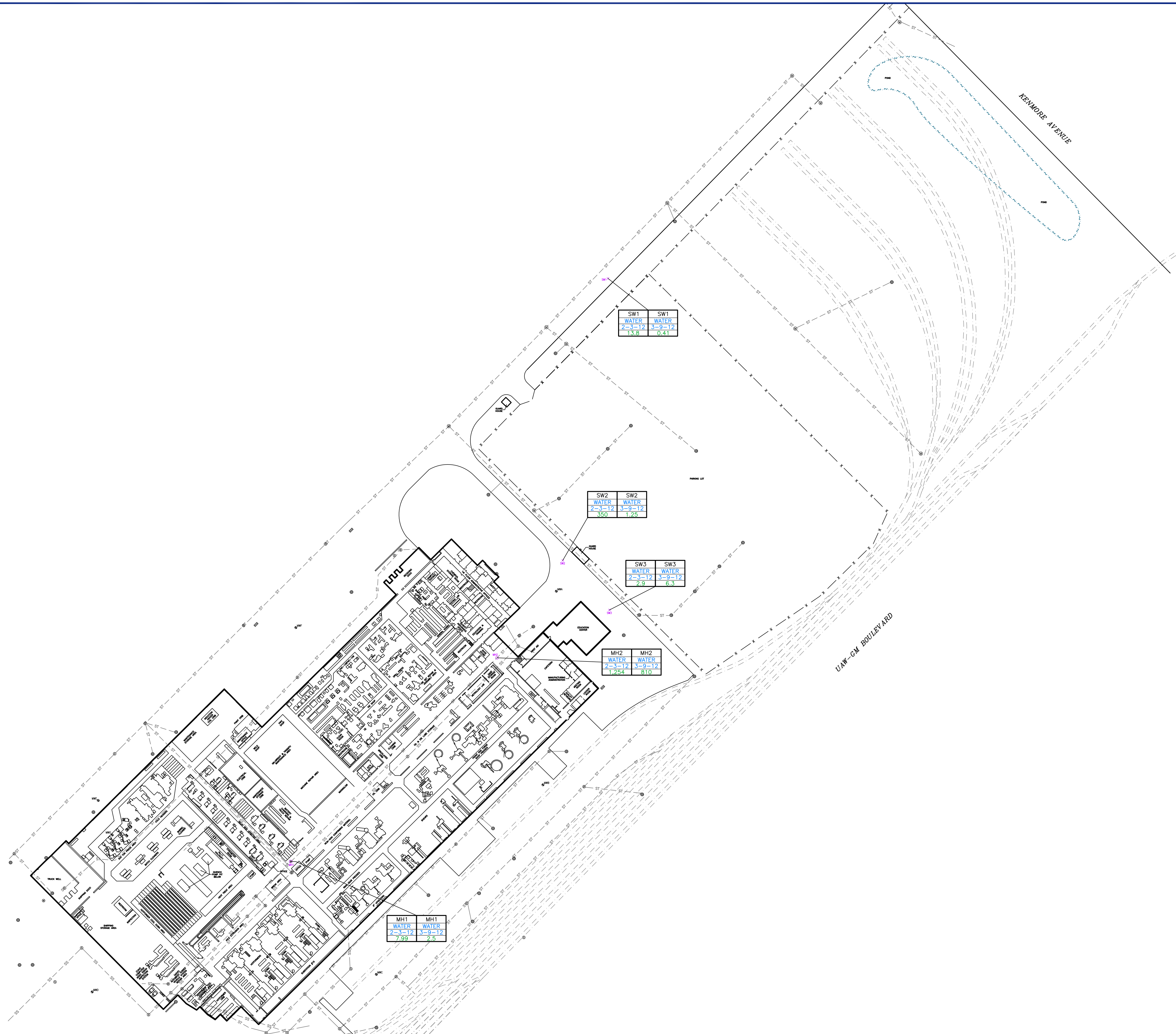

DRAFTED BY: B.C.S. (N.J.)	<b>STORM WATER ANALYTICAL MAP</b>  NYSDEC TONAWANDA FORGE 2390 KENMORE AVENUE KENMORE, NEW YORK	
CHECKED BY:		
REVIEWED BY:		
NORTH 	Groundwater & Environmental Services, Inc. 158 SONWIL DRIVE, CHEEKTOWAGA, NEW YORK 14225	
	DATE 3-30-12	FIGURE 12



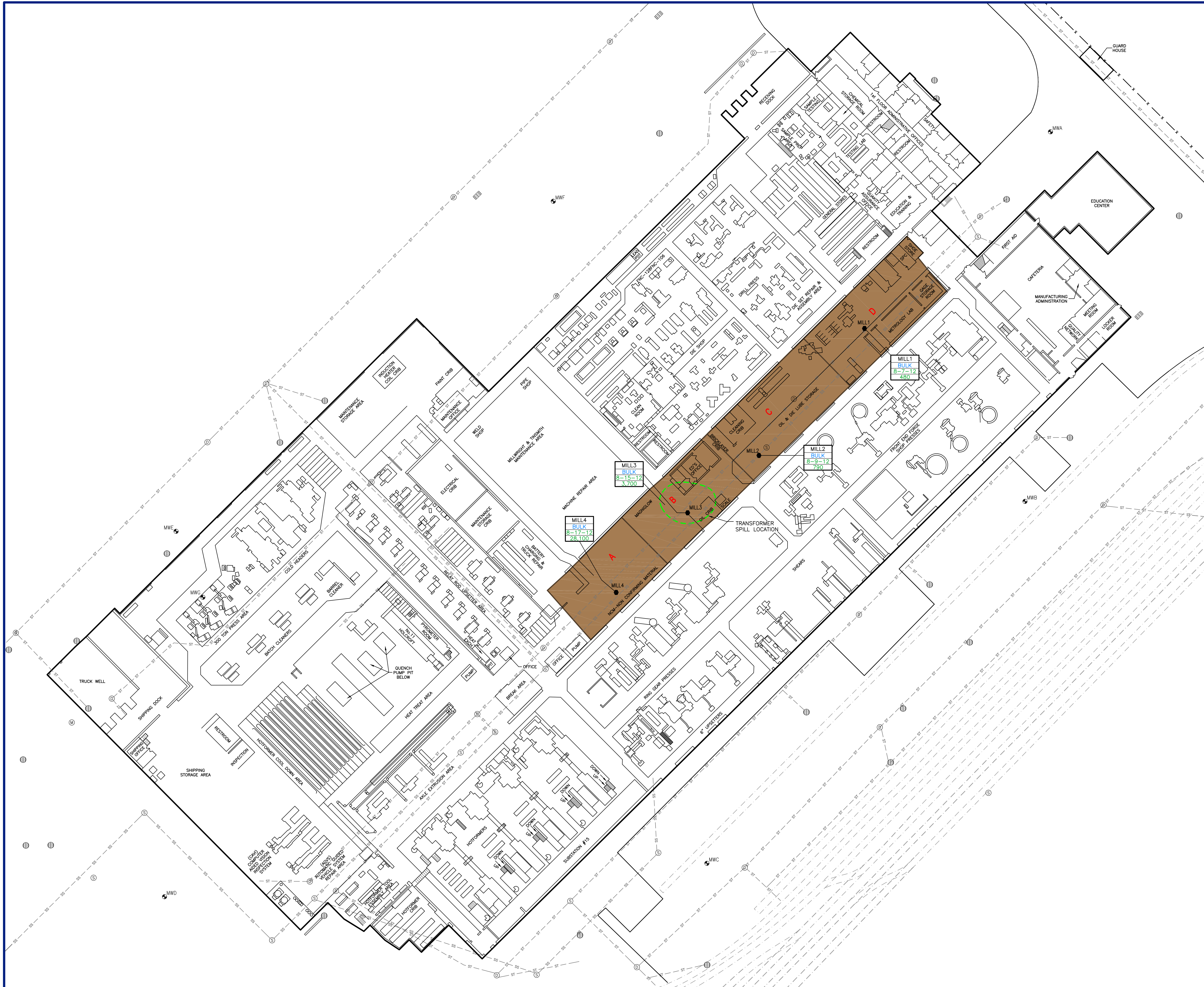

- LEGEND**
- TRACKS
  - x- FENCE
  - ⊕ STORM DRAIN
  - ⊙ UTILITY MANHOLE
  - ⊙ STORM SEWER MANHOLE
  - ⊙ SANITARY SEWER MANHOLE
  - ⊙ MONITORING WELL
  - SS --- UNDERGROUND SANITARY SEWER LINE
  - ST --- UNDERGROUND STORM SEWER LINE
  - MILLING AREA
  - SAMPLE POINT
- |        |                    |
|--------|--------------------|
| MILL1  | SAMPLE NAME        |
| BULK   | SAMPLE TYPE        |
| 8-7-12 | SAMPLE DATE        |
| 480    | TOTAL PCBs (ug/kg) |
- ug/kg MICROGRAMS PER KILOGRAM  
PCBs POLYCHLORINATED BIPHENYLS

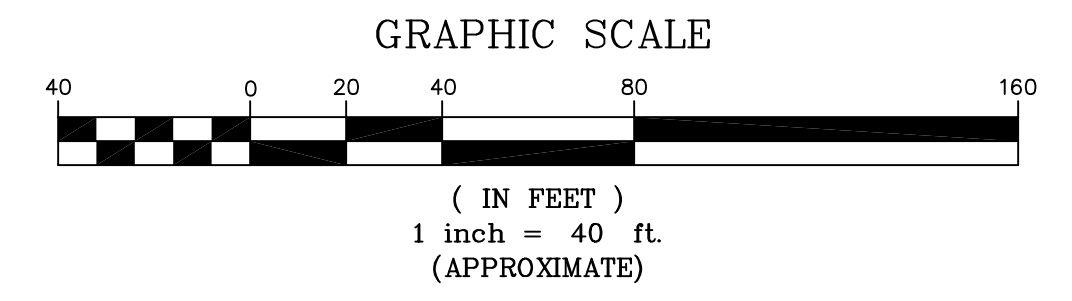

DRAFTED BY: E.M.E. (N.J.)	<b>PCB REMEDIATION (MILLED AREAS)</b> <b>AUGUST 2012</b>	
CHECKED BY:	NYSDEC TONAWANDA FORGE 2390 KENMORE AVENUE KENMORE, NEW YORK	
REVIEWED BY:	Groundwater & Environmental Services, Inc. 495 AERO DRIVE, SUITE 3, CHEEKTOWAGA, NEW YORK 14225	
NORTH	DATE 9-17-12	FIGURE 14

H:\Projects\2012\Bulky\GIS\20120828\20120828\_2390Kenmore.dwg, 20120828 10:10:10 AM, E:\Users\Amanda.Hoffman\AppData\Local\Temp\GIS\20120828\_2390Kenmore.dwg, 11



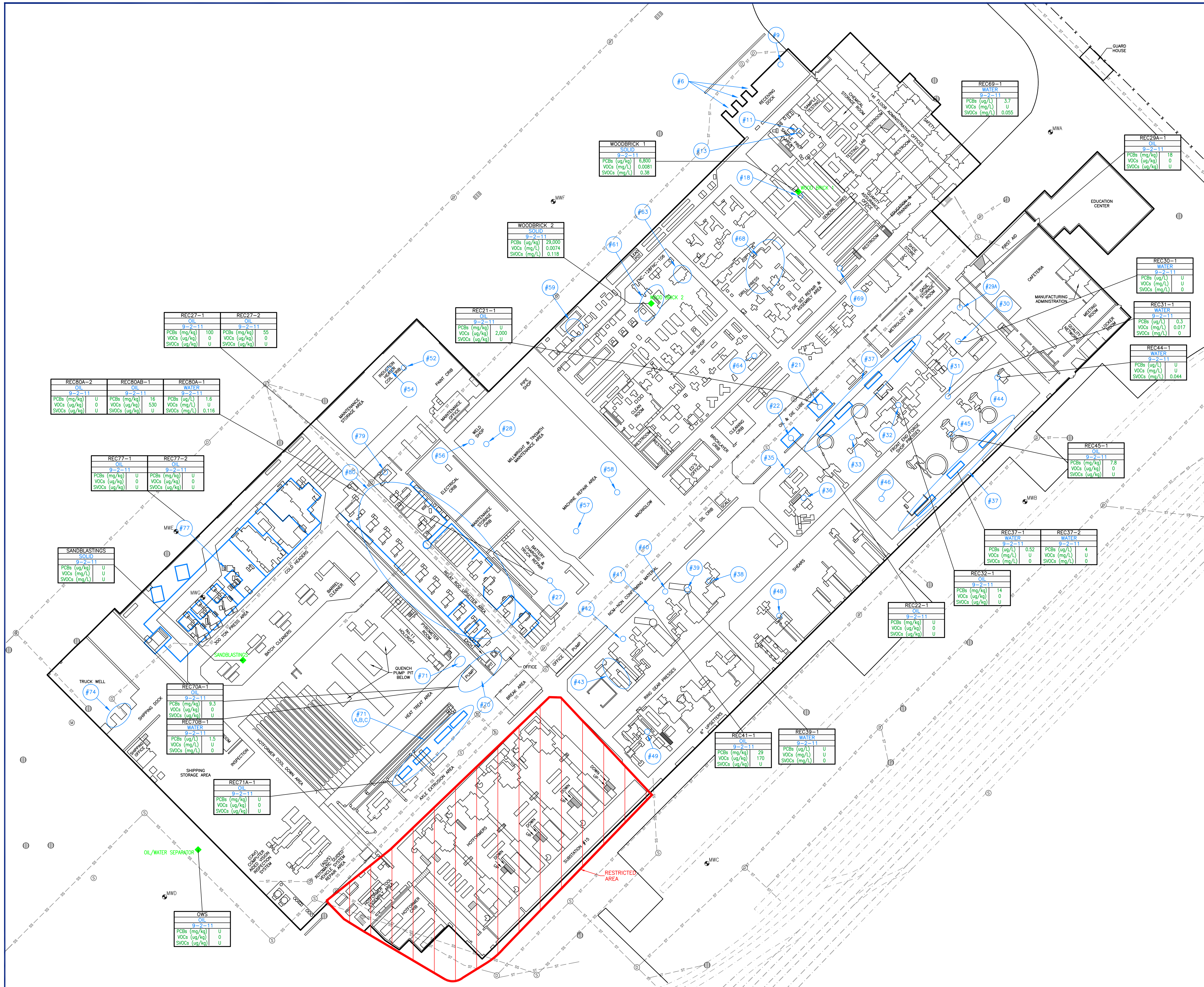

**LEGEND**

- TRACKS
- x- FENCE
- STORM DRAIN
- ⊕ UTILITY MANHOLE
- ⊙ STORM SEWER MANHOLE
- ⊙ SANITARY SEWER MANHOLE
- ⊙ MONITORING WELL
- UNDERGROUND SANITARY SEWER LINE
- UNDERGROUND STORM SEWER LINE
- ◆ REC INVESTIGATION SAMPLE

WELL IDENTIFICATION	
SAMPLE TYPE	
SAMPLE DATE	
TOTAL PCBs (VARIES)	
TOTAL TCLP VOCs (VARIES)	
TOTAL TCLP SVOCs (VARIES)	
REC30-1	WATER
9-2-11	U
PCBs (ug/L)	U
VOCs (mg/L)	U
SVOCs (mg/L)	0

ug/L MICROGRAMS PER LITER  
 mg/L MILLIGRAMS PER LITER  
 ug/kg MICROGRAMS PER KILOGRAMS  
 mg/kg MILLIGRAMS PER KILOGRAMS  
 VOCs VOLATILE ORGANIC COMPOUNDS  
 SVOCs SEMI-VOLATILE ORGANIC COMPOUNDS  
 U BELOW LABORATORY DETECTION LIMITS

**GRAPHIC SCALE**

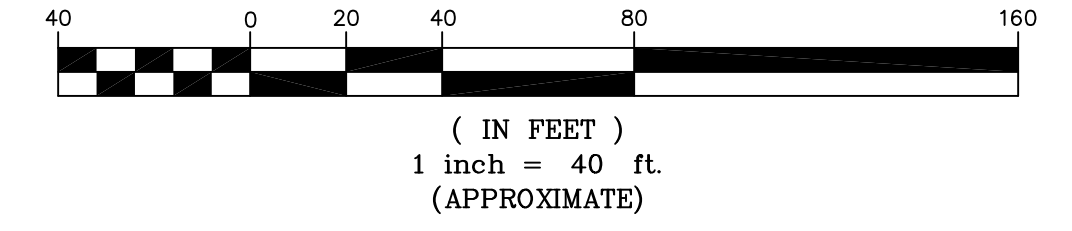

DRAFTED BY: B.C.S. (N.J.)	<b>REC INVESTIGATIONS ANALYTICAL RESULTS MAP</b> SEPTEMBER 2, 2011
CHECKED BY:	NYSDEC TONAWANDA FORGE 2390 KENMORE AVENUE KENMORE, NEW YORK
REVIEWED BY:	Groundwater & Environmental Services, Inc. 158 SONWIL DRIVE, CHEEKTOWAGA, NEW YORK 14225
NORTH	DATE 3-1-12
	FIGURE 5



**LEGEND**

- TRACKS
  - x- FENCE
  - ⊕ STORM DRAIN
  - ⊙ UTILITY MANHOLE
  - ⊖ STORM SEWER MANHOLE
  - ⊙ SANITARY SEWER MANHOLE
  - ⊙ MONITORING WELL
  - SS --- UNDERGROUND SANITARY SEWER LINE
  - ST --- UNDERGROUND STORM SEWER LINE
  - ⊕ SOIL BORING LOCATION
  - ⊗ SURFACE WATER SAMPLE
- |         |                                   |
|---------|-----------------------------------|
| MWA     | WELL IDENTIFICATION               |
| 11-3-11 | SAMPLE DATE                       |
| 5-7     | SAMPLE DEPTH (feet)               |
| 0.0     | PID (ppmv)                        |
| 12.9    | TOTAL TCL LISTED VOCs (ug/kg)     |
| NA      | TOTAL TCL LISTED SVOCs (ug/kg)    |
| U       | TOTAL PCBs CONCENTRATIONS (ug/kg) |
| 582.5   | TOTAL PCBs CONCENTRATIONS (ug/kg) |
| U       | TOTAL PCBs CONCENTRATIONS (ug/kg) |
- ppmv PARTS PER MILLION BY VOLUME
  - PID PHOTOIONIZATION DETECTOR
  - ug/kg MICROGRAMS PER KILOGRAMS
  - TCL TARGET COMPOUND LIST
  - VOCs VOLATILE ORGANIC COMPOUNDS
  - SVOCs SEMI-VOLATILE ORGANIC COMPOUNDS
  - U BELOW LABORATORY DETECTION LIMITS

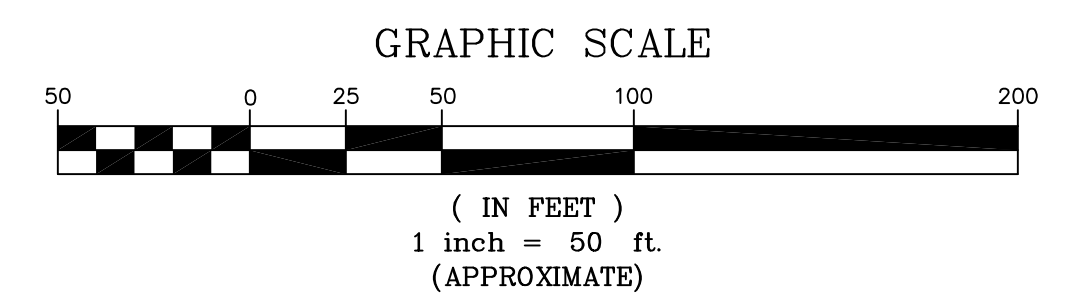

DRAFTED BY: E.M.E. (N.J.)	<b>EASTERN BERM AREA INVESTIGATION DATA MAP</b> <b>MARCH 12-14, 2012</b>
CHECKED BY:	NYSDEC TONAWANDA FORGE 2390 KENMORE AVENUE KENMORE, NEW YORK
REVIEWED BY:	<b>Groundwater &amp; Environmental Services, Inc.</b> 158 SONWIL DRIVE, CHEEKTOWAGA, NEW YORK 14225
	DATE 9-17-12
	FIGURE 9

I:\Projects\2010\Berm\GIS\2010BermData.mxd, 11/17/2011 4:41 PM, E:\Users\Ardur\Documents\2010BermData.mxd, 11/17/2011 4:41 PM, E:\Users\Ardur\Documents\2010BermData.mxd, 11/17/2011 4:41 PM



**LEGEND**

- TRACKS
- x- FENCE
- ⊕ STORM DRAIN
- ⊙ UTILITY MANHOLE
- ⊙ STORM SEWER MANHOLE
- ⊙ SANITARY SEWER MANHOLE
- ⊙ MONITORING WELL
- UNDERGROUND SANITARY SEWER LINE
- UNDERGROUND STORM SEWER LINE
- SW X SURFACE WATER SAMPLE
- MH O SURFACE WATER SAMPLE
- SW1 WELL IDENTIFICATION
- WATER SAMPLE TYPE
- 2-3-12 SAMPLE DATE
- 13.8 TOTAL PCBs (ug/L)
- ug/L MICROGRAMS PER LITER

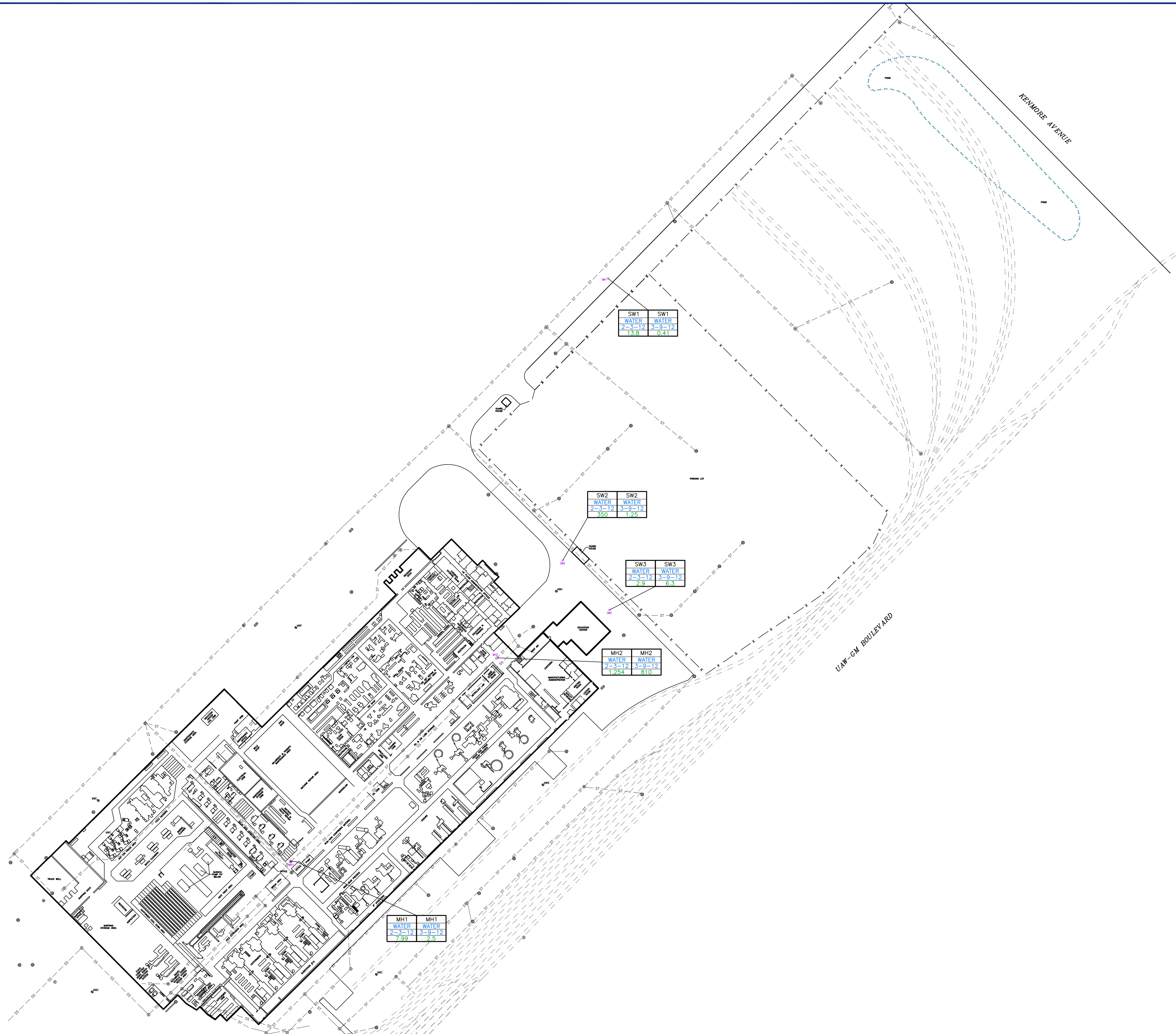

**GRAPHIC SCALE**

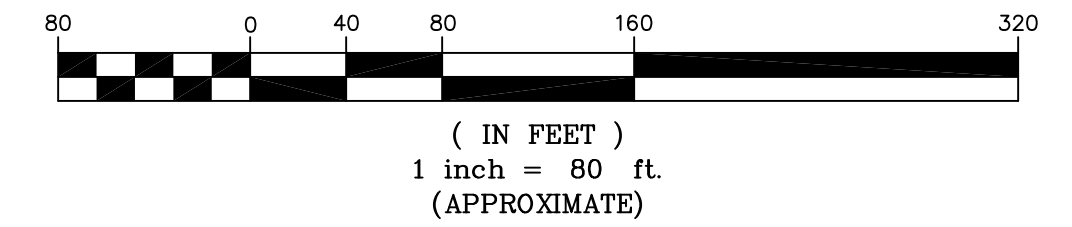

DRAFTED BY: B.C.S. (N.J.)	<b>STORM WATER ANALYTICAL MAP</b>	
CHECKED BY:	NYSDEC TONAWANDA FORGE 2390 KENMORE AVENUE KENMORE, NEW YORK	
REVIEWED BY:	Groundwater & Environmental Services, Inc. 158 SONWIL DRIVE, CHEEKTOWAGA, NEW YORK 14225	
NORTH 	DATE	FIGURE
	3-30-12	12