

Presto-Lite
↳ TCP head
Presto-Lite

APPENDIX A

HISTORICAL DOCUMENTATION

NIAGARA SANITATION COMPANY - N SH ROAD SITE

SUMMARY OF FILE (1962-1986)

phase II
SOL 37.50
Sim 5.3
SFE 26.25

2-28-62 NYS DOH TO FILE RE: POSSIBLE RAT INFESTATION

1-12-65 NYS DOH IN HOUSE MEMO RE: INSPECTION
2-20-64 NYS DOH INSPEC - REFERS TO CARBONUM WASTES

4-12-64 Petitions to stop siting of new landfill at Lockport Rd & Walmore Rd

3-20-65 CITIZEN COMPLAINT RE: UNHEALTHY CONDITIONS AT DUMP

3-23-65 NCHD INSPECTION

4-23-65 Follow-up to 3-20 CITIZEN COMPLAINT - DEMANDS TO KNOW STATUS

5-24-65 Asst Commis, Health → Wheatfield Town Board: Asking to find NEW SITE

6-4-65 " → " RE: CONFIRM INFO OF 6-5

CONFERENCE STATING NEW SITE WILL BE SITED SOON

5-27-66 NCHD → Wheatfield RE: ORDER TO SHOW CAUSE ON IMPROPER OPERATION

6-10-65 CITIZEN COMPLAINT

(4-28-65) MEETING OF NEIGHBORS & NCHD

(5-21-65) NCHD VISITS SITE

6-12-65 NYS DOH INSPECTION

9-14-65 Commissioner → NIAGARA SANITATION RE: IMPROPER OPERATION

9-27-65 NYS DOH INSPEC → RECOMMENDS LEGAL ACTION

10-28-65 Attorney → Attorney RE: Wheatfield/NIAGARA Sanitation Agreement

4-4-66 NCHD → Wheatfield Town Board RE: OPERATIONAL PROBLEMS

5-20-66 Attorney MEMO RE: SLIDES

8-31-66 Summer 66 REPORT - NOTES MANY IMPROVEMENTS MENTIONS 30X10X300 FT DISPOSAL AREA

6-1-66 NYS DOH INSPEC

6-10-66 NCHD → Wheatfield RE: 6/2/66 HEARING

6-10-66 NCHD INSPECTION/SURVEY

6-11-66 NYS DOH INSPECTION OF 7/8 COMMENTS

7-12-66 NCHD → Wheatfield MEMO

8-29-66 NCHD MEMO RE: UNAUTHORIZED CITIZEN ACTION

2-3-66 NCHD → wheatfield re: operations
 1-18-67 NCHD → wheatfield re: improvements & deficiencies
 -11-67 Citizen complaint re open water holes
 -26-67 NT → NCHD RE: DANGEROUS conditions at site
 1-25-67 NCHD → wheatfield RE 7/21 CONFERENCE & drainage plans
 -26-67 NCHD → NT RE: DRAINAGE PROBLEM
 -25-67 Surveyors → NCHD RE: PRINTS FOR PROPOSED GRADING
 -3-67 NCHD → Surveyors → RETURNED PRINTS BECAUSE DOES NOT ADDRESS COVER
 -30-67 Surveyors → NCHD RE: ENCLOSED PRINTS
 -1-67 NCHD → Surveyors → RE: ACCEPTS PLAN
 2-27-67 NCHD → Hasely Trucking RE: CEASE USING dump UNTIL PER COMPLIANCE
 -3-68 N 4500H INSPEC
 -3-68 NCHD → wheatfield → MENTIONS CHEMICAL WASTES BEING BURIED
 -4-68 NCHD → wheatfield / requests using NCRDD-wheatfield discontinue this site
 -15-69 NCHD INSPECTION with sketch
 -1-68 Status Survey
 -13-69 NCHD INSPEC with sketch
 11-69 COMPLAINT RE Flooding backyard
 14-69 NCHD INSPEC
 -28-71 COMPLAINT - Pooled water - ODOR
 11-78 wheatfield → NCHD acknowledges chemical material & REQUEST NCHD to
~~investigate~~ investigate
 2-78 NCHD INSPECTION

Hasely Trucking

1968 still dumping

**NIAGARA COUNTY
DEPARTMENT OF HEALTH**

Code Activity

Code Location

Service Request No.

Date Received Complaint

Service Request *Survey ^{disposition} of closed landfill site*

Originator of Complaint *NCHD* Address

Owner

Occupant *former Tr. of Wheatfield dump* Address *Nash Rd., Ni Ton, N.Y.*

Date

Hours

REPORT OF INVESTIGATION

Tr. of Wheatfield

*9/12/78
(3:35)*

*Surveyed site. Found no evidence of sur-
facing slachati. Unable to detect unusual odors.
Except for some rubbish (pieces glass etc.) & brush
cultivars which were likely deposited by outsiders,
and appears in satisfactory condition.*

Carl Nowakowski

Date Abated *9/12/78* By *C. Nowakowski*

FINDLAY, HACKETT, REID AND WATTENGEL

ATTORNEYS AND COUNSELLORS AT LAW

UNITED OFFICE BUILDING

P. O. BOX 726, FALLS STATION

NIAGARA FALLS, NEW YORK 14303

AREA CODE 716 285-7564

JACK W. HACKETT
PAUL H. REID, JR.
JERALD A. WATTENGEL
GLENN S. HACKETT
DAVID M. CHRISTY
TIMOTHY J. TOONEY

*action taken
Hackett*
*File
Wheatfield
Nash
Road
Dump*
FRANCIS T. FINDLAY
(1892-1971)

September 11, 1978

Niagara County Health Department
10th and East Falls Street
Niagara Falls, New York

RE: Town of Wheatfield, New York

Gentlemen:

The Town Board of the Town of Wheatfield has requested that I advise the County Agencies involved that there was in the past a dumping of chemical material at the Town of Wheatfield Nash Road dump.

The Town Board, in light of recent developments concerning chemical leachage, hereby requests that the Niagara County Health Department take the necessary steps to conduct an analysis of the aforesated area so that the residents of that area can be rest assured there doesn't exist any dangerous situation.

If you have any questions, please contact me.

Yours very truly,

FINDLAY, HACKETT, REID & WATTENGEL

BY *Glenn S. Hackett*
TOWN OF WHEATFIELD ATTORNEY *fmc*

GSH/fmc

cc: Economic Development and Planning Department

16704 NIAGARA COUNTY HEALTH DEPARTMENT
SERVICE REQUEST

Name Mrs. Partish
Address 130 Forbes St
Location Old Wheatfield Dump
Request show

Code Activity 130-Forbes St. NY
Code Location 130-Forbes St. NY
Service Request No. 130-Forbes St. NY
Date Received Complaint 130-Forbes St. NY

Date 5-28-71

Code 81 172

Date Hours

REPORT OF INVESTIGATION

Mrs. Partish complained of condition at rear of her residence. Old gas line in back of her residence. She believes that Hooker Chemical used this line for burying salt brine. She would like area leveled off to prevent water accumulation.

She also complained of old dump (Wheatfield). There is deep water in area of dump creating a hazard to children. odor and mosquitoes present a problem to area Forbes street residents.

Date Abated May 28, 1971 By Russ Schuler

1) coming to view of Home Terrace at
2) coming to view of Home Terrace at

**NIAGARA COUNTY
DEPARTMENT OF HEALTH**

check wheatfield dump

Code Activity

Code Location

Service Request No.

Date Received Complaint *11/14/69*

Service Request *Surface Water to Run off Home on F-100*

Originator of Complaint *N.C.D.H.* Address *674 North 1st St.*

Owner Address

Occupant Address

Date Hours

REPORT OF INVESTIGATION

4/14 1100

① The most near portion of lots on Forbes St. from Forbes Terrace to Mack St. - there is a continuous string of small ponds that vary in size and length. These particular lots border land owned by the Niagara Mohawk Power Co. upon which high voltage towers and power lines are located. Entering the land owned by Niagara Mohawk borders the approach road to the wheatfield dump and part of the dump itself. The portion of the home owner land adjacent to that owned by the Power Co. is lower in height while the wheatfield dump area adjacent to the Mohawk land is higher. Under this arrangement we have the home owner's lot heavily flooded - the Niagara Mohawk land slightly flooded and the wheatfield dump fairly dry.

② In the area behind 32 Forbes Terrace is another pond. This pond is located upon the wheatfield dump and the outer edge of pond has joined the flooded rear portion of the homes 22, 24, 32 and 38 Forbes Terrace.

The area behind 32 Forbes Terrace was graded at one time but has now settled and formed a small pond. In speaking to Mrs. Kneeger the wife of Wayne Kneeger for Wheatfield - he has stated he will grade this area and will fill when the weather permits him to do so. He will be able to grade this area only as high as the rear grade of the home is present. This will rid the area of the pond but the portions of home that are

Date Abated *11/17/69*

By *G. P. P. P. P.*

NIAGARA COUNTY DEPARTMENT OF HEALTH

Code Activity

Code Location

Service Request No.

Date Received Complaint

Service Request Surface water around Parker St.

Originator of Complaint Address

Owner Address

Occupant Address

Date	Hours	REPORT OF INVESTIGATION
		<p>lower than the pond which will be similar level water.</p> <p>In respect to the flooded area on Parker street the problem is much greater. Mr. Krueger will clean out our existing ditch that runs along the approach road to dump. This ditch runs about 1000 yards behind the home in question but is behind only about half of the homes that front on them. This ditch is separate from the land owned by approach road to dump and the land owned by Margaret M. Hawk. Mr. Krueger has also stated he would put a ditch to the other side of approach road on its border line between W. Hartfield land and Powell's land if so desired by us. Grounding that Margaret M. Hawk agrees to this. It must be noted that if level where ponding is lower than that of Cayuga Creek where water must flow this ditch will not drain off all the surface water. Ditch in question will not take care of all the home in question. Another possibility is the use of sanitary sewer located to the front of these homes. The heart of the problem is that the land owned by the home owners is much lower than the land adjacent to them. This lowness appears to have always existed and may have been made more pronounced by the dump once being full up.</p> <p>At the present time no health problem exists and the above suggestions are only for further consideration should a health problem arise.</p> <p>Sanitary and storm sewers present on Parker St.</p>

Date Abated 4/14/69 By A. J. ...

Code Activity

Code Location

Service Request No.

Date Received Complaint

Service Request infant motor near / down rider

Originator of Complaint _____ Address _____

Owner _____ Address _____

Occupant _____ Address _____

Date Abated 11/1/69 By W. J. [Signature]

4/14/60

WATER TO REAR OF HOMES IN FORBES STREET

DEPTH OF WATER ~ 2" TO 12"

POND SIZE - LENGTH APP. 2000 YD - WIDTH APP. 40 FT

PUBLIC WATER - FORBES ST.

PUBLIC SEWERS - FORBES ST.

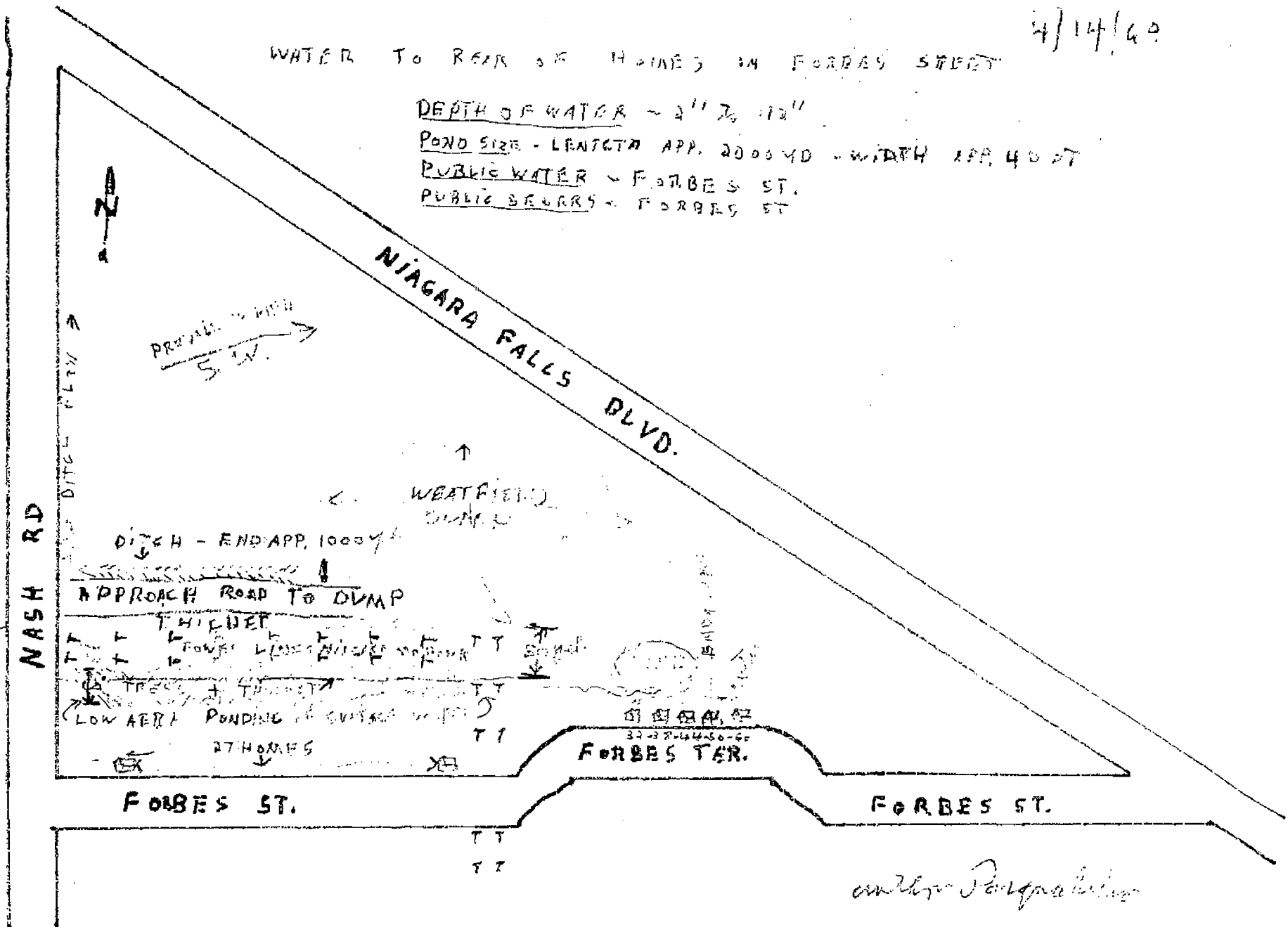

NIAGARA COUNTY HEALTH DEPARTMENT
SERVICE REQUEST

Name

Mr De Marco

Address

32 Forbes Ave.

Location

N. Torawanda

Request

Water on lot.

Code Activity

~~382~~ 382

Code Location

A 2

Service Request No.

9882

Date Received Complaint

41

Date _____

411/69

Code

82 A 2

32 Pals. Toward N.E.

Date _____

Hours

REPORT OF INVESTIGATION

111

71

Surface water has collected on the rear portion of the lot due to the fact that the land is low. The wharfedump dump also surrounds the rear of lot due to ^{the} ~~the~~ (30 Fathoms Trench) and also is lay in some of the surrounding land and a small pond has been placed which is mostly located on the dump site but also extends to the rear of lot.

477

As I am checking the other lots there
was to the left and right of the P. Mar. 4th I found
that they are also under water to various degrees.
This was caused by surface water, and due to the fact
that a house on the side where was lot of house and
streets had damaged meet.

Date Abated 4/11/00

. By

By G. J. M. van der Kerk

**NIAGARA COUNTY
DEPARTMENT OF HEALTH**

Code Activity

Code Location

Service Request No.

Date Received Complaint

Service Request Inspection of Town of Wheatfield Dump

Originator of Complaint Address Nash Road

Owner Town of Wheatfield Address

Occupant Address

Date

Hours

REPORT OF INVESTIGATION

Inspection of the Town of Wheatfield dump site revealed that approx. 90% of the area had been graded with soil and no exposed garbage was found. On the site were found; 1 Pile of wood pile limbs covering an area of approx. 20' x 30' by 10' in height; 1 Pile of somewhat scattered old crates and barrels encompassing an area of approx. 100 sq. ft; also found were a few scattered areas of battery casings, and 1 pile of mixed wood and battery casings. Entrance to the site was barred by means of a chain strung across the approach road. A total of 16 signs were found around the dump site proper stating; Property of the Town of Wheatfield No Trespassing. For exact locations of above areas consult map on following page.

Date Abated

3/13/09

By

[Signature]

Wheat Field Dump.

↑
N

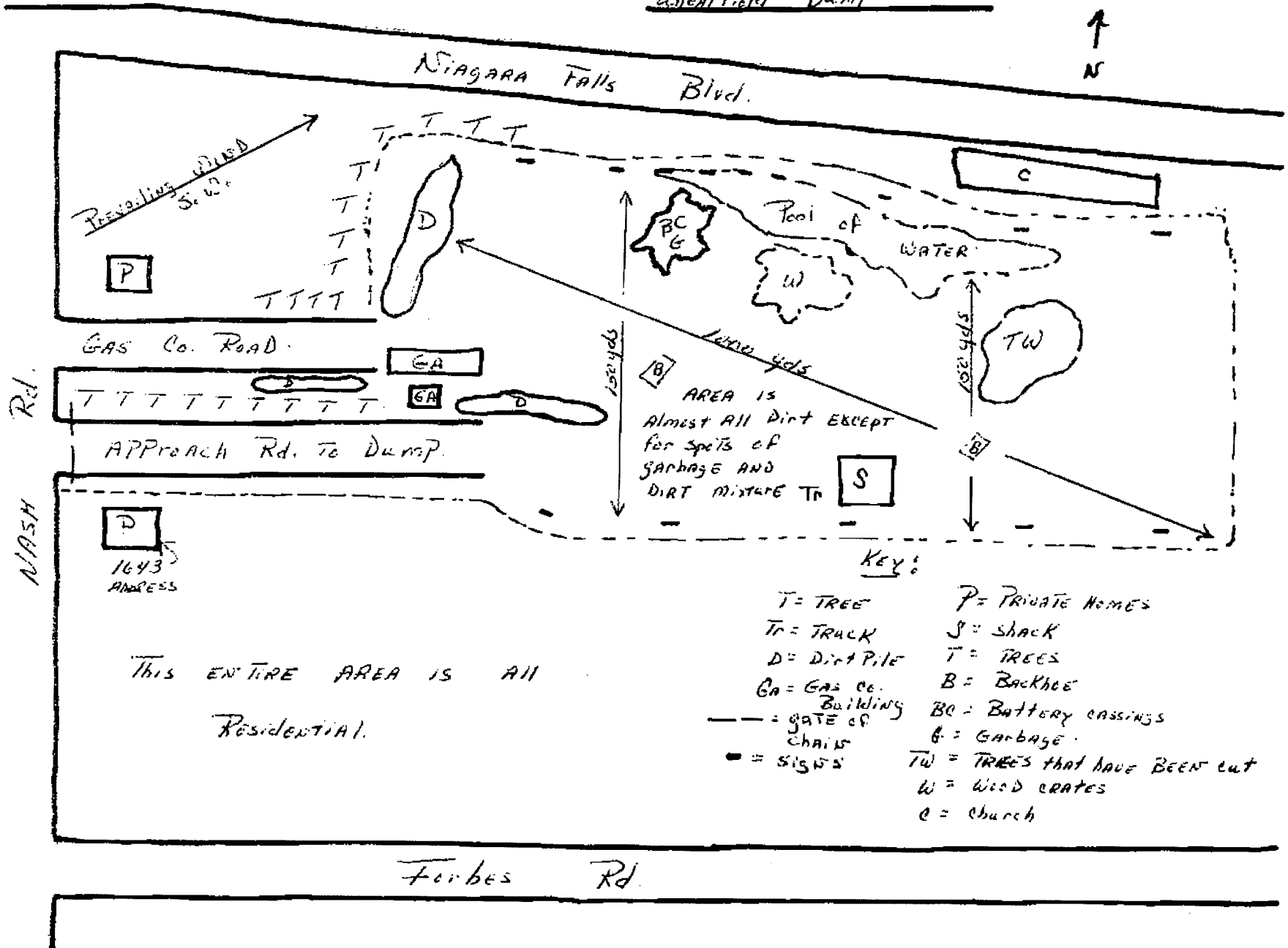

NASH ROAD

WATER CURBS - NONE
PUBLIC WATER - AHEAD OF
OLYMPIC LOCATION - NONE
NAT. CHANNEL OR DRAINS NONE
SUBJECT TO FLOODING - AREAS A
A - C
GEN. LANDSLOPE - FLAT
SITE BOUNDARIES - TREE BLIND
FENCING - TREE BORN LINE
CAGES - CABLE OFF HANG AND
KEY - OVER

ACCESS ROAD

THE UNIVERSITY OF CHICAGO

TREES & BUSH FENCE LINES

SMACK

WHEATFIELD DUMP SITE

Code Activity

Code Location

Service Request No.

Date Received Complaint

[illegible]

Date Abated 8/12/09 By V. Farnell-Lis

BUREAU OF SOLID WASTES ENGINEERING AND
COMMUNITY ENVIRONMENTAL HEALTH

REFUSE DISPOSAL AREA STATUS

Name of refuse disposal area Town of Wheatfield Dump

Location Town of Wheatfield - Mash Road T-106 Niagara County

Operated by Niagara Sanitation, Inc.

1. Does open burning occur routinely or periodically? Yes No X

If yes, has a written exemption for the burning been granted? Yes No

2. Does deposited refuse, or leachings from it, result in apparent contravention of water quality standards? Yes No X

3. Is deposited refuse usually confined to an effectively controlled area? Yes X No

If no, has a written exemption been granted to the operator? Yes No

4. Is deposited refuse normally compacted and covered with suitable material within 24 hours? Yes X No

If not covered within 24 hours, has a written exemption been granted? Yes No

If not covered within 24 hours, describe how frequently refuse is covered

5. Are effective means taken to control insects and rodents? Yes No X

6. Describe what is being done to bring the operation of this refuse disposal area into compliance with Part 19 (Attach Abatement Schedule) This area will be abandoned soon and all

material will be brought to the Niagara County Solid Waste Agency disposal site.

Name and title of person
completing this form See

Date October 1, 1968

File: Niagara San - 7/2/77
nd
inactive CF

September 4, 1965

Mr. Stanley A. Urzezinski
2086 River Road
Niagara Falls, New York

Dear Mr. Urzezinski:

Since the Niagara County Solid Waste Agency is now in limited operation on their site in the Township of Wheatfield--City of North Tonawanda, it is respectfully requested that your board contact their Assistant Director, Mr. Webster, so that arrangements may be made to use the County's facilities, thereby enabling you to discontinue the use of your present disposal site.

We would then hope and trust that immediate action would be taken to rehabilitate your present disposal site by completing the necessary cover and final grading.

In view of our mutual interest in this problem, we would appreciate being kept advised on the circumstances of this situation.

Yours very truly,

W. M. Friedman
Assistant Commissioner
for Environmental Health

WMF:ms

cc: Mr. Bert J. Murphy, Supervisor
North Tonawanda

File Niagara Falls - No. 44
inactive (P)

File

October 3, 1968

Mr. Stanley Z. Brzezinski, Supervisor
Town of Wheatfield
2080 River Road
Niagara Falls, New York

Re: Wheatfield Town Disposal Site
Town of Wheatfield

Dear Mr. Brzezinski:

On September 26, 1968, the writer made an inspection of the above disposal site at which time he was accompanied by and interviewed your operator, Mr. Ziro. While we are pleased with the improvements effected at this site over the past year there now exists unsatisfactory conditions that should be call to your attention.

First, the disposal of domestic refuse is being accomplished in close proximity to the chemical waste recently buried here. This not only makes possible the exposure of these wastes to the atmosphere but is also resulting in considerable difficulty in the proper burial of the refuse. The area where the chemical waste has been buried should be roped to keep heavy equipment away from this location.

Considerable industrial and urban renewal wastes are being disposed of on this property with no attempt at burial. Since these contain a considerable amount of domestic garbage and considerable fly-breeding has been taking place, we must request your cooperation in having these wastes buried in accordance with the State Sanitary Code.

We would call your attention to our letter of September 4, 1967 requesting that you make arrangements with the County Solid Waste Agency to dispose of all refuse at the County Site, so that the town disposal site may be discontinued and the necessary final cover and grading effected.

Very truly yours,

W. M. Friedman, P.E.
Assistant Commissioner for
Environmental Health

WMP:lan

CC: B. Murphy

NEW YORK STATE DEPARTMENT OF HEALTH

INSPECTION REPORT FOR REFUSE DISPOSAL AREAS

NAME OF SITE		LOCATION (T,V,C)		COUNTY	
OWNER		ADDRESS		PHONE	
OPERATOR		ADDRESS		PHONE	
DAYS AND HOURS SITE IS OPEN					
MUNICIPALITIES SERVED			REFUSE COLLECTORS (NAMES)		
TOTAL POPULATION			PERCENT SERVED		
COLLECTIONS PER WEEK: SUMMER		WINTER		TYPES OF REFUSE: MIXED <input type="checkbox"/> GARBAGE <input type="checkbox"/> REFUSE <input type="checkbox"/> OTHER <input type="checkbox"/>	
BUSINESS		TOTAL AMOUNT OF REFUSE: TONS PER WEEK			
RESIDENTIAL					
TOTAL USABLE AREA (ACRES)	TYPE OF SOIL AND TOPOGRAPHY			DEPTH TO ROCK	DEPTH TO GROUND WATER
DUMPING CONTROLLED BY SIGNS <input type="checkbox"/> FENCING <input checked="" type="checkbox"/> SUPERVISION <input checked="" type="checkbox"/>		APPROACH ROAD PASSABLE TO TRAFFIC ALL YEAR		YES	NO
GATE AND LOCK PROVIDED AT ENTRANCE		CONTROL MEASURES FOR RODENTS AND INSECTS		YES	NO
SITE LOCKED WHEN CLOSED		HAZARD CREATED BY INDUSTRIAL WASTE DISPOSAL		YES	NO
ATTENDANT ON DUTY WHEN SITE IS OPENED		LEACHING TO A WATERCOURSE		YES	NO
DRAINAGE INTERFERES WITH OPERATION		FLOATING SOLIDS IN A WATERCOURSE		YES	NO
PAPERS CONFINED TO SITE		DUMPING CONFINED TO A STRIP		YES	NO
DO SWINE FEED ON DUMP		SCAVENGER WASTE PERMITTED		YES	NO
COMPLAINTS FROM PEOPLE IN THE AREA		SALVAGING PERMITTED		YES	NO
SUITABLE COVER MATERIAL AVAILABLE		BURNING PRACTICED		YES	NO
IS REFUSE ADEQUATELY COVERED		BURNED IN SPECIAL AREA AWAY FROM DUMP		YES	NO
COVER MAINTAINED TO PREVENT EXCESSIVE POOLING OF WATER, CRACKING, ETC.		TYPE OF MATERIAL BURNED:			
DEPTH OF COVER:					
TYPE OF COVER:		METHODS OF CONTROL:			
FREQUENCY OF COVER:		FREQUENCY AND TIME OF BURNING:			
ADEQUATE EQUIPMENT AVAILABLE TO MAINTAIN DISPOSAL AREA		FIRE PROTECTION AVAILABLE			
DESCRIBE TYPE AND NUMBERS:		DESCRIBE:			
METHODS OF DISPOSAL OF LARGE ITEMS (FURNITURE, TANKS, APPLIANCES, STUMPS, ETC.)		PRECAUTIONS TAKEN TO PREVENT FIRE:			
EXEMPTIONS GRANTED BY FULL-TIME HEALTH OFFICER:					
INSPECTED BY (SIGNATURE)		PERSON INTERVIEWED		DATE	
		TITLE			

*STATE DETAILS UNDER REMARKS

Address Reply to:

Field Office
355 77th Street
Niagara Falls, New York 14304

May 20, 1968

Mr. W. M. Friedman, P. E.
Asst. Commissioner for Environmental Health
Niagara County Health Department
325 Bewley Building
Lockport, New York 14090

Dear Mr. W. M. Friedman, P. E.

Subject: Chemical Waste Disposal
Township of Wheatfield

In reference to your letter of May 6, 1968, where you requested assurance that there was no garbage or refuse in our proposed dump site this office has the following comments:

A.) On May 16, 1968, our District Soils Engineer sent you copies of the four (4) explorations in the Town of Wheatfield dump area, these borings show no garbage or refuse in our proposed dump area.

B.) Finished grades will be in accordance with the plans submitted by Krehbiel, Guay, Rugg & Hall and under the supervision of the State of New York.

Very truly yours,

Joseph P. Cain

Joseph P. Cain
Engineer-in-Charge
N.Y.S. Dept. of Trans.

JPC/jmw

cc. Mr. Norman W. Krapf
Mr. Herbert Goodkind
Mr. Vincent S. Bogren
File



STATE OF NEW YORK

Chemical Dump
DEPARTMENT OF TRANSPORTATION

GEN. WILLIAM J. DONOVAN STATE OFFICE BLDG., 125 MAIN ST., BUFFALO, N. Y. 14203

COUNTIES IN DISTRICT 5 CATTARAUGUS. CHAUTAUQUA. ERIE. NIAGARA

J. BURCH McMORRAN
COMMISSIONER

NORMAN W. KRAFF
DISTRICT ENGINEER

City of Niagara Falls
LaSalle Expressway, Sect. I
Niagara County

May 16, 1968

Mr. William Friedman
Niagara County Health Department
Lockport, New York

Dear Sir:

At the request of Mr. Joseph Cain, Engineer-In-Charge of the above project, state drilling forces have progressed four (4) explorations in the Town of Wheatfield dump area at the site of the proposed chemical waste disposal location.

The soils material at the disposal elevations appears to be a highly plastic glacial till, highly impervious. Atterberg Limit tests run on representative samples place the Liquid limit at approx. 43% with a Plastic Index of about 23.

The Silt-Clay is highly impervious to the flow of water and should be an acceptable dump area.

The boring logs of our drill holes as well as a location plan of same is attached.

Very truly yours,

By *Peter Nowadly*
Peter Nowadly
District Soils Engineer

PN:rd

CC: Mr. K. L. Reitmeier
Mr. J. P. Cain
District Office File
Soils Lab File

RECEIVED
MAY 20 1968
NIAGARA COUNTY HEALTH
DEPT. LOCKPORT, N. Y.

DISTRICT NO. 5
 COUNTY Niagara
 B.S.M. PROJ. NO. 5-591

STATE OF NEW YORK
 DEPARTMENT OF PUBLIC WORKS
 BUREAU OF SOIL MECHANICS
 SUBSURFACE EXPLORATION LOG
 (STATE FORCES)

HOLE NO. DH #1
 LINE & STA. see
 OFFSET attached

PROJECT La Salle Arterial Hwy, Section 1
 QUAD. LOCATION _____ DATE, START 5-10-68 SURF. ELEV. 578.5
 SOIL SERIES _____ DATE, FINISH 5-10-68 DEPTH TO WATER see note
 (ALSO DESCRIBE UNDER "REMARKS")

CASING O.D. _____ I.D. _____ WEIGHT OF HAMMER 300# HAMMER FALL _____
 SAMPLER O.D. 2" I.D. 1-3/8" INSIDE LENGTH OF SAMPLER 20" CASING SAMPLER 18"

DEPTH BELOW SURFACE	BLOWS ON CASING	SAMPLE NO.	BLOWS ON SAMPLER					CROSS SECTION	MOISTURE	COLOR	DESCRIPTION OF SOIL AND ROCK	REMARKS
			0 6	6 12	12 18	18 24						
0		1	Sampled from Auger							M Br	Silt, some clay, tr. of organic matter, fine sand & sanitary fill material	(FIRM) 573.5
5		2	2	5		4			37.0	Br	Silt, some clay, tr. to some sanitary fill material	(FIRM & PLASTIC) 568.5
10		3	8	8		6			38.6	Br	Silt, some clay, tr. of sanitary fill material	(STIFF & PLASTIC) 563.5
15		4	1	1		1			42.8	Br	Silt, some clay, tr. of fine sand	(VERY SOFT & PLASTIC) 558.5
20		5	1	1		1			46.0	Br	Silt, some clay, tr. of fine sand & sanitary fill material	(VERY SOFT & PLASTIC) 553.5
25		6	wt	wt		wt			42.9	Br	Silt, some clay	(VERY SOFT & PLASTIC)
30		7	wt	1		1			42.6	Br	Same	(VERY SOFT & PLASTIC) 543.5
35		8	21	10	3					M Br	Silt, some fine sand, tr. of fract. stone & clay	(HARD) 542.5
											Bottom of Hole	
40											NOTE: Gnd. to Water: 3' at 3'	
45											Non-evident at 36'	
50												

THE SUBSURFACE INFORMATION SHOWN HEREON WAS OBTAINED FOR STATE DESIGN AND ESTIMATE PURPOSES. IT IS MADE AVAILABLE TO BIDDERS ONLY THAT THEY MAY HAVE ACCESS TO IDENTICAL INFORMATION AVAILABLE TO THE STATE. IT IS PRESENTED IN GOOD FAITH, BUT IS NOT INTENDED AS A SUBSTITUTE FOR INVESTIGATIONS, INTERPRETATION OR JUDGMENT OF THE BIDDER.

DRILL RIG OPERATOR S. Bauer
 SOIL DESCRIPTIONS J. R. Zieziula
 ROCK DESCRIPTIONS _____
 DISTRICT SOILS ENGR. P. Nowadly
 SHEET 1 OF 1 HOLE NO. DH #1

Town of Wheatfield Proposed Chemical Waste Dump Area

DISTRICT NO. <u>5</u> COUNTY <u>Niagara</u> B.S.M. PROJ. NO. <u>5-591</u>	STATE OF NEW YORK DEPARTMENT OF PUBLIC WORKS BUREAU OF SOIL MECHANICS SUBSURFACE EXPLORATION LOG (STATE FORCES)	HOLE NO. <u>DH #2</u> LINE & STA. <u>see</u> OFFSET <u>attached</u>
---	---	---

PROJECT <u>LaSalle Arterial Hwy. Section I</u>	DATE, START <u>5-10-68</u>	SURF. ELEV. <u>577.6</u>
QUAD. LOCATION _____	DATE, FINISH <u>5-10-68</u>	DEPTH TO WATER <u>see note</u>
SOIL SERIES _____	(ALSO DESCRIBE UNDER "REMARKS")	

CASING O.D. _____ I.D. _____	WEIGHT OF HAMMER <u>300#</u>	HAMMER FALL _____
SAMPLER O.D. <u>2"</u> I.D. <u>1-3/8"</u>	INSIDE LENGTH OF SAMPLER <u>20"</u>	CASING SAMPLER <u>18"</u>

DEPTH BELOW SURFACE	BLOWS ON CASING	SAMPLE NO.	BLOWS ON SAMPLER					CROSS SECTION	MOISTURE	COLOR	DESCRIPTION OF SOIL AND ROCK	REMARKS
			0 6	6 12	12 18	18 24	24 30					
0		1								W Blk	Organic Matter with fine sand, tr. of silt & clay	(VERY LOOSE)
5		2	4	5						M Br	Silt, some clay, tr. of fine sand & organic matter	(FIRM)
10		3	3	2						W Br	Fine sand, some silt & clay	(LOOSE)
15		4	wt	wt						40.1 Br	Silt, some clay, tr. of fine sand & fract. stone	(VERY SOFT & PLASTIC)
20		5	1	1						43.4 Br	Same	(VERY SOFT & PLASTIC)
25		6	wt	wt						W Br	Fine sand, some silt & clay, tr. of fract. stone	(VERY LOOSE)
30		7	22	26						M Br	Coarse sand, some silt, tr. of clay, fine sand & round stone	(VERY COMPACT)
35		8	11	23						32.1 Br	Silt, some clay & fine sand, tr. of fract. stone (HARD & SEMI-PLASTIC)	
											Bottom of Hole	
40											NOTE: Gnd. to Water: 4' at 4' Non-evident at 36.5'	

THE SUBSURFACE INFORMATION SHOWN HEREON WAS OBTAINED FOR STATE DESIGN AND ESTIMATE PURPOSES. IT IS MADE AVAILABLE TO BIDDERS ONLY THAT THEY MAY HAVE ACCESS TO IDENTICAL INFORMATION AVAILABLE TO THE STATE. IT IS PRESENTED IN GOOD FAITH, BUT IS NOT INTENDED AS A SUBSTITUTE FOR INVESTIGATIONS, INTERPRETATION OR JUDGMENT OF THE BIDDER.

DRILL RIG OPERATOR S. Bauer
 SOIL DESCRIPTIONS J. R. Zieziula
 ROCK DESCRIPTIONS _____
 DISTRICT SOILS ENGR. P. Nowadly
 SHEET 1 OF 1. HOLE NO. DH #2

Town of Wheatfield Proposed Chemical Waste Dump Area

DISTRICT NO. <u>5</u> COUNTY <u>Niagara</u> B.S.M. PROJ. NO. <u>5-591</u>		STATE OF NEW YORK DEPARTMENT OF PUBLIC WORKS BUREAU OF SOIL MECHANICS SUBSURFACE EXPLORATION LOG (STATE FORCES)		HOLE NO. <u>DH #3</u> LINE & STA. <u>see</u> OFFSET <u>see</u> attached attached	
PROJECT <u>LaSalle Arterial Hwy, Section I</u>				SURF. ELEV. <u>577.4</u>	
QUAD. LOCATION _____		DATE, START <u>5-10-68</u>		DATE, FINISH <u>5-10-68</u>	
SOIL SERIES _____		DEPTH TO WATER <u>see note</u> (ALSO DESCRIBE UNDER "REMARKS")			
CASING O.D. _____ I.D. _____		WEIGHT OF HAMMER <u>300#</u>		HAMMER FALL _____	
SAMPLER O.D. <u>2"</u> I.D. <u>1-3/8"</u>		INSIDE LENGTH OF SAMPLER <u>20"</u>		CASING _____ SAMPLER <u>8"</u>	

DEPTH BELOW SURFACE	BLOWS ON CASING	SAMPLE NO.	BLOWS ON SAMPLER				CROSS SECTION	MOISTURE	COLOR	DESCRIPTION OF SOIL AND ROCK	REMARKS
			0-6	6-12	12-18	18-24					
0		1	Sampled from Flights					W Br	Fine sand, tr. of silt & clay	(LOOSE)	
5		2	2	3				M Br	Silt, some clay, tr. to some fine sand	(SOFT)	
10		3	2	2				22.0 Br	Silt, some clay, tr. of fine sand	(SOFT & PLASTIC)	
15		4	1	1				28.0 Br	Silt, some clay, tr. to some fine sand	(VERY SOFT & PLASTIC)	
20		5	wt	1				39.3 Br	Same	(VERY SOFT & PLASTIC)	
25		6	wt	wt				33.4 Br	Same	(VERY SOFT & PLASTIC)	
30		7	wt	wt				43.2 Br	Silt, some clay	(VERY SOFT & PLASTIC)	
35		8	8	9				32.9 Br	Silt, some clay, tr. of fract. stone & fine sand	(STIFF & PLASTIC)	
					21				Bottom of Hole	540.9	
NOTE: Gnd. to Water: 2.5' at 2.5' Non-evident at 36.5'											

THE SUBSURFACE INFORMATION SHOWN HEREON WAS OBTAINED FOR STATE DESIGN AND ESTIMATE PURPOSES. IT IS MADE AVAILABLE TO BIDDERS ONLY THAT THEY MAY HAVE ACCESS TO IDENTICAL INFORMATION AVAILABLE TO THE STATE. IT IS PRESENTED IN GOOD FAITH, BUT IS NOT INTENDED AS A SUBSTITUTE FOR INVESTIGATIONS, INTERPRETATION OR JUDGMENT OF THE BIDDER.

DRILL RIG OPERATOR S. Bauer
 SOIL DESCRIPTIONS J. R. Zieziula
 ROCK DESCRIPTIONS _____
 DISTRICT SOILS ENGR. P. Nowadly
 SHEET 1 OF 1. HOLE NO. DH #3

DISTRICT NO. <u>5</u> COUNTY <u>Niagara</u> B.S.M. PROJ. NO. <u>5-591</u>		STATE OF NEW YORK DEPARTMENT OF PUBLIC WORKS BUREAU OF SOIL MECHANICS SUBSURFACE EXPLORATION LOG (STATE FORCES)		HOLE NO. <u>DH #4</u> LINE & STA. <u>see</u> OFFSET <u>attached</u>	
PROJECT <u>LaSalle Arterial Hwy. Section I</u>					
QUAD. LOCATION _____		DATE, START <u>5-10-68</u>		SURF. ELEV. <u>578.1</u>	
SOIL SERIES _____		DATE, FINISH <u>5-10-68</u>		DEPTH TO WATER <u>see note</u> (ALSO DESCRIBE UNDER "REMARKS")	
CASING O.D. _____ I.D. _____ SAMPLER O.D. <u>2"</u> I.D. <u>1-3/8"</u>		WEIGHT OF HAMMER <u>300#</u> INSIDE LENGTH OF SAMPLER <u>20"</u>		HAMMER FALL _____ CASING SAMPLER <u>18"</u>	

DEPTH BELOW SURFACE	BLOWS ON CASING	SAMPLE NO.	BLOWS ON SAMPLER					CROSS SECTION	MOISTURE	COLOR	DESCRIPTION OF SOIL AND ROCK	REMARKS
			0 6	6 12	12 18	18 24	24					
0		1	Sampled from Flights						2.3	Brn Blk	Silt, some clay & fine sand	(SOFT & PLASTIC)
5		2	2	4						w Br Blk	Fine sand, some silt, tr. of organic matter	(LOOSE)
10		3	3	5						30.9 Br	Silt, some clay, tr. of fine sand	(FIRM & PLASTIC)
15	3" x 3-3/8" AUGERS	4	wt	wt						44.8 Br	Same	(VERY SOFT & PLASTIC)
20	FLIGHT	5	1	1						38.2 Br	Same	(VERY SOFT & PLASTIC)
25	FLIGHT	6	1	1						32.5 Br	Same	(VERY SOFT & PLASTIC)
30	HOLLOW	7	1	1						38.2 Br	Same	(VERY SOFT & PLASTIC)
35		8	17	21						24.9 Br	Silt, some clay, tr. to some fine sand & fract. stone	(HARD & SEMI-PLASTIC)
40		9	50	74						Br W	Silt, some fine sand, tr. to some fract. stone, tr. of clay	(HARD)
											Bottom of Hole	
											NOTE: Cnd. to Water:	
											3' at 3'	
											Non-evident at	41.5

THE SUBSURFACE INFORMATION SHOWN HEREON WAS OBTAINED FOR STATE DESIGN AND ESTIMATE PURPOSES. IT IS MADE AVAILABLE TO BIDDERS ONLY THAT THEY MAY HAVE ACCESS TO IDENTICAL INFORMATION AVAILABLE TO THE STATE. IT IS PRESENTED IN GOOD FAITH, BUT IS NOT INTENDED AS A SUBSTITUTE FOR INVESTIGATIONS, INTERPRETATION OR JUDGMENT OF THE BIDDER.	DRILL RIG OPERATOR <u>S. Bauer</u> SOIL DESCRIPTIONS <u>J. R. Zieziula</u> ROCK DESCRIPTIONS _____ DISTRICT SOILS ENGR. <u>P. Nowadly</u> SHEET <u>1</u> OF <u>1</u> .
---	--

HOLE NO. DH #4

NEW YORK STATE DEPARTMENT OF HEALTH

INSPECTION REPORT FOR REFUSE DISPOSAL AREAS

NAME OF SITE <i>Landfill</i>		LOCATION (T, V, C) <i>Landfill</i>	COUNTY <i>Albany</i>
OWNER <i>Landfill</i>	ADDRESS		PHONE
OPERATOR <i>LR 200</i>	ADDRESS		PHONE
DAYS AND HOURS SITE IS OPEN			
MUNICIPALITIES SERVED <i>N.Y.</i>		REFUSE COLLECTORS (NAMES) <i>N.Y. SAN</i>	
TOTAL POPULATION _____ PERCENT SERVED _____			
COLLECTIONS PER WEEK: SUMMER <i>2</i> WINTER <i>2</i>		TYPES OF REFUSE: MIXED <input type="checkbox"/> GARBAGE <input checked="" type="checkbox"/> REFUSE <input checked="" type="checkbox"/> OTHER <input type="checkbox"/>	
BUSINESS <i>2</i> RESIDENTIAL <i>16</i>		TOTAL AMOUNT OF REFUSE: <i>75</i> TONS PER WEEK	
TOTAL USABLE AREA (ACRES) <i>30</i>	TYPE OF SOIL AND TOPOGRAPHY <i>Flat Swampy</i>		DEPTH TO ROCK _____
DEPTH TO GROUND WATER _____			
DUMPING CONTROLLED BY SIGNS <input checked="" type="checkbox"/> FENCING <input checked="" type="checkbox"/> SUPERVISION <input checked="" type="checkbox"/>		APPROACH ROAD PASSABLE TO TRAFFIC ALL YEAR	
GATE AND LOCK PROVIDED AT ENTRANCE		CONTROL MEASURES FOR RODENTS AND INSECTS	
SITE LOCKED WHEN CLOSED		HAZARD CREATED BY INDUSTRIAL WASTE DISPOSAL	
ATTENDANT ON DUTY WHEN SITE IS OPENED		LEACHING TO A WATERCOURSE	
DRAINAGE INTERFERES WITH OPERATION		FLOATING SOLIDS IN A WATERCOURSE	
PAPERS CONFINED TO SITE		DUMPING CONFINED TO A STRIP	
DO SWINE FEED ON DUMP		SCAVENGER WASTE PERMITTED	
COMPLAINTS FROM PEOPLE IN THE AREA		SALVAGING PERMITTED	
SUITABLE COVER MATERIAL AVAILABLE		BURNING PRACTICED	
IS REFUSE ADEQUATELY COVERED		BURNED IN SPECIAL AREA AWAY FROM DUMP	
COVER MAINTAINED TO PREVENT EXCESSIVE POOLING OF WATER, CRACKING, ETC.		TYPE OF MATERIAL BURNED:	
DEPTH OF COVER:		<i>None</i>	
TYPE OF COVER: <i>dirt Day for Site</i>		METHODS OF CONTROL: <i>None</i>	
FREQUENCY OF COVER:		FREQUENCY AND TIME OF BURNING: <i>None</i>	
ADEQUATE EQUIPMENT AVAILABLE TO MAINTAIN DISPOSAL AREA YES <input type="checkbox"/> NO <input type="checkbox"/>		FIRE PROTECTION AVAILABLE YES <input type="checkbox"/> NO <input type="checkbox"/>	
DESCRIBE TYPE AND NUMBERS: <i>Dozer International 7 D 15</i>		DESCRIBE: <i>like 1/2 of 7-2 Dep</i>	
METHODS OF DISPOSAL OF LARGE ITEMS (FURNITURE, TANKS, APPLIANCES, STUMPS, ETC.) <i>Crushed & Burned</i>		PRECAUTIONS TAKEN TO PREVENT FIRE: <i>None</i>	

EXEMPTIONS GRANTED BY FULL-TIME HEALTH OFFICER:

INSPECTED BY (SIGNATURE)

R Maida

PERSON INTERVIEWED

TITLE

DATE

*STATE DETAILS UNDER REMARKS

Niagara Sanitation
Disposal Area #2
Town of Wheatfield Dump
Nov 16, 1967
R. Maida



1/2 Mile

Shack

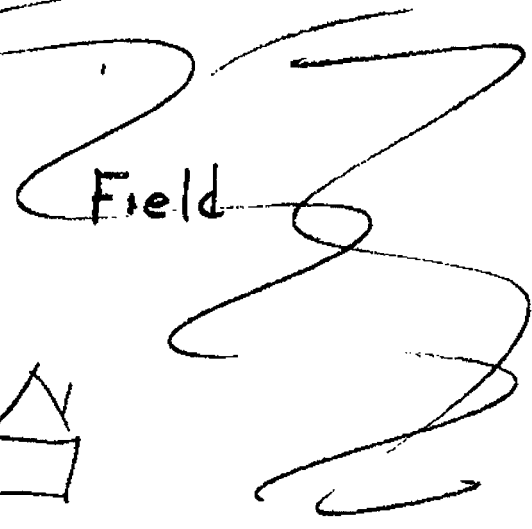
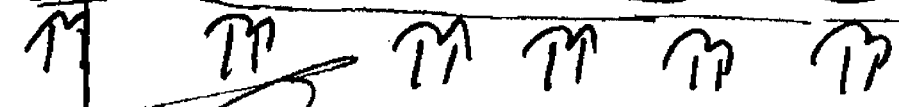
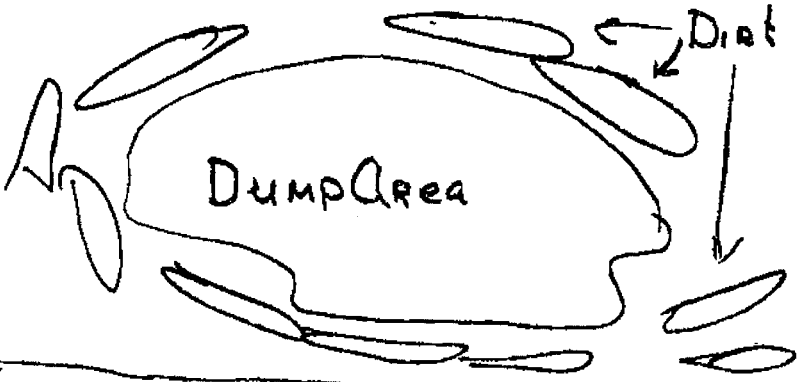

Power Lines

Haul Rd

Field

Nash Rd

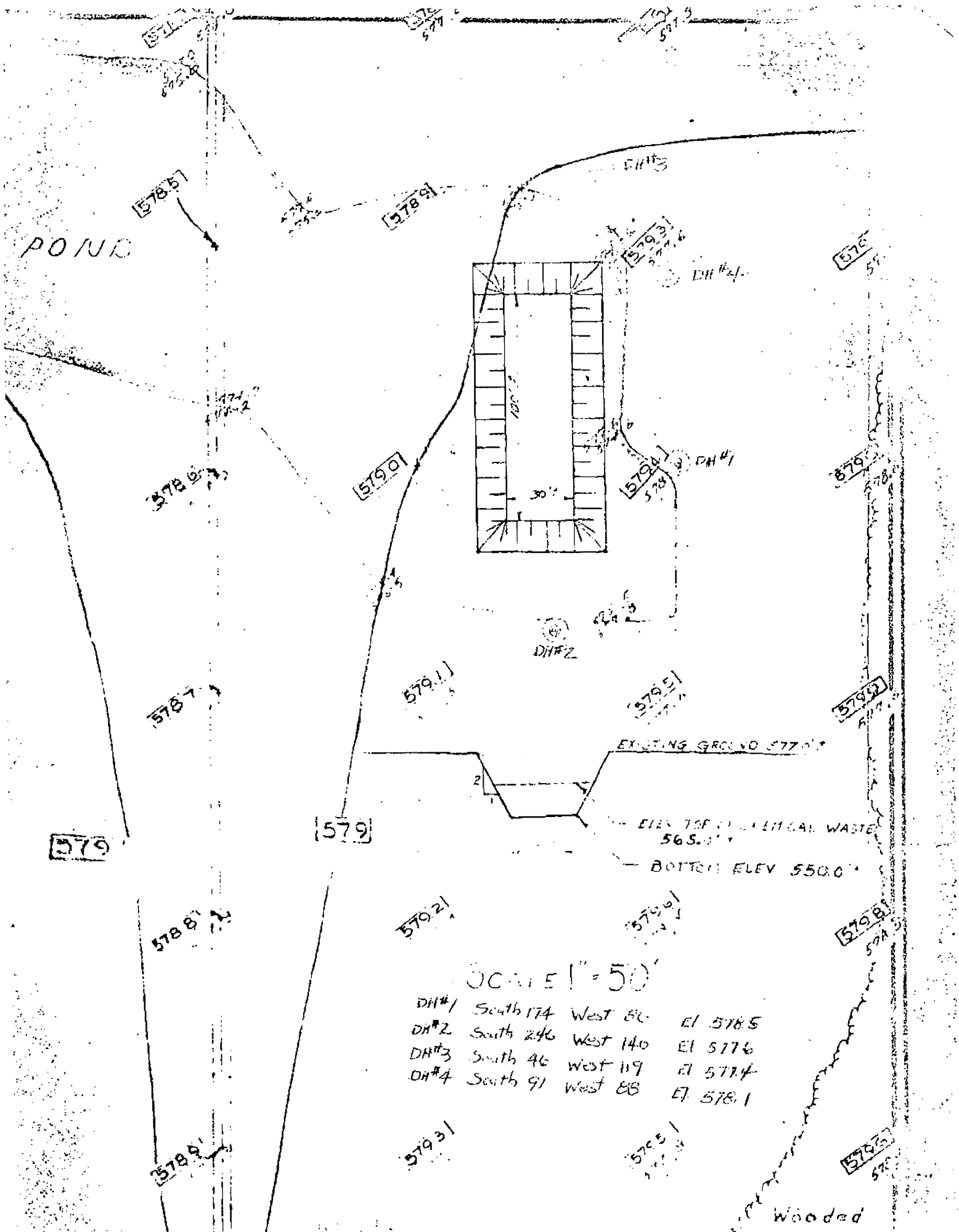

Code Activity

Code Location

Service Request No.

Date Received Complaint

Service Request

Originator of Complaint Address

Owner Address

Occupant Address

Date	Hours	REPORT OF INVESTIGATION
		<p>The sketch depicts a field area with several features labeled in handwritten text:</p> <ul style="list-style-type: none"> Top Left: A large, irregular oval shape. Top Right: The letters "F H" followed by a vertical line and an "X". Center: A series of small circles arranged in a horizontal line, with the text "Damp Area" written below them. Bottom Left: Three large, stylized "A" shapes. Bottom Center: The word "Field" written in a large, stylized font. Bottom Right: The words "Power Line" written in a stylized font. Far Right: A vertical line with a series of small circles or dots along it.

Kush Date Abated _____ By _____

May 6, 1968

Mr. Joseph P. Cain
Engineer-In-Charge
New York State
Department of Transportation
Field Office
355 - 77th Street
Niagara Falls, New York 14304

Dear Mr. Cain:

Subject: Chemical Waste Disposal
Township of Wheatfield

This will confirm my phone conversation of May 3, 1968, relative to the above subject. Before this office could consider approval of the disposal of this chemical solid waste into the Town of Wheatfield disposal area, we would have to be assured that:

- a. No garbage or refuse has been disposed of in the immediate area proposed for this chemical waste.
- b. Finished grades would be in accordance with the plans submitted by the office of Krehbiel, Guay, Rugg, and Hall, and under their supervision.

Very truly yours,

W.M. Friedman, P.E.
Assistant Commissioner
for Environmental Health

WMF/cs

File: Mr. San
No. 101
10/27/67

Mr. Friedman

DATE RECEIVED

10/27/1967

NIAGARA COUNTY HEALTH
DEPT. LOCKPORT, N.Y.

December 27, 1967

Mr. Milton Bassey
Bassey Trucking Co.
10315 Lockport Road
Niagara Falls, N. Y.

Re: Town of Wheatfield
Refuse Disposal Site

Dear Sir:

This letter will confirm your telephone conversation with Mr. Michael Topovici of this department on Tuesday, December 26, 1967, at which time you were told to immediately cease dumping industrial waste at the Town of Wheatfield refuse disposal site.

No additional dumping will be allowed at this site until compliance with Section 19, Chapter I, New York State Sanitary Code and Chapter IV, Niagara County Sanitary Code, can be achieved. All industrial waste presently accumulated on the surface of the ground at the northeast sector of the disposal site must be properly compacted and covered with six (6) inches of satisfactory cover material. Furthermore, sufficient cover material is to be stockpiled at the disposal site to maintain a constant six (6) inches of cover material and provide a final compacted cover of at least two (2) feet, which shall be placed within one week after the final deposit of refuse at any portion of the disposal site. In addition, your firm should make arrangements with the Town of Wheatfield to have the disposal site prepared in advance to accept all future loads of waste. This would include a prepared trench to dump into and adequate earth-moving equipment to immediately compact and cover the material.

On October 17, 1967 you were notified by this office that your application for permit to transport offensive material and proposed disposal site could not be approved. Therefore, you are illegally operating in the refuse disposal business in Niagara County. You should immediately re-submit your application for a permit and this application must include all proposed disposal sites that you will be using in Niagara County. These will be inspected by the Health Department staff to insure that each proposed disposal site meets the requirements of the sanitary code. You will not be allowed to dump at any location in the county that has not been approved as an acceptable, properly operated disposal site.

Effective immediately you must discontinue the practice of transporting and disposing of offensive material in Niagara County until you have obtained the required permit to provide this service.

Mr. Milton Hasley

-2-

December 27, 1967

Please call this office if we can offer any assistance to you in this matter.

Very truly yours,

Ernest R. Nelson
Associate Public Health Sanitarian

ERG:n

cc:
Carborundum -
Coated Abrasives Division
Bell Aerocrystalline
town of Westfield

FAC 67-15, FALSE 67-1
LaSalle Arterial Highway
Section I Niagara County

Mr. Ernest R. Gedson, Chief - Bureau of Air Pollution Control
Niagara County Health Department
City Hall of Niagara Falls
Niagara Falls, New York

May 1, 1968

Dear Sir:

Reference is made to a chemical waste material located at Frontier Avenue near 99th Street on the above captioned project.

On April 23, 1968, Mr. Fred Lemke, Peace Justice Town of Wheatfield, Mr. Stanley Brzezinski, supervisor Town of Wheatfield, Mr. F. O. Garthoff, project manager for Stimm Associates and myself visited the Town of Wheatfield dump located East of Nash Road in the Town. The two (2) Board members were receptive of disposing this chemical waste in the Northeast corner of the dump.

We propose to excavate a hole some 25' to 27' in depth and dispose of this chemical waste. The top of this waste will be some 3' to 5' (feet) below any and all sanitary sewer, water line, septic tanks etc. The size of the hole may vary in length and width depending upon the amount of chemical waste we must dispose of. The amount of chemical waste is approximately 1,000 \pm c.y. from our test holes but may vary when actual excavation commences. After the chemical waste is placed it will be backfilled with the excavated material to finish grade. The excess material will be spread in the immediate surrounding area to correct a low spot in the dump.

Enclosed are the following drawings for you information:

- 1.) Drawing #67-K-03D - Titled Refuse Disposal Area - Town of Wheatfield prepared by Krehbiel, Huffcut, Walters & Guay dated June 1967. In the upper right hand corner I have plotted in green our proposed dump area with a section showing elevations.
- 2.) Boring locations in this area with copies of the soil boring results.
- 3.) One (1) drawing each of nearby residence and water line in the general area.

Project: Pac 67-15, FALSE 67-1
LaSalle Arterial Highway
Section I Niagara County

- 4.) One (1) copy of drawing No. 5641 G prepared by Krehbiel and Krehbiel of the Bell Air Subdivision just south of the Town of Wheatfield dump. This drawing shows elevation of the first floor and surrounding area.

Kindly advise this office of your decision in the matter so that this chemical waste can be disposed of as quickly as possible.

Very truly yours,

Joseph P. Cain

Joseph P. Cain
Engineer-in-Charge
N.Y.S. Dept. of Trans.

JPC/jmw

Encls.

cc. Mr. Norman W. Krapf
Mr. F. O. Garthoff
Mr. Vincent Bogren
File

Address reply to:

Mr. Joseph P. Cain
Field Office
355 - 77th Street
Niagara Falls, New York 14304

283 730

November 1, 1967

Frederick Huffcut Walters Quay
1868 Niagara Falls Blvd.
Tonawanda, New York

ATTENTION: Mr. R. Kent English

Re: Proposed Fill and Grading
Township of Wheatfield
Disposal Area

Dear Mr. English:

Inclosed is an approved copy of the plans submitted by you for the proposed cover and grading on the Township of Wheatfield Disposal Site. We trust that the township will carefully follow the proposed grades and that the necessary work will be accomplished without any unnecessary delay.

We would also request that you furnish the City of North Tonawanda Engineering Department with a copy of this plan so that they may take appropriate steps to solve any drainage problems with the City.

Very truly yours,

E. H. Friedman, P.E.
Assistant Commissioner for
Environmental Health

MEF/cg

Enclosure

CC: Mr. Bert J. Murphy
Mr. Hardleben



KREHBIEL
HUFFCUT
WALTERS
GUAY

e n g i n e e r s 1868 NIAGARA FALLS BLVD. TONAWANDA, N. Y. 14152 • 716-693-9300
s u r v e y o r s

THEODORE A. KREHBIEL
JAMES A. HUFFCUT
WILLIAM N. WALTERS
JAMES E. GUAY

WILLIAM J. RUGG
CHARLES M. HALL
WILLIAM R. PICTOR

October 30, 1967

Niagara County Health Department
525 Bewley Building
Lockport, New York

Attention: Mr. W. M. Friedman, P. E.

Re: Town of Wheatfield
Disposal Area Grading

Dear Mr. Friedman:

Enclosed, for your approval, are three (3) prints of the proposed grading for the Town of Wheatfield Disposal Site adjacent to the City of North Tonawanda.

Very truly yours

KREHBIEL-GUAY-RUGG-HALL

R. Kent English
R. Kent English

RKE/mz

Enclosures

cc: Mr. Winston Moeller
Mr. Stanley Brzezinski

October 3, 1967

Krehbiel-Guay-Rugg-Hall
Engineers, Surveyors
1868 Niagara Falls Boulevard
Tonawanda, New York 14152

Attention: Mr. Guay

Dear Jim:

In accordance with our telephone conversation of October 3, 1967, I am returning the grade plans for the Wheatfield Town Dump. It would appear that, while you have given ample attention to the grade, the matter of proper cover has not been taken into account. We will, therefore, appreciate your reviewing this matter and advising us accordingly.

Very truly yours,

W.M. Friedman, P.E.
Assistant Commissioner
for Environmental Health

WMF/cs
Enclosure



KREHBIEL
HUFFCUT
WALTERS
GUAY

e n g i n e e r s
s u r v e y o r s

1868 NIAGARA FALLS BLVD. TONAWANDA, N.Y. 14152 • 716-693-9300

THEODORE A. KREHBIEL
JAMES A. HUFFCUT
WILLIAM N. WALTERS
JAMES E. GUAY

WILLIAM J. RUGG
CHARLES M. HALL
WILLIAM R. PICTOR

September 25, 1967

Niagara County Department of Health
Bewley Building
Lockport, New York

Attention: Mr. William Friedman

Dear Mr. Friedman:

Enclosed are three (3) prints of the grading proposed for the Town of Wheatfield Disposal Area adjacent to the City of North Tonawanda. We would like your approval of this before proceeding with the work.

Listed below are the industrial establishments which we have contacted with respect to the comprehensive sewerage study for Wheatfield, Pendleton, Cambria and Lewiston.

New York State Power Authority
Greif Brothers Cooperage
Bell Aerosystems
Carborundum Company - Coated abrasives
Carborundum Company - Graphite Products
Continental Can Company
Frontier Chemical Process Inc.

Page 2

We have received replies from all of these except for Frontier Chemical. For each we have annual water consumptions, estimated polluted discharges, and general information as to type of pollutants. In addition we have contacted the military installations in the area, --

Niagara Falls Air Force Base

Lockport Air Force Base (Shawnee Road)

U. S. Army Nike Site (Upper Mountain Road)

and have reviewed the operating records of each of these installations.

Do you have any further information regarding these industries and the military which might be helpful to us?

Very truly yours

KREHBIEL-GUAY-RUGG-HALL

Richard K. English

Richard K. English

RKE/mew

67 K 03

F

July 26, 1967

Mr. Paul Rumbold, Mayor
City Hall
North Tonawanda, New York

Dear Hon. Rumbold:

Reference is made to the attached letter to the Township of Wheatfield relative to improvements in their refuse disposal site. Since the City of North Tonawanda is apparently not interested in jointly solving the drainage problems on the City-Town Line at the rear of the Forbes Circle properties, it is assumed that the Township of Wheatfield will proceed independently on this problem and that the City of North Tonawanda will do likewise.

Very truly yours,

W. M. Friedman, P.E.
Assistant Commissioner
for Environmental Health

WLF....cg
Enclosure

CC: James Guay
CC: Town of Wheatfield

July 25, 1967

Mr. John Brzezinski, Supervisor
2080 River Road
Niagara Falls, New York

RE: Wheatfield Town Disposal Site

Dear Mr. Brzezinski:

This will confirm the results of a conference and an inspection of the Wheatfield Town Disposal Site on July 21, 1967. Present were Supervisor Brzezinski, Justice Leneke, Town Engineer James Guay, and the writer. The purpose of this inspection and conference was to review the topographic map of the site recently completed, determine necessary filling and grading, and attempt to devise a suitable plan of draining the boundary line between the Township of Wheatfield and the North Tonawanda City Line. For this latter purpose, the officials of the North Tonawanda City Engineer Department had been invited to attend but they were apparently not interested in participating. It is therefore assumed that the City of North Tonawanda will proceed independently to provide adequate drainage for the rear lot lines of the residential properties abutting this disposal site.

It was agreed at this conference that sufficient additional fill would be provided over this general area of the disposal site to insure a total of at least two feet of compacted fill being placed over the original refuse. The property will be graded to the north and northeast and seeded to vegetation. This should minimize any odors or drainage problems on this site.

May we once again express our appreciation for the cooperation you have extended to us in these matters.

Very truly yours,

W. M. Friedman, P.E.
Assistant Commissioner
for Environmental Health

WMP....cg

CC: James Guay
CC: City of North Tonawanda

CITY OF NORTH TONAWANDA

NORTH TONAWANDA, NEW YORK, 14120

CHARLES W. HOBBS SR.
CITY CLERK

June 26, 1967

TELEPHONE
693-0451
693-7253

Dr. Dudley A. Hill, Commissioner
Niagara County Health Department
74 Windermere Road
Lockport, New York

Dear Dr. Hill:

We enclose herewith a copy of a communication sent to the North Tonawanda Common Council and read before the same on June 19, 1967. In addition, we enclose a copy of the resolution which the Common Council took following presentation of the aforementioned letter.

"MOVED by Alderman Hogan SECONDED by Alderman Butcheri
That the Common Council herewith authorizes and directs the
Office of the City Clerk to send copies of the aforementioned
letter to the following: Dr. Dudley Hill, Commissioner of
the Niagara County Health Department, the Niagara County
Board of Supervisors, the Town Board of the Town of Wheat-
field, and North Tonawanda Supervisor Bert Murphy. Further-
more, Dr. Hill is requested to reply and indicate what steps
are being undertaken to alleviate this potentially dangerous
condition.
CARRIED."

Very truly yours,

CHARLES W. HOBBS, SR.
CITY CLERK

CWH/sg
Encl.

N JUN 19 1967

FILED
CITY CLERK'S OFFICE

June 11, 1967

Gentlemen:

1967 JUN 13 AM 10:04

May I bring to ~~your~~ ^{NORTH TONAWANDA, N.Y.} attention a pressing problem concerning the residents of Forbes Street and Terrace. The Town of Wheatfield Dump bordering this area is a hazard to the lives of the children living here.

This dump contains among other things, large unprotected water holes. There are copies of letters to Messrs. Brzinski and Rumbold enclosed that pertain to an experience in this dump with my own son.

The Building Inspector of Wheatfield has explained to me that below ground swimming pools in that town must be enclosed by a proper fence with a lockable gate. It seems to me that large water holes represent as much a hazard to children as do swimming pools. If the Wheatfield Dump cannot be filled and closed, it should be surrounded by a proper fence. (i.e. A high chain link fence as is used in Buffalo dumps. Not a snow fence that can fall over or blow over, and is not intended to be used for a protective fence.)

The ideal solution to this problem is to close this dump, after the water holes have been filled and the land graded properly.

Besides the afore metioned hazard this dump breeds vermin, gives an offensive odor and is graded in such a way that it drains from winter snow and spring rain onto my land leaving a 20 to 30 ft. diameter pond that becomes stagnant and stays until June.

Please act on this problem before a child is killed.

Sincerely yours,

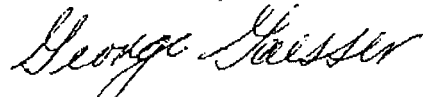
A handwritten signature in cursive script that reads "George Gaesser".

George Gaesser
22 Forbes Terrace
N. Tonawanda, New York

Encl.

NIAGARA COUNTY HEALTH DEPARTMENT

525 BEWLEY BUILDING
LOCKPORT, NEW YORK 14094

DUDLEY A. HILL, M. D.
COMMISSIONER

NEIL S. GORDON, M. D.
DEPUTY COMMISSIONER



DIVISION OF
ENVIRONMENTAL HEALTH SERVICES

W. M. FRIEDMAN, P. E.
ASSISTANT COMMISSIONER

April 18, 1967

Mr. Stanley A. Brzezinski
Supervisor, Town of Wheatfield
2080 River Road
Niagara Falls, New York

Re: Town Refuse Disposal
Wheatfield Town

Dear Mr. Brzezinski:

On April 7, 1967, and again on April 13th, inspections were made of the Town of Wheatfield Disposal Site.

We were extremely gratified to note the tremendous improvement in this operation during the past few months. Garbage and refuse is presently being confined to a limited working area and is being properly covered after each days operation. We should like to take this opportunity to both thank and congratulate your operator Mr. Zino for his cooperation.

We are, however, still concerned over the results of past operational defects, especially in the area to the rear of the Forbes Circle residences. As a result of inadequate cover, more and more refuse is being exposed on the ground surface. Also, because of inadequate grading, an aggravating surface drainage problem has resulted. Both of these conditions were pointed out in our letter of October 3, 1966.

When ground conditions are such as to permit working in this problem area, it is respectfully requested that the required two feet of cover material be provided over this refuse. Proper grading with a minnum slope of 0.5% should be provided to eliminate the many puddles of standing water. With respect to the property line between the disposal site and the residences, the solution might be either a drainage ditch or a storm drain. In any event, it is suggested that perhaps your

April 18, 1967

Superintendent of Highways should confer with the City of North Tonawanda Engineer so that a mutually satisfactory system could be developed.

We appreciate your cooperation in these matters and trust that we will be kept advised of all action taken or contemplated.

Very truly yours,

W. M. Friedman, P.E.

WMF...lam

Mrs. D'Marco
32 Forbes Terrace
N.Tonawanda

Burt Murphy

Mr. Hardleben-City Engineer

Mr. Cvetan

October 3, 1966

Mr. Stanley A. Brzezinski
Supervisor, Town of Wheatfield
2080 River Road
Niagara Falls, New York

Re: Town Refuse Disposal
Township of Wheatfield

Dear Mr. Brzezinski:

On September 12, 1966 our Mr. Friedman met with you, Judge Lamke, and Mr. Angelo Zino of the Niagara Sanitation Company, relative to your refuse disposal site and to discuss the problems being encountered in Mr. Zino's disposal operation. It was pointed out by Mr. Friedman that Part 19 of the New York State Sanitary Code has for the operation of a sanitary land fill, three basic requirements or objectives.

1. That garbage and refuse shall be compacted and covered daily with a compacted layer of at least six inches of suitable cover material.
2. A final compacted cover of at least 2 feet of a suitable cover material shall be placed within one week after the final deposit of refuse at any portion of such refuse disposal area.
3. The final cover material shall be properly graded with a minimum slope of 0.5% (preferably 1.0%) so as to provide accurate surface drainage.

During the September 12 conference, Mr. Zino agreed to comply with all applicable rules and regulations, and summarize his proposed actions, including the effective covering and grading of the completed portions of the refuse area.

Mr. Stanley A. Brzezinski

-2-

October 3, 1966

We are gratified to note that Mr. Zino has in fact greatly improved operations since this September 12th meeting. Since then all refuse has been effectively covered with a minimum of 6 inches of compacted earth, except for one minor mechanical breakdown during the past week which was immediately corrected. We assume that when Mr. Zino relocates to a new area the area now being worked will be covered with the two feet of compacted fill as required. It was also noted that since September 12th an extra bulldozer and an extra man have been made available to the site supplementing the original bulldozer and operator. We are, however, experiencing a little anxiety over the fact that no actual corrective action has been taken upon the completed areas, to provide cover and proper grading for surface drainage. While we do not doubt Mr. Zino's intentions in this matter we would greatly appreciate receiving some written confirmation of his plans so that we may more definitely satisfy the complainants that are occasionally contacting us requesting future action in this matter.

Since the winter weather will soon be upon us, making the grading problems more difficult we would appreciate hearing from Mr. Zino within the next 10 days so that we may be reassured remedial work will be well underway by the 1st of November.

Again, let me express my sincere appreciation for your splendid cooperation in this matter.

Very truly yours,

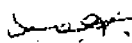
Dudley A. Hill, M. D.
Commissioner

DAH:mb

CC: Mr. Angelo Zino

NIAGARA COUNTY HEALTH DEPARTMENT

DUDLEY A. HILL, M.D.
COMMISSIONER



~~FRANK A. CAMPBELL, M.D.~~
~~DEPUTY COMMISSIONER~~

BOARD OF HEALTH

RAYMOND A. BEITER, PRESIDENT
JOHN H. STUNZ, M.D., VICE-PRESIDENT
RICHARD WENDLANDT
WILLIAM R. CORCORAN, M.D.
STANLEY T. SKOMSKI
DANIEL J. WHITE
EDWARD H. MORGAT, M.D.
RAYMOND M. DEGAN
R. W. LEWIS, D.V.M.
ELLIOTT J. LYNCH

August 29, 1966

Report on Wheatfield Dump:

At 9:15 a.m. I made a routine inspection of the Wheatfield dump in accordance with instructions to keep a daily vigil. The operator of the bulldozer was spreading some dirt cover over an area that had already been covered and graded. This particular section looked very good. *— ? w*

Directly to the rear of the present work site and adjacent to the swamp area was a sizable amount of brush and debris; paper, magazines, chairs, bottles, jars, etc. dumped right on the ground in an area that was already covered. I asked him where it had come from and why it had been dumped there. He told me that he had purposely left it here for me to see and that it had been dumped there on Saturday. He said that on Saturday just as he was closing the dump a large man driving a brown buick and hauling a trailer filled with brush had approached the gate and said he was going to dump. The operator told him where he must dump and instead of dumping where he should have he dumped right in the center of the cleared area. He was then refused permission to enter the second time with another load. When Joe (operator) refused to open the gate this person, according to Joe, said something not too pleasant and told him he was a taxpayer and he was going to dump and if Joe would not open the gate that he would get a key from Hank Krueger. When Joe returned to the dump on Monday a second load of garbage and junk had been deposited on the exact same spot. There were papers, junk, magazines and assorted pieces of junk littered all over an area approx. 10 x 20 yards.

I left the dump and returned to the office where I discussed the condition with Mr. Popovici. We both returned to the dump after first summoning Mr. Al Zino, owner and operator of the dump, to meet us there. He was instructed to clean the area where the violation took place and also clean up all the junk that had accumulated in several areas.

I later tried to contact Mr. Krueger to inform him of what had happened and to suggest that more stringent controls over the issuance of the keys should be exercised. I also contacted Mr. Stan Brzezinski and informed him of the violation. He told me he would find out all he could about the events leading up to this violation and try to find out who the violator was.

July 12, 1966

Mr. Zimo

Mr. Popovici

Niagara Sanitation Refuse Disposal Area

Please be advised that attached memorandum was received by Dr. Hill on Tuesday, July 12 from Mr. Seebald, Buffalo Regional Engineer.

You are hereby requested to comply with items 1-7.

Particularly, Item 1, we feel at this time a snow fence should be erected at both ends of the lateral cut to prevent children from falling into the ditch. Item 2, oil residual placed on the swamp two weeks ago appears to have disappeared.

Sincerely yours,

Michael Popovici
Sanitarian

MP..lsm

STATE OF NEW YORK
DEPARTMENT OF HEALTH

MEMORANDUM

July 11, 1966

To: Dr. Hill - Niagara County Department of Health
From: Mr. Seebald - Buffalo Regional Office
Subject: Town of Wheatfield Refuse Area

I had occasion on July 8, 1966 to view progress at the site of the Wheatfield refuse area. The following is offered for your information:

1. The large excavation at the eastern end of the area is not being used for any purpose. It is much too large for practical cut and fill refuse disposal. At present this excavation presents a proximate hazard to children.
2. There appeared to be little oil residual left on the large garbage-littered swamp to offset mosquito breeding.
3. Recently deposited garbage had not been covered effectively, to obviate burrowing rodents, or to eliminate blowing papers.
4. The bulldozer operator was awaiting a fresh load of refuse and/or garbage, and to accomodate same, had excavated a shallow depression in previously deposited refuse, and accordingly stated that the excavated material would be used to cover the fresh refuse.
5. Attempts at regrading and covering of the easterly end haven't produced an effective final cover.
6. The garbage-littered swamp gave rise to noxious odor conditions.
7. The trenching operation is encroaching on previously buried refuse.

The foregoing prompts the following conclusions and recommendations:

1. The dump operator has not developed a rational plan for dump operation.
2. The equipment operator does not appreciate the philosophies attendant upon proper landfill operation.

3. Steps to minimize nuisance conditions have not been as effective as hoped.

4. An engineering survey by the Town Engineer, a plan for compensating for present deficiencies and for future progressive planned operation, supervised by competent individuals acquainted with sanitary landfill methods is urgently recommended.

It would be most desirable if the County modified its order to the Town, in view of the foregoing, to incorporate the recommendations in the previous paragraph.

A handwritten signature in cursive script, likely of the Town Engineer, is written in the lower right portion of the page.

REPORT TOWN OF WHEATFIELD DUMP

June 1, 1966 to August 31, 1966

File

From the onset of my involvement regarding the Town of Wheatfield Dump, the following things have been eliminated.

1. The gross misuse of rubbish and trash haphazardly dumped in all sections of the dump.
2. The ditch running the entire length North East of the dump was excavated of old garbage which had probably been laying stagnate for two years and compacted up to the swamp area. This is the extreme North East corner directly behind the Pallotine Fathers.
3. The Pallotine Fathers were extremely happy that this condition was removed from their rear yard area. They have been continuously waffed by odors from this ditch. The area directly behind the homes on Forbes Terrace was filled and graded once, this area still must be filled and graded.
4. The old dump area located between Forbes Terrace and the equipment garage has been rough graded. This fill and grade has not stopped, the odors which persist to omit on wet or damp days. This area was limed on August 31 and must also be covered and finished grade. Our odor problem is coming from this old garbage dump area.
5. The swamp has been oiled several times for the control of mosquitoes.
6. One of our original plans of creating a sanitary strip land fill program in which the ditch had been dug 30 feet wide, 10 feet deep and 300 feet long has been filled. A residue of approximately 1/3 of excess dirt is still piled in this area to be used in the final grading of the North East section of the dumps.

7. The operator is presently burying garbage in a low swale area; this operation is insufficient in as much as the ground excavation has not been deep enough and compaction has not been carried out, also lack of sufficient coverage of dirt on the nightly coverings.

It is noted that this operation has sufficient equipment to institute a proper sanitary landfill program, but does not have reliable help. In many instances on our inspections, we have noted times when the dozer operator could be working in other parts of the dump, he goes to sleep in his vehicle while waiting for other loads of garbage to be brought to the dump. His time could be used in pushing old trash into the swamp area and general clean up of the ground area. It is also noted that salvaging is being permitted. That is, in the past few weeks, scavengers have allowed accumulation of small piles of metal junk at several points throughout the dump area. This condition existed without pickup for three weeks, then on Monday, August 29, we requested Mr. Zeno's presence at the dump and directed him to have his operator push all these scrap heaps into the swamp. I do feel that it has been a wast of the taxpayers' money to have the utilization of a man at the dump site every day and incapacitate five to twelve hours of the Health Department's time to insure proper operation of the sanitary landfill program in this dump. In as much as this is a money-making operation, I feel that the responsibility lies with Mr. Zeno to see that his business is functioning proper within the requirements of the law.

I feel that great progress has been made in overall dumping program, that we revert back to the use of the excavated sanitary landfill program for it appears that this area seems to have the most coverage and compaction.

E A F T

P. 10

TOWN OF WHEATFIELD DUMP

6-6-66	10:30	Inspection of area revealed that there was a definite attempt exerted over the weekend to spread and hurry hurry hurry bulldoze large pile of burnable debris and wood into proximate swamp for the purpose of filling swamp as per Mr. Popovici's instructions and program to rid the area of the worst violations and thereby also eliminate the swamp. Will keep dump under constant surveillance. No truck & No bulldozer on site at time of inspection.
6-7-66	9:30	RSM Survey of dump - several loads of cover scattered about dump for recovery recovering of specific area.
6-8-66	10:30	Talked to Mr. Zino-dump operator who has been given plan by Mr. Popovici regard to program
6-9-66	11:30	Survey dump with Mr. Popovici ask talked to dozer operator
6-10-66	1:30	Survey-Back Hoe in place started excavation as per planned program approx. 15'X15' W/10' Trench on North Side of the hole.
6-13-66	9:30	Survey dump- with additional cover spread over pre-covered area- the excavation expanded to approx. 20'X30'
6-14-66	11:30	Met with Mr. Popovici at a dump told operator operator to start pushing into selected swamp and level existing rubbish pile from Carbo & Bell.
6-15-66	9:30	Survey - started to fill in swamp and have carried additional dirt fill & selected spots for spreading
6-16-66	11:00	Surveyed-Suggested to Mr. Zino to fill in swamp area in rear of yards (backyards) which face face the dump.

6-17-66	10:30	Surveyed dump operator told me xxxxxx he was going to start to spread fill in swamp in rear of home this evening-dumped oil in large swamp for mosquito control.
6-19-66	2:30	Survey dump started to fill swamp area & behind houses. Excavation extended - approx size - 70'x50'
6-20-66	9:30	Checked dump - Bulldozer lift not operating broken hydraulic hose-hauling dirt fill to begin again in evening
6-21-66	10:00	* Swamp area xxxx xxx almost completely covered in rear of homes-also more fill spread on graded area.
6-22-66	9:30	Additional fill spread over swamp area behind house & garbage dumping is being done in large swamp on east side & covered daily. Grade is coming up daily.
6-22-66	10:30	At inspection time operator was leveling & grading area (Swamp rear of houses lot seems to be g progressing nicely-
6-23-66 b	11:45	Swamp area (rear of houses practically void of surface water several loads of dirt cover being applied daily-Swamp area on north side is continually being filled.
6-24-66	1:30	Operator grading area & filling in low spots at time of inspection
6-27-66	1:00	Several loads of dirt xx scattered throughout area for spreading x over already covered area - Several small bags
6-28-66	2:30	At time of inspection me operator was in process of dumping 50 gal drum of t oil on large Swamp N.E. corner of dump xxxxxx (mosquito control) Continuing to fill in on east side x with garbage-East leg of swamp approx 40% filled.

NIAGARA COUNTY HEALTH DEPARTMENT

MEMORANDUM

TO: Dr. Hill

FROM: Michael Popovici, Sanitarian

SUBJECT: Town of Wheatfield Dump

DATE: June 10, 1966

As per request of the Niagara County Board of Health a reinspection and survey was conducted of the Town of Wheatfield Dump located off Nash Road on the morning of June 3, 1966.

Present during this initial survey; Environmental Health Trainee Arthur Perez; also, Mr. Skomski member of the Board of Health whom we met by accident at this site.

General survey showed the greatest problem to be the location of pile of debres and rubble at the extreme end of the dump. This pile of debris consists entirely of broken tree stumps, limbs, trash wood, etc.

We next went over to talk to the housewives on Forbes Terrace who were in their backyards. We stated to them that the Health Department was presently conducting a survey to determine the best and most feasible method of disposing of the hard trash located at the east end of the dump, and which we stated is not creating a health menace, but rather a visual nuisance. Furthermore, the inspection conducted of this area, again did not produce any rodent or rat colonies although they may be present; but as stated at the hearing conducted Thursday evening June 2, 1966, no rats have been seen by residents in this area for the past year. With a good and proper sanitary landfill operation none of these things should be present.

We stated to Mrs. DeMarco, that the program to be outlined for the proper disposal and elimination of the swamp would take several months, and that for their benefit we would not desire to hear any complaints regarding the moving of equipment or the creation of dust. This she agreed, they would not complain about.

Mr. Skomski was present during this entire conversation.

On Saturday June 4, 1966 a meeting was arranged by Health Commissioner Dr. Dudley Hill, with Mr. Stanley Brzezinski, Supervisor of Wheatfield; and Mr. Anthony Zino operator and owner of Niagara Sanitation; and Mr. Kruger, Department of Public Works, Wheatfield at 10:00 P.M. on the dump site. I had requested that Mr. Robert Cvetan, Senior Sanitarian, Niagara County Health Department be present, primarily to familiarize him with the condition and lay of action to be instituted in the program.

June 10, 1966

It was agreed by Mr. Brzozinski that a ditch at the east end of the dump approximately 500-600 feet from the homes on Forbes Terrace be constructed. This ditch is to be dug at any depth desired or feasible for the proper operation of the sanitary strip landfill program. Earth is to be piled to the south side of the ditch 6 to 12 feet high. This would continue west 300-500 feet thus blocking and eliminating the creation of any visible nuisance to the home owners on Forbes Terrace.

The sanitary landfill program will then continue to the north along this entire strip of land with dirt being compacted daily until the entire marsh and swamp has been eliminated. It is desired that this program begin immediately so as to dispel the fears of the families on Forbes Terrace, that their complaints have not fallen on deaf ears.

It is also noted that prevailing winds are from the southwest. Any complaints rendered should have come from Pallotine Fathers, or the new owners of Freck's Motel located on Niagara Falls Blvd. Town of Wheatfield for they are continuously waifed by odors from the marsh and septic lagoons.

I would also advise that a burning permit be issued to burn up the residue of wood etc. located at the east end of the dump. Mr. Anthony Zino requested if it would be possible to allow him to burn waste papers from Bell Air Craft, this would help eliminate the scattered-looking condition of the dump.

I stated to Mr. Zino that I would request Mr. Ernest Gedeon, Superintendent of Air Pollution Control, Niagara County to conduct a survey to see if it would be permissible to grant a burning permit.

XXXXXXXXXXXXXXXXXXXXX
XXXXXXXXXXXXXXXXXXXXX

June 10, 1966

Mr. Stanley Brzezinski
2080 River Road
Niagara Falls, N.Y.

Dear Mr. Brzezinski:

At the hearing held by the Board of Health of Niagara County on June 2, 1966, in North Tonawanda, in regard to the Town of Wheatfield dump, located off the Nash Road, the Niagara County Health Department was instructed to formulate immediately a plan whereby the nuisance presently caused by the dump would be abated as quickly as possible and also to outline the procedures to be followed in the future in order to avoid the creation of any further nuisance. The Health Department was further instructed to supervise closely the operation and maintenance of the dump to insure that the plan was being followed and to report to the Board of Health if any deviations or infractions occurred.

The following plan is hereby submitted:

1. A ditch is to be dug at the east end of the dump about 500 to 600 feet behind the homes on Forbes Terrace and is to extend to the west about 300 to 500 feet. The excavated earth is to be piled on the south side of the ditch to a height of 6 to 12 feet. This will effectively block the view of any unsightly conditions which may exist, and is to be done immediately.
2. This ditch is to be the beginning of an approved sanitary landfill operation with proper filling, compacting and covering. Additional ditches will be dug as needed to the north until the whole area has been filled, including the swamp area. The final grade is to be not higher than the back yards on Forbes Terrace.
3. The possibility of burning the large pile of trees and trash wood is being considered. The Air Pollution staff is to make a survey as to its feasibility, to insure that no nuisance or hazard is created.
4. Consideration will also be given to the possibility of permitting the burning of waste paper, which comprises a significant proportion of the refuse collected. This would much improve the appearance of the dump but, again, avoidance of any nuisance or hazard is essential.
5. No burning of any kind is permitted without the prior approval of the Health Department and then only under the circumstances and conditions outlined in the approval.

Cont'd.

6. Close supervision of the operation and maintenance of the dump is to be provided by the Sanitation personnel of the Health Department. No deviations from the plan by the operators is to be permitted without prior approval by the Department. If, despite compliance, nuisance conditions occur, the plan may be modified but only after consultation between the Department and the operator and with the approval of the Board of Health. Any accidental or inadvertent creation of a nuisance must be reported by the operator to the Department. Any deliberate deviation from the plan or from subsequent recommendations of the Department are to be reported to the Board of Health.

Respectfully submitted,

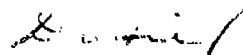

Dudley A. Hill, M.D.
Commissioner

DAH...pal

CC: Mr. Anthony Zino, Niagara Sanitation, Inc.
Mr. Samuel L. Tavano, County Attorney
Dr. John H. Stunz, President, Board of Health
Mr. Eugene F. Seebald, Regional Director of Public Health Engineering
Mr. Michael Popovici, Senior Sanitarian ✓

NEW YORK STATE DEPARTMENT OF HEALTH
INSPECTION REPORT FOR REFUSE DISPOSAL AREAS

T.V.C Wheatfield		County Niagara		Owner Town		Address Town Hall		Phone		
Type of refuse: mixed garbage rubbish other				Operator Niagara Sanitation		Address		Phone		
Municipalities served Wheatfield Niagara, Porter, Youngstown Village				Refuse collectors (names) Niagara Sanitation						
Total population				per cent served						
Business (average collections per week)				Summer		Winter		Total amount of refuse Tons per week		
Residential (average collections per week)										
Total area (acres)		Suitable cover material avail- able Yes <input type="checkbox"/> No <input checked="" type="checkbox"/>		Type of soil and topography Sandy Silt, level and marsh			Depth to rock 10 feet		Depth to ground water 2 to 3 feet	
Gate and lock pro- vided at entrance Yes <input checked="" type="checkbox"/> No <input type="checkbox"/>		Adequate equipment available for maintaining refuse dis- posal area Yes <input checked="" type="checkbox"/> No <input type="checkbox"/>			Describe type and numbers 1 Dozer 1 Shovel					
Fire protection avail- able Yes <input checked="" type="checkbox"/> No <input type="checkbox"/>		Describe			Drainage interfere with operation Yes <input checked="" type="checkbox"/> No <input type="checkbox"/>					
Days and hours refuse disposal site open. 8 hours		Attendant on duty when refuse site open Yes <input type="checkbox"/> No <input checked="" type="checkbox"/>		Site locked when closed Yes <input checked="" type="checkbox"/> No <input type="checkbox"/>		Burning practiced Yes <input type="checkbox"/> No <input checked="" type="checkbox"/>		Type of material burned?		
Burned in a special area away from dump Yes <input checked="" type="checkbox"/> No <input type="checkbox"/>		How often and what time of day?		How controlled?		What precautions are taken to prevent fires? None				
How often is refuse compacted? Varies		Covered Yes <input type="checkbox"/> No <input type="checkbox"/> Partially		Type of cover Sandy Silt		Source of cover		Depth of cover? 0" to 24"		
Cover graded and maintained so no nuisance is caused as the result of pooling of water, cracking, settling, etc. Yes <input type="checkbox"/> No <input checked="" type="checkbox"/>						Dumping controlled by: Signs <input type="checkbox"/> No Fencing <input type="checkbox"/> Supervision <input type="checkbox"/> No				
List any of the above that have been exempted by the full-time health officer										
Dumping confined to a narrow strip Yes <input type="checkbox"/> No <input checked="" type="checkbox"/>		Width		Signs of leachings to a watercourse Yes <input checked="" type="checkbox"/> No <input type="checkbox"/>		Signs of floating solids in a water- course Yes <input checked="" type="checkbox"/> No <input type="checkbox"/>		Measures taken to control flies, rodents and other insects Yes <input type="checkbox"/> No <input type="checkbox"/> ?		
Papers confined to re- fuse site Yes <input type="checkbox"/> No <input checked="" type="checkbox"/>		Scavenger wastes permitted Yes <input type="checkbox"/> No <input checked="" type="checkbox"/>		Nuisance created Yes <input checked="" type="checkbox"/> No <input type="checkbox"/>		Hazard created by the disposal of hazardous industrial wastes Yes <input type="checkbox"/> No <input checked="" type="checkbox"/>				
Methods of disposal of large items (furniture, tanks, appliances, stumps, etc.) All dumped in marsh										
Salvaging per- mitted Yes <input checked="" type="checkbox"/> No <input type="checkbox"/>		Nuisance created Yes <input type="checkbox"/> No <input checked="" type="checkbox"/>		Do swine feed on dump Yes <input type="checkbox"/> No <input checked="" type="checkbox"/>		Is approach road passable to vehicular traf- fic during all seasons of year Yes <input checked="" type="checkbox"/> No <input type="checkbox"/>				
Have there been any complaints (smoke, odor, rodent, insects, water pollution) from people in the area Yes <input checked="" type="checkbox"/> No <input type="checkbox"/>										
Remarks:										
1. Refuse area 1 is months old, not compacted or covered										
2. Refuse - deposited in marsh, decomposing, gasifying area not oriented to program disposal - recent dumping in 3 locations.										
3. Old swamp areas should be covered in as quickly as possible -- this would eliminate a lot of smell, and convert operation to strip dumping.										

*State details under Remarks.

Sketch: (Include location from a known point, access road, prevailing wind, refuse site boundaries, dumping face location, water courses, areas subject to flooding, natural drainage channels or gulleys, general land slope and slope of fill, distance to nearest public water supply source, fences and gates, and habitation within 1500 ft.)

Wheatfield Town
North Tonawanda City
Forbes Terrace St.

Recommendations:

1. Proper landfill of recently deposited putrescible material should be maintained.
2. Steps should be taken to provide adequate grading to prevent leading of putrescible drainage.
3. 24 inches of soil should be deposited on all previously deposited putrescible material; and should be compacted and graded so as not to contribute to a public health nuisance
4. Fill in marshes as soon as possible.

Person Interviewed		Title		Date	
Inspected By (signature)	Date Inspected	Time Inspected	Report rec'd by (sign)	Date rec'd	
<i>W. J. ...</i>	June 1-2, 1966	From 4:15 To 1:30 pm.			

MEMO

5/29/65

FROM: MILES A. LANCE

TO: DR. HILL

RE: REFUSE & GARBAGE
WHEATFIELD

Dear Dr. Hill:

Michael Popovici showed me some slides of this dump. I would not be surprised if there was further investigation than appears from the documents in this file.

MILES A. LANCE
Assistant County Attorney

MAL:aar

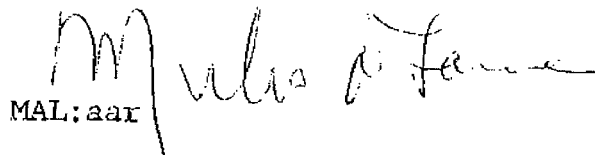
A handwritten signature in cursive script, appearing to read "Miles A. Lance", written over the typed name and title.



NIAGARA COUNTY HEALTH DEPARTMENT

525 BEWLEY BUILDING

LOCKPORT, NEW YORK

TEL. 434-2835

DUDLEY A. HILL, M.D.
Commissioner

JERALD A. CAMPBELL, M.D.
Deputy Commissioner

DIVISION OF
ENVIRONMENTAL HEALTH SERVICES

EUGENE F. SEEBALD, P.E.
Assistant Commissioner

April 4, 1966

Wheatfield Town Board
Mr. Winston E. Moeller
Town Clerk
6934 Maple Drive
North Tonawanda, New York

APR 6 1966

Re: Refuse Area
Nash Road Site

Gentlemen:

Your attention is directed to the following comments pertaining to the operation of the refuse disposal area East of Nash Road and North of the City Limits of North Tonawanda.

1. The landfill area operated at the westerly extremity has been reasonably maintained during the winter months.

2. An inspection by the undersigned on March 23, 1963 revealed a lack of cover of earth over the previously deposited putrescible material on the easterly area of the site sufficient to prevent public health nuisance conditions.

3. The area where previously deposited putrescible material exists has not been graded to prevent leaching of nuisance producing drainage to the surface.

4. Where putrescible material has previously been deposited in existing open water areas, sufficient non putrescible fill has not been used to cover so as to prevent the existence of a public health nuisance.

In view of the foregoing comments the following advisements are tendered:

1. The proper landfill of recently deposited putrescible material is to be maintained in all respects according to existing statutes of the Niagara County Health Department & the New York State Department of Health.

EXHIBIT "A"

April 4, 1968

2. Steps are to be taken to provide adequate grading to prevent the leaching of putrescible drainage to the surface which could create a public health nuisance.

3. Twenty-four inches of soil is to be deposited on all previously deposited putrescible material this to be compacted and graded so as not to contribute to a public health nuisance.

4. Non putrescible hard fill is to be drawn to the site to minimize the nuisance producing aspects of the open water areas previously used for the deposit of putrescible refuse.

5. By a copy of this correspondence we are advising the County Attorney of Niagara County of the circumstances and are requesting that he direct his attention to securing relief at law for prompt compliance with the foregoing requests.

Very truly yours,

Eugene F. Seebald

Eugene F. Seebald, P.E.
Assistant Commissioner for
Environmental Health

EFS...lam

cc: County Attorney ✓
Buffalo Regional
Albany
Supervisor Murphy
Alderman Ramhold
Mr. Peter DeMarco, Forbes Terrace, North Tonawanda
File

October 23, 1968

Henry Schmidt, Esq.,
Attorney at Law
15 Webster Street
North Tonawanda, N. Y.

Dear Hank:

This is to remind you that you were to send me copies of the Agreements between Niagara Sanitation and Town of Wheatfield about two weeks ago. I wish to cooperate with you and the Town.

However, I am going to be forced to proceed without much more discussion unless I have a reasonable basis to help you resolve the problem with the Health Department.

Very truly yours,

(HARRIS and SOUTHARD)

By

Southard
County Atty.

RCS:yj

*Schmidt replied: No written
K. This merely using Dump
under "Oral License" - Payments
of Rent to be made - probably
nothing paid - Schmidt is not
sure!*

NEW YORK STATE DEPARTMENT OF HEALTH
INSPECTION REPORT FOR REFUSE DISPOSAL AREAS

I.V.C.		County	Owner	Address	Phone
J. E. A. P. L.		Highway	T. J. E. P. L.	T. J. E. P. L.	
Type of refuse:	mixed	Operator	Address	Phone	
garbage	rubbish	other			
Municipalities served		Refuse collectors (names)			
J. E. A. P. L.		J. E. A. P. L.			
Total population		per cent served			
Business (average collections per week)		Summer	Winter	Total amount of refuse Tons per week	
Residential (average collections per week)					
Total area (acres)	Suitable cover material available Yes <input type="checkbox"/> No <input checked="" type="checkbox"/>	Type of soil and topography		Depth to rock	Depth to ground water
		Sandy silt		10 ft	6 ft
Gate and lock provided at entrance Yes <input checked="" type="checkbox"/> No <input type="checkbox"/>	Adequate equipment available for maintaining refuse disposal area Yes <input type="checkbox"/> No <input checked="" type="checkbox"/>		Describe type and numbers		
Fire protection available Yes <input type="checkbox"/> No <input checked="" type="checkbox"/>	Describe			Drainage interferes with operation Yes <input type="checkbox"/> No <input checked="" type="checkbox"/>	
Days and hours refuse disposal site open.	Attendant on duty when refuse site open Yes <input type="checkbox"/> No <input checked="" type="checkbox"/>	Site locked when closed Yes <input type="checkbox"/> No <input checked="" type="checkbox"/>	Burning practiced Yes <input type="checkbox"/> No <input checked="" type="checkbox"/>	Type of material burned?	
Burned in a special area away from dump Yes <input type="checkbox"/> No <input checked="" type="checkbox"/>	How often and what time of day?	How controlled?	What precautions are taken to prevent fires? NONE		
How often is refuse compacted? Varies	Covered Yes <input type="checkbox"/> No <input checked="" type="checkbox"/> PARTIALLY	Type of cover SANDY SILT	Source of cover SITE EXCAVATED	Depth of cover? 8' to 12'	
Cover graded and maintained so no nuisance is caused as the result of pooling of water, cracking, settling, etc. Yes <input type="checkbox"/> No <input checked="" type="checkbox"/>			Dumping controlled by: Signs <input checked="" type="checkbox"/> Fencing <input type="checkbox"/> Supervision <input checked="" type="checkbox"/>		
List any of the above that have been exempted by the full-time health officer NONE					
Dumping confined to a narrow strip Yes <input type="checkbox"/> No <input checked="" type="checkbox"/>	Width	Signs of leachings to a watercourse Yes <input checked="" type="checkbox"/> No <input type="checkbox"/>	Signs of floating solids in a water-course Yes <input checked="" type="checkbox"/> No <input type="checkbox"/>	Measures taken to control flies, rodents and other insects Yes <input type="checkbox"/> No <input checked="" type="checkbox"/>	
Papers confined to refuse site Yes <input type="checkbox"/> No <input checked="" type="checkbox"/>	Scavenger wastes permitted Yes <input type="checkbox"/> No <input checked="" type="checkbox"/>	Nuisance created Yes <input type="checkbox"/> No <input checked="" type="checkbox"/>	Hazard created by the disposal of hazardous industrial wastes Yes <input type="checkbox"/> No <input checked="" type="checkbox"/>		
Methods of disposal of large items (furniture, tanks, appliances, stumps, etc.) FILE TO MARSH					
Salvaging permitted Yes <input type="checkbox"/> No <input checked="" type="checkbox"/>	Nuisance created Yes <input type="checkbox"/> No <input checked="" type="checkbox"/>	Do swine feed on dump Yes <input type="checkbox"/> No <input checked="" type="checkbox"/>	Is approach road passable to vehicular traffic during all seasons of year Yes <input type="checkbox"/> No <input checked="" type="checkbox"/>		
Have there been any complaints (smoke, odor, rodent, insects, water pollution) from people in the area Yes <input checked="" type="checkbox"/> No <input type="checkbox"/>					
Remarks:					
Refuse - months-old not covered.					
Refuse - deposited in marsh decomposing - generating					
Area - not oriented to programmed disposal - recent dumping in three locations					
Garbage - recently deposited - smoldering					
Provisions for proper forthcoming winter operations lacking - (i.e.) access roads - site organization -					
Recs - turn over to a city for action.					

*State details under Remarks.

William F. Schaub - 9/27/65

NIAGARA COUNTY HEALTH DEPARTMENT

In the Matter of the Operation :
of the Refuse Disposal Area Situated :
in the Town of Wheatfield adjacent :
to the Nash Road. :

TO: ANGELO L. ZINO
236 63rd Street
Niagara Falls, New York

NIAGARA SANITATION
236 63rd Street
Niagara Falls, New York

PLEASE TAKE NOTICE:

Repeated inspections of this site have revealed that dumping of refuse has not been confined to an area which can be effectively maintained and operated in accordance with Part 19 of the New York State Sanitary Code. Control by supervision, fencing, signs, or equally effective means has been lacking.

Refuse has not been compacted and covered daily with a compacted layer of at least 6 inches of suitable material and a final compacted cover of at least 2 feet of a suitable cover material has not been placed within one week after the final deposit of refuse on the refuse disposal area.

Effective means have not been taken to control flies, rodents, and other insects and vermin in the refuse disposal area.

Fencing or other suitable means has not been established to confine papers and other refuse to the refuse disposal area proper.

All of the foregoing constitute contraventions of Section 19.2 of Part 19 of the New York State Sanitary Code.

You are hereby ordered to take notice of the foregoing and bring the operation into full conformity with the provisions of Part 19 of the New York State Sanitary Code.

Angelo L. Zino and Niagara Sanitation

A reinspection will be made on September 34, 1965, to ascertain the status of the operation of the refuse disposal area.

If at that time, it is found that the refuse area is being operated contrary to the provisions of Part 19 of the New York State Sanitary Code, legal proceedings will be initiated under Section 1.21 of Part I of the New York State Sanitary Code.

You are hereby notified that the said section declares all violations of the code to be a misdemeanor crime punishable by a fine of not more than \$50.00 or by imprisonment of not more than six months or by both.

Lockport, New York
September 14, 1965

D. Hill
Dudley A. Hill, M.D.
Commissioner of Health

NEW YORK STATE DEPARTMENT OF HEALTH
INSPECTION REPORT FOR REFUSE DISPOSAL AREAS

T.V.C. <i>Wheatfield</i>	County <i>Niagara</i>	Owner <i>John</i>	Address	Phone
Type of refuse: mixed garbage rubbish other	Operator <i>Niagara Joint.</i>	Address	Phone	
Municipalities served		Refuse collectors (names)		
Total population		per cent served		
Business (average collections per week)		Summer	Winter	Total amount of refuse Tons per week
Residential (average collections per week)				
Total area (acres)	Suitable cover material avail- able Yes <input checked="" type="checkbox"/> No <input type="checkbox"/>	Type of soil and topography <i>Sandy Clay</i>		Depth to rock
Depth to ground water				
Gate and lock pro- vided at entrance Yes <input checked="" type="checkbox"/> No <input type="checkbox"/>	Adequate equipment available for maintaining refuse dis- posal area Yes <input type="checkbox"/> No <input type="checkbox"/>	Describe type and numbers		
Fire protection avail- able Yes <input type="checkbox"/> No <input checked="" type="checkbox"/>	Describe	Drainage interferes with operation Yes <input checked="" type="checkbox"/> No <input type="checkbox"/>		
Days and hours refuse disposal site open.	Attendant on duty when refuse site open Yes <input type="checkbox"/> No <input checked="" type="checkbox"/>	Site locked when closed Yes <input type="checkbox"/> No <input checked="" type="checkbox"/>	Burning practiced Yes <input type="checkbox"/> No <input checked="" type="checkbox"/>	Type of material burned?
Burned in a special area away from dump Yes <input type="checkbox"/> No <input type="checkbox"/>	How often and what time of day?	How controlled?	What precautions are taken to prevent fires? <i>none</i>	
How often is refuse compacted? <i>varies</i>	Covered Yes <input type="checkbox"/> No <input type="checkbox"/> <i>partially</i>	Type of cover <i>site soil</i>	Source of cover <i>site</i>	Depth of cover? <i>6 to 24"</i>
Cover graded and maintained so no nuisance is caused as the result of pooling of water, cracking, settling, etc. Yes <input type="checkbox"/> No <input checked="" type="checkbox"/>			Dumping controlled by: Signs <input checked="" type="checkbox"/> Fencing <input checked="" type="checkbox"/> Supervision <input checked="" type="checkbox"/>	
List any of the above that have been exempted by the full-time health officer <i>none</i>				
Dumping confined to a narrow strip Yes <input type="checkbox"/> No <input checked="" type="checkbox"/>	Width	Signs of leachings to a watercourse Yes <input type="checkbox"/> * No <input type="checkbox"/>	Signs of floating solids in a water- course Yes <input checked="" type="checkbox"/> * No <input type="checkbox"/>	Measures taken to control flies, rodents and other insects Yes <input type="checkbox"/> No <input checked="" type="checkbox"/>
Papers confined to re- fuse site Yes <input type="checkbox"/> No <input checked="" type="checkbox"/> *	Scavenger wastes permitted Yes <input type="checkbox"/> No <input type="checkbox"/>	Nuisance created Yes <input checked="" type="checkbox"/> No <input type="checkbox"/>	Hazard created by the disposal of hazardous industrial wastes Yes <input type="checkbox"/> No <input checked="" type="checkbox"/>	
Methods of disposal of large items (furniture, tanks, appliances, stumps, etc.) <i>fill for marsh</i>				
Salvaging per- mitted Yes <input checked="" type="checkbox"/> No <input type="checkbox"/>	Nuisance created Yes <input checked="" type="checkbox"/> * No <input type="checkbox"/>	Do swine feed on dump Yes <input type="checkbox"/> No <input checked="" type="checkbox"/>	Is approach road passable to vehicular traf- fic during all seasons of year Yes <input type="checkbox"/> No <input checked="" type="checkbox"/>	
Have there been any complaints (smoke, odor, rodent, insects, water pollution) from people in the area Yes <input checked="" type="checkbox"/> * No <input type="checkbox"/>				
Remarks:				

*State details under Remarks.

*Wheatfield
Before*

16 Forbes Terrace
North Tonawanda, New York
June 10, 1965

Mr. Eugene Seebald
Niagara County Health Department
Bewley Building
Lockport, New York

Dear Mr. Seebald:

The time is long overdue for adding my formal complaint to those of my neighbors regarding the Town of Wheatfield dump located off Nash Road, which borders my property. It would seem to me that the people who operate the dump have already been given plenty of time to clean up the unsanitary and unsightly conditions.

On April 28, 1965, you attended a meeting where several of my neighbors expressed their desire to have this dump closed down. These same neighbors had previously made the Niagara County Board of Health aware of the situation. After you visited the dump on May 21, 1965, less dumping has been done in the area directly adjacent to numbers 18, 20, 26, 32, and 38 Forbes Terrace. However, the area has not been cleaned up, there is often a very unpleasant odor, and dumping is still being done within less than 500 feet of my property.

This dump is a health hazard to all who live near the area. Open garbage is allowed to stand for hours and days at a time. Rats have been seen in the area. No deodorant is used and no rat control program is in effect. It is my understanding that in a dump of this type, the garbage is supposed to be put in eight foot deep holes and covered with at least 20 inches of dirt. To my knowledge this is not being done. Most of the dumping area is constantly littered with debris and garbage.

Several important considerations are:

- 1) Youngsters daily go into the dumping area.
- 2) Often we have seen young boys and men with rifles shooting in the dump. My neighbors and I have contacted the Sheriff's Department several times regarding the shooting.
- 3) Scavengers are often seen rummaging through the garbage.
- 4) An area of this type is bound to draw rats, skunks and rabbits who could be rabid and dangerous.

It is my husband's and my feeling that this dump should be completely closed down and cleaned up. A residential area should not have to be near such a serious health and safety hazard. I urge you to demand that this Town of Wheatfield dump be closed down immediately.

Sincerely yours,

Mona C. Stonebraker
(Mrs. James S. Stonebraker)

STATE OF NEW YORK : COUNTY OF NIAGARA
NIAGARA COUNTY BOARD OF HEALTH

In the Matter of the Complaint

-against-

STANLEY A. BRZEZINSKI, Supervisor, Town of
Wheatfield, New York, WINSTON E. MOELLER,
Clerk of the Town of Wheatfield, New York,
and ANGELO L. ZINO, d/b/a NIAGARA SANITATION,
236 - 63rd Street, Niagara Falls, New York,

Respondents.

: ORDER
: to
: SHOW CAUSE

TO: STANLEY A. BRZEZINSKI
2080 River Road
Niagara Falls, New York

WINSTON E. MOELLER
6934 Maple Drive
North Tonawanda, New York

ANGELO L. ZINO, d/b/a
NIAGARA SANITATION
236-63rd Street
Niagara Falls, New York

Charges having been preferred against you under the provisions of the New York State Public Health Law, Section 225, and the New York State Sanitary Code, Part 19.2,

YOU ARE HEREBY ORDERED TO SHOW CAUSE at the City Hall of the City of North Tonawanda, Payne Avenue, North Tonawanda, New York, on the 2nd day of June, 1966, at eight o'clock in the afternoon of that day, why an order should not be made against you to enjoin you from conducting or maintaining a nuisance in regard to the maintenance of a refuse disposal area located in the Town of Wheatfield, having an entrance on Nash Road in the Town of Wheatfield and abutting and adjoining the City of North Tonawanda, New

York, said nuisance consisting of a lack of cover of earth over putrescible material, otherwise improper coverage of material previously disposed in the refuse area, and otherwise improper maintenance of the refuse disposal area all in accordance with the applicable sections of the New York State Sanitary Code and the annexed letter marked EXHIBIT "A" and made a part hereof.

Dated: May 27, 1966

THE NIAGARA COUNTY BOARD OF
HEALTH

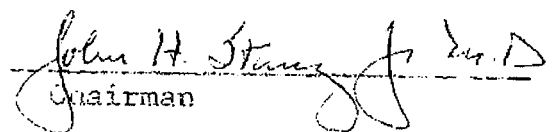
Chairman

June 4, 1965

Mr. Stanley Brzezinski, Supervisor
Town of Wheatfield
2080 River Road
Niagara Falls, New York

Re: Refuse disposal area
Town of Wheatfield

Dear Sir:

This will serve to confirm information resulting from our field conference on June 3rd. Present at the conference beside yourself were, Mr. Demler, Water Superintendent, Mr. Krueger and Mr. Zino of Niagara Sanitation.

In response to inquiries as to your intention toward proper operation of your refuse disposal area off Nash Road, you agreed to direct the Highway and Water Departments to use their equipment to transport fill and cover objectionable areas in the eastern portion of the refuse area, this is to be accomplished within the next few weeks. Mr. Zino, who operates the refuse area in respect to garbage disposal, agreed to excavate holes for the disposal of garbage, using the spoil material from the excavation after covering the compacted refuse to cover the areas most objectionable beyond the site. It was agreed that it would be most desirable to fill in the septic swamp areas with building rubble or non burnable refuse.

You indicated that within several months a new disposal site could be obtained and that the garbage operation would be removed to this site. It is expected that a prior review of the site by this department would be requested to ascertain its suitability for landfill disposal. Mr. Zino was advised that in the event of any interruptions in operation, such as equipment breakdown, he should take immediate steps to obtain suitable substitute arrangements, which will remove any nuisance resulting from his operation. In the event that Mr. Zino or Niagara Sanitation fail to conduct a proper landfill operation in the future, necessary regulatory steps will be instituted for the control of the operation of the facility of Niagara Sanitation organization.

Please advise if there is anything contained herein which does not represent accurately the discussion on June 3rd previously referred to.

Very truly yours,

CC: Town Board - Tn. Wheatfield
Mr. Demler - Supt Water
Mr. Krueger - Highway Supt.
Mr. Zino - Niagara Sanitation
EFSMr.pMrphy - Supervisor, N.T.

Eugene F. Seebald, P.E.
Assistant Commissioner for
Environmental Health

May 24, 1965

Supervisor and Town Board
Town Hall
Niagara Falls Boulevard
North Tonawanda, New York

Wheatfield

Gentlemen:

Subject: Refuse Disposal Area

Some time last year the Department of Health having jurisdiction permitted the development of a trial land fill on the site of the Wheatfield Town refuse area off Nash Road, adjacent to the City of North Tonawanda.

Subsequent inspections have revealed that in spite of the efforts of the Town and the Niagara Sanitation Service, the site cannot be regarded as a practical, efficient land fill development. For a number of reasons to continue on this site is most undesirable and at an early date the Town and or the Niagara Sanitation Service should develop a land fill site considering all of the desirable factors such a site requires.

Until such time as a permanent site can be developed or obtained, it will be permissible to dispose of refuse and garbage on the Nash Road site with due care being taken to excavate garbage disposal pits, covering each night with sufficient earth cover to keep out rodents and to keep other vermin from being attracted. The excavated material from these pits should be used to cover previously deposited refuse and garbage.

During the past month a new threat, that of rabies has been detected in the Town of Wheatfield. In one instance rabies was found in a wild skunk. As you no doubt realize, skunks are scavengers and are in the refuse disposal area previously discussed and therein find harborage and food supply readily available. The fact that this area is frequented by scores of children, makes this very undesirable for disposal of garbage at this site.

I shall be pleased to discuss this matter with you if you should so desire and would be glad to pass upon any prospective land fill site you should propose.

Very truly yours,

Eugene F. Seebald, P.E.
Assistant Commissioner for
Environmental Health

EFS...pal

CC: Mr. Bert J. Murphy, Supervisor, N. Tonawanda
Mr. Demler, Supt. of Water, Town of Wheatfield
Mr. Bernhardt - BRO
Niagara Sanitation Services

26 Forbes Terrace,
N. Tonawanda, N.Y.
April 23rd, 1965.

*F
Wheatfield
Refers*

Mr. Paul Rumbolt, Alderman,
City of North Tonawanda,
North Tonawanda, N.Y.

Mr. Bert Murphy, Sup.
c/o Board of Supervisors,
Lockport, N.Y.

Gentlemen:-

Under date of March 20th, 1965 I wrote to you with reference to a very deplorable dumping situation at the rear of our property but to date have not even had the courtesy of a reply from you.

If this is the manner that you are pursuing in the discharge of your duties as elected representatives of the people of your district I can assure you that when the next election is at hand your name will be stricken from the ballots of many voters.

If it is not too much trouble will you please advise whether or not any firm action will be taken to remove this blight from our area as if you are not able to accomplish this at least we will know where we stand and will then attack this problem through normal legal channels.

Yours very truly,

Joseph C. Ramsbacher
Joseph C. Ramsbacher

CC:- Dr. Hill, c/o Niagara County Health Dept.,
Rowley Bldg.,
Lockport, N.Y.

DATE RECEIVED

APR 26 1965

NIAGARA COUNTY HEALTH DEPT.
LOCKPORT, N. Y.

DEPARTMENT OF HEALTH

Service Request

NUMBER

Originator

~~Owner - Occupant - Agent~~

Address

Address

[illegible]

Date Abated 3-23-65 By [Signature]

26 Forbes Terrace,
N. Tonawanda, N.Y.
March 20, 1965

Mr. Paul Humbolt, Alderman,
City of N. Tonawanda
North Tonawanda, N.Y.

Mr. Bert Murphy, Sup.
c/o Board of Supervisors,
Lockport, N.Y.

Gentlemen:-

The undersigned residing at above address which we understand places us in your respective N. Tonawanda and Niagara County Districts, hereby desire to register formal protest against non-protection of taxpayers with respect to a very disagreeable and both unhealthy and unsanitary condition existing in our residential area.

The rear of our property as well as other neighbor's property border on land owned and presently operated as a garbage and trash dump of City of Wheatfield. This dump should be permanently removed from our highly taxed area as it is not only unsightly but also unhealthy and unsafe and is being operated in direct violation of the New York State Sanitary Code. It provides numerous health hazards such as rat's, vermin, insects, etc. and the stench is not only unbearable but nauseating, thereby preventing residents from taking advantage of their summer outdoor recreational facilities. In addition it is a constant fire hazard, particularly due to spontaneous combustion as a recent fire there smoldered for several days thereby contaminating the area including nearby homes with smoke odors and particularly during high winds is a constant fire threat to our homes and the lives of our children.

The existence of this dump has greatly decreased property values (but not taxes) and in event of necessary resale due to company transfer or other reasons great loss would be suffered due to this deplorable and unwarranted situation.

We are sure you will agree that as payers of high taxes in a fine residential area we should not be made to suffer the hazards of this blight.

Although the undersigned are not presently registered voters due to insufficient residency, as soon as we have properly met the eligibility requirement of one years residence in N.Y. State (April 1, 1965) we will exercise our registration and voter privilege.

Many of our good neighbors have previously complained about this nasty situation but no firm action has ever been taken and in fact at one time they were told that this dump was only temporary and would be closed in June of 1964 but instead of closing it down the hazards have multiplied considerably over the past year.

We therefore sincerely hope that in the interest of good government you gentlemen who have been duly elected as trustworthy representatives of all the people in your districts will use the full authority of your elected office to bring about a complete satisfactory solution to a very deplorable situation.

Thanking you for your kind and prompt action in this matter and looking forward to hearing from you regarding same, we remain,

Yours very truly,

Joseph G. Ramspacher
Joseph G. Ramspacher

Regina D. Ramspacher

CC:- Dr. Hill,
c/o Niagara County Health Dept.,
Bewley Bldg.,
Lockport, N.Y.

NEW YORK STATE DEPARTMENT OF HEALTH
INSPECTION REPORT FOR REFUSE DISPOSAL AREAS

T.V.C. <u>T. of Wheatfield</u>		County <u>Niagara</u>	Owner <u>T. of Wheatfield</u>	Address		Phone
Type of refuse: mixed <input checked="" type="checkbox"/> garbage <input type="checkbox"/> rubbish <input type="checkbox"/> other <input type="checkbox"/>		Operator <u>Niagara Sanitation Inc.</u>		Address <u>3001 Military Rd</u>		Phone <u>BU - 34 330</u>
Municipalities served <u>T. of Wheatfield, Air Base, Bell Aircraft</u>			Refuse collectors (names) <u>Niagara Sanitation Inc.</u>			
Total population		per cent served				
Business (average collections per week)		Trash - 2/wk.		Summer	Winter	Total amount of refuse Tons per week
Residential (average collections per week)		Mixed		2	2	25 load - 20 yds. ~ 7 T/week
Total area (acres)	Suitable cover material available Yes <input checked="" type="checkbox"/> No <input type="checkbox"/>	Type of soil and topography <u>Sandy clay; flat</u>		Depth to rock <u>> 7 ft.</u>	Depth to ground water <u>> 7 ft.</u>	
Gate and lock provided at entrance Yes <input checked="" type="checkbox"/> No <input type="checkbox"/>		Adequate equipment available for maintaining refuse disposal area Yes <input checked="" type="checkbox"/> No <input type="checkbox"/>		Describe type and numbers <u>1 - 977 Tons capacity 20' front scoop 15'</u>		
Fire protection available Yes <input checked="" type="checkbox"/> No <input type="checkbox"/>		Describe <u>T. of Wheatfield (St. Johnsburg & Adams) Fire Co.</u>			Drainage interferes with operation Yes <input type="checkbox"/> No <input checked="" type="checkbox"/>	
Days and hours refuse disposal site open. <u>Daily 2-5; 1st St.</u>		Attendant on duty when refuse site open Yes <input checked="" type="checkbox"/> No <input type="checkbox"/>		Site locked when closed Yes <input type="checkbox"/> No <input checked="" type="checkbox"/>	Burning practiced Yes <input type="checkbox"/> No <input checked="" type="checkbox"/>	Type of material burned?
Burned in a special area away from dump Yes <input type="checkbox"/> No <input checked="" type="checkbox"/>		How often and what time of day?		How controlled?		What precautions are taken to prevent fires?
How often is refuse compacted? <u>Daily</u>		Covered Yes <input checked="" type="checkbox"/> No <input type="checkbox"/>	Type of cover <u>Backfill</u>		Source of cover <u>Tronching</u>	Depth of cover? <u>1 ft.</u>
Cover graded and maintained so no nuisance is caused as the result of pooling of water, cracking, settling, etc. Yes <input type="checkbox"/> No <input checked="" type="checkbox"/>				Dumping controlled by: Signs <input checked="" type="checkbox"/> Fencing <input checked="" type="checkbox"/> Supervision <input checked="" type="checkbox"/>		
List any of the above that have been exempted by the full-time health officer						
Dumping confined to a narrow strip Yes <input checked="" type="checkbox"/> No <input type="checkbox"/>	Width <u>30'</u>	Signs of leachings to a watercourse Yes <input type="checkbox"/> No <input checked="" type="checkbox"/>	Signs of floating solids in a watercourse Yes <input type="checkbox"/> No <input checked="" type="checkbox"/>	Measures taken to control flies, rodents and other insects Yes <input type="checkbox"/> No <input checked="" type="checkbox"/> <u>Antifly</u>		
Papers confined to refuse site Yes <input checked="" type="checkbox"/> No <input type="checkbox"/>	Scavenger wastes permitted Yes <input type="checkbox"/> No <input checked="" type="checkbox"/>	Nuisance created by the disposal of hazardous industrial wastes Yes <input type="checkbox"/> No <input checked="" type="checkbox"/>				
Methods of disposal of large items (furniture, tanks, appliances, stumps, etc.) <u>Crushed in (trucks or racks) & buried with garbage</u>						
Salvaging permitted Yes <input type="checkbox"/> No <input checked="" type="checkbox"/>	Nuisance created Yes <input type="checkbox"/> No <input checked="" type="checkbox"/>	Do swine feed on dump Yes <input type="checkbox"/> No <input checked="" type="checkbox"/>	Is approach road passable to vehicular traffic during all seasons of year Yes <input checked="" type="checkbox"/> No <input type="checkbox"/>			
Have there been any complaints (smoke, odor, rodent, insects, water pollution) from people in the area Yes <input checked="" type="checkbox"/> No <input type="checkbox"/>						
Remarks:						
1. Some Industrial Wastes from Carborundum, & Graphite Specialists (Carbon, wood, trash)						
2. Neighboring residents have complained about smoke & odor. Operator advised not to cease burning.						

*State details under Remarks.

Sketch: (Include location from a known point, access road, prevailing wind, refuse site boundaries, dumping face location, water courses, areas subject to flooding, natural drainage channels or gulleys, general land slope and slope of fill, distance to nearest public water supply source, fences and gates, and habitation within 1500 ft.)

1. Area surrounded by subdivisions which have been sources of complaint in the past; burning has ceased.

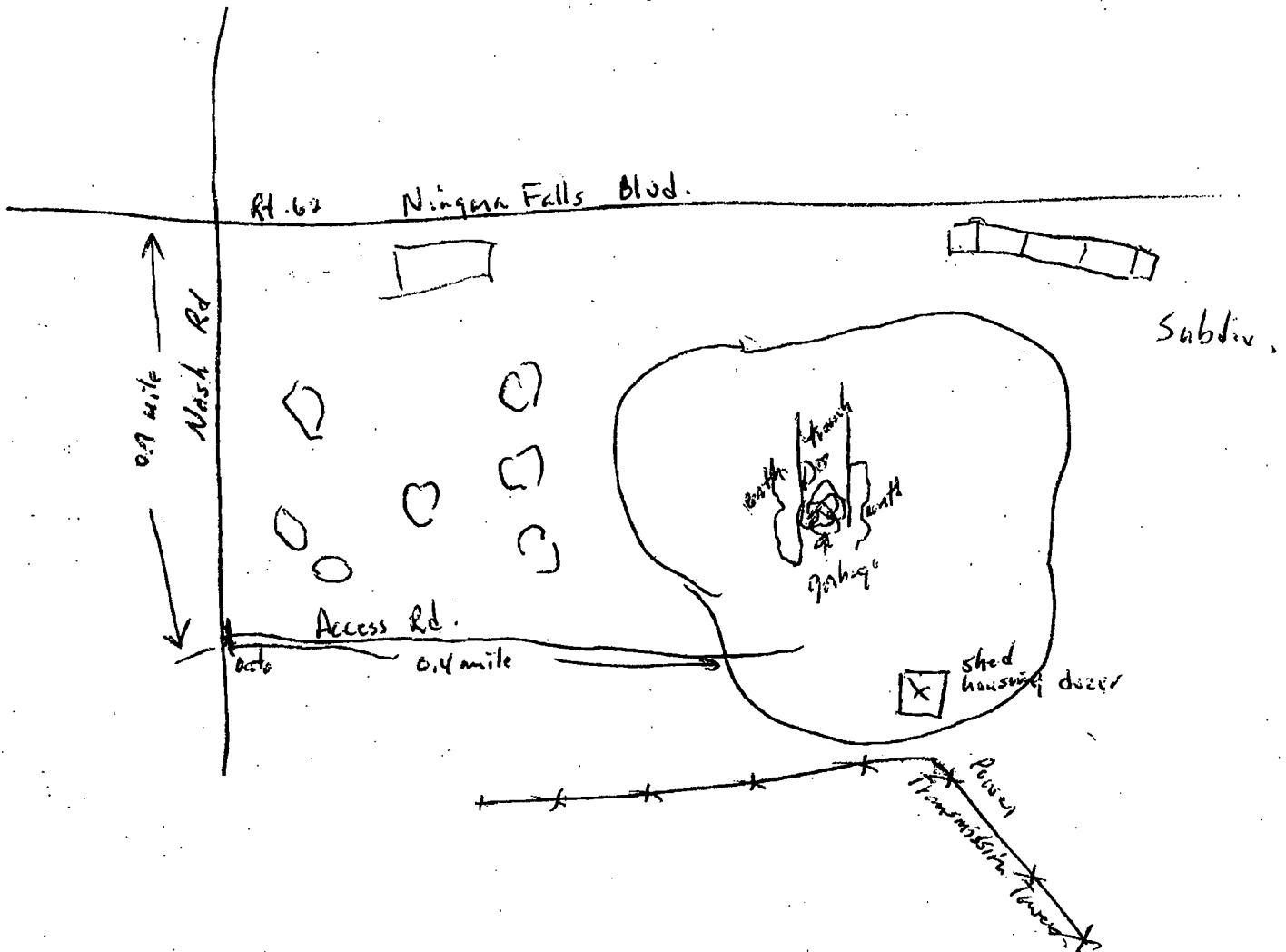

Recommendations:

Person Interviewed <i>Paul Richards</i>		Title <i>Operator</i>		Date <i>2/20/04</i>	
Inspected By (signature) <i>R.C. Mt. Pleasant</i>	Date Inspected <i>2/26/04</i>	Time Inspected From <i>3</i> To <i>3:30</i>	Report rec'd by (sign)		Date rec'd

TO: THE TOWN BOARD OF THE TOWN OF WHEATFIELD, NIAGARA COUNTY,
NEW YORK and THE STATE DEPARTMENT OF HEALTH and THEIR
REPRESENTATIVES

The undersigned being residents of the County of Niagara
and State of New York, and members of the St. Peter's Evangelical
Lutheran Church, hereby register their opposition to the use of
the 96 acre Frank Pirooski farm on the north side of the Lockport
Road as a site for sanitary land fill operations and refuse dis-
posal.

Among the grounds for this opposition is the fact that the
site in question is situate within a predominantly farming area
where the intended use would create a menace to health, a devalu-
ation of lands in the vicinity, and be too close to a religious
organization. Other areas more suitably situate undoubtedly are
available.

Name	Address	Date
Mr. + Mrs. Adolph DE Vantier	9811 Lockport Rd Niagara Falls N.Y.	4-12-64
Edward D. Walck	Samborn N.Y.	
Wm R. Ziemendorf	1363 Ward Road Samborn	4-12-64
Geo Haseloy	1833 Saunders Settlement Road	4.12.64
Rudolf C. Walck	Samborn	
Leonard H. Walck	5939 Walmore Rd	4/12/64
Rudolf A. Walck		
Chester A. Haseloy	Route #2 Samborn	4/12/64
Janette Walck	Walmore Rd.	4/12/64
Lillian Haseloy	Route #2 Samborn	4/12/64
Jonas J. Haseloy	253 Samborn #2 Hwy	
Raymond F. Graft	WR2 Samborn	4-12-64
Mr. & Mrs. P. Fahrwald		

Name	Address	Date
Marion H. Pleasant	Sanborn	4-12-64
Harvey H. Haseley	Sanborn	4-12-64
Robert H. Lang	6291 Millerville Cuck Sanborn, N.Y.	4-12-64
Mrs. Hugo Haseley	2494 Lockport Rd. Sanborn	4-12-64
Max Pfahl	Sanborn N.Y.	4-12-64
Louis Pfahl	Sanborn N.Y.	4/12/64
Hester H. Walck	Sanborn, N.Y.	4-12-64
Edwin Dubois	9721 Lockport Rd. Niagara Falls, N.Y.	4/12/64
W. Schillhauer	3640 Haseley Dr. Niagara Falls, N.Y.	4/12/64
Mrs. W. Mueller	9521 Lockport Rd. Niagara Falls, N.Y.	4/12/64
Edna J. Madenille	5964 Klein Rd. N.Y.	
Norma E. Kroening	3056 Lockport Rd. Sanborn, N.Y.	4/12/64
Minnie Kroening	3056 Lockport Rd. Sanborn, N.Y.	4/12/64
Herman Kroening	3056 Lockport Rd. Sanborn, N.Y.	4/12/64
William Beutel	2915 Tallman St. Sanborn	
Clara Beutel	2915 Tallman St. Sanborn	
Tilbert Walck	2508 Lockport Rd. Sanborn, N.Y.	
Ronald Craft	5988 Walmore Rd. Sanborn, N.Y.	
Howard C. Walck	2251 Lockport Rd. Sanborn, N.Y.	
Herold Walck	Sanborn, N.Y.	
Walter Pfahl	N.Y.	
Ronald Wendt	N.Y.	
Herman E. Beutel	2915 Tallman St. Sanborn, N.Y.	
Albert J. Wolf	6166 Walmore Rd.	
Mrs. Suzanne Miller	2212 Cayuga Dr. East. N.Y.	4-12-64
James L. Beutel	6049 Haver Rd. Sanborn	
May Miller	2212 Cayuga Dr. East. N.Y.	
Ernestine Walck	5939 Walmore Rd.	
Bert De Vantier	9821 Lockport Road.	

Name	Address	Date
Mrs Edward Walck	Sanborn N.Y.	Apr. 1:
Mrs G. Corrachia	140 1st Settlement	4/12/64
Janice M. L'Vantier	9821 Lockport Rd.	
Edgar Kroening	Sanborn N.Y.	4/12/64
Christine Fahl	2115 Lockport Rd.	4/12/64
Mrs. Albert Kroening	3149 Lockport R.	4/12/64
Albert Kroening	Sanborn N.Y.	4/12/64
Elton Wendt	Sanborn N.Y.	4/12/64
Lynia W. Hasely	Lockport, N.Y.	4/12/64
Mrs James Dickless	Sanborn N.Y.	4/12/64
Mrs Emma Hasely	Niagara Falls N.Y.	4/12/64
Mrs Irene Wendt	Sanborn N.Y.	4/12/64
Mrs. Betty Zimmerman	Sanborn N.Y.	4/12/64
Mrs Esther Walck	Niagara Falls N.Y.	4/12/64
Mrs Marcus Hasely	Sanborn N.Y.	4/12/64
Edwin Beutel	Sanborn, N.Y.	4/12/64
Annie Beutel	Sanborn N.Y.	4/12/64
Mrs D.A. Lathrop	Sanborn N.Y.	4/12/64
Max Hasely	Niagara Falls N.Y.	4/12/64
Mrs. Jonas Hasely	Sanborn N.Y.	4/12/64
Esther Lange	Sanborn N.Y.	4/12/64
Mrs. Emma Fahl	Sanborn N.Y.	4/12/64
Mrs. Hermit Hasely	Sanborn, N.Y.	4/12/64

Express Wheatfield RECEIVED
APR 14 1964
N. Y. State Dept. of Health
Lockport District Office

TO: THE TOWN BOARD OF THE TOWN OF WHEATFIELD, NIAGARA COUNTY,
NEW YORK and THE STATE DEPARTMENT OF HEALTH and THEIR
REPRESENTATIVES

The undersigned being residents of the County of Niagara
and State of New York, hereby register their opposition to the
use of the 96-acre Frank Pirooski farm on the north side of the
Lockport Road as a site for sanitary land fill operations and
refuse disposal.

Among the grounds for this opposition is the fact that the
site in question is situate within a predominantly farming area
where the intended use would create a menace to health and a de-
valuation of lands in the vicinity. Other areas more suitably
situate undoubtedly are available.

Name	Address	Date
Samuel J. Mun	2211 Lockport Rd.	4/11/64
Albert W. Waseley	6416 Ward Rd.	4/11/64
John W. Steynberg	6053 Ward Rd.	4/11/64
Anna Trinka	2299 Lockport Road	4/11/64
Shirley Croft	2389 Lockport Rd.	4/11/64
Marion Hymick	2411 Lockport Rd.	4/11/64
Leard Hymick	2411 Lockport Rd.	4/11/64
Wm E. Smith	2431 Lockport Rd.	4/11/64
John M. Smith	2431 Lockport Rd.	4/11/64
Stanley Kowalek	2497 Lockport Rd.	4/11/64
Glennia Lenz	2486 Lockport Rd.	4/11/64
Donald Lenz	2486 Lockport Rd.	4/11/64
Robert Trinka	2704 Lockport Rd.	4/11/64
Lester A. Wagner	2682 Lockport Rd.	4/11/64
Ellen Breichler	2704 Lockport Rd.	4/11/64
Walter D. D. Jones	2754 Lockport Rd.	4/11/64
Alma May	2712 Lockport Rd.	4/11/64
Carlton May	2712 Lockport Rd.	4/11/64

Name	Address	Date
Ralph Del'onten	2766 Lockport Rd.	4-11-64
Edward & Peggy Williams	2792 Lockport Rd.	4/11/64
M. M. Macchia	2816 Lockport Rd.	4-11-64
Charles E. Holstrom	2822 Lockport Rd.	4-11-64
Clarence L. Weaver	2834 Lockport Rd.	" " "
Mrs. Margaret E. Weaver	" " "	" " "
Maled M. Weaver	6252 Ward Rd.	4/11/64
Lain Weaver	6252 Ward Rd.	4/11/64
Mrs. Roy J. Handley	2855 Lockport Rd.	4/11/64
Frank Slight	2845 Lockport	4/11/64
Patricia Dickson	2626 Lockport	4/11/64
Josephine Lajik	2469 Lockport Rd.	4/11/64
Doris H. Heuer	2435 Washington St. Niagara	4/11/64
David Mante	2505 Washington St. Niagara Falls	4/11/64
Alfred B. Woodruff	2413 Niagara Rd. Niagara Falls	4/11/64
Alfred Woodruff	2413 Niagara Rd. N.Y.	4/11/64
Arthur Dubois	2288 Niagara Falls Blvd. N. Falls	4-11-64
Arthur Schoonover	2469 Niagara Rd. Niagara Falls N.Y.	4-11-64
L. E. Carlson	2978 Peace Rd. N. Tona.	4-11-64
Gordon Bagg	2359 Niagara Rd. Niagara Falls N.Y.	4-11-64
Chet Perry	2428 Stoelting St. N. Falls	" " "
A. Schimachuck	6630 Schults St. Niagara Falls	" " "
Franklin F. Zagaw	6635 Hunt St. Niagara Falls, N.Y.	4-11-64
Arthur H. Heuer	2362 Niagara Rd. Niagara Falls N.Y.	4-11-64
Natalie Camann	2474 Niagara Rd. Niagara Falls N.Y.	4-11-64
Melvin C. Hageley	6645 Robt. St. Niagara Falls N.Y.	4-11-64
Nathan Perchen	2390 Niagara Rd. Niagara Falls N.Y.	4-11-64
Roland E. Caman	2213 Cayuga Dr. East. Niagara Falls N.Y.	4-11-64
Willie Ritzhoff	2626 Lockport Rd. Saratoga N.Y.	4-11-64
Norma Walsh	2617 Lockport Rd. Saratoga N.Y.	" " "

Name

Address

Date

Benjamin G. Wald 2617 Lockport Road 9-12-68

TO: THE TOWN BOARD OF THE TOWN OF WHEATFIELD, NIAGARA COUNTY,
NEW YORK and THE STATE DEPARTMENT OF HEALTH and THEIR
REPRESENTATIVES

The undersigned being residents of the County of Niagara
and State of New York, hereby register their opposition to the
use of the 96-acre Frank Piroski farm on the north side of the
Lockport Road as a site for sanitary land fill operations and
refuse disposal.

Among the grounds for this opposition is the fact that the
site in question is situate within a predominantly farming area
where the intended use would create a menace to health and a de-
valuation of lands in the vicinity. Other areas more suitably
situate undoubtedly are available.

Name	Address	Date
Crystal Michel	6211 Walden Rd.	4/11/64
George Michel	6109 Walden Rd. Sanborn N.Y.	4/11/64
Thomas Michel	6109 Walden Rd. Sanborn N.Y.	4/11/64
Ernest Michel	6112 Walden Rd. Sanborn N.Y.	4-11-64
Ernest Michel	6112 Walden Rd. Sanborn N.Y.	4-11-64
Julia Gorman	6092 Walden Rd. Sanborn N.Y.	4-11-64
John Raymond	6088 Walden Rd. Sanborn N.Y.	4-11-64
Earl Emond	6088 Walden Rd. Sanborn N.Y.	4-11-64
Helen Porreca	6082 Walden Rd. Sanborn, N.Y.	4/11/64
Joseph N. Porreca	6082 Walden Rd. Sanborn, N.Y.	4/11/64
Martin F. Pohl	2388 Saunders Settle Rd. Sanborn N.Y.	4-11-64
David D. Hasley	2050 Saunders Settle Rd. Niagara Falls	
Gladys Schildhauer	Niagara Falls, N.Y.	4-12-64
Marcus Nasaley	Sanborn N.Y.	4-12-64
Hermit Hasley	Sanborn N.Y.	4-12-64
Mr. William Galganski	North Tonawanda N.Y.	4/12/64
Mrs. Wm. Galganski	North Tonawanda N.Y.	4/12/64

Name	Address	Date
Marie Allen	6207 Dealmore Rd.	4-12-64
Allen, Charles	6207 Dealmore Rd.	4-12-64
Robert M. Lange	6241 Mulholland Sanborn	4-12-64
Walter R. Lange	6251 Mulholland Cr. Sanborn,	4-12-64
Sally Ann Walsh	2228 Lockport Rd, Sanborn	4-12-64
Clarence Kociany	3219 Lpt. Rd. Sanb.	4/12/64
Sigmond Rfohl	2115 Lockport Rd	4-12-64
Mrs. Luella Hohl	2502 " "	4-12-64

TO: THE TOWN BOARD OF THE TOWN OF WHEATFIELD, NIAGARA COUNTY,
NEW YORK and THE STATE DEPARTMENT OF HEALTH and THEIR
REPRESENTATIVES

The undersigned being residents of the County of Niagara
and State of New York, and members of the St. Peter's Evangelical
Lutheran Church, hereby register their opposition to the use of
the 96 acre Frank Piroski farm on the north side of the Lockport
Road as a site for sanitary land fill operations and refuse dis-
posal.

Among the grounds for this opposition is the fact that the
site in question is situate within a predominantly farming area
where the intended use would create a menace to health, a devalu-
ation of lands in the vicinity, and be too close to a religious
organization. Other areas more suitably situate undoubtedly are
available.

Name	Address	Date
Harbert E. Bier	2595 Lockport Rd.	4-12-64
Edna Pfohl	2502 - Lockport Rd.	4-12-64
Wallace Pfohl	2502 - Lockport Rd.	4-12-64
Emily Ann Bon	2595 Lockport Rd.	4-12-64
Ben Wald	2617 Lockport Rd.	
Evelyn Haselkey	3109 Lockport Rd.	4-12-64
Kenneth A. B. Hoff	2515 Lockport Rd.	4-12-64
Louise Bentele	2381 Lockport Rd.	4/12/64
Lyndal Bentele	6219 Word Road	4/12/64
Edwin W. Wolf	2198 Saunders Settlement Rd.	4/12-64
Leonard H. Bentele	6219 Word Road	4/12/64
Jan M. Camann	2462 Cayuga St.	4-12-64
Allice M. Wolf	2198 Saunders Settlement Rd.	4-12-64
Warren S. Camann	2462 Cayuga St.	4-12-64
Laura Halek	2617 Lockport Rd.	4-12-64
Gustav Pfohl	1785 Saund. Settl.	4-12-64
Anna Pfohl	1785 Saund. Settl. Rd. Lewiston	4-12-64

Name

Address

Date

Norman Hasley 2063 Niagara Falls N.Y.
 Edwin North 2683 Lockport Rd. Danborn N.Y.
 Herbert Jagan 6245 Ward Rd. Danborn, N.Y.
 Arthur Wendt 6545 Ward Rd. Danborn N.Y.
 Delbert Dunder 1906 Saunders Sett Niagara Falls N.Y.
 Arthur Reftaff 2518 Lockport Rd. Danborn N.Y.
 Adolph Pfohl 2540 Lockport Rd. Danborn N.Y.
 Arnold Walck 3479 Lockport Rd. Danborn N.Y.
 Benjamin Wendt 2542 S. S. Rd. Danborn N.Y.
 Edward E. Walck 2251 Lockport Rd. " "
 Allen E. Walck 626-69 34th St. Niagara Falls, N.Y.
 Joe Walck 2171 Lockport Rd. Niagara Falls, N.Y.
 Paul A. Walck 2171 Lockport Rd. Niagara Falls N.Y.
 Louis Walck 381 Miller Rd. Niagara Falls N.Y.
 Donald Walck 4720 Lockport Rd. Lockport N.Y.
 Lina M. Walck 3174 Lockport Rd. Danborn, N.Y.
 Robert W. Kane 1953 Saunders Sett. Rd., Niagara Falls, N.Y.
 Lavern Hasley 8135 Lockport Rd. Niagara Falls N.Y.
 Richard Dobberton 1960 Saunders Settlement Rd. Danborn, N.Y.
 Dana H. Miller 9645 Lockport Rd. Niagara Falls N.Y.
 Ernest E. Hasley 2010 Saunders Settlement Rd. Niagara Falls
 Martin Millholl 1894 Dan. Sett Rd. Niagara Falls
 Richard Sydor 6087 Hoover Rd. Danborn N.Y.
 William Walck Danborn N.Y.
 Philip C. Walck 3971 Lockport Rd. Danborn N.Y.
 Albert Koenig Jr. 3165 Lockport Rd. Danborn N.Y.
 Christine De Vanter 9645 Lockport Rd. Niagara Falls
 Audrey M. Walck 2424 Lockport Rd. Danborn N.Y.
 Hubert P. Hasley Niagara Falls

Name	Address	Date
Norman A. Walck	2424 Lockport Rd. Sanborn	4/11/64
Donald E. Pichner	3979 Lockport Rd. Sanborn	4/11/64
Ron. Walck	3971 Lockport Rd. Sanborn	4/11/64
W. Clarke	Homeyer Rd. N. Tonawanda	
Samuel S. Windt	4047 Lockport Ave. N. Tonawanda	4/11/64
Calvin Pfohl	2540 Lockport Rd. Sanborn	4/11/64
Steve Stephens	6093 Ward Rd. Sanborn	4/11/64
Robert H. Haseley	2035 Lock. Rd. Niagara Falls	4/11/64
Edwin J. Walck	4727 Lockport Rd. Lockport, N.Y.	4/11/64
Edgar H. Walck	2578 S. S. Rd. Sanborn N.Y.	4/11/64
William Haseley	2432 S. S. Rd. Sanborn N.Y.	4/11/64
John H. Walck	2546 S. S. Rd. Sanborn N.Y.	4/11/64
Samuel H. Walck	2432 S. S. Rd. Sanborn N.Y.	4/11/64
John H. Walck	2035 Lockport Rd. Sanborn, N.Y.	4/11/64
Miss Elizabeth Haseley	2435 Lockport Rd. Niagara Falls N.Y.	
Mr. R. Lange	6135 Besset Rd. Sanborn, N.Y.	4/11/64
Mr. E. Lange	6135 Besset Rd. Sanborn, N.Y.	4/12/64
Mr. Edwin Besset	Sanborn N.Y.	4-12-64
Mr. Adolph Besset	Sanborn, N.Y.	4-12-64
Mr. + Mrs. Hubert Walck	Sanborn N.Y.	4-12-64
Josephine Haseley	Sanborn, N.Y.	4-12-64
Mark E. Haseley	Sanborn N.Y.	4-12-64
Emil Walck		4-12-64
Mr. David Walck	Sanborn, N.Y.	4-12-64
Harold Walck	204 Besset Rd.	4, 12, 64
Mr. Walck	Marysville	4-13-64
Mr. + Mrs. Marvin Haseley		
Mr. + Mrs. Marvin Walck	204 Besset Rd. Sanborn N.Y.	
Melvin H. Pfohl	2053 S.S. Rd. N.Y.	

1. 4:30 PM , 1 June, 1966

Wood Pile - Concret Blocks --
Card Board - Planking - Crates

This Pile has not been touched
for over two months



2. 4:40 PM, 1 June, 1966

Swamp - Tires, paper, wood,
stench



STATE OF NEW YORK
DEPARTMENT OF HEALTH

MEMORANDUM

February 22, 1962

To: Record

From: Mr. Tappert

Subject: Wheatfield Town Dump

On February 20, 1962, the writer visited the dump operated by the Town of Wheatfield to determine if it were possible that rats could be infesting the dump and being a nuisance in the area surrounding the dump. At the time of the inspection, the gate leading to the dump was locked. However, there was evidence that it had been opened during the day and that material had been deposited in the dump.

There was a considerable pile of burning material (tin cans, paper and other refuse). The dump showed every indication that it should be infested with rats. However, no tracks or other positive signs of rats were seen.

On speaking with one of the local residents he stated that the rats would leave the dump and spread throughout the area upon the burning of the material. He stated that upon occasion chickens and other livestock had been killed by the rats.

It is the opinion of the writer that a much more satisfactory operation could be maintained to receive the garbage and refuse from the Town of Wheatfield.

sp



STATE OF NEW YORK
DEPARTMENT OF HEALTH

MEMORANDUM

January 12, 1966

To: Mr. Donald

From: Mr. Wt. Pleasant

Subject: Current status of refuse disposal sites - Niagara County

During the latter part of December and the first part of January, the writer undertook a partial survey of refuse disposal sites in Niagara County. This was a follow up study intended to update the status of those dumps reported in a comprehensive survey described earlier. The following narrative briefly describes observations made during this survey.

TOWN OF CHESTER - This town has no refuse disposal sites due to Town Ordinance against same.

TOWN OF HARTLAND - This dump is operated by the Town Highway Department. An attempt is made at sanitary landfill. However, there does not appear to be too much organization in regard to layout and usage. It would appear that supervision of the site during open hours would eliminate occasional haphazard dumping in undesignated areas. There is some minor evidence of burning but it is not a consistent practice.

TOWN OF ROYALTON - (Bancroft & Sons) - This site is nothing more than an open dump. Burning is not practiced. However, there are huge accumulations of uncovered garbage. No apparent attempt has been made to comply with earlier suggestions and recommendations.

TOWN OF ROYALTON - This site has undoubtedly made the most progress of those described in the previous report. The appearance is much improved. Fencing and earth berms shield the site from observation. There is a locked gate and attendant during open hours. The site utilizes an old stone quarry and fill material is at a premium. The open face of the dump is judged too long in that it is in the shape of a large semi-circle. Burning is done in a receptacle which resembles an old converted oil drum. There is some mixed refuse disposed of at this site.

TOWN OF NEWFAIR - This site practices burning of combustibles and at the time of inspection there were large accumulations of burnt debris which had not been covered. Mr. Bracken, who owns and operates the site for the town, maintains a separate location for what he terms garbage which in reality is mixed refuse. The second site which is located some 500 yards west consists of a trench into which the refuse is placed, burned and periodically covered. The owner has reported that he has had trouble with private collectors using this site without authorization. Operation normally consists of burning and pushing back of refuse along a wide face into an excavated area. The top grade is then covered. The site is easily observed from Chestnut Road.

TOWN OF LOCKPORT - The pit previously used has been filled and at present there is a large accumulation of uncovered, unburned refuse. Blowing papers still appeared to be somewhat of a problem.

TOWN OF WHITTON - This town does not have a refuse disposal site due to prohibiting town ordinance.

TOWN OF WILSON - The Town of Wilson still operates a refuse disposal site with the Town of Cambria at a site located in the Town of Wilson, off Chestnut Road about a half a mile. The site is remotely situated and an attempt is made at a sanitary landfill operation. It appears that there is a problem of drainage, since water was noticed in several excavations. Covering of the refuse could be more frequent. Burning was not noticed to be a consistent practice.

TOWN OF PORTER - There is no known refuse disposal site in the Town of Porter due to prohibiting town ordinances.

TOWN OF LEWISTON - The refuse disposal site operated by the Highway Department for the Town of Lewiston is essentially a sanitary landfill, however, burning of the refuse is practiced; compaction is done and finally a covering is provided for it. However as was noted in the earlier report, the covering material is blue clay which does not lend itself readily to compaction. At the time of inspection the site had a large accumulation of refuse and no evidence of recent covering was observed.

TOWN OF NIAGARA - The Town of Niagara operates a refuse disposal site on Lockport Road. At the time of inspection smoldering fires were observed and have been common in the past. There was no equipment at the site nor was an attendant on duty. There was a large accumulation of uncovered burnt and burning refuse and debris. People were observed dumping mixed refuse on the ground and igniting it. Fires from this site in the past have produced thick malodorous smoke over the Expressway which is adjacent to the site. This condition could be described as hazardous.

TOWN OF WHEATFIELD - This site appears to have been operated satisfactorily in the past. However, the current inspection revealed large amounts of uncovered refuse on the ground. The refuse had been spread, but had not yet been covered. It appeared that it may have been compacted. The conditions noted could be termed a nuisance since the current portion of the site utilized is immediately adjacent to backyards of residences on Forbes Terrace. Burning is not practiced.

R.C. Mt. Pleasant



4. 5:10 PM, 1 June, 1966



Overlooking debris to be covered. Being dozed into swamp.
Spongy ground.

3. 4:50 PM, 1 June, 1966



Area being filled with
dumped garbage — was told
it would be covered before
evening



6. 5:15 PM, 1 June, 1966

New load of garbage -
Operator said it would be
dozed and covered before going
home.



5. June 1, 1966

Trench approximately 4 to
6 inches deep—filled with
seepage water 4 to 6 inches—
debris, tires, etc.



7. 10:15 AM, June 2, 1966

View of load of garbage at
10:15 AM. Some of debris
recognized as having been
dumped the previous night.



8. 10:20 AM, June 2, 1966

View of same pile of
garbage (no.7)
South View



10. 10:50 AM, June 2, 1966

Ditch - Lengthwise to dump

Lumber, Planks, Boxes,
Cardboard, Swamp, Stagnant
water.



9. 10:40 AM, June 2, 1966

View of general area - section
9 on sketch-this has been
untouched for 2 or 3 weeks.



12. 11:10 AM, June 2, 1966

General View of North West
corner - Untouched for
several weeks.



11. 11:05 AM, June 2, 1966

General View of north west
corner - This area has been
untouched for 2 or 3 weeks.