

# Remedial Closure Report Roblin Steel Site Remediation

City of North Tonawanda,  
Niagara County, New York

## APPENDICES Volume I

December 2005

**ROBLIN STEEL SITE REMEDIATION  
COMPLETION REPORT**

**LIST OF APPENDICES**

Appendix

Volume I

- A Construction Daily Reports – Phase I
- B Construction Daily Reports – Phase II

# APPENDICES

---



**Stearns & Wheeler, LLC**  
Environmental Engineers and Scientists

**Appendix A**

---

**Construction Daily Reports – Phase I**

ROBLIN STEEL PHASE I

4/24/03

-10 am: meeting/walk through

Dan King-NYSDEC, Dale Marshall, Henry Wostaszek, David -  
City NT; Sen G Maziarz; Sean O'neil - NT News

- MMG: conversation missing milice asi + konard

yousitt hard cards

- license ok

- SOPs ok

- RPP ok

- insurance ok

GET COPY OF SURVEY TO MMG.

TRYING TO GET CONFIRMATION OF NOTIFICATION

FROM DDL

- KEVIN Z FROM ACTION OUT FRIDAY 7AM FOR  
PRE-AIR BACKGROUND TESTING.

- More hard cards to come as labor gets  
onsite.

- Dale Marshall, daughter + intun onsite 3pm

4/24/03

weather : pt cloudy / sunny

50-60

dry

equipment: water truck delivered

used on driveways

street sweeper used on roadway

labor 3op

2 lab

1 super

trucks 37 loads ; tons = 987.92

CD tons to date 1363.95

+ 987.92

= 2351.87 tons

4/24/03

- TWIN-TON CAR SALES CALLED MAYOR'S OFFICE TO COMPLAIN OF DUST (230PM)  
GEORGE + MARK TALKED TO OWNER.  
WILL SWEEP AND WASH DOWN DRIVEWAY.  
MARY FROM NTDPN WILL BE TOLD BY DALE M. TO SWEEP SHOULDERS OF OLIVER ST TO CLEAN WINTER DEBRIS.

- SITE CLEARING ON MAIN PILE, (PILE SOUTH OF QUENCHING POND AND PILE SW OF DECON PAD.

- DOZER CLEARING AREA EAST OF RR BED FOR SITE ACCESS. KEPT SUBSOIL UPTAKE TO MINIMUM.

- WATER TURNED ON, FLUSHING OF HYDRANT SOUTH OF DECON PAD AT 3:30PM.

ROBLIN STEEL

4.25.03

get Karl to move trailer on north end of lot

- action env on site 7:15 AM

walk through site

start set up for <sup>background</sup> monitoring 8:30 AM

- get clipboard

- go to office pick up document from RAA.  
find out how the ton overage is going to

- even after baseline samples taken not enough to allow entry into workzone w/o suit + respirator.

- dozer's continuing site clearing

- Jim Tuk NYSDEC 2:00 pm - 3:00 pm looked around. nothing amiss. seemed satisfied

- act env. serv - break down gas 3:00 pm  
gate key needed for action env.

George to get key Monday



4/25/03

weather: sun / few clouds

50 → 75

dry

equip: decon trailers to be set on east side near gate

water truck used

labor: 3 op

2 labor

1 super

visitor: Jim Turk

Sam - (BFC)

Ad Env Serv

Mike Bull (Metro)

# truck loads C+D waste = 37

total tons = 1010.36

total C+D tons to date = 2351.87

+ 1010.36

3362.23 tons

4/28/03

get copy of Leonard's hard card  
get copied - James Morgan, Wray Fauszy med records

730 am - safety meeting, introduced Leonard to project.

800 move equipment south of field trailers  
set decon trailer at east side of site

900AM meeting on asbestos submittal

Dale Marshall, Dave Martinez, City of NT, Muffett Mallick, George, Mark Cerrone, Mike Bull, Mark Bull, George Chirianos, Dave Rowleson, RBC

Public property owned by 2, on separate parcels

surveys in 1992 and 2000 are inconsistent with each other main building

- EPA notification letter has not been received for all bldgs - not required  
epa notified on bldg A, B, D  
dol notified on bldgs A, B, C, D, E  
no asbestos in G

4/28/03

4/28/03

weather: sunny, clear, dry, ± 60°

labor: 3 operators (Lenny Yousett on-site)  
1 laborer  
1 supervisor

Komatsu 394e loaded + moved off-site

truck loads =

total tons =

total tons to date = 3362.23

±

=

4/28/03

need submittal  
hard cards needed -  
mike orsi  
lenny yousett  
jack dietz

- get kaul some asbestos project signs to post on doorway inside building
- hmg to look at work plan
- Tracy @ metro will be getting MMS canceled checks for dol notifications
- have building H sampled for asbestos prior to work on it: may need to do a notification later if hot. if not send out as non-acm.

PCB area to be marked off by crew today at latest

✓ Nimo - dare to call on 3 transformers on pole near trailer 21 22 & 25

4/28/03

4/28/03

decon trailers set in place on east side 1100AM

talked to dave rowlinson - 2nd buick pile will be sent as C/D not in 10% variance work scope.

dave "undustards" that site was cleared - not a lot of dirt removed - and backblading was done thurs + fri to stay busy.

lenny from schultz landfill onsite 230pm

called jim tuk (nursdec) to inform him demo starting tuesday.

called karl z (armstrong) to inform him demo starting tues am. karl has signs and exits taped on doors near demo sites. karl will attend tues am safety meeting. he had trailers moved offsite mon am from ne corner. karl is all set with demo to start tues am.

4/28/03

4/28/03

4/28/03

Raa informed DLR + RBC that OR  
will be onsite all week 4-28 → 5/2  
to watch demo work.

hard cards and medical records need  
to be sent to MING (fort-albert)

04/29/03

safety meeting 7:30 AM (started early 7:15  
RBC missed 15 minutes)

a pp presents

safety stressed

tomorrow morning need to  
coordinate better with Larry

call Dan King regarding Schultz  
landfill

truck's should be washed prior to be  
torn down. talk to Jack Dietz  
directly

Stearns & Wheeler  
Should side with Muffett.  
we should find out the reg.

Kevin Zielinski needs to be onsite  
at 7:30 am - no questions

4/29/03

weather: sun / pt clouds

60°

dry  
winds from  
NW

labor: 4 operators, mark, jack, jimmie, lenny

3 laborers dom, mike, dan

1 supervisor

1 air monitor 1 asbestos supervisor

action environmental onsite 7AM - 4PM  
testing

used  
equipment 3 excavators

1 dozer

1 decon trailer

1 decon pad

2 fire hydrants

fire hose

1 me data com



4/29/03

"edji" from city remove meter

Dan King 857-7220

"non-frable" on concrete pad

landfill can accept non-fri

is DEC ok with that

call landfill to authorize Vince Grandinetti

628-1241

tag#

37253 PA truck #1 loaded 2pm

37199 PA truck #2 loaded 230

loaded 248

truck 3 loaded 300

truck 4 MAXON radio #35

antenna to comm

40 channels

Asbestos pulled out - source of job potential and then

cleaned out buick can be

used on site and staged

Jim Strickler - later in week on <sup>can be sent</sup> ~~an~~ ACM

below 50 ppm - non haz

4/29/03

- personal samplers - who's performing testing? CEM or AAction?
- hydrant - meter removed; per authorization City NT Water dept "Ed". increase volume of flow to acceptable levels for dust suppression. meter still in place on hydrant near pcb waste area.
- hose must be picked up and put away after use do not leave out for possible contamination into water lines

4/29/03

don't scrape coating, take sample  
of all metal and then crush  
do Hg<sub>2</sub> water determination for PCB  
and nothing else no need full screen

"some does, some doesn't" contain PCB

\* ~~but~~ brick after segregating  
how to certified - pest engineering  
not retested

HAZOPB was last summer Bob Henschell worked on  
Niagara falls project feds were doing  
analysis for asbestos, ran full scan  
before taken to a landfill

fed money was funding  
ask for Brian Sadowski to talk to him  
tomorrow. Dan King not in office 4/30

04/30/03

wrecking continues on 1st building

truck loads - #1 930 AM

action environmental on site 645 am

set up and ready at 730 am

doing completing background monitoring on area #3.

Larry performing monitoring within work area.

NYS DOL Ted Layman onsite 1000 - 1030 AM

went over areas, identified which building go in which order, looked at hardcopy copies, checked decon trailer

air sample 0-12 (0.006) 4/29/03

I-1 (0.005) 4/29/03

0-6 "filter damaged" 4/29/03

04/30/03

Weather: cloudy, am - no precip, dry

50° - 60°

wind from southwest

labor 3 operators

3 laborers

1 supervisor

2 air monitors 1 asbestos supervisor

equipment

mic data van

water meters decom pad

3 excavators

water truck

1 dozer

supply van

decon trailer

fire hose

visitors dol - ted Leyman

sam - ~~the~~ scullavosa - bfc

dave rowlinson

truck load #1 9:30 AM

load 2 1:30

load 3 2:00

load 4 2:15

load 5 2:30

load 6 2:45

load 7 2:10

5/11/03

Safety meeting 7:30 AM - 9 present

dave rowlinson on-site 8-10

dale marshall & bob austin on-site 10-11

jean tuk on-site 11-12

- trees pulled out and placed onto ACM debris pile in bldg 2. -

- Safety mtg:

- slips, trips - stay alert for weather

- wear eye protection

- dust suppression good

- jack plans on moving west after today

will be moving steel back from concrete

pad in bldg 2 to stage area to make

room for trucks to haul debris from

- need to schedule clearance test on areas

with action 1 day ahead of time.

give larry 1 hour notice to move to next

work area.

- action - 3 fails on monitoring tests 4/28/03

larry personal also failed. under asbestos

5/1/03

weather: am rain, cloudy  
pm pt. cloudy, no rain

60-75°

ground conditions = wet

wind southwest and west

labor: 1 Supervisor

4 operators

3 laborers

1 asbestos supervisor - M. Bull

1 air monitor - action

equipment 3 excavators

1 dozer

1 water truck

1 decon trailer, 1 decon pad

fire hose

1 pipe data van

trucks 1 9:15 AM 6 2:30 pm

2 1:30 PM 7 3:00 pm

3 1:45 PM 8 3:15 PM

4 1:55 PM 9 3:45 pm

5 2:05 PM 10

5/1/03

limit though. result - dust is up - do more

dust suppression.

check map for location of failure's

calcium chloride may be added to

access roads to maintain dust suppression

action was offsite  $\leq 1 \text{ ppm}$ .

@ office from 12:15 - 1:45 pm

2nd building down. brick staged on ground  
where outer walls came down. to be used  
as roadway for trucks to run over.

all sample 0-7 high (0.041) 4/30/03

I-1 high "overloaded" 4/30/03



5/2/03

meeting set up 5/5/03 at 1000 am.

no more brick filling in trenches - stage it.

brick pile w/ galbestos needs to be ~~saved~~  
segregated.

call NYSDEC for meeting Monday.

called water dept. not able to increase  
pressure.

action environmental:

- split between kiln
- get pers. lab from metro
- pers monitors can be shut off  
after 2<sup>nd</sup> bldg
- do background Sunday?

Dale Marchese onsite 9:15 AM - 10:15 AM

NiMo - Dan Malik onsite 10:30 am

weather: am: rain, clouds, 45D  
 pm: rain  
 ground: wet  
 wind SW

labor: 1 supervisor  
 4 operators  
 3 labors  
 1 asbestos monitor  
 1 air monitor

equip 3 exc  
 1 boiler  
 1 water truck  
 1 diron trailer, 1 diron pool  
 fire hose  
 1 mil data van

trucks	1	830 AM	6. 225	11 345
	2	900 AM	7 245	
	3	930 AM	8 300	
	4	1415	9 320	
	5	200	10 330	

5/2/03

Called Karl Ziebel (Armstrong) regarding  
workers watching demo on west side of  
Bldg.

buick from east wall of area C used  
on ground as roadway. buick wall (east)  
felled to outside and incorporated into  
roadway.

buick from area C north facing wall  
felled to outside and staged in NW corner  
staged pile to be used as fuel for roadway.

- air sample 0-5 "fitted damaged" 5/1/03

0-7 high (0.009) 5/1/03

E-1 "overloaded" 5/1/03

5/5/03

- action environmental  
"project monitor"  
"air monitor" conflict

- progress meeting  
- 30 trucks anticipating to be onsite

5/5/03

- most demo should be done this  
week then loading operation will  
continue.

- stage brick \*dale marshall  
authorized use of brick as fill  
for roadway or in safety issues  
with open trenches.

- dale has budget to authorize additional  
work on site

- change orders -

• sample asbestos for PCBs

• segregate asbestos from brick

5/5/03

am pm  
Weather: overcast, rain - steady

50° - 60° 50°

ground - dry - am, ground pm - wet

wind <sup>out of</sup> east, southeast

labor: 4 operators, 1 supervisor } core

3 laborers, 1 asbestos monitor }

{ 1 air monitor, 1 owner } action env. services  
{ 1 project monitor }

equip: decon pad, decon trailer, mic data van,  
1 dumper, 3 excavators, 1 water truck, 1 sheet  
sweeper, fire hose

ACM HAUL		STEEL HAUL	
trucks: load 1: 8:00 AM	11	3:30 pm	load 1: 8:30 AM
2: 8:30 AM	12	3:45 pm	2: 10:00 AM
3: 10:00	13	4:00 pm	3: 12:00 PM
4: 10:00	14	4:15 pm	4: 12:15 PM
5: 10:00	15	4:20 pm	
6: 1:50 PM	16	4:40 pm	
7: 2:00 PM			
8: 2:20 p			
9: 2:40 p			
10: 3:05 p			

5/5/03

- buck pre-call ~~both~~ DOL regarding how to handle and get some recommendations on how to move DR to call DOL.
- need pricing on drum removal
- chimney on west side to be sampled prior to demo  
sample 1 large chimney for ash if clean can be staged onsite  
buck price for demo should be a lump sum  
samples taken on 2 chimneys and "kub" for asbestos content
- remedial phase work
  - call Marshall happy at progress
  - no contract yet for state assistance
  - get work plan finished
  - ~~at~~ at 1/2 way point will know more about price of this contract

1200 PM progress meeting w/ action envr, FOIT ALBERT, S+W

Muffett M George, DR, RBC, LN, DONG, CONLITH, KEVIN ZIELINSKI

- addressed issue from 730 am with project monitor

issuing orders, chain of command reiterated.

DR  
RBC → FOIT → ACTION. all issues brought to S+W  
and addressed.

- compromise offered (RBC) poly lining, folded and  
covering load <sup>in work zone</sup> by ~~errone~~ asbestos suited worker,  
then leave work zone for tarp staging area by driver  
who inspects, then canvas tarps when satisfied.

ok'd by DR MMG, Kevin Z, RBC, Doug, Larry, Conn

- project monitoring / backgrounds to be performed by  
2 people proj monitoring, air monitoring to be performed  
by Larry only (on days not requiring 2)

will add additional when performing clearances.

- exclusion zones identified. area D finished 5/5/03  
for backgrounds. area E debris pile, area F  
guard building. possible area by chimney on  
west side of road; per testing results.

- add more snow fence + project signs

- add snow fence surrounding area D.

5/5/03

payment applications  
forms to george from DR.

get fence put up on wire fence  
near armstrong.

get fence put up on area D

OFFSITE SPM.

air sample O-9 (O.009) for 5/2/03

air sample P-1 (O.106) for 5/2/03

5/5/03



5/6/03

- action env onsite 6:45 am
- CEM testing chimneys and kiln
- demo occurred on steel structure supporting partial chimney. area not marked off.  
need fence put up barricading work zone D.
- need more water on buck pile.
- brick from ~~NW~~ area C is being used for roadway between decon pad and concrete slab from area C. Dale Marshall ok'd use 5/5 meeting.
- fence put around burnt bldg in area D and along outside of "historic" chimney to run length of bldg in area C.  
center of bldg ruins in area D to be sent as "C+D" material unless testing proves otherwise. work through scheduled for 5/7/03 with DR.
- Issue with Con. Keogh 5/6 12:30 pm re: decontamination of staged buck.
- Four areas of concern: 1.) no snow fence on wrought iron fence on Oliver St. 2.) tire decon on trucks 3.) brick in driveway 4.) <sup>middle</sup> area excluded from Area D

5/6/03

- bldg on west side of Gravel drive, window caulk sampled and tested. only area of concern there. ID Sample #12 by CEM.
- chimney's and "oven" tank sampled 5/6/03 by CEM.
- chimney on NW side of area D to be sampled 5/7/03 by CEM.
- contents of brick house near "historic" chimney tested 5/6/03 may be drywall pile within building.
- steel surrounding partial chimney removed, brick left as ACM. pictures taken.
- steel picking from large debris pile continues as load operation progresses. Currone aware of need to salvage.
- trucking company (BFC) stopped in PA for inaccurate manifests, situation handled by BFC and Currone 5/6/03 3PM BFC will send trucks starting immediately.
- drums being sampled in storage building per DR
- air sample 0-4 "overloaded" for 5/5/03

5/6/03

5/6/03

weather :	am: sun + clouds	pm: sun
	50° - 60°	60° - 70°
	ground = wet	ground = drying

equipment :

- EX200 LC w/ grapple brought on
- D-4 dozer brought on for clean work
- 3 Excavators
- 1 Dozer
- 1 midata ram
- 1 decon trailer, 1 decon pad
- fire hose
- supply van

	<u>custome</u>	action
labor	4 op	1 air monitor
	3 lab	1 asb monitor
	1 supervisor	
	1 asbestos super	

visitors dene maziarz, pam pantarosa

ACM

trucks : load 1: 1:00 pm

          2: 5:00 pm

STEEL

load 1:

offsite 5:30 pm.

5/6/03

5/7/03

1. get ACM weigh tickets
2. get poly liner mil spec from waste hauler co.
3. get test results from 5/6/03
4. C. Keogh hard card - I asked, he didn't give copy and said "oh well" with a shoulder shrug and "go call the DOL"
5. at 5pm Keogh + I were watching a truck being loaded and then pull into decon pad. the driver got out of the truck w/ resp e' truck but asked RBC if he could be out of truck. Before I could respond, Keogh interjected with "you can't ask her you will have to ask an asbestos licensed person." again demeaning my authority in front of workers. the driver again asked me a question + as I could not hear him I stepped into decon pad to get closer and Keogh "advised me to remove myself from area" loudly.

note on truck. I observed that an additional piece of 4mil poly was put onto truck to overcome the liner not meeting on all sides. the roll was mistakenly grabbed from the wrong pile of 4mil poly. this was the only truck

5/7/03

that had the problem on 5/6/03.

6. Keogh stated at 1230 p 5/6/03 that brick used in roadway between area c + decon pad contained "mastic" and would be contaminated with asbestos.

I informed him this came from a staged pile of washed brick and Keogh stated that "he did not believe me."

5/7/03

- get water on driveway
- get street sweeper on roadway
- hydrant broken <sup>overnight</sup> water dept to repair at 10<sup>th</sup> +  
Oiver. Question of permission to use hydrant.
- poly + wash tires on decon pad w/

Circle areas of concern w/paint & have  
cerroone remove prior to demo.

- cerroone said <sup>water</sup> dept gave permission  
to use hydrants if there was a meter on it.  
if it was broken why didn't cerroone  
call water dept? i told them to leave  
the

- get chimney knocked down on west side

- get copy of survey to DOL / Ted Lyman

- fax - # 847-7138 m

copy letter  
Attn: Ted Lehmann  
Asbestos Control Bureau

65 Court + St # 905

Buff NY 14202

5/7/03

- caution tape on iron fence not complete
- snow fence needs to be fixed on NW corner of area A
- more water on piles
- clean road at lunchtime
- build beer pile
- 6 mil poly brought on to replace 4 mil in case extra needed on load.

SHUT DOWN, FOR A LATE LOADED VEHICLE

- using personal water spicket on brown house on 16<sup>th</sup> street instead of hydrant (TNT) by permission of house resident
- offsite 4:45 pm.

\* air sample I-7 high 0.017 for 5/6/03

weather: sun + clouds, 60°, no prec., dry ground

cermone

labor: 3 operators, 3 laborers, 1 supervisor, 1 asbestos supervisor

action:

1 air-project monitor

equip: payloader - road, 3 excav., 1 dozer, hose hydrants,

material ram,

	<u>acm</u>	
trucks	1 730	10

	2 730	11

	3 730	12

	4 730	13

	5 730	14

	6 730	15

	7 730	16

	8	17

	9	18 4:45 pm

steel

- 14 loads

date 5/6

5/6/03



5/8/03

1. get 6 mil poly spec from George
2. get copy of safety meeting attendance list
3. get lotterio plugs + med forms
4. get dataram data from RAJ CHOPRA
5. get pails to stake off driveway
6. building of decon waste water collection trench for steel washing will be built in next 2 days. no steel washing to occur at this time. steel separated from ACM debris pile on work zone C will be staged on concrete for later washing.
7. signs and fencing fixed per RBC by Mark Bull 5/8/03. driveway access to "steel" area will be closed by M. Bull when not in use.
8. waste manifests copied for RBC
9. get procedure to raise tank

weather: AM cloudy 50', no precip, dry ground

labor: alex lotario brought on

crew: 4 laborers, 1 supervisor, 3 operators, 1 asb. monitor

action: 1 air monitor / asbestos monitor

visitors: ted lehmann, mike bull, dan marshall,  
evan hawden (CEM)

TRUCKS	ACM		STEEL LOADS
	1. 730 AM	9. 330 P	
	2. 730 AM	10. 400 P	
	3. 1000 AM	11. 400 P	
	4. 1200 PM	12. <del>400 P</del>	
	5. 1200 PM	13. ?	
	6. 100 P	14. ?	
	7. 200 P		
	8. 330 P		

5/8/03

10. Trucks loading may be late on 5/8/03 due to storm in OHIO area. Landfill was down for a certain period. 5-7 trucks will arriving onsite approx 4pm. Time to load will put them over the normal work hours.

talked with Kevin Z of Action and decided to keep working, sample til end of work and note sample result return time may not be 24 hours.

11. DR needs to make sure steel being removed from ACM debris pile prior to load out.

12. adjusting work zone tape around brick pile in ZONE A.

13. installed brick road with staged decon brick east-west of area C

14. test results back on chimneys + tank oven"  
see results for analysis

5/8/03

15. CEM needs to sample partial chimney,  
top of sample ID 12 (square bldg on  
west side of site) and brick structure on  
east side near "H" power poles. possible

05/09/03

16. problem with water pressure at Armstrong  
pumps brought to my attention by Karl Z  
Called water dept regarding problem.  
may be caused by broken hydrant on  
10<sup>th</sup> + Oliver streets.

17. air sample 0-7 high for 5/7  
(0.611)

5/9/03

1. test results on chimneys  
discuss at meeting Monday
2. price for segregation  
discuss at meeting Monday
3. how to get waste brick or non-friable chimney off site? modern?
4. send analyticals to landfill for woodblock floor acceptance
5. "oven" what roof material?
6. waste piles - phase II
7. west of driveway - pick manually all steel, phase I. cinders and concrete crushed on phase II.
8. NW debris - brick clean, bldg rubble is ACM.
9. #07 clean room of decon trailer build
10. truck loads not coming in.
12. get weigh slips from 5/7 + 5/8
13. concrete pads are continuously scraped and sprayed throughout day.

5/10/03

	AM	PM	5/9/03
weather	sun + clouds 60°, dry	sun 70°, dry	
labor	corrected: 3 operators 9 laborers 1 supervisor 1 asbestos supervisor	action 1 air/project monitor	
equip:	1 loader, 1 roller moved offsite 1 equip van 2 excavator 1 dozer 1 midi data van, 1 dump trailer, 1 decom pad fire hose		
loads	8 total of ACM	2 total of Steel	
* problem with water pressure at Armstrong steel. called water dept (NT). broken main on Nash Rd. Will come to investigate Armstrong after repairs to Nash main complete.			
* air sample @ 0-12 "overloaded" for 5/9/03 air sample @ 0-7 high, P-1 high for 5/8/03 (0.012) (0.012)			

WEDNESDAY, MAY 7, 2003

5/9

- 14. water added to roadways periodically 5/9/03 as needed.
- 15. don't stop trucks unless load time will not permit weighing at local scale. (OK)
- 16. took down snowfence around SW corner of area. (RBC) wrapped fence to include over.
- 17. instructed Mark Bull to make sure fence is intact and area secured.
- 18. gable bldg came down @ 300pm replaced fencing damaged by debris in area B.
- 19. Miller + payload off site 5/9/03 to be returned
- 20. more brick down with wood on SW walls of bldg in area C. supposedly when wood was being removed, brick caved in.

5/12/03

1. need to check on watering while loading
2. LN mentioned meeting on Tues AM with MMG
3. get steel weight report
4. get MUE Data Pam printout
5. talk to Bear re sampling
6. barrel test results back Wed or Thurs
7. west facing wall of bldg in area C was demo Friday and partially standing piled on edge of bldg footprint. Monday dozer moved most of west edge of debris into ACM pile.
8. fence marking work zone ~~are~~ area D on North edge of bldg w/ Armstrong Parking area was knocked down due to high winds. Winds still excessive 5/12 - any efforts to secure barrier were futile. Mark Bull trying to solve issue by adding weight to posts. RBC instructed <sup>contractor</sup> to maintain security in that area as main priority over others during wind.
9. Chain link fence attached to Armstrong Bldg cut free and needs to be reattached for security. RBC instructed G.C. to fix at 2PM



10. 25 trucks loaded 5/12

11. Ed Scakvinski Water Dept NT says Armstrong Pump

Water pressure not caused by NT. May be caused by dirty screen in meter in plant itself. may be caused by flushing from Roblin work. Need to talk to Karl Ziolk re: issue.

12. water dept (NT) never showed on Friday 5/9 investigated 5/12 when valve was turned off. concluded it was not a main but a hydrant

13. asked Bear of CEM testing what was sampled on "oven". It was a black material adjacent / encompassed by roof + roof debris. ic mat moss

14. Shultz said fuel onsite to New woodblock floor and if it can be disposed of at the LF. no answer yet.

15. air monitoring occurred all weekend per action.

16. O-2, O-3, O-4, O-5, O-7 "filter damaged" for 5/11/03 samples all samples good for 5/10/03

5/12

weather: rain, clouds, cold, high winds  
all day.

ground: wet  
50°

winds SW

labor:  
Cerrone:  
2 laborers  
2 operators  
1 supervisor  
1 asbestos superv  
action:  
1 air monitor

1 excavator  
1 doz  
1 supply van  
1 decor pad + trailer  
1 mic data van

trucks: 25 loads

5/13/03

1. fence around site needs repair as soon as winds die down
2. chain link fence along armstrong belongs to armstrong. fence was lying on ground this AM. was to be secured 5/12 by Mark Bull. I called Karl Zlotch re: fence he stated he does not need fence and would not mind or charge us for the removal and disposal costs. we will put up a snow fence barrier in place of fence
3. TRANSFORMER TESTING + MOVE WORK ZONES  
Transf need testing (by CERRONE) and there was a question of how to reach transf near river stream  
Cerrone will be moving tape from decon trailers to shorter area of work zone B. near buck pile.  
once areas A+B are cleared from air monitoring, Cerrone may move location of decon trailers to facilitate work.
4. instructed <sup>G.C.E.</sup> metro env. to secure fence + signs on site
5. 8" watermain on East Ave. will be shut down 5/14/03 at 9:30 AM for 2 hrs to repair damaged gate valve. this may disrupt water flow during site work

5/13/03

5 cont'd: Contractor will make provisions to continue work or suspend work around any water shortage.

6. tracking paperwork expected Tues or Wed with all weigh slips and reports

7. DOL violation on survey submittal received at City, NT Engineers office 5/13. Faxed copy to Muffett George to get clarification.

8. 48 hrs to redo sample on bldg 6 (near field trailers) to comply with DOH standards for a TEM test.

9. Shutdown 4pm  
19 truckloads total

10. 0-2 air sample "filter damaged" (5/13-03)

5/13/03

weather: clouds + rain AM + PM

cold, wind SW

50°

crew:

labor

1 supervisor

2 operators

2 laborers

1 ash monitor

action:

1 asbestos project

air monitor

equip

1 mil data

1 exc

1 dozer

1 decompad + trailer

fuel hose + hydrants

trucks loads total = 18

shut down 4pm

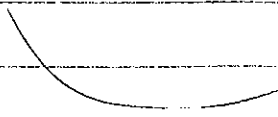

5/14/03

1. Safety meeting 730 am 8 present
2. Waterline on east ave shut down 9:00 AM  
hydrant for decon still available
3. work on clearing ACM.  
work on clearing off pads  
work on galbestos separating if time.  
permits
3. instructed maintenance to repair fence  
need additional "asbestos" signs put up.
4. get chimney knocked down
5. check + design path for incoming + exit  
for steel + ACM loading.
6. removed chain link fence from armstrong  
pumps and installed snow fence  
securing area.
7. cleared galbestos siding from brick  
pile and secured in 55g drums

5/14

8. area B to be cleared from air monitoring as soon as possible with action.
9. area A to be cleared from all steel and concrete pad cleaned 5/15 to enable clearance.
10. discussion of necessity of 2 monitors to complete clearances with action.
11. water dept restored with approximately 1130 am. Armstrong pumps still has low water pressure.

5/14

Weather - am sun + clouds pm sun

no precip →

dry ground →

SW winds →

labor: 2 operators

1 air monitor

2 laborers

1 asbestos monitor

1 pump

visitors: mark errone dale maushae, rachel

Kevin Zielinski dave mazzari,

steph dietz, dave rowlinson

equip: 200LC EX offsite

1 dozer

2 exc

1 supply truck, 1 diem trailer, 1 diem pad

1 mic data ram

hose, hydrants

loads = 18 trucks

\* all PCM samples passed (5-13-03)



5/15

1. clearance / final air monitoring being run on area B by aaction.
2. steel to be transferred from pad in area A to area C for decon  
concrete pad in area B to be cleared off and readied for finals Friday 5/16.
3. P-1 air sample failed <sup>(0.014)</sup>, all others good.
4. give aaction 24 hr notice for clearance air sample on area A.
5. area B will be cleared 5/15, area A 5/16 then on Monday 5/19 should be able to move decon trailers and work areas to center around area C + D.
6. debris pile in area C, near west edge being separated for steel and acm.
7. aaction conducting final air on area B using generator borrowed from cerone. generator will also be needed 5/16 to

5/15

7. cont'd to complete samples on area A.

clearance should be complete in 4 hrs.

8. Kevin Z. running a PCM and then a TEM test on clearance samples. PCM samples being taken at edge of Armstrong pump driveway where heavy truck traffic is being seen 5/15 - potential for failures

TEM test and PCM test would be redundant when run together. DR to call MMS of Foit to determine the necessity of tests

9. Corrone to aid action by locking generator in FX truck overnight

10. final samples complete for area B  
results to return 5/16

11. TED LEHMANN, NYSDOL onsite 130p - 330p  
NO comments or violations walked through site again, checked hand cards, decon areas, suggested taping off decon pad.

5/15/03

Weather = am sun/clouds pm rain

50°

80°

no precip

wet

ground dry

wind SSE

wind SW

labor : 2 op

2 lab

1 supervisor

1 asbestos supervisor

Equip : 1 hitachi 200 LC EX onsite

1 data van

2 excavator

1 dozer

visitors : jim tuk, ted lehmann

truck loads = total

\* PCM samples (5-14-03) 0-12 "filters damaged"

5/15

12. old use of some fallen buick to build area for road access.

13. steel moved from area A to Area C

14. roof off small buick bldg.

15. jim tuk onsite 1145-100p. "just visiting"

16. built driveway on west side of area c using corner of standing buick bldg. buick was piled and leveled to form roadway with excavator.

17. work til 530pm. office til 6pm

18.

5/15

5/14

1. area A final monitoring scheduled for 9AM by action
2. clear additional debris off corners of pad in area A.
3. Larry Nelson mentioned final results from area B will be received via fax in 1 hr. Kevin 2 put a rush 12hr on tests.
4. TEM tests don't need to be run for final samples.  
read inside, not outside samples cut costs in half
5. have george sample TCLP composite grab at each pile and put together to form composite.
6. opened hole in concrete structure on north end of area A near tanks for Larry Nelson to view inside. structure is entirely concrete: floors, walls, ceiling.

contd

5/16/03

Iron fence around tanks ok to stay. Buck  
on perimeter of area ok to stay. will be  
completed in phase II crushing.

had excavator remove a small pile  
of buck debris that had wood block  
in it. scraped edge back again on west  
side near snow fence.

7. project sign installed on wooden frame  
at front near trailers

8. talked with george regarding finishing  
Aem by 5/23. if trucks available - may be  
possible.

9. KENN ZIELINSKI (action) accepted my  
authorization that area A is clear and  
ready for clearance monitoring. Larry Nelson  
set up samplers at 1045 AM - 1130 AM. Needs  
to collect 5/5 PCM ; 5/5 TEM tests for 120  
minutes each.

10. steady rain all day - erroneous  
air sample data possible result?

5/16/03

11. Clearance air monitoring complete at 3:45 pm. RBC helped LN pick up equipment. generator to be stored with cesare in FX truck?

12. pump installed in pit within concrete pad in area C for containment of steel decon waste water. plastic tank in place to collect pumped wastewater.

13. all WIP PCM tests ok (5-15-03)  
area B clearance samples (5-15-03)  
"PCM 0-10 "filter damaged" (5-15-03)  
" all other PCM ok -passed (5-15-03)  
" all TEM passed (5-15-03)  
(NEED RETEST 0-10)

weather : steady rain

50°

wet

wind S-SW

rain tapered off 4pm

labor  
Cerrone  
1 Super  
1 asbestos Super  
2 laborer  
2 operators

action  
1 air monitor

equip - 1 dozer  
2 excavators  
1 mid data van  
1 decon trailer

1 decon pad  
hydrant / hose

trucks - 13 ACM

9 steel

work - 715-500 PM



5-19-03

1. loading of debris from area C continues
2. test break up of concrete pad north of field trailer. 27 x 87 (pieces) = 68 x 218 ft area hammered and cleared from 9AM- PM footers + wall also dug up. work done to give estimate to DR. concrete slab approx 4" thick
3. Dale Marshall - get authorization to work 1 more day TEM on concrete footers in area.
4. Cerrone to develop square footage cost of concrete for DR
5. CEM onsite 200 to sample roots. & chimney roots get PCM test, not TEM per DR
6. action performing 2 clearance air sample tests inside A and outside B

5-19-03

6. cont'd - these test results came back "filter damaged" so need to be re-sampled for clearance. results expected Tuesday.

7. chimney corner removed for sampling in area D.

8. wood block floor - landfill to check with DEC for approval and then can take block as C&D.

9. Ted Lehmann called 12:11 regarding survey of buildings and was there a notification for guard shack. he wanted to know which zone shack would be in and how much asbestos was in it.

10. only PCM samples run on roof of bldg on east side of area B by CEM per DR

11. concrete work until 3:30 pm. finished pad with area

5-20-03

7 cont'd) pictures taken of area work to cease after today until authorization to proceed price submitted to DR by someone.

8. AIA form given to Dale Marshall for processing

9. ACM load out continued in area C total 16 trucks.

10. give George map + plan for soil contamination to enable price to be submitted for work.

11. Is CEM "CLP" certified?

12. Area A Clearance TEM F-4 "filter damaged" 5-16-03

(need to re-run)

PCM 0-9 "filter damaged" 5-16-03

(Need to re-run)

WIPS 0-6 "filter damaged" 5-16-03

Area B Clearance PCM: 0-10 (re-run) Passed (5-20-03)

Area B Cleared.

Area A Clearance TEM: F-4 (re-run) Passed (5-20-03)

WIPS 5-17, 5-18, 5-19 (all passed)

AM	PM
weather: sun/clouds	sun/clouds
50'	60'
ground - dry	dry
no precip	no precip
wind - SW	SW
water added to roadways for dust suppress	
equip: 1 dozer	
2 excavators (400 in service 10AM)	
JLG lift	
supply van	
decou trailer + pad	
MIE data van	
hydrant/hose	
cell phone:	action:
labor: 1 supervisor 1 asbestos monitor	1 air monitor
2 laborers	
2 operators	
total ACM = 16 (13)	total steel = 5
visitors: DR,	
* all air samples 5-20 OK	

5-21-03

7. T&M work square footage price to be resolved with George + DR (#.38 high?)
8. Mark Cimone to be onsite 5-22 to clear area D. work on ACM debris first? need walk through with RBC prior to work starting. how to get trucks to area? stage bick from debris piles on edge of pad in area D along roadway for tie?
9. background air samples taken on area F (guard shack) by aaction. bldg to have a notification sent to NYSDEC for approval so no. work to commence for 10+ days
10. air sample: WIPS 5-20-03 all passed

5-22-03

1. measured concrete test area  
dimensions - total work completed 6400  $\text{ft}^2$
2. Air sample: Area A Clearance: 0-9 PCM passed  
Area A cleared
3. Decon trailer moved into Zone C since  
A + B are clear.
4. background monitoring complete on area F  
(debris pile) 5-22-03.
5. work in progress on area D. ACM to  
be moved to north. C & D material moved  
to south. back to stay separate. bunches  
to be moved in through area C and  
out driveway or backed up to go back  
out area C.
6. main bull moving hose to area D for ACM.
7. area C almost cleared of ACM  
and steel.

5-22-03

5-22-03

weather: sun	sun
none	none
dust	dust
50°	60°
wind SW	wind SW
water added to	roadways for dust

Labor	3 operators	1 air monitor
	2 laborers	
	1 asbestos super	
	1 supervisor	

equip:	3 excavators	hose/hydrants
	1 dozer	
	1 discm pad + trailer	
	1 mie data lam	

truck loads:	17 ACM (17)
	11 Steel

5-22-03

8. Chimney (historic) on hold until authorization from Dale Marshall.

9. Kevin Z. on vacation until Thursday. Con Keogn will be fill in for Kevin while on vacation. per DR - Keogn only onsite if situation arises to warrant.

10. offsite 5pm

11. decon trailer set in place by 2pm fencing around areas C to be fixed to incorporate decon trailer. fence around area A+B to be removed 5-23-03

Cons. staff on call



5-23-02

AM  
weather: sun/clouds  
dry

PM  
sun/clouds  
dry

11 p.m.  
11 p.m.  
material added to loadways

labor: 3 operators  
2 laborers  
1 supervisor  
1 asbestos supervisor

action  
1 administrator

equip: 1 dozer  
3 excavators  
1 misc data van  
1 dump trailer + dump pad  
hydraulics / hose

trucks: ACM = 10  
Steel =

1. diron trailer moved into work zone C

2. work zone A + B cleared from air monitoring

3. call muffed m george u, daily monitoring

4. area D work in progress clearing debris

1 ACM pile on north side of area

2 large C+D piles south side of area

brick floor to remain in place as best possible for phase II crushing. wood block floor to be removed as C+D.

2 chimneys to remain until further notice.

5. deli marshall on site

dave rowleson on site

5-27-03

1. checked area D. most wood block has been pulled up and piled into C+D area still needs more cleaning  
area C needs more clearing
2. "oren" contents have been picktioned off and will be loaded out as ACM 5-26.
3. small pile of acm still in area C.
4. tanks in area A scheduled to be moved down from structure and staged on poly for cleaning, cleaning to be scheduled yet.
5. area F contents were demolished and loaded into ACM trucks between 2-300pm. area scheduled for final air monitoring Friday 5/30.
6. area D cleared of all ACM piles, pad backbladed and cleared of all loose debris per RBC. area D scheduled for final air monitoring 5/28/03 (Wed) →

5-27-03

AM  
Weather = mostly cloudy

no precip

dry ground

60°

PM  
cloudy

rain - heavy

wet

65°

labor: 2 operators

equip 2 laborers

3 excavators

1 dozer

1 mill data tank

2 hydrant / hose

1 decontain. pad

trucks: 20 ACM

5 STEEL

5-28-03

1. wood block floor in area C (small bldg) to be removed by operator

2. finals being run in area D

3. finals scheduled for area C and area F 5-29-03, will run consecutively

6. filter if water test comes back positive for asbestos, portable filter avail to rent. Choptera LLC can do test.

other tests: TOC, COD, suspended solids  
pH, asbestos

p. drop can issue an ind. discharge permit  
opoke to paul at 11:30 pm

7. Larry Nelson to walk through after lunch to check for ACM.

ACM pile on west side of area C needs to be loaded out. oven bucket on

SW side of area C needs to be loaded out. <sup>small amount</sup> wood block in area A to be loaded out.

weather: AM  
sun/clouds  
no precip  
dry ground  
water not necessary

PM  
clouds  
none  
dry  
none required

labor/equip: 2 operators  
1 laborer  
1 asbestos supervisor  
1 supervisor

action: air  
monitor

1 dozer  
3 excavators  
1 decon trailer,  
1 decon pad  
hydrant/hose

TRUCKS: ACM = 4  
STEEL = 3  
CFD = 1

work til 430p

5-28-03

8. final inspection of area C by Kevin Zielinski (action) Thursday afternoon per con Keogh brick roadway between decon pad & area C "suspect material" according to con Keogh - needs inspection. brick roadway issue was addressed in meeting with Fort Albert + Action and resolved by all parties that brick was decon'd prior to use in roadway.
9. need 2<sup>nd</sup> generator for action
10. Change order request needs to be in tomorrow for common Council meeting.
11. area C + area F inspected and cleared for final sampling by L.N. (action crew)

5-29-03

1. load out of C+D waste from area D and area west of area D today.
2. final sampling being performed on area C + area F.
3. no work in ACM areas today.
4. Ted Lehmann, Al Jakubowski onsite 2:30 pm - 3:15 pm visit to look at the chimney. "creative variance writing"
5. tank work performed on small tank cut straps/supports. laid poly in area. work to follow 5-30-03
6. area F air sampled not finished (PCM) will resume 5-30-03. quantity of dust from truck traffic purchased testing in area.
7. offsite 4pm.



5-29-03

Weather: AM

PM

sun/cloud mix

sun/don'ts

no precip

none

dry

dry

wind SW

water added  
onto roadway

labor/equip: 1 dozer

3 excavator

1 laborer

1 equip truck

visitors: ted leblond, al jakubowski, nys dot

jim tuck, nys dex

trucks: C&D =

5-30-03

1. CID loadout continues on area east of railroad.
2. area D passed air sampling for clearance
3. remove barricade for area D clear steel pieces out of D minor wood block remains
4. DR notification on gatehouse not received
5. drums in stage area are ready to be repacked for shipment. was approval received to ahead with work?
6. Walkthrough with MMS (Fort Albert) and DR. spotted areas of more debris to be removed. roadway built East to West in area A. edges need cleaning. concrete pad in area D needs clearing

5.30.03

weather: AM

sun/clouds

sun/clouds

no prec

no prec

dry

dry

wind SW

→

labor: 1 operator

1 laborer

1 supervisor

1 air monitor (action)

1 dozer

1 excavator

petrol acetelene torches to cut tanks

hydrant/hose

equip van

5-30-03

7. brick road (E-W) between areas C + D needs to be piled and staged prior to chimney being demolished. all staged brick needs to be away from potential contamination.

8. Kevin Z (action) to be onsite 2:30 pm for walk thru

9. tank decommissioning being performed on smaller tank. there was a large hole in the bottom of the tank that will prevent cleaning and containment of wastewater. G.C. to place tank over trench (concrete) in area A and proceed with washing. wastewater will be collected in trench and then trench cleared per approved method.

6-2-03

1. tank decommissioning tanks
2. barrels on hold
3. continue load out of material
4. TEM J-5 "not analyzed" - re-run 5-31-03, <sup>results</sup> 6-2
5. action not on site for monitoring per NYSDOL, all separate projects areas have cleared, once clearance is achieved daily monitoring is not needed, area E has not had work started as of date therefore does not require daily monitoring
6. misc steel and beams to be loaded out in next few days
7. clean trench containing wastewater of tank decommissioning tanks
8. ted lehmann called: notification sent 5/28/03, rec'd 6/2/03 in DOI start date for work 6/11/03
9. CTD expected to finish 6-3-03 if trucks available over CTD completely, stage back will continue
10. get CTD quantity to date
11. oil pit on east edge of area A in foundation - to do?

G203

weather: part clouds →

no precip →

wind SW →

dry ground →

labor/equip: 1 dozen

1 excavator

1 operator

1 supervisor

trucks: C&D =

offsite 4pm

6-3-03

1. TEM IS clear, area C clear Area F  
clear 6-2

2. environmental onsite to pump out  
trench

3. grease pit sampling  
5 pts

get going to cover MH near tree pit

4. steel tank decomm. procedure  
not followed.

5. old transformer shell on concrete  
pad to be <sup>taken</sup> out as steel

6. concrete trench containing tank decomm  
wastewater. pH still too low, green  
env. procedure did not work. DR  
recommend add lime to WW to  
up pH and settle out metals then  
perform test on metals and RCRA.

7. O&D had out only work performed.

6-3-03

3. laborer removed area barricades,  
hose lines, and misc cleanup.

07.



6-3-03

AM

PM

Weather - Over clouds

→

no precip

→

wind SW

→

dry ground

→

water not added, some dust generated

late pm

labor/equip: 1 digger

1 operator

3 excavators

1 laborer

1 supply truck

1 supervisor

6503

wastewater in trench at first look  
separated into 2 distinct layers  
solids settled to bottom "clear" orange  
liquid on top.

adding lime from 50 lb bags (2 bags)

pH to start 3-4.0 |||||

10:30 AM 4.0 → (5 bags)

<sup>24</sup> 80 x 10 x 2 = 1600 ft<sup>3</sup>

<sub>78</sub> 10:45 AM 4 ↑ (8 bags)

11:00 AM 4-5.0 (12 bags)

11:15 AM 5.0 (16 bags)

11:30 AM 6.0 (@ 10 bags)

left site to wait 2-3 hours and then  
retest pH levels.

pH samples taken at each end and  
middle of trench.

6-6-03

pH procedure on trench continued

added 6 bags of sodium bicarbonate  
(total 9 per 3 days)

added 2 bags lime (total 18 per 3 days)

pH at end = 8.5 to 9.0

sample taken for analysis w/ 5.7 day  
turn

6-17-03

work started 6AM on historic  
Chimney. 8:45AM chimney fell  
to SW.

water used continuously  
barricades to be set up around  
area after demo.

small chimney also demolished

work started on gate house at 12pm  
gate house down by 1pm.

debris piled for loadout. loadout  
started in afternoon. continued 6/18.

caution  
tape set up around perimeter of  
gate house.

soil to be scraped down after debris  
removed.

6/17/03

weather:	AM	PM
	sun	sun
	70°	80°
	winds w	→
	dry	dry

labor:

- 1 operator
- 2 laborers
- 1 asbestos supervisor
- 1 supervisor
- 1 radon air monitor

equipment

- 400 exc.
- 300 exc.
- 1 mic data van
- 1 decon pad
- 1 decon trailer

6/17/03

6/18

1. Cleanup + loading of gate house demo debris.
2. waterline (service) broken in gate house. water rushing from pipe GC crimped copper pipe and SW notified city water dept. water dept stated crimping is good as is, leaking not major city will decide who repairs break. leave pipe as is.
3. need to estimate water usage
4. gate house debris removed and area scraped by 330pm. tape barricade reinstalled. area ready for finish 6-19-03.
5. aem debris (brick) being loaded pump being used for water collection.
6. water + sludge samples taken by SW.

6. 18. 03

6-18-03

weather	sun	sun / clouds
	dry	dry
	wind SW	→
	60°	70°

equip:  
labor

- 2 laborers
- 1 operator
- 1 asbestos supervisor
- 1 super
- 1 RACTON air monitor

- 1 exc 400
- 1 exc 300
- 1 decm pad
- 1 decm trailer

6-18-03

6-19-03

1. finals performed on Gate house
2. loading of acm debris of brick pile
3. need to repair caution tape
4. DR = overage on original ACM  
absorb into chimney.  
3<sup>rd</sup> Bidder  
DR - Mortar = RARE remote chance
5. walked through area D. found misc woodblock
6. Steve - Verizon came out to remove wires in 2 areas of site. removed wire closest to trailer. wire near armstrong needs a lineman to remove. contact Tim Halig @ verizon to schedule date. 689-9953
7. area by chimney cleared of debris pit near driveway cleared of

6-19-03



6-19-03

weather: clouds  
lt rain  
wind SW  
60°

equip<sub>x</sub> : 1 operator  
labour 2 laborers  
1 asbestos pump  
1 pump

1.300 EX  
1.400 EX  
1 decon pad  
1 decon trailer  
1

Trucks 14 ACM  
2 Steel

6-19-03

6-20-03

- air monitoring
1. final to be performed on area by historic chimney.
  2. barrel transfer continues
  3. trees being removed by quench pond.
  4. schedule touch cleaning when results are submitted from lab
  5. misc pieces of white fibrous material fire bricks near generator setup @ small chimney

6-19-03

7) small amt of debris upon picking debris in pit foul smell was emanating. RBC told crew to leave debris as is.

8) area by gate house - finals performed. lt rain in am kept dust down. dry conditions in pm produced some dust in roadway

9) small bldg by oliver, chain link fence AST's, abandoned equip all to be removed 6-20-03  
barrel transfer to continue 6-20-03

10.)

Weather: am

pm

sun/clouds

60°

dry

wind -X

Labor: 1 operator

~~1~~ 1 laborer

1 asbestos supervisor

1 supervisor

1 AACTON air monitor

**Appendix B**

---

**Construction Daily Reports – Phase II**

6/23/04

Labor (1) Foreman

(1) Laborer

(1) Operator

Equipment

Excavator

Komatsu  
PC300LC

ONSITE

Leibherr 974 Excavator

Cat D6R

Komatsu 400 Excavator

Cat C977

Weather: AM sun, 60° . 1/2 rain

PM sun, 70° . dry

Notes: Leibherr Excavator shut down, hyd cylinder fail  
Mechanic crew on site for repair

Work consisted of excavating concrete in Area A.

Additional footers found along fence line. Stopped search  
for end of footer at 10.5 ft

Found 3 add'l piers, 6 footers @ 10ft length and  
3 add'l slabs (total 101 SF)

6/23 Measurements

Footers

- 1. 40.5' (A)
- 2. 15.0' (A)
- 3. 34 (A)
- 4. 39 (A)
- 5. 10 (A)
- 6. 60' x #6 = 360 ft (C)
- 7. 20 x 2 = 40 (C)
- 8. 19 x 2 = 38 (C)
- 9. 16 x 2 = 32 (C)
- 10. 6 x 2 = 12 (C)

Day Total = 622 LF

Slabs

- 1. 9.5' x 11 x 2 = 209 (A)
- 2. 9.5' x 11 x 2 = 209 (A)
- 3. 20' x 19 x 1 = 380 (C)
- 4. 16' x 6 x 1 = 96 (C)
- 5. 15' x 9 x 1 = 135 (C)

Day Total = 1029 SF

PIERS

3 NOT SHOWN ON DWG

4 x 4 x 6' x #3

6/24/04

Labor : 1 Foreman  
1 operator  
1 laborer

Equipment : 1 PC300LC  
1 CAT D6R

ONSITE : VOLVO ABS Truck  
Leibher 974  
Komatsu 400  
Komatsu 300  
Cat D6R  
Cat C977

Weather : AM sun, some clouds  
windy, dry  
PM sun, clouds,  
very windy, dry

Notes: excavation cont'd in Area A and Area C.  
Under area of Buck Pile #1, found many footers;  
Total found length = 430 LF  
Clean up of areas cont'd 2p-330pm to stage  
brick + concrete prior to crushing

Progress Mtg onsite Wed. June 30 10:00 AM Tentatively Scheduled.



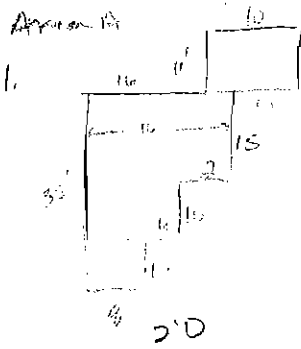

### 6/24/04 Measurements

110 sf = 220  
 240 sf 480  
 140 280  
80 160  
 570 x 3 = 3120

### Footer

1. 10 x 2 = 20
2. 11 x 2 = 22
3. 12
4. 10
5. 5
6. 28'
7. 20 x 2 = 40
8. 15 x 4 = 60
9. 4 x 3 = 12
10. 25 x 3 = 75
11. 32'
12. 23'
13. 25'
14. 15'
15. 10'
16. 12'
17. 10'
18. 8'
19. 6'

### Slab

1. 110 sf x 2 (A)
2. 240 sf x 2 (B)
3. 140 sf x 2 (C)
4. 80 sf x 2 (A)
5. 7 x 9 x 2 (K)

3546

6. 28' 97' A (P)
7. 20 x 10 = 200 sf (A)
8. 15 x 4 = 60 sf (C)
9. 4 x 3 = 12 LF (C)
10. 25 x 3 = 75 LF (C)
11. 32' (C)
12. 23' (C)
13. 25' (C)
14. 15' (C)
15. 10' (C)
16. 12' (C)
17. 10' (C)
18. 8' (C)
19. 6' (C)

20 x 10 = 200 sf  
 A = 3744 sf

7. 95 x 50 = 4750 (C)

Total = 8496

Total = 8400

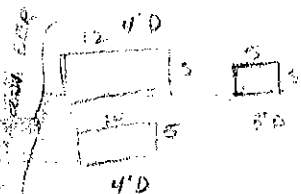

Come back to with 974 to remove

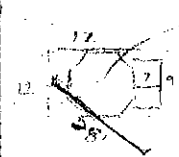

### Area C

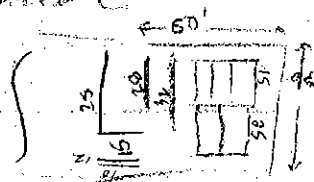

### Total To Date

Footer	Slab
1251	9435

Total 430 LF

20. 50 (C)
21. 50 (C)
22. 95 (C)
23. 1625 LF

Decided = (8400) SF  
 = (629) LF

1625 LF

6/25/04

Labor: 1 Foreman  
1 Operator  
1 Laborer

Equip: 1 PC300LC Exc.

ONSITE: Volvo A35

Leibherr 974

Komatsu 400, 300

CAT DoR, C9.77

Weather: AM - Clouds, 50%,

ground wet from overnight rain

Notes: work cont'd area C. Building c1. concrete slab (<12") removed in width 34' length 235'. Concrete piers found frequently where machinery must have sat. Concrete footer runs length under RR tracks. Concrete piers size noted for payment purposes.

6/25/04 Measurements

<u>Pier not on dwgs</u>	<u>Footers</u>	<u>Slabs</u>
1. $4 \times 5 \times 2 = 40 \text{ CF}$ <del>777</del> <del>111</del>	1. $235' \times 2 = 470'$ <sup>Extra</sup> (C)	1. $235 \times 34 =$ (C)
2. $6 \times 6 \times 5 \times \del{777} = 2340 \text{ CF}$	2. 51' (C)	total = 7990 SF
3. $12 \times 12 \times 9 = 1296 \text{ CF}$	3. 51' (C)	
= $3676 \text{ CF} = 136.1 \text{ CY}$	4. 17' (C)	
	5. 17' (C)	
1. 48 cy	6. 23' (C)	
86.66	7. 34' (C)	
48 cy	8. 34' (C)	
<u>136.14 cy</u>	9. 34' (C)	
	total = 731 LF	

Total To Date

<u>Footer</u>	<u>Slab</u>	<u>Piers</u>
1982 LF	17425 SF	146.8 CY

JUNE 28, 2004

Labor:

3 Operators  
1 Laborer  
1 Foreman

Equip:

3 Komatsu 300 Excavators:  
1 "Munching"  
1 Hammer  
1 Bucket  
D6 DOZER

WEATHER:

AM - 1/2 rain, clouds, 60°, around dig  
PM - 1/2 rain, clouds, 60°, ground

Notes: 3 machines out on west side of site. 1 Exc hammering concrete into smaller pieces. 1 Exc with "muncher" breaking up concrete. 1 Exc with bucket working on concrete slab in bldg C1 area of S1 LF, 235 LF. Dozer run over area A + area C to pile up concrete prior to staging material.

In Area C, Bldg C1, west side near foundation wall, stronger odor of oils found upon removing concrete slab. Odor is similar to the odors prevalent on-site. No discoloration of soil was apparent.

1/2/04

6/23/04 : Measurements

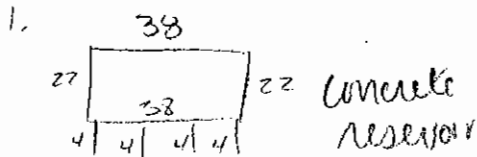

Footers:

- 1.  $38 \times 2 = 76$  <sup>c</sup> CONC RESERVOIR
- 2.  $22 \times 2 = 44$  <sup>c</sup> CONC RESERVOIR
- 3.  $4 \times 4 = 16$  <sup>c</sup> CONC RESERVOIR
- 4.

Slabs

- 5. 5' footer in mid (C)
- 6.  $12 \times 2 = 24$  (C)
- 7.  $0 \times 2 = 12$  (C)
- 8. 5' footer in mid (C)
- 9. 13'
- 10. 13'
- 11. 8'

TOTAL = 308 LF

Footers

Total to date = 2290 LF

Piers:

- 1.  $9 \times 7 \times 2 = 126$  CF
- 2.  $27 \times 10 \times 6 = 1620$  CF
- 3.  $10 \times 10 \times 6 = 600$  CF
- 4.  $4 \times 4 \times 6 \times 3 = 288$  CF

from 6/23/04 →

Total = 10 3138 CF

116.2 CY

Slabs

Total to date = 17,425 SF

Piers

Total to date = 243 CY

June 29, 2004

Labor:

1 Foreman  
3 Operators  
1 Laborer

Equipment

3 - Komatsu 300 Excavators:  
1 hammer, 1 bucket  
1 munch

Weather: AM - sun, 65°, ground dry,

PM - sun, pt cloudy, 75°, ground dry.

Notes:

Work cont'd in area c bldg c1. Western side of bldg c1 concrete pad excavated. Footer uncovered that runs length of pad. Large piers uncovered along length of footer. Pier dimensions + number noted. Breakup of concrete piers cont'd in work areas to downsize prior to crushing.

6/29/04 Measurements

Footers

1. 235' (C1)

Total = 235 LF

Slabs

1. 38x22 = 836 SF (C1)

2. 35x31 = 1198 SF (C1)

Total = 2034 SF

Piers

1. 8x3x3 = 72 CF ✓

2. 7x4x3 = 84 CF ✓

3. 7x4x3 = 84 ✓

4. 4x3x3 = 36 ✓

5. 9x3x3 = 81 ✓

6. 12x8x2 = 192 ✓

7. 20x10x3 = 600 ✓

8. 10x8x2 = 160 ✓

9. 9x6x4 = 216 ✓

10. 16x8x3 = 384 ✓

11. 6x3x3 = 54 ✓

12. 6x3x3 = 54 ✓

13. 8x4x2 = 64 ✓

14. 6x3x3 = 54 ✓

15. 4x4x2 = 32 ✓

16. 5x5x4 = 100 ✓

17. 12x10x3 = 360 ✓

18. 6x3x3 = 54 ✓

19. 5x4x4 = 80 ✓

20. 3x3x2 = 18 ✓

21. 9x4x3 = 108 ✓

22. 6x3x3 = 54 ✓

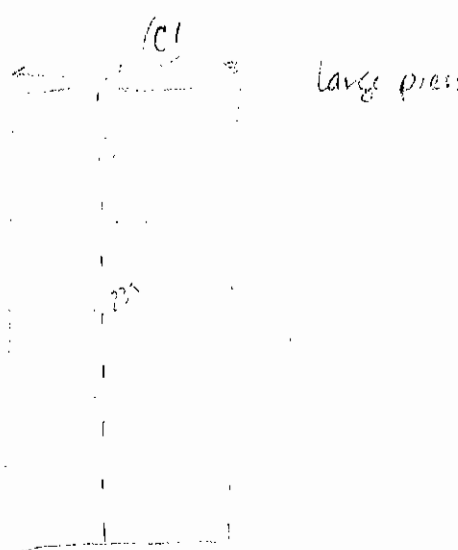

6/29/04

Area 3

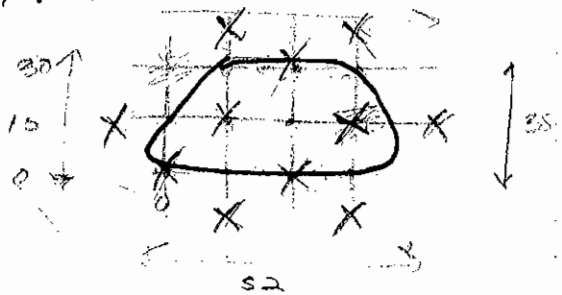

$\geq 10$  PCB  
= 2 TCLP (10 grab)  
15x15' GRID = 11

Area 4

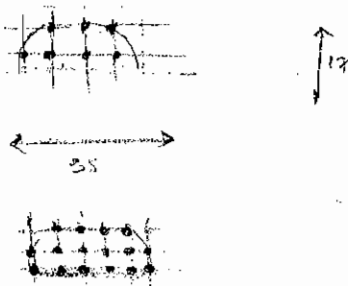

1 TCLP = 5  
8x8' GRID = 16  
10x10 GRID = 7

35x35 = 24 samp  
50x50 = 10 samp

100%  
TCLP

15x15 = 11 samp  
Area 2

25x25 = 20 samp

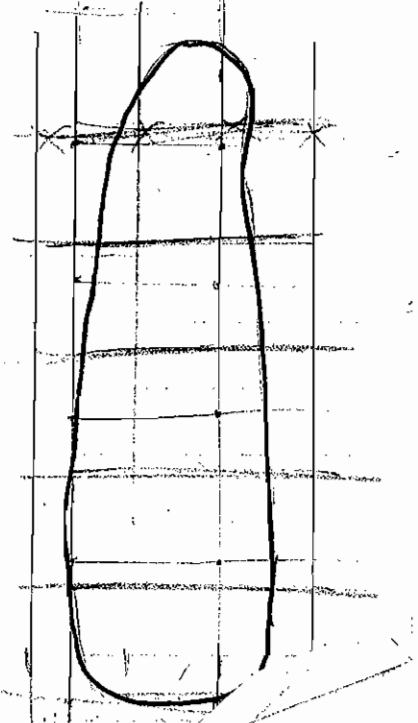
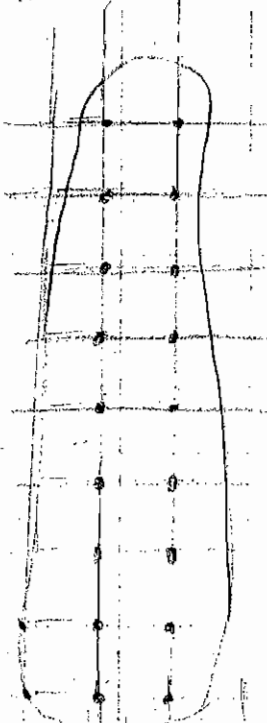
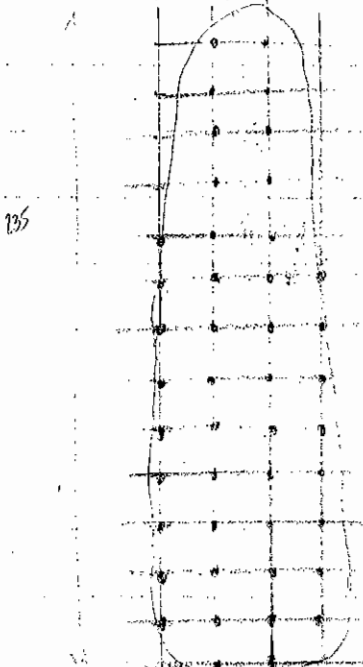



4/29/04 area 2

16 samples

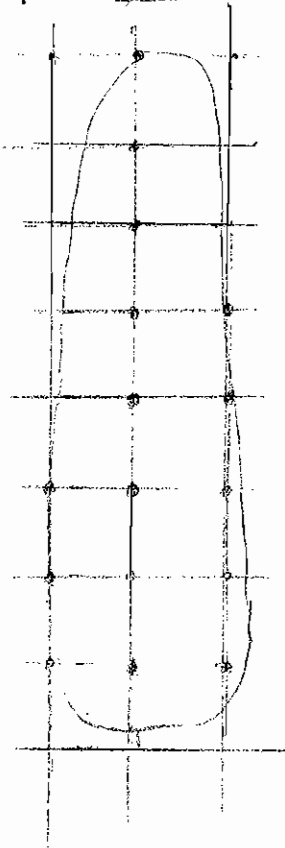

AREA #2

30 X 30 GRID = 5

25 X 25 GRID = 7 Dump

15 X 15 GRID = 12 Dam

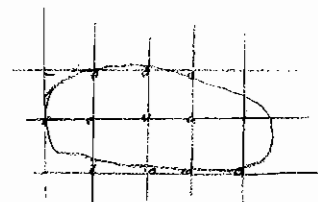
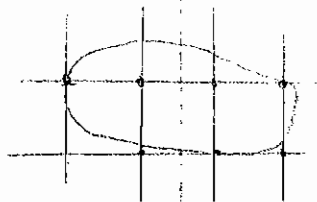
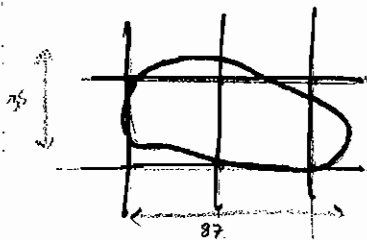

6/29/04

Area #6

15x15 GRID - 5 samples

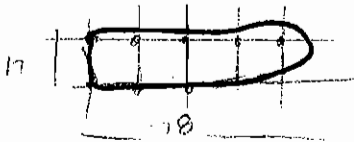

Area 5

10x10 GRID = 6 samples

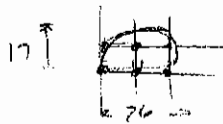

Area #1: 30x30 GRID - 14 samples  
15x30 GRID - 13 samples

15' x 60' GRID - 15 samples

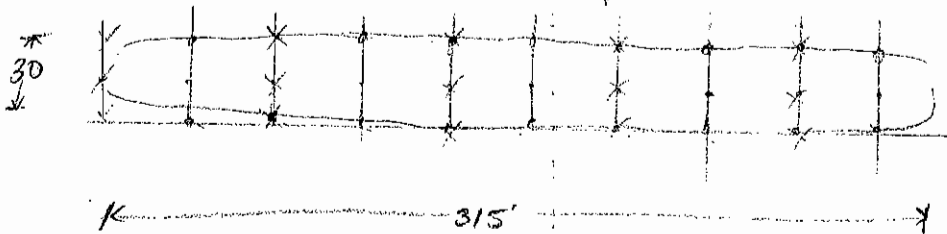

6/29/04

Piers

23.  $20 \times 12 \times 5 = 1200$  ✓

24.  $1.5 \times 3 \times 2 = 9$  ✓

25.  $6 \times 3 \times 3 = 27$  ✓

total = 156.13 cy

Total To Date:

Footer

2525 LF

Slabs

30,246 SF

Piers

343 CY

6/30/04

002  
0929

Labor.

- 3 Operators
- 1 Foreman
- 1 Laborer
- 1 Driver

Equip.

- 3 Komatsu 300 Exc.
- 2 Buckets, Hammer,
- 1 Dozer Cat D6
- 1 Volvo Dump

Weather: AM - sun, warm, 65°, ground dry

PM - sun, warm, 75°, ground dry

Visitors - Fran Barone, Bill Eichhorn, Dave Moziarz, Dale Marshall

Work: cont'd in area C clearing concrete to crushing staging area. Hammer cont'd to downsize concrete to crushing size. Concrete pieces near South side of Armstrong Pumps broken down to smaller pieces with hammer.

Started work in area A near the edge of Area B called III on dwgs. on the concrete footers near Quid. The footers are topped with a concrete slab not shown on the drawings. Work is being done to clear concrete debris from surface to determine extent of concrete slab and footers.

Work end 330p

4/30/04 Measurements

Footer	Slabs	Flags	
1. 5'	47	1. 3x3x4 23: 4x2x2	
2. 10'		2. 10x6x1	
3. 10'		3. 6x3x3	
4. 10'		4. 10x6x1	
5. 10'		5. 6x1x3	
6. 10'		6. 14x8x2	
7. 10'		1. 47x57 = 2679	7. 5x5x3
8. 10'	2. 30x17 = 612	8. 4x4x2	
9. 10'	Total = 3291	9. 5x4x2	
10. 10'		10. 12x5x2	
11. 10'		11. 10x4x3	
12. 10'		12. 8x5x3	
13. 10'		13. 4x6x3	
14. 25'		1. 7x5x1 10. 4x5x3	14. 7x6x3
15. 25'		2. 7x5x3 11. 12x5x2	15. 4x5x3
16. 15'		3. 6x3x3 12. 4x4x4	16. 6x8x2
17. 15'		4. 4x2x2 13. 4x4x2	17. 7x5x2
18. 47'		5. 11x2x2 14. 3x3x3	18. 7x3x2
19. 61'		6. 3x3x2	19. 7x5x2
Total: 349		7. 3x4x3	20. 10x5x3
(355)		8. 3x2x2	21. 8x5x2
		9. 6x1x3	22. 6x3x3

7/1/04

Labor

1 foreman

3 operators

1 laborer

1 driver

Equip

3 Komatsu Exc 1 hammer  
2 bucket

1 CAT D6 DOZER

1 Volvo Truck

Weather: AM sun, pls cloudy, 70°, dry ground  
some dust w/ traffic on dirt roads

PM

Visitors - Bill Eichbaum, Cal - Contractor for water line

Work - Cont'd on area A in area called III  
on dump. Excavator removing debris from

top + sides of slab to uncover footers + slab.

Excavator then started removing footers.

G.C. & RBC decided to take out of all  
footers + the concrete slab w/ no additional  
under slab footers unless the size and quantity  
is too great.

- Work was done in area E moving large conc  
debris to staging area.

- Work in area III cont'd until 330 and was  
not finished. need 2<sup>nd</sup> day. additional footers  
added to quantity for day from w/in area III.

7/1/04 Measurements

Footers

- 1. 665 LF <sup>area III</sup>
- 2. 70 <sup>area III</sup>
- 70 <sup>area III</sup>
- 85 <sup>area III</sup>
- Total 890 LF

Slabs

- 1. 253 x 75 = 18,975
- Total = 18,975 SF

Piers

- 1. 7 x 5 x 2
- 2. 7 x 5 x 3
- 3. 6 x 3 x 3
- 4. 4 x 2 x 2
- 5. 11 x 2 x 2
- 6. 3 x 3 x 2
- 7. 3 x 4 x 3
- 8. 3 x 2 x 2
- 9. 6 x 4 x 3
- 10. 4 x 5 x 3
- 11. 12 x 5 x 2

Total To Date

<u>Footer</u>	<u>Slab</u>	<u>Pier</u>
3,704	52,512	476.0

Total = 607.5 CF  
 = 22.5 CY  
 (18,975) CF

7/2/04

Labor. 4 Operators  
1 Driver  
1 Laborer  
1 Foreman

Equip - 4 Komatsu 300 Exc.  
1 CAT D6 Dozer  
1 Volvo Dump

Weather: AM - sun, 70°, NO clouds, dry  
PM -

Work - Excavating slabs: footers cont'd in area III  
Break up of concrete cont'd in area III. Concrete  
hauled to staging area for crushing.

excavator removing footers (outside walls) from  
Bldg C1 in area C.

Concrete pad debris started in Area D with  
former bldg "D1" Pad removed to expose two  
steel trenches possibly used to store oils.

Discolored soil and heavy oil smell found near  
trenches. RBC instructed GC to leave trenches  
as is, soils may be removed as impacted.



7/2/04 Measurements

<u>Footers</u>	<u>Slabs</u>	<u>Piers</u>
1. 235' (C1)	1. 208x65 (D1)	1. 11 (5x5x4)
Total = 235 LF	Total = 13,520 SF	2. (5x5x2)
		3. 5x4 x 2
		4. 4x4x2
		5. 4x4x2
		Total = 46.4 cy
		1252.8 CF

Total To Date

<u>Footer</u>	<u>Slab</u>	<u>Pier</u>
3999 LF	66,032 SF	522.4

7/6/04

Labor: 5 Operator  
2 Laborer  
1 Foreman

Equipment:  
4 Komatsu 300 Exc.  
1 Volvo Dump

Visitors - Leon K. - Fire Marshall (MT)

Weather: AM - sun, clouds, 60°, ground wet from  
previous rains

PM - sun, pt. clouds, 75°

Notes: Work cont'd on slab in area D  
(bldg D1). Additional 100' length by 100' width  
of slab removed. Trenches removed from  
length of slab. Concrete footer beneath ~~the~~  
trenches removed. 2 areas of trenches had  
wet, darker material than surrounding soils.  
1 Area - SW corner of slab, 2 Area - NE corner  
Metal separated from concrete for cleaning  
& salvage. Material loaded out from area III  
200  
212 to concrete stage area.

7/6/04 Measurement

FOOTER  
 1. 308' (DI)  
 2. 308' (DI)  
 3. 15 Extra DI  
 4. 15  
 5. 19  
 6. 19  
 Total = 684 LF

SLABS  
 1. 100' x 100' = (DI)  
 Total = 10,000 SF

PIERS

1. 8x6x4	12. 12x4 x3
2. 3x4x3	23. 4x4x5
3. 4x3x3	
4. 4x2x3	
5. 8x6x4	
6. 10x3x3	
7. 8x4x3	
8. 10x6x3	
9. 6x3x2	
10. 12x6x4	
11. 8x6x6	
12. 5x4x3	
13. 3x3x3	
14. 3x3x3	
15. 3x3x3	
16. 10x8x4	
17. 13x17x4	
18. 3x3x2	
19. 8x8x2	
20. 6x6x5	
21. 10x8x6	
Total = 138.4 (141.87)	

Total To Date  
Footer     Slab     Pier  
 4683 LF     76032 SF     660.8

7/7/04

Labor: 1 Foreman  
5 Operator  
2 Laborer

Equip: 5 Komatsu 300 Exc  
1 Volvo Dump  
1 Trash Pump  
Not Used Leihbrn 974

Weather - AM - sun, warm 70°

PM - sun/pt cloudy, hot, humid 75°

Lt rain 2 pm

Visitors - Fran Barone, Cambria Cont

Work - Area C, Bldg "C2" removing footer from outside walls near brick pile. Cleanup of debris for staging in weather. Cleanup of concrete debris from area D, "D1" - break up of concrete pieces, staging to crushing pile.

De-watered trench in area D to remove water prior to removal of remaining 2 footer walls. Water dispersed across site on grassy area. Found 6" pipe near remains of historical chimney. Pipe is flowing full w/ oil substance. GC capped + backfilled pipe until decision made on contents. Contents will be sent out as sludge and GC to chase pipe back to source.

Work -

City wastewater Dept ok'd disposal of <sup>approved</sup> surface water to east avenue sewer only. Dye test not necessary for East Ave sewer.

Leibherr 974 should be repaired on 7/7

City NT Water Dept met @ 10AM to discuss cut + cap. Determined all cuts are not on main lines and city personnel does not need to be present during procedure. City needs a phone call alerting water dept in the morning before cuts are made. 695-8537 "Edgy" Three locations found for valves to shut off lines.

7/7/04

7/7/07 Measurements

Footer	Slab	Piers
1. 178 D	1. $40 \times 275 = 9000$	1. $8 \times 1 \times 8$
2. 178 D	2. <u><math>40 \times 10 = 400</math></u>	2. $6 \times 1 \times 2$
3. 70	Total 9400	3. $12 \times 6 \times 5$
4. 225 C1		4. —
5. 6		5. $6 \times 6 \times 4$
6. 6		6. $12 \times 4 \times 2$
7. 12		7. $11 \times 4 \times 2$
8. 125 D1		8. <u><math>12 \times 8 \times 4</math></u>
9. 90		total = 38.2 cy
10. 60		
11. 66		
12. 125		
13. 40 (C2)		
14. 40 (C2)		
Total = 1054 LF		

Total To Date

Footer	Slab	Pier
5,737 LF	85,432 SF	699.0

7/8/04

LABOR:

5 OPERATORS

1 FOREMAN

1 LABORER

1 DRIVER

TANK TRUCK

OFFSITE REMOVAL

(1) DOZER

EQUIPMENT: (11X USE)

(3) EXCAVATORS - KOMATSU

PC 300LC

(1) SITE TANDUM - UCCO

(1) EXCAVATOR w/ DEMO CLAW

WEATHER: 7:00 AM; OVERCAST, ± 70°F, Ground Damp

9:00 AM, OVERCAST, ± 72°F, Ground Damp

2:00 PM, OVERCAST ± 72°F, LT RAIN

DELIVERY: New Fuel Tank

Work:

ON-SITE: D.E.C. (WORK TRAIL)  
ADMIN SUPPLY

- 1) Removal of Foundation Walls AREA "D", Removal of Stackpiled Site Debris to Tandums AREA "D", 3<sup>rd</sup> EXCAVATOR Stackpiled Debris AREA "D"
- 2) Removal of Dumped Debris from ON-SITE Tandum to OFFSITE LOCATION (STEEL-DEBRIS) Stackpiled Southwest Corner of Area "A"
- 3) HIGH Groundwater Table Encountered During Excavation of Pictorial in Area "D", Excavation Stopped until Ground Water can be removed. All excavators worked on removal of site debris stockpiles. Two (1) METAL PIPES ± 6" Ø ~~broken~~ broken, Excavation Filled with Water from pipes.

4) Directed Contractor To Break Full Excavation.  
 WATER EXTRACTED FASTER THAN CAN BE PUMPED OUT.  
 EXISTING CONCRETE BELOW 5'-0" GRADE DEPTH,  
 CONCRETE LEFT IN PLACE  
 \* WATER REMOVED FROM EXCAVATION PUMP TO  
 SURFACE GRADE LEVEL.

- PUMPS STOPPED, WATER WILL BE REMOVED  
 ONCE QUINCY POND IS FULL.  
 - STRONG ODOUR FROM EXCAVATION, OILY SUBSTANCES  
 IN WATER & BLACK SOIL CONDITIONS

- 5) DEBRIS REMOVAL FROM AREA "C"
- 6) MAINTENANCE / MOVEMENT TO REPAIR HOIST MECHANISM

TIME: START → 1:16 @ 2750 GMS  
 FINISH → 3:20 @ 15500 GMS > 12750  
 MOTOR @ 2750 GMS

DRIF - 695-8560

7) PUGH GRADING NORTH & EAST SIDE OF  
 AREA "A"



7/9/04

Impacted Soil Test Locations

Area 4-

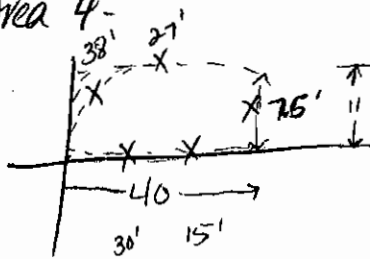

5 Grab samples 9AM

Karl Limman  
Millhurst Const.

Area #6

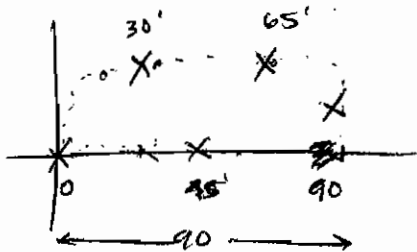

45 X

5 GRAB samples 950 AM

Area 2B

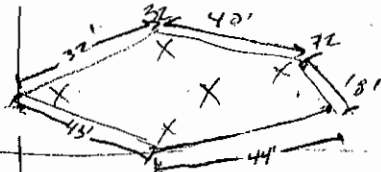

area 2A 7/9/04

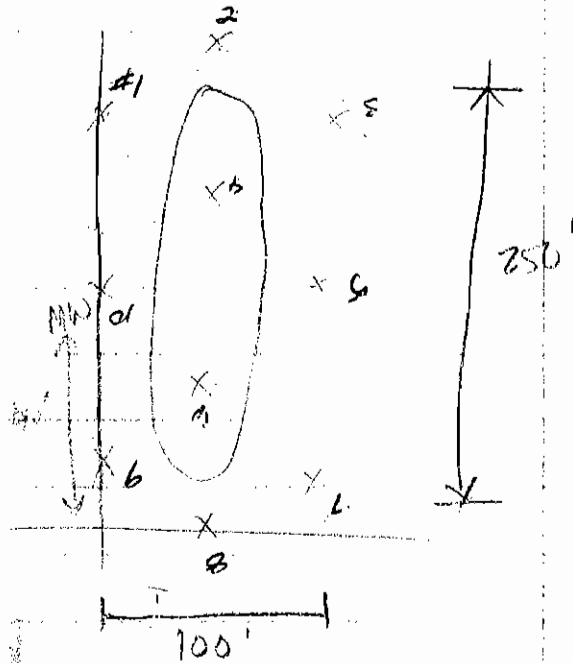

1 TCLP - 5 grab

7/9/04

Footers

Slabs

Piers

- 1. 38' (A) extra
- 2. 170 (D) - guess what was used to delineate the piers on footer was on dug?
- 3. 174 (E)

Total = 382 LF

Total Water = 40,000 gal

To Tal To Date

Footer

Slab

Pier

6119 LF

85,432 SF

699.0

7/12/04

Labor: 1 Foreman  
5 Operators  
2 Laborer

Equip: 1-D6 Dozer  
4 Komatsu Exc  
1-Leibherr Exc

Weather: AM - Mostly cldy, Lt rain 12NOON 70°  
PM - partly sun/cldy, hot/humid 80°

Visitors - Waterline cap crew onsite 8AM - 500 PM

Work - removed 2 cut/cap from project per DER  
Annoyng pumps hydrant is being removed.  
cut/cap to pave hydrant not necessary.  
cut/cap complete for NW line and line  
near East Ave. Cut/cap scheduled w/ City NT  
for wed 7/21 for the line near 9th Ave.  
Area C footers and slab being removed from  
area where Leibherr excavator sat. More piers  
found under slab. large pier found under former  
water tank. Footers removed from area D that  
were being impacted by hydrant.

- quench pond discharge start 05500, end 160500  
total discharge 105,000 gal.

7/12/04 MEASUREMENTS

<u>Footers</u>	<u>Slabs</u>	<u>Piers</u>
1. 175 (A)	1. 10x18=180 (C)	1. 7x3x3
2. 10	2. 10x18=180 (C)	2. 4x3x3
3. 10	3. 150x9x2 (C) = 13,500	3. 6x3x3
4. 18	4. 45x25 (C) = 1125	4. 7x3x3
5. 18	5. 20x15 (C) = 300	5. 9x5x3
6. 10x20 near piers	Total = 15,285 SF	6. 4x4x3
7. 8 near piers	(15,185) SF	7. 9x4x3
8. 8 near piers		8. 10x6x3
9. 175 (C)		9. 7x4x3
10. 30		10. 15x6x3
11. 20	Surface Water	11. 7x3x3
12. 15	Start: 55,500	12. 10x10x3
13. 20	End: 160,500	13. 10x10x3
14. 25	total = 105,000	14. 5x5x17
15. 45		15. 5x5x17
16. 10		Total = 97.7 cy
17. 10		
18. 17	Total To Date	
19. 17 (C)	<u>Footer</u>	<u>Slab</u>
Total = 651 LF	6,770	100717 SF
		796.7 cy

7/13/04

Labor: 1 Foreman  
5 Operators  
2 Laborers

Equip: 5 Komatsu 300 Exc  
1 Leihberr 974 Exc  
1 Volvo Dump  
1 D6 Dozer

Visitors: City NT Water Dept, "Edgy"

Weather - AM dense fog, humid, 70°, misty rain  
- PM cloudy, humid, 80°, no precip

Work: Area C, removal of footers, and buried foundations in <sup>Bldg C1</sup> Area C. Area D, Bldg D1 Western edge of slab, large <sup>footer</sup> ~~debris~~ excavated from below grade.

- Area C - concrete being removed to staging area all day. 1-Exc w/hammer downsizing mat'l. 1-Exc loading dump.
- Quench Pond water disposal. Start 160500 gal.

7/13/04 Measurements

Footers

Slabs

Piers

1. 57

0

1. 8x8x3

2. 27

2. 7x5x3

3. 150

3. 5x5x3

Total = 234 LF

4. 6x6x8

5. 6x6x8

Total = 35.1 cy

Water:

Start: 160,500 gal

End: 270,500 gal

Total: 110,000 gal

Total to date = 267,750 gal

Total To Date

Footer

Slab

Pier

7004

100717

831.8

7/14/04

78-85

<u>Labor</u>	5 operators	<u>Equip</u>	5 Komatsu 360 Exc.
	2 Laborers		1 - Liebherr 974 Exc
	1 Foreman		1 - CAT D6 DOZER
			1 - Volvo A35 Dump
			1 - Pump

Weather AM - RAIN, CLOUDS, 68°, GROUND = WET,

Visitors - NYSDEC - J. TOL, J. Kinsella, DFR, NY - D. MAZIAREZ,

CAMBRID - B. FICHARDEN, F. BARONE

Work: Water Pumping

start 270 500 gal

END 296 700 gal

total 26200 gal

Work: - area C bldg C2 excavation of pad  
concret. footers removed on east 1/2 north  
side of ~~footprint~~. 1/2 of slab + footers removed.  
concrete placed on second 1/2 of slab prior to  
slaging. ~~The~~ slab near pile. continues  
to the east into area D. The slabs were connected  
There also was odd 1/2 footers found to east  
of footer wall in vegetation area. was a former  
part of the bldg prior to demo last year → ~~trails~~



work - add'l footers also uncovered near  
SLD 6. Payment for these footers not  
taken 7/14.

- clean up of area C cont'd with  
downsizing concrete and hauling to  
staging area.

7/24/04 Measurements

Footers		Slab	Piers
1. 420	(10) 15		1) 6x5x3
2. 70	(11) 17	1) 30x20 = 600 SF	2) 5x4x3
3. 40	(12) 17	2) 420x105 = 44100 SF	3) 7x5x3
4. 123	(13) 25	Total = 44700 SF	4) 5x11x3
5. 263	(14) 25	Water = 270506 gal	5) 8x3x3
6. 15	(15) 90	= 298700 gal	Total = 18.2 CY
7. 15	(16) 30	26,200 gal	
8. 20	(17) 30		
9. 20	(18) 20		

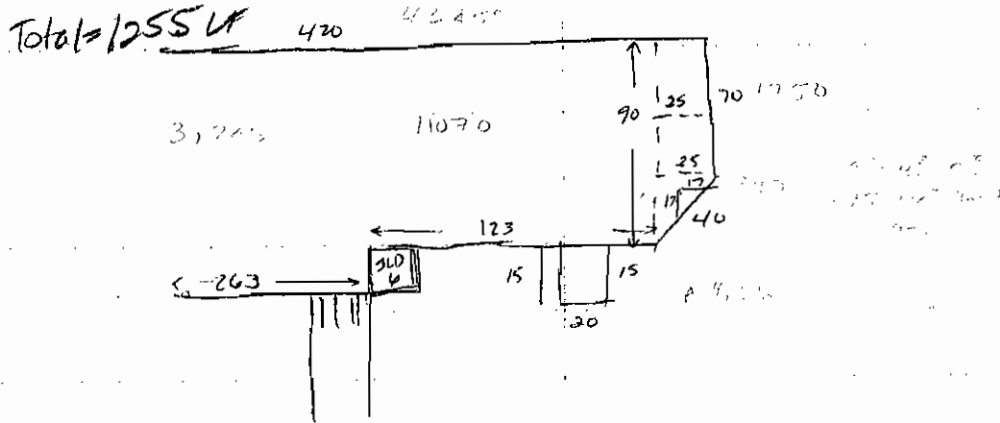

Total To date  
 Footer 8259  
 Slab 145417 SF  
 Pier 850.0

7/15/04

Labor: 1 Foreman  
2 Laborers  
5 Operators

Equip: 4 Komatsu 500 Exc  
1 Liebherr 97f Exc  
1 CAT D6 DOZER  
1 Volvo A25 Dump  
1 Pump

Weather: AM - cloudy, 65°, ground partially wet,  
PM

Work - work started in Area C to continue cleanup  
downsizing of concrete, hauling of concrete to  
staging area. Work/cleanup in Area C Bldg C1, C2

7/15/04 Measurements

<u>Footers</u>	<u>Slab</u>	<u>Piers</u>
1. 25		
2. 25	1. none	1. 12x6x3
3. 45		2. 12x6x3
4. 10	* deduct 530 SF	3. 6x4x3
Total = 105 LF	from future quantity	4. 6x14x5
	of slab	5. 12x10x5
		6. 7x5x6
		7. 15x8x8
		Total = 99.8 cy

Area  
C

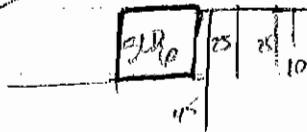

Total To Date

<u>Footer</u>	<u>Slab</u>	<u>Pier</u>
9364 LF	145412 SF	949.8 cy

Water - Start - 296,700

End - 335,700

total - 37,000

to date = 330,950 gpd

7/16/04

Labor: 1 Foreman  
2 Laborer  
5 Operator

Equip. 1 Liebherr 974  
4 Komatsu Exc  
1 Volvo Dump  
1 CAT DU DOZER

Work - Removing 150'x60' pad in Area D South of  
Armstrong + west of concrete ramp. Maintained  
20 ft distance to Armstrong Pumps. Need to ask  
City what do about edge of concrete - sawcut  
to look better? Leave broken off?

concrete pad extends all the way to Armstrong  
building, not shown on plans

2x 77 pages 1 pit sample

7/16/04

<u>Footer</u>	<u>Slab</u>	<u>Piers</u>
1. 35	1. 195 x 60 (12,300)	3x5x3
2. 30	total = 11,700 SF	4x6x5
3. 30	To date = 157,117 SF	Total = 6.1 CY
4. 60	* deduct 530 SF from future quantity	To date = 955.9 CY
Total = 155 LF		
To date = 8519 LF		

Water Start: 288,300  
 End: 343,700  
 total 1,000 gal

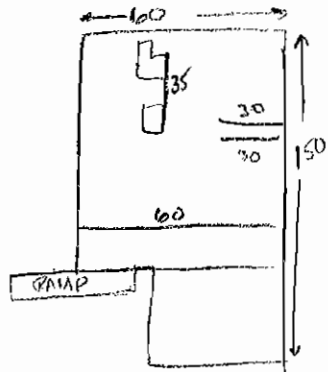

7/16/04

7/19/04

Labor: 1 Foreman  
2 Laborer  
4 Operators

Equip: 1 Pump  
1- Lechbeer 974  
3- Komatsu 300  
1- Cat D6 Dozer  
1- Volvo A35 Dump  
1 Komatsu 300 Exc

Weather: AM: clouds, 60°  
ground wet from  
overnite rain  
12N sun/clouds, 70°

Visitors: Cambria mechanic, DER (SIN)

Work: Cont'd in Area C downsizing concrete and  
hauling to staging pile.

Concrete pad removal in Area D Bldg D2 near ramp

Found underground pit area 30'x15' that is  
holding 3" of water that's very "iron" colored.

Not to be sampled. Pull footer as is.

Area uncovered approx 200x80. Found addtl footers  
and 6 addtl piers. Area south of ramp w/ steel  
tracks uncovered. 12 addtl footers excavated that  
ran E-W from pad.

Quench pond draining cont'd. Process slower  
due to low water level. Small sediment being pumped  
as level decreases. GC to keep working as is.

7/19/04

<u>Footer</u>				<u>Slab</u>	<u>Pier</u>	
1.	4	(8) 50	(15) 102	(21) 6x2	(1) 90x37	(1) 5x4x3
2.	11	(9) 37	(16) 27	(25) 10	(2) 115x32	(2) 5x4x3
3.	11	(10) 37	(17) 27	(27) 8x1	(3) 105x27	(3) 5x4x3
4.	11	(11) 8	(18) 27	(24) 5x2	Total=98455 SF	(4) 5x4x3
5.	5	(12) 7	(19) 105	(25) 20x2		(5) 5x4x3
6.	19	(13) 39	(20) 105	Total=830 LF		(6) 9x4x3
7.	50	(14) 39		(734) LF		

Area D:

Total = 15.1 CY  
(14.1)

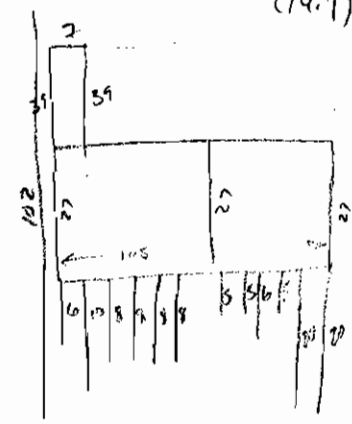
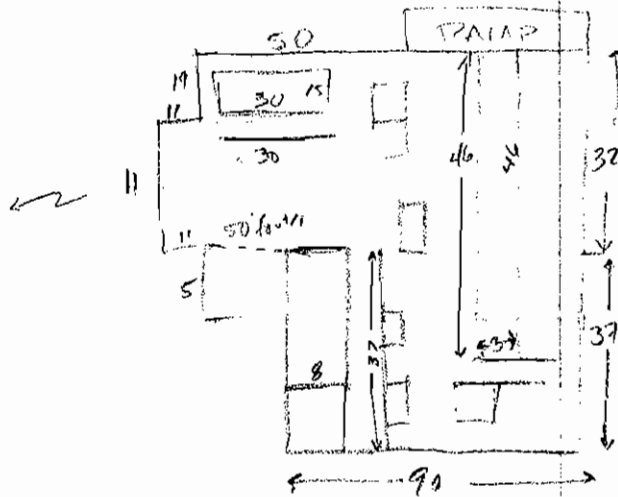

Water S. 343,700 gal  
 F. 373,700 gal  
 total 30000 gal

To Date:  
Footer = Slab  
 9349 LF      166,962 SF  
 Pier = 970 CY



7/20/04

Labor: 1 Foreman  
4 Operators  
2 Laborers

Equip: 1 Liebherr 974  
2 Komatsu 300 Exc  
1 Volvo A55 1/2 Dump Truck  
1 Pump

Weather:  
AM Sun. haze, 70°

Not Used CAT DL Dozer  
1 Komatsu 300 Exc

Visitors: DER (SRW)

Work - area C+D downsizing concrete pieces and hauling to staging pile. Work continued in area D near concrete ramp. removed ramp (not solid).

Worked cont'd to south of concrete ramp removed tank saddles and small pads up to the point of impact area 2B.

Not many under slab piers found.

-quench pond pumping cont'd. harder to pump as levels decrease.

7/21/04

Labor 1 Foreman	Equip 1 Liebherr 974
2 Laborer	4 Komatsu 300
4 Operator	1 Dump, 1 Volvo A35
	1 CAT D6 Dozer
	1 Pump

Weather: AM - sun/clouds, 70°, haze

dry

PM - sun, 85° dry, humid, haze

Visitors - Watuline Cap Crew, NT Water Dept  
Cambria Mechanic, Jim Tuk NYSOEC

Work -

Watuline capped on south end of site.  
Shutdown service 8-10am. No problems  
reported by residents.

clean up, downsize and hauling from area  
C+D to staging area.

Water pumping from quench pond.  
SW1 mistakenly taken for area east of  
quench pond. 500 gal pumped to sewer.  
SW1 + SW2 will be pumped 7/27.

The area pumped was from a pit dug in 2003

and which filled from quench pond water.

- area B slab worked on near trailers not too much footers/peers found as an extra.
- one load scrap metal removed off site
- set up perimeters of area 1, 3, 5 for impacted soils. set to sample 7/22.
- one additional 80' footer found in area C when grading area.

7/21/04

Footer

Slab

Pier

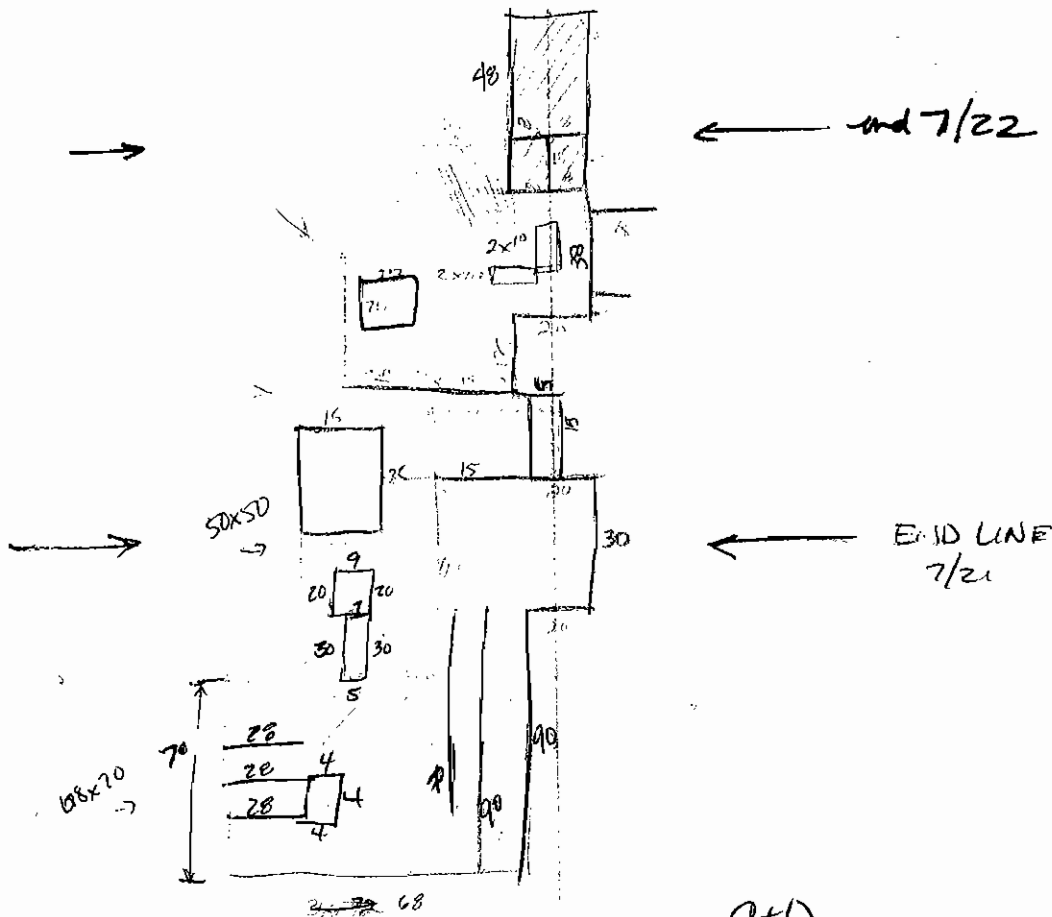

C+D  
 total = 21.0 tons  
 To Date = 21 tons

Footer:

- 1. 68 (7) 28 (13) 20
- 2. 70 (5) 4 (14) 30
- 3. 90 (9) 4 (15) 30
- 4. 90 (10) 4 (16) 9
- 5. 28 (11) 4 (17) 7
- 6. 28 (12) 20 (18) 5

Slab:

- 1. 68x70 = 4760
- 2. 50x50 = 2500
- Total = 7260
- To Date = 178,832 SF

Pier

—  
 To Date = 970.04

Water = 393,700

end = 409,700

(SLT) total = 16,000 gal

Total = 539 LF total to date = 112,000 gal

7/21/04

Area 1

area seems smaller  
much vegetation growing  
thru area.

length 175 ft  
width at widest 53 ft

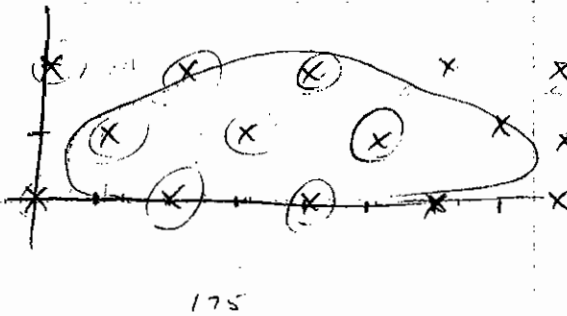

Area #3 GRID

area smaller . 35'x35'  
also north side is on  
concrete pad.

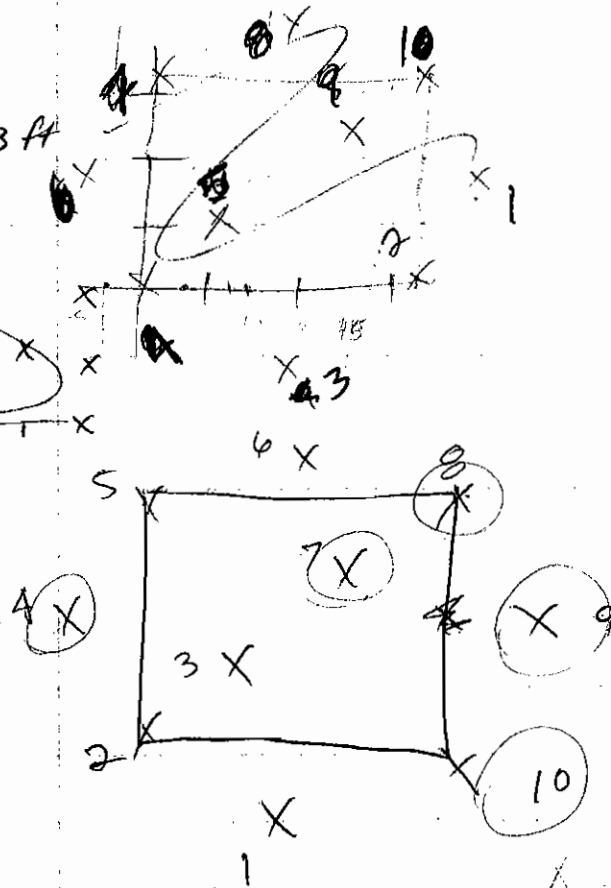

7/22/04

Labor: 1 Foreman	Equip: 1 Liebherr 974
4 Operator	4 Komatsu 300
2 Laborer	1 Volvo A35
	1 Pump
	1 Dump Truck

Work: - cont'd in area B near field trailers removing pad + footers.

- area C + D cont'd cleanup and staging to crushing area.
- quench pond - stopped pumping per RBC at 980 gal today. We are at 414,750 gal pumped total. I instructed contractor to start letting sludge dry and to stop pumping. Cambria decided to keep pumping (not for payment) to make it easier to remove sludge from pond.

Cont'd

- 1 load C+D material hauled from site  
to BFI Niagara Falls  
total weight 20.99 tons

4/22/04

Area 5  
5 dampers

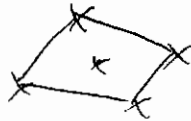

Slab

20x25 = 500  
30x15 = 300  
Total 800 SF

Footer

~~Slab~~

Pier Piers -

- 1. 8 (6) 15 (11) 15 (16) 15 (21) 25 (26) 15
- 2. 8 (7) 20 (12) 15 (17) 15 (22) 15 Total = 421 LF
- 3. 8 (8) 5 (13) 12 (18) 20 (23) 15
- 4. 8 (9) 38 (14) 5 (19) 30 (24) 15
- 5. 15 (10) 30 (15) 15 (20) 25 (25) 20

none

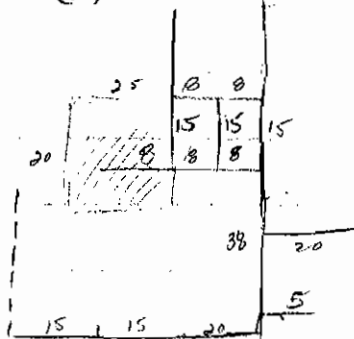

← end 7/22

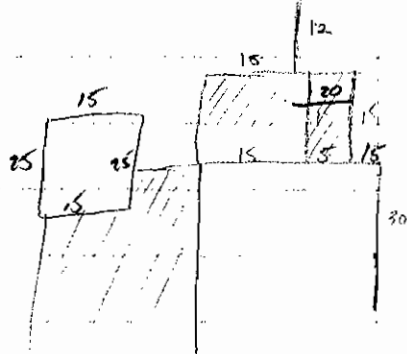

← end 7/21

Total To date =

Water Start: 409,700 gal

Footer 10838 LF  
Slab 174,332 SF  
Pier 970 CY

End 419,500 gal  
Total = 9800 gal



7/23/04

Labor: 1 Foreman  
4 Operators  
2 Laborers

Equip: 1 Liebherr 974

4 Komatsu 300

1 Volvo A35

1 Dump Truck

1 Cat D6 Dozer

1 Pump (2")

Weather: AM - cloudy, 60-75°  
no precip.

PM - cloudy, 70°

Work-

- area B (near trailers) measured out up to area of sludge on concrete. work cont'd to remove slabs + footers. Downsizing of concrete debris also started in area.
- work cont'd in area D to haul concrete to staging area.
- quench pond cont'd pumping to remove water (not at NT cost)
- delivery of sludge bed 40 mil liner
-

7/23/04

Footers:

- 1. 34 (11) 8
- 2. 24 (12) 8
- 3. 40 (13) 36
- 4. 4 (14) 19
- 5. 16 (15) 24
- 6. 16 (16) 20
- 7. 18 (17) 20
- 8) 65 (18) 2
- 9) 65 (19) 18
- 10) 20 (20) 34
- (21) 20
- (22) 2
- (23) 20
- (24) 20
- (25) 20
- (26) 20

total = 593 LF  
(1013)

Slab =

$34 \times 24 = 816$   
 $20 \times 40 = 800$   
 $8 \times 16 = 128$

$20 \times 65 = 1300$   
 $24 \times 36 = 864$   
total = 3908

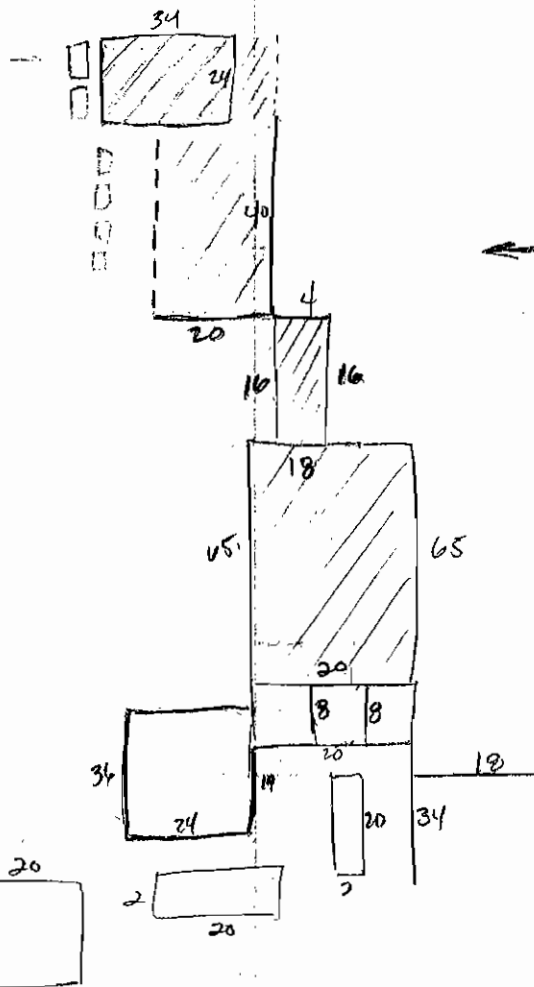

- 7/26/04

Labor: 1 Foreman  
4 Operators  
2 Laborers

Equip = 1 Liebherr 974  
4 Komatsu 300  
1 Volvo A35  
1 Dump truck  
1 Cat B6 Dozer  
1 2" Pump

Weather

Work: work cont'd in area D+E excavating footers + slab.

- started building berms for sludge drying bed in area D, using existing concrete slab as bottom of bed under ~~so~~ lines.
- cont'd pumping of surface water in quench pond to sewer.

7/26

Footers

- 1. 40
- 2. 15
- 3. 40
- 4. 25
- 5. 25
- 6. 5

Total = 150 LF

To Date = 11,500 LF

Slabs

- 1. 20x5 = 100
  - 2. 15x40 = 600
- Total = 700 SF  
 To Date = 181,640 SF

Piers

- 1. 20x4x5
- 2. 20x4x3
- 3. 15x10x5
- 4. 4x3x3
- 5. 4x3x3
- 6. 4x3x3
- 7. 4x3x3
- 8. 4x5x5 (6)
- 9. 20x5x5 (5)
- 10. 20x5x5 (4)
- 11. 10x19x3 (3)
- 12. 19x15x3 (2)
- 13. 14x5x3 (1)

Total = 107.7 CY  
 (159.03) CY

To Date = 1129.04  
 1158.7

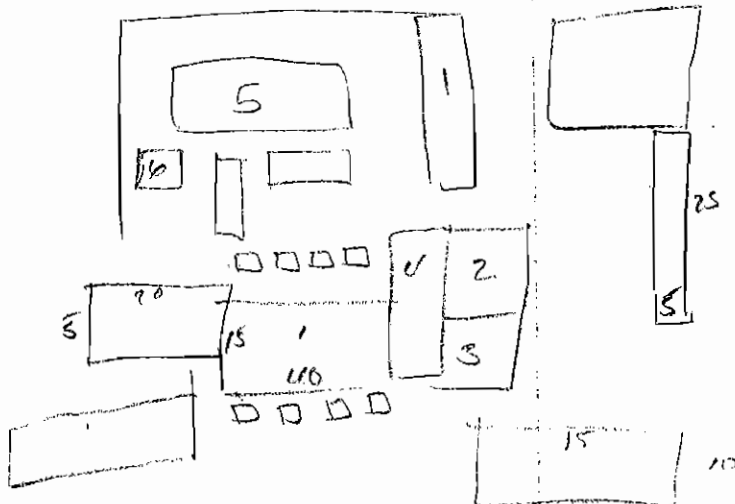

7/27/04

Labor: 1 Foreman  
2 laborer  
4 Operators

Equip: 4 Komatsu 300  
1 Payloader  
1 Skid Steer  
1 Liebherr 974  
1 Cat D6  
1 Volvo A35  
1 Pump

Weather: AM cloudy, lt precip,  
ground wet, 65°  
PM =

Work continues from Area B to Area E breaking up slab + excavating footers. Some large pieces of under slab foundations found. Downsizing concrete pieces and hauling to staging area also in Area E.

- additional pumping of quench pond. overnight rainfall brought level back up in 3 small areas of pond.

- cont'd building berms for sludge drying bed using <sup>Soil</sup> material excavated from driveway near quench pond.

- brought on payloader + skid steer for quench pond

7/27/04 Measurements

Footers

- 1. 60 (6) 10 (11) 10
- 2. 60 (7) 5 (2) 20
- 3. 50 (8) 10 (13) 35
- 4. 5 (9) 5 (14) 42
- 5. 10 (10) 5

Total = 337 LF

To Date = 11,923 LF

Slab

- 8x5
  - 8x5
  - 10x5
- Total 130 SF  
To Date = 181,770 SF

Piers

- 1. 4x4x5
  - 2. 4x4x3
- Total = 4.7  
To Date = 118.7 CY

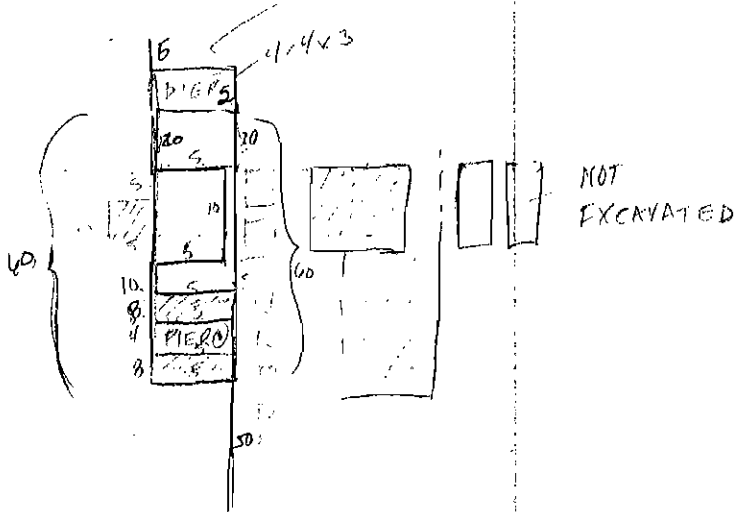
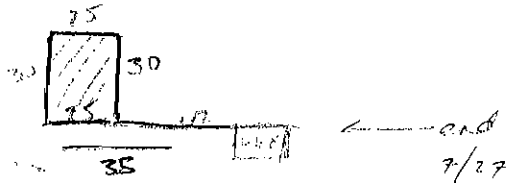

60	10	287
60	5	50
5	5	337
10	170	
10	40	
5	210	
	35	
150	245	
	42	
	287	

7/28/04

Labor: 1 Foreman  
4 Operators  
2 Labor

Equip 1 Leihbur 97H  
4 Komatsu 300  
1 CAT D4  
1 CAT D37E  
1 Komatsu 450  
1 Bobcat 553  
1 Pump  
1 A35 Volvo  
1 Tandem Dump

Weather: AM - cloudy, 70°  
PM - cloudy, 70°

Visitors: Fran Buone, Bill Eichorn, Dak Marshall, Jeff Karsella

Work: excavation of sludge from <sup>quench pond to</sup> drying bed  
started at 2pm. five loads - (buckets) taken  
out of quench pond NE corner, then excavator  
broke down for repairs. stopped excavation  
for day. sludge looks fairly dry.

- excavation of slab, footers + piers started on  
Area E north end approaching area of SW 9  
and SCD pit. large piers found under  
slabs. noted as extra material.

- clean up, downsize and hauling to stage area  
cont'd in area E.

- AM work finished installing sludge bed poly, phoring up berms and placing sand bags to hold down sides
- C&D material picked up + staged from area E. steel separated for offsite disposal.  
Told GC trees are not to go out as C&D



7/28/04

Footer

- 1. 10 (8) 6 (5) 10 (22) 42x2
- 2. 10 (9) 42 (16) 2x30 (23) 30x3
- 3. 20 (10) 6 (11) 10x2 (24) 25
- 4. 20 (11) 3x2 (18) 60x2 (25) 48
- 5. 10x4 (12) 47 (19) 70 Total = 960LF
- 6. 32 (13) 10x2 (16) 130 Total = 12,883LF
- 7. 25 (14) 15 (21) 5x2

Pier

- 1. 5x5x1 ~~11~~ ~~11~~
- 2. 3x5x6 ~~11~~ ~~11~~
- total = 33.11 CY
- To date = 1196.5 CY

Slab

- 160x25 = 4000
- 32x96 = 2880
- 49x130 = 6370
- Total = 13250 SF
- To date = 198020 SF

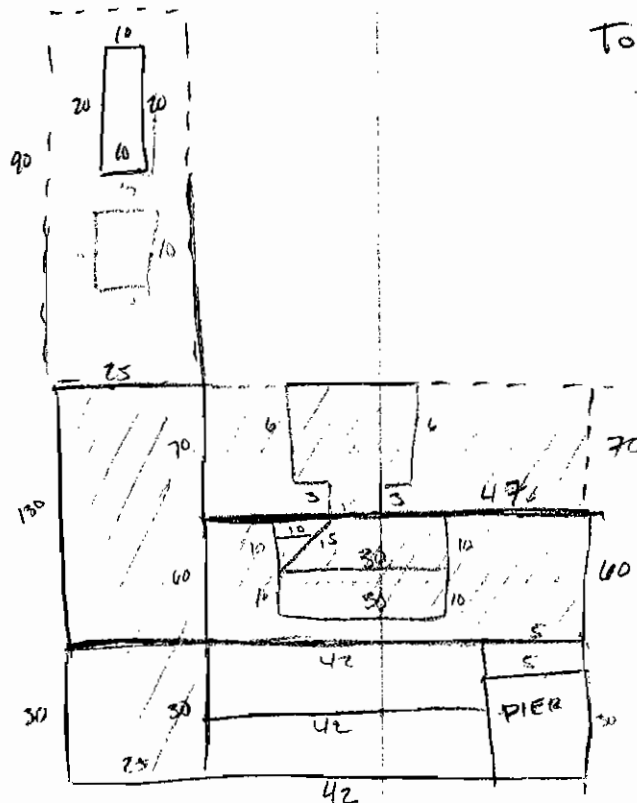

7/29/04

Labor  
Work

1 Foreman

5 operators (1 new = training)

2 laborer

Equip:

1 Liebherr 974

4 Komatsu

1 CAT D4

BOBCAT S53

1 SKID STEER

KOMATSU 450

1 PAYLOADER

1 CAT D57E

1 Pump

1 ABS Volvo

1 Tandem Dump

Weather: AM - sun, 75°, no precip

PM - sun, 75°, no precip

Visitors: Jim Tuk, DEC, mechanics - cambria

Work: Excavation of sludge from quench pond

to sludge drying bed started at 8am. Used

1 Komatsu to haul from pond and dump to Volvo

dump. Volvo hauled sludge ± 50 ft to bed + unloaded

material. Material peeped from equipment to

fill on ground. Instructed GC to doze area at

end of day to remove fallen sludge.

- Area E, eastern edge by gate, started

excavation of slab. GC/crew to stay away

from impact areas 1 + 5.

- 2 excavators down for repairs

- clean up of pump near old concrete ramp  
sws . . . old metal scrap + wood found.  
told GC wood out as C+D, save metal for  
scrap recycle

7/29/04

Footers:

- 1. 225 (E)
- 2. 225 (E)
- 3. 20 (E)
- 4. 20 (E)
- 5. 28 (D)
- 6. 28 (D)
- 7. 20 (D)
- 8. 20 (D)

Total = 586 LF

To date = 13469 LF  
Area E

Slab

1.  $225 \times 20 = 4500$  (E)

2.  $28 \times 20 = 560$  (D)

Total 5060 SF

To date = 200,980 SF

Piers

-

To date = 1196.5

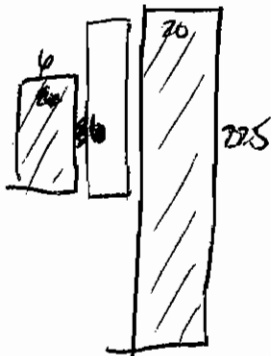

7/30/04

Labor :	1 Foreman	Equip :	1 Leihberr 974
	5 operators		4 Komatsu 300
	2 laborers		1 CAT D6
			1 CAT D37E
Weather :	AM , rain , 70° , clouds		1 KOMATSU 450
	PM , rain , 75° , clouds		1 BOBCAT 553
			1 PUMP
Visitors :	<del>At</del> Dale Marshall (NT)		1 ABS Volvo
	Bill Eichhorn (Cambria)		1 Tandem Pump
	Fran Barone (Cambria)		

Work: Area E work cont'd. excavating slabs + footers near iron fence. work also on downsizing concrete and hauling to staging pile.

- work cont'd on sludge drying bed, spreading out sludge to dry. pump area collecting runoff. haybales placed on edge of pump to filter material

7/30

- Footers
1. ~~352~~ 18
  2. ~~18~~ 18
  3. 60
  4. 60
  5. 11
  6. 11
  7. 34
  8. 34
  9. 4
  10. 6
  11. 20
  12. 20
  13. 15
  14. 15

Total = 332 LF  
 To date = 1380 LF

- Slab
1. 60 x 11
  2. 34 x 4
  3. 60 x 20
  4. 20 x 15
- total = 2376 SF  
 To date = 262,456 SF

- Pier
1. 4 x 4 x 4
- total = 2.4 CY  
 to date = 1198.9 CY

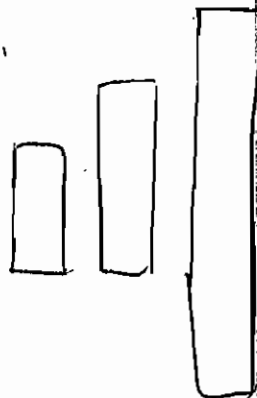

8/2/04

Labor: 1 Foreman

5 Operators

2 Laborers

Weather: AM-AM, no prec, 75°

PM AM, no prec, 80°

Visitors: Bill Eichleorn

Equip: 5 Komatsu 300

1 Liebherr 974

1 VOIUD A55

1 Surface Water Pump

1 CAT D6

1 KOMATSU 450

1 BOBCAT 553

1 CAT D37E

1 DUMP (TANDEM)

- Work on Area E pulling footers + slabs  
downsizing of concrete cont'd; hauling to  
staging area.
- search/gumming in area E near fence  
on East Ave looking for plabs + footers

8/2/04

Footer  
 1. 18  
 2. 10  
 10  
 10  
 10  
 210  
 210  
 20  
 20  
 total = 518 LF  
 To date = 14319 LF

Slab  
 1. 210x20  
 2. 10x14  
 3. 12x20  
 total = 4580 SF  
 To date = 207036.0 SF

Piers  
 1. 2x2x4  
 2. 2x2x4  
 3. 2x2x4  
 4. 2x2x4  
 5. 2x2x4  
 6. 2x2x4  
 7. 2x2x4  
 8. 2x2x4  
 total = 4.7 CY  
 total = 1203.6 CY

C/D  
 total = 32.38 ton  
 To Date = 53.4 tons



8/3/04

Labor: 1 Foreman  
5 Operators  
2 Laborers

Equip:

5 Komatsu 300  
1 Liebherr 974  
1 Volvo A35  
1 Dump  
1 2" Pump  
1 Cat D6  
1 Komatsu 450  
1 Bobcat 553  
1 Cat D37E  
1 Tandem Dump

Weather:

Work =

- Work cont'd into area E near East Avenue.  
excavating slab + footers from area 10.  
lateral footers running crosswise in <sup>grass</sup> ~~pad~~ area  
no pad found.
- cont'd hauling ctd from area <sup>Br</sup> E to staging pile
- downsizing concrete in area Br E & hauling to staging pile.

8/3/04

Footer  
 1. 42x10 =  
 2. 175  
 3. 175  
 4. 15  
 5. 15  
 6. 18  
 7. 18  
 Total = 836 LF  
 To Date 15155 LF

Slab  
 1. 10x10  
 2. 10x20  
 3. 12x40  
 total = 780 SF  
 To Date = 207,816 SF

Pier  
 1. ~~4.8x4 = 46704~~  
 Total = 4.7 cy  
 To Date = 1203,6

C+D  
 total = 40.1 +  
 To Date = 93.5 +

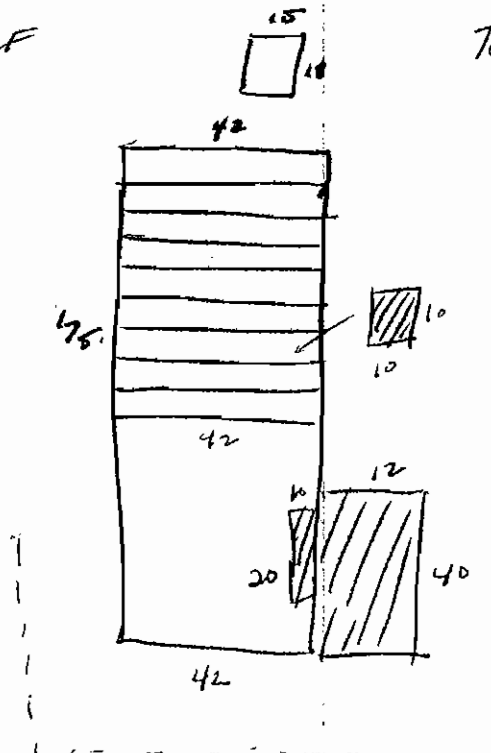

8/4/04

Labor: 1 Foreman  
5 Operators  
2 Laborers

Equipment: 1 Liebherr 974  
4 Komatsu 300  
1 CAT D6  
1 Komatsu 450  
1 Bobcat 553  
1 Cat D37E  
1 Pump  
1 Volvo A35  
1 Truck to  
haul ctd

Weather: AM - sun, part clouds  
PM - sun, part clouds

Work cont'd into Area E towards north end of site. concrete pad + footers excavated one excavator removing pad + footers, 1 exc downsizing, 1 exc loading material to haul to staging pile.

ctd material also hauled offsite.

ctd material moved from north end of site to staging pile near field trailers.

8/4/04

Footers		8/4/04 Slab	Pier-
1. 45	10, 5x4-20'	1. 50 x 100 =	0
2. 45	11.	2. 45 x 175	To Date = 1203.6
3. 40	12.	total = 12875 SF	
4. 40	13.	To Date = 220691. SF	
5. 40		CAD = 12.83 tons	
6. 175			
7. 175			
8. 25			
9. 25			

Total = 630 LF  
 To Date = 15785 LF

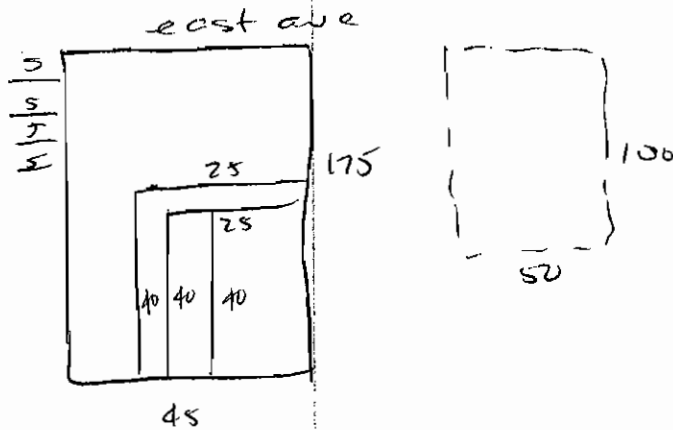

CAD  
 total = 12.83  
 To Date = 106.3 tons

elutaw

9/5/04

Labor: 1 Foreman  
2 Laborers  
4 Operators

Equip: 1 Liebherr 974  
5 Komatsu 300  
1 Bobcat 553  
1 2" pump  
1 Cat D6  
1 Komatsu 450  
1 ABS Volvo  
1 Dump

Weather:

Visitors: Bill Eichhorn

Work: excavation of footers, piers in area E between SW 4 and bldg footers to the east. Large piers found under ground <1 deep. Approx 50 large pieces pulled

- Crd material hauled to staging area + then disposed off site.

- downsizing concrete in area E (north end) hauling pieces to staging pile.

- dewatering cont'd in quench pond.

- sludge in center of pond needs drying.

8/5/04

<u>Footers</u>	<u>Slab</u>	
1. 18	<del>18</del> 20	1. 270 x 100 = 27,000
2. 10	<del>9</del> 20	To date = 247,691 SF
3. 10	Total 218 LF	
4. 40	To Date	
5. 10	Footers:	
6. 210	1. 25	
7. 210	2. 20	
Total = 45 LF		
To date = 15830 LF		



8x5x4	415	<del>IIII</del> III
5x5x3		III
4x5x5		TTTT I
4x6x4		TTTT TTTT TTT
5x4x3		TTTT TTTT II

6	= 5x4x4
1	8x5x4
TTTT IIII	
TTTT TTTT	= 5x3x3 (14 x 6 x 4)
III	5x3x6
IIII	5x8x4
I	5x4x2
II	4x8x5

Lump Sum

8x4x5 = IIII  
2x2x4 = TTT

<u>Piers</u>	<u>CrD</u>
Total = 177.2 CY	11.76 +
To Date = 1380.8 CY	11.59 +
	total = 23.4 +
	To date = 129.7 +

8/6/04

Labor : 1 Foreman      Equip: 1 974 Liebherr  
5 Operators            5 Komatsu 300  
2 Laborers            1 Bobcat 553  
                                 1 Komatsu  
                                 1 Cat 450  
Weather:                1 Cat 156  
                                 1 2" pump  
Visitors DER            1 ABS Volvo, 1 tandem

Work: work started at 7a excavating <sup>impact</sup> area 6 (quench pond). soils removed to a depth of 1 foot. Railroad ties found in area. RR ties taken to CTD pile for disposal. total area 16.5 ft x 80 ft x 1 foot = 48.9 cy

-CTD cont'd to be picked up from site.

-DER instructed Cambria to get sludge <sup>mt</sup> of quench pond + to the drying bed. and to start washing down the walls, floor. addtl 1500 gal pumped today.

Started excavating impact area 2a (east end of area) a few loads were hauled off site and then work stopped at 2pm.

8/6/04

↪

area 2A left for another day so operator could work on sludge area.

- area 2A - footers found over top of mound, some slab pieces. Will take 12" of soil as best as possible over concrete
- crushing operations started



8/6/04

Footers

total 779 LF

To Date = 16609 LF

Slabs

15x40 = 600

15x40 = 600

10x40 = 400

18x55 = 990

10x35 = 350

Total = 2940

To Date = 250631 SF

Piers

6x6x5 = 6.7 cy

8x6x5 = 8.9 cy

10x8x5 = 14.8 cy

3x2x4 x 5 = 4.5 cy

total = 34.8 cy

To Date = 1415.6 CY

C+D

1. 12.04 tons

To Date = 141.7 CY

Water

total = 1500 gal

To Date = 569250 gal

8/9

Labor 1 Foreman  
2 Laborers  
5 Operators

Equip 1 Liebherr 974  
5 Komatsu 300  
1 Komatsu 950  
1 Bobcat 553  
1 Cat D6  
1-2" pump  
1 Volvo A35, 1 tandem dump

Weather:

AM:

PM:

-work- cont'd on excavating quench pond sludge to drying bed. Sludge seems to be drying on top layers ± 8" depth. corners of sludge bed SE, SW, NW are very solid.

-cont'd excavating area E for footers + slabs.

-downsizing concrete cont'd in area E for hauling to staging area.

-crushing operations cont'd by Metzger

8/9

<u>Footers</u>	<u>Slab</u>	<u>Piers</u>
1. 403 LF (408)	0	4x5x6 = 1.44
to Date = 17017 LF	To date = 250,431 SF	4x4x3 = 1.78
		6x10x3 = 6.67
		total = 12.89
		To date = 1428.49

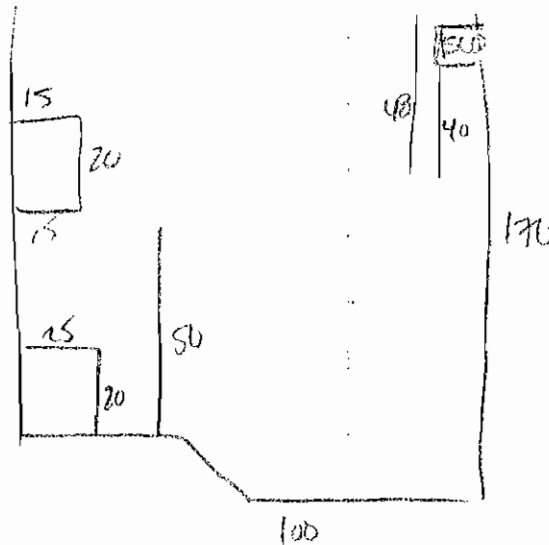

8/10

Labor: 1 Foreman  
2 Laborers  
5 Operators

Equip: 1 Liebherr 974

5 Komatsu 300

1 Komatsu 450

1 Cat 86

1 Bobcat 553

1 Volvo Dump, 1 tandem dumper

1-2" pump

Weather:

work cont'd excavating area E for  
footers and slabs. concrete <sup>+ hauled</sup> downsized  
to area for crushing.

excavated impact areas 2A, 2B  
to a depth of 12". found footers and  
misc trash when excavating area 2A.

- pumped 12,000 gal surface water from  
area E, in trenches w/in old bldg  
also

8/10/04

Footers

100

35

35

100

8

total 180 LF

total = 17205 LF

Slabs

40 x 100 = 4000

75 x 20 = 1500

Total = 5500 SF

To date = 256131 SF

Piers

1. 10 x 15 x 5 = 27.8

total = 27.8 CY

To date = 1456.3 CY

Impact Soil

area 2A = 130 x 255 x 1 = 1227.8 CY

area 2B = 30 x 70 x 1 = 77.78 CY

Total = 1305.6 CY (1304 CY)

Water = 12000 gal from Area E.

total loads impact area =

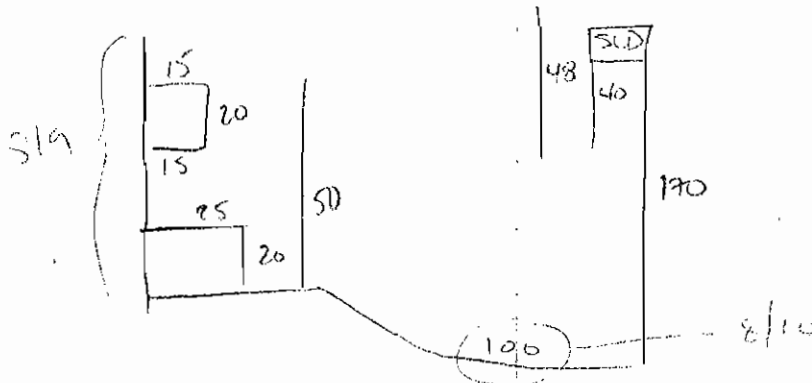

8/11/04

Footers

See below ↓  
 total = 879 CF  
 (878)  
 total = 18084 CF

Slab

0  
 total = 256,131 SF

Piers

1. 2x2x10  
 2. 2x2x4  
 3. 6x5x4  
 total = 6.5 CY  
 total = 1462.8 CY  
 CTD = 22.01 tons  
 total = 163.7 tons  
 Water = 1000 gal  
 total = 582,250 gal

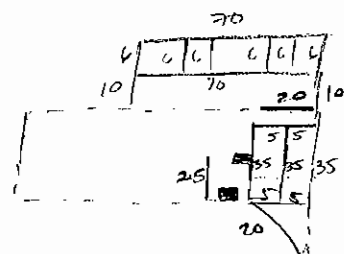
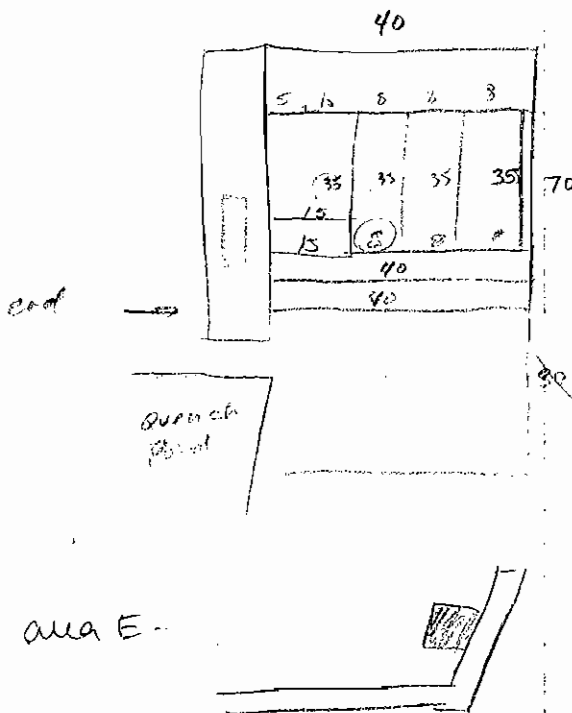

8/11/04

Labor: 1 Foreman

Equip

3 Laborers

5 Operators

Visitors - Bill Eichhorn, DER, Dale Marshall (NT)

Work - excavation of area 2A + 2B cont'd today. removed 12 inches of material area 2A had a lot of footers crossing the middle of the area. some concrete slab buck roadway was pushed back to uncover soil below. 12" of soil removed from under bricks.

- progress meeting at 10AM. discussed reducing size of PCB area by 50%.

8/12

1 Foreman  
3 Laborers  
5 Operators



8/12

Footers	Slab	Piers NOT DWG
1, 50	1. $50 \times 6 = 300$	1. $6 \times 5 \times 5 = 5.6 \text{ cy}$
2, 50	2. $29 \times 35 = 1015$	total = 5.6 cy
3, 6	total = 1315 SF	to date = 1468.4 cy
4, 6	to date = 257446.0 SF	

- 5, 29
- 6, 29
- 7, 10
- 8, 35
- 9, 35
- 10, 22
- 11, 22
- 12, 40
- 13, 40
- 14, 70

total = 444 LF  
 to date = 18,522 LF

Piers ON DWG  
 1  $2 \times 2 \times 6 =$

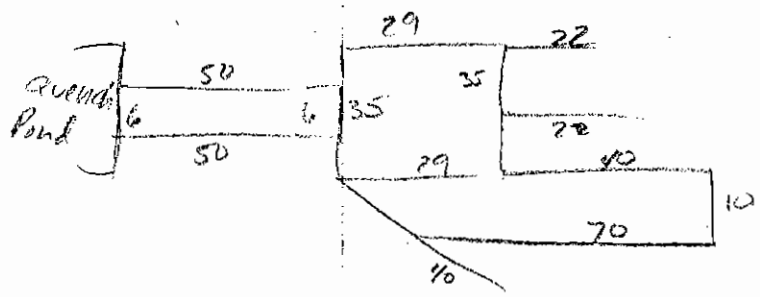

8/12

<u>Footers</u>	<u>Slab</u>	<u>Piers NOT DWG</u>
1, 50	1. $50 \times 6 = 300$	1. $6 \times 5 \times 5 = 5.6 \text{ cy}$
2, 50	2. $29 \times 55 = 1055$	total = 5.6 cy
3, 6	total = 1315 SF	to date = 1468.4 cy
4, 6	to date = 257446.0 SF	
5, 29		<u>Piers ON DWG</u>
6, 29		1 $2 \times 2 \times 6 =$
7, 10		
8, 35		
9, 35		
10, 22		
11, 22		
12, 40		
13, 40		
14, 70		

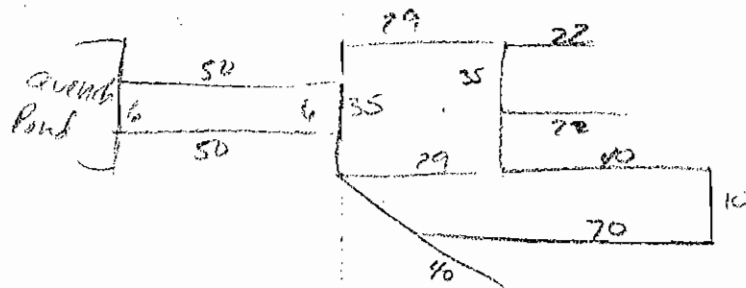

total = 444 LF

to date = 18,528 LF

8/13

Labor	1 Foreman	Equip	1 wrecking ball
	2 Laborers		2 Komatsu Ex 300
	3 Operators		1 Volvo P35
			1 2" pump

Weather - AM & PM rain, clouds, 65°

Work-

- crushing operations cont'd all day.
- breakup of quench pond bottom and the bottom was filled in with buck debris from the area to the north (SW1+2)
- walls broken down after buck + crushed conc. material were added to stabilize.
- impact areas 1, 4, +5 were excavated to a depth of 12 inches and hauled offsite to Modern.

8/13/04

<u>Footers</u>	<u>Slab</u>	<u>Piers</u>
1. 40	1. 102x90 = 9180	0
total = 40 LF	2. 10x10 = 100	to date =
to date = 18568 LF	total = 9280 SF	1468.4 CY
	to date = 266726 SF	

Quench Pond

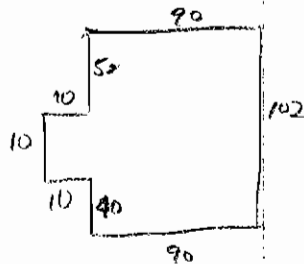

Impact areas

#1 = 27x93 = 84.4 CY  
38x60 = 93.0 CY  
total = 177.4 CY

#4 = 35x15 = 19.4 CY

#5 = 19x40 = 28.15 CY

total = 224.94 CY

(196.89) CY

8/16

labor	1 Foreman	Equip.	1 Lechbear 97Y
	4 Operators		2 Komatsu
	2 Laborers		1 Volvo A35
			1- 2" pump

Weather - AM. sun, 70°

PM sun, 75°

Visitors: Dub Mardace (NT)

- Work: cont'd removing walls in quenna pond area. adding crushed material to void to fill in.

- cont'd pulling foundations in area near SW1 + SW2.

8/16

Footers

- 1. 90 (11) 50 (21) 35 (31) 30
- 2. 90 (12) 20 (22) 35 (32) 30
- 3. 102 (13) 20 (23) 45 (33) 28
- 4. 52 (14) 20 (24) 10 (34) 28
- 5. 10 (15) 18 (15) 12 (35) 105 x 4
- 6. 40 (14) 15 (26) 4 (36) 50
- 7. 10 (17) 20 (27) 3 (37) 102 x 2
- 8. 10 (18) 20 (28) 10 (38) 75
- 9. 28 (19) 18 (29) 4 (39) 30
- 10. 20 (20) 15 (30) 5 (40) 4
- (41) 4

total = 1734 LF  
(1729) LF  
to date = 20,302 LF

Slabs

- 1. 102 x 50 = 5100 SF
- 2. 20 x 20 = 400
- total = 5500 SF
- to date = 272,226 SF

Piers

- 1. 10 x 8 x 5 = 14.8
- 2. 20 x 8 x 5 = 29.6
- 3. 5 x 8 x 5 = 7.4
- total = 88.9 CY
- to date = 1557.3 CY

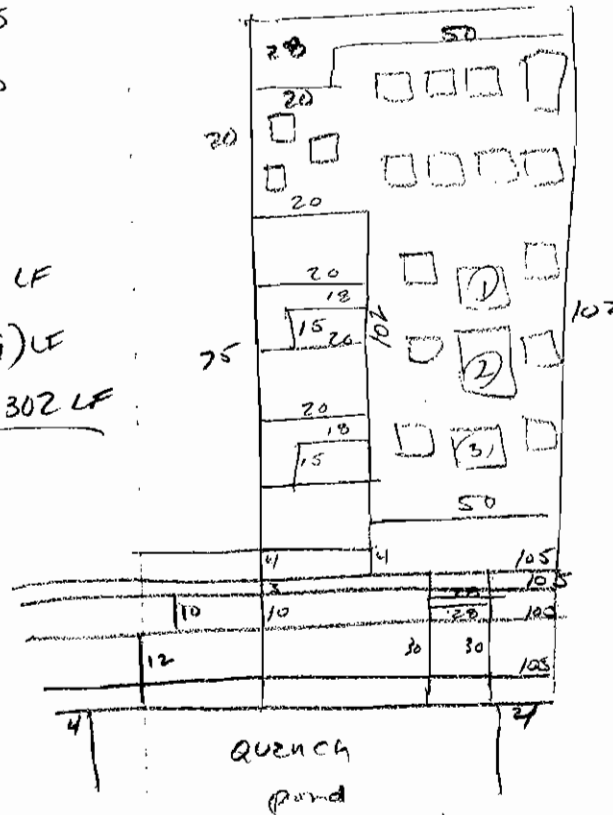

8/16

8/17/04

labr - 1 Foreman                      Equip 1 Leibers 974  
          3 operators                    2 Komatsu 300  
          2 laborers                     1 2" pump

Weather: AM sun, 70', lt breeze  
          PM - sun, 70, lt breeze

Visitors - none

Work -

cont'd excavating area E, quench pond walls  
impact  
area 2A near roadway.

RBC instructed GC to leave concrete  
in place that is below roadway. GC not  
to search for concrete. only pull visible  
concrete.

- concrete footers pulled from area E near SW9.
- concrete pieces downsized and staged for hauling to crushing pile

8/17/04

8/17/04

labr - 1 Foreman                      Equip 1 Leibers 974  
          3 operators                      2 Komatsu 300  
          2 laborers                        1 2" pump

Weather: AM sun, 70', 4 breeze  
          PM - sun, 70, lt breeze

Visitors - none

Work -

cont'd excavating area E, quench pond walls  
impact  
area 2A near roadway.

RBC instructed GC to leave concrete  
in place that is below roadway. GC not  
to search for concrete. only pull visible  
concrete.

- concrete footers pulled from area E near  
SW9.
- concrete pieces downsized and staged for hauling  
to crushing pit



8/17/04

impact area 2A

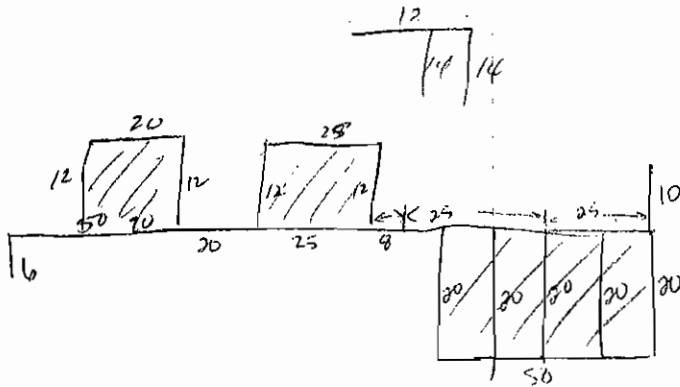

Footers

20	8	20
20	25	50
20	25	6
20	12	20
20	12	12
50	20	14
50	12	14

10   12   \_\_\_\_\_  
 total = 472 LF (462 LF)

to date = 20,774 LF

Slabs

1.	50 x 20 = 1000
2.	12 x 25 = 300
3.	12 x 20 = 240
	1540 SF
	to date = 273,766 SF

Piers

1.	10 x 10 x 3 = 11.11
2.	3 x 3 x 5 = 1
3.	4 x 4 x 4 = 2.37
4.	12 x 12 x 4 = 21.33
	35.81 cy
	to date = 1593.11 cy

8/18/04

Labor :  
1 Foreman  
2 Laborers  
5 operators

Equip : 1 Liebherr  
4 Komatsu 300  
1 Volvo A35  
1 2" pump

Weather AM-sun, clouds, 70°

Work: excavating top layers (dry material) of sludge bed to dispose offsite. trucks had 1<sup>st</sup> round unlined, 2<sup>nd</sup> round and all following truck beds were lined.

excavating footers + slabs in impact area 2A. large masses of concrete found in area. large amounts of refuse found in area. instructed GC to remove visible concrete down to 5' below finished grade as previously discussed on job. <sup>Ground elev.</sup> of area 2A is at a higher ( $\pm 5$ ) level than surrounding site. according to contract area will be leveled to match and create an even contour on the site.

8/18/04

Footers

1. 12 25 28
2. 70 25
3. 35 20
4. 35 20
5. 35 30
6. 35 30
7. 15 30
8. 15 30
9. 15 45
10. 15 45
11. 35 45
12. 35 45
13. 35 28
14. 35 28

total = 924 LF  
to date = 21698 LF

Slabs

1. 45x45
2. 20x15
3. 30x30
4. 20x25
5. 5x15
6. 5x15
7. 10x15
8. 10x15
9. 30x30
10. 100x30
11. 35x70
12. 10x15
13. 10x15

Total = 11,725 SF  
to date = 285,491.0 SF

Piers

1. 6x4x4
  2. 3x3x3
  3. 15x6x8
  4. 5x5x7
  5. 5x5x7
  6. 6x5x4
  7. 10x8x6
  8. 10x12x5
  9. 4x4x4
  10. 35x35x5
  11. 8x4x5
- total 12 = 2x2x3  
total = 324.2 CY  
to date = 1917.3 CY

Piers (LS)

15 (2x2x5)

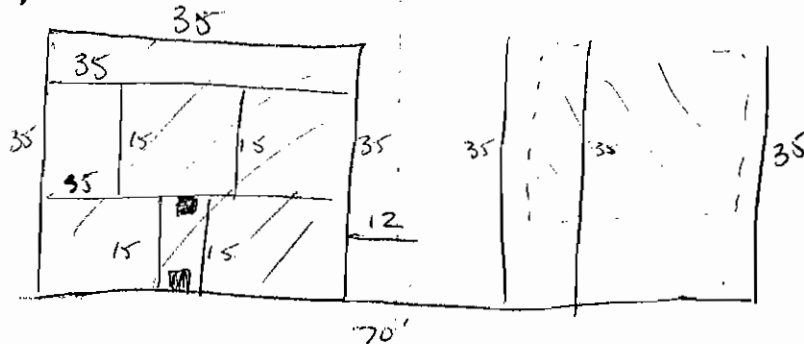

Stone

8/18/07

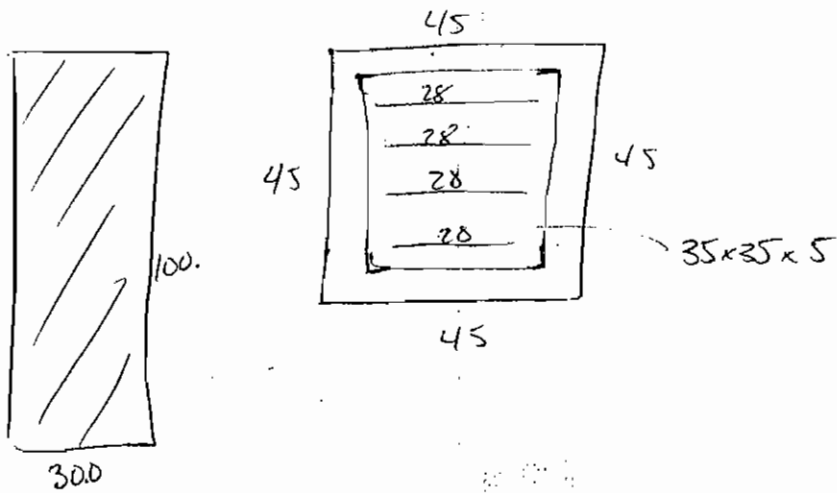
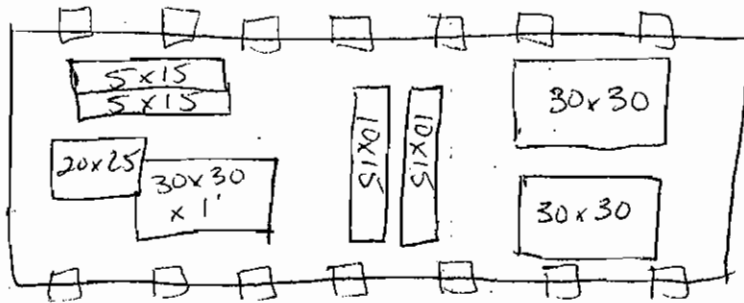

8/19

Labor: 1 Foreman  
4 Operators  
2 Laborers

Equip: 1 Liebherr 974  
3 Komatsu 300

Weather: sun/clouds  
sun/clouds

Visitors -

Work - cont'd excavating <sup>impact</sup> area 2A for  
footers and slab. Large amounts of  
garbage/refuse found in area. Instructed  
operator to bury in ~~at~~ areas of excavated  
footers. Material is not in any shape to  
go out as CID. Material is very deteriorated,  
mucky, broken glass.

excavated footers in area E by ~~for~~  
SID 4 area. Some large piers removed  
as extra, some piers removed that were  
lump sum.

- started grading impact area 2A to match final grade of site.
- cont'd filling in quench pond with crushed material.
- Metzger crushing to stop operation at 2pm and will move offsite for 3± weeks. Will return to finish quantity of crushed material as of date 18,600 tons.
- cont'd building roadways, filling depressions on site with crushed material. areas of excavation need to be filled in with crushed mat'l to prevent settling.

8/19

Footers

- 1. 35 (11) 25
- 2. 35 (12) 25
- 3. 70 (13) 25
- 4. 55 (14) 25
- 5. 60 (15) 50
- 6. 44 (16) 50
- 7. 120
- 8. 30
- 9. 70
- 10. 5

total = 924 LF

to date = 22422 SF

Slabs

1. 20x70 = 1400

2. 50x25 = 1250

total = 2650 SF

to date = 288141 SF

Impact Sludge

1. 25.04 tons

2. 28.74 tons

3. 29.53 tons

4. 35.52 tons

total = 118.8 tons

to date = 118,83

tons

Extra Piers

0.

to date = 1917.5

8/20/04

labor -

Equip:

Weather -

Visitors - RAA, DER, Dale Marshall (NT)

Work -

- cont'd grading, clearing concrete from impact area 2A.

- excavating concrete footings, slab, piers area E.



8/20/04

Footers

- 1. 63 (11) 15
- 2. 15 (12) 15
- 3. 20 (13) 25
- 4. 30 (14) 68
- 5. 25 (15) 68
- 6. 43 (16) 20
- 7. 36 (17) 35
- 8. 15
- 9. 25
- 10. 15

total = 527 LF

total = 22949 LF

Slab

- 1. 90x103 = 2060 SF
- 2. 43x30 = 1290 SF
- total = 3350 SF
- total = 29149 SF

Pier

- 1. 6x5x5 = 5.4 CY
- 2. 6x5x5 = 5.4
- 3. 6x5x5 = 5.4
- 4. 6x5x5 = 5.4
- total = 22.2 CY
- total = 1939.5

8/23/04

Labor: 1 Foreman  
4 Operators  
2 Laborers

Equip: 1 Leihben 974  
3 Komatsu 300  
1 Cat D6 Dozer  
1 Volvo A35 dump  
1 2" pump

Weather: sun/clouds 60°  
sun/clouds 70°

Visitors - Bill Eichhorn, Fran Bawne (Cambria)

Work:

- cont'd grading area 2A, clearing concrete to staging area for crushing. downsizing concrete, cont'd in area.
- cont'd excavating concrete in area E near SW 4, & SW 3+4
- cont'd building roadway on site with crushed material
- removed 1 bad CTD offsite for disposal

8/23

Footers

- 1. 90
  - 2. 84
  - 3. 78
  - 4. 78
  - 5. 10
  - 6. 10
- total = 350 LF  
to date = 23299 LF

Slabs

- 1. 10x78 = 780 SF
- total = 780 SF  
to date = 292771 SF

Piers

- 1. 2(6x5x5) = 11.1
  - 2. 4x5x4 = 2.74
  - 3. 8x5x4 = 5.92
  - 4. 8x4x4 = 4.74
- total = 24.73 cy  
to date = 1964.2

Any work

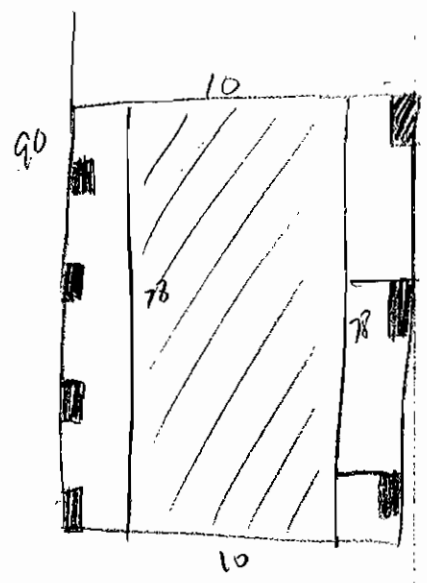

Extra Fdn/Pier

- 1. 2(6x5x5)
- 2. (4x5x4)
- 3. 8x5x4
- 4. 8x4x4

Lump Sum Piers

70 CY

8/24/04

Labor: 1 Foreman  
4 Operators  
2 Laborers

Equip: 1 Liebherr 974  
3 Komatsu 360  
1 Volvo A35 Dump  
1 2" pump

Weather: AM - Sun, no clouds, 60°  
PM - Sun, no clouds, 75°

Visitors: Fran Barone (Cambria),

Work:

- finished grading area 2A. cont'd hauling + downsizing concrete from area to staging pile.
- started excavating area E to east of SW 1 and west of Impact area 1.
- find out property line for mail service bldg. Dale says property line is edge of bldg.
- cont'd hauling <sup>crushed</sup> stone to areas of site to fill in depressions

- cont'd grading site to meet final grade
- downsizing + hauling stone to stage pile also cont'd around site.
- 2 loads sludge removed

8/24/04

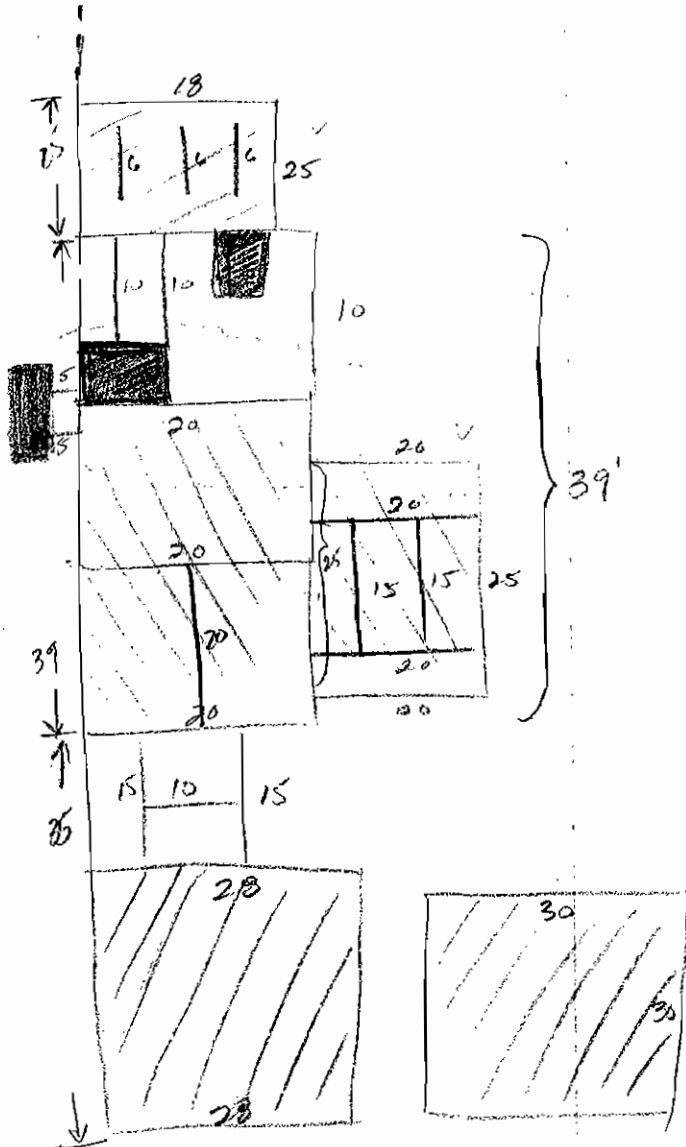

Piers/Fo

- 5x10x3
- 5x10x3
- Bx4x2

Slab

- 19x25
- 20x25
- 30x30
- 28x20
- 20x29

Footers

25	10	30	18
39	10	30	20
35	20	28	20
25	15	28	20
39	15	10	20
35	15	20	5
6	25	20	5
6	30	20	100
6	30	12	
216	170	204	698

8/24/04

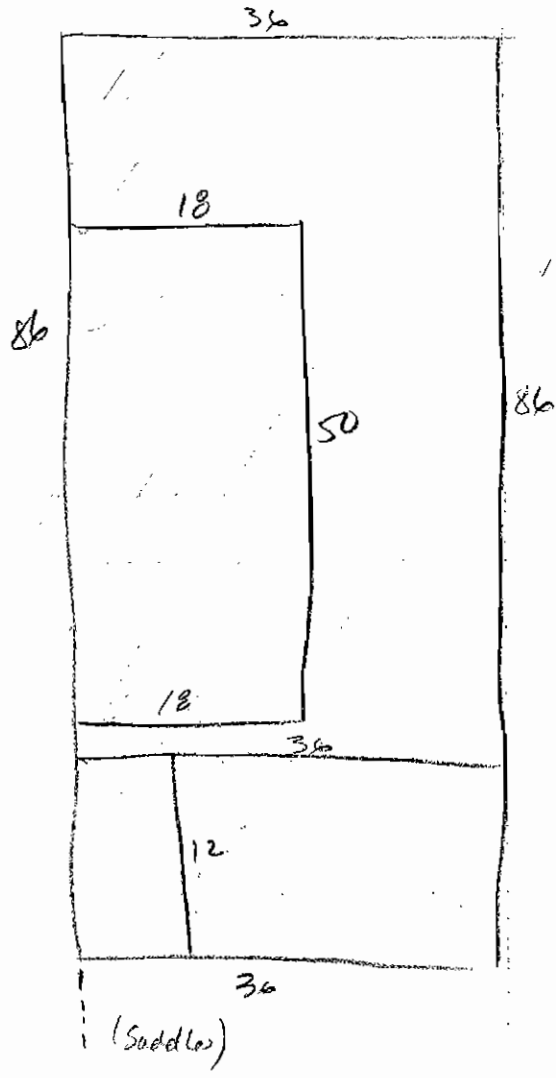

Filters

36 ✓	22
86 ✓	22
86 ✓	22
36 ✓	55
	55
	<hr/>
	1760

19 ✓
50 ✓
15 ✓
12 ✓
36 ✓
<hr/>
378

total: 557

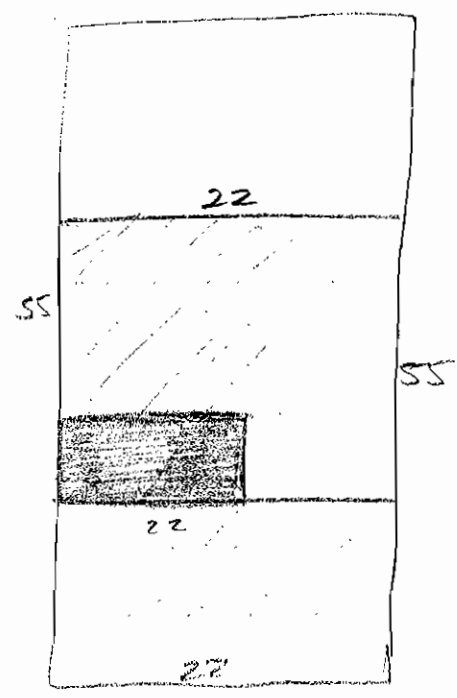

8/24

### Footers

1.	25	(23)	15
2.	39	(24)	20
3.	35	(25)	15
4.	20	(24)	10
5.	15	(27)	15
6.	39	(78)	28
7.	25	(29)	28
8.	18	(30)	30
9.	6	(31)	30
10	4	(32)	30
11.	6	(33)	30
12.	10	(34)	30
13.	16	(35)	86
14.	10	(36)	56
15.	20	(37)	84
16.	20	(38)	18
17.	20	(39)	50
18.	20	(40)	18
19.	20	(41)	36
20.	20	(42)	12
21.	25		
22.	15		

total = 1252 LF

### Slab

1.	28x20
2.	30x30
3.	20x29
4.	36x86
5.	75x20
6.	18x25
7.	27x55
total:	6086.0 SF
to date	= 298357.0 SF

### Piers

1.	5x10x3
2.	5x10x3
3.	8x4x2
total	= 13.5 cy
to date	= 1977.7 cy

### Impacted Sludge

1.	41.79 tons
2.	37.03 tons
total	= 78.82 tons
to date	= 197.65 tons



8/25/04

Labor: 1 Foreman      Equip- 1 Leihberr 974  
4 Operators                      3 Komatsu 300  
2 Laborers                        1 Volvo A35  
   1 CAT D6

Weather AM/ Sun/haze/clouds 65°  
PM/ sun/pt. clouds / 75°, humid

Visitors- Fran B., Bill E., Dale Marshall, Dave M., DER  
Wbvk - Jeff Kensella

cont'd excavating Area E near sludge pits. large pads 3-4' below surface were excavated.

- cont'd grading site and adding crushed material as fill
- cont'd downsizing concrete + staging material. 2nd hobknocker added to speed up process.
- pcb test results from continuation of trench showed ND for all analysis. area of trench can be excavated, ~~without~~
- 2 loads ord removed.
- 2 loads sludge removed from disbed - 1 - 1...

8/25/04

Footers

- 1. 20
- 2. 20
- 3. 20
- 4. 20
- 5. 20
- 6. 14
- 7. 14
- 8. 38
- 9. 38
- 10. 16
- 11. 16
- 12. 16
- 13. 20
- 14. 20
- 15. 20
- 16. 40
- 17. 40
- 18. 38
- 19. 38
- 20. 38
- 21. 18
- 22. 10

Slab

- 1. 20x38
- 2. 20x22
- 3. 38x40
- total = 2720 SF
- to date = 301,077 SF

Piers

- 1. (5x5x5) 3 = (4.6)3
- 2. (6x5x5) 6 = (5.6)6
- total = 47.2 CY
- to date = 2024.9 CY

lump sum piers

- 1. (8x4x5) 2
- 2. (2x3x3) 2

Sludge

- 1. 37.16
- 2. 27.26
- total = 64.4
- to date =

total = 534 LF

02/26/2004

8/26/04

Labor 1 Foreman  
2 laborers  
4 Operators

Equip : 1 Leibers 977  
3 Komatsu 300  
1 ABS Volvo  
1 CAT D6

Weather:

Visitors - Fran Barone

Work -

- 2 loads c+d removed
- excavation of concrete in area E.
- VBE drew up sketch of area E with measurements
- cont'd downsizing + hauling concrete to staging area.
- 2 loads sludge removed from dry bed
- 2 loads c+d removed

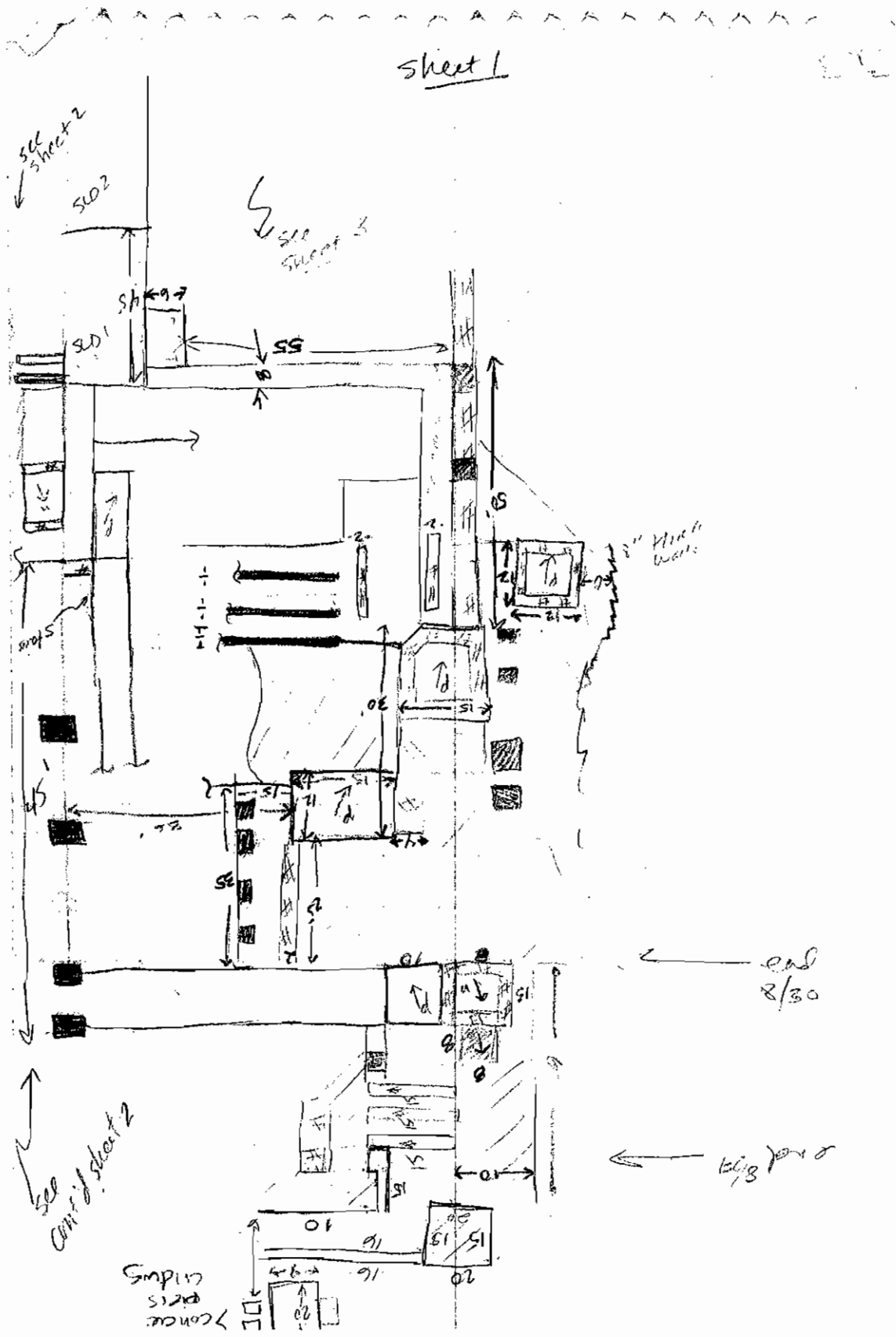

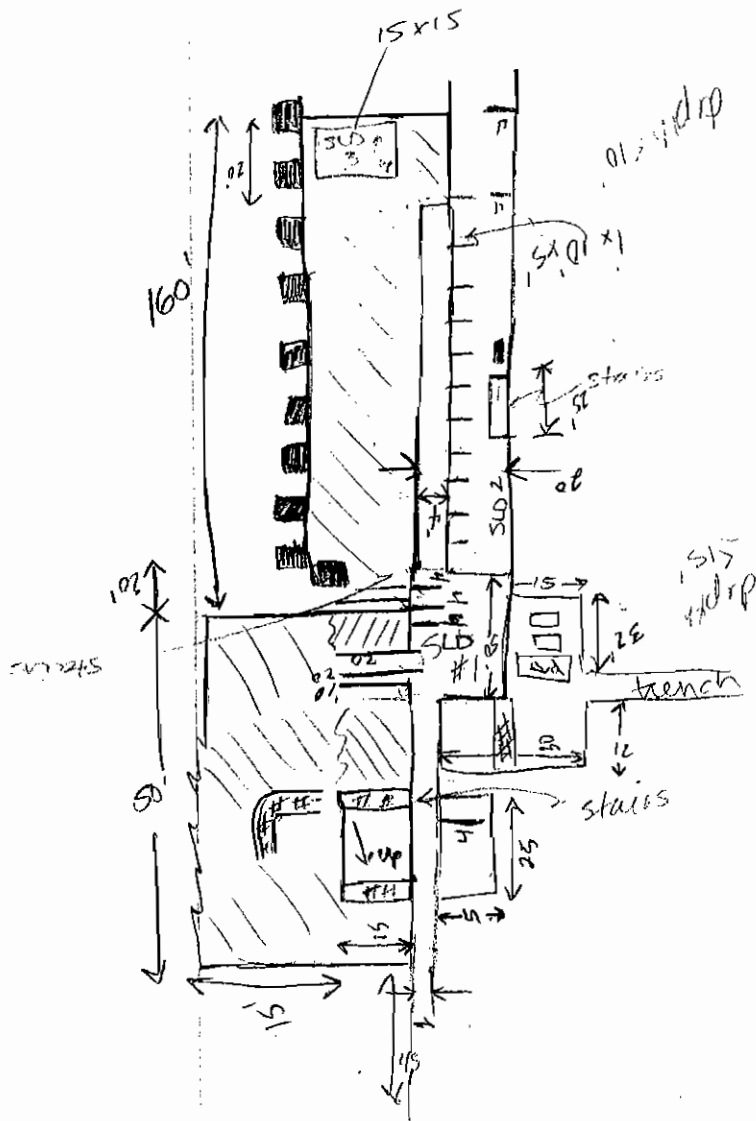

8/26

<u>Footers</u>				<u>Slabs</u>		<u>Piers</u>		
1.	38	(21)	8	1.	38x15	1.	5x10x5	
2.	5	(22)	8	2.	33x30	2.	5x10x5	
3.	5	(23)	8	total = 1560	3.	7x15x5		
4.	10	(24)	8	total = 302,637sf	4.	7x15x5		
5.	10	(25)	8		5.	5x5x5		
6.	10	(26)	38		6.	5x5x5		
7.	10	(27)	5		7.	5x8x5		
8.	10	(28)	5		8.	5x4x5		
9.	10	(29)	5		9.	26x8x5		
10.	10	(30)	5		10.	7x8x5		
11.	38		total = 531		11.	20x10x5		
12.	7		total = 256,016sf		total = 143.7			
13.	7				total = 2188.6 CY			
14.	15				<u>Sludge</u>	<u>CID</u>		
15.	15				1.	35.29	1.	15.25 ton
16.	33				2.	36.66	2.	28.41 +
17.	62				total = 71.95		total = 43.66	
18.	62				total =		total =	
19.	33							
20.	33							

8/27

Labor:	1 Foreman	Equip	1 Liebherr 974
	4 Operators		3 Komatsu 20.
	2 laborers		1 Volvo A35
			1 Cat D6

Weather -

Visitors - Fran Balone, Bill Siehborn (Cambria)

Work -

- cont'd excavating area E.
- cont'd downsizing & hauling concrete to staging area.
- 2 loads sludge removed from dry bed
- investigated pit area near butterfly industries found east end of trench western edge continues. Instructed GC to leave length opened as is and backfill open spots with concrete and then crushed concrete.
- one load C+D removed.

8/27/04

<u>Footers</u>	<u>Slab</u>	<u>Piers</u>
1. 58	1. 20x15	0
2. 14	2. 10x15	to date = 2188.6 CY
3. 16	total = 450	
4. 20	to date = 303,087 SF	
5. 20		
6. 15		
7. 15	C+D = 11.52 tons	Sludge
8. 10	total =	32.17
9. 10		30.29
10. 8		total = 625 tons
11. 8		
total = 1960F		
to date: 25812 LF		



8/30/04

Labor 1 Foreman

4 Op

2 laborers

Weather AM cloudy, lt rain, humid

PM. cloudy, less humid

Visitors- Bill Eichhorn

Work -

- cont'd excavating area E
- cont'd downsizing + hauling concrete to staging area
- scraping sludge drying bed back to facilitate loading. instructed OC to roll empty end of bed lines to meet the end of bed of material in it to shorten bed length and to prevent leakage from perforations.

8/30/04

Footcans

Sleb

Pins

1. 50

1. none

1. (4x5x5) 4"

2. 25

to date = 3030875F

total = 14.8 CY

total = 75'

to date = 2203.4 CY

to date = 25887LF

Sludex =

38.90

32.99

total = 71.9 tons

8/31/04

Labor: 1 Foreman  
3 operators  
2 laborers

Weather - AM - pm, no clouds, 70°  
PM

Visitors:

Work -

- cont'd excavating area E. large pieces in area.
- cont'd filling in depression areas w/ crushed material to bring up grade
- cont'd pumping pits of water to site after rainfall
-

8/31/04

<u>Footer</u>	<u>Slab</u>	<u>Piers</u>
20	20 x 15 = 300	0
20	total = 300	to date = 2203.4 cy
15	to date = 303387 SF	
<u>10</u>		
total = 65 LF		
to date = 25,952 LF		
	<u>Sledge</u>	<u>C+D</u>
	35.162	0
	38.05	
	total = 73.7 tons	

9/3/04

labor: 1 Foreman  
2 laborers  
6 Operators

1 Liebherr 971  
4 Komatsu 300  
1 Volvo A35  
1 Cat D6

Weather:

Visitors, DER

Work -- DER onsite --

9/3/04

Footers

16

16

12

12

total = 56 LF

total = 264 SF LF

Slab

16x12

total = 192 SF

total = 304, 152 SF

Piers

0

total = 2798.59  
CF

Sludges

1.09.68 tons

9/7/04

Labor. 1 Foreman  
2 Labor  
6 Operators

Equip- 1 Ceilber 974  
4 Komatsu 300  
1 Volvo 35  
1 Cat D6

Weather clouds, 70  
clouds, 11 am, 70

Visitors: Fran Barone

Work-

started removing slab under sludge drying pit

cont'd downsizing concrete and hauling  
to staging area

progress meeting on site, 10:00 AM

7/7/24

Footers -

200

200

50

50

8

8

8

8

total = 332.0 LF

total = 26988 LF

(26843)

Slab

50x200 = 10000 SF

total = 10000 SF

total = 314152 SF

(316842)

Piers

1. (3x3x5) B

total = 21.7 CY

total = 2400.9 CY

(2315.6)

Sludge -

total = 574.73 tons

(611.76)

Sludge bed slabs

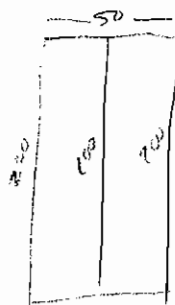



9/8/04

Labor: 1 Foreman

6 Op

2 Laborers

Weather sun/clouds

sun/clouds, H+rain

Visitors- Bill Eichhorn, DER, Dale Marshall

Work-

Cont'd excavating on site - removed slab under  
sludge drying pit. removed footers from  
ILD to area.

9/8/04

<u>Footers</u>	<u>Slab</u>	<u>Piers</u>
1. 24	1. 20x30	1. (3x4x3) 2
2. 200	2. 45x50	2. (4x4x4) 2
3. 70	3. 50x50	total = 7.4 cy
4. 60	total = 5350SF	to date =
5. 60	to date =	
total = 414 LF		
to date =		

Sludge

- 1. 40.61
- 2. 37.68
- 3. 34.27
- 4. 35.16
- 5. 19.68
- total = 167.4 tons
- to date =

9/9/04.

Labor -

Work - none except breaking down concrete  
due to rain

9/10

Labor. 1 Foreman  
2 laborers  
6 Operators

Equip. 1 Hitachi 977  
2 Komatsu 300  
1 Volvo A35  
1 Cat D6

Weather: sun / 70° / clearing  
sun / 75° / from rainstorm

Work -

- Instructed GC that we need to take  
3 more PCB samples in area 3

- Instructed GC that we can't let city  
come in to test until Monday. Let  
the water settle and see if oil comes  
back to the surface over the weekend  
but much oil residue remains in the  
pits - may have dispersed with heavy rain  
and was absorbed by ground.

Area 3 samples

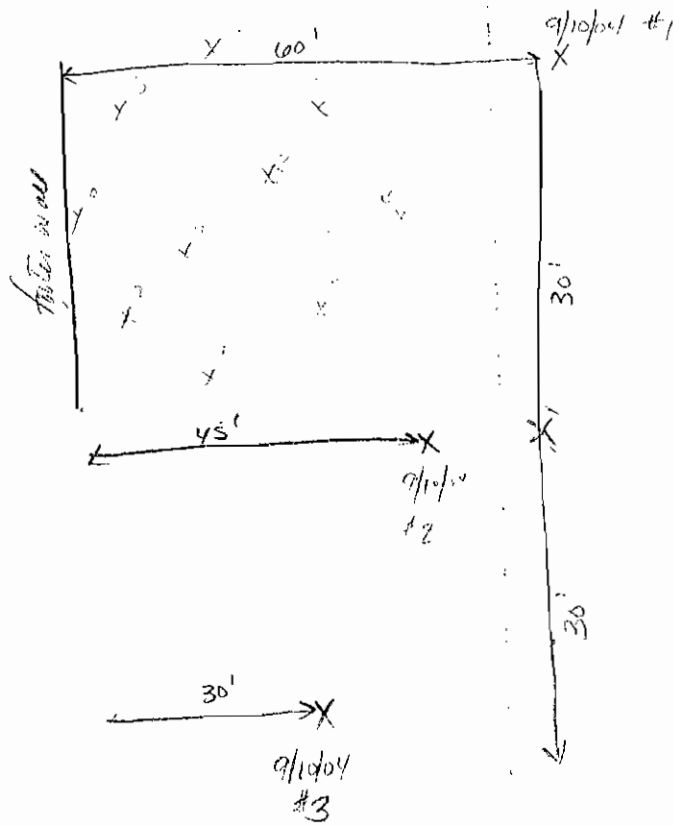

9/10

Footcans

0

Slab

0

Pier

0

C+D

14.68 hours

9/13/04

Labor	1 FOREMAN	Equip	1 Liebherr 974
	6 Operators		4 Komatsu
	2 Laborers		1 VOLVO A35
			1 Cat D6

- Sampled water near pw3+4 to check if it can be pumped to sewer. by city XT will know Tues. if ok.
- removing footer + slab from area west of Sld 2
- removing sludge debris from area west of SLD2
- removed building debris near 9<sup>th</sup> street entrance, 45x65, 21x70, 28x28

9/13/04

Footers

25	20	36
25	28	14
60	20	14
20	18	
10	18	
35	30	
20	10	
20	36	
30	36	
30	36	

total = 635 LF

Slab

20x30
30x30
14x30
20x28
<u>30x15</u>
total = 2,550

Piers

1. 4x6x5
2. 4x6x5
3. 4(8x4x5)
4. <u>4(2x2x3)</u>
total = 39.8 CY



9/14/04

Labor: 1 Foreman  
3 Laborers  
6 Operators

Equip: 1 Liebherr 974  
2 Komatsu 300  
1 Link Belt 300  
1 Volvo A35  
1 Cat D4

Weather: <sup>AM</sup> Sun, 70°

PM - sun/cloud mix, 75°

Work -

- GC started excavating SLD 2 pit w/o removing sludge. RBC stopped the excavating and informed GC that sludge needs to be removed according to plans.
- GC stopped excavating and started removing the sludge from the area. Waited for settling to occur in water and then started pumping SW out of pits.
- during pumping of pits, SLD #1 also decreased in water level, possibly due to water seeking its own level.
- will continue to clean sludge out of SLD #2
- cont'd downsizing concrete and hauling to staging pile.

9/14

<u>Footer</u>	<u>Slab</u>	<u>Pier</u>
0	0	0

Sludge

1. 31.22

2. 34.14

3. 29.94

4. 33.41

5. 37.10

Total = 165.81

9/15

Labor: 1 Foreman  
3 Laborers  
5 Operators

1 Leihbom 974  
1 Cat 06  
1 Volvo 135  
4 Komatsu 300

Weather - sun, 65°  
sun, 70°

Work - excavation of sludge from SLD 1 (PCB pit) started. added soil from Area 3 to the PCB pit to solidify the wet material. started removing the material on the floor of the pit to the hauling truck

Started excavating area 3 (pcbs) based on new sketch of area and test results. area 3 now contained 2 areas. each area was removed with 2 spots in each area taken down  $\approx$  2 feet to remove redish and black colored material

9/16

Labor: 1 Foreman  
3 laborers  
5 Operators

1 Liebherr 974  
4 Komatsu 300  
1 Volvo A35  
1 CAT D6

late after AM - sun

PM - clouds, w rain

- work cont'd on removing material from Area 3 (pcb) and SUD 1 (pcb)  
SUD 1 was cleared of material from bottom of pit and sides were scraped. floor of pit was loaded out as pcb material. it would be too difficult to clean surface. walls were left to dry and to assess condition after dry.
- onsite downsizing of concrete cont'd. hauling concrete to staging area for crushing.
- samples taken of area 3 for confirmatory Cat B ASP protocols. samples picked up by PSC analytical

9/16

Footers

- 1. 5' x 11' = 55
- 2. 160
- 3. 160
- 4. 25
- 5. 25
- 6. 25

total 610 LF

Slab

- 1. 100 x 50 = 8000 SF

Piers

- 1. (4 x 4 x 5) #14-
- 2. 8 x 18 x 4
- 3. 8 x 20 x 4
- 4. 6 x 18 x 4
- 5. 6 x 18 x 4
- 6. 10 x 8 x 5
- 7. 10 x 5 x 5

total = 742.58 CY

9/17/04

Labor: 1 Foreman  
2 laborers  
5 operators

Equip: 1 Liebherr 974  
4 Komatsu 300  
1 Volvo A35  
1 CAT D6

Weather AM-  
PM-

- Work - finished cleaning SUD1 (pcb pit) walls were removed for crushing after inspection.
- finished removing sludge from SUD3 concrete piers that were coated with a black material
- removed black material from sides of pit in area E east of SUD1. Sent out with sludge loads.

9/17

<u>Footer</u>	<u>Slabs</u>	<u>Piers</u>
20	48x18	8x8x3
10	10x20	3x3x4
10	total = 1064 SF	5x6x5
48		3x3x5
18		6x3x3
18		4x4x4
48		8x3x4
4		6x4x4
6		4x4x5
8		8x5x4
12		2x3x4
10		2x3x4
4		10x12x5
6		total = 63.91 cy
total = 222 SF		

9/20

Labor: 1 Foreman  
2 Labor  
5 Operator

1 Leihberr  
1 Volvo A35  
3 Komatsu 300  
1 Cat D6

Weather: AM - sun, 40°  
PM - sun, 70°

Work -

cont'd in area E pulling fosters +  
piss from area. large mass of concrete  
found in middle of area. instructed GC  
to remove debris + soil from surface to  
obtain a better view of concrete.

- PCB area completed.
- pludge areas cleaned/completed
- crushing equip starting to move onsite
- cont'd grading onsite to meet finish grade



9/20

Footer  
 10  
 12  
 13  
 18  

---

 total = 58 LF

Slab  
0

Pier  
 10x10x4  
 12x8x6  
 6x6x4  
 4x5x4  
 5x6x5  
 3x3x4  
 3x3x4  
 3x3x4  
 3x3x4  
 3x4x5  
 4x3x6  
 6x6x5  
 10x8x4  
 4x5x6  
 10x4x4  
 3x3x3  
 3x3x4  
 6x3x7  

---

 total 97 cy  
 - 42 cy taken 9/14  

---

 total 55 cy

9/21

Labor: 1 Foreman  
2 labor  
5 Operators

Equip: 1 Cat 974  
1 Volvo A35  
4 Komatsu 350  
1 Cat D6

Weather: Sun, 60°

Sun, 70°

Work:

- cont'd grading onsite
- cleanup of concrete material on area  
to crushing pile

9/21

Foster  
0

Slab  
0

Pier  
0

PCB

24.32

19.78

18.74

19.78

24.14

18.36

total = 125.12 tons

Sludge

27.24

26.93

26.15

23.02

20.91

total = 119.25 tons

9/22

Labour: 1 Foreman  
2 Labor  
5 Operator

Equip 4 Komatsu 300  
1 Volvo A35  
1 Cat D6

Weather AM - Sun, 70  
PM - sun, 80"

Visitors Dale Marchant, Jeff Kinsella, Bill Eichhorn,  
Metzger Consulting onsite

Work -

- cont'd dmsizing + clearing concrete to staging area.
- cont'd grading site.
- started removing tree stumps from fence.
- started demo on concrete piers. submittals on construction to follow.

9/23

labor: 1 Foreman  
2 labor  
5 operators

1 Komatsu 300  
1 Cat D6  
1 Volvo A35

Weather - AM, sun 60°  
- PM, sun, 80°

Visitors - Dale Marshall

Trucking in fill from Cerrone + Garassi  
per Dale Marshall

- Work -
- cleared area on top of concrete mass.  
showed large areas of open space  
took measurements with G@ on footers  
piers etc... started breaking concrete with  
breakers, wrecking ball.
  - cont'd grading site.
  - cont'd dem of concrete piers
  - cont'd crushing operations
  - cont'd downsizing concrete and hauling to  
staging area.



9/23

<u>Footers</u>	<u>Slab</u>	<u>Piers</u>
900 LF	0	12x10x8
		13x5x5
		13x5x5
		18x8x5
		15x5x5
		6x4x4
		10x5x6
		5x2x6
		5x2x6
		10x12x5
		<u>total = 141.51 cy</u>

<u>C+D</u>	<u>Sludge</u>
22.71 tons	22.49
	<u>21.97</u>
	total = 44.46 tons

9/24

Labour	1 Foreman	Equip	4 Komatsu 300
	2 labour		1 Cat D6
	5 Operators		1 Volvo A35

Weather: AM - sun, 65°  
PM - sun, 80°

Visitors - trucking firm Cerrone & Yonessi (backfill material) per Dale Marshall

Work -

- crushing operations cont'd
- breaking of concrete mass area with hammer + brushing ball cont'd
- downsizing concrete and hauling to staging area.
- cont'd grading on site.
- cont'd demo on concrete piers
-