

MIDDLETON ENVIRONMENTAL, INC.  
*Environmental Consultants and Engineers*

**PHASE I ENVIRONMENTAL SITE ASSESSMENT REPORT**

*Property located at 3206-3224 Long Beach Road*

*In Oceanside, New York*



*Prepared for United Properties*

*November 3, 2004*

181 WEST MAIN STREET, SUITE 102, BABYLON, NY 11702  
631 321-4300 • FAX: 631 321-4349 • middletonenvironmental.com

**TABLE OF CONTENTS AND REPORT FORMAT FOR**  
**PHASE I ENVIRONMENTAL SITE ASSESSMENT**

**A. EXECUTIVE SUMMARY**

**B. INTRODUCTION**

1. *Purpose*
2. *Limiting Conditions and Methodology Used*

**C. SITE INFORMATION**

1. *Location and Legal Description*
2. *Site and Vicinity Characteristics*
3. *Information (if any) Reported by User Regarding Environmental Liens or Specialized Knowledge or Experience (pursuant to Section 5)*
4. *Current Uses of the Property*
5. *Historical Usage of the Property (to the extent identified)*
6. *Current and Past Uses of Adjoining Properties (to the extent identified)*
7. *Descriptions of Structures, Roads, Other Improvements on the Site (including heating/cooling system, sewage disposal, source of potable water)*

**D. RECORD REVIEW**

1. *Standard Environmental Record Sources, Federal and State*
2. *Summary of Environmental Records Review (Environmental Database Information)*

## ***E. INFORMATION FROM SITE RECONNAISSANCE AND INTERVIEWS***

1. *Physical Site Inspection*
2. *Current Uses of Property*
3. *Past Uses of Property*
4. *Potential Asbestos Containing Materials (PACM)*
5. *Above Ground Tanks*
6. *PCB's*
7. *Drums (Interior or Exterior)*
8. *Stains or Corrosion*
9. *Pools of Liquid (if any)*
10. *Odors*
11. *Interior Wall Coverings (if Lead Based Paint is an issue)*
12. *Radon*
13. *Underground Storage Tanks*
14. *Solid Wastes*
15. *Stressed Vegetation*
16. *Sumps, Pits, Ponds, Lagoons or Wetlands (if any)*
17. *Waste Water*
18. *Wells*
19. *Underground Injection Control*
20. *Possibility of Migrating Hazardous Substances*
21. *Additional Concerns (if any)*
22. *Interviews*

## ***F. FINDINGS AND CONCLUSIONS***

## ***G. SIGNATURES OF ENVIRONMENTAL PROFESSIONAL***

## ***H. PROFESSIONALS QUALIFICATIONS***

## ***I. APPENDICES***

#### A. EXECUTIVE SUMMARY:

*The site is located at 3206-3224 Long Beach Road in Oceanside, New York. The subject site is .56 acres in size and there are two (2) single story retail buildings on the subject site. The 3206-3218 Long Beach Road building is 5,880 square feet in size and contains a nail salon, a dog groomer, a travel agency, a cellular phone store, a restaurant, an ice cream store and a hair salon. The 3220-3224 Long Beach Road building is 3,750 square feet in size and contains a stationery store and a dry cleaner.*

*It was determined from the physical site inspection, records review and interviews that there were no recognized environmental conditions with regard to the subject site. Recognized environmental conditions are those conditions that could adversely affect the environmental integrity of the property.*

*There were no floor drains observed in the dry cleaner. The dry cleaning machine inside the dry cleaner was properly stored and vented outside the building. All wastes generated by the dry cleaner are carted off-site for disposal by a licensed waste hauler (Safety Kleen). A review of the Nassau County Department of Health's (NCDH), Industrial Waste Systems information did not reveal any cases of improper chemical disposal on the subject site. However, a review of the NCDH files indicated that as of the last inspection (in 1998), the owner of the dry cleaner was cited with a violation for operating without a NCDH Article XI permit (for dry cleaners). It is recommended that the owner of the dry cleaner file for a NCDH Article XI permit in order to be in compliance. There were no 55 gallon drums or any signs of friable Potential Asbestos Containing Material (PACM), noticed inside the building. There were two (2) 30 gallon drum of waste perchloroethylene noticed inside the dry cleaner that did not show any signs of leakage.*

*There were no outside above ground electrical transformers or any outside 55 gallon drum storage areas noticed on the subject site. There were no signs of stressed vegetation or soil contamination noticed on the subject site. There were no fuel fill ports or fuel vents noticed on the subject site (such port or vents could indicate the presence of an underground storage tank on the subject site). There was one (1) 275 gallon above ground heating oil storage tank noticed behind the dry cleaner that did not show any signs of staining or leakage.*

*It is the opinion of Middleton Environmental Incorporated that no further testing (subsurface or otherwise), is required on the subject site.*



## **B. INTRODUCTION:**

### **1. Purpose;**

*The general purpose of this Phase I Environmental Site Assessment is to determine whether or not the property is subject to certain recognized environmental conditions that may affect property use or increase the risk of liability exposure associated with the property. Recognized environmental conditions include the presence or possible presence of hazardous substances or petroleum related products that indicate an existing release, past release, or a significant threat of a release into structures on the property, into the ground, groundwater or surface water. Recognized environmental conditions can include past uses, disposal practices, spills, off-site contamination, and regulatory compliance.*

*The findings and conclusions of this report can be found in Sections F. Sections C, D, E describe the property, reviews records related to the property and contains information gathered during site reconnaissance and interviews. MEI Phase I Site Assessments are prepared by environmental professionals, supervised by Professional Engineers. Signatures and qualification statements can be found in Sections G and H of this report.*

### **2. Limiting Conditions and Methodology Utilized;**

*The limiting conditions and methodology used in preparing this Phase I Environmental Site Assessment Report are those contained in ASTM Standard E1527-00. This practice does not address requirements of any state or local laws or any federal laws other than the appropriate inquiry provisions of CERCLA's "Innocent Landowner Defense". Users are cautioned that federal, state, and local laws may impose environmental assessment obligations that are beyond the scope of this practice. Users should also be aware that there are likely to be other legal obligations with regard to hazardous substances or petroleum products discovered on property that are not addressed in this practice and that may pose risks of civil and/or criminal sanctions for non-compliance.*

*The report is not, and should not be construed as, a guaranty, warranty, or certification of the presence or absence of any toxic substances, (which can be made only with testing), and contains no formal plans or recommendations to rectify or remediate the presence of any toxic substances, (which may be subject to regulatory approval). No environmental site assessment can wholly eliminate uncertainty regarding the potential for recognized environmental conditions in connection with a property. Performance of this practice under ASTM Standards is intended to reduce, but not eliminate, uncertainty regarding the potential for recognized environmental conditions in connection with a property.*

*Except for acts and omissions by Middleton Environmental Incorporated (MEI), or its employees which are shown to be grossly negligent and which represent intentional misconduct, United Properties has agreed, to the maximum extent permitted by law, to hold harmless and indemnify MEI from and against any and all claims and liabilities arising in respect to the Environmental Site Assessment performed by MEI on behalf of United Properties. All liability on the part of MEI shall be limited solely to the cost of this report. MEI shall have no liability for any other damages, whether consequential, compensatory, punitive, or special arising out of, incidental to, or as a result of this report. MEI assumes no liability for the use of this report by any person or entity other than the client for whom the report was prepared.*

### C. SITE INFORMATION:

#### 1. Location and Legal Description:

*The site is located at 3206-3224 Long Beach Road in Oceanside, New York. The subject site is .56 acres in size and is zoned for commercial usage.*

#### 2. Site and Vicinity Characteristics:

*The property site and vicinity characteristics listed below were analyzed utilizing a current USGS 7.5 Minute Topographic Map. This information is useful in determining the grade and topography of the subject site. It was determined that the property is primarily flat and there were no slopes, depressions or rolling hills observed on the subject site. The site has been graded for commercial usage and slopes on the subject site range from 0 to 3 percent. The groundwater flow beneath the subject site is in a generally southerly direction as obtained from groundwater contour maps developed by the United States Geologic Survey (USGS Groundwater Flow and USGS Contour Map).*

#### 3. Information Reported by User Regarding Environmental Liens or Specialized Knowledge or Experience:

*No information concerning any environmental liens that may be currently recorded against the property was reported to MEI. Moreover, no specialized knowledge or experience related to recognized environmental conditions at the property was reported to MEI prior to site examination.*

#### 4. Current Uses of the Property:

*The current use of the property is commercial. The subject site is .56 acres in size and there are two (2) single story retail buildings on the subject site. The 3206-3218 Long Beach Road building is 5,880 square feet in size and contains a nail salon, a dog groomer, a travel agency, a cellular phone store, a restaurant, an ice cream store and a hair salon. The 3220-3224 Long Beach Road building is 3,750 square feet in size and contains a stationery store and a dry cleaner.*

#### 5. Historical Usage of the Property:

*A review of the Nassau County Department of Assessment files indicated that it was reported that the 3206-3218 Long Beach Road building was constructed in 1979 and the 3220-3224 Long Beach Road building was constructed in 1959. These buildings have been utilized as strip retail buildings since they were first constructed. A review of available Coles information indicated that the buildings were utilized in the past by several retail tenants including an insurance office, a maternity store, a travel agency, a liquor store, a pizzeria, a hair salon, a shoe repair store, real estate office. It was reported that the 3206-3218 property was vacant prior to the construction of the existing building.*

6. Current and Past Uses of the Surrounding Properties:

The past and current use of the adjoining properties is residential and commercial. The property is bordered on three sides by commercial properties and on one side by residential property. The property borders are as follows:

North - The property is bordered to the north by a furniture store.

South - The property is bordered to the south by Montgomery Street and a Nemo's store.

East - The property is bordered to the east by Long Beach Road and a shopping center.

West - The property is bordered to the west by a house.



**BORDER TO THE NORTH**



**BORDER TO THE SOUTH**



**BORDER TO THE EAST**



**BORDER TO THE WEST**

## 7. General Description of Structure;

### *A. Improvements;*

*The site is located at 3206-3224 Long Beach Road in Oceanside, New York. The subject site is .56 acres in size and there are two (2) single story retail buildings on the subject site. The 3206-3218 Long Beach Road building is 5,880 square feet in size and contains a nail salon, a dog groomer, a travel agency, a cellular phone store, a restaurant, an ice cream store and a hair salon. The 3220-3224 Long Beach Road building is 3,750 square feet in size and contains a stationery store and a dry cleaner.*

### *B. Heating and Cooling System;*

*The buildings are heated by natural gas fired heating systems and there are overhead duct heating units in the retail areas.*

### *C. Roads;*

*The subject site is entered via Long Beach Road that is located to the east of the site.*

### *D. Potable Water Supply;*

*The potable water supply comes from the municipal water supply system. There were no on-site drinking water supply wells noticed on the subject site.*

### *E. Sewage Disposal;*

*The building is connected to the municipal sewer system.*

#### **D. RECORD REVIEW:**

##### **1. Standard Environmental Record Source, Federal and State:**

*In preparing this Phase I Environmental Site Assessment Report the following reasonably ascertainable standard environmental record sources were reviewed. Search radii are those that are suggested under ASTM 1527-00.*

<i>Federal NPL Site List (Federal Superfund)</i>	-	<i>Within 1 mile</i>
<i>Federal RCRA-TSD List (Treatment, Storage or Disposal facilities)</i>	-	<i>Within 1 mile</i>
<i>Federal CERCLIS List</i>	-	<i>Within 1/2 mile</i>
<i>Federal RCRA Hazardous Waste Generators List</i>	-	<i>Site &amp; Surrounding Sites</i>
<i>State List of Inactive Hazardous Waste Disposal Sites</i>	-	<i>Within 1 mile</i>
<i>State Leaking Underground Storage Tank (LUST) List</i>	-	<i>Within 1/2 mile</i>
<i>State Landfill Site List</i>	-	<i>Within 1/2 mile</i>
<i>Local Department of Health Records (if accessible for Underground Storage Tanks and Environmental Data)</i>	-	<i>Subject Site</i>
<i>Local Sources</i>	-	<i>Fire Department, Building Department, Water/Electric/Utility Company</i>

## 2. Summary of Environmental Records Review:

### NPL:

*The National Priorities List did not indicate the presence of any USEPA confirmed hazardous waste facilities within a mile radius of the subject site.*

### RCRA-TSD:

*The USEPA RCRA-TSD (Treatment, Storage or Disposal), database did not indicate the presence of any treatment, storage or disposal facilities within a mile radius of the subject site.*

### CERCLIS:

*The USEPA CERCLIS (Comprehensive Environmental Responsibility Cleanup Liability Information Systems), database did not indicate the presence of any treatment, storage or disposal facilities within a half mile radius of the subject site.*

### RCRA HAZARDOUS WASTE GENERATORS LIST:

*The subject site was identified as a RCRA Hazardous Waste Generator (Y&S Cleaners). There were no RCRA Violations noted for this facility. It should be noted that identification of the subject site as a RCRA Hazardous Waste Generator does not necessarily indicate an increased risk of property contamination.*

### STATE HAZARDOUS WASTE SITES:

*There were three (3) New York State Department of Environmental Conservation Inactive Hazardous Waste Sites within a mile radius of the subject site (the Autotronic Products located at 3300 Lawson Boulevard, Hercules Machine Sales at 3188 Lawson Boulevard and Railroad Dry Cleaners at 3180 Lawson Boulevard). All of these sites are located 2/3 of a mile southwest of the subject site and would not have an apparent adverse impact on the subject site.*



#### STATE HAZARDOUS SUBSTANCE WASTE DISPOSAL SITE STUDY:

*A review of the NYSDEC Hazardous Substance Waste Disposal Site Study list did not indicate the presence of any known or suspected hazardous waste sites within a half mile radius of the site.*

#### STATE SPILL LIST:

*The New York State Department of Environmental Conservation (NYSDEC) Spill Information System Database was searched in order to ascertain whether any spill incidents or leaking underground storage tank (LUST), sites were reported within a half mile radius of the subject site. The search indicated that there have not been any reported incidents with regard to the subject site (property located at 3206-3224 Long Beach Road in Oceanside, New York). The search indicated that there were twenty eight (28) leaking underground storage tank sites within a half mile radius of the subject site. The nearest site was located at 3248 Fifth Street (500 feet southeast of the site). This site has been fully remedied and the spill file for this incident has been closed. Neither this site nor any of the other LUST sites would have an apparent adverse impact on the subject site based upon the direction of groundwater flow and distance to the subject site (see Environmental Data section in appendix information regarding the above referenced LUST sites).*

#### STATE LANDFILL SITE LIST:

*The NYSDEC Landfill List was examined in order to determine if there were any known or suspected landfill sites within the vicinity of the subject site. The search indicated that there were no known or suspected landfill sites within a half mile radius of the subject site.*

#### NASSAU COUNTY DEPARTMENT OF HEALTH (NCDH):

*A review of the NCDH Industrial Waste Systems information did not reveal the presence of any registered underground storage tanks on the site or any cases of improper chemical disposal on the subject site. However, a review of the NCDH files indicated that as of the last inspection (in 1998), the owner of the dry cleaner was cited with a violation for operating without a NCDH Article XI permit (for dry cleaners). It is recommended that the owner of the dry cleaner file for a NCDH Article XI permit in order to be in compliance.*



## **E. INFORMATION FROM SITE RECONNAISSANCE AND INTERVIEWS:**

*The purpose of site reconnaissance is to identify any recognized environmental conditions that could adversely affect the property. Mr. Donald J. Middleton Jr. conducted the site reconnaissance on October 15, 2004. The site and the periphery of the site were inspected visually and physically.*

### **1. Physical Site Inspection:**

*The site is located at 3206-3224 Long Beach Road in Oceanside, New York. The subject site is .56 acres in size and there are two (2) single story retail buildings on the subject site. The 3206-3218 Long Beach Road building is 5,880 square feet in size and contains a nail salon, a dog groomer, a travel agency, a cellular phone store, a restaurant, an ice cream store and a hair salon. The 3220-3224 Long Beach Road building is 3,750 square feet in size and contains a stationery store and a dry cleaner.*

*The first areas examined were the retail areas. The retail areas were similar in material design and had 1 by 1 foot vinyl floor tiles as well as carpeted and ceramic tile floors, sheetrock walls and 2 by 4 foot fiberglass ceiling tiles (with sheetrock and wood ceilings atop the ceiling tiles). There were no signs of friable Potential Asbestos Containing Material (PACM), noticed on the overhead pipes inside the building and there were no signs of PACM fireproofing noticed inside the buildings. There were no floor drains, 55 gallon drums, above ground electrical transformers or any signs of severe peeling or flaking paint observed inside the buildings. The dry cleaning machine inside the dry cleaner was properly stored and vented outside the building. There were two (2) 30 gallon containers of perchloroethylene noticed inside the dry cleaner that did not show any signs of staining or leakage. All wastes are carted off-site for disposal by a licensed waste hauler (Safety Kleen), and no wastes are reportedly disposed on-site.*

*The next area examined was the outside grounds. There were no outside above ground electrical transformers or any outside 55 gallon drum storage areas noticed on the subject site. There were no signs of stressed vegetation or soil contamination noticed on the subject site. There were no fuel fill ports or fuel vents noticed on the subject site (such ports or vents could indicate the presence of an underground storage tank on the subject site). There was one (1) 275 gallon above ground heating oil storage tank noticed behind the dry cleaner that did not show any signs of staining or leakage.*



***TRAVEL AGENCY OFFICE AREA***



***AREA TOP CEILING TILES***



***HAIR SALON AREA***



***DRY CLEANING MACHINE***



***DRUMS IN DRY CLEANER***



***HEATING OIL TANK BEHIND BUILDING***

## 2. Current Uses of the Property:

*The current uses are likely to involve the use, treatment, disposal or generation of hazardous substances or petroleum products. There is a dry cleaner on the subject site and small quantities of waste perchloroethylene is generated on the subject site.*

## 3. Past Uses of the Property:

*To the extent that indications of past uses of the property were visually or physically observed on the site visit, or were identified in the interviews or records review, the past uses were likely to involve the use, treatment, storage, disposal or generation of hazardous substances or petroleum products (the generation of waste perchloroethylene is similar to past practices).*

## 4. Potential Asbestos Containing Material (PACM):

*There were no signs of friable Potential Asbestos Containing Material (PACM), noticed inside the buildings.*

## 5. Above Ground Tanks:

*There was one (1) 275 gallon above ground heating oil storage tank noticed behind the dry cleaner that did not show any signs of staining or leakage.*

## 6. PCB's:

*There were no above ground electrical transformers noticed on the subject site.*

## 7. Drums (Interior or Exterior):

*There were two (2) 30 gallon drum of waste perchloroethylene noticed inside the dry cleaner that did not show any signs of leakage. All wastes generated by the dry cleaner are carted off-site for disposal by a licensed waste hauler (Safety Kleen).*

8. Pavement Stains or Corrosion:

*There were no signs of severe staining or corrosion on any floors on the subject site.*

9. Pools of Liquid:

*There were no unusual pools of liquid or sheens detected on the subject site.*

10. Odors:

*There were no strong, pungent or noxious odors with regard to the subject site.*

11. Interior Wall Coverings (if Lead Based Paint is an issue):

*There were no signs of severe peeling or flaking paint observed inside the building.*

12. Radon:

*Radon is a colorless, odorless, radioactive gas. Radon comes from the natural decay of uranium that is found in nearly all soils. Radon typically moves through the ground and into building through cracks and openings in the foundation. The USEPA has developed a "Map of Radon Zones" indicating the levels of radon concentrations from testing and aerial surveys conducted in all counties in New York State. It was determined that Nassau County was designated as a "Zone 3" area where the concentrations are the lowest in the state (see "Map of Radon Zones" in Appendix for more information).*

13. Underground Storage Tanks:

*There were no oil fill ports or fuel vents noticed in the subject site (such ports or vents could indicate the presence of an underground storage tank on the subject site).*

14. Solid Wastes:

*All solid wastes generated on-site are carted away by a licensed waste hauler to an approved solid waste facility and are not disposed on-site. There were no areas on site that appeared to be filled or graded by non-natural causes.*

15. Stressed Vegetation or Stained Soil:

*There were no signs of stressed vegetation or stained soil noticed on the subject site.*

16. Sumps, Pits, Ponds, Lagoons or Wetlands:

*There were no visible sumps, pits, ponds, lagoons or wetlands noticed on the subject site.*

17. Waste Water:

*There were no signs of improper disposal of waste water into drains, ditches or streams on the site.*

18. Wells:

*There were no irrigation wells or any groundwater monitoring wells noticed on the site.*

19. Underground Injection Control (floor drains or interior drywells);

The Federal Environmental Protection Agency Underground Injection Control (UIC) Program is Congressionally mandated under the Safe Drinking Water Act. The UIC Program is designed to prevent any contamination of underground sources of drinking water by any man-made well, drywell or other subsurface hole that is deeper than its largest surface dimension. Generally, State and local regulatory programs implement UIC. Currently, regulatory efforts are concentrating on testing and sealing floor drains in industrial, automobile repair and dry cleaning facilities. It is expected that this initial focus will expand in the near future to include other facilities, drywells, etc.. There were no floor drains observed in the dry cleaner and the dry cleaning machine inside the dry cleaner was properly stored and vented outside the building. All wastes generated by the dry cleaner are carted off-site for disposal by a licensed waste hauler (Safety Kleen). A review of the Nassau County Department of Health's (NCDH), Industrial Waste Systems information did not reveal any cases of improper chemical disposal on the subject site

20. Possibility of Migrating Hazardous Substances;

Due to the distance, groundwater flow direction and nature of the contamination, the nearest known identified hazardous waste site was not judged to have the potential for adversely impacting the subject site.

21. Additional Concerns;

There were no additional concerns with regard to the subject site.

22. Interviews;

The following persons were interviewed with regard to the subject site.

1. Anne Zoll – United Properties Corporation (for site inspection)
2. Vincent Marzullo – Nassau County Department of Assessment (for property information)
3. Michael Sekreta - Nassau County Department of Health (for environmental information)
4. Patty Giangaspro - Coles Information Service (for past property usage information)
5. Manager of travel agency and dry cleaner (names withheld - for site information and access)

**F. FINDINGS AND CONCLUSIONS:**

*We have performed a Phase I Environmental Site Assessment in conformance with the scope and limitations of ASTM Practice E1527 on the property located at 3206-3224 Long Beach Road in Oceanside, New York. This assessment has revealed no evidence of recognized environmental conditions in connection with the property.*

*The site reconnaissance, interviews and review of records have not found the presence or possible presence of hazardous substances or petroleum related products that could indicate an existing release, past release or significant threat of a release into structures on the property, into ground, groundwater or surface water.*

*It is the opinion of Middleton Environmental Incorporated that no further testing (subsurface or otherwise), is required on the subject site.*

**G. SIGNATURES OF ENVIRONMENTAL PROFESSIONALS:**

*This Phase I Environmental Site Assessment report was reviewed by;*



A handwritten signature in black ink, written over a horizontal line. The signature is stylized and appears to be "DJM". Below the signature, the word "Signature" is printed in a small, italicized font.



## H. PROFESSIONALS QUALIFICATIONS:

*MEI Phase I Environmental Site Assessment reports are prepared by or under the supervision of the following professionals:*

### DONALD J. MIDDLETON JR.

*Don Middleton Jr. has been President at Middleton Environmental Incorporated from May 1990 to present. Serves as the manager of the Environmental Site Assessment Program. This program helps lenders to avoid clean-up liability and litigation cost often associated with asbestos and hazardous waste contaminated properties. Conducting and supervising field inspection of the subject property, a regulatory agency search and a survey of past and current property use. A "Phase One" report is then submitted and if analysis shows no sign of contamination, the service is concluded.*

*If contamination is suspected, air water, and soil samples are collected and a report on the laboratory analyses and findings is then submitted. This "Phase Two" report includes mortgage or loan recommendations and clean up costs. Environmental Site Assessments have been prepared for more than 35 lending institutions on Long Island, in the tri-state area and throughout the country. Assessments have also been conducted for real estate & law firms, the FDIC & RTC.*

*Don Jr. received his Bachelors of Science from Fordham University College of Business Administration in May of 1988 (where he completed his undergraduate education in three years). Don Jr. attended Iona College in New Rochelle, New York from September 1985 - May 1986. Don Jr. has also attended the NYU School for Continuing Education where he received his New York State Department of Health Asbestos Investigator & Management Planners Licenses in 1993.*

### DONALD J. MIDDLETON SR.

*Don Middleton was President of Middleton, Kontokosta Associates, an environmental consulting firm he founded in 1984 with offices on Long Island and New York City. Don has more than 20 years of public service experience. He served as Assistant Professor at the Fordham University Graduate School of Social Service at Lincoln Center in 1970 and '71, and was appointed by Mayor John Lindsay to the Mayor's Office of Neighborhood Services from 1972 to '76. From 1976 to 1983, Don served as Long Island Regional Director for the New York State Department of Environmental Conservation, having been appointed by Governor Hugh Carey.*

*Since establishing his firm, Don has directed a number of environmental consulting projects. Over the past seven years Don's firm has specialized in preparing Environmental Site Assessments to assist banks, the FDIC and the RTC to assess and avoid clean-up liability and litigation costs associated with contaminated properties. Don's firm has also been involved in major environmental impact studies for state and local governmental agencies and a number of private clients. Don's firm's clients include more than thirty banks and a range of private clients, including Browning-Ferris Industries and the Rolite Corporation. Don has been a member of the Board of the Long Island Association since 1985 and serves as Chairman of the Association's Environment and Energy Committee. He has served on the Board of Directors of the New York League of Conservation Voters, the Board of the Museum of Long Island Natural Science, and as Chairman of the Town of Babylon Board of Assessment Review.*

*Don has both his Bachelor of Science degree and Masters degree from Fordham University.*

## **I. APPENDICES:**

*The following sources were utilized in order to determine the physical setting of the subject site, current and past usage of the site and are researched in order to evaluate and recognized environmental conditions that might have an adverse affect on the subject site.*

- A. USGS 7.5 Minute Topographic Map*
- B. Zoning/Land Use Records*
- C. Department of Assessment Records*
- D. Sanborn or Belcher-Hyde Fire Insurance Maps (if available)*
- E. Coles Directory*
- F. Aerial Photographs*
- G. Local Street Directories*
- H. Building Department Records*
- I. Prior Environmental Site Assessment*
- J. Soils Conditions Report (from the U.S.G.S. Soil Conservation Service)*
- K. Groundwater Conditions (U.S.G.S. Groundwater Flow Map)*

**ENVIRONMENTAL DATA (SUPPLIED BY FIRSTSEARCH TECHNOLOGY)**

# ***FirstSearch Technology Corporation***

## **Environmental FirstSearch<sup>™</sup> Report**

**TARGET PROPERTY:**

**3206 LONG BEACH ROAD**

**OCEANSIDE NY 11572**

Job Number: 04-678

**PREPARED FOR:**

Middleton Environmental, Inc.

181 West Main Street, Suite 102

Babylon, NY 11702

10-22-04



*Tel: (201) 848-4789*

*Fax: (201) 848-4789*

# *Environmental FirstSearch* *Search Summary Report*

**Target Site:** 3206 LONG BEACH ROAD  
OCEANSIDE NY 11572

## FirstSearch Summary

Database	Sel	Updated	Radius	Site	1/8	1/4	1/2	1/2>	ZIP	TOTALS
NPL	Y	09-13-04	1.00	0	0	0	0	0	0	0
CERCLIS	Y	09-13-04	0.50	0	0	0	0	-	0	0
NFRAP	Y	06-23-04	0.25	0	0	0	-	-	0	0
RCRA TSD	Y	07-12-04	0.50	0	0	0	0	-	0	0
RCRA COR	Y	07-12-04	1.00	0	0	0	0	0	0	0
RCRA GEN	Y	07-12-04	0.25	1	1	1	-	-	0	3
ERNS	Y	12-31-03	0.15	0	1	0	-	-	0	1
State Sites	Y	07-01-04	1.00	0	0	0	0	3	0	3
Spills-1990	Y	08-27-04	0.50	0	6	20	59	-	13	98
Spills-1980	Y	10-18-00	0.50	1	1	6	12	-	8	28
SWL	Y	01-01-04	0.50	0	0	0	0	-	0	0
REG UST/AST	Y	01-01-02	0.25	0	3	9	-	-	3	15
Leaking UST	Y	08-27-04	0.50	0	2	6	19	-	1	28
- TOTALS -				2	14	42	90	3	25	176

### Notice of Disclaimer

Due to the limitations, constraints, inaccuracies and incompleteness of government information and computer mapping data currently available to FirstSearch Technology Corp., certain conventions have been utilized in preparing the locations of all federal, state and local agency sites residing in FirstSearch Technology Corp.'s databases. All EPA NPL and state landfill sites are depicted by a rectangle approximating their location and size. The boundaries of the rectangles represent the eastern and western most longitudes; the northern and southern most latitudes. As such, the mapped areas may exceed the actual areas and do not represent the actual boundaries of these properties. All other sites are depicted by a point representing their approximate address location and make no attempt to represent the actual areas of the associated property. Actual boundaries and locations of individual properties can be found in the files residing at the agency responsible for such information.

### Waiver of Liability

Although FirstSearch Technology Corp. uses its best efforts to research the actual location of each site, FirstSearch Technology Corp. does not and can not warrant the accuracy of these sites with regard to exact location and size. All authorized users of FirstSearch Technology Corp.'s services proceeding are signifying an understanding of FirstSearch Technology Corp.'s searching and mapping conventions, and agree to waive any and all liability claims associated with search and map results showing incomplete and or inaccurate site locations.

## Environmental FirstSearch

**Request Date:** 10-22-04  
**Requestor Name:** Amy M. Colichio  
**Standard:** AMY

**Search Type:** COORD  
**Job Number:** 04-678  
**Filtered Report**

**TARGET ADDRESS:** 3206 LONG BEACH ROAD  
OCEANSIDE NY 11572

## Demographics

**Sites:** 176                      **Non-Geocoded:** 25                      **Population:** NA  
**Radon:** OF THE 10 HOMES TESTED, THE AVG. PCI/L LEVEL WAS .8

### Site Location

	<u>Degrees (Decimal)</u>	<u>Degrees (Min/Sec)</u>	<u>UTMs</u>
<b>Longitude:</b>	-73.640293	-73:38:25	<b>Easting:</b> 614989.523
<b>Latitude:</b>	40.633339	40:38:0	<b>Northing:</b> 4498732.897
			<b>Zone:</b> 18

*Comment*

**Comment:**

### *Additional Requests/Services*

**Adjacent ZIP Codes:** 0 Mile(s)

**Services:**

ZIP Code	City Name	ST	Dist/Dir	Sel

	Requested?	Date
Sanborns	No	
Aerial Photographs	No	
Topographical Maps	No	
City Directories	No	
Title Search	No	
Municipal Reports	No	
Online Topos	No	









**Environmental FirstSearch**  
.5 Mile Radius  
ASTM Map: CERCLIS, RCRATSD, LUST, SWL



**3206 LONG BEACH ROAD, OCEANSIDE NY 11572**



Source: 2002 U.S. Census TIGER Files

Target Site (Latitude: 40.633339 Longitude: -73.640293) .....   
Identified Site, Multiple Sites, Receptor .....     
NPL, Brownfield, Solid Waste Landfill (SWL) or Hazardous Waste .....   
Railroads ..... 

Black Rings Represent 1/4 Mile Radii; Red Ring Represents 500 ft. Radius



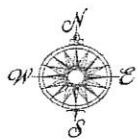

**Environmental FirstSearch**  
1 Mile Radius  
ASTM Map: NPL, RCRACOR, STATE Sites



**3206 LONG BEACH ROAD, OCEANSIDE NY 11572**



Source: 2002 U.S. Census TIGER Files

Target Site (Latitude: 40.633339 Longitude: -73.640293) .....

Identified Site, Multiple Sites, Receptor .....

NPL, Brownfield, Solid Waste Landfill (SWL) or Hazardous Waste .....

Railroads .....

Black Rings Represent 1/4 Mile Radii; Red Ring Represents 500 ft. Radius



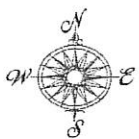

# Environmental FirstSearch

.25 Mile Radius

ASTM Map: RCRAGEN, ERNS, UST



3206 LONG BEACH ROAD, OCEANSIDE NY 11572

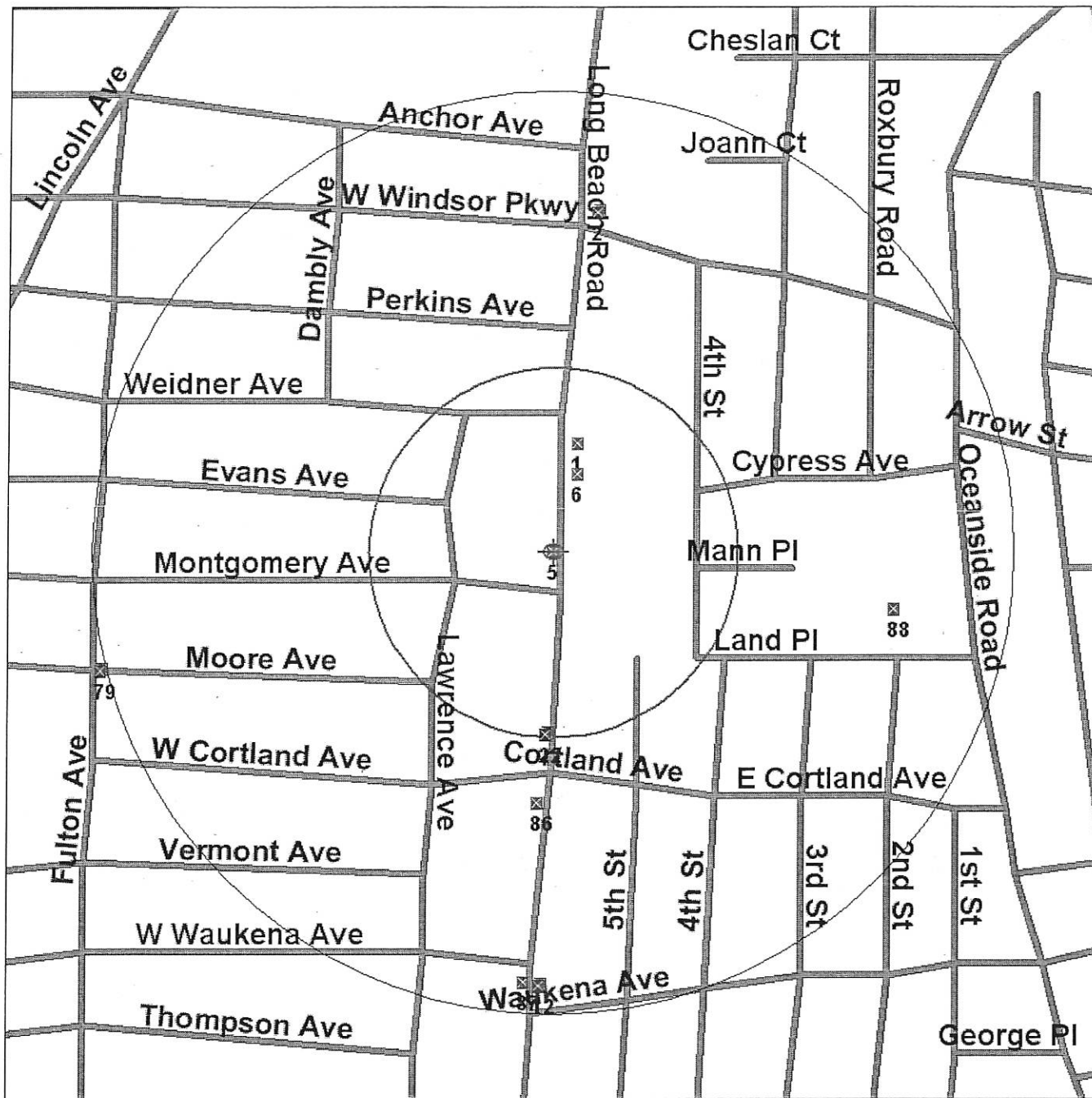

Source: 2002 U.S. Census TIGER Files

Target Site (Latitude: 40.633339 Longitude: -73.640293) .....

Identified Site, Multiple Sites, Receptor .....

NPL, Brownfield, Solid Waste Landfill (SWL) or Hazardous Waste .....

Railroads .....

Black Rings Represent 1/4 Mile Radii; Red Ring Represents 500 ft. Radius



# Environmental FirstSearch

.5 Mile Radius

Non-ASTM Map: Spills 90, Spills 80



3206 LONG BEACH ROAD, OCEANSIDE NY 11572



Source: 2002 U.S. Census TIGER Files

- Target Site (Latitude: 40.633339 Longitude: -73.640293) .....
- Identified Site, Multiple Sites, Receptor .....
- NPL, Brownfield, Solid Waste Landfill (SWL) or Hazardous Waste .....
- National Historic Sites and Landmark Sites .....
- Soil Sites .....
- Railroads .....

Black Rings Represent 1/4 Mile Radii; Red Ring Represents 500 ft. Radius

# Environmental FirstSearch

## Sites Summary Report

**TARGET SITE:** 3206 LONG BEACH ROAD  
OCEANSIDE NY 11572

**JOB:** 04-678

**TOTAL:** 176      **GEOCODED:** 151      **NON GEOCODED:** 25      **SELECTED:** 11

Map ID	DB Type	Site Name/ID/Status	Address	Dist/Dir	Page No.
6	ERNS	JES-EL CLEANERS 164367/UNKNOWN	3193 LONG BEACH RD OCEANSIDE NY 11572	0.04 NE	N/A
23	LUST	COHN RESIDENCE 0108339/CLOSED 03/05/2003	3248 FIFTH STREET OCEANSIDE NY 11572	0.09 SE	N/A
22	LUST	<b>CLOSED BUSINESS</b> <b>0011285/ACTIVE</b>	<b>3274 LONG BEACH ROAD</b> <b>OCEANSIDE NY 11572</b>	<b>0.10 SW</b>	<b>1</b>
31	LUST	EIDELMAN RESIDENCE 9705594/CLOSED 05/21/1999	57 EVANS AVENUE OCEANSIDE NY 11572	0.15 NW	N/A
28	LUST	DESIMONE RESIDENCE 9010960/CLOSED 05/21/1991	99 WEST CORTLAND AVENUE OCEANSIDE NY 11572	0.18 SW	N/A
2	LUST	SHELL S/S 9300580/CLOSED 05/20/1993	3121 LONG BEACH ROAD OCEANSIDE NY 11572	0.19 NE	N/A
2	LUST	SHELL OIL 8807234/CLOSED	LONG BEACH RD & WINDSOR OCEANSIDE NY 11572	0.19 NE	N/A
27	LUST	DAVID SOLOMON RESIDENCE 0225127/CLOSED	3159 OCEANSIDE AVENUE OCEANSIDE NY 11572	0.25 NE	N/A
79	LUST	<b>OCEANSIDE SCHOOL DISTRICT</b> <b>8906786/ACTIVE</b>	<b>FULTON AVE &amp; MOORE AVENUE</b> <b>OCEANSIDE NY 11572</b>	<b>0.25 SW</b>	<b>2</b>
18	LUST	<b>BILL GRIESHABER RESIDENCE</b> <b>9501253/ACTIVE</b>	<b>166 MONTGOMERY AVE</b> <b>OCEANSIDE NY 11572</b>	<b>0.30 SW</b>	<b>3</b>
81	LUST	ST ANTHONYS CHURCH 8710651/CLOSED	110 ANKER AVENUE OCEANSIDE NY 11572	0.32 NW	N/A
36	LUST	GOMEZ RESIDENCE 9901717/CLOSED 08/27/1999	143 ANCHOR AVENUE OCEANSIDE NY 11572	0.36 NW	N/A
4	LUST	EXXON USA 9202964/CLOSED 10/25/1994	2962 LONG BEACH ROAD OCEANSIDE NY 11572	0.38 NE	N/A
4	LUST	EXXON 9011400/CLOSED 03/26/1991	2962 LONG BEACH ROAD OCEANSIDE NY 11572	0.38 NE	N/A
14	LUST	AMOCO SERVICE STATION 9410975/CLOSED 07/20/1995	210 ATLANTIC AVENUE OCEANSIDE NY 11572	0.41 NE	N/A
77	LUST	EAST NY SAVINGS BANK 8707422/CLOSED	12 ATLANTIC AVENUE OCEANSIDE NY 11572	0.41 NW	N/A
37	LUST	GUARINO RESIDENCE 9714581/CLOSED 04/07/1998	250 EVANS AVENUE OCEANSIDE NY 11572	0.41 NW	N/A
17	LUST	BEY RESIDENCE 9914033/CLOSED 07/06/2000	2967 TRINITY STREET OCEANSIDE NY 11572	0.42 NE	N/A
49	LUST	<b>MOBIL</b> <b>9004003/ACTIVE</b>	<b>3438 LONG BEACH ROAD</b> <b>OCEANSIDE NY 11572</b>	<b>0.42 SE</b>	<b>4</b>
20	LUST	BRODY RESIDENCE 9312514/CLOSED 12/18/1995	38 CONCORD AVENUE OCEANSIDE NY 11572	0.42 SW	N/A
11	LUST	ALHAMBRA CONDO 9505562/CLOSED 08/12/2002	ALHAMBRA DRIVE OCEANSIDE NY 11572	0.46 SW	N/A

# Environmental FirstSearch

## Sites Summary Report

**TARGET SITE:** 3206 LONG BEACH ROAD  
OCEANSIDE NY 11572

**JOB:** 04-678

**TOTAL:** 176      **GEOCODED:** 151      **NON GEOCODED:** 25      **SELECTED:** 11

Map ID	DB Type	Site Name/ID/Status	Address	Dist/Dir	Page No.
11	LUST	ALLAHAMBRA CONDO S 9105661/CLOSED 12/26/1991	ALLAHAMBRA DRIVE OCEANSIDE NY 11572	0.46 SW	N/A
11	LUST	ALHAMBRA CONDO S 9307485/CLOSED 08/12/2002	ALHAMBRA DRIVE OCEANSIDE NY 11572	0.46 SW	N/A
11	LUST	ALLAHABRA CONDO S 9105807/CLOSED 12/26/1991	ALLAHAMBRA DRIVE OCEANSIDE NY 11572	0.46 SW	N/A
11	LUST	ALHAMBRA CONDO 9307618/CLOSED 12/02/1998	ALHAMBRA DRIVE OCEANSIDE NY 11572	0.46 SW	N/A
45	LUST	MOBIL SVC STAT #17-K7Q 9609604/CLOSED 10/05/2001	3483 LONG BEACH ROAD OCEANSIDE NY 11572	0.47 SE	N/A
45	LUST	MOBIL SERVICE STATION 9800779/CLOSED 10/05/2001	3483 LONG BEACH ROAD OCEANSIDE NY 11570	0.47 SE	N/A
74	LUST	BONNIE TROY 8906850/CLOSED	3417 FIRST STREET OCEANSIDE NY 11572	0.49 SE	N/A
	LUST	AMTEC (AKA CHEVRON) 8200280/ACTIVE	LONG BEACH ROAD OCEANSIDE NY 11572	NON GC	5
5	RCRAGN	Y & S CLEANERS NYD986985562/SGN	3220 LONG BEACH RD OCEANSIDE NY 11572	0.00 -	6
1	RCRAGN	JEF EL CLEANERS NYD981137177/SGN	3181 LONG BRANCH RD OCEANSIDE NY 11572	0.06 NE	N/A
2	RCRAGN	SHELL SERVICE STATION NYD986886505/SGN	3121 LONG BEACH RD OCEANSIDE NY 11572	0.19 NE	N/A
7	STATE	AUTOTRONIC PRODUCTS, INC. 130030	3300 LAWSON BOULEVARD OCEANSIDE NY 11572	0.68 SW	7
8	STATE	HERCULES MACHINE SALES COMPANY 130083	3188 LAWSON BOULEVARD OCEANSIDE NY 11572	0.69 NW	9
9	STATE	RAILROAD DRY CLEANERS 130066	3180 LAWSON BOULEVARD OCEANSIDE NY 11572	0.70 NW	11
35	SPILLS	GM REALTY 9106727/CLOSED 01/02/1992	3224 LONG BEACH ROAD OCEANSIDE NY 11572	0.01 S-	13
51	SPILLS	PARKING LOT-TJ MAXX 9610198/CLOSED 11/18/1996	3221 LONG BEACH ROAD OCEANSIDE NY 11572	0.01 SE	N/A
23	SPILLS	COHN RESIDENCE 0108339/CLOSED 03/05/2003	3248 FIFTH STREET OCEANSIDE NY 11572	0.09 SE	N/A
22	SPILLS	GIBRALTAR TRANSMISSIONS 9925364/CLOSED 02/15/2000	3274 LONG BEACH ROAD OCEANSIDE NY 11572	0.10 SW	N/A
22	SPILLS	GEAR TRANSMISSIONS 9103239/CLOSED 07/13/2000	3274 LONG BEACH ROAD OCEANSIDE NY 11572	0.10 SW	N/A
22	SPILLS	CLOSED BUSINESS 0011285/ACTIVE	3274 LONG BEACH ROAD OCEANSIDE NY 11572	0.10 SW	N/A

# *Environmental FirstSearch*

## *Sites Summary Report*

**TARGET SITE:** 3206 LONG BEACH ROAD  
OCEANSIDE NY 11572

**JOB:** 04-678

**TOTAL:** 176      **GEOCODED:** 151      **NON GEOCODED:** 25      **SELECTED:** 11

Map ID	DB Type	Site Name/ID/Status	Address	Dist/Dir	Page No.
38	SPILLS	LAZAREIS RESIDENCE 9413794/CLOSED 01/18/1995	3274 5TH STREET OCEANSIDE NY 11572	0.13 SE	N/A
31	SPILLS	EIDELMAN RESIDENCE 9705594/CLOSED 05/21/1999	57 EVANS AVENUE OCEANSIDE NY 11572	0.15 NW	N/A
31	SPILLS	HOWIE EIDELMAN RESIDENCE 9611145/CLOSED 07/27/2001	57 EVANS AVENUE OCEANSIDE NY 11572	0.15 NW	N/A
41	SPILLS	LIDRIZZI RESIDENCE 9506224/CLOSED 08/21/1995	41 PERKINS AVENUE OCEANSIDE NY 11572	0.16 NW	N/A
59	SPILLS	UNK 9301571/CLOSED 05/05/1993	LONG BEACH RD & WINDSOR P OCEANSIDE NY 11572	0.18 NE	N/A
28	SPILLS	DESIMONE RESIDENCE 9010960/CLOSED 05/21/1991	99 WEST CORTLAND AVENUE OCEANSIDE NY 11572	0.18 SW	N/A
2	SPILLS	SHELL S/S 9300580/CLOSED 05/20/1993	3121 LONG BEACH ROAD OCEANSIDE NY 11572	0.19 NE	N/A
2	SPILLS	SHELL GAS STATION 0206303/ACTIVE	3121 LONG BEACH ROAD OCEANSIDE NY 11572	0.19 NE	N/A
55	SPILLS	SHA RESIDENCE 0010832/CLOSED 02/04/2004	3118 LONG BEACH ROAD OCEANSIDE NY 11572	0.19 NE	N/A
33	SPILLS	GEE BEE S COLLISION 9308444/CLOSED 11/09/1993	3314 LONG BEACH ROAD OCEANSIDE NY 11572	0.19 SW	N/A
68	SPILLS	0302352/ACTIVE	3122 LONG BEACH ROAD OCEANSIDE NY 11572	0.20 NE	N/A
73	SPILLS	0008219/CLOSED 11/01/2000	3168 TRINITY STREET OCEANSIDE NY 11572	0.22 NE	N/A
50	SPILLS	OK PETRO 9313888/CLOSED 02/28/1994	PANKER AVE/LONG BEACH RD OCEANSIDE NY 11572	0.22 NE	N/A
30	SPILLS	DOYLE WHITEMAN 9504467/CLOSED 06/30/1999	W WAUKENA AVE&LONG BCH RD OCEANSIDE NY 11572	0.22 SW	N/A
60	SPILLS	UNK 9410777/CLOSED 02/12/1998	3098 LONG BEACH ROAD OCEANSIDE NY 11572	0.23 NE	N/A
12	SPILLS	PRECISION TUNE 9304341/CLOSED 02/24/1995	3337 LONG BEACH ROAD OCEANSIDE NY 11572	0.23 SW	N/A
12	SPILLS	AMOCO 8201037/CLOSED	3337 LONG BEACH ROAD OCEANSIDE NY 11572	0.23 SW	N/A
27	SPILLS	DAVID SOLOMON RESIDENCE 0225127/CLOSED	3159 OCEANSIDE AVENUE OCEANSIDE NY 11572	0.25 NE	N/A
15	SPILLS	ARTIES REPAIR SHOP 9309504/CLOSED 12/08/1993	50 ANCHOR AVE OCEANSIDE NY 11572	0.25 NW	N/A
19	SPILLS	BRENNAN RESIDENCE 9314830/CLOSED 03/21/1994	43 WEST WAUKENA AVE OCEANSIDE NY 11572	0.25 SW	N/A



# Environmental FirstSearch

## Sites Summary Report

**TARGET SITE:** 3206 LONG BEACH ROAD  
OCEANSIDE NY 11572

**JOB:** 04-678

**TOTAL:** 176      **GEOCODED:** 151      **NON GEOCODED:** 25      **SELECTED:** 11

Map ID	DB Type	Site Name/ID/Status	Address	Dist/Dir	Page No.
21	SPILLS	CANNET RESIDENCE 9713341/CLOSED 11/30/1998	3308 SECOND STREET OCEANSIDE NY 11572	0.26 SE	N/A
25	SPILLS	CUMBERLAND FARMS/CHEVRON 9406346/ACTIVE	3345 LONG BEACH ROAD OCEANSIDE NY 11572	0.26 SW	N/A
42	SPILLS	LILCO 9213392/CLOSED 03/05/1993	98 VERMONT AVENUE OCEANSIDE NY 11572	0.26 SW	N/A
47	SPILLS	MCMISH RESIDENCE 9004525/CLOSED 08/09/1990	69 ANCHOR AVENUE OCEANSIDE NY 11572	0.27 NW	N/A
65	SPILLS	WEINTROUB 9209366/CLOSED 06/14/2004	70 WEST WAUKENA AVENUE OCEANSIDE NY 11572	0.27 SW	N/A
44	SPILLS	LILCO TRUCK 9214383/CLOSED 03/31/1993	103 VERMONT AVENUE OCEANSIDE NY 11572	0.27 SW	N/A
64	SPILLS	WALL RESIDENCE 9413251/CLOSED 01/05/1995	3300 1ST OCEANSIDE NY 11572	0.28 SE	N/A
39	SPILLS	LEONETTI RESIDENCE 9705445/CLOSED 06/30/2004	3351 4TH STREET OCEANSIDE NY 11572	0.29 SE	N/A
43	SPILLS	LILCO 9309018/CLOSED 01/04/1994	3361 4TH STREET OCEANSIDE NY 11572	0.30 SE	N/A
18	SPILLS	BILL GRIESHABER RESIDENCE 9501253/ACTIVE	166 MONTGOMERY AVE OCEANSIDE NY 11572	0.30 SW	N/A
40	SPILLS	LEVINE RESIDENCE 0101401/CLOSED 02/11/2004	3287 OCEANSIDE ROAD OCEANSIDE NY 11572	0.31 SE	N/A
26	SPILLS	DAVE NEGRIN RESIDENCE 9310702/CLOSED 05/19/1997	3259 PERRY AVENUE OCEANSIDE NY 11572	0.31 SE	N/A
69	SPILLS	9809514/CLOSED 05/06/2003	LONG BEACH ROAD OCEANSIDE NY 11572	0.31 SW	N/A
52	SPILLS	PODAIR RESIDENCE 9311676/CLOSED 01/04/1994	91 CAMPBELL AVE OCEANSIDE NY 11572	0.32 NE	N/A
54	SPILLS	RESIDENCE 9814923/CLOSED 10/01/2002	10 MAHLAND PLACE OCEANSIDE NY 11572	0.32 NW	N/A
46	SPILLS	LORSCH RESIDENCE 9012084/CLOSED 02/20/1991	100 THOMPSON AVENUE OCEANSIDE NY 11572	0.33 SW	N/A
72	SPILLS	0313423/CLOSED	OCEANSIDE RD/CAMPBELL OCEANSIDE NY 11572	0.36 NE	N/A
70	SPILLS	0404940/ACTIVE	210 ARROW STREET OCEANSIDE NY 11572	0.36 NE	N/A
36	SPILLS	GOMEZ RESIDENCE 9901717/CLOSED 08/27/1999	143 ANCHOR AVENUE OCEANSIDE NY 11572	0.36 NW	N/A
4	SPILLS	EXXON 9011400/CLOSED 03/26/1991	2962 LONG BEACH ROAD OCEANSIDE NY 11572	0.38 NE	N/A



# Environmental FirstSearch

## Sites Summary Report

**TARGET SITE:** 3206 LONG BEACH ROAD  
OCEANSIDE NY 11572

**JOB:** 04-678

**TOTAL:** 176      **GEOCODED:** 151      **NON GEOCODED:** 25      **SELECTED:** 11

Map ID	DB Type	Site Name/ID/Status	Address	Dist/Dir	Page No.
4	SPILLS	EXXON 0311973/CLOSED	2962 LONG BEACH ROAD OCEANSIDE NY 11572	0.38 NE	N/A
4	SPILLS	EXXON USA 9202964/CLOSED 10/25/1994	2962 LONG BEACH ROAD OCEANSIDE NY 11572	0.38 NE	N/A
32	SPILLS	FRED ZUCKER RESIDENCE 0301247/CLOSED	3053 OCEANSIDE ROAD OCEANSIDE NY 11572	0.38 NE	N/A
48	SPILLS	MEINEKE MUFFLER 9925059/CLOSED 10/06/1999	3401 LONG BEACH ROAD OCEANSIDE NY 11572	0.38 SW	N/A
56	SPILLS	SUNOCO OIL 9007564/CLOSED 03/14/1996	3414 LONG BEACH ROAD OCEANSIDE NY 11572	0.39 SW	N/A
56	SPILLS	SUNOCO S/S 9005549/CLOSED 12/13/1990	3414 LONG BEACH ROAD OCEANSIDE NY 11572	0.39 SW	N/A
66	SPILLS	0211524/CLOSED	LONG BEACH RD/EAST ATLANT OCEANSIDE NY 11572	0.40 NE	N/A
66	SPILLS	0403413/CLOSED	LONG BEACH RD/ATLANTIC AV OCEANSIDE NY 11572	0.40 NE	N/A
62	SPILLS	UNK AUTO BODY SHOP 9203090/CLOSED 06/15/1992	3050 OCEANSIDE ROAD OCEANSIDE NY 11572	0.40 NE	N/A
16	SPILLS	BEDELL CREEK 0325018/ACTIVE	END OF ARROW STREET OCEANSIDE NY 11572	0.41 NE	N/A
14	SPILLS	AMOCO SERVICE STATION 9410975/CLOSED 07/20/1995	210 ATLANTIC AVENUE OCEANSIDE NY 11572	0.41 NE	N/A
29	SPILLS	DOLAN RESIDENCE 0400820/CLOSED	244 EVANS AVENUE OCEANSIDE NY 11572	0.41 NW	N/A
37	SPILLS	GUARINO RESIDENCE 9714581/CLOSED 04/07/1998	250 EVANS AVENUE OCEANSIDE NY 11572	0.41 NW	N/A
17	SPILLS	BEY RESIDENCE 9914033/CLOSED 07/06/2000	2967 TRINITY STREET OCEANSIDE NY 11572	0.42 NE	N/A
3	SPILLS	HGE S/S SPARTAN PETROL 9013297/CLOSED 07/07/2003	65 ATLANTIC AVENUE OCEANSIDE NY 11572	0.42 NW	N/A
49	SPILLS	MOBIL 9004003/ACTIVE	3438 LONG BEACH ROAD OCEANSIDE NY 11572	0.42 SE	N/A
20	SPILLS	BRODY RESIDENCE 9312514/CLOSED 12/18/1995	38 CONCORD AVENUE OCEANSIDE NY 11572	0.42 SW	N/A
34	SPILLS	GENERAL ENV SVCS 9409577/CLOSED 02/16/1995	3091 XAVIER PLACE OCEANSIDE NY 11572	0.43 NE	N/A
53	SPILLS	RESIDENCE 9612036/CLOSED 04/21/1997	229 WEST WAUKENA AVENUE OCEANSIDE NY 11572	0.43 SW	N/A
61	SPILLS	UNK 9310246/CLOSED 09/29/1995	KENNETH PL & ATLANTIC AVE OCEANSIDE NY 11572	0.44 NW	N/A

# Environmental FirstSearch

## Sites Summary Report

**TARGET SITE:** 3206 LONG BEACH ROAD  
OCEANSIDE NY 11572

**JOB:** 04-678

**TOTAL:** 176      **GEOCODED:** 151      **NON GEOCODED:** 25      **SELECTED:** 11

Map ID	DB Type	Site Name/ID/Status	Address	Dist/Dir	Page No.
13	SPILLS	AMOCO S/S 9411655/CLOSED 12/30/1994	ATLANTIC AVE/LINCOLN OCEANSIDE NY 11572	0.44 NW	N/A
67	SPILLS	0308355/ACTIVE	3411 LONG BEACH ROAD OCEANSIDE NY 11572	0.44 SE	N/A
57	SPILLS	UNK 9211968/CLOSED 10/30/1997	3451 4TH STREET OCEANSIDE NY 11572	0.46 SE	N/A
11	SPILLS	ALHAMBRA CONDO 9307618/CLOSED 12/02/1998	ALHAMBRA DRIVE OCEANSIDE NY 11572	0.46 SW	N/A
11	SPILLS	ALHAMBRA CONDO S 9307485/CLOSED 08/12/2002	ALHAMBRA DRIVE OCEANSIDE NY 11572	0.46 SW	N/A
11	SPILLS	ALLAHABRA CONDO S 9105807/CLOSED 12/26/1991	ALLAHAMBRA DRIVE OCEANSIDE NY 11572	0.46 SW	N/A
11	SPILLS	ALHAMBRA CONDO 9505562/CLOSED 08/12/2002	ALHAMBRA DRIVE OCEANSIDE NY 11572	0.46 SW	N/A
11	SPILLS	ALLAHAMBRA CONDO S 9105661/CLOSED 12/26/1991	ALLAHAMBRA DRIVE OCEANSIDE NY 11572	0.46 SW	N/A
45	SPILLS	MOBIL S/S 9102554/CLOSED 11/07/1991	LONG BEACH & MOTT OCEANSIDE NY 11572	0.47 SE	N/A
45	SPILLS	MOBIL SVC STAT #17-K7Q 9609604/CLOSED 10/05/2001	3483 LONG BEACH ROAD OCEANSIDE NY 11572	0.47 SE	N/A
45	SPILLS	MOBIL SERVICE STATION 9800779/CLOSED 10/05/2001	3483 LONG BEACH ROAD OCEANSIDE NY 11570	0.47 SE	N/A
45	SPILLS	LONG BEACH & MOTT SERVICE 0205363/ACTIVE	3483 LONG BEACH ROAD OCEANSIDE NY 11570	0.47 SE	N/A
63	SPILLS	VILLEROA RESIDENCE 0312274/ACTIVE	236 WEST HENRIETTA AVE OCEANSIDE NY 11572	0.47 SW	N/A
71	SPILLS	0010768/CLOSED 12/28/2000	275 BAYARD STREET OCEANSIDE NY 11572	0.48 SE	N/A
10	SPILLS	ALS AUTO CONCEPTS 9211904/CLOSED 02/12/1999	2975 MILL STREET OCEANSIDE NY 11572	0.49 NE	N/A
10	SPILLS	AL S AUTO CONCEPT 9009684/CLOSED 12/14/1990	2975 MILLS STREET OCEANSIDE NY 11572	0.49 NE	N/A
24	SPILLS	CUOCO RESIDENCE 9912211/CLOSED 01/24/2000	159 CHAMBERLIN STREET OCEANSIDE NY 11572	0.50 SE	N/A
58	SPILLS	UNK 9302445/CLOSED 01/14/1994	226 EAST WAUKENA AVE OCEANSIDE NY 11572	0.50 SE	N/A
24	SPILLS	COUCO RESIDENCE 9601392/CLOSED 05/28/1997	159 CHAMBERLAIN STREET OCEANSIDE NY 11572	0.50 SE	N/A
	SPILLS	LILCO 9008930/CLOSED 11/15/1990	LONG BEACH ROAD OCEANSIDE NY 11572	NON GC	N/A

# Environmental FirstSearch

## Sites Summary Report

**TARGET SITE:** 3206 LONG BEACH ROAD  
OCEANSIDE NY 11572

**JOB:** 04-678

**TOTAL:** 176      **GEOCODED:** 151      **NON GEOCODED:** 25      **SELECTED:** 11

Map ID	DB Type	Site Name/ID/Status	Address	Dist/Dir	Page No.
	SPILLS	RICHARD DIGILLO 9001946/CLOSED 05/20/1990	LONG BEACH ROAD OCEANSIDE NY 11572	NON GC	N/A
	SPILLS	UNK VEHICLE 9800972/CLOSED 04/24/1998	OCEANSIDE ROAD OCEANSIDE NY 11572	NON GC	N/A
	SPILLS	0103536/CLOSED 12/24/2003	LONG BEACH ROAD OCEANSIDE NY 11572	NON GC	N/A
	SPILLS	TEXAS RANGER 9003195/CLOSED 06/22/1990	LONG BEACH ROAD OCEANSIDE NY 11572	NON GC	N/A
	SPILLS	AMTEC (AKA CHEVRON) 8200280/ACTIVE	LONG BEACH ROAD OCEANSIDE NY 11572	NON GC	N/A
	SPILLS	9412382/CLOSED 12/16/1994	LAWRENCE AVENUE OCEANSIDE NY 11572	NON GC	N/A
	SPILLS	9607211/CLOSED 09/09/1996	ATLANTIC BEACH BRIDGE OCEANSIDE NY 00000	NON GC	N/A
	SPILLS	0005754/CLOSED 08/14/2000	ATLANTIC AVENUE OCEANSIDE NY 11572	NON GC	N/A
	SPILLS	9909053/CLOSED 10/27/1999	2962 ATLANTIC AVENUE OCEANSIDE NY 11572	NON GC	N/A
	SPILLS	TIRE TOWN INC 0401432/ACTIVE	LONG BEACH ROAD OCEANSIDE NY	NON GC	N/A
	SPILLS	LILCO 9004980/CLOSED 08/06/1990	OCEANSIDE ROAD OCEANSIDE NY 11572	NON GC	N/A
	SPILLS	UNK 9400369/CLOSED 06/20/1994	LONG BEACH ROAD OCEANSIDE NY 11572	NON GC	N/A
84	SPILLS80	UNK 8702234/CLOSED	3218 LONG BEACH ROAD OCEANSIDE NY 11572	0.00 --	14
80	SPILLS80	PETE PETRAUSKAS 8908469/CLOSED	LONG BEACH RD/W CORTLAND OCEANSIDE NY 11572	0.12 SE	N/A
2	SPILLS80	OLYMPIC 8908819/CLOSED	3121 LONG BEACH ROAD OCEANSIDE NY 11572	0.19 NE	N/A
2	SPILLS80	SHELL OIL COMPANY 8907062/CLOSED	LONG BEACH RD & WINDSOR OCEANSIDE NY 11572	0.19 NE	N/A
2	SPILLS80	SHELL OIL 8807234/CLOSED	LONG BEACH RD & WINDSOR OCEANSIDE NY 11572	0.19 NE	N/A
82	SPILLS80	TIMOTHY CECERA 8901471/CLOSED	3149 TRINITY STREET OCEANSIDE NY 11572	0.22 NE	N/A
75	SPILLS80	CAMILLE HERBACZEWSKI 8908733/CLOSED	3322 FIFTH STREET OCEANSIDE NY 11572	0.22 SE	N/A
79	SPILLS80	OCEANSIDE SCHOOL DISTRICT 8906786/ACTIVE	FULTON AVE & MOORE AVENUE OCEANSIDE NY 11572	0.25 SW	N/A

# Environmental FirstSearch

## Sites Summary Report

**TARGET SITE:** 3206 LONG BEACH ROAD  
OCEANSIDE NY 11572

**JOB:** 04-678

**TOTAL:** 176      **GEOCODED:** 151      **NON GEOCODED:** 25      **SELECTED:** 11

Map ID	DB Type	Site Name/ID/Status	Address	Dist/Dir	Page No.
85	SPILLS80	WHALEN 8903076/CLOSED	95 WEST WINDSOR PARKWAY OCEANSIDE NY 11572	0.26 NW	N/A
69	SPILLS80	PETROLEUM HAULERS 8302719/CLOSED	HENRIETTA AVE & LONG BEAC OCEANSIDE NY 11572	0.31 SW	N/A
81	SPILLS80	ST ANTHONYS CHURCH 8710651/CLOSED	110 ANKER AVENUE OCEANSIDE NY 11572	0.32 NW	N/A
76	SPILLS80	CARBO CONCORD 8710424/CLOSED	3362 1ST STREET OCEANSIDE NY 11572	0.37 SE	N/A
4	SPILLS80	EXXON S/S 8809507/ACTIVE	2962 LONG BEACH ROAD OCEANSIDE NY 11572	0.38 NE	N/A
78	SPILLS80	IRVING GOODMAN 8607160/CLOSED	3421 5TH STREET OCEANSIDE NY 11572	0.39 SE	N/A
66	SPILLS80	INCORP. VILL. OF HEMPSTEAD 8607618/CLOSED	LONG BEACH RD/ATLANTIC AV OCEANSIDE NY 11572	0.40 NE	N/A
77	SPILLS80	EAST NY SAVINGS BANK 8707422/CLOSED	12 ATLANTIC AVENUE OCEANSIDE NY 11572	0.41 NW	N/A
83	SPILLS80	UNK 8907574/ACTIVE	NEPTUNE AVE & ARC STREET OCEANSIDE NY 11572	0.43 NE	N/A
13	SPILLS80	LI RUBBISH REMOVAL 8706220/CLOSED	ATLANTIC & LINCOLN AVE OCEANSIDE NY 11572	0.44 NW	N/A
13	SPILLS80	LILCO 8903223/CLOSED	ATLANTIC AVENUE & LINCOLN OCEANSIDE NY 11572	0.44 NW	N/A
74	SPILLS80	BONNIE TROY 8906850/CLOSED	3417 FIRST STREET OCEANSIDE NY 11572	0.49 SE	N/A
	SPILLS80	8200613/UNKNOWN	LONG BEACH RD. ROCKVILLE CENT NY 11572	NON GC	N/A
	SPILLS80	UNK 8603395/CLOSED	LONG BEACH ROAD OCEANSIDE NY 11572	NON GC	N/A
	SPILLS80	TROTТА BROTHERS CARTING C 8906033/CLOSED	CONCORD AVE/LARSEN BLVD OCEANSIDE NY 11572	NON GC	N/A
	SPILLS80	LILCO 8905405/CLOSED	LONG BEACH ROAD OCEANSIDE NY 11572	NON GC	N/A
	SPILLS80	LILCO 8904198/CLOSED	OCEANSIDE AVENUE OCEANSIDE NY 11572	NON GC	N/A
	SPILLS80	AMTEC 8200280/GAS STATION	LONG BEACH RD. OCEANSIDE NY 11572	NON GC	N/A
	SPILLS80	LILCO 8809221/CLOSED	OCEANSIDE ROAD OCEANSIDE NY 11572	NON GC	N/A
	SPILLS80	LILCO 8807630/CLOSED	OCEANSIDE ROAD OCEANSIDE NY 11572	NON GC	N/A

# Environmental FirstSearch

## Sites Summary Report

**TARGET SITE:** 3206 LONG BEACH ROAD  
OCEANSIDE NY 11572

**JOB:** 04-678

**TOTAL:** 176      **GEOCODED:** 151      **NON GEOCODED:** 25      **SELECTED:** 11

Map ID	DB Type	Site Name/ID/Status	Address	Dist/Dir	Page No.
22	UST	CONFIDENTIAL NAFM-1847/NC FIRE MARSHAL	3274 LONG BEACH RD OCEANSIDE NY 11572	0.10 SW	N/A
22	UST	GIBRALTAR TRANSMISSION N-057050	3274 LONG BEACH RD. OCEANSIDE NY 11572	0.10 SW	N/A
22	UST	GIBRALTAR TRANSMISSION N-057438	3274 LONG BEACH RD. OCEANSIDE NY 11572	0.10 SW	N/A
86	UST	CHEMICAL BANK BRANCH #204 N-057144/UST	3285 LONG BEACH RD. OCEANSIDE NY 11572	0.14 SW	N/A
2	UST	OLYMPIC S/S N-040026	3121 LONG BEACH ROAD OCEANSIDE NY 11572	0.19 NE	N/A
2	UST	SHELL S/S-OLYMPIC N-057647/ACTIVE FACILITY	3121 LONG BEACH RD. OCEANSIDE NY 11572	0.19 NE	N/A
2	UST	CONFIDENTIAL NAFM-5033/NC FIRE MARSHAL	3121 LONG BEACH RD OCEANSIDE NY 11572	0.19 NE	N/A
88	UST	OCEANSIDE SCHOOL #4 N-052191/ACTIVE FACILITY	S. OCEANSIDE RD. OCEANSIDE NY 11572	0.19 SE	N/A
12	UST	TUNE TIME LTD. N-057875/ACTIVE FACILITY	3337 LONG BEACH RD. OCEANSIDE NY 11572	0.23 SW	N/A
87	UST	CONFIDENTIAL NAFM-1383/NC FIRE MARSHAL	3334 LONG BEACH RD OCEANSIDE NY 11572	0.23 SW	N/A
12	UST	CONFIDENTIAL NAFM-4422/NC FIRE MARSHAL	3337 LONG BEACH RD OCEANSIDE NY 11572	0.23 SW	N/A
79	UST	OCEANSIDE SCHOOL #8 N-052184/ACTIVE FACILITY	FULTON AND MOORE AVES. OCEANSIDE NY 11572	0.25 SW	N/A
	UST	CONFIDENTIAL NAFM-1610/NC FIRE MARSHAL	335 LONG BEACH RD OCEANSIDE NY 11572	NON GC	N/A
	UST	CONFIDENTIAL NAFM-4075/NC FIRE MARSHAL	LONG BEACH RD OCEANSIDE NY 11572	NON GC	N/A
	UST	CONFIDENTIAL NAFM-57/NC FIRE MARSHAL	246 LONG BEACH RD OCEANSIDE NY 11572	NON GC	N/A

**Environmental FirstSearch**  
**Site Detail Report**

**TARGET SITE:** 3206 LONG BEACH ROAD  
OCEANSIDE NY 11572

**JOB:** 04-678

**LEAKING UNDERGROUND STORAGE TANKS**

**SEARCH ID:** 135                      **DIST/DIR:** 0.10 SW                      **MAP ID:** 22

**NAME:** CLOSED BUSINESS  
**ADDRESS:** 3274 LONG BEACH ROAD  
OCEANSIDE NY  
NASSAU  
**CONTACT:**

**REV:** 8/27/04  
**ID1:** 0011285  
**ID2:**  
**STATUS:** ACTIVE  
**PHONE:**

**SPILL DATE:** 01/16/01  
**SPILL TIME:** 14:30

**DATE REPORTED:** 01/16/01  
**TIME REPORTED:** 16:43

**MATERIAL SPILLED:** GASOLINE  
**MATERIAL CLASS:** PETROLEUM

**AMOUNT SPILLED:** 0 G  
**AMOUNT RECOVERED:** 0 G

**CAUSE OF SPILL:** TANK FAILURE  
**RESOURCE AFFECTED:** ON LAND  
**WATERBODY AFFECTED:**  
**SOURCE OF SPILL:** COMMERCIAL/INDUSTRIAL  
**REPORTED BY:** OTHER  
**CALLER REMARKS:**

THEY HAD TWO 3,000 GALLON TANKS ON THE PROPERTY THERE APPEARS THEY WERE LEAKING.

**REGION:** 1                      **UST TRUST?** TRUE

**SPILL INVESTIGATOR:** HART WELL  
**SPILL CONTACT:** CHRIS FLYNN

**TELEPHONE:** (631) 756-8000

**SPILLER:** CLOSED BUSINESS  
**ADDRESS:** 3274 LONG BEACH ROAD  
OCEANSIDE , NY  
**SPILLER CONTACT:** CHRIS FLYNN

**TELEPHONE:**

**CALLER:**  
**AGENCY:**  
**TELEPHONE:**

**NOTIFIER:**  
**AGENCY:**  
**TELEPHONE:**

**LAST DEC UPDATE:** 07/10/01  
**DOES CLEAN UP MEET STANDARDS?** FALSE  
**DEC REMARKS:**  
2/1/01 FILE REASSIGNED

**CLOSE DATE:** / /  
**PENALTY RECOMMENDED?** FALSE

**Environmental FirstSearch**  
**Site Detail Report**

**TARGET SITE:** 3206 LONG BEACH ROAD  
OCEANSIDE NY 11572

**JOB:** 04-678

**LEAKING UNDERGROUND STORAGE TANKS**

**SEARCH ID:** 148                      **DIST/DIR:** 0.25 SW                      **MAP ID:** 79

**NAME:** OCEANSIDE SCHOOL DISTRICT  
**ADDRESS:** FULTON AVE & MOORE AVENUE  
OCEANSIDE NY  
NASSAU  
**CONTACT:**

**REV:** 1/1/02  
**ID1:** 8906786  
**ID2:**  
**STATUS:** ACTIVE  
**PHONE:**

**SPILL DATE:** 10/10/89  
**SPILL TIME:** 13:00

**DATE REPORTED:** 10/10/89  
**TIME REPORTED:** 13:10

**MATERIAL SPILLED:** #6 FUEL OIL  
**MATERIAL CLASS:** PETROLEUM

**AMOUNT SPILLED:** 0 G  
**AMOUNT RECOVERED:** 0 G

**CAUSE OF SPILL:** TANK FAILURE  
**RESOURCE AFFECTED:** GROUNDWATER  
**WATERBODY AFFECTED:**  
**SOURCE OF SPILL:** NON-COMMERCIAL/INSTITUTIONAL  
**REPORTED BY:** HEALTH DEPARTMENT

**CALLER REMARKS:**  
CONTAMINATION ENCOUNTERED DURING ROUTINE REMOVAL(2- 3500) SCHOOL OFFICIAL SAID TANK HAD LEAK LONG TIME  
AGO & TANKS WERE THAN RELINED

**REGION:** 1                      **UST TRUST?** F

**SPILL INVESTIGATOR:** REASSIGN WELL  
**SPILL CONTACT:**

**TELEPHONE:**

**SPILLER:** OCEANSIDE SCHOOL DISTRICT  
**ADDRESS:**

**SPILLER CONTACT:**

**TELEPHONE:**

**CALLER:**  
**AGENCY:**  
**TELEPHONE:**

**NOTIFIER:**  
**AGENCY:**  
**TELEPHONE:**

**LAST DEC UPDATE:** 12/05/97  
**DOES CLEAN UP MEET STANDARDS?** F  
**DEC REMARKS:**

**CLOSE DATE:** / /  
**PENALTY RECOMMENDED?** F



**Environmental FirstSearch**  
**Site Detail Report**

**TARGET SITE:** 3206 LONG BEACH ROAD  
OCEANSIDE NY 11572

**JOB:** 04-678

**LEAKING UNDERGROUND STORAGE TANKS**

**SEARCH ID:** 132

**DIST/DIR:** 0.30 SW

**MAP ID:** 18

**NAME:** BILL GRIESHABER RESIDENCE  
**ADDRESS:** 166 MONTGOMERY AVE  
OCEANSIDE NY  
NASSAU

**REV:** 8/27/04  
**ID1:** 9501253  
**ID2:**  
**STATUS:** ACTIVE  
**PHONE:**

**CONTACT:**

**SPILL DATE:** 04/29/95  
**SPILL TIME:** 10:00

**DATE REPORTED:** 04/29/95  
**TIME REPORTED:** 10:53

**MATERIAL SPILLED:** #2 FUEL OIL  
**MATERIAL CLASS:** PETROLEUM

**AMOUNT SPILLED:** 0 G  
**AMOUNT RECOVERED:** 0 G

**CAUSE OF SPILL:** TANK TEST FAILURE  
**RESOURCE AFFECTED:** ON LAND  
**WATERBODY AFFECTED:**  
**SOURCE OF SPILL:-** PRIVATE DWELLING  
**REPORTED BY:** TANK TESTER

**CALLER REMARKS:**  
FILL LINE DAMAGED BY VEHICLE DRY AS A BONE FIXED LINE & TESTED TANK, TANK STILL FAILED,

**REGION:** 1

**UST TRUST?** F

**SPILL INVESTIGATOR:** AUSTIN  
**SPILL CONTACT:**

**TELEPHONE:**

**SPILLER:** BILL GRIESHABER RESIDENCE  
**ADDRESS:**

**SPILLER CONTACT:**

**TELEPHONE:**

**CALLER:**  
**AGENCY:**  
**TELEPHONE:**

**NOTIFIER:**  
**AGENCY:**  
**TELEPHONE:**

**LAST DEC UPDATE:** / /  
**DOES CLEAN UP MEET STANDARDS?** F  
**DEC REMARKS:**

**CLOSE DATE:** / /  
**PENALTY RECOMMENDED?** F

*Environmental FirstSearch*  
*Site Detail Report*

**TARGET SITE:** 3206 LONG BEACH ROAD  
OCEANSIDE NY 11572

**JOB:** 04-678

LEAKING UNDERGROUND STORAGE TANKS

**SEARCH ID:** 145

**DIST/DIR:** 0.42 SE

**MAP ID:** 49

**NAME:** MOBIL  
**ADDRESS:** 3438 LONG BEACH ROAD  
OCEANSIDE NY  
NASSAU  
**CONTACT:**

**REV:** 8/27/04  
**ID1:** 9004003  
**ID2:**  
**STATUS:** ACTIVE  
**PHONE:**

**SPILL DATE:** 07/11/90  
**SPILL TIME:** 12:30

**DATE REPORTED:** 07/11/90  
**TIME REPORTED:** 13:51

**MATERIAL SPILLED:** GASOLINE  
**MATERIAL CLASS:** PETROLEUM

**AMOUNT SPILLED:** 0 G  
**AMOUNT RECOVERED:** 0 G

**CAUSE OF SPILL:** TANK TEST FAILURE  
**RESOURCE AFFECTED:** GROUNDWATER  
**WATERBODY AFFECTED:**  
**SOURCE OF SPILL:** GASOLINE STATION  
**REPORTED BY:** TANK TESTER  
**CALLER REMARKS:**

10K, 8K, 6K FAILED GROSS LEAK. NO ACTION DETERMINED. SYSTEM TEST. PETROTITE TEST ON ALL

**REGION:** 1

**UST TRUST?** T

**SPILL INVESTIGATOR:** YAGER WELL  
**SPILL CONTACT:**

**TELEPHONE:**

**SPILLER:** MOBIL  
**ADDRESS:**

**SPILLER CONTACT:**

**TELEPHONE:** (516) 766-6546

**CALLER:**  
**AGENCY:**  
**TELEPHONE:**

**NOTIFIER:**  
**AGENCY:**  
**TELEPHONE:**

**LAST DEC UPDATE:** 09/28/01  
**DOES CLEAN UP MEET STANDARDS?** F  
**DEC REMARKS:**

**CLOSE DATE:** - / -  
**PENALTY RECOMMENDED?** F

**Environmental FirstSearch**  
**Site Detail Report**

**TARGET SITE:** 3206 LONG BEACH ROAD  
OCEANSIDE NY 11572

**JOB:** 04-678

LEAKING UNDERGROUND STORAGE TANKS

**SEARCH ID:** 176

**DIST/DIR:** NON GC

**MAP ID:**

**NAME:** AMTEC (AKA CHEVRON)  
**ADDRESS:** LONG BEACH ROAD  
OCEANSIDE NY  
NASSAU

**REV:** 1/1/02  
**ID1:** 8200280  
**ID2:**  
**STATUS:** ACTIVE  
**PHONE:**

**CONTACT:**

**SPILL DATE:** 05/14/82  
**SPILL TIME:** 12:00

**DATE REPORTED:** / /  
**TIME REPORTED:**

**MATERIAL SPILLED:** GASOLINE  
**MATERIAL CLASS:** PETROLEUM

**AMOUNT SPILLED:** 0 G  
**AMOUNT RECOVERED:** 0 G

**CAUSE OF SPILL:** TANK FAILURE  
**RESOURCE AFFECTED:** GROUNDWATER  
**WATERBODY AFFECTED:**  
**SOURCE OF SPILL:** GASOLINE STATION  
**REPORTED BY:** OTHER  
**CALLER REMARKS:**

**REGION:** 1

**UST TRUST?** T

**SPILL INVESTIGATOR:** YAGER WELL  
**SPILL CONTACT:**

**TELEPHONE:**

**SPILLER:** AMTEC (AKA CHEVRON)  
**ADDRESS:**

**SPILLER CONTACT:**

**TELEPHONE:**

**CALLER:**  
**AGENCY:**  
**TELEPHONE:**

**NOTIFIER:**  
**AGENCY:**  
**TELEPHONE:**

**LAST DEC UPDATE:** 09/27/01  
**DOES CLEAN UP MEET STANDARDS?** F  
**DEC REMARKS:**

**CLOSE DATE:** / /  
**PENALTY RECOMMENDED?** F

// : RECOVERY CONTINUING. // : RECOVERY CONTINUING. 50 SITE WELLS INSTALLED. 1143 GALS RECOVERED. 1/27/00  
FILE REASSIGNED

**Environmental FirstSearch**  
**Site Detail Report**

**TARGET SITE:** 3206 LONG BEACH ROAD  
OCEANSIDE NY 11572

**JOB:** 04-678

**RCRA GENERATOR SITE**

**SEARCH ID:** 3

**DIST/DIR:** 0.00 --

**MAP ID:** 5

**NAME:** Y & S CLEANERS  
**ADDRESS:** 3220 LONG BEACH RD  
OCEANSIDE NY 11572  
NASSAU  
**CONTACT:** YIM SEONG GIM

**REV:** 7/12/04  
**ID1:** NYD986985562  
**ID2:**  
**STATUS:** SGN  
**PHONE:** 5169388026

**SITE INFORMATION**

**CONTACT INFORMATION:** YIM SEONG GIM  
PRES  
3220 LONG BEACH RD  
OCEANSIDE NY 11572

**PHONE:** 5169388026

**UNIVERSE TYPE:**

SQG - SMALL QUANTITY GENERATOR: GENERATES 100 - 1000 KG/MONTH OF HAZARDOUS WASTE

**SIC INFORMATION:**

**ENFORCEMENT INFORMATION:**

**VIOLATION INFORMATION:**

**JOB:** 04-678

Selected Site Details Page - 7

**Environmental FirstSearch  
Site Detail Report**

**TARGET SITE:** 3206 LONG BEACH ROAD  
OCEANSIDE NY 11572

**JOB:** 04-678

STATE SITE

**SEARCH ID:** 5

**DIST/DIR:** 0.68 SW

**MAP ID:** 7

**NAME:** AUTOTRONIC PRODUCTS, INC.  
**ADDRESS:** 3300 LAWSON BOULEVARD  
OCEANSIDE (HEMPSTEAD NY 11572  
NASSAU

**REV:** 7/1/04  
**ID1:** 130030  
**ID2:** NYD981184211  
**STATUS:**  
**PHONE:**

**CONTACT:**

**GROUNDWATER:** X  
**AIR:**  
**SOIL:** X

**SURFACE WATER:**  
**SEDIMENT:**

**APPLICABLE STANDARDS EXCEEDED FOR**

**GROUNDWATER:** X  
**AIR:**

**SURFACE WATER:**  
**DRINKING WATER:**

**GEOTECHNICAL INFORMATION**

**SOIL/ROCK TYPE:** SAND WITH VARIABLE ORGANICS AND LAYERS OF PEAT.  
**DEPTH TO GROUNDWATER:** RANGE: 1 TO 5 FEET.

**LEGAL ACTION**

**TYPE:**  
**STATUS:**

**REMEDIATION**

**PROPOSED:** **DESIGN**  
**ACTIVE:** **COMPLETE**

**ASSESSMENT OF ENVIRONMENTAL PROBLEMS:**

Soil and groundwater contamination by solvents has been confirmed.

**ASSESSMENT OF HEALTH PROBLEMS:**

Used solvents and soldering wastes were spilled onto the ground and allowed to evaporate. This improper disposal of wastes resulted in groundwater contamination beneath the site with organic and inorganic compounds at levels that exceed public drinking water standards. The nearest public drinking water supply wellfield is upgradient of the site and therefore will not be impacted by the site. Exposure to contaminated subsurface soils is unlikely unless soil excavation is conducted in the future.

**Environmental FirstSearch**  
**Site Detail Report**

**TARGET SITE:** 3206 LONG BEACH ROAD  
OCEANSIDE NY 11572

**JOB:** 04-678

STATE SITE			
<b>SEARCH ID:</b> 6	<b>DIST/DIR:</b> 0.69 NW	<b>MAP ID:</b> 8	
<b>NAME:</b> HERCULES MACHINE SALES COMPANY <b>ADDRESS:</b> 3188 LAWSON BOULEVARD OCEANSIDE NY 11572 NASSAU		<b>REV:</b> 7/1/04 <b>ID1:</b> 130083 <b>ID2:</b> <b>STATUS:</b> <b>PHONE:</b>	
<b>CONTACT:</b>			
<u><b>SITE INFORMATION</b></u>			
<b>CLASS CODE:</b> 2		<b>REGION:</b> 1	
<b>SIZE (ACRES):</b> 0.25			
<b>SITE TYPE:</b>			
<b>OPEN DUMP:</b>		<b>STRUCTURE:</b> X	
<b>LAGOON:</b>		<b>LANDFILL:</b>	
<b>POND:</b>			
<u><b>SITE OWNER/OPERATOR INFORMATION:</b></u>			
<b>CURRENT OWNER(S) NAME:</b>		DAVID AND JANICE GOLDMAN	
<b>CURRENT OWNER(S) ADDRESS:</b>		68-37 YELLOWSTONE BOULEVARD FOREST HILLS NY 11375	
<b>OPERATOR(S) DURING DISPOSAL:</b>		HERCULES MACHINE SALES COMPANY	
<b>OPERATOR(S) ADDRESS:</b>		3188 LAWSON BOULEVARD OCEANSIDE NY 11572	
<b>HAZARDOUS WASTE DISPOSAL PERIOD:</b>		unknown TO present	
<u><b>SITE DESCRIPTION:</b></u>			
This company is a supplier of new dry cleaning machines. The company also takes in used machines. Activated carbon, which is used in dry cleaning machines, was found on the ground on May 2, 1995. Soil samples taken from this area revealed significant contamination by tetrachloroethylene (F001 Waste). This facility is located adjacent to the Railroad Drive-In Cleaners (130066). Groundwater wells downgradient of this facility, which are also downgradient of Railroad Drive-In Cleaners, show significantly elevated levels of tetrachloroethylene and its breakdown products. A significant threat exists because, based on soil sampling data from this site and groundwater sampling data from the adjacent facility, contaminants from this site have impacted a sole-source aquifer. Specifically, tetrachloroethylene has been detected at up to 1,400 ppm in on-site soils and at up to 28,000 ppb in groundwater. The PRP signed a Consent Order in January 2003.			
<b>CONFIRMED HAZARDOUS WASTE DISPOSAL:</b>		<b>QUANTITY:</b>	
Tetrachloroethylene (F001)		unknown	
<u><b>ANALYTICAL DATA AVAILABLE FOR</b></u>			
<b>GROUNDWATER:</b>		<b>SURFACE WATER:</b>	
<b>AIR:</b>		<b>SEDIMENT:</b>	
<b>SOIL:</b>			

- Continued on next page -



**Environmental FirstSearch**  
**Site Detail Report**

**TARGET SITE:** 3206 LONG BEACH ROAD  
OCEANSIDE NY 11572

**JOB:** 04-678

STATE SITE

**SEARCH ID:** 6

**DIST/DIR:** 0.69 NW

**MAP ID:** 8

**NAME:** HERCULES MACHINE SALES COMPANY  
**ADDRESS:** 3188 LAWSON BOULEVARD  
OCEANSIDE NY 11572  
NASSAU  
**CONTACT:**

**REV:** 7/1/04  
**ID1:** 130083  
**ID2:**  
**STATUS:**  
**PHONE:**

**APPLICABLE STANDARDS EXCEEDED FOR**

**GROUNDWATER:** X  
**AIR:**

**SURFACE WATER:**  
**DRINKING WATER:**

**GEOTECHNICAL INFORMATION**

**SOIL/ROCK TYPE:** SAND.  
**DEPTH TO GROUNDWATER:** RANGE: 1 TO 5 FEET.

**LEGAL ACTION**

**TYPE:**  
**STATUS:**

**REMEDIATION**

**PROPOSED:**  
**ACTIVE:** **DESIGN**  
**COMPLETE**

**ASSESSMENT OF ENVIRONMENTAL PROBLEMS:**

Past site operations have contaminated the soils and the groundwater within a sole-source aquifer at the site with tetrachloroethylene.

**ASSESSMENT OF HEALTH PROBLEMS:**

Contaminated soils exist on-site due to the improper disposal of waste material behind the facility. The material was removed and the majority of contaminated soil is paved over with concrete. The site has controlled access. Low soil vapor levels were found in on-site soils. Off-site soil vapor testing has not been performed to assess the potential for impacts to indoor air quality at nearby dwellings. Indoor air sampling is planned in the vicinity of the site. Downgradient groundwater monitoring wells, which are also downgradient of Railroad Drive-in Cleaners (130066), are contaminated with tetrachloroethene at levels above New York State standards for public drinking water supplies. Public drinking water is supplied to the area. The nearest public drinking water supply wells are located to the north (groundwater flow is to the west) and have not been affected by site-related contaminants. No private drinking water supply wells have been identified downgradient of the site.

**JOB:** 04-678

*Selected Site Details Page - 11*

**Environmental FirstSearch**  
**Site Detail Report**

**TARGET SITE:** 3206 LONG BEACH ROAD  
OCEANSIDE NY 11572

**JOB:** 04-678

STATE SITE

**SEARCH ID:** 7

**DIST/DIR:** 0.70 NW

**MAP ID:** 9

**NAME:** RAILROAD DRY CLEANERS  
**ADDRESS:** 3180 LAWSON BOULEVARD  
OCEANSIDE NY 11572  
NASSAU  
**CONTACT:**

**REV:** 7/1/04  
**ID1:** 130066  
**ID2:**  
**STATUS:**  
**PHONE:**

**ANALYTICAL DATA AVAILABLE FOR**

**GROUNDWATER:** X

**AIR:**

**SOIL:** X

**SURFACE WATER:**  
**SEDIMENT:**

**APPLICABLE STANDARDS EXCEEDED FOR**

**GROUNDWATER:** X

**AIR:**

**SURFACE WATER:**  
**DRINKING WATER:**

**GEOTECHNICAL INFORMATION**

**SOIL/ROCK TYPE:**

**DEPTH TO GROUNDWATER:** RANGE: 1 TO 5 FEET.

**LEGAL ACTION**

**TYPE:** CONSENT ORDER RI/FS

**STATUS:** NE

**REMEDIATION**

**PROPOSED:** X

**ACTIVE:**

**DESIGN**  
**COMPLETE**

**ASSESSMENT OF ENVIRONMENTAL PROBLEMS:**

Tetrachloroethylene has been released to the aquifer. Fuel oil constituents such as benzene, toluene, and xylenes, have been found in the soil.

**ASSESSMENT OF HEALTH PROBLEMS:**

Subsurface soils and groundwater are contaminated with dry cleaning solvents and some components of fuel oil above applicable guidelines and standards. There is a potential for volatile organic compounds from the site to impact indoor air quality in nearby buildings. Additional data is needed to further evaluate this exposure pathway. It is unknown whether private drinking water supply wells exist in the area. However, public drinking water is supplied to the area and is routinely tested to see that water quality meets New York State standards for public drinking water supplies. The nearest public drinking water supply wells are located to the north and have not been affected by site-related contaminants. Contact with contaminated soils is unlikely as they are at depth.

**Environmental FirstSearch**  
**Site Detail Report**

**TARGET SITE:** 3206 LONG BEACH ROAD  
OCEANSIDE NY 11572

**JOB:** 04-678

STATE SPILLS SITE			
<b>SEARCH ID:</b> 44	<b>DIST/DIR:</b> 0.01 S-	<b>MAP ID:</b> 35	
<b>NAME:</b> GM REALTY <b>ADDRESS:</b> 3224 LONG BEACH ROAD OCEANSIDE NY NASSAU <b>CONTACT:</b>		<b>REV:</b> 5/10/04 <b>ID1:</b> 9106727 <b>ID2:</b> <b>STATUS:</b> CLOSED 01/02/1992 <b>PHONE:</b>	
<b>SPILL DATE:</b> 09/22/91 <b>SPILL TIME:</b> 14:00		<b>DATE REPORTED:</b> 09/22/91 <b>TIME REPORTED:</b> 15:12	
<b>MATERIAL SPILLED:</b> #2 FUEL OIL <b>MATERIAL CLASS:</b> PETROLEUM		<b>AMOUNT SPILLED:</b> 10 G <b>AMOUNT RECOVERED:</b> 0 G	
<b>CAUSE OF SPILL:</b> <b>RESOURCE AFFECTED:</b> <b>WATERBODY AFFECTED:</b> <b>SOURCE OF SPILL:</b> <b>REPORTED BY:</b> <b>CALLER REMARKS:</b> VALVE ON 275 LEAKED, SPEEDI DRY APPLIED		EQUIPMENT FAILURE ON LAND  COMMERCIAL/INDUSTRIAL FIRE DEPARTMENT	
<b>REGION:</b> 1		<b>UST TRUST?</b> F	
<b>SPILL INVESTIGATOR:</b> ACAMPORA <b>SPILL CONTACT:</b>		<b>TELEPHONE:</b>	
<b>SPILLER:</b> GM REALTY <b>ADDRESS:</b>		<b>TELEPHONE:</b> (718) 445-7333	
<b>SPILLER CONTACT:</b>		<b>TELEPHONE:</b> (718) 445-7333	
<b>CALLER:</b> <b>AGENCY:</b> <b>TELEPHONE:</b>		<b>NOTIFIER:</b> <b>AGENCY:</b> <b>TELEPHONE:</b>	
<b>LAST DEC UPDATE:</b> 01/03/92 <b>DOES CLEAN UP MEET STANDARDS?</b> T <b>DEC REMARKS:</b>		<b>CLOSE DATE:</b> 01/02/92 <b>PENALTY RECOMMENDED?</b> F	

**Environmental FirstSearch**  
**Site Detail Report**

**TARGET SITE:** 3206 LONG BEACH ROAD  
OCEANSIDE NY 11572

**JOB:** 04-678

STATE SPILLS 80's SITE

**SEARCH ID:** 111

**DIST/DIR:** 0.00 --

**MAP ID:** 84

**NAME:** UNK  
**ADDRESS:** 3218 LONG BEACH ROAD  
OCEANSIDE NY  
NASSAU  
**CONTACT:**

**REV:** 10/18/00  
**ID1:** 8702234  
**ID2:**  
**STATUS:** CLOSED  
**PHONE:**

**SPILL DATE:** 06/18/87  
**SPILL TIME:** 11:00

**DATE REPORTED:** 06/18/87  
**TIME REPORTED:** 11:15

**MATERIAL SPILLED:** GASOLINE  
**MATERIAL CLASS:** PETROLEUM

**AMOUNT SPILLED:** 15 G  
**AMOUNT RECOVERED:** 0 G

**CAUSE OF SPILL:** OTHER  
**RESOURCE AFFECTED:** IN SEWER  
**WATERBODY AFFECTED:**  
**SOURCE OF SPILL:** PASSENGER VEHICLE  
**REPORTED BY:** LOCAL AGENCY

**CALLER REMARKS:**

CAR TOWED AWAY-TANK RUPTURED-GAS IN DEAD END BASIN. \*\*\*PROVISIONAL EPA ID # NYP000870220\*\*\*

**REGION:** 1 **UST TRUST?** NO

**SPILL INVESTIGATOR:** O BRIEN  
**SPILL CONTACT:**

**TELEPHONE:**

**SPILLER:** UNK  
**ADDRESS:**

**SPILLER CONTACT:**

**TELEPHONE:**

**CALLER:** RICH MAGEE  
**AGENCY:** NASSAU CTY FIRE MARSHALL  
**TELEPHONE:** (516) 566-5277

**NOTIFIER:**  
**AGENCY:**  
**TELEPHONE:**

**LAST DEC UPDATE:** 01/05/94  
**DOES CLEAN UP MEET STANDARDS?** YES

**CLOSE DATE:** 06/19/87  
**PENALTY RECOMMENDED?** NO

**DEC REMARKS:**

// : (UNK DATE): RECEIVE REPLY FROM NCPD EME SVCS- NOTHING. 06/18/87: NASS CTY FIRE MARSHALL REPORTS SPILL OF GAS FROM RUPTURED CAR TANK. (NCFM CASE # NOT OBTAINED BY DEC; NOT STATED IF PD PRESENT). 06/18/87: DEC RESPOND. AS PER NCFM: CAR STRUCK MOUNTING BOLTS THAT USED TO HOLD A SIGN. TENANT OF NEARBY STORE (WHICH NOT SPECIFIED) FLUSHED GAS INTO DRAIN. MOST OF GAS EVAPORATED BY DEC ARRIVAL. 06/18/87: DEC HIRED MPC TO CLEAN UP. APPROX 1/2 DRUM SPEEDI-DRI GENERATED. CLEANUP SATISFACTORY. 06/19/87: DEC CLOSED REGIONAL FILE. 08/04/87: DEC ISSUES PROVISIONAL EPA ID # NYP000870220 FOR THE MATERIAL (PLUS A DRUM CONTAINING WASTE SOLVENTS [FREON, 1,1,1 TRICHLOROETHANE & TETRACHLOROETHANE]??). 10/16/92: \*\*\*NOTE: SENT LETTER REQUESTING INFO TO NCFM. 10/16/92: \*\*\*NOTE: SENT LETTER REQUESTING INFO TO NCPD. 04/01/93: \*\*\*NOTE: SENT LETTER REQUESTING INFO TO NCPD. 05/19/93: \*\*\*NOTE: SENT LETTER REQUESTING INFO TO NCFM. 12/01/93: \*\*\*NOTE: AS OF THIS DATE, NO REPLY FROM NCFM. 12/01/93: \*\*\*NOTE (C): IN ADDITION, THE INCIDENT SITE MAY OR MAY NOT BE UNDER NCPD JURISDICTION. 12/01/93: \*\*\*NOTE (B): EVIDENTLY, THE INFORMATION, IF IT EXISTS, MAY RESIDE WITH ONE OR MORE UNITS AND MAY OR MAY NOT BE COMPUTERIZED. 12/01/93: \*\*\*NOTE (A): AS OF THIS DATE, EXCEPT FOR EME SVCS REPLY, NO INFO FROM NCPD.

*Environmental FirstSearch*  
*Street Name Report for Streets within .25 Mile(s) of Target Property*

**TARGET SITE:** 3206 LONG BEACH ROAD  
OCEANSIDE NY 11572

**JOB:** 04-678

Street Name	Dist/Dir	Street Name	Dist/Dir
2nd St	0.20 SE		
3rd St	0.15 SE		
4th St	0.08 -E		
5th St	0.08 SE		
Anchor Ave	0.22 NE		
Arrow St	0.23 NE		
Cortland Ave	0.12 SE		
Cypress Ave	0.09 NE		
Dambly Ave	0.14 NW		
E Cortland Ave	0.19 SE		
EAST Cortland Ave	0.19 SE		
Evans Ave	0.06 NW		
Fulton Ave	0.24 NW		
Joann Ct	0.23 NE		
John St	0.13 NE		
Land Pl	0.10 SE		
Lawrence Ave	0.05 SW		
Long Beach Rd	0.18 NE		
Mann Pl	0.08 SE		
Montgomery Ave	0.02 SW		
Moore Ave	0.09 SW		
Oceanside Rd	0.23 NE		
Perkins Ave	0.12 NE		
Roxbury Rd	0.22 NE		
S Long Beach Rd	0.01 -E		
SOUTH Long Beach Rd	0.01 -E		
Trinity St	0.20 NE		
Vermont Ave	0.19 SW		
W Cortland Ave	0.12 SE		
W Waukena Ave	0.22 SW		
W Windsor Pky	0.18 NE		
Waukena Ave	0.25 SE		
Weidner Ave	0.07 N-		
WEST Cortland Ave	0.12 SE		
WEST Waukena Ave	0.22 SW		
WEST Windsor Pky	0.18 NE		
Williams St	0.18 NE		
Windsor Pky	0.17 NE		



## USEPA MAP OF RADON ZONES

### NEW YORK - EPA Map of Radon Zones

The purpose of this map is to assist National, State and local organizations to target their resources and to implement radon-resistant building codes.

This map is not intended to determine if a home in a given zone should be tested for radon. Homes with elevated levels of radon have been found in all three zones. All homes should be tested, regardless of zone designation.

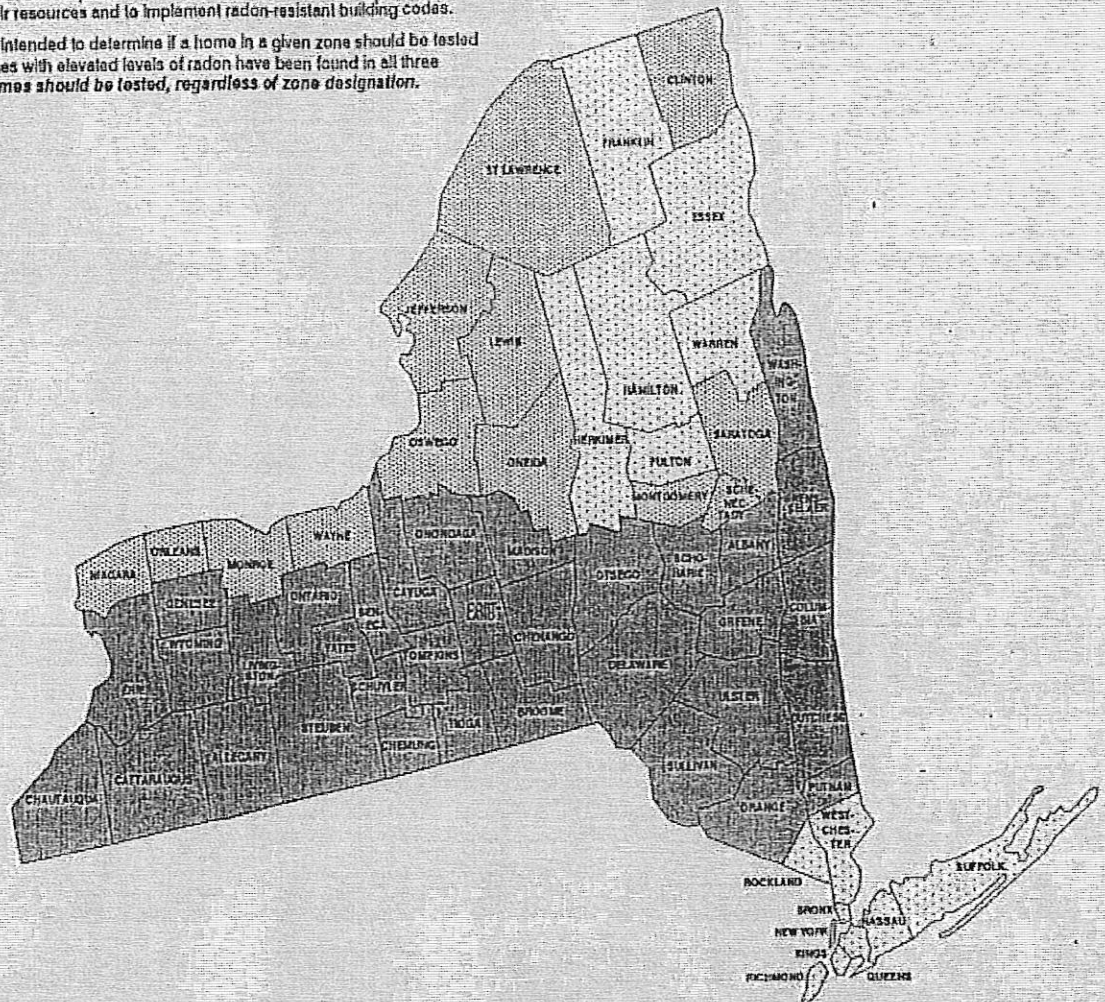

Zone 1

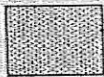

Zone 2

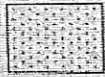

Zone 3

**IMPORTANT:** Consult the publication entitled "Preliminary Geologic Radon Potential Assessment of New York" before using this map. This document contains information on radon potential variations within counties. EPA also recommends that this map be supplemented with any available local data in order to further understand and predict the radon potential of a specific area.



**NASSAU COUNTY DEPARTMENT OF HEALTH INFORMATION**

## DRI CLEANER INSPECTION REPORT

Bureau of Environmental Management

Hassan County Department of Health

Facility Name: Tuon CleanersAddress: 3220 Long Beach Rd, OceansideContact: Mike Klein Title: ownerName: Mike Klein CorpPhone: 956-4888

Property Address:

Owner Address:

Expiration Date:

Member RCA

Yes

No

Permit No.:

New

Renewal

Effective Date:

Expiration Date:

Member RCA

Yes

No

Item

Yes

No

N/A

Item

Yes

No

N/A

A. Equipment:

Frimer 35 15

Yes

No

N/A

F. Chemical Storage:

Capacity 100

Yes

No

N/A

C.T.U. [ ] Combo [x] Dryer [ ] Outside Venting:

Yes

No

N/A

1. D/C Reservoir

Capacity

Yes

No

N/A

Still [ ] Sniffer [ ] Solvation Unit [ ]

Yes

No

N/A

2. Storage Tank

Capacity

Yes

No

N/A

B. Waste Sources: Frimer

Yes

No

N/A

3. Drum(s) Total

Capacity

Yes

No

N/A

1. Filter Cartridges

Yes

No

N/A

G. Cooling Water System:

Capacity

Yes

No

N/A

2. Still Bottom

Yes

No

N/A

1. Tower

Capacity

Yes

No

N/A

3. Filter Powder

Yes

No

N/A

2. Chiller

Capacity

Yes

No

N/A

4. Separator Water

Yes

No

N/A

3. Other: Light unit

Capacity

Yes

No

N/A

C. Waste Storage:

Yes

No

N/A

H. Records:

Capacity

Yes

No

N/A

1. Inside [x] Outside [ ]

Yes

No

N/A

1. Purchase Receipts

Capacity

Yes

No

N/A

2. Container Type: Plastic [x] Metal [ ]

Yes

No

N/A

2. Removal Receipts

Capacity

Yes

No

N/A

D. Waste Disposal: DECA

Yes

No

N/A

3. Annual Waste Report Submitted

Capacity

Yes

No

N/A

E. Separator Water Disposal:

Yes

No

N/A

4. Records on File for Past 3 Years

Capacity

Yes

No

N/A

1. Recirculator

Yes

No

N/A

I. Floor Drains

Capacity

Yes

No

N/A

2. Evaporator

Yes

No

N/A

1. Location:

Capacity

Yes

No

N/A

3. Sewer

Yes

No

N/A

J. Boiler Discharge (Blowdown)

Capacity

Yes

No

N/A

4. Other:

Yes

No

N/A

K. Inspection Rating:

Capacity

Yes

No

N/A

Date

Item

Comments

Pass [ ] Fail [x]

Pass [ ] Fail [x]

Yes

No

N/A

Signature of Inspector:

Date

Signature of Company Rep.:

Date:

Signature of Company Rep.:

Date:

Yes

No

N/A

eb795

EX-1507, 12/94

Facility Name: Y.S. Cleaners Inc. Address: 3235 Long Beach Rd. Brownsdale NY 11512

Company Representative: Vin Seong GIM Title: President Phone: 766-4535

Property Name: G.M. Realty Corporation Address: 136-89 41st Avenue, Flushing NY 11355 (7/18) Phone: 445-9333

Owner Name: G.M. Realty Corporation Address: 136-89 41st Avenue, Flushing NY 11355

Effective Date: 03/01/92 Expiration Date: 03/01/97 Member NCA: Yes ☐ No

Permit No. 556 ☒ New ☐ Renewal

Item Yes No N/A

A. Waste Sources

1. Separator Water: ☐ Sniffer ☒ Reclaimer

2. Filter Powder

3. Filter Cartridge

4. Still Bottom

B. Waste Storage

1. ☒ Inside ☐ Outside

2. Drum

3. Special Container

C. Waste Disposal

1. Registered Industrial Scavenger

a. Name Robert K. Lee

b. D.E.C. # [redacted]

2. Evaporator

3. Recirculation System

Date Item

Comments

Engineer Fris - 35 lb unit - 90 gal. capacity

last removed by Robert K. Lee 07/29/92

1 Drum of 90 lbs. → waste filter cartridge

Left 136-89 41st Ave with new equipment installed - 7/18/92

Signature of Inspector 7/8/92 Date 10/28/92

Signature of Company Representative 10/28/92 Date 10/28/92

EH 795 7/84

DRY CLEANER INSPECTION REPORT  
Bureau of Land Resources Management  
Nassau County Department of Health

Facility Name: St. John's Cleaners Inc. Address: 32202 on Bay Rd. Ocean side  
Company Name: St. John's Cleaners Inc. Title: President Phone: 966-4535  
Representative: St. John's Cleaners Inc.

Property Name: C.W. Roarty Co. (718) 449-9333  
Owner Address: 136-89 41st Avenue, Bayside, NY 11355

Permit No. 556 ☐ New ☐ Renewal Effective Date \_\_\_\_\_ Expiration Date \_\_\_\_\_ Member ☐ Yes ☐ No

Item	Yes	No	N/A	Item	Yes	No	N/A
<b>A. Waste Sources</b>							
1. Separator Water: <input type="checkbox"/> Sniffer <input checked="" type="checkbox"/> Reclaimer				<b>C. Waste Disposal (cont'd)</b>			
2. Filter Powder				4. Sewer			
3. Filter Cartridge				5. Other			
4. Still Bottom				D. Chemical Storage			
<b>B. Waste Storage</b>				1. Drums			
1. <input checked="" type="checkbox"/> Inside <input type="checkbox"/> Outside				2. Tanks			
2. Drum				3. D.C. Reservoir			
<b>3. Special Container</b>				E. Records <u>W. J. de Chamis</u>			
<b>C. Waste Disposal</b>				1. <input checked="" type="checkbox"/> Purchase Receipts <input type="checkbox"/> Removal Receipts			
1. Registered Industrial Scavenger				2. Records Kept a Minimum of 3 Yrs.			
a. Name <u>Sagey Klean</u>				3. Reports Submitted on Time			
b. D.E.C. # _____				<b>F. Overall Inspection Rating</b>			
2. Evaporator				<input checked="" type="checkbox"/> Satisfactory <input type="checkbox"/> Non-Compliance			
3. Recirculation System							

Comments

Repair - 90 Gal. Capacity - 35 lb unit.  
Lost record by Sagey Klean. ~~18,1992~~ 18,1992.  
1 drum still broken and 1 drum waste cartridge broken.  
All applicable completed @ this time of Insp.

Signature of Inspector H. W. de Chamis Date 26 Feb 1992 Signature of Company Representative Vincent Date 26 Feb 1992  
EH 795 7/84



# CLEANER INSPECTION REPORT

Bureau of Land Resources Management  
Nassau County Department of Health

Facility Name: 3580 York Address: 3220 Long Beach Rd. Clearville NY 1572  
 Company Representative: Bryon G Kim Title: owner Phone: 66-4535  
 Property Name: Dino Guiducci (718) 735-7332  
 Owner Address:

Permit No.	<input type="checkbox"/> New <input type="checkbox"/> Renewal	Effective Date	Expiration Date	Member NCA	<input type="checkbox"/> Yes <input checked="" type="checkbox"/> No
A. Waste Sources		Item	Yes No N/A	Item	Yes No N/A
1. Separator Water: <input type="checkbox"/> Sniffer <input checked="" type="checkbox"/> Reclaimer				C. Waste Disposal (cont'd)	
2. Filter Powder				4. Sewer	
3. Filter Cartridge				5. Other <u>Septic Tank</u> in <u>Basin Room</u>	
4. Still Bottom				D. Chemical Storage	
B. Waste Storage				1. Drums	
1. <input checked="" type="checkbox"/> Inside <input type="checkbox"/> Outside				2. Tanks	
2. Drum				3. D.C. Reservoir	
3. Special Container				E. Records <u>West Side</u>	
C. Waste Disposal				1. <input checked="" type="checkbox"/> Purchase Receipts <input type="checkbox"/> Removal Receipts	
1. Registered Industrial Scavenger				2. Records Kept a Minimum of 3 Yrs.	
a. Name <u>Sally Klean</u>				3. Reports Submitted on Time	
b. D.E.C. #				F. Overall Inspection Rating	
2. Evaporator				<input checked="" type="checkbox"/> Satisfactory <input type="checkbox"/> Non-Compliance	
3. Recirculation System					

Date Item Comments

Aug 01 1991 Bryon G Kim Assisted management with Septic application

Signature of Inspector R. Wolch Date 19 Sept 1991 Signature of Company Representative [Signature] Date

EH 795 7/84

# DRY CLEANER INSPECTION REPORT

Bureau of Environmental Management

Nassau County Department of Health

Facility Name: 15 Clean

Address: 3220 Long Beach Rd Oceanside

Contact: Gym, IN. Seng Title: Owner

Phone: 766-4535

Property Name:

Owner Address:

Permit No.: 556 New Renewal Effective Date: 5/1/92

Expiration Date: 3/1/97 Member NCA Yes ☒ No ☐

Item Yes No N/A

A. Equipment: Frimer (35)

C.T.U. ☒ Combo ☐ Dryer ☐ Outside Venting: ☒

Still ☐ Sniffer ☐ Solvation Unit ☐

B. Waste Sources:

1. Filter Cartridges ☒

2. Still Bottom ☒

3. Filter Powder ☒

4. Separator Water ☒

C. Waste Storage:

1. Inside ☐ Outside ☐

2. Container Type: Plastic ☒ Metal ☐

D. Waste Disposal: Self Clean

1. N.Y.S Transporter: DEC#

E. Separator Water Disposal:

1. Recirculator ☒

2. Evaporator ☒

3. Sewer ☒

4. Other: 70 Self Clean

Date Item

Comments

Signature of Inspector: C. Buckle

Date: 5/1/92

Signature of Company Rep.: Robert O. Buckle

Date: 5/1/92

# DRY CLEANER INSPECTION REPORT

Bureau of Environmental Management

Nassau County Department of Health

Facility Name: Y.B. CLEANERS INC.

Address: 3220 LONG BEACH RD. OCEANSIDE

Contact: YIN SEONG GIM

Property Name: G.M. REALTY CORP.

Owner Address: 136-89 41ST AVE.

FLUSHING NY

Title: PRESIDENT

Phone: (516) 766-4335

Phone: ( ) -

Permit No.: 556

☒ New

☐ Renewal

Effective Date: 03/01/92

Expiration Date: 03/01/97

Member NCA

Yes

☒ No

Item

1. Equipment: *Exhaust* 35 lbs. *new*

C.T.U. [ ] Combo [ ☒ ] Dryer [ ]

Outside Venting: [ ]

Still [ ] Sniffer [ ]

Solvation Unit [ ]

3. Waste Sources:

1. Filter Cartridges

2. Still Bottom

3. Filter Powder

4. Separator Water

5. Waste Storage:

1. Inside [ ☒ ] Outside [ ]

2. Container Type: Plastic [ ☒ ] Metal [ ]

3. Waste Disposal:

1. N.Y.S. Transporter: *Sage-Klean* DEC#

3. Separator Water Disposal:

1. Recirculator

2. Evaporator

3. Sewer

4. Other: *Exhaust in Boiler Room*

Date

Item

Yes

No

N/A

Item

F. Chemical Storage:

1. D/C Reservoir Capacity *90 Gal.*

2. Storage Tank Capacity

3. Drum(s) Total Capacity

G. Cooling Water System:

1. Tower

2. Chiller

3. Other: *Blue Green rec'd Sewer*

H. Records:

1. Purchase Receipts *Wishla Dismant*

2. Removal Receipts

3. Annual Waste Report Submitted

4. Records on File For Past 3 Years *Submitted 03/01/92*

I. Floor Drains

1. Location:

J. Boiler Discharge (Blowdown)

1. Location: *Run of Bldg via Pipe*

K. Inspection Rating: *Pass* ☒ Fail [ ]

Yes

No

N/A

Item

F. Chemical Storage:

1. D/C Reservoir Capacity *90 Gal.*

2. Storage Tank Capacity

3. Drum(s) Total Capacity

G. Cooling Water System:

1. Tower

2. Chiller

3. Other: *Blue Green rec'd Sewer*

H. Records:

1. Purchase Receipts *Wishla Dismant*

2. Removal Receipts

3. Annual Waste Report Submitted

4. Records on File For Past 3 Years *Submitted 03/01/92*

I. Floor Drains

1. Location:

J. Boiler Discharge (Blowdown)

1. Location: *Run of Bldg via Pipe*

K. Inspection Rating: *Pass* ☒ Fail [ ]

Yes

No

N/A

Item

F. Chemical Storage:

1. D/C Reservoir Capacity *90 Gal.*

2. Storage Tank Capacity

3. Drum(s) Total Capacity

G. Cooling Water System:

1. Tower

2. Chiller

3. Other: *Blue Green rec'd Sewer*

H. Records:

1. Purchase Receipts *Wishla Dismant*

2. Removal Receipts

3. Annual Waste Report Submitted

4. Records on File For Past 3 Years *Submitted 03/01/92*

I. Floor Drains

1. Location:

J. Boiler Discharge (Blowdown)

1. Location: *Run of Bldg via Pipe*

K. Inspection Rating: *Pass* ☒ Fail [ ]

Yes

No

N/A

Item

F. Chemical Storage:

1. D/C Reservoir Capacity *90 Gal.*

2. Storage Tank Capacity

3. Drum(s) Total Capacity

G. Cooling Water System:

1. Tower

2. Chiller

3. Other: *Blue Green rec'd Sewer*

H. Records:

1. Purchase Receipts *Wishla Dismant*

2. Removal Receipts

3. Annual Waste Report Submitted

4. Records on File For Past 3 Years *Submitted 03/01/92*

I. Floor Drains

1. Location:

J. Boiler Discharge (Blowdown)

1. Location: *Run of Bldg via Pipe*

K. Inspection Rating: *Pass* ☒ Fail [ ]

Yes

No

N/A

Item

F. Chemical Storage:

1. D/C Reservoir Capacity *90 Gal.*

2. Storage Tank Capacity

3. Drum(s) Total Capacity

G. Cooling Water System:

1. Tower

2. Chiller

3. Other: *Blue Green rec'd Sewer*

H. Records:

1. Purchase Receipts *Wishla Dismant*

2. Removal Receipts

3. Annual Waste Report Submitted

4. Records on File For Past 3 Years *Submitted 03/01/92*

I. Floor Drains

1. Location:

J. Boiler Discharge (Blowdown)

1. Location: *Run of Bldg via Pipe*

K. Inspection Rating: *Pass* ☒ Fail [ ]

Yes

No

N/A

Item

F. Chemical Storage:

1. D/C Reservoir Capacity *90 Gal.*

2. Storage Tank Capacity

3. Drum(s) Total Capacity

G. Cooling Water System:

1. Tower

2. Chiller

3. Other: *Blue Green rec'd Sewer*

H. Records:

1. Purchase Receipts *Wishla Dismant*

2. Removal Receipts

3. Annual Waste Report Submitted

4. Records on File For Past 3 Years *Submitted 03/01/92*

I. Floor Drains

1. Location:

J. Boiler Discharge (Blowdown)

1. Location: *Run of Bldg via Pipe*

K. Inspection Rating: *Pass* ☒ Fail [ ]

Yes

No

N/A

Item

F. Chemical Storage:

1. D/C Reservoir Capacity *90 Gal.*

2. Storage Tank Capacity

3. Drum(s) Total Capacity

G. Cooling Water System:

1. Tower

2. Chiller

3. Other: *Blue Green rec'd Sewer*

H. Records:

1. Purchase Receipts *Wishla Dismant*

2. Removal Receipts

3. Annual Waste Report Submitted

4. Records on File For Past 3 Years *Submitted 03/01/92*

I. Floor Drains

1. Location:

J. Boiler Discharge (Blowdown)

1. Location: *Run of Bldg via Pipe*

K. Inspection Rating: *Pass* ☒ Fail [ ]

Yes

No

N/A

Item

F. Chemical Storage:

1. D/C Reservoir Capacity *90 Gal.*

2. Storage Tank Capacity

3. Drum(s) Total Capacity

G. Cooling Water System:

1. Tower

2. Chiller

3. Other: *Blue Green rec'd Sewer*

H. Records:

1. Purchase Receipts *Wishla Dismant*

2. Removal Receipts

3. Annual Waste Report Submitted

4. Records on File For Past 3 Years *Submitted 03/01/92*

I. Floor Drains

1. Location:

J. Boiler Discharge (Blowdown)

1. Location: *Run of Bldg via Pipe*

K. Inspection Rating: *Pass* ☒ Fail [ ]

Yes

No

N/A

Item

F. Chemical Storage:

1. D/C Reservoir Capacity *90 Gal.*

2. Storage Tank Capacity

3. Drum(s) Total Capacity

G. Cooling Water System:

1. Tower

2. Chiller

3. Other: *Blue Green rec'd Sewer*

H. Records:

1. Purchase Receipts *Wishla Dismant*

2. Removal Receipts

3. Annual Waste Report Submitted

4. Records on File For Past 3 Years *Submitted 03/01/92*

I. Floor Drains

1. Location:

J. Boiler Discharge (Blowdown)

1. Location: *Run of Bldg via Pipe*

K. Inspection Rating: *Pass* ☒ Fail [ ]

Yes

No

N/A

Item

F. Chemical Storage:

1. D/C Reservoir Capacity *90 Gal.*

2. Storage Tank Capacity

3. Drum(s) Total Capacity

G. Cooling Water System:

1. Tower

2. Chiller

3. Other: *Blue Green rec'd Sewer*

H. Records:

1. Purchase Receipts *Wishla Dismant*

2. Removal Receipts

3. Annual Waste Report Submitted

4. Records on File For Past 3 Years *Submitted 03/01/92*

I. Floor Drains

1. Location:

J. Boiler Discharge (Blowdown)

1. Location: *Run of Bldg via Pipe*

K. Inspection Rating: *Pass* ☒ Fail [ ]

Yes

No

N/A

Item

F. Chemical Storage:



# DRY CLEANER INSPECTION REPORT

Facility Name: Y.S. CLEANERS INC.

Address: 3220 LONG BEACH RD. OCEANSIDE

Contact: YIN SEONG GIM

Title: PRESIDENT

Phone: (516) 766-4335

Property Name: G.M. REALTY CORP.

Phone: ( ) -

Address: 136-89 41ST AVE. FLUSHING NY

Permit No.: 556

☒ New

☐ Renewal

Effective Date: 03/01/92

Expiration Date: 03/01/97

Member NCA

Yes

☒ No

## Item

Yes No N/A

## Item

Yes No N/A

A. Equipment:

Exhaust 350 units

F. Chemical Storage:

Yes No N/A

C.T.U. [ ] Combo ☒ Dryer [ ] Outside Venting:

1. D/C Reservoir Capacity 90 Gallons.

Yes No N/A

Still [ ] Sniffer [ ] Solvation Unit [ ]

2. Storage Tank Capacity

Yes No N/A

B. Waste Sources:

3. Drum(s) Total Capacity

Yes No N/A

1. Filter Cartridges

G. Cooling Water System:

Yes No N/A

2. Still Bottom

1. Tower

Yes No N/A

3. Filter Powder

2. Chiller

Yes No N/A

4. Separator Water

3. Other: Public Water Supply

Yes No N/A

C. Waste Storage:

H. Records:

Yes No N/A

1. Inside ☒ Outside [ ]

1. Purchase Receipts

Yes No N/A

2. Container Type: Plastic ☒ Metal ☒

2. Removal Receipts

Yes No N/A

D. Waste Disposal: Safety Klean

3. Annual Waste Report Submitted

Yes No N/A

1. N.Y.S Transporter: DEC#

4. Records on File For Past 3 Years

Yes No N/A

E. Separator Water Disposal:

I. Floor Drains

Yes No N/A

1. Recirculator

1. Location:

Yes No N/A

2. Evaporator

J. Boiler Discharge (Blowdown) Enter Boiler

Yes No N/A

3. Sewer

1. Location: Rear of Shop - via

Yes No N/A

4. Other: Evaporator Boil Room

K. Inspection Rating: Pass ☒ Fail [ ]

Yes No N/A

Date

11 August 1994

Signature of Inspector:

Signature of Company Rep.:

Date:

Comments: Last removed by Safety Klean. 08/01/94. - 100lbs of still bottom.

Signature of Inspector:

H. Walden

11 August 1994

Signature of Company Rep.:

Date:

DRY CLEANER SURVEY  
Bureau of Land Resources Mgmt.  
Nassau County Dept. of Health

Facility Name

Date:

Todd's Custom <sup>DRY</sup> Cleaners

22 March 1991

Contact: Yi Sook Kim - owner

Phone: 766-4535

Address: 3220 Long Beach Road, Oceanside NY

Zip 11572

Make of Equipment	D.C.	FRIMAIR 35lb unit	
	Reclaimer	Combo	
	Sniffer		
Reclamation Process	Type	<input checked="" type="checkbox"/> Condensation	<input checked="" type="checkbox"/> Distillation
Chemical Usage	Chemical Name	Perchloroethylene	
	Gallons Purchased/Year	?	
Separator Water Discharge	Quantity Per Month	8 Gal / month - ?	
	Disposal Method	<input type="checkbox"/> Cesspool <input type="checkbox"/> Sewer <input type="checkbox"/> Recirculation <input type="checkbox"/> Evaporator <input type="checkbox"/> Dry Well <input type="checkbox"/> Hold to Haul <input checked="" type="checkbox"/> Other <span style="margin-left: 150px;">Bailor Room - Evaporates</span>	
Solid Discharge	Nature	<input type="checkbox"/> Filter Powder <input checked="" type="checkbox"/> Filter Cartridge <input checked="" type="checkbox"/> Still Bottom	
	Disposal Method	<input type="checkbox"/> Garbage <input checked="" type="checkbox"/> <del>Hold to Haul</del> <sup>Safety Klean</sup> <input type="checkbox"/> Other	
Chemical Storage	Type	<input checked="" type="checkbox"/> D.C. Reservoir <input type="checkbox"/> Drums <input type="checkbox"/> Tank Capacity	
Sewer	Available?	<input checked="" type="checkbox"/> Yes <input type="checkbox"/> No    If Yes, Is It Hooked Up? <input checked="" type="checkbox"/> Yes <input type="checkbox"/> No	

Comments Mr. Yi Sook Kim not on premises @ this time of inspection

~~Interviewed~~ Jane Kim - employee @ facility @ this time

Signature of Business Representative

*[Signature]*

Inspector:

*[Signature]*

Nassau County Department of Health  
NASSAU COUNTY PUBLIC HEALTH ORDINANCE - ARTICLE XI  
APPLICATION FOR A TOXIC OR HAZARDOUS MATERIALS  
STORAGE FACILITY PERMIT  
FORM I-GENERAL INFORMATION (SEE INSTRUCTION SHEET)

If applicable, check the following:  
☐ Municipality  
☐ Public School  
☐ Other tax-supported institutions

If tax exempt facility, enter N.Y. State Exempt Organization Certificate No. and enclose a copy:

For Office Use Only  
Facility I.D. 556  
Date Rec'd.  
Fee Exempt Fac. ☐ Yes ☐ No  
Permit Months:

Check all that apply to your facility:

☐ Tank Storage

☐ Container Storage

☐ Bulk Storage

☐ Storage of Road De-icing Materials

Reason for submitting application:

☒ New

☐ Renewal

☐ Change

☐ Construction

Facility Name: <u>S.S. CUSTODY CLEANERS</u>	Street Address: <u>3220 Long Beach Rd</u>	Post Office: <u>OCEANSIDE</u>	State: <u>N.Y.</u>	Zip: <u>11572</u>	Phone: <u>766-4535</u>
If Facility Mailing Address is different from above indicate: Name: <u>Byung O Kim</u>	Street Address: <u>3220 Long Beach Rd</u>	Facility Contact Person (Name & Title): <u>SBS CLEANERS</u>			
Facility Owner (Business Owner): <u>Byung O Kim</u>	Street Address: <u>2949 Beach St</u>	Post Office: <u>OCEANSIDE</u>	State: <u>N.Y.</u>	Zip: <u>11572</u>	Phone: <u>766-4535</u>
Property Owner (If not Facility Owner): <u>GM REALTY CORP</u>	Street Address: <u>136-09 41st Ave</u>	Post Office: <u>FLUSHING</u>	State: <u>N.Y.</u>	Zip: <u>11355</u>	Phone: <u>718-445-9333</u>
Tank Owner (If not Facility Owner):	Street Address:	Post Office:	State:	Zip:	Phone:

Name that should appear on Permit (Permittee)  
(If different from Facility Owner)

Permittee's Street Address: 3220 Long Beach Rd  
Post Office: OCEANSIDE  
State: N.Y.  
Zip: 11572  
Phone: 516-968-4535

Permittee's Relationship to Facility Owner: ☒ Same ☐ Operator of Facility ☐ Other (Specify):

Principal Property Tax Code: 011  
School District No. 43  
Section 336  
Block 2042  
Lot

Forms Attached ☐ Form 2 - Tank Registration ☒ Form 3 - Bulk & Container Storage Registration ☐ Form 4 - Storage of Road De-icing Materials

I hereby affirm under penalty of perjury that the information provided on this form and on any attached forms, statements and exhibits is true and correct to the best of my knowledge and belief.

Print Name: \_\_\_\_\_ Signature: \_\_\_\_\_ Title: \_\_\_\_\_ Date: \_\_\_\_\_

For Office Use Only	
Date Application Received	Facility I.D.
Reviewed	Date Reviewed

By

7 3

ify

1250

1

☐ No

1

2

0	1
---	---

4

--

--	--

---

+

---



FORM I - GENERAL INFORMATION (SEE INSTRUCTION SHEET)

☐ Yes ☒ No

☐ Storage of Road De-icing Materials

☐ Constriction

Phone (676)

766-44-71-

Phone

Phone 6576

760-445-315

Phone 718)

445-9333

Phone

Y S ~~S~~ cleaners Inc

1.1.1

Phone 516)  
766-4525

☒ Same  
☐ Operator of Facility  
☐ Other (Specify):

100

☐ Form 4 - Storage of Road  
De-icing Mater.

I hereby affirm under penalty of perjury that the information provided on this form and on any attached forms, statements and exhibits is true and correct to the best of my knowledge and belief.

Data

2126192

Nassau County Department of Health  
NASSAU COUNTY PUBLIC HEALTH ORDINANCE - ARTICLE XI  
APPLICATION FOR A TOXIC OR HAZARDOUS MATERIALS  
STORAGE FACILITY PERMIT  
FORM I-GENERAL INFORMATION (SEE INSTRUCTION SHEET)

If applicable, check the following:  
☐ Municipality  
☐ Public School  
☐ Other tax-supported institutions

If tax exempt facility, enter N.Y. State Exempt Organization Certificate No. and enclose a copy:

For Office Use Only  
Facility I.D. 3080 Date Rec'd. 9/26/97  
Fee Exempt Fac. ☐ Yes ☐ No Permit Month(s): 60

Check all that apply to your facility: ☐ Tank Storage ☒ Container Storage ☒ Bulk Storage ☐ Storage of Road De-icing Materials

Reason for submitting application: ☒ New ☐ Renewal ☐ Change ☐ Construction

Facility Name <u>Tison Cleaners, Inc.</u>	Street Address <u>3220 Long Beach Rd.</u>	Post Office <u>Oceanside</u>	State <u>NY</u>	Zip <u>11572</u>	Phone <u>(516) 766-4535</u>
Facility Mailing Address (If different from above) <u>Same as above</u>		Facility Contact Person (Name & Title) <u>In Suk Kim / owner</u>			Phone <u>same</u>
Facility Owner <u>In Suk Kim</u>	Street Address <u>Same as above</u>	Post Office	State	Zip	Phone
Property Owner (If not Facility Owner) <u>GIM Realty Corp.</u>	Street Address <u>136-89 41 Ave.</u>	Post Office <u>Flushing</u>	State <u>NY</u>	Zip <u>11355</u>	Phone <u>(718) 445-7333</u>
Tank Owner (If not Facility Owner) <u>In Suk Kim</u>	Street Address	Post Office	State	Zip	Phone

Name that should appear on Permit (Permittee)  
(If different from Facility Owner)

Imperial Cleaners

Permittee's Street Address <u>3220 Long Beach Rd.</u>	Post Office <u>Oceanside</u>	State <u>NY</u>	Zip <u>11572</u>	Phone <u>(516) 766-4535</u>
Permittee's Relationship to Facility Owner: <input checked="" type="checkbox"/> Same <input type="checkbox"/> Operator of Facility <input type="checkbox"/> Other (Specify):				

Principal Property Tax Code:	School District No.	Section	Block	Lot
------------------------------	---------------------	---------	-------	-----

Forms Attached (Check all that apply) ☐ Form 2 - Tank Registration ☐ Form 3 - Bulk & Container Storage Registration ☐ Form 4 - Storage of Road De-icing Materials

I hereby affirm under penalty of perjury that the information provided on this form and on any attached forms, statements and exhibits is true and correct to the best of my knowledge and belief.

Print Name <u>INSUK KIM</u>	Signature <u>insuk kim</u>	Title <u>Owner</u>	Date <u>9/26/97</u>
--------------------------------	-------------------------------	-----------------------	------------------------

Facility Name	Simon Cleaners, Inc.
Facility Address	

3220 Long Beach Rd. Oceanside NY 11572

For Office Use Only	
Date Application Received	Facility I. D.
Reviewed By	Date Reviewed
Action:	No. of Months
<input type="checkbox"/> Approved <input type="checkbox"/> Disapproved	

[illegible]





**NASSAU COUNTY  
DEPARTMENT OF HEALTH**  
240 OLD COUNTRY ROAD  
MINEOLA, NEW YORK 11501-4250  
516 571-3314

Amy M. Colichio  
Middleton Environmental  
181 W. Main St.- Suite B  
Babylon, NY 11702

October 22, 2004

Re: Property  
3206-3224 Long Beach Rd  
Oceanside

Dear Amy M. Colichio,

Your request for access to records of the Department of Health, Bureau of Environmental Protection has been approved. Records will be made available during normal working hours at 240 Old Country Rd., Mineola. There will be a \$0.25 per page fee for photocopying any records.

The Bureau has searched its files for records pertaining to your request and found the following records to exist:

Dry Cleaners File

Please contact Christine Pienkoski at (516) 571-3314 to schedule an appointment to review these records.

Very truly yours,

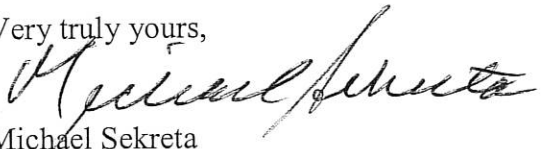
  
Michael Sekreta  
Bureau of Environmental Protection

**NASSAU COUNTY DEPARTMENT OF ASSESSMENT INFORMATION**

50' 25' 0' 50' 100'  
SCALE: 1" = 50'

N 149,100 +

WEIDNER AVE.  
(OCEANSIDE PKWY.)

LAWRENCE AVE.

24	23	22	21	20	19	18	17	16	15	14	13	12	11	10	9	8	7	6	5	4	3	2	1
100	100	100	100	100	100	100	100	100	100	100	100	100	100	100	100	100	100	100	100	100	100	100	100
102	104	107	108	109	110	111	112	113	114	115	116	117	118	119	120	121	122	123	124	125	126	127	128

MONTGOMERY AVE.

LONG BEACH RD.

N 148,600 +  
E 2,099,250 +

E 2,099,700 +



LEGEND

COUNTY LINE	---
VILLAGE LINE	---
SCHOOL DISTRICT LINE	---
SPECIAL DISTRICT LINE	---
BLOCK LIMIT	---
TOWN OF HEMPSTEAD	---
UNINCORPORATED	---
DEED DIVISION	---
REFERENCE MAPS	---

SPECIAL DISTRICTS

POLICE	---
NASSAU COUNTY	---
WATER	---
SEWER	---
REFUSE DISPOSAL	---
TOWN OF HEMPSTEAD	---
UNINCORPORATED	---
DEED DIVISION	---
REFERENCE MAPS	---

MUNICIPALITIES

TOWN OF HEMPSTEAD	---
UNINCORPORATED	---
DEED DIVISION	---
REFERENCE MAPS	---

NASSAU COUNTY  
LAND & TAX MAP  
DEPARTMENT OF ASSESSMENT  
ABE SELDIN, ASST. CHAIRMAN, BOARD OF ASSESSORS  
MAP ADOPTED: 11/98

SEC. 43  
BLK. 336



### PROPERTY INFORMATION

3) Property: 3220-3224 LONG BEACH RD, OCEANSIDE NY 11572-4110 C050

APN:	2089-43-336-00-0042-0	Use:	COMMERCIAL BUILDING
Alt/Old APN:		Tax Class/Area:	Total Value: \$3,668
Card #:	0 of 2	Prop Tax:	\$24,584.66
County:	NASSAU, NY	Tax Yr: 2004 Delinq:	Land Value: \$1,600
Census:	4132.00	Tax Apprsl Dist:	Imprv Value: \$2,068
Map Pg:	43-336-00	School Dist: 1011	Market Value:
Municipality:	TOWN OF HEMPSTEAD	Exemptions:	Mkt Land Val:
Township:		Exempt Land:	Assd Yr: 2004
		Exempt Total:	% Improve: 056%
Owner:	UNITED PROPERTIES CORP	Neighbr Code:	C1903
		Owner Vest:	/ / CO
		Phone:	
Mail:	2280 GRAND AVE; BALDWIN NY 11510-3164 C010		
Owner Transfer =	Rec Dt:	Price:	Doc#:
	Sale Dt:		Type:

### SALE & FINANCE INFORMATION

	LAST SALE		PRIOR SALE
Recording/Sale Date:	12/02/1998	11/23/1998	10/1978
Sale Price/Type:	\$1,000,000		\$130,000
Document #/Stamp \$:	10991-966	\$4,000.00	9150-787
			\$520.00
Deed Type:	DEED (REG)		
1st Mtg Loan \$/Type:	\$500,000	PRIVATE PARTY	
1st Mtg Rate/Type/Term:	/	/	
1st Mtg Lender:			
2nd Mtg Loan \$/Type:			
2nd Mtg Rate/Type/Term:	/	/	
Transfer B&P:			
Title Company:			
Seller:	GM REALTY CO		
New Construction:			
Other Last Sale Info =	# Parcels:	Type 2: MULTI	Pend:

### SITE INFORMATION

Zoning:	Sewer Type:	PUBLIC SERVICE	Acres:	0.23
County Use: 482.24	Water Type:	PUBLIC	Lot Area:	10,000
State Use: 482	Electric:	AVAILABLE	Lot Width:	100.00
Bldg Class:			Lot Depth:	100.00
			Lot Shape:	
Garage Cap#:	Site Influence:		Bldg Width:	
Garage2 Sqft:			Bldg Depth:	
Parking Sqft:				
Parking Type:				

**IMPROVEMENT INFORMATION**County: **NASSAU, NY**APN: **2089-43-336-00-0042-0**

Gross Bldg Area:	<b>3,750</b>	Total Rooms:		Construction:
Bldg/Living Area:	<b>3,750</b>	Bedrms:		Foundation:
Ground Flr Area:		Baths (Full/Half):		Ext Wall:
Above Grade:		Ttl Baths/Fixt:		Int Wall:
Upper Area:		Yr Built/Eff:	<b>1959</b>	Roof Type:
2nd Flr Area:		# Stories:		Roof Matl:
Rec Rm Area:		Fireplace/#:		Roof Shape:
Basement Area:		Basement Type:		Heat Fuel:
Basement Fin:		Pool:		Heat Type:
\$/SF:		Porch Type:		Parcel Fuel:
Perimeter Area:		Patio Type:		Floor Type:
		Attic Type:		Floor Cover:
# Bldgs:	<b>1</b>	Style:		Air Cond:
# Res. Units:				
# Comm Units:				
Inspect Entry:	<b>CP6</b>			
Permit Amt:				
Bldg Type:				
Bldg Comments:				
Parcel Comments:				

---

**LEGAL INFORMATION**

Legal Blk/Bldg: **336**  
Legal Lot/Unit: **42**  
  
Legal Desc: **42-46**

### PROPERTY INFORMATION

3) Property: **3206-3218 LONG BEACH RD, OCEANSIDE NY 11572-4110 C050**

APN:	<b>2089-43-336-00-0035-0</b>	Use:	<b>COMMERCIAL BUILDING</b>		
Alt/Old APN:		Tax Class/Area:	Total Value: <b>\$5,839</b>		
Card #:	<b>0 of 2</b>	Prop Tax:	<b>\$39,135.73</b>	Land Value:	<b>\$2,240</b>
County:	<b>NASSAU, NY</b>	Tax Yr: <b>2004</b>	Delinq:	Imprv Value:	<b>\$3,599</b>
Census:	<b>4132.00</b>	Tax Apprsl Dist:		Market Value:	
Map Pg:	<b>43-336-00</b>	School Dist:	<b>1011</b>	Mkt Land Val:	
Municipality:	<b>TOWN OF HEMPSTEAD</b>	Exemptions:		Assd Yr:	<b>2004</b>
Township:		Exempt Land:		% Improve:	<b>062%</b>
		Exempt Total:		Neighbr Code:	<b>C1903</b>
Owner:	<b>UNITED PROPERTIES CORP</b>	Owner Vest:	<b>/</b>	<b>/ CO</b>	
		Phone:			
Mail:	<b>2280 GRAND AVE STE 309; BALDWIN NY 11510-3110 C010</b>				
Owner Transfer =	Rec Dt:	Price:	Doc#:	Type:	
	Sale Dt:				

### SALE & FINANCE INFORMATION

	LAST SALE		PRIOR SALE
Recording/Sale Date:	<b>12/02/1998</b>	<b>11/23/1998</b>	<b>04/1980</b>
Sale Price/Type:	<b>\$1,000,000</b>		
Document #/Stamp \$:	<b>10991-966</b>	<b>\$4,000.00</b>	<b>9267-232</b>
Deed Type:	<b>DEED (REG)</b>		
1st Mtg Loan \$/Type:	<b>\$500,000</b>	<b>PRIVATE PARTY</b>	
1st Mtg Rate/Type/Term:	<b>/</b>	<b>/</b>	
1st Mtg Lender:			
2nd Mtg Loan \$/Type:			
2nd Mtg Rate/Type/Term:	<b>/</b>	<b>/</b>	
Transfer B&P:			
Title Company:			
Seller:	<b>GM REALTY CO</b>		
New Construction:			
Other Last Sale Info =	# Parcels:	Type 2: <b>MULTIPLE</b>	Pend:

### SITE INFORMATION

Zoning:	Sewer Type:	<b>PUBLIC SERVICE</b>	Acres:	<b>0.32</b>	
County Use:	<b>482.24</b>	Water Type:	<b>PUBLIC</b>	Lot Area:	<b>14,000</b>
State Use:	<b>482</b>	Electric:	<b>AVAILABLE</b>	Lot Width:	<b>140.00</b>
Bldg Class:				Lot Depth:	<b>100.00</b>
				Lot Shape:	
Garage Cap#:	Site Influence:		Bldg Width:		
Garage2 Sqft:			Bldg Depth:		
Parking Sqft:					
Parking Type:					

**IMPROVEMENT INFORMATION**County: **NASSAU, NY**APN: **2089-43-336-00-0035-0**

Gross Bldg Area: <b>5,880</b>	Total Rooms:	Construction:
Bldg/Living Area: <b>5,880</b>	Bedrms:	Foundation:
Ground Flr Area:	Baths (Full/Half):	Ext Wall:
Above Grade:	Ttl Baths/Fixt:	Int Wall:
Upper Area:	Yr Built/Eff: <b>1979</b>	Roof Type:
2nd Flr Area:	# Stories:	Roof Matl:
Rec Rm Area:	Fireplace/#:	Roof Shape:
Basement Area:	Basement Type:	Heat Fuel:
Basement Fin:	Pool:	Heat Type:
\$/SF:	Porch Type:	Parcel Fuel:
Perimeter Area:	Patio Type:	Floor Type:
	Attic Type:	Floor Cover:
# Bldgs: <b>1</b>	Style:	Air Cond:
# Res. Units:		
# Comm Units:		
Inspect Entry: <b>PA1</b>		
Permit Amt:		
Bldg Type:		
Bldg Comments:		
Parcel Comments:		

---

**LEGAL INFORMATION**

Legal Blk/Bldg: **336**  
Legal Lot/Unit: **35**  
  
Legal Desc: **35-41**



**Parcel**

Property Location 3206 3218 LONG BEACH RD  
Parcel ID 43336 00350  
Classification COMMERCIAL  
Land Use Code 4-Row Type Store Det, no Party Walls  
Land Area (acres) .3214  
School District OCEANSIDE UFSD  
Municipality HEMPSTEAD

**Commercial**

Card	Building Use	Year Built	Building Number	Area Per Floor	Total Area	Floor Level(s)
1	RETAIL STORE	1979	1	5,880	5,880	01 - 01

**Other Building and Yard Improvements**

Description	Area
PAVING ASP	8,000
POST & RL	840

43336 00350

3206-3218 LONG BEACH RD

NA

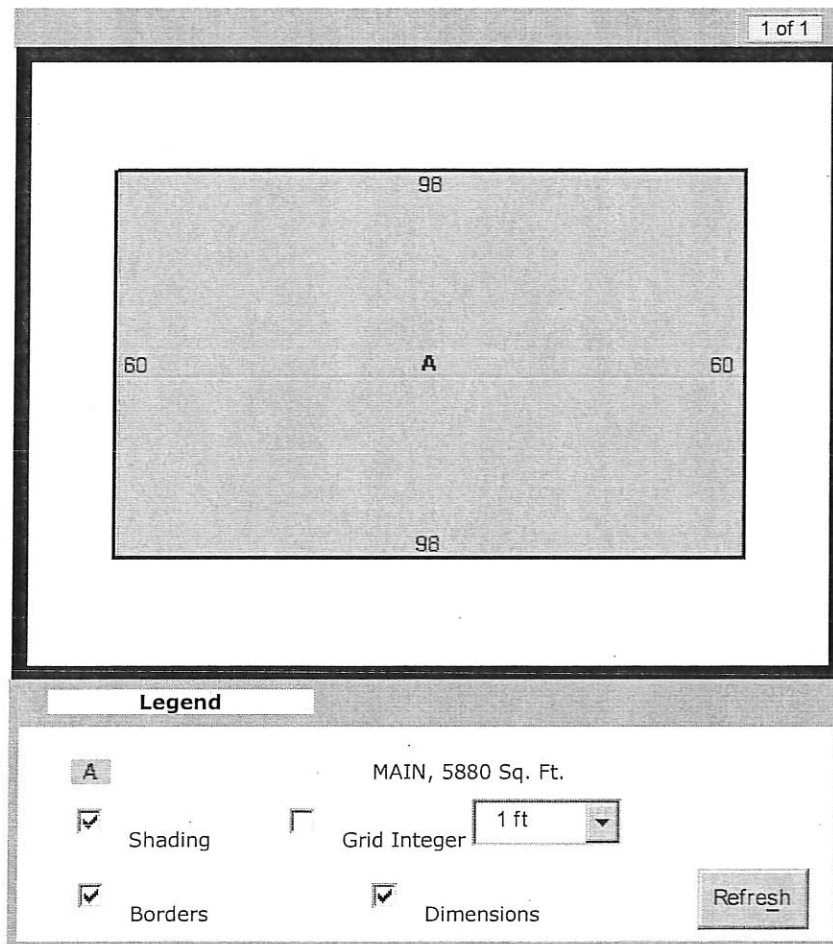

**Parcel**

Property Location 3220 3224 LONG BEACH RD  
 Parcel ID 43336 00420  
 Classification COMMERCIAL  
 Land Use Code 4-Row Type Store Det, no Party Walls  
 Land Area (acres) .2296  
 School District OCEANSIDE UFSD  
 Municipality HEMPSTEAD

**Commercial**

Card	Building Use	Year Built	Building Number	Area Per Floor	Total Area	Floor Level(s)
1	RETAIL STORE	1959	1	3,750	3,750	01 - 01

**Building Features**

Card	Description	Area/Count
1	CANOPY	455

**Other Building and Yard Improvements**

Description	Area
PAVING ASP	5,800

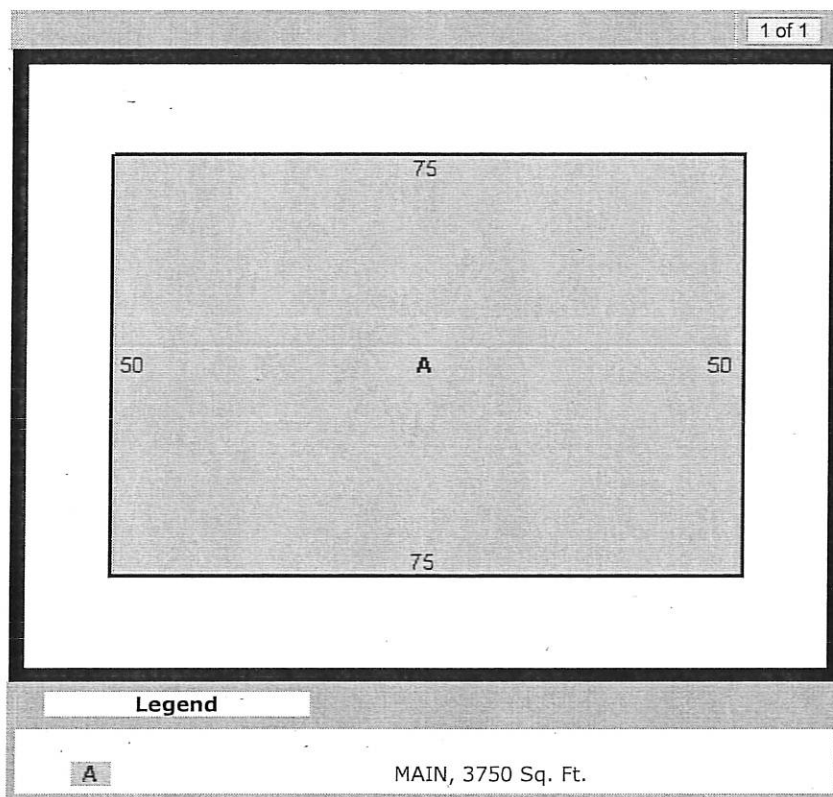

# 3206 - 3218 BUILDING

AR-33-10M-9/68

OCCUPANCY	CONSTRUCTION	SIZE	GRADE	AGE	REMOD.	COND.	PHY. DEF.	FUNCT. DEF.	REPL. VALUE	PHYSICAL VALUE	NO.
STOR	12 BRICK			1979		6	5		25,596	24,830	
HA	12 BRICK			1979		6	5		910	920	
TOTAL									25,596	24,830	

EXTERIOR WALLS	BSMT	1ST	2ND	3RD	PRICE	TOTAL
SOLID COM. BRICK						25,596
BUBBLE OR NATIVESTONE						
CONCRETE					675	
CEMENT OR CINDER BLOCK						
COM. BR. ON TILE OR C. B.					1179	
FACE BR. ON TILE OR C. B.					1042	
FACE BR. ON COM. BR.					4182	
FACE BR. VENEER						
COM. BR. VENEER						
ART. STONE FACING						
STONE FACING						
TERRA COTTA FACING						
STONE OR T. C. TRIM						
STUCCO ON TILE OR C. B.						
STUCCO ON FRAME						
SIDING OR SHINGLES						
WOOD FRAME WINDOWS						
PLATE GLASS FRONT						
PLASTERED DIRECT						
PLASTER ON FURRING						
UNFINISHED INTERIOR						
FLOORS & BSMT. AREAS						
BASEMENT AREA						
CONCRETE						
EARTH						
PINE OR FIR						
HARDWOOD						
SUB FLOOR						
WOOD JOISTS						
STEEL JOISTS						
REINFORCED CONCRETE						
FLAT ARCH TILE						
STEEL BEAMS						
TIMBER BEAMS						
REIN. CONC. BEAMS						
CEILINGS						
LATH AND PLASTER						
PRESSED METAL						
NO CEILING						
ROOFING & FRAMING						
TAR & SLAG						
COMPOSITION						
WOOD JOIST						
WOOD BEAMS						
WOOD TRUSSES						
SKY LIGHTS						
PARTITIONS						
L. & P. ON WOOD STUDS						
COM. WOOD BOARD						
PLST. BD. ON STUDS						
PLST. ON TILE OR C. B.						
PLST. ON BRICK						
STAIRS & FIRE ESCAPES						
PINE STAIRS						
HARDWOOD STAIRS						
METAL STAIRS						
FIRE ESCAPES						
INTERIOR FINISH						
PINE DOORS & TRIM						
HARDWOOD DOORS & TRIM						
ENAMEL DOORS & TRIM						
FIRE PROOF DOORS						
BUILT IN FEATURES						
HEATING						
STEAM						
VAPOR						
HOT WATER						
HOT AIR						
PIPELESS FURNACE						
NO HEATING SYSTEM						
OIL BURNER						
PLUMBING						
TOILET ROOMS						
WATER CLOSET'S EXTRA						
C. I. PIPING						
TILING						
TOILET ROOM FL. & WAINSCOT						
BATH ROOM FL. & WAINSCOT						
ELECTRICAL WIRING						
FLEXIBLE CONDUIT						
PIPE CONDUIT						

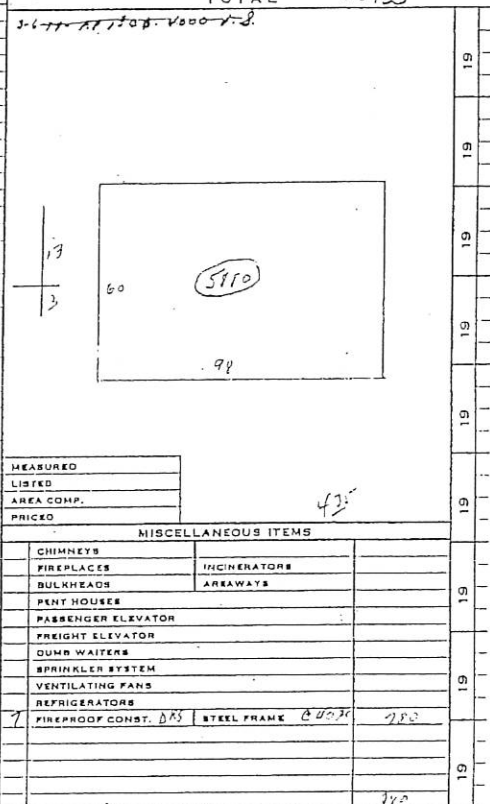

LOCATION	GOOD	FAIR	POOR
GROSS CUBAGE			
COMPUTATIONS			
WALLS (VERTICAL)			
DOORS & WINDOWS			
STORE FRONTS			
FACE BRICK OR WALL TRIM			
ROOF & FLOORS ETC. (HORIZONTAL)			
BASEMENT AREA			
STAIRS & FIRE ESCAPES			
INTERIOR FINISH			
OIL BURNER			
PLUMBING			
TILING			
TOTAL REPLACEMENT VALUE			
OCCUPANCY DETAIL & INCOME			
TOTAL			
RENTAL CAPITALIZATION			
PERCENTAGE ITEMS			
TAXES			
INSURANCE			
MAINTENANCE			
DEPR. ALLOWANCE			
CONTINGENCIES			
TOTAL CAP. RATE			
GROSS ANNUAL INCOME			
LESS FLAT EXPENSES			
BALANCE FOR PERCENTAGE CAPITALIZATION			
REFLECTED CAPITALIZED VALUE			
FLAT EXPENSE ITEMS			
COST OF OWNING LAND			
VACANCY ALLOWANCE			
COST OF HEATING			
COST OF WATER			
COST OF ELECTRICITY			
COST OF MANAGEMENT			
COST OF JANITOR			
TOTAL FLAT EXPENSES			

# 3220- 3224 BUILDING

UPFANCY	CONSTRUCTION	SIZE	GRADE	AGE	REMODEL'D	COND.	PHF. DEP.	FUNCT. DEP.	REPL. VALUE	PHYSICAL VALUE	SOUND VALUE
1/4C STAGE	15-190-51			1939		G	3		12451	12077	
1/4G-	BLACK 317	5800 sq ft	12th	1939		G	5		696	661	

EXTERIOR WALLS										TOTAL	
LIO COM. BRICK										12788	
BBLE OR NATIVESTONE											
NCRETE	3'	12"	4 1/2"	1/2"	1/2"	1/2"	1/2"	1/2"	1/2"	1/2"	
MENT OR CINDER BLOCK	14'	8"	8 1/2"	1/2"	1/2"	1/2"	1/2"	1/2"	1/2"	1/2"	
M. BR. ON TILE OR C. B.											
CE BR. ON TILE OR C. B.											
CE BR. ON COM. BR.											
CE BR. VENEER											
M. BR. VENEER											
T. STONE FACING											
ONE FACING											
TRA COTTA FACING											
ONE OR T. C. TRIM											
JCCO ON TILE OR C. B.											
JCCO ON FRAME											
ING OR SHINGLES											
OOD FRAME WINDOWS											
ATE GLASS FRONT											
ASTERED DIRECT											
ASTER ON FURRING											
FINISHED INTERIOR											
IRS & BSMT. AREAS											
EMENT AREA											
NCRETE	9 1/2"										
ITH											
IE OR FIR											
RDWOOD											
S FLOOR											
OOD JOISTS											
TEL JOISTS											
TEL JOISTS											
INFORCED CONCRETE											
AT ARCH TILE											
TEL BEAMS											
IBER BEAMS											
IN. CONC. BEAMS											
CEILINGS											
IN AND-PESTEN	5/8" x 4" x 1/2"										
ESSED METAL											
CEILING											
OFING & FRAMING											

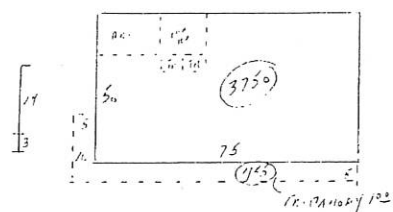

MEASURED	1-14-59
LISTED	(1.1)
AREA COMP.	
PRICED	

MISCELLANEOUS ITEMS			
1 CHIMNEYS 2 X 2 X 17	62 1/2		68
FIREPLACES		INCINERATORS	
BULKHEADS		AREAWAYS	
PENT HOUSES			
PASSENGER ELEVATOR			
FREIGHT ELEVATOR			
DUMB WAITERS			
SPRINKLER SYSTEM			
VENTILATING FANS			
REFRIGERATORS			
3 FIREPROOF CONST. DWS	STEEL FRAME 4/8 EA		120
1-1/2" x 1/2" x 1/2" x 1/2" x 1/2" x 1/2"	4-53 1/4" x 1/2"		455

LOCATION			GOOD	FAIR	POOR
GROSS CUBAGE			62720	194	
COMPUTATIONS					
230 1/2	WALLS (VERTICAL)				3175
1020 1/2	DOORS & WINDOWS				1020
	STORE FRONTS	24.60			
	FACE BRICK OR WALL TRIM				643
	MISC.				
2720 1/2	ROOF & FLOORS ETC. (HORIZONTAL)	2	191		7163
	BASEMENT AREA				
	STAIRS & FIRE ESCAPES				
	INTERIOR FINISH				
	OIL BURNER				
	PLUMBING				450
	TILING				
TOTAL REPLACEMENT VALUE					12451
OCCUPANCY DETAIL & INCOME					
No. 11A-15 - DRIVE IN DRY CLEANER - 700 sq. ft. x 1200					
Sq. ft. 1150 x 1200					
TOTAL RENTAL CAPITALIZATION					
PERCENTAGE ITEMS		FLAT EXPENSE ITEMS			
TAXES		COST OF OWNING LAND			
INSURANCE		VACANCY ALLOWANCE			
		COST OF HEATING			
		COST OF WATER			
		COST OF ELECTRICITY			
		COST OF MANAGEMENT			
		COST OF JANITOR			
MAINTENANCE					
DEPR. ALLOWANCE					
CONTINGENCIES					
TOTAL CAP. RATE		TOTAL FLAT EXPENSES			
GROSS ANNUAL INCOME					
LESS FLAT EXPENSES					
BALANCE FOR PERCENTAGE CAPITALIZATION					
REFLECTED CAPITALIZED VALUE					

**COLES INFORMATION (FOR PAST PROPERTY USAGE)**



2115 Harold Luchy	766-3732	3381 Andon Sales Corp	535-5601	3600 R&G Brenner Tax	764-7383	342 E J Davis	764-3282
*W&J Agency	766-3525	*Minal Corp	678-1045	*C&K Palace	538-3553	*Dr Robert C Hock	536-4512
*Pine Town House	766-3732	*Dr Michael Perillo	536-5850	*Deville Jewelry	764-7228	*Dr Siegel Assoc	536-4512
*Ralph Poller	766-3525	3393 Alliance Vending	764-6448	*Fabulous Travel	536-0700	*Dr Siegel Assoc	536-4512
*Andrew Spadovola	766-3732	3395 Fox Store Fronts	536-6800	*Foodtown	536-6448	Dr S A Bagal	536-4512
*Tringoni Corp	766-3732	3400 Ship-Town	766-9020	*Foodtown	764-3396	345 Alan Frisberg	657-6760
3118 Olga Oline	766-3525	3401 McIntyre Dist Muffin	766-2832	*Jacobs Meyers Law	538-4502	346 Jack O Lehon	764-5191
*Tuck-Her Inn	766-9018	3414 T J Automotive Del	766-3565	*Jacobs Meyers Law	538-4502	350 Michael Mancilio	678-4350
3118 Consumers Electric	764-3485	*T J Automotive Del	766-9132	*Kohn Oceanide	678-4774	354 John F Loonam	764-1162
*Gorak Electric	764-4495	*T J Sunoco	766-0132	*Lew Jacoby & Meyer	678-4502	355 358	NP
*Ralph Harris	536-2155	3427 A Oceanide Auto Bix	678-4733	*Lew Jacoby & Meyer	678-7870	414 Thomas H Murphy	764-0599
3120 Thomas Gould	80 678-6795	3440 The Drop Spot Inc	536-2972	*TSS Optical Cntr	768-1616	421 Joseph M Kelly	678-4742
*Maxwell Delicat	766-9883	3451 George Corson's	678-1275	*Times Sq Stores	678-4800	443 Great Rock Florist	766-7006
W Kenneth McDowell	77 578-4013	*Rudy's Fish & Chips	766-9819	*Universal Dentist	536-5336	A Kava	80 764-9007
3121 Olympia Shell Sta	626-2867	3452 Andy's Road Beef	766-9705	*Winterhill Liquors	766-4869	Unk Mary Kane	678-2207
3122-62 Stationary	536-4940	3463 Color Tile Suppmnt	766-5500	No *Abby's Garden Cntr	536-3830	Ronald K Kana	768-3903
3124 B Ferguson	76 766-1879	*Lori's Previn Four	764-6252	No *Erie Clothing Inc	678-1888	*M&B Florists Inc	768-7001
William R Hanagan	878-2977	3475 Ocnad Trvl Center	678-1151	No *Lady Rose of Ocnad	536-5165	*Merrill Florists	766-7000
*Ocean Chemists	764-9600	3477 Eastin Signs LI	678-1151	No *Rocky Crtry Club	766-9200	444 Dr Herbert M Parr	766-4741
W J Smith Jr	64 536-4465	3496 East Bay Diner	766-2551	No *Rockville Link Ctr	766-9742	451 Neil Rulo	67 678-2782
3131 M&S Automotive Amst	766-2066	3530 Burton Berger	71 766-1556	No *Rockville Link Ctr	766-9742	453 Yohel V Palumbo	536-7343
*Nalsons Famous Inc	766-2345	Joacan S Daniels	74 536-2892	No *Rockville Link Ctr	766-9742	455 Richard Karpac	678-2993
3132 Liberty Enterprises	766-4379	Fred A Flank	764-9287	No *Times Sq Electronic	768-3328	478	NP
*Liberty Real Est	536-4385	Mrs S Kait	76 536-4657	188 Residence	458 Business	479 Cln Smenberg	76 678-4853
3140 A Trachars Fish	766-3414	Abe Nazimsky	76 536-2088			Robert J Smenberg	73 536-0821
3151 Century Fedl SwLn	678-2244	Alon Silvanian	74 678-3678			Florence Fogarty	76 678-4241
3152B Conversation Place	764-1171	Rit Vaznar	678-3745			Robert C Smith	76 678-1404
3165 Andre Ben & Co	764-8484	Lawrence Lenc	678-0687			484 Dr S Goldstein	768-1169
*Chibank N	456-5300	3530-2 H. Zimmerman	76 678-5165			488 F Tiller	63 768-7299
3157 Oceanide Bookshop	764-3024	3530-3 T K Eisenberg	76 678-5165			493	NP
3158 Yogurt Plus	766-5558	3530-4 Alan Grossberg	76 766-6108			523 William Lechinski	80 764-8141
3162 Window Rama Corp	764-0804	3530-5 Neil Stein	76 764-4735			531	NP
*Windowrama	678-4479	3530-6 Gerald Hader	80 536-2803			532 A Anna Acerno	74 763-1891
3167 Male Depot	536-7225	3530-7 James M Kannev	76 766-8506			A Anna Acerno	74 766-7107
3170 Carpet City Sls	678-2111	3530-8 R Kassin	79 536-5812			543 535	NP
*Furnman Realty Co	536-5515	3530-9 M Gudinsky	67 678-2884			609 Joseph Toman	766-7255
*Furnman Realty Co	536-5515	3530-10 Marvin Lewin	536-4681			637 Raymond Butler	79 678-1520
*Rug Mart Inc	536-5515	3530-11 Marvin Lewin	536-4681			561 Wilam L Denchly	80 764-9218
3173 Even Stage Inc	766-2515		NP			1327 Herold Gerson	76 678-1812
*Proless	766-3100					M Gordon	76 678-2822
3177 Nassau Vision Ctr	536-5300					1358 Charles H Voheln	80 766-7687
3179 Helicover Lid	764-3339					1375	NP
3181 J&E Cleaners	766-5699					No *Rockville Links Corp	766-3200
3183 Candy Cottage Cntr	536-5620					No *Rockville Links PI	766-3444
3185 Kason Travel	764-5090					89 Residence	62 Business
3187 Krawli Jewellers	766-3855						
3190 Burger King	536-6405						
3191 Fayre Shoes	766-9629						
3193 Twist of Lmn Cds	766-3600						
3195 Martin PnHm Decr	766-8257						
3199 Oceanview Drug Stor	764-7200						
3200 Maple Ctr Furnr	678-4800						
3202 Allstate Ins Co	766-7800						
3204 Ocean Plaza Rl Est	536-7772						
3210 Andrew Watson	626-7776						
3212 Myriad Travel Lid	678-4422						
3214 S&Z Liquor Corp	764-7893						
3216 Lill Al Pizzeria	766-0411						
3218 Capriccio Hair Sid	764-8003						
*Capriccio Hair Sid	536-0303						
3220 B&K Ladies Apparel	766-8824						
3221 Wadsworth Supermrt	766-8824						
3223 Atlantic Ave Int	536-2288						
*Anmol Inn	626-2288						
3232 Nemo Army & Navy	764-3706						
3233 Schwartz Mdel	80 764-1188						
3235 Chantale Cuisine	536-8187						
3247 The Poultry Chef	536-5100						
3249 The Dance Shoppe	766-8764						
*The Dance Shoppe	766-8778						
*Oceanide Country	766-9458						
3250 The Candy People	766-7878						
3255	NP						
3256 Arthur Sandberg	77 678-4474						
*Whitbread Sons Lmbr	678-2545						
*Whitbread Sons Lmbr	678-2522						
*Whitbread Sons Lmbr	766-2482						
3257 Emerald Barber Shop	766-8437						
3259 Addict Cosmetics	766-5883						
*Beaede Jewelry	766-0767						
*Frans Bagg & Accs	536-7480						
*Ungerle Affair	536-4472						
*P M Boutique Ltd	764-0064						
*Sweet Emily Ath	678-5885						
326 *ALS Glass	764-2415						
327 Gibraltar Trsmns	764-7277						
3279 J Lenore II	536-6480						
*Terry Fish Mkt	678-2209						
3285 A Graphic Method	764-1144						
*Chemical Bank	766-7100						
3286 Carvel	764-7716						
3281 Seachuan E Cr	536-5181						
3297 Christopher's Loung	766-9622						
*Rives Tailoring	536-4451						
3298 Frame Fantasy	764-1113						
3300 Famous Pizza Lid	766-3050						
3303 Golan Kichan Mrs	678-2264						
A Sew Again Inc	764-7521						
3308 Tori Landromet	766-9521						
3312 Y M Ohelein	678-1848						
B&B Secure L&A Lim	766-2770						
3314 Gee Bees Motors	678-4484						
3323 Freight Claims Del	536-4930						
3324 Andys Auto Parts	766-4128						
*Andys Auto Parts	766-5070						
*Andys Auto Parts	766-4134						
Maria Giordano	88 764-8556						
3324 Oceanide Powermt	766-9340						
3327 P&A Sons Auto	536-6110						
*P&A Sons Auto	766-8288						
*P&A Sons Auto	766-8438						
3344 Senior APPL Serv	764-6080						
*Senior APPL Serv	764-6080						
3345 Oceanide Gulf Sls	766-9270						
*Oceanide Gulf Sls	766-9270						
3348 State Farm Ins Co	678-4221						
*E Vanhoulen Inc	678-4228						
3350 Mendinger Gifts	678-1392						
3354 Classic Floors Inc	678-3058						
3356 Big Banana Market	678-3358						
*Big Banana Mkt	766-3200						
336 H J Adorno Inc	766-0758						

1.	name, address of the donor	1. 9. 9. 1912 - 102 Elm Street 1907, 1908, 1909
2.	name of the gift	3A 524, 715 - Common Traces Whelan Rating
3.	quantity of gift	100 - Map Location -

PERMURGENT PAINT	7683377
55 CUMMINGS RESTRAINT	7663777
55 JOSEPH FURNITURE	6313664
55 JOSEPH FURN CO	6783006
55 BLOSSOM HEATH	8061000
55 BLOSSOM HEATH	8063566
55 HENRIE WATSON	7663666
55 HENRIE TAILOR	7640325
55 ANDREW LUNGB CTR	6336060
55 HENRIE LUNGB AND	8063666
55 HENRIE LUNGB AND	8063666
55 HENRY W DAVOLI	7666762
55 MICHAEL EOWNER	7640011
55 M E GREENSPAN	5366141
55 H HINSCHMANN	6761161
55 B LEHMAN	7670161
55 ADRIED LUBART 8	7645161
55 HARVEY ORLIN	6768154
55 PAUL SCHOFFELD	7666153
55 SEYMOUR SICHAL	7666153
55 SMITH SHER	7646811
55 MARTIN SPIEGEL	7666875
55 CARP TAKE OUT	0066800
55 MILDRED W LANKENAU	8064400
55 SAN PAN CHINESE	8042001
55 PAUL POTTERBY PLACE	7642100
55 C FRIEDBERG CPA	5363555
55 HALLSON DEVELOP CO	7662727
55 HALLSON DEVELOP COMP	7662747
55 HALLSON DEVELOP CO	8607254
55 JUDD ACADEMY	7666277
55 KLS DEVELOPERS	7669767
55 KLS DEVELOPERS INCORP	7667727
55 KLS DEVELOPERS CORP	7662727
55 KLS DEVELOPERS	80764055
55 MEED-COM SYSTEMS	7662747
55 JOHN BOLES	7603292
55 CHRIS LILL	7603292
55 JILL DELICIOUS	8066288
55 JOHN RIOLA	8063219
55 AUTO AUTOMOTIVE	7667620
55 MAURICE	5364440
55 STATIONARY	8069268
55 JACKS BARBER SHOP	7667331
55 LUCY LUND	5366733

MRS EMMA MCQUADE 4 5304468  
W J SMITH JR 9 7066998  
MELBA WARMHOLD 9 8065371  
3280 PARKER RD EST 7041974  
708J A ROODES PARK 7041974  
A ROODES PARK 6785400  
DOORHAPLE CNTR INTERIOR 9048999  
TRIANGLE INTERIORS 9042073  
MATTIE BOG BAKE SHOPS

\*SYON KCSHER PACKNG RO88830  
\*VALDBAUMS SUPERMKT 7669437

327	DR ALLAN J AHEARN	0065000
328	DOE ANIMO ANML HOPE	0060060
329	DOE RICHARD ZEITLER	0060600
330	DOE RICHARD GUTLEY SHOES	0080700
331	DOE THE TAILOR INC	0081160
332	DOE MAX SCHWARTZ TLR	0081550
333	DOE TIMOTHY LINT	0706150
334	DOE W H WART	0067180
335	DOE M M SCHROEDER	0064121
336	DOE ARBSCO SVCS INC	0080000
337	DOE KEN ROSE STUDIO	0080500
338	DOE ROSEBUDS	0080607
339	DOE ROSEBUDS DRUGS	7664484
340	DOE SUE NOM	8764200
341	DOE WHITEBREADS SONS LM	0085222
342	DOE WHITEBREADS SONS LM	0085222
343	DOE WEEBES BARBER SHP	7694931
344	DOE WEEBES BARBER SHP	7698292
345	DOE WESSAU TOOL RENTAL	0065177
346	DOE WEMURRAYS SVCE CNTR	0069300
347	DOE WHEELER TRUCK RENTAL	0069300
348	DOE STEVENSON BOY WRKS	0069328
349	DOE WALS GLASS	8762115
350	DOE WALS GLASS	8762115
351	DOE CONSUMERS ELECTRONC	0043492
352	DOE GERGO ELECTRONICS	0080458
353	DOE GEMCHEMICAL BANK	7671000
354	DOE HANDELMAN ASSOC'S	7644144
355	DOE HANDELMAN ASSOC'S	7647716
356	DOE MORRISONS RESTAUR	0066882
357	DOE ROYAL CASTLE DNUT SH	0069491
358	DOE ROYAL CASTLE SHOPS	0069351
359	DOE ROYAL CASTLE SHOPS	0069381
360	DOE S350 NEON SIGNS	0064342
361	DOE S450 SOUTH SHORE SHT	8708622
362	DOE S450 SOUTH SHORE SHT	7644121
363	DOE S450 SOUTH SHORE SHT	7644121
364	DOE S450 SOUTH SHORE SHT	7644121
365	DOE S450 SOUTH SHORE SHT	7644121
366	DOE S450 SOUTH SHORE SHT	7644121
367	DOE S450 SOUTH SHORE SHT	7644121
368	DOE S450 SOUTH SHORE SHT	7644121
369	DOE S450 SOUTH SHORE SHT	7644121
370	DOE S450 SOUTH SHORE SHT	7644121
371	DOE S450 SOUTH SHORE SHT	7644121
372	DOE S450 SOUTH SHORE SHT	7644121
373	DOE S450 SOUTH SHORE SHT	7644121
374	DOE S450 SOUTH SHORE SHT	7644121
375	DOE S450 SOUTH SHORE SHT	7644121
376	DOE S450 SOUTH SHORE SHT	7644121
377	DOE S450 SOUTH SHORE SHT	7644121
378	DOE S450 SOUTH SHORE SHT	7644121
379	DOE S450 SOUTH SHORE SHT	7644121
380	DOE S450 SOUTH SHORE SHT	7644121
381	DOE S450 SOUTH SHORE SHT	7644121
382	DOE S450 SOUTH SHORE SHT	7644121
383	DOE S450 SOUTH SHORE SHT	7644121
384	DOE S450 SOUTH SHORE SHT	7644121
385	DOE S450 SOUTH SHORE SHT	7644121
386	DOE S450 SOUTH SHORE SHT	7644121
387	DOE S450 SOUTH SHORE SHT	7644121
388	DOE S450 SOUTH SHORE SHT	7644121
389	DOE S450 SOUTH SHORE SHT	7644121
390	DOE S450 SOUTH SHORE SHT	7644121
391	DOE S450 SOUTH SHORE SHT	7644121
392	DOE S450 SOUTH SHORE SHT	7644121
393	DOE S450 SOUTH SHORE SHT	7644121
394	DOE S450 SOUTH SHORE SHT	7644121
395	DOE S450 SOUTH SHORE SHT	7644121
396	DOE S450 SOUTH SHORE SHT	7644121
397	DOE S450 SOUTH SHORE SHT	7644121
398	DOE S450 SOUTH SHORE SHT	7644121
399	DOE S450 SOUTH SHORE SHT	7644121
400	DOE S450 SOUTH SHORE SHT	7644121