

(Fact Sheet Begins Next)

Act Now to Continue Receiving Information About This Site!

DEC's Division of Environmental Remediation (DER) now distributes information about contaminated sites *electronically by email*.

If you would like to continue to receive information about the contaminated site featured in this fact sheet:

You must sign up for the DER email listserv:

www.dec.ny.gov/chemical/61092.html

DER cannot register your email address - only the email address owner can do so. If you already have signed up for the listserv for the county in which the site is located, you need do nothing.



Why You Should Go “Paperless”:

- Get site information faster and share it easily;
- Receive information about all sites in a chosen county - read what you want, delete the rest;
- It helps the environment and stretches your tax dollars.

If “paperless” is not an option for you, call or write to the DER project manager identified in this fact sheet. Indicate that you need to receive paper copies of fact sheets through the Postal Service. Include the site name in your correspondence. The option to receive paper is available to individuals only. Groups, organizations, businesses, and government entities are assumed to have email access.



Department of
Environmental
Conservation

Where to Find Information

Access project documents through the
DECinfo Locator at:

<https://www.dec.ny.gov/data/DecDocs/C152146/>
<https://www.dec.ny.gov/data/DecDocs/V00384/>

and at these location(s):

Longwood Public Library
800 Middle Country Road
Middle Island, NY 11953
(631) 924-6400

Mastics-Moriches-Shirley-Community
Library
407 William Floyd Parkway
Shirley, NY 11967
(631) 399-1511

Who to Contact

Comments and questions are always
welcome and should be directed as follows:

Project-Related Questions

Tara Rutland, Project Manager
NYSDEC
625 Broadway
Albany NY, 12233-7015
(518) 402-9621
tara.rutland@dec.ny.gov

Project-Related Health Questions

Anthony Perretta
NYSDOH
ESP Corning Tower, Rm 1787
Albany, NY 12237
(518) 486-7186
beej@health.ny.gov

For more information about New York's
Brownfield Cleanup Program, visit:
www.dec.ny.gov/chemical/8450.html

FACT SHEET

Brownfield Cleanup Program

Long Island Rail Road -
Yaphank Site
East of River Road,
South of RR Tracks
Yaphank, NY 11980

April 2021

SITE No. C152146
NYSDEC REGION 1

Remedy Proposed for Brownfield Site Contamination; Public Comment Period Announced

The public is invited to comment on a proposed remedy being reviewed by the New York State Department of Environmental Conservation (NYSDEC), in consultation with the New York State Department of Health (NYSDOH), to address contamination related to the Long Island Rail Road Yaphank site ("site") located between River Road and Moriches-Middle Island Road, and along the south side of the Long Island Rail Road (LIRR) tracks, in the Hamlet of Yaphank, Town of Brookhaven. Please see the map for the site location.

Based on the findings of the investigation, NYSDEC in consultation with the NYSDOH has determined that the site does not pose a significant threat to public health or the environment.

How to Comment: NYSDEC is accepting written comments about the proposed plan, called a "Remedial Work Plan (RWP)" for 45 days, from **April 7 through May 24**.

- Access the RWP and other project documents online through the DECinfo Locator:
<https://www.dec.ny.gov/data/DecDocs/C152146/> and
<https://www.dec.ny.gov/data/DecDocs/V00384/>
- Documents are also available at the location(s) identified at left under "Where to Find Information."
- Please submit comments to the NYSDEC project manager listed under Project-Related Questions in the "Who to Contact" area at left.

Remedial Work Plan: The proposed mixed-use remedy consists of:

- Excavation and on-site consolidation of fill material and soils on the residential property that exceeds residential use soil cleanup objectives (SCOs), and importing clean material that meets residential SCOs for use as backfill;
- Excavation and regrading of on-site soil to achieve design grades, improve drainage, and facilitate a site-wide cover system;
- Consolidation of all excavated material on to the western portion of the LIRR property;
- Installation of an impervious geomembrane cap over the area of consolidated fill on the LIRR property;
- Placement of cover systems, including a demarcation layer over areas without hardscape (buildings, asphalt or concrete), to address contamination remaining above industrial soil cleanup objectives;

BROWNFIELD CLEANUP PROGRAM

- Implementing a Health and Safety Plan and Community Air Monitoring Plan during all ground intrusive activities;
- Implementation of a Site Management Plan (SMP) would also be required for long term maintenance of remedial systems; and
- Recording of an Environmental Easement to ensure proper use of the site.

The proposed remedy was developed by the Long Island Rail Road (“applicant”) after performing a detailed investigation of the site under New York State oversight.

Next Steps: NYSDEC will consider public comments, revise the cleanup plan as necessary, and issue a final Decision Document. NYSDOH must concur with the proposed remedy. After approval, the proposed remedy becomes the selected remedy. The applicant may then design and perform the cleanup action to address the site contamination, with oversight by NYSDEC and NYSDOH.

NYSDEC will keep the public informed throughout the investigation and cleanup of the site.

Site Description: The 7.5-acre brownfield site is comprised of the LIRR-owned property and impacted portions of three adjacent parcels. The LIRR-owned property is a relatively long, narrow, 4-acre parcel running parallel to and south of the LIRR main line track and located immediately east of River Road. A 1.6-acre property operated by an asbestos and hazardous waste collection and trucking company is located immediately to the east of the LIRR property and is extensively underlain with fill material. A 1.9-acre concrete mixing plant property and a 0.02-acre undeveloped residential property are located immediately south of the LIRR property and are impacted by fill material to a lesser extent. The overall brownfield site is identified on the Suffolk County Tax Maps as Section 640 Block 1 Lot 2 (4-acres); Section 641 Block 1 – Lot Nos. 12-21 and 44 (3.5+- acres). Following remediation, the properties will remain in use as they are currently.

Additional site details, including environmental and health assessment summaries, are available on NYSDEC's Environmental Site Remediation Database (by entering the site ID, C152146) at:

<https://www.dec.ny.gov/cfm/xtapps/derexternal/index.cfm?pageid=3>

Summary of the Investigation: Metals including lead and arsenic were found in surface and subsurface soil at concentrations above use-specific soil cleanup objectives. Contamination is present at depths of up to 24 feet below grade and is the result of past site use and historic fill disposed of on the site. There are no off-site impacts to groundwater including that which extends to the Carmen’s River.

Brownfield Cleanup Program: New York's Brownfield Cleanup Program (BCP) encourages the voluntary cleanup of contaminated properties known as "brownfields" so that they can be reused and redeveloped. These uses may include recreation, housing, business, or other uses. A brownfield site is any real property where a contaminant is present at levels exceeding the soil cleanup objectives or other health-based or environmental standards, criteria or guidance adopted by DEC that are applicable based on the reasonably anticipated use of the property, in accordance with applicable regulations.

For more information about the BCP, visit:
<https://www.dec.ny.gov/chemical/8450.html>

We encourage you to share this fact sheet with neighbors and tenants, and/or post this fact sheet in a prominent area of your building for others to see.

Stay Informed With DEC Delivers

Sign up to receive site updates by email:
www.dec.ny.gov/chemical/61092.html

Note: Please disregard if you already have signed up and received this fact sheet electronically.

DECinfo Locator

Interactive map to access DEC documents and public data about the environmental quality of specific sites: <https://www.dec.ny.gov/pubs/109457.html>

BROWNFIELD CLEANUP PROGRAM

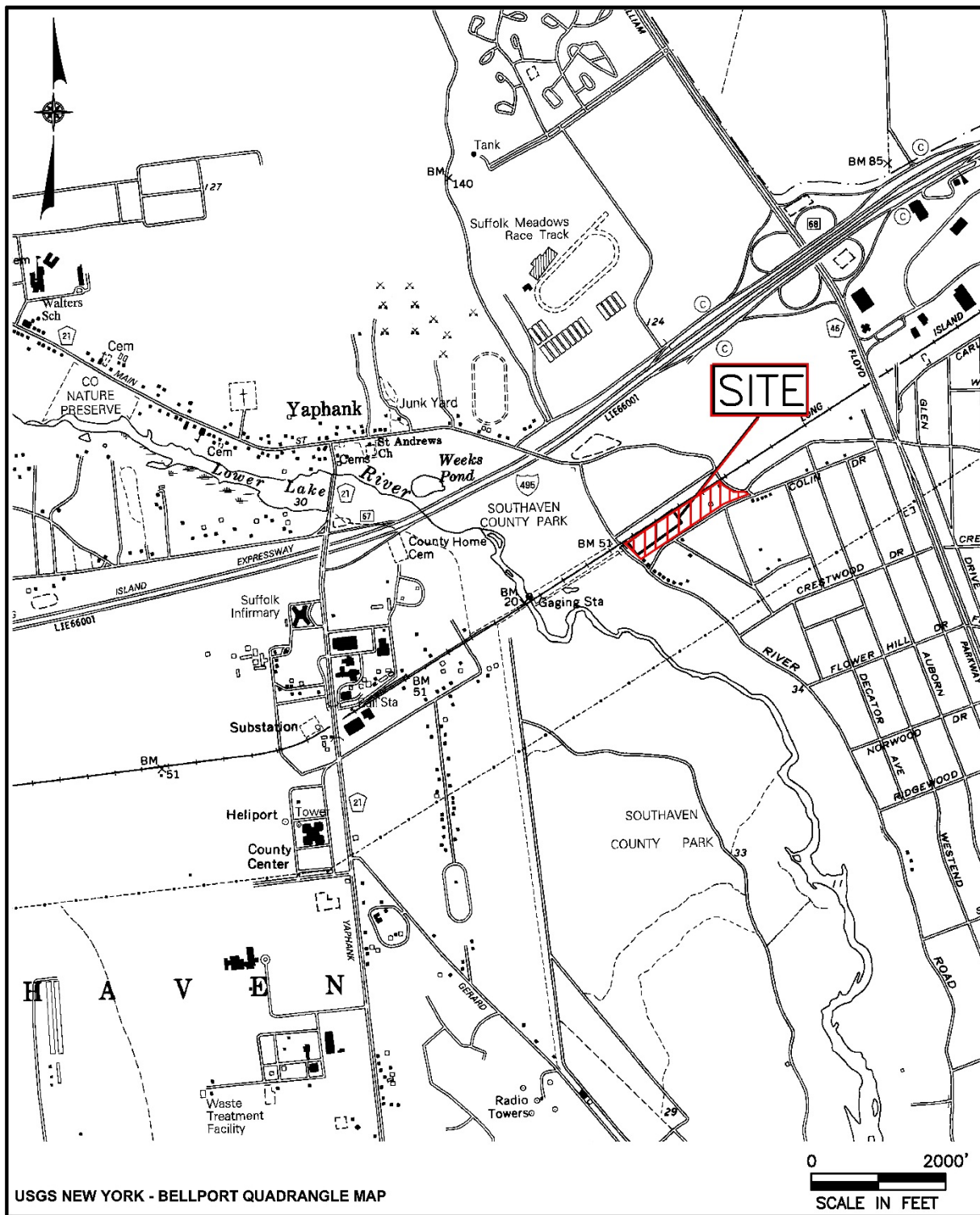

USGS NEW YORK - BELLPORT QUADRANGLE MAP

LONG ISLAND RAIL ROAD - YAPHANK SITE



Department of Environmental Conservation

SITE LOCATION MAP