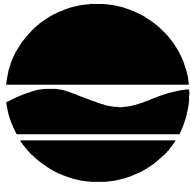

NEW YORK STATE
DEPARTMENT OFENVIRONMENTAL
CONSERVATION**Dear Citizen:**

The New York State Department of Environmental Conservation (NYSDEC) will be conducting additional off-site groundwater investigation activities related to the Levey Property Site. This groundwater investigation activity involves the drilling and development of several temporary monitoring wells identified at several strategic points down-gradient of the Levey Property site. Please refer to Figure 2 for the identified locations for the well installations.

The State is intending to install these temporary wells in your area between **April 19, 2010** and **May 3, 2010**. Please keep in mind that these dates are tentative, and may change due to unforeseen circumstances encountered during the well drilling and development process. If you have any questions or would like more information, please contact:

Mr. Chek Beng Ng
Project Manager
NYSDEC

625 Broadway, 11th Floor
Albany, NY 12233-7015
(518) 402-9620

FACT SHEET

April 9, 2010

Levey Property Site

SITE No. C152201

1305 South Strong Ave.,

Copiague, NY 11726

**Field Activities for the Levey
Property Site****Background**

The New York State Department of Environmental Conservation (NYSDEC) is proposing to conduct an off-site Remedial Investigation (RI) study to evaluate any potential contamination issues related to the Levey Property Site under the State Superfund Program (SSF).

The site is located at 1305 South Strong Avenue, Copiague, NY (see Figure 1). This site is a rectangular-shaped parcel and is approximately one acre consisting of Lot 29 in Block 2 of Section 198 as identified by the Town of Babylon Assessor's Office. An abandoned two-story commercial building currently occupies the site.

Site History

Environmental investigations at the site began in 2002 by the Suffolk County Department of Health Services. Further site investigation performed by NYSDEC in 2006 found 1,1,1-trichloroethane (TCA) to be the main groundwater contaminant on-site. The source of the TCA is believed to be associated with previous on-site activities which included wallpaper production and a car and boat repair business. In November 2006, the Levey Property site was accepted into the NYSDEC Brownfield Cleanup Program (BCP). The on-site remedial RI work is currently being performed under the BCP.

Proposed Activities

As part of the off-site RI, the State is planning to install up to eleven (11) groundwater monitoring wells at locations identified in Figure 2 to track the extent of the TCA plume. All drilling work will be done in the right-of-way at the side of the road. This investigation will be used to determine the type of remedial measures needed, if any, to minimize the impact of the plume. The results of this groundwater investigation will also be used to determine if additional monitoring wells are needed to track the plume migration and to assess the need for any soil vapor intrusion investigations at locations south of the site.

Field activities are scheduled to be performed from 8 AM to 5 PM between **April 19, 2010** and **May 3, 2010**. Please keep in mind that these dates are tentative, and may change due to unforeseen circumstances encountered during the well drilling procedure.

Health Assessment

Public water, which is regularly monitored, serves the area surrounding the site so people are not expected to drink contaminated water. Annual Water Quality Reports are available on the Suffolk County Water Authority's website: www.scwa.com

Citizen Participation

Results from this off-site groundwater investigation and the RI will be available when milestones (e.g. Proposed Remedial Action Plan and Record of Decision) are reached. Public comments will be sought and considered on the Proposed Remedial Action Plan.

Document Repositories: *To review site information:*

NYSDEC Region 1
Attn: Mr. Walter Parish
SUNY Campus Bldg. 40
Stony Brook, NY 11790
Phone: (631) 444-0240

NYSDEC Central Office
Attn: Mr. Chek Beng Ng
625 Broadway, 11th Floor
Albany, NY 12233-7015
Phone: (518) 402-9620

For More Information: *Call or write the following staff for more information about:***Project-Related Information:**

Mr. Chek Beng Ng
NYSDEC Central Office
625 Broadway, 11th Floor
Albany, NY 12233-7015
Phone: (518) 402-9620

Site-Related Health Information:

Ms. Sharon McLelland
NYSDOH, BEEI
Flanigan Square, Room 300
547 River Street
Troy, New York 12180-2216
Phone: (800)458-1158 x27880

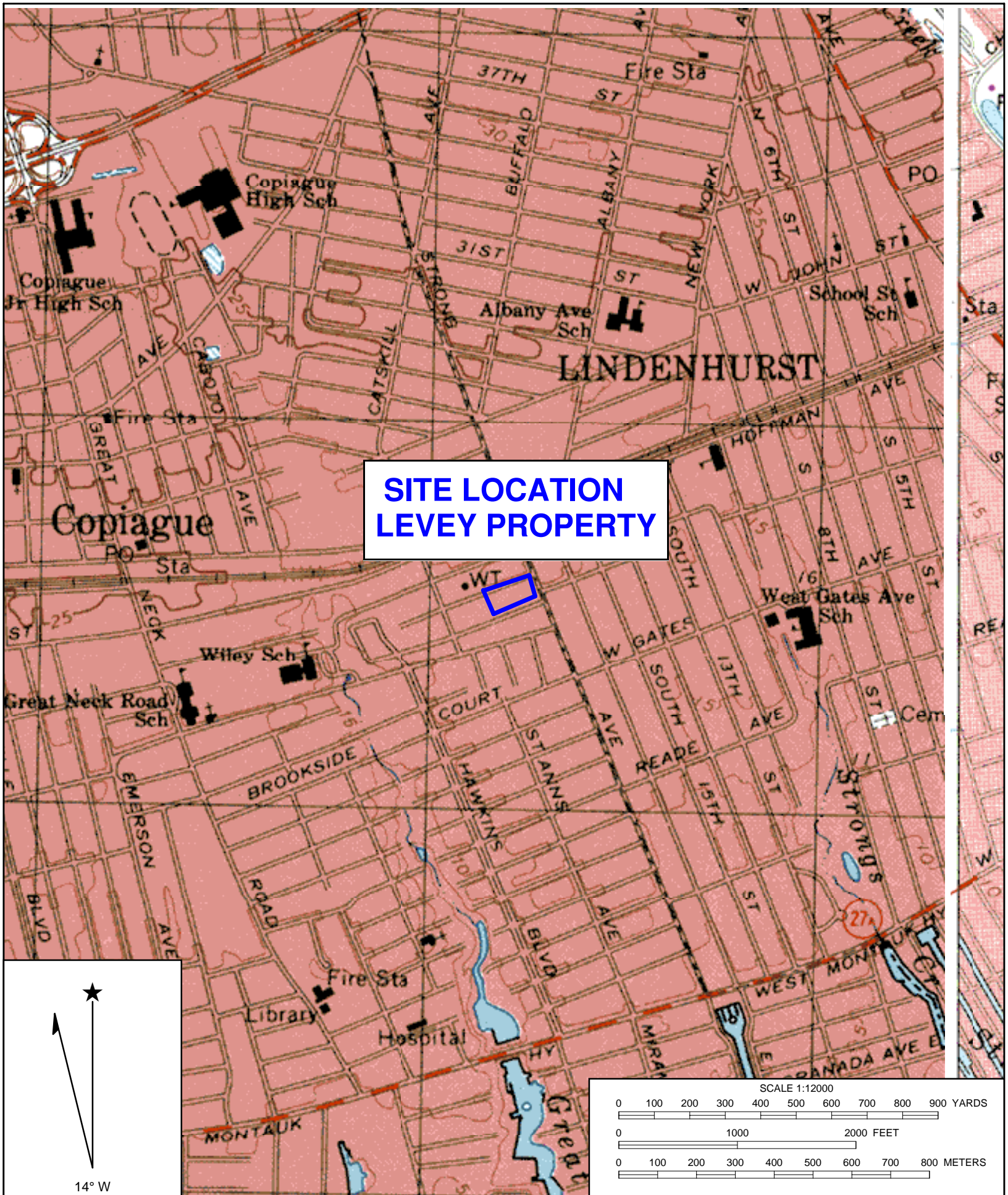

**SITE LOCATION
LEVEY PROPERTY**

Name: AMITYVILLE
 Date: 8/31/2006
 Scale: 1 inch equals 1000 feet

Location: 040° 40' 49.43" N 073° 23' 19.89" W
 Caption: FIGURE 1
 1305 SOUTH STRONG AVE
 COPIAGUE, NY 11726

Figure 2: Off-Site Levey Property Groundwater Investigation

