

EAST 139th

(PUBLIC STREET)  
(60' WIDE)

SS-08	6NYCRR Part 375 Restricted SCO Rstrct Resident	0-2"	2"-24"
Constituent	Lead	400	37.7 [7000]

SS-15-17 Composite	6NYCRR Part 375 Restricted SCO Rstrct Resident	0-2"	2"-24"
Constituent	Benzo(a)anthracene	1000	[1300] [1400]
	Benzo(a)pyrene	1000	[1200] [1300]
	Benzo(b)fluoranthene	1000	[1600] [1700]
	Indeno(1,2,3-cd)pyrene	500	[710] [710]

SS-03	6NYCRR Part 375 Restricted SCO Rstrct Resident	0-2"	2"-24"
Constituent	Lead	400	58.5J [2480]J

SS-01	6NYCRR Part 375 Restricted SCO Rstrct Resident	0-2"	2"-24"
Constituent	Benzo(a)anthracene	1000	[4400] 450
	Benzo(a)pyrene	1000	[4100] 420
	Benzo(b)fluoranthene	1000	[5400] 500
	Chrysene	3900	[4800] 480

SS-04	6NYCRR Part 375 Restricted SCO Rstrct Resident	0-2"	2"-24"
Constituent	Lead	400	337J [460]J

SS-02	6NYCRR Part 375 Restricted SCO Rstrct Resident	0-2"	2"-24"
Constituent	Benzo(a)anthracene	1000	820 [3100]
	Benzo(a)pyrene	1000	740 [2900]
	Benzo(b)fluoranthene	1000	890 [3400]
	Indeno(1,2,3-cd)pyrene	500	400 [1600]

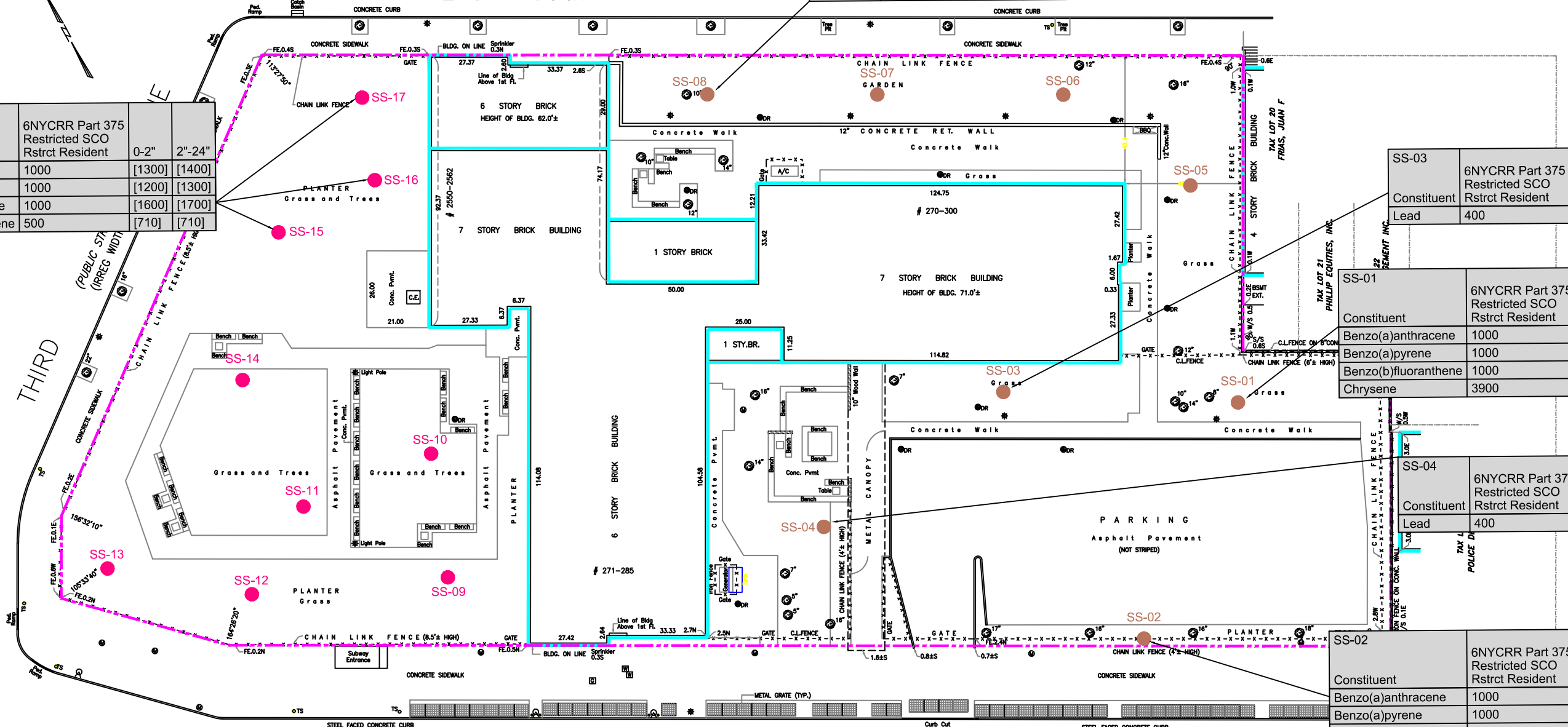

EAST 138th

(100' WIDE)  
(PUBLIC STREET)

STREET

SOURCE #1:  
© 2010 JOSEPH NICOLETTI ASSOCIATES, PROFESSIONAL LAND SURVEYORS, P.C. - ALL RIGHTS RESERVED  
REF.NO.: B2314-010, TITLE NO.: BRX-239244-L

SOURCE #2:  
DONALD G. DEKENIPP L.S., P.C., PROFESSIONAL LAND SURVEYOR, 222 GREENE AVENUE, SYVILLE, NY 11782  
(631) 589-5350  
PROJECT NO. 111027, SURVEYED: NOVEMBER 1, 2011, TITLE: MONITING WELL SURVEY OF PROPERTY SITUATED AT MOTT HAVEN, BOROUGH OF THE BRONX CITY OF NEW YORK.

THIS SURVEY WAS PREPARED FOR USE IN DISCLOSING INFORMATION FOR TITLE PURPOSES ONLY. THE OFFSETS OR DIMENSIONS SHOWN HEREON FROM THE STRUCTURES TO THE PROPERTY LINES ARE FOR SPECIFIC TITLE PURPOSES ONLY AND ARE NOT INTENDED TO GUIDE IN THE ERECTION OF FENCES, RETAINING WALLS, POOLS, PATIOS, PLANTING AREAS, ADDITION TO BUILDINGS AND/OR ANY OTHER CONSTRUCTION. NO LIABILITY IS ASSUMED BY JOSEPH NICOLETTI ASSOCIATES, PROFESSIONAL LAND SURVEYORS, P.C. FOR ANY USE OF THE DATA FOR CONSTRUCTION OF ANY NEW IMPROVEMENTS.

THE EXISTENCE OF RIGHT-OF-WAYS AND/OR EASEMENTS OF RECORD, IF ANY, NOT SHOWN HEREON, ARE NOT CERTIFIED. ENCROACHMENTS OR WALLS, IF ANY, BELOW SURFACE ARE NOT SHOWN.

UNAUTHORIZED ALTERATIONS OR ADDITIONS TO THIS SURVEY IS A VIOLATION OF SECTION 7209 OF THE NEW YORK STATE EDUCATION LAW. COPIES OF THIS SURVEY MAP NOT BEARING THE LAND SURVEYORS INKED SEAL OR EMBOSSED SEAL SHALL NOT BE CONSIDERED TO BE A VALID TRUE COPY. GUARANTEES OR CERTIFICATIONS INDICATED HEREON SHALL RUN ONLY TO THE PERSON FOR WHOM THE SURVEY IS PREPARED AND ON BEHALF TO THE TITLE COMPANY, GOVERNMENTAL AGENCY AND LENDING INSTITUTION LISTED HEREON, AND TO THE ASSIGNEES OF THE LENDING INSTITUTION. GUARANTEES OR CERTIFICATIONS ARE NOT TRANSFERABLE TO ADDITIONAL INSTITUTIONS OR SUBSEQUENT OWNERS.

**LEGEND:**  
P.O.B..... POINT OF BEGINNING  
C.L.F..... CHAIN LINK FENCE  
BLDG..... BUILDING  
CONC.BLK..... CONCRETE BLOCK  
CONC.RET..... CONCRETE RETAINING WALL

**LOT AREA:**  
79,254.5 SQ.FT. = 1.8194 ACRES

**BUILDING AREA:**  
±21,510.9 SQ.FT.

● SURFACE SOIL FOR INVESTIGATIVE PURPOSES  
● SURFACE SOIL FOR DISPOSAL PURPOSES  
[ ] INDICATES EXCEEDANCE  
— BUILDING OUTLINE  
- - - PROPERTY LINE  
- - - OTHER PROPERTIES

NOTES: ALL METAL CONCENTRATIONS IN UNITS OF mg/kg  
ALL OTHER COMPOUNDS ARE IN UNITS OF ug/kg

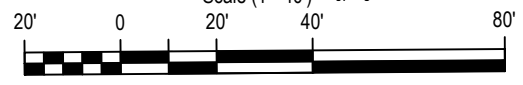

TITLE  
**PRE-REMEDIAL SURFACE AND SHALLOW SOIL SAMPLING RESULTS EXCEEDING RESTRICTED RESIDENTIAL SOIL CLEAN UP OBJECTIVES**

PREPARED FOR  
**BORINQUEN COURT, BRONX, NY**

Environmental Resources Management  
DRAWN BY: JMC/EMF SCALE: AS SHOWN DATE: 09/25/13 JOB NO.: 0168812.04

FIGURE  
**1-6**