	Daily Activity Report					
	2413 Third Avenue					
	Bronx, New York					
	BCP No. C203137					
General Site Information						
Date:	Friday, December 3, 2021					
Weather:	Partly Cloudy, 36-48°F					
Wind Direction/Speed:	WNW @ 16 mph					
AKRF Personnel on Site:	Nathaly Cota					
AKRF Equipment on Site:	RAE MiniRAE 3000 Photoionization Detector (PID)(x3), TSI DustTrak II(x2), and SidePak Aerosol Monitor 8530 (x1)					
Visitors:	None					
Contractor Information						
Contracting Company	Main Personnel		Equipment			
King's Contracting (waterproofing contractor)	Hanley Rivera		-			
LRC Construction	Pasquale Lampugnale		-			
ECD NY	Matthew Keane		Hydraulic excavator (x2), mini excavator (x1)			
Description and Location of Work Activities Performed						
The contractor installed rebar and concrete forms for foundation pile caps in Grids B3 and B4. Concrete was poured in Grid B3. King's Contracting (waterproofing contractor) installed the waterproofing membrane (Aussie Skin 550G) in the southwestern corner of Grid B4. Minor grading occurred throughout the Site. Dewatering continued.						
Site Import Tracking Information						
Material	Daily Trucks	Total Trucks	Daily Tonnage	Total Tons	Facility of Origin	
Virgin Trap Rock- for Truck Tracking Pad	0	6	0	148.57	Haverstraw Quarry - Tilcon NY, Inc.	
Virgin Trap Rock - for Backfilling below slab	0	18	0	474.34	Haverstraw Quarry - Tilcon NY, Inc.	
Disposal Tracking Information						
Destination Facility/Material Type	Daily Trucks	Total Trucks	Daily Approx. Cubic Yds	Total Approx. Cubic Yds	Total Site Loads	Total Approximate Cubic Yards
EarthEfficient HBR, Phillipsburgh, NJ / Non-Haz Soil	0	258	0	5,160	604	12,080
EarthEfficient BTL, Pocono Summit, PA / C&D	0	17	0	340		
Bayshore Soil Management LLC, Keasbey NJ / Non-Haz Soil	0	72	0	1,440		
Cycle Chem, Inc., Elizabeth, NJ / Hazardous Soil	0	1	0	20		
MCUA Landfill, East Brunswick, NJ / Non-Haz Soil	0	256	0	5,120		
Air Monitoring Results						
CAMP Station	Upwind		Downwind			
Odors:	ND		ND			
VOC Action Level Exceedance(s):	ND		ND			
Particulate Action Level Exceedance(s):	NO		NO			
Maximum VOC 15-minute average (ppm):	0.603		0.003			
Maximum Particulate 15-minute average (mg/m³):	0.110		0.110			
Additional Information						
Planned Work Activity for Following Day/week:	LRC will continue pouring cement next week. Dewatering will continue throughout the site.					
Comments:	None.					

2413 Third Avenue, Bronx, NY - Grid Map

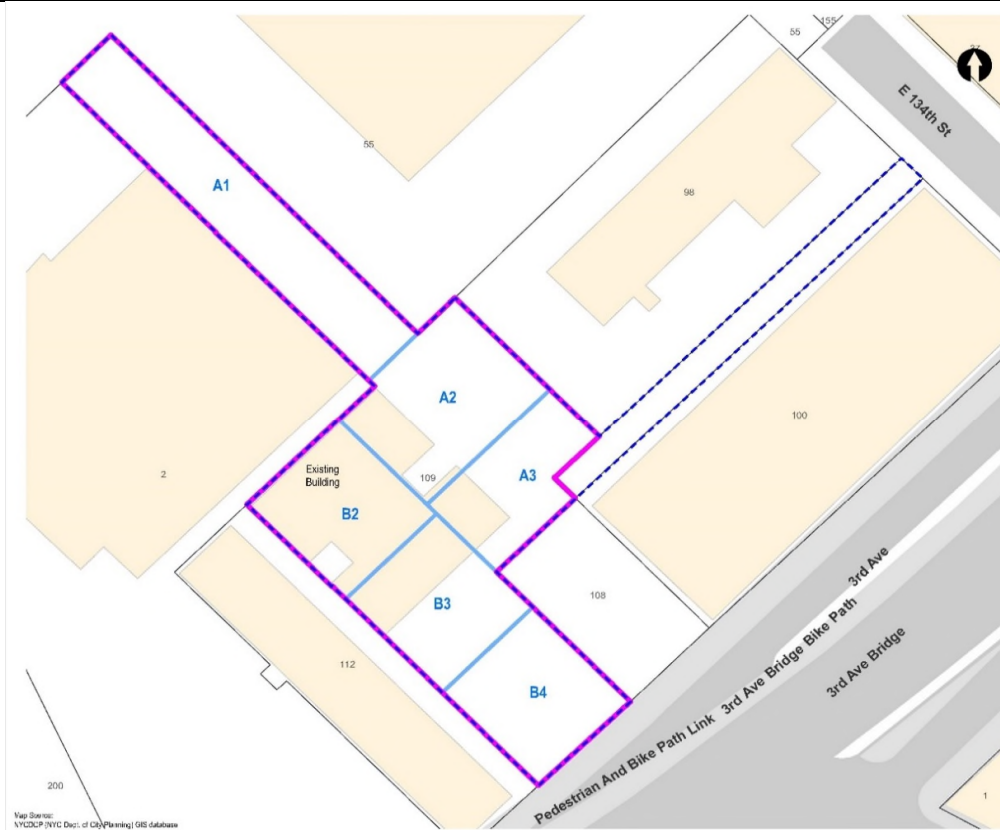

LEGEND

- BCP SITE BOUNDARY
- REDEVELOPMENT SITE BOUNDARY
- 109 LOT BOUNDARY AND TAX LOT NUMBER
- 2319 BLOCK NUMBER
- BUILDING
- ALPHANUMERIC GRID



Site Photographs

Photograph 1 -
Site grading in Grid A3,
view facing north.



Photograph 2 -
Installed waterproofing
(background) and pile
cap work (foreground),
view facing west.



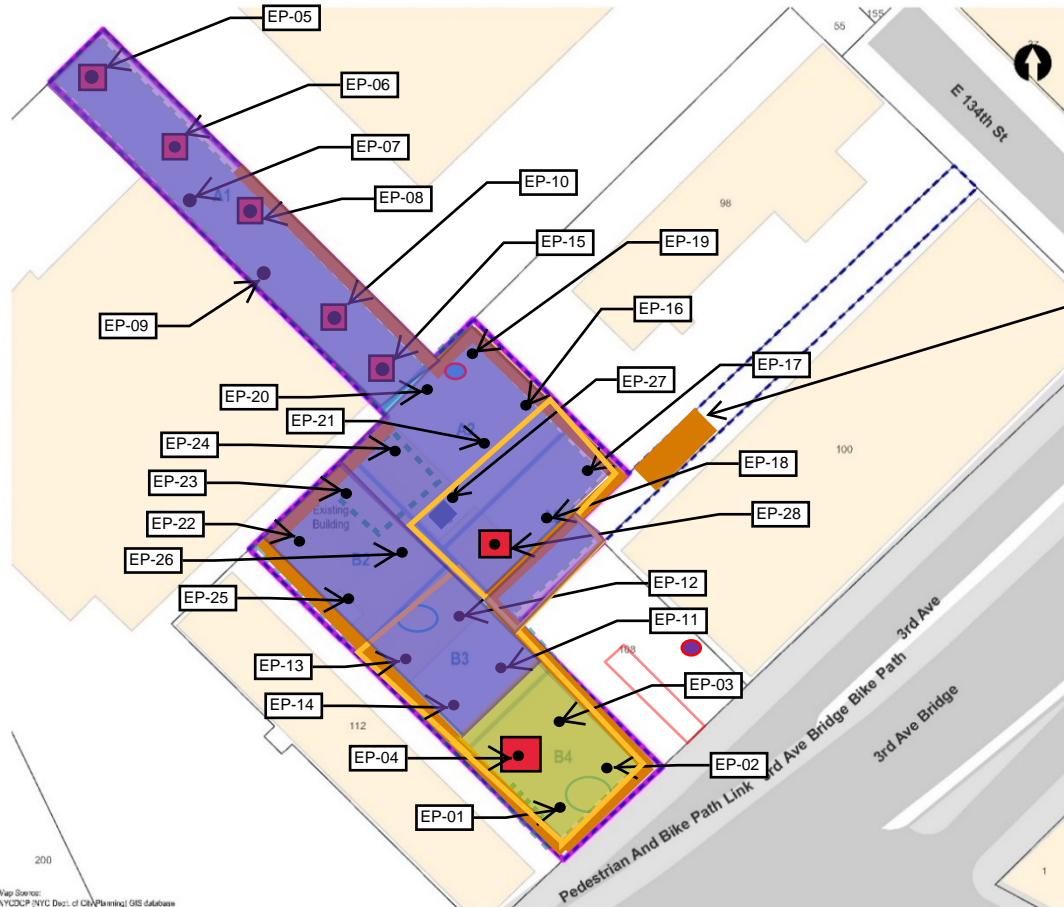

Achieved Track 1 SCOs in this area

Excavated hotspot area to 15' below grade

Soil excavated to 12' below grade

Location of dewatering system components

Extent of dewatering system installation

SOE Drilling Completed (9/9/21)

LEGEND

BCP SITE BOUNDARY

REDEVELOPMENT SITE BOUNDARY

109 LOT BOUNDARY AND TAX LOT NUMBER

2319 BLOCK NUMBER

BUILDING

ALPHANUMERIC GRID

SOE INSTALLED PREVIOUSLY

CURRENT WORK AREAS

DOWNWIND CAMP STATION

UPWIND CAMP STATIONS

INSTALLED TEST PILES IN THIS AREA PREVIOUSLY

Location of Truck Tracking Pad

Location of hazardous lead contaminated soil (removed)



	Daily Activity Report					
	2413 Third Avenue					
	Bronx, New York					
BCP No. C203137						
General Site Information						
Date:	Saturday, December 4, 2021					
Weather:	Partly Cloudy, 35-40°F					
Wind Direction/Speed:	S @ 0 mph					
AKRF Personnel on Site:	Tara Simmons (AM only)					
AKRF Equipment on Site:	RAE MiniRAE 3000 Photoionization Detector (PID)(x3), TSI DustTrak II(x2), and SidePak Aerosol Monitor 8530 (x1)					
Visitors:	None					
Contractor Information						
Contracting Company	Main Personnel			Equipment		
King's Contracting (waterproofing contractor)	Hanley Rivera			-		
LRC Construction	Pasquale Lampugnale			-		
ECD NY	Matthew Keane			Hydraulic excavator (x2), mini excavator (x1)		
Description and Location of Work Activities Performed						
The contractor installed rebar and concrete forms for foundation pile caps and stripped previously poured piles in Grid B4. Dewatering continued. No soil disturbance or grading occurred.						
Site Import Tracking Information						
Material	Daily Trucks	Total Trucks	Daily Tonnage	Total Tons	Facility of Origin	
Virgin Trap Rock- for Truck Tracking Pad	0	6	0	148.57	Haverstraw Quarry - Tilcon NY, Inc.	
Virgin Trap Rock - for Backfilling below slab	0	18	0	474.34	Haverstraw Quarry - Tilcon NY, Inc.	
Disposal Tracking Information						
Destination Facility/Material Type	Daily Trucks	Total Trucks	Daily Approx. Cubic Yds	Total Approx. Cubic Yds	Total Site Loads	Total Approximate Cubic Yards
EarthEfficient HBR, Phillipsburgh, NJ / Non-Haz Soil	0	258	0	5,160	604	12,080
EarthEfficient BTL, Pocono Summit, PA / C&D	0	17	0	340		
Bayshore Soil Management LLC, Keasbey NJ / Non-Haz Soil	0	72	0	1,440		
Cycle Chem, Inc., Elizabeth, NJ / Hazardous Soil	0	1	0	20		
MCUA Landfill, East Brunswick, NJ / Non-Haz Soil	0	256	0	5,120		
Air Monitoring Results						
CAMP Station	Upwind			Downwind		
Odors:	ND			ND		
VOC Action Level Exceedance(s):	ND			ND		
Particulate Action Level Exceedance(s):	ND			ND		
Maximum VOC 15-minute average (ppm):	0.744			0.070		
Maximum Particulate 15-minute average (mg/m³):	0.005			-		
Additional Information						
Planned Work Activity for Following Day/week:	LRC will continue pouring cement next week. Dewatering will continue throughout the site.					
Comments:	Due to equipment malfunction, the downwind CAMP station dust trak did not connect to remote database. Supplemental air monitoring readings were collected near the station. No exceedances were noted.					

2413 Third Avenue, Bronx, NY - Grid Map

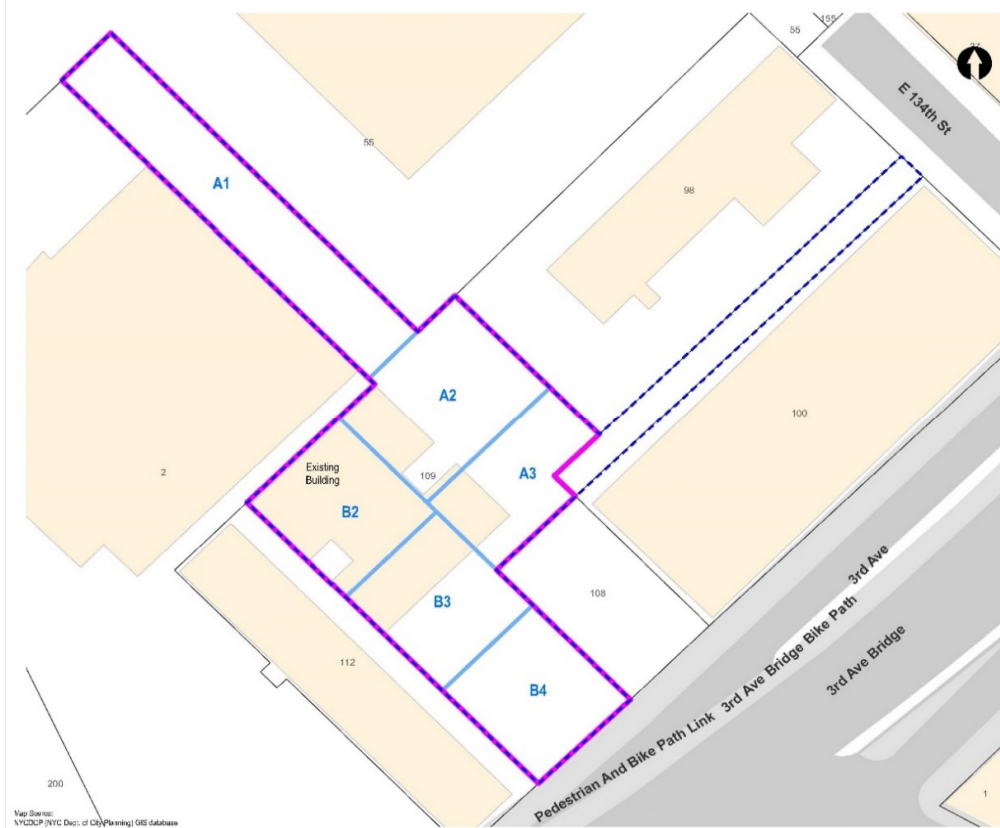

- LEGEND**
- BCP SITE BOUNDARY
 - REDEVELOPMENT SITE BOUNDARY
 - 109 LOT BOUNDARY AND TAX LOT NUMBER
 - 2319 BLOCK NUMBER
 - BUILDING
 - ALPHANUMERIC GRID



Site Photographs

Photograph 1 -
General view of the
Site, view facing north.



Photograph 2 -
Pile cap work
(including form
stripping), view facing
southwest.

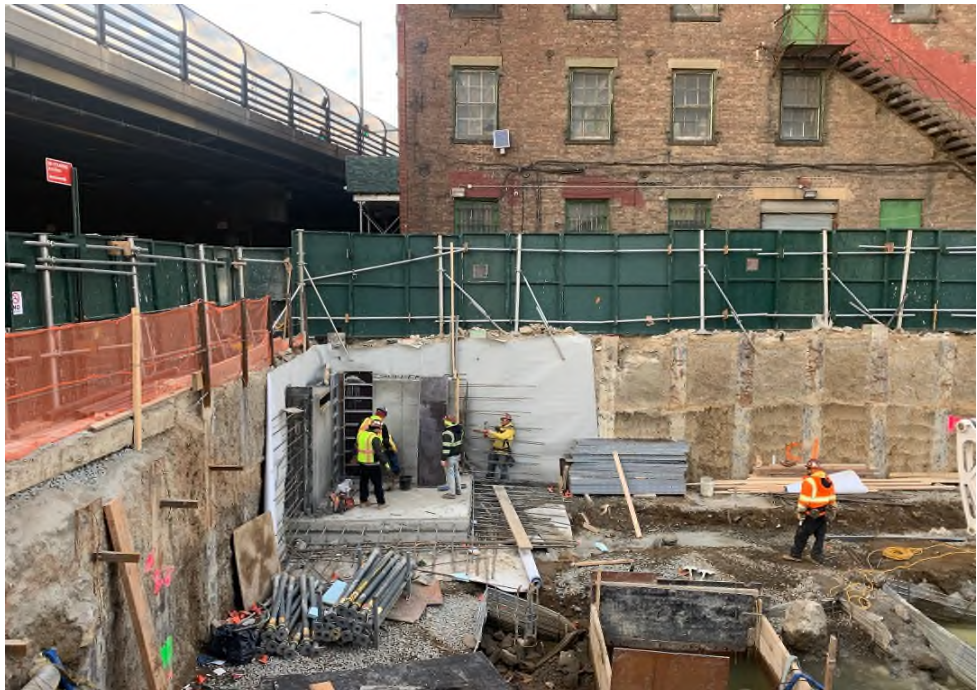

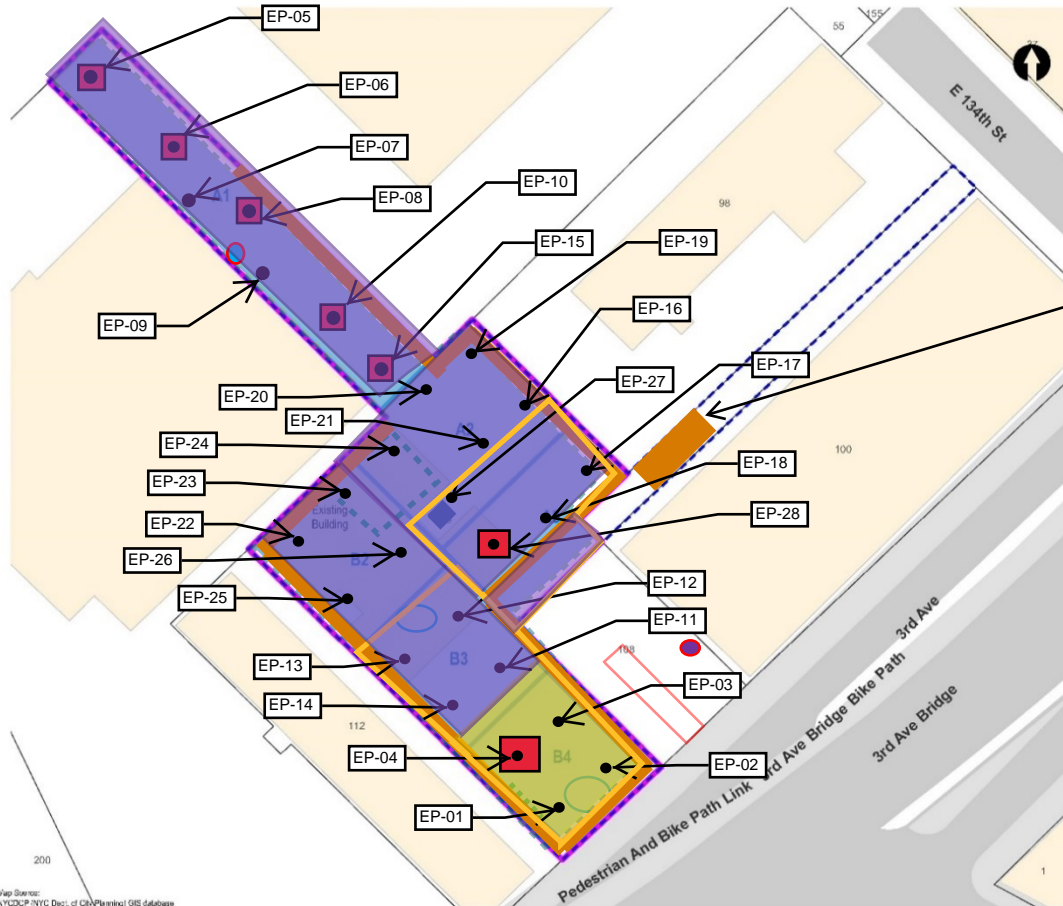

Achieved Track 1 SCOs in this area

Excavated hotspot area to 15' below grade

Soil excavated to 12' below grade

Location of dewatering system components

Extent of dewatering system installation

SOE Drilling Completed (9/9/21)

LEGEND

BCP SITE BOUNDARY

REDEVELOPMENT SITE BOUNDARY

109 LOT BOUNDARY AND TAX LOT NUMBER

2319 BLOCK NUMBER

BUILDING

ALPHANUMERIC GRID

SOE INSTALLED PREVIOUSLY

CURRENT WORK AREAS

DOWNWIND CAMP STATION

UPWIND CAMP STATIONS

INSTALLED TEST PILES IN THIS AREA PREVIOUSLY

INSTALLED TEST PILES IN THIS AREA PREVIOUSLY

Location of Truck Tracking Pad

Location of hazardous lead contaminated soil (removed)

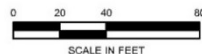

	Daily Activity Report					
	2413 Third Avenue					
	Bronx, New York					
	BCP No. C203137					
General Site Information						
Date:	Monday, December 6, 2021					
Weather:	Cloudy, 37-61°F					
Wind Direction/Speed:	WNW @ 3 mph					
AKRF Personnel on Site:	Nathaly Cota					
AKRF Equipment on Site:	RAE MiniRAE 3000 Photoionization Detector (PID)(x3), TSI DustTrak II(x2), and SidePak Aerosol Monitor 8530 (x1)					
Visitors:	None					
Contractor Information						
Contracting Company	Main Personnel		Equipment			
King's Contracting (waterproofing contractor)	Hanley Rivera		-			
LRC Construction	Pasquale Lampugnale		-			
ECD NY	Matthew Keane		Hydraulic excavator (x2), mini excavator (x1)			
Description and Location of Work Activities Performed						
<p>The contractor installed rebar and concrete forms for foundation pile caps in Grids B3 and B4. King's Contracting (waterproofing contractor) installed the waterproofing membrane (Aussie Skin 550G) in the southwestern corner of Grid B4. The contractor excavated in select areas to remove hotspots based on the endpoint samples collected previously. A total of 16 endpoint samples (sidewall and bottom) were collected from the excavated areas for laboratory analysis. The excavated areas were backfilled with imported virgin stone. Minor grading occurred throughout the Site. Dewatering continued.</p>						
Site Import Tracking Information						
Material	Daily Trucks	Total Trucks	Daily Tonnage	Total Tons	Facility of Origin	
Virgin Trap Rock- for Truck Tracking Pad	0	6	0	148.57	Haverstraw Quarry - Tilcon NY, Inc.	
Virgin Trap Rock - for Backfilling below slab	0	18	0	474.34	Haverstraw Quarry - Tilcon NY, Inc.	
Disposal Tracking Information						
Destination Facility/Material Type	Daily Trucks	Total Trucks	Daily Approx. Cubic Yds	Total Approx. Cubic Yds	Total Site Loads	Total Approximate Cubic Yards
EarthEfficient HBR, Phillipsburgh, NJ / Non-Haz Soil	0	258	0	5,160	604	12,080
EarthEfficient BTL, Pocono Summit, PA / C&D	0	17	0	340		
Bayshore Soil Management LLC, Keasbey NJ / Non-Haz Soil	0	72	0	1,440		
Cycle Chem, Inc., Elizabeth, NJ / Hazardous Soil	0	1	0	20		
MCUA Landfill, East Brunswick, NJ / Non-Haz Soil	0	256	0	5,120		
Air Monitoring Results						
CAMP Station	Upwind		Downwind			
Odors:	ND		ND			
VOC Action Level Exceedance(s):	ND		ND			
Particulate Action Level Exceedance(s):	NO		NO			
Maximum VOC 15-minute average (ppm):	-		-			
Maximum Particulate 15-minute average (mg/m³):	0.090		0.156			
Additional Information						
Planned Work Activity for Following Day/week:	LRC will continue pouring concrete throughout the week. Dewatering will continue throughout the site.					
Comments:	No VOC readings were recorded at the CAMP stations due to technical issues. Roving equipment was used to collect the data. No issues were noted.					

2413 Third Avenue, Bronx, NY - Grid Map

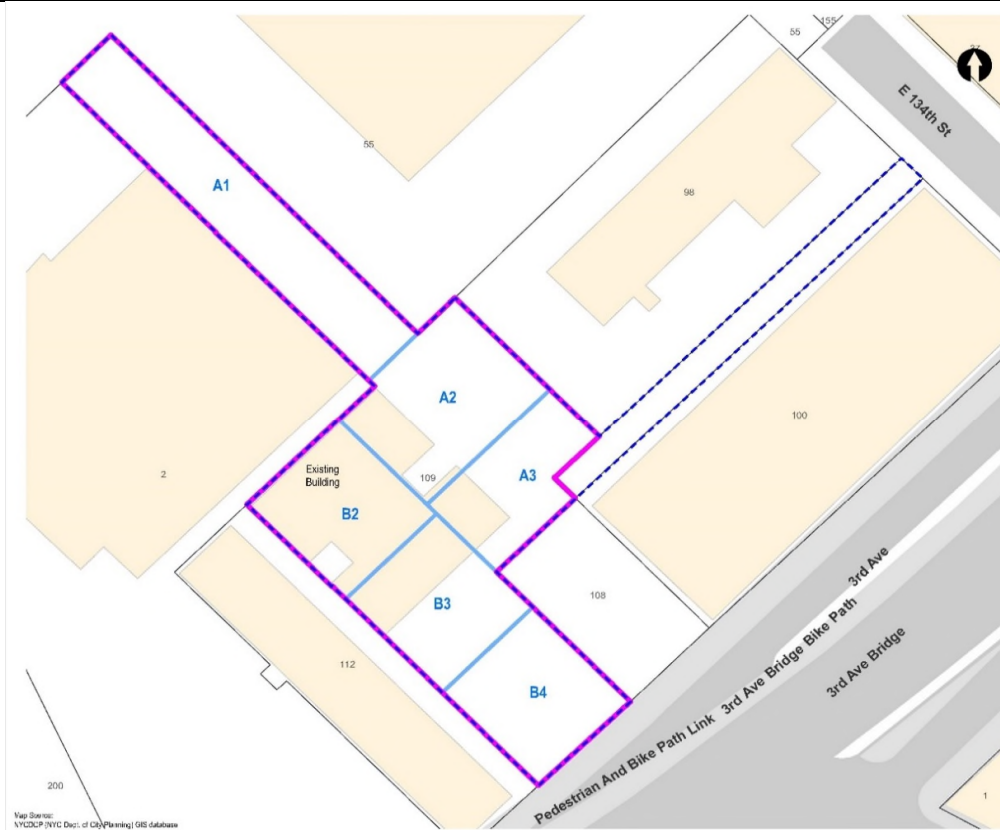

LEGEND

- BCP SITE BOUNDARY
- REDEVELOPMENT SITE BOUNDARY
- 109 LOT BOUNDARY AND TAX LOT NUMBER
- 2319 BLOCK NUMBER
- BUILDING
- ALPHANUMERIC GRID



Site Photographs

Photograph 1 -
Aerial view of Grids B3
and B4.



Photograph 2 -
Installed waterproofing
(background) and pile
cap work (foreground),
view facing west.



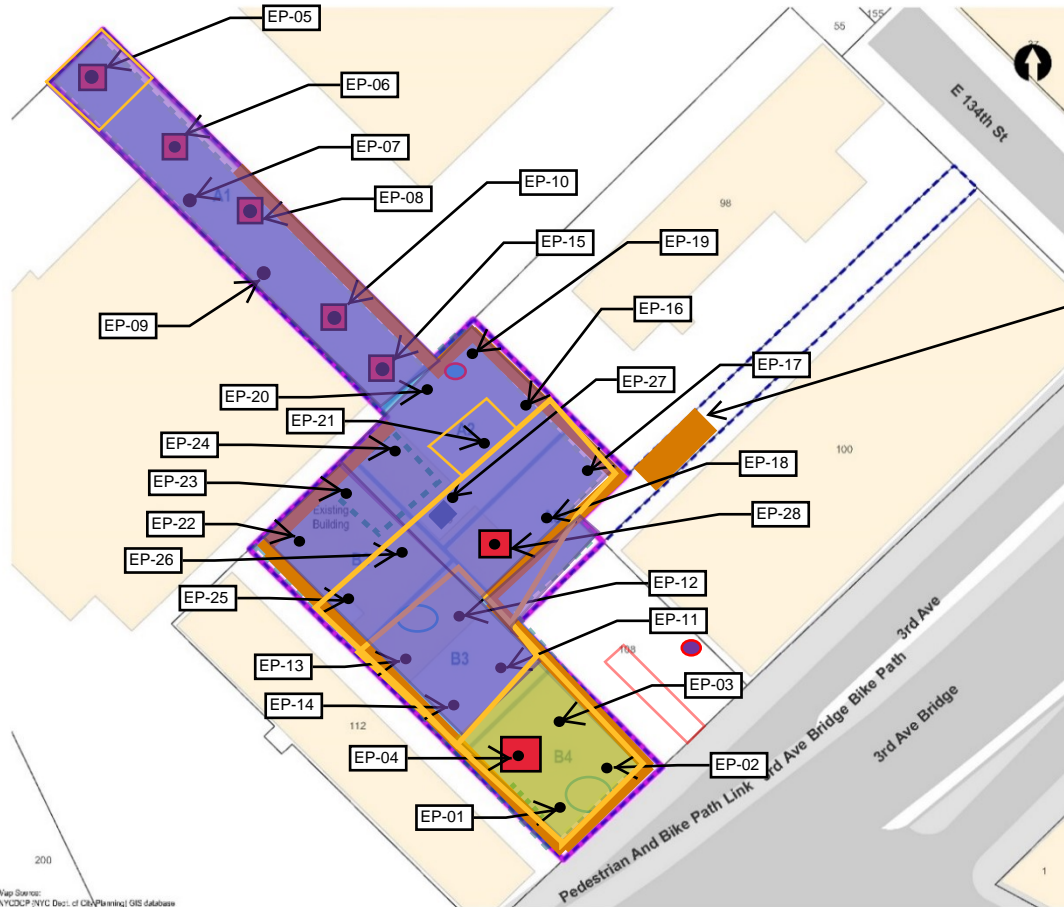

- Achieved Track 1 SCOs in this area
- Excavated hotspot area to 15' below grade
- Soil excavated to 12' below grade
- Location of dewatering system components
- Extent of dewatering system installation

SOE Drilling Completed (9/9/21)

LEGEND

- BCP SITE BOUNDARY
 - REDEVELOPMENT SITE BOUNDARY
 - 109 LOT BOUNDARY AND TAX LOT NUMBER
 - 2319 BLOCK NUMBER
 - BUILDING
 - ALPHANUMERIC GRID
 - SOE INSTALLED PREVIOUSLY
 - CURRENT WORK AREAS
 - DOWNDISK CAMP STATION
 - UPWIND CAMP STATIONS
 - INSTALLED TEST PILES IN THIS AREA PREVIOUSLY
 - Location of Truck Tracking Pad
 - Location of hazardous lead contaminated soil (removed)
- 0 20 40 80
SCALE IN FEET

	Daily Activity Report					
	2413 Third Avenue					
	Bronx, New York					
	BCP No. C203137					
General Site Information						
Date:	Tuesday, December 7, 2021					
Weather:	Partly cloudy, 36-45°F					
Wind Direction/Speed:	WNW @ 7 mph					
AKRF Personnel on Site:	Nathaly Cota					
AKRF Equipment on Site:	RAE MiniRAE 3000 Photoionization Detector (PID)(x3), TSI DustTrak II(x2), and SidePak Aerosol Monitor 8530 (x1)					
Visitors:	None					
Contractor Information						
Contracting Company	Main Personnel			Equipment		
King's Contracting (waterproofing contractor)	Hanley Rivera			-		
LRC Construction	Pasquale Lampugnale			-		
ECD NY	Matthew Keane			Hydraulic excavator (x2), mini excavator (x1)		
Description and Location of Work Activities Performed						
<p>The contractor installed rebar and concrete forms for foundation pile caps in Grids B3 and B4. King's Contracting (waterproofing contractor) installed the waterproofing membrane (Aussie Skin 550G) in the southwestern corner of Grid B4. Piping for electric wiring was installed along the western side of Grid B4. Minor grading occurred throughout the Site. AKRF collected one soil end point sample (EP-22A) from Grid B2. Dewatering continued.</p>						
Site Import Tracking Information						
Material	Daily Trucks	Total Trucks	Daily Tonnage	Total Tons	Facility of Origin	
Virgin Trap Rock- for Truck Tracking Pad	0	6	0	148.57	Haverstraw Quarry - Tilcon NY, Inc.	
Virgin Trap Rock - for Backfilling below slab	0	18	0	474.34	Haverstraw Quarry - Tilcon NY, Inc.	
Disposal Tracking Information						
Destination Facility/Material Type	Daily Trucks	Total Trucks	Daily Approx. Cubic Yds	Total Approx. Cubic Yds	Total Site Loads	Total Approximate Cubic Yards
EarthEfficient HBR, Phillipsburgh, NJ / Non-Haz Soil	0	258	0	5,160	604	12,080
EarthEfficient BTL, Pocono Summit, PA / C&D	0	17	0	340		
Bayshore Soil Management LLC, Keasbey NJ / Non-Haz Soil	0	72	0	1,440		
Cycle Chem, Inc., Elizabeth, NJ / Hazardous Soil	0	1	0	20		
MCUA Landfill, East Brunswick, NJ / Non-Haz Soil	0	256	0	5,120		
Air Monitoring Results						
CAMP Station	Upwind			Downwind		
Odors:	ND			ND		
VOC Action Level Exceedance(s):	ND			ND		
Particulate Action Level Exceedance(s):	NO			Yes		
Maximum VOC 15-minute average (ppm):	0.541			0.111		
Maximum Particulate 15-minute average (mg/m³):	0.079			0.229		
Additional Information						
Planned Work Activity for Following Day/week:	LRC will continue pouring cement throughout the week. Soil from sample points throughout the Site will be exported. Dewatering will continue throughout the site.					
Comments:	An elevated particulate reading was noted at the Downwind CAMP station during system startup. The elevated reading was not related to site work.					

2413 Third Avenue, Bronx, NY - Grid Map

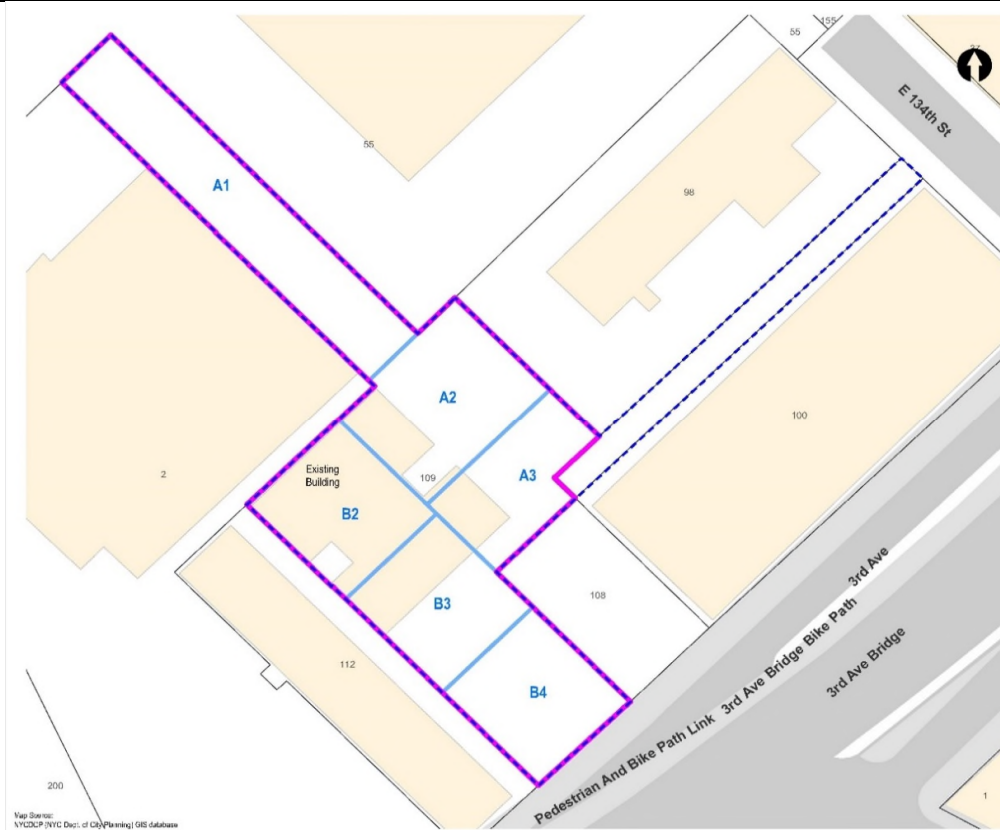

- LEGEND**
- BCP SITE BOUNDARY
 - REDEVELOPMENT SITE BOUNDARY
 - 109 LOT BOUNDARY AND TAX LOT NUMBER
 - 2319 BLOCK NUMBER
 - BUILDING
 - ALPHANUMERIC GRID



Site Photographs

Photograph 1 -
Installing
waterproofing
(background) and pile
cap work (foreground),
view facing southwest



Photograph 2 -
Rebar staged in Grid
A3, view facing north



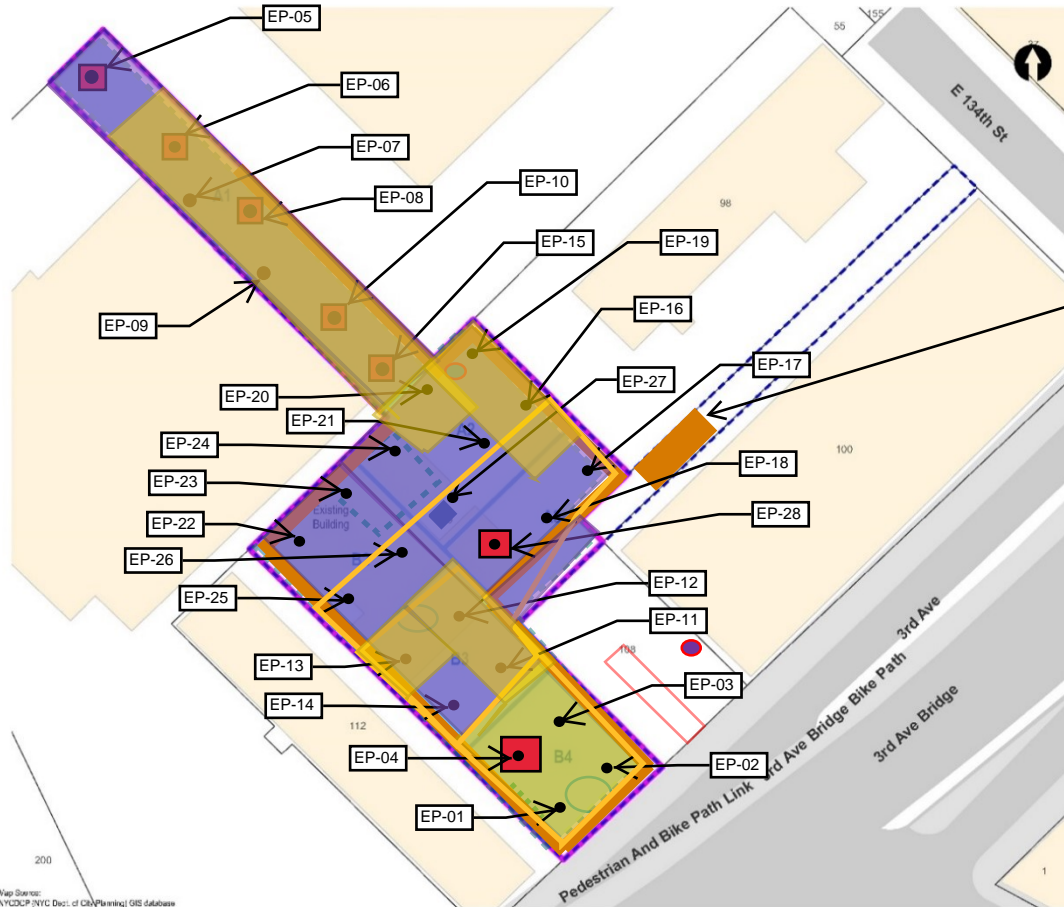

Achieved Track 1 SCOs in this area

Excavated hotspot area to 15' below grade

Soil excavated to 12' below grade

Location of dewatering system components

Extent of dewatering system installation

SOE Drilling Completed (9/9/21)

LEGEND

BCP SITE BOUNDARY

REDEVELOPMENT SITE BOUNDARY

LOT BOUNDARY AND TAX LOT NUMBER

2319 BLOCK NUMBER

BUILDING

ALPHANUMERIC GRID

SOE INSTALLED PREVIOUSLY

CURRENT WORK AREAS

DOWNDOWN CAMP STATION

UPWIND CAMP STATIONS

INSTALLED TEST PILES IN THIS AREA PREVIOUSLY

Location of Truck Tracking Pad

Location of hazardous lead contaminated soil (removed)

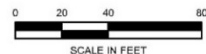

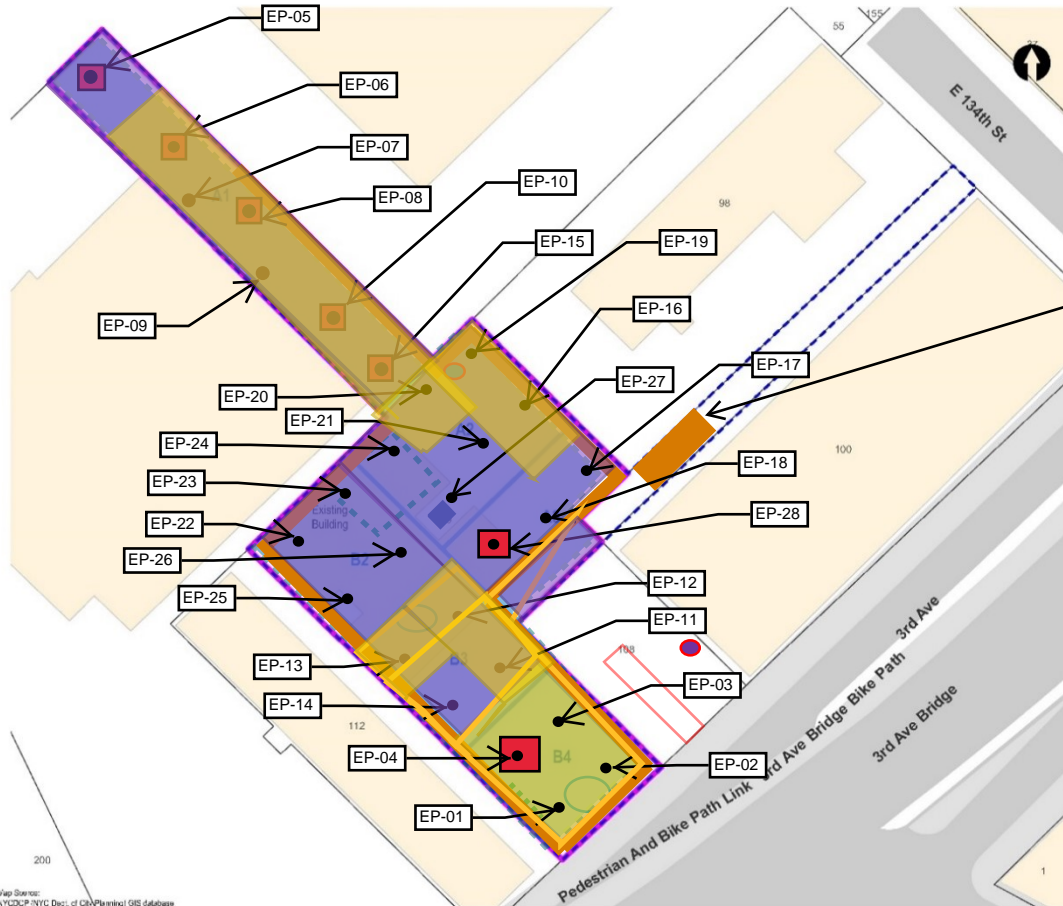

Achieved Track 1 SCOs in this area

Excavated hotspot area to 15' below grade

Soil excavated to 12' below grade

Location of dewatering system components

Extent of dewatering system installation

SOE Drilling Completed (9/9/21)

LEGEND

BCP SITE BOUNDARY

REDEVELOPMENT SITE BOUNDARY

LOT BOUNDARY AND TAX LOT NUMBER

2319 BLOCK NUMBER

BUILDING

ALPHANUMERIC GRID

SOE INSTALLED PREVIOUSLY

CURRENT WORK AREAS

DOWNDOWN CAMP STATION

UPWIND CAMP STATIONS

INSTALLED TEST PILES IN THIS AREA PREVIOUSLY

Location of Truck Tracking Pad

Location of hazardous lead contaminated soil (removed)



SCALE IN FEET

200

	Daily Activity Report					
	2413 Third Avenue					
	Bronx, New York					
	BCP No. C203137					
General Site Information						
Date:	Tuesday, December 14, 2021					
Weather:	Partly cloudy, 40-51°F					
Wind Direction/Speed:	SE @ 7 mph					
AKRF Personnel on Site:	Nathaly Cota					
AKRF Equipment on Site:	RAE MiniRAE 3000 Photoionization Detector (PID)(x3), TSI DustTrak II(x2), and SidePak Aerosol Monitor 8530 (x1)					
Visitors:	None					
Contractor Information						
Contracting Company	Main Personnel		Equipment			
King's Contracting (waterproofing contractor)	Hanley Rivera		-			
LRC Construction	Pasquale Lampugnale		-			
ECD NY	Matthew Keane		Hydraulic excavator (x2), mini excavator (x1)			
Description and Location of Work Activities Performed						
The contractor installed rebar and concrete forms for foundation pile caps in Grids B3 and B4. Cement was poured and tower crane installation continued in Grid B3. Minor grading occurred throughout the Site. Dewatering continued.						
Site Import Tracking Information						
Material	Daily Trucks	Total Trucks	Daily Tonnage	Total Tons	Facility of Origin	
Virgin Trap Rock- for Truck Tracking Pad	0	6	0	148.57	Haverstraw Quarry - Tilcon NY, Inc.	
Virgin Trap Rock - for Backfilling below slab	0	18	0	474.34	Haverstraw Quarry - Tilcon NY, Inc.	
Disposal Tracking Information						
Destination Facility/Material Type	Daily Trucks	Total Trucks	Daily Approx. Cubic Yds	Total Approx. Cubic Yds	Total Site Loads	Total Approximate Cubic Yards
EarthEfficient HBR, Phillipsburgh, NJ / Non-Haz Soil	0	259	0	5,180	605	12,100
EarthEfficient BTL, Pocono Summit, PA / C&D	0	17	0	340		
Bayshore Soil Management LLC, Keasbey NJ / Non-Haz Soil	0	72	0	1,440		
Cycle Chem, Inc., Elizabeth, NJ / Hazardous Soil	0	1	0	20		
MCUA Landfill, East Brunswick, NJ / Non-Haz Soil	0	256	0	5,120		
Air Monitoring Results						
CAMP Station	Upwind			Downwind		
Odors:	ND			ND		
VOC Action Level Exceedance(s):	ND			ND		
Particulate Action Level Exceedance(s):	NO			NO		
Maximum VOC 15-minute average (ppm):	0.772			0.118		
Maximum Particulate 15-minute average (mg/m³):	0.061			0.168		
Additional Information						
Planned Work Activity for Following Day/week:	LRC will continue concrete work throughout the week and install the tower crane base. Dewatering will continue throughout the site. Additional soil endpoint samples will be collected from select areas of the Site.					
Comments:	None					

2413 Third Avenue, Bronx, NY - Grid Map

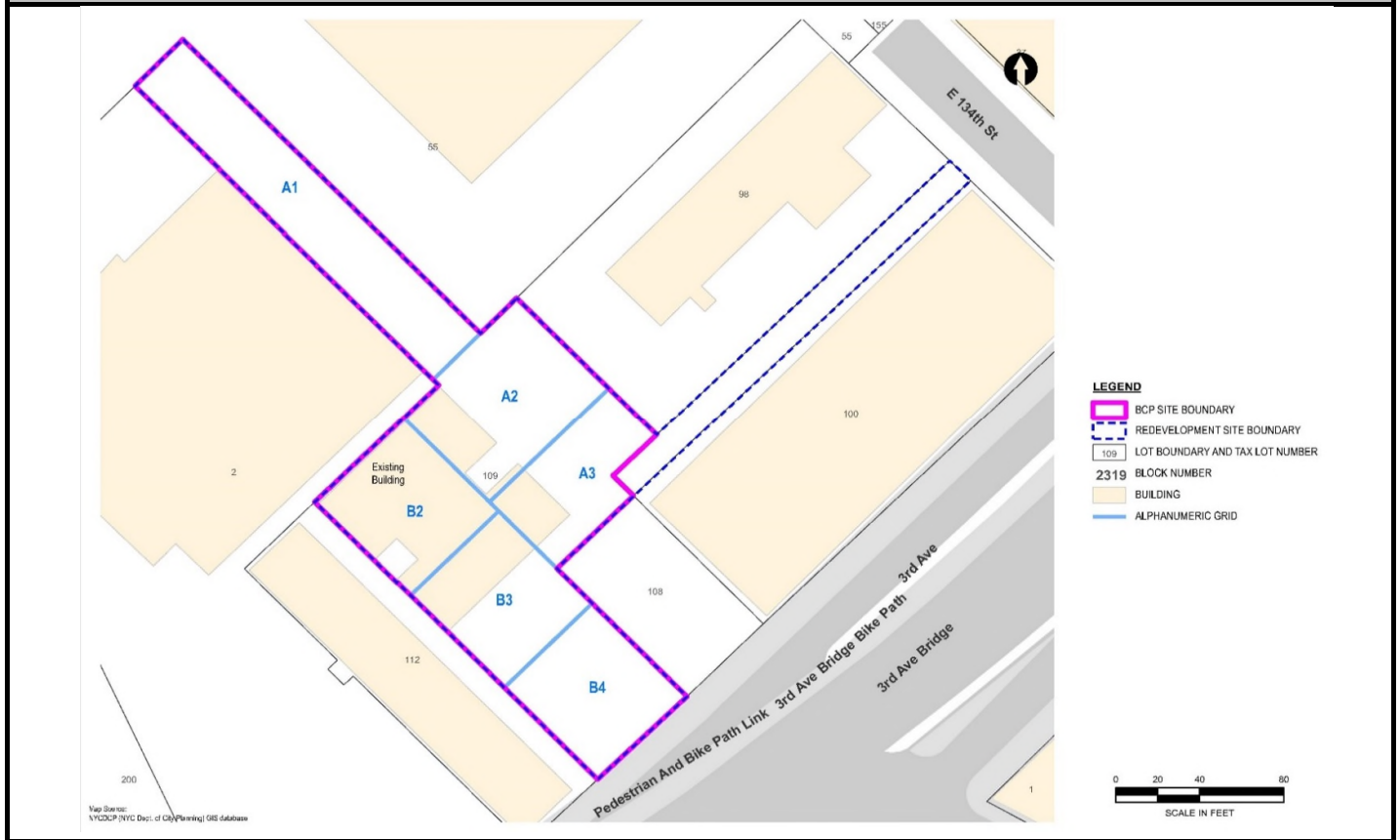

Site Photographs

Photograph 1 -
Pouring concrete in
Grid B3, view facing
northwest



Photograph 2 -
Ongoing foundation
and concrete work in
Grid B3, aerial view.

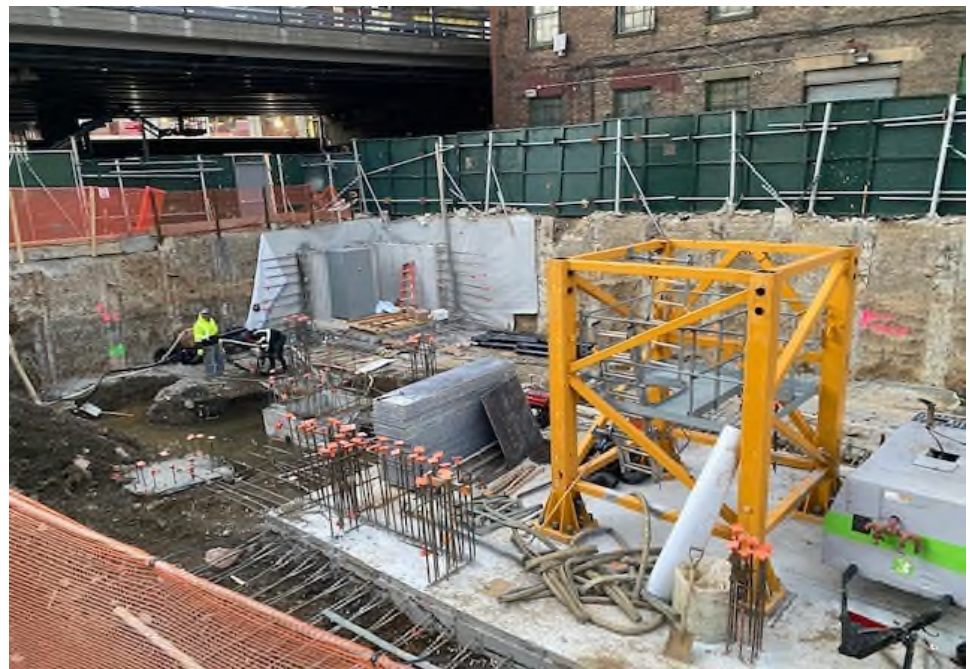



Daily Activity Report

2413 Third Avenue
Bronx, New York
BCP No. C203137

General Site Information

Date:	Wednesday, December 15, 2021
Weather:	Sunny, 41-52°F
Wind Direction/Speed:	NE @ 6 mph
AKRF Personnel on Site:	Nathaly Cota
AKRF Equipment on Site:	RAE MiniRAE 3000 Photoionization Detector (PID)(x3), TSI DustTrak II(x2), and SidePak Aerosol Monitor 8530 (x1)
Visitors:	None

Contractor Information

Contracting Company	Main Personnel	Equipment
King's Contracting (waterproofing contractor)	Hanley Rivera	-
LRC Construction	Pasquale Lampugnale	-
ECD NY	Matthew Keane	Hydraulic excavator (x2), mini excavator (x1)

Description and Location of Work Activities Performed

ECD excavated and exported approximately 160 cubic yards of soil/fill from Grids B2 and B3 for off-site disposal which was sent to the EarthEfficient HBR facility located in Phillipsburgh, NJ. The contractor installed rebar and concrete forms for foundation pile caps in Grids B3 and B4. Tower crane installation continued in Grid B3. A total of 16 soil endpoint samples (from sidewalls and/or bottom) were collected following over-excavation in the areas which exceeded Track 1 UUSCOs based on the initial sampling. Samples were collected from Grids A1, A2, B2, and B3. Minor grading occurred throughout the Site. Dewatering continued.

Site Import Tracking Information

Material	Daily Trucks	Total Trucks	Daily Tonnage	Total Tons	Facility of Origin
Virgin Trap Rock- for Truck Tracking Pad	0	6	0	148.57	Haverstraw Quarry - Tilcon NY, Inc.
Virgin Trap Rock - for Backfilling below slab	0	18	0	474.34	Haverstraw Quarry - Tilcon NY, Inc.

Disposal Tracking Information

Destination Facility/Material Type	Daily Trucks	Total Trucks	Daily Approx. Cubic Yds	Total Approx. Cubic Yds	Total Site Loads	Total Approximate Cubic Yards
EarthEfficient HBR, Phillipsburgh, NJ / Non-Haz Soil	8	267	160	5,340	613	12,260
EarthEfficient BTL, Pocono Summit, PA / C&D	0	17	0	340		
Bayshore Soil Management LLC, Keasbey NJ / Non-Haz Soil	0	72	0	1,440		
Cycle Chem, Inc., Elizabeth, NJ / Hazardous Soil	0	1	0	20		
MCUA Landfill, East Brunswick, NJ / Non-Haz Soil	0	256	0	5,120		

Air Monitoring Results

CAMP Station	Upwind	Downwind
Odors:	ND	ND
VOC Action Level Exceedance(s):	ND	ND
Particulate Action Level Exceedance(s):	NO	NO
Maximum VOC 15-minute average (ppm):	0.877	0.168
Maximum Particulate 15-minute average (mg/m³):	0.015	0.256

Additional Information

Planned Work Activity for Following Day/week:	LRC will continue concrete work throughout the week and install the tower crane base. Dewatering will continue throughout the site. Excavated soil will be exported off-site for disposal.
Comments:	Elevated particulate readings were noted at the Downwind CAMP station during the system startup and once during the soil export/trucking. The levels went back to normal immediately after the truck left the Site.

2413 Third Avenue, Bronx, NY - Grid Map

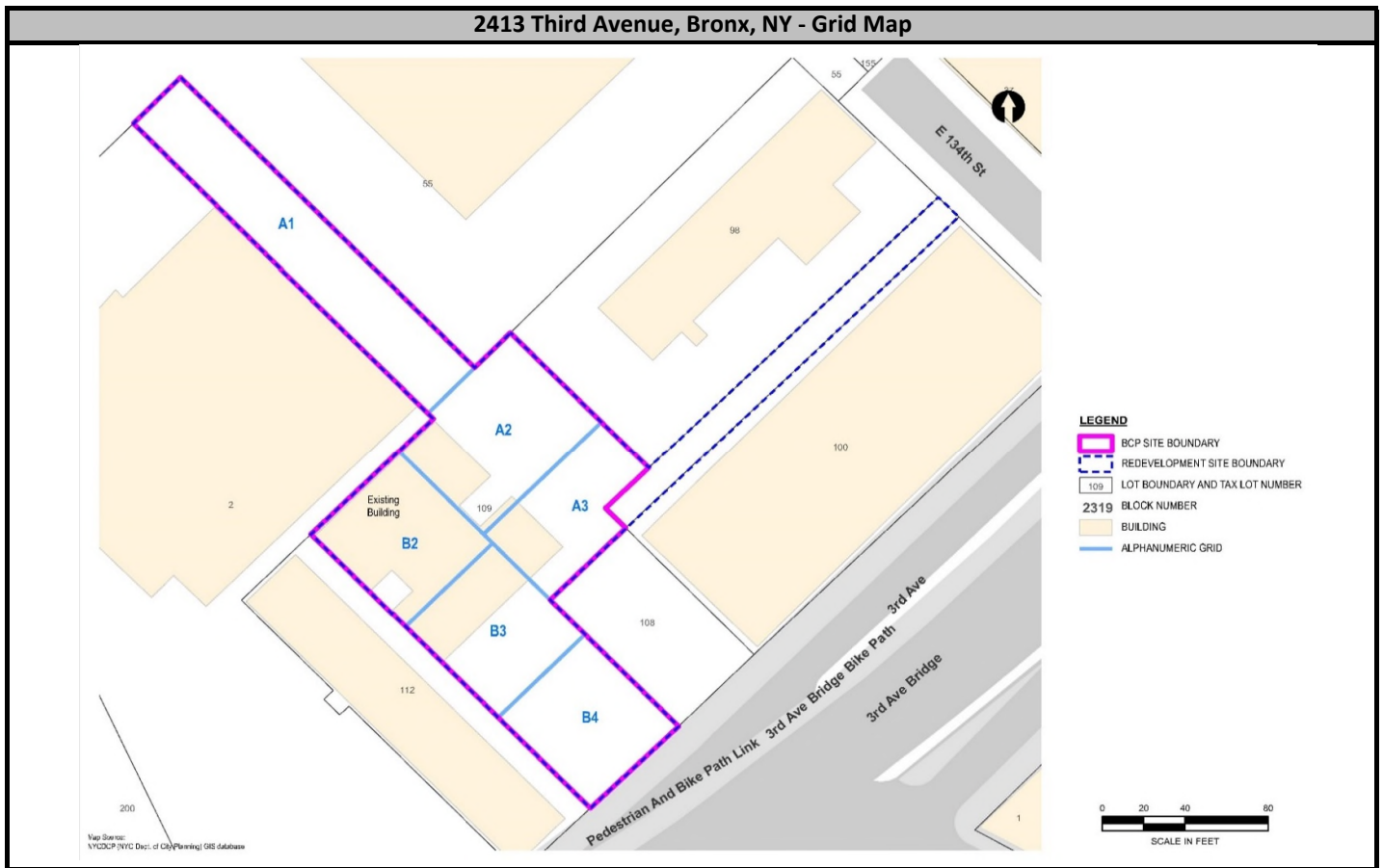

Site Photographs

Photograph 1 -
Soil export in Grid B3,
view facing northwest



Photograph 2 -
Ongoing foundation and concrete work in
Grid B3, view facing
north.



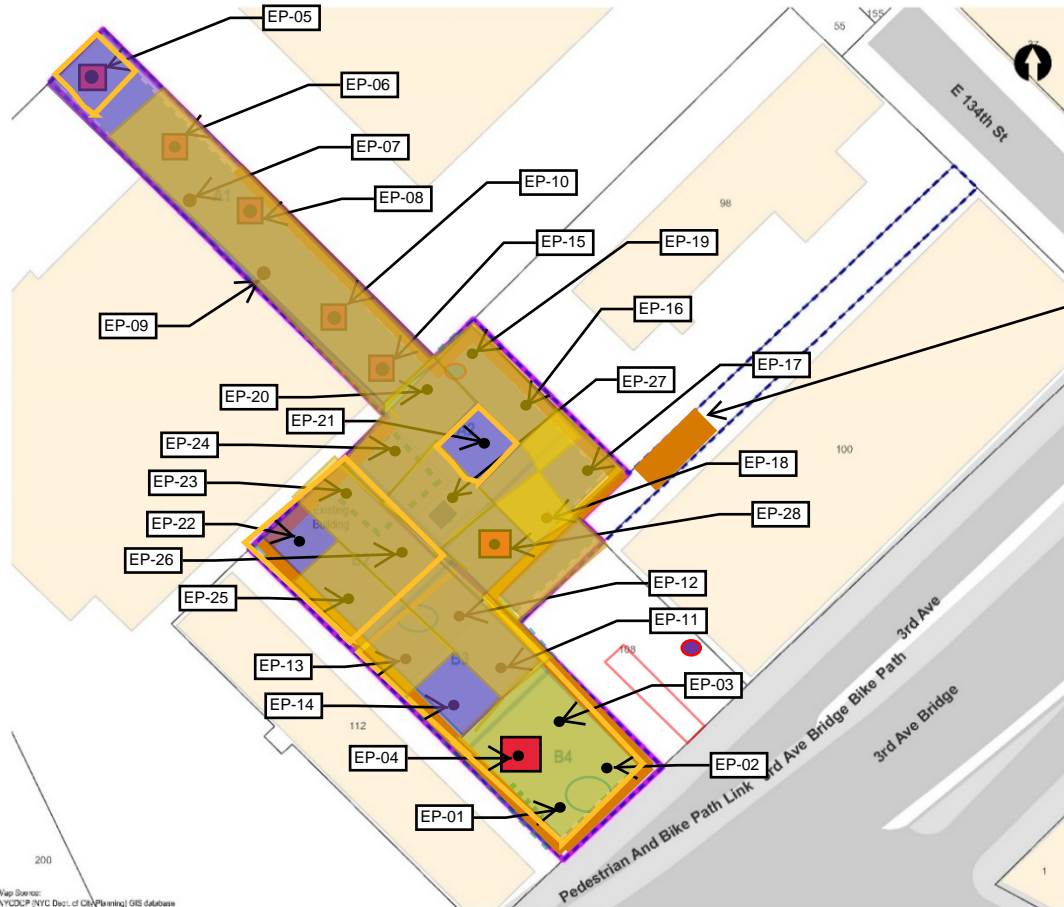

- Achieved Track 1 SCOs in this area
- Excavated hotspot area to 15' below grade
- Soil excavated to 12' below grade
- Location of dewatering system components
- Extent of dewatering system installation

SOE Drilling Completed (9/9/21)

LEGEND

- BCP SITE BOUNDARY
- REDEVELOPMENT SITE BOUNDARY
- 109 LOT BOUNDARY AND TAX LOT NUMBER
- 2319 BLOCK NUMBER
- BUILDING
- ALPHANUMERIC GRID
- SOE INSTALLED PREVIOUSLY
- CURRENT WORK AREAS
- DOWNWIND CAMP STATION
- UPWIND CAMP STATIONS
- INSTALLED TEST PILES IN THIS AREA PREVIOUSLY
- Location of Truck Tracking Pad
- Location of hazardous lead contaminated soil (removed)





Daily Activity Report

2413 Third Avenue
Bronx, New York
BCP No. C203137

General Site Information

Date:	Monday, December 20, 2021
Weather:	Sunny, 23-37°F
Wind Direction/Speed:	NE @ 7 mph
AKRF Personnel on Site:	Nathaly Cota
AKRF Equipment on Site:	RAE MiniRAE 3000 Photoionization Detector (PID)(x3), TSI DustTrak II(x2), and SidePak Aerosol Monitor 8530 (x1)
Visitors:	None

Contractor Information

Contracting Company	Main Personnel	Equipment
King's Contracting (waterproofing contractor)	Hanley Rivera	-
LRC Construction	Pasquale Lampugnale	-
ECD NY	Matthew Keane	Hydraulic excavator (x2), mini excavator (x1)

Description and Location of Work Activities Performed

The contractor installed rebar and concrete forms for foundation pile caps in Grids B3 and B4. Tower crane installation continued in Grid B3. Approximately 20 cubic yards of excavated soil/fill (from Grids A1, A2, and B2) was exported off-site for disposal at the MCUA Landfill located in East Brunswick, NJ. Staged rebar in Grid A3. Minor grading occurred throughout the Site. Dewatering continued.

Site Import Tracking Information

Material	Daily Trucks	Total Trucks	Daily Tonnage	Total Tons	Facility of Origin
Virgin Trap Rock- for Truck Tracking Pad	0	6	0	148.57	Haverstraw Quarry - Tilcon NY, Inc.
Virgin Trap Rock - for Backfilling below slab	0	18	0	474.34	Haverstraw Quarry - Tilcon NY, Inc.

Disposal Tracking Information

Destination Facility/Material Type	Daily Trucks	Total Trucks	Daily Approx. Cubic Yds	Total Approx. Cubic Yds	Total Site Loads	Total Approximate Cubic Yards
EarthEfficient HBR, Phillipsburgh, NJ / Non-Haz Soil	0	267	0	5,340	614	12,280
EarthEfficient BTL, Pocono Summit, PA / C&D	0	17	0	340		
Bayshore Soil Management LLC, Keasbey NJ / Non-Haz Soil	0	72	0	1,440		
Cycle Chem, Inc., Elizabeth, NJ / Hazardous Soil	0	1	0	20		
MCUA Landfill, East Brunswick, NJ / Non-Haz Soil	1	257	20	5,140		

Air Monitoring Results

CAMP Station	Upwind	Downwind
Odors:	ND	ND
VOC Action Level Exceedance(s):	ND	ND
Particulate Action Level Exceedance(s):	NO	Yes
Maximum VOC 15-minute average (ppm):	0.726	0.123
Maximum Particulate 15-minute average (mg/m³):	0.064	0.245

Additional Information

Planned Work Activity for Following Day/week:	LRC will continue concrete work throughout the week and install the tower crane base. Dewatering will continue throughout the site. Virgin trap rock for backfilling is expected to be delivered tomorrow, 12/21/2021.
Comments:	An elevated particulate reading was noted at the Downwind CAMP station during system startup. The levels went below the threshold following the CAMP setup. The elevated reading was not attributed to the ongoing Site work.

2413 Third Avenue, Bronx, NY - Grid Map

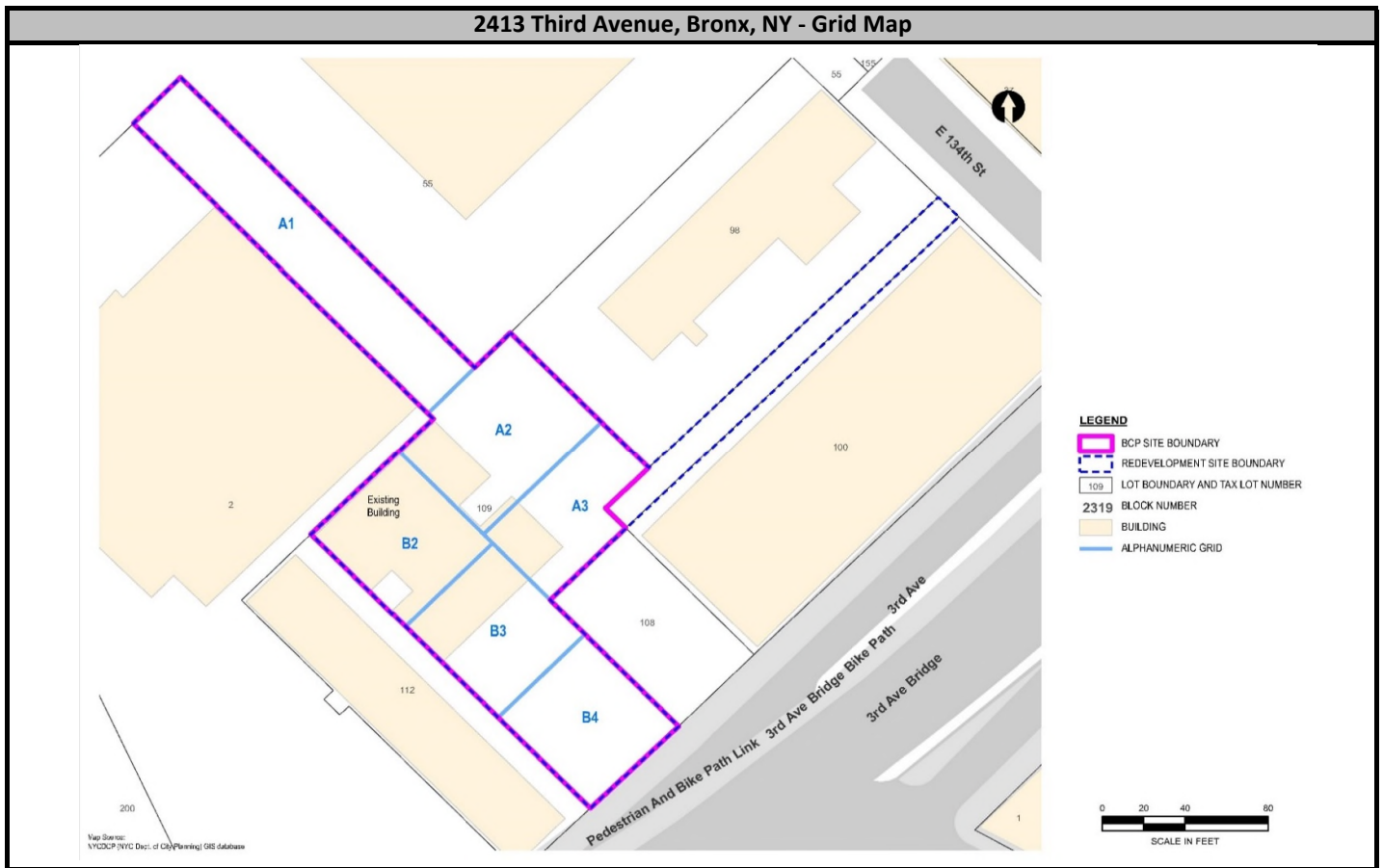

Site Photographs

Photograph 1 -
Loading out truck for
soil export, view facing
north



Photograph 2 -
Ongoing foundation and
concrete work in
Grid B3, view facing
northwest.



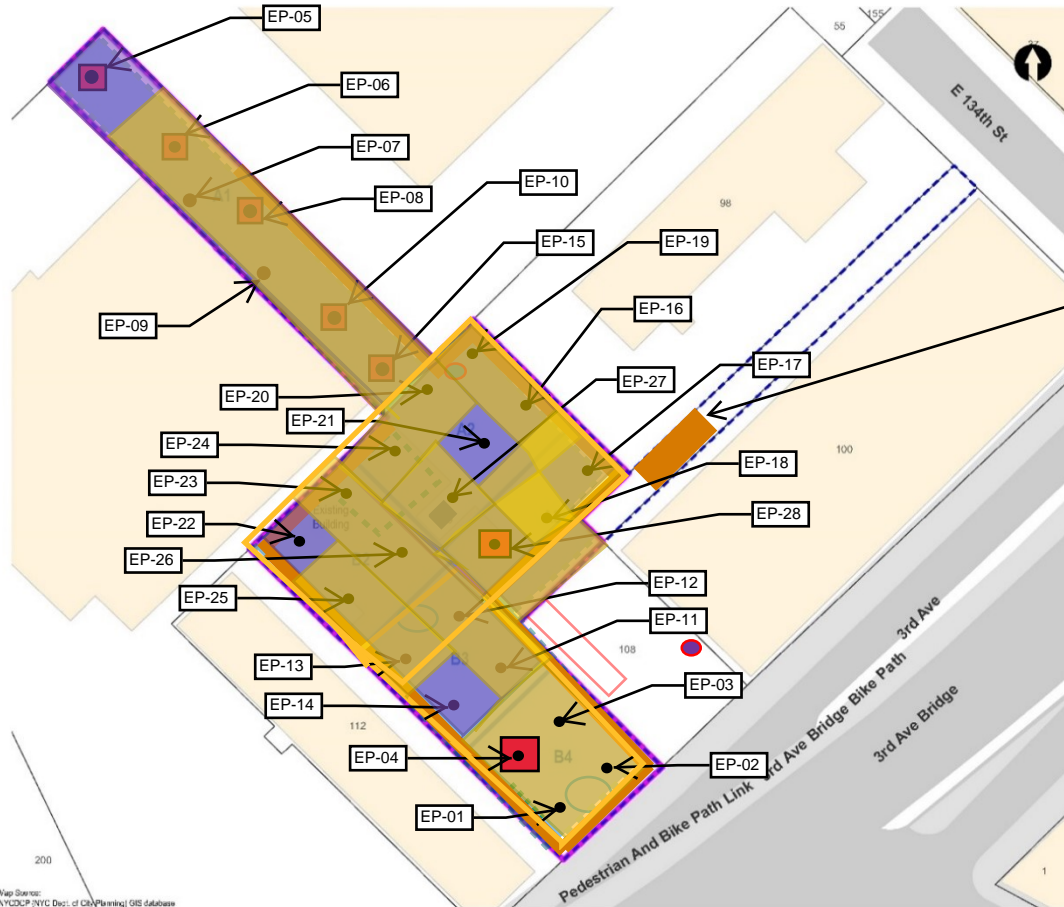

- Achieved Track 1 SCOs in this area
- Excavated hotspot area to 15' below grade
- Soil excavated to 12' below grade
- Location of dewatering system components
- Extent of dewatering system installation

SOE Drilling Completed (9/9/21)

LEGEND

- BCP SITE BOUNDARY
- REDEVELOPMENT SITE BOUNDARY
- LOT BOUNDARY AND TAX LOT NUMBER
- 2319 BLOCK NUMBER
- BUILDING
- ALPHANUMERIC GRID
- SOE INSTALLED PREVIOUSLY
- CURRENT WORK AREAS
- DOWNWIND CAMP STATION
- UPWIND CAMP STATIONS
- INSTALLED TEST PILES IN THIS AREA PREVIOUSLY
- Location of Truck Tracking Pad
- Location of hazardous lead contaminated soil (removed)



	Daily Activity Report					
	2413 Third Avenue					
	Bronx, New York					
	BCP No. C203137					
General Site Information						
Date:	Tuesday, December 21, 2021					
Weather:	Partly Cloudy, 30-44°F					
Wind Direction/Speed:	NE @ 7 mph					
AKRF Personnel on Site:	Nathaly Cota					
AKRF Equipment on Site:	RAE MiniRAE 3000 Photoionization Detector (PID)(x3), TSI DustTrak II(x2), and SidePak Aerosol Monitor 8530 (x1)					
Visitors:	None					
Contractor Information						
Contracting Company	Main Personnel		Equipment			
King's Contracting (waterproofing contractor)	Hanley Rivera		-			
LRC Construction	Pasquale Lampugnale		-			
ECD NY	Matthew Keane		Hydraulic excavator (x2), mini excavator (x1)			
Description and Location of Work Activities Performed						
The contractor installed rebar and concrete forms for foundation pile caps in Grids B3 and B4. Tower crane installation continued in Grid B3. King's Contracting (waterproofing contractor) installed the waterproofing membrane (Aussie Skin 550G) in the southern corner of Grid B4. Staged rebar in Grid A3. Minor grading occurred throughout the Site. Dewatering continued.						
Site Import Tracking Information						
Material	Daily Trucks	Total Trucks	Daily Tonnage	Total Tons	Facility of Origin	
Virgin Trap Rock- for Truck Tracking Pad	0	6	0	148.57	Haverstraw Quarry - Tilcon NY, Inc.	
Virgin Trap Rock - for Backfilling below slab	0	18	0	474.34	Haverstraw Quarry - Tilcon NY, Inc.	
Disposal Tracking Information						
Destination Facility/Material Type	Daily Trucks	Total Trucks	Daily Approx. Cubic Yds	Total Approx. Cubic Yds	Total Site Loads	Total Approximate Cubic Yards
EarthEfficient HBR, Phillipsburgh, NJ / Non-Haz Soil	0	267	0	5,340	614	12,280
EarthEfficient BTL, Pocono Summit, PA / C&D	0	17	0	340		
Bayshore Soil Management LLC, Keasbey NJ / Non-Haz Soil	0	72	0	1,440		
Cycle Chem, Inc., Elizabeth, NJ / Hazardous Soil	0	1	0	20		
MCUA Landfill, East Brunswick, NJ / Non-Haz Soil	1	257	20	5,140		
Air Monitoring Results						
CAMP Station	Upwind			Downwind		
Odors:	ND			ND		
VOC Action Level Exceedance(s):	ND			ND		
Particulate Action Level Exceedance(s):	NO			NO		
Maximum VOC 15-minute average (ppm):	0.882			0.201		
Maximum Particulate 15-minute average (mg/m³):	0.082			0.124		
Additional Information						
Planned Work Activity for Following Day/week:	LRC will continue concrete work throughout the week and install the tower crane base. Dewatering will continue throughout the site. Virign trap rock for backfilling is expected to be delivered tomorrow (12/22/2021). AKRF will collect soil endpoint samples.					
Comments:	None.					

2413 Third Avenue, Bronx, NY - Grid Map

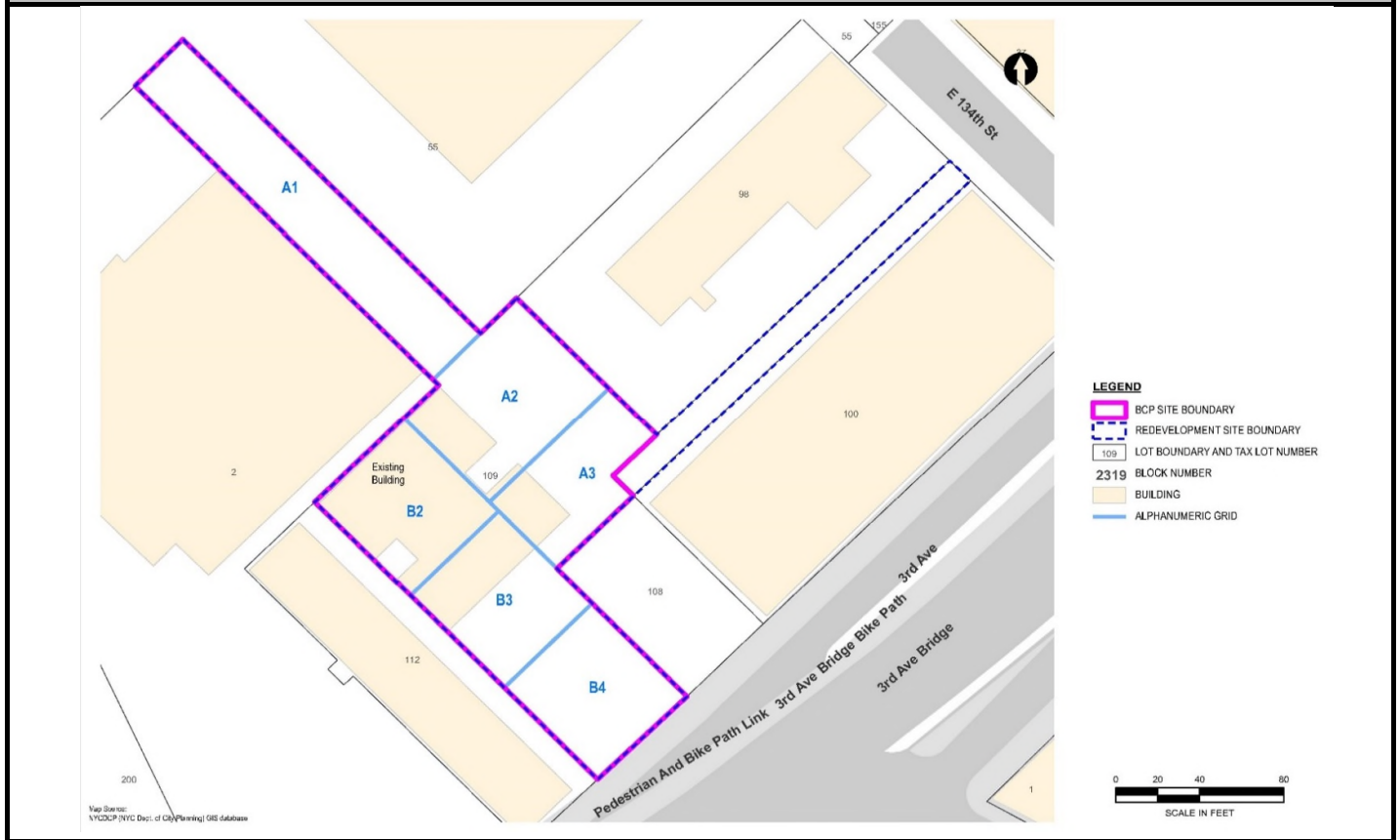

Site Photographs

Photograph 1 -
Staged rebar in Grid
A3, view facing north



Photograph 2 -
Installing
waterproofing/vapor
barrier membrane in
Grid B4, view facing
west.



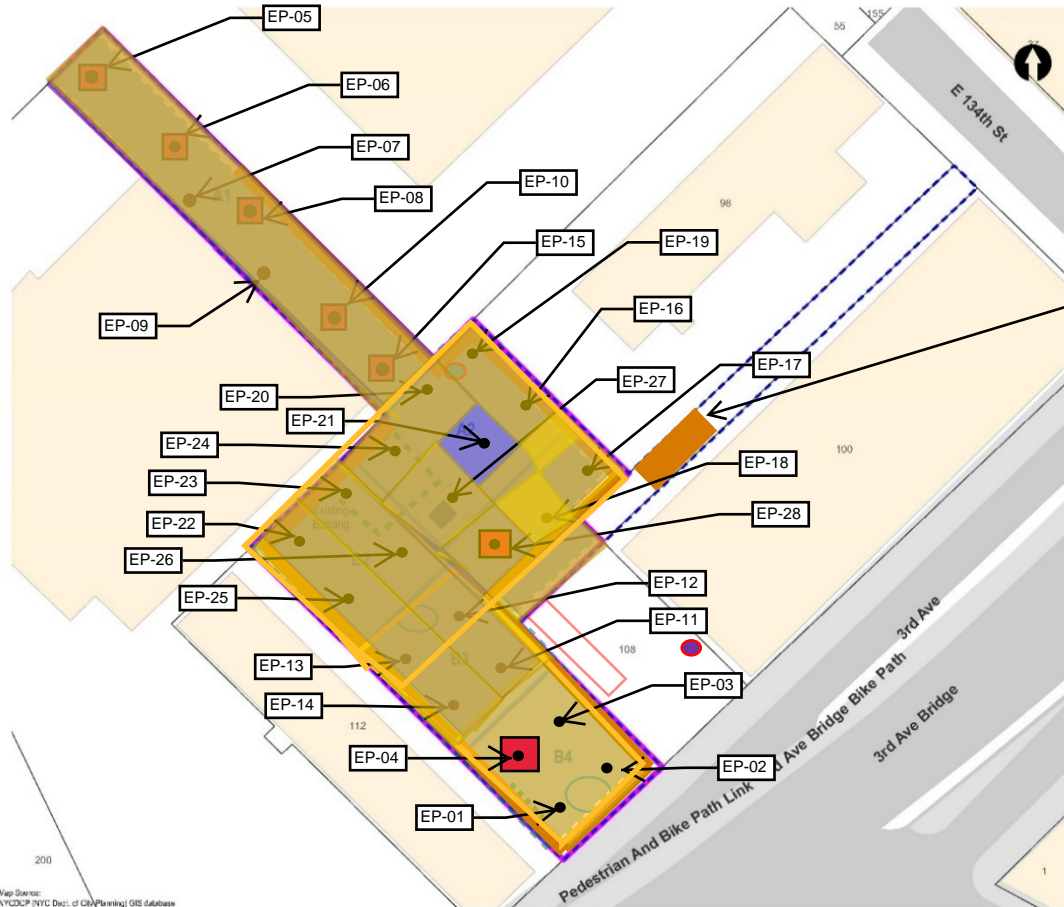

- Achieved Track 1 SCOs in this area
- Excavated hotspot area to 15' below grade
- Soil excavated to 12' below grade
- Location of dewatering system components
- Extent of dewatering system installation

SOE Drilling Completed (9/9/21)

LEGEND

- BCP SITE BOUNDARY
 - REDEVELOPMENT SITE BOUNDARY
 - LOT BOUNDARY AND TAX LOT NUMBER
 - 2319 BLOCK NUMBER
 - BUILDING
 - ALPHANUMERIC GRID
 - SOE INSTALLED PREVIOUSLY
 - CURRENT WORK AREAS
 - DOWNDOWN CAMP STATION
 - UPWIND CAMP STATIONS
 - INSTALLED TEST PILES IN THIS AREA PREVIOUSLY
 - Location of Truck Tracking Pad
 - Location of hazardous lead contaminated soil (removed)
- 0 20 40 80
SCALE IN FEET