



Daily Activity Report

Seton Brilla Charter School
1956 Jerome Avenue, Bronx, NY
BCP No. C203152

General Site Information

Date:	Tuesday, April 4, 2023
Weather:	Mostly Sunny, 44-71°F
Wind Direction/Speed:	NW @ 3 mph
AKRF Personnel on Site:	Celia Meyer
AKRF Equipment on Site:	Mini RAE 3000 Photoionization Detector [(PID) x1], 2 Fixed Air Monitoring Stations [DustTrak
Visitors:	None.

Contractor Information

Contracting Company	Main Personnel	Equipment
Casino Construction	Carlos	Excavator

Description and Location of Work Activities Performed

- 1) Casino continued installing rebar in the wooden foundation forms in Grid WC-03.
- 2) Casino continued cutting off pile cap rebar in Grid WC-03.
- 3) Casino continued to build wood foundation frames and grade soil within the structures for future concrete pour in Grid WC-03.

Destination Facility	Daily Trucks	Total Trucks	Daily Approx. Cubic Yds	Total Approx. Cubic Yds	Total Site Loads	Total Approximate Cubic Yards
Clean Earth Carteret	0	92	0	1,840	186	3,720
Clean Earth Southeastern Pennsylvania	0	67	0	1,340		
Concrete Disposal	0	27	0	540		
N/A	0	0	0	0		
N/A	0	0	0	0		

CAMP Air Monitoring Results

CAMP Station	UPWIND				DOWNWIND		
Odors:	None.				None.		
VOC Action Level Exceedance(s):	None.				None.		
Particulate Action Level Exceedance(s):	None.				None.		
Maximum VOC Level (15 min ppm):	0.24				0.618		
Maximum Particulate Level (15 min mg/m ³):	0.048				0.1141		

Notes: CAMP monitoring was performed throughout the day. Downwind CAMP dust trak recording negative readings and not recording readings consistently, troubleshooting failed throughout the day. If issues persist through 4/5/2023, will call EcoRentals to help troubleshoot.

Additional Information

Planned Work Activity for Following Day/Week:	1) Installation of rebar. 2) Installation of wooden foundation structures. 3) Exporting of soil off-site.
Comments:	None.

Site Map

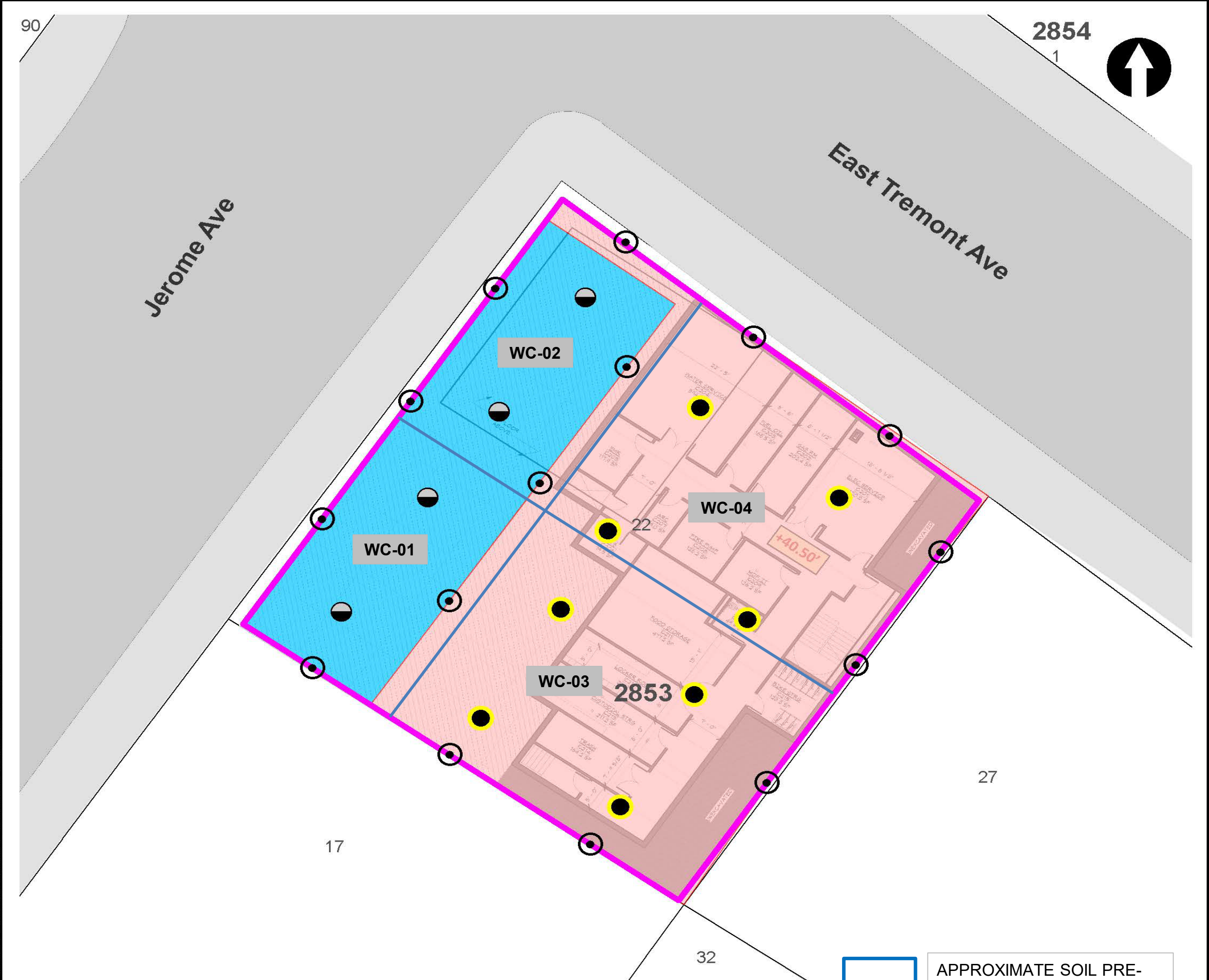

LEGEND

- PROJECT SITE BOUNDARY
- LOT BOUNDARY AND TAX LOT NUMBER
- 2853** BLOCK NUMBER
- REMEDIAL EXCAVATION TO APPROXIMATELY TWO FEET BELOW EXISTING GRADE
- REMEDIAL EXCAVATION TO GROUNDWATER (SOURCE AREA)

- CONFIRMATION DOCUMENTATION BOTTOM SAMPLE
- SOURCE AREA DOCUMENTATION BOTTOM SAMPLE
- DOCUMENTATION SIDEWALL SAMPLE

NOTE
 REMEDIAL EXCAVATION WILL INCLUDE REMOVAL OF APPROXIMATELY 1,280 TONS (850 CUBIC YARDS) OF SOURCE MATERIAL ASSOCIATED WITH NYSDEC SPILL NO. 2103719 AND APPROXIMATELY 860 TONS (570 CUBIC YARDS) OF SOIL/FILL FROM THE UPPER 2 FEET SITE-WIDE.



APPROXIMATE SOIL PRE-CHARACTERIZATION GRID

Map Source:
 NYCDOP (NYC Dept. of City Planning) GIS database

© 2021 AKRF. W:\Projects\210024 - 1956 JEROME AVENUE\Technical\GIS and Graphics\AR\RAW\210024 Figure 9 Proposed Remedial Excavation and Documentation Sample Location Plan.mxd 10/25/2021 2:03:38 PM iszalus



440 Park Avenue South, New York, NY 10016

1956 Jerome Avenue
 Bronx, New York

TRACK 4 CLEANUP AND DOCUMENTATION
SAMPLE LOCATION PLAN

DATE
04/29/2022

PROJECT NO.
210024

FIGURE
11

Site Photographs

Photograph 1 - Site overview, facing east.



Photograph 2 - Building wooden foundation structures in grid WC-03, facing east.



Photograph 3 - grading and light excavation in WC-03, facing northeast.



Upwind Station						
Time	Instaneous VOC (ppm)	Instaneous Mass Conc. Total (mg/m ³)	Mass Conc. Total mg/m ³ AVG 15m (mg/m ³)	Dust Exceedance	VOC ppm AVG 15m (ppm)	VOC Exceedance
4/4/2023 7:05	0	0.027	0.027	No	0	No
4/4/2023 7:06	0	0.029	0.028	No	0	No
4/4/2023 7:07	0	0.029	0.0283	No	0	No
4/4/2023 7:08	0	0.03	0.0288	No	0	No
4/4/2023 7:09	0	0.034	0.0298	No	0	No
4/4/2023 7:10	0	0.032	0.0302	No	0	No
4/4/2023 7:11	0	0.029	0.03	No	0	No
4/4/2023 7:12	0	0.028	0.0298	No	0	No
4/4/2023 7:13	0	0.028	0.0296	No	0	No
4/4/2023 7:14	0	0.028	0.0294	No	0	No
4/4/2023 7:15	0	0.027	0.0292	No	0	No
4/4/2023 7:16	0	0.028	0.0291	No	0	No
4/4/2023 7:17	0	0.029	0.0291	No	0	No
4/4/2023 7:18	0	0.029	0.0291	No	0	No
4/4/2023 7:19	0	0.029	0.0291	No	0	No
4/4/2023 7:20	0	0.03	0.0293	No	0	No
4/4/2023 7:21	0	0.032	0.0295	No	0	No
4/4/2023 7:22	0	0.031	0.0296	No	0	No
4/4/2023 7:23	0	0.035	0.0299	No	0	No
4/4/2023 7:24	0	0.04	0.0303	No	0	No
4/4/2023 7:25	0	0.032	0.0303	No	0	No
4/4/2023 7:26	0	0.035	0.0307	No	0	No
4/4/2023 7:27	0	0.035	0.0312	No	0	No
4/4/2023 7:28	0	0.034	0.0316	No	0	No
4/4/2023 7:29	0	0.048	0.0329	No	0	No
4/4/2023 7:30	0	0.096	0.0375	No	0	No
4/4/2023 7:31	0	0.059	0.0396	No	0	No
4/4/2023 7:32	0	0.078	0.0429	No	0	No
4/4/2023 7:33	0	0.051	0.0443	No	0	No
4/4/2023 7:34	0	0.047	0.0455	No	0	No
4/4/2023 7:35	0	0.042	0.0463	No	0	No
4/4/2023 7:36	0	0.044	0.0471	No	0	No
4/4/2023 7:37	0	0.044	0.048	No	0	No
4/4/2023 7:38	0	0.036	0.0481	No	0	No
4/4/2023 7:39	0	0.035	0.0477	No	0	No
4/4/2023 7:40	0	0.033	0.0478	No	0	No
4/4/2023 7:41	0	0.03	0.0475	No	0	No
4/4/2023 7:42	0	0.033	0.0473	No	0	No
4/4/2023 7:43	0	0.033	0.0473	No	0	No
4/4/2023 7:44	0	0.032	0.0462	No	0	No
4/4/2023 7:45	0	0.032	0.0419	No	0	No
4/4/2023 7:46	0	0.048	0.0412	No	0	No
4/4/2023 7:47	0	0.065	0.0403	No	0	No
4/4/2023 7:48	0	0.034	0.0392	No	0	No
4/4/2023 7:49	0	0.032	0.0382	No	0	No
4/4/2023 7:50	0	0.037	0.0379	No	0	No
4/4/2023 7:51	0	0.032	0.0371	No	0	No
4/4/2023 7:52	0	0.03	0.0361	No	0	No
4/4/2023 7:53	0	0.031	0.0358	No	0	No
4/4/2023 7:54	0	0.031	0.0355	No	0	No
4/4/2023 7:55	0	0.032	0.0355	No	0	No
4/4/2023 7:56	0	0.035	0.0358	No	0	No

Upwind Station						
Time	Instaneous VOC (ppm)	Instaneous Mass Conc. Total (mg/m³)	Mass Conc. Total mg/m³ AVG 15m (mg/m³)	Dust Exceedance	VOC ppm AVG 15m (ppm)	VOC Exceedance
4/4/2023 7:57	0	0.034	0.0359	No	0	No
4/4/2023 7:58	0	0.033	0.0359	No	0	No
4/4/2023 7:59	0	0.031	0.0358	No	0	No
4/4/2023 8:00	0	0.032	0.0358	No	0	No
4/4/2023 8:01	0	0.033	0.0348	No	0	No
4/4/2023 8:02	0	0.044	0.0334	No	0	No
4/4/2023 8:03	0	0.039	0.0337	No	0	No
4/4/2023 8:04	0	0.035	0.0339	No	0	No
4/4/2023 8:05	0	0.035	0.0338	No	0	No
4/4/2023 8:06	0	0.033	0.0339	No	0	No
4/4/2023 8:07	0	0.033	0.0341	No	0	No
4/4/2023 8:08	0	0.033	0.0342	No	0	No
4/4/2023 8:09	0	0.034	0.0344	No	0	No
4/4/2023 8:10	0	0.033	0.0345	No	0	No
4/4/2023 8:11	0	0.033	0.0343	No	0	No
4/4/2023 8:12	0	0.034	0.0343	No	0	No
4/4/2023 8:13	0	0.034	0.0344	No	0	No
4/4/2023 8:14	0	0.036	0.0347	No	0	No
4/4/2023 8:15	0	0.037	0.0351	No	0	No
4/4/2023 8:16	0	0.038	0.0354	No	0	No
4/4/2023 8:17	0	0.038	0.035	No	0	No
4/4/2023 8:18	0	0.037	0.0349	No	0	No
4/4/2023 8:19	0	0.037	0.035	No	0	No
4/4/2023 8:20	0	0.038	0.0352	No	0	No
4/4/2023 8:21	0	0.036	0.0354	No	0	No
4/4/2023 8:22	2.321	0.039	0.0358	No	0.1547	No
4/4/2023 8:23	0	0.041	0.0363	No	0.1547	No
4/4/2023 8:24	0	0.035	0.0364	No	0.1547	No
4/4/2023 8:25	0	0.036	0.0366	No	0.1547	No
4/4/2023 8:26	0	0.036	0.0368	No	0.1547	No
4/4/2023 8:27	0	0.037	0.037	No	0.1547	No
4/4/2023 8:28	0	0.036	0.0371	No	0.1547	No
4/4/2023 8:29	0	0.036	0.0371	No	0.1547	No
4/4/2023 8:30	0	0.036	0.0371	No	0.1547	No
4/4/2023 8:31	0	0.036	0.0369	No	0.1547	No
4/4/2023 8:32	0	0.037	0.0369	No	0.1547	No
4/4/2023 8:33	0	0.038	0.0369	No	0.1547	No
4/4/2023 8:34	0	0.041	0.0372	No	0.1547	No
4/4/2023 8:35	0	0.04	0.0373	No	0.1547	No
4/4/2023 8:36	0	0.04	0.0376	No	0.1547	No
4/4/2023 8:37	0	0.038	0.0375	No	0	No
4/4/2023 8:38	0	0.037	0.0373	No	0	No
4/4/2023 8:39	0	0.038	0.0375	No	0	No
4/4/2023 8:40	0	0.04	0.0377	No	0	No
4/4/2023 8:41	0	0.042	0.0381	No	0	No
4/4/2023 8:42	0	0.042	0.0385	No	0	No
4/4/2023 8:43	0	0.043	0.0389	No	0	No
4/4/2023 8:44	0	0.041	0.0393	No	0	No
4/4/2023 8:45	0	0.041	0.0396	No	0	No
4/4/2023 8:46	0	0.042	0.04	No	0	No
4/4/2023 8:47	0	0.039	0.0401	No	0	No
4/4/2023 8:48	0	0.04	0.0403	No	0	No

Upwind Station						
Time	Instaneous VOC (ppm)	Instaneous Mass Conc. Total (mg/m ³)	Mass Conc. Total mg/m ³ AVG 15m (mg/m ³)	Dust Exceedance	VOC ppm AVG 15m (ppm)	VOC Exceedance
4/4/2023 8:49	0	0.04	0.0402	No	0	No
4/4/2023 8:50	0	0.041	0.0403	No	0	No
4/4/2023 8:51	0	0.041	0.0403	No	0	No
4/4/2023 8:52	0	0.042	0.0406	No	0	No
4/4/2023 8:53	0	0.042	0.0409	No	0	No
4/4/2023 8:54	0	0.038	0.0409	No	0	No
4/4/2023 8:55	0	0.036	0.0407	No	0	No
4/4/2023 8:56	0	0.037	0.0403	No	0	No
4/4/2023 8:57	0	0.039	0.0401	No	0	No
4/4/2023 8:58	0	0.041	0.04	No	0	No
4/4/2023 8:59	0	0.044	0.0402	No	0	No
4/4/2023 9:00	0	0.085	0.0431	No	0	No
4/4/2023 9:01	0	0.046	0.0434	No	0	No
4/4/2023 9:02	0	0.046	0.0439	No	0	No
4/4/2023 9:03	0	0.048	0.0444	No	0	No
4/4/2023 9:04	0	0.044	0.0447	No	0	No
4/4/2023 9:05	0	0.04	0.0446	No	0	No
4/4/2023 9:06	0	0.042	0.0447	No	0	No
4/4/2023 9:07	0	0.04	0.0445	No	0	No
4/4/2023 9:08	0	0.043	0.0446	No	0	No
4/4/2023 9:09	0	0.042	0.0449	No	0	No
4/4/2023 9:10	0	0.045	0.0455	No	0	No
4/4/2023 9:11	0	0.042	0.0458	No	0	No
4/4/2023 9:12	0	0.039	0.0458	No	0	No
4/4/2023 9:13	0	0.038	0.0456	No	0	No
4/4/2023 9:14	0	0.039	0.0453	No	0	No
4/4/2023 9:15	0	0.039	0.0422	No	0	No
4/4/2023 9:16	0	0.039	0.0417	No	0	No
4/4/2023 9:17	0	0.038	0.0412	No	0	No
4/4/2023 9:18	0	0.039	0.0406	No	0	No
4/4/2023 9:19	0	0.041	0.0404	No	0	No
4/4/2023 9:20	0	0.04	0.0404	No	0	No
4/4/2023 9:21	0	0.036	0.04	No	0	No
4/4/2023 9:22	0	0.033	0.0395	No	0	No
4/4/2023 9:23	0	0.032	0.0388	No	0	No
4/4/2023 9:24	0	0.033	0.0382	No	0	No
4/4/2023 9:25	0	0.034	0.0375	No	0	No
4/4/2023 9:26	0	0.033	0.0369	No	0	No
4/4/2023 9:27	0	0.061	0.0383	No	0	No
4/4/2023 9:28	0	0.038	0.0383	No	0	No
4/4/2023 9:29	0	0.037	0.0382	No	0	No
4/4/2023 9:30	0	0.038	0.0381	No	0	No
4/4/2023 9:31	0	0.035	0.0379	No	0	No
4/4/2023 9:32	0	0.037	0.0378	No	0	No
4/4/2023 9:33	0	0.038	0.0377	No	0	No
4/4/2023 9:34	0	0.035	0.0373	No	0	No
4/4/2023 9:35	0	0.034	0.0369	No	0	No
4/4/2023 9:36	0	0.036	0.0369	No	0	No
4/4/2023 9:37	0	0.035	0.0371	No	0	No
4/4/2023 9:38	0	0.036	0.0373	No	0	No
4/4/2023 9:39	0	0.036	0.0375	No	0	No
4/4/2023 9:40	0	0.037	0.0377	No	0	No

Upwind Station

Time	Instantaneous VOC (ppm)	Instantaneous Mass Conc. Total (mg/m ³)	Mass Conc. Total mg/m ³ AVG 15m (mg/m ³)	Dust Exceedance	VOC ppm AVG 15m (ppm)	VOC Exceedance
4/4/2023 9:41	0	0.038	0.0381	No	0	No
4/4/2023 9:42	0	0.044	0.0369	No	0	No
4/4/2023 9:43	0	0.047	0.0375	No	0	No
4/4/2023 9:44	0	0.043	0.0379	No	0	No
4/4/2023 9:45	0	0.036	0.0378	No	0	No
4/4/2023 9:46	0	0.034	0.0377	No	0	No
4/4/2023 9:47	0	0.034	0.0375	No	0	No
4/4/2023 9:48	0	0.034	0.0373	No	0	No
4/4/2023 9:49	0	0.034	0.0372	No	0	No
4/4/2023 9:50	0	0.037	0.0374	No	0	No
4/4/2023 9:51	0	0.036	0.0374	No	0	No
4/4/2023 9:52	0	0.038	0.0376	No	0	No
4/4/2023 9:53	0	0.037	0.0377	No	0	No
4/4/2023 9:54	0	0.037	0.0377	No	0	No
4/4/2023 9:55	0	0.037	0.0377	No	0	No
4/4/2023 9:56	0	0.038	0.0377	No	0	No
4/4/2023 9:57	0	0.039	0.0374	No	0	No
4/4/2023 9:58	0	0.043	0.0371	No	0	No
4/4/2023 9:59	0	0.043	0.0371	No	0	No
4/4/2023 10:00	0	0.044	0.0377	No	0	No
4/4/2023 10:01	0	0.04	0.0381	No	0	No
4/4/2023 10:02	0	0.039	0.0384	No	0	No
4/4/2023 10:03	0	0.038	0.0387	No	0	No
4/4/2023 10:04	0	0.037	0.0389	No	0	No
4/4/2023 10:05	0	0.037	0.0389	No	0	No
4/4/2023 10:06	0	0.038	0.039	No	0	No
4/4/2023 10:07	0	0.038	0.039	No	0	No
4/4/2023 10:08	0	0.04	0.0392	No	0	No
4/4/2023 10:09	0	0.039	0.0393	No	0	No
4/4/2023 10:10	0	0.041	0.0396	No	0	No
4/4/2023 10:11	0	0.04	0.0397	No	0	No
4/4/2023 10:12	0	0.041	0.0399	No	0	No
4/4/2023 10:13	0	0.041	0.0397	No	0	No
4/4/2023 10:14	0	0.038	0.0394	No	0	No
4/4/2023 10:15	0	0.04	0.0391	No	0	No
4/4/2023 10:16	0	0.037	0.0389	No	0	No
4/4/2023 10:17	0	0.037	0.0388	No	0	No
4/4/2023 10:18	0	0.041	0.039	No	0	No
4/4/2023 10:19	0	0.035	0.0389	No	0	No
4/4/2023 10:20	0	0.033	0.0386	No	0	No
4/4/2023 10:21	0	0.034	0.0383	No	0	No
4/4/2023 10:22	0	0.033	0.038	No	0	No
4/4/2023 10:23	0	0.033	0.0375	No	0	No
4/4/2023 10:24	0	0.033	0.0371	No	0	No
4/4/2023 10:25	0	0.034	0.0367	No	0	No
4/4/2023 10:26	0	0.033	0.0362	No	0	No
4/4/2023 10:27	0	0.034	0.0357	No	0	No
4/4/2023 10:28	0	0.033	0.0352	No	0	No
4/4/2023 10:29	0	0.035	0.035	No	0	No
4/4/2023 10:30	0	0.038	0.0349	No	0	No
4/4/2023 10:31	0	0.045	0.0354	No	0	No
4/4/2023 10:32	0	0.044	0.0359	No	0	No

Upwind Station						
Time	Instaneous VOC (ppm)	Instaneous Mass Conc. Total (mg/m ³)	Mass Conc. Total mg/m ³ AVG 15m (mg/m ³)	Dust Exceedance	VOC ppm AVG 15m (ppm)	VOC Exceedance
4/4/2023 10:33	0	0.043	0.036	No	0	No
4/4/2023 10:34	0	0.04	0.0363	No	0	No
4/4/2023 10:35	0	0.038	0.0367	No	0	No
4/4/2023 10:36	0	0.038	0.0369	No	0	No
4/4/2023 10:37	0	0.038	0.0373	No	0	No
4/4/2023 10:38	0	0.038	0.0376	No	0	No
4/4/2023 10:39	0	0.038	0.0379	No	0	No
4/4/2023 10:40	0	0.038	0.0382	No	0	No
4/4/2023 10:41	0	0.039	0.0386	No	0	No
4/4/2023 10:42	0	0.039	0.0389	No	0	No
4/4/2023 10:43	0	0.041	0.0395	No	0	No
4/4/2023 10:44	0	0.041	0.0399	No	0	No
4/4/2023 10:45	0	0.053	0.0409	No	0	No
4/4/2023 10:46	0	0.038	0.0404	No	0	No
4/4/2023 10:47	0	0.04	0.0401	No	0	No
4/4/2023 10:48	0	0.046	0.0403	No	0	No
4/4/2023 10:49	0	0.043	0.0405	No	0	No
4/4/2023 10:50	0	0.041	0.0407	No	0	No
4/4/2023 10:51	0	0.041	0.0409	No	0	No
4/4/2023 10:52	0	0.04	0.0411	No	0	No
4/4/2023 10:53	0	0.046	0.0416	No	0	No
4/4/2023 10:54	0	0.047	0.0422	No	0	No
4/4/2023 10:55	0	0.04	0.0423	No	0	No
4/4/2023 10:56	0	0.041	0.0425	No	0	No
4/4/2023 10:57	0	0.041	0.0426	No	0	No
4/4/2023 10:58	0	0.042	0.0427	No	0	No
4/4/2023 10:59	0	0.041	0.0427	No	0	No
4/4/2023 11:00	0	0.04	0.0418	No	0	No
4/4/2023 11:01	0	0.04	0.0419	No	0	No
4/4/2023 11:02	0	0.042	0.0421	No	0	No
4/4/2023 11:03	0	0.041	0.0417	No	0	No
4/4/2023 11:04	0	0.04	0.0415	No	0	No
4/4/2023 11:05	0	0.039	0.0414	No	0	No
4/4/2023 11:06	0	0.042	0.0415	No	0	No
4/4/2023 11:07	0.008	0.04	0.0415	No	0.0005	No
4/4/2023 11:08	0	0.039	0.041	No	0.0005	No
4/4/2023 11:09	0	0.038	0.0404	No	0.0005	No
4/4/2023 11:10	0	0.038	0.0403	No	0.0005	No
4/4/2023 11:11	0	0.04	0.0402	No	0.0005	No
4/4/2023 11:12	0	0.042	0.0403	No	0.0005	No
4/4/2023 11:13	0	0.042	0.0403	No	0.0005	No
4/4/2023 11:14	0	0.043	0.0404	No	0.0005	No
4/4/2023 11:15	0	0.042	0.0405	No	0.0005	No
4/4/2023 11:16	0	0.042	0.0407	No	0.0005	No
4/4/2023 11:17	0	0.042	0.0407	No	0.0005	No
4/4/2023 11:18	0	0.041	0.0407	No	0.0005	No
4/4/2023 11:19	0	0.042	0.0408	No	0.0005	No
4/4/2023 11:20	0	0.04	0.0409	No	0.0005	No
4/4/2023 11:21	0	0.039	0.0407	No	0.0005	No
4/4/2023 11:22	0	0.04	0.0407	No	0	No
4/4/2023 11:23	0	0.04	0.0407	No	0	No
4/4/2023 11:24	0.022	0.041	0.0409	No	0.0015	No

Upwind Station						
Time	Instaneous VOC (ppm)	Instaneous Mass Conc. Total (mg/m ³)	Mass Conc. Total mg/m ³ AVG 15m (mg/m ³)	Dust Exceedance	VOC ppm AVG 15m (ppm)	VOC Exceedance
4/4/2023 11:25	0	0.041	0.0411	No	0.0015	No
4/4/2023 11:26	0	0.04	0.0411	No	0.0015	No
4/4/2023 11:27	0.003	0.038	0.0409	No	0.0017	No
4/4/2023 11:28	0.049	0.039	0.0407	No	0.0049	No
4/4/2023 11:29	0.007	0.038	0.0403	No	0.0054	No
4/4/2023 11:30	0.004	0.04	0.0402	No	0.0057	No
4/4/2023 11:31	0.047	0.039	0.04	No	0.0088	No
4/4/2023 11:32	0	0.039	0.0398	No	0.0088	No
4/4/2023 11:33	0	0.039	0.0397	No	0.0088	No
4/4/2023 11:34	0.001	0.039	0.0395	No	0.0089	No
4/4/2023 11:35	0	0.041	0.0395	No	0.0089	No
4/4/2023 11:36	0	0.04	0.0396	No	0.0089	No
4/4/2023 11:37	0.053	0.039	0.0395	No	0.0124	No
4/4/2023 11:38	0.004	0.039	0.0395	No	0.0127	No
4/4/2023 11:39	0	0.039	0.0393	No	0.0112	No
4/4/2023 11:40	0.012	0.04	0.0393	No	0.012	No
4/4/2023 11:41	0.001	0.04	0.0393	No	0.0121	No
4/4/2023 11:42	0.007	0.039	0.0393	No	0.0123	No
4/4/2023 11:43	0	0.039	0.0393	No	0.0091	No
4/4/2023 11:44	0	0.04	0.0395	No	0.0086	No
4/4/2023 11:45	0	0.038	0.0393	No	0.0083	No
4/4/2023 11:46	0.015	0.037	0.0392	No	0.0062	No
4/4/2023 11:47	0.023	0.038	0.0391	No	0.0077	No
4/4/2023 11:48	0.073	0.038	0.0391	No	0.0126	No
4/4/2023 11:49	0.123	0.037	0.0389	No	0.0207	No
4/4/2023 11:50	0.031	0.038	0.0387	No	0.0228	No
4/4/2023 11:51	0.024	0.038	0.0386	No	0.0244	No
4/4/2023 11:52	0.06	0.037	0.0385	No	0.0249	No
4/4/2023 11:53	0.036	0.039	0.0385	No	0.027	No
4/4/2023 11:54	0.093	0.043	0.0387	No	0.0332	No
4/4/2023 11:55	0.088	0.038	0.0386	No	0.0383	No
4/4/2023 11:56	0.035	0.039	0.0385	No	0.0405	No
4/4/2023 11:57	0.093	0.037	0.0384	No	0.0463	No
4/4/2023 11:58	0.042	0.037	0.0383	No	0.0491	No
4/4/2023 11:59	0.08	0.038	0.0381	No	0.0544	No
4/4/2023 12:00	0.152	0.039	0.0382	No	0.0645	No
4/4/2023 12:01	0.057	0.039	0.0383	No	0.0673	No
4/4/2023 12:02	0.078	0.04	0.0385	No	0.071	No
4/4/2023 12:03	0.063	0.039	0.0385	No	0.0703	No
4/4/2023 12:04	0.102	0.037	0.0385	No	0.0689	No
4/4/2023 12:05	0.048	0.037	0.0385	No	0.0701	No
4/4/2023 12:06	0.098	0.036	0.0383	No	0.075	No
4/4/2023 12:07	0.396	0.037	0.0383	No	0.0974	No
4/4/2023 12:08	0.412	0.04	0.0384	No	0.1225	No
4/4/2023 12:09	0.163	0.041	0.0383	No	0.1271	No
4/4/2023 12:10	0.09	0.039	0.0383	No	0.1273	No
4/4/2023 12:11	0.068	0.039	0.0383	No	0.1295	No
4/4/2023 12:12	0.074	0.04	0.0385	No	0.1282	No
4/4/2023 12:13	0.25	0.039	0.0387	No	0.1421	No
4/4/2023 12:14	0.115	0.04	0.0388	No	0.1444	No
4/4/2023 12:15	0.128	0.042	0.039	No	0.1428	No
4/4/2023 12:16	0.197	0.04	0.0391	No	0.1521	No

Upwind Station						
Time	Instaneous VOC (ppm)	Instaneous Mass Conc. Total (mg/m ³)	Mass Conc. Total mg/m ³ AVG 15m (mg/m ³)	Dust Exceedance	VOC ppm AVG 15m (ppm)	VOC Exceedance
4/4/2023 12:17	0.202	0.042	0.0392	No	0.1604	No
4/4/2023 12:18	0.142	0.04	0.0393	No	0.1657	No
4/4/2023 12:19	0.117	0.04	0.0395	No	0.1667	No
4/4/2023 12:20	0.133	0.044	0.0399	No	0.1723	No
4/4/2023 12:21	0.142	0.042	0.0403	No	0.1753	No
4/4/2023 12:22	0.145	0.045	0.0409	No	0.1585	No
4/4/2023 12:23	0.293	0.047	0.0413	No	0.1506	No
4/4/2023 12:24	0.137	0.049	0.0419	No	0.1489	No
4/4/2023 12:25	0.094	0.04	0.0419	No	0.1491	No
4/4/2023 12:26	0.128	0.044	0.0423	No	0.1531	No
4/4/2023 12:27	0.21	0.039	0.0422	No	0.1622	No
4/4/2023 12:28	0.267	0.042	0.0424	No	0.1633	No
4/4/2023 12:29	0.136	0.045	0.0427	No	0.1647	No
4/4/2023 12:30	0.125	0.041	0.0427	No	0.1645	No
4/4/2023 12:31	0.101	0.038	0.0425	No	0.1581	No
4/4/2023 12:32	0.295	0.04	0.0424	No	0.1643	No
4/4/2023 12:33	0.149	0.054	0.0433	No	0.1648	No
4/4/2023 12:34	0.172	0.054	0.0443	No	0.1685	No
4/4/2023 12:35	0.096	0.042	0.0441	No	0.166	No
4/4/2023 12:36	0.093	0.043	0.0442	No	0.1627	No
4/4/2023 12:37	0.13	0.04	0.0439	No	0.1617	No
4/4/2023 12:38	0.121	0.043	0.0436	No	0.1503	No
4/4/2023 12:39	0.164	0.041	0.0431	No	0.1521	No
4/4/2023 12:40	0.448	0.063	0.0446	No	0.1757	No
4/4/2023 12:41	0.258	0.045	0.0447	No	0.1843	No
4/4/2023 12:42	0.213	0.041	0.0448	No	0.1845	No
4/4/2023 12:43	0.135	0.041	0.0447	No	0.1757	No
4/4/2023 12:44	0.348	0.041	0.0445	No	0.1899	No
4/4/2023 12:45	0.148	0.04	0.0444	No	0.1914	No
4/4/2023 12:46	0.232	0.04	0.0445	No	0.2001	No
4/4/2023 12:47	0.16	0.039	0.0445	No	0.1911	No
4/4/2023 12:48	0.129	0.043	0.0437	No	0.1898	No
4/4/2023 12:49	0.273	0.039	0.0427	No	0.1965	No
4/4/2023 12:50	0.162	0.038	0.0425	No	0.2009	No
4/4/2023 12:51	0.153	0.039	0.0422	No	0.2049	No
4/4/2023 12:52	0.128	0.042	0.0423	No	0.2048	No
4/4/2023 12:53	0.132	0.043	0.0423	No	0.2055	No
4/4/2023 12:54	0.28	0.039	0.0422	No	0.2133	No
4/4/2023 12:55	0.157	0.039	0.0406	No	0.1939	No
4/4/2023 12:56	0.209	0.038	0.0401	No	0.1906	No
4/4/2023 12:57	0.201	0.038	0.0399	No	0.1898	No
4/4/2023 12:58	0.153	0.038	0.0397	No	0.191	No
4/4/2023 12:59	0.452	0.037	0.0395	No	0.1979	No
4/4/2023 13:00	0.172	0.035	0.0391	No	0.1995	No
4/4/2023 13:01	0.189	0.035	0.0388	No	0.1967	No
4/4/2023 13:02	0.159	0.035	0.0385	No	0.1966	No
4/4/2023 13:03	0.253	0.033	0.0379	No	0.2049	No
4/4/2023 13:04	0.173	0.034	0.0375	No	0.1982	No
4/4/2023 13:05	0.181	0.038	0.0375	No	0.1995	No
4/4/2023 13:06	0.175	0.038	0.0375	No	0.2009	No
4/4/2023 13:07	0.236	0.036	0.0371	No	0.2081	No
4/4/2023 13:08	0.272	0.034	0.0365	No	0.2175	No

Upwind Station						
Time	Instaneous VOC (ppm)	Instaneous Mass Conc. Total (mg/m ³)	Mass Conc. Total mg/m ³ AVG 15m (mg/m ³)	Dust Exceedance	VOC ppm AVG 15m (ppm)	VOC Exceedance
4/4/2023 13:09	0.192	0.034	0.0361	No	0.2116	No
4/4/2023 13:10	0.159	0.032	0.0357	No	0.2117	No
4/4/2023 13:11	0.167	0.03	0.0351	No	0.2089	No
4/4/2023 13:12	0.141	0.026	0.0343	No	0.2049	No
4/4/2023 13:13	0.139	0.026	0.0335	No	0.204	No
4/4/2023 13:14	0.137	0.025	0.0327	No	0.183	No
4/4/2023 13:15	0.152	0.025	0.0321	No	0.1817	No
4/4/2023 13:16	0.22	0.022	0.0312	No	0.1837	No
4/4/2023 13:17	0.173	0.024	0.0305	No	0.1847	No
4/4/2023 13:18	0.296	0.026	0.03	No	0.1875	No
4/4/2023 13:19	0.24	0.027	0.0295	No	0.192	No
4/4/2023 13:20	0.196	0.027	0.0288	No	0.193	No
4/4/2023 13:21	0.163	0.028	0.0281	No	0.1922	No
4/4/2023 13:22	0.195	0.03	0.0277	No	0.1895	No
4/4/2023 13:23	0.16	0.028	0.0273	No	0.182	No
4/4/2023 13:24	0.319	0.029	0.027	No	0.1905	No
4/4/2023 13:25	0.163	0.026	0.0266	No	0.1907	No
4/4/2023 13:26	0.206	0.026	0.0263	No	0.1933	No
4/4/2023 13:27	0.402	0.025	0.0263	No	0.2107	No
4/4/2023 13:28	0.325	0.024	0.0261	No	0.2231	No
4/4/2023 13:29	0.252	0.024	0.0261	No	0.2308	No
4/4/2023 13:30	0.29	0.025	0.0261	No	0.24	No
4/4/2023 13:31	0.161	0.022	0.0261	No	0.2361	No
4/4/2023 13:32	0.176	0.023	0.026	No	0.2363	No
4/4/2023 13:33	0.135	0.024	0.0259	No	0.2255	No
4/4/2023 13:34	0.155	0.025	0.0257	No	0.2199	No
4/4/2023 13:35	0.212	0.025	0.0256	No	0.2209	No
4/4/2023 13:36	0.429	0.025	0.0254	No	0.2387	No
4/4/2023 13:37	0.251	0.028	0.0253	No	0.2424	No
4/4/2023 13:38	0.149	0.026	0.0251	No	0.2417	No
4/4/2023 13:39	0.192	0.026	0.0249	No	0.2332	No
4/4/2023 13:40	0.124	0.04	0.0259	No	0.2306	No
4/4/2023 13:41	0.111	0.029	0.0261	No	0.2243	No
4/4/2023 13:42	0.101	0.024	0.026	No	0.2042	No
4/4/2023 13:43	0.106	0.023	0.0259	No	0.1896	No
4/4/2023 13:44	0.155	0.024	0.0259	No	0.1831	No
4/4/2023 13:45	0.296	0.027	0.0261	No	0.1835	No
4/4/2023 13:46	0.3	0.027	0.0264	No	0.1928	No
4/4/2023 13:47	0.344	0.027	0.0267	No	0.204	No
4/4/2023 13:48	0.18	0.028	0.0269	No	0.207	No
4/4/2023 13:49	0.208	0.027	0.0271	No	0.2105	No
4/4/2023 13:50	0.212	0.026	0.0271	No	0.2105	No
4/4/2023 13:51	0.305	0.025	0.0271	No	0.2023	No
4/4/2023 13:52	0.237	0.026	0.027	No	0.2013	No
4/4/2023 13:53	0.306	0.026	0.027	No	0.2118	No
4/4/2023 13:54	0.163	0.028	0.0271	No	0.2099	No
4/4/2023 13:55	0.149	0.028	0.0263	No	0.2115	No
4/4/2023 13:56	0.117	0.027	0.0262	No	0.2119	No
4/4/2023 13:57	0.327	0.026	0.0263	No	0.227	No
4/4/2023 13:58	0.242	0.027	0.0266	No	0.2361	No
4/4/2023 13:59	0.231	0.026	0.0267	No	0.2411	No
4/4/2023 14:00	0.189	0.024	0.0265	No	0.234	No

Upwind Station						
Time	Instaneous VOC (ppm)	Instaneous Mass Conc. Total (mg/m ³)	Mass Conc. Total mg/m ³ AVG 15m (mg/m ³)	Dust Exceedance	VOC ppm AVG 15m (ppm)	VOC Exceedance
4/4/2023 14:01	0.213	0.022	0.0262	No	0.2282	No
4/4/2023 14:02	0.144	0.022	0.0259	No	0.2149	No
4/4/2023 14:03	0.205	0.025	0.0257	No	0.2165	No
4/4/2023 14:04	0.189	0.026	0.0256	No	0.2153	No
4/4/2023 14:05	0.163	0.026	0.0256	No	0.212	No
4/4/2023 14:06	0.122	0.027	0.0257	No	0.1998	No
4/4/2023 14:07	0.325	0.026	0.0257	No	0.2057	No
4/4/2023 14:08	0.146	0.027	0.0258	No	0.195	No
4/4/2023 14:09	0.134	0.026	0.0257	No	0.1931	No
4/4/2023 14:10	0.189	0.027	0.0256	No	0.1957	No
4/4/2023 14:11	0.16	0.027	0.0256	No	0.1986	No
4/4/2023 14:12	0.15	0.028	0.0257	No	0.1868	No
4/4/2023 14:13	0.124	0.026	0.0257	No	0.1789	No
4/4/2023 14:14	0.141	0.027	0.0257	No	0.1729	No
4/4/2023 14:15	0.163	0.028	0.026	No	0.1712	No
4/4/2023 14:16	0.127	0.027	0.0263	No	0.1655	No
4/4/2023 14:17	0.09	0.028	0.0267	No	0.1619	No
4/4/2023 14:18	0.123	0.029	0.027	No	0.1564	No
4/4/2023 14:19	0.098	0.027	0.0271	No	0.1503	No
4/4/2023 14:20	0.079	0.025	0.027	No	0.1447	No
4/4/2023 14:21	0.097	0.025	0.0269	No	0.1431	No
4/4/2023 14:22	0.095	0.025	0.0268	No	0.1277	No
4/4/2023 14:23	0.175	0.026	0.0267	No	0.1297	No
4/4/2023 14:24	0.365	0.025	0.0267	No	0.1451	No
4/4/2023 14:25	0.155	0.027	0.0267	No	0.1428	No
4/4/2023 14:26	0.185	0.027	0.0267	No	0.1445	No
4/4/2023 14:27	0.146	0.027	0.0266	No	0.1442	No
4/4/2023 14:28	0.262	0.026	0.0266	No	0.1534	No
4/4/2023 14:29	0.158	0.026	0.0265	No	0.1545	No
4/4/2023 14:30	0.13	0.026	0.0264	No	0.1523	No
4/4/2023 14:31	0.131	0.027	0.0264	No	0.1526	No
4/4/2023 14:32	0.182	0.027	0.0263	No	0.1587	No
4/4/2023 14:33	0.155	0.027	0.0262	No	0.1609	No
4/4/2023 14:34	0.097	0.026	0.0261	No	0.1608	No
4/4/2023 14:35	0.132	0.026	0.0262	No	0.1643	No
4/4/2023 14:36	0.144	0.025	0.0262	No	0.1675	No
4/4/2023 14:37	0.18	0.026	0.0263	No	0.1731	No
4/4/2023 14:38	0.247	0.026	0.0263	No	0.1779	No
4/4/2023 14:39	0.325	0.025	0.0263	No	0.1753	No
4/4/2023 14:40	0.127	0.025	0.0261	No	0.1734	No
4/4/2023 14:41	0.096	0.025	0.026	No	0.1675	No
4/4/2023 14:42	0.143	0.025	0.0259	No	0.1673	No
4/4/2023 14:43	0.121	0.025	0.0258	No	0.1579	No
4/4/2023 14:44	0.124	0.026	0.0258	No	0.1556	No
4/4/2023 14:45	0.373	0.025	0.0257	No	0.1718	No
4/4/2023 14:46	0.14	0.026	0.0257	No	0.1724	No
4/4/2023 14:47	0.127	0.025	0.0255	No	0.1687	No
4/4/2023 14:48	0.253	0.023	0.0253	No	0.1753	No
4/4/2023 14:49	0.147	0.022	0.025	No	0.1786	No
4/4/2023 14:50	0.097	0.023	0.0248	No	0.1763	No
4/4/2023 14:51	0.129	0.025	0.0248	No	0.1753	No
4/4/2023 14:52	0.093	0.024	0.0247	No	0.1695	No

Upwind Station						
Time	Instaneous VOC (ppm)	Instaneous Mass Conc. Total (mg/m ³)	Mass Conc. Total mg/m ³ AVG 15m (mg/m ³)	Dust Exceedance	VOC ppm AVG 15m (ppm)	VOC Exceedance
4/4/2023 14:53	0.09	0.025	0.0246	No	0.159	No
4/4/2023 14:54	0.157	0.024	0.0245	No	0.1478	No
4/4/2023 14:55	0.078	0.026	0.0246	No	0.1445	No
4/4/2023 14:56	0.171	0.024	0.0245	No	0.1495	No
4/4/2023 14:57	0.079	0.023	0.0244	No	0.1453	No
4/4/2023 14:58	0.205	0.024	0.0243	No	0.1509	No
4/4/2023 14:59	0.067	0.022	0.0241	No	0.1471	No
4/4/2023 15:00	0.126	0.021	0.0238	No	0.1306	No
4/4/2023 15:01	0.203	0.021	0.0235	No	0.1348	No
4/4/2023 15:02	0.103	0.021	0.0232	No	0.1332	No
4/4/2023 15:03	0.095	0.021	0.0231	No	0.1227	No
4/4/2023 15:04	0.148	0.022	0.0231	No	0.1227	No
4/4/2023 15:05	0.119	0.022	0.023	No	0.1242	No
4/4/2023 15:06	0.079	0.023	0.0229	No	0.1209	No
4/4/2023 15:07	0.083	0.02	0.0226	No	0.1202	No
4/4/2023 15:08	0.079	0.028	0.0228	No	0.1195	No
4/4/2023 15:09	0.051	0.027	0.023	No	0.1124	No
4/4/2023 15:10	0.047	0.019	0.0225	No	0.1103	No
4/4/2023 15:11	0.03	0.021	0.0223	No	0.1009	No
4/4/2023 15:12	0.04	0.023	0.0223	No	0.0983	No
4/4/2023 15:13	0.026	0.02	0.0221	No	0.0864	No
4/4/2023 15:14	0.117	0.02	0.0219	No	0.0897	No
4/4/2023 15:15	0.029	0.026	0.0223	No	0.0833	No
4/4/2023 15:16	0.009	0.02	0.0222	No	0.0703	No
4/4/2023 15:17	0.043	0.02	0.0221	No	0.0663	No
4/4/2023 15:18	0.044	0.023	0.0223	No	0.0629	No
4/4/2023 15:19	0.046	0.021	0.0222	No	0.0561	No

Downwind Station						
Time	Instantaneous VOC (ppm)	Instantaneous Mass Conc. Total (mg/m ³)	Mass Conc. Total mg/m ³ AVG 15m (mg/m ³)	Dust Exceedance	VOC ppm AVG 15m (ppm)	VOC Exceedance
4/4/2023 7:11	0	0.04	0.04	No	0	No
4/4/2023 7:12	0	0.034	0.037	No	0	No
4/4/2023 7:13	0			No	0	No
4/4/2023 7:14	0	0.025	0.033	No	0	No
4/4/2023 7:15	0.056	0.027	0.0315	No	0.0112	No
4/4/2023 7:16	0.01	0.023	0.0298	No	0.011	No
4/4/2023 7:17	0.012	0.023	0.0287	No	0.0111	No
4/4/2023 7:18	0	0.022	0.0277	No	0.0098	No
4/4/2023 7:19	0.013	0.023	0.0271	No	0.0101	No
4/4/2023 7:20	0	0.027	0.0271	No	0.0091	No
4/4/2023 7:21	0.064	0.044	0.0288	No	0.0141	No
4/4/2023 7:22	0.184	0.058	0.0315	No	0.0283	No
4/4/2023 7:23	0	0.031	0.0314	No	0.0261	No
4/4/2023 7:24	0.557	0.029	0.0312	No	0.064	No
4/4/2023 7:25	0.003	0.029	0.0311	No	0.0599	No
4/4/2023 7:26	0.01	0.027	0.0301	No	0.0606	No
4/4/2023 7:27	0	0.035	0.0302	No	0.0606	No
4/4/2023 7:28	0	0.271	0.0463	No	0.0606	No
4/4/2023 7:29	0	0.448	0.0745	No	0.0606	No
4/4/2023 7:30	0	0.401	0.0994	No	0.0569	No
4/4/2023 7:31	0	0.065	0.1022	No	0.0562	No
4/4/2023 7:32	0	0.044	0.1036	No	0.0554	No
4/4/2023 7:33	0	0.038	0.1047	No	0.0554	No
4/4/2023 7:34	0	0.111	0.1105	No	0.0545	No
4/4/2023 7:35	0	0.061	0.1128	No	0.0545	No
4/4/2023 7:36	0	0.063	0.1141	No	0.0503	No
4/4/2023 7:37	0.049	0.039	0.1128	No	0.0413	No
4/4/2023 7:38	0.008	0.029	0.1127	No	0.0418	No
4/4/2023 7:39	0.041	0.019	0.112	No	0.0074	No
4/4/2023 7:40	0.266	0.019	0.1113	No	0.0249	No
4/4/2023 7:41	0.014	0.019	0.1108	No	0.0252	No
4/4/2023 7:42	0.015	0.022	0.1099	No	0.0262	No
4/4/2023 7:43	0	0.022	0.0933	No	0.0262	No
4/4/2023 7:44	0.014	0.021	0.0649	No	0.0271	No
4/4/2023 7:45	0	0.02	0.0395	No	0.0271	No
4/4/2023 7:46	0.143	0.018	0.0363	No	0.0367	No
4/4/2023 7:47	0.052	0.018	0.0346	No	0.0401	No
4/4/2023 7:48	0.022	0.022	0.0335	No	0.0416	No
4/4/2023 7:49	0.07	0.019	0.0274	No	0.0463	No
4/4/2023 7:50	0.104	0.02	0.0247	No	0.0532	No
4/4/2023 7:51	0.025	0.023	0.022	No	0.0549	No
4/4/2023 7:52	0	0.019	0.0207	No	0.0516	No
4/4/2023 7:53	0.086	0.019	0.02	No	0.0568	No
4/4/2023 7:54	0.172	0.022	0.0202	No	0.0655	No
4/4/2023 7:55	0.011	0.021	0.0203	No	0.0485	No
4/4/2023 7:56	0.013	0.037	0.0215	No	0.0485	No
4/4/2023 7:57	0.001	0.025	0.0217	No	0.0475	No
4/4/2023 7:58	0.002	-0.059	0.0163	No	0.0477	No
4/4/2023 7:59	0.027	-0.073	0.0101	No	0.0485	No
4/4/2023 8:00	0.077	-0.081	0.0033	No	0.0537	No
4/4/2023 8:01	0.046	-0.08	-0.0032	No	0.0472	No
4/4/2023 8:02	0.034	-0.086	-0.0101	No	0.046	No
4/4/2023 8:03	0.011	-0.087	-0.0174	No	0.0453	No
4/4/2023 8:04	0.033	-0.082	-0.0241	No	0.0428	No
4/4/2023 8:05	0.026	-0.089	-0.0314	No	0.0376	No

Downwind Station

Time	Instantaneous VOC (ppm)	Instantaneous Mass Conc. Total (mg/m ³)	Mass Conc. Total mg/m ³ AVG 15m (mg/m ³)	Dust Exceedance	VOC ppm AVG 15m (ppm)	VOC Exceedance
4/4/2023 8:06	0.004	-0.084	-0.0385	No	0.0362	No
4/4/2023 8:07	0.018			No	0.0374	No
4/4/2023 8:08	0.031			No	0.0337	No
4/4/2023 8:09	0.007	0.001	-0.049	No	0.0227	No
4/4/2023 8:10	0.008	0.001	-0.0505	No	0.0225	No
4/4/2023 8:11	0.011	0.001	-0.0533	No	0.0224	No
4/4/2023 8:12	0.038	0.001	-0.0552	No	0.0249	No
4/4/2023 8:13	0.043	0.001	-0.0505	No	0.0276	No
4/4/2023 8:14	0.03	0.001	-0.0448	No	0.0278	No
4/4/2023 8:15	0.047	0.001	-0.0385	No	0.0258	No
4/4/2023 8:16	0.064	0.001	-0.0323	No	0.027	No
4/4/2023 8:17	0.065	0.001	-0.0256	No	0.0291	No
4/4/2023 8:18	0.11	0.001	-0.0188	No	0.0357	No
4/4/2023 8:19	0.148	0.001	-0.0125	No	0.0433	No
4/4/2023 8:20	0.117	0.001	-0.0055	No	0.0494	No
4/4/2023 8:21	0.049	0.001	0.001	No	0.0524	No
4/4/2023 8:22	0.069	0.001	0.001	No	0.0558	No
4/4/2023 8:23	0.092	0.001	0.001	No	0.0599	No
4/4/2023 8:24	0.095	0.001	0.001	No	0.0657	No
4/4/2023 8:25	0.05	0.001	0.001	No	0.0685	No
4/4/2023 8:26	0.185	0.001	0.001	No	0.0801	No
4/4/2023 8:27	0.074	0.001	0.001	No	0.0825	No
4/4/2023 8:28	0.079	0.001	0.001	No	0.0849	No
4/4/2023 8:29	0.108	0.001	0.001	No	0.0901	No
4/4/2023 8:30	0.139	0.001	0.001	No	0.0963	No
4/4/2023 8:31	0.068	0.001	0.001	No	0.0965	No
4/4/2023 8:32	0.103	0.001	0.001	No	0.0991	No
4/4/2023 8:33	0.169	0.001	0.001	No	0.103	No
4/4/2023 8:34	0.143	0.001	0.001	No	0.1027	No
4/4/2023 8:35	0.137	0.001	0.001	No	0.104	No
4/4/2023 8:36	0.101	0.001	0.001	No	0.1075	No
4/4/2023 8:37	0.115	0.001	0.001	No	0.1105	No
4/4/2023 8:38	0.127	0.001	0.001	No	0.1129	No
4/4/2023 8:39	0.134	0.001	0.001	No	0.1155	No
4/4/2023 8:40	0.122	0.001	0.001	No	0.1203	No
4/4/2023 8:41	0.091	0.001	0.001	No	0.114	No
4/4/2023 8:42	0.144	0.001	0.001	No	0.1187	No
4/4/2023 8:43	0.156	0.001	0.001	No	0.1238	No
4/4/2023 8:44	0.137	0.001	0.001	No	0.1257	No
4/4/2023 8:45	0.141	0.001	0.001	No	0.1259	No
4/4/2023 8:46	0.16	0.001	0.001	No	0.132	No
4/4/2023 8:47	0.136	0.001	0.001	No	0.1342	No
4/4/2023 8:48	0.111	0.001	0.001	No	0.1303	No
4/4/2023 8:49	0.107	0.001	0.001	No	0.1279	No
4/4/2023 8:50	0.096	0.001	0.001	No	0.1252	No
4/4/2023 8:51	0.089	0.001	0.001	No	0.1244	No
4/4/2023 8:52	0.121	0.001	0.001	No	0.1248	No
4/4/2023 8:53	0.129	0.001	0.001	No	0.1249	No
4/4/2023 8:54	0.111	0.001	0.001	No	0.1234	No
4/4/2023 8:55	0.091	0.001	0.001	No	0.1213	No
4/4/2023 8:56	0.132	0.001	0.001	No	0.1241	No
4/4/2023 8:57	0.105	0.001	0.001	No	0.1215	No
4/4/2023 8:58	0.123	0.001	0.001	No	0.1193	No
4/4/2023 8:59	0.125	0.001	0.001	No	0.1185	No
4/4/2023 9:00	0.141	0.001	0.001	No	0.1185	No

Downwind Station

Time	Instantaneous VOC (ppm)	Instantaneous Mass Conc. Total (mg/m ³)	Mass Conc. Total mg/m ³ AVG 15m (mg/m ³)	Dust Exceedance	VOC ppm AVG 15m (ppm)	VOC Exceedance
4/4/2023 9:01	0.146	0.001	0.001	No	0.1175	No
4/4/2023 9:02	0.164	0.001	0.001	No	0.1194	No
4/4/2023 9:03	0.112	0.001	0.001	No	0.1195	No
4/4/2023 9:04	0.121	0.001	0.001	No	0.1204	No
4/4/2023 9:05	0.146	0.001	0.001	No	0.1237	No
4/4/2023 9:06	0.157	0.001	0.001	No	0.1283	No
4/4/2023 9:07	0.162	0.001	0.001	No	0.131	No
4/4/2023 9:08	0.159	0.001	0.001	No	0.133	No
4/4/2023 9:09	0.151	0.001	0.001	No	0.1357	No
4/4/2023 9:10	0.156	0.001	0.001	No	0.14	No
4/4/2023 9:11	0.122	0.001	0.001	No	0.1393	No
4/4/2023 9:12	0.146	0.001	0.001	No	0.1421	No
4/4/2023 9:13	0.119	0.001	0.001	No	0.1418	No
4/4/2023 9:14	0.149	0.001	0.001	No	0.1434	No
4/4/2023 9:15	0.119	0.001	0.001	No	0.1419	No
4/4/2023 9:16	0.12	0.001	0.001	No	0.1402	No
4/4/2023 9:17	0.169	0.001	0.001	No	0.1405	No
4/4/2023 9:18	0.258	0.001	0.001	No	0.1503	No
4/4/2023 9:19	0.135	0.001	0.001	No	0.1512	No
4/4/2023 9:20	0.12	0.001	0.001	No	0.1495	No
4/4/2023 9:21	0.104	0.001	0.001	No	0.1459	No
4/4/2023 9:22	0.119			No	0.1431	No
4/4/2023 9:23	0.1			No	0.1391	No
4/4/2023 9:24		0.052	0.0049	No	0.142	No
4/4/2023 9:25		-0.009	0.0042	No	0.1333	No
4/4/2023 9:26	0	-0.045	0.0006	No	0.1319	No
4/4/2023 9:27	0			No	0.1321	No
4/4/2023 9:28	0	0.004	0.0008	No	0.1356	No
4/4/2023 9:29	0.015	0.006	0.0012	No	0.1353	No
4/4/2023 9:30	0.045	0.003	0.0014	No	0.1335	No
4/4/2023 9:31	0.007	0.004	0.0017	No	0.1357	No
4/4/2023 9:32	0.011	0.01	0.0024	No	0.1412	No
4/4/2023 9:33	0.133	0.003	0.0026	No	0.1442	No
4/4/2023 9:34	0.022	0.006	0.003	No	0.1467	No
4/4/2023 9:35	0.029	0.006	0.0034	No	0.1478	No
4/4/2023 9:36	0.016	0.026	0.0055	No	0.1495	No
4/4/2023 9:37	0.032	0.036	0.0078	No	0.1485	No
4/4/2023 9:38	0.031	0.033	0.0096	No	0.1538	No
4/4/2023 9:39	0.033	0.013	0.0069	No	0.1581	No
4/4/2023 9:40	0.029	0.011	0.0083	No	0.1615	No
4/4/2023 9:41	0.008	0.015	0.0126	No	0.1635	No
4/4/2023 9:42	0.038	0.02	0.0131	No	0.1712	No
4/4/2023 9:43	0.042	0.02	0.0141	No	0.1707	No
4/4/2023 9:44	0.058	0.02	0.0151	No	0.1735	No
4/4/2023 9:45	0.035	0.02	0.0162	No	0.2057	No
4/4/2023 9:46	0.021	0.02	0.0173	No	0.2167	No
4/4/2023 9:47	0.041	0.02	0.0179	No	0.2184	No
4/4/2023 9:48	0.009	0.02	0.0191	No	0.2169	No
4/4/2023 9:49	0.015	0.02	0.02	No	0.2209	No
4/4/2023 9:50	0.05	0.02	0.0209	No	0.2207	No
4/4/2023 9:51	0.16	0.02	0.0205	No	0.2197	No
4/4/2023 9:52	0.07	0.02	0.0195	No	0.2241	No
4/4/2023 9:53	0.037	0.02	0.0186	No	0.2265	No
4/4/2023 9:54	0.065	0.02	0.0191	No	0.2279	No
4/4/2023 9:55	0.03	0.02	0.0197	No	0.2337	No

Downwind Station						
Time	Instaneous VOC (ppm)	Instaneous Mass Conc. Total (mg/m ³)	Mass Conc. Total mg/m ³ AVG 15m (mg/m ³)	Dust Exceedance	VOC ppm AVG 15m (ppm)	VOC Exceedance
4/4/2023 9:56	0.033	0.02	0.02	No	0.2358	No
4/4/2023 9:57	0.05	0.02	0.02	No	0.2323	No
4/4/2023 9:58	0.032	0.02	0.02	No	0.2307	No
4/4/2023 9:59	0.012	0.02	0.02	No	0.2315	No
4/4/2023 10:00	0.02	0.02	0.02	No	0.1983	No
4/4/2023 10:01	0.022	0.02	0.02	No	0.1943	No
4/4/2023 10:02	0.017	0.02	0.02	No	0.1911	No
4/4/2023 10:03	0.015	0.02	0.02	No	0.1909	No
4/4/2023 10:04	0.014	0.02	0.02	No	0.1915	No
4/4/2023 10:05	0.051	0.02	0.02	No	0.1873	No
4/4/2023 10:06	0.019	0.02	0.02	No	0.1821	No
4/4/2023 10:07	0.038	0.02	0.02	No	0.1849	No
4/4/2023 10:08	0.062	0.02	0.02	No	0.1775	No
4/4/2023 10:09	0.064	0.02	0.02	No	0.176	No
4/4/2023 10:10	0.029	0.02	0.02	No	0.1765	No
4/4/2023 10:11	0.053	0.02	0.02	No	0.1785	No
4/4/2023 10:12	0.066	0.02	0.02	No	0.1833	No
4/4/2023 10:13	0.061	0.02	0.02	No	0.1839	No
4/4/2023 10:14	0.098	0.02	0.02	No	0.1839	No
4/4/2023 10:15	0.05	0.02	0.02	No	0.1883	No
4/4/2023 10:16	0.026	0.02	0.02	No	0.1858	No
4/4/2023 10:17	0.043	0.02	0.02	No	0.1826	No
4/4/2023 10:18	0.032	0.02	0.02	No	0.1849	No
4/4/2023 10:19	0.03	0.02	0.02	No	0.1791	No
4/4/2023 10:20	0.034	0.02	0.02	No	0.1817	No
4/4/2023 10:21	0.096	0.02	0.02	No	0.1884	No
4/4/2023 10:22	0.034	0.02	0.02	No	0.1829	No
4/4/2023 10:23	0.035	0.02	0.02	No	0.1853	No
4/4/2023 10:24	0.095	0.02	0.02	No	0.1841	No
4/4/2023 10:25	0.03	0.02	0.02	No	0.1783	No
4/4/2023 10:26	0.043	0.02	0.02	No	0.1771	No
4/4/2023 10:27	0.02	0.02	0.02	No	0.1709	No
4/4/2023 10:28	0.013	0.02	0.02	No	0.1715	No
4/4/2023 10:29	0.014	0.02	0.02	No	0.1702	No
4/4/2023 10:30	0.017	0.02	0.02	No	0.1711	No
4/4/2023 10:31	0.039	0.02	0.02	No	0.1702	No
4/4/2023 10:32	0.064	0.02	0.02	No	0.1749	No
4/4/2023 10:33	0.016	0.02	0.02	No	0.1782	No
4/4/2023 10:34	0.028	0.02	0.02	No	0.1828	No
4/4/2023 10:35	0.212	0.02	0.02	No	0.1849	No
4/4/2023 10:36	0.079	0.02	0.02	No	0.2399	No
4/4/2023 10:37	0.054	0.02	0.02	No	0.2508	No
4/4/2023 10:38	0.022	0.02	0.02	No	0.2539	No
4/4/2023 10:39	0.054	0.02	0.02	No	0.2673	No
4/4/2023 10:40	0.016	0.02	0.02	No	0.2666	No
4/4/2023 10:41	0.013	0.02	0.02	No	0.2742	No
4/4/2023 10:42	0.033	0.02	0.02	No	0.2803	No
4/4/2023 10:43	0.028	0.02	0.02	No	0.3046	No
4/4/2023 10:44	0.03	0.02	0.02	No	0.3085	No
4/4/2023 10:45	0.082	0.02	0.02	No	0.3194	No
4/4/2023 10:46	0.108	0.02	0.02	No	0.3406	No
4/4/2023 10:47	0.111	0.02	0.02	No	0.3496	No
4/4/2023 10:48	0.057	0.02	0.02	No	0.3664	No
4/4/2023 10:49	0.149	0.02	0.02	No	0.3705	No
4/4/2023 10:50	0.032	0.02	0.02	No	0.4175	No

Downwind Station

Time	Instantaneous VOC (ppm)	Instantaneous Mass Conc. Total (mg/m ³)	Mass Conc. Total mg/m ³ AVG 15m (mg/m ³)	Dust Exceedance	VOC ppm AVG 15m (ppm)	VOC Exceedance
4/4/2023 10:51	0.079	0.02	0.02	No	0.4503	No
4/4/2023 10:52	0.036	0.02	0.02	No	0.4498	No
4/4/2023 10:53	0.063	0.02	0.02	No	0.4521	No
4/4/2023 10:54	0.022	0.02	0.02	No	0.4954	No
4/4/2023 10:55	0.015	0.02	0.02	No	0.5123	No
4/4/2023 10:56	0.03	0.02	0.02	No	0.5179	No
4/4/2023 10:57	0.068	0.02	0.02	No	0.5192	No
4/4/2023 10:58	0.077	0.02	0.02	No	0.4999	No
4/4/2023 10:59	0.076	0.02	0.02	No	0.5516	No
4/4/2023 11:00	0.075	0.02	0.02	No	0.551	No
4/4/2023 11:01	0.083	0.02	0.02	No	0.5304	No
4/4/2023 11:02	0.041	0.02	0.02	No	0.6099	No
4/4/2023 11:03	0.09	0.02	0.02	No	0.6179	No
4/4/2023 11:04	0.08	0.02	0.02	No	0.6165	No
4/4/2023 11:05	0.044	0.02	0.02	No	0.5728	No
4/4/2023 11:06	0.061	0.02	0.02	No	0.4869	No
4/4/2023 11:07	0.057	0.02	0.02	No	0.4779	No
4/4/2023 11:08	0.066	0.02	0.02	No	0.4756	No
4/4/2023 11:09	0.101	0.02	0.02	No	0.432	No
4/4/2023 11:10	0.046	0.02	0.02	No	0.4197	No
4/4/2023 11:11	0.056	0.02	0.02	No	0.4057	No
4/4/2023 11:12	0.075	0.02	0.02	No	0.3983	No
4/4/2023 11:13	0.057	0.02	0.02	No	0.3976	No
4/4/2023 11:14	0.065	0.02	0.02	No	0.3469	No
4/4/2023 11:15	0.065	0.02	0.02	No	0.3383	No
4/4/2023 11:16	0.044	0.02	0.02	No	0.3512	No
4/4/2023 11:17	0.06	0.02	0.02	No	0.2686	No
4/4/2023 11:18	0.109	0.02	0.02	No	0.2418	No
4/4/2023 11:19	0.048	0.02	0.02	No	0.2393	No
4/4/2023 11:20	0.082	0.02	0.02	No	0.2335	No
4/4/2023 11:21	0.041	0.02	0.02	No	0.2299	No
4/4/2023 11:22	0.029	0.02	0.02	No	0.2299	No
4/4/2023 11:23	0.058	0.02	0.02	No	0.2304	No
4/4/2023 11:24	0.09	0.02	0.02	No	0.2367	No
4/4/2023 11:25	0.07	0.02	0.02	No	0.235	No
4/4/2023 11:26	0.064	0.02	0.02	No	0.2385	No
4/4/2023 11:27	0.086	0.02	0.02	No	0.2416	No
4/4/2023 11:28	0.059	0.02	0.02	No	0.2459	No
4/4/2023 11:29	0.064	0.02	0.02	No	0.2431	No
4/4/2023 11:30	0.058	0.02	0.02	No	0.2421	No
4/4/2023 11:31	0.037	0.02	0.02	No	0.234	No
4/4/2023 11:32	0.074	0.02	0.02	No	0.2279	No
4/4/2023 11:33	0.075	0.02	0.02	No	0.2271	No
4/4/2023 11:34	0.089	0.02	0.02	No	0.2259	No
4/4/2023 11:35	0.067	0.02	0.02	No	0.2313	No
4/4/2023 11:36	0.058	0.02	0.02	No	0.2343	No
4/4/2023 11:37	0.074	0.02	0.02	No	0.2393	No
4/4/2023 11:38	0.05	0.02	0.02	No	0.2359	No
4/4/2023 11:39	0.089	0.02	0.02	No	0.2195	No
4/4/2023 11:40	0.107	0.02	0.02	No	0.2168	No
4/4/2023 11:41	0.042	0.02	0.02	No	0.2101	No
4/4/2023 11:42	0.042	0.02	0.02	No	0.2097	No
4/4/2023 11:43	0.051	0.02	0.02	No	0.2269	No
4/4/2023 11:44	0.056	0.02	0.02	No	0.2281	No
4/4/2023 11:45	0.039	0.02	0.02	No	0.2382	No

Downwind Station

Time	Instaneous VOC (ppm)	Instaneous Mass Conc. Total (mg/m ³)	Mass Conc. Total mg/m ³ AVG 15m (mg/m ³)	Dust Exceedance	VOC ppm AVG 15m (ppm)	VOC Exceedance
4/4/2023 11:46	0.035	0.02	0.02	No	0.2371	No
4/4/2023 11:47	0.051	0.02	0.02	No	0.2385	No
4/4/2023 11:48	0.051	0.02	0.02	No	0.2447	No
4/4/2023 11:49	0.047	0.02	0.02	No	0.2551	No
4/4/2023 11:50	0.04	0.02	0.02	No	0.2553	No
4/4/2023 11:51	0.124	0.02	0.02	No	0.2553	No
4/4/2023 11:52	0.13	0.02	0.02	No	0.2728	No
4/4/2023 11:53	0.079	0.02	0.02	No	0.2737	No
4/4/2023 11:54	0.16	0.02	0.02	No	0.2732	No
4/4/2023 11:55	0.152	0.02	0.02	No	0.2746	No
4/4/2023 11:56	0.079	0.02	0.02	No	0.2772	No
4/4/2023 11:57	0.065	0.02	0.02	No	0.2773	No
4/4/2023 11:58	0.039	0.02	0.02	No	0.2513	No
4/4/2023 11:59	0.125	0.02	0.02	No	0.2501	No
4/4/2023 12:00	0.086	0.02	0.02	No	0.2347	No
4/4/2023 12:01	0.102	0.02	0.02	No	0.2266	No
4/4/2023 12:02	0.018	0.02	0.02	No	0.2247	No
4/4/2023 12:03	0.1	0.02	0.02	No	0.2207	No
4/4/2023 12:04	0.059	0.02	0.02	No	0.2153	No
4/4/2023 12:05	0.075	0.02	0.02	No	0.2143	No
4/4/2023 12:06	0.057	0.02	0.02	No	0.2119	No
4/4/2023 12:07	0.174	0.02	0.02	No	0.1868	No
4/4/2023 12:08	0.584	0.02	0.02	No	0.1847	No
4/4/2023 12:09	0.578	0.02	0.02	No	0.1848	No
4/4/2023 12:10	0.107	0.02	0.02	No	0.1793	No
4/4/2023 12:11	0.093	0.02	0.02	No	0.178	No
4/4/2023 12:12	0.087	0.02	0.02	No	0.1735	No
4/4/2023 12:13	0.269	0.02	0.02	No	0.1714	No
4/4/2023 12:14	0.412	0.02	0.02	No	0.169	No
4/4/2023 12:15	0.301	0.02	0.02	No	0.1695	No
4/4/2023 12:16	0.164	0.02	0.02	No	0.171	No
4/4/2023 12:17	0.113	0.02	0.02	No	0.1696	No
4/4/2023 12:18	0.277	0.02	0.02	No	0.1645	No
4/4/2023 12:19	0.19	0.02	0.02	No	0.1552	No
4/4/2023 12:20	0.253	0.02	0.02	No	0.1483	No
4/4/2023 12:21	0.183	0.02	0.02	No	0.1479	No
4/4/2023 12:22	0.147	0.02	0.02	No	0.1462	No
4/4/2023 12:23	0.126	0.02	0.02	No	0.1439	No
4/4/2023 12:24	0.114	0.02	0.02	No	0.139	No
4/4/2023 12:25	0.099	0.02	0.02	No	0.1426	No
4/4/2023 12:26	0.115	0.02	0.02	No	0.1448	No
4/4/2023 12:27	0.128	0.02	0.02	No	0.1459	No
4/4/2023 12:28	0.109	0.02	0.02	No	0.1475	No
4/4/2023 12:29	0.135	0.02	0.02	No	0.1449	No
4/4/2023 12:30	0.131	0.02	0.02	No	0.1421	No
4/4/2023 12:31	0.129	0.02	0.02	No	0.1389	No
4/4/2023 12:32	0.104	0.02	0.02	No	0.1372	No
4/4/2023 12:33	0.141	0.02	0.02	No	0.1407	No
4/4/2023 12:34	0.089	0.02	0.02	No	0.1441	No
4/4/2023 12:35	0.155	0.02	0.02	No	0.1495	No
4/4/2023 12:36	0.146	0.02	0.02	No	0.1479	No
4/4/2023 12:37	0.102	0.02	0.02	No	0.1501	No
4/4/2023 12:38	0.1	0.02	0.02	No	0.152	No
4/4/2023 12:39	0.107	0.02	0.02	No	0.1521	No
4/4/2023 12:40	0.131	0.02	0.02	No	0.1558	No

Downwind Station						
Time	Instaneous VOC (ppm)	Instaneous Mass Conc. Total (mg/m ³)	Mass Conc. Total mg/m ³ AVG 15m (mg/m ³)	Dust Exceedance	VOC ppm AVG 15m (ppm)	VOC Exceedance
4/4/2023 12:41	0.125	0.02	0.02	No	0.1594	No
4/4/2023 12:42	0.107	0.02	0.02	No	0.1603	No
4/4/2023 12:43	0.088	0.02	0.02	No	0.1617	No
4/4/2023 12:44	0.096	0.02	0.02	No	0.1637	No
4/4/2023 12:45	0.089	0.02	0.02	No	0.1701	No
4/4/2023 12:46	0.163	0.02	0.02	No	0.1679	No
4/4/2023 12:47	0.123	0.02	0.02	No	0.1753	No
4/4/2023 12:48	0.092	0.02	0.02	No	0.1742	No
4/4/2023 12:49	0.088	0.02	0.02	No	0.1752	No
4/4/2023 12:50	0.108	0.02	0.02	No	0.1743	No
4/4/2023 12:51	0.08	0.02	0.02	No	0.1739	No
4/4/2023 12:52	0.073	0.02	0.02	No	0.1746	No
4/4/2023 12:53	0.089	0.02	0.02	No	0.1792	No
4/4/2023 12:54	0.081	0.02	0.02	No	0.191	No
4/4/2023 12:55	0.075	0.02	0.02	No	0.1891	No
4/4/2023 12:56	0.093	0.02	0.02	No	0.1886	No
4/4/2023 12:57	0.513	0.02	0.02	No	0.1889	No
4/4/2023 12:58	0.171	0.02	0.02	No	0.1928	No
4/4/2023 12:59	0.496	0.02	0.02	No	0.1961	No
4/4/2023 13:00	0.31	0.02	0.02	No	0.1942	No
4/4/2023 13:01	0.207	0.02	0.02	No	0.2023	No
4/4/2023 13:02	0.191	0.02	0.02	No	0.2054	No
4/4/2023 13:03	0.123	0.02	0.02	No	0.2133	No
4/4/2023 13:04	0.093	0.02	0.02	No	0.2183	No
4/4/2023 13:05	0.122	0.02	0.02	No	0.2172	No
4/4/2023 13:06	0.139	0.02	0.02	No	0.2215	No
4/4/2023 13:07	0.103	0.02	0.02	No	0.2225	No
4/4/2023 13:08	0.145	0.02	0.02	No	0.2228	No
4/4/2023 13:09	0.126	0.02	0.02	No	0.2246	No
4/4/2023 13:10	0.119	0.02	0.02	No	0.2285	No
4/4/2023 13:11	0.134	0.02	0.02	No	0.2331	No
4/4/2023 13:12	0.079	0.02	0.02	No	0.2391	No
4/4/2023 13:13	0.135	0.02	0.02	No	0.2424	No
4/4/2023 13:14	0.1	0.02	0.02	No	0.2408	No
4/4/2023 13:15	0.091	0.02	0.02	No	0.2405	No
4/4/2023 13:16	0.085	0.02	0.02	No	0.2402	No
4/4/2023 13:17	0.085	0.02	0.02	No	0.2331	No
4/4/2023 13:18	0.125	0.02	0.02	No	0.2272	No
4/4/2023 13:19	0.107	0.02	0.02	No	0.2232	No
4/4/2023 13:20	0.138	0.02	0.02	No	0.2238	No
4/4/2023 13:21	0.13	0.02	0.02	No	0.2234	No
4/4/2023 13:22	0.13	0.02	0.02	No	0.2292	No
4/4/2023 13:23	0.091	0.02	0.02	No	0.2289	No
4/4/2023 13:24	0.113	0.02	0.02	No	0.2219	No
4/4/2023 13:25	0.101	0.02	0.02	No	0.2208	No
4/4/2023 13:26	0.13	0.02	0.02	No	0.2122	No
4/4/2023 13:27	0.112	0.02	0.02	No	0.2121	No
4/4/2023 13:28	0.108	0.02	0.02	No	0.2226	No
4/4/2023 13:29	0.129	0.02	0.02	No	0.2258	No
4/4/2023 13:30	0.107	0.02	0.02	No	0.2299	No
4/4/2023 13:31	0.124	0.02	0.02	No	0.2268	No
4/4/2023 13:32	0.086	0.02	0.02	No	0.2269	No
4/4/2023 13:33	0.071	0.02	0.02	No	0.2279	No
4/4/2023 13:34	0.071	0.02	0.02	No	0.2363	No
4/4/2023 13:35	0.069	0.02	0.02	No	0.2417	No

Downwind Station

Time	Instantaneous VOC (ppm)	Instantaneous Mass Conc. Total (mg/m ³)	Mass Conc. Total mg/m ³ AVG 15m (mg/m ³)	Dust Exceedance	VOC ppm AVG 15m (ppm)	VOC Exceedance
4/4/2023 13:36	0.083	0.02	0.02	No	0.2415	No
4/4/2023 13:37	0.089	0.02	0.02	No	0.2384	No
4/4/2023 13:38	0.079	0.02	0.02	No	0.2469	No
4/4/2023 13:39	0.077	0.02	0.02	No	0.2491	No
4/4/2023 13:40	0.058	0.02	0.02	No	0.2483	No
4/4/2023 13:41	0.122	0.02	0.02	No	0.2527	No
4/4/2023 13:42	0.061	0.02	0.02	No	0.2499	No
4/4/2023 13:43	0.077	0.02	0.02	No	0.2368	No
4/4/2023 13:44	0.091	0.02	0.02	No	0.2435	No
4/4/2023 13:45	0.103	0.02	0.02	No	0.2423	No
4/4/2023 13:46	0.113	0.02	0.02	No	0.2437	No
4/4/2023 13:47	0.11	0.02	0.02	No	0.2431	No
4/4/2023 13:48	0.086	0.02	0.02	No	0.26	No
4/4/2023 13:49	0.109	0.02	0.02	No	0.2515	No
4/4/2023 13:50	0.096	0.02	0.02	No	0.2528	No
4/4/2023 13:51	0.085	0.02	0.02	No	0.2643	No
4/4/2023 13:52	0.095	0.02	0.02	No	0.2659	No
4/4/2023 13:53	0.144	0.02	0.02	No	0.255	No
4/4/2023 13:54	0.165	0.02	0.02	No	0.2532	No
4/4/2023 13:55	0.15	0.02	0.02	No	0.2555	No
4/4/2023 13:56	0.068	0.02	0.02	No	0.256	No
4/4/2023 13:57	0.121	0.02	0.02	No	0.2537	No
4/4/2023 13:58	0.318	0.02	0.02	No	0.2605	No
4/4/2023 13:59	0.166	0.02	0.02	No	0.2521	No
4/4/2023 14:00	0.119	0.02	0.02	No	0.2511	No
4/4/2023 14:01	0.073	0.02	0.02	No	0.2929	No
4/4/2023 14:02	0.051	0.02	0.02	No	0.4063	No
4/4/2023 14:03	0.09	0.02	0.02	No	0.4035	No
4/4/2023 14:04	0.139	0.02	0.02	No	0.4245	No
4/4/2023 14:05	0.082	0.02	0.02	No	0.4211	No
4/4/2023 14:06	0.059	0.02	0.02	No	0.4128	No
4/4/2023 14:07	0.155	0.02	0.02	No	0.4137	No
4/4/2023 14:08	0.051	0.02	0.02	No	0.4208	No
4/4/2023 14:09	0.043	0.02	0.02	No	0.4184	No
4/4/2023 14:10	0.049	0.02	0.02	No	0.4147	No
4/4/2023 14:11	0.208	0.02	0.02	No	0.4219	No
4/4/2023 14:12	0.152	0.02	0.02	No	0.4283	No
4/4/2023 14:13	0.112	0.02	0.02	No	0.4196	No
4/4/2023 14:14	0.075	0.02	0.02	No	0.4192	No
4/4/2023 14:15	0.084	0.02	0.02	No	0.4197	No
4/4/2023 14:16	0.063	0.02	0.02	No	0.3758	No
4/4/2023 14:17	0.075	0.02	0.02	No	0.2654	No
4/4/2023 14:18	0.037	0.02	0.02	No	0.2499	No
4/4/2023 14:19	0.044	0.02	0.02	No	0.2337	No
4/4/2023 14:20	0.093	0.02	0.02	No	0.2308	No
4/4/2023 14:21	0.112	0.02	0.02	No	0.2262	No
4/4/2023 14:22	0.096	0.02	0.02	No	0.2233	No
4/4/2023 14:23	0.089	0.02	0.02	No	0.2159	No
4/4/2023 14:24	0.075	0.02	0.02	No	0.2158	No
4/4/2023 14:25	0.091	0.02	0.02	No	0.2314	No
4/4/2023 14:26	0.096	0.02	0.02	No	0.2689	No
4/4/2023 14:27	0.067	0.02	0.02	No	0.277	No
4/4/2023 14:28	0.056	0.02	0.02	No	0.2765	No
4/4/2023 14:29	0.066	0.02	0.02	No	0.2731	No
4/4/2023 14:30	0.045	0.02	0.02	No	0.2742	No

Downwind Station

Time	Instantaneous VOC (ppm)	Instantaneous Mass Conc. Total (mg/m ³)	Mass Conc. Total mg/m ³ AVG 15m (mg/m ³)	Dust Exceedance	VOC ppm AVG 15m (ppm)	VOC Exceedance
4/4/2023 14:31	0.083	0.02	0.02	No	0.2723	No
4/4/2023 14:32	0.076	0.02	0.02	No	0.2713	No
4/4/2023 14:33	0.065	0.02	0.02	No	0.2683	No
4/4/2023 14:34	0.027	0.02	0.02	No	0.2628	No
4/4/2023 14:35	0.019	0.02	0.02	No	0.2632	No
4/4/2023 14:36	0.024	0.02	0.02	No	0.2611	No
4/4/2023 14:37	0.101	0.02	0.02	No	0.2583	No
4/4/2023 14:38	0.099	0.02	0.02	No	0.2562	No
4/4/2023 14:39	0.083	0.02	0.02	No	0.2544	No
4/4/2023 14:40	0.034	0.02	0.02	No	0.2345	No
4/4/2023 14:41	0.07	0.02	0.02	No	0.1841	No
4/4/2023 14:42	0.074	0.02	0.02	No	0.1659	No
4/4/2023 14:43	0.082	0.02	0.02	No	0.1615	No
4/4/2023 14:44	0.04	0.02	0.02	No	0.1641	No
4/4/2023 14:45	0.038	0.02	0.02	No	0.1596	No
4/4/2023 14:46	0.036	0.02	0.02	No	0.1675	No
4/4/2023 14:47	0.081	0.02	0.02	No	0.1661	No
4/4/2023 14:48	0.058	0.02	0.02	No	0.1643	No
4/4/2023 14:49	0.095	0.02	0.02	No	0.1599	No
4/4/2023 14:50	0.057	0.02	0.02	No	0.1732	No
4/4/2023 14:51	0.042	0.02	0.02	No	0.2053	No
4/4/2023 14:52	0.028	0.02	0.02	No	0.2089	No
4/4/2023 14:53	0.05	0.02	0.02	No	0.2201	No
4/4/2023 14:54	0.033	0.02	0.02	No	0.2194	No
4/4/2023 14:55	0.03	0.02	0.02	No	0.2209	No
4/4/2023 14:56	0.027	0.02	0.02	No	0.2208	No
4/4/2023 14:57	0.012	0.02	0.02	No	0.2202	No
4/4/2023 14:58	0.038	0.02	0.02	No	0.2193	No
4/4/2023 14:59	0.004	0.02	0.02	No	0.2221	No
4/4/2023 15:00	0.046	0.02	0.02	No	0.2238	No
4/4/2023 15:01	0.009	0.02	0.02	No	0.2255	No
4/4/2023 15:02	0.002	0.02	0.02	No	0.2272	No
4/4/2023 15:03	0.108	0.02	0.02	No	0.2289	No
4/4/2023 15:04	0.032	0.02	0.02	No	0.2306	No
4/4/2023 15:05	0.042	0.02	0.02	No	0.2323	No
4/4/2023 15:06	0.01	0.02	0.02	No	0.234	No
4/4/2023 15:07	0.035	0.02	0.02	No	0.2357	No
4/4/2023 15:08	0.023	0.02	0.02	No	0.2374	No
4/4/2023 15:09	0.017	0.02	0.02	No	0.2391	No
4/4/2023 15:10	0	0.02	0.02	No	0.2408	No
4/4/2023 15:11	0	0.02	0.02	No	0.2425	No
4/4/2023 15:12	0	0.02	0.02	No	0.2442	No
4/4/2023 15:13	0.01	0.02	0.02	No	0.2459	No
4/4/2023 15:14	0	0.02	0.02	No	0.2476	No
4/4/2023 15:15	0	0.02	0.02	No	0.2493	No
4/4/2023 15:16	0.001	0.02	0.02	No	0.251	No