



Daily Activity Report

Seton Brilla Charter School
1956 Jerome Avenue, Bronx, NY
BCP No. C203152

General Site Information

Date:	Thursday, June 22, 2023
Weather:	Rainy 60-68°
Wind Direction/Speed:	N @ 5 mph
AKRF Personnel on Site:	Lucas Belangia
AKRF Equipment on Site:	Mini RAE 3000 Photoionization Detector [(PID) x1], Roving SidePak Particulate Monitor (1), 2 Fixed Air Monitoring Stations [DustTrak Aerosol Monitors (x2) & MiniRAE 3000 PIDs (x2)].
Visitors:	None

Contractor Information

Contracting Company	Main Personnel	Equipment
Casino Construction	Carlos	Excavator and a mini-excavator

Description and Location of Work Activities Performed

- 1) Formwork and rebar work in grid WC-04 and WC-03.
- 2) Minor excavation in grids WC-01 and WC-02.
- 3) Five truckloads of soil from grid WC-01 (5-10) were sent for off-site disposal at the Clean Earth of South Philadelphia in Morrisville, Pennsylvania.

Destination Facility	Daily Trucks	Total Trucks	Daily Approx. Cubic Yds	Total Approx. Cubic Yds	Total Site Loads	Total Approximate Cubic Yards
Clean Earth Carteret	0	108	0	2,160	217	4,340
Clean Earth Southeastern Pennsylvania	5	78	100	1,560		
Clean Earth Bethlehem	0	31	0	620		
Concrete Disposal	0	27	0	540		
N/A	0	0	0	0		

CAMP Air Monitoring Results

CAMP Station	UPWIND			DOWNWIND		
Odors:	None	Number of Exceedances	Time of Exceedance(s)	None	Number of Exceedances	Time of Exceedance(s)
VOC Action Level Exceedance(s):	None			None		
Particulate Action Level Exceedance(s):	None			None		
Maximum VOC Level (15 min ppm):	N/A			N/A		
Maximum Particulate Level (15 min mg/m ³):	N/A			N/A		

Notes: CAMP monitoring was not performed throughout the day due to precipitation throughout the day. No odors related to site activities were noted throughout the day, and no visible dust was observed near the Site boundaries.

Additional Information

Planned Work Activity for Following Day/Week:	<ol style="list-style-type: none"> 1) Continued installation of rebar in WC-02, WC-03, WC-04. 2) Waterproofing over rebar structures. 3) Grading gas permeable aggregate for SSDS installation. 4.) SSDS and SVE installation.
Comments:	

Site Map

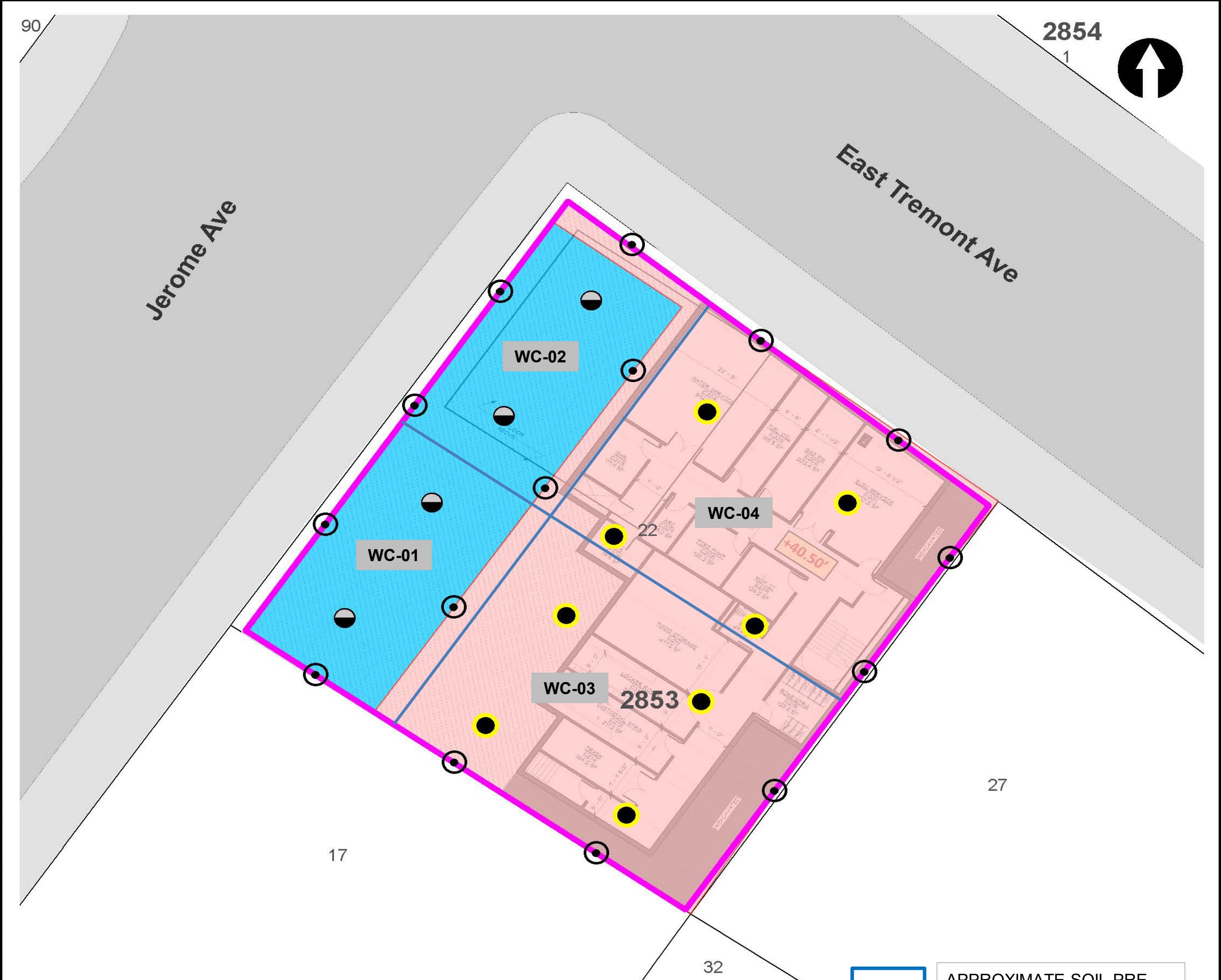

LEGEND

- PROJECT SITE BOUNDARY
- LOT BOUNDARY AND TAX LOT NUMBER
- 2853** BLOCK NUMBER
- REMEDIAL EXCAVATION TO APPROXIMATELY TWO FEET BELOW EXISTING GRADE
- REMEDIAL EXCAVATION TO GROUNDWATER (SOURCE AREA)

- CONFIRMATION DOCUMENTATION BOTTOM SAMPLE
- SOURCE AREA DOCUMENTATION BOTTOM SAMPLE
- DOCUMENTATION SIDEWALL SAMPLE

NOTE
 REMEDIAL EXCAVATION WILL INCLUDE REMOVAL OF APPROXIMATELY 1,280 TONS (850 CUBIC YARDS) OF SOURCE MATERIAL ASSOCIATED WITH NYSDEC SPILL NO. 2103719 AND APPROXIMATELY 860 TONS (570 CUBIC YARDS) OF SOIL/FILL FROM THE UPPER 2 FEET SITE-WIDE.



APPROXIMATE SOIL PRE-CHARACTERIZATION GRID

Map Source:
 NYCDOP (NYC Dept. of City Planning) GIS database

© 2021 AKRF. W:\Projects\210024 - 1956 JEROME AVENUE\Technical\GIS and Graphics\AR\RAW\210024 Figure 9 Proposed Remedial Excavation and Documentation Sample Location Plan.mxd 10/25/2021 2:03:38 PM iszalus



440 Park Avenue South, New York, NY 10016

1956 Jerome Avenue
 Bronx, New York

TRACK 4 CLEANUP AND DOCUMENTATION
SAMPLE LOCATION PLAN

DATE
04/29/2022

PROJECT NO.
210024

FIGURE
11

Site Photographs

Photograph 1 -
Export of soil from
WC-01 to Clean
Earth of Southeast
Pennsylvania in
Morrisville,
Pennsylvania. View
facing Northeast.



Photograph 2 -Minor
excavation around
piles in grid WC-01.
Facing Northwest.



Photograph 3 - Site
condition. Casino
installing rebar in WC
01. View facing
Northeast.

