



Daily Activity Report

Seton Brilla Charter School
1956 Jerome Avenue, Bronx, NY
BCP No. C203152

General Site Information

Date:	Thursday, July 6, 2023
Weather:	Sunny 74-91°
Wind Direction/Speed:	N @ 4 mph
AKRF Personnel on Site:	Lucas Belangia
AKRF Equipment on Site:	Mini RAE 3000 Photoionization Detector [(PID) x1], Roving SidePak Particulate Monitor (1), 2 Fixed Air Monitoring Stations [DustTrak Aerosol Monitors (x2) & MiniRAE 3000 PIDs (x2)].
Visitors:	None

Contractor Information

Contracting Company	Main Personnel	Equipment
Casino Construction	Carlos	Excavator and a mini-excavator

Description and Location of Work Activities Performed

- 1) Formwork, rebar installation, and minimal excavation in grid WC-02.
- 2) Trench excavation in grid WC-01 in preparation for SSDS and SVE piping installation.
- 3) AKRF personnel began development on monitoring well.

Destination Facility	Daily Trucks	Total Trucks	Daily Approx. Cubic Yds	Total Approx. Cubic Yds	Total Site Loads	Total Approximate Cubic Yards
Clean Earth Carteret	0	112	0	2,240	210	4,200
Clean Earth Southeastern Pennsylvania	0	67	0	1,340		
Clean Earth Bethlehem	0	31	0	620		
Concrete Disposal	0	27	0	540		
N/A	0	0	0	0		

CAMP Air Monitoring Results

CAMP Station	UPWIND			DOWNWIND		
Odors:	None	Number of Exceedances	Time of Exceedance(s)	None	Number of Exceedances	Time of Exceedance(s)
VOC Action Level Exceedance(s):	None			None.		
Particulate Action Level Exceedance(s):	None			None		
Maximum VOC Level (15 min ppm):	0.00			0.000		
Maximum Particulate Level (15 min mg/m ³):	0.083			0.218	1	7:59

Notes: CAMP monitoring was performed throughout the day. There was one downwind particulate exceedance at approximately 0759 due to jackhammering of concrete piles nearby to downwind station. AKRF requested that water be sprayed on piles, and levels returned to background conditions.

Additional Information

Planned Work Activity for Following Day/Week:	<ol style="list-style-type: none"> 1) Grading gas permeable aggregate for SSDS installation. 2) SSDS and SVE installation. 3) Pour concrete slab over remaining footprint.
Comments:	

Site Map

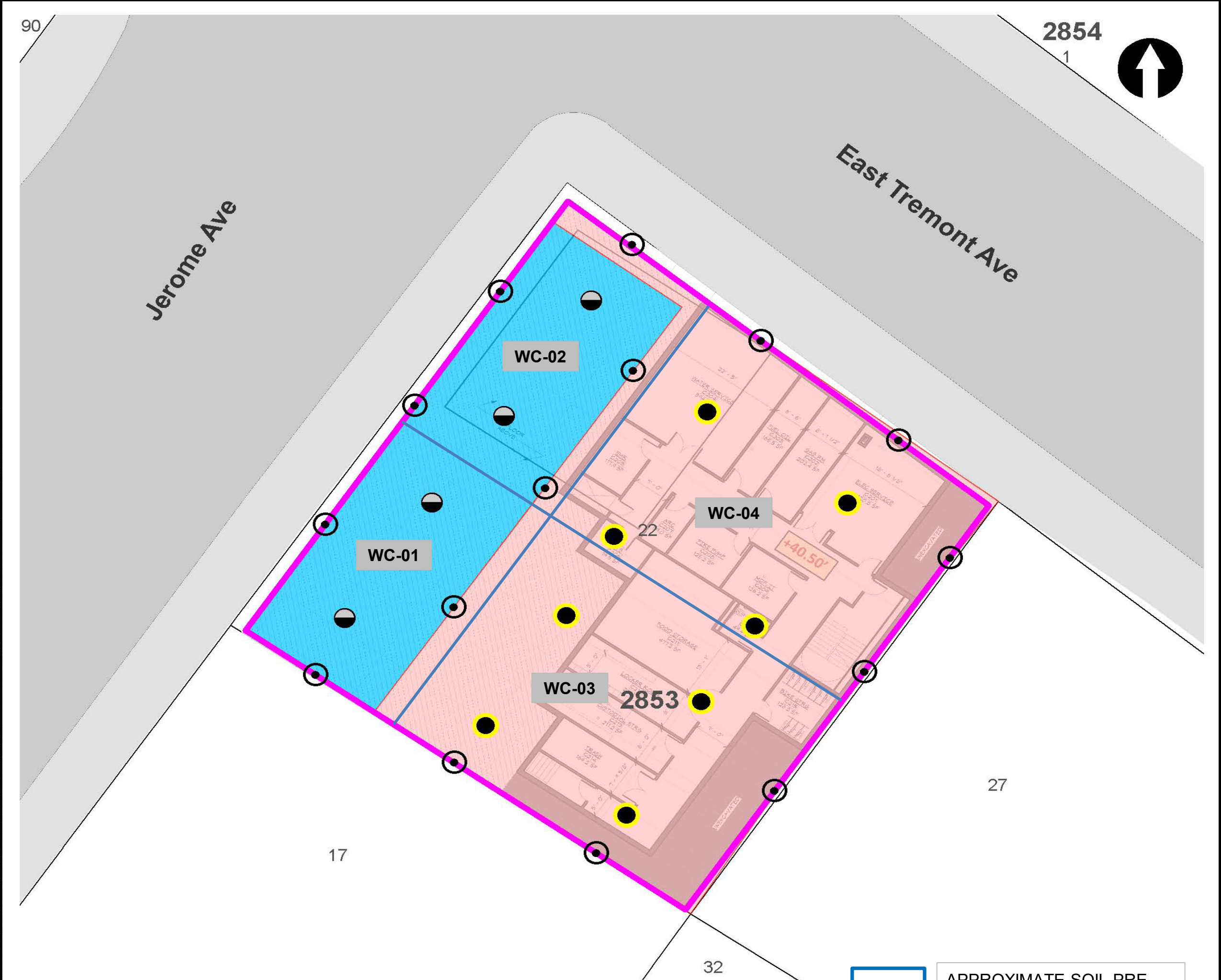

LEGEND

- PROJECT SITE BOUNDARY
- LOT BOUNDARY AND TAX LOT NUMBER
- 2853** BLOCK NUMBER
- REMEDIAL EXCAVATION TO APPROXIMATELY TWO FEET BELOW EXISTING GRADE
- REMEDIAL EXCAVATION TO GROUNDWATER (SOURCE AREA)

- CONFIRMATION DOCUMENTATION BOTTOM SAMPLE
- SOURCE AREA DOCUMENTATION BOTTOM SAMPLE
- DOCUMENTATION SIDEWALL SAMPLE

NOTE
 REMEDIAL EXCAVATION WILL INCLUDE REMOVAL OF APPROXIMATELY 1,280 TONS (850 CUBIC YARDS) OF SOURCE MATERIAL ASSOCIATED WITH NYSDEC SPILL NO. 2103719 AND APPROXIMATELY 860 TONS (570 CUBIC YARDS) OF SOIL/FILL FROM THE UPPER 2 FEET SITE-WIDE.



APPROXIMATE SOIL PRE-CHARACTERIZATION GRID

Map Source:
 NYCDOP (NYC Dept. of City Planning) GIS database

© 2021 AKRF. W:\Projects\210024 - 1956 JEROME AVENUE\Technical\GIS and Graphics\AR\RAW\210024 Figure 9 Proposed Remedial Excavation and Documentation Sample Location Plan.mxd 10/25/2021 2:03:38 PM iszalus



440 Park Avenue South, New York, NY 10016

1956 Jerome Avenue
 Bronx, New York

**TRACK 4 CLEANUP AND DOCUMENTATION
 SAMPLE LOCATION PLAN**

DATE
04/29/2022

PROJECT NO.
210024

FIGURE
11

Site Photographs

Photograph 1 - Rebar installation over piles in WC-02. View facing East.



Photograph 2 - Site condition. Excavation around piles and formwork construction in WC-02. View facing South.



Photograph 3 - AKRF developing first monitoring well. View facing North.



Upwind Station

Time	Instaneous VOC (ppm)	Instaneous Mass Conc. Total (mg/m ³)	Mass Conc. Total mg/m ³ AVG 15m (mg/m ³)	Dust Exceedance	VOC ppm AVG 15m (ppm)	VOC Exceedance
7/6/2023 7:02	0	0.007	0.007	No	0	No
7/6/2023 7:03	0	0.015	0.011	No	0	No
7/6/2023 7:04	0	0.01	0.0107	No	0	No
7/6/2023 7:05	0	0.029	0.0153	No	0	No
7/6/2023 7:06	0	0.026	0.0174	No	0	No
7/6/2023 7:07	0	0.022	0.0182	No	0	No
7/6/2023 7:08	0	0.015	0.0177	No	0	No
7/6/2023 7:09	0	0.01	0.0167	No	0	No
7/6/2023 7:10	0	0.039	0.0192	No	0	No
7/6/2023 7:11	0	0.183	0.0356	No	0	No
7/6/2023 7:12	0	0.142	0.0453	No	0	No
7/6/2023 7:13	0	0.139	0.0531	No	0	No
7/6/2023 7:14	0	0.279	0.0705	No	0	No
7/6/2023 7:15	0	0.161	0.0769	No	0	No
7/6/2023 7:16	0	0.094	0.0781	No	0	No
7/6/2023 7:17	0	0.073	0.0825	No	0	No
7/6/2023 7:18	0	0.016	0.0825	No	0	No
7/6/2023 7:19	0	0.008	0.0824	No	0	No
7/6/2023 7:20	0	0.007	0.0809	No	0	No
7/6/2023 7:21	0	0.014	0.0801	No	0	No
7/6/2023 7:22	0	0.007	0.0791	No	0	No
7/6/2023 7:23	0	0.038	0.0807	No	0	No
7/6/2023 7:24	0	0.02	0.0813	No	0	No
7/6/2023 7:25	0	0.01	0.0794	No	0	No
7/6/2023 7:26	0	0.02	0.0685	No	0	No
7/6/2023 7:27	0	0.009	0.0597	No	0	No
7/6/2023 7:28	0	0.01	0.0511	No	0	No
7/6/2023 7:29	0	0.008	0.033	No	0	No
7/6/2023 7:30	0	0.01	0.0229	No	0	No
7/6/2023 7:31	0	0.015	0.0177	No	0	No
7/6/2023 7:32	0	0.015	0.0138	No	0	No
7/6/2023 7:33	0	0.008	0.0133	No	0	No
7/6/2023 7:34	0	0.006	0.0131	No	0	No
7/6/2023 7:35	0	0.056	0.0164	No	0	No
7/6/2023 7:36	0	0.014	0.0164	No	0	No
7/6/2023 7:37	0	0.017	0.0171	No	0	No
7/6/2023 7:38	0	0.012	0.0153	No	0	No
7/6/2023 7:39	0	0.007	0.0145	No	0	No
7/6/2023 7:40	0	0.007	0.0143	No	0	No
7/6/2023 7:41	0	0.007	0.0134	No	0	No
7/6/2023 7:42	0	0.006	0.0132	No	0	No
7/6/2023 7:43	0	0.013	0.0134	No	0	No
7/6/2023 7:44	0	0.008	0.0134	No	0	No
7/6/2023 7:45	0	0.018	0.0139	No	0	No
7/6/2023 7:46	0	0.008	0.0135	No	0	No
7/6/2023 7:47	0	0.006	0.0129	No	0	No
7/6/2023 7:48	0	0.005	0.0127	No	0	No
7/6/2023 7:49	0	0.006	0.0127	No	0	No
7/6/2023 7:50	0	0.007	0.0094	No	0	No
7/6/2023 7:51	0	0.007	0.0089	No	0	No
7/6/2023 7:52	0	0.012	0.0086	No	0	No
7/6/2023 7:53	0	0.006	0.0082	No	0	No

Upwind Station

Time	Instantaneous VOC (ppm)	Instantaneous Mass Conc. Total (mg/m ³)	Mass Conc. Total mg/m ³ AVG 15m (mg/m ³)	Dust Exceedance	VOC ppm AVG 15m (ppm)	VOC Exceedance
7/6/2023 7:54	0	0.012	0.0085	No	0	No
7/6/2023 7:55	0	0.009	0.0087	No	0	No
7/6/2023 7:56	0	0.005	0.0085	No	0	No
7/6/2023 7:57	0	0.006	0.0085	No	0	No
7/6/2023 7:58	0	0.009	0.0083	No	0	No
7/6/2023 7:59	0	0.013	0.0086	No	0	No
7/6/2023 8:00	0	0.018	0.0086	No	0	No
7/6/2023 8:01	0	0.013	0.0089	No	0	No
7/6/2023 8:02	0	0.017	0.0097	No	0	No
7/6/2023 8:03	0	0.008	0.0099	No	0	No
7/6/2023 8:04	0	0.006	0.0099	No	0	No
7/6/2023 8:05	0	0.009	0.01	No	0	No
7/6/2023 8:06	0	0.007	0.01	No	0	No
7/6/2023 8:07	0	0.023	0.0107	No	0	No
7/6/2023 8:08	0	0.011	0.0111	No	0	No
7/6/2023 8:09	0	0.008	0.0108	No	0	No
7/6/2023 8:10	0	0.008	0.0107	No	0	No
7/6/2023 8:11	0	0.007	0.0109	No	0	No
7/6/2023 8:12	0	0.007	0.0109	No	0	No
7/6/2023 8:13	0	0.008	0.0109	No	0	No
7/6/2023 8:14	0	0.011	0.0107	No	0	No
7/6/2023 8:15	0	0.009	0.0101	No	0	No
7/6/2023 8:16	0	0.008	0.0098	No	0	No
7/6/2023 8:17	0	0.006	0.0091	No	0	No
7/6/2023 8:18	0	0.005	0.0089	No	0	No
7/6/2023 8:19	0	0.005	0.0088	No	0	No
7/6/2023 8:20	0	0.004	0.0085	No	0	No
7/6/2023 8:21	0	0.004	0.0083	No	0	No
7/6/2023 8:22	0	0.007	0.0072	No	0	No
7/6/2023 8:23	0	0.007	0.0069	No	0	No
7/6/2023 8:24	0	0.01	0.0071	No	0	No
7/6/2023 8:25	0	0.014	0.0075	No	0	No
7/6/2023 8:26	0	0.007	0.0075	No	0	No
7/6/2023 8:27	0	0.004	0.0073	No	0	No
7/6/2023 8:28	0	0.006	0.0071	No	0	No
7/6/2023 8:29	0	0.009	0.007	No	0	No
7/6/2023 8:30	0	0.009	0.007	No	0	No
7/6/2023 8:31	0	0.013	0.0073	No	0	No
7/6/2023 8:32	0	0.016	0.008	No	0	No
7/6/2023 8:33	0	0.012	0.0085	No	0	No
7/6/2023 8:34	0	0.015	0.0091	No	0	No
7/6/2023 8:35	0	0.011	0.0096	No	0	No
7/6/2023 8:36	0	0.03	0.0113	No	0	No
7/6/2023 8:37	0	0.031	0.0129	No	0	No
7/6/2023 8:38	0	0.008	0.013	No	0	No
7/6/2023 8:39	0	0.008	0.0129	No	0	No
7/6/2023 8:40	0	0.005	0.0123	No	0	No
7/6/2023 8:41	0	0.004	0.0121	No	0	No
7/6/2023 8:42	0	0.006	0.0122	No	0	No
7/6/2023 8:43	0	0.005	0.0121	No	0	No
7/6/2023 8:44	0	0.003	0.0117	No	0	No
7/6/2023 8:45	0	0.003	0.0113	No	0	No

Upwind Station

Time	Instantaneous VOC (ppm)	Instantaneous Mass Conc. Total (mg/m ³)	Mass Conc. Total mg/m ³ AVG 15m (mg/m ³)	Dust Exceedance	VOC ppm AVG 15m (ppm)	VOC Exceedance
7/6/2023 8:46	0	0.005	0.0108	No	0	No
7/6/2023 8:47	0	0.004	0.01	No	0	No
7/6/2023 8:48	0	0.006	0.0096	No	0	No
7/6/2023 8:49	0	0.003	0.0088	No	0	No
7/6/2023 8:50	0	0.002	0.0082	No	0	No
7/6/2023 8:51	0	0.002	0.0063	No	0	No
7/6/2023 8:52	0	0.003	0.0045	No	0	No
7/6/2023 8:53	0	0.002	0.0041	No	0	No
7/6/2023 8:54	0	0.002	0.0037	No	0	No
7/6/2023 8:55	0	0.001	0.0034	No	0	No
7/6/2023 8:56	0	0.004	0.0034	No	0	No
7/6/2023 8:57	0	0.001	0.0031	No	0	No
7/6/2023 8:58	0	0	0.0027	No	0	No
7/6/2023 8:59	0	0	0.0025	No	0	No
7/6/2023 9:00	0	0.001	0.0024	No	0	No
7/6/2023 9:01	0	0.001	0.0021	No	0	No
7/6/2023 9:02	0	0	0.0019	No	0	No
7/6/2023 9:03	0	0.003	0.0017	No	0	No
7/6/2023 9:04	0	0.001	0.0015	No	0	No
7/6/2023 9:05	0	0.002	0.0015	No	0	No
7/6/2023 9:06	0	0.002	0.0015	No	0	No
7/6/2023 9:07	0	0.001	0.0014	No	0	No
7/6/2023 9:08	0	0.002	0.0014	No	0	No
7/6/2023 9:09	0	0.001	0.0013	No	0	No
7/6/2023 9:10	0	0	0.0013	No	0	No
7/6/2023 9:11	0	0.016	0.0021	No	0	No
7/6/2023 9:12	0	0.008	0.0025	No	0	No
7/6/2023 9:13	0	0	0.0025	No	0	No
7/6/2023 9:14	0	0	0.0025	No	0	No
7/6/2023 9:15	0	0	0.0025	No	0	No
7/6/2023 9:16	0	0.001	0.0025	No	0	No
7/6/2023 9:17	0	0.001	0.0025	No	0	No
7/6/2023 9:18	0	0.001	0.0024	No	0	No
7/6/2023 9:19	0	0	0.0023	No	0	No
7/6/2023 9:20	0	0	0.0022	No	0	No
7/6/2023 9:21	0	0	0.0021	No	0	No
7/6/2023 9:22	0	0.001	0.0021	No	0	No
7/6/2023 9:23	0	0	0.0019	No	0	No
7/6/2023 9:24	0	0.001	0.0019	No	0	No
7/6/2023 9:25	0	0.001	0.0020	No	0	No
7/6/2023 9:26	0	0	0.0009	No	0	No
7/6/2023 9:27	0	0.001	0.0005	No	0	No
7/6/2023 9:28	0	0	0.0005	No	0	No
7/6/2023 9:29	0	0.025	0.0021	No	0	No
7/6/2023 9:30	0	0.002	0.0023	No	0	No
7/6/2023 9:31	0	0.002	0.0023	No	0	No
7/6/2023 9:32	0	0.001	0.0023	No	0	No
7/6/2023 9:33	0	0.001	0.0023	No	0	No
7/6/2023 9:34	0	0.002	0.0025	No	0	No
7/6/2023 9:35	0	0.001	0.0025	No	0	No
7/6/2023 9:36	0	0.001	0.0026	No	0	No
7/6/2023 9:37	0	0.007	0.0030	No	0	No

Upwind Station

Time	Instaneous VOC (ppm)	Instaneous Mass Conc. Total (mg/m ³)	Mass Conc. Total mg/m ³ AVG 15m (mg/m ³)	Dust Exceedance	VOC ppm AVG 15m (ppm)	VOC Exceedance
7/6/2023 9:38	0	0.001	0.0031	No	0	No
7/6/2023 9:39	0	0.002	0.0031	No	0	No
7/6/2023 9:40	0	0.002	0.0032	No	0	No
7/6/2023 9:41	0	0.003	0.0034	No	0	No
7/6/2023 9:42	0	0.002	0.0035	No	0	No
7/6/2023 9:43	0	0.002	0.0036	No	0	No
7/6/2023 9:44	0	0.002	0.0021	No	0	No
7/6/2023 9:45	0	0.003	0.0021	No	0	No
7/6/2023 9:46	0	0.005	0.0023	No	0	No
7/6/2023 9:47	0	0.005	0.0026	No	0	No
7/6/2023 9:48	0	0.005	0.0029	No	0	No
7/6/2023 9:49	0	0.004	0.0030	No	0	No
7/6/2023 9:50	0	0.005	0.0033	No	0	No
7/6/2023 9:51	0	0.005	0.0035	No	0	No
7/6/2023 9:52	0	0.006	0.0035	No	0	No
7/6/2023 9:53	0	0.004	0.0037	No	0	No
7/6/2023 9:54	0	0.001	0.0036	No	0	No
7/6/2023 9:55	0	0.005	0.0038	No	0	No
7/6/2023 9:56	0	0.007	0.0041	No	0	No
7/6/2023 9:57	0	0.007	0.0044	No	0	No
7/6/2023 9:58	0	0.007	0.0047	No	0	No
7/6/2023 9:59	0	0.006	0.0050	No	0	No
7/6/2023 10:00	0	0.007	0.0053	No	0	No
7/6/2023 10:01	0	0.007	0.0054	No	0	No
7/6/2023 10:02	0	0.008	0.0056	No	0	No
7/6/2023 10:03	0	0.008	0.0058	No	0	No
7/6/2023 10:04	0	0.007	0.0060	No	0	No
7/6/2023 10:05	0	0.006	0.0061	No	0	No
7/6/2023 10:06	0	0.005	0.0061	No	0	No
7/6/2023 10:07	0	0.007	0.0061	No	0	No
7/6/2023 10:08	0	0.006	0.0063	No	0	No
7/6/2023 10:09	0	0.006	0.0066	No	0	No
7/6/2023 10:10	0	0.005	0.0066	No	0	No
7/6/2023 10:11	0	0.004	0.0064	No	0	No
7/6/2023 10:12	0	0.005	0.0063	No	0	No
7/6/2023 10:13	0	0.007	0.0063	No	0	No
7/6/2023 10:14	0	0.006	0.0063	No	0	No
7/6/2023 10:15	0	0.007	0.0063	No	0	No
7/6/2023 10:16	0	0.008	0.0063	No	0	No
7/6/2023 10:17	0	0	0.0058	No	0	No
7/6/2023 10:18	0	0.007	0.0057	No	0	No
7/6/2023 10:19	0	0.008	0.0058	No	0	No
7/6/2023 10:20	0	0.008	0.0059	No	0	No
7/6/2023 10:21	0	0.007	0.0061	No	0	No
7/6/2023 10:22	0	0.008	0.0061	No	0	No
7/6/2023 10:23	0	0.008	0.0063	No	0	No
7/6/2023 10:24	0	0.006	0.0063	No	0	No
7/6/2023 10:25	0	0.008	0.0065	No	0	No
7/6/2023 10:26	0	0.007	0.0067	No	0	No
7/6/2023 10:27	0	0.002	0.0065	No	0	No
7/6/2023 10:28	0	0.001	0.0061	No	0	No
7/6/2023 10:29	0	0.002	0.0058	No	0	No

Upwind Station						
Time	Instaneous VOC (ppm)	Instaneous Mass Conc. Total (mg/m ³)	Mass Conc. Total mg/m ³ AVG 15m (mg/m ³)	Dust Exceedance	VOC ppm AVG 15m (ppm)	VOC Exceedance
7/6/2023 10:30	0	0.046	0.0084	No	0	No
7/6/2023 10:31	0	0.051	0.0113	No	0	No
7/6/2023 10:32	0	0.011	0.0120	No	0	No
7/6/2023 10:33	0	0.007	0.0120	No	0	No
7/6/2023 10:34	0	0.004	0.0117	No	0	No
7/6/2023 10:35	0	0.01	0.0119	No	0	No
7/6/2023 10:36	0	0.025	0.0131	No	0	No
7/6/2023 10:37	0	0.005	0.0129	No	0	No
7/6/2023 10:38	0	0.005	0.0127	No	0	No
7/6/2023 10:39	0	0.005	0.0126	No	0	No
7/6/2023 10:40	0	0.005	0.0124	No	0	No
7/6/2023 10:41	0	0.004	0.0122	No	0	No
7/6/2023 10:42	0	0.007	0.0125	No	0	No
7/6/2023 10:43	0	0.006	0.0129	No	0	No
7/6/2023 10:44	0	0.006	0.0131	No	0	No
7/6/2023 10:45	0	0.006	0.0105	No	0	No
7/6/2023 10:46	0	0.01	0.0077	No	0	No
7/6/2023 10:47	0	0.012	0.0078	No	0	No
7/6/2023 10:48	0	0.007	0.0078	No	0	No
7/6/2023 10:49	0	0.008	0.0081	No	0	No
7/6/2023 10:50	0	0.036	0.0098	No	0	No
7/6/2023 10:51	0	0.071	0.0129	No	0	No
7/6/2023 10:52	0	0.042	0.0153	No	0	No
7/6/2023 10:53	0	0.012	0.0158	No	0	No
7/6/2023 10:54	0	0.024	0.0171	No	0	No
7/6/2023 10:55	0	0.016	0.0178	No	0	No
7/6/2023 10:56	0	0.012	0.0183	No	0	No
7/6/2023 10:57	0	0.01	0.0185	No	0	No
7/6/2023 10:58	0	0.007	0.0186	No	0	No
7/6/2023 10:59	0	0.101	0.0249	No	0	No
7/6/2023 11:00	0	0.06	0.0285	No	0	No
7/6/2023 11:01	0	0.049	0.0311	No	0	No
7/6/2023 11:02	0	0.006	0.0307	No	0	No
7/6/2023 11:03	0	0.006	0.0307	No	0	No
7/6/2023 11:04	0	0.008	0.0307	No	0	No
7/6/2023 11:05	0	0.008	0.0288	No	0	No
7/6/2023 11:06	0	0.009	0.0247	No	0	No
7/6/2023 11:07	0	0.006	0.0223	No	0	No
7/6/2023 11:08	0	0.007	0.0219	No	0	No
7/6/2023 11:09	0	0.005	0.0207	No	0	No
7/6/2023 11:10	0	0.006	0.0200	No	0	No
7/6/2023 11:11	0	0.006	0.0196	No	0	No
7/6/2023 11:12	0	0.007	0.0194	No	0	No
7/6/2023 11:13	0	0.006	0.0193	No	0	No
7/6/2023 11:14	0	0.006	0.0130	No	0	No
7/6/2023 11:15	0	0.006	0.0094	No	0	No
7/6/2023 11:16	0	0.007	0.0066	No	0	No
7/6/2023 11:17	0	0.006	0.0066	No	0	No
7/6/2023 11:18	0	0.006	0.0066	No	0	No
7/6/2023 11:19	0	0.006	0.0065	No	0	No
7/6/2023 11:20	0	0.007	0.0064	No	0	No
7/6/2023 11:21	0	0.013	0.0067	No	0	No

Upwind Station

Time	Instantaneous VOC (ppm)	Instantaneous Mass Conc. Total (mg/m ³)	Mass Conc. Total mg/m ³ AVG 15m (mg/m ³)	Dust Exceedance	VOC ppm AVG 15m (ppm)	VOC Exceedance
7/6/2023 11:22	0	0.01	0.0069	No	0	No
7/6/2023 11:23	0	0.007	0.0069	No	0	No
7/6/2023 11:24	0	0.008	0.0071	No	0	No
7/6/2023 11:25	0	0.006	0.0071	No	0	No
7/6/2023 11:26	0	0.007	0.0072	No	0	No
7/6/2023 11:27	0	0.009	0.0073	No	0	No
7/6/2023 11:28	0	0.007	0.0074	No	0	No
7/6/2023 11:29	0	0.008	0.0075	No	0	No
7/6/2023 11:30	0	0.007	0.0076	No	0	No
7/6/2023 11:31	0	0.009	0.0077	No	0	No
7/6/2023 11:32	0	0.015	0.0083	No	0	No
7/6/2023 11:33	0	0.012	0.0087	No	0	No
7/6/2023 11:34	0	0.01	0.0090	No	0	No
7/6/2023 11:35	0	0.012	0.0093	No	0	No
7/6/2023 11:36	0	0.009	0.0091	No	0	No
7/6/2023 11:37	0	0.008	0.0089	No	0	No
7/6/2023 11:38	0	0.009	0.0091	No	0	No
7/6/2023 11:39	0	0.013	0.0094	No	0	No
7/6/2023 11:40	0	0.008	0.0095	No	0	No
7/6/2023 11:41	0	0.008	0.0096	No	0	No
7/6/2023 11:42	0	0.01	0.0097	No	0	No
7/6/2023 11:43	0	0.011	0.0099	No	0	No
7/6/2023 11:44	0	0.009	0.0100	No	0	No
7/6/2023 11:45	0	0.016	0.0106	No	0	No
7/6/2023 11:46	0	0.01	0.0107	No	0	No
7/6/2023 11:47	0	0.009	0.0103	No	0	No
7/6/2023 11:48	0	0.011	0.0102	No	0	No
7/6/2023 11:49	0	0.013	0.0104	No	0	No
7/6/2023 11:50	0	0.021	0.0110	No	0	No
7/6/2023 11:51	0	0.014	0.0113	No	0	No
7/6/2023 11:52	0	0.016	0.0119	No	0	No
7/6/2023 11:53	0	0.022	0.0127	No	0	No
7/6/2023 11:54	0	0.023	0.0134	No	0	No
7/6/2023 11:55	0	0.013	0.0137	No	0	No
7/6/2023 11:56	0	0.012	0.0140	No	0	No
7/6/2023 11:57	0	0.011	0.0141	No	0	No
7/6/2023 11:58	0	0.019	0.0146	No	0	No
7/6/2023 11:59	0	0.036	0.0164	No	0	No
7/6/2023 12:00	0	0.013	0.0162	No	0	No
7/6/2023 12:01	0	0.017	0.0167	No	0	No
7/6/2023 12:02	0	0.013	0.0169	No	0	No
7/6/2023 12:03	0	0.012	0.0170	No	0	No
7/6/2023 12:04	0	0.012	0.0169	No	0	No
7/6/2023 12:05	0	0.013	0.0164	No	0	No
7/6/2023 12:06	0	0.013	0.0163	No	0	No
7/6/2023 12:07	0	0.016	0.0163	No	0	No
7/6/2023 12:08	0	0.013	0.0157	No	0	No
7/6/2023 12:09	0	0.016	0.0153	No	0	No
7/6/2023 12:10	0	0.013	0.0153	No	0	No
7/6/2023 12:11	0	0.013	0.0153	No	0	No
7/6/2023 12:12	0	0.016	0.0157	No	0	No
7/6/2023 12:13	0	0.015	0.0154	No	0	No

Upwind Station						
Time	Instaneous VOC (ppm)	Instaneous Mass Conc. Total (mg/m ³)	Mass Conc. Total mg/m ³ AVG 15m (mg/m ³)	Dust Exceedance	VOC ppm AVG 15m (ppm)	VOC Exceedance
7/6/2023 12:14	0	0.013	0.0139	No	0	No
7/6/2023 12:15	0	0.014	0.0139	No	0	No
7/6/2023 12:16	0	0.013	0.0137	No	0	No
7/6/2023 12:17	0	0.015	0.0138	No	0	No
7/6/2023 12:18	0	0.017	0.0141	No	0	No
7/6/2023 12:19	0	0.013	0.0142	No	0	No
7/6/2023 12:20	0	0.014	0.0143	No	0	No
7/6/2023 12:21	0	0.014	0.0143	No	0	No
7/6/2023 12:22	0	0.015	0.0143	No	0	No
7/6/2023 12:23	0	0.014	0.0143	No	0	No
7/6/2023 12:24	0	0.013	0.0141	No	0	No
7/6/2023 12:25	0	0.013	0.0141	No	0	No
7/6/2023 12:26	0	0.015	0.0143	No	0	No
7/6/2023 12:27	0	0.016	0.0143	No	0	No
7/6/2023 12:28	0	0.015	0.0143	No	0	No
7/6/2023 12:29	0	0.015	0.0144	No	0	No
7/6/2023 12:30	0	0.025	0.0151	No	0	No
7/6/2023 12:31	0	0.015	0.0153	No	0	No
7/6/2023 12:32	0	0.014	0.0152	No	0	No
7/6/2023 12:33	0	0.013	0.0149	No	0	No
7/6/2023 12:34	0	0.019	0.0153	No	0	No
7/6/2023 12:35	0	0.014	0.0153	No	0	No
7/6/2023 12:36	0	0.013	0.0153	No	0	No
7/6/2023 12:37	0	0.013	0.0151	No	0	No
7/6/2023 12:38	0	0.014	0.0151	No	0	No
7/6/2023 12:39	0	0.015	0.0153	No	0	No
7/6/2023 12:40	0	0.017	0.0155	No	0	No
7/6/2023 12:41	0	0.017	0.0157	No	0	No
7/6/2023 12:42	0	0.017	0.0157	No	0	No
7/6/2023 12:43	0	0.021	0.0161	No	0	No
7/6/2023 12:44	0	0.037	0.0176	No	0	No
7/6/2023 12:45	0	0.019	0.0172	No	0	No
7/6/2023 12:46	0	0.017	0.0173	No	0	No
7/6/2023 12:47	0	0.016	0.0175	No	0	No
7/6/2023 12:48	0	0.014	0.0175	No	0	No
7/6/2023 12:49	0	0.021	0.0177	No	0	No
7/6/2023 12:50	0	0.016	0.0178	No	0	No
7/6/2023 12:51	0	0.02	0.0183	No	0	No
7/6/2023 12:52	0	0.018	0.0186	No	0	No
7/6/2023 12:53	0	0.018	0.0189	No	0	No
7/6/2023 12:54	0	0.015	0.0189	No	0	No
7/6/2023 12:55	0	0.014	0.0187	No	0	No
7/6/2023 12:56	0	0.017	0.0187	No	0	No
7/6/2023 12:57	0	0.026	0.0193	No	0	No
7/6/2023 12:58	0	0.021	0.0193	No	0	No
7/6/2023 12:59	0	0.023	0.0183	No	0	No
7/6/2023 13:00	0	0.02	0.0184	No	0	No
7/6/2023 13:01	0	0.018	0.0185	No	0	No
7/6/2023 13:02	0	0.124	0.0257	No	0	No
7/6/2023 13:03	0	0.02	0.0261	No	0	No
7/6/2023 13:04	0	0.016	0.0257	No	0	No
7/6/2023 13:05	0	0.016	0.0257	No	0	No

Upwind Station						
Time	Instaneous VOC (ppm)	Instaneous Mass Conc. Total (mg/m ³)	Mass Conc. Total mg/m ³ AVG 15m (mg/m ³)	Dust Exceedance	VOC ppm AVG 15m (ppm)	VOC Exceedance
7/6/2023 13:06	0	0.019	0.0257	No	0	No
7/6/2023 13:07	0	0.015	0.0255	No	0	No
7/6/2023 13:08	0	0.015	0.0253	No	0	No
7/6/2023 13:09	0	0.015	0.0253	No	0	No
7/6/2023 13:10	0	0.016	0.0254	No	0	No
7/6/2023 13:11	0	0.057	0.0281	No	0	No
7/6/2023 13:12	0	0.028	0.0282	No	0	No
7/6/2023 13:13	0	0.024	0.0284	No	0	No
7/6/2023 13:14	0	0.017	0.0280	No	0	No
7/6/2023 13:15	0	0.015	0.0277	No	0	No
7/6/2023 13:16	0	0.015	0.0275	No	0	No
7/6/2023 13:17	0	0.017	0.0203	No	0	No
7/6/2023 13:18	0	0.015	0.0200	No	0	No
7/6/2023 13:19	0	0.028	0.0208	No	0	No
7/6/2023 13:20	0	0.017	0.0209	No	0	No
7/6/2023 13:21	0	0.015	0.0206	No	0	No
7/6/2023 13:22	0	0.015	0.0206	No	0	No
7/6/2023 13:23	0	0.019	0.0209	No	0	No
7/6/2023 13:24	0	0.022	0.0213	No	0	No
7/6/2023 13:25	0	0.019	0.0215	No	0	No
7/6/2023 13:26	0	0.019	0.0190	No	0	No
7/6/2023 13:27	0	0.014	0.0181	No	0	No
7/6/2023 13:28	0	0.016	0.0175	No	0	No
7/6/2023 13:29	0	0.021	0.0178	No	0	No
7/6/2023 13:30	0	0.02	0.0181	No	0	No
7/6/2023 13:31	0	0.017	0.0183	No	0	No
7/6/2023 13:32	0	0.023	0.0187	No	0	No
7/6/2023 13:33	0	0.062	0.0218	No	0	No
7/6/2023 13:34	0	0.023	0.0215	No	0	No
7/6/2023 13:35	0	0.019	0.0216	No	0	No
7/6/2023 13:36	0	0.027	0.0224	No	0	No
7/6/2023 13:37	0	0.022	0.0229	No	0	No
7/6/2023 13:38	0	0.025	0.0233	No	0	No
7/6/2023 13:39	0	0.018	0.0230	No	0	No
7/6/2023 13:40	0	0.015	0.0227	No	0	No
7/6/2023 13:41	0	0.026	0.0232	No	0	No
7/6/2023 13:42	0	0.254	0.0392	No	0	No
7/6/2023 13:43	0	0.103	0.0450	No	0	No
7/6/2023 13:44	0	0.018	0.0448	No	0	No
7/6/2023 13:45	0	0.025	0.0451	No	0	No
7/6/2023 13:46	0	0.018	0.0452	No	0	No
7/6/2023 13:47	0	0.024	0.0453	No	0	No
7/6/2023 13:48	0	0.021	0.0425	No	0	No
7/6/2023 13:49	0	0.021	0.0424	No	0	No
7/6/2023 13:50	0	0.017	0.0423	No	0	No
7/6/2023 13:51	0	0.015	0.0415	No	0	No
7/6/2023 13:52	0	0.018	0.0412	No	0	No
7/6/2023 13:53	0	0.018	0.0407	No	0	No
7/6/2023 13:54	0	0.097	0.0460	No	0	No
7/6/2023 13:55	0	0.015	0.0460	No	0	No
7/6/2023 13:56	0	0.024	0.0459	No	0	No
7/6/2023 13:57	0	0.038	0.0315	No	0	No

Upwind Station						
Time	Instantaneous VOC (ppm)	Instantaneous Mass Conc. Total (mg/m ³)	Mass Conc. Total mg/m ³ AVG 15m (mg/m ³)	Dust Exceedance	VOC ppm AVG 15m (ppm)	VOC Exceedance
7/6/2023 13:58	0	0.015	0.0256	No	0	No
7/6/2023 13:59	0	0.014	0.0253	No	0	No
7/6/2023 14:00	0	0.014	0.0246	No	0	No
7/6/2023 14:01	0	0.013	0.0243	No	0	No
7/6/2023 14:02	0	0.013	0.0235	No	0	No
7/6/2023 14:03	0	0.017	0.0233	No	0	No
7/6/2023 14:04	0	0.017	0.0230	No	0	No
7/6/2023 14:05	0	0.016	0.0229	No	0	No
7/6/2023 14:06	0	0.023	0.0235	No	0	No
7/6/2023 14:07	0	0.026	0.0240	No	0	No
7/6/2023 14:08	0	0.028	0.0247	No	0	No
7/6/2023 14:09	0	0.015	0.0192	No	0	No
7/6/2023 14:10	0	0.017	0.0193	No	0	No
7/6/2023 14:11	0	0.012	0.0185	No	0	No
7/6/2023 14:12	0	0.012	0.0168	No	0	No
7/6/2023 14:13	0	0.015	0.0168	No	0	No
7/6/2023 14:14	0	0.014	0.0168	No	0	No
7/6/2023 14:15	0	0.029	0.0178	No	0	No
7/6/2023 14:16	0	0.023	0.0185	No	0	No
7/6/2023 14:17	0	0.036	0.0200	No	0	No
7/6/2023 14:18	0	0.015	0.0199	No	0	No
7/6/2023 14:19	0	0.014	0.0197	No	0	No
7/6/2023 14:20	0	0.032	0.0207	No	0	No
7/6/2023 14:21	0	0.039	0.0218	No	0	No
7/6/2023 14:22	0	0.024	0.0217	No	0	No
7/6/2023 14:23	0	0.047	0.0229	No	0	No
7/6/2023 14:24	0	0.018	0.0231	No	0	No
7/6/2023 14:25	0	0.016	0.0231	No	0	No
7/6/2023 14:26	0	0.014	0.0232	No	0	No
7/6/2023 14:27	0	0.013	0.0233	No	0	No
7/6/2023 14:28	0	0.02	0.0236	No	0	No
7/6/2023 14:29	0	0.066	0.0271	No	0	No
7/6/2023 14:30	0	0.016	0.0262	No	0	No
7/6/2023 14:31	0	0.013	0.0255	No	0	No
7/6/2023 14:32	0	0.013	0.0240	No	0	No
7/6/2023 14:33	0	0.017	0.0241	No	0	No
7/6/2023 14:34	0	0.012	0.0240	No	0	No
7/6/2023 14:35	0	0.012	0.0227	No	0	No
7/6/2023 14:36	0	0.012	0.0209	No	0	No
7/6/2023 14:37	0	0.013	0.0201	No	0	No
7/6/2023 14:38	0	0.018	0.0182	No	0	No
7/6/2023 14:39	0	0.012	0.0178	No	0	No
7/6/2023 14:40	0	0.016	0.0178	No	0	No
7/6/2023 14:41	0	0.018	0.0181	No	0	No
7/6/2023 14:42	0	0.025	0.0189	No	0	No
7/6/2023 14:43	0	0.015	0.0185	No	0	No

Downwind Station						
Time	Instantaneous VOC (ppm)	Instantaneous Mass Conc. Total (mg/m ³)	Mass Conc. Total mg/m ³ AVG 15m (mg/m ³)	Dust Exceedance	VOC ppm AVG 15m (ppm)	VOC Exceedance
7/6/2023 7:02	0	0.075	0.075	No	0	No
7/6/2023 7:03	0	0.079	0.077	No	0	No
7/6/2023 7:04	0	0.076	0.0767	No	0	No
7/6/2023 7:05	0.06	0.074	0.076	No	0	No
7/6/2023 7:06	0	0.074	0.0756	No	0	No
7/6/2023 7:07	0	0.096	0.079	No	0	No
7/6/2023 7:08	0	0.083	0.0796	No	0	No
7/6/2023 7:09	0	0.132	0.0861	No	0	No
7/6/2023 7:10	0	0.093	0.0869	No	0	No
7/6/2023 7:11	0	0.113	0.0895	No	0	No
7/6/2023 7:12	0	0.125	0.0927	No	0	No
7/6/2023 7:13	0	0.142	0.0968	No	0	No
7/6/2023 7:14	0	0.085	0.0959	No	0	No
7/6/2023 7:15	0	0.091	0.0956	No	0	No
7/6/2023 7:16	0	0.334	0.1115	No	0	No
7/6/2023 7:17	0	0.207	0.1203	No	0	No
7/6/2023 7:18	0	0.204	0.1286	No	0	No
7/6/2023 7:19	0	0.139	0.1328	No	0	No
7/6/2023 7:20	0	0.09	0.1339	No	0	No
7/6/2023 7:21	0	0.09	0.1349	No	0	No
7/6/2023 7:22	0	0.08	0.1339	No	0	No
7/6/2023 7:23	0	0.113	0.1359	No	0	No
7/6/2023 7:24	0	0.1	0.1337	No	0	No
7/6/2023 7:25	0	0.12	0.1355	No	0	No
7/6/2023 7:26	0	0.101	0.1347	No	0	No
7/6/2023 7:27	0	0.076	0.1315	No	0	No
7/6/2023 7:28	0	0.074	0.1269	No	0	No
7/6/2023 7:29	0	0.078	0.1265	No	0	No
7/6/2023 7:30	0	0.084	0.126	No	0	No
7/6/2023 7:31	0	0.681	0.1491	No	0	No
7/6/2023 7:32	0	0.197	0.1485	No	0	No
7/6/2023 7:33	0	0.139	0.1441	No	0	No
7/6/2023 7:34	0	0.087	0.1407	No	0	No
7/6/2023 7:35	0	0.127	0.1431	No	0	No
7/6/2023 7:36	0	0.141	0.1465	No	0	No
7/6/2023 7:37	0	0.1	0.1479	No	0	No
7/6/2023 7:38	0	0.111	0.1477	No	0	No
7/6/2023 7:39	0	0.215	0.1554	Yes	0	No
7/6/2023 7:40	0	0.117	0.1552	Yes	0	No
7/6/2023 7:41	0	0.168	0.1597	Yes	0	No
7/6/2023 7:42	0	0.107	0.1617	Yes	0	No
7/6/2023 7:43	0	0.12	0.1648	Yes	0	No
7/6/2023 7:44	0	0.236	0.1753	Yes	0	No
7/6/2023 7:45	0	0.11	0.1771	Yes	0	No
7/6/2023 7:46	0	0.093	0.1379	No	0	No
7/6/2023 7:47	0	0.097	0.1312	No	0	No
7/6/2023 7:48	0	0.099	0.1285	No	0	No
7/6/2023 7:49	0	0.078	0.1279	No	0	No
7/6/2023 7:50	0	0.07	0.1241	No	0	No
7/6/2023 7:51	0	0.074	0.1197	No	0	No
7/6/2023 7:52	0	0.07	0.1177	No	0	No
7/6/2023 7:53	0	0.121	0.1183	No	0	No
7/6/2023 7:54	0	0.275	0.1223	No	0	No
7/6/2023 7:55	0	0.111	0.1219	No	0	No
7/6/2023 7:56	0	0.316	0.1318	No	0	No

Downwind Station

Time	Instantaneous VOC (ppm)	Instantaneous Mass Conc. Total (mg/m ³)	Mass Conc. Total mg/m ³ AVG 15m (mg/m ³)	Dust Exceedance	VOC ppm AVG 15m (ppm)	VOC Exceedance
7/6/2023 7:57	0	0.203	0.1382	No	0	No
7/6/2023 7:58	0	0.099	0.1368	No	0	No
7/6/2023 7:59	0	0.247	0.1375	No	0	No
7/6/2023 8:00	0	0.313	0.1511	Yes	0	No
7/6/2023 8:01	0	0.323	0.1664	Yes	0	No
7/6/2023 8:02	0	0.316	0.181	Yes	0	No
7/6/2023 8:03	0	0.158	0.1849	Yes	0	No
7/6/2023 8:04	0	0.242	0.1959	Yes	0	No
7/6/2023 8:05	0	0.277	0.2097	Yes	0	No
7/6/2023 8:06	0	0.166	0.2158	Yes	0	No
7/6/2023 8:07	0	0.099	0.2177	Yes	0	No
7/6/2023 8:08	0	0.086	0.2154	Yes	0	No
7/6/2023 8:09	0	0.117	0.2049	Yes	0	No
7/6/2023 8:10	0	0.182	0.2096	Yes	0	No
7/6/2023 8:11	0	0.148	0.1984	Yes	0	No
7/6/2023 8:12	0	0.18	0.1969	Yes	0	No
7/6/2023 8:13	0	0.163	0.2011	Yes	0	No
7/6/2023 8:14	0	0.274	0.2029	Yes	0	No
7/6/2023 8:15	0	0.283	0.2009	Yes	0	No
7/6/2023 8:16	0	0.232	0.1949	Yes	0	No
7/6/2023 8:17	0	0.119	0.1817	Yes	0	No
7/6/2023 8:18	0	0.132	0.18	Yes	0	No
7/6/2023 8:19	0	0.131	0.1726	Yes	0	No
7/6/2023 8:20	0	0.155	0.1645	Yes	0	No
7/6/2023 8:21	0	0.179	0.1653	Yes	0	No
7/6/2023 8:22	0	0.139	0.168	Yes	0	No
7/6/2023 8:23	0	0.098	0.1688	Yes	0	No
7/6/2023 8:24	0	0.125	0.1693	Yes	0	No
7/6/2023 8:25	0	0.242	0.1733	Yes	0	No
7/6/2023 8:26	0	0.341	0.1862	Yes	0	No
7/6/2023 8:27	0	0.229	0.1895	Yes	0	No
7/6/2023 8:28	0	0.124	0.1869	Yes	0	No
7/6/2023 8:29	0	0.14	0.1779	Yes	0	No
7/6/2023 8:30	0	0.13	0.1677	Yes	0	No
7/6/2023 8:31	0	0.251	0.169	Yes	0	No
7/6/2023 8:32	0	0.157	0.1715	Yes	0	No
7/6/2023 8:33	0	0.132	0.1715	Yes	0	No
7/6/2023 8:34	0	0.136	0.1719	Yes	0	No
7/6/2023 8:35	0	0.138	0.1707	Yes	0	No
7/6/2023 8:36	0	0.107	0.1659	Yes	0	No
7/6/2023 8:37	0	0.098	0.1632	Yes	0	No
7/6/2023 8:38	0	0.097	0.1631	Yes	0	No
7/6/2023 8:39	0	0.105	0.1618	Yes	0	No
7/6/2023 8:40	0	0.103	0.1525	Yes	0	No
7/6/2023 8:41	0	0.108	0.137	No	0	No
7/6/2023 8:42	0	0.103	0.1286	No	0	No
7/6/2023 8:43	0	0.094	0.1266	No	0	No
7/6/2023 8:44	0	0.135	0.1263	No	0	No
7/6/2023 8:45	0	0.081	0.123	No	0	No
7/6/2023 8:46	0	0.083	0.1118	No	0	No
7/6/2023 8:47	0	0.118	0.1092	No	0	No
7/6/2023 8:48	0	0.09	0.1064	No	0	No
7/6/2023 8:49	0	0.242	0.1135	No	0	No
7/6/2023 8:50	0	0.075	0.1093	No	0	No
7/6/2023 8:51	0	0.089	0.1081	No	0	No

Downwind Station

Time	Instantaneous VOC (ppm)	Instantaneous Mass Conc. Total (mg/m ³)	Mass Conc. Total mg/m ³ AVG 15m (mg/m ³)	Dust Exceedance	VOC ppm AVG 15m (ppm)	VOC Exceedance
7/6/2023 8:52	0	0.1	0.1082	No	0	No
7/6/2023 8:53	0	0.1	0.1084	No	0	No
7/6/2023 8:54	0	0.067	0.1059	No	0	No
7/6/2023 8:55	0	0.064	0.1033	No	0	No
7/6/2023 8:56	0	0.064	0.1003	No	0	No
7/6/2023 8:57	0	0.089	0.0994	No	0	No
7/6/2023 8:58	0	0.071	0.0979	No	0	No
7/6/2023 8:59	0	0.069	0.0935	No	0	No
7/6/2023 9:00	0	0.118	0.0959	No	0	No
7/6/2023 9:01	0	0.098	0.0969	No	0	No
7/6/2023 9:02	0	0.079	0.0943	No	0	No
7/6/2023 9:03	0	0.074	0.0933	No	0	No
7/6/2023 9:04	0	0.081	0.0825	No	0	No
7/6/2023 9:05	0	0.098	0.0841	No	0	No
7/6/2023 9:06	0	0.084	0.0837	No	0	No
7/6/2023 9:07	0	0.087	0.0829	No	0	No
7/6/2023 9:08	0	0.088	0.0821	No	0	No
7/6/2023 9:09	0	0.089	0.0835	No	0	No
7/6/2023 9:10	0	0.079	0.0845	No	0	No
7/6/2023 9:11	0	0.071	0.085	No	0	No
7/6/2023 9:12	0	0.075	0.0841	No	0	No
7/6/2023 9:13	0	0.081	0.0847	No	0	No
7/6/2023 9:14	0	0.086	0.0859	No	0	No
7/6/2023 9:15	0	0.078	0.0832	No	0	No
7/6/2023 9:16	0	0.103	0.0835	No	0	No
7/6/2023 9:17	0	0.096	0.0847	No	0	No
7/6/2023 9:18	0	0.096	0.0861	No	0	No
7/6/2023 9:19	0	0.077	0.0859	No	0	No
7/6/2023 9:20	0	0.072	0.0841	No	0	No
7/6/2023 9:21	0	0.072	0.0833	No	0	No
7/6/2023 9:22	0	0.075	0.0825	No	0	No
7/6/2023 9:23	0	0.079	0.0819	No	0	No
7/6/2023 9:24	0	0.079	0.0813	No	0	No
7/6/2023 9:25	0	0.093	0.0822	No	0	No
7/6/2023 9:26	0	0.076	0.0825	No	0	No
7/6/2023 9:27	0	0.086	0.0833	No	0	No
7/6/2023 9:28	0	0.074	0.0828	No	0	No
7/6/2023 9:29	0	0.082	0.0825	No	0	No
7/6/2023 9:30	0	0.074	0.0823	No	0	No
7/6/2023 9:31	0	0.073	0.0803	No	0	No
7/6/2023 9:32	0	0.073	0.0787	No	0	No
7/6/2023 9:33	0	0.07	0.077	No	0	No
7/6/2023 9:34	0	0.072	0.0767	No	0	No
7/6/2023 9:35	0	0.071	0.0766	No	0	No
7/6/2023 9:36	0	0.063	0.076	No	0	No
7/6/2023 9:37	0	0.069	0.0756	No	0	No
7/6/2023 9:38	0	0.064	0.0746	No	0	No
7/6/2023 9:39	0	0.071	0.0741	No	0	No
7/6/2023 9:40	0	0.076	0.0729	No	0	No
7/6/2023 9:41	0	0.063	0.0721	No	0	No
7/6/2023 9:42	0	0.067	0.0708	No	0	No
7/6/2023 9:43	0	0.083	0.0714	No	0	No
7/6/2023 9:44	0	0.068	0.0705	No	0	No
7/6/2023 9:45	0	0.065	0.0699	No	0	No
7/6/2023 9:46	0	0.063	0.0692	No	0	No

Downwind Station

Time	Instantaneous VOC (ppm)	Instantaneous Mass Conc. Total (mg/m ³)	Mass Conc. Total mg/m ³ AVG 15m (mg/m ³)	Dust Exceedance	VOC ppm AVG 15m (ppm)	VOC Exceedance
7/6/2023 9:47	0	0.064	0.0686	No	0	No
7/6/2023 9:48	0	0.062	0.0681	No	0	No
7/6/2023 9:49	0	0.06	0.0673	No	0	No
7/6/2023 9:50	0	0.063	0.0667	No	0	No
7/6/2023 9:51	0	0.065	0.0669	No	0	No
7/6/2023 9:52	0	0.065	0.0666	No	0	No
7/6/2023 9:53	0	0.059	0.0663	No	0	No
7/6/2023 9:54	0	0.063	0.0657	No	0	No
7/6/2023 9:55	0	0.065	0.065	No	0	No
7/6/2023 9:56	0	0.059	0.0647	No	0	No
7/6/2023 9:57	0	0.057	0.0641	No	0	No
7/6/2023 9:58	0	0.057	0.0623	No	0	No
7/6/2023 9:59	0	0.064	0.0621	No	0	No
7/6/2023 10:00	0	0.067	0.0622	No	0	No
7/6/2023 10:01	0	0.064	0.0623	No	0	No
7/6/2023 10:02	0	0.055	0.0617	No	0	No
7/6/2023 10:03	0	0.055	0.0612	No	0	No
7/6/2023 10:04	0	0.057	0.061	No	0	No
7/6/2023 10:05	0	0.057	0.0606	No	0	No
7/6/2023 10:06	0	0.062	0.0604	No	0	No
7/6/2023 10:07	0	0.059	0.06	No	0	No
7/6/2023 10:08	0	0.059	0.06	No	0	No
7/6/2023 10:09	0	0.056	0.0595	No	0	No
7/6/2023 10:10	0	0.059	0.0591	No	0	No
7/6/2023 10:11	0	0.064	0.0595	No	0	No
7/6/2023 10:12	0	0.057	0.0595	No	0	No
7/6/2023 10:13	0	0.055	0.0593	No	0	No
7/6/2023 10:14	0	0.056	0.0588	No	0	No
7/6/2023 10:15	0	0.059	0.0583	No	0	No
7/6/2023 10:16	0	0.058	0.0579	No	0	No
7/6/2023 10:17	0	0.055	0.0579	No	0	No
7/6/2023 10:18	0	0.055	0.0579	No	0	No
7/6/2023 10:19	0	0.054	0.0577	No	0	No
7/6/2023 10:20	0	0.055	0.0575	No	0	No
7/6/2023 10:21	0	0.061	0.0575	No	0	No
7/6/2023 10:22	0	0.054	0.0571	No	0	No
7/6/2023 10:23	0	0.069	0.0578	No	0	No
7/6/2023 10:24	0	0.061	0.0581	No	0	No
7/6/2023 10:25	0	0.06	0.0582	No	0	No
7/6/2023 10:26	0	0.057	0.0577	No	0	No
7/6/2023 10:27	0	0.091	0.06	No	0	No
7/6/2023 10:28	0	0.072	0.0611	No	0	No
7/6/2023 10:29	0	0.058	0.0613	No	0	No
7/6/2023 10:30	0	0.056	0.0611	No	0	No
7/6/2023 10:31	0	0.057	0.061	No	0	No

Downwind Station						
Time	Instantaneous VOC (ppm)	Instantaneous Mass Conc. Total (mg/m ³)	Mass Conc. Total mg/m ³ AVG 15m (mg/m ³)	Dust Exceedance	VOC ppm AVG 15m (ppm)	VOC Exceedance
7/6/2023 10:32	0	0.057	0.0611	No	0	No
7/6/2023 10:33	0	0.057	0.0613	No	0	No
7/6/2023 10:34	0	0.057	0.0615	No	0	No
7/6/2023 10:35	0	0.053	0.0613	No	0	No
7/6/2023 10:36	0	0.053	0.0608	No	0	No
7/6/2023 10:37	0	0.053	0.0607	No	0	No
7/6/2023 10:38	0	0.125	0.0645	No	0	No
7/6/2023 10:39	0	0.088	0.0663	No	0	No
7/6/2023 10:40	0	0.06	0.0663	No	0	No
7/6/2023 10:41	0	0.062	0.0666	No	0	No
7/6/2023 10:42	0	0.057	0.0643	No	0	No
7/6/2023 10:43	0	0.106	0.0666	No	0	No
7/6/2023 10:44	0	0.063	0.0669	No	0	No
7/6/2023 10:45	0	0.054	0.0668	No	0	No
7/6/2023 10:46	0	0.14	0.0723	No	0	No
7/6/2023 10:47	0	0.082	0.074	No	0	No
7/6/2023 10:48	0	0.062	0.0743	No	0	No
7/6/2023 10:49	0	0.15	0.0805	No	0	No
7/6/2023 10:50	0	0.132	0.0858	No	0	No
7/6/2023 10:51	0	0.062	0.0864	No	0	No
7/6/2023 10:52	0	0.064	0.0871	No	0	No
7/6/2023 10:53	0	0.065	0.0831	No	0	No
7/6/2023 10:54	0	0.062	0.0814	No	0	No
7/6/2023 10:55	0	0.066	0.0818	No	0	No
7/6/2023 10:56	0	0.062	0.0818	No	0	No
7/6/2023 10:57	0	0.061	0.0821	No	0	No
7/6/2023 10:58	0	0.064	0.0793	No	0	No
7/6/2023 10:59	0	0.057	0.0789	No	0	No
7/6/2023 11:00	0	0.061	0.0793	No	0	No
7/6/2023 11:01	0	0.088	0.0759	No	0	No
7/6/2023 11:02	0	0.075	0.0754	No	0	No
7/6/2023 11:03	0	0.058	0.0751	No	0	No
7/6/2023 11:04	0	0.049	0.0684	No	0	No
7/6/2023 11:05	0	0.048	0.0628	No	0	No
7/6/2023 11:06	0	0.054	0.0623	No	0	No
7/6/2023 11:07	0	0.051	0.0614	No	0	No
7/6/2023 11:08	0	0.069	0.0617	No	0	No
7/6/2023 11:09	0	0.057	0.0613	No	0	No
7/6/2023 11:10	0	0.048	0.0601	No	0	No
7/6/2023 11:11	0	0.051	0.0594	No	0	No
7/6/2023 11:12	0	0.063	0.0595	No	0	No
7/6/2023 11:13	0	0.049	0.0585	No	0	No
7/6/2023 11:14	0	0.053	0.0583	No	0	No
7/6/2023 11:15	0	0.048	0.0574	No	0	No
7/6/2023 11:16	0	0.1	0.0582	No	0	No
7/6/2023 11:17	0	0.067	0.0577	No	0	No
7/6/2023 11:18	0	0.061	0.0579	No	0	No
7/6/2023 11:19	0	0.053	0.0581	No	0	No
7/6/2023 11:20	0	0.052	0.0584	No	0	No
7/6/2023 11:21	0	0.051	0.0582	No	0	No
7/6/2023 11:22	0	0.054	0.0584	No	0	No
7/6/2023 11:23	0	0.051	0.0572	No	0	No
7/6/2023 11:24	0	0.05	0.0567	No	0	No
7/6/2023 11:25	0	0.05	0.0569	No	0	No
7/6/2023 11:26	0	0.048	0.0567	No	0	No

Downwind Station						
Time	Instantaneous VOC (ppm)	Instantaneous Mass Conc. Total (mg/m ³)	Mass Conc. Total mg/m ³ AVG 15m (mg/m ³)	Dust Exceedance	VOC ppm AVG 15m (ppm)	VOC Exceedance
7/6/2023 11:27	0	0.049	0.0557	No	0	No
7/6/2023 11:28	0	0.056	0.0562	No	0	No
7/6/2023 11:29	0	0.061	0.0567	No	0	No
7/6/2023 11:30	0	0.06	0.0575	No	0	No
7/6/2023 11:31	0	0.056	0.0546	No	0	No
7/6/2023 11:32	0	0.052	0.0536	No	0	No
7/6/2023 11:33	0	0.055	0.0532	No	0	No
7/6/2023 11:34	0	0.052	0.0531	No	0	No
7/6/2023 11:35	0	0.054	0.0533	No	0	No
7/6/2023 11:36	0	0.057	0.0537	No	0	No
7/6/2023 11:37	0	0.062	0.0542	No	0	No
7/6/2023 11:38	0	0.058	0.0547	No	0	No
7/6/2023 11:39	0	0.057	0.0551	No	0	No
7/6/2023 11:40	0	0.052	0.0553	No	0	No
7/6/2023 11:41	0	0.058	0.0559	No	0	No
7/6/2023 11:42	0	0.064	0.0569	No	0	No
7/6/2023 11:43	0	0.052	0.0567	No	0	No
7/6/2023 11:44	0	0.052	0.0561	No	0	No
7/6/2023 11:45	0	0.057	0.0559	No	0	No
7/6/2023 11:46	0	0.064	0.0564	No	0	No
7/6/2023 11:47	0	0.055	0.0566	No	0	No
7/6/2023 11:48	0	0.052	0.0564	No	0	No
7/6/2023 11:49	0	0.06	0.0569	No	0	No
7/6/2023 11:50	0	0.06	0.0573	No	0	No
7/6/2023 11:51	0	0.058	0.0574	No	0	No
7/6/2023 11:52	0	0.052	0.0567	No	0	No
7/6/2023 11:53	0	0.06	0.0569	No	0	No
7/6/2023 11:54	0	0.072	0.0579	No	0	No
7/6/2023 11:55	0	0.055	0.0581	No	0	No
7/6/2023 11:56	0	0.066	0.0586	No	0	No
7/6/2023 11:57	0	0.052	0.0578	No	0	No
7/6/2023 11:58	0	0.05	0.0577	No	0	No
7/6/2023 11:59	0	0.047	0.0573	No	0	No
7/6/2023 12:00	0	0.049	0.0568	No	0	No
7/6/2023 12:01	0	0.048	0.0557	No	0	No
7/6/2023 12:02	0	0.05	0.0554	No	0	No
7/6/2023 12:03	0	0.065	0.0563	No	0	No
7/6/2023 12:04	0	0.051	0.0557	No	0	No
7/6/2023 12:05	0	0.047	0.0548	No	0	No
7/6/2023 12:06	0	0.047	0.0541	No	0	No
7/6/2023 12:07	0	0.052	0.0541	No	0	No
7/6/2023 12:08	0	0.045	0.0531	No	0	No
7/6/2023 12:09	0	0.048	0.0515	No	0	No
7/6/2023 12:10	0	0.048	0.051	No	0	No
7/6/2023 12:11	0	0.05	0.0499	No	0	No
7/6/2023 12:12	0	0.047	0.0496	No	0	No
7/6/2023 12:13	0	0.048	0.0495	No	0	No
7/6/2023 12:14	0	0.049	0.0496	No	0	No
7/6/2023 12:15	0	0.066	0.0507	No	0	No
7/6/2023 12:16	0	0.207	0.0613	No	0	No
7/6/2023 12:17	0	0.185	0.0703	No	0	No
7/6/2023 12:18	0	0.084	0.0716	No	0	No
7/6/2023 12:19	0	0.063	0.0724	No	0	No
7/6/2023 12:20	0	0.085	0.0749	No	0	No
7/6/2023 12:21	0	0.076	0.0769	No	0	No

Downwind Station						
Time	Instantaneous VOC (ppm)	Instantaneous Mass Conc. Total (mg/m ³)	Mass Conc. Total mg/m ³ AVG 15m (mg/m ³)	Dust Exceedance	VOC ppm AVG 15m (ppm)	VOC Exceedance
7/6/2023 12:22	0	0.086	0.0791	No	0	No
7/6/2023 12:23	0	0.082	0.0816	No	0	No
7/6/2023 12:24	0	0.159	0.089	No	0	No
7/6/2023 12:25	0	0.095	0.0921	No	0	No
7/6/2023 12:26	0	0.126	0.0972	No	0	No
7/6/2023 12:27	0	0.123	0.1023	No	0	No
7/6/2023 12:28	0	0.122	0.1072	No	0	No
7/6/2023 12:29	0	0.108	0.1111	No	0	No
7/6/2023 12:30	0	0.066	0.1111	No	0	No
7/6/2023 12:31	0	0.053	0.1009	No	0	No
7/6/2023 12:32	0	0.076	0.0936	No	0	No
7/6/2023 12:33	0	0.063	0.0922	No	0	No
7/6/2023 12:34	0	0.072	0.0928	No	0	No
7/6/2023 12:35	0	0.046	0.0902	No	0	No
7/6/2023 12:36	0	0.047	0.0883	No	0	No
7/6/2023 12:37	0	0.05	0.0859	No	0	No
7/6/2023 12:38	0	0.057	0.0842	No	0	No
7/6/2023 12:39	0	0.048	0.0768	No	0	No
7/6/2023 12:40	0	0.06	0.0745	No	0	No
7/6/2023 12:41	0	0.045	0.0691	No	0	No
7/6/2023 12:42	0	0.044	0.0638	No	0	No
7/6/2023 12:43	0	0.048	0.0589	No	0	No
7/6/2023 12:44	0	0.047	0.0548	No	0	No
7/6/2023 12:45	0	0.051	0.0538	No	0	No
7/6/2023 12:46	0	0.07	0.0549	No	0	No
7/6/2023 12:47	0	0.059	0.0538	No	0	No
7/6/2023 12:48	0	0.084	0.0552	No	0	No
7/6/2023 12:49	0	0.059	0.0543	No	0	No
7/6/2023 12:50	0	0.047	0.0544	No	0	No
7/6/2023 12:51	0	0.074	0.0562	No	0	No
7/6/2023 12:52	0	0.086	0.0586	No	0	No
7/6/2023 12:53	0	0.085	0.0605	No	0	No
7/6/2023 12:54	0	0.067	0.0617	No	0	No
7/6/2023 12:55	0	0.047	0.0609	No	0	No
7/6/2023 12:56	0	0.045	0.0609	No	0	No
7/6/2023 12:57	0	0.046	0.061	No	0	No
7/6/2023 12:58	0	0.043	0.0607	No	0	No
7/6/2023 12:59	0	0.043	0.0604	No	0	No
7/6/2023 13:00	0	0.045	0.06	No	0	No
7/6/2023 13:01	0	0.042	0.0581	No	0	No
7/6/2023 13:02	0	0.048	0.0574	No	0	No
7/6/2023 13:03	0	0.044	0.0547	No	0	No
7/6/2023 13:04	0	0.049	0.0541	No	0	No
7/6/2023 13:05	0	0.047	0.0541	No	0	No
7/6/2023 13:06	0	0.045	0.0521	No	0	No
7/6/2023 13:07	0	0.043	0.0493	No	0	No
7/6/2023 13:08	0	0.043	0.0465	No	0	No
7/6/2023 13:09	0	0.044	0.0449	No	0	No
7/6/2023 13:10	0	0.064	0.0461	No	0	No
7/6/2023 13:11	0	0.044	0.046	No	0	No
7/6/2023 13:12	0	0.043	0.0458	No	0	No
7/6/2023 13:13	0	0.04	0.0456	No	0	No
7/6/2023 13:14	0	0.04	0.0454	No	0	No
7/6/2023 13:15	0	0.04	0.0451	No	0	No
7/6/2023 13:16	0	0.043	0.0451	No	0	No

Downwind Station						
Time	Instantaneous VOC (ppm)	Instantaneous Mass Conc. Total (mg/m ³)	Mass Conc. Total mg/m ³ AVG 15m (mg/m ³)	Dust Exceedance	VOC ppm AVG 15m (ppm)	VOC Exceedance
7/6/2023 13:17	0	0.043	0.0448	No	0	No
7/6/2023 13:18	0	0.043	0.0447	No	0	No
7/6/2023 13:19	0	0.041	0.0442	No	0	No
7/6/2023 13:20	0	0.041	0.0438	No	0	No
7/6/2023 13:21	0	0.036	0.0432	No	0	No
7/6/2023 13:22	0	0.042	0.0431	No	0	No
7/6/2023 13:23	0	0.041	0.043	No	0	No
7/6/2023 13:24	0	0.045	0.0431	No	0	No
7/6/2023 13:25	0	0.046	0.0419	No	0	No
7/6/2023 13:26	0	0.045	0.0419	No	0	No
7/6/2023 13:27	0	0.044	0.042	No	0	No
7/6/2023 13:28	0	0.042	0.0421	No	0	No
7/6/2023 13:29	0	0.042	0.0423	No	0	No
7/6/2023 13:30	0	0.039	0.0422	No	0	No
7/6/2023 13:31	0	0.041	0.0421	No	0	No
7/6/2023 13:32	0	0.04	0.0419	No	0	No
7/6/2023 13:33	0	0.042	0.0418	No	0	No
7/6/2023 13:34	0	0.04	0.0417	No	0	No
7/6/2023 13:35	0	0.038	0.0415	No	0	No
7/6/2023 13:36	0	0.04	0.0418	No	0	No
7/6/2023 13:37	0	0.041	0.0417	No	0	No
7/6/2023 13:38	0	0.041	0.0417	No	0	No
7/6/2023 13:39	0	0.049	0.042	No	0	No
7/6/2023 13:40	0	0.043	0.0418	No	0	No
7/6/2023 13:41	0	0.044	0.0417	No	0	No
7/6/2023 13:42	0	0.043	0.0417	No	0	No
7/6/2023 13:43	0	0.041	0.0416	No	0	No
7/6/2023 13:44	0	0.041	0.0415	No	0	No
7/6/2023 13:45	0	0.037	0.0414	No	0	No
7/6/2023 13:46	0	0.044	0.0416	No	0	No
7/6/2023 13:47	0	0.052	0.0424	No	0	No
7/6/2023 13:48	0	0.072	0.0444	No	0	No
7/6/2023 13:49	0	0.058	0.046	No	0	No
7/6/2023 13:50	0	0.057	0.047	No	0	No
7/6/2023 13:51	0	0.054	0.048	No	0	No
7/6/2023 13:52	0.287	0.04	0.048	No	0	No
7/6/2023 13:53	0	0.046	0.048	No	0	No
7/6/2023 13:54	0	0.057	0.049	No	0	No
7/6/2023 13:55	0	0.053	0.049	No	0	No
7/6/2023 13:56	0	0.022	0.048	No	0	No
7/6/2023 13:57	0	0.024	0.047	No	0	No
7/6/2023 13:58	0	0.016	0.045	No	0	No
7/6/2023 13:59	0	0.005	0.042	No	0	No
7/6/2023 14:00	0	0.003	0.040	No	0	No
7/6/2023 14:01	0	0	0.037	No	0	No
7/6/2023 14:02	0	0.002	0.034	No	0	No
7/6/2023 14:03	0	0	0.029	No	0	No
7/6/2023 14:04	0	0.027	0.027	No	0	No
7/6/2023 14:05	0	0.004	0.024	No	0	No
7/6/2023 14:06	0	0	0.020	No	0	No
7/6/2023 14:07	0	0.003	0.017	No	0	No
7/6/2023 14:08	0	0.081	0.020	No	0	No
7/6/2023 14:09	0	0.028	0.018	No	0	No
7/6/2023 14:10	0	0.003	0.015	No	0	No
7/6/2023 14:11	0	0.003	0.013	No	0	No

Downwind Station						
Time	Instantaneous VOC (ppm)	Instantaneous Mass Conc. Total (mg/m ³)	Mass Conc. Total mg/m ³ AVG 15m (mg/m ³)	Dust Exceedance	VOC ppm AVG 15m (ppm)	VOC Exceedance
7/6/2023 14:12	0	0.001	0.012	No	0	No
7/6/2023 14:13	0	0.003	0.011	No	0	No
7/6/2023 14:14	0	0.003	0.011	No	0	No
7/6/2023 14:15	0	0.002	0.011	No	0	No
7/6/2023 14:16	0	0.004	0.011	No	0	No
7/6/2023 14:17	0	0.01	0.011	No	0	No
7/6/2023 14:18	0	0.002	0.012	No	0	No
7/6/2023 14:19	0	0.016	0.011	No	0	No
7/6/2023 14:20	0	0.014	0.012	No	0	No
7/6/2023 14:21	0	0.004	0.012	No	0	No
7/6/2023 14:22	0	0.006	0.012	No	0	No
7/6/2023 14:23	0	0.008	0.007	No	0	No
7/6/2023 14:24	0	0.002	0.005	No	0	No
7/6/2023 14:25	0	0.008	0.006	No	0	No
7/6/2023 14:26	0	0.004	0.006	No	0	No
7/6/2023 14:27	0	0.002	0.006	No	0	No
7/6/2023 14:28	0	0.06	0.010	No	0	No
7/6/2023 14:29	0	0.026	0.011	No	0	No
7/6/2023 14:30	0	0.018	0.012	No	0	No
7/6/2023 14:31	0	0.003	0.012	No	0	No
7/6/2023 14:32	0	0.006	0.012	No	0	No
7/6/2023 14:33	0	0.002	0.012	No	0	No
7/6/2023 14:34	0	0.002	0.011	No	0	No
7/6/2023 14:35	0	0.008	0.011	No	0	No
7/6/2023 14:36	0	0.007	0.011	No	0	No
7/6/2023 14:37	0	0.011	0.011	No	0	No
7/6/2023 14:38	0	0.015	0.012	No	0	No
7/6/2023 14:39	0	0.009	0.012	No	0	No
7/6/2023 14:40	0	0.004	0.012	No	0	No
7/6/2023 14:41	0	0.009	0.012	No	0	No
7/6/2023 14:42	0	0.02	0.013	No	0	No
7/6/2023 14:43	0	0.008	0.010	No	0	No