



Daily Activity Report

Seton Brilla Charter School
1956 Jerome Avenue, Bronx, NY
BCP No. C203152

General Site Information

| | |
|-------------------------|---|
| Date: | Tuesday, July 25, 2023 |
| Weather: | Cloudy, 71-87° |
| Wind Direction/Speed: | SW @ 0-10 mph |
| AKRF Personnel on Site: | Madelyn Fleming, Patrick Diggins |
| AKRF Equipment on Site: | Mini RAE 3000 Photoionization Detector [(PID) x1], Roving SidePak Particulate Monitor (1), 2 Fixed Air Monitoring Stations [DustTrak Aerosol Monitors (x2) & MiniRAE 3000 PIDs (x2)]. |
| Visitors: | None |

Contractor Information

| Contracting Company | Main Personnel | Equipment |
|---------------------|----------------|----------------|
| Casino Construction | Carlos | Mini-excavator |

Description and Location of Work Activities Performed

- 1) The Site was not active, and the composite cover system remains intact.
- 2) AKRF collected one post-remedial sidewall soil sample (SW-17) on the northeastern wall of the Site.

| Destination Facility | Daily Trucks | Total Trucks | Daily Approx. Cubic Yds | Total Approx. Cubic Yds | Total Site Loads | Total Approximate Cubic Yards |
|---------------------------------------|--------------|--------------|-------------------------|-------------------------|------------------|-------------------------------|
| Clean Earth Carteret | 0 | 112 | 0 | 2,240 | 210 | 4,200 |
| Clean Earth Southeastern Pennsylvania | 0 | 67 | 0 | 1,340 | | |
| Clean Earth Bethlehem | 0 | 31 | 0 | 620 | | |
| Concrete Disposal | 0 | 27 | 0 | 540 | | |
| N/A | 0 | 0 | 0 | 0 | | |

CAMP Air Monitoring Results

| CAMP Station | UPWIND | | | DOWNWIND | | |
|--|--------|-----------------------|-----------------------|----------|-----------------------|-----------------------|
| Odors: | None | Number of Exceedances | Time of Exceedance(s) | None | Number of Exceedances | Time of Exceedance(s) |
| VOC Action Level Exceedance(s): | None | 0 | N/A | None | 0 | N/A |
| Particulate Action Level Exceedance(s): | None | 0 | N/A | None | 0 | N/A |
| Maximum VOC Level (15 min ppm): | 0.937 | 0 | N/A | 0.000 | 0 | N/A |
| Maximum Particulate Level (15 min mg/m ³): | 0.0387 | 0 | N/A | 0.057 | 0 | N/A |

Notes: CAMP was performed at the Site throughout the morning, and no particulate or VOC exceedances were detected.

Additional Information

| | |
|---|---|
| Planned Work Activity for Following Day/Week: | 1) Pour concrete slab over remaining footprint. |
| Comments: | AKRF will not be on Site tomorrow, July 26, 2023 as CAMP monitoring will not be needed for Site activities. |

Site Map

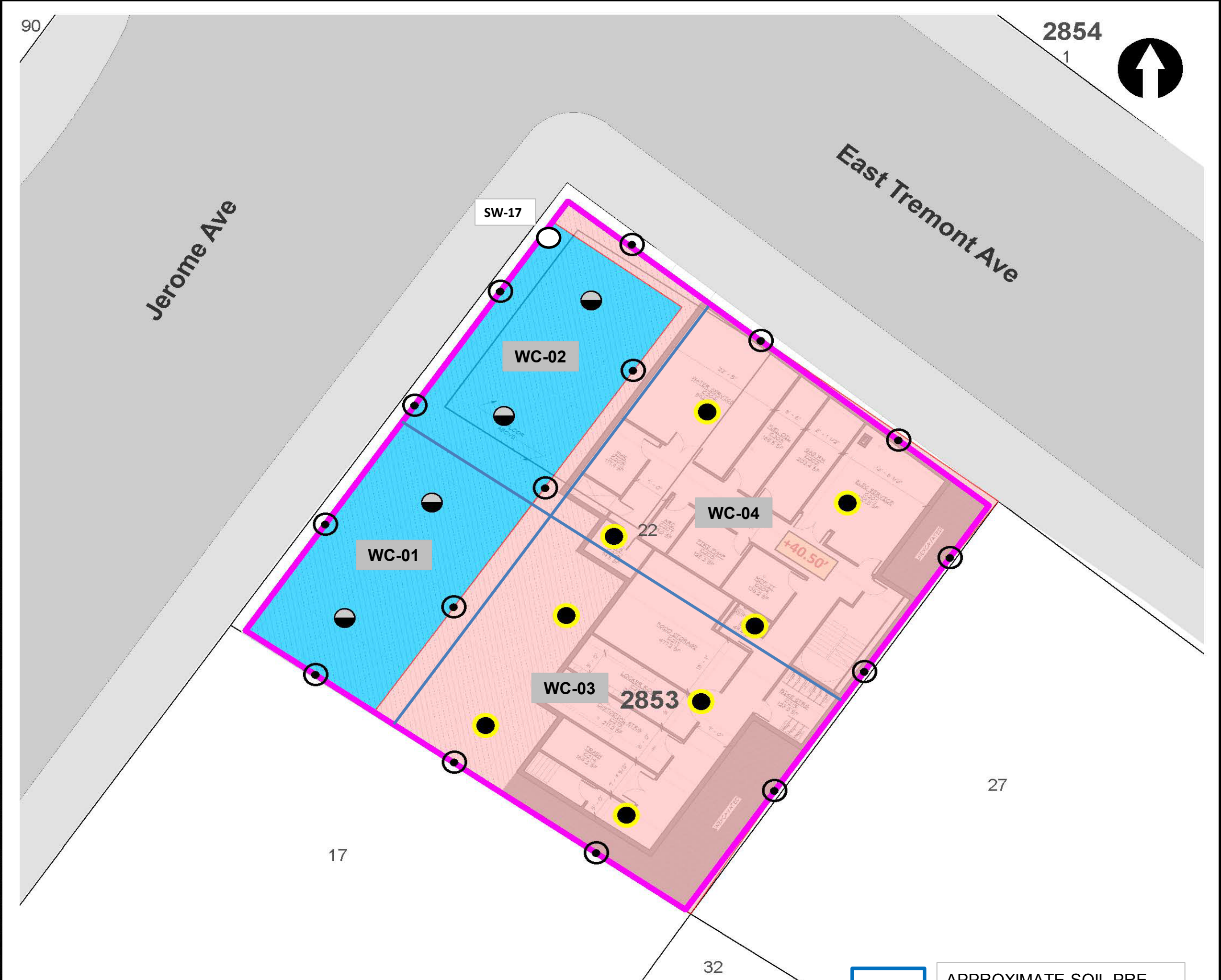

LEGEND

- PROJECT SITE BOUNDARY
- LOT BOUNDARY AND TAX LOT NUMBER
- 2853** BLOCK NUMBER
- REMEDIAL EXCAVATION TO APPROXIMATELY TWO FEET BELOW EXISTING GRADE
- REMEDIAL EXCAVATION TO GROUNDWATER (SOURCE AREA)

- CONFIRMATION DOCUMENTATION BOTTOM SAMPLE
- SOURCE AREA DOCUMENTATION BOTTOM SAMPLE
- DOCUMENTATION SIDEWALL SAMPLE

NOTE
 REMEDIAL EXCAVATION WILL INCLUDE REMOVAL OF APPROXIMATELY 1,280 TONS (850 CUBIC YARDS) OF SOURCE MATERIAL ASSOCIATED WITH NYSDEC SPILL NO. 2103719 AND APPROXIMATELY 860 TONS (570 CUBIC YARDS) OF SOIL/FILL FROM THE UPPER 2 FEET SITE-WIDE.



APPROXIMATE SOIL PRE-CHARACTERIZATION GRID

Map Source:
 NYCDCP (NYC Dept. of City Planning) GIS database

© 2021 AKRF. W:\Projects\210024 - 1956 JEROME AVENUE\Technical\GIS and Graphics\AR\RAW\210024 Figure 9 Proposed Remedial Excavation and Documentation Sample Location Plan.mxd 10/25/2021 2:03:38 PM iszalus



440 Park Avenue South, New York, NY 10016

1956 Jerome Avenue
 Bronx, New York

**TRACK 4 CLEANUP AND DOCUMENTATION
 SAMPLE LOCATION PLAN**

DATE
04/29/2022

PROJECT NO.
210024

FIGURE
11

Site Photographs

Photograph 1 - Site conditions at the beginning of the work day in Grid WC-03 .View facing south.



Photograph 2 - Sidewall sampling for SW-17 in Grid WC-02. View facing down and northeast.



Upwind Station

| Time | Instaneous VOC (ppm) | Instaneous Mass Conc. Total (mg/m ³) | Mass Conc. Total mg/m ³ AVG 15m (mg/m ³) | Dust Exceedance | VOC ppm AVG 15m (ppm) | VOC Exceedance |
|----------------|----------------------|--|---|-----------------|-----------------------|----------------|
| 7/25/2023 7:07 | 0 | 0.028 | 0.028 | No | 0 | No |
| 7/25/2023 7:08 | 0 | 0.028 | 0.028 | No | 0 | No |
| 7/25/2023 7:09 | 0 | 0.028 | 0.028 | No | 0 | No |
| 7/25/2023 7:10 | 0 | 0.027 | 0.0278 | No | 0 | No |
| 7/25/2023 7:11 | 0 | 0.027 | 0.0276 | No | 0 | No |
| 7/25/2023 7:12 | 0 | 0.027 | 0.0275 | No | 0 | No |
| 7/25/2023 7:13 | 0 | 0.028 | 0.0276 | No | 0 | No |
| 7/25/2023 7:14 | 0 | 0.028 | 0.0276 | No | 0 | No |
| 7/25/2023 7:15 | 0 | 0.028 | 0.0277 | No | 0 | No |
| 7/25/2023 7:16 | 0 | 0.029 | 0.0278 | No | 0 | No |
| 7/25/2023 7:17 | 0 | 0.028 | 0.0278 | No | 0 | No |
| 7/25/2023 7:18 | 0 | 0.029 | 0.0279 | No | 0 | No |
| 7/25/2023 7:19 | 0 | 0.028 | 0.0279 | No | 0 | No |
| 7/25/2023 7:20 | 0 | 0.029 | 0.028 | No | 0 | No |
| 7/25/2023 7:21 | 0 | 0.028 | 0.028 | No | 0 | No |
| 7/25/2023 7:22 | 0 | 0.029 | 0.0281 | No | 0 | No |
| 7/25/2023 7:23 | 0 | 0.028 | 0.0281 | No | 0 | No |
| 7/25/2023 7:24 | 0 | 0.028 | 0.0281 | No | 0 | No |
| 7/25/2023 7:25 | 0 | 0.028 | 0.0281 | No | 0 | No |
| 7/25/2023 7:26 | 0 | 0.028 | 0.0282 | No | 0 | No |
| 7/25/2023 7:27 | 0 | 0.028 | 0.0283 | No | 0 | No |
| 7/25/2023 7:28 | 0 | 0.028 | 0.0283 | No | 0 | No |
| 7/25/2023 7:29 | 0 | 0.028 | 0.0283 | No | 0 | No |
| 7/25/2023 7:30 | 0 | 0.027 | 0.0282 | No | 0 | No |
| 7/25/2023 7:31 | 0 | 0.027 | 0.0281 | No | 0 | No |
| 7/25/2023 7:32 | 0 | 0.027 | 0.028 | No | 0 | No |
| 7/25/2023 7:33 | 0 | 0.027 | 0.0279 | No | 0 | No |
| 7/25/2023 7:34 | 0 | 0.027 | 0.0278 | No | 0 | No |
| 7/25/2023 7:35 | 0 | 0.027 | 0.0277 | No | 0 | No |
| 7/25/2023 7:36 | 0 | 0.027 | 0.0276 | No | 0 | No |
| 7/25/2023 7:37 | 0 | 0.027 | 0.0275 | No | 0 | No |
| 7/25/2023 7:38 | 0 | 0.027 | 0.0274 | No | 0 | No |
| 7/25/2023 7:39 | 0 | 0.027 | 0.0273 | No | 0 | No |
| 7/25/2023 7:40 | 0 | 0.027 | 0.0273 | No | 0 | No |
| 7/25/2023 7:41 | 0 | 0.027 | 0.0272 | No | 0 | No |
| 7/25/2023 7:42 | 0 | 0.028 | 0.0272 | No | 0 | No |
| 7/25/2023 7:43 | 0 | 0.028 | 0.0272 | No | 0 | No |
| 7/25/2023 7:44 | 0 | 0.028 | 0.0272 | No | 0 | No |
| 7/25/2023 7:45 | 0 | 0.028 | 0.0273 | No | 0 | No |
| 7/25/2023 7:46 | 0 | 0.029 | 0.0274 | No | 0 | No |
| 7/25/2023 7:47 | 0 | 0.029 | 0.0275 | No | 0 | No |
| 7/25/2023 7:48 | 0 | 0.028 | 0.0276 | No | 0 | No |
| 7/25/2023 7:49 | 0 | 0.028 | 0.0277 | No | 0 | No |
| 7/25/2023 7:50 | 0 | 0.027 | 0.0277 | No | 0 | No |
| 7/25/2023 7:51 | 0 | 0.027 | 0.0277 | No | 0 | No |
| 7/25/2023 7:52 | 0 | 0.028 | 0.0277 | No | 0 | No |
| 7/25/2023 7:53 | 0 | 0.028 | 0.0278 | No | 0 | No |
| 7/25/2023 7:54 | 0 | 0.028 | 0.0279 | No | 0 | No |
| 7/25/2023 7:55 | 0 | 0.029 | 0.028 | No | 0 | No |
| 7/25/2023 7:56 | 0 | 0.028 | 0.0281 | No | 0 | No |
| 7/25/2023 7:57 | 0 | 0.028 | 0.0281 | No | 0 | No |
| 7/25/2023 7:58 | 0 | 0.028 | 0.0281 | No | 0 | No |

Upwind Station

| Time | Instantaneous VOC (ppm) | Instantaneous Mass Conc. Total (mg/m ³) | Mass Conc. Total mg/m ³ AVG 15m (mg/m ³) | Dust Exceedance | VOC ppm AVG 15m (ppm) | VOC Exceedance |
|----------------|-------------------------|---|---|-----------------|-----------------------|----------------|
| 7/25/2023 7:59 | 0 | 0.029 | 0.0281 | No | 0 | No |
| 7/25/2023 8:00 | 0 | 0.03 | 0.0283 | No | 0 | No |
| 7/25/2023 8:01 | 0 | 0.029 | 0.0283 | No | 0 | No |
| 7/25/2023 8:02 | 0 | 0.029 | 0.0283 | No | 0 | No |
| 7/25/2023 8:03 | 0 | 0.028 | 0.0283 | No | 0 | No |
| 7/25/2023 8:04 | 0 | 0.028 | 0.0283 | No | 0 | No |
| 7/25/2023 8:05 | 0 | 0.028 | 0.0283 | No | 0 | No |
| 7/25/2023 8:06 | 0 | 0.029 | 0.0285 | No | 0 | No |
| 7/25/2023 8:07 | 0 | 0.031 | 0.0287 | No | 0 | No |
| 7/25/2023 8:08 | 0 | 0.03 | 0.0288 | No | 0 | No |
| 7/25/2023 8:09 | 0 | 0.029 | 0.0289 | No | 0 | No |
| 7/25/2023 8:10 | 0 | 0.028 | 0.0288 | No | 0 | No |
| 7/25/2023 8:11 | 0 | 0.028 | 0.0288 | No | 0 | No |
| 7/25/2023 8:12 | 0 | 0.027 | 0.0287 | No | 0 | No |
| 7/25/2023 8:13 | 0 | 0.027 | 0.0287 | No | 0 | No |
| 7/25/2023 8:14 | 0 | 0.028 | 0.0286 | No | 0 | No |
| 7/25/2023 8:15 | 0 | 0.027 | 0.0284 | No | 0 | No |
| 7/25/2023 8:16 | 0 | 0.027 | 0.0283 | No | 0 | No |
| 7/25/2023 8:17 | 0 | 0.028 | 0.0282 | No | 0 | No |
| 7/25/2023 8:18 | 0 | 0.028 | 0.0282 | No | 0 | No |
| 7/25/2023 8:19 | 0 | 0.027 | 0.0281 | No | 0 | No |
| 7/25/2023 8:20 | 0 | 0.027 | 0.0281 | No | 0 | No |
| 7/25/2023 8:21 | 0 | 0.028 | 0.028 | No | 0 | No |
| 7/25/2023 8:22 | 0 | 0.027 | 0.0277 | No | 0 | No |
| 7/25/2023 8:23 | 0 | 0.027 | 0.0275 | No | 0 | No |
| 7/25/2023 8:24 | 0 | 0.026 | 0.0273 | No | 0 | No |
| 7/25/2023 8:25 | 0 | 0.027 | 0.0273 | No | 0 | No |
| 7/25/2023 8:26 | 0 | 0.027 | 0.0272 | No | 0 | No |
| 7/25/2023 8:27 | 0 | 0.027 | 0.0272 | No | 0 | No |
| 7/25/2023 8:28 | 0 | 0.027 | 0.0272 | No | 0 | No |
| 7/25/2023 8:29 | 0 | 0.027 | 0.0271 | No | 0 | No |
| 7/25/2023 8:30 | 0 | 0.028 | 0.0272 | No | 0 | No |
| 7/25/2023 8:31 | 0 | 0.027 | 0.0272 | No | 0 | No |
| 7/25/2023 8:32 | 0 | 0.026 | 0.0271 | No | 0 | No |
| 7/25/2023 8:33 | 0 | 0.026 | 0.0269 | No | 0 | No |
| 7/25/2023 8:34 | 0 | 0.027 | 0.0269 | No | 0 | No |
| 7/25/2023 8:35 | 0 | 0.027 | 0.0269 | No | 0 | No |
| 7/25/2023 8:36 | 0 | 0.026 | 0.0268 | No | 0 | No |
| 7/25/2023 8:37 | 0 | 0.026 | 0.0267 | No | 0 | No |
| 7/25/2023 8:38 | 0 | 0.026 | 0.0267 | No | 0 | No |
| 7/25/2023 8:39 | 0 | 0.027 | 0.0267 | No | 0 | No |
| 7/25/2023 8:40 | 0 | 0.028 | 0.0268 | No | 0 | No |
| 7/25/2023 8:41 | 0 | 0.027 | 0.0268 | No | 0 | No |
| 7/25/2023 8:42 | 0 | 0.027 | 0.0268 | No | 0 | No |
| 7/25/2023 8:43 | 0 | 0.026 | 0.0267 | No | 0 | No |
| 7/25/2023 8:44 | 0 | 0.026 | 0.0267 | No | 0 | No |
| 7/25/2023 8:45 | 0 | 0.026 | 0.0265 | No | 0 | No |
| 7/25/2023 8:46 | 0 | 0.026 | 0.0265 | No | 0 | No |
| 7/25/2023 8:47 | 0 | 0.026 | 0.0265 | No | 0 | No |
| 7/25/2023 8:48 | 0 | 0.026 | 0.0265 | No | 0 | No |
| 7/25/2023 8:49 | 0 | 0.025 | 0.0263 | No | 0 | No |
| 7/25/2023 8:50 | 0 | 0.025 | 0.0262 | No | 0 | No |

Upwind Station

| Time | Instaneous VOC (ppm) | Instaneous Mass Conc. Total (mg/m³) | Mass Conc. Total mg/m³ AVG 15m (mg/m³) | Dust Exceedance | VOC ppm AVG 15m (ppm) | VOC Exceedance |
|----------------|----------------------|-------------------------------------|--|-----------------|-----------------------|----------------|
| 7/25/2023 8:51 | 0 | 0.025 | 0.0261 | No | 0 | No |
| 7/25/2023 8:52 | 0 | 0.026 | 0.0261 | No | 0 | No |
| 7/25/2023 8:53 | 0 | 0.025 | 0.0261 | No | 0 | No |
| 7/25/2023 8:54 | 0 | 0.025 | 0.0259 | No | 0 | No |
| 7/25/2023 8:55 | 0 | 0.026 | 0.0258 | No | 0 | No |
| 7/25/2023 8:56 | 0 | 0.026 | 0.0257 | No | 0 | No |
| 7/25/2023 8:57 | 0 | 0.025 | 0.0256 | No | 0 | No |
| 7/25/2023 8:58 | 0 | 0.026 | 0.0256 | No | 0 | No |
| 7/25/2023 8:59 | 0 | 0.026 | 0.0256 | No | 0 | No |
| 7/25/2023 9:00 | 0 | 0.026 | 0.0256 | No | 0 | No |
| 7/25/2023 9:01 | 0 | 0.026 | 0.0256 | No | 0 | No |
| 7/25/2023 9:02 | 0 | 0.025 | 0.0255 | No | 0 | No |
| 7/25/2023 9:03 | 0 | 0.025 | 0.0255 | No | 0 | No |
| 7/25/2023 9:04 | 0 | 0.025 | 0.0255 | No | 0 | No |
| 7/25/2023 9:05 | 0 | 0.024 | 0.0254 | No | 0 | No |
| 7/25/2023 9:06 | 0 | 0.025 | 0.0254 | No | 0 | No |
| 7/25/2023 9:07 | 0 | 0.026 | 0.0254 | No | 0 | No |
| 7/25/2023 9:08 | 0 | 0.027 | 0.0255 | No | 0 | No |
| 7/25/2023 9:09 | 0 | 0.026 | 0.0256 | No | 0 | No |
| 7/25/2023 9:10 | 0 | 0.025 | 0.0255 | No | 0 | No |
| 7/25/2023 9:11 | 0 | 0.024 | 0.0254 | No | 0 | No |
| 7/25/2023 9:12 | 0 | 0.024 | 0.0253 | No | 0 | No |
| 7/25/2023 9:13 | 0 | 0.023 | 0.0251 | No | 0 | No |
| 7/25/2023 9:14 | 0 | 0.024 | 0.025 | No | 0 | No |
| 7/25/2023 9:15 | 0 | 0.025 | 0.0249 | No | 0 | No |
| 7/25/2023 9:16 | 0 | 0.025 | 0.0249 | No | 0 | No |
| 7/25/2023 9:17 | 0 | 0.024 | 0.0248 | No | 0 | No |
| 7/25/2023 9:18 | 0 | 0.023 | 0.0247 | No | 0 | No |
| 7/25/2023 9:19 | 0 | 0.023 | 0.0245 | No | 0 | No |
| 7/25/2023 9:20 | 0 | 0.023 | 0.0245 | No | 0 | No |
| 7/25/2023 9:21 | 0 | 0.024 | 0.0244 | No | 0 | No |
| 7/25/2023 9:22 | 0 | 0.024 | 0.0243 | No | 0 | No |
| 7/25/2023 9:23 | 0 | 0.025 | 0.0241 | No | 0 | No |
| 7/25/2023 9:24 | 0 | 0.024 | 0.024 | No | 0 | No |
| 7/25/2023 9:25 | 0 | 0.025 | 0.024 | No | 0 | No |
| 7/25/2023 9:26 | 0 | 0.025 | 0.0241 | No | 0 | No |
| 7/25/2023 9:27 | 0 | 0.024 | 0.0241 | No | 0 | No |
| 7/25/2023 9:28 | 0 | 0.024 | 0.0241 | No | 0 | No |
| 7/25/2023 9:29 | 0 | 0.024 | 0.0241 | No | 0 | No |
| 7/25/2023 9:30 | 0 | 0.023 | 0.024 | No | 0 | No |
| 7/25/2023 9:31 | 0 | 0.024 | 0.0239 | No | 0 | No |
| 7/25/2023 9:32 | 0 | 0.024 | 0.0239 | No | 0 | No |
| 7/25/2023 9:33 | 0 | 0.028 | 0.0243 | No | 0 | No |
| 7/25/2023 9:34 | 0 | 0.026 | 0.0245 | No | 0 | No |
| 7/25/2023 9:35 | 0 | 0.025 | 0.0246 | No | 0 | No |
| 7/25/2023 9:36 | 0 | 0.024 | 0.0246 | No | 0 | No |
| 7/25/2023 9:37 | 0 | 0.024 | 0.0246 | No | 0 | No |
| 7/25/2023 9:38 | 0 | 0.024 | 0.0245 | No | 0 | No |
| 7/25/2023 9:39 | 0 | 0.024 | 0.0245 | No | 0 | No |
| 7/25/2023 9:40 | 0 | 0.024 | 0.0245 | No | 0 | No |
| 7/25/2023 9:41 | 0 | 0.024 | 0.0244 | No | 0 | No |
| 7/25/2023 9:42 | 0.008 | 0.024 | 0.0244 | No | 0.0005 | No |

Upwind Station

| Time | Instaneous VOC (ppm) | Instaneous Mass Conc. Total (mg/m ³) | Mass Conc. Total mg/m ³ AVG 15m (mg/m ³) | Dust Exceedance | VOC ppm AVG 15m (ppm) | VOC Exceedance |
|-----------------|----------------------|--|---|-----------------|-----------------------|----------------|
| 7/25/2023 9:43 | 0.019 | 0.024 | 0.0244 | No | 0.0018 | No |
| 7/25/2023 9:44 | 0.031 | 0.024 | 0.0244 | No | 0.0039 | No |
| 7/25/2023 9:45 | 0.034 | 0.024 | 0.0245 | No | 0.0061 | No |
| 7/25/2023 9:46 | 0.04 | 0.024 | 0.0245 | No | 0.0088 | No |
| 7/25/2023 9:47 | 0.043 | 0.024 | 0.0245 | No | 0.0117 | No |
| 7/25/2023 9:48 | 0.056 | 0.024 | 0.0242 | No | 0.0154 | No |
| 7/25/2023 9:49 | 0.059 | 0.025 | 0.0241 | No | 0.0193 | No |
| 7/25/2023 9:50 | 0.069 | 0.025 | 0.0241 | No | 0.0239 | No |
| 7/25/2023 9:51 | 0.078 | 0.025 | 0.0242 | No | 0.0291 | No |
| 7/25/2023 9:52 | 0.087 | 0.025 | 0.0243 | No | 0.0349 | No |
| 7/25/2023 9:53 | 0.099 | 0.025 | 0.0243 | No | 0.0415 | No |
| 7/25/2023 9:54 | 0.106 | 0.024 | 0.0243 | No | 0.0486 | No |
| 7/25/2023 9:55 | 0.116 | 0.025 | 0.0244 | No | 0.0563 | No |
| 7/25/2023 9:56 | 0.122 | 0.025 | 0.0245 | No | 0.0645 | No |
| 7/25/2023 9:57 | 0.128 | 0.025 | 0.0245 | No | 0.0725 | No |
| 7/25/2023 9:58 | 0.139 | 0.025 | 0.0246 | No | 0.0805 | No |
| 7/25/2023 9:59 | 0.144 | 0.025 | 0.0247 | No | 0.088 | No |
| 7/25/2023 10:00 | 0.152 | 0.025 | 0.0247 | No | 0.0959 | No |
| 7/25/2023 10:01 | 0.158 | 0.026 | 0.0249 | No | 0.1037 | No |
| 7/25/2023 10:02 | 0.166 | 0.026 | 0.025 | No | 0.1119 | No |
| 7/25/2023 10:03 | 0.167 | 0.026 | 0.0251 | No | 0.1193 | No |
| 7/25/2023 10:04 | 0.172 | 0.027 | 0.0253 | No | 0.1269 | No |
| 7/25/2023 10:05 | 0.171 | 0.027 | 0.0254 | No | 0.1337 | No |
| 7/25/2023 10:06 | 0.185 | 0.027 | 0.0255 | No | 0.1408 | No |
| 7/25/2023 10:07 | 0.186 | 0.027 | 0.0257 | No | 0.1474 | No |
| 7/25/2023 10:08 | 0.19 | 0.027 | 0.0258 | No | 0.1535 | No |
| 7/25/2023 10:09 | 0.198 | 0.026 | 0.0259 | No | 0.1596 | No |
| 7/25/2023 10:10 | 0.212 | 0.026 | 0.026 | No | 0.166 | No |
| 7/25/2023 10:11 | 0.217 | 0.026 | 0.0261 | No | 0.1723 | No |
| 7/25/2023 10:12 | 0.229 | 0.026 | 0.0261 | No | 0.1791 | No |
| 7/25/2023 10:13 | 0.237 | 0.026 | 0.0262 | No | 0.1856 | No |
| 7/25/2023 10:14 | 0.246 | 0.026 | 0.0263 | No | 0.1924 | No |
| 7/25/2023 10:15 | 0.249 | 0.026 | 0.0263 | No | 0.1989 | No |
| 7/25/2023 10:16 | 0.257 | 0.027 | 0.0264 | No | 0.2055 | No |
| 7/25/2023 10:17 | 0.266 | 0.027 | 0.0265 | No | 0.2121 | No |
| 7/25/2023 10:18 | 0.273 | 0.027 | 0.0265 | No | 0.2192 | No |
| 7/25/2023 10:19 | 0.276 | 0.027 | 0.0265 | No | 0.2261 | No |
| 7/25/2023 10:20 | 0.28 | 0.027 | 0.0265 | No | 0.2334 | No |
| 7/25/2023 10:21 | 0.285 | 0.027 | 0.0265 | No | 0.2401 | No |
| 7/25/2023 10:22 | 0.292 | 0.027 | 0.0265 | No | 0.2471 | No |
| 7/25/2023 10:23 | 0.307 | 0.026 | 0.0265 | No | 0.2549 | No |
| 7/25/2023 10:24 | 0.318 | 0.026 | 0.0265 | No | 0.2629 | No |
| 7/25/2023 10:25 | 0.326 | 0.027 | 0.0265 | No | 0.2705 | No |
| 7/25/2023 10:26 | 0.337 | 0.027 | 0.0266 | No | 0.2785 | No |
| 7/25/2023 10:27 | 0.346 | 0.027 | 0.0267 | No | 0.2863 | No |
| 7/25/2023 10:28 | 0.348 | 0.028 | 0.0268 | No | 0.2937 | No |
| 7/25/2023 10:29 | 0.353 | 0.029 | 0.027 | No | 0.3009 | No |
| 7/25/2023 10:30 | 0.351 | 0.028 | 0.0271 | No | 0.3077 | No |
| 7/25/2023 10:31 | 0.356 | 0.029 | 0.0273 | No | 0.3143 | No |
| 7/25/2023 10:32 | 0.366 | 0.029 | 0.0274 | No | 0.3209 | No |
| 7/25/2023 10:33 | 0.375 | 0.029 | 0.0275 | No | 0.3277 | No |
| 7/25/2023 10:34 | 0.377 | 0.029 | 0.0277 | No | 0.3345 | No |

| Upwind Station | | | | | | |
|-----------------|----------------------|--|---|-----------------|-----------------------|----------------|
| Time | Instaneous VOC (ppm) | Instaneous Mass Conc. Total (mg/m ³) | Mass Conc. Total mg/m ³ AVG 15m (mg/m ³) | Dust Exceedance | VOC ppm AVG 15m (ppm) | VOC Exceedance |
| 7/25/2023 10:35 | 0.382 | 0.029 | 0.0278 | No | 0.3413 | No |
| 7/25/2023 10:36 | 0.387 | 0.029 | 0.0279 | No | 0.3481 | No |
| 7/25/2023 10:37 | 0.391 | 0.029 | 0.0281 | No | 0.3547 | No |
| 7/25/2023 10:38 | 0.394 | 0.03 | 0.0283 | No | 0.3605 | No |
| 7/25/2023 10:39 | 0.401 | 0.03 | 0.0286 | No | 0.366 | No |
| 7/25/2023 10:40 | 0.406 | 0.033 | 0.029 | No | 0.3713 | No |
| 7/25/2023 10:41 | 0.415 | 0.031 | 0.0293 | No | 0.3765 | No |
| 7/25/2023 10:42 | 0.423 | 0.03 | 0.0295 | No | 0.3817 | No |
| 7/25/2023 10:43 | 0.434 | 0.03 | 0.0296 | No | 0.3874 | No |
| 7/25/2023 10:44 | 0.435 | 0.03 | 0.0297 | No | 0.3929 | No |
| 7/25/2023 10:45 | 0.443 | 0.03 | 0.0298 | No | 0.399 | No |
| 7/25/2023 10:46 | 0.442 | 0.031 | 0.0299 | No | 0.4047 | No |
| 7/25/2023 10:47 | 0.444 | 0.03 | 0.03 | No | 0.4099 | No |
| 7/25/2023 10:48 | 0.46 | 0.03 | 0.0301 | No | 0.4156 | No |
| 7/25/2023 10:49 | 0.464 | 0.029 | 0.0301 | No | 0.4214 | No |
| 7/25/2023 10:50 | 0.47 | 0.03 | 0.0301 | No | 0.4273 | No |
| 7/25/2023 10:51 | 0.478 | 0.03 | 0.0302 | No | 0.4333 | No |
| 7/25/2023 10:52 | 0.482 | 0.03 | 0.0303 | No | 0.4394 | No |
| 7/25/2023 10:53 | 0.489 | 0.03 | 0.0303 | No | 0.4457 | No |
| 7/25/2023 10:54 | 0.495 | 0.03 | 0.0303 | No | 0.452 | No |
| 7/25/2023 10:55 | 0.502 | 0.03 | 0.0301 | No | 0.4584 | No |
| 7/25/2023 10:56 | 0.512 | 0.03 | 0.03 | No | 0.4649 | No |
| 7/25/2023 10:57 | 0.516 | 0.03 | 0.03 | No | 0.4711 | No |
| 7/25/2023 10:58 | 0.522 | 0.031 | 0.0301 | No | 0.4769 | No |
| 7/25/2023 10:59 | 0.525 | 0.031 | 0.0301 | No | 0.4829 | No |
| 7/25/2023 11:00 | 0.536 | 0.031 | 0.0302 | No | 0.4891 | No |
| 7/25/2023 11:01 | 0.535 | 0.03 | 0.0301 | No | 0.4953 | No |
| 7/25/2023 11:02 | 0.542 | 0.031 | 0.0302 | No | 0.5019 | No |
| 7/25/2023 11:03 | 0.544 | 0.03 | 0.0302 | No | 0.5075 | No |
| 7/25/2023 11:04 | 0.544 | 0.031 | 0.0303 | No | 0.5128 | No |
| 7/25/2023 11:05 | 0.552 | 0.031 | 0.0304 | No | 0.5183 | No |
| 7/25/2023 11:06 | 0.552 | 0.032 | 0.0305 | No | 0.5232 | No |
| 7/25/2023 11:07 | 0.564 | 0.032 | 0.0307 | No | 0.5287 | No |
| 7/25/2023 11:08 | 0.563 | 0.032 | 0.0308 | No | 0.5336 | No |
| 7/25/2023 11:09 | 0.563 | 0.032 | 0.0309 | No | 0.5381 | No |
| 7/25/2023 11:10 | 0.574 | 0.032 | 0.0311 | No | 0.5429 | No |
| 7/25/2023 11:11 | 0.575 | 0.032 | 0.0312 | No | 0.5471 | No |
| 7/25/2023 11:12 | 0.576 | 0.033 | 0.0314 | No | 0.5511 | No |
| 7/25/2023 11:13 | 0.577 | 0.035 | 0.0317 | No | 0.5548 | No |
| 7/25/2023 11:14 | 0.578 | 0.033 | 0.0318 | No | 0.5583 | No |
| 7/25/2023 11:15 | 0.591 | 0.033 | 0.0319 | No | 0.562 | No |
| 7/25/2023 11:16 | 0.592 | 0.033 | 0.0321 | No | 0.5658 | No |
| 7/25/2023 11:17 | 0.595 | 0.032 | 0.0322 | No | 0.5693 | No |
| 7/25/2023 11:18 | 0.6 | 0.033 | 0.0324 | No | 0.5731 | No |
| 7/25/2023 11:19 | 0.609 | 0.032 | 0.0325 | No | 0.5774 | No |
| 7/25/2023 11:20 | 0.612 | 0.034 | 0.0327 | No | 0.5814 | No |
| 7/25/2023 11:21 | 0.615 | 0.034 | 0.0328 | No | 0.5856 | No |
| 7/25/2023 11:22 | 0.622 | 0.033 | 0.0329 | No | 0.5895 | No |
| 7/25/2023 11:23 | 0.631 | 0.032 | 0.0329 | No | 0.594 | No |
| 7/25/2023 11:24 | 0.637 | 0.034 | 0.033 | No | 0.5989 | No |
| 7/25/2023 11:25 | 0.645 | 0.034 | 0.0331 | No | 0.6037 | No |
| 7/25/2023 11:26 | 0.645 | 0.034 | 0.0333 | No | 0.6083 | No |

Upwind Station

| Time | Instantaneous VOC (ppm) | Instantaneous Mass Conc. Total (mg/m ³) | Mass Conc. Total mg/m ³ AVG 15m (mg/m ³) | Dust Exceedance | VOC ppm AVG 15m (ppm) | VOC Exceedance |
|-----------------|-------------------------|---|---|-----------------|-----------------------|----------------|
| 7/25/2023 11:27 | 0.651 | 0.034 | 0.0333 | No | 0.6133 | No |
| 7/25/2023 11:28 | 0.652 | 0.034 | 0.0333 | No | 0.6183 | No |
| 7/25/2023 11:29 | 0.661 | 0.033 | 0.0333 | No | 0.6239 | No |
| 7/25/2023 11:30 | 0.663 | 0.033 | 0.0333 | No | 0.6287 | No |
| 7/25/2023 11:31 | 0.669 | 0.035 | 0.0334 | No | 0.6338 | No |
| 7/25/2023 11:32 | 0.672 | 0.034 | 0.0335 | No | 0.6389 | No |
| 7/25/2023 11:33 | 0.672 | 0.034 | 0.0336 | No | 0.6437 | No |
| 7/25/2023 11:34 | 0.679 | 0.033 | 0.0337 | No | 0.6484 | No |
| 7/25/2023 11:35 | 0.683 | 0.034 | 0.0337 | No | 0.6531 | No |
| 7/25/2023 11:36 | 0.686 | 0.034 | 0.0337 | No | 0.6579 | No |
| 7/25/2023 11:37 | 0.693 | 0.033 | 0.0337 | No | 0.6626 | No |
| 7/25/2023 11:38 | 0.697 | 0.033 | 0.0337 | No | 0.667 | No |
| 7/25/2023 11:39 | 0.699 | 0.033 | 0.0337 | No | 0.6711 | No |
| 7/25/2023 11:40 | 0.697 | 0.033 | 0.0336 | No | 0.6746 | No |
| 7/25/2023 11:41 | 0.697 | 0.034 | 0.0336 | No | 0.6781 | No |
| 7/25/2023 11:42 | 0.717 | 0.035 | 0.0337 | No | 0.6825 | No |
| 7/25/2023 11:43 | 0.72 | 0.034 | 0.0337 | No | 0.687 | No |
| 7/25/2023 11:44 | 0.738 | 0.036 | 0.0339 | No | 0.6921 | No |
| 7/25/2023 11:45 | 0.724 | 0.034 | 0.0339 | No | 0.6962 | No |
| 7/25/2023 11:46 | 0.736 | 0.034 | 0.0339 | No | 0.7007 | No |
| 7/25/2023 11:47 | 0.727 | 0.036 | 0.034 | No | 0.7043 | No |
| 7/25/2023 11:48 | 0.742 | 0.035 | 0.0341 | No | 0.709 | No |
| 7/25/2023 11:49 | 0.728 | 0.035 | 0.0342 | No | 0.7123 | No |
| 7/25/2023 11:50 | 0.736 | 0.036 | 0.0343 | No | 0.7158 | No |
| 7/25/2023 11:51 | 0.736 | 0.032 | 0.0342 | No | 0.7191 | No |
| 7/25/2023 11:52 | 0.747 | 0.033 | 0.0342 | No | 0.7227 | No |
| 7/25/2023 11:53 | 0.759 | 0.032 | 0.0341 | No | 0.7269 | No |
| 7/25/2023 11:54 | 0.757 | 0.032 | 0.0341 | No | 0.7307 | No |
| 7/25/2023 11:55 | 0.764 | 0.032 | 0.034 | No | 0.7352 | No |
| 7/25/2023 11:56 | 0.766 | 0.033 | 0.0339 | No | 0.7398 | No |
| 7/25/2023 11:57 | 0.781 | 0.033 | 0.0338 | No | 0.7441 | No |
| 7/25/2023 11:58 | 0.782 | 0.034 | 0.0338 | No | 0.7482 | No |
| 7/25/2023 11:59 | 0.782 | 0.034 | 0.0337 | No | 0.7511 | No |
| 7/25/2023 12:00 | 0.787 | 0.036 | 0.0338 | No | 0.7553 | No |
| 7/25/2023 12:01 | 0.791 | 0.036 | 0.0339 | No | 0.759 | No |
| 7/25/2023 12:02 | 0.788 | 0.036 | 0.0339 | No | 0.7631 | No |
| 7/25/2023 12:03 | 0.79 | 0.034 | 0.0339 | No | 0.7663 | No |
| 7/25/2023 12:04 | 0.793 | 0.034 | 0.0338 | No | 0.7706 | No |
| 7/25/2023 12:05 | 0.792 | 0.035 | 0.0337 | No | 0.7743 | No |
| 7/25/2023 12:06 | 0.796 | 0.034 | 0.0339 | No | 0.7783 | No |
| 7/25/2023 12:07 | 0.804 | 0.035 | 0.034 | No | 0.7821 | No |
| 7/25/2023 12:08 | 0.81 | 0.034 | 0.0341 | No | 0.7855 | No |
| 7/25/2023 12:09 | 0.806 | 0.035 | 0.0343 | No | 0.7888 | No |
| 7/25/2023 12:10 | 0.816 | 0.035 | 0.0345 | No | 0.7923 | No |
| 7/25/2023 12:11 | 0.82 | 0.035 | 0.0347 | No | 0.7959 | No |
| 7/25/2023 12:12 | 0.829 | 0.035 | 0.0348 | No | 0.7991 | No |
| 7/25/2023 12:13 | 0.835 | 0.036 | 0.0349 | No | 0.8026 | No |
| 7/25/2023 12:14 | 0.832 | 0.035 | 0.035 | No | 0.8059 | No |
| 7/25/2023 12:15 | 0.836 | 0.035 | 0.0349 | No | 0.8092 | No |
| 7/25/2023 12:16 | 0.837 | 0.034 | 0.0348 | No | 0.8123 | No |
| 7/25/2023 12:17 | 0.843 | 0.035 | 0.0347 | No | 0.8159 | No |
| 7/25/2023 12:18 | 0.84 | 0.038 | 0.035 | No | 0.8193 | No |

Upwind Station

| Time | Instantaneous VOC (ppm) | Instantaneous Mass Conc. Total (mg/m ³) | Mass Conc. Total mg/m ³ AVG 15m (mg/m ³) | Dust Exceedance | VOC ppm AVG 15m (ppm) | VOC Exceedance |
|-----------------|-------------------------|---|---|-----------------|-----------------------|----------------|
| 7/25/2023 12:19 | 0.845 | 0.037 | 0.0352 | No | 0.8227 | No |
| 7/25/2023 12:20 | 0.849 | 0.036 | 0.0353 | No | 0.8265 | No |
| 7/25/2023 12:21 | 0.846 | 0.037 | 0.0355 | No | 0.8299 | No |
| 7/25/2023 12:22 | 0.846 | 0.035 | 0.0355 | No | 0.8327 | No |
| 7/25/2023 12:23 | 0.853 | 0.036 | 0.0356 | No | 0.8355 | No |
| 7/25/2023 12:24 | 0.858 | 0.036 | 0.0357 | No | 0.839 | No |
| 7/25/2023 12:25 | 0.853 | 0.036 | 0.0357 | No | 0.8415 | No |
| 7/25/2023 12:26 | 0.858 | 0.035 | 0.0357 | No | 0.844 | No |
| 7/25/2023 12:27 | 0.862 | 0.036 | 0.0358 | No | 0.8462 | No |
| 7/25/2023 12:28 | 0.863 | 0.036 | 0.0358 | No | 0.8481 | No |
| 7/25/2023 12:29 | 0.866 | 0.036 | 0.0359 | No | 0.8503 | No |
| 7/25/2023 12:30 | 0.86 | 0.037 | 0.036 | No | 0.8519 | No |
| 7/25/2023 12:31 | 0.87 | 0.04 | 0.0364 | No | 0.8541 | No |
| 7/25/2023 12:32 | 0.869 | 0.041 | 0.0368 | No | 0.8559 | No |
| 7/25/2023 12:33 | 0.872 | 0.04 | 0.0369 | No | 0.858 | No |
| 7/25/2023 12:34 | 0.878 | 0.039 | 0.0371 | No | 0.8602 | No |
| 7/25/2023 12:35 | 0.889 | 0.043 | 0.0375 | No | 0.8629 | No |
| 7/25/2023 12:36 | 0.885 | 0.04 | 0.0377 | No | 0.8655 | No |
| 7/25/2023 12:37 | 0.891 | 0.038 | 0.0379 | No | 0.8685 | No |
| 7/25/2023 12:38 | 0.893 | 0.037 | 0.038 | No | 0.8711 | No |
| 7/25/2023 12:39 | 0.896 | 0.037 | 0.0381 | No | 0.8737 | No |
| 7/25/2023 12:40 | 0.902 | 0.037 | 0.0381 | No | 0.8769 | No |
| 7/25/2023 12:41 | 0.895 | 0.038 | 0.0383 | No | 0.8794 | No |
| 7/25/2023 12:42 | 0.909 | 0.037 | 0.0384 | No | 0.8825 | No |
| 7/25/2023 12:43 | 0.909 | 0.037 | 0.0385 | No | 0.8856 | No |
| 7/25/2023 12:44 | 0.901 | 0.037 | 0.0385 | No | 0.8879 | No |
| 7/25/2023 12:45 | 0.909 | 0.038 | 0.0386 | No | 0.8912 | No |
| 7/25/2023 12:46 | 0.913 | 0.038 | 0.0385 | No | 0.8941 | No |
| 7/25/2023 12:47 | 0.913 | 0.037 | 0.0382 | No | 0.897 | No |
| 7/25/2023 12:48 | 0.92 | 0.038 | 0.0381 | No | 0.9002 | No |
| 7/25/2023 12:49 | 0.919 | 0.037 | 0.0379 | No | 0.9029 | No |
| 7/25/2023 12:50 | 0.922 | 0.042 | 0.0379 | No | 0.9051 | No |
| 7/25/2023 12:51 | 0.928 | 0.039 | 0.0378 | No | 0.908 | No |
| 7/25/2023 12:52 | 0.942 | 0.041 | 0.038 | No | 0.9114 | No |
| 7/25/2023 12:53 | 0.94 | 0.038 | 0.0381 | No | 0.9145 | No |
| 7/25/2023 12:54 | 0.931 | 0.038 | 0.0381 | No | 0.9169 | No |
| 7/25/2023 12:55 | 0.929 | 0.038 | 0.0382 | No | 0.9187 | No |
| 7/25/2023 12:56 | 0.94 | 0.038 | 0.0382 | No | 0.9217 | No |
| 7/25/2023 12:57 | 0.937 | 0.038 | 0.0383 | No | 0.9235 | No |
| 7/25/2023 12:58 | 0.941 | 0.037 | 0.0383 | No | 0.9257 | No |
| 7/25/2023 12:59 | 0.946 | 0.038 | 0.0383 | No | 0.9287 | No |
| 7/25/2023 13:00 | 0.946 | 0.038 | 0.0383 | No | 0.9311 | No |
| 7/25/2023 13:01 | 0.945 | 0.04 | 0.0385 | No | 0.9333 | No |
| 7/25/2023 13:02 | 0.946 | 0.039 | 0.0386 | No | 0.9355 | No |
| 7/25/2023 13:03 | 0.948 | 0.038 | 0.0386 | No | 0.9373 | No |
| 7/25/2023 13:04 | 0.947 | 0.038 | 0.0387 | No | 0.9392 | No |

Downwind Station

| Time | Instantaneous VOC (ppm) | Instantaneous Mass Conc. Total (mg/m ³) | Mass Conc. Total mg/m ³ AVG 15m (mg/m ³) | Dust Exceedance | VOC ppm AVG 15m (ppm) | VOC Exceedance |
|----------------|-------------------------|---|---|-----------------|-----------------------|----------------|
| 7/25/2023 7:03 | 0 | | | No | 0 | No |
| 7/25/2023 7:04 | 0 | 0.025 | 0.025 | No | 0 | No |
| 7/25/2023 7:05 | 0 | 0.027 | 0.026 | No | 0 | No |
| 7/25/2023 7:06 | 0 | 0.026 | 0.026 | No | 0 | No |
| 7/25/2023 7:07 | 0 | 0.026 | 0.026 | No | 0 | No |
| 7/25/2023 7:08 | 0 | 0.027 | 0.0262 | No | 0 | No |
| 7/25/2023 7:09 | 0 | 0.027 | 0.0263 | No | 0 | No |
| 7/25/2023 7:10 | 0 | 0.026 | 0.0263 | No | 0 | No |
| 7/25/2023 7:11 | 0 | 0.026 | 0.0263 | No | 0 | No |
| 7/25/2023 7:12 | 0 | 0.027 | 0.0263 | No | 0 | No |
| 7/25/2023 7:13 | 0 | 0.028 | 0.0265 | No | 0 | No |
| 7/25/2023 7:14 | 0 | 0.029 | 0.0267 | No | 0 | No |
| 7/25/2023 7:15 | 0 | 0.028 | 0.0268 | No | 0 | No |
| 7/25/2023 7:16 | 0 | 0.029 | 0.027 | No | 0 | No |
| 7/25/2023 7:17 | 0 | 0.028 | 0.0271 | No | 0 | No |
| 7/25/2023 7:18 | 0 | 0.029 | 0.0272 | No | 0 | No |
| 7/25/2023 7:19 | 0 | 0.029 | 0.0275 | No | 0 | No |
| 7/25/2023 7:20 | 0 | 0.028 | 0.0275 | No | 0 | No |
| 7/25/2023 7:21 | 0 | 0.028 | 0.0277 | No | 0 | No |
| 7/25/2023 7:22 | 0 | 0.03 | 0.0279 | No | 0 | No |
| 7/25/2023 7:23 | 0 | 0.03 | 0.0281 | No | 0 | No |
| 7/25/2023 7:24 | 0 | 0.033 | 0.0285 | No | 0 | No |
| 7/25/2023 7:25 | 0 | 0.031 | 0.0289 | No | 0 | No |
| 7/25/2023 7:26 | 0 | 0.03 | 0.0291 | No | 0 | No |
| 7/25/2023 7:27 | 0 | 0.029 | 0.0293 | No | 0 | No |
| 7/25/2023 7:28 | 0 | 0.03 | 0.0294 | No | 0 | No |
| 7/25/2023 7:29 | 0 | 0.029 | 0.0294 | No | 0 | No |
| 7/25/2023 7:30 | 0 | 0.029 | 0.0295 | No | 0 | No |
| 7/25/2023 7:31 | 0 | 0.029 | 0.0295 | No | 0 | No |
| 7/25/2023 7:32 | 0 | 0.029 | 0.0295 | No | 0 | No |
| 7/25/2023 7:33 | 0 | 0.03 | 0.0296 | No | 0 | No |
| 7/25/2023 7:34 | 0 | 0.029 | 0.0296 | No | 0 | No |
| 7/25/2023 7:35 | 0 | 0.029 | 0.0297 | No | 0 | No |
| 7/25/2023 7:36 | 0 | 0.03 | 0.0298 | No | 0 | No |
| 7/25/2023 7:37 | 0 | 0.03 | 0.0298 | No | 0 | No |
| 7/25/2023 7:38 | 0 | 0.03 | 0.0298 | No | 0 | No |
| 7/25/2023 7:39 | 0 | 0.033 | 0.0298 | No | 0 | No |
| 7/25/2023 7:40 | 0 | 0.033 | 0.0299 | No | 0 | No |
| 7/25/2023 7:41 | 0 | 0.031 | 0.03 | No | 0 | No |
| 7/25/2023 7:42 | 0 | 0.031 | 0.0301 | No | 0 | No |
| 7/25/2023 7:43 | 0 | 0.032 | 0.0303 | No | 0 | No |
| 7/25/2023 7:44 | 0 | 0.032 | 0.0305 | No | 0 | No |
| 7/25/2023 7:45 | 0 | 0.032 | 0.0307 | No | 0 | No |
| 7/25/2023 7:46 | 0 | 0.032 | 0.0309 | No | 0 | No |
| 7/25/2023 7:47 | 0 | 0.032 | 0.0311 | No | 0 | No |
| 7/25/2023 7:48 | 0 | 0.032 | 0.0312 | No | 0 | No |
| 7/25/2023 7:49 | 0 | 0.033 | 0.0315 | No | 0 | No |
| 7/25/2023 7:50 | 0 | 0.033 | 0.0317 | No | 0 | No |
| 7/25/2023 7:51 | 0 | 0.032 | 0.0319 | No | 0 | No |
| 7/25/2023 7:52 | 0 | 0.032 | 0.032 | No | 0 | No |
| 7/25/2023 7:53 | 0 | 0.033 | 0.0322 | No | 0 | No |
| 7/25/2023 7:54 | 0 | 0.034 | 0.0323 | No | 0 | No |
| 7/25/2023 7:55 | 0 | 0.035 | 0.0324 | No | 0 | No |
| 7/25/2023 7:56 | 0 | 0.035 | 0.0327 | No | 0 | No |
| 7/25/2023 7:57 | 0 | 0.035 | 0.0329 | No | 0 | No |

Downwind Station

| Time | Instantaneous VOC (ppm) | Instantaneous Mass Conc. Total (mg/m ³) | Mass Conc. Total mg/m ³ AVG 15m (mg/m ³) | Dust Exceedance | VOC ppm AVG 15m (ppm) | VOC Exceedance |
|----------------|-------------------------|---|---|-----------------|-----------------------|----------------|
| 7/25/2023 7:58 | 0 | 0.035 | 0.0331 | No | 0 | No |
| 7/25/2023 7:59 | 0 | 0.037 | 0.0335 | No | 0 | No |
| 7/25/2023 8:00 | 0 | 0.033 | 0.0335 | No | 0 | No |
| 7/25/2023 8:01 | 0 | 0.034 | 0.0337 | No | 0 | No |
| 7/25/2023 8:02 | 0 | 0.035 | 0.0339 | No | 0 | No |
| 7/25/2023 8:03 | 0 | 0.034 | 0.034 | No | 0 | No |
| 7/25/2023 8:04 | 0 | 0.035 | 0.0341 | No | 0 | No |
| 7/25/2023 8:05 | 0 | 0.036 | 0.0343 | No | 0 | No |
| 7/25/2023 8:06 | 0 | 0.036 | 0.0346 | No | 0 | No |
| 7/25/2023 8:07 | 0 | 0.037 | 0.0349 | No | 0 | No |
| 7/25/2023 8:08 | 0 | 0.037 | 0.0352 | No | 0 | No |
| 7/25/2023 8:09 | 0 | 0.037 | 0.0354 | No | 0 | No |
| 7/25/2023 8:10 | 0 | 0.035 | 0.0354 | No | 0 | No |
| 7/25/2023 8:11 | 0 | 0.036 | 0.0355 | No | 0 | No |
| 7/25/2023 8:12 | 0 | 0.036 | 0.0355 | No | 0 | No |
| 7/25/2023 8:13 | 0 | 0.035 | 0.0355 | No | 0 | No |
| 7/25/2023 8:14 | 0 | 0.035 | 0.0354 | No | 0 | No |
| 7/25/2023 8:15 | 0 | 0.036 | 0.0356 | No | 0 | No |
| 7/25/2023 8:16 | 0 | 0.035 | 0.0357 | No | 0 | No |
| 7/25/2023 8:17 | 0 | 0.036 | 0.0357 | No | 0 | No |
| 7/25/2023 8:18 | 0 | 0.035 | 0.0358 | No | 0 | No |
| 7/25/2023 8:19 | 0 | 0.043 | 0.0363 | No | 0 | No |
| 7/25/2023 8:20 | 0 | 0.036 | 0.0363 | No | 0 | No |
| 7/25/2023 8:21 | 0 | 0.036 | 0.0363 | No | 0 | No |
| 7/25/2023 8:22 | 0 | 0.035 | 0.0362 | No | 0 | No |
| 7/25/2023 8:23 | 0 | 0.036 | 0.0361 | No | 0 | No |
| 7/25/2023 8:24 | 0 | 0.036 | 0.0361 | No | 0 | No |
| 7/25/2023 8:25 | 0 | 0.036 | 0.0361 | No | 0 | No |
| 7/25/2023 8:26 | 0 | 0.036 | 0.0361 | No | 0 | No |
| 7/25/2023 8:27 | 0 | 0.036 | 0.0361 | No | 0 | No |
| 7/25/2023 8:28 | 0 | 0.036 | 0.0362 | No | 0 | No |
| 7/25/2023 8:29 | 0 | 0.036 | 0.0363 | No | 0 | No |
| 7/25/2023 8:30 | 0 | 0.036 | 0.0363 | No | 0 | No |
| 7/25/2023 8:31 | 0 | 0.036 | 0.0363 | No | 0 | No |
| 7/25/2023 8:32 | 0 | 0.035 | 0.0363 | No | 0 | No |
| 7/25/2023 8:33 | 0 | 0.036 | 0.0363 | No | 0 | No |
| 7/25/2023 8:34 | 0 | 0.035 | 0.0358 | No | 0 | No |
| 7/25/2023 8:35 | 0 | 0.036 | 0.0358 | No | 0 | No |
| 7/25/2023 8:36 | 0 | 0.037 | 0.0359 | No | 0 | No |
| 7/25/2023 8:37 | 0 | 0.037 | 0.036 | No | 0 | No |
| 7/25/2023 8:38 | 0 | 0.036 | 0.036 | No | 0 | No |
| 7/25/2023 8:39 | 0 | 0.037 | 0.0361 | No | 0 | No |
| 7/25/2023 8:40 | 0 | 0.037 | 0.0361 | No | 0 | No |
| 7/25/2023 8:41 | 0 | 0.038 | 0.0363 | No | 0 | No |
| 7/25/2023 8:42 | 0 | 0.038 | 0.0364 | No | 0 | No |
| 7/25/2023 8:43 | 0 | 0.038 | 0.0365 | No | 0 | No |
| 7/25/2023 8:44 | 0 | 0.037 | 0.0366 | No | 0 | No |
| 7/25/2023 8:45 | 0 | 0.037 | 0.0367 | No | 0 | No |
| 7/25/2023 8:46 | 0 | 0.037 | 0.0367 | No | 0 | No |
| 7/25/2023 8:47 | 0 | 0.037 | 0.0369 | No | 0 | No |
| 7/25/2023 8:48 | 0 | 0.038 | 0.037 | No | 0 | No |
| 7/25/2023 8:49 | 0 | 0.037 | 0.0371 | No | 0 | No |
| 7/25/2023 8:50 | 0 | 0.037 | 0.0372 | No | 0 | No |
| 7/25/2023 8:51 | 0 | 0.037 | 0.0372 | No | 0 | No |
| 7/25/2023 8:52 | 0 | 0.038 | 0.0373 | No | 0 | No |

Downwind Station

| Time | Instantaneous VOC (ppm) | Instantaneous Mass Conc. Total (mg/m ³) | Mass Conc. Total mg/m ³ AVG 15m (mg/m ³) | Dust Exceedance | VOC ppm AVG 15m (ppm) | VOC Exceedance |
|----------------|-------------------------|---|---|-----------------|-----------------------|----------------|
| 7/25/2023 8:53 | 0 | 0.039 | 0.0375 | No | 0 | No |
| 7/25/2023 8:54 | 0 | 0.038 | 0.0375 | No | 0 | No |
| 7/25/2023 8:55 | 0 | 0.038 | 0.0376 | No | 0 | No |
| 7/25/2023 8:56 | 0 | 0.038 | 0.0376 | No | 0 | No |
| 7/25/2023 8:57 | 0 | 0.039 | 0.0377 | No | 0 | No |
| 7/25/2023 8:58 | 0 | 0.039 | 0.0377 | No | 0 | No |
| 7/25/2023 8:59 | 0 | 0.039 | 0.0379 | No | 0 | No |
| 7/25/2023 9:00 | 0 | 0.039 | 0.038 | No | 0 | No |
| 7/25/2023 9:01 | 0 | 0.038 | 0.0381 | No | 0 | No |
| 7/25/2023 9:02 | 0 | 0.038 | 0.0381 | No | 0 | No |
| 7/25/2023 9:03 | 0 | 0.038 | 0.0381 | No | 0 | No |
| 7/25/2023 9:04 | 0 | 0.039 | 0.0383 | No | 0 | No |
| 7/25/2023 9:05 | 0 | 0.038 | 0.0383 | No | 0 | No |
| 7/25/2023 9:06 | 0 | 0.04 | 0.0385 | No | 0 | No |
| 7/25/2023 9:07 | 0 | 0.039 | 0.0386 | No | 0 | No |
| 7/25/2023 9:08 | 0 | 0.04 | 0.0387 | No | 0 | No |
| 7/25/2023 9:09 | 0 | 0.041 | 0.0389 | No | 0 | No |
| 7/25/2023 9:10 | 0 | 0.041 | 0.0391 | No | 0 | No |
| 7/25/2023 9:11 | 0 | 0.04 | 0.0392 | No | 0 | No |
| 7/25/2023 9:12 | 0 | 0.044 | 0.0395 | No | 0 | No |
| 7/25/2023 9:13 | 0 | 0.04 | 0.0396 | No | 0 | No |
| 7/25/2023 9:14 | 0 | 0.039 | 0.0396 | No | 0 | No |
| 7/25/2023 9:15 | 0 | 0.039 | 0.0396 | No | 0 | No |
| 7/25/2023 9:16 | 0 | 0.041 | 0.0398 | No | 0 | No |
| 7/25/2023 9:17 | 0 | 0.04 | 0.0399 | No | 0 | No |
| 7/25/2023 9:18 | 0 | 0.039 | 0.04 | No | 0 | No |
| 7/25/2023 9:19 | 0 | 0.038 | 0.0399 | No | 0 | No |
| 7/25/2023 9:20 | 0 | 0.04 | 0.0401 | No | 0 | No |
| 7/25/2023 9:21 | 0 | 0.041 | 0.0401 | No | 0 | No |
| 7/25/2023 9:22 | 0 | 0.041 | 0.0403 | No | 0 | No |
| 7/25/2023 9:23 | 0 | 0.042 | 0.0404 | No | 0 | No |
| 7/25/2023 9:24 | 0 | 0.041 | 0.0404 | No | 0 | No |
| 7/25/2023 9:25 | 0 | 0.041 | 0.0404 | No | 0 | No |
| 7/25/2023 9:26 | 0 | 0.042 | 0.0405 | No | 0 | No |
| 7/25/2023 9:27 | 0 | 0.041 | 0.0403 | No | 0 | No |
| 7/25/2023 9:28 | 0 | 0.042 | 0.0405 | No | 0 | No |
| 7/25/2023 9:29 | 0 | 0.041 | 0.0406 | No | 0 | No |
| 7/25/2023 9:30 | 0 | 0.04 | 0.0407 | No | 0 | No |
| 7/25/2023 9:31 | 0 | 0.041 | 0.0407 | No | 0 | No |
| 7/25/2023 9:32 | 0 | 0.041 | 0.0407 | No | 0 | No |
| 7/25/2023 9:33 | 0 | 0.044 | 0.0411 | No | 0 | No |
| 7/25/2023 9:34 | 0 | 0.049 | 0.0418 | No | 0 | No |
| 7/25/2023 9:35 | 0 | 0.043 | 0.042 | No | 0 | No |
| 7/25/2023 9:36 | 0 | 0.042 | 0.0421 | No | 0 | No |
| 7/25/2023 9:37 | 0 | 0.041 | 0.0421 | No | 0 | No |
| 7/25/2023 9:38 | 0 | 0.041 | 0.042 | No | 0 | No |
| 7/25/2023 9:39 | 0 | 0.042 | 0.0421 | No | 0 | No |
| 7/25/2023 9:40 | 0 | 0.041 | 0.0421 | No | 0 | No |
| 7/25/2023 9:41 | 0 | 0.041 | 0.042 | No | 0 | No |
| 7/25/2023 9:42 | 0 | 0.042 | 0.0421 | No | 0 | No |
| 7/25/2023 9:43 | 0 | 0.042 | 0.0421 | No | 0 | No |
| 7/25/2023 9:44 | 0 | 0.041 | 0.0421 | No | 0 | No |
| 7/25/2023 9:45 | 0 | 0.041 | 0.0421 | No | 0 | No |
| 7/25/2023 9:46 | 0 | 0.041 | 0.0421 | No | 0 | No |
| 7/25/2023 9:47 | 0 | 0.042 | 0.0422 | No | 0 | No |

Downwind Station

| Time | Instantaneous VOC (ppm) | Instantaneous Mass Conc. Total (mg/m ³) | Mass Conc. Total mg/m ³ AVG 15m (mg/m ³) | Dust Exceedance | VOC ppm AVG 15m (ppm) | VOC Exceedance |
|-----------------|-------------------------|---|---|-----------------|-----------------------|----------------|
| 7/25/2023 9:48 | 0 | 0.042 | 0.0421 | No | 0 | No |
| 7/25/2023 9:49 | 0 | 0.042 | 0.0416 | No | 0 | No |
| 7/25/2023 9:50 | 0 | 0.042 | 0.0415 | No | 0 | No |
| 7/25/2023 9:51 | 0 | 0.045 | 0.0417 | No | 0 | No |
| 7/25/2023 9:52 | 0 | 0.045 | 0.042 | No | 0 | No |
| 7/25/2023 9:53 | 0 | 0.043 | 0.0421 | No | 0 | No |
| 7/25/2023 9:54 | 0 | 0.043 | 0.0422 | No | 0 | No |
| 7/25/2023 9:55 | 0 | 0.043 | 0.0423 | No | 0 | No |
| 7/25/2023 9:56 | 0 | 0.044 | 0.0425 | No | 0 | No |
| 7/25/2023 9:57 | 0 | 0.043 | 0.0426 | No | 0 | No |
| 7/25/2023 9:58 | 0 | 0.043 | 0.0427 | No | 0 | No |
| 7/25/2023 9:59 | 0 | 0.043 | 0.0428 | No | 0 | No |
| 7/25/2023 10:00 | 0 | 0.043 | 0.0429 | No | 0 | No |
| 7/25/2023 10:01 | 0 | 0.044 | 0.0431 | No | 0 | No |
| 7/25/2023 10:02 | 0 | 0.045 | 0.0433 | No | 0 | No |
| 7/25/2023 10:03 | 0 | 0.044 | 0.0435 | No | 0 | No |
| 7/25/2023 10:04 | 0 | 0.043 | 0.0435 | No | 0 | No |
| 7/25/2023 10:05 | 0 | 0.045 | 0.0437 | No | 0 | No |
| 7/25/2023 10:06 | 0 | 0.044 | 0.0437 | No | 0 | No |
| 7/25/2023 10:07 | 0 | 0.045 | 0.0437 | No | 0 | No |
| 7/25/2023 10:08 | 0 | 0.046 | 0.0439 | No | 0 | No |
| 7/25/2023 10:09 | 0 | 0.045 | 0.044 | No | 0 | No |
| 7/25/2023 10:10 | 0 | 0.046 | 0.0442 | No | 0 | No |
| 7/25/2023 10:11 | 0 | 0.045 | 0.0443 | No | 0 | No |
| 7/25/2023 10:12 | 0 | 0.046 | 0.0445 | No | 0 | No |
| 7/25/2023 10:13 | 0 | 0.046 | 0.0447 | No | 0 | No |
| 7/25/2023 10:14 | 0 | 0.044 | 0.0447 | No | 0 | No |
| 7/25/2023 10:15 | 0 | 0.045 | 0.0449 | No | 0 | No |
| 7/25/2023 10:16 | 0 | 0.046 | 0.045 | No | 0 | No |
| 7/25/2023 10:17 | 0 | 0.047 | 0.0451 | No | 0 | No |
| 7/25/2023 10:18 | 0 | 0.046 | 0.0453 | No | 0 | No |
| 7/25/2023 10:19 | 0 | 0.046 | 0.0455 | No | 0 | No |
| 7/25/2023 10:20 | 0 | 0.046 | 0.0455 | No | 0 | No |
| 7/25/2023 10:21 | 0 | 0.046 | 0.0457 | No | 0 | No |
| 7/25/2023 10:22 | 0 | 0.046 | 0.0457 | No | 0 | No |
| 7/25/2023 10:23 | 0 | 0.046 | 0.0457 | No | 0 | No |
| 7/25/2023 10:24 | 0 | 0.046 | 0.0458 | No | 0 | No |
| 7/25/2023 10:25 | 0 | 0.047 | 0.0459 | No | 0 | No |
| 7/25/2023 10:26 | 0 | 0.047 | 0.046 | No | 0 | No |
| 7/25/2023 10:27 | 0 | 0.046 | 0.046 | No | 0 | No |
| 7/25/2023 10:28 | 0 | 0.047 | 0.0461 | No | 0 | No |
| 7/25/2023 10:29 | 0 | 0.048 | 0.0463 | No | 0 | No |
| 7/25/2023 10:30 | 0 | 0.048 | 0.0465 | No | 0 | No |
| 7/25/2023 10:31 | 0 | 0.047 | 0.0466 | No | 0 | No |
| 7/25/2023 10:32 | 0 | 0.048 | 0.0467 | No | 0 | No |

| Downwind Station | | | | | | |
|------------------|-------------------------|---|---|-----------------|-----------------------|----------------|
| Time | Instantaneous VOC (ppm) | Instantaneous Mass Conc. Total (mg/m ³) | Mass Conc. Total mg/m ³ AVG 15m (mg/m ³) | Dust Exceedance | VOC ppm AVG 15m (ppm) | VOC Exceedance |
| 7/25/2023 10:33 | 0 | 0.049 | 0.0469 | No | 0 | No |
| 7/25/2023 10:34 | 0 | 0.049 | 0.0471 | No | 0 | No |
| 7/25/2023 10:35 | 0 | 0.048 | 0.0472 | No | 0 | No |
| 7/25/2023 10:36 | 0 | 0.048 | 0.0473 | No | 0 | No |
| 7/25/2023 10:37 | 0 | 0.05 | 0.0476 | No | 0 | No |
| 7/25/2023 10:38 | 0 | 0.052 | 0.048 | No | 0 | No |
| 7/25/2023 10:39 | 0 | 0.054 | 0.0485 | No | 0 | No |
| 7/25/2023 10:40 | 0 | 0.054 | 0.049 | No | 0 | No |
| 7/25/2023 10:41 | 0 | 0.063 | 0.0501 | No | 0 | No |
| 7/25/2023 10:42 | 0 | 0.056 | 0.0507 | No | 0 | No |
| 7/25/2023 10:43 | 0 | 0.051 | 0.051 | No | 0 | No |
| 7/25/2023 10:44 | 0 | 0.068 | 0.0523 | No | 0 | No |
| 7/25/2023 10:45 | 0 | 0.052 | 0.0526 | No | 0 | No |
| 7/25/2023 10:46 | 0 | 0.05 | 0.0528 | No | 0 | No |
| 7/25/2023 10:47 | 0 | 0.051 | 0.053 | No | 0 | No |
| 7/25/2023 10:48 | 0 | 0.05 | 0.0531 | No | 0 | No |
| 7/25/2023 10:49 | 0 | 0.051 | 0.0532 | No | 0 | No |
| 7/25/2023 10:50 | 0 | 0.051 | 0.0534 | No | 0 | No |
| 7/25/2023 10:51 | 0 | 0.051 | 0.0536 | No | 0 | No |
| 7/25/2023 10:52 | 0 | 0.051 | 0.0537 | No | 0 | No |
| 7/25/2023 10:53 | 0 | 0.051 | 0.0536 | No | 0 | No |
| 7/25/2023 10:54 | 0 | 0.051 | 0.0534 | No | 0 | No |
| 7/25/2023 10:55 | 0 | 0.052 | 0.0533 | No | 0 | No |
| 7/25/2023 10:56 | 0 | 0.051 | 0.0525 | No | 0 | No |
| 7/25/2023 10:57 | 0 | 0.052 | 0.0522 | No | 0 | No |
| 7/25/2023 10:58 | 0 | 0.054 | 0.0524 | No | 0 | No |
| 7/25/2023 10:59 | 0 | 0.052 | 0.0513 | No | 0 | No |
| 7/25/2023 11:00 | 0 | 0.053 | 0.0514 | No | 0 | No |
| 7/25/2023 11:01 | 0 | 0.052 | 0.0515 | No | 0 | No |
| 7/25/2023 11:02 | 0 | 0.053 | 0.0517 | No | 0 | No |
| 7/25/2023 11:03 | 0 | 0.052 | 0.0518 | No | 0 | No |
| 7/25/2023 11:04 | 0 | 0.051 | 0.0518 | No | 0 | No |
| 7/25/2023 11:05 | 0 | 0.052 | 0.0519 | No | 0 | No |
| 7/25/2023 11:06 | 0 | 0.054 | 0.0521 | No | 0 | No |
| 7/25/2023 11:07 | 0 | 0.055 | 0.0523 | No | 0 | No |
| 7/25/2023 11:08 | 0 | 0.053 | 0.0525 | No | 0 | No |
| 7/25/2023 11:09 | 0 | 0.054 | 0.0527 | No | 0 | No |
| 7/25/2023 11:10 | 0 | 0.055 | 0.0529 | No | 0 | No |
| 7/25/2023 11:11 | 0 | 0.056 | 0.0532 | No | 0 | No |
| 7/25/2023 11:12 | 0 | 0.054 | 0.0533 | No | 0 | No |
| 7/25/2023 11:13 | 0 | 0.058 | 0.0536 | No | 0 | No |
| 7/25/2023 11:14 | 0 | 0.056 | 0.0539 | No | 0 | No |
| 7/25/2023 11:15 | 0 | 0.057 | 0.0541 | No | 0 | No |
| 7/25/2023 11:16 | 0 | 0.055 | 0.0543 | No | 0 | No |
| 7/25/2023 11:17 | 0 | 0.055 | 0.0545 | No | 0 | No |
| 7/25/2023 11:18 | 0 | 0.055 | 0.0547 | No | 0 | No |
| 7/25/2023 11:19 | 0 | 0.054 | 0.0549 | No | 0 | No |
| 7/25/2023 11:20 | 0 | 0.057 | 0.0552 | No | 0 | No |
| 7/25/2023 11:21 | 0 | 0.056 | 0.0553 | No | 0 | No |
| 7/25/2023 11:22 | 0 | 0.056 | 0.0554 | No | 0 | No |
| 7/25/2023 11:23 | 0 | 0.056 | 0.0556 | No | 0 | No |
| 7/25/2023 11:24 | 0 | 0.055 | 0.0557 | No | 0 | No |
| 7/25/2023 11:25 | 0 | 0.057 | 0.0558 | No | 0 | No |
| 7/25/2023 11:26 | 0 | 0.057 | 0.0559 | No | 0 | No |
| 7/25/2023 11:27 | 0 | 0.06 | 0.0563 | No | 0 | No |

Downwind Station

| Time | Instantaneous VOC (ppm) | Instantaneous Mass Conc. Total (mg/m ³) | Mass Conc. Total mg/m ³ AVG 15m (mg/m ³) | Dust Exceedance | VOC ppm AVG 15m (ppm) | VOC Exceedance |
|-----------------|-------------------------|---|---|-----------------|-----------------------|----------------|
| 7/25/2023 11:28 | 0 | 0.059 | 0.0563 | No | 0 | No |
| 7/25/2023 11:29 | 0 | 0.057 | 0.0564 | No | 0 | No |
| 7/25/2023 11:30 | 0 | 0.057 | 0.0564 | No | 0 | No |
| 7/25/2023 11:31 | 0 | 0.059 | 0.0567 | No | 0 | No |
| 7/25/2023 11:32 | 0 | 0.058 | 0.0569 | No | 0 | No |
| 7/25/2023 11:33 | 0 | 0.057 | 0.057 | No | 0 | No |
| 7/25/2023 11:34 | 0 | 0.058 | 0.0573 | No | 0 | No |
| 7/25/2023 11:35 | 0 | 0.03 | 0.0555 | No | 0 | No |
| 7/25/2023 11:36 | 0 | 0.008 | 0.0523 | No | 0 | No |
| 7/25/2023 11:37 | 0 | 0.007 | 0.049 | No | 0 | No |
| 7/25/2023 11:38 | 0 | 0.007 | 0.0457 | No | 0 | No |
| 7/25/2023 11:39 | 0 | 0.007 | 0.0425 | No | 0 | No |
| 7/25/2023 11:40 | 0 | 0.006 | 0.0391 | No | 0 | No |
| 7/25/2023 11:41 | 0 | 0.007 | 0.0358 | No | 0 | No |
| 7/25/2023 11:42 | 0 | 0.01 | 0.0325 | No | 0 | No |
| 7/25/2023 11:43 | 0 | 0.008 | 0.0291 | No | 0 | No |
| 7/25/2023 11:44 | 0 | 0.009 | 0.0259 | No | 0 | No |
| 7/25/2023 11:45 | 0 | 0.009 | 0.0227 | No | 0 | No |
| 7/25/2023 11:46 | 0 | 0.008 | 0.0193 | No | 0 | No |
| 7/25/2023 11:47 | 0 | 0.008 | 0.0159 | No | 0 | No |
| 7/25/2023 11:48 | 0 | 0.008 | 0.0127 | No | 0 | No |
| 7/25/2023 11:49 | 0 | 0.009 | 0.0094 | No | 0 | No |
| 7/25/2023 11:50 | 0 | 0.01 | 0.0081 | No | 0 | No |
| 7/25/2023 11:51 | 0 | 0.008 | 0.0081 | No | 0 | No |
| 7/25/2023 11:52 | 0 | 0.005 | 0.0079 | No | 0 | No |
| 7/25/2023 11:53 | 0 | 0.005 | 0.0078 | No | 0 | No |
| 7/25/2023 11:54 | 0 | 0.006 | 0.0077 | No | 0 | No |
| 7/25/2023 11:55 | 0 | 0.007 | 0.0078 | No | 0 | No |
| 7/25/2023 11:56 | 0 | 0.005 | 0.0077 | No | 0 | No |
| 7/25/2023 11:57 | 0 | 0.006 | 0.0074 | No | 0 | No |
| 7/25/2023 11:58 | 0 | 0.007 | 0.0073 | No | 0 | No |
| 7/25/2023 11:59 | 0 | 0.028 | 0.0086 | No | 0 | No |
| 7/25/2023 12:00 | 0 | 0.008 | 0.0085 | No | 0 | No |
| 7/25/2023 12:01 | 0 | 0.008 | 0.0085 | No | 0 | No |
| 7/25/2023 12:02 | 0 | 0.006 | 0.0084 | No | 0 | No |
| 7/25/2023 12:03 | 0 | 0.005 | 0.0082 | No | 0 | No |
| 7/25/2023 12:04 | 0 | 0.005 | 0.0079 | No | 0 | No |
| 7/25/2023 12:05 | 0 | 0.005 | 0.0076 | No | 0 | No |
| 7/25/2023 12:06 | 0 | 0.005 | 0.0074 | No | 0 | No |
| 7/25/2023 12:07 | 0 | 0.005 | 0.0074 | No | 0 | No |
| 7/25/2023 12:08 | 0 | 0.005 | 0.0074 | No | 0 | No |
| 7/25/2023 12:09 | 0 | 0.004 | 0.0073 | No | 0 | No |
| 7/25/2023 12:10 | 0 | 0.005 | 0.0071 | No | 0 | No |
| 7/25/2023 12:11 | 0 | 0.007 | 0.0073 | No | 0 | No |
| 7/25/2023 12:12 | 0 | 0.005 | 0.0072 | No | 0 | No |
| 7/25/2023 12:13 | 0 | 0.004 | 0.007 | No | 0 | No |
| 7/25/2023 12:14 | 0 | 0.004 | 0.0054 | No | 0 | No |
| 7/25/2023 12:15 | 0 | 0.004 | 0.0051 | No | 0 | No |
| 7/25/2023 12:16 | 0 | 0.004 | 0.0049 | No | 0 | No |
| 7/25/2023 12:17 | 0 | 0.005 | 0.0048 | No | 0 | No |
| 7/25/2023 12:18 | 0 | 0.005 | 0.0048 | No | 0 | No |
| 7/25/2023 12:19 | 0 | 0.005 | 0.0048 | No | 0 | No |
| 7/25/2023 12:20 | 0 | 0.01 | 0.0051 | No | 0 | No |
| 7/25/2023 12:21 | 0 | 0.008 | 0.0053 | No | 0 | No |
| 7/25/2023 12:22 | 0 | 0.005 | 0.0053 | No | 0 | No |

Downwind Station

| Time | Instantaneous VOC (ppm) | Instantaneous Mass Conc. Total (mg/m ³) | Mass Conc. Total mg/m ³ AVG 15m (mg/m ³) | Dust Exceedance | VOC ppm AVG 15m (ppm) | VOC Exceedance |
|-----------------|-------------------------|---|---|-----------------|-----------------------|----------------|
| 7/25/2023 12:23 | 0 | 0.005 | 0.0053 | No | 0 | No |
| 7/25/2023 12:24 | 0 | 0.005 | 0.0054 | No | 0 | No |
| 7/25/2023 12:25 | 0 | 0.005 | 0.0054 | No | 0 | No |
| 7/25/2023 12:26 | 0 | 0.005 | 0.0053 | No | 0 | No |
| 7/25/2023 12:27 | 0 | 0.006 | 0.0053 | No | 0 | No |
| 7/25/2023 12:28 | 0 | 0.007 | 0.0055 | No | 0 | No |
| 7/25/2023 12:29 | 0 | 0.008 | 0.0058 | No | 0 | No |
| 7/25/2023 12:30 | 0 | 0.008 | 0.0061 | No | 0 | No |
| 7/25/2023 12:31 | 0 | 0.014 | 0.0067 | No | 0 | No |
| 7/25/2023 12:32 | 0 | 0.014 | 0.0073 | No | 0 | No |
| 7/25/2023 12:33 | 0 | 0.012 | 0.0078 | No | 0 | No |
| 7/25/2023 12:34 | 0 | 0.01 | 0.0081 | No | 0 | No |
| 7/25/2023 12:35 | 0 | 0.015 | 0.0085 | No | 0 | No |
| 7/25/2023 12:36 | 0 | 0.016 | 0.009 | No | 0 | No |
| 7/25/2023 12:37 | 0 | 0.012 | 0.0095 | No | 0 | No |
| 7/25/2023 12:38 | 0 | 0.01 | 0.0098 | No | 0 | No |
| 7/25/2023 12:39 | 0 | 0.012 | 0.0103 | No | 0 | No |
| 7/25/2023 12:40 | 0 | 0.014 | 0.0109 | No | 0 | No |
| 7/25/2023 12:41 | 0 | 0.013 | 0.0114 | No | 0 | No |
| 7/25/2023 12:42 | 0 | 0.013 | 0.0119 | No | 0 | No |
| 7/25/2023 12:43 | 0 | 0.013 | 0.0123 | No | 0 | No |
| 7/25/2023 12:44 | 0 | 0.012 | 0.0125 | No | 0 | No |
| 7/25/2023 12:45 | 0 | 0.012 | 0.0128 | No | 0 | No |
| 7/25/2023 12:46 | 0 | 0.012 | 0.0127 | No | 0 | No |
| 7/25/2023 12:47 | 0 | 0.012 | 0.0125 | No | 0 | No |
| 7/25/2023 12:48 | 0 | 0.013 | 0.0126 | No | 0 | No |
| 7/25/2023 12:49 | 0 | 0.013 | 0.0128 | No | 0 | No |
| 7/25/2023 12:50 | 0 | 0.014 | 0.0127 | No | 0 | No |
| 7/25/2023 12:51 | 0 | 0.012 | 0.0125 | No | 0 | No |
| 7/25/2023 12:52 | 0 | 0.013 | 0.0125 | No | 0 | No |
| 7/25/2023 12:53 | 0 | 0.013 | 0.0127 | No | 0 | No |
| 7/25/2023 12:54 | 0 | 0.012 | 0.0127 | No | 0 | No |
| 7/25/2023 12:55 | 0 | 0.012 | 0.0126 | No | 0 | No |
| 7/25/2023 12:56 | 0 | 0.012 | 0.0125 | No | 0 | No |
| 7/25/2023 12:57 | 0 | 0.013 | 0.0125 | No | 0 | No |
| 7/25/2023 12:58 | 0 | 0.013 | 0.0125 | No | 0 | No |
| 7/25/2023 12:59 | 0 | 0.06 | 0.0157 | No | 0 | No |
| 7/25/2023 13:00 | 0 | 0.069 | 0.0195 | No | 0 | No |
| 7/25/2023 13:01 | 0 | 0.039 | 0.0213 | No | 0 | No |
| 7/25/2023 13:02 | 0 | 0.015 | 0.0215 | No | 0 | No |
| 7/25/2023 13:03 | 0 | 0.014 | 0.0216 | No | 0 | No |