

LANGAN SITE OBSERVATION REPORT – Day 103

CLIENT: Gowanus Canal LLC and GowCan Owner, LLC	DATE: Friday, January 13, 2023
PROJECT No.: 170295301	WEATHER: Cloudy, 43 to 56 °F Wind: S @ 4 – 13 mph
PROJECT: Gowanus Canal Northside	TIME: 06:30 – 17:00
LOCATION: Brooklyn, New York	BCP SITE ID: C224080
EQUIPMENT: Komatsu PC 490 Excavator Junttan PM20/25 Drill Rig Komatsu PC 240 Excavator JLG HC3 Boom Lift Komatsu PC 78 US Excavator APE Model 23.2 Vibratory Hammer Komatsu Wheel Loader Junttan PM20US Drill Rig	PRESENT AT SITE: Langan: Brian Kenneally (Environmental), Ahmed Mahmoud (Geotechnical) Urban Atelier Group (UAG): Seth Anderson Kingdom Associates, Inc. (Kingdom): George Minchala Earth Construction Services (ECS): Chaitram Sookram
OBSERVATIONS, DISCUSSIONS, TEST RESULTS, ETC.:	
<p>Langan was on-site to document implementation of the New York State Department of Environmental Conservation (NYSDEC)-approved March 24, 2022 Remedial Action Work Plan (RAWP) for Brownfield Cleanup Program (BCP) Site No. C224080. Site Map 1 presents the Society Brooklyn and Sackett Place developments, which together comprise the BCP site.</p>	
Site Activities	
<ul style="list-style-type: none"> • Kingdom exported non-hazardous historic fill from waste characterization cells WC01, WC09, WC10, and WC11 (WC01_COMP_0-5, WC09_COMP_0-5, WC10_COMP_0-5, WC11_COMP_0-5, WC11_COMP_5-10, and WC11_COMP_10-15) using permitted tri-axle trucks for off-site disposal. See material tracking section for details. • Kingdom exported previously stockpiled construction and demolition (C&D) debris in permitted tri-axle trucks for off-site disposal. See material tracking section for details. • Kingdom imported 14 truckloads of 0.5-inch crushed stone. The stone was stockpiled in the central part of Society Brooklyn. See material tracking section for details. • Kingdom completed demolition of the former concrete slab within Remedial Excavation Area No. 4 in the southern part of Sackett Place. <ul style="list-style-type: none"> ○ Demolished C&D debris was screened for odor, staining, and organic vapor using a photoionization detector (PID). Petroleum-like impacts including petroleum-like odor, staining, and a maximum PID reading of 1.6 parts per million (ppm) were observed. ○ The demolished C&D debris was stockpiled in the central part of Sackett Place on top of and covered with polyethylene sheeting pending future off-site disposal. • Kingdom backfilled around structural pile cap formwork with previously imported 0.5-inch crushed stone in the northeastern part of Society Brooklyn. • Kingdom installed formwork for structural pile caps in the northeastern part of Society Brooklyn and northern part of Sackett Place. • Kingdom removed previously installed formwork for structural pile caps in the northeastern part of Society Brooklyn. • Kingdom placed concrete for structural pile caps in the northwestern part of Society Brooklyn. • Kingdom placed concrete for a cellar-level mud slab in the northern part of Sackett Place. 	
Cc: J. Hayes, M. Burke, P. Farnham, E. Adkins, A. Nesci	By: Brian Kenneally Langan, D.P.C.

Import and Export Tracking

- Kingdom exported 11 truckloads of non-hazardous historic fill from waste characterization cells WC01, WC09, WC10, and WC11 (WC01_COMP_0-5, WC09_COMP_0-5, WC10_COMP_0-5, WC11_COMP_0-5, WC11_COMP_5-10, and WC11_COMP_10-15) to Bayshore Soil Management (BSM) in Keasbey, NJ.
- Kingdom imported 14 truckloads of 0.5-inch crushed stone from the Impact Environmental facility in Jersey City, NJ.
- Kingdom exported one truckload of C&D debris to Faztec Industries in Staten Island, NY.

Soil/Fill Export Summary			
Facility	Exported	Today	Total
Bayshore Soil Management Keasbey, NJ Non-Hazardous Soil/Fill	No. Loads	11	629
	Quantity (CY)	220	12,580
Bayshore Soil Management Keasbey, NJ Non-Hazardous MGP-Impacted Soil/Fill	No. Loads	0	79
	Quantity (CY)	0	1,580

Material Import Summary				
Facility	NYSDEC Approved Quantity (CY)	Imported	Today	Total
Stavola Construction Materials, Inc Bridgewater, NJ 2.5-inch Stone	1,000	No. Loads	0	8
		Quantity (CY)	0	160
87 19th Avenue Astoria, NY 2.5-inch Stone	2,000	No. Loads	0	22
		Quantity (CY)	0	470
Impact Environmental Jersey City, NJ 0.5-inch Crushed Stone	2,000	No. Loads	14	55
		Quantity (CY)	280	1,100
Impact Environmental Lyndhurst, NJ 0.75-inch Stone	4,000	No. Loads	0	5
		Quantity (CY)	0	100

Sampling

- No samples were collected.

Community Air Monitoring

- Langan conducted real-time air monitoring for volatile organic compounds (VOC) and particulate matter smaller than 10 microns in diameter (PM10) at the upwind and downwind perimeters of the work area during ground-intrusive work. VOC and PM10 concentrations did not exceed the action levels established by the community air monitoring plan (CAMP).

Anticipated Activities

- Kingdom will continue to install timber lagging as part of the support of excavation (SOE) system at Society Brooklyn and Sackett Place.
- Kingdom will continue excavation for structural pile cap installation at Society Brooklyn and Sackett Place.

Cc:	J. Hayes, M. Burke, P. Farnham, E. Adkins, A. Nesci	By:	Brian Kenneally Langan, D.P.C.
-----	---	-----	--

Site Photographs:



Photo 1: Kingdom backfilling around structural pile caps in the northeastern part of Society Brooklyn (facing northwest)



Photo 2: Kingdom exporting non-hazardous soil in a permitted tri-axle truck for off-site disposal from Sackett Place (facing north)

Cc:	J. Hayes, M. Burke, P. Farnham, E. Adkins, A. Nesci	By:	Brian Kenneally Langan, D.P.C.
-----	---	-----	--

Site Map 1:

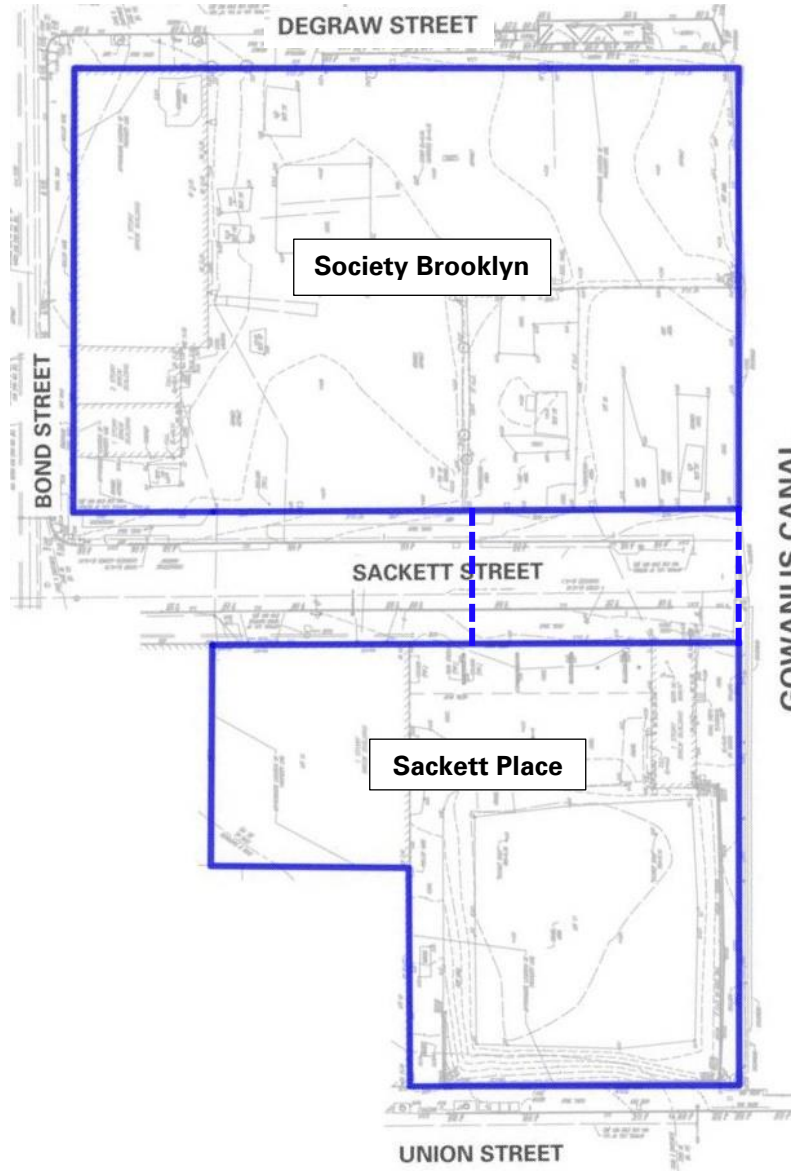

Legend

- Approximate BCP site boundary
- - - Approximate construction fence boundary

Notes

1. Base map adapted from 24 March 2022 RAWP, Figure 2 – Site Plan.
2. This Site Map is provided for context only; refer to the Northern (Society Brooklyn) and Southern (Sackett Place) Work Area Maps on the following pages for work and air monitoring location(s).

Cc:	J. Hayes, M. Burke, P. Farnham, E. Adkins, A. Nesci	By:	Brian Kenneally Langan, D.P.C.
------------	---	------------	--

Site Map 2: Northern Work Area Map (Society Brooklyn)

Base map adapted from 1 April 2022 drawing FO-201.00, "Ground Floor Framing Plan" for Society Brooklyn, prepared by DeSimone Consulting Engineers.

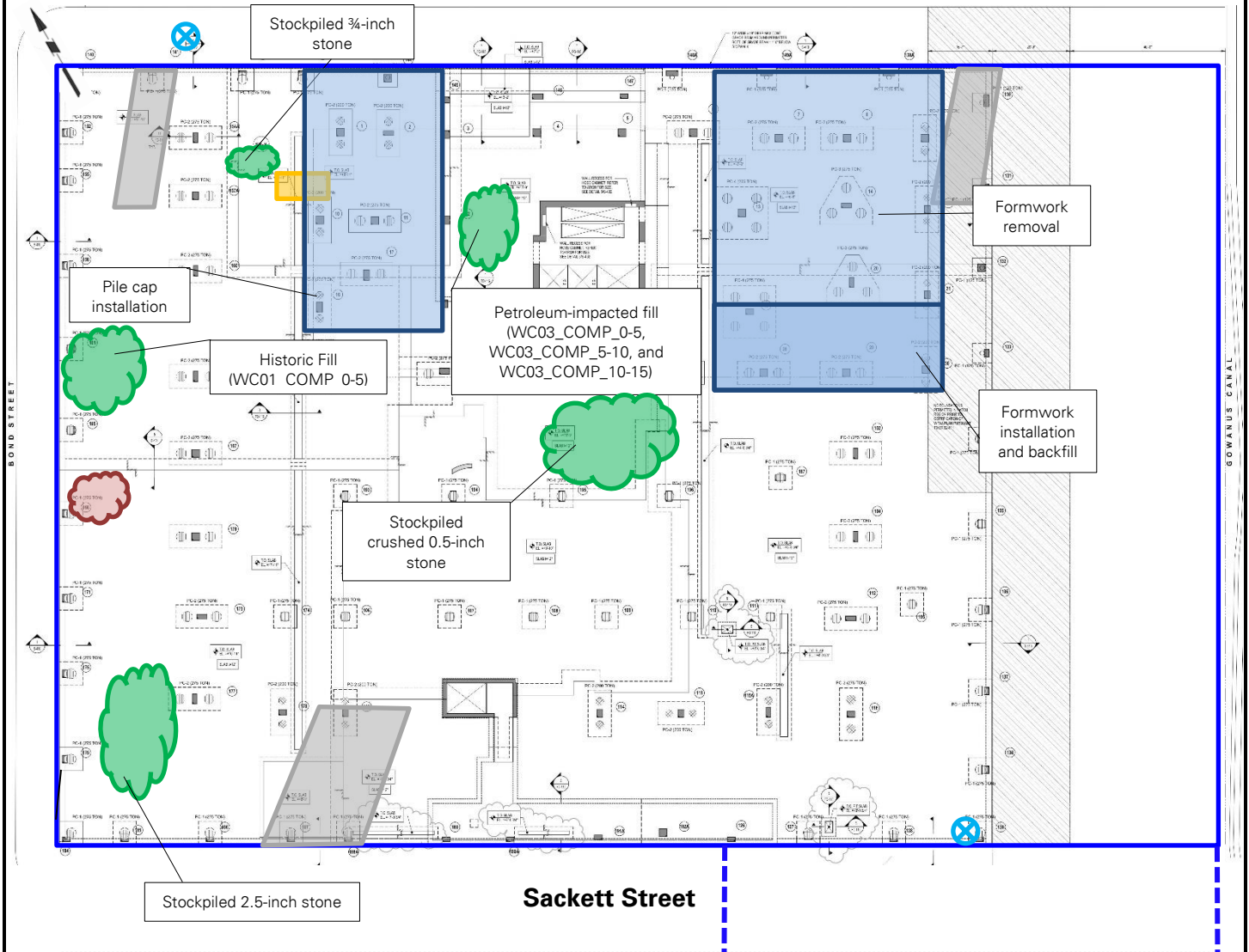

Legend:

- Approximate site boundary
- - - Approximate construction fence boundary
- ⊗ Upwind air monitoring station
- ⊗ Downwind air monitoring station
- Approximate work area
- Approximate stabilized construction entrance
- ☁ Approximate soil/fill stockpile location
- ☁ Approximate C&D debris stockpile location
- Approximate location of 20 cubic yard scrap metal container
- Approximate location of documentation sample collected today

Cc:	J. Hayes, M. Burke, P. Farnham, E. Adkins, A. Nesci	By:	Brian Kenneally Langan, D.P.C.
-----	---	-----	--

Site Map 3: Southern Work Area Map (Sackett Place)

Base map adapted from 1 April 2022 drawing FO-201.00, "Ground Floor Framing Plan" for Sackett Place, prepared by DeSimone Consulting Engineers.

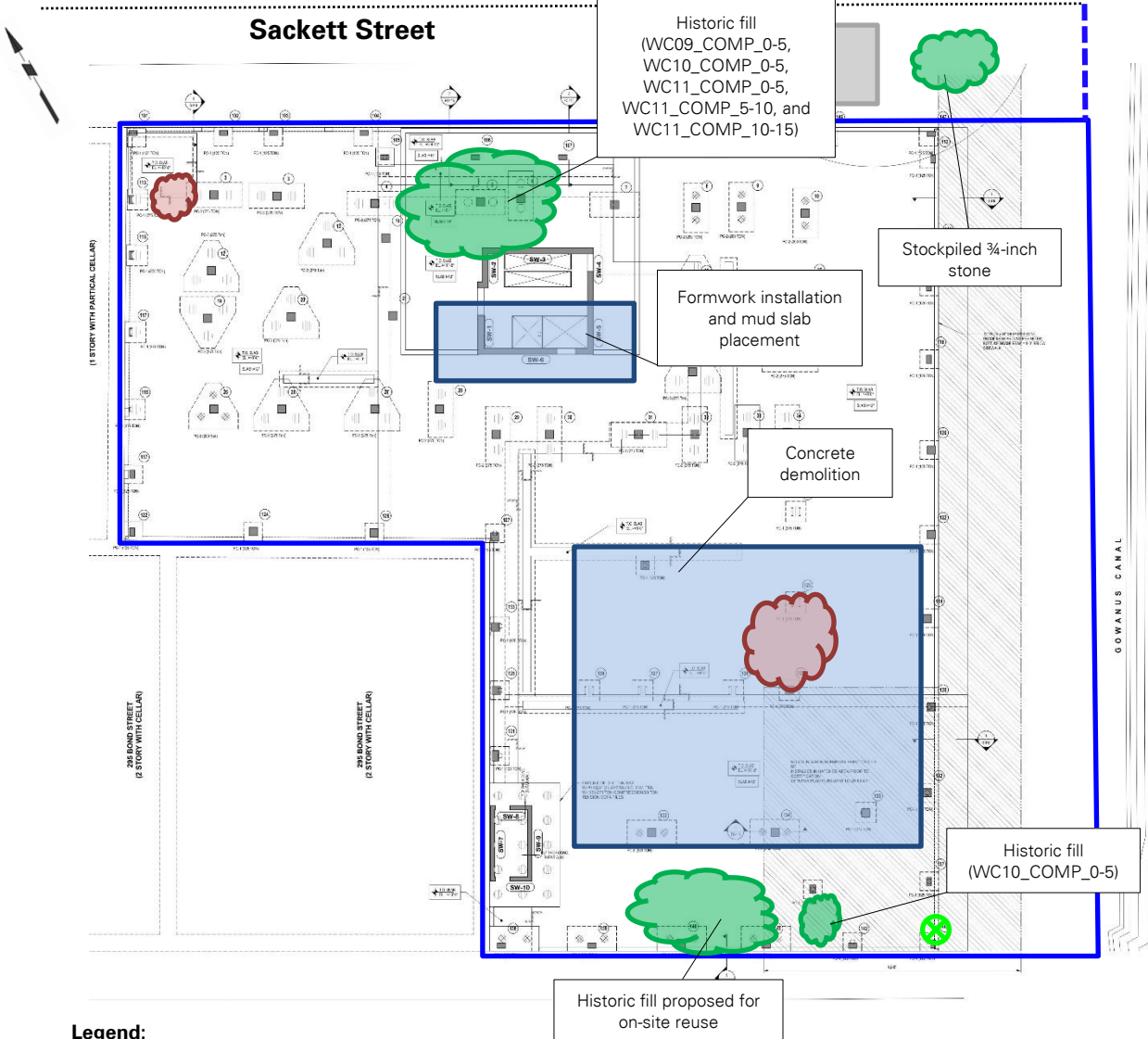

Legend:

- Approximate site boundary
- Approximate construction fence boundary
- X Upwind air monitoring station
- X Downwind air monitoring station
- Approximate work area
- Approximate stabilized construction entrance
- ☁ Approximate soil/fill stockpile location
- ☁ Approximate C&D debris stockpile location

Cc:	J. Hayes, M. Burke, P. Farnham, E. Adkins, A. Nesci	By:	Brian Kenneally Langan, D.P.C.
-----	---	-----	--

	DAILY AIR MONITORING REPORT				01/13/23	
	Gowanus Canal Northside				Project number: 170295301	
	267 Bond Street, Brooklyn, New York				Page 1 of 2	Rev. No. 0
					Submitted By:	
					Dust Action Level	150 $\mu\text{g}/\text{m}^3$
				TVOC Action Level	5 ppm	

Weather Data Range for Work Day		Wind Direction	S	Relative Humidity (%)	0.0 - 0.0	Daily Rain (in)	0.12	Readings in the summary table and graphs below are the reported downwind concentrations.
Temp (°F)	43.0 - 56.0	Wind Speed (MPH)	3.5 - 13.4	Barometer (inHg)	0.00 - 0.00			

Station Location Area	Work	Daily Avg. Dust Concentration ($\mu\text{g}/\text{m}^3$)	Max 15 Min Dust Concentration ($\mu\text{g}/\text{m}^3$)	Time of Maximum 15 Minute Avg Dust Reading	Daily Avg. VOC Concentration (ppm)	Max 15 Min VOC Concentration (ppm)	Time of Max VOC Reading
Upwind		22.1	82.6	8:53	0.0	0.1	10:54
Downwind 1		22.9	72.3	7:11	0.0	0.2	10:13
Downwind 2		24.2	104.7	8:16	0.0	0.0	7:11

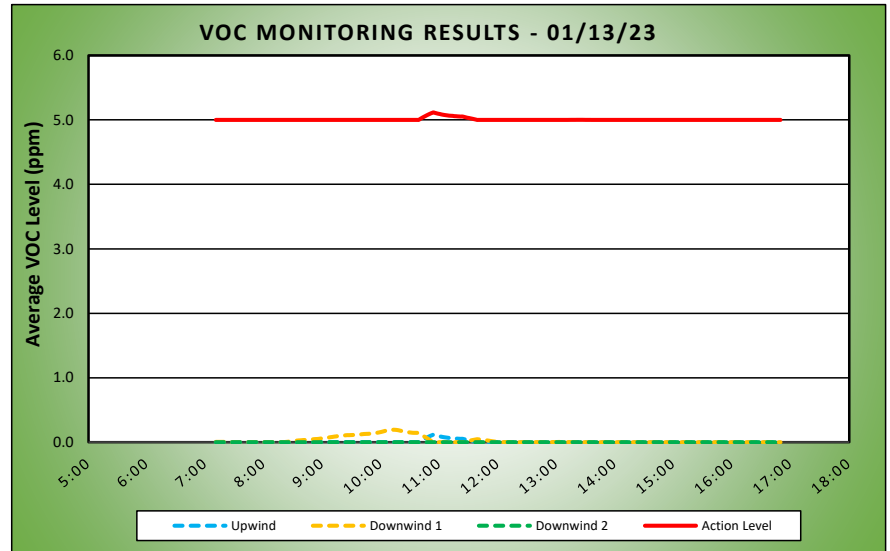
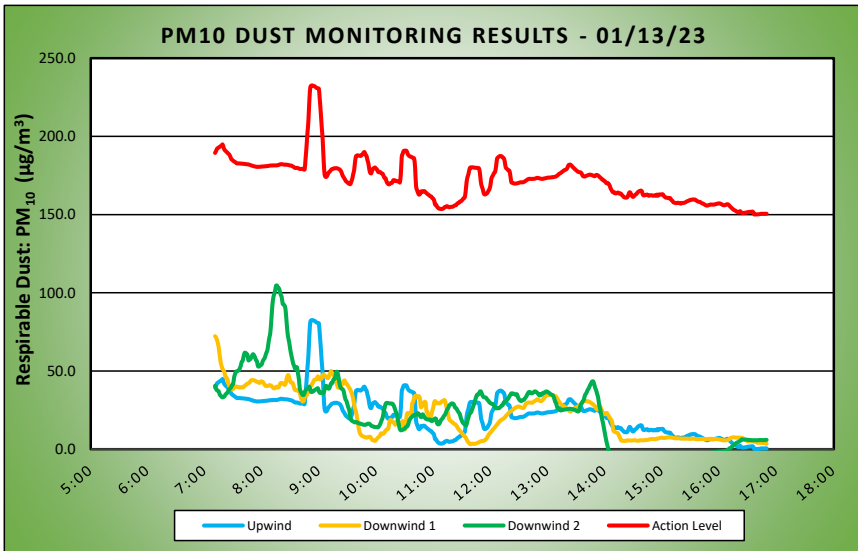

Air Monitoring Notes:

Sampling Notes:

Weather Notes:

Friday, January 13, 2023									
Number of Instances Where Downwind Particulates Exceeds Upwind Particulate + 150 =									0
Number of Comparable Data Points =									580
Start Time:									6:56
End Time:									16:50
PARTICULATE DATA									
Upwind			Downwind						Exceeds Particulate Alarm Limit
Time	Concentration (ug/m ³)	15-Min Avg Concentration (ug/m ³)	Time	Concentration (ug/m ³)	15-Min Avg Concentration (ug/m ³)	Time	Concentration (ug/m ³)	15-Min Avg Concentration (ug/m ³)	
6:56	33.0	-	6:56	76.0	-	6:56	57.0	-	-
6:57	33.0	-	6:57	68.8	-	6:57	59.3	-	-
6:58	33.8	-	6:58	74.0	-	6:58	50.8	-	-
6:59	33.0	-	6:59	75.3	-	6:59	36.0	-	-
7:00	33.0	-	7:00	83.0	-	7:00	43.0	-	-
7:01	33.0	-	7:01	108.5	-	7:01	62.8	-	-
7:02	33.0	-	7:02	92.0	-	7:02	42.8	-	-
7:03	32.8	-	7:03	71.0	-	7:03	46.8	-	-
7:04	32.0	-	7:04	67.8	-	7:04	36.8	-	-
7:05	64.0	-	7:05	49.3	-	7:05	32.5	-	-
7:06	53.5	-	7:06	63.5	-	7:06	33.0	-	-
7:07	42.3	-	7:07	76.5	-	7:07	33.0	-	-
7:08	42.5	-	7:08	47.0	-	7:08	33.0	-	-
7:09	41.8	-	7:09	58.3	-	7:09	33.0	-	-
7:10	41.8	-	7:10	84.3	-	7:10	33.0	-	-
7:11	42.3	39.4	7:11	65.0	72.3	7:11	33.0	40.6	-
7:12	50.0	40.6	7:12	56.3	71.4	7:12	33.0	38.8	-
7:13	55.3	42.0	7:13	51.3	69.9	7:13	33.0	37.6	-
7:14	41.0	42.5	7:14	40.5	67.6	7:14	33.0	37.4	-
7:15	40.0	43.0	7:15	35.0	64.4	7:15	33.0	36.8	-
7:16	39.0	43.4	7:16	33.5	59.4	7:16	34.0	34.9	-
7:17	39.0	43.8	7:17	31.3	55.4	7:17	33.8	34.3	-
7:18	40.8	44.3	7:18	34.3	52.9	7:18	34.0	33.4	-
7:19	39.3	44.8	7:19	40.8	51.1	7:19	33.0	33.2	-
7:20	33.0	42.8	7:20	38.0	50.4	7:20	36.5	33.4	-
7:21	33.0	41.4	7:21	39.0	48.7	7:21	40.0	33.9	-
7:22	33.0	40.8	7:22	38.8	46.2	7:22	50.3	35.0	-
7:23	33.0	40.1	7:23	40.0	45.7	7:23	40.3	35.5	-
7:24	33.0	39.6	7:24	41.3	44.6	7:24	43.3	36.2	-
7:25	32.3	38.9	7:25	43.0	41.9	7:25	53.3	37.6	-
7:26	32.5	38.3	7:26	42.3	40.3	7:26	43.5	38.3	-
7:27	32.3	37.1	7:27	38.3	39.1	7:27	41.8	38.8	-
7:28	32.8	35.6	7:28	39.5	38.4	7:28	48.3	39.9	-
7:29	32.0	35.0	7:29	39.0	38.3	7:29	53.0	41.2	-
7:30	32.0	34.5	7:30	40.3	38.6	7:30	41.0	41.7	-
7:31	32.3	34.0	7:31	43.0	39.2	7:31	96.8	45.9	-
7:32	33.0	33.6	7:32	40.8	39.9	7:32	66.3	48.1	-
7:33	33.8	33.1	7:33	38.3	40.1	7:33	57.3	49.6	-
7:34	33.0	32.7	7:34	37.0	39.9	7:34	35.5	49.8	-
7:35	33.0	32.7	7:35	36.5	39.8	7:35	41.3	50.1	-
7:36	33.0	32.7	7:36	36.0	39.6	7:36	48.0	50.6	-
7:37	32.5	32.7	7:37	37.8	39.5	7:37	67.3	51.8	-
7:38	32.0	32.6	7:38	40.3	39.5	7:38	64.0	53.4	-
7:39	32.0	32.6	7:39	42.8	39.6	7:39	80.5	55.8	-
7:40	32.0	32.5	7:40	42.5	39.6	7:40	64.8	56.6	-
7:41	31.3	32.5	7:41	44.8	39.8	7:41	84.8	59.4	-
7:42	31.5	32.4	7:42	50.0	40.6	7:42	74.8	61.6	-
7:43	31.0	32.3	7:43	45.5	41.0	7:43	49.8	61.7	-
7:44	31.0	32.2	7:44	47.0	41.5	7:44	42.0	60.9	-
7:45	31.0	32.2	7:45	47.3	42.0	7:45	34.5	60.5	-
7:46	31.0	32.1	7:46	45.8	42.1	7:46	42.0	56.8	-
7:47	30.5	31.9	7:47	47.0	42.6	7:47	73.3	57.3	-
7:48	30.0	31.7	7:48	51.3	43.4	7:48	61.5	57.6	-
7:49	30.0	31.5	7:49	46.5	44.1	7:49	50.3	58.6	-
7:50	30.0	31.3	7:50	38.5	44.2	7:50	62.5	60.0	-
7:51	30.0	31.1	7:51	35.5	44.2	7:51	59.8	60.8	-
7:52	30.0	30.9	7:52	35.8	44.0	7:52	53.3	59.8	-
7:53	30.0	30.8	7:53	36.3	43.8	7:53	46.3	58.7	-
7:54	30.0	30.6	7:54	38.0	43.4	7:54	53.5	56.9	-
7:55	30.8	30.5	7:55	38.0	43.1	7:55	54.8	56.2	-
7:56	31.5	30.6	7:56	40.8	42.9	7:56	39.0	53.1	-
7:57	31.3	30.5	7:57	44.5	42.5	7:57	69.8	52.8	-
7:58	31.5	30.6	7:58	44.5	42.4	7:58	59.3	53.4	-
7:59	32.0	30.6	7:59	57.0	43.1	7:59	46.5	53.7	-
8:00	32.0	30.7	8:00	51.3	43.4	8:00	42.5	54.3	-
8:01	31.8	30.8	8:01	39.3	42.9	8:01	71.3	56.2	-
8:02	31.0	30.8	8:02	38.0	42.3	8:02	89.3	57.3	-
8:03	31.0	30.9	8:03	35.0	41.3	8:03	74.5	58.2	-
8:04	31.0	30.9	8:04	36.0	40.6	8:04	78.8	60.1	-
8:05	31.0	31.0	8:05	35.5	40.4	8:05	89.5	61.9	-

PARTICULATE DATA									
Upwind			Downwind						Exceeds Particulate Alarm Limit
Time	Concentration (ug/m ³)	15-Min Avg Concentration (ug/m ³)	Time	Concentration (ug/m ³)	15-Min Avg Concentration (ug/m ³)	Time	Concentration (ug/m ³)	15-Min Avg Concentration (ug/m ³)	
8:06	31.0	31.1	8:06	37.3	40.5	8:06	82.8	63.4	-
8:07	31.0	31.1	8:07	39.3	40.7	8:07	116.0	67.6	-
8:08	32.0	31.3	8:08	39.8	40.9	8:08	103.3	71.4	-
8:09	31.8	31.4	8:09	37.0	40.9	8:09	100.0	74.5	-
8:10	31.0	31.4	8:10	32.5	40.5	8:10	165.0	81.8	-
8:11	32.0	31.4	8:11	32.0	39.9	8:11	173.0	90.8	-
8:12	31.3	31.4	8:12	34.0	39.2	8:12	153.5	96.3	-
8:13	32.0	31.5	8:13	39.5	38.9	8:13	99.8	99.0	-
8:14	32.0	31.5	8:14	59.0	39.0	8:14	77.5	101.1	-
8:15	32.0	31.5	8:15	64.3	39.9	8:15	93.3	104.5	-
8:16	32.0	31.5	8:16	38.3	39.8	8:16	74.0	104.7	-
8:17	33.8	31.7	8:17	30.8	39.3	8:17	68.3	103.3	-
8:18	33.5	31.8	8:18	41.5	39.8	8:18	69.3	102.9	-
8:19	34.3	32.0	8:19	60.5	41.4	8:19	49.8	101.0	-
8:20	33.8	32.2	8:20	50.0	42.4	8:20	53.5	98.6	-
8:21	30.8	32.2	8:21	34.3	42.2	8:21	62.0	97.2	-
8:22	30.0	32.1	8:22	39.5	42.2	8:22	51.8	92.9	-
8:23	30.0	32.0	8:23	33.0	41.7	8:23	96.5	92.5	-
8:24	30.8	31.9	8:24	27.5	41.1	8:24	90.3	91.8	-
8:25	31.0	31.9	8:25	42.0	41.7	8:25	128.5	89.4	-
8:26	30.8	31.9	8:26	76.5	44.7	8:26	62.5	82.0	-
8:27	31.0	31.8	8:27	64.5	46.7	8:27	46.8	74.9	-
8:28	30.0	31.7	8:28	49.3	47.4	8:28	38.8	70.8	-
8:29	29.3	31.5	8:29	30.3	45.5	8:29	31.0	67.7	-
8:30	29.8	31.4	8:30	29.5	43.2	8:30	30.0	63.5	-
8:31	31.3	31.3	8:31	30.8	42.7	8:31	26.8	60.4	-
8:32	29.0	31.0	8:32	29.0	42.5	8:32	26.5	57.6	-
8:33	28.5	30.7	8:33	26.3	41.5	8:33	27.0	54.8	-
8:34	28.0	30.3	8:34	26.8	39.3	8:34	27.8	53.3	-
8:35	28.0	29.9	8:35	28.8	37.9	8:35	26.0	51.5	-
8:36	30.3	29.8	8:36	32.8	37.8	8:36	65.5	51.7	-
8:37	30.5	29.9	8:37	38.3	37.7	8:37	61.5	52.4	-
8:38	27.5	29.7	8:38	27.0	37.3	8:38	38.3	48.5	-
8:39	27.0	29.5	8:39	28.5	37.3	8:39	36.5	44.9	-
8:40	27.5	29.2	8:40	25.5	36.2	8:40	36.3	38.7	-
8:41	29.8	29.2	8:41	32.3	33.3	8:41	33.3	36.8	-
8:42	32.5	29.3	8:42	37.3	31.5	8:42	28.8	35.6	-
8:43	28.5	29.2	8:43	34.3	30.5	8:43	25.8	34.7	-
8:44	25.5	28.9	8:44	36.5	30.9	8:44	30.8	34.7	-
8:45	28.5	28.8	8:45	57.5	32.8	8:45	51.0	36.1	-
8:46	132.3	35.6	8:46	46.0	33.8	8:46	49.3	37.6	-
8:47	145.8	43.3	8:47	38.3	34.4	8:47	38.0	38.4	-
8:48	163.5	52.3	8:48	43.8	35.6	8:48	32.5	38.7	-
8:49	141.3	59.9	8:49	41.5	36.5	8:49	34.3	39.2	-
8:50	222.8	72.9	8:50	55.3	38.3	8:50	38.5	40.0	-
8:51	159.0	81.5	8:51	63.3	40.3	8:51	37.8	38.2	-
8:52	45.3	82.4	8:52	42.3	40.6	8:52	37.5	36.6	-
8:53	29.3	82.6	8:53	45.8	41.9	8:53	43.3	36.9	-
8:54	24.3	82.4	8:54	45.5	43.0	8:54	37.3	36.9	-
8:55	24.8	82.2	8:55	43.8	44.2	8:55	45.8	37.6	-
8:56	24.3	81.8	8:56	36.3	44.5	8:56	38.5	37.9	-
8:57	24.0	81.3	8:57	39.0	44.6	8:57	35.3	38.4	-
8:58	23.5	80.9	8:58	45.5	45.3	8:58	31.3	38.7	-
8:59	23.0	80.8	8:59	56.0	46.6	8:59	33.8	38.9	-
9:00	23.8	80.4	9:00	34.5	45.1	9:00	23.5	37.1	-
9:01	23.3	73.2	9:01	39.0	44.6	9:01	33.0	36.0	-
9:02	24.0	65.1	9:02	44.3	45.0	9:02	41.3	36.2	-
9:03	24.0	55.8	9:03	48.5	45.4	9:03	33.0	36.3	-
9:04	23.5	47.9	9:04	71.5	47.4	9:04	25.3	35.7	-
9:05	23.0	34.6	9:05	63.0	47.9	9:05	44.5	36.1	-
9:06	23.0	25.5	9:06	45.3	46.7	9:06	69.5	38.2	-
9:07	24.8	24.2	9:07	39.8	46.5	9:07	70.8	40.4	-
9:08	30.5	24.2	9:08	43.8	46.4	9:08	43.0	40.4	-
9:09	39.3	25.2	9:09	31.3	45.4	9:09	27.5	39.7	-
9:10	45.8	26.6	9:10	48.8	45.8	9:10	30.8	38.7	-
9:11	34.3	27.3	9:11	62.0	47.5	9:11	41.5	38.9	-
9:12	33.8	28.0	9:12	56.8	48.7	9:12	64.0	40.8	-
9:13	36.0	28.8	9:13	65.8	50.0	9:13	53.0	42.3	-
9:14	28.3	29.1	9:14	27.8	48.1	9:14	33.0	42.2	-
9:15	26.0	29.3	9:15	26.8	47.6	9:15	50.5	44.0	-
9:16	28.5	29.6	9:16	27.0	46.8	9:16	48.0	45.0	-
9:17	23.3	29.6	9:17	28.0	45.7	9:17	45.3	45.3	-
9:18	25.3	29.7	9:18	23.5	44.1	9:18	85.8	48.8	-
9:19	22.8	29.6	9:19	32.8	41.5	9:19	36.8	49.6	-
9:20	19.5	29.4	9:20	33.3	39.5	9:20	19.5	47.9	-
9:21	19.0	29.1	9:21	45.3	39.5	9:21	18.0	44.5	-

PARTICULATE DATA									
Upwind			Downwind						Exceeds Particulate Alarm Limit
Time	Concentration (ug/m ³)	15-Min Avg Concentration (ug/m ³)	Time	Concentration (ug/m ³)	15-Min Avg Concentration (ug/m ³)	Time	Concentration (ug/m ³)	15-Min Avg Concentration (ug/m ³)	
9:22	19.0	28.7	9:22	57.0	40.6	9:22	17.8	41.0	-
9:23	18.5	27.9	9:23	46.0	40.8	9:23	17.0	39.2	-
9:24	18.8	26.6	9:24	33.8	41.0	9:24	18.3	38.6	-
9:25	19.5	24.8	9:25	73.8	42.6	9:25	25.5	38.3	-
9:26	20.3	23.9	9:26	74.5	43.5	9:26	23.5	37.1	-
9:27	18.8	22.9	9:27	65.0	44.0	9:27	19.3	34.1	-
9:28	18.5	21.7	9:28	39.0	42.2	9:28	18.0	31.7	-
9:29	18.3	21.1	9:29	23.8	42.0	9:29	17.8	30.7	-
9:30	18.5	20.6	9:30	14.3	41.1	9:30	17.3	28.5	-
9:31	19.5	20.0	9:31	11.3	40.1	9:31	17.8	26.5	-
9:32	19.8	19.7	9:32	11.0	38.9	9:32	18.0	24.7	-
9:33	21.3	19.5	9:33	10.8	38.1	9:33	16.5	20.1	-
9:34	46.8	21.1	9:34	8.8	36.5	9:34	14.0	18.5	-
9:35	46.5	22.9	9:35	6.3	34.7	9:35	12.8	18.1	-
9:36	64.5	25.9	9:36	5.8	32.1	9:36	12.3	17.7	-
9:37	56.3	28.4	9:37	5.3	28.6	9:37	13.0	17.4	-
9:38	103.0	34.0	9:38	4.8	25.9	9:38	13.0	17.1	-
9:39	68.0	37.3	9:39	4.3	23.9	9:39	21.5	17.3	-
9:40	26.8	37.8	9:40	19.3	20.3	9:40	24.3	17.3	-
9:41	21.8	37.9	9:41	18.0	16.5	9:41	17.0	16.8	-
9:42	16.3	37.7	9:42	7.8	12.7	9:42	14.5	16.5	-
9:43	17.8	37.7	9:43	6.0	10.5	9:43	17.5	16.5	-
9:44	15.8	37.5	9:44	6.0	9.3	9:44	14.0	16.2	-
9:45	28.5	38.2	9:45	5.5	8.7	9:45	13.5	16.0	-
9:46	27.5	38.7	9:46	5.3	8.3	9:46	15.0	15.8	-
9:47	34.8	39.7	9:47	7.8	8.1	9:47	16.0	15.7	-
9:48	24.3	39.9	9:48	6.8	7.8	9:48	15.3	15.6	-
9:49	20.5	38.1	9:49	5.3	7.6	9:49	15.0	15.6	-
9:50	37.3	37.5	9:50	4.0	7.4	9:50	16.5	15.9	-
9:51	23.5	34.8	9:51	7.5	7.6	9:51	17.3	16.2	-
9:52	23.8	32.6	9:52	10.0	7.9	9:52	14.5	16.3	-
9:53	44.3	28.7	9:53	4.8	7.9	9:53	12.3	16.3	-
9:54	36.0	26.6	9:54	4.0	7.9	9:54	13.3	15.7	-
9:55	24.5	26.4	9:55	4.5	6.9	9:55	13.5	15.0	-
9:56	50.8	28.4	9:56	4.3	6.0	9:56	13.0	14.7	-
9:57	32.5	29.4	9:57	3.8	5.7	9:57	12.3	14.6	-
9:58	23.0	29.8	9:58	3.0	5.5	9:58	12.3	14.2	-
9:59	20.5	30.1	9:59	3.5	5.3	9:59	13.8	14.2	-
10:00	16.5	29.3	10:00	14.3	5.9	10:00	12.3	14.1	-
10:01	20.3	28.8	10:01	16.8	6.7	10:01	15.0	14.1	-
10:02	15.5	27.5	10:02	18.3	7.4	10:02	13.8	14.0	-
10:03	17.5	27.1	10:03	14.8	7.9	10:03	24.8	14.6	-
10:04	24.3	27.3	10:04	13.5	8.5	10:04	30.8	15.7	-
10:05	28.3	26.7	10:05	27.3	10.0	10:05	38.3	17.1	-
10:06	17.5	26.3	10:06	8.0	10.0	10:06	41.3	18.7	-
10:07	19.8	26.1	10:07	6.0	9.8	10:07	38.5	20.3	-
10:08	21.3	24.5	10:08	10.0	10.1	10:08	62.8	23.7	-
10:09	18.5	23.4	10:09	12.5	10.7	10:09	54.5	26.4	-
10:10	22.3	23.2	10:10	24.0	12.0	10:10	50.8	28.9	-
10:11	20.0	21.2	10:11	9.5	12.3	10:11	23.0	29.6	-
10:12	16.0	20.1	10:12	12.0	12.9	10:12	11.5	29.5	-
10:13	13.8	19.5	10:13	9.3	13.3	10:13	11.0	29.5	-
10:14	19.5	19.4	10:14	58.0	16.9	10:14	11.0	29.3	-
10:15	28.0	20.2	10:15	40.5	18.7	10:15	12.0	29.3	-
10:16	20.0	20.1	10:16	14.8	18.6	10:16	13.0	29.1	-
10:17	21.5	20.5	10:17	6.0	17.7	10:17	14.5	29.2	-
10:18	37.3	21.9	10:18	8.0	17.3	10:18	14.5	28.5	-
10:19	27.3	22.1	10:19	6.5	16.8	10:19	11.3	27.2	-
10:20	20.0	21.5	10:20	9.8	15.7	10:20	12.3	25.5	-
10:21	20.0	21.7	10:21	13.3	16.0	10:21	13.8	23.6	-
10:22	15.3	21.4	10:22	37.3	18.1	10:22	12.5	21.9	-
10:23	19.8	21.3	10:23	5.0	17.8	10:23	11.3	18.5	-
10:24	15.8	21.1	10:24	5.3	17.3	10:24	10.3	15.5	-
10:25	15.0	20.6	10:25	8.3	16.2	10:25	11.0	12.9	-
10:26	98.8	25.9	10:26	5.3	15.9	10:26	11.8	12.1	-
10:27	184.3	37.1	10:27	18.8	16.4	10:27	13.0	12.2	-
10:28	42.0	39.0	10:28	33.3	18.0	10:28	15.0	12.5	-
10:29	45.5	40.7	10:29	8.5	14.7	10:29	14.8	12.7	-
10:30	30.5	40.9	10:30	9.3	12.6	10:30	19.0	13.2	-
10:31	20.8	40.9	10:31	30.5	13.7	10:31	23.8	13.9	-
10:32	19.0	40.7	10:32	118.0	21.1	10:32	21.8	14.4	-
10:33	13.3	39.1	10:33	37.5	23.1	10:33	20.8	14.8	-
10:34	10.8	38.0	10:34	3.3	22.9	10:34	34.5	16.4	-
10:35	11.5	37.5	10:35	10.3	22.9	10:35	43.8	18.5	-
10:36	13.5	37.0	10:36	15.0	23.0	10:36	30.3	19.6	-
10:37	13.8	36.9	10:37	35.8	22.9	10:37	26.8	20.5	-

PARTICULATE DATA									
Upwind			Downwind						Exceeds Particulate Alarm Limit
Time	Concentration (ug/m ³)	15-Min Avg Concentration (ug/m ³)	Time	Concentration (ug/m ³)	15-Min Avg Concentration (ug/m ³)	Time	Concentration (ug/m ³)	15-Min Avg Concentration (ug/m ³)	
10:38	13.8	36.5	10:38	102.0	29.4	10:38	16.0	20.8	-
10:39	12.3	36.3	10:39	17.5	30.2	10:39	20.0	21.5	-
10:40	7.5	35.8	10:40	48.3	32.9	10:40	17.3	21.9	-
10:41	9.8	29.9	10:41	21.5	34.0	10:41	11.5	21.9	-
10:42	8.5	18.2	10:42	22.8	34.2	10:42	16.3	22.1	-
10:43	6.5	15.8	10:43	15.0	33.0	10:43	25.0	22.8	-
10:44	19.5	14.1	10:44	16.3	33.5	10:44	18.8	23.0	-
10:45	11.8	12.8	10:45	14.5	33.9	10:45	10.0	22.4	-
10:46	25.5	13.1	10:46	10.8	32.6	10:46	9.8	21.5	-
10:47	44.3	14.8	10:47	33.0	26.9	10:47	9.0	20.6	-
10:48	5.0	14.3	10:48	42.0	27.2	10:48	22.3	20.7	-
10:49	20.8	14.9	10:49	18.3	28.2	10:49	58.5	22.3	-
10:50	12.8	15.0	10:50	26.3	29.3	10:50	28.5	21.3	-
10:51	12.3	14.9	10:51	32.0	30.4	10:51	17.0	20.4	-
10:52	3.0	14.2	10:52	28.5	29.9	10:52	13.8	19.6	-
10:53	6.8	13.7	10:53	13.8	24.0	10:53	11.8	19.3	-
10:54	2.5	13.1	10:54	11.0	23.6	10:54	16.0	19.0	-
10:55	2.5	12.8	10:55	11.0	21.1	10:55	15.0	18.9	-
10:56	1.3	12.2	10:56	12.0	20.5	10:56	12.8	19.0	-
10:57	2.0	11.8	10:57	14.3	19.9	10:57	13.5	18.8	-
10:58	3.3	11.5	10:58	43.0	21.8	10:58	14.3	18.1	-
10:59	4.8	10.6	10:59	56.3	24.4	10:59	19.0	18.1	-
11:00	6.3	10.2	11:00	46.0	26.5	11:00	19.3	18.7	-
11:01	7.0	9.0	11:01	59.8	29.8	11:01	17.0	19.2	-
11:02	6.5	6.4	11:02	48.3	30.8	11:02	16.5	19.7	-
11:03	3.5	6.3	11:03	21.0	29.4	11:03	17.8	19.4	-
11:04	2.0	5.1	11:04	19.5	29.5	11:04	18.3	16.7	-
11:05	3.0	4.4	11:05	29.3	29.7	11:05	17.0	15.9	-
11:06	3.0	3.8	11:06	27.5	29.4	11:06	18.5	16.0	-
11:07	2.0	3.8	11:07	28.0	29.4	11:07	27.5	16.9	-
11:08	3.8	3.6	11:08	21.3	29.9	11:08	34.3	18.4	-
11:09	3.8	3.6	11:09	20.3	30.5	11:09	26.8	19.2	-
11:10	4.0	3.7	11:10	16.0	30.8	11:10	26.0	19.9	-
11:11	6.0	4.1	11:11	17.3	31.2	11:11	29.0	21.0	-
11:12	13.0	4.8	11:12	17.3	31.4	11:12	26.5	21.8	-
11:13	4.5	4.9	11:13	13.8	29.4	11:13	28.3	22.8	-
11:14	12.0	5.4	11:14	14.0	26.6	11:14	46.3	24.6	-
11:15	4.5	5.2	11:15	12.5	24.4	11:15	34.0	25.6	-
11:16	2.0	4.9	11:16	12.3	21.2	11:16	33.5	26.7	-
11:17	3.3	4.7	11:17	12.8	18.8	11:17	37.8	28.1	-
11:18	5.8	4.8	11:18	12.0	18.2	11:18	24.0	28.5	-
11:19	4.0	5.0	11:19	12.8	17.8	11:19	28.0	29.2	-
11:20	3.3	5.0	11:20	20.5	17.2	11:20	18.3	29.2	-
11:21	6.0	5.2	11:21	21.3	16.8	11:21	15.8	29.1	-
11:22	8.8	5.6	11:22	19.3	16.2	11:22	13.0	28.1	-
11:23	7.8	5.9	11:23	16.8	15.9	11:23	11.5	26.6	-
11:24	6.0	6.1	11:24	11.8	15.3	11:24	22.5	26.3	-
11:25	16.0	6.9	11:25	2.3	14.4	11:25	11.8	25.3	-
11:26	13.5	7.4	11:26	2.5	13.4	11:26	12.0	24.2	-
11:27	16.5	7.6	11:27	2.3	12.4	11:27	13.0	23.3	-
11:28	16.5	8.4	11:28	4.3	11.8	11:28	12.5	22.3	-
11:29	13.3	8.5	11:29	3.3	11.1	11:29	12.0	20.0	-
11:30	12.3	9.0	11:30	1.8	10.4	11:30	11.0	18.4	-
11:31	13.5	9.8	11:31	1.3	9.6	11:31	13.0	17.1	-
11:32	14.3	10.5	11:32	2.8	9.0	11:32	27.8	16.4	-
11:33	11.3	10.9	11:33	1.3	8.3	11:33	18.8	16.1	-
11:34	57.0	14.4	11:34	2.0	7.5	11:34	13.5	15.1	-
11:35	97.8	20.7	11:35	2.8	6.4	11:35	28.0	15.7	-
11:36	54.0	23.9	11:36	2.8	5.1	11:36	54.8	18.3	-
11:37	38.0	25.8	11:37	8.5	4.4	11:37	42.5	20.3	-
11:38	52.5	28.8	11:38	6.5	3.7	11:38	42.0	22.3	-
11:39	25.8	30.1	11:39	4.0	3.2	11:39	34.0	23.1	-
11:40	15.3	30.1	11:40	4.5	3.4	11:40	24.3	23.9	-
11:41	15.5	30.2	11:41	4.5	3.5	11:41	38.3	25.7	-
11:42	15.8	30.2	11:42	2.0	3.5	11:42	40.3	27.5	-
11:43	15.0	30.1	11:43	2.5	3.4	11:43	36.5	29.1	-
11:44	11.3	29.9	11:44	5.3	3.5	11:44	45.3	31.3	-
11:45	12.3	29.9	11:45	4.8	3.7	11:45	39.3	33.2	-
11:46	12.3	29.9	11:46	5.5	4.0	11:46	38.0	34.9	-
11:47	11.8	29.7	11:47	5.5	4.2	11:47	29.0	35.0	-
11:48	11.0	29.7	11:48	6.0	4.5	11:48	25.3	35.4	-
11:49	11.3	26.6	11:49	7.0	4.8	11:49	35.8	36.9	-
11:50	11.5	20.9	11:50	6.5	5.1	11:50	28.8	36.9	-
11:51	12.0	18.1	11:51	6.0	5.3	11:51	34.8	35.6	-
11:52	12.0	16.3	11:52	8.3	5.3	11:52	19.8	34.1	-
11:53	12.8	13.7	11:53	8.3	5.4	11:53	30.5	33.3	-

PARTICULATE DATA									
Upwind			Downwind						Exceeds Particulate Alarm Limit
Time	Concentration (ug/m ³)	15-Min Avg Concentration (ug/m ³)	Time	Concentration (ug/m ³)	15-Min Avg Concentration (ug/m ³)	Time	Concentration (ug/m ³)	15-Min Avg Concentration (ug/m ³)	
11:54	13.8	12.9	11:54	9.3	5.7	11:54	31.5	33.1	-
11:55	17.5	13.0	11:55	11.5	6.2	11:55	23.5	33.1	-
11:56	21.5	13.4	11:56	14.8	6.9	11:56	28.5	32.4	-
11:57	25.0	14.1	11:57	18.0	7.9	11:57	25.3	31.4	-
11:58	33.5	15.3	11:58	18.8	9.0	11:58	29.8	31.0	-
11:59	26.0	16.3	11:59	19.5	10.0	11:59	29.3	29.9	-
12:00	46.8	18.6	12:00	14.8	10.6	12:00	34.0	29.6	-
12:01	75.8	22.8	12:01	15.8	11.3	12:01	31.0	29.1	-
12:02	34.8	24.3	12:02	16.5	12.1	12:02	27.3	29.0	-
12:03	27.0	25.4	12:03	18.3	12.9	12:03	21.3	28.7	-
12:04	31.0	26.7	12:04	17.0	13.5	12:04	19.5	27.6	-
12:05	21.5	27.4	12:05	16.0	14.2	12:05	20.5	27.1	-
12:06	65.8	31.0	12:06	18.8	15.0	12:06	20.3	26.1	-
12:07	83.3	35.7	12:07	19.0	15.7	12:07	22.0	26.3	-
12:08	25.0	36.5	12:08	20.0	16.5	12:08	31.5	26.3	-
12:09	21.8	37.1	12:09	21.0	17.3	12:09	28.8	26.2	-
12:10	22.8	37.4	12:10	22.0	18.0	12:10	33.3	26.8	-
12:11	21.3	37.4	12:11	23.5	18.6	12:11	35.3	27.3	-
12:12	22.3	37.2	12:12	22.0	18.9	12:12	38.5	28.1	-
12:13	21.8	36.4	12:13	25.5	19.3	12:13	31.5	28.3	-
12:14	20.8	36.1	12:14	24.8	19.7	12:14	53.3	29.9	-
12:15	19.3	34.3	12:15	24.0	20.3	12:15	41.5	30.4	-
12:16	19.0	30.5	12:16	26.0	21.0	12:16	35.0	30.6	-
12:17	19.3	29.4	12:17	28.8	21.8	12:17	35.0	31.1	-
12:18	19.3	28.9	12:18	26.0	22.3	12:18	33.8	32.0	-
12:19	20.0	28.2	12:19	26.3	22.9	12:19	29.0	32.6	-
12:20	19.0	28.0	12:20	28.5	23.7	12:20	39.0	33.8	-
12:21	19.3	24.9	12:21	24.3	24.1	12:21	33.8	34.7	-
12:22	19.8	20.7	12:22	25.0	24.5	12:22	36.8	35.7	-
12:23	19.0	20.3	12:23	27.0	25.0	12:23	28.8	35.5	-
12:24	19.0	20.1	12:24	29.3	25.5	12:24	29.5	35.6	-
12:25	19.3	19.9	12:25	29.3	26.0	12:25	28.3	35.3	-
12:26	20.8	19.8	12:26	29.0	26.4	12:26	31.5	35.0	-
12:27	22.8	19.9	12:27	28.3	26.8	12:27	35.3	34.8	-
12:28	23.3	20.0	12:28	28.8	27.0	12:28	36.3	35.1	-
12:29	23.5	20.2	12:29	27.5	27.2	12:29	24.8	33.2	-
12:30	22.0	20.3	12:30	24.8	27.2	12:30	24.0	32.0	-
12:31	22.0	20.5	12:31	23.8	27.1	12:31	23.0	31.2	-
12:32	21.0	20.7	12:32	23.5	26.7	12:32	29.3	30.9	-
12:33	19.8	20.7	12:33	22.8	26.5	12:33	35.3	31.0	-
12:34	19.5	20.7	12:34	24.3	26.4	12:34	36.8	31.5	-
12:35	21.5	20.8	12:35	29.3	26.4	12:35	39.3	31.5	-
12:36	25.0	21.2	12:36	40.3	27.5	12:36	45.5	32.3	-
12:37	25.0	21.6	12:37	43.0	28.7	12:37	49.3	33.1	-
12:38	26.0	22.0	12:38	37.5	29.4	12:38	43.0	34.1	-
12:39	25.0	22.4	12:39	34.0	29.7	12:39	48.3	35.3	-
12:40	24.3	22.8	12:40	31.0	29.8	12:40	43.0	36.3	-
12:41	22.5	22.9	12:41	29.0	29.8	12:41	37.0	36.7	-
12:42	22.0	22.8	12:42	27.8	29.8	12:42	30.0	36.3	-
12:43	23.5	22.8	12:43	27.0	29.7	12:43	26.8	35.7	-
12:44	23.0	22.8	12:44	27.8	29.7	12:44	27.8	35.9	-
12:45	23.0	22.9	12:45	31.3	30.1	12:45	28.0	36.1	-
12:46	22.5	22.9	12:46	30.5	30.6	12:46	32.8	36.8	-
12:47	23.0	23.0	12:47	28.5	30.9	12:47	31.8	37.0	-
12:48	23.0	23.3	12:48	29.5	31.4	12:48	31.3	36.7	-
12:49	22.0	23.4	12:49	31.5	31.9	12:49	29.5	36.2	-
12:50	22.0	23.5	12:50	30.5	31.9	12:50	27.5	35.4	-
12:51	22.0	23.3	12:51	31.5	31.4	12:51	34.3	34.7	-
12:52	22.8	23.1	12:52	36.3	30.9	12:52	45.3	34.4	-
12:53	23.5	22.9	12:53	36.3	30.8	12:53	56.8	35.3	-
12:54	24.0	22.9	12:54	36.3	31.0	12:54	41.3	34.9	-
12:55	24.3	22.9	12:55	39.8	31.6	12:55	59.0	35.9	-
12:56	24.8	23.0	12:56	40.5	32.3	12:56	39.0	36.1	-
12:57	24.0	23.2	12:57	40.0	33.1	12:57	31.8	36.2	-
12:58	25.3	23.3	12:58	38.5	33.9	12:58	36.5	36.8	-
12:59	25.8	23.5	12:59	36.0	34.5	12:59	28.8	36.9	-
13:00	24.8	23.6	13:00	33.5	34.6	13:00	25.5	36.7	-
13:01	24.0	23.7	13:01	31.0	34.6	13:01	25.5	36.2	-
13:02	23.0	23.7	13:02	30.0	34.7	13:02	25.8	35.8	-
13:03	23.5	23.7	13:03	30.3	34.8	13:03	23.5	35.3	-
13:04	23.8	23.8	13:04	29.8	34.7	13:04	23.5	34.9	-
13:05	23.0	23.9	13:05	29.8	34.6	13:05	23.5	34.7	-
13:06	23.3	24.0	13:06	31.0	34.6	13:06	23.5	33.9	-
13:07	24.3	24.1	13:07	30.8	34.2	13:07	24.0	32.5	-
13:08	26.0	24.2	13:08	32.5	34.0	13:08	25.0	30.4	-
13:09	26.8	24.4	13:09	32.0	33.7	13:09	25.0	29.3	-

PARTICULATE DATA									
Upwind			Downwind						Exceeds Particulate Alarm Limit
Time	Concentration (ug/m ³)	15-Min Avg Concentration (ug/m ³)	Time	Concentration (ug/m ³)	15-Min Avg Concentration (ug/m ³)	Time	Concentration (ug/m ³)	15-Min Avg Concentration (ug/m ³)	
13:10	31.0	24.9	13:10	24.5	32.7	13:10	25.3	27.1	-
13:11	32.0	25.4	13:11	24.0	31.6	13:11	24.0	26.1	-
13:12	33.0	26.0	13:12	24.8	30.6	13:12	25.5	25.7	-
13:13	30.8	26.3	13:13	24.5	29.6	13:13	27.0	25.0	-
13:14	31.5	26.7	13:14	25.0	28.9	13:14	25.3	24.8	-
13:15	32.0	27.2	13:15	25.0	28.3	13:15	28.0	25.0	-
13:16	30.5	27.6	13:16	24.8	27.9	13:16	27.8	25.1	-
13:17	30.8	28.1	13:17	24.8	27.6	13:17	28.3	25.3	-
13:18	28.8	28.5	13:18	23.5	27.1	13:18	24.3	25.3	-
13:19	27.5	28.7	13:19	23.0	26.7	13:19	25.8	25.5	-
13:20	29.0	29.1	13:20	23.0	26.2	13:20	24.3	25.5	-
13:21	38.0	30.1	13:21	23.0	25.7	13:21	25.0	25.6	-
13:22	46.0	31.6	13:22	23.3	25.2	13:22	25.8	25.7	-
13:23	31.0	31.9	13:23	24.0	24.6	13:23	26.8	25.9	-
13:24	27.3	31.9	13:24	23.0	24.0	13:24	25.0	25.9	-
13:25	23.0	31.4	13:25	34.5	24.7	13:25	23.0	25.7	-
13:26	23.0	30.8	13:26	36.0	25.5	13:26	23.0	25.6	-
13:27	22.0	30.1	13:27	29.0	25.8	13:27	23.0	25.5	-
13:28	22.3	29.5	13:28	29.3	26.1	13:28	23.0	25.2	-
13:29	23.0	28.9	13:29	31.3	26.5	13:29	23.0	25.1	-
13:30	23.0	28.3	13:30	30.0	26.8	13:30	22.5	24.7	-
13:31	23.5	27.9	13:31	28.3	27.1	13:31	23.0	24.4	-
13:32	24.0	27.4	13:32	29.5	27.4	13:32	24.5	24.1	-
13:33	25.0	27.2	13:33	28.5	27.7	13:33	29.5	24.5	-
13:34	25.8	27.1	13:34	33.5	28.4	13:34	59.8	26.7	-
13:35	26.0	26.9	13:35	31.5	29.0	13:35	51.3	28.5	-
13:36	26.0	26.1	13:36	34.3	29.7	13:36	38.0	29.4	-
13:37	26.5	24.8	13:37	30.3	30.2	13:37	45.5	30.7	-
13:38	26.5	24.5	13:38	28.3	30.5	13:38	37.0	31.4	-
13:39	25.8	24.4	13:39	32.0	31.1	13:39	62.5	33.9	-
13:40	26.3	24.6	13:40	30.8	30.8	13:40	42.8	35.2	-
13:41	27.3	24.9	13:41	32.3	30.6	13:41	37.5	36.2	-
13:42	25.5	25.1	13:42	30.5	30.7	13:42	46.5	37.8	-
13:43	25.8	25.3	13:43	26.0	30.5	13:43	36.5	38.7	-
13:44	26.0	25.5	13:44	27.8	30.2	13:44	43.0	40.0	-
13:45	22.8	25.5	13:45	25.5	29.9	13:45	42.5	41.3	-
13:46	21.3	25.4	13:46	21.5	29.5	13:46	40.8	42.5	-
13:47	21.0	25.2	13:47	23.0	29.0	13:47	37.0	43.3	-
13:48	21.0	24.9	13:48	22.3	28.6	13:48	28.8	43.3	-
13:49	21.0	24.6	13:49	22.8	27.9	13:49	31.5	41.4	-
13:50	28.3	24.7	13:50	21.0	27.2	13:50	19.3	39.3	-
13:51	35.3	25.3	13:51	20.0	26.3	13:51	15.5	37.8	-
13:52	26.0	25.3	13:52	18.3	25.5	13:52	11.0	35.5	-
13:53	22.0	25.0	13:53	31.0	25.6	13:53	5.5	33.4	-
13:54	18.3	24.5	13:54	74.0	28.4	13:54	2.0	29.3	-
13:55	15.8	23.8	13:55	18.3	27.6	13:55	-3.3	26.3	-
13:56	21.0	23.4	13:56	11.0	26.2	13:56	-5.3	23.4	-
13:57	13.5	22.6	13:57	9.5	24.8	13:57	-5.5	20.0	-
13:58	23.8	22.5	13:58	8.5	23.6	13:58	-2.5	17.4	-
13:59	14.0	21.7	13:59	10.5	22.5	13:59	-4.8	14.2	-
14:00	20.0	21.5	14:00	26.3	22.5	14:00	-7.8	10.8	-
14:01	10.3	20.7	14:01	22.5	22.6	14:01	-8.0	7.6	-
14:02	9.8	20.0	14:02	33.0	23.3	14:02	-8.3	4.6	-
14:03	25.3	20.3	14:03	9.3	22.4	14:03	-9.0	2.0	-
14:04	13.3	19.8	14:04	9.3	21.5	14:04	-8.0	-0.6	-
14:05	14.5	18.8	14:05	5.5	20.5	14:05	-8.8	-2.5	-
14:06	10.0	17.2	14:06	5.3	19.5	14:06	-9.0	-4.1	-
14:07	7.0	15.9	14:07	5.3	18.6	14:07	-9.0	-5.4	-
14:08	6.3	14.8	14:08	4.0	16.8	14:08	-8.5	-6.4	-
14:09	8.5	14.2	14:09	4.5	12.2	14:09	-5.8	-6.9	-
14:10	18.0	14.3	14:10	6.5	11.4	14:10	-3.8	-6.9	-
14:11	10.8	13.7	14:11	5.0	11.0	14:11	-5.8	-7.0	-
14:12	12.0	13.6	14:12	5.5	10.7	14:12	-6.0	-7.0	-
14:13	27.0	13.8	14:13	5.5	10.5	14:13	-6.0	-7.2	-
14:14	19.5	14.1	14:14	4.5	10.1	14:14	-4.5	-7.2	-
14:15	11.0	13.5	14:15	5.0	8.7	14:15	-5.5	-7.1	-
14:16	9.3	13.5	14:16	5.0	7.5	14:16	-6.3	-6.9	-
14:17	9.8	13.5	14:17	6.0	5.7	14:17	-3.5	-6.6	-
14:18	11.5	12.6	14:18	6.5	5.6	14:18	-4.3	-6.3	-
14:19	5.0	12.0	14:19	6.0	5.3	14:19	-6.5	-6.2	-
14:20	4.0	11.3	14:20	5.5	5.3	14:20	-5.3	-6.0	-
14:21	4.8	11.0	14:21	5.0	5.3	14:21	-6.8	-5.8	-
14:22	5.8	10.9	14:22	5.8	5.4	14:22	-7.5	-5.7	-
14:23	6.0	10.9	14:23	6.3	5.5	14:23	-7.5	-5.7	-
14:24	15.5	11.3	14:24	6.5	5.6	14:24	-6.3	-5.7	-
14:25	40.8	12.8	14:25	6.0	5.6	14:25	-4.3	-5.7	-

PARTICULATE DATA									
Upwind			Downwind						Exceeds Particulate Alarm Limit
Time	Concentration (ug/m ³)	15-Min Avg Concentration (ug/m ³)	Time	Concentration (ug/m ³)	15-Min Avg Concentration (ug/m ³)	Time	Concentration (ug/m ³)	15-Min Avg Concentration (ug/m ³)	
14:26	31.5	14.2	14:26	5.0	5.6	14:26	-6.5	-5.8	-
14:27	7.8	13.9	14:27	5.0	5.6	14:27	-7.0	-5.8	-
14:28	6.3	12.6	14:28	5.0	5.5	14:28	-6.3	-5.9	-
14:29	6.0	11.7	14:29	5.3	5.6	14:29	-7.0	-6.0	-
14:30	5.8	11.3	14:30	6.8	5.7	14:30	-6.8	-6.1	-
14:31	19.0	12.0	14:31	5.0	5.7	14:31	-6.8	-6.1	-
14:32	20.3	12.7	14:32	5.0	5.6	14:32	-6.3	-6.3	-
14:33	17.0	13.0	14:33	5.0	5.5	14:33	-1.5	-6.1	-
14:34	15.5	13.7	14:34	4.8	5.5	14:34	-5.0	-6.0	-
14:35	14.5	14.4	14:35	4.5	5.4	14:35	-6.3	-6.1	-
14:36	11.5	14.9	14:36	6.5	5.5	14:36	-5.8	-6.0	-
14:37	10.0	15.2	14:37	9.0	5.7	14:37	-5.3	-5.9	-
14:38	8.5	15.3	14:38	6.8	5.7	14:38	-6.5	-5.8	-
14:39	10.0	15.0	14:39	5.3	5.7	14:39	-5.0	-5.7	-
14:40	9.5	12.9	14:40	5.8	5.6	14:40	-6.5	-5.9	-
14:41	22.3	12.3	14:41	6.3	5.7	14:41	-6.5	-5.9	-
14:42	9.8	12.4	14:42	6.0	5.8	14:42	-5.8	-5.8	-
14:43	9.3	12.6	14:43	6.0	5.9	14:43	-6.0	-5.8	-
14:44	7.3	12.7	14:44	6.0	5.9	14:44	-5.5	-5.7	-
14:45	7.5	12.8	14:45	7.5	6.0	14:45	-5.0	-5.6	-
14:46	8.5	12.1	14:46	7.5	6.1	14:46	-5.0	-5.5	-
14:47	21.0	12.1	14:47	7.0	6.3	14:47	-4.3	-5.3	-
14:48	20.0	12.3	14:48	7.0	6.4	14:48	-4.3	-5.5	-
14:49	16.0	12.4	14:49	6.0	6.5	14:49	-4.5	-5.5	-
14:50	12.0	12.2	14:50	6.0	6.6	14:50	-5.3	-5.4	-
14:51	8.8	12.0	14:51	6.0	6.5	14:51	-6.0	-5.4	-
14:52	14.0	12.3	14:52	6.5	6.4	14:52	-6.5	-5.5	-
14:53	7.0	12.2	14:53	8.0	6.5	14:53	-7.0	-5.5	-
14:54	8.3	12.1	14:54	7.3	6.6	14:54	-6.3	-5.6	-
14:55	20.5	12.8	14:55	8.0	6.7	14:55	-5.8	-5.6	-
14:56	11.3	12.1	14:56	8.5	6.9	14:56	-5.3	-5.5	-
14:57	20.5	12.8	14:57	8.0	7.0	14:57	-4.8	-5.4	-
14:58	10.8	12.9	14:58	8.8	7.2	14:58	-6.5	-5.5	-
14:59	7.0	12.9	14:59	8.5	7.4	14:59	-7.0	-5.6	-
15:00	8.5	12.9	15:00	7.3	7.4	15:00	-6.3	-5.6	-
15:01	9.5	13.0	15:01	6.0	7.3	15:01	-4.3	-5.6	-
15:02	5.8	12.0	15:02	6.3	7.2	15:02	-5.0	-5.6	-
15:03	11.5	11.4	15:03	7.0	7.2	15:03	-5.0	-5.7	-
15:04	8.3	10.9	15:04	8.0	7.3	15:04	-4.5	-5.7	-
15:05	10.8	10.8	15:05	8.0	7.5	15:05	-4.0	-5.6	-
15:06	7.5	10.7	15:06	7.5	7.6	15:06	-3.3	-5.4	-
15:07	9.5	10.4	15:07	7.8	7.7	15:07	-3.0	-5.2	-
15:08	9.5	10.6	15:08	6.8	7.6	15:08	-3.5	-5.0	-
15:09	5.0	10.4	15:09	7.0	7.6	15:09	-5.3	-4.9	-
15:10	4.0	9.3	15:10	7.0	7.5	15:10	-5.3	-4.9	-
15:11	5.3	8.9	15:11	6.0	7.3	15:11	-5.5	-4.9	-
15:12	6.8	8.0	15:12	7.0	7.3	15:12	-3.3	-4.8	-
15:13	5.5	7.6	15:13	7.0	7.1	15:13	-4.3	-4.6	-
15:14	5.0	7.5	15:14	7.0	7.0	15:14	-3.5	-4.4	-
15:15	6.0	7.3	15:15	7.0	7.0	15:15	-2.8	-4.2	-
15:16	11.0	7.4	15:16	6.0	7.0	15:16	-3.0	-4.1	-
15:17	8.3	7.6	15:17	6.0	7.0	15:17	-3.3	-4.0	-
15:18	8.0	7.4	15:18	6.0	6.9	15:18	-2.3	-3.8	-
15:19	7.3	7.3	15:19	7.0	6.9	15:19	-1.5	-3.6	-
15:20	6.3	7.0	15:20	7.8	6.9	15:20	-3.5	-3.5	-
15:21	14.3	7.4	15:21	7.0	6.8	15:21	-4.0	-3.6	-
15:22	9.0	7.4	15:22	7.0	6.8	15:22	-4.0	-3.7	-
15:23	11.3	7.5	15:23	7.0	6.8	15:23	-5.0	-3.8	-
15:24	7.3	7.7	15:24	7.0	6.8	15:24	-5.0	-3.7	-
15:25	8.0	7.9	15:25	6.3	6.7	15:25	-5.0	-3.7	-
15:26	11.3	8.3	15:26	6.3	6.8	15:26	-5.0	-3.7	-
15:27	11.3	8.6	15:27	7.0	6.8	15:27	-4.0	-3.7	-
15:28	8.5	8.8	15:28	6.0	6.7	15:28	-5.0	-3.8	-
15:29	9.5	9.1	15:29	6.0	6.6	15:29	-4.0	-3.8	-
15:30	10.5	9.4	15:30	6.5	6.6	15:30	-4.8	-4.0	-
15:31	10.0	9.4	15:31	7.8	6.7	15:31	-3.0	-4.0	-
15:32	12.5	9.7	15:32	6.5	6.7	15:32	-2.8	-3.9	-
15:33	8.5	9.7	15:33	6.0	6.7	15:33	-1.3	-3.9	-
15:34	6.3	9.6	15:34	5.8	6.7	15:34	-2.8	-3.9	-
15:35	6.0	9.6	15:35	6.0	6.5	15:35	-2.5	-3.9	-
15:36	5.0	9.0	15:36	6.3	6.5	15:36	-2.8	-3.8	-
15:37	5.3	8.7	15:37	6.3	6.4	15:37	-5.0	-3.9	-
15:38	5.0	8.3	15:38	7.0	6.4	15:38	-4.3	-3.8	-
15:39	5.0	8.2	15:39	7.0	6.4	15:39	-3.8	-3.7	-
15:40	7.0	8.1	15:40	6.8	6.5	15:40	-1.8	-3.5	-
15:41	5.0	7.7	15:41	6.0	6.5	15:41	-3.3	-3.4	-

PARTICULATE DATA									
Upwind			Downwind						Exceeds Particulate Alarm Limit
Time	Concentration (ug/m ³)	15-Min Avg Concentration (ug/m ³)	Time	Concentration (ug/m ³)	15-Min Avg Concentration (ug/m ³)	Time	Concentration (ug/m ³)	15-Min Avg Concentration (ug/m ³)	
15:42	5.5	7.3	15:42	6.5	6.4	15:42	-3.5	-3.4	-
15:43	5.0	7.1	15:43	6.0	6.4	15:43	-2.5	-3.2	-
15:44	4.3	6.7	15:44	6.8	6.5	15:44	-3.0	-3.1	-
15:45	5.0	6.4	15:45	6.8	6.5	15:45	-2.0	-2.9	-
15:46	5.0	6.0	15:46	6.8	6.4	15:46	-2.3	-2.9	-
15:47	8.8	5.8	15:47	7.0	6.5	15:47	-3.0	-2.9	-
15:48	8.8	5.8	15:48	7.0	6.5	15:48	-2.0	-3.0	-
15:49	10.5	6.1	15:49	7.0	6.6	15:49	1.5	-2.7	-
15:50	7.3	6.2	15:50	6.0	6.6	15:50	-0.5	-2.5	-
15:51	9.5	6.5	15:51	6.0	6.6	15:51	-1.3	-2.4	-
15:52	5.0	6.4	15:52	6.3	6.6	15:52	-2.0	-2.2	-
15:53	4.0	6.4	15:53	6.8	6.6	15:53	-2.8	-2.1	-
15:54	5.5	6.4	15:54	6.0	6.5	15:54	-3.0	-2.1	-
15:55	7.0	6.4	15:55	6.0	6.5	15:55	-3.5	-2.2	-
15:56	8.3	6.6	15:56	6.3	6.5	15:56	-3.0	-2.2	-
15:57	8.3	6.8	15:57	6.3	6.5	15:57	1.5	-1.9	-
15:58	6.0	6.9	15:58	5.0	6.4	15:58	-1.5	-1.8	-
15:59	7.5	7.1	15:59	5.8	6.3	15:59	0.8	-1.5	-
16:00	6.0	7.2	16:00	5.2	6.2	16:00	-2.5	-1.6	-
16:01	4.5	7.1	16:01	5.0	6.1	16:01	-1.8	-1.5	-
16:02	3.8	6.8	16:02	5.0	6.0	16:02	-1.8	-1.5	-
16:03	5.3	6.6	16:03	5.0	5.8	16:03	-1.0	-1.4	-
16:04	4.0	6.1	16:04	5.0	5.7	16:04	0.3	-1.5	-
16:05	6.0	6.0	16:05	5.6	5.7	16:05	3.0	-1.2	-
16:06	8.3	6.0	16:06	6.0	5.7	16:06	0.3	-1.1	-
16:07	8.8	6.2	16:07	6.2	5.7	16:07	0.5	-1.0	-
16:08	9.3	6.6	16:08	7.8	5.7	16:08	-1.3	-0.9	-
16:09	6.5	6.6	16:09	8.0	5.9	16:09	-2.3	-0.8	-
16:10	2.0	6.3	16:10	10.0	6.1	16:10	7.0	-0.1	-
16:11	-1.5	5.6	16:11	14.3	6.7	16:11	6.6	0.5	-
16:12	-1.8	5.0	16:12	13.3	7.1	16:12	6.0	0.8	-
16:13	-2.0	4.4	16:13	6.5	7.2	16:13	6.0	1.3	-
16:14	-2.0	3.8	16:14	9.8	7.5	16:14	7.0	1.7	-
16:15	-2.0	3.3	16:15	6.0	7.6	16:15	7.8	2.4	-
16:16	-1.5	2.9	16:16	4.8	7.5	16:16	6.0	2.9	-
16:17	-0.3	2.6	16:17	4.0	7.5	16:17	6.0	3.5	-
16:18	-1.5	2.2	16:18	4.3	7.4	16:18	6.0	3.9	-
16:19	-0.3	1.9	16:19	4.5	7.4	16:19	6.0	4.3	-
16:20	-0.8	1.4	16:20	4.3	7.3	16:20	6.0	4.5	-
16:21	7.8	1.4	16:21	7.8	7.4	16:21	6.0	4.9	-
16:22	21.8	2.3	16:22	6.3	7.4	16:22	6.0	5.3	-
16:23	-0.5	1.6	16:23	5.5	7.3	16:23	6.0	5.7	-
16:24	-0.3	1.2	16:24	5.0	7.1	16:24	6.0	6.3	-
16:25	0.0	1.0	16:25	10.0	7.1	16:25	6.0	6.2	-
16:26	-0.3	1.1	16:26	6.0	6.5	16:26	6.0	6.2	-
16:27	-1.0	1.2	16:27	4.5	5.9	16:27	6.0	6.2	-
16:28	-0.8	1.2	16:28	4.8	5.8	16:28	6.0	6.2	-
16:29	0.0	1.4	16:29	3.0	5.4	16:29	5.6	6.1	-
16:30	0.8	1.6	16:30	2.5	5.1	16:30	5.8	6.0	-
16:31	0.0	1.7	16:31	3.0	5.0	16:31	5.4	5.9	-
16:32	0.0	1.7	16:32	4.3	5.0	16:32	5.8	5.9	-
16:33	0.0	1.8	16:33	4.0	5.0	16:33	5.0	5.8	-
16:34	0.0	1.8	16:34	4.3	5.0	16:34	5.0	5.8	-
16:35	1.5	1.9	16:35	5.5	5.1	16:35	5.6	5.7	-
16:36	1.0	1.5	16:36	4.8	4.9	16:36	6.0	5.7	-
16:37	1.0	0.1	16:37	4.5	4.8	16:37	6.0	5.7	-
16:38	0.0	0.1	16:38	5.0	4.7	16:38	6.0	5.7	-
16:39	0.0	0.2	16:39	4.0	4.7	16:39	6.0	5.7	-
16:40	0.0	0.2	16:40	3.8	4.3	16:40	5.6	5.7	-
16:41	0.0	0.2	16:41	4.3	4.1	16:41	6.4	5.7	-
16:42	0.0	0.2	16:42	5.0	4.2	16:42	8.2	5.9	-
16:43	0.8	0.3	16:43	3.0	4.1	16:43	5.6	5.9	-
16:44	2.3	0.5	16:44	2.8	4.0	16:44	5.6	5.9	-
16:45	0.8	0.5	16:45	2.5	4.0	16:45	5.4	5.8	-
16:46	0.0	0.5	16:46	2.5	4.0	16:46	5.0	5.8	-
16:47	0.0	0.5	16:47	2.5	3.9	16:47	5.2	5.8	-
16:48	0.0	0.5	16:48	2.0	3.8	16:48	6.0	5.8	-
16:49	0.8	0.5	16:49	2.8	3.7	16:49	6.4	5.9	-
16:50	1.3	0.5	16:50	3.0	3.5	16:50	5.6	5.9	-

Friday, January 13, 2023

Number of Instances Where Downwind VOCs Exceeds Upwind VOCs + 5 = 0

Number of Comparable Data Points = 580

Start Time: 6:56

End Time: 16:50

PID DATA

Upwind			Downwind					Exceeds Particulate Alarm Limit	
Time	Concentration (ppm)	15-Min Avg Concentration (ppm)	Time	Concentration (ppm)	15-Min Avg Concentration (ppm)	Time	Concentration (ppm)		15-Min Avg Concentration (ppm)
6:56	0.0	-	6:56	0.0	-	6:56	0.0	-	-
6:57	0.0	-	6:57	0.0	-	6:57	0.0	-	-
6:58	0.0	-	6:58	0.0	-	6:58	0.0	-	-
6:59	0.0	-	6:59	0.0	-	6:59	0.0	-	-
7:00	0.0	-	7:00	0.0	-	7:00	0.0	-	-
7:01	0.0	-	7:01	0.0	-	7:01	0.0	-	-
7:02	0.0	-	7:02	0.0	-	7:02	0.0	-	-
7:03	0.0	-	7:03	0.0	-	7:03	0.0	-	-
7:04	0.0	-	7:04	0.0	-	7:04	0.0	-	-
7:05	0.0	-	7:05	0.0	-	7:05	0.0	-	-
7:06	0.0	-	7:06	0.0	-	7:06	0.0	-	-
7:07	0.0	-	7:07	0.0	-	7:07	0.0	-	-
7:08	0.0	-	7:08	0.0	-	7:08	0.0	-	-
7:09	0.0	-	7:09	0.1	-	7:09	0.0	-	-
7:10	0.0	-	7:10	0.0	-	7:10	0.0	-	-
7:11	0.0	0.0	7:11	0.0	0.0	7:11	0.0	0.0	-
7:12	0.0	0.0	7:12	0.0	0.0	7:12	0.0	0.0	-
7:13	0.0	0.0	7:13	0.0	0.0	7:13	0.0	0.0	-
7:14	0.0	0.0	7:14	0.0	0.0	7:14	0.0	0.0	-
7:15	0.0	0.0	7:15	0.0	0.0	7:15	0.0	0.0	-
7:16	0.0	0.0	7:16	0.0	0.0	7:16	0.0	0.0	-
7:17	0.0	0.0	7:17	0.0	0.0	7:17	0.0	0.0	-
7:18	0.0	0.0	7:18	0.0	0.0	7:18	0.0	0.0	-
7:19	0.0	0.0	7:19	0.0	0.0	7:19	0.0	0.0	-
7:20	0.0	0.0	7:20	0.0	0.0	7:20	0.0	0.0	-
7:21	0.0	0.0	7:21	0.0	0.0	7:21	0.0	0.0	-
7:22	0.0	0.0	7:22	0.0	0.0	7:22	0.0	0.0	-
7:23	0.0	0.0	7:23	0.0	0.0	7:23	0.0	0.0	-
7:24	0.0	0.0	7:24	0.0	0.0	7:24	0.0	0.0	-
7:25	0.0	0.0	7:25	0.0	0.0	7:25	0.0	0.0	-
7:26	0.0	0.0	7:26	0.0	0.0	7:26	0.0	0.0	-
7:27	0.0	0.0	7:27	0.0	0.0	7:27	0.0	0.0	-
7:28	0.0	0.0	7:28	0.0	0.0	7:28	0.0	0.0	-
7:29	0.0	0.0	7:29	0.0	0.0	7:29	0.0	0.0	-
7:30	0.0	0.0	7:30	0.0	0.0	7:30	0.0	0.0	-
7:31	0.0	0.0	7:31	0.0	0.0	7:31	0.0	0.0	-
7:32	0.0	0.0	7:32	0.0	0.0	7:32	0.0	0.0	-
7:33	0.0	0.0	7:33	0.0	0.0	7:33	0.0	0.0	-
7:34	0.0	0.0	7:34	0.0	0.0	7:34	0.0	0.0	-
7:35	0.0	0.0	7:35	0.0	0.0	7:35	0.0	0.0	-
7:36	0.0	0.0	7:36	0.0	0.0	7:36	0.0	0.0	-
7:37	0.0	0.0	7:37	0.0	0.0	7:37	0.0	0.0	-
7:38	0.0	0.0	7:38	0.0	0.0	7:38	0.0	0.0	-
7:39	0.0	0.0	7:39	0.0	0.0	7:39	0.0	0.0	-
7:40	0.0	0.0	7:40	0.0	0.0	7:40	0.0	0.0	-
7:41	0.0	0.0	7:41	0.0	0.0	7:41	0.0	0.0	-
7:42	0.0	0.0	7:42	0.0	0.0	7:42	0.0	0.0	-
7:43	0.0	0.0	7:43	0.0	0.0	7:43	0.0	0.0	-
7:44	0.0	0.0	7:44	0.0	0.0	7:44	0.0	0.0	-
7:45	0.0	0.0	7:45	0.0	0.0	7:45	0.0	0.0	-
7:46	0.0	0.0	7:46	0.0	0.0	7:46	0.0	0.0	-
7:47	0.0	0.0	7:47	0.0	0.0	7:47	0.0	0.0	-
7:48	0.0	0.0	7:48	0.0	0.0	7:48	0.0	0.0	-
7:49	0.0	0.0	7:49	0.0	0.0	7:49	0.0	0.0	-
7:50	0.0	0.0	7:50	0.0	0.0	7:50	0.0	0.0	-
7:51	0.0	0.0	7:51	0.0	0.0	7:51	0.0	0.0	-
7:52	0.0	0.0	7:52	0.0	0.0	7:52	0.0	0.0	-
7:53	0.0	0.0	7:53	0.0	0.0	7:53	0.0	0.0	-
7:54	0.0	0.0	7:54	0.0	0.0	7:54	0.0	0.0	-
7:55	0.0	0.0	7:55	0.0	0.0	7:55	0.0	0.0	-
7:56	0.0	0.0	7:56	0.0	0.0	7:56	0.0	0.0	-
7:57	0.0	0.0	7:57	0.0	0.0	7:57	0.0	0.0	-
7:58	0.0	0.0	7:58	0.0	0.0	7:58	0.0	0.0	-
7:59	0.0	0.0	7:59	0.0	0.0	7:59	0.0	0.0	-
8:00	0.0	0.0	8:00	0.0	0.0	8:00	0.0	0.0	-
8:01	0.0	0.0	8:01	0.0	0.0	8:01	0.0	0.0	-
8:02	0.0	0.0	8:02	0.0	0.0	8:02	0.0	0.0	-
8:03	0.0	0.0	8:03	0.0	0.0	8:03	0.0	0.0	-
8:04	0.0	0.0	8:04	0.0	0.0	8:04	0.0	0.0	-
8:05	0.0	0.0	8:05	0.0	0.0	8:05	0.0	0.0	-

PID DATA									
Upwind			Downwind						Exceeds Particulate Alarm Limit
Time	Concentration (ppm)	15-Min Avg Concentration (ppm)	Time	Concentration (ppm)	15-Min Avg Concentration (ppm)	Time	Concentration (ppm)	15-Min Avg Concentration (ppm)	
8:06	0.0	0.0	8:06	0.0	0.0	8:06	0.0	0.0	-
8:07	0.0	0.0	8:07	0.0	0.0	8:07	0.0	0.0	-
8:08	0.0	0.0	8:08	0.0	0.0	8:08	0.0	0.0	-
8:09	0.0	0.0	8:09	0.0	0.0	8:09	0.0	0.0	-
8:10	0.0	0.0	8:10	0.0	0.0	8:10	0.0	0.0	-
8:11	0.0	0.0	8:11	0.0	0.0	8:11	0.0	0.0	-
8:12	0.0	0.0	8:12	0.0	0.0	8:12	0.0	0.0	-
8:13	0.0	0.0	8:13	0.0	0.0	8:13	0.0	0.0	-
8:14	0.0	0.0	8:14	0.0	0.0	8:14	0.0	0.0	-
8:15	0.0	0.0	8:15	0.0	0.0	8:15	0.0	0.0	-
8:16	0.0	0.0	8:16	0.0	0.0	8:16	0.0	0.0	-
8:17	0.0	0.0	8:17	0.0	0.0	8:17	0.0	0.0	-
8:18	0.0	0.0	8:18	0.0	0.0	8:18	0.0	0.0	-
8:19	0.0	0.0	8:19	0.0	0.0	8:19	0.0	0.0	-
8:20	0.0	0.0	8:20	0.0	0.0	8:20	0.0	0.0	-
8:21	0.0	0.0	8:21	0.0	0.0	8:21	0.0	0.0	-
8:22	0.0	0.0	8:22	0.0	0.0	8:22	0.0	0.0	-
8:23	0.0	0.0	8:23	0.0	0.0	8:23	0.0	0.0	-
8:24	0.0	0.0	8:24	0.0	0.0	8:24	0.0	0.0	-
8:25	0.0	0.0	8:25	0.0	0.0	8:25	0.0	0.0	-
8:26	0.0	0.0	8:26	0.0	0.0	8:26	0.0	0.0	-
8:27	0.0	0.0	8:27	0.0	0.0	8:27	0.0	0.0	-
8:28	0.0	0.0	8:28	0.0	0.0	8:28	0.0	0.0	-
8:29	0.0	0.0	8:29	0.0	0.0	8:29	0.0	0.0	-
8:30	0.0	0.0	8:30	0.0	0.0	8:30	0.0	0.0	-
8:31	0.0	0.0	8:31	0.0	0.0	8:31	0.0	0.0	-
8:32	0.0	0.0	8:32	0.0	0.0	8:32	0.0	0.0	-
8:33	0.0	0.0	8:33	0.0	0.0	8:33	0.0	0.0	-
8:34	0.0	0.0	8:34	0.0	0.0	8:34	0.0	0.0	-
8:35	0.0	0.0	8:35	0.0	0.0	8:35	0.0	0.0	-
8:36	0.0	0.0	8:36	0.0	0.0	8:36	0.0	0.0	-
8:37	0.0	0.0	8:37	0.0	0.0	8:37	0.0	0.0	-
8:38	0.0	0.0	8:38	0.0	0.0	8:38	0.0	0.0	-
8:39	0.0	0.0	8:39	0.0	0.0	8:39	0.0	0.0	-
8:40	0.0	0.0	8:40	0.1	0.0	8:40	0.0	0.0	-
8:41	0.0	0.0	8:41	0.0	0.0	8:41	0.0	0.0	-
8:42	0.0	0.0	8:42	0.0	0.0	8:42	0.0	0.0	-
8:43	0.0	0.0	8:43	0.0	0.0	8:43	0.0	0.0	-
8:44	0.0	0.0	8:44	0.0	0.0	8:44	0.0	0.0	-
8:45	0.0	0.0	8:45	0.0	0.0	8:45	0.0	0.0	-
8:46	0.0	0.0	8:46	0.0	0.0	8:46	0.0	0.0	-
8:47	0.0	0.0	8:47	0.1	0.0	8:47	0.0	0.0	-
8:48	0.0	0.0	8:48	0.0	0.0	8:48	0.0	0.0	-
8:49	0.0	0.0	8:49	0.1	0.0	8:49	0.0	0.0	-
8:50	0.0	0.0	8:50	0.1	0.0	8:50	0.0	0.0	-
8:51	0.0	0.0	8:51	0.1	0.0	8:51	0.0	0.0	-
8:52	0.0	0.0	8:52	0.1	0.0	8:52	0.0	0.0	-
8:53	0.0	0.0	8:53	0.1	0.0	8:53	0.0	0.0	-
8:54	0.0	0.0	8:54	0.1	0.0	8:54	0.0	0.0	-
8:55	0.0	0.0	8:55	0.1	0.0	8:55	0.0	0.0	-
8:56	0.0	0.0	8:56	0.1	0.1	8:56	0.0	0.0	-
8:57	0.0	0.0	8:57	0.1	0.1	8:57	0.0	0.0	-
8:58	0.0	0.0	8:58	0.1	0.1	8:58	0.0	0.0	-
8:59	0.0	0.0	8:59	0.1	0.1	8:59	0.0	0.0	-
9:00	0.0	0.0	9:00	0.1	0.1	9:00	0.0	0.0	-
9:01	0.0	0.0	9:01	0.1	0.1	9:01	0.0	0.0	-
9:02	0.0	0.0	9:02	0.1	0.1	9:02	0.0	0.0	-
9:03	0.0	0.0	9:03	0.1	0.1	9:03	0.0	0.0	-
9:04	0.0	0.0	9:04	0.1	0.1	9:04	0.0	0.0	-
9:05	0.0	0.0	9:05	0.1	0.1	9:05	0.0	0.0	-
9:06	0.0	0.0	9:06	0.1	0.1	9:06	0.0	0.0	-
9:07	0.0	0.0	9:07	0.1	0.1	9:07	0.0	0.0	-
9:08	0.0	0.0	9:08	0.1	0.1	9:08	0.0	0.0	-
9:09	0.0	0.0	9:09	0.1	0.1	9:09	0.0	0.0	-
9:10	0.0	0.0	9:10	0.1	0.1	9:10	0.0	0.0	-
9:11	0.0	0.0	9:11	0.1	0.1	9:11	0.0	0.0	-
9:12	0.0	0.0	9:12	0.1	0.1	9:12	0.0	0.0	-
9:13	0.0	0.0	9:13	0.1	0.1	9:13	0.0	0.0	-
9:14	0.0	0.0	9:14	0.1	0.1	9:14	0.0	0.0	-
9:15	0.0	0.0	9:15	0.1	0.1	9:15	0.0	0.0	-
9:16	0.0	0.0	9:16	0.1	0.1	9:16	0.0	0.0	-
9:17	0.0	0.0	9:17	0.1	0.1	9:17	0.0	0.0	-
9:18	0.0	0.0	9:18	0.1	0.1	9:18	0.0	0.0	-
9:19	0.0	0.0	9:19	0.1	0.1	9:19	0.0	0.0	-
9:20	0.0	0.0	9:20	0.1	0.1	9:20	0.0	0.0	-
9:21	0.0	0.0	9:21	0.1	0.1	9:21	0.0	0.0	-

PID DATA									
Upwind			Downwind						Exceeds Particulate Alarm Limit
Time	Concentration (ppm)	15-Min Avg Concentration (ppm)	Time	Concentration (ppm)	15-Min Avg Concentration (ppm)	Time	Concentration (ppm)	15-Min Avg Concentration (ppm)	
9:22	0.0	0.0	9:22	0.1	0.1	9:22	0.0	0.0	-
9:23	0.0	0.0	9:23	0.1	0.1	9:23	0.0	0.0	-
9:24	0.0	0.0	9:24	0.1	0.1	9:24	0.0	0.0	-
9:25	0.0	0.0	9:25	0.1	0.1	9:25	0.0	0.0	-
9:26	0.0	0.0	9:26	0.1	0.1	9:26	0.0	0.0	-
9:27	0.0	0.0	9:27	0.1	0.1	9:27	0.0	0.0	-
9:28	0.0	0.0	9:28	0.1	0.1	9:28	0.0	0.0	-
9:29	0.0	0.0	9:29	0.1	0.1	9:29	0.0	0.0	-
9:30	0.0	0.0	9:30	0.1	0.1	9:30	0.0	0.0	-
9:31	0.0	0.0	9:31	0.1	0.1	9:31	0.0	0.0	-
9:32	0.0	0.0	9:32	0.1	0.1	9:32	0.0	0.0	-
9:33	0.0	0.0	9:33	0.1	0.1	9:33	0.0	0.0	-
9:34	0.0	0.0	9:34	0.1	0.1	9:34	0.0	0.0	-
9:35	0.0	0.0	9:35	0.1	0.1	9:35	0.0	0.0	-
9:36	0.0	0.0	9:36	0.1	0.1	9:36	0.0	0.0	-
9:37	0.0	0.0	9:37	0.1	0.1	9:37	0.0	0.0	-
9:38	0.0	0.0	9:38	0.1	0.1	9:38	0.0	0.0	-
9:39	0.0	0.0	9:39	0.1	0.1	9:39	0.0	0.0	-
9:40	0.0	0.0	9:40	0.1	0.1	9:40	0.0	0.0	-
9:41	0.0	0.0	9:41	0.1	0.1	9:41	0.0	0.0	-
9:42	0.0	0.0	9:42	0.1	0.1	9:42	0.0	0.0	-
9:43	0.0	0.0	9:43	0.1	0.1	9:43	0.0	0.0	-
9:44	0.0	0.0	9:44	0.1	0.1	9:44	0.0	0.0	-
9:45	0.0	0.0	9:45	0.1	0.1	9:45	0.0	0.0	-
9:46	0.0	0.0	9:46	0.1	0.1	9:46	0.0	0.0	-
9:47	0.0	0.0	9:47	0.1	0.1	9:47	0.0	0.0	-
9:48	0.0	0.0	9:48	0.1	0.1	9:48	0.0	0.0	-
9:49	0.0	0.0	9:49	0.1	0.1	9:49	0.0	0.0	-
9:50	0.0	0.0	9:50	0.1	0.1	9:50	0.0	0.0	-
9:51	0.0	0.0	9:51	0.1	0.1	9:51	0.0	0.0	-
9:52	0.0	0.0	9:52	0.2	0.1	9:52	0.0	0.0	-
9:53	0.0	0.0	9:53	0.2	0.1	9:53	0.0	0.0	-
9:54	0.0	0.0	9:54	0.2	0.1	9:54	0.0	0.0	-
9:55	0.0	0.0	9:55	0.2	0.1	9:55	0.0	0.0	-
9:56	0.0	0.0	9:56	0.2	0.1	9:56	0.0	0.0	-
9:57	0.0	0.0	9:57	0.2	0.1	9:57	0.0	0.0	-
9:58	0.0	0.0	9:58	0.2	0.2	9:58	0.0	0.0	-
9:59	0.0	0.0	9:59	0.2	0.2	9:59	0.0	0.0	-
10:00	0.0	0.0	10:00	0.2	0.2	10:00	0.0	0.0	-
10:01	0.0	0.0	10:01	0.2	0.2	10:01	0.0	0.0	-
10:02	0.0	0.0	10:02	0.2	0.2	10:02	0.0	0.0	-
10:03	0.0	0.0	10:03	0.2	0.2	10:03	0.0	0.0	-
10:04	0.0	0.0	10:04	0.2	0.2	10:04	0.0	0.0	-
10:05	0.0	0.0	10:05	0.2	0.2	10:05	0.0	0.0	-
10:06	0.0	0.0	10:06	0.2	0.2	10:06	0.0	0.0	-
10:07	0.0	0.0	10:07	0.2	0.2	10:07	0.0	0.0	-
10:08	0.0	0.0	10:08	0.2	0.2	10:08	0.0	0.0	-
10:09	0.0	0.0	10:09	0.2	0.2	10:09	0.0	0.0	-
10:10	0.0	0.0	10:10	0.2	0.2	10:10	0.0	0.0	-
10:11	0.0	0.0	10:11	0.2	0.2	10:11	0.0	0.0	-
10:12	0.0	0.0	10:12	0.2	0.2	10:12	0.0	0.0	-
10:13	0.0	0.0	10:13	0.2	0.2	10:13	0.0	0.0	-
10:14	0.0	0.0	10:14	0.2	0.2	10:14	0.0	0.0	-
10:15	0.0	0.0	10:15	0.2	0.2	10:15	0.0	0.0	-
10:16	0.0	0.0	10:16	0.2	0.2	10:16	0.0	0.0	-
10:17	0.0	0.0	10:17	0.2	0.2	10:17	0.0	0.0	-
10:18	0.0	0.0	10:18	0.2	0.2	10:18	0.0	0.0	-
10:19	0.0	0.0	10:19	0.2	0.2	10:19	0.0	0.0	-
10:20	0.0	0.0	10:20	0.2	0.2	10:20	0.0	0.0	-
10:21	0.0	0.0	10:21	0.2	0.2	10:21	0.0	0.0	-
10:22	0.0	0.0	10:22	0.1	0.2	10:22	0.0	0.0	-
10:23	0.0	0.0	10:23	0.1	0.2	10:23	0.0	0.0	-
10:24	0.0	0.0	10:24	0.2	0.2	10:24	0.0	0.0	-
10:25	0.0	0.0	10:25	0.2	0.2	10:25	0.0	0.0	-
10:26	0.0	0.0	10:26	0.2	0.2	10:26	0.0	0.0	-
10:27	0.0	0.0	10:27	0.2	0.2	10:27	0.0	0.0	-
10:28	0.0	0.0	10:28	0.1	0.2	10:28	0.0	0.0	-
10:29	0.0	0.0	10:29	0.1	0.2	10:29	0.0	0.0	-
10:30	0.0	0.0	10:30	0.1	0.2	10:30	0.0	0.0	-
10:31	0.0	0.0	10:31	0.1	0.1	10:31	0.0	0.0	-
10:32	0.0	0.0	10:32	0.1	0.1	10:32	0.0	0.0	-
10:33	0.0	0.0	10:33	0.1	0.1	10:33	0.0	0.0	-
10:34	0.0	0.0	10:34	0.1	0.1	10:34	0.0	0.0	-
10:35	0.0	0.0	10:35	0.2	0.1	10:35	0.0	0.0	-
10:36	0.0	0.0	10:36	0.2	0.1	10:36	0.0	0.0	-
10:37	0.0	0.0	10:37	0.1	0.1	10:37	0.0	0.0	-

PID DATA									
Upwind			Downwind						Exceeds Particulate Alarm Limit
Time	Concentration (ppm)	15-Min Avg Concentration (ppm)	Time	Concentration (ppm)	15-Min Avg Concentration (ppm)	Time	Concentration (ppm)	15-Min Avg Concentration (ppm)	
10:38	0.0	0.0	10:38	0.1	0.1	10:38	0.0	0.0	-
10:39	0.0	0.0	10:39	0.1	0.1	10:39	0.0	0.0	-
10:40	0.1	0.0	10:40	0.0	0.1	10:40	0.0	0.0	-
10:41	0.1	0.0	10:41	0.0	0.1	10:41	0.0	0.0	-
10:42	0.1	0.0	10:42	0.0	0.1	10:42	0.0	0.0	-
10:43	0.1	0.0	10:43	0.0	0.1	10:43	0.0	0.0	-
10:44	0.1	0.0	10:44	0.0	0.1	10:44	0.0	0.0	-
10:45	0.1	0.1	10:45	0.0	0.1	10:45	0.0	0.0	-
10:46	0.1	0.1	10:46	0.0	0.1	10:46	0.0	0.0	-
10:47	0.1	0.1	10:47	0.0	0.1	10:47	0.0	0.0	-
10:48	0.1	0.1	10:48	0.0	0.1	10:48	0.0	0.0	-
10:49	0.1	0.1	10:49	0.0	0.0	10:49	0.0	0.0	-
10:50	0.1	0.1	10:50	0.0	0.0	10:50	0.0	0.0	-
10:51	0.1	0.1	10:51	0.0	0.0	10:51	0.0	0.0	-
10:52	0.1	0.1	10:52	0.0	0.0	10:52	0.0	0.0	-
10:53	0.1	0.1	10:53	0.0	0.0	10:53	0.0	0.0	-
10:54	0.1	0.1	10:54	0.0	0.0	10:54	0.0	0.0	-
10:55	0.1	0.1	10:55	0.0	0.0	10:55	0.0	0.0	-
10:56	0.1	0.1	10:56	0.0	0.0	10:56	0.0	0.0	-
10:57	0.1	0.1	10:57	0.0	0.0	10:57	0.0	0.0	-
10:58	0.1	0.1	10:58	0.0	0.0	10:58	0.0	0.0	-
10:59	0.1	0.1	10:59	0.0	0.0	10:59	0.0	0.0	-
11:00	0.1	0.1	11:00	0.0	0.0	11:00	0.0	0.0	-
11:01	0.1	0.1	11:01	0.0	0.0	11:01	0.0	0.0	-
11:02	0.1	0.1	11:02	0.0	0.0	11:02	0.0	0.0	-
11:03	0.1	0.1	11:03	0.0	0.0	11:03	0.0	0.0	-
11:04	0.1	0.1	11:04	0.0	0.0	11:04	0.0	0.0	-
11:05	0.1	0.1	11:05	0.0	0.0	11:05	0.0	0.0	-
11:06	0.1	0.1	11:06	0.0	0.0	11:06	0.0	0.0	-
11:07	0.1	0.1	11:07	0.0	0.0	11:07	0.0	0.0	-
11:08	0.1	0.1	11:08	0.0	0.0	11:08	0.0	0.0	-
11:09	0.1	0.1	11:09	0.0	0.0	11:09	0.0	0.0	-
11:10	0.1	0.1	11:10	0.0	0.0	11:10	0.0	0.0	-
11:11	0.1	0.1	11:11	0.0	0.0	11:11	0.0	0.0	-
11:12	0.1	0.1	11:12	0.0	0.0	11:12	0.0	0.0	-
11:13	0.1	0.1	11:13	0.0	0.0	11:13	0.0	0.0	-
11:14	0.1	0.1	11:14	0.0	0.0	11:14	0.0	0.0	-
11:15	0.0	0.1	11:15	0.0	0.0	11:15	0.0	0.0	-
11:16	0.0	0.1	11:16	0.0	0.0	11:16	0.0	0.0	-
11:17	0.0	0.1	11:17	0.0	0.0	11:17	0.0	0.0	-
11:18	0.0	0.1	11:18	0.0	0.0	11:18	0.0	0.0	-
11:19	0.0	0.1	11:19	0.0	0.0	11:19	0.0	0.0	-
11:20	0.1	0.1	11:20	0.0	0.0	11:20	0.0	0.0	-
11:21	0.1	0.1	11:21	0.0	0.0	11:21	0.0	0.0	-
11:22	0.0	0.1	11:22	0.0	0.0	11:22	0.0	0.0	-
11:23	0.1	0.1	11:23	0.0	0.0	11:23	0.0	0.0	-
11:24	0.1	0.1	11:24	0.0	0.0	11:24	0.0	0.0	-
11:25	0.0	0.0	11:25	0.1	0.0	11:25	0.0	0.0	-
11:26	0.0	0.0	11:26	0.0	0.0	11:26	0.0	0.0	-
11:27	0.0	0.0	11:27	0.1	0.0	11:27	0.0	0.0	-
11:28	0.0	0.0	11:28	0.1	0.0	11:28	0.0	0.0	-
11:29	0.0	0.0	11:29	0.0	0.0	11:29	0.0	0.0	-
11:30	0.0	0.0	11:30	0.1	0.0	11:30	0.0	0.0	-
11:31	0.0	0.0	11:31	0.0	0.0	11:31	0.0	0.0	-
11:32	0.0	0.0	11:32	0.0	0.0	11:32	0.0	0.0	-
11:33	0.0	0.0	11:33	0.0	0.0	11:33	0.0	0.0	-
11:34	0.0	0.0	11:34	0.0	0.0	11:34	0.0	0.0	-
11:35	0.0	0.0	11:35	0.0	0.0	11:35	0.0	0.0	-
11:36	0.0	0.0	11:36	0.0	0.0	11:36	0.0	0.0	-
11:37	0.0	0.0	11:37	0.0	0.0	11:37	0.0	0.0	-
11:38	0.0	0.0	11:38	0.0	0.0	11:38	0.0	0.0	-
11:39	0.0	0.0	11:39	0.0	0.0	11:39	0.0	0.0	-
11:40	0.0	0.0	11:40	0.0	0.0	11:40	0.0	0.0	-
11:41	0.0	0.0	11:41	0.0	0.0	11:41	0.0	0.0	-
11:42	0.0	0.0	11:42	0.0	0.0	11:42	0.0	0.0	-
11:43	0.0	0.0	11:43	0.0	0.0	11:43	0.0	0.0	-
11:44	0.0	0.0	11:44	0.0	0.0	11:44	0.0	0.0	-
11:45	0.0	0.0	11:45	0.0	0.0	11:45	0.0	0.0	-
11:46	0.0	0.0	11:46	0.0	0.0	11:46	0.0	0.0	-
11:47	0.0	0.0	11:47	0.0	0.0	11:47	0.0	0.0	-
11:48	0.0	0.0	11:48	0.0	0.0	11:48	0.0	0.0	-
11:49	0.0	0.0	11:49	0.0	0.0	11:49	0.0	0.0	-
11:50	0.0	0.0	11:50	0.0	0.0	11:50	0.0	0.0	-
11:51	0.0	0.0	11:51	0.0	0.0	11:51	0.0	0.0	-
11:52	0.0	0.0	11:52	0.0	0.0	11:52	0.0	0.0	-
11:53	0.0	0.0	11:53	0.0	0.0	11:53	0.0	0.0	-

PID DATA									
Upwind			Downwind						Exceeds Particulate Alarm Limit
Time	Concentration (ppm)	15-Min Avg Concentration (ppm)	Time	Concentration (ppm)	15-Min Avg Concentration (ppm)	Time	Concentration (ppm)	15-Min Avg Concentration (ppm)	
11:54	0.0	0.0	11:54	0.0	0.0	11:54	0.0	0.0	-
11:55	0.0	0.0	11:55	0.0	0.0	11:55	0.0	0.0	-
11:56	0.0	0.0	11:56	0.0	0.0	11:56	0.0	0.0	-
11:57	0.0	0.0	11:57	0.0	0.0	11:57	0.0	0.0	-
11:58	0.0	0.0	11:58	0.0	0.0	11:58	0.0	0.0	-
11:59	0.0	0.0	11:59	0.0	0.0	11:59	0.0	0.0	-
12:00	0.0	0.0	12:00	0.0	0.0	12:00	0.0	0.0	-
12:01	0.0	0.0	12:01	0.0	0.0	12:01	0.0	0.0	-
12:02	0.0	0.0	12:02	0.0	0.0	12:02	0.0	0.0	-
12:03	0.0	0.0	12:03	0.0	0.0	12:03	0.0	0.0	-
12:04	0.0	0.0	12:04	0.0	0.0	12:04	0.0	0.0	-
12:05	0.0	0.0	12:05	0.0	0.0	12:05	0.0	0.0	-
12:06	0.0	0.0	12:06	0.0	0.0	12:06	0.0	0.0	-
12:07	0.0	0.0	12:07	0.0	0.0	12:07	0.0	0.0	-
12:08	0.0	0.0	12:08	0.0	0.0	12:08	0.0	0.0	-
12:09	0.0	0.0	12:09	0.0	0.0	12:09	0.0	0.0	-
12:10	0.0	0.0	12:10	0.0	0.0	12:10	0.0	0.0	-
12:11	0.0	0.0	12:11	0.0	0.0	12:11	0.0	0.0	-
12:12	0.0	0.0	12:12	0.0	0.0	12:12	0.0	0.0	-
12:13	0.0	0.0	12:13	0.0	0.0	12:13	0.0	0.0	-
12:14	0.0	0.0	12:14	0.0	0.0	12:14	0.0	0.0	-
12:15	0.0	0.0	12:15	0.0	0.0	12:15	0.0	0.0	-
12:16	0.0	0.0	12:16	0.0	0.0	12:16	0.0	0.0	-
12:17	0.0	0.0	12:17	0.0	0.0	12:17	0.0	0.0	-
12:18	0.0	0.0	12:18	0.0	0.0	12:18	0.0	0.0	-
12:19	0.0	0.0	12:19	0.0	0.0	12:19	0.0	0.0	-
12:20	0.0	0.0	12:20	0.0	0.0	12:20	0.0	0.0	-
12:21	0.0	0.0	12:21	0.0	0.0	12:21	0.0	0.0	-
12:22	0.0	0.0	12:22	0.0	0.0	12:22	0.0	0.0	-
12:23	0.0	0.0	12:23	0.0	0.0	12:23	0.0	0.0	-
12:24	0.0	0.0	12:24	0.0	0.0	12:24	0.0	0.0	-
12:25	0.0	0.0	12:25	0.0	0.0	12:25	0.0	0.0	-
12:26	0.0	0.0	12:26	0.0	0.0	12:26	0.0	0.0	-
12:27	0.0	0.0	12:27	0.0	0.0	12:27	0.0	0.0	-
12:28	0.0	0.0	12:28	0.0	0.0	12:28	0.0	0.0	-
12:29	0.0	0.0	12:29	0.0	0.0	12:29	0.0	0.0	-
12:30	0.0	0.0	12:30	0.0	0.0	12:30	0.0	0.0	-
12:31	0.0	0.0	12:31	0.0	0.0	12:31	0.0	0.0	-
12:32	0.0	0.0	12:32	0.0	0.0	12:32	0.0	0.0	-
12:33	0.0	0.0	12:33	0.0	0.0	12:33	0.0	0.0	-
12:34	0.0	0.0	12:34	0.0	0.0	12:34	0.0	0.0	-
12:35	0.0	0.0	12:35	0.0	0.0	12:35	0.0	0.0	-
12:36	0.0	0.0	12:36	0.0	0.0	12:36	0.0	0.0	-
12:37	0.0	0.0	12:37	0.0	0.0	12:37	0.0	0.0	-
12:38	0.0	0.0	12:38	0.0	0.0	12:38	0.0	0.0	-
12:39	0.0	0.0	12:39	0.0	0.0	12:39	0.0	0.0	-
12:40	0.0	0.0	12:40	0.0	0.0	12:40	0.0	0.0	-
12:41	0.0	0.0	12:41	0.0	0.0	12:41	0.0	0.0	-
12:42	0.0	0.0	12:42	0.0	0.0	12:42	0.0	0.0	-
12:43	0.0	0.0	12:43	0.0	0.0	12:43	0.0	0.0	-
12:44	0.0	0.0	12:44	0.0	0.0	12:44	0.0	0.0	-
12:45	0.0	0.0	12:45	0.0	0.0	12:45	0.0	0.0	-
12:46	0.0	0.0	12:46	0.0	0.0	12:46	0.0	0.0	-
12:47	0.0	0.0	12:47	0.0	0.0	12:47	0.0	0.0	-
12:48	0.0	0.0	12:48	0.0	0.0	12:48	0.0	0.0	-
12:49	0.0	0.0	12:49	0.0	0.0	12:49	0.0	0.0	-
12:50	0.0	0.0	12:50	0.0	0.0	12:50	0.0	0.0	-
12:51	0.0	0.0	12:51	0.0	0.0	12:51	0.0	0.0	-
12:52	0.0	0.0	12:52	0.0	0.0	12:52	0.0	0.0	-
12:53	0.0	0.0	12:53	0.0	0.0	12:53	0.0	0.0	-
12:54	0.0	0.0	12:54	0.0	0.0	12:54	0.0	0.0	-
12:55	0.0	0.0	12:55	0.0	0.0	12:55	0.0	0.0	-
12:56	0.0	0.0	12:56	0.0	0.0	12:56	0.0	0.0	-
12:57	0.0	0.0	12:57	0.0	0.0	12:57	0.0	0.0	-
12:58	0.0	0.0	12:58	0.0	0.0	12:58	0.0	0.0	-
12:59	0.0	0.0	12:59	0.0	0.0	12:59	0.0	0.0	-
13:00	0.0	0.0	13:00	0.0	0.0	13:00	0.0	0.0	-
13:01	0.0	0.0	13:01	0.0	0.0	13:01	0.0	0.0	-
13:02	0.0	0.0	13:02	0.0	0.0	13:02	0.0	0.0	-
13:03	0.0	0.0	13:03	0.0	0.0	13:03	0.0	0.0	-
13:04	0.0	0.0	13:04	0.0	0.0	13:04	0.0	0.0	-
13:05	0.0	0.0	13:05	0.0	0.0	13:05	0.0	0.0	-
13:06	0.0	0.0	13:06	0.0	0.0	13:06	0.0	0.0	-
13:07	0.0	0.0	13:07	0.0	0.0	13:07	0.0	0.0	-
13:08	0.0	0.0	13:08	0.0	0.0	13:08	0.0	0.0	-
13:09	0.0	0.0	13:09	0.0	0.0	13:09	0.0	0.0	-

PID DATA									
Upwind			Downwind						Exceeds Particulate Alarm Limit
Time	Concentration (ppm)	15-Min Avg Concentration (ppm)	Time	Concentration (ppm)	15-Min Avg Concentration (ppm)	Time	Concentration (ppm)	15-Min Avg Concentration (ppm)	
15:42	0.0	0.0	15:42	0.0	0.0	15:42	0.0	0.0	-
15:43	0.0	0.0	15:43	0.0	0.0	15:43	0.0	0.0	-
15:44	0.0	0.0	15:44	0.0	0.0	15:44	0.0	0.0	-
15:45	0.0	0.0	15:45	0.0	0.0	15:45	0.0	0.0	-
15:46	0.0	0.0	15:46	0.0	0.0	15:46	0.0	0.0	-
15:47	0.0	0.0	15:47	0.0	0.0	15:47	0.0	0.0	-
15:48	0.0	0.0	15:48	0.0	0.0	15:48	0.0	0.0	-
15:49	0.0	0.0	15:49	0.0	0.0	15:49	0.0	0.0	-
15:50	0.0	0.0	15:50	0.0	0.0	15:50	0.0	0.0	-
15:51	0.0	0.0	15:51	0.0	0.0	15:51	0.0	0.0	-
15:52	0.0	0.0	15:52	0.0	0.0	15:52	0.0	0.0	-
15:53	0.0	0.0	15:53	0.0	0.0	15:53	0.0	0.0	-
15:54	0.0	0.0	15:54	0.0	0.0	15:54	0.0	0.0	-
15:55	0.0	0.0	15:55	0.0	0.0	15:55	0.0	0.0	-
15:56	0.0	0.0	15:56	0.0	0.0	15:56	0.0	0.0	-
15:57	0.0	0.0	15:57	0.0	0.0	15:57	0.0	0.0	-
15:58	0.0	0.0	15:58	0.0	0.0	15:58	0.0	0.0	-
15:59	0.0	0.0	15:59	0.0	0.0	15:59	0.0	0.0	-
16:00	0.0	0.0	16:00	0.0	0.0	16:00	0.0	0.0	-
16:01	0.0	0.0	16:01	0.0	0.0	16:01	0.0	0.0	-
16:02	0.0	0.0	16:02	0.0	0.0	16:02	0.0	0.0	-
16:03	0.0	0.0	16:03	0.0	0.0	16:03	0.0	0.0	-
16:04	0.0	0.0	16:04	0.0	0.0	16:04	0.0	0.0	-
16:05	0.0	0.0	16:05	0.0	0.0	16:05	0.0	0.0	-
16:06	0.0	0.0	16:06	0.0	0.0	16:06	0.0	0.0	-
16:07	0.0	0.0	16:07	0.0	0.0	16:07	0.0	0.0	-
16:08	0.0	0.0	16:08	0.0	0.0	16:08	0.0	0.0	-
16:09	0.0	0.0	16:09	0.0	0.0	16:09	0.0	0.0	-
16:10	0.0	0.0	16:10	0.0	0.0	16:10	0.0	0.0	-
16:11	0.0	0.0	16:11	0.0	0.0	16:11	0.0	0.0	-
16:12	0.0	0.0	16:12	0.0	0.0	16:12	0.0	0.0	-
16:13	0.0	0.0	16:13	0.0	0.0	16:13	0.0	0.0	-
16:14	0.0	0.0	16:14	0.0	0.0	16:14	0.0	0.0	-
16:15	0.0	0.0	16:15	0.0	0.0	16:15	0.0	0.0	-
16:16	0.0	0.0	16:16	0.0	0.0	16:16	0.0	0.0	-
16:17	0.0	0.0	16:17	0.0	0.0	16:17	0.0	0.0	-
16:18	0.0	0.0	16:18	0.0	0.0	16:18	0.0	0.0	-
16:19	0.0	0.0	16:19	0.0	0.0	16:19	0.0	0.0	-
16:20	0.0	0.0	16:20	0.0	0.0	16:20	0.0	0.0	-
16:21	0.0	0.0	16:21	0.0	0.0	16:21	0.0	0.0	-
16:22	0.0	0.0	16:22	0.0	0.0	16:22	0.0	0.0	-
16:23	0.0	0.0	16:23	0.0	0.0	16:23	0.0	0.0	-
16:24	0.0	0.0	16:24	0.0	0.0	16:24	0.0	0.0	-
16:25	0.0	0.0	16:25	0.0	0.0	16:25	0.0	0.0	-
16:26	0.0	0.0	16:26	0.0	0.0	16:26	0.0	0.0	-
16:27	0.0	0.0	16:27	0.0	0.0	16:27	0.0	0.0	-
16:28	0.0	0.0	16:28	0.0	0.0	16:28	0.0	0.0	-
16:29	0.0	0.0	16:29	0.0	0.0	16:29	0.0	0.0	-
16:30	0.0	0.0	16:30	0.0	0.0	16:30	0.0	0.0	-
16:31	0.0	0.0	16:31	0.0	0.0	16:31	0.0	0.0	-
16:32	0.0	0.0	16:32	0.0	0.0	16:32	0.0	0.0	-
16:33	0.0	0.0	16:33	0.0	0.0	16:33	0.0	0.0	-
16:34	0.0	0.0	16:34	0.0	0.0	16:34	0.0	0.0	-
16:35	0.0	0.0	16:35	0.0	0.0	16:35	0.0	0.0	-
16:36	0.0	0.0	16:36	0.0	0.0	16:36	0.0	0.0	-
16:37	0.0	0.0	16:37	0.0	0.0	16:37	0.0	0.0	-
16:38	0.0	0.0	16:38	0.0	0.0	16:38	0.0	0.0	-
16:39	0.0	0.0	16:39	0.0	0.0	16:39	0.0	0.0	-
16:40	0.0	0.0	16:40	0.0	0.0	16:40	0.0	0.0	-
16:41	0.0	0.0	16:41	0.0	0.0	16:41	0.0	0.0	-
16:42	0.0	0.0	16:42	0.0	0.0	16:42	0.0	0.0	-
16:43	0.0	0.0	16:43	0.0	0.0	16:43	0.0	0.0	-
16:44	0.0	0.0	16:44	0.0	0.0	16:44	0.0	0.0	-
16:45	0.0	0.0	16:45	0.0	0.0	16:45	0.0	0.0	-
16:46	0.0	0.0	16:46	0.0	0.0	16:46	0.0	0.0	-
16:47	0.0	0.0	16:47	0.0	0.0	16:47	0.0	0.0	-
16:48	0.0	0.0	16:48	0.0	0.0	16:48	0.0	0.0	-
16:49	0.0	0.0	16:49	0.0	0.0	16:49	0.0	0.0	-
16:50	0.0	0.0	16:50	0.0	0.0	16:50	0.0	0.0	-