

LANGAN SITE OBSERVATION REPORT – Day 228

CLIENT: Gowanus Canal LLC, GowCan Owner, LLC, and Bayside Gowanus Owner, L.L.C.	DATE: Monday, July 10, 2023
PROJECT No.: 170295301	WEATHER: Clear, 73 – 84 °F Wind: NW @ 2 – 5 mph
PROJECT: Gowanus Canal Northside	TIME: 08:00 – 16:00
LOCATION: Brooklyn, New York	BCP SITE ID: C224080
EQUIPMENT: Komatsu PC 490 Excavator Komatsu PC 240 Excavator Komatsu PC 78 US Excavator Komatsu Wheel Loader Komatsu PC 490 Excavator Manitou MRT 3255 Crane Liebherr Crane	PRESENT AT SITE: Langan: Lauren Roper (Environmental) Urban Atelier Group (UAG): John Mullan TT Mechanical Corp. (TT Mechanical): Damien Sokol G&M Works Landscape Construction (G&M): Gino Latona WSP/NYSDEC: Brian Jessourian

OBSERVATIONS, DISCUSSIONS, TEST RESULTS, ETC.:

Langan was on-site to document implementation of the New York State Department of Environmental Conservation (NYSDEC)-approved March 24, 2022 Remedial Action Work Plan (RAWP) for Brownfield Cleanup Program (BCP) Site No. C224080. Site Map 1 presents the Society Brooklyn and Sackett Place developments, which together comprise the BCP site.

Site Activities

- G&M imported 15 truckloads of 0.5-inch crushed stone. The stone will be used as part of the temporary composite cover system within the shore public walkway (SPW). See material tracking section for details.
- G&M installed a demarcation layer (i.e., orange snow fencing) as part of the temporary composite cover system in the southeastern part of Sackett Place within the SPW.
- G&M placed about 1.5 feet of 0.5-inch crushed stone on top of the demarcation layer as part of the temporary composite cover system in the southeastern part of Sackett Place within the SPW.

Import and Export Tracking

- G&M imported 14 truckloads of 0.5-inch crushed stone from the Impact Environmental Facility in Jersey City, NJ.
- G&M imported 1 truckload of 0.5-inch crushed stone from the Impact Environmental Facility in Lyndhurst, NJ.
- No material was exported from the site.

Soil/Fill Export Summary			
Facility	Exported	Today	Total
Bayshore Soil Management Keasbey, NJ Non-Hazardous Soil/Fill	No. Loads	0	795
	Quantity (CY)	0	15,900
Bayshore Soil Management Keasbey, NJ Non-Hazardous MGP-Impacted Soil/Fill	No. Loads	0	79
	Quantity (CY)	0	1,580
Phase III Environmental Palmerton, PA Non-Hazardous Soil/Fill	No. Loads	0	67
	Quantity (CY)	0	1,340

Cc: J. Hayes, M. Burke, P. Farnham, E. Adkins, A. Nesci	By: Lauren Roper

Material Import Summary				
Facility	NYSDEC Approved Quantity (CY)	Imported	Today	Total
Stavola Construction Materials, Inc Bridgewater, NJ 2.5-inch Stone	1,000	No. Loads	0	15
		Quantity (CY)	0	300
87 19th Avenue Astoria, NY 2.5-inch Stone	2,000	No. Loads	0	31
		Quantity (CY)	0	650
Impact Environmental Jersey City, NJ 0.5-inch Crushed Stone	5,000	No. Loads	14	248
		Quantity (CY)	280	4,960
Impact Environmental Lyndhurst, NJ 0.5-inch Crushed Stone	6,000	No. Loads	1	49
		Quantity (CY)	20	980
Impact Environmental Lyndhurst, NJ 0.75-inch Crushed Stone	4,000	No. Loads	0	29
		Quantity (CY)	0	580
Tilcon New York Inc. Wharton, NJ ASTM #5 Virgin Quarry Stone	3,500	No. Loads	0	95
		Quantity (CY)	0	1,900

Sampling

- No samples were collected.

Community Air Monitoring

- Langan conducted real-time air monitoring for volatile organic compounds (VOC) and particulate matter smaller than 10 microns in diameter (PM10) at the upwind and downwind perimeters of the work area during ground-intrusive work. PM10 and VOC concentrations did not exceed the action levels established by the community air monitoring plan (CAMP).

Anticipated Activities

- G&M will continue to install the demarcation layer and temporary composite cover system within the SPW.

Cc:	J. Hayes, M. Burke, P. Farnham, E. Adkins, A. Nesci	By:	Lauren Roper Langan, D.P.C.
-----	---	-----	---------------------------------------

Site Photographs



Photo 1: G&M installing demarcation layer as part of the temporary composite cover system in the southeastern part of Sackett Place within the SPW (facing south)





Photo 2: G&M importing 0.5-Inch crushed stone for the temporary composite cover system in the southeastern part of Sackett Place within the SPW (facing southwest)

Cc:	J. Hayes, M. Burke, P. Farnham, E. Adkins, A. Nesci	By:	Lauren Roper Langan, D.P.C.
-----	---	-----	---------------------------------------

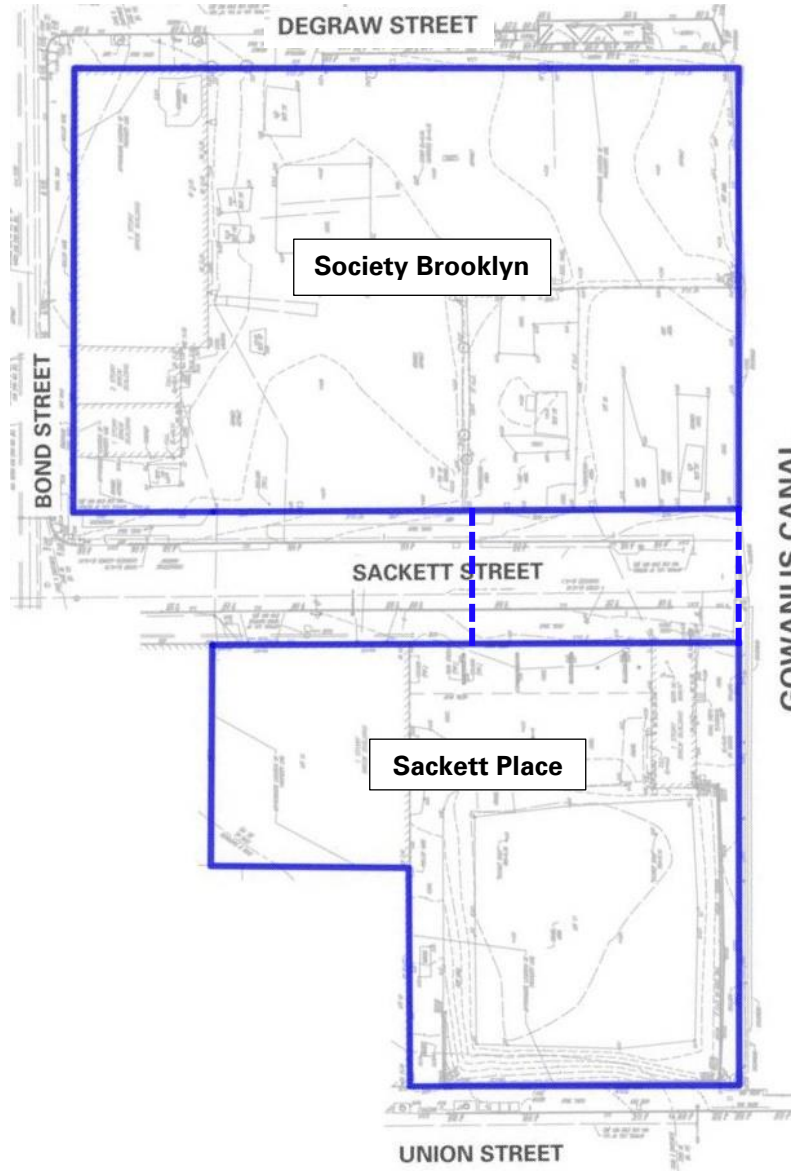
Site Map 1:



Legend

-  Approximate BCP site boundary
-  Approximate construction fence boundary

Notes

1. Base map adapted from 24 March 2022 RAWP, Figure 2 – Site Plan.
2. This Site Map is provided for context only; refer to the Northern (Society Brooklyn) and Southern (Sackett Place) Work Area Maps on the following pages for work and air monitoring location(s).

Cc:	J. Hayes, M. Burke, P. Farnham, E. Adkins, A. Nesci	By:	Lauren Roper Langan, D.P.C.
-----	---	-----	---------------------------------------

Site Map 2: Northern Work Area Map (Society Brooklyn)

Base map adapted from 1 April 2022 drawing FO-201.00, "Ground Floor Framing Plan" for Society Brooklyn, prepared by DeSimone Consulting Engineers.

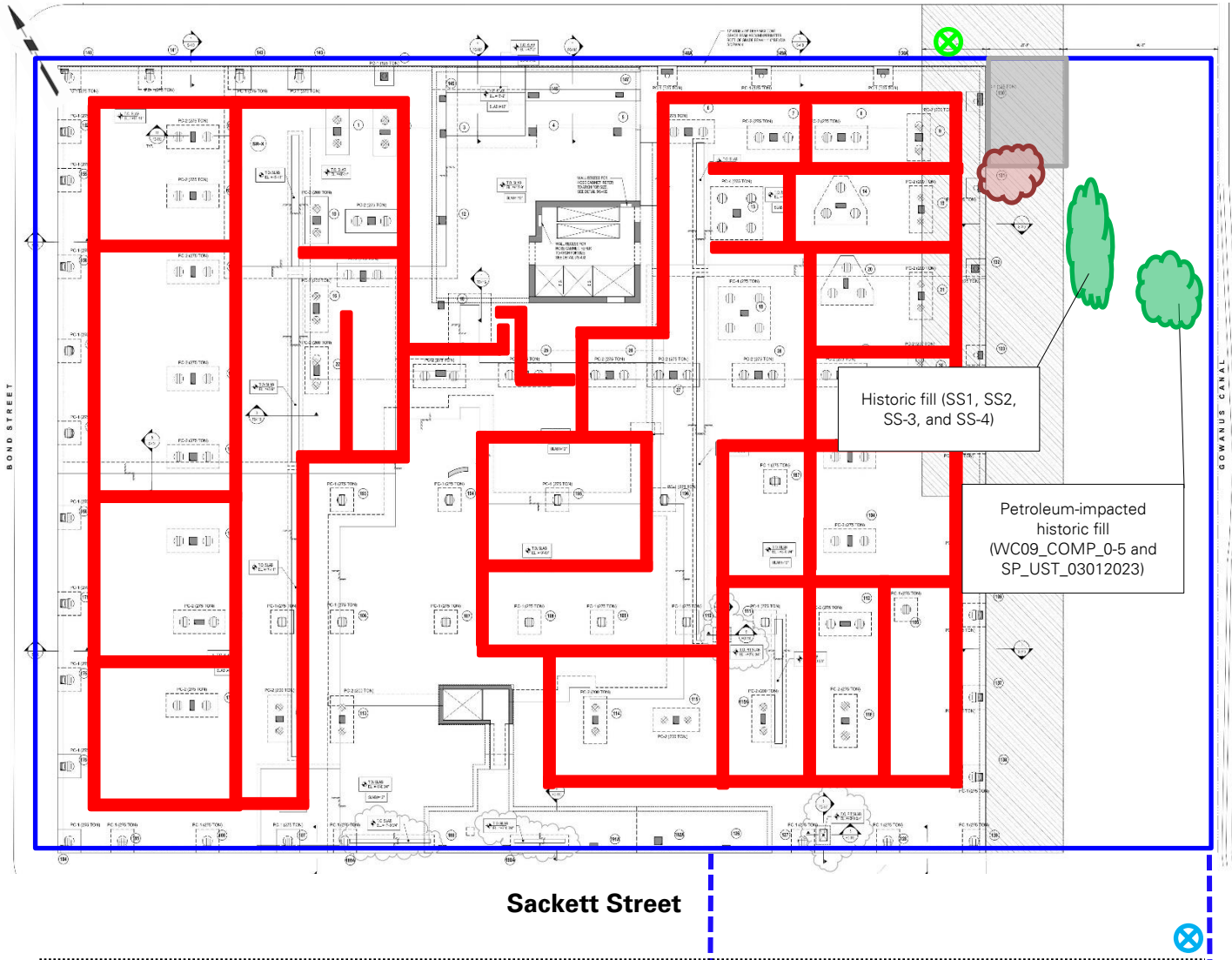

Historic fill (SS1, SS2, SS-3, and SS-4)

Petroleum-impacted historic fill (WC09_COMP_0-5 and SP_UST_03012023)

Sackett Street

Legend:

- Approximate site boundary
- - - Approximate construction fence boundary
- ⊗ Upwind air monitoring station
- ⊗ Downwind air monitoring station
- Approximate work area
- Approximate stabilized construction entrance
- ☁ Approximate soil/fill stockpile location
- ☁ Approximate import stockpile location
- ☁ Approximate C&D debris stockpile location
- Approximate location of 20 cubic yard scrap metal container
- Approximate location of SMD piping installation

Cc:	J. Hayes, M. Burke, P. Farnham, E. Adkins, A. Nesci	By:	Lauren Roper Langan, D.P.C.
-----	---	-----	---------------------------------------

Site Map 3: Southern Work Area Map (Sackett Place)

Base map adapted from 1 April 2022 drawing FO-201.00, "Ground Floor Framing Plan" for Sackett Place, prepared by DeSimone Consulting Engineers.

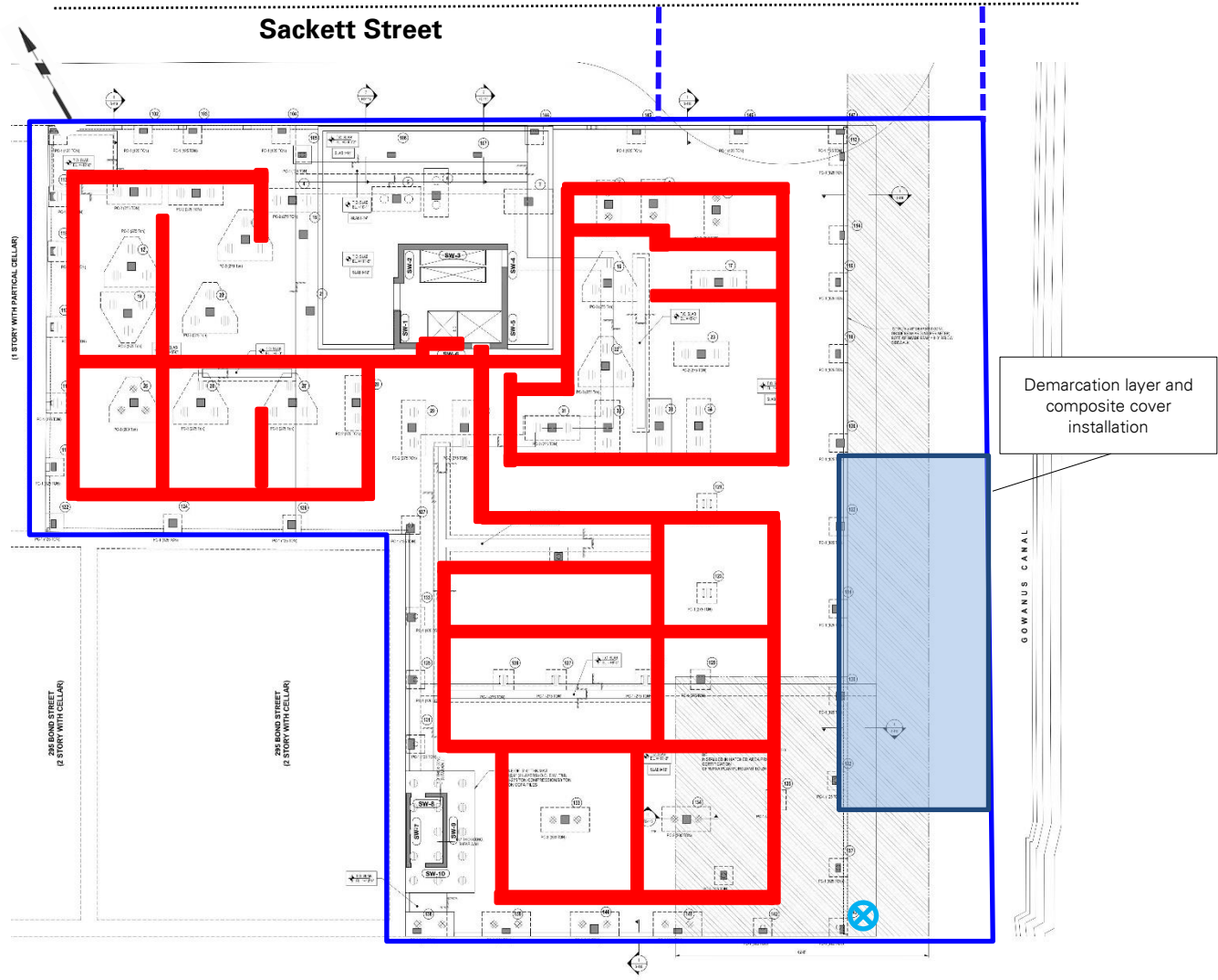

Legend:

- Approximate site boundary
- - - Approximate construction fence boundary
- ⊗ Upwind air monitoring station
- ⊗ Downwind air monitoring station
- Approximate work area
- Approximate stabilized construction entrance
- ☁ Approximate soil/fill stockpile location
- ☁ Approximate import stockpile location
- ☁ Approximate C&D debris stockpile location
- ▭ Approximate location of SMD piping installation

Cc:	J. Hayes, M. Burke, P. Farnham, E. Adkins, A. Nesci	By:	Lauren Roper Langan, D.P.C.
-----	---	-----	---------------------------------------

	DAILY AIR MONITORING REPORT				07/10/23	
	Gowanus Canal Northside				Project number: 170295301	
	267 Bond Street, Brooklyn, New York				Page 1 of 2	Rev. No. 0
					Submitted By:	
					Dust Action Level	150 $\mu\text{g}/\text{m}^3$
				TVOC Action Level	5 ppm	

Weather Data Range for Work Day		Wind Direction	NW	Relative Humidity (%)	57.0 - 91.0	Daily Rain (in)	0.10	Readings in the summary table and graphs below are the reported downwind concentrations.
Temp (°F)	73.0 - 84.0	Wind Speed (MPH)	1.9 - 5.0	Barometer (inHg)	29.80 - 29.80			

Station Location Area	Work	Daily Avg. Dust Concentration ($\mu\text{g}/\text{m}^3$)	Max 15 Min Dust Concentration ($\mu\text{g}/\text{m}^3$)	Time of Maximum 15 Minute Avg Dust Reading	Daily Avg. VOC Concentration (ppm)	Max 15 Min VOC Concentration (ppm)	Time of Max VOC Reading
Upwind		10.9	19.8	13:44	0.0	0.0	8:38
Downwind 1		6.0	23.2	8:50	0.0	0.0	8:50
Downwind 2		17.7	42.0	13:45	0.0	0.0	8:48

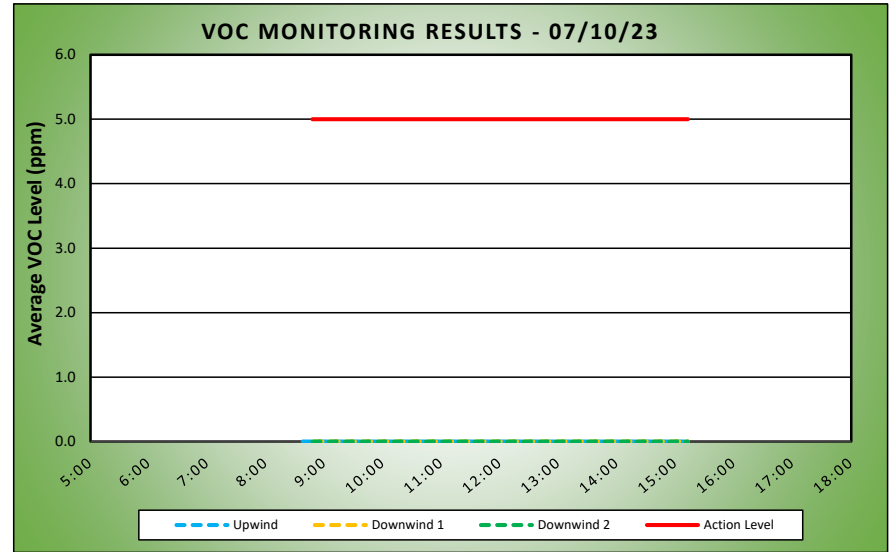
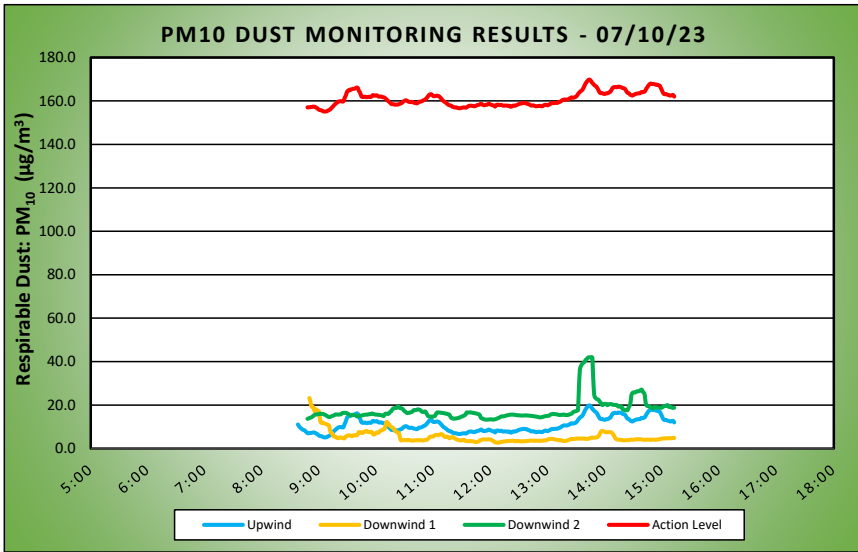

Air Monitoring Notes:

Sampling Notes:

Weather Notes:

Langan - Gowanus Canal Northside
Air Monitoring 07/10/23
Wind Speed & Direction
Daily Readings

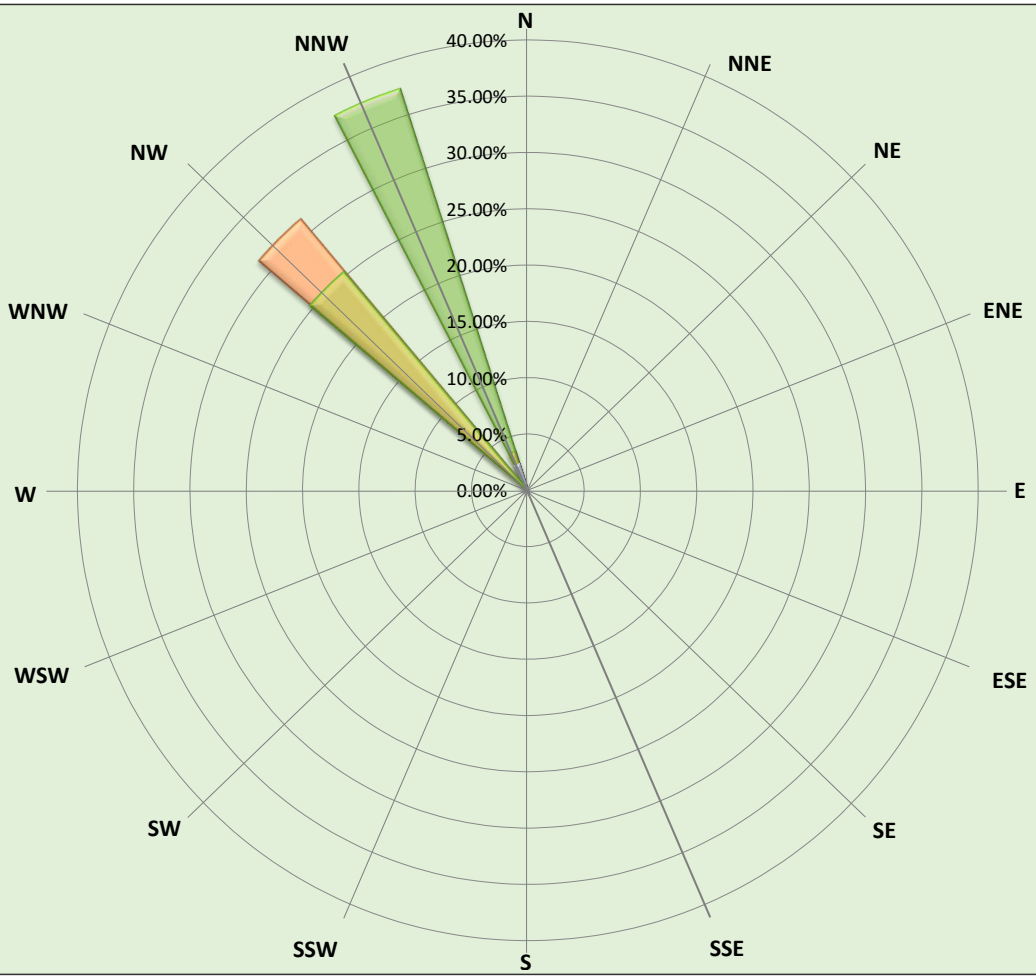

- > 10 MPH
- 8 - 10 MPH
- 6 - 8 MPH
- 4 - 6 MPH
- 2 - 4 MPH
- 1 - 2 MPH
- Calm

Monday, July 10, 2023									
Number of Instances Where Downwind Particulates Exceeds Upwind Particulate + 150 =									0
Number of Comparable Data Points =									386
Start Time:									8:23
End Time:									15:13
PARTICULATE DATA									
Upwind			Downwind						Exceeds Particulate Alarm Limit
Time	Concentration (ug/m ³)	15-Min Avg Concentration (ug/m ³)	Time	Concentration (ug/m ³)	15-Min Avg Concentration (ug/m ³)	Time	Concentration (ug/m ³)	15-Min Avg Concentration (ug/m ³)	
8:23	0.0	-	8:23	-	-	8:23	-	-	-
8:24	16.8	-	8:24	-	-	8:24	-	-	-
8:25	14.5	-	8:25	-	-	8:25	-	-	-
8:26	14.0	-	8:26	-	-	8:26	-	-	-
8:27	14.8	-	8:27	-	-	8:27	-	-	-
8:28	12.8	-	8:28	-	-	8:28	-	-	-
8:29	12.0	-	8:29	-	-	8:29	-	-	-
8:30	12.0	-	8:30	0.0	-	8:30	-	-	-
8:31	12.5	-	8:31	48.3	-	8:31	-	-	-
8:32	12.5	-	8:32	18.3	-	8:32	-	-	-
8:33	13.3	-	8:33	-	-	8:33	12.5	-	-
8:34	8.5	-	8:34	-	-	8:34	13.0	-	-
8:35	7.5	-	8:35	44.3	-	8:35	14.3	-	-
8:36	5.0	-	8:36	28.5	-	8:36	15.0	-	-
8:37	5.0	-	8:37	42.0	-	8:37	14.5	-	-
8:38	5.3	11.1	8:38	11.5	-	8:38	14.0	-	-
8:39	5.3	10.3	8:39	10.5	-	8:39	14.0	-	-
8:40	6.8	9.8	8:40	26.0	-	8:40	13.5	-	-
8:41	7.8	9.4	8:41	30.5	-	8:41	13.0	-	-
8:42	9.0	9.0	8:42	21.0	-	8:42	13.0	-	-
8:43	8.5	8.7	8:43	19.3	-	8:43	13.0	-	-
8:44	9.3	8.5	8:44	21.8	-	8:44	13.0	-	-
8:45	9.3	8.4	8:45	15.5	-	8:45	13.0	-	-
8:46	6.0	7.9	8:46	60.0	-	8:46	13.3	-	-
8:47	6.0	7.5	8:47	32.3	-	8:47	14.0	-	-
8:48	7.0	7.1	8:48	9.8	-	8:48	14.8	13.7	-
8:49	8.5	7.1	8:49	9.5	-	8:49	14.8	13.8	-
8:50	7.8	7.1	8:50	10.5	23.2	8:50	17.5	14.0	-
8:51	6.0	7.2	8:51	7.5	21.8	8:51	17.8	14.2	-
8:52	6.0	7.2	8:52	7.0	19.5	8:52	16.3	14.3	-
8:53	6.0	7.3	8:53	7.8	19.3	8:53	18.8	14.6	-
8:54	7.0	7.4	8:54	7.8	19.1	8:54	19.0	15.0	-
8:55	6.3	7.4	8:55	6.8	17.8	8:55	19.0	15.3	-
8:56	5.8	7.2	8:56	18.5	17.0	8:56	16.8	15.6	-
8:57	5.0	7.0	8:57	36.3	18.0	8:57	14.0	15.7	-
8:58	5.0	6.7	8:58	13.8	17.6	8:58	14.0	15.7	-
8:59	4.0	6.4	8:59	8.5	16.8	8:59	14.0	15.8	-
9:00	3.3	6.0	9:00	21.3	17.1	9:00	14.8	15.9	-
9:01	3.8	5.8	9:01	10.8	13.9	9:01	14.3	16.0	-
9:02	4.8	5.7	9:02	5.0	12.0	9:02	14.0	16.0	-
9:03	5.0	5.6	9:03	6.0	11.8	9:03	14.5	16.0	-
9:04	5.0	5.4	9:04	12.3	12.0	9:04	15.0	16.0	-
9:05	5.0	5.2	9:05	5.5	11.6	9:05	15.0	15.8	-
9:06	5.0	5.1	9:06	4.8	11.5	9:06	14.3	15.6	-
9:07	6.5	5.2	9:07	5.8	11.4	9:07	13.8	15.4	-
9:08	7.0	5.2	9:08	4.8	11.2	9:08	14.3	15.1	-
9:09	10.0	5.4	9:09	5.0	11.0	9:09	15.0	14.8	-
9:10	10.3	5.7	9:10	5.0	10.9	9:10	15.0	14.6	-
9:11	8.8	5.9	9:11	5.0	10.0	9:11	15.3	14.5	-
9:12	9.8	6.2	9:12	4.8	7.9	9:12	16.5	14.6	-
9:13	11.5	6.6	9:13	4.3	7.2	9:13	16.5	14.8	-
9:14	11.3	7.1	9:14	5.0	7.0	9:14	16.8	15.0	-
9:15	10.3	7.6	9:15	4.5	5.9	9:15	16.8	15.1	-
9:16	11.5	8.1	9:16	4.8	5.5	9:16	17.5	15.3	-
9:17	10.5	8.5	9:17	4.0	5.4	9:17	18.3	15.6	-
9:18	11.8	8.9	9:18	4.8	5.3	9:18	15.5	15.7	-
9:19	9.3	9.2	9:19	6.0	4.9	9:19	14.8	15.7	-
9:20	10.3	9.6	9:20	4.3	4.8	9:20	14.3	15.6	-
9:21	8.5	9.8	9:21	4.8	4.8	9:21	14.3	15.6	-
9:22	7.3	9.9	9:22	10.5	5.2	9:22	15.0	15.7	-
9:23	8.0	9.9	9:23	3.5	5.1	9:23	14.8	15.7	-
9:24	8.5	9.8	9:24	3.0	4.9	9:24	20.5	16.1	-
9:25	8.5	9.7	9:25	3.0	4.8	9:25	19.3	16.4	-
9:26	13.0	10.0	9:26	4.3	4.8	9:26	15.3	16.4	-
9:27	30.0	11.3	9:27	4.3	4.7	9:27	17.3	16.4	-
9:28	24.8	12.2	9:28	15.5	5.5	9:28	16.5	16.4	-
9:29	31.3	13.6	9:29	8.0	5.7	9:29	15.5	16.4	-
9:30	25.5	14.6	9:30	8.5	5.9	9:30	13.8	16.2	-
9:31	13.0	14.7	9:31	6.3	6.0	9:31	13.0	15.9	-
9:32	18.3	15.2	9:32	4.0	6.0	9:32	13.0	15.5	-
9:33	10.8	15.1	9:33	3.5	6.0	9:33	13.5	15.4	-

PARTICULATE DATA									
Upwind			Downwind						Exceeds Particulate Alarm Limit
Time	Concentration (ug/m ³)	15-Min Avg Concentration (ug/m ³)	Time	Concentration (ug/m ³)	15-Min Avg Concentration (ug/m ³)	Time	Concentration (ug/m ³)	15-Min Avg Concentration (ug/m ³)	
9:34	11.3	15.3	9:34	3.3	5.8	9:34	14.3	15.3	-
9:35	13.5	15.5	9:35	3.5	5.7	9:35	14.8	15.4	-
9:36	9.8	15.6	9:36	11.0	6.1	9:36	15.3	15.4	-
9:37	8.8	15.7	9:37	9.5	6.1	9:37	14.5	15.4	-
9:38	9.5	15.8	9:38	3.0	6.0	9:38	15.3	15.4	-
9:39	12.3	16.0	9:39	3.5	6.1	9:39	15.8	15.1	-
9:40	11.3	16.2	9:40	4.0	6.1	9:40	14.5	14.8	-
9:41	8.5	15.9	9:41	14.3	6.8	9:41	14.3	14.7	-
9:42	11.0	14.6	9:42	16.0	7.6	9:42	21.5	15.0	-
9:43	15.8	14.0	9:43	11.8	7.3	9:43	18.3	15.1	-
9:44	12.8	12.8	9:44	9.5	7.4	9:44	15.3	15.1	-
9:45	12.5	11.9	9:45	5.3	7.2	9:45	15.5	15.2	-
9:46	13.8	12.0	9:46	5.8	7.2	9:46	14.8	15.4	-
9:47	15.8	11.8	9:47	11.0	7.7	9:47	14.3	15.4	-
9:48	12.8	11.9	9:48	4.5	7.7	9:48	15.0	15.5	-
9:49	10.8	11.9	9:49	6.3	7.9	9:49	15.0	15.6	-
9:50	10.8	11.7	9:50	6.5	8.1	9:50	15.0	15.6	-
9:51	11.0	11.8	9:51	6.3	7.8	9:51	15.5	15.6	-
9:52	9.8	11.9	9:52	5.8	7.6	9:52	16.3	15.7	-
9:53	10.0	11.9	9:53	3.0	7.6	9:53	16.8	15.8	-
9:54	11.0	11.8	9:54	5.3	7.7	9:54	15.8	15.8	-
9:55	13.3	12.0	9:55	4.8	7.7	9:55	16.8	16.0	-
9:56	15.8	12.4	9:56	5.8	7.2	9:56	16.5	16.1	-
9:57	15.5	12.7	9:57	7.5	6.6	9:57	18.0	15.9	-
9:58	12.3	12.5	9:58	10.3	6.5	9:58	16.5	15.8	-
9:59	12.3	12.5	9:59	13.0	6.7	9:59	14.0	15.7	-
10:00	13.8	12.6	10:00	12.3	7.2	10:00	14.0	15.6	-
10:01	14.0	12.6	10:01	8.8	7.4	10:01	14.5	15.6	-
10:02	10.3	12.2	10:02	8.3	7.2	10:02	14.0	15.6	-
10:03	9.5	12.0	10:03	7.8	7.4	10:03	14.0	15.5	-
10:04	11.0	12.0	10:04	14.0	7.9	10:04	14.0	15.4	-
10:05	11.5	12.1	10:05	12.0	8.3	10:05	14.0	15.4	-
10:06	8.5	11.9	10:06	8.0	8.4	10:06	14.0	15.3	-
10:07	7.5	11.7	10:07	9.0	8.6	10:07	14.0	15.1	-
10:08	9.3	11.7	10:08	6.5	8.9	10:08	14.3	15.0	-
10:09	8.0	11.5	10:09	7.3	9.0	10:09	26.8	15.7	-
10:10	7.8	11.1	10:10	31.5	10.8	10:10	21.8	16.0	-
10:11	9.0	10.7	10:11	26.5	12.2	10:11	17.0	16.1	-
10:12	9.0	10.2	10:12	3.8	11.9	10:12	16.3	15.9	-
10:13	6.8	9.9	10:13	3.0	11.4	10:13	17.3	16.0	-
10:14	6.5	9.5	10:14	4.0	10.8	10:14	21.0	16.5	-
10:15	7.5	9.1	10:15	4.0	10.3	10:15	21.3	16.9	-
10:16	7.3	8.6	10:16	4.0	10.0	10:16	19.0	17.2	-
10:17	8.5	8.5	10:17	4.0	9.7	10:17	24.5	17.9	-
10:18	9.5	8.5	10:18	4.0	9.4	10:18	21.0	18.4	-
10:19	10.0	8.4	10:19	3.3	8.7	10:19	16.5	18.6	-
10:20	9.0	8.3	10:20	3.8	8.2	10:20	15.8	18.7	-
10:21	9.5	8.3	10:21	3.5	7.9	10:21	14.5	18.7	-
10:22	7.5	8.3	10:22	4.0	7.5	10:22	15.5	18.8	-
10:23	9.5	8.4	10:23	3.8	7.4	10:23	24.0	19.5	-
10:24	10.8	8.5	10:24	3.0	7.1	10:24	19.5	19.0	-
10:25	10.3	8.7	10:25	3.8	5.2	10:25	17.0	18.7	-
10:26	11.0	8.8	10:26	5.3	3.8	10:26	15.8	18.6	-
10:27	12.8	9.1	10:27	3.3	3.8	10:27	14.0	18.4	-
10:28	12.5	9.5	10:28	6.5	4.0	10:28	13.0	18.2	-
10:29	12.5	9.9	10:29	3.3	4.0	10:29	13.3	17.6	-
10:30	10.8	10.1	10:30	3.0	3.9	10:30	14.3	17.2	-
10:31	10.3	10.3	10:31	3.5	3.9	10:31	15.0	16.9	-
10:32	7.5	10.2	10:32	4.0	3.9	10:32	18.0	16.5	-
10:33	5.8	10.0	10:33	4.5	3.9	10:33	19.5	16.4	-
10:34	5.5	9.7	10:34	4.0	3.9	10:34	17.5	16.4	-
10:35	7.3	9.6	10:35	2.8	3.9	10:35	16.0	16.5	-
10:36	8.3	9.5	10:36	2.0	3.8	10:36	17.5	16.7	-
10:37	9.5	9.6	10:37	3.0	3.7	10:37	17.0	16.8	-
10:38	7.8	9.5	10:38	3.0	3.7	10:38	27.3	17.0	-
10:39	8.0	9.3	10:39	3.3	3.7	10:39	26.3	17.4	-
10:40	8.3	9.2	10:40	4.8	3.7	10:40	21.5	17.7	-
10:41	9.5	9.1	10:41	5.0	3.7	10:41	15.3	17.7	-
10:42	11.0	9.0	10:42	5.5	3.9	10:42	15.0	17.8	-
10:43	12.0	8.9	10:43	5.5	3.8	10:43	15.0	17.9	-
10:44	16.8	9.2	10:44	3.0	3.8	10:44	15.0	18.0	-
10:45	16.8	9.6	10:45	4.0	3.9	10:45	13.5	18.0	-
10:46	11.0	9.7	10:46	3.3	3.8	10:46	12.3	17.8	-
10:47	8.3	9.7	10:47	4.0	3.8	10:47	13.0	17.4	-
10:48	8.3	9.9	10:48	3.5	3.8	10:48	13.3	17.0	-
10:49	9.0	10.1	10:49	3.0	3.7	10:49	14.5	16.8	-

PARTICULATE DATA									
Upwind			Downwind						Exceeds Particulate Alarm Limit
Time	Concentration (ug/m ³)	15-Min Avg Concentration (ug/m ³)	Time	Concentration (ug/m ³)	15-Min Avg Concentration (ug/m ³)	Time	Concentration (ug/m ³)	15-Min Avg Concentration (ug/m ³)	
10:50	11.3	10.4	10:50	3.5	3.8	10:50	17.5	16.9	-
10:51	10.5	10.5	10:51	4.0	3.9	10:51	19.3	17.0	-
10:52	14.3	10.8	10:52	3.5	3.9	10:52	15.8	17.0	-
10:53	14.8	11.3	10:53	4.8	4.0	10:53	15.0	16.1	-
10:54	15.3	11.8	10:54	6.3	4.2	10:54	14.3	15.3	-
10:55	17.8	12.4	10:55	10.0	4.6	10:55	13.5	14.8	-
10:56	16.5	12.9	10:56	13.3	5.1	10:56	14.0	14.7	-
10:57	13.3	13.0	10:57	10.0	5.4	10:57	15.0	14.7	-
10:58	12.5	13.1	10:58	6.5	5.5	10:58	14.0	14.7	-
10:59	11.0	12.7	10:59	3.3	5.5	10:59	13.5	14.6	-
11:00	11.0	12.3	11:00	5.0	5.6	11:00	16.5	14.8	-
11:01	9.3	12.2	11:01	7.8	5.9	11:01	13.5	14.8	-
11:02	9.0	12.2	11:02	7.5	6.1	11:02	16.8	15.1	-
11:03	10.0	12.4	11:03	5.5	6.3	11:03	26.0	15.9	-
11:04	10.0	12.4	11:04	3.3	6.3	11:04	24.0	16.6	-
11:05	10.3	12.4	11:05	2.0	6.2	11:05	17.8	16.6	-
11:06	7.8	12.2	11:06	4.0	6.2	11:06	20.0	16.6	-
11:07	8.0	11.8	11:07	8.3	6.5	11:07	14.8	16.6	-
11:08	8.0	11.3	11:08	5.8	6.6	11:08	13.8	16.5	-
11:09	7.5	10.8	11:09	6.8	6.6	11:09	13.0	16.4	-
11:10	9.5	10.2	11:10	6.0	6.3	11:10	13.0	16.4	-
11:11	10.8	9.9	11:11	4.8	5.8	11:11	13.0	16.3	-
11:12	9.5	9.6	11:12	5.5	5.5	11:12	13.0	16.2	-
11:13	7.5	9.3	11:13	4.3	5.3	11:13	13.0	16.1	-
11:14	6.3	9.0	11:14	6.5	5.5	11:14	12.8	16.1	-
11:15	4.8	8.5	11:15	3.0	5.4	11:15	13.0	15.8	-
11:16	4.8	8.2	11:16	3.0	5.1	11:16	13.0	15.8	-
11:17	6.0	8.0	11:17	3.0	4.8	11:17	13.0	15.5	-
11:18	7.8	7.9	11:18	7.8	4.9	11:18	14.0	14.7	-
11:19	9.0	7.8	11:19	7.0	5.2	11:19	14.3	14.1	-
11:20	4.3	7.4	11:20	3.0	5.2	11:20	16.0	14.0	-
11:21	4.8	7.2	11:21	3.5	5.2	11:21	16.3	13.7	-
11:22	6.0	7.1	11:22	2.8	4.8	11:22	15.5	13.8	-
11:23	7.0	7.0	11:23	2.3	4.6	11:23	14.0	13.8	-
11:24	7.8	7.0	11:24	2.8	4.3	11:24	14.3	13.9	-
11:25	7.0	6.9	11:25	3.0	4.1	11:25	14.0	13.9	-
11:26	8.8	6.7	11:26	3.0	4.0	11:26	14.3	14.0	-
11:27	8.3	6.7	11:27	3.0	3.9	11:27	14.8	14.1	-
11:28	8.0	6.7	11:28	3.8	3.8	11:28	16.0	14.3	-
11:29	7.3	6.8	11:29	5.0	3.7	11:29	16.0	14.6	-
11:30	6.5	6.9	11:30	4.1	3.8	11:30	15.3	14.7	-
11:31	5.8	6.9	11:31	4.5	3.9	11:31	15.0	14.8	-
11:32	7.3	7.0	11:32	4.5	4.0	11:32	17.5	15.1	-
11:33	7.5	7.0	11:33	3.9	3.7	11:33	16.5	15.3	-
11:34	7.5	6.9	11:34	3.0	3.5	11:34	20.0	15.7	-
11:35	6.0	7.0	11:35	3.0	3.5	11:35	29.3	16.6	-
11:36	9.5	7.3	11:36	2.4	3.4	11:36	16.8	16.6	-
11:37	10.5	7.6	11:37	2.4	3.4	11:37	15.0	16.6	-
11:38	9.0	7.8	11:38	3.0	3.4	11:38	14.8	16.6	-
11:39	8.5	7.8	11:39	2.8	3.4	11:39	14.5	16.6	-
11:40	7.0	7.8	11:40	2.3	3.4	11:40	13.0	16.6	-
11:41	7.5	7.7	11:41	2.0	3.3	11:41	12.8	16.5	-
11:42	7.3	7.7	11:42	2.5	3.3	11:42	13.5	16.4	-
11:43	6.3	7.6	11:43	2.8	3.2	11:43	14.8	16.3	-
11:44	9.0	7.7	11:44	2.0	3.0	11:44	15.2	16.2	-
11:45	8.8	7.8	11:45	3.0	2.9	11:45	13.4	16.1	-
11:46	8.8	8.0	11:46	6.1	3.0	11:46	13.8	16.0	-
11:47	9.3	8.2	11:47	7.1	3.2	11:47	14.8	15.9	-
11:48	8.8	8.2	11:48	5.6	3.3	11:48	14.6	15.7	-
11:49	10.5	8.4	11:49	9.0	3.7	11:49	13.0	15.3	-
11:50	10.8	8.8	11:50	6.4	4.0	11:50	13.0	14.2	-
11:51	6.5	8.6	11:51	4.0	4.1	11:51	12.6	13.9	-
11:52	5.8	8.2	11:52	4.0	4.2	11:52	12.0	13.7	-
11:53	6.0	8.0	11:53	3.6	4.2	11:53	12.0	13.5	-
11:54	8.5	8.0	11:54	2.0	4.2	11:54	12.4	13.4	-
11:55	9.3	8.2	11:55	2.0	4.1	11:55	12.0	13.3	-
11:56	8.3	8.2	11:56	2.5	4.2	11:56	12.4	13.3	-
11:57	9.5	8.4	11:57	2.6	4.2	11:57	13.2	13.3	-
11:58	11.0	8.7	11:58	2.9	4.2	11:58	16.0	13.4	-
11:59	7.5	8.6	11:59	2.3	4.2	11:59	15.6	13.4	-
12:00	6.0	8.4	12:00	3.0	4.2	12:00	14.0	13.4	-
12:01	5.8	8.2	12:01	3.0	4.0	12:01	13.6	13.4	-
12:02	6.8	8.1	12:02	3.0	3.7	12:02	14.0	13.4	-
12:03	7.8	8.0	12:03	3.0	3.6	12:03	14.0	13.3	-
12:04	6.8	7.7	12:04	2.1	3.1	12:04	14.0	13.4	-
12:05	5.8	7.4	12:05	3.0	2.9	12:05	14.0	13.5	-

PARTICULATE DATA									
Upwind			Downwind						Exceeds Particulate Alarm Limit
Time	Concentration (ug/m ³)	15-Min Avg Concentration (ug/m ³)	Time	Concentration (ug/m ³)	15-Min Avg Concentration (ug/m ³)	Time	Concentration (ug/m ³)	15-Min Avg Concentration (ug/m ³)	
12:06	16.5	8.1	12:06	2.8	2.8	12:06	14.6	13.6	-
12:07	8.3	8.2	12:07	3.0	2.7	12:07	15.0	13.8	-
12:08	6.8	8.3	12:08	3.0	2.7	12:08	15.0	14.0	-
12:09	6.5	8.2	12:09	3.0	2.7	12:09	15.0	14.2	-
12:10	8.3	8.1	12:10	4.0	2.9	12:10	15.6	14.4	-
12:11	9.8	8.2	12:11	4.4	3.0	12:11	16.0	14.6	-
12:12	8.0	8.1	12:12	3.8	3.1	12:12	16.0	14.8	-
12:13	7.8	7.9	12:13	3.3	3.1	12:13	15.8	14.8	-
12:14	7.0	7.8	12:14	4.0	3.2	12:14	15.4	14.8	-
12:15	6.5	7.9	12:15	4.0	3.3	12:15	16.0	14.9	-
12:16	6.3	7.9	12:16	4.0	3.4	12:16	15.8	15.1	-
12:17	6.0	7.9	12:17	3.5	3.4	12:17	16.0	15.2	-
12:18	7.0	7.8	12:18	3.1	3.4	12:18	15.6	15.3	-
12:19	6.0	7.8	12:19	3.8	3.5	12:19	15.0	15.4	-
12:20	6.8	7.8	12:20	3.0	3.5	12:20	15.8	15.5	-
12:21	9.3	7.3	12:21	3.0	3.5	12:21	16.0	15.6	-
12:22	9.5	7.4	12:22	3.0	3.5	12:22	15.2	15.6	-
12:23	8.8	7.6	12:23	3.4	3.5	12:23	15.0	15.6	-
12:24	11.3	7.9	12:24	3.0	3.5	12:24	14.8	15.6	-
12:25	8.3	7.9	12:25	3.0	3.5	12:25	15.0	15.6	-
12:26	9.0	7.8	12:26	3.0	3.4	12:26	14.6	15.5	-
12:27	10.5	8.0	12:27	3.3	3.4	12:27	15.0	15.4	-
12:28	10.5	8.2	12:28	5.1	3.5	12:28	15.0	15.3	-
12:29	10.3	8.4	12:29	3.9	3.5	12:29	15.0	15.3	-
12:30	9.5	8.6	12:30	3.0	3.4	12:30	15.4	15.3	-
12:31	8.0	8.7	12:31	3.0	3.3	12:31	15.0	15.2	-
12:32	8.0	8.8	12:32	3.0	3.3	12:32	15.6	15.2	-
12:33	7.8	8.9	12:33	3.6	3.3	12:33	15.2	15.2	-
12:34	7.8	9.0	12:34	3.0	3.3	12:34	15.4	15.2	-
12:35	8.0	9.1	12:35	4.1	3.4	12:35	16.0	15.2	-
12:36	8.5	9.0	12:36	3.3	3.4	12:36	16.0	15.2	-
12:37	8.0	8.9	12:37	3.0	3.4	12:37	15.8	15.3	-
12:38	8.8	8.9	12:38	4.6	3.5	12:38	14.8	15.2	-
12:39	6.8	8.6	12:39	3.3	3.5	12:39	14.0	15.2	-
12:40	6.5	8.5	12:40	3.4	3.5	12:40	14.2	15.1	-
12:41	6.8	8.4	12:41	4.4	3.6	12:41	14.8	15.1	-
12:42	6.0	8.1	12:42	4.1	3.7	12:42	14.0	15.1	-
12:43	8.0	7.9	12:43	4.8	3.6	12:43	14.0	15.0	-
12:44	10.3	7.9	12:44	3.4	3.6	12:44	14.6	15.0	-
12:45	10.5	8.0	12:45	3.0	3.6	12:45	14.4	14.9	-
12:46	5.8	7.8	12:46	3.0	3.6	12:46	14.0	14.9	-
12:47	5.3	7.6	12:47	3.0	3.6	12:47	14.0	14.7	-
12:48	7.0	7.6	12:48	3.9	3.6	12:48	14.5	14.7	-
12:49	7.8	7.6	12:49	3.3	3.6	12:49	14.3	14.6	-
12:50	9.0	7.7	12:50	2.9	3.5	12:50	14.8	14.5	-
12:51	9.5	7.7	12:51	3.0	3.5	12:51	14.0	14.4	-
12:52	8.0	7.7	12:52	4.0	3.6	12:52	14.8	14.3	-
12:53	7.0	7.6	12:53	4.0	3.6	12:53	15.0	14.4	-
12:54	6.8	7.6	12:54	3.0	3.5	12:54	15.5	14.5	-
12:55	7.0	7.6	12:55	5.3	3.7	12:55	15.8	14.6	-
12:56	11.8	8.0	12:56	5.1	3.7	12:56	16.8	14.7	-
12:57	9.0	8.2	12:57	5.0	3.8	12:57	16.0	14.8	-
12:58	9.0	8.2	12:58	4.9	3.8	12:58	15.5	14.9	-
12:59	8.5	8.1	12:59	4.3	3.8	12:59	15.3	15.0	-
13:00	8.8	8.0	13:00	6.0	4.0	13:00	15.5	15.0	-
13:01	8.5	8.2	13:01	6.5	4.3	13:01	14.8	15.1	-
13:02	9.0	8.4	13:02	4.6	4.4	13:02	16.3	15.2	-
13:03	10.0	8.6	13:03	4.8	4.4	13:03	20.0	15.6	-
13:04	11.5	8.9	13:04	3.5	4.5	13:04	17.0	15.8	-
13:05	10.8	9.0	13:05	2.6	4.4	13:05	15.8	15.9	-
13:06	9.8	9.0	13:06	2.0	4.4	13:06	15.0	15.9	-
13:07	8.3	9.0	13:07	2.0	4.2	13:07	14.3	15.9	-
13:08	7.8	9.1	13:08	2.0	4.1	13:08	14.0	15.8	-
13:09	7.3	9.1	13:09	3.0	4.1	13:09	14.8	15.8	-
13:10	7.0	9.1	13:10	3.9	4.0	13:10	15.0	15.7	-
13:11	13.0	9.2	13:11	3.6	3.9	13:11	14.8	15.6	-
13:12	13.3	9.5	13:12	5.0	3.9	13:12	14.0	15.5	-
13:13	10.8	9.6	13:13	4.0	3.9	13:13	15.5	15.5	-
13:14	12.5	9.9	13:14	4.0	3.8	13:14	16.0	15.5	-
13:15	13.3	10.2	13:15	3.3	3.7	13:15	15.5	15.5	-
13:16	13.0	10.5	13:16	4.8	3.5	13:16	14.8	15.5	-
13:17	10.8	10.6	13:17	4.0	3.5	13:17	18.8	15.7	-
13:18	11.3	10.7	13:18	4.0	3.4	13:18	17.3	15.5	-
13:19	11.0	10.6	13:19	4.0	3.5	13:19	16.0	15.4	-
13:20	10.3	10.6	13:20	5.0	3.6	13:20	16.0	15.4	-
13:21	11.0	10.7	13:21	4.0	3.8	13:21	15.0	15.4	-

PARTICULATE DATA									
Upwind			Downwind						Exceeds Particulate Alarm Limit
Time	Concentration (ug/m ³)	15-Min Avg Concentration (ug/m ³)	Time	Concentration (ug/m ³)	15-Min Avg Concentration (ug/m ³)	Time	Concentration (ug/m ³)	15-Min Avg Concentration (ug/m ³)	
13:22	11.0	10.9	13:22	4.5	3.9	13:22	15.5	15.5	-
13:23	11.3	11.1	13:23	4.1	4.1	13:23	16.8	15.7	-
13:24	11.0	11.4	13:24	5.3	4.2	13:24	17.0	15.9	-
13:25	11.0	11.6	13:25	5.8	4.4	13:25	17.8	16.0	-
13:26	11.8	11.5	13:26	4.3	4.4	13:26	19.0	16.3	-
13:27	12.3	11.5	13:27	4.0	4.3	13:27	21.3	16.8	-
13:28	13.3	11.6	13:28	5.0	4.4	13:28	18.3	17.0	-
13:29	14.0	11.7	13:29	5.3	4.5	13:29	18.0	17.1	-
13:30	18.0	12.1	13:30	4.9	4.6	13:30	17.5	17.3	-
13:31	19.5	12.5	13:31	4.1	4.5	13:31	18.3	17.5	-
13:32	21.0	13.2	13:32	4.1	4.6	13:32	22.3	17.7	-
13:33	19.8	13.7	13:33	4.3	4.6	13:33	177.3	28.4	-
13:34	17.8	14.2	13:34	5.0	4.6	13:34	137.3	36.5	-
13:35	16.0	14.6	13:35	4.1	4.6	13:35	36.8	37.9	-
13:36	15.5	14.9	13:36	4.0	4.6	13:36	27.5	38.7	-
13:37	19.0	15.4	13:37	4.1	4.6	13:37	24.0	39.3	-
13:38	23.8	16.2	13:38	5.3	4.6	13:38	21.5	39.6	-
13:39	25.5	17.2	13:39	4.4	4.6	13:39	24.0	40.0	-
13:40	24.5	18.1	13:40	4.0	4.5	13:40	28.5	40.8	-
13:41	20.5	18.7	13:41	4.0	4.4	13:41	25.0	41.2	-
13:42	21.0	19.3	13:42	4.3	4.5	13:42	28.5	41.6	-
13:43	19.5	19.7	13:43	6.3	4.5	13:43	23.0	42.0	-
13:44	16.3	19.8	13:44	7.4	4.7	13:44	18.5	42.0	-
13:45	13.8	19.6	13:45	7.9	4.9	13:45	18.3	42.0	-
13:46	10.3	18.9	13:46	5.9	5.0	13:46	18.0	42.0	-
13:47	11.5	18.3	13:47	4.3	5.0	13:47	21.0	41.9	-
13:48	13.0	17.9	13:48	4.0	5.0	13:48	28.3	32.0	-
13:49	10.3	17.4	13:49	5.5	5.0	13:49	27.5	24.7	-
13:50	10.5	17.0	13:50	4.6	5.1	13:50	19.3	23.5	-
13:51	11.5	16.7	13:51	4.0	5.1	13:51	19.8	23.0	-
13:52	10.0	16.1	13:52	6.4	5.2	13:52	19.3	22.7	-
13:53	11.8	15.3	13:53	9.5	5.5	13:53	19.5	22.6	-
13:54	12.8	14.5	13:54	12.9	6.1	13:54	18.0	22.2	-
13:55	14.3	13.8	13:55	15.0	6.8	13:55	18.0	21.5	-
13:56	17.8	13.6	13:56	18.0	7.7	13:56	17.5	21.0	-
13:57	21.3	13.6	13:57	9.1	8.0	13:57	16.8	20.2	-
13:58	17.0	13.5	13:58	6.5	8.1	13:58	21.3	20.1	-
13:59	13.8	13.3	13:59	5.0	7.9	13:59	25.0	20.5	-
14:00	13.0	13.2	14:00	4.3	7.7	14:00	18.5	20.5	-
14:01	12.5	13.4	14:01	4.0	7.5	14:01	18.5	20.5	-
14:02	14.0	13.6	14:02	4.0	7.5	14:02	18.0	20.3	-
14:03	12.3	13.5	14:03	4.3	7.5	14:03	22.5	20.0	-
14:04	14.0	13.8	14:04	4.9	7.5	14:04	33.8	20.4	-
14:05	14.8	14.0	14:05	5.5	7.6	14:05	20.5	20.5	-
14:06	15.0	14.3	14:06	4.1	7.6	14:06	20.3	20.5	-
14:07	21.3	15.0	14:07	4.0	7.4	14:07	18.5	20.4	-
14:08	23.0	15.8	14:08	3.9	7.0	14:08	16.3	20.2	-
14:09	20.0	16.3	14:09	4.0	6.4	14:09	17.5	20.2	-
14:10	15.3	16.3	14:10	5.0	5.8	14:10	16.5	20.1	-
14:11	19.8	16.5	14:11	3.8	4.8	14:11	16.8	20.0	-
14:12	19.5	16.3	14:12	3.0	4.4	14:12	18.0	20.1	-
14:13	17.0	16.3	14:13	3.4	4.2	14:13	17.0	19.8	-
14:14	17.3	16.6	14:14	4.0	4.1	14:14	18.5	19.4	-
14:15	12.3	16.5	14:15	3.3	4.1	14:15	17.0	19.3	-
14:16	12.3	16.5	14:16	3.0	4.0	14:16	18.5	19.3	-
14:17	11.3	16.3	14:17	3.5	4.0	14:17	20.3	19.5	-
14:18	10.0	16.2	14:18	3.5	3.9	14:18	16.3	19.0	-
14:19	10.5	15.9	14:19	4.0	3.9	14:19	17.3	17.9	-
14:20	12.8	15.8	14:20	4.1	3.8	14:20	20.5	17.9	-
14:21	13.0	15.7	14:21	4.0	3.8	14:21	17.8	17.8	-
14:22	12.8	15.1	14:22	4.3	3.8	14:22	16.8	17.7	-
14:23	11.0	14.3	14:23	4.9	3.8	14:23	16.0	17.6	-
14:24	11.5	13.7	14:24	4.6	3.9	14:24	18.0	17.7	-
14:25	14.0	13.7	14:25	4.4	3.8	14:25	33.0	18.8	-
14:26	13.8	13.3	14:26	4.8	3.9	14:26	29.8	19.6	-
14:27	13.3	12.8	14:27	5.1	4.1	14:27	33.5	20.7	-
14:28	14.0	12.6	14:28	4.0	4.1	14:28	73.3	24.4	-
14:29	14.8	12.5	14:29	3.3	4.0	14:29	34.5	25.5	-
14:30	15.3	12.7	14:30	3.1	4.0	14:30	21.8	25.8	-
14:31	16.0	12.9	14:31	3.9	4.1	14:31	19.3	25.9	-
14:32	14.8	13.2	14:32	5.4	4.2	14:32	19.5	25.8	-
14:33	12.3	13.3	14:33	4.0	4.3	14:33	21.0	26.1	-
14:34	12.0	13.4	14:34	4.0	4.3	14:34	20.3	26.3	-
14:35	14.0	13.5	14:35	4.0	4.2	14:35	20.0	26.3	-
14:36	13.5	13.5	14:36	4.0	4.2	14:36	20.3	26.5	-
14:37	13.8	13.6	14:37	5.0	4.3	14:37	19.8	26.7	-

PARTICULATE DATA									
Upwind			Downwind						Exceeds Particulate Alarm Limit
Time	Concentration (ug/m ³)	15-Min Avg Concentration (ug/m ³)	Time	Concentration (ug/m ³)	15-Min Avg Concentration (ug/m ³)	Time	Concentration (ug/m ³)	15-Min Avg Concentration (ug/m ³)	
14:38	15.5	13.9	14:38	4.0	4.2	14:38	21.8	27.0	-
14:39	15.3	14.1	14:39	4.0	4.2	14:39	18.0	27.0	-
14:40	11.8	14.0	14:40	3.5	4.1	14:40	20.0	26.2	-
14:41	17.0	14.2	14:41	3.8	4.1	14:41	22.8	25.7	-
14:42	16.0	14.4	14:42	4.0	4.0	14:42	19.8	24.8	-
14:43	23.5	15.0	14:43	4.0	4.0	14:43	17.0	21.0	-
14:44	28.0	15.9	14:44	4.0	4.0	14:44	17.0	19.9	-
14:45	23.8	16.5	14:45	4.0	4.1	14:45	17.0	19.6	-
14:46	26.3	17.2	14:46	3.8	4.1	14:46	18.3	19.5	-
14:47	21.8	17.6	14:47	4.0	4.0	14:47	18.3	19.4	-
14:48	18.0	18.0	14:48	4.5	4.0	14:48	17.3	19.2	-
14:49	10.5	17.9	14:49	4.3	4.1	14:49	16.3	18.9	-
14:50	12.5	17.8	14:50	4.9	4.1	14:50	16.0	18.6	-
14:51	13.5	17.8	14:51	4.3	4.1	14:51	18.0	18.5	-
14:52	12.8	17.7	14:52	3.8	4.0	14:52	29.0	19.1	-
14:53	14.3	17.7	14:53	3.9	4.0	14:53	20.3	19.0	-
14:54	12.0	17.4	14:54	4.1	4.0	14:54	17.3	18.9	-
14:55	12.8	17.5	14:55	4.3	4.1	14:55	21.3	19.0	-
14:56	13.0	17.2	14:56	5.0	4.2	14:56	20.8	18.9	-
14:57	15.5	17.2	14:57	5.0	4.2	14:57	18.3	18.8	-
14:58	18.3	16.9	14:58	5.0	4.3	14:58	17.8	18.8	-
14:59	13.8	15.9	14:59	5.6	4.4	14:59	16.0	18.8	-
15:00	10.3	15.0	15:00	6.4	4.6	15:00	17.5	18.8	-
15:01	11.0	14.0	15:01	4.0	4.6	15:01	24.0	19.2	-
15:02	12.0	13.3	15:02	4.6	4.6	15:02	22.5	19.5	-
15:03	14.5	13.1	15:03	4.8	4.7	15:03	17.8	19.5	-
15:04	12.3	13.2	15:04	4.4	4.7	15:04	17.5	19.6	-
15:05	9.8	13.0	15:05	5.8	4.7	15:05	19.8	19.8	-
15:06	10.8	12.9	15:06	4.3	4.7	15:06	20.5	20.0	-
15:07	11.3	12.8	15:07	4.0	4.7	15:07	18.0	19.3	-
15:08	11.8	12.6	15:08	4.1	4.8	15:08	18.0	19.1	-
15:09	10.0	12.5	15:09	4.4	4.8	15:09	18.5	19.2	-
15:10	14.5	12.6	15:10	3.5	4.7	15:10	17.8	19.0	-
15:11	15.3	12.7	15:11	6.4	4.8	15:11	18.0	18.8	-
15:12	14.8	12.7	15:12	5.0	4.8	15:12	17.8	18.8	-
15:13	8.5	12.0	15:13	5.9	4.9	15:13	18.3	18.8	-

Monday, July 10, 2023									
Number of Instances Where Downwind VOCs Exceeds Upwind VOCs + 5 =								0	
Number of Comparable Data Points =								386	
Start Time:								8:23	
End Time:								15:13	
PID DATA									
Upwind			Downwind						Exceeds Particulate Alarm Limit
Time	Concentration (ppm)	15-Min Avg Concentration (ppm)	Time	Concentration (ppm)	15-Min Avg Concentration (ppm)	Time	Concentration (ppm)	15-Min Avg Concentration (ppm)	
8:23	0.0	-	8:23	-	-	8:23	-	-	-
8:24	0.0	-	8:24	-	-	8:24	-	-	-
8:25	0.0	-	8:25	-	-	8:25	-	-	-
8:26	0.0	-	8:26	-	-	8:26	-	-	-
8:27	0.0	-	8:27	-	-	8:27	-	-	-
8:28	0.0	-	8:28	-	-	8:28	-	-	-
8:29	0.0	-	8:29	-	-	8:29	-	-	-
8:30	0.0	-	8:30	0.0	-	8:30	-	-	-
8:31	0.0	-	8:31	0.0	-	8:31	-	-	-
8:32	0.0	-	8:32	0.0	-	8:32	-	-	-
8:33	0.0	-	8:33	-	-	8:33	0.0	-	-
8:34	0.0	-	8:34	-	-	8:34	0.0	-	-
8:35	0.0	-	8:35	0.0	-	8:35	0.0	-	-
8:36	0.0	-	8:36	0.0	-	8:36	0.0	-	-
8:37	0.0	-	8:37	0.0	-	8:37	0.0	-	-
8:38	0.0	0.0	8:38	0.0	-	8:38	0.0	-	-
8:39	0.0	0.0	8:39	0.0	-	8:39	0.0	-	-
8:40	0.0	0.0	8:40	0.0	-	8:40	0.0	-	-
8:41	0.0	0.0	8:41	0.0	-	8:41	0.0	-	-
8:42	0.0	0.0	8:42	0.0	-	8:42	0.0	-	-
8:43	0.0	0.0	8:43	0.0	-	8:43	0.0	-	-
8:44	0.0	0.0	8:44	0.0	-	8:44	0.0	-	-
8:45	0.0	0.0	8:45	0.0	-	8:45	0.0	-	-
8:46	0.0	0.0	8:46	0.0	-	8:46	0.0	-	-
8:47	0.0	0.0	8:47	0.0	-	8:47	0.0	-	-
8:48	0.0	0.0	8:48	0.0	-	8:48	0.0	0.0	-
8:49	0.0	0.0	8:49	0.0	-	8:49	0.0	0.0	-
8:50	0.0	0.0	8:50	0.0	0.0	8:50	0.0	0.0	-
8:51	0.0	0.0	8:51	0.0	0.0	8:51	0.0	0.0	-
8:52	0.0	0.0	8:52	0.0	0.0	8:52	0.0	0.0	-
8:53	0.0	0.0	8:53	0.0	0.0	8:53	0.0	0.0	-
8:54	0.0	0.0	8:54	0.0	0.0	8:54	0.0	0.0	-
8:55	0.0	0.0	8:55	0.0	0.0	8:55	0.0	0.0	-
8:56	0.0	0.0	8:56	0.0	0.0	8:56	0.0	0.0	-
8:57	0.0	0.0	8:57	0.0	0.0	8:57	0.0	0.0	-
8:58	0.0	0.0	8:58	0.0	0.0	8:58	0.0	0.0	-
8:59	0.0	0.0	8:59	0.0	0.0	8:59	0.0	0.0	-
9:00	0.0	0.0	9:00	0.0	0.0	9:00	0.0	0.0	-
9:01	0.0	0.0	9:01	0.0	0.0	9:01	0.0	0.0	-
9:02	0.0	0.0	9:02	0.0	0.0	9:02	0.0	0.0	-
9:03	0.0	0.0	9:03	0.0	0.0	9:03	0.0	0.0	-
9:04	0.0	0.0	9:04	0.0	0.0	9:04	0.0	0.0	-
9:05	0.0	0.0	9:05	0.0	0.0	9:05	0.0	0.0	-
9:06	0.0	0.0	9:06	0.0	0.0	9:06	0.0	0.0	-
9:07	0.0	0.0	9:07	0.0	0.0	9:07	0.0	0.0	-
9:08	0.0	0.0	9:08	0.0	0.0	9:08	0.0	0.0	-
9:09	0.0	0.0	9:09	0.0	0.0	9:09	0.0	0.0	-
9:10	0.0	0.0	9:10	0.0	0.0	9:10	0.0	0.0	-
9:11	0.0	0.0	9:11	0.0	0.0	9:11	0.0	0.0	-
9:12	0.0	0.0	9:12	0.0	0.0	9:12	0.0	0.0	-
9:13	0.0	0.0	9:13	0.0	0.0	9:13	0.0	0.0	-
9:14	0.0	0.0	9:14	0.0	0.0	9:14	0.0	0.0	-
9:15	0.0	0.0	9:15	0.0	0.0	9:15	0.0	0.0	-
9:16	0.0	0.0	9:16	0.0	0.0	9:16	0.0	0.0	-
9:17	0.0	0.0	9:17	0.0	0.0	9:17	0.0	0.0	-
9:18	0.0	0.0	9:18	0.0	0.0	9:18	0.0	0.0	-
9:19	0.0	0.0	9:19	0.0	0.0	9:19	0.0	0.0	-
9:20	0.0	0.0	9:20	0.0	0.0	9:20	0.0	0.0	-
9:21	0.0	0.0	9:21	0.0	0.0	9:21	0.0	0.0	-
9:22	0.0	0.0	9:22	0.0	0.0	9:22	0.0	0.0	-
9:23	0.0	0.0	9:23	0.0	0.0	9:23	0.0	0.0	-
9:24	0.0	0.0	9:24	0.0	0.0	9:24	0.0	0.0	-
9:25	0.0	0.0	9:25	0.0	0.0	9:25	0.0	0.0	-
9:26	0.0	0.0	9:26	0.0	0.0	9:26	0.0	0.0	-
9:27	0.0	0.0	9:27	0.0	0.0	9:27	0.0	0.0	-
9:28	0.0	0.0	9:28	0.0	0.0	9:28	0.0	0.0	-
9:29	0.0	0.0	9:29	0.0	0.0	9:29	0.0	0.0	-
9:30	0.0	0.0	9:30	0.0	0.0	9:30	0.0	0.0	-
9:31	0.0	0.0	9:31	0.0	0.0	9:31	0.0	0.0	-
9:32	0.0	0.0	9:32	0.0	0.0	9:32	0.0	0.0	-
9:33	0.0	0.0	9:33	0.0	0.0	9:33	0.0	0.0	-

PID DATA									
Upwind			Downwind						Exceeds Particulate Alarm Limit
Time	Concentration (ppm)	15-Min Avg Concentration (ppm)	Time	Concentration (ppm)	15-Min Avg Concentration (ppm)	Time	Concentration (ppm)	15-Min Avg Concentration (ppm)	
9:34	0.0	0.0	9:34	0.0	0.0	9:34	0.0	0.0	-
9:35	0.0	0.0	9:35	0.0	0.0	9:35	0.0	0.0	-
9:36	0.0	0.0	9:36	0.0	0.0	9:36	0.0	0.0	-
9:37	0.0	0.0	9:37	0.0	0.0	9:37	0.0	0.0	-
9:38	0.0	0.0	9:38	0.0	0.0	9:38	0.0	0.0	-
9:39	0.0	0.0	9:39	0.0	0.0	9:39	0.0	0.0	-
9:40	0.0	0.0	9:40	0.0	0.0	9:40	0.0	0.0	-
9:41	0.0	0.0	9:41	0.0	0.0	9:41	0.0	0.0	-
9:42	0.0	0.0	9:42	0.0	0.0	9:42	0.0	0.0	-
9:43	0.0	0.0	9:43	0.0	0.0	9:43	0.0	0.0	-
9:44	0.0	0.0	9:44	0.0	0.0	9:44	0.0	0.0	-
9:45	0.0	0.0	9:45	0.0	0.0	9:45	0.0	0.0	-
9:46	0.0	0.0	9:46	0.0	0.0	9:46	0.0	0.0	-
9:47	0.0	0.0	9:47	0.0	0.0	9:47	0.0	0.0	-
9:48	0.0	0.0	9:48	0.0	0.0	9:48	0.0	0.0	-
9:49	0.0	0.0	9:49	0.0	0.0	9:49	0.0	0.0	-
9:50	0.0	0.0	9:50	0.0	0.0	9:50	0.0	0.0	-
9:51	0.0	0.0	9:51	0.0	0.0	9:51	0.0	0.0	-
9:52	0.0	0.0	9:52	0.0	0.0	9:52	0.0	0.0	-
9:53	0.0	0.0	9:53	0.0	0.0	9:53	0.0	0.0	-
9:54	0.0	0.0	9:54	0.0	0.0	9:54	0.0	0.0	-
9:55	0.0	0.0	9:55	0.0	0.0	9:55	0.0	0.0	-
9:56	0.0	0.0	9:56	0.0	0.0	9:56	0.0	0.0	-
9:57	0.0	0.0	9:57	0.0	0.0	9:57	0.0	0.0	-
9:58	0.0	0.0	9:58	0.0	0.0	9:58	0.0	0.0	-
9:59	0.0	0.0	9:59	0.0	0.0	9:59	0.0	0.0	-
10:00	0.0	0.0	10:00	0.0	0.0	10:00	0.0	0.0	-
10:01	0.0	0.0	10:01	0.0	0.0	10:01	0.0	0.0	-
10:02	0.0	0.0	10:02	0.0	0.0	10:02	0.0	0.0	-
10:03	0.0	0.0	10:03	0.0	0.0	10:03	0.0	0.0	-
10:04	0.0	0.0	10:04	0.0	0.0	10:04	0.0	0.0	-
10:05	0.0	0.0	10:05	0.0	0.0	10:05	0.0	0.0	-
10:06	0.0	0.0	10:06	0.0	0.0	10:06	0.0	0.0	-
10:07	0.0	0.0	10:07	0.0	0.0	10:07	0.0	0.0	-
10:08	0.0	0.0	10:08	0.0	0.0	10:08	0.0	0.0	-
10:09	0.0	0.0	10:09	0.0	0.0	10:09	0.0	0.0	-
10:10	0.0	0.0	10:10	0.0	0.0	10:10	0.0	0.0	-
10:11	0.0	0.0	10:11	0.0	0.0	10:11	0.0	0.0	-
10:12	0.0	0.0	10:12	0.0	0.0	10:12	0.0	0.0	-
10:13	0.0	0.0	10:13	0.0	0.0	10:13	0.0	0.0	-
10:14	0.0	0.0	10:14	0.0	0.0	10:14	0.0	0.0	-
10:15	0.0	0.0	10:15	0.0	0.0	10:15	0.0	0.0	-
10:16	0.0	0.0	10:16	0.0	0.0	10:16	0.0	0.0	-
10:17	0.0	0.0	10:17	0.0	0.0	10:17	0.0	0.0	-
10:18	0.0	0.0	10:18	0.0	0.0	10:18	0.0	0.0	-
10:19	0.0	0.0	10:19	0.0	0.0	10:19	0.0	0.0	-
10:20	0.0	0.0	10:20	0.0	0.0	10:20	0.0	0.0	-
10:21	0.0	0.0	10:21	0.0	0.0	10:21	0.0	0.0	-
10:22	0.0	0.0	10:22	0.0	0.0	10:22	0.0	0.0	-
10:23	0.0	0.0	10:23	0.0	0.0	10:23	0.0	0.0	-
10:24	0.0	0.0	10:24	0.0	0.0	10:24	0.0	0.0	-
10:25	0.0	0.0	10:25	0.0	0.0	10:25	0.0	0.0	-
10:26	0.0	0.0	10:26	0.0	0.0	10:26	0.0	0.0	-
10:27	0.0	0.0	10:27	0.0	0.0	10:27	0.0	0.0	-
10:28	0.0	0.0	10:28	0.0	0.0	10:28	0.0	0.0	-
10:29	0.0	0.0	10:29	0.0	0.0	10:29	0.0	0.0	-
10:30	0.0	0.0	10:30	0.0	0.0	10:30	0.0	0.0	-
10:31	0.0	0.0	10:31	0.0	0.0	10:31	0.0	0.0	-
10:32	0.0	0.0	10:32	0.0	0.0	10:32	0.0	0.0	-
10:33	0.0	0.0	10:33	0.0	0.0	10:33	0.0	0.0	-
10:34	0.0	0.0	10:34	0.0	0.0	10:34	0.0	0.0	-
10:35	0.0	0.0	10:35	0.0	0.0	10:35	0.0	0.0	-
10:36	0.0	0.0	10:36	0.0	0.0	10:36	0.0	0.0	-
10:37	0.0	0.0	10:37	0.0	0.0	10:37	0.0	0.0	-
10:38	0.0	0.0	10:38	0.0	0.0	10:38	0.0	0.0	-
10:39	0.0	0.0	10:39	0.0	0.0	10:39	0.0	0.0	-
10:40	0.0	0.0	10:40	0.0	0.0	10:40	0.0	0.0	-
10:41	0.0	0.0	10:41	0.0	0.0	10:41	0.0	0.0	-
10:42	0.0	0.0	10:42	0.0	0.0	10:42	0.0	0.0	-
10:43	0.0	0.0	10:43	0.0	0.0	10:43	0.0	0.0	-
10:44	0.0	0.0	10:44	0.0	0.0	10:44	0.0	0.0	-
10:45	0.0	0.0	10:45	0.0	0.0	10:45	0.0	0.0	-
10:46	0.0	0.0	10:46	0.0	0.0	10:46	0.0	0.0	-
10:47	0.0	0.0	10:47	0.0	0.0	10:47	0.0	0.0	-
10:48	0.0	0.0	10:48	0.0	0.0	10:48	0.0	0.0	-
10:49	0.0	0.0	10:49	0.0	0.0	10:49	0.0	0.0	-

PID DATA									
Upwind			Downwind						Exceeds Particulate Alarm Limit
Time	Concentration (ppm)	15-Min Avg Concentration (ppm)	Time	Concentration (ppm)	15-Min Avg Concentration (ppm)	Time	Concentration (ppm)	15-Min Avg Concentration (ppm)	
14:38	0.0	0.0	14:38	0.0	0.0	14:38	0.0	0.0	-
14:39	0.0	0.0	14:39	0.0	0.0	14:39	0.0	0.0	-
14:40	0.0	0.0	14:40	0.0	0.0	14:40	0.0	0.0	-
14:41	0.0	0.0	14:41	0.0	0.0	14:41	0.0	0.0	-
14:42	0.0	0.0	14:42	0.0	0.0	14:42	0.0	0.0	-
14:43	0.0	0.0	14:43	0.0	0.0	14:43	0.0	0.0	-
14:44	0.0	0.0	14:44	0.0	0.0	14:44	0.0	0.0	-
14:45	0.0	0.0	14:45	0.0	0.0	14:45	0.0	0.0	-
14:46	0.0	0.0	14:46	0.0	0.0	14:46	0.0	0.0	-
14:47	0.0	0.0	14:47	0.0	0.0	14:47	0.0	0.0	-
14:48	0.0	0.0	14:48	0.0	0.0	14:48	0.0	0.0	-
14:49	0.0	0.0	14:49	0.0	0.0	14:49	0.0	0.0	-
14:50	0.0	0.0	14:50	0.0	0.0	14:50	0.0	0.0	-
14:51	0.0	0.0	14:51	0.0	0.0	14:51	0.0	0.0	-
14:52	0.0	0.0	14:52	0.0	0.0	14:52	0.0	0.0	-
14:53	0.0	0.0	14:53	0.0	0.0	14:53	0.0	0.0	-
14:54	0.0	0.0	14:54	0.0	0.0	14:54	0.0	0.0	-
14:55	0.0	0.0	14:55	0.0	0.0	14:55	0.0	0.0	-
14:56	0.0	0.0	14:56	0.0	0.0	14:56	0.0	0.0	-
14:57	0.0	0.0	14:57	0.0	0.0	14:57	0.0	0.0	-
14:58	0.0	0.0	14:58	0.0	0.0	14:58	0.0	0.0	-
14:59	0.0	0.0	14:59	0.0	0.0	14:59	0.0	0.0	-
15:00	0.0	0.0	15:00	0.0	0.0	15:00	0.0	0.0	-
15:01	0.0	0.0	15:01	0.0	0.0	15:01	0.0	0.0	-
15:02	0.0	0.0	15:02	0.0	0.0	15:02	0.0	0.0	-
15:03	0.0	0.0	15:03	0.0	0.0	15:03	0.0	0.0	-
15:04	0.0	0.0	15:04	0.0	0.0	15:04	0.0	0.0	-
15:05	0.0	0.0	15:05	0.0	0.0	15:05	0.0	0.0	-
15:06	0.0	0.0	15:06	0.0	0.0	15:06	0.0	0.0	-
15:07	0.0	0.0	15:07	0.0	0.0	15:07	0.0	0.0	-
15:08	0.0	0.0	15:08	0.0	0.0	15:08	0.0	0.0	-
15:09	0.0	0.0	15:09	0.0	0.0	15:09	0.0	0.0	-
15:10	0.0	0.0	15:10	0.0	0.0	15:10	0.0	0.0	-
15:11	0.0	0.0	15:11	0.0	0.0	15:11	0.0	0.0	-
15:12	0.0	0.0	15:12	0.0	0.0	15:12	0.0	0.0	-
15:13	0.0	0.0	15:13	0.0	0.0	15:13	0.0	0.0	-