

# LANGAN SITE OBSERVATION REPORT – Day 233

<b>CLIENT:</b> Gowanus Canal LLC, GowCan Owner, LLC, and Bayside Gowanus Owner, L.L.C.	<b>DATE:</b> Monday, July 17, 2023
<b>PROJECT No.:</b> 170295301	<b>WEATHER:</b> Clear, 74 – 91 °F Wind: NNW @ 1 – 2 mph
<b>PROJECT:</b> Gowanus Canal Northside	<b>TIME:</b> 07:00 – 12:00
<b>LOCATION:</b> Brooklyn, New York	<b>BCP SITE ID:</b> C224080
<b>EQUIPMENT:</b> Komatsu PC 490 Excavator Komatsu PC 240 Excavator Komatsu PC 78 US Excavator Komatsu Wheel Loader Komatsu PC 490 Excavator Manitou MRT 3255 Crane Liebherr Crane	<b>PRESENT AT SITE:</b> <b>Langan:</b> Lauren Roper (Environmental) <b>Urban Atelier Group (UAG):</b> Seth Anderson <b>TT Mechanical Corp. (TT Mechanical):</b> Damien Sokol <b>G&amp;M Works Landscape Construction (G&amp;M):</b> Gino Latona <b>WSP/NYSDEC:</b> Brian Jessourian

## OBSERVATIONS, DISCUSSIONS, TEST RESULTS, ETC.:

Langan was on-site to document implementation of the New York State Department of Environmental Conservation (NYSDEC)-approved March 24, 2022 Remedial Action Work Plan (RAWP) for Brownfield Cleanup Program (BCP) Site No. C224080. Site Map 1 presents the Society Brooklyn and Sackett Place developments, which together comprise the BCP site.

### Site Activities

- G&M imported 4 truckloads of 0.75-inch crushed stone. The stone will be used as part of the temporary composite cover system within the shore public walkway (SPW). See material tracking section for details.
- G&M placed about 6 inches of 0.75-inch crushed stone on top of the previously imported and backfilled 0.5-inch crushed stone as part of the temporary composite cover system in the northeastern and eastern parts of Society Brooklyn within the SPW.

### Import and Export Tracking

- G&M imported 4 truckloads of 0.75-inch stone from the Impact Environmental Facility in Lyndhurst, NJ.
- No material was exported from the site.

Soil/Fill Export Summary			
Facility	Exported	Today	Total
Bayshore Soil Management Keasbey, NJ Non-Hazardous Soil/Fill	No. Loads	0	802
	Quantity (CY)	0	16,040
Bayshore Soil Management Keasbey, NJ Non-Hazardous MGP-Impacted Soil/Fill	No. Loads	0	79
	Quantity (CY)	0	1,580
Phase III Environmental Palmerton, PA Non-Hazardous Soil/Fill	No. Loads	0	67
	Quantity (CY)	0	1,340

<b>Cc:</b>	J. Hayes, M. Burke, P. Farnham, E. Adkins, A. Nesci	<b>By:</b>	Lauren Roper
			<b>Langan, D.P.C.</b>

Material Import Summary				
Facility	NYSDEC Approved Quantity (CY)	Imported	Today	Total
Impact Environmental Jersey City, NJ 0.75-inch Crushed Stone	*N/A (not reviewed)	No. Loads	0	10
		Quantity (CY)	0	200
Stavola Construction Materials, Inc Bridgewater, NJ 2.5-inch Stone	1,000	No. Loads	0	15
		Quantity (CY)	0	300
87 19 <sup>th</sup> Avenue Astoria, NY 2.5-inch Stone	2,000	No. Loads	0	31
		Quantity (CY)	0	650
Impact Environmental Jersey City, NJ 0.5-inch Crushed Stone	5,000	No. Loads	0	248
		Quantity (CY)	0	4,960
Impact Environmental Lyndhurst, NJ 0.5-inch Crushed Stone	6,000	No. Loads	0	99
		Quantity (CY)	0	1,980
Impact Environmental Lyndhurst, NJ 0.75-inch Crushed Stone	4,000	No. Loads	4	47
		Quantity (CY)	80	940
Tilcon New York Inc. Wharton, NJ ASTM #5 Virgin Quarry Stone	3,500	No. Loads	0	95
		Quantity (CY)	0	1,900

\*Request to Import Form was provided to the NYSDEC on 7/14/2023.

**Sampling**

- No samples were collected today.

**Community Air Monitoring**

- Langan conducted real-time air monitoring for volatile organic compounds (VOC) and particulate matter smaller than 10 microns in diameter (PM10) at the upwind and downwind perimeters of the work area during ground-intrusive work. VOC and PM10 concentrations did not exceed the action levels established by the community air monitoring plan (CAMP).

**Anticipated Activities**

- WSP will survey and gauge monitoring wells installed during the Grossly Contaminated Material/Non-Aqueous Phase Liquid Investigation within the SPW.

Cc:	J. Hayes, M. Burke, P. Farnham, E. Adkins, A. Nesci	By:	Lauren Roper
			<b>Langan, D.P.C.</b>

## Site Photographs



**Photo 1:** G&M placing 0.75-inch crushed stone for the temporary composite cover system in the northeastern part of Society Brooklyn (facing northeast)



**Photo 2:** View of the temporary composite cover system in the northeastern part of Society Brooklyn within the SPW (facing south)

Cc:	J. Hayes, M. Burke, P. Farnham, E. Adkins, A. Nesci	By:	Lauren Roper <b>Langan, D.P.C.</b>
-----	---	-----	---------------------------------------

**Site Map 1:**

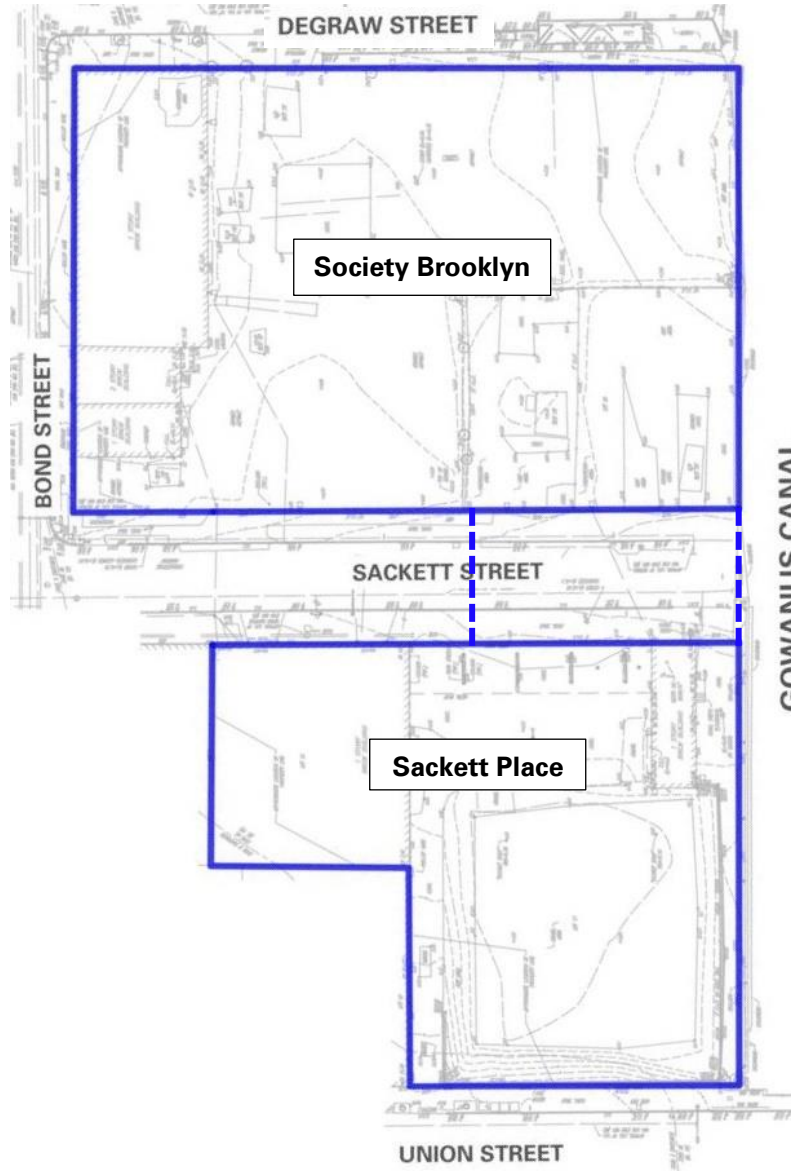

**Legend**

- Approximate BCP site boundary
- - - Approximate construction fence boundary

**Notes**

1. Base map adapted from 24 March 2022 RAWP, Figure 2 – Site Plan.
2. This Site Map is provided for context only; refer to the Northern (Society Brooklyn) and Southern (Sackett Place) Work Area Maps on the following pages for work and air monitoring location(s).







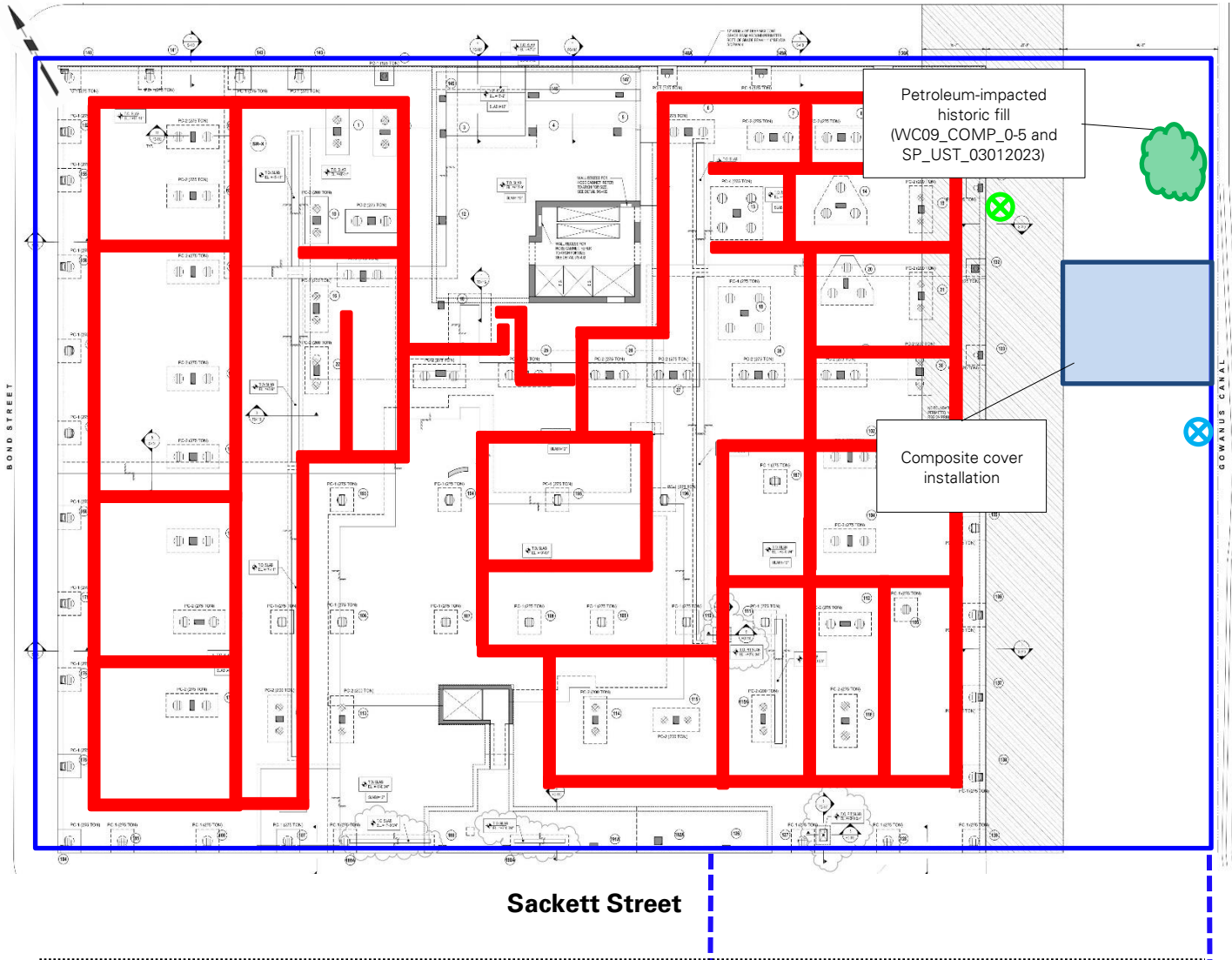



Cc:	J. Hayes, M. Burke, P. Farnham, E. Adkins, A. Nesci	By:	Lauren Roper <b>Langan, D.P.C.</b>
-----	---	-----	---------------------------------------

### Site Map 2: Northern Work Area Map (Society Brooklyn)

Base map adapted from 1 April 2022 drawing FO-201.00, "Ground Floor Framing Plan" for Society Brooklyn, prepared by DeSimone Consulting Engineers.



**Legend:**

-  Approximate site boundary
-  Approximate construction fence boundary
-  Upwind air monitoring station
-  Downwind air monitoring station
-  Approximate work area
-  Approximate stabilized construction entrance
-  Approximate soil/fill stockpile location
-  Approximate import stockpile location
-  Approximate C&D debris stockpile location
-  Approximate location of 20 cubic yard scrap metal container
-  Approximate location of SMD piping installation

Cc: J. Hayes, M. Burke, P. Farnham, E. Adkins, A. Nesci

By: Lauren Roper  
Langan, D.P.C.

**Site Map 3: Southern Work Area Map (Sackett Place)**

Base map adapted from 1 April 2022 drawing FO-201.00, "Ground Floor Framing Plan" for Sackett Place, prepared by DeSimone Consulting Engineers.

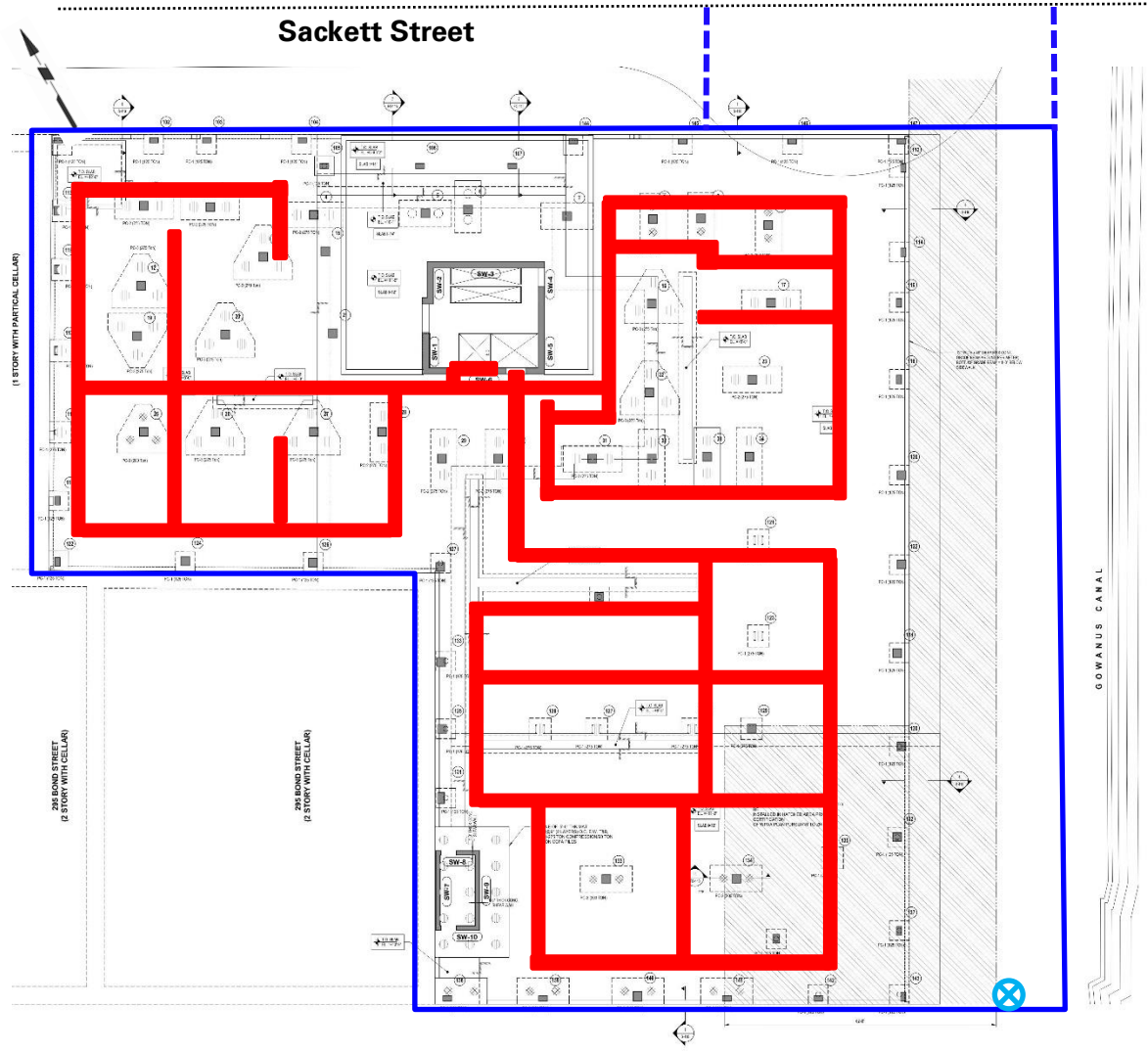

**Legend:**

- Approximate site boundary
- Approximate construction fence boundary
- Upwind air monitoring station
- Downwind air monitoring station
- Approximate work area
- Approximate stabilized construction entrance
- Approximate soil/fill stockpile location
- Approximate import stockpile location
- Approximate C&D debris stockpile location
- Approximate location of SMD piping installation

Cc:	J. Hayes, M. Burke, P. Farnham, E. Adkins, A. Nesci	By:	Lauren Roper <b>Langan, D.P.C.</b>
-----	---	-----	---------------------------------------



# DAILY AIR MONITORING REPORT

## Gowanus Canal Northside

### 267 Bond Street, Brooklyn, New York

07/17/23

Project number: 170295301

Page 1 of 2

Rev. No. 0

Submitted By:

Dust Action Level

150  $\mu\text{g}/\text{m}^3$

TVOC Action Level

5 ppm

Weather Data Range for Work Day		Wind Direction	NNW	Relative Humidity (%)	51.0 - 95.0	Daily Rain (in)	0.00	Readings in the summary table and graphs below are the reported downwind concentrations.
Temp (°F)	74.0 - 91.0	Wind Speed (MPH)	0.6 - 1.7	Barometer (inHg)	29.90 - 29.90			

Station Location Work Area	Daily Avg. Dust Concentration ( $\mu\text{g}/\text{m}^3$ )	Max 15 Min Dust Concentration ( $\mu\text{g}/\text{m}^3$ )	Time of Maximum 15 Minute Avg Dust Reading	Daily Avg. VOC Concentration (ppm)	Max 15 Min VOC Concentration (ppm)	Time of Max VOC Reading
Upwind	54.8	104.3	11:22	0.2	0.6	12:14
Downwind 1	42.2	83.8	11:25	0.0	0.0	8:01
Downwind 2	55.2	99.0	11:46	0.0	0.1	7:59

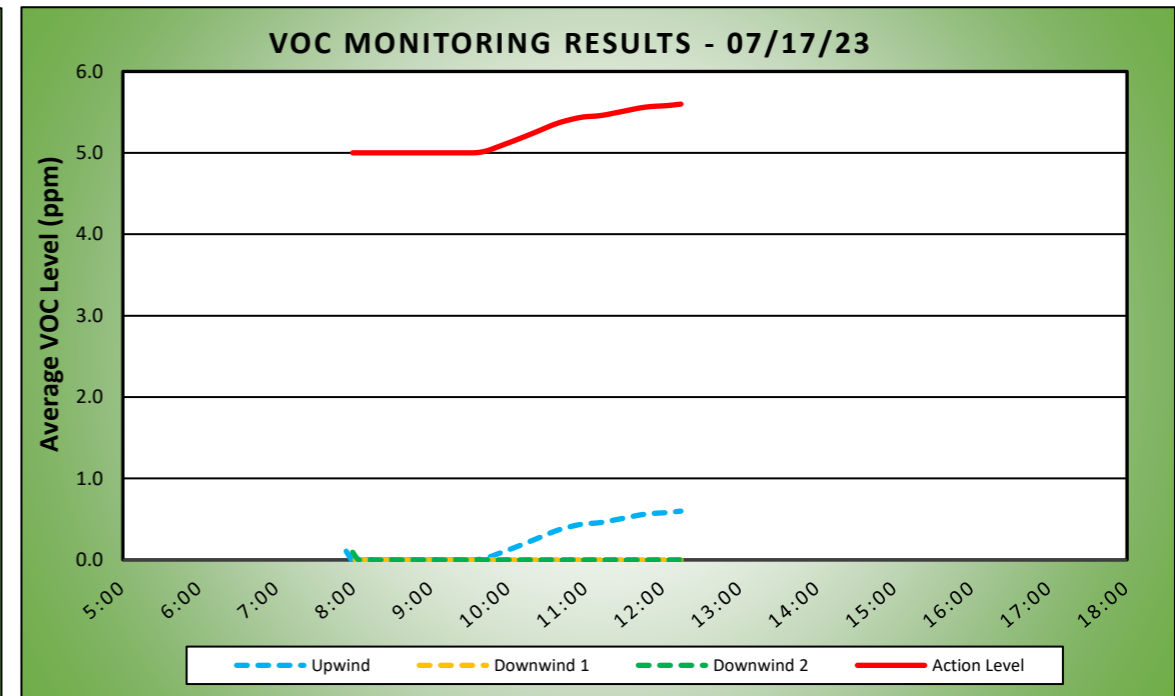
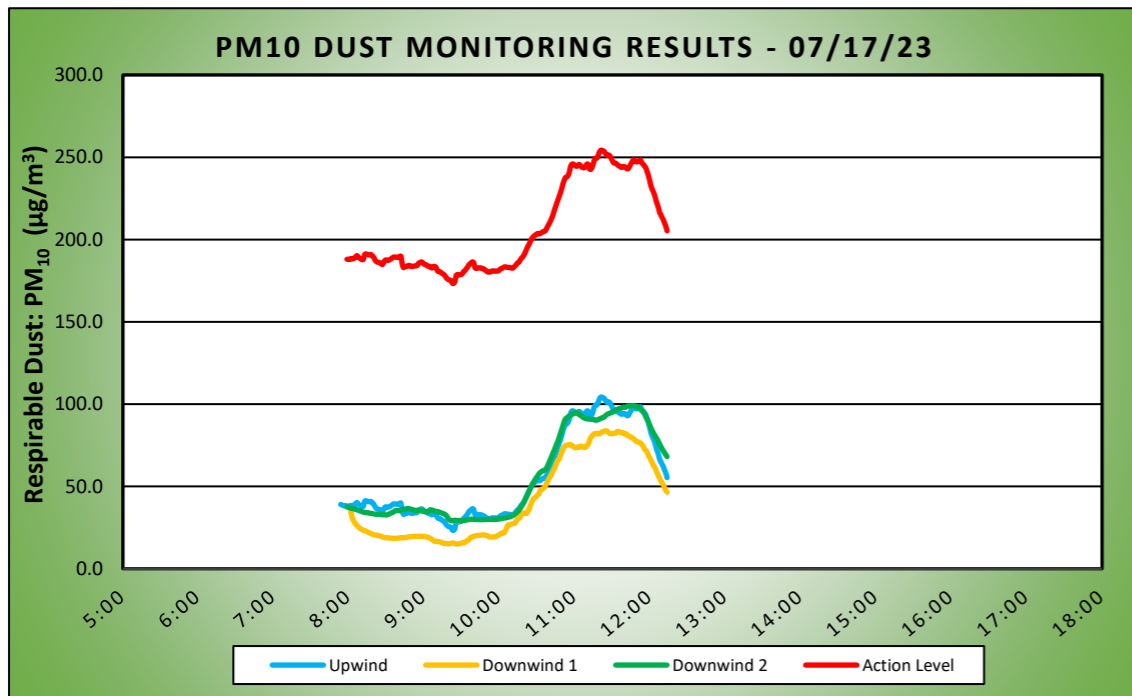

Air Monitoring Notes:

Sampling Notes:

Weather Notes:



Langan - Gowanus Canal Northside  
Air Monitoring 07/17/23  
Wind Speed & Direction  
Daily Readings

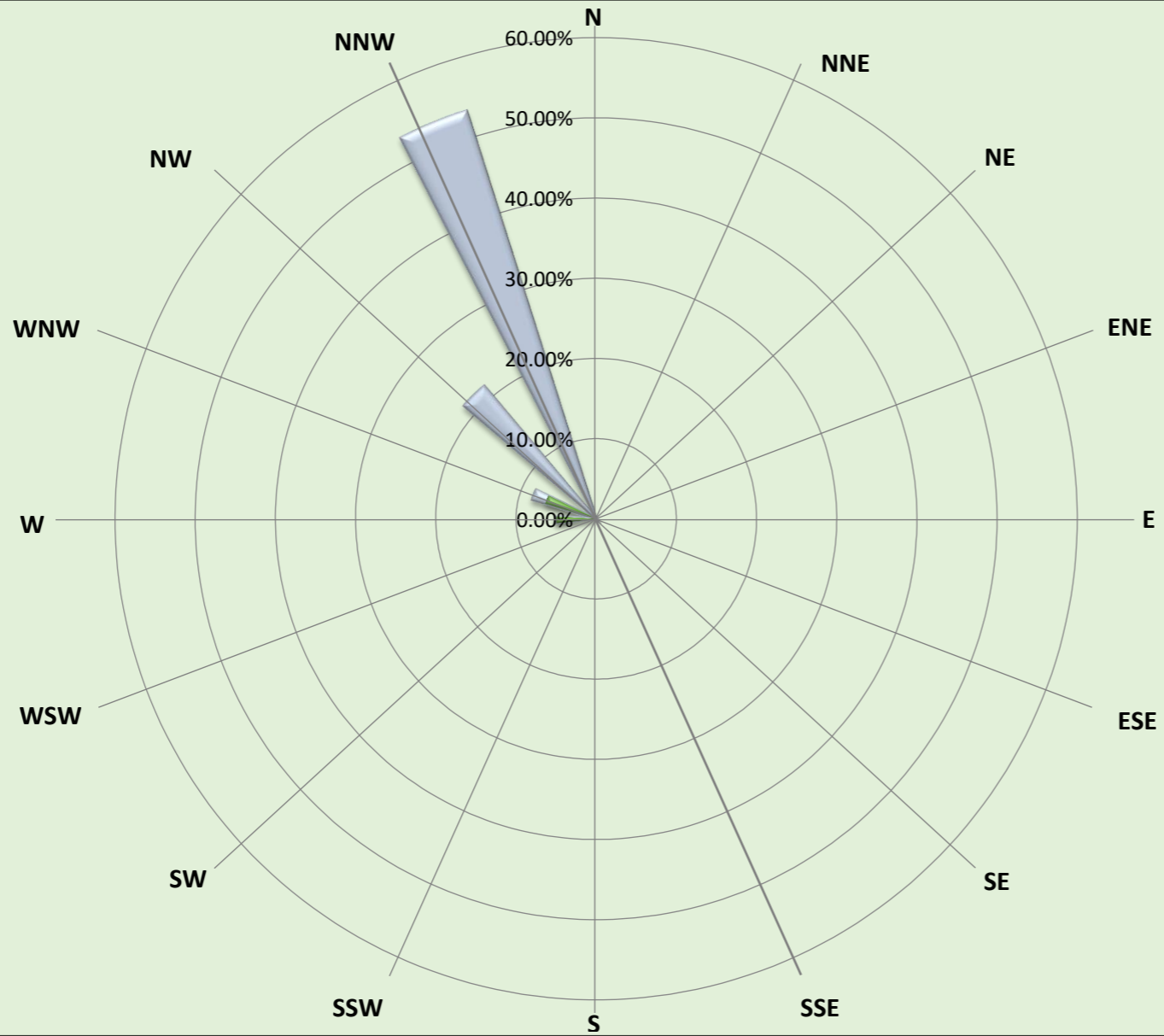

- > 10 MPH
- 8 - 10 MPH
- 6 - 8 MPH
- 4 - 6 MPH
- 2 - 4 MPH
- 1 - 2 MPH
- Calm



Monday, July 17, 2023									
Number of Instances Where Downwind Particulates Exceeds Upwind Particulate + 150 =									0
Number of Comparable Data Points =									256
Start Time:									7:39
End Time:									12:14
PARTICULATE DATA									
Upwind			Downwind						Exceeds Particulate Alarm Limit
Time	Concentration (ug/m <sup>3</sup> )	15-Min Avg Concentration (ug/m <sup>3</sup> )	Time	Concentration (ug/m <sup>3</sup> )	15-Min Avg Concentration (ug/m <sup>3</sup> )	Time	Concentration (ug/m <sup>3</sup> )	15-Min Avg Concentration (ug/m <sup>3</sup> )	
7:39	43.0	-	7:39	-	-	7:39	-	-	-
7:40	43.0	-	7:40	-	-	7:40	-	-	-
7:41	42.0	-	7:41	-	-	7:41	-	-	-
7:42	41.8	-	7:42	-	-	7:42	-	-	-
7:43	41.0	-	7:43	-	-	7:43	-	-	-
7:44	41.8	-	7:44	-	-	7:44	41.0	-	-
7:45	38.8	-	7:45	-	-	7:45	40.8	-	-
7:46	35.0	-	7:46	-	-	7:46	38.8	-	-
7:47	32.3	-	7:47	80.0	-	7:47	38.0	-	-
7:48	35.8	-	7:48	72.5	-	7:48	37.0	-	-
7:49	35.5	-	7:49	57.5	-	7:49	37.0	-	-
7:50	36.3	-	7:50	42.3	-	7:50	37.0	-	-
7:51	34.8	-	7:51	37.5	-	7:51	37.0	-	-
7:52	37.3	-	7:52	34.8	-	7:52	37.0	-	-
7:53	49.3	-	7:53	32.0	-	7:53	37.0	-	-
7:54	41.3	39.0	7:54	30.3	-	7:54	37.3	-	-
7:55	37.8	38.7	7:55	30.3	-	7:55	39.3	-	-
7:56	37.8	38.4	7:56	28.3	-	7:56	38.0	-	-
7:57	37.0	38.1	7:57	27.8	-	7:57	37.0	-	-
7:58	44.3	38.3	7:58	26.5	-	7:58	36.8	-	-
7:59	37.5	38.0	7:59	26.0	-	7:59	36.0	37.6	-
8:00	38.0	38.0	8:00	25.8	-	8:00	36.0	37.3	-
8:01	35.5	38.0	8:01	24.8	-	8:01	35.3	37.0	-
8:02	39.0	38.5	8:02	25.8	34.8	8:02	35.0	36.8	-
8:03	31.5	38.2	8:03	24.3	31.6	8:03	34.0	36.6	-
8:04	40.5	38.5	8:04	24.5	29.4	8:04	34.0	36.4	-
8:05	39.8	38.7	8:05	23.5	28.1	8:05	34.0	36.2	-
8:06	48.5	39.7	8:06	22.0	27.1	8:06	34.0	36.0	-
8:07	45.8	40.2	8:07	21.8	26.2	8:07	33.5	35.8	-
8:08	36.0	39.3	8:08	21.0	25.5	8:08	33.0	35.5	-
8:09	31.5	38.7	8:09	20.3	24.8	8:09	33.3	35.3	-
8:10	31.8	38.3	8:10	20.8	24.2	8:10	33.5	34.9	-
8:11	30.0	37.8	8:11	21.5	23.7	8:11	34.0	34.6	-
8:12	40.3	38.0	8:12	23.0	23.4	8:12	34.0	34.4	-
8:13	85.3	40.7	8:13	22.5	23.2	8:13	33.3	34.2	-
8:14	46.8	41.3	8:14	22.3	22.9	8:14	34.5	34.1	-
8:15	32.3	41.0	8:15	19.8	22.5	8:15	35.3	34.0	-
8:16	33.5	40.8	8:16	19.0	22.1	8:16	33.5	33.9	-
8:17	36.3	40.6	8:17	19.0	21.7	8:17	32.3	33.7	-
8:18	35.5	40.9	8:18	20.0	21.4	8:18	32.0	33.6	-
8:19	30.5	40.2	8:19	19.0	21.0	8:19	32.0	33.5	-
8:20	29.0	39.5	8:20	19.0	20.7	8:20	32.0	33.3	-
8:21	28.3	38.2	8:21	19.5	20.6	8:21	32.0	33.2	-
8:22	27.8	37.0	8:22	20.0	20.4	8:22	32.0	33.1	-
8:23	26.5	36.3	8:23	18.5	20.3	8:23	32.3	33.1	-
8:24	29.0	36.2	8:24	18.0	20.1	8:24	33.5	33.1	-
8:25	26.8	35.8	8:25	18.3	20.0	8:25	33.3	33.1	-
8:26	26.0	35.6	8:26	18.3	19.7	8:26	32.0	32.9	-
8:27	28.5	34.8	8:27	18.0	19.4	8:27	32.0	32.8	-
8:28	97.0	35.6	8:28	18.5	19.1	8:28	33.5	32.8	-
8:29	69.3	37.1	8:29	18.5	18.9	8:29	34.0	32.8	-
8:30	40.5	37.6	8:30	18.8	18.8	8:30	33.5	32.7	-
8:31	30.0	37.4	8:31	19.0	18.8	8:31	35.3	32.8	-
8:32	36.0	37.4	8:32	18.5	18.8	8:32	35.5	33.0	-
8:33	41.8	37.8	8:33	17.3	18.6	8:33	38.3	33.4	-
8:34	37.0	38.2	8:34	18.0	18.5	8:34	38.0	33.8	-
8:35	37.3	38.8	8:35	19.0	18.5	8:35	35.8	34.1	-
8:36	36.5	39.3	8:36	18.3	18.5	8:36	38.0	34.5	-
8:37	28.3	39.4	8:37	20.0	18.5	8:37	40.0	35.0	-
8:38	26.0	39.3	8:38	19.3	18.5	8:38	37.5	35.3	-
8:39	26.5	39.2	8:39	19.0	18.6	8:39	33.8	35.4	-
8:40	28.5	39.3	8:40	19.0	18.6	8:40	32.0	35.3	-
8:41	33.5	39.8	8:41	19.8	18.7	8:41	32.5	35.3	-
8:42	29.0	39.8	8:42	19.3	18.8	8:42	35.0	35.5	-
8:43	27.0	35.1	8:43	19.0	18.8	8:43	38.3	35.8	-
8:44	37.3	33.0	8:44	19.0	18.9	8:44	37.0	36.0	-
8:45	46.5	33.4	8:45	19.0	18.9	8:45	34.5	36.1	-
8:46	35.0	33.7	8:46	20.5	19.0	8:46	37.8	36.3	-
8:47	35.0	33.7	8:47	20.5	19.1	8:47	40.8	36.6	-
8:48	49.8	34.2	8:48	20.0	19.3	8:48	37.5	36.6	-
8:49	37.3	34.2	8:49	19.0	19.4	8:49	34.5	36.3	-

PARTICULATE DATA									
Upwind			Downwind						Exceeds Particulate Alarm Limit
Time	Concentration (ug/m <sup>3</sup> )	15-Min Avg Concentration (ug/m <sup>3</sup> )	Time	Concentration (ug/m <sup>3</sup> )	15-Min Avg Concentration (ug/m <sup>3</sup> )	Time	Concentration (ug/m <sup>3</sup> )	15-Min Avg Concentration (ug/m <sup>3</sup> )	
8:50	29.0	33.7	8:50	19.8	19.4	8:50	33.3	36.2	-
8:51	36.5	33.7	8:51	19.5	19.5	8:51	35.5	36.0	-
8:52	30.0	33.8	8:52	21.0	19.6	8:52	35.5	35.7	-
8:53	28.8	34.0	8:53	20.8	19.7	8:53	33.5	35.4	-
8:54	26.5	34.0	8:54	19.3	19.7	8:54	33.0	35.4	-
8:55	33.8	34.3	8:55	19.0	19.7	8:55	33.0	35.4	-
8:56	51.3	35.5	8:56	19.5	19.7	8:56	33.5	35.5	-
8:57	36.0	36.0	8:57	19.0	19.7	8:57	34.0	35.4	-
8:58	32.3	36.3	8:58	19.3	19.7	8:58	34.0	35.2	-
8:59	35.5	36.2	8:59	19.0	19.7	8:59	34.0	35.0	-
9:00	33.8	35.4	9:00	19.0	19.7	9:00	35.5	35.0	-
9:01	27.3	34.8	9:01	20.0	19.6	9:01	34.5	34.8	-
9:02	33.3	34.7	9:02	17.5	19.4	9:02	34.8	34.4	-
9:03	39.5	34.0	9:03	16.0	19.2	9:03	36.0	34.3	-
9:04	32.5	33.7	9:04	16.0	19.0	9:04	45.3	35.0	-
9:05	28.5	33.7	9:05	14.0	18.6	9:05	43.8	35.7	-
9:06	24.5	32.9	9:06	12.8	18.1	9:06	35.5	35.7	-
9:07	28.8	32.8	9:07	12.8	17.6	9:07	32.3	35.5	-
9:08	42.5	33.7	9:08	12.8	17.1	9:08	30.3	35.3	-
9:09	24.5	33.6	9:09	14.0	16.7	9:09	28.3	35.0	-
9:10	24.3	33.0	9:10	19.0	16.7	9:10	29.8	34.8	-
9:11	23.5	31.1	9:11	18.0	16.6	9:11	33.5	34.8	-
9:12	27.5	30.5	9:12	16.5	16.4	9:12	30.5	34.5	-
9:13	31.8	30.5	9:13	16.8	16.3	9:13	29.5	34.2	-
9:14	25.5	29.8	9:14	15.3	16.0	9:14	30.0	34.0	-
9:15	25.8	29.3	9:15	14.5	15.7	9:15	31.0	33.7	-
9:16	20.8	28.9	9:16	14.5	15.4	9:16	30.5	33.4	-
9:17	20.3	28.0	9:17	17.5	15.4	9:17	28.0	32.9	-
9:18	22.8	26.9	9:18	15.8	15.3	9:18	28.8	32.5	-
9:19	20.5	26.1	9:19	13.3	15.2	9:19	27.5	31.3	-
9:20	21.0	25.6	9:20	13.5	15.1	9:20	27.0	30.2	-
9:21	21.3	25.4	9:21	14.8	15.3	9:21	27.0	29.6	-
9:22	21.0	24.9	9:22	15.0	15.4	9:22	27.3	29.3	-
9:23	21.3	23.4	9:23	15.0	15.6	9:23	29.5	29.2	-
9:24	23.3	23.4	9:24	14.0	15.6	9:24	30.0	29.3	-
9:25	41.5	24.5	9:25	14.3	15.2	9:25	31.8	29.5	-
9:26	78.3	28.2	9:26	15.0	15.0	9:26	31.3	29.3	-
9:27	35.8	28.7	9:27	15.8	15.0	9:27	30.0	29.3	-
9:28	29.3	28.5	9:28	18.3	15.1	9:28	30.0	29.3	-
9:29	27.0	28.6	9:29	18.5	15.3	9:29	30.0	29.3	-
9:30	27.8	28.8	9:30	18.0	15.5	9:30	30.0	29.2	-
9:31	30.0	29.4	9:31	17.0	15.7	9:31	30.0	29.2	-
9:32	38.8	30.6	9:32	17.8	15.7	9:32	30.0	29.3	-
9:33	31.0	31.2	9:33	19.8	16.0	9:33	29.3	29.4	-
9:34	36.5	32.2	9:34	22.0	16.6	9:34	29.5	29.5	-
9:35	34.8	33.2	9:35	22.0	17.1	9:35	30.5	29.7	-
9:36	41.3	34.5	9:36	22.0	17.6	9:36	29.0	29.9	-
9:37	32.8	35.3	9:37	28.8	18.5	9:37	29.5	30.0	-
9:38	30.3	35.9	9:38	23.5	19.1	9:38	30.3	30.1	-
9:39	31.8	36.4	9:39	18.8	19.4	9:39	29.5	30.0	-
9:40	33.0	35.9	9:40	18.5	19.7	9:40	30.5	30.0	-
9:41	32.8	32.8	9:41	17.3	19.9	9:41	30.0	29.9	-
9:42	30.5	32.5	9:42	19.0	20.1	9:42	30.3	29.9	-
9:43	31.0	32.6	9:43	20.8	20.2	9:43	30.0	29.9	-
9:44	30.5	32.8	9:44	18.3	20.2	9:44	29.0	29.8	-
9:45	26.3	32.7	9:45	19.5	20.3	9:45	30.0	29.8	-
9:46	30.3	32.8	9:46	19.0	20.5	9:46	30.0	29.8	-
9:47	30.8	32.2	9:47	20.0	20.6	9:47	29.8	29.8	-
9:48	29.8	32.1	9:48	18.5	20.5	9:48	30.0	29.9	-
9:49	26.8	31.5	9:49	20.0	20.4	9:49	30.0	29.9	-
9:50	26.8	31.0	9:50	19.3	20.2	9:50	30.0	29.9	-
9:51	31.3	30.3	9:51	19.8	20.1	9:51	30.5	30.0	-
9:52	33.0	30.3	9:52	19.5	19.4	9:52	30.0	30.0	-
9:53	29.8	30.3	9:53	20.0	19.2	9:53	30.0	30.0	-
9:54	38.0	30.7	9:54	18.8	19.2	9:54	30.0	30.0	-
9:55	37.0	31.0	9:55	19.0	19.2	9:55	29.3	29.9	-
9:56	30.5	30.8	9:56	19.0	19.4	9:56	29.8	29.9	-
9:57	31.5	30.9	9:57	20.0	19.4	9:57	30.0	29.9	-
9:58	30.3	30.8	9:58	25.5	19.7	9:58	31.0	30.0	-
9:59	31.0	30.9	9:59	24.3	20.1	9:59	31.0	30.1	-
10:00	30.5	31.1	10:00	24.5	20.5	10:00	31.8	30.2	-
10:01	43.0	32.0	10:01	28.0	21.1	10:01	32.0	30.3	-
10:02	37.0	32.4	10:02	26.5	21.5	10:02	32.0	30.5	-
10:03	33.5	32.7	10:03	21.5	21.7	10:03	32.0	30.6	-
10:04	35.0	33.2	10:04	19.8	21.7	10:04	32.0	30.8	-
10:05	29.5	33.4	10:05	38.0	22.9	10:05	32.0	30.9	-

PARTICULATE DATA									
Upwind			Downwind						Exceeds Particulate Alarm Limit
Time	Concentration (ug/m <sup>3</sup> )	15-Min Avg Concentration (ug/m <sup>3</sup> )	Time	Concentration (ug/m <sup>3</sup> )	15-Min Avg Concentration (ug/m <sup>3</sup> )	Time	Concentration (ug/m <sup>3</sup> )	15-Min Avg Concentration (ug/m <sup>3</sup> )	
10:06	29.3	33.3	10:06	42.8	24.5	10:06	32.0	31.0	-
10:07	29.8	33.0	10:07	47.3	26.3	10:07	32.8	31.2	-
10:08	30.3	33.1	10:08	25.0	26.7	10:08	33.0	31.4	-
10:09	36.0	32.9	10:09	23.0	26.9	10:09	33.8	31.6	-
10:10	33.0	32.7	10:10	22.0	27.1	10:10	34.0	31.9	-
10:11	30.5	32.7	10:11	22.0	27.3	10:11	34.3	32.2	-
10:12	39.3	33.2	10:12	22.5	27.5	10:12	36.3	32.7	-
10:13	43.3	34.1	10:13	31.0	27.9	10:13	38.8	33.2	-
10:14	43.8	34.9	10:14	44.8	29.2	10:14	41.8	33.9	-
10:15	45.0	35.9	10:15	37.0	30.1	10:15	43.0	34.6	-
10:16	49.5	36.3	10:16	35.5	30.6	10:16	46.3	35.6	-
10:17	57.0	37.6	10:17	38.3	31.4	10:17	49.0	36.7	-
10:18	49.3	38.7	10:18	37.5	32.4	10:18	50.0	37.9	-
10:19	46.0	39.4	10:19	37.8	33.6	10:19	50.8	39.2	-
10:20	48.0	40.7	10:20	40.8	33.8	10:20	53.3	40.6	-
10:21	52.0	42.2	10:21	41.5	33.7	10:21	55.3	42.1	-
10:22	57.3	44.0	10:22	44.3	33.5	10:22	56.3	43.7	-
10:23	56.0	45.7	10:23	44.3	34.8	10:23	58.0	45.4	-
10:24	56.5	47.1	10:24	44.0	36.2	10:24	59.0	47.1	-
10:25	56.0	48.6	10:25	51.5	38.2	10:25	58.3	48.7	-
10:26	56.0	50.3	10:26	49.0	40.0	10:26	58.0	50.3	-
10:27	55.3	51.4	10:27	47.8	41.7	10:27	58.0	51.7	-
10:28	53.8	52.1	10:28	48.8	42.8	10:28	59.0	53.1	-
10:29	53.0	52.7	10:29	50.8	43.2	10:29	60.0	54.3	-
10:30	54.3	53.3	10:30	49.8	44.1	10:30	61.0	55.5	-
10:31	54.8	53.7	10:31	47.0	44.9	10:31	61.3	56.5	-
10:32	53.0	53.4	10:32	50.8	45.7	10:32	66.8	57.7	-
10:33	53.5	53.7	10:33	67.5	47.7	10:33	61.3	58.4	-
10:34	53.8	54.2	10:34	46.0	48.2	10:34	60.0	59.0	-
10:35	55.5	54.7	10:35	45.8	48.6	10:35	60.3	59.5	-
10:36	55.5	54.9	10:36	51.8	49.3	10:36	60.0	59.8	-
10:37	64.3	55.4	10:37	59.0	50.2	10:37	60.5	60.1	-
10:38	75.8	56.7	10:38	68.5	51.9	10:38	73.0	61.1	-
10:39	78.5	58.2	10:39	69.3	53.5	10:39	84.5	62.8	-
10:40	77.0	59.6	10:40	71.0	54.8	10:40	84.8	64.6	-
10:41	78.8	61.1	10:41	68.5	56.1	10:41	84.3	66.3	-
10:42	82.0	62.9	10:42	70.8	57.7	10:42	86.3	68.2	-
10:43	82.0	64.8	10:43	71.3	59.2	10:43	86.8	70.0	-
10:44	90.5	67.3	10:44	74.0	60.7	10:44	86.0	71.8	-
10:45	88.5	69.6	10:45	76.3	62.5	10:45	89.0	73.6	-
10:46	88.8	71.8	10:46	75.3	64.4	10:46	91.0	75.6	-
10:47	85.5	74.0	10:47	75.0	66.0	10:47	93.5	77.4	-
10:48	85.8	76.1	10:48	77.5	66.7	10:48	95.5	79.7	-
10:49	87.3	78.4	10:49	77.0	68.7	10:49	96.0	82.1	-
10:50	90.8	80.7	10:50	76.8	70.8	10:50	95.3	84.4	-
10:51	100.0	83.7	10:51	76.5	72.4	10:51	94.3	86.7	-
10:52	97.0	85.9	10:52	79.5	73.8	10:52	98.3	89.2	-
10:53	101.5	87.6	10:53	82.0	74.7	10:53	98.3	90.9	-
10:54	85.8	88.1	10:54	74.5	75.1	10:54	94.8	91.6	-
10:55	87.8	88.8	10:55	72.0	75.1	10:55	93.5	92.2	-
10:56	106.5	90.6	10:56	73.3	75.4	10:56	92.8	92.7	-
10:57	132.3	94.0	10:57	68.8	75.3	10:57	92.5	93.2	-
10:58	107.5	95.7	10:58	66.0	75.0	10:58	93.3	93.6	-
10:59	93.5	95.9	10:59	65.8	74.4	10:59	93.3	94.1	-
11:00	82.5	95.5	11:00	67.3	73.8	11:00	95.0	94.5	-
11:01	79.3	94.9	11:01	70.3	73.5	11:01	94.0	94.7	-
11:02	80.0	94.5	11:02	76.5	73.6	11:02	94.8	94.8	-
11:03	95.0	95.1	11:03	83.5	74.0	11:03	89.0	94.3	-
11:04	94.3	95.6	11:04	74.3	73.8	11:04	86.3	93.7	-
11:05	81.5	95.0	11:05	85.3	74.4	11:05	86.8	93.1	-
11:06	84.8	93.9	11:06	77.8	74.4	11:06	87.0	92.6	-
11:07	94.3	93.8	11:07	73.5	74.0	11:07	89.8	92.1	-
11:08	98.8	93.6	11:08	75.5	73.6	11:08	91.3	91.6	-
11:09	98.5	94.4	11:09	77.3	73.8	11:09	90.3	91.3	-
11:10	107.8	95.8	11:10	85.0	74.7	11:10	90.0	91.1	-
11:11	106.3	95.7	11:11	86.3	75.5	11:11	91.3	91.0	-
11:12	94.0	93.2	11:12	95.0	77.3	11:12	91.8	90.9	-
11:13	98.3	92.6	11:13	98.8	79.5	11:13	92.0	90.8	-
11:14	106.3	93.4	11:14	81.3	80.5	11:14	93.0	90.8	-
11:15	113.5	95.5	11:15	80.0	81.3	11:15	92.5	90.6	-
11:16	120.5	98.2	11:16	79.3	81.9	11:16	91.8	90.5	-
11:17	98.0	99.4	11:17	80.3	82.2	11:17	91.0	90.2	-
11:18	95.5	99.5	11:18	80.0	82.0	11:18	90.0	90.3	-
11:19	113.8	100.8	11:19	78.3	82.2	11:19	90.5	90.6	-
11:20	114.5	103.0	11:20	80.0	81.9	11:20	91.8	90.9	-
11:21	102.3	104.1	11:21	86.3	82.4	11:21	92.5	91.3	-

PARTICULATE DATA									
Upwind			Downwind						Exceeds Particulate Alarm Limit
Time	Concentration (ug/m <sup>3</sup> )	15-Min Avg Concentration (ug/m <sup>3</sup> )	Time	Concentration (ug/m <sup>3</sup> )	15-Min Avg Concentration (ug/m <sup>3</sup> )	Time	Concentration (ug/m <sup>3</sup> )	15-Min Avg Concentration (ug/m <sup>3</sup> )	
11:22	96.3	104.3	11:22	83.5	83.1	11:22	94.8	91.6	-
11:23	92.0	103.8	11:23	79.5	83.4	11:23	95.0	91.9	-
11:24	92.3	103.4	11:24	80.3	83.6	11:24	95.8	92.2	-
11:25	89.3	102.2	11:25	88.8	83.8	11:25	101.3	93.0	-
11:26	90.0	101.1	11:26	83.5	83.6	11:26	101.3	93.7	-
11:27	98.8	101.4	11:27	86.3	83.1	11:27	98.0	94.1	-
11:28	94.0	101.1	11:28	85.5	82.2	11:28	96.8	94.4	-
11:29	90.5	100.1	11:29	79.8	82.1	11:29	97.8	94.7	-
11:30	91.8	98.6	11:30	80.8	82.1	11:30	97.0	95.0	-
11:31	96.3	97.0	11:31	80.0	82.2	11:31	96.5	95.3	-
11:32	89.8	96.5	11:32	81.5	82.3	11:32	96.8	95.7	-
11:33	94.8	96.4	11:33	84.0	82.5	11:33	96.5	96.1	-
11:34	104.3	95.8	11:34	88.0	83.2	11:34	97.3	96.6	-
11:35	104.3	95.1	11:35	83.3	83.4	11:35	98.3	97.0	-
11:36	95.8	94.7	11:36	82.8	83.2	11:36	96.3	97.3	-
11:37	87.5	94.1	11:37	78.5	82.8	11:37	97.3	97.4	-
11:38	88.5	93.8	11:38	77.5	82.7	11:38	100.8	97.8	-
11:39	99.3	94.3	11:39	79.8	82.7	11:39	101.3	98.2	-
11:40	88.0	94.2	11:40	76.8	81.9	11:40	100.0	98.1	-
11:41	85.3	93.9	11:41	87.8	82.1	11:41	102.0	98.2	-
11:42	85.0	93.0	11:42	76.3	81.5	11:42	104.0	98.6	-
11:43	95.8	93.1	11:43	75.0	80.8	11:43	101.3	98.9	-
11:44	108.5	94.3	11:44	75.0	80.5	11:44	98.0	98.9	-
11:45	112.8	95.7	11:45	74.5	80.0	11:45	98.5	99.0	-
11:46	116.5	97.1	11:46	73.5	79.6	11:46	97.5	99.0	-
11:47	107.5	98.2	11:47	74.0	79.1	11:47	96.0	99.0	-
11:48	94.8	98.2	11:48	75.5	78.5	11:48	95.8	98.9	-
11:49	90.0	97.3	11:49	74.0	77.6	11:49	94.8	98.8	-
11:50	102.3	97.2	11:50	78.8	77.3	11:50	93.3	98.4	-
11:51	101.3	97.5	11:51	78.8	77.0	11:51	91.8	98.1	-
11:52	95.0	98.0	11:52	72.0	76.6	11:52	89.3	97.6	-
11:53	91.8	98.2	11:53	70.3	76.1	11:53	87.0	96.7	-
11:54	71.8	96.4	11:54	68.3	75.4	11:54	89.8	95.9	-
11:55	77.8	95.7	11:55	63.5	74.5	11:55	89.5	95.2	-
11:56	69.0	94.6	11:56	59.8	72.6	11:56	85.0	94.1	-
11:57	69.3	93.6	11:57	67.3	72.0	11:57	79.0	92.4	-
11:58	63.5	91.4	11:58	55.8	70.7	11:58	78.3	90.9	-
11:59	74.5	89.2	11:59	49.3	69.0	11:59	74.5	89.3	-
12:00	68.8	86.2	12:00	52.5	67.5	12:00	71.8	87.5	-
12:01	68.3	83.0	12:01	52.5	66.1	12:01	70.0	85.7	-
12:02	74.3	80.8	12:02	51.5	64.6	12:02	71.3	84.1	-
12:03	68.0	79.0	12:03	49.8	62.9	12:03	73.5	82.6	-
12:04	61.5	77.1	12:04	57.5	61.8	12:04	74.5	81.2	-
12:05	60.8	74.4	12:05	55.8	60.3	12:05	75.0	80.0	-
12:06	62.3	71.8	12:06	48.8	58.3	12:06	73.3	78.8	-
12:07	63.5	69.7	12:07	45.8	56.5	12:07	66.3	77.2	-
12:08	46.5	66.6	12:08	48.8	55.1	12:08	65.0	75.8	-
12:09	48.8	65.1	12:09	44.0	53.5	12:09	67.0	74.3	-
12:10	52.8	63.4	12:10	42.3	52.1	12:10	68.8	72.9	-
12:11	47.3	62.0	12:11	42.0	50.9	12:11	66.0	71.6	-
12:12	38.0	59.9	12:12	41.8	49.2	12:12	61.5	70.4	-
12:13	36.3	58.1	12:13	31.0	47.5	12:13	59.3	69.2	-
12:14	32.3	55.3	12:14	33.5	46.5	12:14	59.0	68.1	-

Monday, July 17, 2023

Number of Instances Where Downwind VOCs Exceeds Upwind VOCs + 5 = 0

Number of Comparable Data Points = 256

Start Time: 7:39

End Time: 12:14

PID DATA

Upwind			Downwind					Exceeds Particulate Alarm Limit	
Time	Concentration (ppm)	15-Min Avg Concentration (ppm)	Time	Concentration (ppm)	15-Min Avg Concentration (ppm)	Time	Concentration (ppm)		15-Min Avg Concentration (ppm)
7:39	0.4	-	7:39	-	-	7:39	-	-	-
7:40	0.4	-	7:40	-	-	7:40	-	-	-
7:41	0.4	-	7:41	-	-	7:41	-	-	-
7:42	0.4	-	7:42	-	-	7:42	-	-	-
7:43	0.4	-	7:43	-	-	7:43	-	-	-
7:44	0.0	-	7:44	-	-	7:44	0.4	-	-
7:45	0.0	-	7:45	-	-	7:45	0.4	-	-
7:46	0.0	-	7:46	0.0	-	7:46	0.4	-	-
7:47	0.0	-	7:47	0.0	-	7:47	0.3	-	-
7:48	0.0	-	7:48	0.0	-	7:48	0.3	-	-
7:49	0.0	-	7:49	0.0	-	7:49	0.1	-	-
7:50	0.0	-	7:50	0.0	-	7:50	0.0	-	-
7:51	0.0	-	7:51	0.0	-	7:51	0.0	-	-
7:52	0.0	-	7:52	0.0	-	7:52	0.0	-	-
7:53	0.0	-	7:53	0.0	-	7:53	0.0	-	-
7:54	0.0	0.1	7:54	0.0	-	7:54	0.0	-	-
7:55	0.0	0.1	7:55	0.0	-	7:55	0.0	-	-
7:56	0.0	0.1	7:56	0.0	-	7:56	0.0	-	-
7:57	0.0	0.0	7:57	0.0	-	7:57	0.0	-	-
7:58	0.0	0.0	7:58	0.0	-	7:58	0.0	-	-
7:59	0.0	0.0	7:59	0.0	-	7:59	0.0	0.1	-
8:00	0.0	0.0	8:00	0.0	-	8:00	0.0	0.1	-
8:01	0.0	0.0	8:01	0.0	0.0	8:01	0.0	0.0	-
8:02	0.0	0.0	8:02	0.0	0.0	8:02	0.0	0.0	-
8:03	0.0	0.0	8:03	0.0	0.0	8:03	0.0	0.0	-
8:04	0.0	0.0	8:04	0.0	0.0	8:04	0.0	0.0	-
8:05	0.0	0.0	8:05	0.0	0.0	8:05	0.0	0.0	-
8:06	0.0	0.0	8:06	0.0	0.0	8:06	0.0	0.0	-
8:07	0.0	0.0	8:07	0.0	0.0	8:07	0.0	0.0	-
8:08	0.0	0.0	8:08	0.0	0.0	8:08	0.0	0.0	-
8:09	0.0	0.0	8:09	0.0	0.0	8:09	0.0	0.0	-
8:10	0.0	0.0	8:10	0.0	0.0	8:10	0.0	0.0	-
8:11	0.0	0.0	8:11	0.0	0.0	8:11	0.0	0.0	-
8:12	0.0	0.0	8:12	0.0	0.0	8:12	0.0	0.0	-
8:13	0.0	0.0	8:13	0.0	0.0	8:13	0.0	0.0	-
8:14	0.0	0.0	8:14	0.0	0.0	8:14	0.0	0.0	-
8:15	0.0	0.0	8:15	0.0	0.0	8:15	0.0	0.0	-
8:16	0.0	0.0	8:16	0.0	0.0	8:16	0.0	0.0	-
8:17	0.0	0.0	8:17	0.0	0.0	8:17	0.0	0.0	-
8:18	0.0	0.0	8:18	0.0	0.0	8:18	0.0	0.0	-
8:19	0.0	0.0	8:19	0.0	0.0	8:19	0.0	0.0	-
8:20	0.0	0.0	8:20	0.0	0.0	8:20	0.0	0.0	-
8:21	0.0	0.0	8:21	0.0	0.0	8:21	0.0	0.0	-
8:22	0.0	0.0	8:22	0.0	0.0	8:22	0.0	0.0	-
8:23	0.0	0.0	8:23	0.0	0.0	8:23	0.0	0.0	-
8:24	0.0	0.0	8:24	0.0	0.0	8:24	0.0	0.0	-
8:25	0.0	0.0	8:25	0.0	0.0	8:25	0.0	0.0	-
8:26	0.0	0.0	8:26	0.0	0.0	8:26	0.0	0.0	-
8:27	0.0	0.0	8:27	0.0	0.0	8:27	0.0	0.0	-
8:28	0.0	0.0	8:28	0.0	0.0	8:28	0.0	0.0	-
8:29	0.0	0.0	8:29	0.0	0.0	8:29	0.0	0.0	-
8:30	0.0	0.0	8:30	0.0	0.0	8:30	0.0	0.0	-
8:31	0.0	0.0	8:31	0.0	0.0	8:31	0.0	0.0	-
8:32	0.0	0.0	8:32	0.0	0.0	8:32	0.0	0.0	-
8:33	0.0	0.0	8:33	0.0	0.0	8:33	0.0	0.0	-
8:34	0.0	0.0	8:34	0.0	0.0	8:34	0.0	0.0	-
8:35	0.0	0.0	8:35	0.0	0.0	8:35	0.0	0.0	-
8:36	0.0	0.0	8:36	0.0	0.0	8:36	0.0	0.0	-
8:37	0.0	0.0	8:37	0.0	0.0	8:37	0.0	0.0	-
8:38	0.0	0.0	8:38	0.0	0.0	8:38	0.0	0.0	-
8:39	0.0	0.0	8:39	0.0	0.0	8:39	0.0	0.0	-
8:40	0.0	0.0	8:40	0.0	0.0	8:40	0.0	0.0	-
8:41	0.0	0.0	8:41	0.0	0.0	8:41	0.0	0.0	-
8:42	0.0	0.0	8:42	0.0	0.0	8:42	0.0	0.0	-
8:43	0.0	0.0	8:43	0.0	0.0	8:43	0.0	0.0	-
8:44	0.0	0.0	8:44	0.0	0.0	8:44	0.0	0.0	-
8:45	0.0	0.0	8:45	0.0	0.0	8:45	0.0	0.0	-
8:46	0.0	0.0	8:46	0.0	0.0	8:46	0.0	0.0	-
8:47	0.0	0.0	8:47	0.0	0.0	8:47	0.0	0.0	-
8:48	0.0	0.0	8:48	0.0	0.0	8:48	0.0	0.0	-
8:49	0.0	0.0	8:49	0.0	0.0	8:49	0.0	0.0	-

PID DATA									
Upwind			Downwind						Exceeds Particulate Alarm Limit
Time	Concentration (ppm)	15-Min Avg Concentration (ppm)	Time	Concentration (ppm)	15-Min Avg Concentration (ppm)	Time	Concentration (ppm)	15-Min Avg Concentration (ppm)	
8:50	0.0	0.0	8:50	0.0	0.0	8:50	0.0	0.0	-
8:51	0.0	0.0	8:51	0.0	0.0	8:51	0.0	0.0	-
8:52	0.0	0.0	8:52	0.0	0.0	8:52	0.0	0.0	-
8:53	0.0	0.0	8:53	0.0	0.0	8:53	0.0	0.0	-
8:54	0.0	0.0	8:54	0.0	0.0	8:54	0.0	0.0	-
8:55	0.0	0.0	8:55	0.0	0.0	8:55	0.0	0.0	-
8:56	0.0	0.0	8:56	0.0	0.0	8:56	0.0	0.0	-
8:57	0.0	0.0	8:57	0.0	0.0	8:57	0.0	0.0	-
8:58	0.0	0.0	8:58	0.0	0.0	8:58	0.0	0.0	-
8:59	0.0	0.0	8:59	0.0	0.0	8:59	0.0	0.0	-
9:00	0.0	0.0	9:00	0.0	0.0	9:00	0.0	0.0	-
9:01	0.0	0.0	9:01	0.0	0.0	9:01	0.0	0.0	-
9:02	0.0	0.0	9:02	0.0	0.0	9:02	0.0	0.0	-
9:03	0.0	0.0	9:03	0.0	0.0	9:03	0.0	0.0	-
9:04	0.0	0.0	9:04	0.0	0.0	9:04	0.0	0.0	-
9:05	0.0	0.0	9:05	0.0	0.0	9:05	0.0	0.0	-
9:06	0.0	0.0	9:06	0.0	0.0	9:06	0.0	0.0	-
9:07	0.0	0.0	9:07	0.0	0.0	9:07	0.0	0.0	-
9:08	0.0	0.0	9:08	0.0	0.0	9:08	0.0	0.0	-
9:09	0.0	0.0	9:09	0.0	0.0	9:09	0.0	0.0	-
9:10	0.0	0.0	9:10	0.0	0.0	9:10	0.0	0.0	-
9:11	0.0	0.0	9:11	0.0	0.0	9:11	0.0	0.0	-
9:12	0.0	0.0	9:12	0.0	0.0	9:12	0.0	0.0	-
9:13	0.0	0.0	9:13	0.0	0.0	9:13	0.0	0.0	-
9:14	0.0	0.0	9:14	0.0	0.0	9:14	0.0	0.0	-
9:15	0.0	0.0	9:15	0.0	0.0	9:15	0.0	0.0	-
9:16	0.0	0.0	9:16	0.0	0.0	9:16	0.0	0.0	-
9:17	0.0	0.0	9:17	0.0	0.0	9:17	0.0	0.0	-
9:18	0.0	0.0	9:18	0.0	0.0	9:18	0.0	0.0	-
9:19	0.0	0.0	9:19	0.0	0.0	9:19	0.0	0.0	-
9:20	0.0	0.0	9:20	0.0	0.0	9:20	0.0	0.0	-
9:21	0.0	0.0	9:21	0.0	0.0	9:21	0.0	0.0	-
9:22	0.0	0.0	9:22	0.0	0.0	9:22	0.0	0.0	-
9:23	0.0	0.0	9:23	0.0	0.0	9:23	0.0	0.0	-
9:24	0.0	0.0	9:24	0.0	0.0	9:24	0.0	0.0	-
9:25	0.0	0.0	9:25	0.0	0.0	9:25	0.0	0.0	-
9:26	0.0	0.0	9:26	0.0	0.0	9:26	0.0	0.0	-
9:27	0.0	0.0	9:27	0.0	0.0	9:27	0.0	0.0	-
9:28	0.0	0.0	9:28	0.0	0.0	9:28	0.0	0.0	-
9:29	0.0	0.0	9:29	0.0	0.0	9:29	0.0	0.0	-
9:30	0.0	0.0	9:30	0.0	0.0	9:30	0.0	0.0	-
9:31	0.0	0.0	9:31	0.0	0.0	9:31	0.0	0.0	-
9:32	0.0	0.0	9:32	0.0	0.0	9:32	0.0	0.0	-
9:33	0.0	0.0	9:33	0.0	0.0	9:33	0.0	0.0	-
9:34	0.0	0.0	9:34	0.0	0.0	9:34	0.0	0.0	-
9:35	0.0	0.0	9:35	0.0	0.0	9:35	0.0	0.0	-
9:36	0.0	0.0	9:36	0.0	0.0	9:36	0.0	0.0	-
9:37	0.0	0.0	9:37	0.0	0.0	9:37	0.0	0.0	-
9:38	0.0	0.0	9:38	0.0	0.0	9:38	0.0	0.0	-
9:39	0.0	0.0	9:39	0.0	0.0	9:39	0.0	0.0	-
9:40	0.0	0.0	9:40	0.0	0.0	9:40	0.0	0.0	-
9:41	0.0	0.0	9:41	0.0	0.0	9:41	0.0	0.0	-
9:42	0.1	0.0	9:42	0.0	0.0	9:42	0.0	0.0	-
9:43	0.1	0.0	9:43	0.0	0.0	9:43	0.0	0.0	-
9:44	0.1	0.0	9:44	0.0	0.0	9:44	0.0	0.0	-
9:45	0.1	0.0	9:45	0.0	0.0	9:45	0.0	0.0	-
9:46	0.1	0.0	9:46	0.0	0.0	9:46	0.0	0.0	-
9:47	0.1	0.0	9:47	0.0	0.0	9:47	0.0	0.0	-
9:48	0.1	0.1	9:48	0.0	0.0	9:48	0.0	0.0	-
9:49	0.1	0.1	9:49	0.0	0.0	9:49	0.0	0.0	-
9:50	0.1	0.1	9:50	0.0	0.0	9:50	0.0	0.0	-
9:51	0.1	0.1	9:51	0.0	0.0	9:51	0.0	0.0	-
9:52	0.1	0.1	9:52	0.0	0.0	9:52	0.0	0.0	-
9:53	0.1	0.1	9:53	0.0	0.0	9:53	0.0	0.0	-
9:54	0.1	0.1	9:54	0.0	0.0	9:54	0.0	0.0	-
9:55	0.1	0.1	9:55	0.0	0.0	9:55	0.0	0.0	-
9:56	0.1	0.1	9:56	0.0	0.0	9:56	0.0	0.0	-
9:57	0.1	0.1	9:57	0.0	0.0	9:57	0.0	0.0	-
9:58	0.2	0.1	9:58	0.0	0.0	9:58	0.0	0.0	-
9:59	0.2	0.1	9:59	0.0	0.0	9:59	0.0	0.0	-
10:00	0.2	0.1	10:00	0.0	0.0	10:00	0.0	0.0	-
10:01	0.2	0.1	10:01	0.0	0.0	10:01	0.0	0.0	-
10:02	0.2	0.1	10:02	0.0	0.0	10:02	0.0	0.0	-
10:03	0.2	0.1	10:03	0.0	0.0	10:03	0.0	0.0	-
10:04	0.2	0.1	10:04	0.0	0.0	10:04	0.0	0.0	-
10:05	0.2	0.2	10:05	0.0	0.0	10:05	0.0	0.0	-

PID DATA									
Upwind			Downwind						Exceeds Particulate Alarm Limit
Time	Concentration (ppm)	15-Min Avg Concentration (ppm)	Time	Concentration (ppm)	15-Min Avg Concentration (ppm)	Time	Concentration (ppm)	15-Min Avg Concentration (ppm)	
10:06	0.2	0.2	10:06	0.0	0.0	10:06	0.0	0.0	-
10:07	0.2	0.2	10:07	0.0	0.0	10:07	0.0	0.0	-
10:08	0.2	0.2	10:08	0.0	0.0	10:08	0.0	0.0	-
10:09	0.2	0.2	10:09	0.0	0.0	10:09	0.0	0.0	-
10:10	0.2	0.2	10:10	0.0	0.0	10:10	0.0	0.0	-
10:11	0.2	0.2	10:11	0.0	0.0	10:11	0.0	0.0	-
10:12	0.2	0.2	10:12	0.0	0.0	10:12	0.0	0.0	-
10:13	0.2	0.2	10:13	0.0	0.0	10:13	0.0	0.0	-
10:14	0.3	0.2	10:14	0.0	0.0	10:14	0.0	0.0	-
10:15	0.3	0.2	10:15	0.0	0.0	10:15	0.0	0.0	-
10:16	0.3	0.2	10:16	0.0	0.0	10:16	0.0	0.0	-
10:17	0.3	0.2	10:17	0.0	0.0	10:17	0.0	0.0	-
10:18	0.3	0.2	10:18	0.0	0.0	10:18	0.0	0.0	-
10:19	0.3	0.2	10:19	0.0	0.0	10:19	0.0	0.0	-
10:20	0.3	0.2	10:20	0.0	0.0	10:20	0.0	0.0	-
10:21	0.3	0.3	10:21	0.0	0.0	10:21	0.0	0.0	-
10:22	0.3	0.3	10:22	0.0	0.0	10:22	0.0	0.0	-
10:23	0.3	0.3	10:23	0.0	0.0	10:23	0.0	0.0	-
10:24	0.3	0.3	10:24	0.0	0.0	10:24	0.0	0.0	-
10:25	0.3	0.3	10:25	0.0	0.0	10:25	0.0	0.0	-
10:26	0.3	0.3	10:26	0.0	0.0	10:26	0.0	0.0	-
10:27	0.3	0.3	10:27	0.0	0.0	10:27	0.0	0.0	-
10:28	0.3	0.3	10:28	0.0	0.0	10:28	0.0	0.0	-
10:29	0.4	0.3	10:29	0.0	0.0	10:29	0.0	0.0	-
10:30	0.4	0.3	10:30	0.0	0.0	10:30	0.0	0.0	-
10:31	0.4	0.3	10:31	0.0	0.0	10:31	0.0	0.0	-
10:32	0.4	0.3	10:32	0.0	0.0	10:32	0.0	0.0	-
10:33	0.4	0.3	10:33	0.0	0.0	10:33	0.0	0.0	-
10:34	0.4	0.3	10:34	0.0	0.0	10:34	0.0	0.0	-
10:35	0.4	0.3	10:35	0.0	0.0	10:35	0.0	0.0	-
10:36	0.4	0.4	10:36	0.0	0.0	10:36	0.0	0.0	-
10:37	0.4	0.4	10:37	0.0	0.0	10:37	0.0	0.0	-
10:38	0.4	0.4	10:38	0.0	0.0	10:38	0.0	0.0	-
10:39	0.4	0.4	10:39	0.0	0.0	10:39	0.0	0.0	-
10:40	0.4	0.4	10:40	0.0	0.0	10:40	0.0	0.0	-
10:41	0.4	0.4	10:41	0.0	0.0	10:41	0.0	0.0	-
10:42	0.4	0.4	10:42	0.0	0.0	10:42	0.0	0.0	-
10:43	0.4	0.4	10:43	0.0	0.0	10:43	0.0	0.0	-
10:44	0.4	0.4	10:44	0.0	0.0	10:44	0.0	0.0	-
10:45	0.4	0.4	10:45	0.0	0.0	10:45	0.0	0.0	-
10:46	0.4	0.4	10:46	0.0	0.0	10:46	0.0	0.0	-
10:47	0.4	0.4	10:47	0.0	0.0	10:47	0.0	0.0	-
10:48	0.4	0.4	10:48	0.0	0.0	10:48	0.0	0.0	-
10:49	0.4	0.4	10:49	0.0	0.0	10:49	0.0	0.0	-
10:50	0.4	0.4	10:50	0.0	0.0	10:50	0.0	0.0	-
10:51	0.4	0.4	10:51	0.0	0.0	10:51	0.0	0.0	-
10:52	0.4	0.4	10:52	0.0	0.0	10:52	0.0	0.0	-
10:53	0.4	0.4	10:53	0.0	0.0	10:53	0.0	0.0	-
10:54	0.4	0.4	10:54	0.0	0.0	10:54	0.0	0.0	-
10:55	0.4	0.4	10:55	0.0	0.0	10:55	0.0	0.0	-
10:56	0.4	0.4	10:56	0.0	0.0	10:56	0.0	0.0	-
10:57	0.4	0.4	10:57	0.0	0.0	10:57	0.0	0.0	-
10:58	0.4	0.4	10:58	0.0	0.0	10:58	0.0	0.0	-
10:59	0.4	0.4	10:59	0.0	0.0	10:59	0.0	0.0	-
11:00	0.4	0.4	11:00	0.0	0.0	11:00	0.0	0.0	-
11:01	0.4	0.4	11:01	0.0	0.0	11:01	0.0	0.0	-
11:02	0.4	0.4	11:02	0.0	0.0	11:02	0.0	0.0	-
11:03	0.5	0.4	11:03	0.0	0.0	11:03	0.0	0.0	-
11:04	0.5	0.4	11:04	0.0	0.0	11:04	0.0	0.0	-
11:05	0.5	0.4	11:05	0.0	0.0	11:05	0.0	0.0	-
11:06	0.5	0.5	11:06	0.0	0.0	11:06	0.0	0.0	-
11:07	0.5	0.5	11:07	0.0	0.0	11:07	0.0	0.0	-
11:08	0.5	0.5	11:08	0.0	0.0	11:08	0.0	0.0	-
11:09	0.5	0.5	11:09	0.0	0.0	11:09	0.0	0.0	-
11:10	0.5	0.5	11:10	0.0	0.0	11:10	0.0	0.0	-
11:11	0.5	0.5	11:11	0.0	0.0	11:11	0.0	0.0	-
11:12	0.5	0.5	11:12	0.0	0.0	11:12	0.0	0.0	-
11:13	0.5	0.5	11:13	0.0	0.0	11:13	0.0	0.0	-
11:14	0.5	0.5	11:14	0.0	0.0	11:14	0.0	0.0	-
11:15	0.5	0.5	11:15	0.0	0.0	11:15	0.0	0.0	-
11:16	0.5	0.5	11:16	0.0	0.0	11:16	0.0	0.0	-
11:17	0.5	0.5	11:17	0.0	0.0	11:17	0.0	0.0	-
11:18	0.5	0.5	11:18	0.0	0.0	11:18	0.0	0.0	-
11:19	0.5	0.5	11:19	0.0	0.0	11:19	0.0	0.0	-
11:20	0.5	0.5	11:20	0.0	0.0	11:20	0.0	0.0	-
11:21	0.5	0.5	11:21	0.0	0.0	11:21	0.0	0.0	-

PID DATA									
Upwind			Downwind						Exceeds Particulate Alarm Limit
Time	Concentration (ppm)	15-Min Avg Concentration (ppm)	Time	Concentration (ppm)	15-Min Avg Concentration (ppm)	Time	Concentration (ppm)	15-Min Avg Concentration (ppm)	
11:22	0.5	0.5	11:22	0.0	0.0	11:22	0.0	0.0	-
11:23	0.5	0.5	11:23	0.0	0.0	11:23	0.0	0.0	-
11:24	0.5	0.5	11:24	0.0	0.0	11:24	0.0	0.0	-
11:25	0.5	0.5	11:25	0.0	0.0	11:25	0.0	0.0	-
11:26	0.5	0.5	11:26	0.0	0.0	11:26	0.0	0.0	-
11:27	0.5	0.5	11:27	0.0	0.0	11:27	0.0	0.0	-
11:28	0.5	0.5	11:28	0.0	0.0	11:28	0.0	0.0	-
11:29	0.5	0.5	11:29	0.0	0.0	11:29	0.0	0.0	-
11:30	0.5	0.5	11:30	0.0	0.0	11:30	0.0	0.0	-
11:31	0.5	0.5	11:31	0.0	0.0	11:31	0.0	0.0	-
11:32	0.5	0.5	11:32	0.0	0.0	11:32	0.0	0.0	-
11:33	0.5	0.5	11:33	0.0	0.0	11:33	0.0	0.0	-
11:34	0.5	0.5	11:34	0.0	0.0	11:34	0.0	0.0	-
11:35	0.6	0.5	11:35	0.0	0.0	11:35	0.0	0.0	-
11:36	0.6	0.5	11:36	0.0	0.0	11:36	0.0	0.0	-
11:37	0.6	0.5	11:37	0.0	0.0	11:37	0.0	0.0	-
11:38	0.6	0.5	11:38	0.0	0.0	11:38	0.0	0.0	-
11:39	0.6	0.5	11:39	0.0	0.0	11:39	0.0	0.0	-
11:40	0.6	0.5	11:40	0.0	0.0	11:40	0.0	0.0	-
11:41	0.6	0.5	11:41	0.0	0.0	11:41	0.0	0.0	-
11:42	0.6	0.6	11:42	0.0	0.0	11:42	0.0	0.0	-
11:43	0.6	0.6	11:43	0.0	0.0	11:43	0.0	0.0	-
11:44	0.6	0.6	11:44	0.0	0.0	11:44	0.0	0.0	-
11:45	0.6	0.6	11:45	0.0	0.0	11:45	0.0	0.0	-
11:46	0.6	0.6	11:46	0.0	0.0	11:46	0.0	0.0	-
11:47	0.6	0.6	11:47	0.0	0.0	11:47	0.0	0.0	-
11:48	0.6	0.6	11:48	0.0	0.0	11:48	0.0	0.0	-
11:49	0.6	0.6	11:49	0.0	0.0	11:49	0.0	0.0	-
11:50	0.6	0.6	11:50	0.0	0.0	11:50	0.0	0.0	-
11:51	0.6	0.6	11:51	0.0	0.0	11:51	0.0	0.0	-
11:52	0.6	0.6	11:52	0.0	0.0	11:52	0.0	0.0	-
11:53	0.6	0.6	11:53	0.0	0.0	11:53	0.0	0.0	-
11:54	0.6	0.6	11:54	0.0	0.0	11:54	0.0	0.0	-
11:55	0.6	0.6	11:55	0.0	0.0	11:55	0.0	0.0	-
11:56	0.6	0.6	11:56	0.0	0.0	11:56	0.0	0.0	-
11:57	0.6	0.6	11:57	0.0	0.0	11:57	0.0	0.0	-
11:58	0.6	0.6	11:58	0.0	0.0	11:58	0.0	0.0	-
11:59	0.6	0.6	11:59	0.0	0.0	11:59	0.0	0.0	-
12:00	0.6	0.6	12:00	0.0	0.0	12:00	0.0	0.0	-
12:01	0.6	0.6	12:01	0.0	0.0	12:01	0.0	0.0	-
12:02	0.6	0.6	12:02	0.0	0.0	12:02	0.0	0.0	-
12:03	0.6	0.6	12:03	0.0	0.0	12:03	0.0	0.0	-
12:04	0.6	0.6	12:04	0.0	0.0	12:04	0.0	0.0	-
12:05	0.6	0.6	12:05	0.0	0.0	12:05	0.0	0.0	-
12:06	0.6	0.6	12:06	0.0	0.0	12:06	0.0	0.0	-
12:07	0.6	0.6	12:07	0.0	0.0	12:07	0.0	0.0	-
12:08	0.6	0.6	12:08	0.0	0.0	12:08	0.0	0.0	-
12:09	0.6	0.6	12:09	0.0	0.0	12:09	0.0	0.0	-
12:10	0.6	0.6	12:10	0.0	0.0	12:10	0.0	0.0	-
12:11	0.6	0.6	12:11	0.0	0.0	12:11	0.0	0.0	-
12:12	0.6	0.6	12:12	0.0	0.0	12:12	0.0	0.0	-
12:13	0.6	0.6	12:13	0.0	0.0	12:13	0.0	0.0	-
12:14	0.6	0.6	12:14	0.0	0.0	12:14	0.0	0.0	-