

## DAILY STATUS REPORT

Prepared By: **Paul Matli**

<b>WEATHER</b>	Snow	Rain	Overcast	Partly Cloudy	Bright Sun
<b>TEMP.</b>	< 32	32-50	50-70	70-85	>85

BCP Project No.:	<b>C224187</b>	Date:	<b>6-26-2018</b>
Project Name:	<b>471-483 20<sup>th</sup> Street, Brooklyn, NY</b>		

<b>Consultants:</b> Hydro Tech Environmental Eng & Geol DPC Tarek Z. Khouri P.E. Mairio Pineda /Paul I. Matli	<b>Safety Officer:</b> Not available at this time Frank Gagliardi
<b>General Contractor:</b> Not applicable at this time	<b>Site Manager/ Supervisor:</b> Frank Gagliardi

### Activities:

- Perform GPR survey to clear the proposed locations of SVE wells, pipe trenches and vacuum test ports
- Installation of SVE wells EW-3 and EW-4 using Geoprobe machine equipped with Auger equipment
- Contain soil cuttings from drilling with augers in 55-gallon drums

### Working In Grid #:

**Samples Collected (Since Last Report): None**

### Air Monitoring (Since Last Report):

**PID:** 0.1 ppm ( in all wells)

Pre-start Condition: Upwind – 0.024mg/m<sup>3</sup>

Downwind –0.034 mg/m<sup>3</sup>

Highest Condition: Upwind – 0.037mg/m<sup>3</sup>

Downwind –0.034 mg/m<sup>3</sup>

### Problems Encountered:

No problems encountered

### Planned Activities for the Next Day/ Week:

Continue SVE wells installation

Example:

Facility # Name/ Location Type of Waste Solid <u>Or</u> Liquid										
(Trucks, Cu.Yds. <u>Or</u> Gallons)	Trucks	Cu. Yds.	Trucks	Cu. Yds.	Trucks	Cu. Yds.	Trucks	Cu. Yds.	Trucks	Cu. Yds.
Today										
Total										

Imported Backfill/ Facility	(Cu. Yds.)		(Cu. Yds.)		(Cu. Yds.)		(Cu. Yds.)		(Cu. Yds.)	
Today										

### Site Map

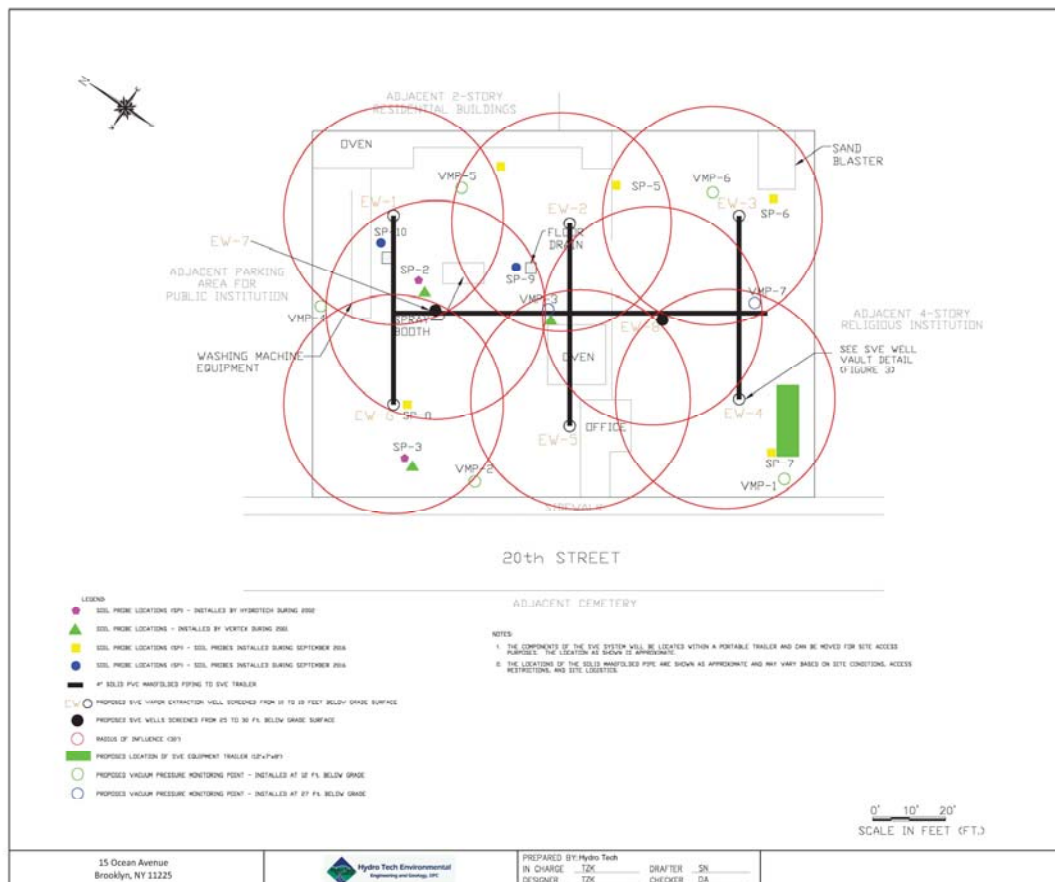

27 December 2017

SIGNATURE \_\_\_\_\_ DATE \_\_\_\_\_

CONTRACT NO. 844

471-400 20th Street, Brooklyn, NY

**PROPOSED SVE EQUIPMENT/WELL LOCATIONS**

DWG. NO. 2	SCALE 3/32"=1'-0"	DATE DECEMBER 2017	SHEET 2 OF 4
------------	-------------------	--------------------	--------------

15 Ocean Avenue  
Brooklyn, NY 11225



PREPARED BY: Hydro Tech  
IN CHARGE: TKZ DRAFTER: SN  
DESIGNER: TKZ CHECKER: DA

## Photo Log

GPR survey



SVE wells installation



--	--

# DAILY STATUS REPORT

Prepared By: **Paul Matli**

<b>WEATHER</b>	Snow	Rain		Overcast		Partly Cloudy	Bright Sun	x
<b>TEMP.</b>	< 32	32-50	x	50-70		70-85	>85	

BCP Project No.:	<b>C224187</b>	Date:	<b>6-27-2018</b>
Project Name:	<b>471-483 20<sup>th</sup> Street, Brooklyn, NY</b>		

<b>Consultants:</b> Hydro Tech Environmental Eng & Geol DPC Tarek Z. Khouri P.E. Mairio Pineda /Paul I. Matli	<b>Safety Officer:</b> Not available at this time Frank Gagliardi
<b>General Contractor:</b> Not applicable at this time	<b>Site Manager/ Supervisor:</b> Frank Gagliardi

<b>Activities:</b> <ul style="list-style-type: none"><li>- Installation of SVE wells EW-5 and EW-6 using Geoprobe machine equipped with Auger equipment</li><li>- Contain soil cuttings from drilling with augers in 55-gallon drums</li></ul>
--

<b>Working In Grid #:</b>
---------------------------

<b>Samples Collected (Since Last Report):</b> None
--

<b>Air Monitoring (Since Last Report):</b>  <b>PID:</b> 0.1 ppm  Pre-start Condition: 0.065 mg/m <sup>3</sup> Highest Condition: 0.074 mg/m <sup>3</sup>
---

<b>Problems Encountered:</b> No problems encountered
---

<b>Planned Activities for the Next Day/ Week:</b> Continue SVE wells installation
--

Example:

Facility # Name/ Location Type of Waste Solid <u>Or</u> Liquid										
(Trucks, Cu.Yds. <u>Or</u> Gallons)	Trucks	Cu. Yds.	Trucks	Cu. Yds.	Trucks	Cu. Yds.	Trucks	Cu. Yds.	Trucks	Cu. Yds.
Today										
Total										

Imported Backfill/ Facility	(Cu. Yds.)		(Cu. Yds.)		(Cu. Yds.)		(Cu. Yds.)		(Cu. Yds.)	
Today										

### Site Map

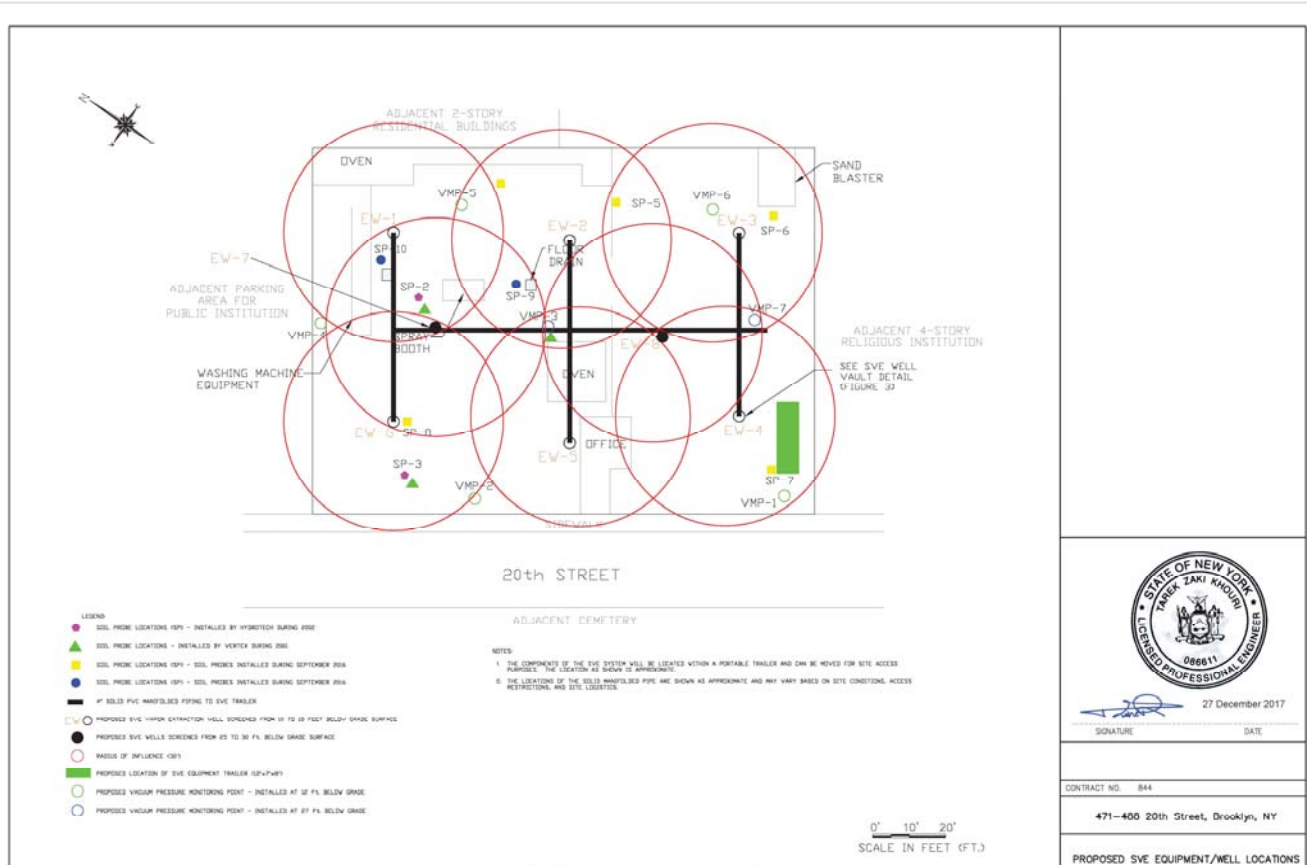

27 December 2017

SIGNATURE \_\_\_\_\_ DATE \_\_\_\_\_

CONTRACT NO. 844

471-400 20th Street, Brooklyn, NY

**PROPOSED SVE EQUIPMENT/WELL LOCATIONS**

DWG. NO.	SCALE	DATE	SHEET
2	3/32"=1'-0"	DECEMBER 2017	2 OF 4

Photo Log

SVE well installation



SVE wells installation



# DAILY STATUS REPORT

Prepared By: **Paul Matli**

<b>WEATHER</b>	Snow	Rain	Overcast	x	Partly Cloudy	Bright Sun
<b>TEMP.</b>	< 32	32-50	50-70	x	70-85	>85

BCP Project No.:	<b>C224187</b>	Date:	<b>6-28-2018</b>
Project Name:	<b>471-483 20<sup>th</sup> Street, Brooklyn, NY</b>		

<b>Consultants:</b> Hydro Tech Environmental Eng & Geol DPC Tarek Z. Khouri P.E. Mairio Pineda /Paul I. Matli	<b>Safety Officer:</b> Not available at this time Frank Gagliardi
<b>General Contractor:</b> Not applicable at this time	<b>Site Manager/ Supervisor:</b> Frank Gagliardi

<b>Activities:</b> <ul style="list-style-type: none"><li>- Installation of SVE well EW-8 using Geoprobe machine equipped with Auger equipment</li><li>- Contain soil cuttings from drilling with augers in 55-gallon drum</li></ul>
---

<b>Working In Grid #:</b>
---------------------------

<b>Samples Collected (Since Last Report): None</b>
--

<b>Air Monitoring (Since Last Report):</b>  <b>PID:</b> 0.1 ppm  Pre-start Condition: 0.053 mg/m <sup>3</sup> Highest Condition: 0.096 mg/m <sup>3</sup>
---

<b>Problems Encountered:</b> No problems encountered
---

<b>Planned Activities for the Next Day/ Week:</b> Continue drilling SVE wells Installing vacuum test ports
--

Example:

Facility # Name/ Location Type of Waste Solid <u>Or</u> Liquid										
(Trucks, Cu.Yds. <u>Or</u> Gallons)	Trucks	Cu. Yds.	Trucks	Cu. Yds.	Trucks	Cu. Yds.	Trucks	Cu. Yds.	Trucks	Cu. Yds.
Today										
Total										

Imported Backfill/ Facility	(Cu. Yds.)		(Cu. Yds.)		(Cu. Yds.)		(Cu. Yds.)		(Cu. Yds.)	
Today										

### Site Map

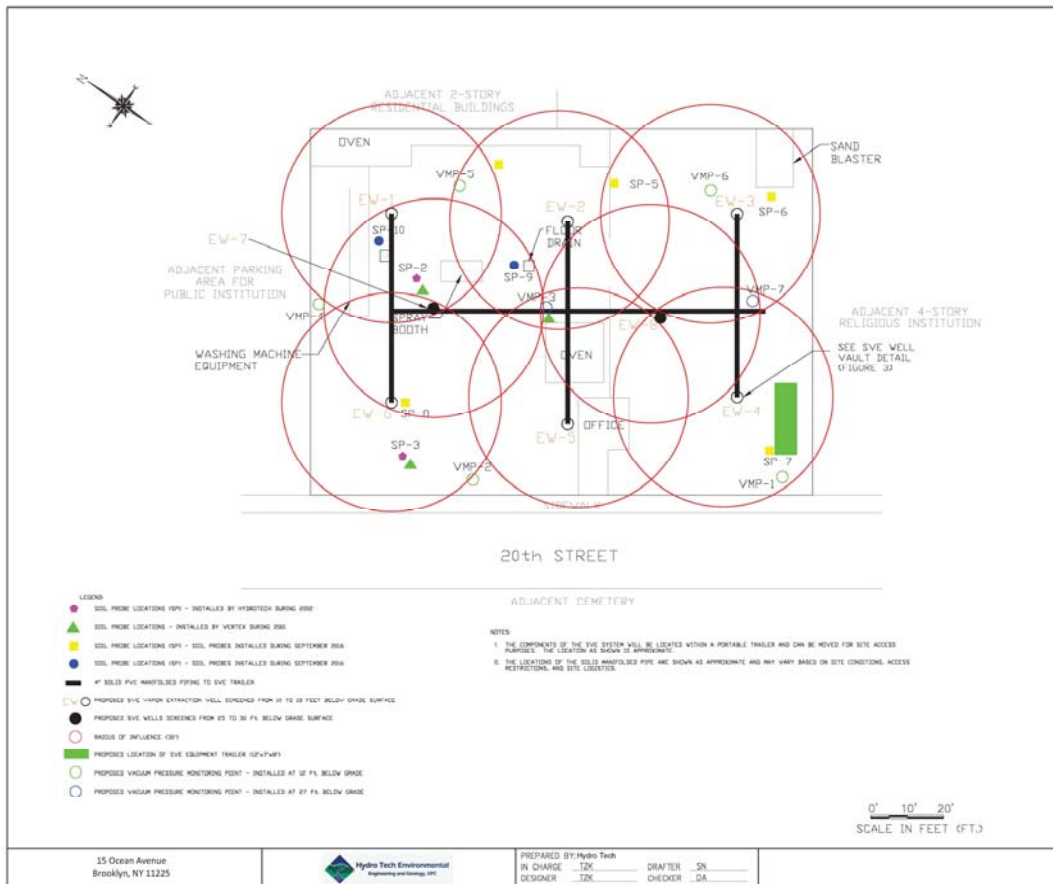

27 December 2017

SIGNATURE \_\_\_\_\_ DATE \_\_\_\_\_

CONTRACT NO. 844

471-400 20th Street, Brooklyn, NY

**PROPOSED SVE EQUIPMENT/WELL LOCATIONS**

DRG. NO.	SCALE	DATE	SHEET
2	3/32"=1'-0"	DECEMBER 2017	2 OF 4

15 Ocean Avenue  
Brooklyn, NY 11225



PREPARED BY: Hydro Tech  
IN CHARGE: TKZ DRAFTER: SN  
DESIGNER: TKZ CHECKER: DA

**Photo Log**

SVE well installation



Drums containing soil cuttings





Example:

Facility # Name/ Location Type of Waste Solid <u>Or</u> Liquid										
(Trucks, Cu.Yds. <u>Or</u> Gallons)	Trucks	Cu. Yds.	Trucks	Cu. Yds.	Trucks	Cu. Yds.	Trucks	Cu. Yds.	Trucks	Cu. Yds.
Today										
Total										

Imported Backfill/ Facility	(Cu. Yds.)		(Cu. Yds.)		(Cu. Yds.)		(Cu. Yds.)		(Cu. Yds.)	
Today										

### Site Map

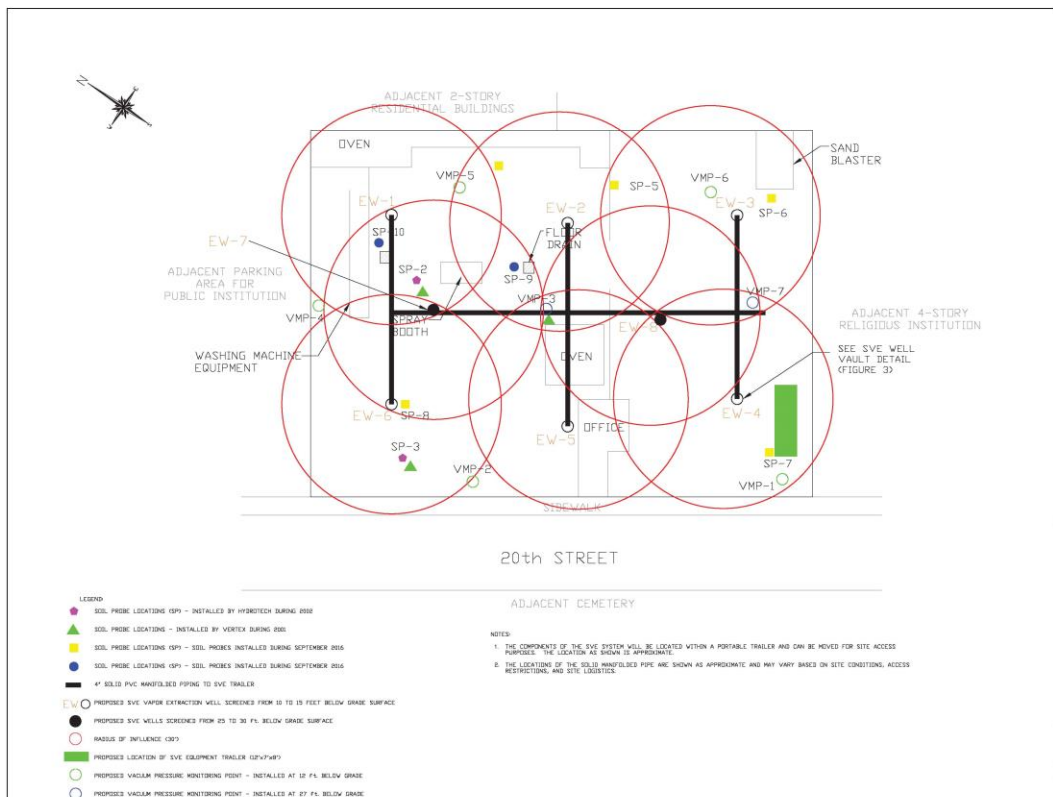

27 December 2017

SIGNATURE \_\_\_\_\_ DATE \_\_\_\_\_

CONTRACT NO. 844

471-488 20th Street, Brooklyn, NY

PROPOSED SVE EQUIPMENT/WELL LOCATIONS

DWG. NO. 2	SCALE 3/32"=1'-0"	DATE DECEMBER 2017	SHEET 2 OF 4
------------	-------------------	--------------------	--------------

Photo Log

Vacuum test port installation



Finished manhole cover of installed vacuum test port

