

# DAILY FIELD REPORT – Day 01

# LANGAN

<b>CLIENT:</b> NYM 145 Wolcott, LLC		<b>DATE:</b> Tuesday, April 01, 2025	
<b>PROJECT No.:</b> 170562203		<b>WEATHER:</b> Sunny, 45-52°F Wind: NW @ 16-22 mph	
<b>PROJECT:</b> 145-165 Wolcott Street		<b>TIME:</b> 11:00 – 2:30 (3.5 hours)	
<b>LOCATION:</b> Brooklyn, New York		<b>BCP SITE ID:</b> C224256	
<b>EQUIPMENT:</b> Trimble DA2 GPS Unit		<b>PRESENT AT SITE:</b> <b>Langan:</b> Olivia O'Donnell <b>Clean Earth, Inc. (Clean Earth):</b> Kelly Sanger	
<b>OBSERVATIONS, DISCUSSIONS, TEST RESULTS, ETC.:</b> <p>Langan was on-site to oversee Clean Earth performing supplemental waste characterization sampling at the New York Department of Environmental Conservation Brownfield Cleanup Program (BCP) Site No. C224256.</p> <p><b>Site Activities</b></p> <ul style="list-style-type: none"> <li>Langan used a Trimble DA2 global positioning unit (GPS) to locate and mark out proposed boring locations for the supplemental waste characterization sampling.</li> </ul> <p><b>Import and Export Tracking</b></p> <ul style="list-style-type: none"> <li>No material was exported from the site.</li> <li>No material was imported to the site.</li> </ul> <p><b>Sampling</b></p> <ul style="list-style-type: none"> <li>No samples were collected.</li> </ul> <p><b>Community Air Monitoring</b></p> <ul style="list-style-type: none"> <li>Ground-intrusive work was not performed; therefore, community air monitoring was not performed.</li> </ul> <p><b>Material Tracking</b></p> <ul style="list-style-type: none"> <li>No investigation-derived waste was generated.</li> </ul> <p><b>Anticipated Activities</b></p> <ul style="list-style-type: none"> <li>Clean Earth and Eastern will advance soil borings and collect soil samples across the site under Langan oversight.</li> </ul>			
<b>Cc:</b> M. Burke, G. Nicholls, S. Knoop, N. Palumbo, L. Grose		<b>By:</b> Olivia O'Donnell <b>Langan Eng, Env, Surv, L.A. &amp; Geo, DPC</b>	

## DAILY FIELD REPORT

### Site Photographs:



**Photo 1:** Proposed supplemental waste characterization boring WC02C in the eastern part of the site (facing southeast)

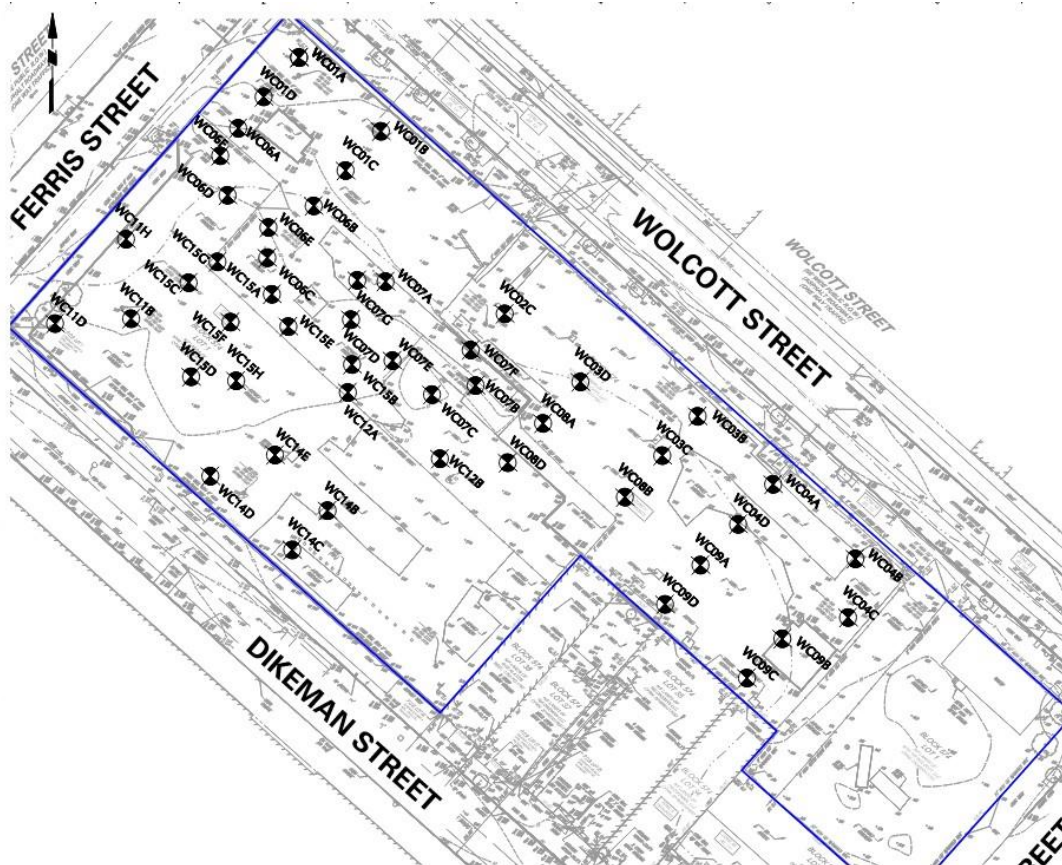

**Photo 2:** Western part of the site (facing south)

Cc:	M. Burke, G. Nicholls, S. Knoop, N. Palumbo, L. Grose	By:	Olivia O'Donnell <b>Langan Eng, Env, Surv, L.A. &amp; Geo, DPC</b>
-----	---	-----	---

## DAILY FIELD REPORT

### Site Map:



### Legend:

	BCP Site Boundary		Proposed Supplemental Waste Characterization Soil Boring
	Upwind CAMP Station		Soil Boring Complete
	Downwind CAMP Station		IDW Drum Staging Area
	Wind Direction		

### Notes:

- Base map referenced from September 22, 2023, ALTA Survey prepared by Boro Land Surveying, P.C.

Cc:	M. Burke, G. Nicholls, S. Knoop, N. Palumbo, L. Grose	By:	Olivia O'Donnell
			<b>Langan Eng, Env, Surv, L.A. &amp; Geo, DPC</b>