

LANGAN SITE OBSERVATION REPORT- Day 145

PROJECT No.: 170452203	CLIENT: NYM 145 Wolcott, LLC 233 Broadway, 10 th Fl., New York, NY 10279	DATE: Mon., March 30, 2026
PROJECT: 145-165 Wolcott Street		WEATHER: Partly Cloudy, 46 - 69 °F Wind: SSE @ 0.5 – 7.0 mph
LOCATION: Brooklyn, New York		TIME: 6:45 am – 6:00 pm
SITE CODE: C224256		MONITOR: Brayden Klein

EQUIPMENT: AQS1 Air Monitoring Station x 2 MiniRAE 3000 Photoionization Detector (PID) CAT 335F x 2 Zaxis 135US Hyundai HL955A Bauer BG 36 H ABI TM22 RTG RG 27S Hitachi 670 Takeuchi TB260 Terex TA9 TB260 Geoprobe 7822DT Kubota KX080-4α2 BW120 AD	PRESENT AT SITE: Langan (Environmental): Brayden Klein Urban Atelier Group (UAG) ECD NY Inc. (ECD): Kyle McGovern
---	--

OBSERVATIONS, DISCUSSIONS, TEST RESULTS, ETC.:

Langan was present to document remediation activities in accordance with the New York State Department of Environmental Conservation (NYSDEC)-approved July 22, 2025 Remedial Action Work Plan (RAWP) at the 145-165 Wolcott Street site in Brooklyn, New York (Site No. C224256).

Site Activities

- ECD used a CAT 335F to excavate the following areas:
 - An about 150-foot-long by 5-foot-wide area to 5 feet below grade surface (bgs) for soil vapor extraction (SVE) system installation in the northeastern part of the site.
 - An about 60-foot-long by 5-foot-wide area to 5 feet bgs for SVE system installation in the northern part of the site.
 - Excavated non-native fill was stockpiled in the center of the site.
 - Excavated non-native fill was screened for odors, staining, and organic vapors using a PID. No impacts were observed.
- ECD used a Kubota KX080-4α2 to backfill an about 12-inch-thick layer of ¾-inch virgin stone (gas permeable aggregate) within an about 40 foot-long by 15-foot-wide area as part of the SVE system within the eastern part of the site.

Cc: M. Burke, G. Nicholls, S. Knoop, N. Palumbo, L. Grose	By: Brayden Klein
Langan Eng, Env, Surv, L.A. & Geo, DPC	

LANGAN SITE OBSERVATION REPORT- Day 145

- ECD used a Kubota KX080-4α2 to backfill an about 12-inch-thick layer of ¾-inch virgin stone (gas permeable aggregate) within an about 10 foot-long by 10-feet-wide area as part of the sub-slab depressurization system (SSDS) within the western part of the site.
- ECD installed geotextile fabric within an about 25-foot-long by 15-feet-wide area and used a Kubota KX080-4α2 to backfill an about 12-inch-thick layer of ¾-inch virgin stone (gas permeable aggregate) as part of the SSDS within the southern part of the site.
- ECD used a CAT 335F to backfill an about 50 foot-long by 10-feet-wide area from 6 feet bgs to about 4 feet bgs with previously imported clean fill in the central part of the site.
- ECD installed 35 feet of 4-inch-diameter polyvinyl chloride (PVC) piping as part of the SSDS in the southern part of the site.
- ECD poured an about 3-inch-thick rat slab within an about 115-foot-long by 60-feet-wide area within the northern part of the site.
- ECD installed Preprufe 300R Plus waterproofing/vapor barrier membrane atop the rat slab in the southeastern part of the site.

Material Tracking

- No material was imported into the site.
- No material was exported from the site.

Material Export Summary – Soil										
Facility Name	Clean Earth of North Jersey									
Location	Kearny, NJ									
Material	Non-Hazardous Low pH Soil		Hazardous Lead Impacted Soil with UHCs		Hazardous Lead Impacted Soil with No UHCs		High Hazardous Lead		Non-Hazardous Soil	
Quantities	No. of Loads	Approx. Volume (CY)	No. of Loads	Approx. Volume (CY)	No. of Loads	Approx. Volume (CY)	No. of Loads	Approx. Volume (CY)	No. of Loads	Approx. Volume (CY)
Today	-	-	-	-	-	-	-	-	-	-
Project Total	332	5,495	56	901	27	467	5	68	1	18

Notes:

1. UHC – Underlying Hazardous Constituent

Material Export Summary – Soil						
Facility Name	Clean Earth of New Castle		Conestoga Landfill		Waste Management	
Location	New Castle, DE		Morgantown, PA		Morgantown, PA	
Material	Non-Hazardous Soil		Non-Hazardous Soil		Non-Hazardous Soil	
Quantities	No. of Loads	Approx. Volume (CY)	No. of Loads	Approx. Volume (CY)	No. of Loads	Approx. Volume (CY)
Today	-	-	-	-	-	-
Project Total	729	13,682	39	703	224	4,007

Cc: M. Burke, G. Nicholls, S. Knoop,
N. Palumbo, L. Grose

By: Brayden Klein

Langan Eng, Env, Surv, L.A. & Geo, DPC

Material Export Summary – C&D						
Facility Name	PPark NJ, LLC		Bayshore Soil Management, LLC		Silva Recycling, LLC	
Location	Prospect Park, NJ		Keasbey, NJ		Newark, NJ	
Material	Asphalt, Concrete		Asphalt, Concrete		Concrete	
Quantities	No. of Loads	Approx. Volume (CY)	No. of Loads	Approx. Volume (CY)	No. of Loads	Approx. Volume (CY)
Today	-	-	-	-	-	-
Project Total	119	2,380	31	645	25	880

Material Import Summary										
Facility Name	Impact Materials, LLC		Callahan & Nannini Quarry Inc.		Durante Brothers Construction		Tilcon West Nyack Quarry		B.G.L.J Servicing Corp	
Location	Jersey City, NJ		Salisbury Mills, NY		Flushing, NY		West Nyack, NY		Moriches, NY	
Material	3/4" Recycled Clean Stone		2-4" Granite Stone		Clean Fill		ASTM No. 5 Stone		Virgin Sand	
Quantities	No. of Loads	Approx. Volume (CY)	No. of Loads	Approx. Volume (CY)	No. of Loads	Approx. Volume (CY)	No. of Loads	Approx. Volume (CY)	No. of Loads	Approx. Volume (CY)
Today	-	-	-	-	-	-	-	-	-	-
Project Total	62	1,240	4	100	228	4,088	44	792	1	18

Samples

- No samples were collected.

Community Air Monitoring Plan (CAMP) Activities

- Langan performed community air monitoring at the perimeter of the work area at one upwind and one downwind location during intrusive work. Implementation of the Community Air Monitoring Plan (CAMP) included air monitoring for particulate matter for particulates less than 10 µm in diameter (PM10) and volatile organic compounds (VOC). PM10 and VOC concentrations did not exceed the action levels established by the community air monitoring plan.
- No fugitive dust or odors associated with site activities were observed migrating from the site.

Anticipated Activities

- ECD will continue excavating and backfilling for utility piping in the northern part of the site.
- ECD will continue foundation framing/concrete pouring in the central part of the site.
- ECD will continue laying PVC piping, geotextile fabric, and ¾-inch virgin stone as part of the SSDS and SVE system installation in the western part of the site.

Cc: M. Burke, G. Nicholls, S. Knoop,
N. Palumbo, L. Grose

By: Brayden Klein

Langan Eng, Env, Surv, L.A. & Geo, DPC

Figure 1: Site Map

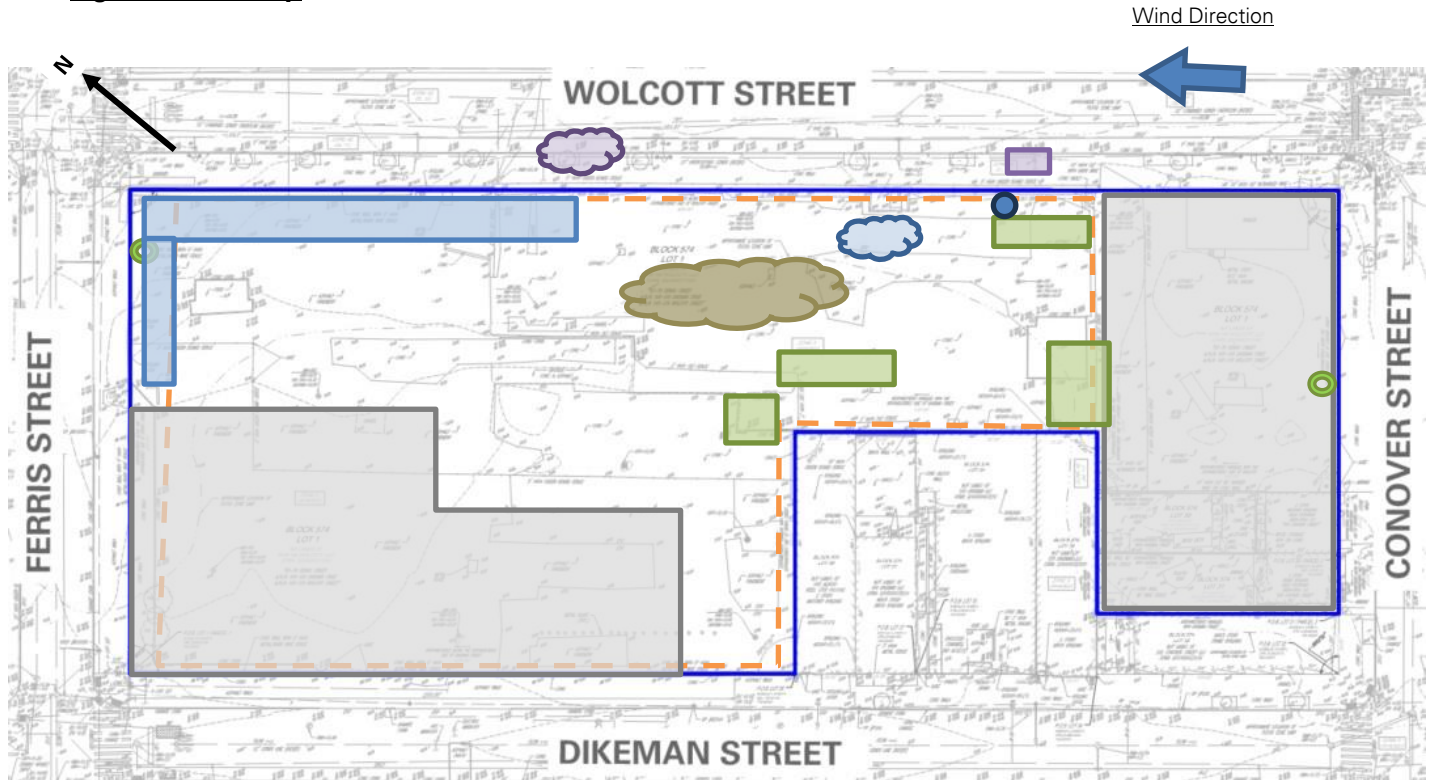

Legend

	Site Boundary-		Approximate Area Excavated
	Approximate Work Area		Approximate Area Backfilled
	Approximate Location of Perimeter CAMP Station		Approximate Area Graded
	Approximate Location of Installed Site Cover System		Approximate C&D Stockpile
	Approximate IDW Drum Staging Area		Approximate Non-Native Fill Stockpile
	Approximate Metal Structure Location		Approximate Stone Stockpile
			Approximate imported clean fill Stockpile

Notes:

1. Basemap is referenced from 26 March 2025 ALTA/NSPS Land Title Survey prepared by Control Point Associates Inc PC.
2. IDW – Investigation-derived waste generated during the April 2025 and August 2025 supplemental waste characterizations and the January through May 2025 non-aqueous phase liquid gauging.

Cc: M. Burke, G. Nicholls, S. Knoop,
N. Palumbo, L. Grose

By: Brayden Klein

Langan Eng, Env, Surv, L.A. & Geo, DPC

Figure 2: Endpoint / Sidewalk Sample Location Map

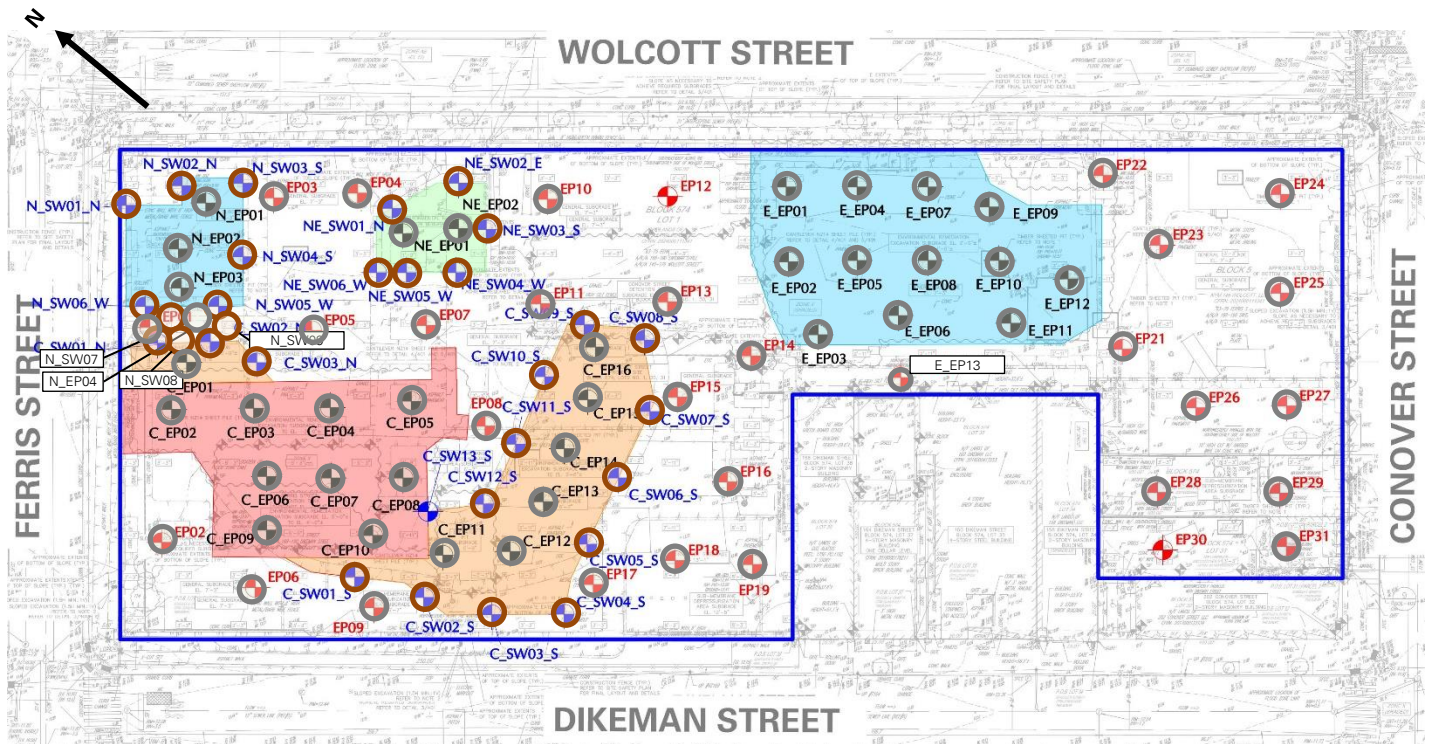

Legend

- Site Boundary
- Approximate Location of Documentation Endpoint Soil Sample Collected
- Approximate Location of Documentation Sidewalk Soil Sample Collected
- Approximate Location of Previously Collected Documentation Endpoint Soil Sample
- Approximate Location of Previously Collected Documentation Sidewalk Soil Sample

Notes:

1. Basemap is referenced from 26 March 2025 ALTA/NSPS Land Title Survey prepared by Control Point Associates Inc PC.

Cc: M. Burke, G. Nicholls, S. Knoop,
N. Palumbo, L. Grose

By: Brayden Klein
Langan Eng, Env, Surv, L.A. & Geo, DPC

LANGAN SITE OBSERVATION REPORT- Day 145

Photographs

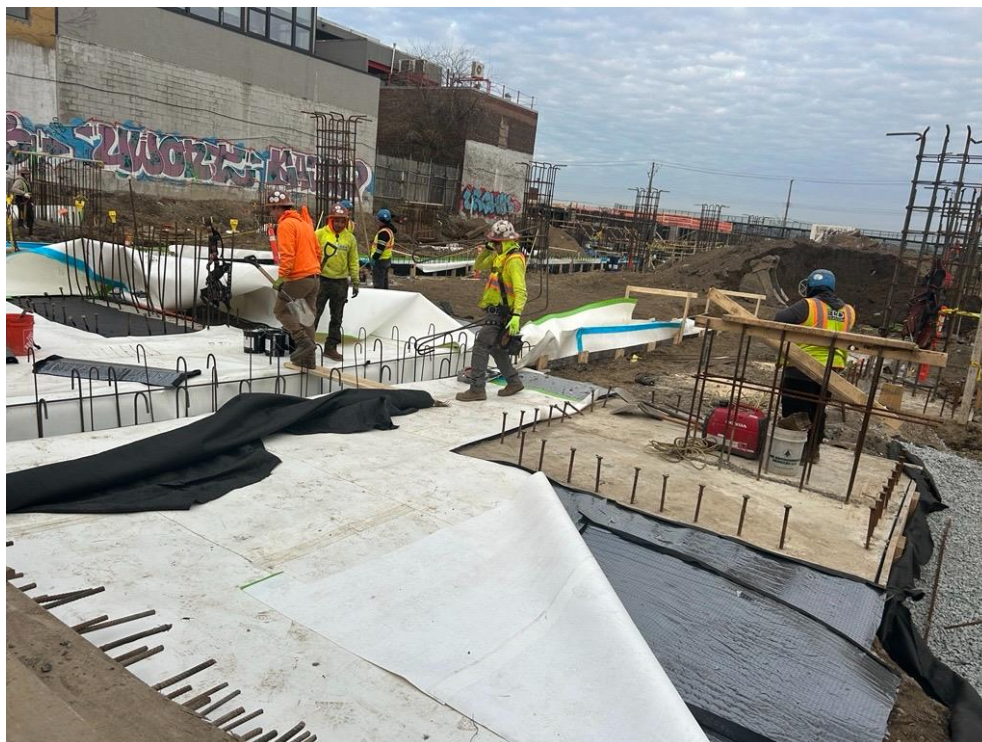

Photo 1: ECD installing Preprufe 300R Plus waterproofing / vapor barrier atop the rat slab in the southern part of the site (facing west)



Photo 2: ECD pouring a 3-inch-thick rat slab in the northern part of the site (facing southwest)

Cc: M. Burke, G. Nicholls, S. Knoop,
N. Palumbo, L. Grose

By: Brayden Klein
Langan Eng, Env, Surv, L.A. & Geo, DPC



Photo 3: ECD excavating previously imported clean fill for SVE installation in the northern part of the site (facing southeast)



Photo 4: ECD backfilling with $\frac{3}{4}$ -inch virgin stone (gas permeable aggregate) as part of the SSDS in the southern part of the site (facing northwest)

Cc: M. Burke, G. Nicholls, S. Knoop,
N. Palumbo, L. Grose

By: Brayden Klein
Langan Eng, Env, Surv, L.A. & Geo, DPC

LANGAN	Contribution 2 Station 031026 Report	170562203 - 145 Wolcott St	
		Report Period	
		From:	03/30/2026 06:00
		To:	03/30/2026 18:00
		PM10 Action Level:	150 $\mu\text{g}/\text{m}^3$
VOC Action Level:	5 ppm		

Daily Environmental Summary	Temp (°F)	Relative Humidity (%)	Barometer (inHg)	Wind Speed (mph)	Prevailing Wind Direction
03/30/2026	45.5 - 69.3	41.8 - 76.5	30.0 - 30.2	0.5 - 7.0	SSE

Daily Monitoring Summary	PM10 ($\mu\text{g}/\text{m}^3$)	Time	VOC (ppm)	Time
Min Contribution (15 min avg.) - 3/30/2026	-392.3	11:51	-2.9033	16:50
Max Contribution (15 min avg.) - 3/30/2026	560.3	14:27	0.0367	09:21
Daily Avg. Contribution (15 min avg.) - 3/30/2026	10.6	-	-0.0639	-

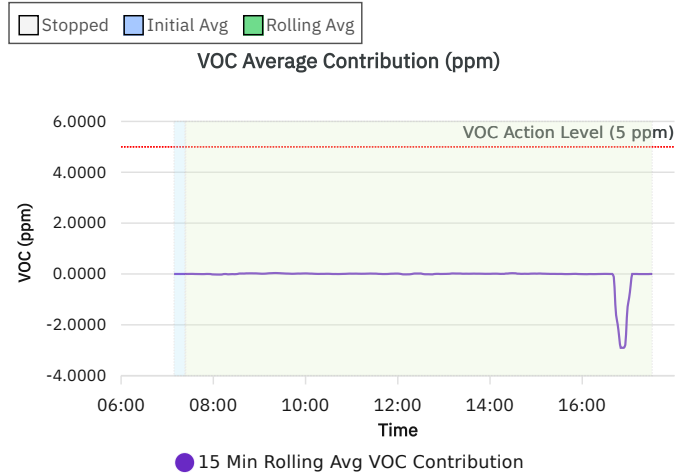
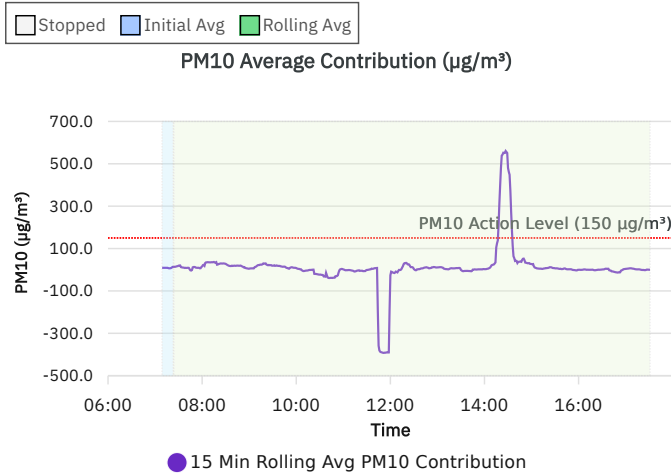
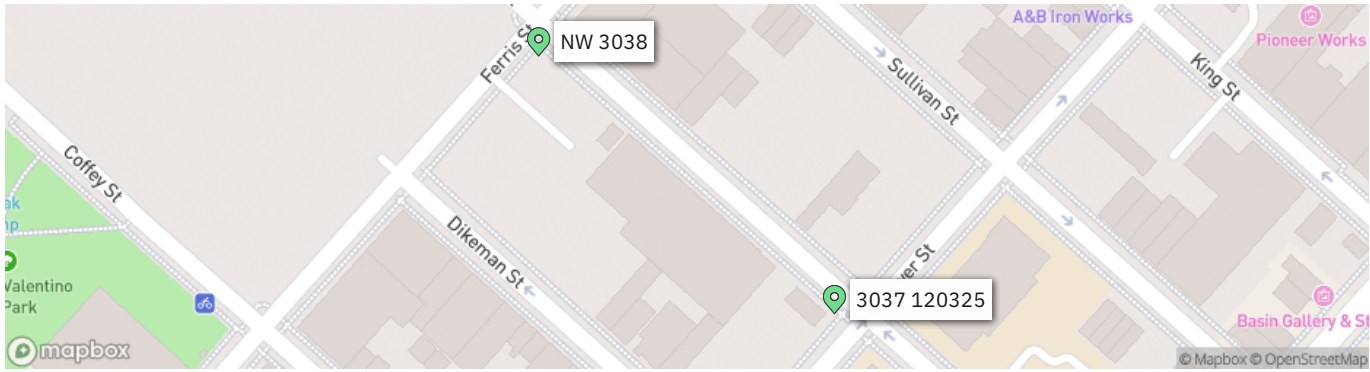

LANGAN SITE OBSERVATION REPORT- Day 146

PROJECT No.: 170452203	CLIENT: NYM 145 Wolcott, LLC 233 Broadway, 10 th Fl., New York, NY 10279	DATE: Tue., March 31, 2026
PROJECT: 145-165 Wolcott Street		WEATHER: Partly Cloudy, 57 - 80 °F Wind: SSE @ 1.1 – 6.9 mph
LOCATION: Brooklyn, New York		TIME: 6:45 am – 6:30 pm
SITE CODE: C224256		MONITOR: Brayden Klein

EQUIPMENT: AQS1 Air Monitoring Station x 2 MiniRAE 3000 Photoionization Detector (PID) CAT 335F x 2 Zaxis 135US Hyundai HL955A Bauer BG 36 H ABI TM22 RTG RG 27S Hitachi 670 Takeuchi TB260 Terex TA9 TB260 Kubota KX080-4α2 BW120 AD	PRESENT AT SITE: Langan (Environmental): Brayden Klein Urban Atelier Group (UAG) ECD NY Inc. (ECD): Kyle McGovern
--	--

OBSERVATIONS, DISCUSSIONS, TEST RESULTS, ETC.:

Langan was present to document remediation activities in accordance with the New York State Department of Environmental Conservation (NYSDEC)-approved July 22, 2025 Remedial Action Work Plan (RAWP) at the 145-165 Wolcott Street site in Brooklyn, New York (Site No. C224256).

Site Activities

- ECD used a CAT 335F to excavate an about 25-foot-long by 10-foot-wide area to about 8 feet below grade surface (bgs) the central part of the site for the installation of utility piping.
 - Excavated non-native fill was stockpiled adjacent to the excavation.
 - Excavated non-native fill was screened for odors, staining, and organic vapors using a PID. No impacts were observed.
- ECD installed geotextile fabric within an about 65-foot-long by 15-foot-wide area and an about 120-foot-long by 15-foot-wide area and used a Takeuchi TB260 to backfill an about 12-inch-thick layer of ¾-inch virgin stone (gas permeable aggregate) as part of the soil vapor extraction (SVE) system within the northern part of the site.
- ECD installed 175 feet of 4-inch-diameter polyvinyl chloride (PVC) piping as part of the SVE in the northern part of the site.
- ECD used a CAT 335F to backfill an about 120-foot-long by 7-foot-wide area from 4 feet bgs to grade with previously imported clean fill in the central part of the site.

Cc: M. Burke, G. Nicholls, S. Knoop, N. Palumbo, L. Grose	By: Brayden Klein
Langan Eng, Env, Surv, L.A. & Geo, DPC	

LANGAN SITE OBSERVATION REPORT- Day 146

- ECD poured an about 12-inch-thick concrete slab within an about 115-foot-long by 20-foot-wide area within the southern part of the site.
- ECD installed Preprufe 300R Plus waterproofing/vapor barrier membrane atop the rat slab in the northern part of the site.

Material Tracking

- ECD imported the following material:
 - 2 loads (approximately 36 cubic yards) of ASTM No. 5 Stone were imported from Tilcon West Nyack Quarry in West Nyack, NY.
- No material was exported from the site.

Material Export Summary – Soil										
Facility Name Location	Clean Earth of North Jersey Kearny, NJ									
Material	Non-Hazardous Low pH Soil		Hazardous Lead Impacted Soil with UHCs		Hazardous Lead Impacted Soil with No UHCs		High Hazardous Lead		Non-Hazardous Soil	
Quantities	No. of Loads	Approx. Volume (CY)	No. of Loads	Approx. Volume (CY)	No. of Loads	Approx. Volume (CY)	No. of Loads	Approx. Volume (CY)	No. of Loads	Approx. Volume (CY)
Today	-	-	-	-	-	-	-	-	-	-
Project Total	332	5,495	56	901	27	467	5	68	1	18

Notes:

1. UHC – Underlying Hazardous Constituent

Material Export Summary – Soil						
Facility Name Location	Clean Earth of New Castle New Castle, DE		Conestoga Landfill Morgantown, PA		Waste Management Morgantown, PA	
Material	Non-Hazardous Soil		Non-Hazardous Soil		Non-Hazardous Soil	
Quantities	No. of Loads	Approx. Volume (CY)	No. of Loads	Approx. Volume (CY)	No. of Loads	Approx. Volume (CY)
Today	-	-	-	-	-	-
Project Total	729	13,682	39	703	224	4,007

Material Export Summary – C&D						
Facility Name Location	PPark NJ, LLC Prospect Park, NJ		Bayshore Soil Management, LLC Keasbey, NJ		Silva Recycling, LLC Newark, NJ	
Material	Asphalt, Concrete		Asphalt, Concrete		Concrete	
Quantities	No. of Loads	Approx. Volume (CY)	No. of Loads	Approx. Volume (CY)	No. of Loads	Approx. Volume (CY)
Today	-	-	-	-	-	-
Project Total	119	2,380	31	645	25	880

Cc: M. Burke, G. Nicholls, S. Knoop,
N. Palumbo, L. Grose

By: Brayden Klein

Langan Eng, Env, Surv, L.A. & Geo, DPC

Material Import Summary										
Facility Name	Impact Materials, LLC		Callahan & Nannini Quarry Inc.		Durante Brothers Construction		Tilcon West Nyack Quarry		B.G.L.J Servicing Corp	
Location	Jersey City, NJ		Salisbury Mills, NY		Flushing, NY		West Nyack, NY		Moriches, NY	
Material	3/4" Recycled Clean Stone		2-4" Granite Stone		Clean Fill		ASTM No. 5 Stone		Virgin Sand	
Quantities	No. of Loads	Approx. Volume (CY)	No. of Loads	Approx. Volume (CY)	No. of Loads	Approx. Volume (CY)	No. of Loads	Approx. Volume (CY)	No. of Loads	Approx. Volume (CY)
Today	-	-	-	-	-	-	2	36	-	-
Project Total	62	1,240	4	100	228	4,088	46	828	1	18

Samples

- No samples were collected.

Community Air Monitoring Plan (CAMP) Activities

- Langan performed community air monitoring at the perimeter of the work area at one upwind and one downwind location during intrusive work. Implementation of the Community Air Monitoring Plan (CAMP) included air monitoring for particulate matter for particulates less than 10 µm in diameter (PM10) and volatile organic compounds (VOC). VOC concentrations did not exceed the action levels established by the community air monitoring plan.
- PM10 exceeded the 15-minute time-weighted-average (TWA) site contribution action level of 150 micrograms per cubic meter (µg/m³) for 15 minutes from 9:50 to 10:04 AM. The exceedance was attributed to backfilling of ¾-inch virgin stone (gas permeable aggregate) in the northern part of the site as part of the SVE system installation. Work was temporarily suspended until PM10 concentrations returned to below action levels.
- No fugitive dust or odors associated with site activities were observed migrating from the site.

Anticipated Activities

- ECD will continue excavating and backfilling for utility piping in the northern part of the site.
- ECD will continue foundation framing/concrete pouring in the central part of the site.
- ECD will continue laying PVC piping, geotextile fabric, and ¾-inch virgin stone as part of the sub-slab depressurization system and SVE system installation in the western part of the site.

Cc: M. Burke, G. Nicholls, S. Knoop,
N. Palumbo, L. Grose

By: Brayden Klein

Langan Eng, Env, Surv, L.A. & Geo, DPC

Figure 1: Site Map

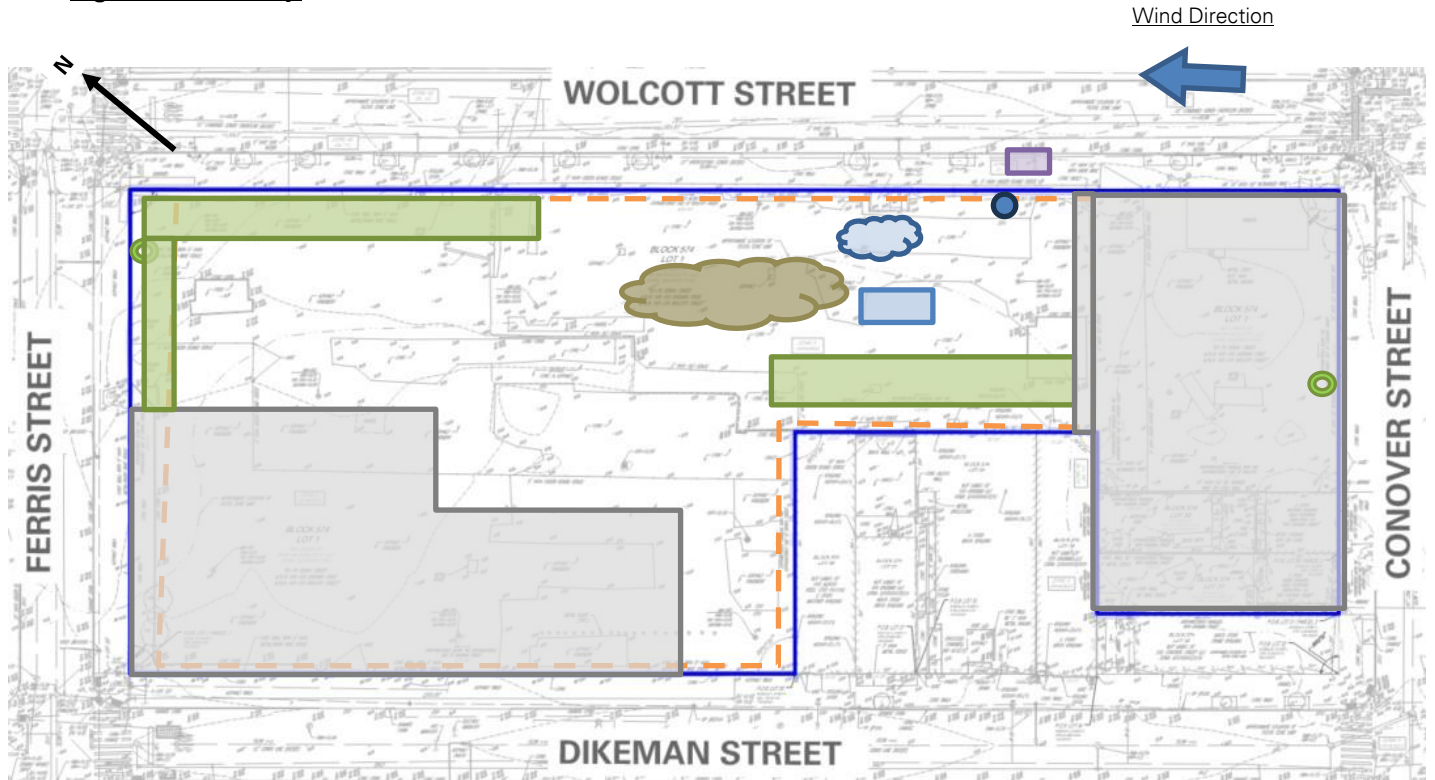

Legend

	Site Boundary-		Approximate Area Excavated
	Approximate Work Area		Approximate Area Backfilled
	Approximate Location of Perimeter CAMP Station		Approximate Area Graded
	Approximate Location of Installed Site Cover System		Approximate C&D Stockpile
	Approximate IDW Drum Staging Area		Approximate Non-Native Fill Stockpile
	Approximate Metal Structure Location		Approximate Stone Stockpile
			Approximate imported clean fill Stockpile

Notes:

1. Basemap is referenced from 26 March 2025 ALTA/NSPS Land Title Survey prepared by Control Point Associates Inc PC.
2. IDW – Investigation-derived waste generated during the April 2025 and August 2025 supplemental waste characterizations and the January through May 2025 non-aqueous phase liquid gauging.

Cc: M. Burke, G. Nicholls, S. Knoop,
N. Palumbo, L. Grose

By: Brayden Klein

Langan Eng, Env, Surv, L.A. & Geo, DPC

Photographs



Photo 1: ECD importing ¾-inch virgin stone in the central part of the site (facing southwest)

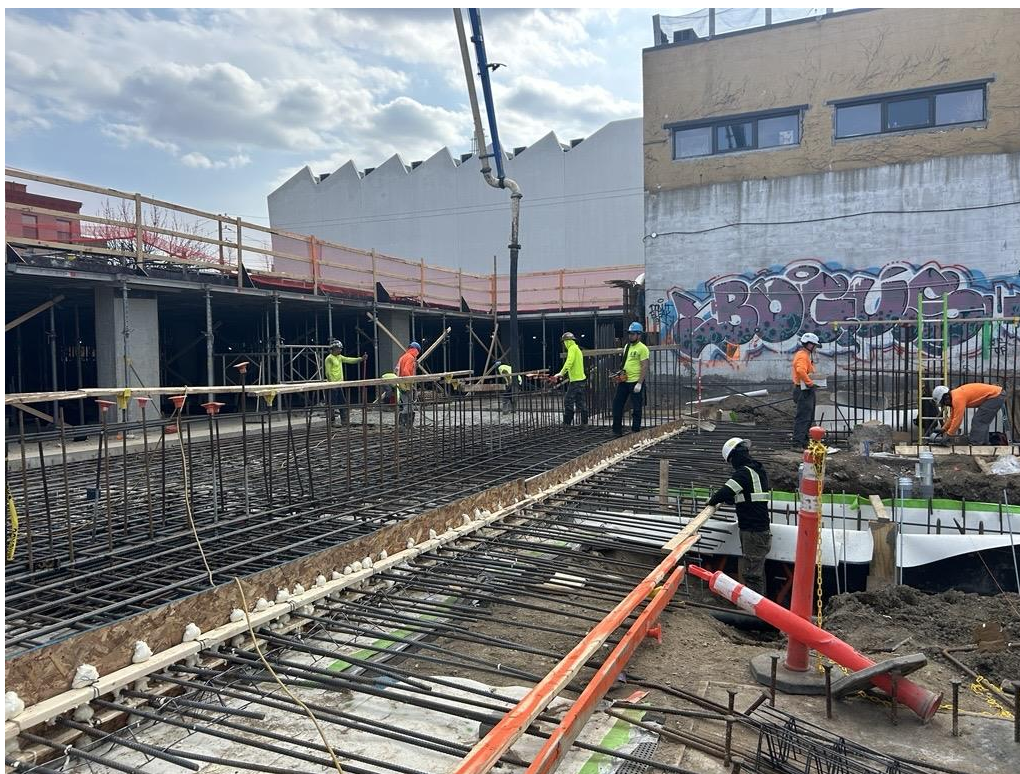

Photo 2: ECD pouring a 12-inch-thick concrete slab in the southern part of the site (facing south)

Cc: M. Burke, G. Nicholls, S. Knoop,
N. Palumbo, L. Grose

By: Brayden Klein
Langan Eng, Env, Surv, L.A. & Geo, DPC



Photo 3: ECD backfilling with $\frac{3}{4}$ -inch virgin stone (gas permeable aggregate) as part of the SVE system in the northern part of the site (facing north)



Photo 4: ECD backfilling with previously imported clean fill atop utility piping in the central part of the site (facing northwest)

Cc: M. Burke, G. Nicholls, S. Knoop,
N. Palumbo, L. Grose

By: Brayden Klein
Langan Eng, Env, Surv, L.A. & Geo, DPC

LANGAN	Contribution 2 Station 031026 Report	170562203 - 145 Wolcott St	
		Report Period	
		From:	03/31/2026 06:00
		To:	03/31/2026 18:00
		PM10 Action Level:	150 µg/m³
VOC Action Level:	5 ppm		

Daily Environmental Summary	Temp (°F)	Relative Humidity (%)	Barometer (inHg)	Wind Speed (mph)	Prevailing Wind Direction
03/31/2026	57.2 - 79.7	42.4 - 71.1	29.8 - 30.0	1.1 - 6.9	SSE

Daily Monitoring Summary	PM10 (µg/m³)	Time	VOC (ppm)	Time
Min Contribution (15 min avg.) - 3/31/2026	-141.0	16:08	-0.8807	12:57
Max Contribution (15 min avg.) - 3/31/2026	328.8	09:56	1.0473	13:12
Daily Avg. Contribution (15 min avg.) - 3/31/2026	17.7	-	0.0684	-

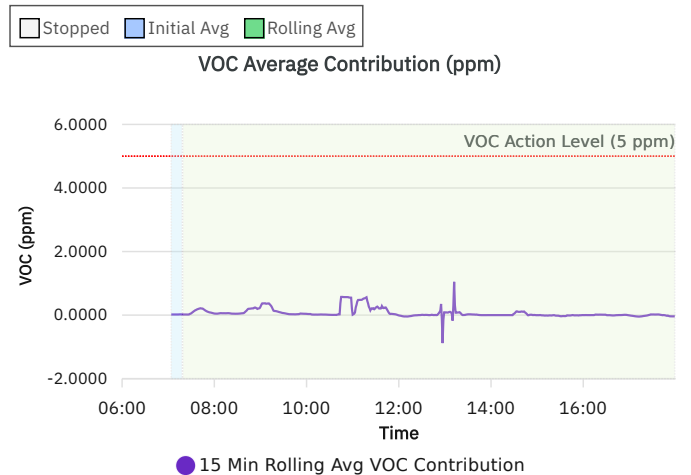
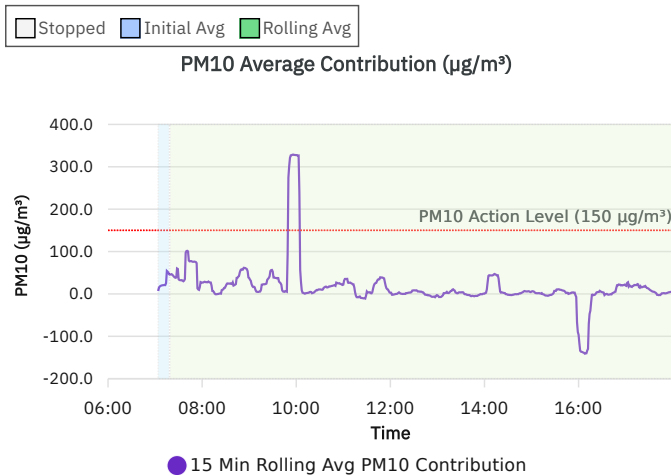
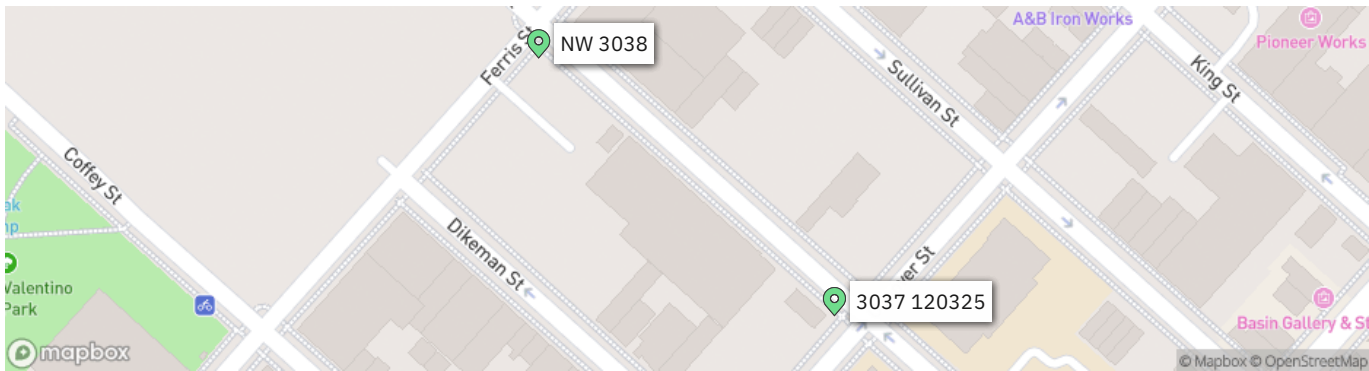

LANGAN SITE OBSERVATION REPORT- Day 147

PROJECT No.: 170452203	CLIENT: NYM 145 Wolcott, LLC 233 Broadway, 10 th Fl., New York, NY 10279	DATE: Wed., April 01, 2026
PROJECT: 145-165 Wolcott Street		WEATHER: Partly Cloudy, 50 - 871 °F Wind: S @ 0.7 – 11.8 mph
LOCATION: Brooklyn, New York		TIME: 6:45 am – 4:30 pm
SITE CODE: C224256		MONITOR: Brayden Klein

EQUIPMENT: AQS1 Air Monitoring Station x 2 MiniRAE 3000 Photoionization Detector (PID) CAT 335F x 2 Zaxis 135US Hyundai HL955A Bauer BG 36 H ABI TM22 RTG RG 27S Hitachi 670 Takeuchi TB260 Terex TA9 TB260 Kubota KX080-4α2 BW120 AD	PRESENT AT SITE: Langan (Environmental): Brayden Klein Urban Atelier Group (UAG) ECD NY Inc. (ECD): Kyle McGovern Arcwood Environmental, LLC (Arcwood)
--	---

OBSERVATIONS, DISCUSSIONS, TEST RESULTS, ETC.:

Langan was present to document remediation activities in accordance with the New York State Department of Environmental Conservation (NYSDEC)-approved July 22, 2025 Remedial Action Work Plan (RAWP) at the 145-165 Wolcott Street site in Brooklyn, New York (Site No. C224256).

Site Activities

- ECD used a CAT 335F to excavate an about 10-foot-long by 10-feet-wide area to about 5 feet below grade surface (bgs) the southeastern part of the site for the removal of the 550-gallon steel tank.
 - Excavated non-native fill was stockpiled adjacent to the excavation and staged on polyethylene sheeting.
 - The 550-gallon steel tank was removed from the excavation and stockpiled on polyethylene sheeting adjacent to the excavation.
 - Excavated non-native fill was screened for odors, staining, and organic vapors using a PID. No impacts were observed.
- ECD used a CAT 335F to excavate an about 30-foot-long by 20-feet-wide area to about 8 feet bgs the central part of the site for the installation of utility piping.
 - Excavated non-native fill was stockpiled adjacent to the excavation.
 - Excavated non-native fill was screened for odors, staining, and organic vapors using a PID. No impacts were observed.

Cc: M. Burke, G. Nicholls, S. Knoop, N. Palumbo, L. Grose	By: Brayden Klein
Langan Eng, Env, Surv, L.A. & Geo, DPC	

LANGAN SITE OBSERVATION REPORT- Day 147

- ECD used a CAT 335F to backfill an about 120-foot-long by 7-foot-wide area from 4 feet bgs to working grade with previously imported clean fill in the central part of the site.
- ECD installed Preprufe 300R Plus waterproofing/vapor barrier membrane atop the rat slab in the northern part of the site.
- ECD used a Kubota KX080-4α2 to backfill an about 12-inch-thick layer of ¾-inch virgin stone (gas permeable aggregate) within an about 30-foot-long by 10-foot-wide area as part of the sub-slab depressurization system (SSDS) within the western part of the site.
- Arcwood used a vacuum to extract about 550 gallons of non-hazardous petroleum-impacted water from the 550-gallon steel tank in the southeastern part of the site.

Material Tracking

- ECD imported the following material:
 - 3 loads (approximately 54 cubic yards) of ASTM No. 5 Stone were imported from Tilcon West Nyack Quarry in West Nyack, NY.
- No material was exported from the site.

Material Export Summary – Soil										
Facility Name Location	Clean Earth of North Jersey Kearny, NJ									
Material	Non-Hazardous Low pH Soil		Hazardous Lead Impacted Soil with UHCs		Hazardous Lead Impacted Soil with No UHCs		High Hazardous Lead		Non-Hazardous Soil	
Quantities	No. of Loads	Approx. Volume (CY)	No. of Loads	Approx. Volume (CY)	No. of Loads	Approx. Volume (CY)	No. of Loads	Approx. Volume (CY)	No. of Loads	Approx. Volume (CY)
Today	-	-	-	-	-	-	-	-	-	-
Project Total	332	5,495	56	901	27	467	5	68	1	18

Notes:

1. UHC – Underlying Hazardous Constituent

Material Export Summary – Soil						
Facility Name Location	Clean Earth of New Castle New Castle, DE		Conestoga Landfill Morgantown, PA		Waste Management Morgantown, PA	
Material	Non-Hazardous Soil		Non-Hazardous Soil		Non-Hazardous Soil	
Quantities	No. of Loads	Approx. Volume (CY)	No. of Loads	Approx. Volume (CY)	No. of Loads	Approx. Volume (CY)
Today	-	-	-	-	-	-
Project Total	729	13,682	39	703	224	4,007

Cc: M. Burke, G. Nicholls, S. Knoop,
N. Palumbo, L. Grose

By: Brayden Klein

Langan Eng, Env, Surv, L.A. & Geo, DPC

Material Export Summary – C&D						
Facility Name	PPark NJ, LLC		Bayshore Soil Management, LLC		Silva Recycling, LLC	
Location	Prospect Park, NJ		Keasbey, NJ		Newark, NJ	
Material	Asphalt, Concrete		Asphalt, Concrete		Concrete	
Quantities	No. of Loads	Approx. Volume (CY)	No. of Loads	Approx. Volume (CY)	No. of Loads	Approx. Volume (CY)
Today	-	-	-	-	-	-
Project Total	119	2,380	31	645	25	880

Material Import Summary										
Facility Name	Impact Materials, LLC		Callahan & Nannini Quarry Inc.		Durante Brothers Construction		Tilcon West Nyack Quarry		B.G.L.J Servicing Corp	
Location	Jersey City, NJ		Salisbury Mills, NY		Flushing, NY		West Nyack, NY		Moriches, NY	
Material	3/4" Recycled Clean Stone		2-4" Granite Stone		Clean Fill		ASTM No. 5 Stone		Virgin Sand	
Quantities	No. of Loads	Approx. Volume (CY)	No. of Loads	Approx. Volume (CY)	No. of Loads	Approx. Volume (CY)	No. of Loads	Approx. Volume (CY)	No. of Loads	Approx. Volume (CY)
Today	-	-	-	-	-	-	3	54	-	-
Project Total	62	1,240	4	100	228	4,088	49	882	1	18

Samples

- Langan collected one base of excavation soil sample (BEP01_EL_2.5) from the southeastern part of the site (plus quality assurance/quality control samples). Langan collected the following:
 - One grab soil sample for laboratory analysis of target compound list and NSYDEC Part 375 volatile organic compounds (VOC) and semivolatile organic compounds (SVOC) (including 1,4-dioxane), pesticides, herbicides, polychlorinated biphenyls, target analyte list metals (including hexavalent and trivalent chromium), total cyanide, and per- and polyfluoroalkyl substances.
- Langan collected three sidewall soil samples (SW01_N_EL_5.0_SW02_E_EL_5.0, SW03_W_EL_5.0) from the southeastern part of the site (plus quality assurance/quality control samples). Langan collected the following:
 - Three grab soil sample for laboratory analysis of Commissioner’s Policy-51 VOCs and SVOCs.
 - Samples will be relinquished to York Analytical Laboratories on 4/2/2026, an Environmental Laboratory Accredited Program-certified laboratory under standard chain-of-custody protocols.

Community Air Monitoring Plan (CAMP) Activities

- Langan performed community air monitoring at the perimeter of the work area at one upwind and three downwind locations during intrusive work. Implementation of the Community Air Monitoring Plan (CAMP) included air monitoring for particulate matter for particulates less than 10 µm in diameter (PM10) and VOCs. PM10 and VOC concentrations did not exceed the action levels established by the community air monitoring plan.
- No fugitive dust or odors associated with site activities were observed migrating from the site.

Anticipated Activities

- ECD will continue excavating and backfilling for utility piping in the northern part of the site.

Cc: M. Burke, G. Nicholls, S. Knoop,
N. Palumbo, L. Grose

By: Brayden Klein

Langan Eng, Env, Surv, L.A. & Geo, DPC

LANGAN SITE OBSERVATION REPORT- Day 147

- ECD will continue foundation framing/concrete pouring in the central part of the site.
- ECD will continue laying polyvinyl chloride piping, geotextile fabric, and ¾-inch virgin stone as part of the SSDS and soil vapor extrusion system installation in the western part of the site.

Cc: M. Burke, G. Nicholls, S. Knoop,
N. Palumbo, L. Grose

By: Brayden Klein

Langan Eng, Env, Surv, L.A. & Geo, DPC

Figure 1: Site Map

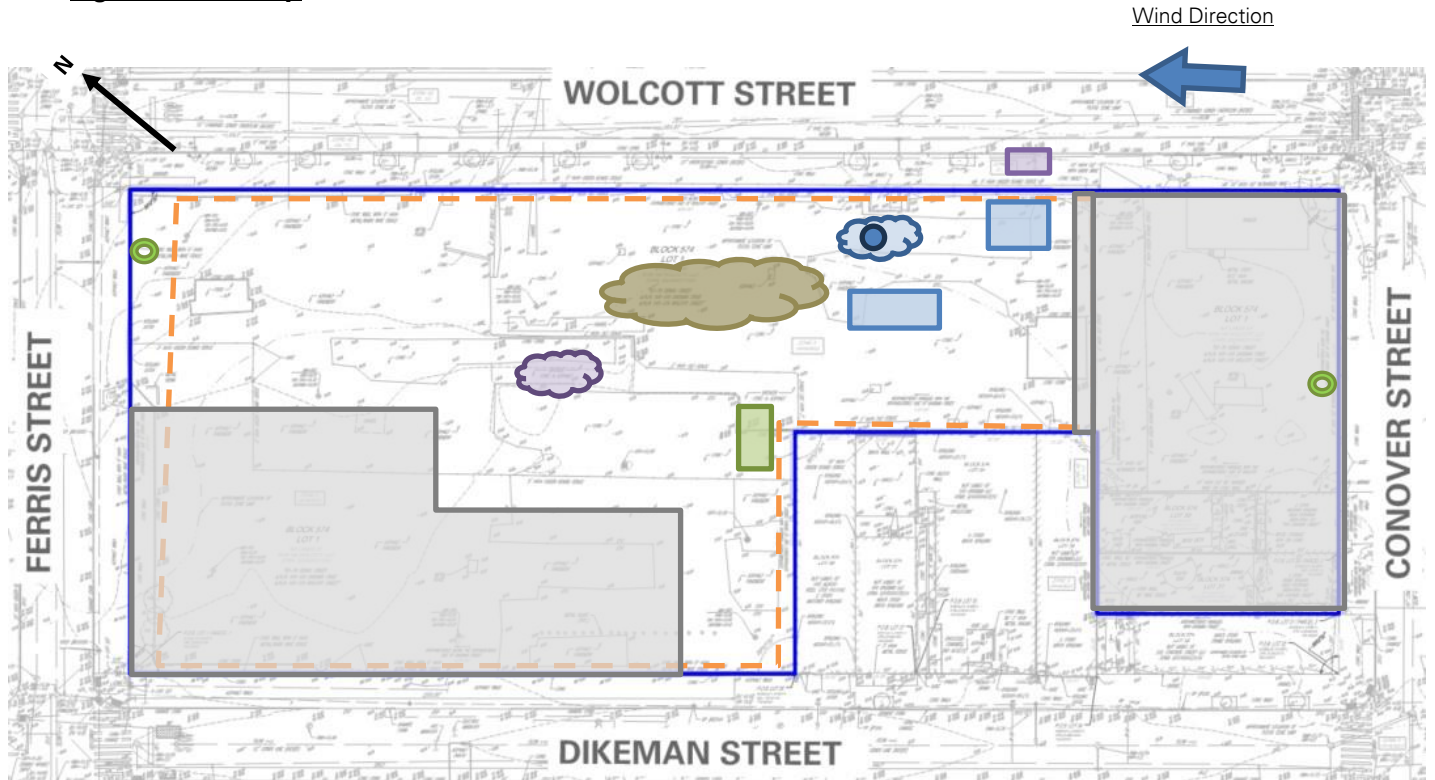

Legend

	Site Boundary-		Approximate Area Excavated
	Approximate Work Area		Approximate Area Backfilled
	Approximate Location of Perimeter CAMP Station		Approximate Area Graded
	Approximate Location of Installed Site Cover System		Approximate C&D Stockpile
	Approximate IDW Drum Staging Area		Approximate Non-Native Fill Stockpile
	Approximate Steel Tank Location		Approximate Stone Stockpile
			Approximate Imported Clean Fill Stockpile

Notes:

1. Basemap is referenced from 26 March 2025 ALTA/NSPS Land Title Survey prepared by Control Point Associates Inc PC.
2. IDW – Investigation-derived waste generated during the April 2025 and August 2025 supplemental waste characterizations and the January through May 2025 non-aqueous phase liquid gauging.

Cc: M. Burke, G. Nicholls, S. Knoop,
N. Palumbo, L. Grose

By: Brayden Klein

Langan Eng, Env, Surv, L.A. & Geo, DPC

Figure 2: Endpoint / Sidewalk Sample Location Map

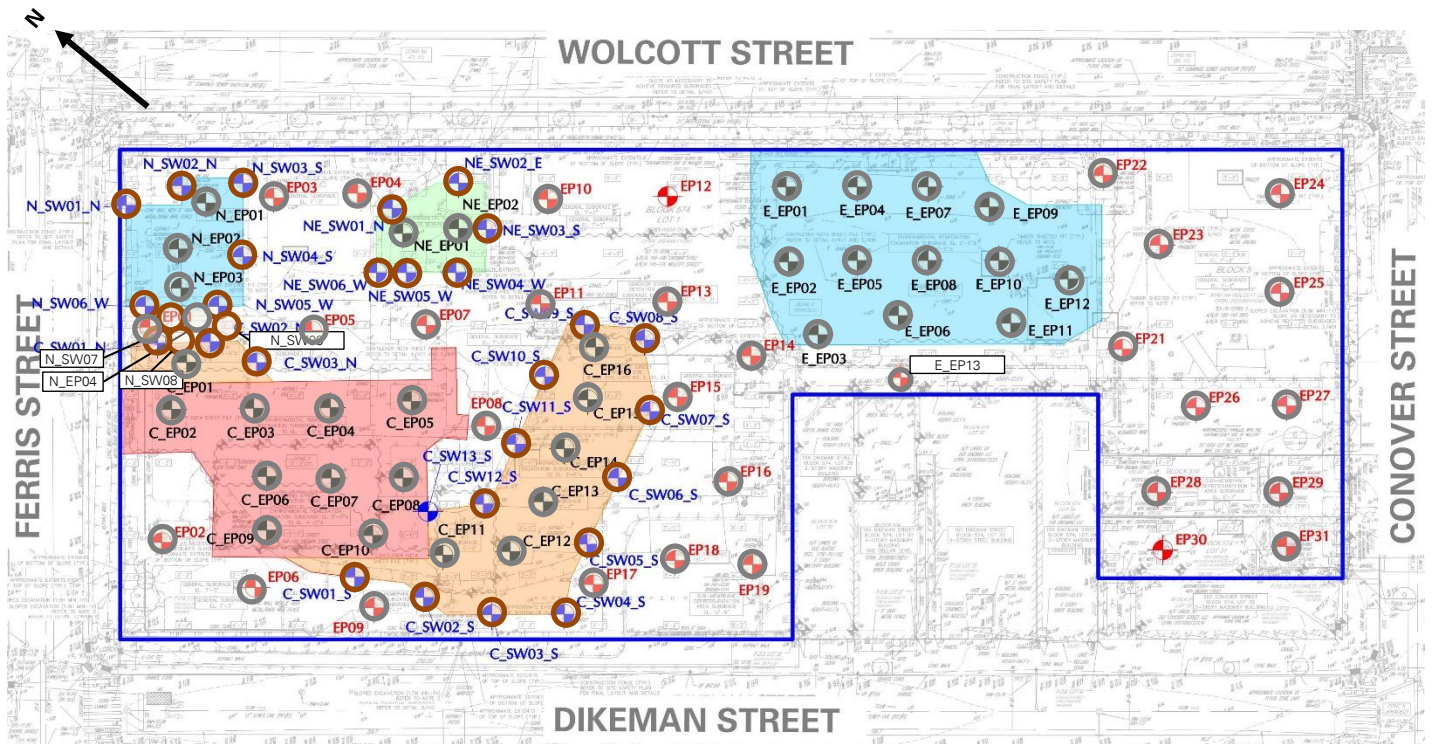

Legend

- Site Boundary
- Approximate Location of Documentation Endpoint Soil Sample Collected
- Approximate Location of Documentation Sidewalk Soil Sample Collected
- Approximate Location of Previously Collected Documentation Endpoint Soil Sample
- Approximate Location of Previously Collected Documentation Sidewalk Soil Sample

Notes:

1. Basemap is referenced from 26 March 2025 ALTA/NSPS Land Title Survey prepared by Control Point Associates Inc PC.

Cc: M. Burke, G. Nicholls, S. Knoop,
N. Palumbo, L. Grose

By: Brayden Klein
Langan Eng, Env, Surv, L.A. & Geo, DPC

LANGAN SITE OBSERVATION REPORT- Day 147

Photographs



Photo 1: ECD importing ¾-inch virgin stone in the central part of the site (facing southeast)



Photo 2: Arcwood extracting the contents of the steel tank for off-site disposal (facing south)

Cc: M. Burke, G. Nicholls, S. Knoop,
N. Palumbo, L. Grose

By: Brayden Klein

Langan Eng, Env, Surv, L.A. & Geo, DPC

LANGAN SITE OBSERVATION REPORT- Day 147



Photo 3: ECD excavating non-native fill beneath the base of the former steel tank in the southeastern part of the site (facing west)



Photo 4: ECD backfilling SVE piping with previously imported ¾-inch stone in the western part of the site (facing east)

Cc: M. Burke, G. Nicholls, S. Knoop,
N. Palumbo, L. Grose

By: Brayden Klein
Langan Eng, Env, Surv, L.A. & Geo, DPC

LANGAN	Contribution 2 Station 031026 Report	170562203 - 145 Wolcott St	
		Report Period	
		From:	04/01/2026 06:00
		To:	04/01/2026 18:00
		PM10 Action Level:	150 $\mu\text{g}/\text{m}^3$
VOC Action Level:	5 ppm		

Daily Environmental Summary	Temp (°F)	Relative Humidity (%)	Barometer (inHg)	Wind Speed (mph)	Prevailing Wind Direction
04/01/2026	60.8 - 83.1	43.9 - 71.0	29.9 - 30.1	0.7 - 11.8	S

Daily Monitoring Summary	PM10 ($\mu\text{g}/\text{m}^3$)	Time	VOC (ppm)	Time
Min Contribution (15 min avg.) - 4/1/2026	-86.9	07:24	-0.6013	09:56
Max Contribution (15 min avg.) - 4/1/2026	79.1	07:04	0.4367	10:11
Daily Avg. Contribution (15 min avg.) - 4/1/2026	-2.9	-	-0.0017	-

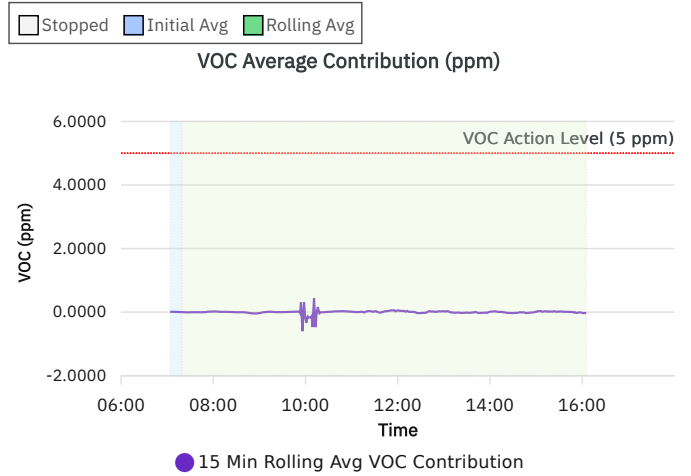
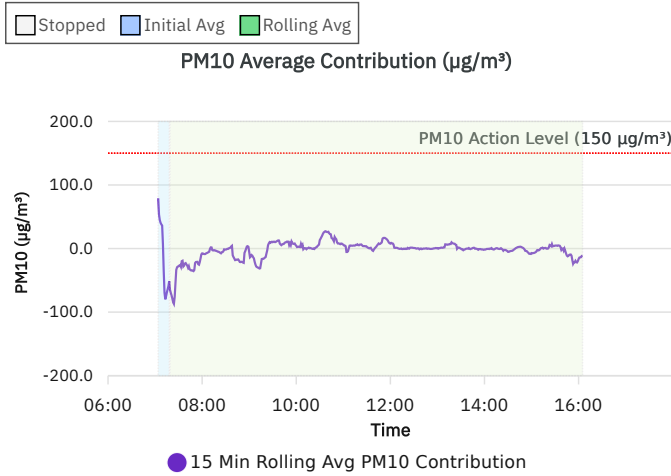
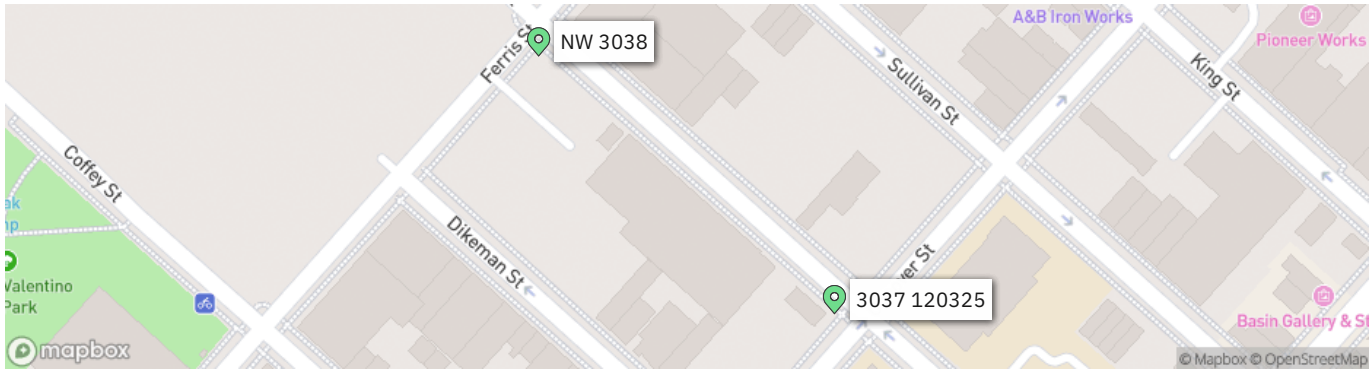

LANGAN SITE OBSERVATION REPORT- Day 148

PROJECT No.: 170452203	CLIENT: NYM 145 Wolcott, LLC 233 Broadway, 10 th Fl., New York, NY 10279	DATE: Thu., April 02, 2026
PROJECT: 145-165 Wolcott Street		WEATHER: Partly Cloudy, 44 - 47°F Wind: SSW @ 1.0 – 4.9 mph
LOCATION: Brooklyn, New York		TIME: 9:45 am – 6:00 pm
SITE CODE: C224256		MONITOR: Alexandra Fitzgerald

EQUIPMENT: AQS1 Air Monitoring Station x 2 MiniRAE 3000 Photoionization Detector (PID) CAT 335F x 2 Zaxis 135US Hyundai HL955A Bauer BG 36 H ABI TM22 RTG RG 27S Hitachi 670 Takeuchi TB260 Terex TA9 TB260 Kubota KX080-4α2 BW120 AD	PRESENT AT SITE: Langan (Environmental): Alexandra Fitzgerald Urban Atelier Group (UAG) ECD NY Inc. (ECD): Kyle McGovern
--	---

OBSERVATIONS, DISCUSSIONS, TEST RESULTS, ETC.:

Langan was present to document remediation activities in accordance with the New York State Department of Environmental Conservation (NYSDEC)-approved July 22, 2025 Remedial Action Work Plan (RAWP) at the 145-165 Wolcott Street site in Brooklyn, New York (Site No. C224256).

Site Activities

- ECD used a Kubota KX080-4α2 to backfill an about 10-foot-long by 10-feet-wide area from about 5 feet below grade surface (bgs) to working grade with previously imported clean fill in the southern part of the site. ECD used a CAT 303E to backfill an about 25-foot-long by 20-feet-wide, an about 20-foot-long by 8-foot-wide, and an about 8-foot-long by 6-feet-wide area from about 5 feet bgs to working grade with previously imported clean fill in the central part of the site.
- ECD used a Kubota KX080-4α2 to backfill an about 12-inch-thick layer of ¾-inch virgin stone (gas permeable aggregate) within an about 30-foot-long by 30-feet-wide area as part of the sub-slab depressurization system (SSDS) within the western part of the site.
- ECD installed 45-feet of 4-inch-diameter polyvinyl chloride (PVC) piping as part of the SSDS in the western part of the site.
- ECD poured an about 12-inch-thick concrete slab within an about 105-foot-long by 60-feet-wide area within the northern part of the site.

Cc: M. Burke, G. Nicholls, S. Knoop, N. Palumbo, L. Grose	By: Alexandra Fitzgerald
Langan Eng, Env, Surv, L.A. & Geo, DPC	

Material Tracking

- No material was imported into the site.
- No material was exported from the site.

Material Export Summary – Soil										
Facility Name Location	Clean Earth of North Jersey Kearny, NJ									
Material	Non-Hazardous Low pH Soil		Hazardous Lead Impacted Soil with UHCs		Hazardous Lead Impacted Soil with No UHCs		High Hazardous Lead		Non-Hazardous Soil	
Quantities	No. of Loads	Approx. Volume (CY)	No. of Loads	Approx. Volume (CY)	No. of Loads	Approx. Volume (CY)	No. of Loads	Approx. Volume (CY)	No. of Loads	Approx. Volume (CY)
Today	-	-	-	-	-	-	-	-	-	-
Project Total	332	5,495	56	901	27	467	5	68	1	18

Notes:

1. UHC – Underlying Hazardous Constituent

Material Export Summary – Soil							
Facility Name Location	Clean Earth of New Castle New Castle, DE		Conestoga Landfill Morgantown, PA		Waste Management Morgantown, PA		
Material	Non-Hazardous Soil		Non-Hazardous Soil		Non-Hazardous Soil		
Quantities	No. of Loads	Approx. Volume (CY)	No. of Loads	Approx. Volume (CY)	No. of Loads	Approx. Volume (CY)	
Today	-	-	-	-	-	-	
Project Total	729	13,682	39	703	224	4,007	

Material Export Summary – C&D						
Facility Name Location	PPark NJ, LLC Prospect Park, NJ		Bayshore Soil Management, LLC Keasbey, NJ		Silva Recycling, LLC Newark, NJ	
Material	Asphalt, Concrete		Asphalt, Concrete		Concrete	
Quantities	No. of Loads	Approx. Volume (CY)	No. of Loads	Approx. Volume (CY)	No. of Loads	Approx. Volume (CY)
Today	-	-	-	-	-	-
Project Total	119	2,380	31	645	25	880

Cc: M. Burke, G. Nicholls, S. Knoop,
N. Palumbo, L. Grose

By: Alexandra Fitzgerald

Langan Eng, Env, Surv, L.A. & Geo, DPC

Material Import Summary										
Facility Name Location	Impact Materials, LLC Jersey City, NJ		Callahan & Nannini Quarry Inc. Salisbury Mills, NY		Durante Brothers Construction Flushing, NY		Tilcon West Nyack Quarry West Nyack, NY		B.G.L.J Servicing Corp Moriches, NY	
Material	3/4" Recycled Clean Stone		2-4" Granite Stone		Clean Fill		ASTM No. 5 Stone		Virgin Sand	
Quantities	No. of Loads	Approx. Volume (CY)	No. of Loads	Approx. Volume (CY)	No. of Loads	Approx. Volume (CY)	No. of Loads	Approx. Volume (CY)	No. of Loads	Approx. Volume (CY)
Today	-	-	-	-	-	-	-	-	-	-
Project Total	62	1,240	4	100	228	4,088	49	882	1	18

Samples

- No samples were collected.

Community Air Monitoring Plan (CAMP) Activities

- Langan performed community air monitoring at the perimeter of the work area at one upwind and three downwind locations during intrusive work. Implementation of the Community Air Monitoring Plan (CAMP) included air monitoring for particulate matter for particulates less than 10 µm in diameter (PM10) and volatile organic compounds (VOC). PM10 and VOC concentrations did not exceed the action levels established by the community air monitoring plan.
- No fugitive dust or odors associated with site activities were observed migrating from the site.

Anticipated Activities

- ECD will continue excavating and backfilling for utility piping in the northern part of the site.
- ECD will continue foundation framing/concrete pouring in the central part of the site.
- ECD will continue laying PVC piping, geotextile fabric, and ¾-inch virgin stone as part of the SSDS and soil vapor extrusion system installation in the western part of the site.

Cc: M. Burke, G. Nicholls, S. Knoop,
N. Palumbo, L. Grose

By: Alexandra Fitzgerald

Langan Eng, Env, Surv, L.A. & Geo, DPC

Figure 1: Site Map

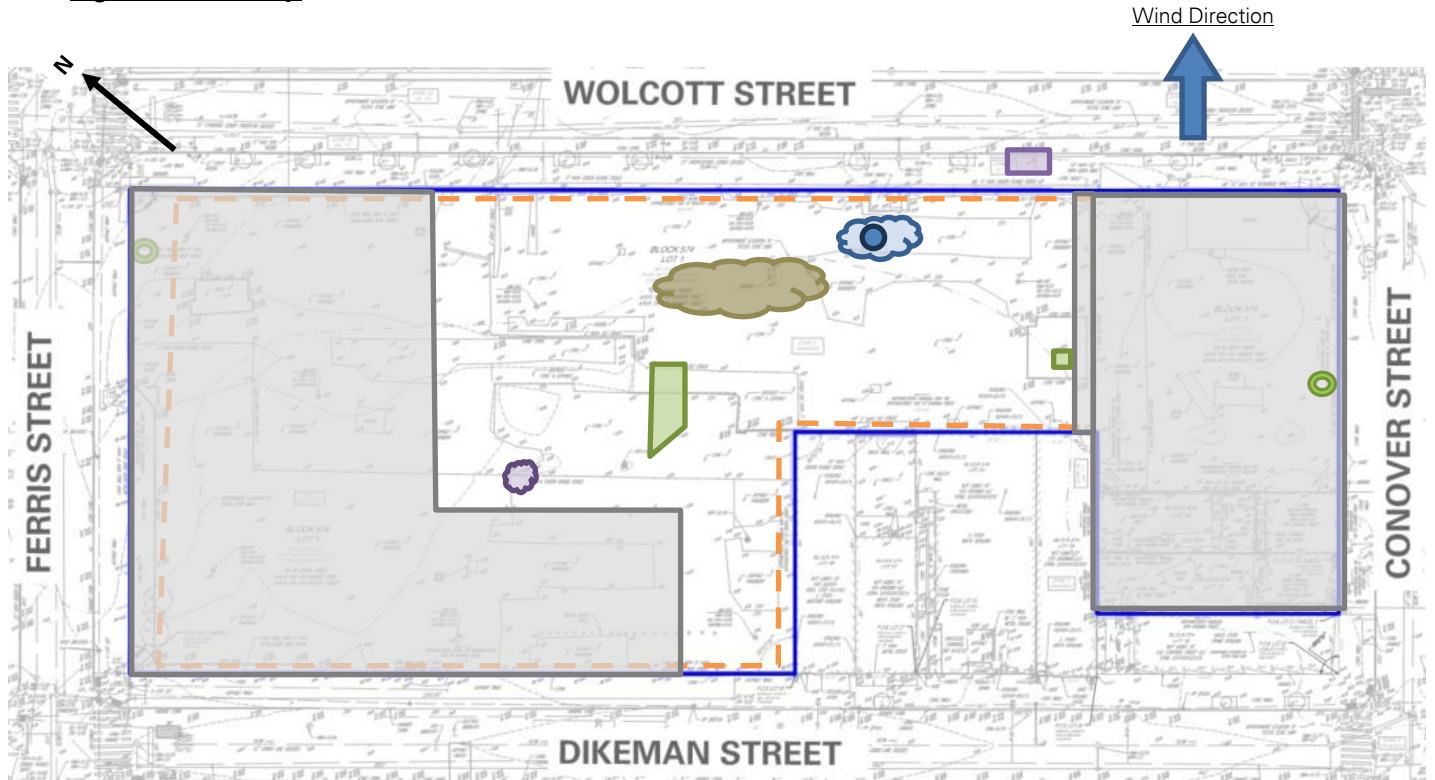

Legend

	Site Boundary-		Approximate Area Excavated
	Approximate Work Area		Approximate Area Backfilled
	Approximate Location of Perimeter CAMP Station		Approximate Area Graded
	Approximate Location of Installed Site Cover System		Approximate C&D Stockpile
	Approximate IDW Drum Staging Area		Approximate Non-Native Fill Stockpile
	Approximate Steel Tank Location		Approximate Stone Stockpile
			Approximate Imported Clean Fill Stockpile

Notes:

1. Basemap is referenced from 26 March 2025 ALTA/NSPS Land Title Survey prepared by Control Point Associates Inc PC.
2. IDW – Investigation-derived waste generated during the April 2025 and August 2025 supplemental waste characterizations and the January through May 2025 non-aqueous phase liquid gauging.

Cc: M. Burke, G. Nicholls, S. Knoop,
N. Palumbo, L. Grose

By: Alexandra Fitzgerald
Langan Eng, Env, Surv, L.A. & Geo, DPC

Figure 2: Endpoint / Sidewalk Sample Location Map

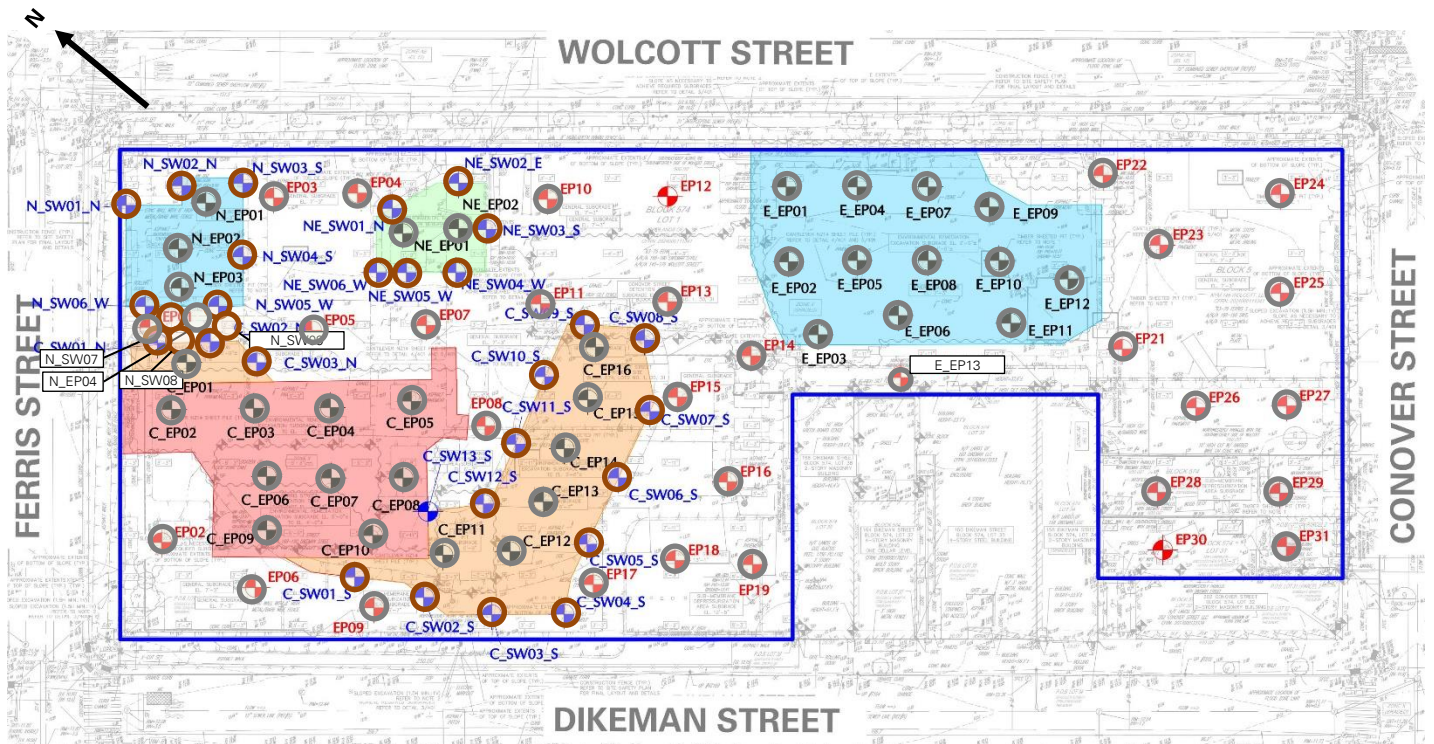

Legend

- Site Boundary
- Approximate Location of Documentation Endpoint Soil Sample Collected
- Approximate Location of Documentation Sidewalk Soil Sample Collected
- Approximate Location of Previously Collected Documentation Endpoint Soil Sample
- Approximate Location of Previously Collected Documentation Sidewalk Soil Sample

Notes:

1. Basemap is referenced from 26 March 2025 ALTA/NSPS Land Title Survey prepared by Control Point Associates Inc PC.

Cc: M. Burke, G. Nicholls, S. Knoop,
N. Palumbo, L. Grose

By: Alexandra Fitzgerald
Langan Eng, Env, Surv, L.A. & Geo, DPC

Photographs



Photo 1: ECD backfilling with previously imported clean fill to surface grade around ConEd utility boxes in the western part of the site (facing north)



Photo 2: ECD installing the SSDS in the western part of the site (facing west)

Cc: M. Burke, G. Nicholls, S. Knoop,
N. Palumbo, L. Grose

By: Alexandra Fitzgerald
Langan Eng, Env, Surv, L.A. & Geo, DPC



Photo 3: ECD backfilling a utility pipe trench with previously imported clean fill in the southern part of the site (facing east)



Photo 4: ECD backfilling SSDS piping with previously imported 3/4-inch stone in the western part of the site (facing north)

Cc: M. Burke, G. Nicholls, S. Knoop,
N. Palumbo, L. Grose

By: Alexandra Fitzgerald
Langan Eng, Env, Surv, L.A. & Geo, DPC

LANGAN	Contribution 2 Station 031026 Report	170562203 - 145 Wolcott St	
		Report Period	
		From:	04/02/2026 06:00
		To:	04/02/2026 18:00
		PM10 Action Level:	150 µg/m³
VOC Action Level:	5 ppm		

Daily Environmental Summary	Temp (°F)	Relative Humidity (%)	Barometer (inHg)	Wind Speed (mph)	Prevailing Wind Direction
04/02/2026	44.1 - 46.9	69.1 - 80.0	30.4 - 30.5	1.0 - 4.9	SSW

Daily Monitoring Summary	PM10 (µg/m³)	Time	VOC (ppm)	Time
Min Contribution (15 min avg.) - 4/2/2026	-17.2	10:34	-0.0320	16:35
Max Contribution (15 min avg.) - 4/2/2026	126.9	16:49	0.0413	13:51
Daily Avg. Contribution (15 min avg.) - 4/2/2026	4.5	-	0.0018	-

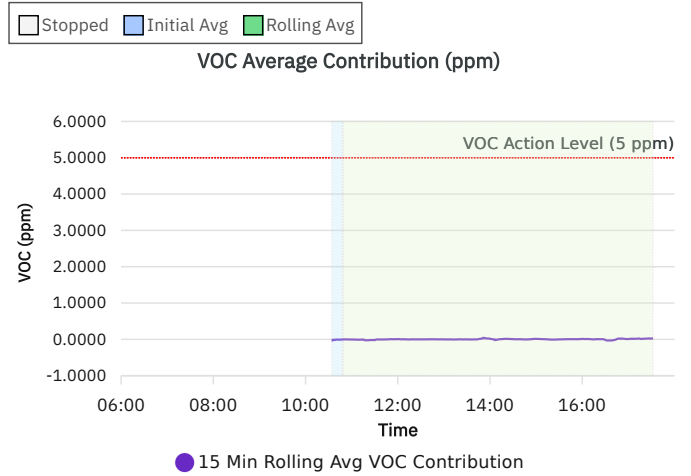
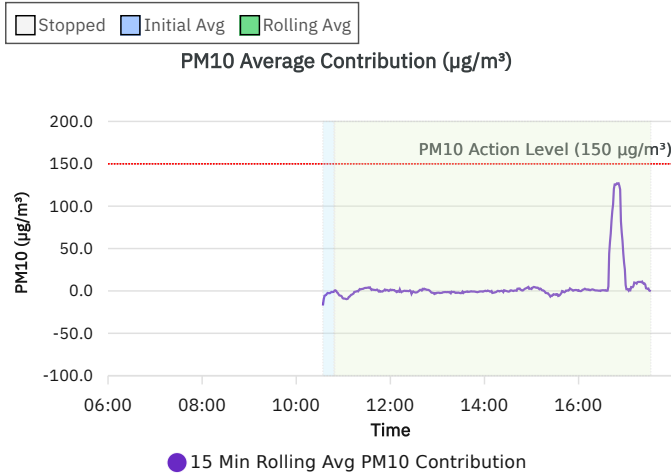
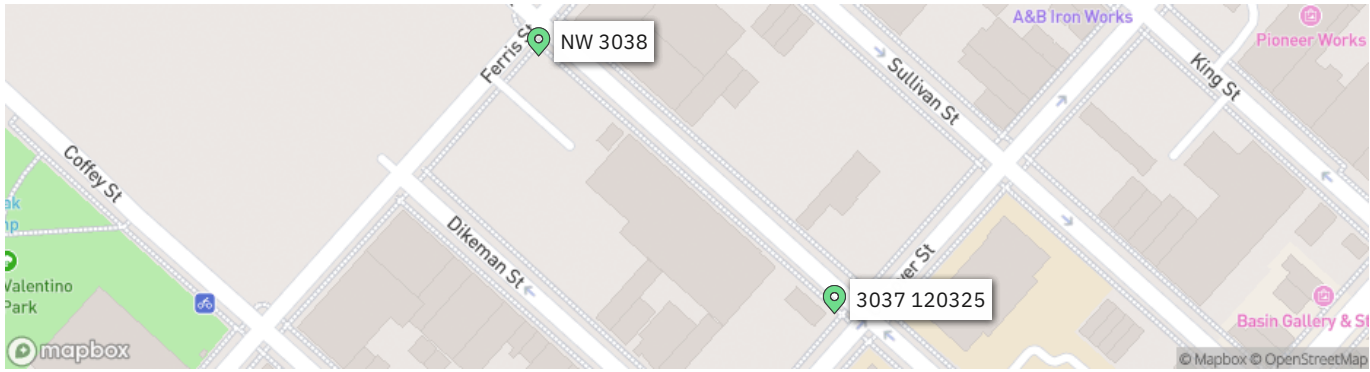

LANGAN SITE OBSERVATION REPORT- Day 149

PROJECT No.: 170452203	CLIENT: NYM 145 Wolcott, LLC 233 Broadway, 10 th Fl., New York, NY 10279	DATE: Fri., April 03, 2026
PROJECT: 145-165 Wolcott Street		WEATHER: Partly Cloudy, 41 - 67°F Wind: S @ 0.5 – 6.5 mph
LOCATION: Brooklyn, New York		TIME: 6:45 am – 6:00 pm
SITE CODE: C224256		MONITOR: Brayden Klein

EQUIPMENT: AQS1 Air Monitoring Station x 2 MiniRAE 3000 Photoionization Detector (PID) CAT 335F x 2 Zaxis 135US Hyundai HL955A Bauer BG 36 H ABI TM22 RTG RG 27S Hitachi 670 Takeuchi TB260 Terex TA9 TB260 Kubota KX080-4α2 BW120 AD	PRESENT AT SITE: Langan (Environmental): Brayden Klein Urban Atelier Group (UAG) ECD NY Inc. (ECD): Kyle McGovern
--	--

OBSERVATIONS, DISCUSSIONS, TEST RESULTS, ETC.:	
<p>Langan was present to document remediation activities in accordance with the New York State Department of Environmental Conservation (NYSDEC)-approved July 22, 2025 Remedial Action Work Plan (RAWP) at the 145-165 Wolcott Street site in Brooklyn, New York (Site No. C224256).</p> <p>Site Activities</p> <ul style="list-style-type: none"> • ECD used a CAT 335F to excavate the following areas: <ul style="list-style-type: none"> ○ An about 20-foot-long by 10-foot-wide area to about 8 feet below grade surface (bgs) the central part of the site for the installation of utility piping. ○ An about 15-foot-long by 15-foot-wide area to about 5 feet bgs in the western part of the site for the installation of utility piping. ○ An about 10-foot-long by 5-foot-wide area to about 1-foot bgs in the western part of the site for sub slab depressurization system (SSDS) installation. ○ An about 10-foot-long by 2-foot-wide area to about 5 feet bgs in the eastern part of the site. ○ Excavated non-native fill was stockpiled adjacent to the excavation. ○ Excavated non-native fill was screened for odors, staining, and organic vapors using a PID. No impacts were observed. • ECD used a Kubota KX080-4α2 to backfill an about 15-foot-long by 10-foot-wide area from 3 feet bgs to working grade with previously imported clean fill in the western part of the site. 	
Cc: M. Burke, G. Nicholls, S. Knoop, N. Palumbo, L. Grose	By: Brayden Klein Langan Eng, Env, Surv, L.A. & Geo, DPC

LANGAN SITE OBSERVATION REPORT- Day 149

- ECD used hand tools to backfill an about 12-inch-thick layer of ¾-inch virgin stone (gas permeable aggregate) within an about 25-foot-long by 8-feet-wide area as part of the SSDS within the western part of the site.
- ECD installed about 8 feet of 4-inch-diameter polyvinyl chloride (PVC) piping as part of the SSDS in the western part of the site.
- ECD installed Preprufe 300R Plus waterproofing/vapor barrier membrane atop the rat slab in the western part of the site.

Material Tracking

- No material was imported into the site.
- No material was exported from the site.

Material Export Summary – Soil										
Facility Name Location	Clean Earth of North Jersey Kearny, NJ									
Material	Non-Hazardous Low pH Soil		Hazardous Lead Impacted Soil with UHCs		Hazardous Lead Impacted Soil with No UHCs		High Hazardous Lead		Non-Hazardous Soil	
Quantities	No. of Loads	Approx. Volume (CY)	No. of Loads	Approx. Volume (CY)	No. of Loads	Approx. Volume (CY)	No. of Loads	Approx. Volume (CY)	No. of Loads	Approx. Volume (CY)
Today	-	-	-	-	-	-	-	-	-	-
Project Total	332	5,495	56	901	27	467	5	68	1	18

Notes:

1. UHC – Underlying Hazardous Constituent

Material Export Summary – Soil						
Facility Name Location	Clean Earth of New Castle New Castle, DE		Conestoga Landfill Morgantown, PA		Waste Management Morgantown, PA	
Material	Non-Hazardous Soil		Non-Hazardous Soil		Non-Hazardous Soil	
Quantities	No. of Loads	Approx. Volume (CY)	No. of Loads	Approx. Volume (CY)	No. of Loads	Approx. Volume (CY)
Today	-	-	-	-	-	-
Project Total	729	13,682	39	703	224	4,007

Material Export Summary – C&D						
Facility Name Location	PPark NJ, LLC Prospect Park, NJ		Bayshore Soil Management, LLC Keasbey, NJ		Silva Recycling, LLC Newark, NJ	
Material	Asphalt, Concrete		Asphalt, Concrete		Concrete	
Quantities	No. of Loads	Approx. Volume (CY)	No. of Loads	Approx. Volume (CY)	No. of Loads	Approx. Volume (CY)
Today	-	-	-	-	-	-
Project Total	119	2,380	31	645	25	880

Cc: M. Burke, G. Nicholls, S. Knoop,
N. Palumbo, L. Grose

By: Brayden Klein

Langan Eng, Env, Surv, L.A. & Geo, DPC

Material Import Summary										
Facility Name Location	Impact Materials, LLC Jersey City, NJ		Callahan & Nannini Quarry Inc. Salisbury Mills, NY		Durante Brothers Construction Flushing, NY		Tilcon West Nyack Quarry West Nyack, NY		B.G.L.J Servicing Corp Moriches, NY	
Material	3/4" Recycled Clean Stone		2-4" Granite Stone		Clean Fill		ASTM No. 5 Stone		Virgin Sand	
Quantities	No. of Loads	Approx. Volume (CY)	No. of Loads	Approx. Volume (CY)	No. of Loads	Approx. Volume (CY)	No. of Loads	Approx. Volume (CY)	No. of Loads	Approx. Volume (CY)
Today	-	-	-	-	-	-	-	-	-	-
Project Total	62	1,240	4	100	228	4,088	49	882	1	18

Samples

- No samples were collected.

Community Air Monitoring Plan (CAMP) Activities

- Langan performed community air monitoring at the perimeter of the work area at one upwind and three downwind locations during intrusive work. Implementation of the Community Air Monitoring Plan (CAMP) included air monitoring for particulate matter for particulates less than 10 µm in diameter (PM10) and volatile organic compounds (VOC). PM10 and VOC concentrations did not exceed the action levels established by the community air monitoring plan.
- No fugitive dust or odors associated with site activities were observed migrating from the site.

Anticipated Activities

- ECD will continue excavating and backfilling for utility piping in the central part of the site.
- ECD will continue foundation framing/concrete pouring in the central part of the site.
- ECD will continue laying polyvinyl chloride piping, geotextile fabric, and ¾-inch virgin stone as part of the SSDS system and soil vapor extrusion system installation in the western part of the site.

Cc: M. Burke, G. Nicholls, S. Knoop,
N. Palumbo, L. Grose

By: Brayden Klein

Langan Eng, Env, Surv, L.A. & Geo, DPC

Figure 1: Site Map

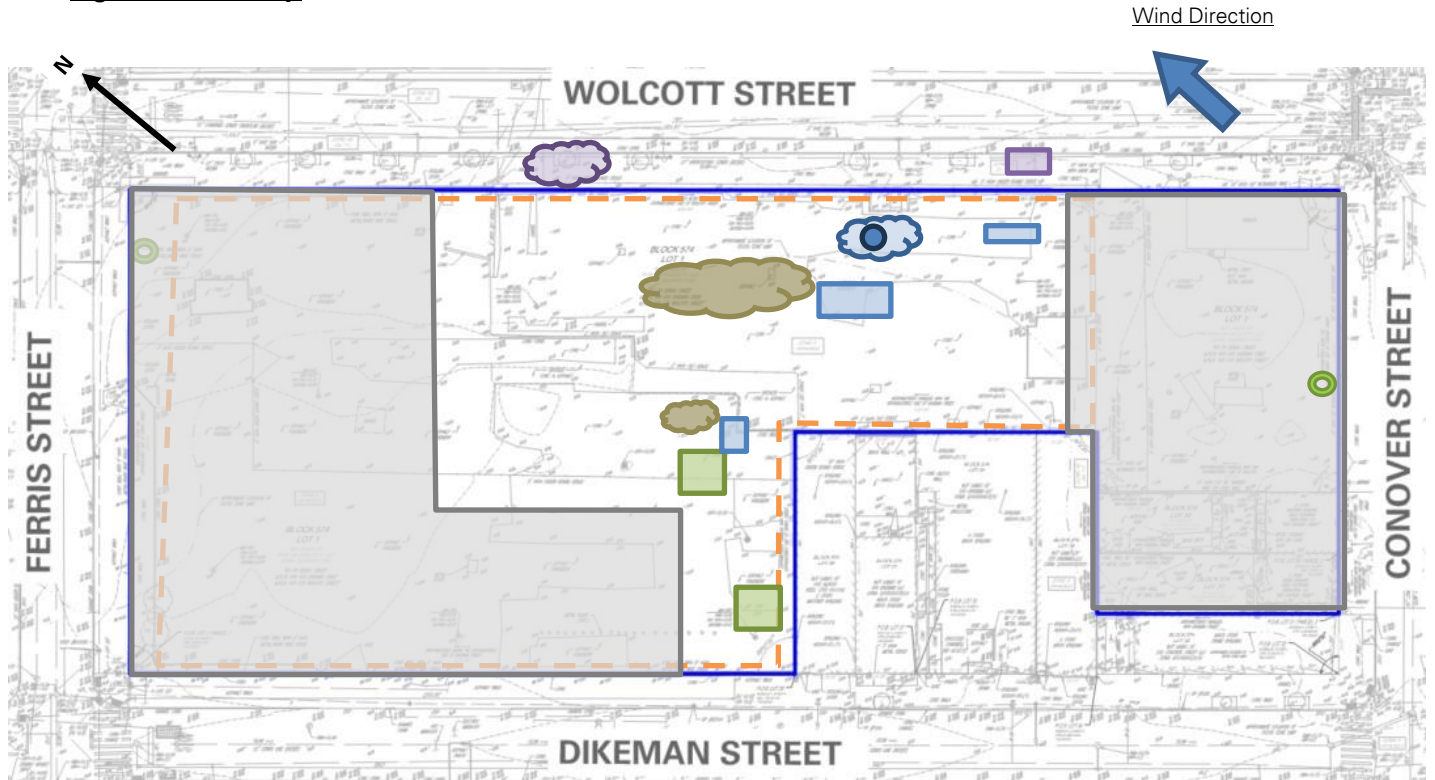

Legend

	Site Boundary-		Approximate Area Excavated
	Approximate Work Area		Approximate Area Backfilled
	Approximate Location of Perimeter CAMP Station		Approximate Area Graded
	Approximate Location of Installed Site Cover System		Approximate C&D Stockpile
	Approximate IDW Drum Staging Area		Approximate Non-Native Fill Stockpile
	Approximate Steel Tank Location		Approximate Stone Stockpile
			Approximate Imported Clean Fill Stockpile

Notes:

1. Basemap is referenced from 26 March 2025 ALTA/NSPS Land Title Survey prepared by Control Point Associates Inc PC.
2. IDW – Investigation-derived waste generated during the April 2025 and August 2025 supplemental waste characterizations and the January through May 2025 non-aqueous phase liquid gauging.

Cc: M. Burke, G. Nicholls, S. Knoop,
N. Palumbo, L. Grose

By: Brayden Klein

Langan Eng, Env, Surv, L.A. & Geo, DPC

Figure 2: Endpoint / Sidewalk Sample Location Map

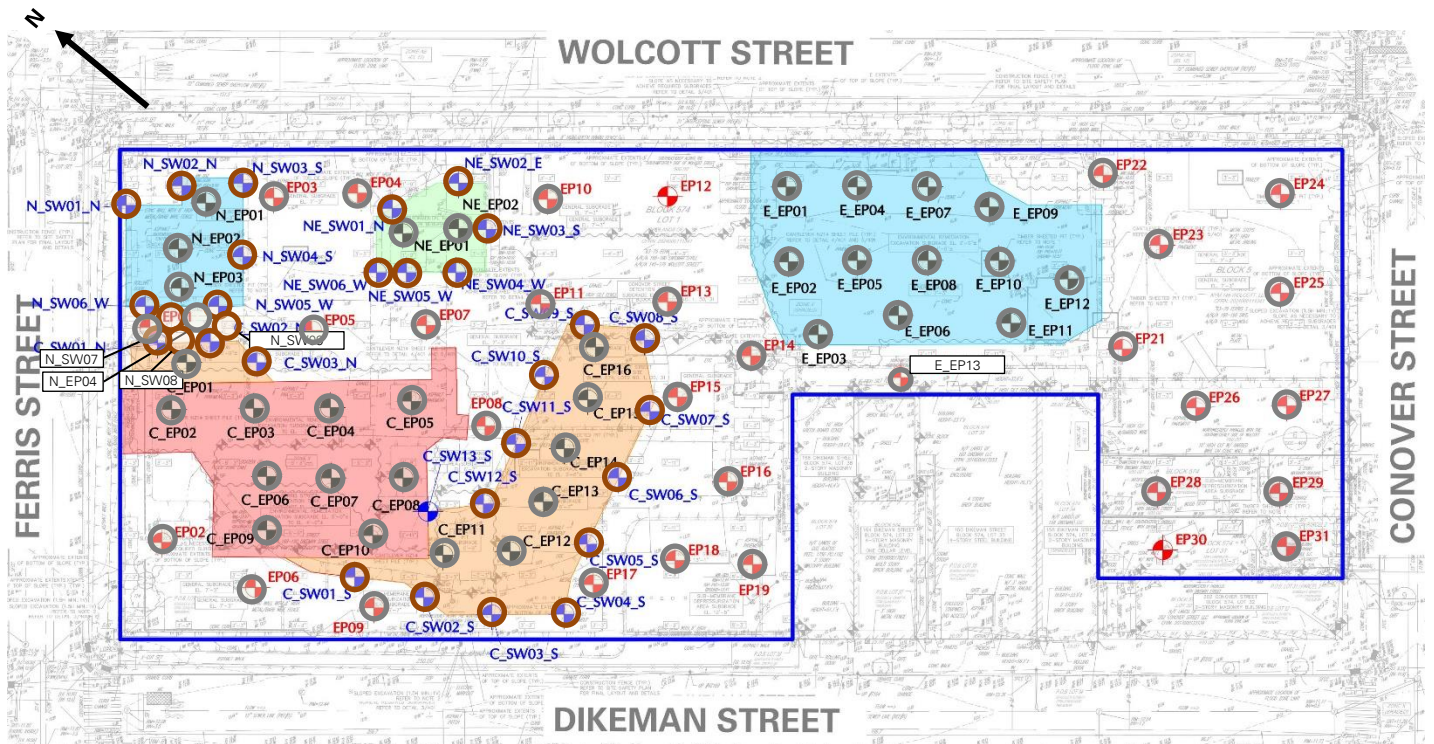

Legend

- Site Boundary
- Approximate Location of Documentation Endpoint Soil Sample Collected
- Approximate Location of Documentation Sidewalk Soil Sample Collected
- Approximate Location of Previously Collected Documentation Endpoint Soil Sample
- Approximate Location of Previously Collected Documentation Sidewalk Soil Sample

Notes:

1. Basemap is referenced from 26 March 2025 ALTA/NSPS Land Title Survey prepared by Control Point Associates Inc PC.

Cc: M. Burke, G. Nicholls, S. Knoop,
N. Palumbo, L. Grose

By: Brayden Klein
Langan Eng, Env, Surv, L.A. & Geo, DPC

Photographs



Photo 1: ECD backfilling with previously imported clean fill to surface grade around ConEd utility boxes in the western part of the site (facing north)



Photo 2: ECD installing Preprufe 300R Plus waterproofing/vapor barrier in the western part of the site (facing west)

Cc: M. Burke, G. Nicholls, S. Knoop,
N. Palumbo, L. Grose

By: Brayden Klein
Langan Eng, Env, Surv, L.A. & Geo, DPC



Photo 3: ECD stockpiling previously imported clean fill within the central part of the site (facing northwest)



Photo 4: ECD installing utility piping in the central part of the site (facing north)

Cc: M. Burke, G. Nicholls, S. Knoop,
N. Palumbo, L. Grose

By: Brayden Klein
Langan Eng, Env, Surv, L.A. & Geo, DPC

LANGAN	Contribution 2 Station 031026 Report	170562203 - 145 Wolcott St	
		Report Period	
		From:	04/03/2026 06:30
		To:	04/03/2026 18:00
		PM10 Action Level:	150 µg/m³
		VOC Action Level:	5 ppm

Daily Environmental Summary	Temp (°F)	Relative Humidity (%)	Barometer (inHg)	Wind Speed (mph)	Prevailing Wind Direction
04/03/2026	41.2 - 67.1	60.3 - 93.3	30.1 - 30.4	0.5 - 6.5	S

Daily Monitoring Summary	PM10 (µg/m³)	Time	VOC (ppm)	Time
Min Contribution (15 min avg.) - 4/3/2026	-6.1	07:24	-0.1113	10:58
Max Contribution (15 min avg.) - 4/3/2026	11.9	15:47	0.0500	10:43
Daily Avg. Contribution (15 min avg.) - 4/3/2026	1.3	-	-0.0006	-

