

LANGAN SITE OBSERVATION REPORT- Day 150

PROJECT No.: 170452203	CLIENT: NYM 145 Wolcott, LLC 233 Broadway, 10 th Fl., New York, NY 10279	DATE: Mon., April 06, 2026
PROJECT: 145-165 Wolcott Street		WEATHER: Clear, 39 - 57°F Wind: WNW @ 0.8 – 10.7 mph
LOCATION: Brooklyn, New York		TIME: 6:45 am – 6:00 pm
SITE CODE: C224256		MONITOR: Brayden Klein

EQUIPMENT: AQS1 Air Monitoring Station x 2 MiniRAE 3000 Photoionization Detector (PID) CAT 335F x 2 Zaxis 135US Hyundai HL955A Bauer BG 36 H ABI TM22 RTG RG 27S Hitachi 670 Takeuchi TB260 Terex TA9 TB260 Kubota KX080-4α2 BW120 AD	PRESENT AT SITE: Langan (Environmental): Brayden Klein, Richo Brian Urban Atelier Group (UAG) ECD NY Inc. (ECD): Kyle McGovern
--	---

OBSERVATIONS, DISCUSSIONS, TEST RESULTS, ETC.:	
<p>Langan was present to document remediation activities in accordance with the New York State Department of Environmental Conservation (NYSDEC)-approved July 22, 2025 Remedial Action Work Plan (RAWP) at the 145-165 Wolcott Street site in Brooklyn, New York (Site No. C224256).</p> <p>Site Activities</p> <ul style="list-style-type: none"> • ECD used a CAT 335F to excavate the following areas: <ul style="list-style-type: none"> ○ An about 10-foot-long by 10-feet-wide area to about 8 feet below grade surface (bgs) in the central part of the site for the installation of utility piping. ○ An about 5-foot-long by 5-feet-wide area from about 1 foot above grade to surface grade in the western part of the site for the installation of waterproofing and vapor barrier. ○ Excavated non-native fill was stockpiled adjacent to the excavation. ○ Excavated non-native fill was screened for odors, staining, and organic vapors using a PID. No impacts were observed. • ECD used hand tools to excavate an about 5-foot-long by 5-feet-wide area to about 8 feet bgs in the eastern part of the site for the installation of utility piping. <ul style="list-style-type: none"> ○ Excavated non-native fill was stockpiled in the eastern part of the site. ○ Excavated non-native fill was screened for odors, staining, and organic vapors using a PID. No impacts were observed. 	
Cc: M. Burke, G. Nicholls, S. Knoop, N. Palumbo, L. Grose	By: Brayden Klein Langan Eng, Env, Surv, L.A. & Geo, DPC

LANGAN SITE OBSERVATION REPORT- Day 150

- ECD installed Preprufe 300R Plus waterproofing/vapor barrier membrane atop the rat slab in the western and northwestern parts of the site.
- ECD poured an about 12-inch-thick concrete slab within an about 60-foot-long by 30-feet-wide area within the northwestern part of the site.
- ECD poured an about 3-inch-thick rat slab within an about 100-foot-long by 55-feet-wide area within the central part of the site.

Material Tracking

- No material was imported into the site.
- No material was exported from the site.

Material Export Summary – Soil										
Facility Name Location	Clean Earth of North Jersey Kearny, NJ									
Material	Non-Hazardous Low pH Soil		Hazardous Lead Impacted Soil with UHCs		Hazardous Lead Impacted Soil with No UHCs		High Hazardous Lead		Non-Hazardous Soil	
Quantities	No. of Loads	Approx. Volume (CY)	No. of Loads	Approx. Volume (CY)	No. of Loads	Approx. Volume (CY)	No. of Loads	Approx. Volume (CY)	No. of Loads	Approx. Volume (CY)
Today	-	-	-	-	-	-	-	-	-	-
Project Total	332	5,495	56	901	27	467	5	68	1	18

Notes:

1. UHC – Underlying Hazardous Constituent

Material Export Summary – Soil							
Facility Name Location	Clean Earth of New Castle New Castle, DE		Conestoga Landfill Morgantown, PA		Waste Management Morgantown, PA		
Material	Non-Hazardous Soil		Non-Hazardous Soil		Non-Hazardous Soil		
Quantities	No. of Loads	Approx. Volume (CY)	No. of Loads	Approx. Volume (CY)	No. of Loads	Approx. Volume (CY)	
Today	-	-	-	-	-	-	
Project Total	729	13,682	39	703	224	4,007	

Material Export Summary – C&D						
Facility Name Location	PPark NJ, LLC Prospect Park, NJ		Bayshore Soil Management, LLC Keasbey, NJ		Silva Recycling, LLC Newark, NJ	
Material	Asphalt, Concrete		Asphalt, Concrete		Concrete	
Quantities	No. of Loads	Approx. Volume (CY)	No. of Loads	Approx. Volume (CY)	No. of Loads	Approx. Volume (CY)
Today	-	-	-	-	-	-
Project Total	119	2,380	31	645	25	880

Cc: M. Burke, G. Nicholls, S. Knoop,
N. Palumbo, L. Grose

By: Brayden Klein

Langan Eng, Env, Surv, L.A. & Geo, DPC

Material Import Summary										
Facility Name Location	Impact Materials, LLC Jersey City, NJ		Callahan & Nannini Quarry Inc. Salisbury Mills, NY		Durante Brothers Construction Flushing, NY		Tilcon West Nyack Quarry West Nyack, NY		B.G.L.J Servicing Corp Moriches, NY	
Material	3/4" Recycled Clean Stone		2-4" Granite Stone		Clean Fill		ASTM No. 5 Stone		Virgin Sand	
Quantities	No. of Loads	Approx. Volume (CY)	No. of Loads	Approx. Volume (CY)	No. of Loads	Approx. Volume (CY)	No. of Loads	Approx. Volume (CY)	No. of Loads	Approx. Volume (CY)
Today	-	-	-	-	-	-	-	-	-	-
Project Total	62	1,240	4	100	228	4,088	49	882	1	18

Samples

- No samples were collected.

Community Air Monitoring Plan (CAMP) Activities

- Langan performed community air monitoring at the perimeter of the work area at one upwind and three downwind locations during intrusive work. Implementation of the Community Air Monitoring Plan (CAMP) included air monitoring for particulate matter for particulates less than 10 µm in diameter (PM10) and volatile organic compounds (VOC). PM10 and VOC concentrations did not exceed the action levels established by the community air monitoring plan.
- No fugitive dust or odors associated with site activities were observed migrating from the site.

Anticipated Activities

- ECD will continue excavating and backfilling for utility piping in the central part of the site.
- ECD will continue foundation framing/concrete pouring in the central part of the site.
- ECD will continue laying polyvinyl chloride piping, geotextile fabric, and ¾-inch virgin stone as part of the sub slab depressurization system and soil vapor extrusion system installation in the western part of the site.

Cc: M. Burke, G. Nicholls, S. Knoop,
N. Palumbo, L. Grose

By: Brayden Klein

Langan Eng, Env, Surv, L.A. & Geo, DPC

Figure 1: Site Map

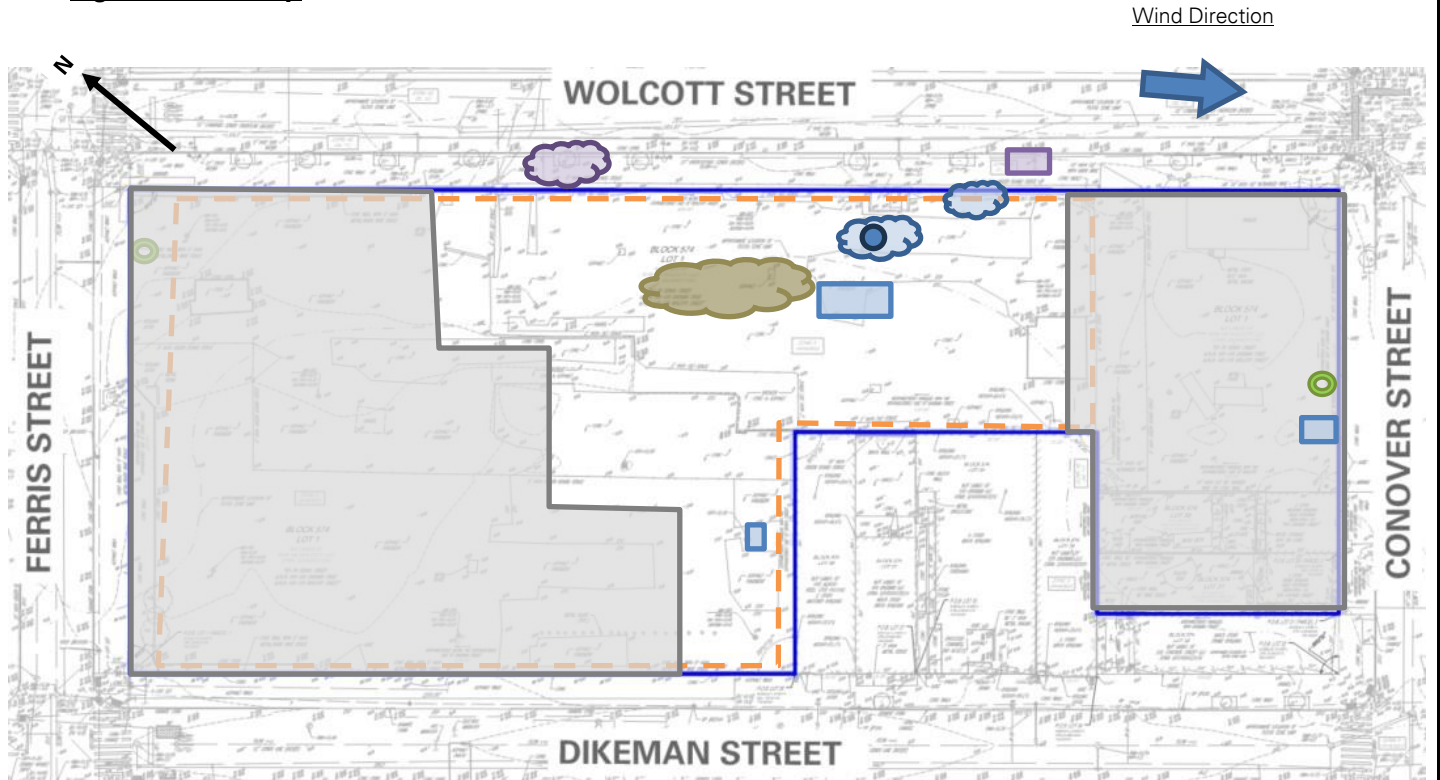

Legend

	Site Boundary-		Approximate Area Excavated
	Approximate Work Area		Approximate Area Backfilled
	Approximate Location of Perimeter CAMP Station		Approximate Area Graded
	Approximate Location of Installed Site Cover System		Approximate C&D Stockpile
	Approximate IDW Drum Staging Area		Approximate Non-Native Fill Stockpile
	Approximate Steel Tank Location		Approximate Stone Stockpile
			Approximate Imported Clean Fill Stockpile

Notes:

1. Basemap is referenced from 26 March 2025 ALTA/NSPS Land Title Survey prepared by Control Point Associates Inc PC.
2. IDW – Investigation-derived waste generated during the April 2025 and August 2025 supplemental waste characterizations and the January through May 2025 non-aqueous phase liquid gauging.

Cc: M. Burke, G. Nicholls, S. Knoop,
N. Palumbo, L. Grose

By: Brayden Klein

Langan Eng, Env, Surv, L.A. & Geo, DPC

Figure 2: Endpoint / Sidewalk Sample Location Map

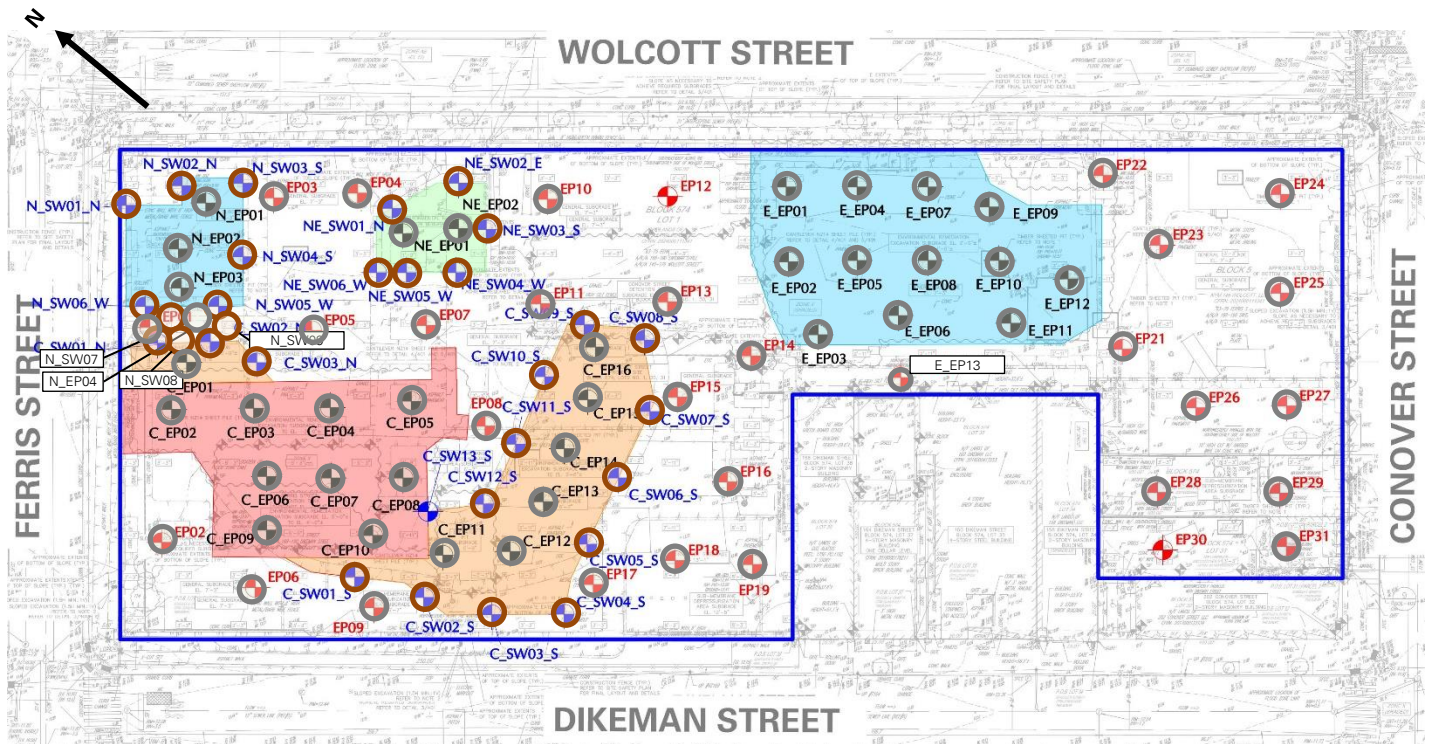

Legend

- Site Boundary
- Approximate Location of Documentation Endpoint Soil Sample Collected
- Approximate Location of Documentation Sidewalk Soil Sample Collected
- Approximate Location of Previously Collected Documentation Endpoint Soil Sample
- Approximate Location of Previously Collected Documentation Sidewalk Soil Sample

Notes:

1. Basemap is referenced from 26 March 2025 ALTA/NSPS Land Title Survey prepared by Control Point Associates Inc PC.

Cc: M. Burke, G. Nicholls, S. Knoop,
N. Palumbo, L. Grose

By: Brayden Klein
Langan Eng, Env, Surv, L.A. & Geo, DPC

Photographs



Photo 1: ECD stockpiling previously imported clean fill in the central part of the site for future backfill (facing northwest)



Photo 2: ECD installing Preprufe 300R Plus waterproofing/vapor barrier in the western part of the site (facing west)

Cc: M. Burke, G. Nicholls, S. Knoop,
N. Palumbo, L. Grose

By: Brayden Klein
Langan Eng, Env, Surv, L.A. & Geo, DPC



Photo 3: ECD pouring an about 12-inch-thick concrete slab within the northwestern part of the site (facing west)



Photo 4: ECD pouring an about 3-inch-thick rat slab in the central part of the site (facing north)

Cc: M. Burke, G. Nicholls, S. Knoop,
N. Palumbo, L. Grose

By: Brayden Klein

Langan Eng, Env, Surv, L.A. & Geo, DPC

LANGAN	Contribution 2 Station 031026 Report	170562203 - 145 Wolcott St	
		Report Period	
		From:	04/06/2026 06:00
		To:	04/06/2026 18:00
		PM10 Action Level:	150 $\mu\text{g}/\text{m}^3$
VOC Action Level:	5 ppm		

Daily Environmental Summary	Temp (°F)	Relative Humidity (%)	Barometer (inHg)	Wind Speed (mph)	Prevailing Wind Direction
04/06/2026	39.0 - 57.0	32.1 - 58.5	30.0 - 30.1	0.8 - 10.7	WNW

Daily Monitoring Summary	PM10 ($\mu\text{g}/\text{m}^3$)	Time	VOC (ppm)	Time
Min Contribution (15 min avg.) - 4/6/2026	-160.3	14:42	-0.0173	11:55
Max Contribution (15 min avg.) - 4/6/2026	128.6	17:01	0.0162	07:13
Daily Avg. Contribution (15 min avg.) - 4/6/2026	-18.3	-	0.0010	-

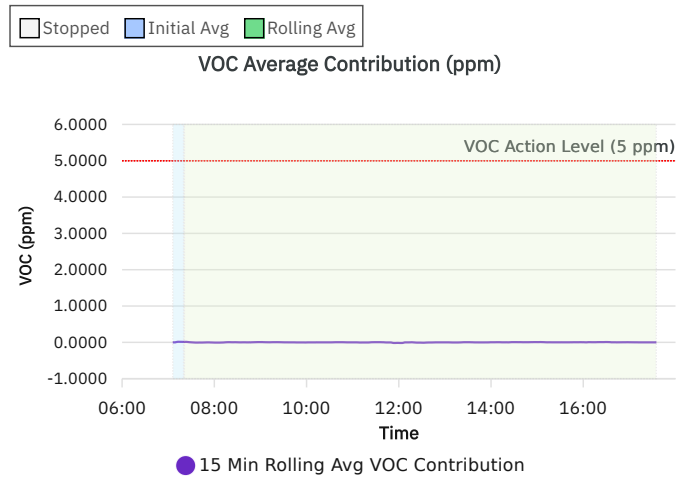
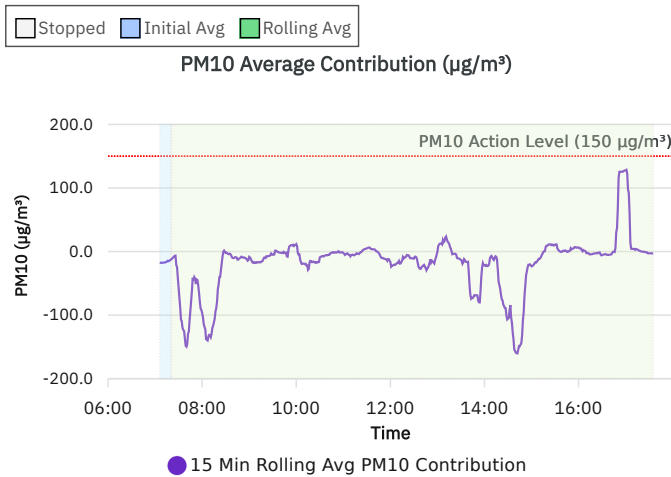
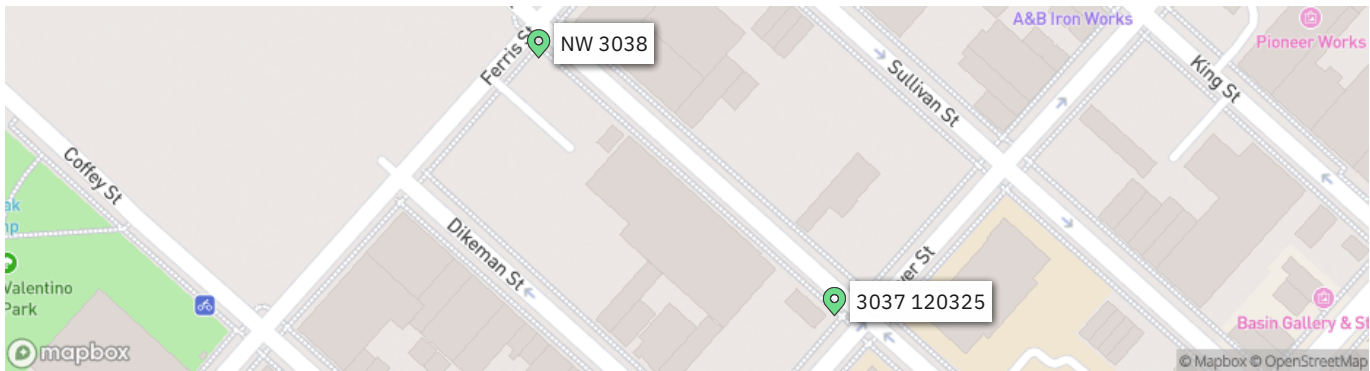

LANGAN SITE OBSERVATION REPORT- Day 151

PROJECT No.: 170452203	CLIENT: NYM 145 Wolcott, LLC 233 Broadway, 10 th Fl., New York, NY 10279	DATE: Tue., April 07, 2026
PROJECT: 145-165 Wolcott Street		WEATHER: Clear, 45 - 55°F Wind: WNW @ 1.1 – 16.1 mph
LOCATION: Brooklyn, New York		TIME: 6:45 am – 6:00 pm
SITE CODE: C224256		MONITOR: Brayden Klein

EQUIPMENT: AQS1 Air Monitoring Station x 2 MiniRAE 3000 Photoionization Detector (PID) CAT 335F x 2 Zaxis 135US Hyundai HL955A Bauer BG 36 H ABI TM22 RTG RG 27S Hitachi 670 Takeuchi TB260 Terex TA9 TB260 Kubota KX080-4α2 BW120 AD	PRESENT AT SITE: Langan (Environmental): Brayden Klein Urban Atelier Group (UAG) ECD NY Inc. (ECD): Kyle McGovern
--	--

OBSERVATIONS, DISCUSSIONS, TEST RESULTS, ETC.:

Langan was present to document remediation activities in accordance with the New York State Department of Environmental Conservation (NYSDEC)-approved July 22, 2025 Remedial Action Work Plan (RAWP) at the 145-165 Wolcott Street site in Brooklyn, New York (Site No. C224256).

Site Activities

- ECD used a CAT 335F to grade an about 20-foot-long by 5-feet-wide area in the central part of the site.
 - Graded clean fill was stockpiled adjacent to the work area for future on-site reuse.
 - Graded clean fill was screened for odors, staining, and organic vapors using a PID. No impacts were observed.
- ECD used hand tools to backfill an about 5-foot-long by 5-feet-wide area with previously imported clean fill from about 8 feet below grade surface (bgs) to 6 feet bgs in the eastern part of the site for the installation of utility piping.
- ECD used a Kubota KX080-4α2 to backfill an about 15-foot-long by 8-feet-wide area with an about 6-inch-thick layer of ¾-inch virgin stone for the installation of utility piping within the western part of the site.
- ECD installed Preprufe 300R Plus waterproofing/vapor barrier membrane atop the rat slab within an about 60-foot-long by 30-feet-wide area in the central part of the site.
- ECD poured an about 12-inch-thick concrete slab within an about 50-foot-long by 25-feet-wide area in the northwestern part of the site.

Cc: M. Burke, G. Nicholls, S. Knoop, N. Palumbo, L. Grose	By: Brayden Klein
Langan Eng, Env, Surv, L.A. & Geo, DPC	

Material Tracking

- No material was imported into the site.
- No material was exported from the site.

Material Export Summary – Soil										
Facility Name Location	Clean Earth of North Jersey Kearny, NJ									
Material	Non-Hazardous Low pH Soil		Hazardous Lead Impacted Soil with UHCs		Hazardous Lead Impacted Soil with No UHCs		High Hazardous Lead		Non-Hazardous Soil	
Quantities	No. of Loads	Approx. Volume (CY)	No. of Loads	Approx. Volume (CY)	No. of Loads	Approx. Volume (CY)	No. of Loads	Approx. Volume (CY)	No. of Loads	Approx. Volume (CY)
Today	-	-	-	-	-	-	-	-	-	-
Project Total	332	5,495	56	901	27	467	5	68	1	18

Notes:

1. UHC – Underlying Hazardous Constituent

Material Export Summary – Soil						
Facility Name Location	Clean Earth of New Castle New Castle, DE		Conestoga Landfill Morgantown, PA		Waste Management Morgantown, PA	
Material	Non-Hazardous Soil		Non-Hazardous Soil		Non-Hazardous Soil	
Quantities	No. of Loads	Approx. Volume (CY)	No. of Loads	Approx. Volume (CY)	No. of Loads	Approx. Volume (CY)
Today	-	-	-	-	-	-
Project Total	729	13,682	39	703	224	4,007

Material Export Summary – C&D						
Facility Name Location	PPark NJ, LLC Prospect Park, NJ		Bayshore Soil Management, LLC Keasbey, NJ		Silva Recycling, LLC Newark, NJ	
Material	Asphalt, Concrete		Asphalt, Concrete		Concrete	
Quantities	No. of Loads	Approx. Volume (CY)	No. of Loads	Approx. Volume (CY)	No. of Loads	Approx. Volume (CY)
Today	-	-	-	-	-	-
Project Total	119	2,380	31	645	25	880

Cc: M. Burke, G. Nicholls, S. Knoop,
N. Palumbo, L. Grose

By: Brayden Klein

Langan Eng, Env, Surv, L.A. & Geo, DPC

Material Import Summary										
Facility Name	Impact Materials, LLC		Callahan & Nannini Quarry Inc.		Durante Brothers Construction		Tilcon West Nyack Quarry		B.G.L.J Servicing Corp	
Location	Jersey City, NJ		Salisbury Mills, NY		Flushing, NY		West Nyack, NY		Moriches, NY	
Material	3/4" Recycled Clean Stone		2-4" Granite Stone		Clean Fill		ASTM No. 5 Stone		Virgin Sand	
Quantities	No. of Loads	Approx. Volume (CY)	No. of Loads	Approx. Volume (CY)	No. of Loads	Approx. Volume (CY)	No. of Loads	Approx. Volume (CY)	No. of Loads	Approx. Volume (CY)
Today	-	-	-	-	-	-	-	-	-	-
Project Total	63	1,134	2	36	638	11,484	44	792	1	18

Samples

- No samples were collected.

Community Air Monitoring Plan (CAMP) Activities

- Langan performed community air monitoring at the perimeter of the work area at one upwind and one downwind location during intrusive work. Implementation of the Community Air Monitoring Plan (CAMP) included air monitoring for particulate matter for particulates less than 10 µm in diameter (PM10) and volatile organic compounds (VOC). PM10 and VOC concentrations did not exceed the action levels established by the community air monitoring plan.
- No fugitive dust or odors associated with site activities were observed migrating from the site.

Anticipated Activities

- ECD will continue excavating and backfilling for utility piping in the central part of the site.
- ECD will continue foundation framing and concrete pouring in the central part of the site.
- ECD will continue laying polyvinyl chloride piping, geotextile fabric, and ¾-inch virgin stone as part of the sub slab depressurization system (SSDS) and soil vapor extrusion system installation in the western part of the site.

Cc: M. Burke, G. Nicholls, S. Knoop,
N. Palumbo, L. Grose







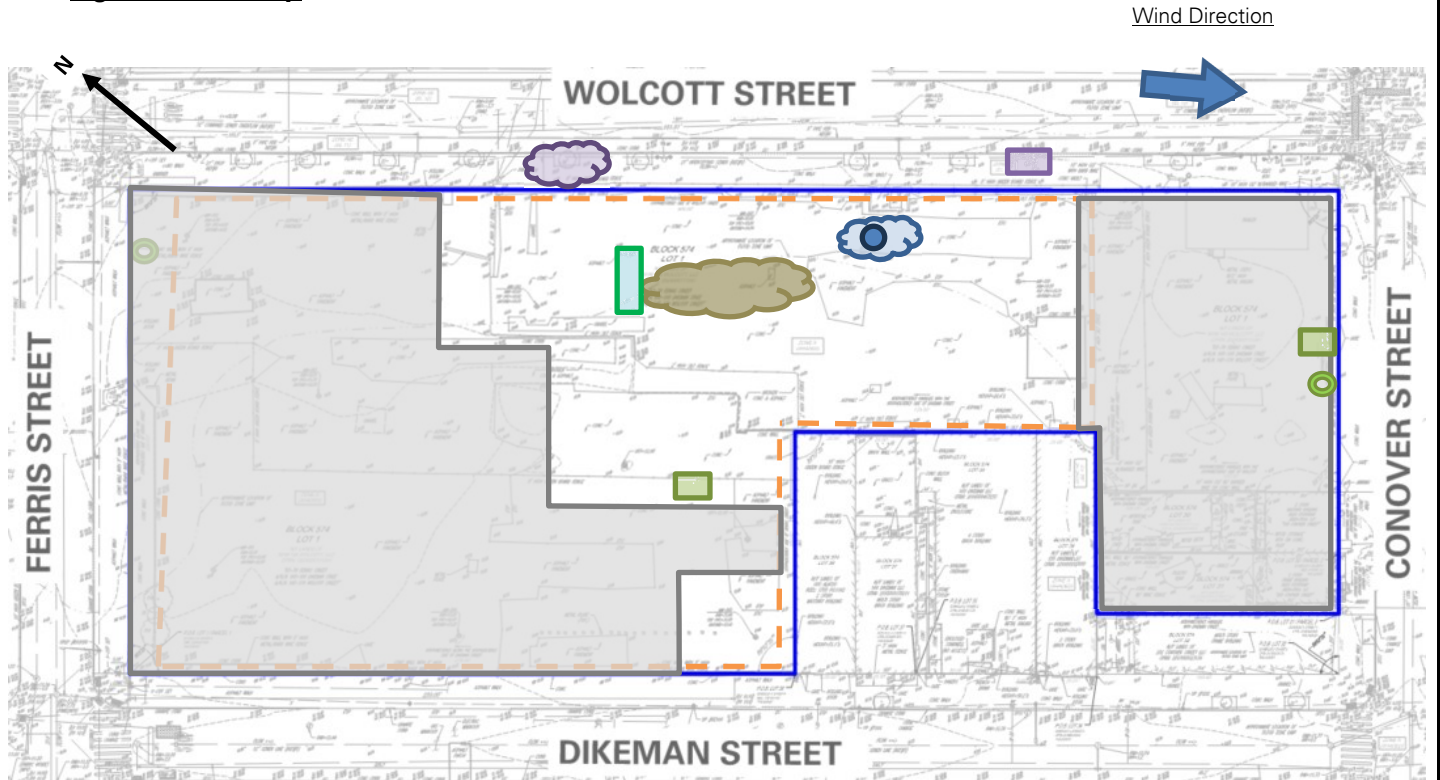





By: Brayden Klein

Langan Eng, Env, Surv, L.A. & Geo, DPC

Figure 1: Site Map



Legend

	Site Boundary-		Approximate Area Excavated
	Approximate Work Area		Approximate Area Backfilled
	Approximate Location of Perimeter CAMP Station		Approximate Area Graded
	Approximate Location of Installed Site Cover System		Approximate C&D Stockpile
	Approximate IDW Drum Staging Area		Approximate Non-Native Fill Stockpile
	Approximate Steel Tank Location		Approximate Stone Stockpile
			Approximate Imported Clean Fill Stockpile

Notes:

1. Basemap is referenced from 26 March 2025 ALTA/NSPS Land Title Survey prepared by Control Point Associates Inc PC.
2. IDW – Investigation-derived waste generated during the April 2025 and August 2025 supplemental waste characterizations and the January through May 2025 non-aqueous phase liquid gauging.

Cc: M. Burke, G. Nicholls, S. Knoop,
N. Palumbo, L. Grose

By: Brayden Klein

Langan Eng, Env, Surv, L.A. & Geo, DPC

Figure 2: Endpoint / Sidewalk Sample Location Map

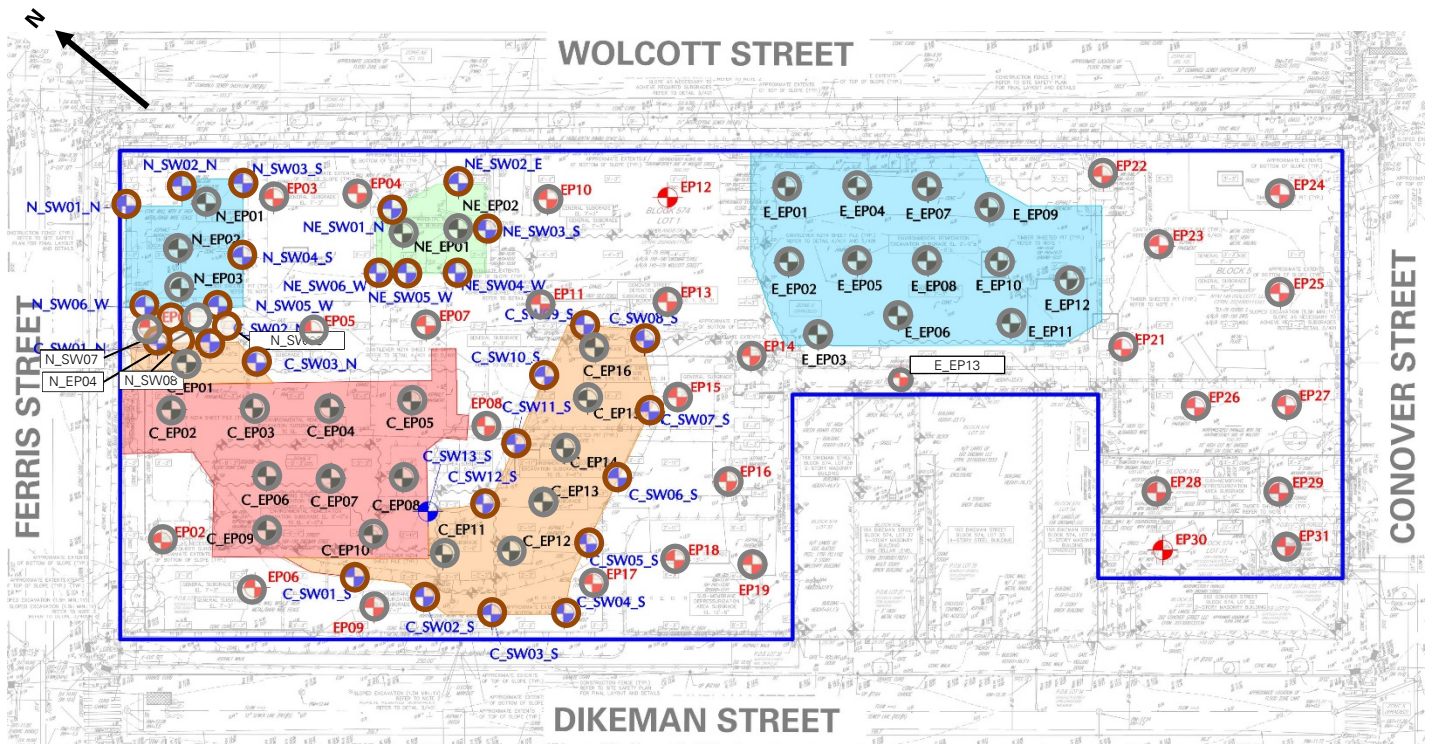

Legend

- Site Boundary
- Approximate Location of Documentation Endpoint Soil Sample Collected
- Approximate Location of Documentation Sidewalk Soil Sample Collected
- Approximate Location of Previously Collected Documentation Endpoint Soil Sample
- Approximate Location of Previously Collected Documentation Sidewalk Soil Sample

Notes:

1. Basemap is referenced from 26 March 2025 ALTA/NSPS Land Title Survey prepared by Control Point Associates Inc PC.

Cc: M. Burke, G. Nicholls, S. Knoop,
N. Palumbo, L. Grose

By: Brayden Klein
Langan Eng, Env, Surv, L.A. & Geo, DPC

Photographs



Photo 1: ECD installing a box-out within the slab for future monitoring point installation for the SSDS in the western part of site (facing southwest)



Photo 2: ECD installing Preprufe 300R Plus waterproofing/vapor barrier atop the rat slab in the central part of the site (facing east)

Cc: M. Burke, G. Nicholls, S. Knoop,
N. Palumbo, L. Grose

By: Brayden Klein

Langan Eng, Env, Surv, L.A. & Geo, DPC



Photo 3: ECD pouring an about 12-inch-thick concrete slab within the western part of the site (facing south)



Photo 4: ECD stockpiling previously imported clean fill in the central part of the site (facing west)

Cc: M. Burke, G. Nicholls, S. Knoop,
N. Palumbo, L. Grose

By: Brayden Klein

Langan Eng, Env, Surv, L.A. & Geo, DPC

LANGAN	Contribution 2 Station 031026 Report	170562203 - 145 Wolcott St	
		Report Period	
		From:	04/07/2026 06:00
		To:	04/07/2026 18:00
		PM10 Action Level:	150 µg/m³
VOC Action Level:	5 ppm		

Daily Environmental Summary	Temp (°F)	Relative Humidity (%)	Barometer (inHg)	Wind Speed (mph)	Prevailing Wind Direction
04/07/2026	45.1 - 55.4	27.4 - 63.8	30.1 - 30.3	1.6 - 16.1	WNW

Daily Monitoring Summary	PM10 (µg/m³)	Time	VOC (ppm)	Time
Min Contribution (15 min avg.) - 4/7/2026	-131.4	10:25	-0.0853	11:39
Max Contribution (15 min avg.) - 4/7/2026	110.4	12:20	0.1133	12:22
Daily Avg. Contribution (15 min avg.) - 4/7/2026	-0.7	-	0.0003	-

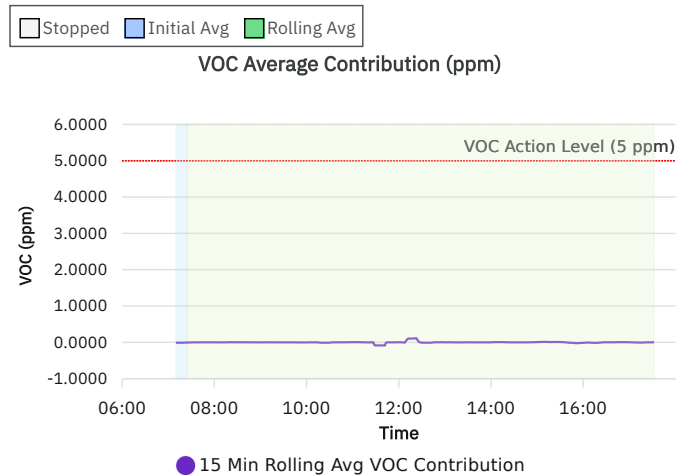
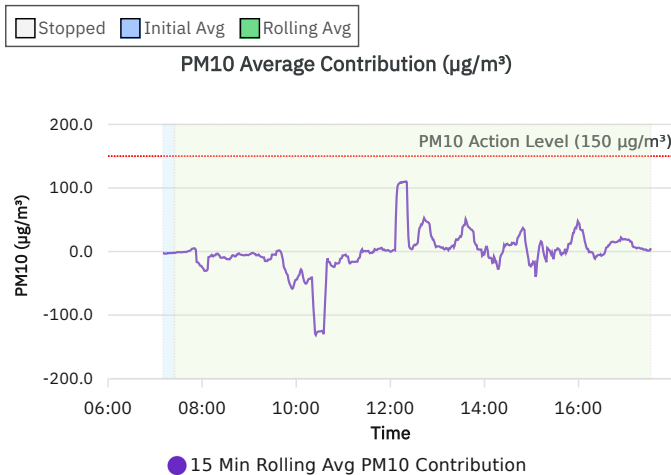
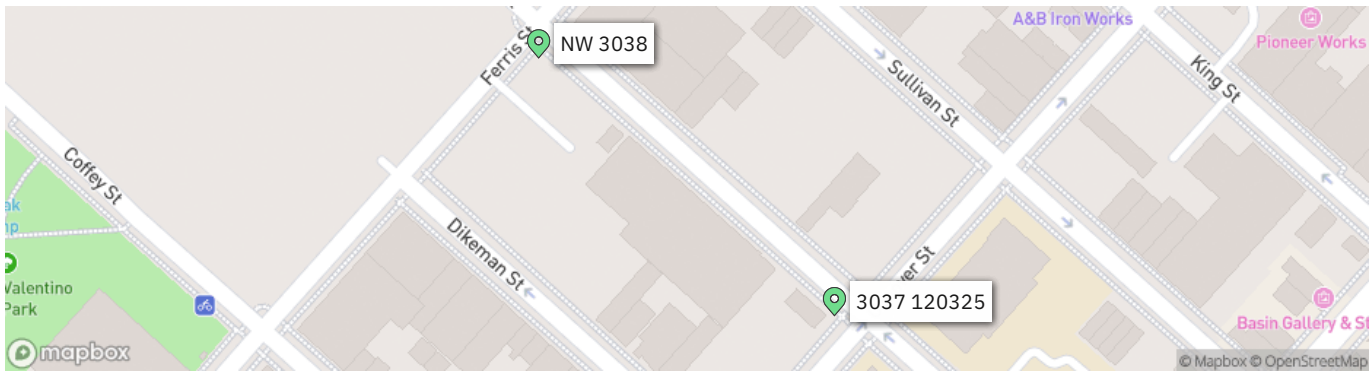

LANGAN SITE OBSERVATION REPORT- Day 152

PROJECT No.: 170452203	CLIENT: NYM 145 Wolcott, LLC 233 Broadway, 10 th Fl., New York, NY 10279	DATE: Wed., April 08, 2026
PROJECT: 145-165 Wolcott Street		WEATHER: Clear, 29 - 54°F Wind: SW @ 0.8 – 5.9 mph
LOCATION: Brooklyn, New York		TIME: 6:45 am – 6:00 pm
SITE CODE: C224256		MONITOR: Brayden Klein

EQUIPMENT: AQS1 Air Monitoring Station x 2 MiniRAE 3000 Photoionization Detector (PID) CAT 335F x 2 Zaxis 135US Hyundai HL955A Bauer BG 36 H ABI TM22 RTG RG 27S Hitachi 670 Takeuchi TB260 Terex TA9 TB260 Kubota KX080-4α2 BW120 AD	PRESENT AT SITE: Langan (Environmental): Brayden Klein, Richo Brian Urban Atelier Group (UAG) ECD NY Inc. (ECD): Kyle McGovern
--	---

OBSERVATIONS, DISCUSSIONS, TEST RESULTS, ETC.:

Langan was present to document remediation activities in accordance with the New York State Department of Environmental Conservation (NYSDEC)-approved July 22, 2025 Remedial Action Work Plan (RAWP) at the 145-165 Wolcott Street site in Brooklyn, New York (Site No. C224256).

Site Activities

- ECD used a CAT 335F to grade an about 10-foot-long by 10-feet-wide area in the central part of the site.
 - Graded clean fill was added to the stockpile adjacent to the work area for future on-site reuse.
 - Graded clean fill was screened for odors, staining, and organic vapors using a PID. No impacts were observed.
- ECD used a Kubota KX080-4α2 to backfill an about 10-foot-long by 10-feet-wide area from with previously imported clean fill from about 4.5 feet below grade surface to surface grade in the eastern part of the site.
- ECD used a CAT 335F to relocate a stockpile made up of previously imported clean fill from the central part of the site to the eastern part of the site for future backfill.
- ECD installed Preprufe 300R Plus waterproofing/vapor barrier membrane atop the rat slab within an about 50-foot-long by 30-feet-wide area in the central part of the site.

Material Tracking

- No material was imported into the site.

Cc: M. Burke, G. Nicholls, S. Knoop, N. Palumbo, L. Grose	By: Brayden Klein
	Langan Eng, Env, Surv, L.A. & Geo, DPC

LANGAN SITE OBSERVATION REPORT- Day 152

- No material was exported from the site.

Material Export Summary – Soil										
Facility Name Location	Clean Earth of North Jersey Kearny, NJ									
Material	Non-Hazardous Low pH Soil		Hazardous Lead Impacted Soil with UHCs		Hazardous Lead Impacted Soil with No UHCs		High Hazardous Lead		Non-Hazardous Soil	
Quantities	No. of Loads	Approx. Volume (CY)	No. of Loads	Approx. Volume (CY)	No. of Loads	Approx. Volume (CY)	No. of Loads	Approx. Volume (CY)	No. of Loads	Approx. Volume (CY)
Today	-	-	-	-	-	-	-	-	-	-
Project Total	332	5,495	56	901	27	467	5	68	1	18

Notes:

- UHC – Underlying Hazardous Constituent

Material Export Summary – Soil						
Facility Name Location	Clean Earth of New Castle New Castle, DE		Conestoga Landfill Morgantown, PA		Waste Management Morgantown, PA	
Material	Non-Hazardous Soil		Non-Hazardous Soil		Non-Hazardous Soil	
Quantities	No. of Loads	Approx. Volume (CY)	No. of Loads	Approx. Volume (CY)	No. of Loads	Approx. Volume (CY)
Today	-	-	-	-	-	-
Project Total	729	13,682	39	703	224	4,007

Material Export Summary – C&D						
Facility Name Location	PPark NJ, LLC Prospect Park, NJ		Bayshore Soil Management, LLC Keasbey, NJ		Silva Recycling, LLC Newark, NJ	
Material	Asphalt, Concrete		Asphalt, Concrete		Concrete	
Quantities	No. of Loads	Approx. Volume (CY)	No. of Loads	Approx. Volume (CY)	No. of Loads	Approx. Volume (CY)
Today	-	-	-	-	-	-
Project Total	119	2,380	31	645	25	880

Cc: M. Burke, G. Nicholls, S. Knoop,
N. Palumbo, L. Grose

By: Brayden Klein

Langan Eng, Env, Surv, L.A. & Geo, DPC

Material Import Summary										
Facility Name	Impact Materials, LLC		Callahan & Nannini Quarry Inc.		Durante Brothers Construction		Tilcon West Nyack Quarry		B.G.L.J Servicing Corp	
Location	Jersey City, NJ		Salisbury Mills, NY		Flushing, NY		West Nyack, NY		Moriches, NY	
Material	3/4" Recycled Clean Stone		2-4" Granite Stone		Clean Fill		ASTM No. 5 Stone		Virgin Sand	
Quantities	No. of Loads	Approx. Volume (CY)	No. of Loads	Approx. Volume (CY)	No. of Loads	Approx. Volume (CY)	No. of Loads	Approx. Volume (CY)	No. of Loads	Approx. Volume (CY)
Today	-	-	-	-	-	-	-	-	-	-
Project Total	63	1,134	2	36	638	11,484	44	792	1	18

Samples

- No samples were collected.

Community Air Monitoring Plan (CAMP) Activities

- Langan performed community air monitoring at the perimeter of the work area at one upwind and one downwind location during intrusive work. Implementation of the Community Air Monitoring Plan (CAMP) included air monitoring for particulate matter for particulates less than 10 µm in diameter (PM10) and volatile organic compounds (VOC). PM10 and VOC concentrations did not exceed the action levels established by the community air monitoring plan.
- No fugitive dust or odors associated with site activities were observed migrating from the site.

Anticipated Activities

- ECD will continue excavating and backfilling for utility piping in the central part of the site.
- ECD will continue foundation framing and concrete pouring in the central part of the site.
- ECD will continue laying polyvinyl chloride piping, geotextile fabric, and ¾-inch virgin stone as part of the sub slab depressurization system and soil vapor extrusion system installation in the western part of the site.

Cc: M. Burke, G. Nicholls, S. Knoop,
N. Palumbo, L. Grose

By: Brayden Klein

Langan Eng, Env, Surv, L.A. & Geo, DPC

Figure 1: Site Map

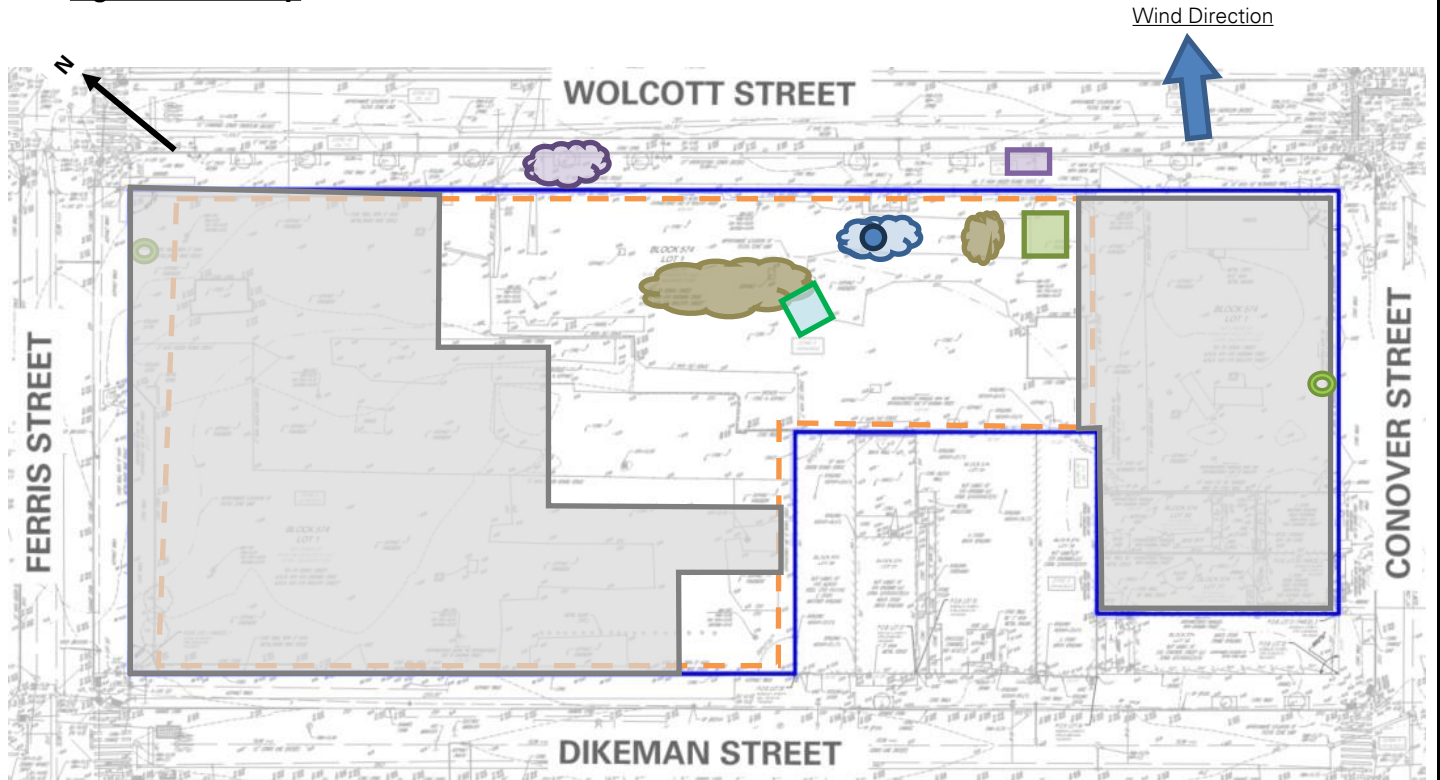

Legend

	Site Boundary-		Approximate Area Excavated
	Approximate Work Area		Approximate Area Backfilled
	Approximate Location of Perimeter CAMP Station		Approximate Area Graded
	Approximate Location of Installed Site Cover System		Approximate C&D Stockpile
	Approximate IDW Drum Staging Area		Approximate Non-Native Fill Stockpile
	Approximate Steel Tank Location		Approximate Stone Stockpile
			Approximate Imported Clean Fill Stockpile

Notes:

1. Basemap is referenced from 26 March 2025 ALTA/NSPS Land Title Survey prepared by Control Point Associates Inc PC.
2. IDW – Investigation-derived waste generated during the April 2025 and August 2025 supplemental waste characterizations and the January through May 2025 non-aqueous phase liquid gauging.

Cc: M. Burke, G. Nicholls, S. Knoop,
N. Palumbo, L. Grose

By: Brayden Klein

Langan Eng, Env, Surv, L.A. & Geo, DPC

Figure 2: Endpoint / Sidewalk Sample Location Map

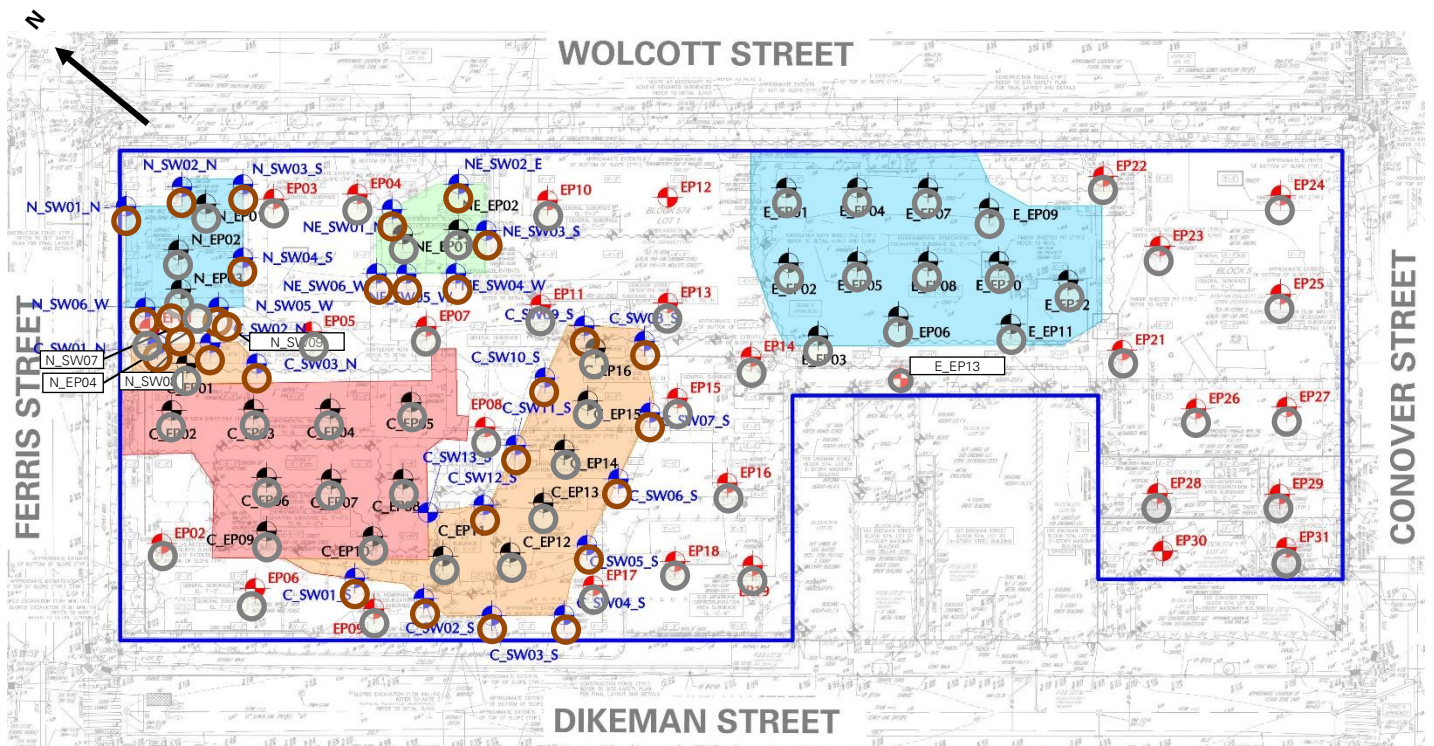

Legend

- Site Boundary
- Approximate Location of Documentation Endpoint Soil Sample Collected
- Approximate Location of Documentation Sidewalk Soil Sample Collected
- Approximate Location of Previously Collected Documentation Endpoint Soil Sample
- Approximate Location of Previously Collected Documentation Sidewalk Soil Sample

Notes:

1. Basemap is referenced from 26 March 2025 ALTA/NSPS Land Title Survey prepared by Control Point Associates Inc PC.

Cc: M. Burke, G. Nicholls, S. Knoop,
N. Palumbo, L. Grose

By: Brayden Klein
Langan Eng, Env, Surv, L.A. & Geo, DPC

LANGAN SITE OBSERVATION REPORT- Day 152

Photographs



Photo 1: General view of the western part of the site (facing south)



Photo 2: ECD installing Preprufe 300R Plus waterproofing/vapor barrier atop the rat slab in the central part of the site (facing north)

Cc: M. Burke, G. Nicholls, S. Knoop,
N. Palumbo, L. Grose

By: Brayden Klein

Langan Eng, Env, Surv, L.A. & Geo, DPC



Photo 3: ECD backfilling with previously imported clean fill in the central part of the site (facing west)



Photo 4: ECD relocating stockpiled clean fill from the center of the site to the eastern part of the site (facing northwest)

Cc: M. Burke, G. Nicholls, S. Knoop,
N. Palumbo, L. Grose

By: Brayden Klein

Langan Eng, Env, Surv, L.A. & Geo, DPC

LANGAN	Contribution 2 Station 031026 Report	170562203 - 145 Wolcott St	
		Report Period	
		From:	04/08/2026 06:00
		To:	04/08/2026 18:00
		PM10 Action Level:	150 $\mu\text{g}/\text{m}^3$
VOC Action Level:	5 ppm		

Daily Environmental Summary	Temp (°F)	Relative Humidity (%)	Barometer (inHg)	Wind Speed (mph)	Prevailing Wind Direction
04/08/2026	28.8 - 54.1	22.5 - 55.0	30.6 - 30.7	0.8 - 5.9	SW

Daily Monitoring Summary	PM10 ($\mu\text{g}/\text{m}^3$)	Time	VOC (ppm)	Time
Min Contribution (15 min avg.) - 4/8/2026	-43.6	15:36	-0.1100	07:12
Max Contribution (15 min avg.) - 4/8/2026	161.3	16:47	0.0433	09:18
Daily Avg. Contribution (15 min avg.) - 4/8/2026	10.7	-	-0.0014	-

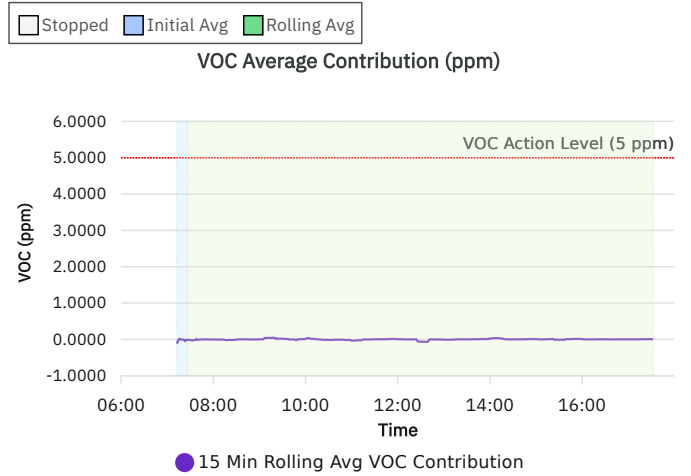
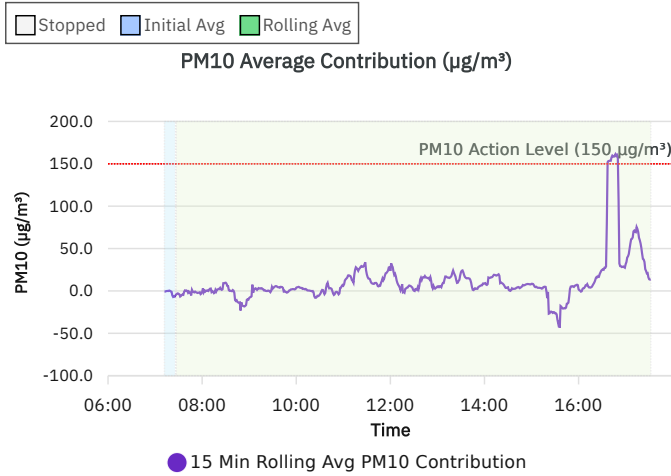
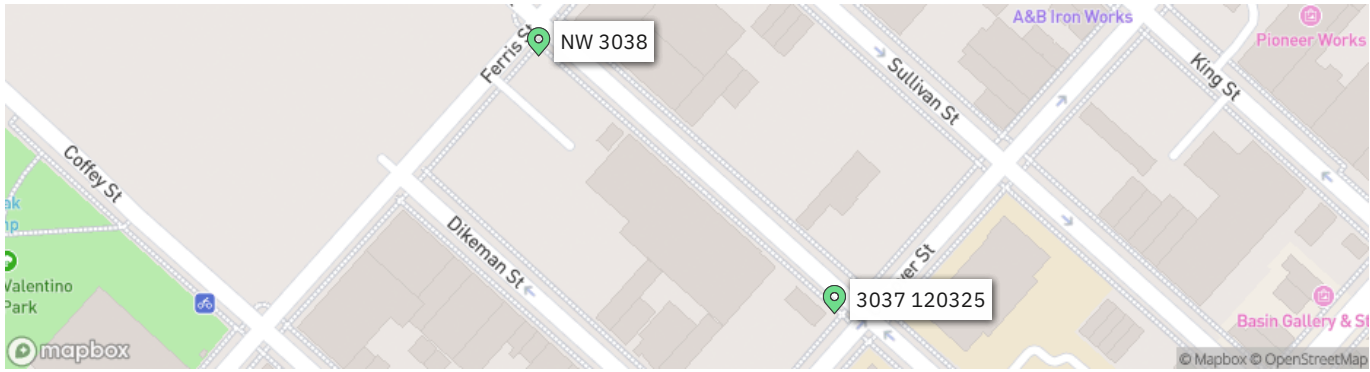

LANGAN SITE OBSERVATION REPORT- Day 153

PROJECT No.: 170452203	CLIENT: NYM 145 Wolcott, LLC 233 Broadway, 10 th Fl., New York, NY 10279	DATE: Thu., April 09, 2026
PROJECT: 145-165 Wolcott Street		WEATHER: Clear, 30 - 56°F Wind: SSE @ 0.6 – 7.4 mph
LOCATION: Brooklyn, New York		TIME: 6:45 am – 5:45 pm
SITE CODE: C224256		MONITOR: Alexandre Beregi

EQUIPMENT: AQS1 Air Monitoring Station x 2 MiniRAE 3000 Photoionization Detector (PID) CAT 335F x 2 Zaxis 135US Hyundai HL955A Bauer BG 36 H ABI TM22 RTG RG 27S Hitachi 670 Takeuchi TB260 Terex TA9 TB260 Kubota KX080-4α2 BW120 AD	PRESENT AT SITE: Langan (Environmental): Alexandre Beregi Urban Atelier Group (UAG) ECD NY Inc. (ECD): Kyle McGovern Coastal Environmental Solutions (Driller): Brandon Sullivan, Austin Panettieri
--	---

OBSERVATIONS, DISCUSSIONS, TEST RESULTS, ETC.:

Langan was present to document remediation activities in accordance with the New York State Department of Environmental Conservation (NYSDEC)-approved July 22, 2025 Remedial Action Work Plan (RAWP) at the 145-165 Wolcott Street site in Brooklyn, New York (Site No. C224256).

Site Activities

- ECD used a CAT 335F to grade an about 15-foot-long by 15-foot-wide area and an about 30-foot-long by 15-foot-wide area in the central part of the site.
 - Graded clean fill was added to an existing clean fill stockpile adjacent to the work area for future on-site reuse.
 - Graded clean fill was screened for odors, staining, and organic vapors using a PID. No impacts were observed.
- ECD used a Kubota KX080-4α2 to backfill an about 20-foot-long by 8-foot-wide area from with previously imported and stockpiled clean fill from about 4.5 feet below grade surface to surface grade in the eastern part of the site.
- Coastal decommissioned the 4 groundwater monitoring wells (MW-1, MW-2, MW-3, and MW-4) via grouting in place with tremie pump in accordance with NYSDEC Commissioner’s Policy-43: Groundwater Monitoring Well Decommissioning Policy. The monitoring well decommissioning forms will be included in the Final Engineering Report.

Cc: M. Burke, G. Nicholls, S. Knoop, N. Palumbo, L. Grose	By: Alexandre Beregi
Langan Eng, Env, Surv, L.A. & Geo, DPC	

Material Tracking

- No material was imported into the site.
- No material was exported from the site.

Material Export Summary – Soil										
Facility Name Location	Clean Earth of North Jersey Kearny, NJ									
Material	Non-Hazardous Low pH Soil		Hazardous Lead Impacted Soil with UHCs		Hazardous Lead Impacted Soil with No UHCs		High Hazardous Lead		Non-Hazardous Soil	
Quantities	No. of Loads	Approx. Volume (CY)	No. of Loads	Approx. Volume (CY)	No. of Loads	Approx. Volume (CY)	No. of Loads	Approx. Volume (CY)	No. of Loads	Approx. Volume (CY)
Today	-	-	-	-	-	-	-	-	-	-
Project Total	332	5,495	56	901	27	467	5	68	1	18

Notes:

1. UHC – Underlying Hazardous Constituent

Material Export Summary – Soil						
Facility Name Location	Clean Earth of New Castle New Castle, DE		Conestoga Landfill Morgantown, PA		Waste Management Morgantown, PA	
Material	Non-Hazardous Soil		Non-Hazardous Soil		Non-Hazardous Soil	
Quantities	No. of Loads	Approx. Volume (CY)	No. of Loads	Approx. Volume (CY)	No. of Loads	Approx. Volume (CY)
Today	-	-	-	-	-	-
Project Total	729	13,682	39	703	224	4,007

Material Export Summary – C&D						
Facility Name Location	PPark NJ, LLC Prospect Park, NJ		Bayshore Soil Management, LLC Keasbey, NJ		Silva Recycling, LLC Newark, NJ	
Material	Asphalt, Concrete		Asphalt, Concrete		Concrete	
Quantities	No. of Loads	Approx. Volume (CY)	No. of Loads	Approx. Volume (CY)	No. of Loads	Approx. Volume (CY)
Today	-	-	-	-	-	-
Project Total	119	2,380	31	645	25	880

Cc: M. Burke, G. Nicholls, S. Knoop,
N. Palumbo, L. Grose

By: Alexandre Beregi
Langan Eng, Env, Surv, L.A. & Geo, DPC

Material Import Summary										
Facility Name Location	Impact Materials, LLC Jersey City, NJ		Callahan & Nannini Quarry Inc. Salisbury Mills, NY		Durante Brothers Construction Flushing, NY		Tilcon West Nyack Quarry West Nyack, NY		B.G.L.J Servicing Corp Moriches, NY	
Material	3/4" Recycled Clean Stone		2-4" Granite Stone		Clean Fill		ASTM No. 5 Stone		Virgin Sand	
Quantities	No. of Loads	Approx. Volume (CY)	No. of Loads	Approx. Volume (CY)	No. of Loads	Approx. Volume (CY)	No. of Loads	Approx. Volume (CY)	No. of Loads	Approx. Volume (CY)
Today	-	-	-	-	-	-	-	-	-	-
Project Total	63	1,134	2	36	638	11,484	44	792	1	18

Samples

- No samples were collected.

Community Air Monitoring Plan (CAMP) Activities

- Langan performed community air monitoring at the perimeter of the work area at one upwind and one downwind location during intrusive work. Implementation of the Community Air Monitoring Plan (CAMP) included air monitoring for particulate matter for particulates less than 10 µm in diameter (PM10) and volatile organic compounds (VOC). PM10 and VOC concentrations did not exceed the action levels established by the community air monitoring plan.
- No fugitive dust or odors associated with site activities were observed migrating from the site.

Anticipated Activities

- ECD will continue excavating and backfilling for utility piping in the central part of the site.
- ECD will continue foundation framing and concrete pouring in the central part of the site.
- ECD will continue laying polyvinyl chloride piping, geotextile fabric, and ¾-inch virgin stone as part of the sub slab depressurization system and soil vapor extrusion system installation in the western part of the site.

Cc: M. Burke, G. Nicholls, S. Knoop,
N. Palumbo, L. Grose

By: Alexandre Beregi

Langan Eng, Env, Surv, L.A. & Geo, DPC

Figure 1: Site Map

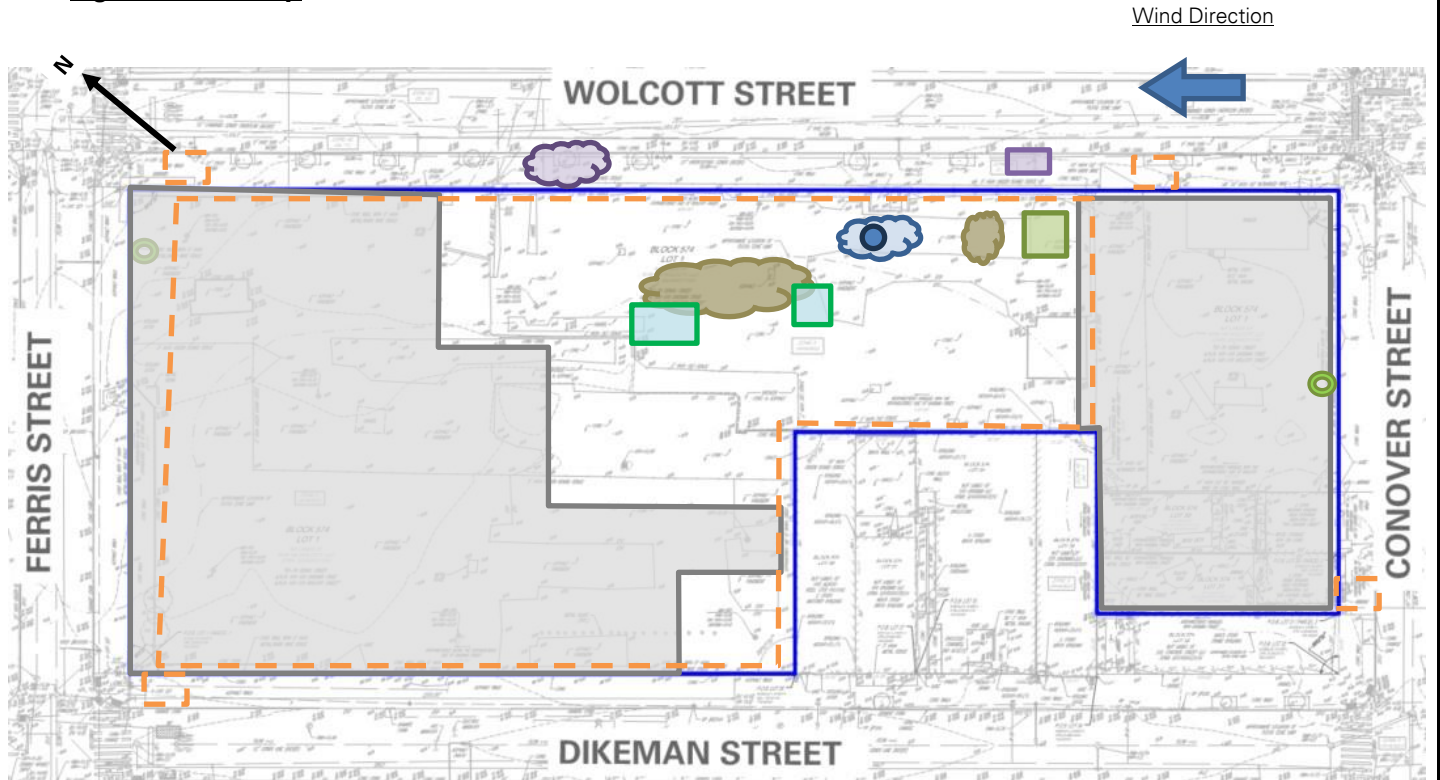

Legend

	Site Boundary-		Approximate Area Excavated
	Approximate Work Area		Approximate Area Backfilled
	Approximate Location of Perimeter CAMP Station		Approximate Area Graded
	Approximate Location of Installed Site Cover System		Approximate C&D Stockpile
	Approximate IDW Drum Staging Area		Approximate Non-Native Fill Stockpile
	Approximate Steel Tank Location		Approximate Stone Stockpile
			Approximate Imported Clean Fill Stockpile

Notes:

1. Basemap is referenced from 26 March 2025 ALTA/NSPS Land Title Survey prepared by Control Point Associates Inc PC.
2. IDW – Investigation-derived waste generated during the April 2025 and August 2025 supplemental waste characterizations and the January through May 2025 non-aqueous phase liquid gauging.

Cc: M. Burke, G. Nicholls, S. Knoop,
N. Palumbo, L. Grose

By: Alexandre Beregi
Langan Eng, Env, Surv, L.A. & Geo, DPC

Figure 2: Endpoint / Sidewall Sample Location Map

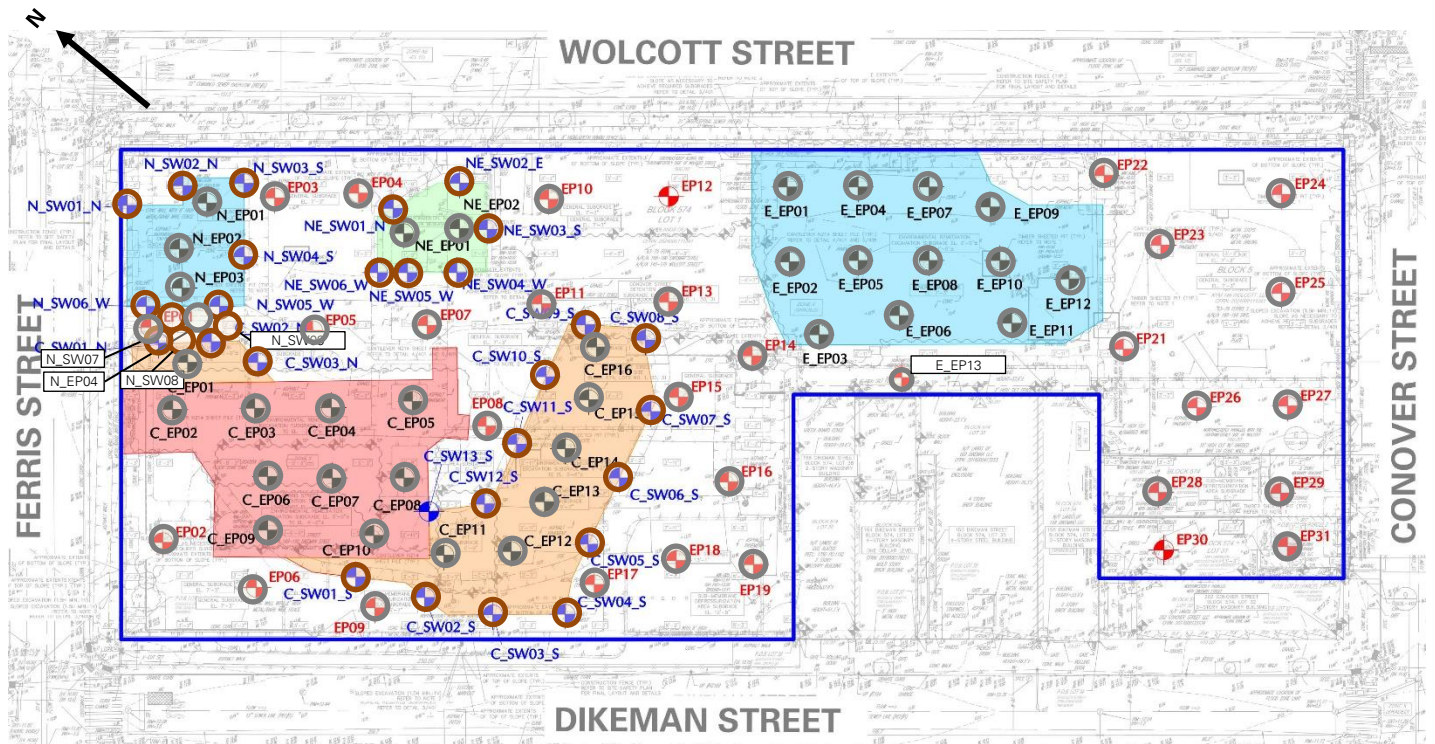

Legend

- Site Boundary
- Approximate Location of Documentation Endpoint Soil Sample Collected
- Approximate Location of Documentation Sidewall Soil Sample Collected
- Approximate Location of Previously Collected Documentation Endpoint Soil Sample
- Approximate Location of Previously Collected Documentation Sidewall Soil Sample

Notes:

1. Basemap is referenced from 26 March 2025 ALTA/NSPS Land Title Survey prepared by Control Point Associates Inc PC.

Cc: M. Burke, G. Nicholls, S. Knoop,
N. Palumbo, L. Grose

By: Alexandre Beregi
Langan Eng, Env, Surv, L.A. & Geo, DPC

Photographs

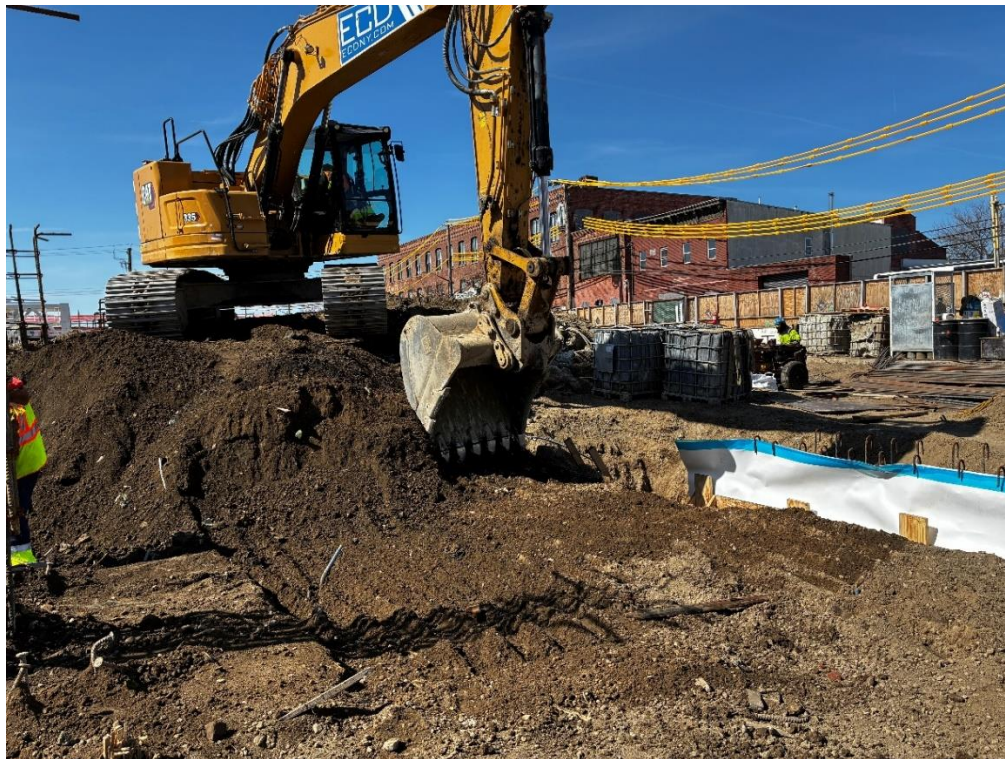

Photo 1: ECD using a CAT 335F to grade clean fill in the central part of the site (facing north)



Photo 2: Coastal hand mixing grout for monitoring well decommissioning.

Cc: M. Burke, G. Nicholls, S. Knoop,
N. Palumbo, L. Grose

By: Alexandre Beregi
Langan Eng, Env, Surv, L.A. & Geo, DPC



Photo 3: ECD using a Kubota KX080-4 $\alpha 2$ to backfill previously imported clean fill in the central part of the site (facing west)

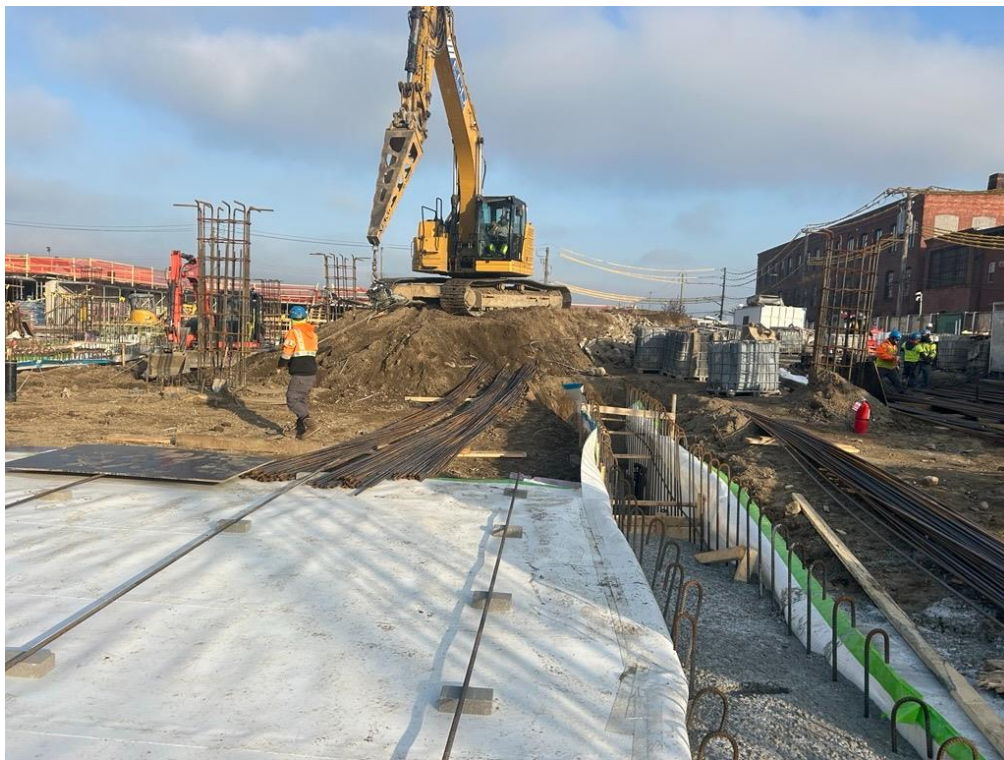

Photo 4: General view of the central part of the site (facing north)

Cc: M. Burke, G. Nicholls, S. Knoop,
N. Palumbo, L. Grose

By: Alexandre Beregi
Langan Eng, Env, Surv, L.A. & Geo, DPC

LANGAN	Contribution 2 Station 031026 Report	170562203 - 145 Wolcott St	
		Report Period	
		From:	04/09/2026 06:00
		To:	04/09/2026 18:00
		PM10 Action Level:	150 µg/m³
VOC Action Level:	5 ppm		

Daily Environmental Summary	Temp (°F)	Relative Humidity (%)	Barometer (inHg)	Wind Speed (mph)	Prevailing Wind Direction
04/09/2026	30.4 - 55.6	45.1 - 84.4	30.5 - 30.7	0.6 - 7.4	SSE

Daily Monitoring Summary	PM10 (µg/m³)	Time	VOC (ppm)	Time
Min Contribution (15 min avg.) - 4/9/2026	-43.7	07:45	-0.0687	07:49
Max Contribution (15 min avg.) - 4/9/2026	95.9	11:43	0.1353	15:45
Daily Avg. Contribution (15 min avg.) - 4/9/2026	25.6	-	0.0098	-

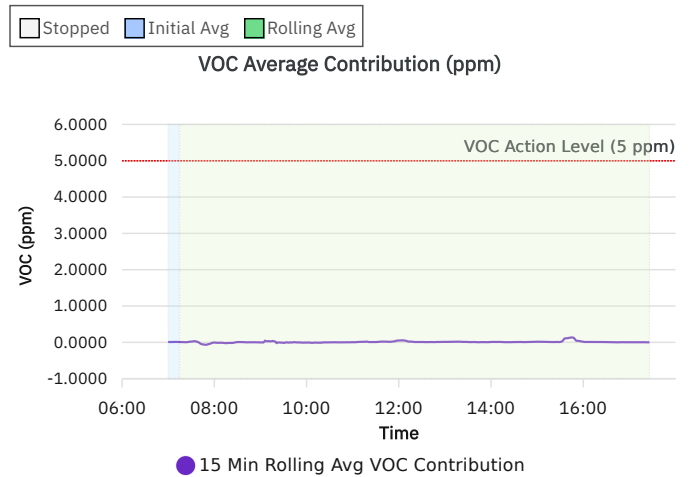
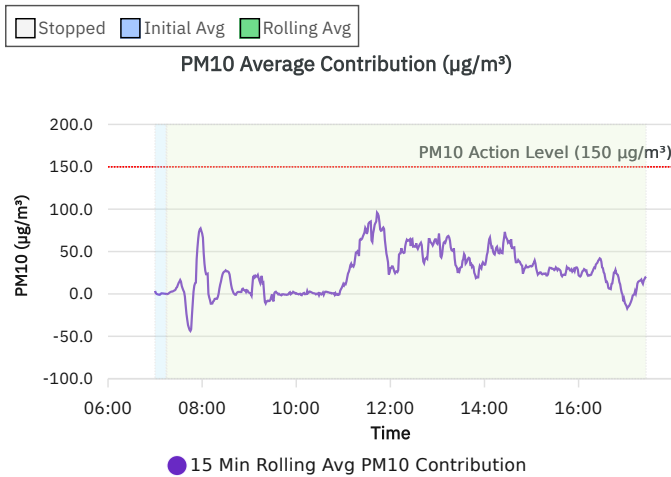
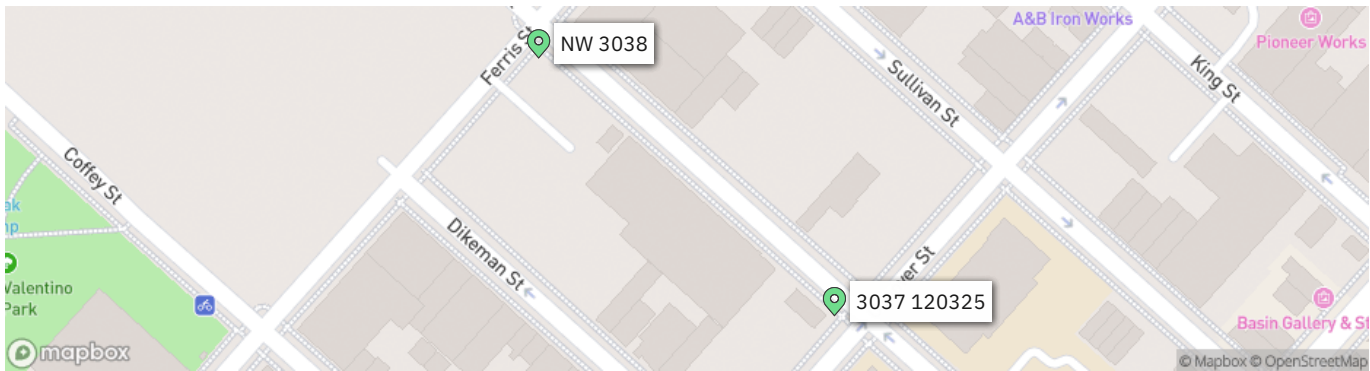

LANGAN SITE OBSERVATION REPORT- Day 154

PROJECT No.: 170452203	CLIENT: NYM 145 Wolcott, LLC 233 Broadway, 10 th Fl., New York, NY 10279	DATE: Fri., April 10, 2026
PROJECT: 145-165 Wolcott Street		WEATHER: Clear, 38 - 65°F Wind: SSE @ 0.5 – 6.3 mph
LOCATION: Brooklyn, New York		TIME: 6:45 am – 6:00 pm
SITE CODE: C224256		MONITOR: Brayden Klein

EQUIPMENT: AQS1 Air Monitoring Station x 2 MiniRAE 3000 Photoionization Detector (PID) CAT 335F x 2 Zaxis 135US Hyundai HL955A Bauer BG 36 H ABI TM22 RTG RG 27S Hitachi 670 Takeuchi TB260 Terex TA9 TB260 Kubota KX080-4α2 BW120 AD	PRESENT AT SITE: Langan (Environmental): Brayden Klein Urban Atelier Group (UAG) ECD NY Inc. (ECD): Kyle McGovern
--	--

OBSERVATIONS, DISCUSSIONS, TEST RESULTS, ETC.:

Langan was present to document remediation activities in accordance with the New York State Department of Environmental Conservation (NYSDEC)-approved July 22, 2025 Remedial Action Work Plan (RAWP) at the 145-165 Wolcott Street site in Brooklyn, New York (Site No. C224256).

Site Activities

- ECD used a CAT 335F to grade an about 20-foot-long by 15-feet-wide area in the central part of the site.
 - Graded clean fill was added to an existing clean fill stockpile adjacent to the work area for future on-site reuse.
- ECD used a Kubota KX080-4α2 to backfill the following areas with previously imported clean fill:
 - An about 75-foot-long by 30-foot-wide area from about 0.5 feet below grade surface (bgs) to surface grade in the central part of the site.
 - An about 10-foot-long by 10-feet-wide area from about 2 feet bgs to surface grade in the western part of the site.
 - Backfill consisted of previously stockpiled clean fill from the central part of the site.
- ECD installed Preprufe 300R Plus waterproofing/vapor barrier membrane atop the rat slab within an about 60-foot-long by 20-feet-wide area in the central part of the site.

Cc: M. Burke, G. Nicholls, S. Knoop, N. Palumbo, L. Grose	By: Brayden Klein
Langan Eng, Env, Surv, L.A. & Geo, DPC	

Material Tracking

- No material was imported into the site.
- No material was exported from the site.

Material Export Summary – Soil										
Facility Name Location	Clean Earth of North Jersey Kearny, NJ									
Material	Non-Hazardous Low pH Soil		Hazardous Lead Impacted Soil with UHCs		Hazardous Lead Impacted Soil with No UHCs		High Hazardous Lead		Non-Hazardous Soil	
Quantities	No. of Loads	Approx. Volume (CY)	No. of Loads	Approx. Volume (CY)	No. of Loads	Approx. Volume (CY)	No. of Loads	Approx. Volume (CY)	No. of Loads	Approx. Volume (CY)
Today	-	-	-	-	-	-	-	-	-	-
Project Total	332	5,495	56	901	27	467	5	68	1	18

Notes:

1. UHC – Underlying Hazardous Constituent

Material Export Summary – Soil						
Facility Name Location	Clean Earth of New Castle New Castle, DE		Conestoga Landfill Morgantown, PA		Waste Management Morgantown, PA	
Material	Non-Hazardous Soil		Non-Hazardous Soil		Non-Hazardous Soil	
Quantities	No. of Loads	Approx. Volume (CY)	No. of Loads	Approx. Volume (CY)	No. of Loads	Approx. Volume (CY)
Today	-	-	-	-	-	-
Project Total	729	13,682	39	703	224	4,007

Material Export Summary – C&D						
Facility Name Location	PPark NJ, LLC Prospect Park, NJ		Bayshore Soil Management, LLC Keasbey, NJ		Silva Recycling, LLC Newark, NJ	
Material	Asphalt, Concrete		Asphalt, Concrete		Concrete	
Quantities	No. of Loads	Approx. Volume (CY)	No. of Loads	Approx. Volume (CY)	No. of Loads	Approx. Volume (CY)
Today	-	-	-	-	-	-
Project Total	119	2,380	31	645	25	880

Cc: M. Burke, G. Nicholls, S. Knoop,
N. Palumbo, L. Grose

By: Brayden Klein

Langan Eng, Env, Surv, L.A. & Geo, DPC

Material Import Summary										
Facility Name Location	Impact Materials, LLC Jersey City, NJ		Callahan & Nannini Quarry Inc. Salisbury Mills, NY		Durante Brothers Construction Flushing, NY		Tilcon West Nyack Quarry West Nyack, NY		B.G.L.J Servicing Corp Moriches, NY	
Material	3/4" Recycled Clean Stone		2-4" Granite Stone		Clean Fill		ASTM No. 5 Stone		Virgin Sand	
Quantities	No. of Loads	Approx. Volume (CY)	No. of Loads	Approx. Volume (CY)	No. of Loads	Approx. Volume (CY)	No. of Loads	Approx. Volume (CY)	No. of Loads	Approx. Volume (CY)
Today	-	-	-	-	-	-	-	-	-	-
Project Total	63	1,134	2	36	638	11,484	44	792	1	18

Samples

- No samples were collected.

Community Air Monitoring Plan (CAMP) Activities

- Langan performed community air monitoring at the perimeter of the work area at one upwind and one downwind location during intrusive work. Implementation of the Community Air Monitoring Plan (CAMP) included air monitoring for particulate matter for particulates less than 10 µm in diameter (PM10) and volatile organic compounds (VOC). VOC concentrations did not exceed the action levels established by the community air monitoring plan.
- PM10 exceeded the 15-minute time-weighted-average (TWA) site contribution action level of 150 micrograms per cubic meter (µg/m³) for 16 minutes from 3:53 to 4:08 PM. The exceedance was attributed to dust generated from concrete ready-mix trucks entering the northern part of the site and was mitigated by the Contractor spraying the tracking pad with water. Work was temporarily halted until PM10 concentrations returned to below action levels.
- No fugitive dust or odors associated with site activities were observed migrating from the site.

Anticipated Activities

- ECD will continue excavating and backfilling for utility piping in the central part of the site.
- ECD will continue foundation framing and concrete pouring in the central part of the site.
- ECD will continue laying polyvinyl chloride piping, geotextile fabric, and ¾-inch virgin stone as part of the sub slab depressurization system and soil vapor extrusion system installation in the western part of the site.

Cc: M. Burke, G. Nicholls, S. Knoop,
N. Palumbo, L. Grose

By: Brayden Klein

Langan Eng, Env, Surv, L.A. & Geo, DPC

Figure 1: Site Map

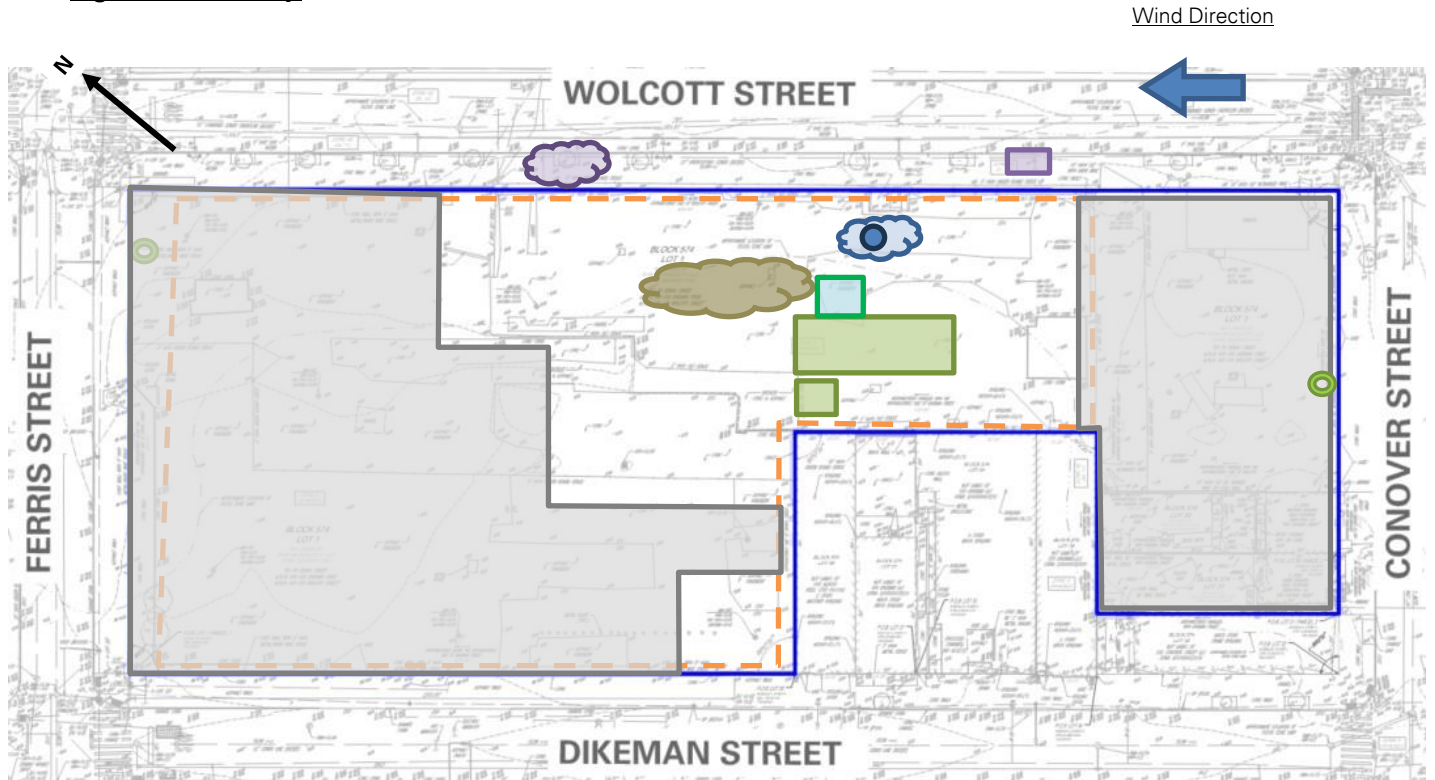

Legend

	Site Boundary-		Approximate Area Excavated
	Approximate Work Area		Approximate Area Backfilled
	Approximate Location of Perimeter CAMP Station		Approximate Area Graded
	Approximate Location of Installed Site Cover System		Approximate C&D Stockpile
	Approximate IDW Drum Staging Area		Approximate Non-Native Fill Stockpile
	Approximate Steel Tank Location		Approximate Stone Stockpile
			Approximate Imported Clean Fill Stockpile

Notes:

1. Basemap is referenced from 26 March 2025 ALTA/NSPS Land Title Survey prepared by Control Point Associates Inc PC.
2. IDW – Investigation-derived waste generated during the April 2025 and August 2025 supplemental waste characterizations and the January through May 2025 non-aqueous phase liquid gauging.

Cc: M. Burke, G. Nicholls, S. Knoop,
N. Palumbo, L. Grose

By: Brayden Klein

Langan Eng, Env, Surv, L.A. & Geo, DPC

Figure 2: Endpoint / Sidewalk Sample Location Map

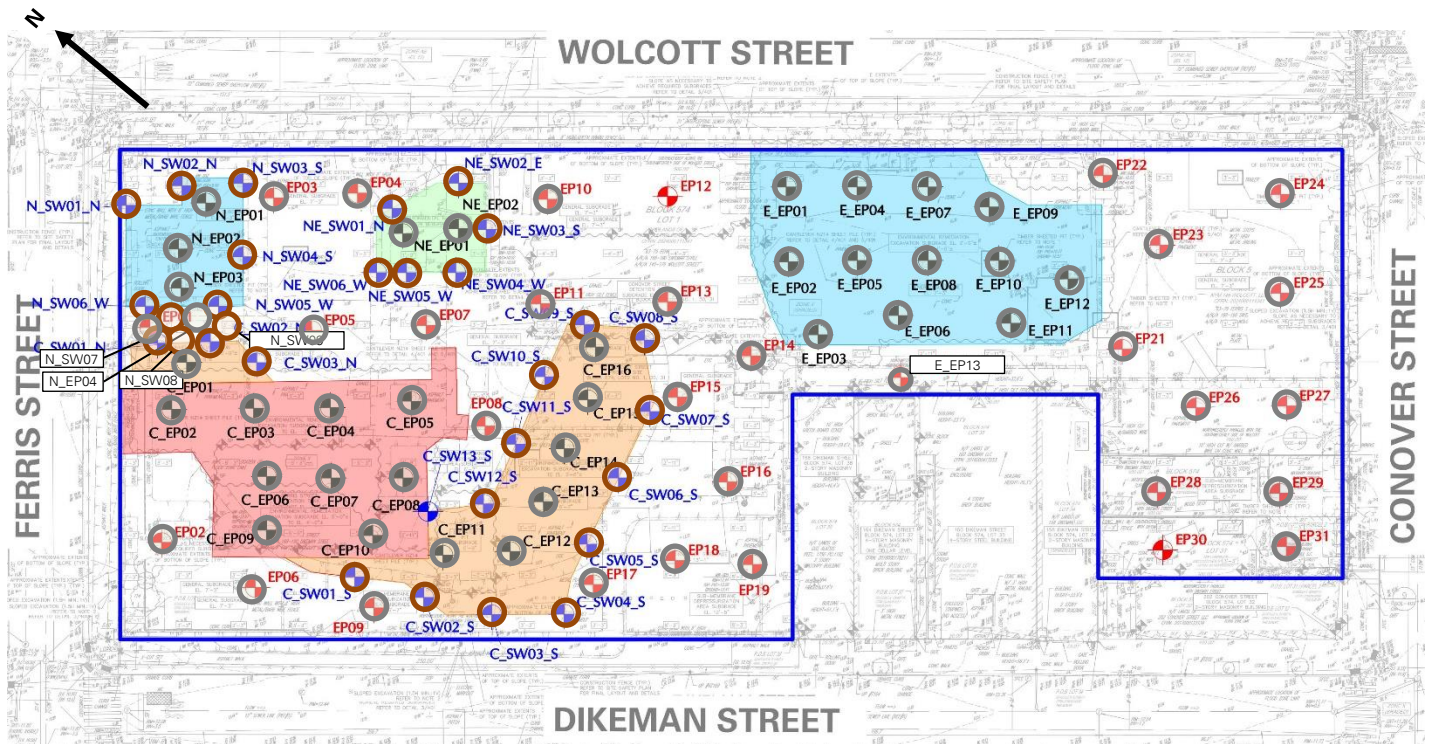

Legend

- Site Boundary
- Approximate Location of Documentation Endpoint Soil Sample Collected
- Approximate Location of Documentation Sidewalk Soil Sample Collected
- Approximate Location of Previously Collected Documentation Endpoint Soil Sample
- Approximate Location of Previously Collected Documentation Sidewalk Soil Sample

Notes:

1. Basemap is referenced from 26 March 2025 ALTA/NSPS Land Title Survey prepared by Control Point Associates Inc PC.

Cc: M. Burke, G. Nicholls, S. Knoop,
N. Palumbo, L. Grose

By: Brayden Klein
Langan Eng, Env, Surv, L.A. & Geo, DPC

Photographs



Photo 1: ECD grading previously imported clean fill in the central part of site (facing east)



Photo 2: ECD backfilling previously imported clean fill in the western part of the site (facing west)

Cc: M. Burke, G. Nicholls, S. Knoop,
N. Palumbo, L. Grose

By: Brayden Klein

Langan Eng, Env, Surv, L.A. & Geo, DPC



Photo 3: ECD installing Preprufe 300R Plus waterproofing / vapor barrier in the western part of the site (facing south)



Photo 4: ECD backfilling with previously imported clean fill in the central part of the site (facing north)

Cc: M. Burke, G. Nicholls, S. Knoop,
N. Palumbo, L. Grose

By: Brayden Klein

Langan Eng, Env, Surv, L.A. & Geo, DPC

LANGAN	Contribution 2 Station 031026 Report	170562203 - 145 Wolcott St	
		Report Period	
		From:	04/10/2026 06:00
		To:	04/10/2026 18:00
		PM10 Action Level:	150 $\mu\text{g}/\text{m}^3$
VOC Action Level:	5 ppm		

Daily Environmental Summary	Temp (°F)	Relative Humidity (%)	Barometer (inHg)	Wind Speed (mph)	Prevailing Wind Direction
04/10/2026	37.8 - 64.9	43.4 - 86.5	30.2 - 30.4	0.5 - 6.3	SSE

Daily Monitoring Summary	PM10 ($\mu\text{g}/\text{m}^3$)	Time	VOC (ppm)	Time
Min Contribution (15 min avg.) - 4/10/2026	-19.6	11:42	-0.0200	07:13
Max Contribution (15 min avg.) - 4/10/2026	377.6	16:05	0.0893	16:28
Daily Avg. Contribution (15 min avg.) - 4/10/2026	36.7	-	0.0080	-

