

## SITE OBSERVATION REPORT

<b>PROJECT No.:</b> 170552901		<b>DATE:</b> Wednesday, November 9, 2022
<b>PROJECT:</b> 159 Boerum Street	<b>CLIENT:</b> SPG Boerum LLC	<b>WEATHER:</b> Partly Cloudy, 40-56 °F Wind: NNE @ 1.6-3.2 mph
<b>LOCATION:</b> Brooklyn, NY		<b>TIME:</b> 6:30 am to 5:15 pm
<b>CONTRACTOR:</b> SD Builders		<b>LANGAN REP. :</b> Lauren Roper
<b>CONTRACTOR'S EQUIPMENT:</b> Hitachi ZX 160LC Excavator Deere 300G Excavator Casagrande C9 Drill Rig	<b>PRESENT AT SITE:</b> Lauren Roper – Langan James Hsu – SD Builders - General Contractor Lucas Alvarez - Rise Concrete (Rise) – Foundation Contractor Able Siquij – Anel Queens Construction Inc. (Anel) – Drilling Contractor	
<b>OBSERVATIONS, DISCUSSIONS, TEST RESULTS, ETC.:</b> <p>Langan was present to observe environmental protocols in accordance with the New York State Department of Environmental Conservation (NYSDEC)-approved Remedial Action Work Plan (RAWP) for Brownfield Cleanup Program (BCP) site C224291 at 159 Boerum Street (Block 3071, Lot 40). Observed activities were as follows:</p> <p><b>Site Activities</b></p> <ul style="list-style-type: none"><li>• Anel used a Casagrande drill rig to install soldier piles along the southern site boundary to a maximum depth of 30 feet below grade surface (bgs).</li><li>• Rise used a Deere excavator to remove the concrete sidewalk in the southern part of the site. Concrete was stockpiled in the eastern-central part of the site to be disposed of as construction and demolition (C&amp;D) debris.</li><li>• Rise placed polyethylene sheeting in the central and southern parts of the site in preparation for import of NYSDEC-approved recycled concrete aggregate (RCA) for the construction of the temporary equipment ramp.</li></ul> <p><b>Material Tracking</b></p> <ul style="list-style-type: none"><li>• No material was exported from the site.</li><li>• No material was imported to the site.</li></ul> <p><b>Sampling</b></p> <ul style="list-style-type: none"><li>• No samples were collected.</li></ul>		
<b>Cc:</b> L. Haley, K. Semon, B. Gochenaur (Langan)	<b>By:</b> Lauren Roper	<b>LANGAN</b>

## SITE OBSERVATION REPORT

### CAMP Activities:

Langan performed on-site air monitoring during ground-intrusive activities for particulate matter smaller than 10 microns in diameter (PM10) or volatile organic compounds (VOCs). Fifteen-minute average concentrations of PM10 and VOCs did not exceed action levels established by the community air monitoring plan (CAMP).

- Concentrations of PM10 and VOCs were not recorded at the downwind monitoring station from 8:09 to 8:21 and 12:12 to 12:47 due to equipment errors. The equipment was recalibrated and the battery was replaced and the issues were resolved. Fugitive dust and odors were not observed leaving the site.

Particulate Monitoring (mg/m <sup>3</sup> )			Organic Vapor Monitoring (ppm)		
Daily background	0.003		Daily Background	0.0	
Averaging Period	Upwind	Downwind	Averaging Period	Upwind	Downwind
Daily Time Weighted Average	0.003	0.005	Daily Time Weighted Average	0.0	0.0
Maximum 15-min Average	0.007	0.023	Maximum 15-min Average	0.0	0.6
Minimum 1-min Instant Reading	0.003	0.005	Minimum 1-min Instant Reading	0.0	0.0
Maximum 1-min Instant Reading	0.012	0.064	Maximum 1-min Instant Reading	0.0	5.4

mg/m<sup>3</sup> = milligrams per cubic meter

ppm = parts per million

NA = Not Available

### Anticipated Activities

- Anel will continue to install soldier piles along the southern site boundary.
- Rise will import recycled concrete aggregate (RCA) to the site for the temporary site ramp.

Cc:	L. Haley, K. Semon, B. Gochenaur (Langan)	By:	Lauren Roper
			<b>LANGAN</b>

## SITE OBSERVATION REPORT

Figure 1: Site Map

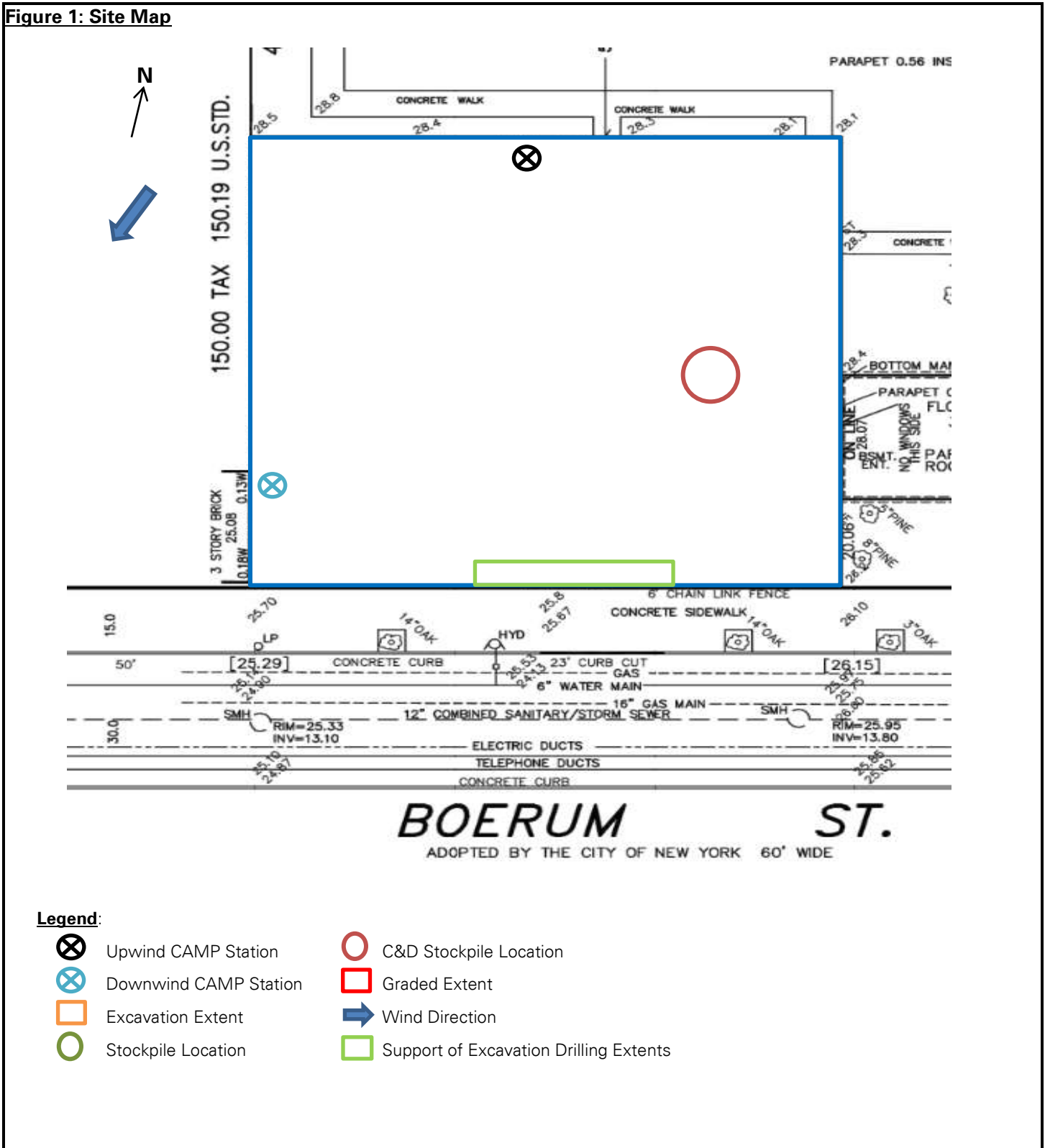

**Legend:**

- Upwind CAMP Station
- Downwind CAMP Station
- Excavation Extent
- Stockpile Location
- C&D Stockpile Location
- Graded Extent
- Wind Direction
- Support of Excavation Drilling Extents

Cc:	L. Haley, K. Semon, B. Gochenaur (Langan)	By:	Lauren Roper <b>LANGAN</b>
-----	---	-----	-------------------------------

## SITE OBSERVATION REPORT

### SITE PHOTOGRAPHS



**Photo 1:** View of Anel installing soldier piles along the southern site boundary (facing east)..



**Photo 2:** General view of the site at the end of the work day (facing northwest).

Cc:	L. Haley, K. Semon, B. Gochenaur (Langan)	By:	Lauren Roper
			<b>LANGAN</b>