

SITE OBSERVATION REPORT

PROJECT No.: 170552901 PROJECT: 159 Boerum Street LOCATION: Brooklyn, NY	CLIENT: SPG Boerum LLC	DATE: Tuesday, January 10, 2023 WEATHER: Overcast, 35-43 °F Wind: NW @ 2.2-3.9 mph TIME: 6:45 am to 2:00 pm
CONTRACTOR: SD Builders		LANGAN REP. : Lauren Roper
CONTRACTOR'S EQUIPMENT: Hitachi ZX 160LC Excavator Deere 300G Excavator Kubota SVL65-2 Skid Steer Deere 135G Excavator Deere 259 Forklift	PRESENT AT SITE: Lauren Roper – Langan James Hsu, Kevin Gray, Tim Flynn – SD Builders - General Contractor Lucas Alvarez - Rise Concrete (Rise) – Foundation Contractor	
OBSERVATIONS, DISCUSSIONS, TEST RESULTS, ETC.: Langan was present to observe environmental protocols in accordance with the New York State Department of Environmental Conservation (NYSDEC)-approved Remedial Action Work Plan (RAWP) for Brownfield Cleanup Program (BCP) site C224291 at 159 Boerum Street (Block 3071, Lot 40). Observed activities were as follows: Site Activities <ul style="list-style-type: none"> • Rise graded the following areas to install support of excavation (SOE) underpinning at about 17 feet below grade surface (bgs): <ul style="list-style-type: none"> ○ An about 60-foot-long by 20-foot wide area in the western part of the site ○ An about 20-foot-long by 5-foot wide area in the southwestern part of the site 		
Cc:	L. Haley, K. Semon, B. Gochenaur (Langan)	By: Lauren Roper LANGAN

SITE OBSERVATION REPORT

Material Tracking

- No material was imported to the site.
- No material was exported from the site.

Materials Import Summary			
Facility	Imported	Today	Total
Allocco Recycling, Inc. Brooklyn, NY ¾-inch RCA	No. Loads	0	45
	Quantity (CY)	0	900
	NYSDEC Approved Quantity (CY)		1,000

Materials Export Summary			
Facility	Exported	Today	Total
Cycle Chem, Inc. Elizabeth, NJ Lead Contaminated Soil	No. Loads	0	14
	Quantity (CY)	0	280
Bayshore Soil Management Keasbey, NJ Non-Hazardous Fill/Soil	No. Loads	0	314
	Quantity (CY)	0	6,280
Clean Earth of North Jersey Kearny, NJ Hazardous Lead Historic Fill	No. Loads	0	5
	Quantity (CY)	0	125

Sampling

- No samples were collected.

Cc:	L. Haley, K. Semon, B. Gochenaur (Langan)	By:	Lauren Roper
			LANGAN

SITE OBSERVATION REPORT

CAMP Activities

Langan performed on-site air monitoring during ground-intrusive activities for particulate matter smaller than 10 microns in diameter (PM10) or volatile organic compounds (VOCs). Fifteen-minute average concentrations of VOCs did not exceed action levels established by the community air monitoring plan (CAMP). No fugitive dust or odors were observed leaving the site.

- The CAMP was stopped at 12:42 due to inclement weather. Fugitive dust and odors were not observed leaving the site during this time.

Particulate Monitoring (mg/m ³)			Organic Vapor Monitoring (ppm)		
Daily background	0.053		Daily Background	0.0	
Averaging Period	Upwind	Downwind	Averaging Period	Upwind	Downwind
Daily Time Weighted Average	0.053	0.008	Daily Time Weighted Average	0.0	0.0
Maximum 15-min Average	0.069	0.057	Maximum 15-min Average	0.0	0.0
Minimum 1-min Instant Reading	0.003	0.002	Minimum 1-min Instant Reading	0.0	0.0
Maximum 1-min Instant Reading	0.088	0.067	Maximum 1-min Instant Reading	0.0	0.0

mg/m³ = milligrams per cubic meter

ppm = parts per million

NA = Not Available

Anticipated Activities

- Rise will install SOE elements along the site boundaries.

Cc:	L. Haley, K. Semon, B. Gochenaur (Langan)	By:	Lauren Roper
			LANGAN

SITE OBSERVATION REPORT

Figure 1: Site Map

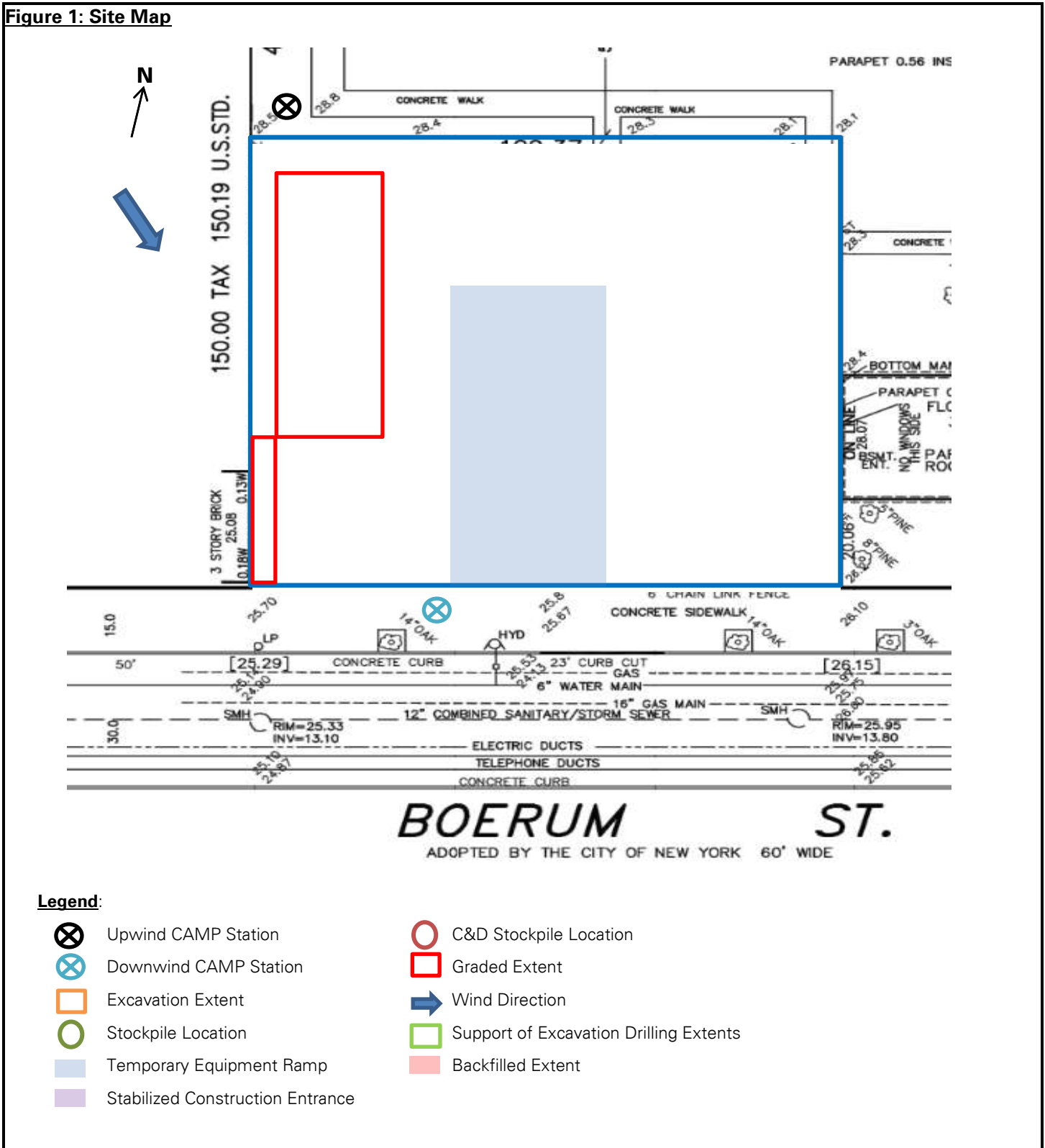

Legend:

- Upwind CAMP Station
- Downwind CAMP Station
- Excavation Extent
- Stockpile Location
- Temporary Equipment Ramp
- Stabilized Construction Entrance
- C&D Stockpile Location
- Graded Extent
- Wind Direction
- Support of Excavation Drilling Extents
- Backfilled Extent

Cc:	L. Haley, K. Semon, B. Gochenaur (Langan)	By:	Lauren Roper LANGAN
-----	---	-----	-------------------------------

SITE OBSERVATION REPORT

SITE PHOTOGRAPHS



Photo 1: View of Rise installing SOE underpinning in the southwestern part of the site (facing northwest).



Photo 2: View of graded area in the western part of the site (facing northwest).

Cc:	L. Haley, K. Semon, B. Gochenaur (Langan)	By:	Lauren Roper
			LANGAN