

SITE OBSERVATION REPORT

PROJECT No.: 170552901		DATE: Monday, April 3, 2023
PROJECT: 159 Boerum Street	CLIENT: SPG Boerum LLC	WEATHER: Partly Cloudy, 36-51°F Wind: WSW @ 5-11 mph
LOCATION: Brooklyn, NY		TIME: 6:45 am to 1:15 pm
CONTRACTOR: SD Builders		LANGAN REP. : Sophia Misiakiewicz
CONTRACTOR'S EQUIPMENT: Hitachi ZX 160LC Excavator Deere 300G Excavator Kubota SVL65-2 Skid Steer Deere 135G Excavator Deere 259 Forklift	PRESENT AT SITE: Sophia Misiakiewicz – Langan James Hsu, Kevin Gray– SD Builders - General Contractor Lucas Alvarez - Rise Concrete (Rise) – Foundation Contractor	
OBSERVATIONS, DISCUSSIONS, TEST RESULTS, ETC.: <p>Langan was present to observe environmental protocols in accordance with the New York State Department of Environmental Conservation (NYSDEC)-approved Remedial Action Work Plan (RAWP) for Brownfield Cleanup Program (BCP) site C224291 at 159 Boerum Street (Block 3071, Lot 40). Observed activities were as follows:</p> <p>Site Activities</p> <ul style="list-style-type: none">Rise imported about 140 cubic yards (CY) of ¾-inch virgin quarry stone from the Tilcon West Nyack Quarry located in West Nyack, New York. The stone was stockpiled in the southern part of site.		
Cc: L. Haley, K. Semon, B. Gochenaur (Langan)	By: Sophia Misiakiewicz	LANGAN

SITE OBSERVATION REPORT

Material Tracking

- Seven truckloads (about 140 CY) of ¾-inch virgin stone was imported from the Tilcon New York - West Nyack Quarry located in West Nyack, New York.
- No material was exported from the site.

Materials Import Summary			
Facility	Imported	Today	Total
Allocco Recycling, Inc. Brooklyn, NY ¾-inch RCA	No. Loads	0	45
	Quantity (CY)	0	900
	NYSDEC Approved Quantity (CY)		1,000
Tilcon – West Nyack Quarry West Nyack, NY ¾-inch Virgin Stone	No. Loads	7	10
	Quantity (CY)	140	200
	NYSDEC Approved Quantity (CY)		1,250

Materials Export Summary			
Facility	Exported	Today	Total
Cycle Chem, Inc. Elizabeth, NJ Lead Contaminated Soil	No. Loads	0	14
	Quantity (CY)	0	280
Bayshore Soil Management Keasbey, NJ Non-Hazardous Fill/Soil	No. Loads	0	344
	Quantity (CY)	0	6,880
Clean Earth of North Jersey Kearny, NJ Hazardous Lead Historic Fill	No. Loads	0	5
	Quantity (CY)	0	125

Sampling

- One groundwater sample (GWDRUM01_040323) was collected from containerized purged groundwater stored in a 55-gallon drum on-site and analyzed for Part 375 Target Compound List (TCL) volatile organic compounds (VOCs) and Resource Conservation and Recovery Act (RCRA) 8 metals. The sample was relinquished to Alpha Analytical Inc. (Alpha) of Westborough, Massachusetts, a New York State Department of Health (NYSDOH) Environmental Laboratory Accredited Program (ELAP)-certified laboratory.

Cc:	L. Haley, K. Semon, B. Gochenaur (Langan)	By:	Sophia Misiakiewicz
			LANGAN

SITE OBSERVATION REPORT

CAMP Activities

Langan performed on-site air monitoring during ground-intrusive activities for particulate matter smaller than 10 microns in diameter (PM10). Fifteen-minute average concentrations of PM10 did not exceed action levels established by the community air monitoring plan (CAMP). No fugitive dust or odors were observed leaving the site.

Particulate Monitoring (mg/m ³)		
Daily background	0.008	
Averaging Period	Upwind	Downwind
Daily Time Weighted Average	0.008	0.009
Maximum 15-min Average	0.072	0.101
Minimum 1-min Instant Reading	0.007	0.008
Maximum 1-min Instant Reading	0.348	0.574

mg/m³ = milligrams per cubic meter

Anticipated Activities

- None.

Cc:	L. Haley, K. Semon, B. Gochenaur (Langan)	By:	Sophia Misiakiewicz
			LANGAN

SITE OBSERVATION REPORT

Figure 1: Site Map

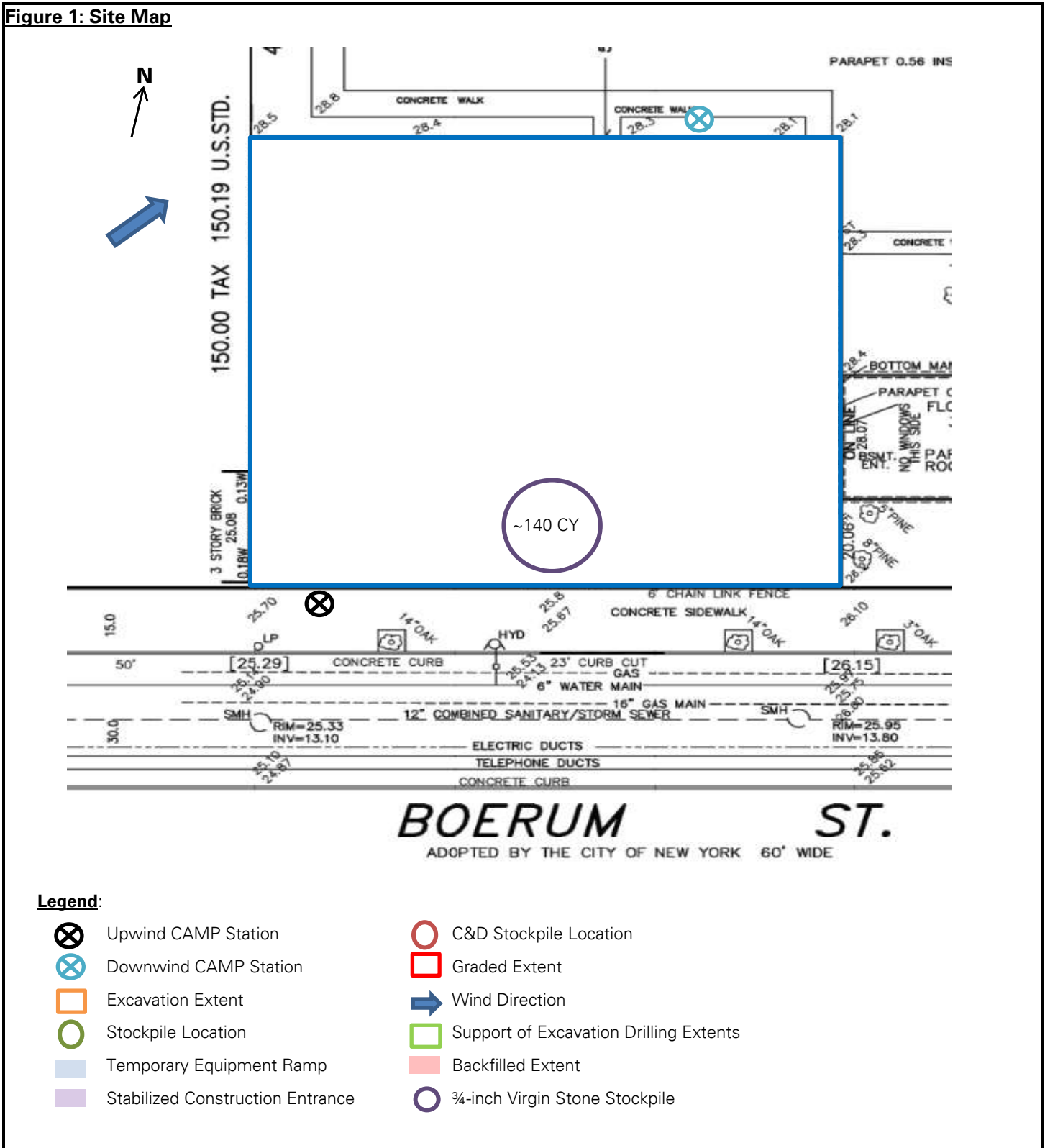

Legend:

- Upwind CAMP Station
- Downwind CAMP Station
- Excavation Extent
- Stockpile Location
- Temporary Equipment Ramp
- Stabilized Construction Entrance
- C&D Stockpile Location
- Graded Extent
- Wind Direction
- Support of Excavation Drilling Extents
- Backfilled Extent
- 3/4-inch Virgin Stone Stockpile

Cc: L. Haley, K. Semon, B. Gochenaur (Langan)

By: Sophia Misiakiewicz

LANGAN

SITE OBSERVATION REPORT

SITE PHOTOGRAPHS



Photo 1: View of $\frac{3}{4}$ -inch virgin stone stockpiled in the southern part of site (facing southeast).

Cc:	L. Haley, K. Semon, B. Gochenaur (Langan)	By:	Sophia Misiakiewicz
			LANGAN