

DAILY FIELD REPORT 106

Prepared By: LANGAN

WEATHER	Snow		Rain	x	Overcast	x	Partly Cloudy		Sunny	
TEMP.	< 32		32-50	x	50-70		70-85		>85	

BCP Project No:	C224304	Date:	December 6, 2021
------------------------	---------	--------------	------------------

Project Name:	45 Commercial Street	Time:	5:30 am to 2:30 pm
----------------------	----------------------	--------------	--------------------

Consultant: Langan Engineering, Environmental, Surveying, Landscape Architecture and Geology, D.P.C. (Langan)

Langan Field Personnel:
Yaskira Mota

Construction Manager: Monadnock Construction Inc. (MC)
Foundation Contractor: StructureTech New York, Inc. (STNY)
Building Contractor: Highbury Concrete, Inc. (Highbury)
Soil Broker: Clean Earth, Inc. (CE)

Work Activities Performed:

- STNY relocated two non-native soil stockpiles within waste characterization grid COMP J South to make room for a utility repair excavation.
- STNY loaded trucks with a portion of a soil stockpile¹ in waste characterization grid COMP J South for off-site disposal to the Clean Earth of Carteret (CEC) facility located in Carteret, New Jersey.
- STNY excavated an about 10-foot-long by 3-foot-wide area to about 3 feet below grade surface (bgs) (from original site grade) in waste characterization grid COMP J South to repair a damaged plumbing utility pipe. Excavated material consisted of imported 0.75-inch stone and non-native soil that did not exhibit signs of chemical- or petroleum-like contamination. Excavated material was added to a soil stockpile¹ in waste characterization grid COMP J South.
- STNY demobilized from the site.

Material Tracking:

- The following soil/fill was exported from the site:
 - Two truckloads of non-native soil were transported to the CEC facility located in Carteret, New Jersey.
- No material was imported to the site.

Samples Collected:

- No samples were collected

¹ MEP Trench 2, COMP J South (0-2)

Air Monitoring

Particulate Monitoring ($\mu\text{g}/\text{m}^3$)			Organic Vapor Monitoring (ppm)		
Daily background	39.8		Daily background	0.0	
Averaging Period	Upwind	Downwind	Averaging Period	Upwind	Downwind
Daily Time Weighted Average	52.5	26.3	Daily Time Weighted Average	0.1	0.9
Maximum 15-min Average	69.5	72.	Maximum 15-min Average	1.3	9.1
Minimum 1-min Instant Reading	0.3	0.0	Minimum 1-min Instant Reading	0.0	0.0
Maximum 1-min Instant Reading	80.8	98.7	Maximum 1-min Instant Reading	2.4	16.6

$\mu\text{g}/\text{m}^3$ =micrograms per cubic meter. ppm= parts per million.

Data collection did begin until 9:03 due to ongoing precipitation in the morning. Data was not collected at the downwind station from 10:58 to 11:19 and from 13:03 to 14:03 due to connectivity issues. The manufacturer was contacted and the issue was resolved. Organic vapor exceedances were reported at the downwind station from 9:18 to 9:27 due to a calibration issue, which was resolved. No particulate or other organic vapor exceedances at the downwind station were encountered. The daily Community Air Monitoring Program (CAMP) monitoring results are also presented in the following charts:

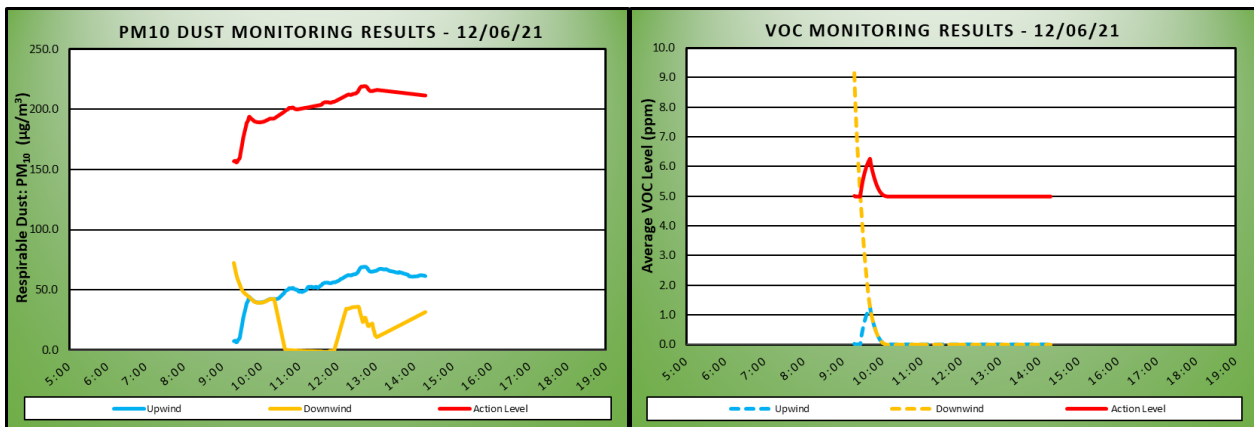

Planned Activities:



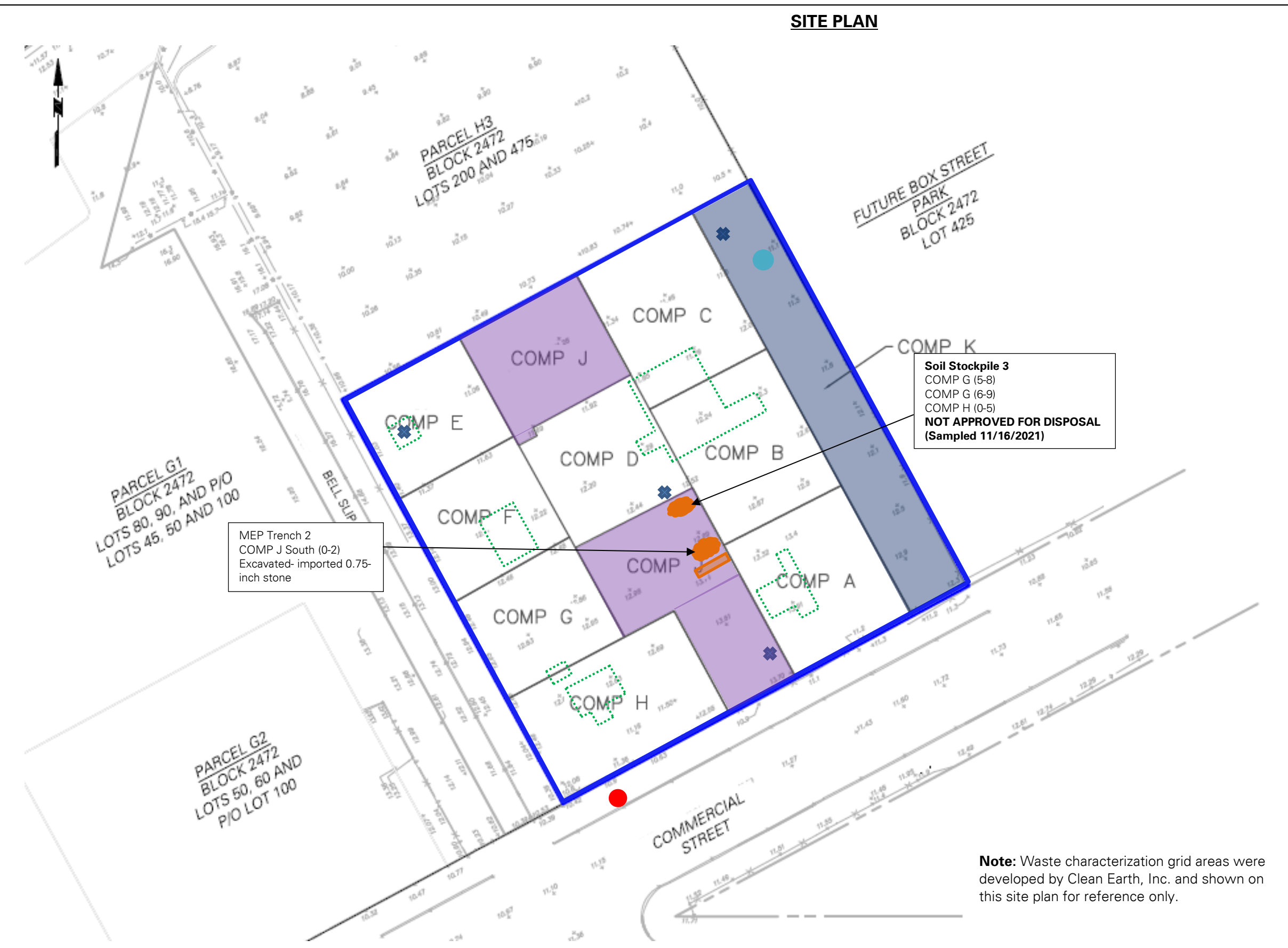

- The selected landscaping contractor will regrade waste characterization grid COMP J North (courtyard), install demarcation barriers in waste characterization grids COMP J North and COMP J South, and backfill with at least 2 feet of clean cover.
- MC will continue exporting soil for off-site disposal.
- MC will pour concrete at a remaining area of exposed vapor barrier in waste characterization grid COMP F.

SITE PLAN



Soil Stockpile 3
 COMP G (5-8)
 COMP G (6-9)
 COMP H (0-5)
NOT APPROVED FOR DISPOSAL
 (Sampled 11/16/2021)

MEP Trench 2
 COMP J South (0-2)
 Excavated- imported 0.75-inch stone

-  **Site Boundary**
-  **Waste Characterization Grid
COMP I (5-10)**
-  **Upwind CAMP station**
-  **Downwind CAMP station**
-  **Stockpile - Soil**
-  **Stockpile - Imported Material**
-  **Approximate Location of
Excavation**
-  **Approximate Area of Backfilling**
-  **Approximate Area of Regrading**
-  **Approximate Location of
Concrete Pouring**
-  **Approximate Area of Installed
Demarcation Layer**
-  **2 Foot Remedial Excavation
Completed**
-  **2 Foot Remedial Excavation
Completed, Demarcation Layer
Installed, and 2 Feet of Clean
Cover Layer Placed**

Note: Waste characterization grid areas were developed by Clean Earth, Inc. and shown on this site plan for reference only.

DOCUMENTATION SAMPLE PLAN

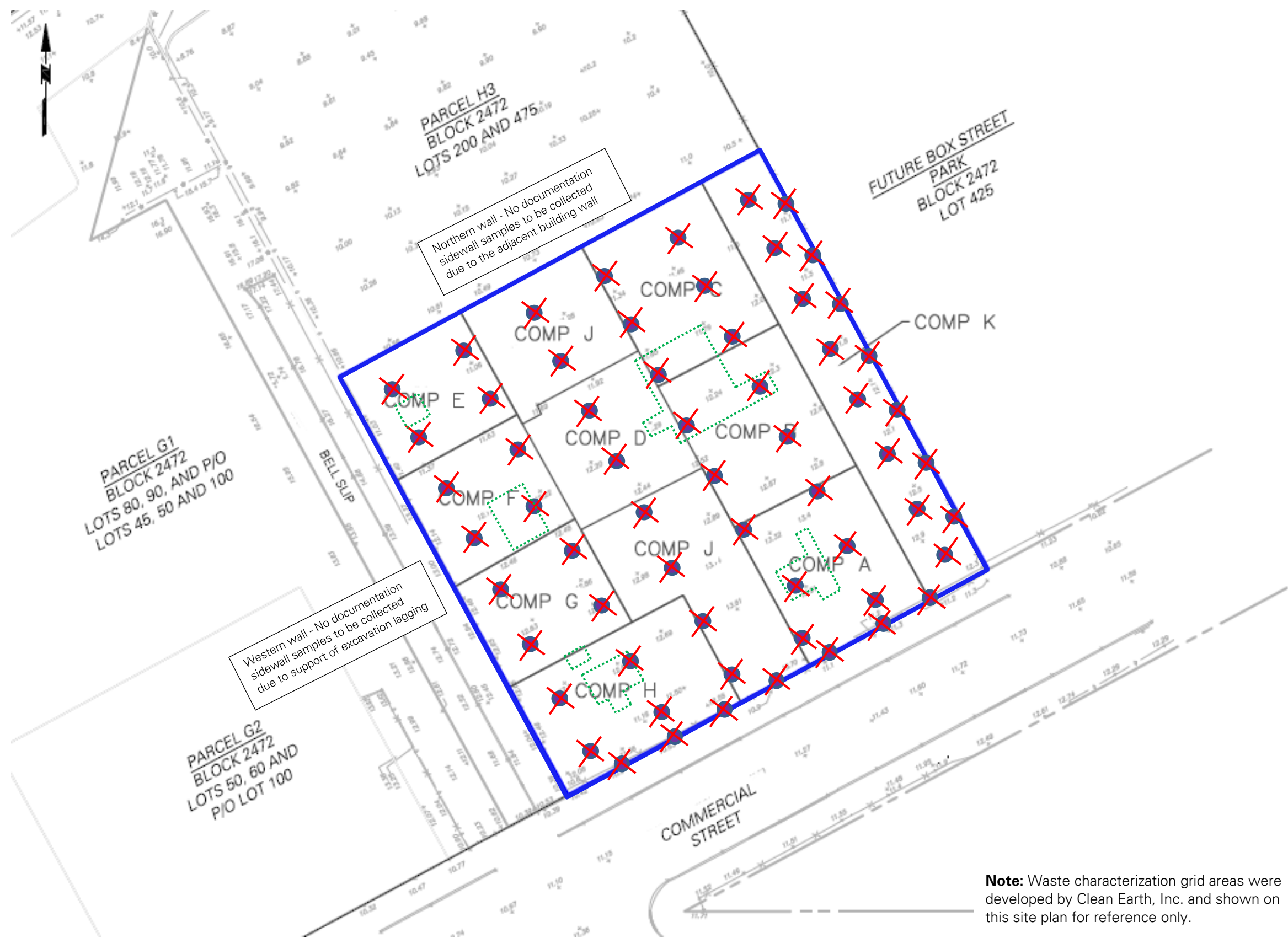



- Site Boundary**
- Waste Characterization Grid
COMP I (5-10)**
- Proposed Base Documentation
Sample Location**
- Proposed Base Documentation
Sample Location**
- Documentation Sample
Collected Today**
- X **Previously Collected
Documentation Sample**

Note: Waste characterization grid areas were developed by Clean Earth, Inc. and shown on this site plan for reference only.

WATERPROOFING/VAPOR BARRIER AND SMD INSTALLATION MAP





-  Site Boundary

-  Approximate Location of Sub-Slab Vapor Collection Slotted Pipe Run – Blower A

-  Approximate Location of Sub-Slab Vapor Collection Slotted Pipe Run – Blower B

-  SMD System Installation In Progress (Geotextile/Aggregate)

-  SMD System Installation In Progress (SMD Piping)

-  SMD System Installation In Progress (Waterproofing/Vapor Barrier)

-  Concrete Foundation Slab Poured

Note: Base Map Source: Drawing FO-100.00, Foundation (1st Floor) Plan, Dated December 20, 2019, Prepared by WSP USA.

Photo Log

Photo 1:

View of STNY loading a truck with soil for off-site disposal to the CEC facility (facing north).



Photo 2:

View of STNY excavating in waste characterization grid COMP J South to repair a utility pipe (facing north).



Photo 3:

View of utility repair excavation in waste characterization grid COMP J South (facing north).



Photo 4:

View of soil stockpiles in waste characterization grid COMP J South (facing northwest).



Curley, Ruth E (DEC)

From: Tyler Goodnough <tgoodnough@langan.com>
Sent: Wednesday, December 15, 2021 2:47 PM
To: Curley, Ruth E (DEC)
Cc: Woo Kim; Greg Wyka; Yaskira Mota diaz; O'Neil, Eamonn M (HEALTH)
Subject: 45 Commercial Street (C224304) - Remedial Action - Daily Field Reports - 12/6 and 12/13
Attachments: 2021-12-06 - 45 Commercial Street - C224304 - Daily Field Report_106.pdf; 2021-12-13 - 45 Commercial Street - C224304 - Daily Field Report_107.pdf; 2021-12-06 - C224304.pdf; C224304 - 2021-12-13.pdf

ATTENTION: This email came from an external source. Do not open attachments or click on links from unknown senders or unexpected emails.

Hi Ruth,

Attached are the daily field reports and CAMP summary sheets for the remedial action at 45 Commercial Street (C224304) for 12/06 and 12/13. No ground intrusive/RAWP associated work was performed at the site from 12/07 through 12/10.

Thanks,

Tyler Goodnough
Senior Staff Scientist

LANGAN

Direct: 212.479.5499 x5712

Mobile: 917.922.1697

[File Sharing Link](#)

Phone: 212.479.5400 Fax: 212.479.5444

21 Penn Plaza

360 West 31st Street, 8th Floor

New York, NY 10001-2727

www.langan.com

NEW YORK NEW JERSEY CONNECTICUT MASSACHUSETTS PENNSYLVANIA WASHINGTON, DC
VIRGINIA OHIO ILLINOIS FLORIDA TEXAS ARIZONA COLORADO WASHINGTON CALIFORNIA
ATHENS CALGARY DUBAI LONDON PANAMA

A Carbon-Neutral Firm | **Langan's goal is to be SAFE (Stay Accident Free Everyday)**

Build your career with a premier firm. [Join Langan.](#)



This message may contain confidential, proprietary, or privileged information. Confidentiality or privilege is not intended to be waived or lost by erroneous transmission of this message. If you receive this message in error, please notify the sender immediately by return email and delete this message from your system. Disclosure, use, distribution, or copying of a message or any of its attachments by anyone other than the intended recipient is strictly prohibited.