	Daily Activity Report					
	975 Nostrand Avenue					
	Brooklyn, NY					
BCP Site No. C224335						
General Site Information						
Date:	Tuesday, August 1, 2023					
Weather:	67-83°F, Clear					
Wind Direction/Speed (from):	North @ 8 mph					
AKRF Personnel on Site:	Chad Walters					
AKRF Equipment on Site:	Mini RAE 3000 Photoionization Detectors [(PID) x3] and DustTrak Aerosol Monitors (x3)					
Visitors:	None.					
Contractor Information						
Subcontractor				Service		
Olivero Construction (Olivero)				SOE Installation		
Broadway Builders (Broadway)				General Contractor (GC)		
Description and Location of Work Activities Performed						
<p>Approximately 60 cubic yards of soil were excavated and exported from Grid 2 for off-site disposal at the Impact Recovery and Reuse Center (IRRC) facility located in Lyndhurst, NJ. A total of 47.42 tons of GPA stone were imported to Grid 1 from Tilcon West Nyack Quarry, NY. Concrete was poured along the western site wall in Grids 5, 6, and 7. Grading occurred in Grid 4.</p>						
Material Disposal Tracking Information						
Destination Facility	Daily Trucks	Total Trucks	Daily Approx. Cubic Yds	Total Approx. Cubic Yds	Total Site Loads	Total Approximate Cubic Yards
Alocco Recycling - C&D 540 Kingsland Ave, Brooklyn, NY	0	16	0	320	2433	48,660
IRRC (Impact Recovery and Reuse Center) - C&D Lyndhurst, NJ	0	13	0	260		
IRRC (Impact Recovery and Reuse Center) - soil/fill Lyndhurst, NJ	3	791	60	15,820		
KSR Corp Development - soil/fill 936 Harrison Ave, Kearny, NJ	0	22	0	440		
Bayshore Soil Management - soil/fill 75 Crows Mill Road, Keasbey, NJ	0	1,517	0	30,340		
Clean Earth of Carteret - soil/fill 24 Middlesex Avenue, Carteret NJ	0	74	0	1,480		
Import Material Tracking Information						
Origin Facility	Daily Trucks	Total Trucks	Daily Tonnage	Total Tonnage	Total Site Loads	Total Quantity (tons)
IRRC (Impact Recovery and Reuse Center) - 3/4" Clean Blue Stone	0	9	0	166.45	221	5,066.27
IRRC (Impact Recovery and Reuse Center) - 1.5" Clean Blue Stone	0	17	0	415.81		
IRRC - DGA	0	2	0	46.55		
Stone Industries, Inc. - 2.5" Crushed Stone	0	7	0	158.19		
Impact Materials Jersey City - 3/4" Clean Blue Stone	0	2	0	45.20		
Vulcan Materials (Hamburg Quarry) - GPA	0	87	0	2,145.00		
Tilcon Mt. Hope Quarry - GPA	0	1	0	25.86		
Tilcon West Nyack Quarry - GPA	2	78	47.42	1650.80		
Evergreen Recycling of Corona - 2.5" Quarried Stone	0	1	0	20.87		
Impact Materials Jersey City - DGA	0	17	0	391.54		
CAMP Air Monitoring Results						
CAMP Station	UPWIND			DOWNWIND		
Odors:	None			None		
VOC Action Level Exceedance(s):	None			None		
Particulate Action Level Exceedance(s):	None			None		
Maximum VOC Level (ppm) 15-min avg:	0.2447			0.0000		
Maximum Particulate Level (mg/m ³) 15-min avg:	0.0875			0.0095		
CAMP Response Actions: None.						
Additional Information						
Planned Work Activity for Next Day/Week:	Installation of SOE, soil excavation, installation of the vapor barrier membrane, rebar work, and installation of the SSDS.					
Comments:	None.					

Site Grid Plan

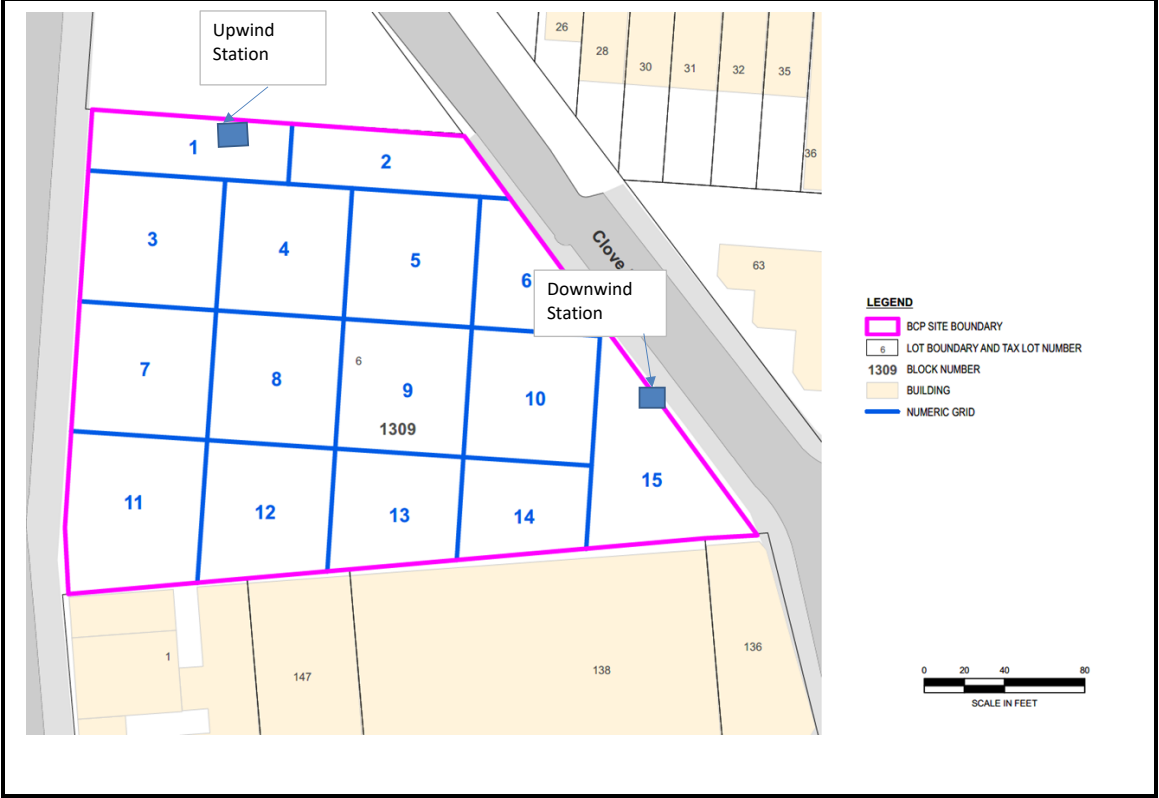

Upwind CAMP Station Data

08/01/2023 0:00:42 – 08/02/2023 0:00:00
(GMT-05:00) Eastern Time (US & Canada)

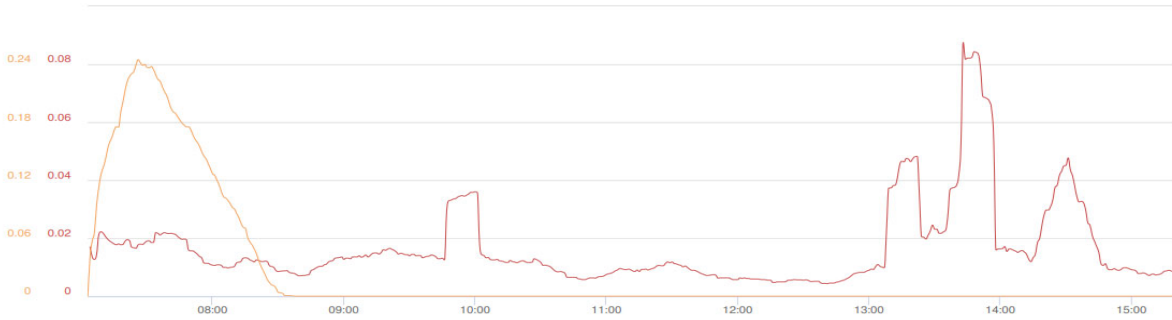

Mass Conc. Total mg/m³ AVG 15m

mg/m³
DustTrak-8530
RS232(C)

MIN	AVG	MAX
0.0043	0.0165	0.0875

VOC ppm AVG 15m ppm

miniRAE 3000
RS232(A)

MIN	AVG	MAX
0	0	0.2447

Name Nostrand UW (FA03920)
S/N 0B444802
Description (FA03920)
Location 54 Clove Rd, Brooklyn, NY 11225, USA

© Netronix 2023

Downwind CAMP Station Data

08/01/2023 0:00:27 – 08/02/2023 0:00:00
(GMT-05:00) Eastern Time (US & Canada)



Mass Conc. Total mg/m³ AVG 15m

mg/m³
DustTrak-8530
RS232(C)

MIN	AVG	MAX
-0.0011	0.0007	0.0095

VOC ppm AVG 15m ppm

miniRAE 3000
RS232(A)

MIN	AVG	MAX
0	0	0

Name Nostrand DW (FA02974)
S/N 0B126096
Description FA02974
Location 958 Nostrand Ave., Brooklyn, NY 11225, USA

© Netronix 2023

Photograph 1 -
Loading soil onto
trucks for export,
view facing east.



Photograph 2 -
Excavation for SSDS
trench in Grid 4, view
facing west.



Photograph 3 -
Pouring concrete for
the western
foundation wall in
Grids 3 and 7, view
facing south.

