

DAILY STATUS REPORT

Prepared By: Lauren Kott

WEATHER	Snow	Rain	Overcast	Partly Cloudy	x	Bright Sun
TEMP.	< 32	40-50	50-70	x	70-85	>85

Langan Project No:	100688801	Project:	12074 Flatlands Avenue p/o Lot 1	Date:	10/31/2022
NYSDEC BCP Site No:	C224353			Time:	06:45 – 1:00

Consultant:

Langan Engineering, Environmental, Surveying, Landscape Architecture and Geology, D.P.C.

PERSONNEL ON SITE:

Langan: Patrick Lenihan (Geotechnical)
Craig: George Zackman, John Millington (Drillers)

EQUIPMENT ON SITE: Two (2) CME truck-mounted drill rigs

Site Activities

- Langan mobilized to the site with Craig Geotechnical Drilling Co., Inc. (Craig), the geotechnical drilling contractor.
- Craig used a CME truck-mounted drill rig to advance soil borings B-2 to a depth of 75-feet bgs, B-8 to a depth of 75-feet bgs, and B-18 to a depth of 55-feet bgs. No soil impacts were observed during the installation of the borings.
- Craig used a CME truck-mounted drill rig to advance soil boring B-15 to a depth of 75-feet bgs. Elevated PID readings (between 0.2 and 1.0 parts per million [ppm]) were observed between 25 and 27 feet bgs within the soil boring. All soil between 25 to 27 feet was placed within a glass sample jar.

Samples Collected

- None.

Community Air Monitoring Program (CAMP)

- Langan implemented the CAMP during soil disturbance. The CAMP equipment consisted of a DustTrack II and photoionization detector (PID) at dedicated locations on the downwind perimeter and upwind perimeter of the site, as well as a personal DataRam (pDR) and Photoionization Detector (PID) at a work zone monitoring station.
- Dust and VOC concentrations were not detected in exceedance of the daily STEL.

Problems Encountered

- None.

Activities Scheduled for Next Day

- Craig will continue the installation of soil borings.

Photo Log

Photo 1 – Craig drilling at B-15, facing west.



Photo 2 – Craig drilling at B-18, facing northeast.





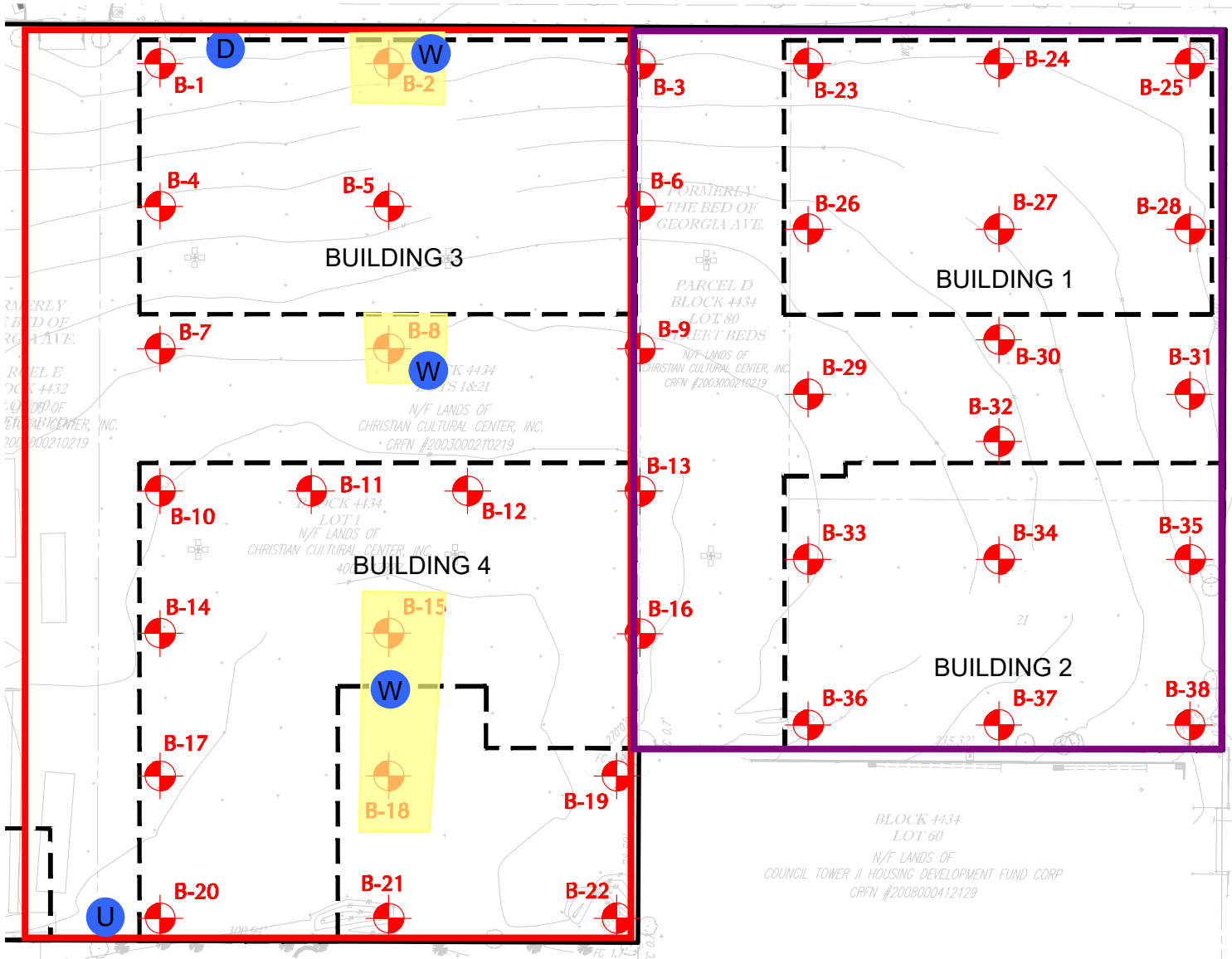





SITE MAP



Approximate and Not to Scale

LEGEND

- | | | | |
|---|---|---|---|
|  | BCP Site No. C224353 (12074 Flatlands Avenue p/o Lot 1) Site Boundary |  | Work Zone Air Monitoring Station |
|  | BCP Site No. C224290 (12096 Flatlands Avenue) Site Boundary |  | Downwind Perimeter Air Monitoring Station |
|  | Proposed Building Area |  | Upwind Perimeter Air Monitoring Station |
|  | Geotechnical Boring |  | Work Area |

NOTES

1. Basemap taken from Figure 1 - Proposed Phase IA & Phase IB Subsurface Investigation Plan.