

## DAILY STATUS REPORT

Prepared By: Daniel Horvath

WEATHER	Snow	Rain	Overcast	<b>X</b>	Partly Cloudy	<b>X</b>	Bright Sun	
TEMP.	< 32	32-50	50-70		70-85	<b>X</b>	>85	<b>X</b>

Langan Project No:	100688803	Project:	12074 Flatlands Avenue p/o Lot 1	Date:	08/06/2024
NYSDEC BCP Site No:	C224353			Time:	06:30 – 17:30

<b>Consultant:</b> Langan Engineering, Environmental, Surveying, Landscape Architecture and Geology, D.P.C.	<b>PERSONNEL ON SITE:</b> <b>Langan:</b> Daniel Horvath (Environmental) <b>Monadnock:</b> Michael Sullivan <b>United Concrete:</b> Claudio Cappiello, Miguel Flores and laborers
--	---

**EQUIPMENT ON SITE:** Bobcat T76 Skid Steer, Komatsu PC 490 LC Excavator

### Site Activities

- 6 truckloads of non-hazardous material were removed for off-Site disposal to Clean Earth Philadelphia in Philadelphia, PA.
  - United excavated an approximately 50-foot long by 15-foot-wide area between 6 feet below ground surface (bgs) and 12 feet below ground surface (bgs) in disposal grids WC20, WC21, WC26, and WC27. No staining, odors, or elevated PID readings were observed during excavation. All excavated material was loaded for off-Site disposal to Clean Earth Philadelphia in Philadelphia, PA.
- United placed filter fabric above the exposed soil on the Support of Excavation (SOE) slope for the adjacent Site to the east (BCP Site No. C224290) along the eastern boundary of the Site.

### Samples Collected

- None

### Community Air Monitoring Program (CAMP)

- Langan implemented the CAMP during import during soil disturbance. CAMP equipment consisted of a DustTrack II and photoionization detector (PID) at dedicated locations on the downwind and upwind perimeter of the Site, as well as a personal DataRam (pDR) and photoionization detector (PID) at a work zone monitoring station.
  - Dust and VOC concentrations were not detected in exceedance of the daily short-term exposure limit (STEL).

### Problems Encountered

- None

## **Activities Scheduled for Next Day**

- Trucks will traverse through the logistical zone of the Site to the adjacent Site to the east (BCP Site No. C224290) for the installation of SOE and the installation of the deep foundation piles and dewatering wells.
- United will continue placing filter fabric above the exposed soil on the Support of Excavation (SOE) slope for the adjacent Site to the east (BCP Site No. C224290) along the eastern boundary of the Site.

## **Two Week Outlook**

- Trucks will continue to traverse through the logistical zone of the Site to the adjacent Site to the east (BCP Site No. C224290) for the loading and export of material, the installation of SOE, and the installation of the deep foundation piles and dewatering wells.

Truck Count Log of Imported Material										
Facility/Material:	Tilcon New York Inc., Mount Hope Quarry <i>(1.5-inch Clean Stone)</i>		Tilcon New York Inc., Mount Hope Quarry <i>(0.75-inch Clean Stone)</i>		Braen Stone of Sparta Lafayette, New Jersey <i>(1.5-inch Clean Stone)</i>		Braen Stone of Sparta Lafayette, New Jersey <i>(0.75-inch Clean Stone)</i>		---	
Volume:	Trucks	Cu. Yds.	Trucks	Cu. Yds.	Trucks	Cu. Yards	Trucks	Cu. Yards	Trucks	Cu. Yards
Today:	0	0	0	0	0	0	0	0	---	---
Total:	0	0	0	0	25	500	0	0	---	---
Approved Quantity:	---	500	---	500	---	500	---	500	---	---
Facility/Material:	---		---		---		---		---	
Volume:	Trucks	Cu. Yds.	Trucks	Cu. Yds.	Trucks	Cu. Yards	Trucks	Cu. Yards	Trucks	Cu. Yards
Today:	---	---	---	---	---	---	---	---	---	---
Total:	---	---	---	---	---	---	---	---	---	---
Approved Quantity:	---	---	---	---	---	---	---	---	---	---

Note: 20 cubic yards assumed per truckload

Truck Count Log of Exported Material											
Facility/Material:	Clean Earth Philadelphia Philadelphia, Pennsylvania Approval # 243100026 (7,000 tons)		Clean Earth Carteret Carteret, New Jersey Approval #243070587 (4,000 tons)		---		---		---		
	Trucks	Cu. Yds.	Trucks	Cu. Yds.	Trucks	Cu. Yds.	Trucks	Cu. Yds.	Trucks	Cu. Yds.	
<b>Today:</b>	6	120	0	0	---	---	---	---	---	---	
<b>Total:</b>	67	1,340	20	400	---	---	---	---	---	---	

Note: 20 cubic yards assumed per truckload

## Photo Log

Photo 1 – United loading non-hazardous material for off-Site disposal to Clean Earth Philadelphia, facing southeast.



Photo 2 – United excavating at the eastern boundary of the Site, facing south.



Photo 3 – United placing filter fabric above exposed soil in the southeastern portion of the Site, facing west.

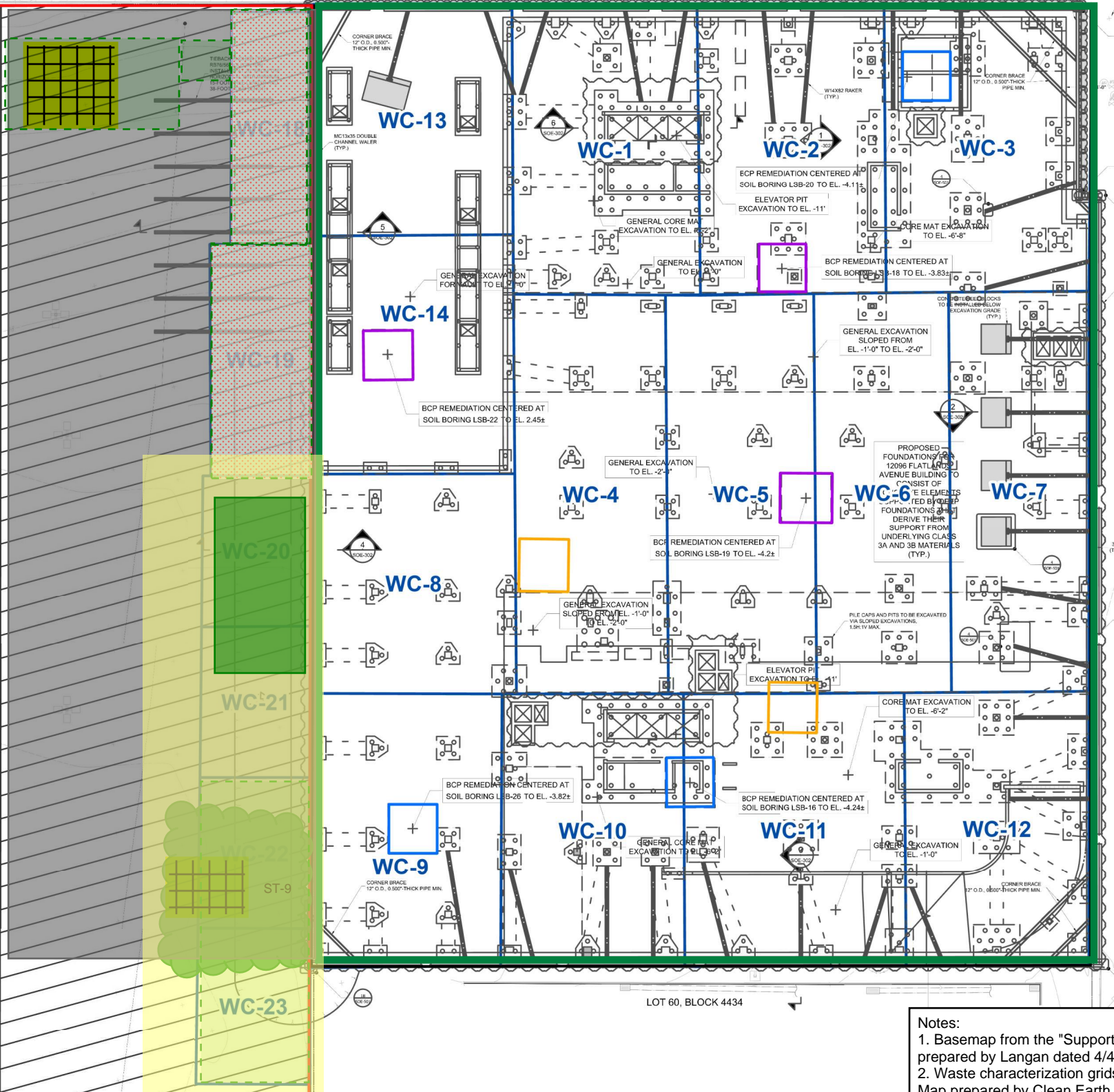
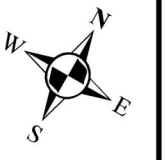

Photo 4 – Filter fabric placed above exposed soil in the southeastern portion of the Site, facing southeast.





# DAILY SITE MAP



- ### Legend
- Excavation Completed Today
  - Excavation Previously Completed
  - Soil Stockpile
  - Area Covered with Filter Fabric
  - 12074 Flatlands Avenue Site Boundary
  - 12096 Flatlands Avenue Site Boundary
  - Logistical Zone
  - Disposal Grid
  - Hotspot for Disposal
  - Remedial Hotspot
  - Colocated Remedial Hotspot and Hotspot for Disposal
  - W Work Zone Air Monitoring Station
  - D Downwind Perimeter Air Monitoring Station
  - U Upwind Perimeter Air Monitoring Station
  - Work Area
  - Clean stone
  - Delineation Borings Completed Today
  - FODS Trackout

**Notes:**

1. Basemap from the "Support of Excavation Plan (Option B)" drawing prepared by Langan dated 4/4/2024.
2. Waste characterization grids are shown as presented in the Draft Disposal Map prepared by Clean Earth.
3. ST-3 contains non-hazardous material excavated from the northern portion of the Site for the construction of the truck wash and is located outside of the logistical zone.
4. ST-9 is being utilized as the construction ramp and contains non-hazardous material excavated from disposal grids WC-20, WC-21, WC-26, and WC-27.

Approximate and Not to Scale